

Sales Selection Sheet
Checklist

1 of 55

LOT 342 Model: 25-2653 D The Wakefield

PURCHASERS: SYED SAYEEDUDDIN/

VENDOR: Heathwood Homes (Huron) Limited

OPTIONAL DOUBLE SINKS IN MASTER ENSUITE BATHROOM

OPTIONAL COFFERED CEILING IN GREAT ROOM

BEDROOM 4 AND 5 COMBINED/ PROVISIONS FOR STACKED WASHER/DRYER IN LAUNDRY ROO

☒ FINISHED BASEMENT

☒ COLD CELLAR

UPGRADED / MODIFIED ELEVATION

☐ CORNER UPGRADE

☐ REAR UPGRADE

CEILING UPGRADE - SMOOTH

☒ MAIN FLOOR

☐ SECOND FLOOR

☐ BASEMENT

ADDITIONAL ROUGH-INS

☒ 200 AMP SERVICE

☐ WET BAR ROUGH-IN

☐ HUMIDIFIER

☒ AIR CONDITIONING

GAS ROUGH-IN

☒ STOVE

☐ DRYER

☐ BBQ

☐ ADDITIONAL FIREPLACE

KITCHEN: HOODFAN VENTING SIZE

☒ 6 IN ROUND DUCT

☐ 7 IN ROUND DUCT

FULL BASEMENT STAIRS:

Carpet Grade

UPPER BASEMENT STAIRS:

N/A

LOWER BASEMENT STAIRS:

N/A

MAIN STAIRS:

All Oak

MEDIA STAIRS (if applicable):

N/A

LOFT STAIRS (if applicable):

N/A

Feb 3/22 Date Purchaser: *Signature on file*

Feb 3/22 Date Decor Consultant: *TINA LEFUR*

Date Purchaser:

APPROVED

-02- 03 2022

Date

Heathwood Homes (Huron) Limited

Locked Date:

Approved

SYED SAYEEDUDDIN/
Project: Wallaceton
Unit: 342, Phase: 3
Model: 25-2653 D The Wakefield

Created: 12/1/2021 09:15:50
Locked:
Closed:

2 of 55

Kitchen/Servery

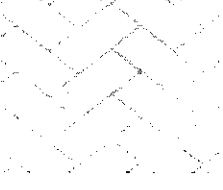
Cabinet Colour/Style	6823	Classic Plus-BOSTON-MACADEMIA-PAINT MDF ***UPG***
Countertop	8903	Group 4-Quartz-Caesarstone-MISTY CARRERA # 4141-3/4 inch with built-up edge ***4***
Countertop Edge	4005	DOUBLE MITRE 1 1/2 INCH ***UPG*** 
Cabinet Hardware	2086	9677-HARDWARE ***STD***
Island Cabinet Colour/Style	6823	Classic Plus-BOSTON-MACADEMIA-PAINT MDF ***UPG***
Island Countertop	8903	Group 4-Quartz-Caesarstone-MISTY CARRERA # 4141-3/4 inch with built-up edge ***4***
Backsplash	5721	QT.CD.ARW.0306.BR-Colour and Dimension Bright-Arctic White-3 x 6 ***STD***
Backsplash Grout	2226	Grout-(00) White ***STD***
Backsplash Tile Pattern	3100	HERRINGBONE ***UPG*** 
HoodFan	9416	AVH-368CS-AVG 36 inch STAINLESS STEEL CHIMNEY WALL MOUNTED HOODFAN PAGES 41-42
Appliances	9416	Purchasers have been advised: standard fridge opening is a minimum 37 3/8 x 73 3/8". Ice Waterline Rough-In is included.
Appliances	9416	Standard stove opening is 30" and standard dishwasher opening is 24". Any gas stove will require backsplash or stainless steel backing to avoid fire hazards.
Appliances	9416	Purchasers acknowledge: Heathwood Homes and its contractors will not be responsible for any kitchen cabinet changes due to appliances dimension changes after
Comment		

Opt. Servery Upper

Cabinet - Uppers	6823	Classic Plus-BOSTON-MACADEMIA-PAINT MDF ***UPG***
Cabinet Hardware	2086	9677-HARDWARE ***STD***
Comment	NO BACKSPLASH IN SERVERY	

SYED SAYEEDUDDIN/
Project: Wallaceton
Unit: 342, Phase: 3
Model: 25-2653 D The Wakefield

Created: 12/1/2021 09:15:50
Locked:
Closed:

3 of 55

Kitchen/Breakfast/Servery

Flooring	8499	Red Oak UVF-Vintage Red Oak Solid Sculpted Character UVF-PEWTER-3/4 inch X 5 inch ***g***
Floor Tile Grout		
Floor Tile Pattern		

Comment

Foyer

Flooring	9243	OV.ET.VLK.2424.MT-ETERNA VOLKAS MATTE 24X24 ***6***
Floor Tile Grout	7705	Grout-(01) Alabaster ***UPG***
Floor Tile Pattern	3000	STANDARD SQUARE ***STD***

Comment

Laundry Room

Flooring	3000	GE.MD.WHT.1818.MT Madison Series White Matte 18
Floor Tile Grout	2225	Grout-(27) Silver ***STD***
Floor Tile Pattern	3000	STANDARD SQUARE ***STD***

Comment

Laundry Room Opt.

Cabinet - Uppers	1111	N/A *****
------------------	------	-----------

SYED SAYEEDUDDIN/
Project: Wallaceton
Unit: 342, Phase: 3
Model: 25-2653 D The Wakefield

Created: 12/1/2021 09:15:50
Locked:
Closed:

4 of 55



Cabinet Hardware 1111 N/A *****

Comment

Mud Room

Flooring 9243 OV.ET.VLK.2424.MT-ETERNA VOLKAS MATTE 24X24
6

Floor Tile Grout 7705 Grout-(01) Alabaster ***UPG***

Floor Tile Pattern 3000 STANDARD SQUARE ***STD***

Comment

Powder Room

Flooring 9243 OV.ET.VLK.2424.MT-ETERNA VOLKAS MATTE 24X24
6

Floor Tile Grout 7705 Grout-(01) Alabaster ***UPG***

Floor Tile Pattern 3000 STANDARD SQUARE ***STD***

Plumbing Fixture (Colour) 1737 Plumbing Fixtures-WHITE ***STD***

Comment

Dining Room/Hall

Flooring 8499 Red Oak UVF-Vintage Red Oak Solid
Sculpted-PEWTER-3/4 inch X 5 inch **UPG**

Comment

Great Room

Flooring 8499 Red Oak UVF-Vintage Red Oak Solid
Sculpted-PEWTER-3/4 inch X 5 inch **UPG**

Customer Colours

392

SYED SAYEEDUDDIN/
Project: Wallaceton
Unit: 342, Phase: 3
Model: 25-2653 D The Wakefield

Created: 12/1/2021 09:15:50
Locked:
Closed:

5 of 55

Comment

Upper Hall

Flooring

8499

Red Oak UVF-Vintage Red Oak Solid Sculpted Character
UVF-PEWTER-3/4 inch X 5 inch ***4***

Comment

Opt. Finished Basement (Rec) Room/Hall

Flooring

9252

DY 16787 -Dynasty Tex-MYSTIC BEIGE-40 oz
Poly***STD***

Comment

Master Bedroom

Flooring

9252

DY 16787 -Dynasty Tex-MYSTIC BEIGE-40 oz
Poly***STD***

Comment

Bedroom 2

Flooring

9252

DY 16787 -Dynasty Tex-MYSTIC BEIGE-40 oz
Poly***STD***

Comment

Bedroom 3

Flooring

9252

DY 16787 -Dynasty Tex-MYSTIC BEIGE-40 oz
Poly***STD***

Comment

Bedroom 4

Flooring

9252

DY 16787 -Dynasty Tex-MYSTIC BEIGE-40 oz
Poly***STD***

SYED SAYEEDUDDIN/
Project: Wallaceeton
Unit: 342, Phase: 3
Model: 25-2653 D The Wakefield

Created: 12/1/2021 09:15:50
Locked:
Closed:

6 of 55

Comment

Bedroom 5

Flooring

9252

DY 16787 -Dynasty Tex-MYSTIC BEIGE-40 oz
Poly***STD***

Comment

Ensuite 5

Cabinet Colour/Style

6261

Viking III-MANCHESTER-OYSTER CL-MAPLE ***STD***

Countertop

8822

4924-38-Countertop-WHITE CARRARA-Wilsonart
STD

Countertop Edge

1111

N/A *****

Cabinet Hardware

2086

9677-HARDWARE ***STD***

Floor Tile

2086

GE.MD.LGR.1818.MT Madison Series Light Grey Matte 18

Floor Tile Grout

2225

Grout-(27) Silver ***STD***

Floor Tile Pattern

3000

STANDARD SQUARE ***STD***

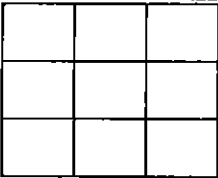

Shower Floor Tile

8661

OD.ON.SWT.0202.MT.N-Ontario Series Mosaic-Snow
White Matte-2 x 2 ***STD***

Shower Floor Tile Grout

2226

Grout-(00) White ***STD***

Shower Floor Tile Pattern

3000

STANDARD SQUARE ***STD***

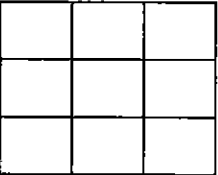

Shower Wall Tile

9022

QT.WV.TGR.0810-Weave-Tender Grey-8 x 10 ***STD***

Shower Wall Tile Grout

2226

Grout-(00) White ***STD***

Shower Wall Tile Pattern

3070

HORIZONTAL STACKED ***STD***

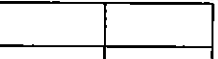

SYED SAYEEDUDDIN/
Project: Wallaceton
Unit: 342, Phase: 3
Model: 25-2653 D The Wakefield

Created: 12/1/2021 09:15:50
Locked:
Closed:

7 of 55

Shower Jamb(s) and Sill(s)	8923	Shower Jamb / Sill-Thassos White ***STD***
Plumbing Fixture (colour)	1737	Plumbing Fixtures-WHITE ***STD***
Comment		

Master Ensuite

Cabinet Colour/Style	6319	Viking III-MANCHESTER-CAVIAR CL-MAPLE ***STD***									
Countertop	8897	Group 4-Quartz-Caesarstone-ORGANIC WHITE # 4600-3/4 inch with built-up edge ***4***									
Countertop Edge	4006	GROUP 4- DOUBLE MITRE 1 1/2 INCH ***2***									
Cabinet Hardware	7672	135-HARDWARE ***STD***									
Floor Tile	8913	UN.BL.BIA.1224-Biel-Bianco (White)-12 x 24 See Tile Direction on Sketch 4 Page 28 ***2***									
Floor Tile Grout	2225	Grout-(27) Silver ***STD***									
Floor Tile Pattern	3040	FRONT TO BACK ***STD***									
		<table><tr><td></td><td></td><td></td><td></td></tr><tr><td></td><td></td><td></td><td></td></tr></table>									
Shower Floor Tile	8661	OD.ON.SWT.0202.MT.N-Ontario Series Mosaic-Snow White Matte-2 x 2 ***STD***									
Shower Floor Tile Grout	2226	Grout-(00) White ***STD***									
Shower Floor Tile Pattern	3000	STANDARD SQUARE ***STD***									
		<table><tr><td></td><td></td><td></td></tr><tr><td></td><td></td><td></td></tr><tr><td></td><td></td><td></td></tr></table>									
Shower Wall Tile	9020	QT.WV.WHT.0810-Weave-White-8 x 10 ***STD***									
Shower Wall Tile Grout	2226	Grout-(00) White ***STD***									
Shower Wall Tile Pattern	3070	HORIZONTAL STACKED ***STD***									
		<table><tr><td></td><td></td></tr><tr><td></td><td></td></tr><tr><td></td><td></td></tr><tr><td></td><td></td></tr></table>									

SYED SAYEEDUDDIN/
Project: Wallaceton
Unit: 342, Phase: 3
Model: 25-2653 D The Wakefield

Created: 12/1/2021 09:15:50
Locked:
Closed:

8 of 55

Shower Jamb(s) and Sill(s)	8923	Shower Jamb / Sill-Thassos White ***STD***
Plumbing Fixture (colour)	1737	Plumbing Fixtures-WHITE ***STD***
Comment		

Main Bathroom

Cabinet Colour/Style	9111	VIKING III SIMCOE ORCHID 3DL ***STD***									
Countertop	8796	6698-46-Countertop-PALOMA POLAR ETCHINGS FINISH-Formica ***STD***									
Countertop Edge	1111	N/A *****									
Cabinet Hardware	7672	135-HARDWARE ***STD***									
Floor Tile	7672	GE.MD.ANT.1818.MT Madison Series Antracite Matte 18									
Floor Tile Grout	7704	Grout-(19) Pearl Gray ***STD***									
Floor Tile Pattern	3000	STANDARD SQUARE ***STD*** <table><tr><td></td><td></td><td></td></tr><tr><td></td><td></td><td></td></tr><tr><td></td><td></td><td></td></tr></table>									
Wall Tile	9020	QT.WV.WHT.0810-Weave-White-8 x 10 ***STD***									
Wall Tile Grout	2226	Grout-(00) White ***STD***									
Wall Tile Pattern	3070	HORIZONTAL STACKED ***STD*** <table><tr><td></td><td></td></tr><tr><td></td><td></td></tr><tr><td></td><td></td></tr><tr><td></td><td></td></tr></table>									
Plumbing Fixture (Colour)	1737	Plumbing Fixtures-WHITE ***STD***									
Comment											

Opt. Finished Basement Bathroom

Cabinet Colour/Style	9111	VIKING III SIMCOE ORCHID 3DL ***STD***
Countertop	8796	6698-46-Countertop-PALOMA POLAR ETCHINGS FINISH-Formica ***STD***

SYED SAYEEDUDDIN/
Project: Wallaceton
Unit: 342, Phase: 3
Model: 25-2653 D The Wakefield

Created: 12/1/2021 09:15:50
Locked:
Closed:

9 of 55

Countertop Edge	1111	N/A *****									
Cabinet Hardware	7672	135-HARDWARE ***STD***									
Floor Tile	7672	GE.MD.ANT.1818.MT Madison Series Antracite Matte 18									
Floor Tile Grout	7704	Grout-(19) Pearl Gray ***STD***									
Floor Tile Pattern	3000	STANDARD SQUARE ***STD*** <table><tr><td></td><td></td><td></td></tr><tr><td></td><td></td><td></td></tr><tr><td></td><td></td><td></td></tr></table>									
Shower Floor Tile	8661	OD.ON.SWT.0202.MT.N-Ontario Series Mosaic-Snow White Matte-2 x 2 ***STD***									
Shower Floor Tile Grout	2226	Grout-(00) White ***STD***									
Shower Floor Tile Pattern	3000	STANDARD SQUARE ***STD*** <table><tr><td></td><td></td><td></td></tr><tr><td></td><td></td><td></td></tr><tr><td></td><td></td><td></td></tr></table>									
Shower Wall Tile	9020	QT.WV.WHT.0810-Weave-White-8 x 10 ***STD***									
Shower Wall Tile Grout	2226	Grout-(00) White ***STD***									
Shower Wall Tile Pattern	3070	HORIZONTAL STACKED ***STD*** <table><tr><td></td><td></td></tr><tr><td></td><td></td></tr><tr><td></td><td></td></tr><tr><td></td><td></td></tr></table>									
Shower Jamb(s)	8923	Shower Jamb / Sill-Thassos White ***STD***									
Plumbing Fixture (Colour)	1737	Plumbing Fixtures-WHITE ***STD***									
Comment											

Great Room Fireplace

Type	8869	Majestic MERC32 ***STD***
Mantle	8891	NF-17-Paint Grade Mantle- Cabinet (Per Plan)-WHITE ***STD*** PAGE 29
Surround Opt.	1111	N/A *****
Disclaimer	1111	Purchasers have been advised: heat from the FP can damage TV above a FP and items placed on mantle.

SYED SAYEEDUDDIN/
Project: Wallaceton
Unit: 342, Phase: 3
Model: 25-2653 D The Wakefield

Created: 12/1/2021 09:15:50
Locked:
Closed:

10 of 55

Disclaimer	1111	Heatnwood and its contractors will not be liable for any damage on items placed/installed above a FP after closing.
Comment		

Basement Stairs

Type	1714	Carpet Grade Stairs ***STD BASEMENT STAIRS***
Carpet	9252	DY 16787 -Dynasty Tex-MYSTIC BEIGE-40 oz Poly***STD***
Carpet Runner	1111	N/A *****
Handrail/Pickets/Post Type	9119	Handrail only on closed walls (one or two sides per building code) ***STD***
Handrail/Pickets/Post Colour	7922	Eclipse (Pewter) STAIN TO COMPLIMENT HARDWOOD AND WILL VARY FROM FLOORING ***99***
Handrail/Pickets/Post Locations	1111	N/A *****
Custom Stain/Paint	1111	N/A *****
Comment		

Main Stairs

Type	1712	Oak Stairs ***STD MAIN STAIRS***
Carpet Runner	1111	N/A *****
Handrail/Pickets/Posts Type	8148	Single Collar Alt. Plain w/ Shoes with 3 1/2" Square/Cap Post(s)-BLACK ***2***
Handrail/Pickets/Posts Colour	7922	Eclipse (Pewter) STAIN TO COMPLIMENT HARDWOOD AND WILL VARY FROM FLOORING ***99***
Handrail/Pickets/Posts Locations	1728	Oak Grade-Stain handrail,oak pickets,stringers,treads,risers
Custom Stain/Paint	1111	N/A *****
Comment		

Throughout

Wall Paint	1717	CCM W/WH/DR GREY ***STD***
------------	------	----------------------------

SYED SAYEEDUDDIN/
Project: Wallaceton
Unit: 342, Phase: 3
Model: 25-2653 D The Wakefield

Created: 12/1/2021 09:15:50
Locked:
Closed:

11 of 55

Walls - Paint Colour	1717	22-Wall-WARM GREY ***STD***
Underpad	1079	500 Series-Underpad ***STD***
Thresholds	2232	Metal Thresholds ***STD***
Switches and Plug	5796	Decora White Switches and Plugs ***STD***
Trim Size	8705	4 1/4 Baseboard and 2 3/4 Casings ***STD***
Trim - Paint Colour	1716	Trim-WHITE ***STD***
Comment		

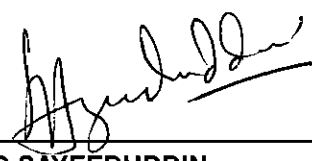
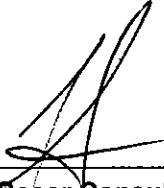
Purchaser:		26-01-2021		01/26/22
	SYED SAYEEDUDDIN	Date	Decor Consultant	Date

Purchaser:				APPROVED
			Wallaceton	-02- 04 2022
		Date		Date Approved



CONSTRUCTION SUMMARY

12 of 55

Lot: 342
Model: 25-2653 D The Wakefield
Project/Phase: Wallaceton / 3

Offer Worksheet	The Purchaser(s) acknowledge that they have NOT been referred by an existing Heathwood Homeowner and therefor are not entitled to a referral fee under Heathwood Homes Referral program. Note:
Offer Worksheet	Finished Lower Level with finished bathroom- 823 Sq Ft (The Wakefield) Note:
Offer Worksheet	Ten Thousand Dollars (\$10,000) At D?cor. (No Cash Value) Singles Note:
Offer Worksheet	Purchasers of a Dwelling with Elevation D are advised that due the second floor exterior walls being brick, room dimensions on the second floor appearing in some promotional or brochure materials are overstated. Actual room dimensions will be slightly sm Note:
Offer Worksheet	SCHEDULE X: ITEM #5 ADJUSTMENTS (e) AND (f) COMBINED TO BE CAPPED AT \$5,000 Note:



CONSTRUCTION SUMMARY

13 of 55

Lot: 342
Model: 25-2653 D The Wakefield
Project/Phase: Wallaceton / 3

ADMIN FEE

Invoice	Qty.	Description
949 07Feb22 NoCat	1	- TEN THOUSAND DOLLARS (\$10,000) AT DECOR. (NO CASH VALUE)

APPLIANCES

Invoice	Qty.	Description
949 313,484 07Feb22	1	KITCHEN - APPLIANCES -AVG 36" WALL MOUNT HOOD FAN SS - AVH 368CS SPECS PAGES 41-42 CABINETRY - delete stove uppers; ELECTRICAL - delete std range hood; HEATING/AIR CONDITIONING - Delete change to 6"
949 314,277 07Feb22 **	1	KITCHEN - GRANITE - GRANITE CUTOUT W/ STRAIGHT EDGE POLISH TO ACCOMMODATE COOK TOP KITCHEN STOVE SPEC PAGES 45-47

CABINETRY

Invoice	Qty.	Description
949 313,901 07Feb22	1	KITCHEN - 19B-45cm wide pull-out door base cabinet waste/recycle centre with soft-close ([2] 35L bins per unit) (available only with 45cm wide cabinet) Classic SKETCH # 3
949 07Feb22 NoCat	1	KITCHEN - RELOCATE STD BANK OF DRAWERS ON ISLAND TO RIGHT HAND SIDE OF STOVE. KITCHEN -. SEE SKETCH # 3
949 330,625 07Feb22	1	KITCHEN - CABINETRY - CLASSIC PLUS - KITCHEN - UPG
949 334,737 07Feb22	1	KITCHEN - CABINETRY - CLASSIC PLUS KITCHEN BUILT IN - KITCHEN - UPG SKETCH # 3 GRANITE - delete partial countertop due to Built-in
949 330,955 07Feb22 **	1	Kitchen - HARDWOOD - VINTAGE - 5" RED OAK SCULPTED - KITCHEN - UPG CABINETRY - Raise Cabinet; CERAMICS - delete std CERAMICS
949 330,927 07Feb22 **	1	Ensuite Master - GRANITE - COUNTERTOP WITH 4" BACKSPLASH - 3/4" GROUP 4 WITH MITRE EDGE - ENSUITE MASTER - UPG MASTER ENSUITE CABINETRY - delete std countertop; GRANITE - see upgraded single hole faucet and undermount Sink
949 330,629 07Feb22	1	Opt. Servery Uppers - CABINETRY - CLASSIC PLUS - OPT. SERVERY UPPERS - UPG SKETCH # 3
949 314,277 07Feb22 **	1	KITCHEN - GRANITE - GRANITE CUTOUT W/ STRAIGHT EDGE POLISH TO ACCOMMODATE COOK TOP KITCHEN STOVE SPEC PAGES 45-47



CONSTRUCTION SUMMARY

14 of 55

Lot: 342
Model: 25-2653 D The Wakefield
Project/Phase: Wallaceton / 3

CABINETRY

Invoice	Qty.	Description
949 330,656 07Feb22	1	KITCHEN - CABINETRY - OPT LIGHT VALANCE (TRIM ONLY) - KITCHEN (ALL DOOR STYLES) - UPG
949 330,657 07Feb22	1	Opt. Servery Uppers - CABINETRY - OPT LIGHT VALANCE (TRIM ONLY) - OPT SERVERY UPPER (ALL DOOR STYLES) - UPG
949 334,723 07Feb22 **	1	MASTER ENSUITE - PLUMBING - OPTION FROM ONE SINK TO DOUBLE SINKS INCLUDING STD CHATEAU FAUCET OVERMOUNT COLONY SINK ONE EXTRA VANITY LIGHT AND CABINET CONVERSION 2D VIKING SKETCH # 3 NOTE: UPGRADED TO BOXE UNDERMOUNT SINKS CABINETRY-2D Convert Viking; ELECTRICAL-Additional Vanity Light; GRANITE-Additional Cutout (see und sink specs)

CARPET

Invoice	Qty.	Description
949 07Feb22 ** NoCat	1	- BEDROOM 4 AND 5 COMBINED - ADD DOUBLE DOOR CLOSET. CHANGE ACCESS TO ORIGINAL BEDROOM 4 SINGLE DOOR CLOSET INTO BEDROOM 3 BEDROOM 4 & 5 - SEE SKETCH # 4 CARPET - Notificationo; DRYWALL - notification; ELECTRICAL - notification; FRAMING - notification; HEATING/AIR CONDITIONING - notification; INTERIOR TRIM AND DOORS - Supply and install additional double door closet in combined Bedroom 4 and 5 and modified Bedroom 3 Closet(s); PAINTING - Paint additional double closet door in combined Bedroom 4 and 5
949 330,968 07Feb22 **	1	Upper Hall - HARDWOOD - VINTAGE - 5" RED OAK UVF OIL - UPPER HALL - UPG CARPET - delete std CARPET; INTERIOR TRIM - supply and install quarter rounds; PAINTING - paint quarter



CONSTRUCTION SUMMARY

16 of 55

Lot: 342
Model: 25-2653 D The Wakefield
Project/Phase: Wallaceton / 3

CERAMICS

Invoice	Qty.	Description
949 330,788 07Feb22	1	Opt. Finished Basement Bathroo - CERAMICS - FLOOR - OPT. FINISHED BASEMENT BATHROOM - UPGRADE I

COFFERED CEILING

Invoice	Qty.	Description
949 330,897 07Feb22	1	GREAT ROOM - COFFERED CEILING - OPT. COFFERED CEILING - GREAT ROOM

COLD CELLAR

Invoice	Qty.	Description
949 330,898 07Feb22	1	- COLD CELLAR - UPG SKETCH # 1 CONCRETE and DRAIN-Notification; DRYWALL-Notification; ELECTRICAL-Supply and install light and switch; FORMING-Notification; FRAMING-Notification; INTERIOR TRIM-Supply and install metal Insulated slab door including hardware;

CONCRETE AND DRAIN

Invoice	Qty.	Description
949 330,898 07Feb22 **	1	- COLD CELLAR - UPG SKETCH # 1 CONCRETE and DRAIN-Notification; DRYWALL-Notification; ELECTRICAL-Supply and install light and switch; FORMING-Notification; FRAMING-Notification; INTERIOR TRIM-Supply and install metal Insulated slab door including hardware;



CONSTRUCTION SUMMARY

17 of 55

Lot: 342

Model: 25-2653 D The Wakefield

Project/Phase: Wallaceton / 3

DRYWALL

Invoice	Qty.	Description
949 330,897 07Feb22 **	1	GREAT ROOM - COFFERED CEILING - OPT. COFFERED CEILING - GREAT ROOM
949 330,898 07Feb22 **	1	- COLD CELLAR - UPG SKETCH # 1 CONCRETE and DRAIN-Notification; DRYWALL-Notification; ELECTRICAL-Supply and install light and switch; FORMING-Notification; FRAMING-Notification; INTERIOR TRIM-Supply and install metal Insulated slab door including hardware;
949 330,900 07Feb22	1	- DRYWALL - SMOOTH CEILING IN MAIN FLOOR PAINTING - Paint smooth ceiling
949 07Feb22 ** NoCat	1	- BEDROOM 4 AND 5 COMBINED - ADD DOUBLE DOOR CLOSET. CHANGE ACCESS TO ORIGINAL BEDROOM 4 SINGLE DOOR CLOSET INTO BEDROOM 3 BEDROOM 4 & 5 - SEE SKETCH # 4 CARPET - Notificationo; DRYWALL - notification; ELECTRICAL - notification; FRAMING - notification; HEATING/AIR CONDITIONING - notification; INTERIOR TRIM AND DOORS - Supply and install additional double door closet in combined Bedroom 4 and 5 and modified Bedroom 3 Closet(s); PAINTING - Paint additional double closet door in combined Bedroom 4 and 5
949 314,345 07Feb22 **	1	MAIN HALL - INTERIOR TRIM - UPGRADE FROM STANDARD 6 FT 8 INCH 2 PANEL HOLLOW CORE DOUBLE DOORS TO 8 FT 2 PANEL HOLLOW CORE DOUBLE DOORS FRONT HALL CLOSET SKETCH # 2 FRAMING-Notify; DRYWALL-Notify; PAINTING-paint upgraded door and frame
949 314,346 07Feb22 **	1	- INTERIOR TRIM - UPGRADE FROM STANDARD 6 FT 8 INCH 2 PANEL HOLLOW CORE SINGLE DOOR TO 8 FT 2 PANEL HOLLOW CORE SINGLE DOOR POWDER ROOM SKETCH # 2 FRAMING-Notify; DRYWALL-Notify; PAINTING-paint upgraded door and frame



CONSTRUCTION SUMMARY

18 of 55

Lot: 342
Model: 25-2653 D The Wakefield
Project/Phase: Wallaceton / 3

ELECTRICAL

Invoice Qty. Description

949 330,898 07Feb22 **	1	- COLD CELLAR - UPG SKETCH # 1 CONCRETE and DRAIN-Notification; DRYWALL-Notification; ELECTRICAL-Supply and install light and switch; FORMING-Notification; FRAMING-Notification; INTERIOR TRIM-Supply and install metal Insulated slab door including hardware;
949 314,223 07Feb22	2	- ELECTRICAL - ADDITIONAL SWITCH SKETCH # 2 1X WITH CAPPED ELECTRICAL IN GREAT ROOM; 1X WITH CAPPED ELECTRICAL CENTERED +/- ON ISLAND
949 314,224 07Feb22	2	- ELECTRICAL - CEILING ROUGH-IN (CAPPED) SKETCH # 2 1X CENTERED ON GREAT ROOM CEILING ON A SEPERATE SWITCH; 1X CENTERED ABOVE ISLAND ON A SEPERATE SWITCH
949 314,232 07Feb22	2	- ELECTRICAL - EXTRA WALL INTERIOR OUTLET ON EXISTING CIRCUIT (DOES NOT INCLUDE KITCHEN OUTLETS) 1)GREAT ROOM - TO BE CENTERED +/- ABOVE THE FIREPLACE APPROX. 70" +/- FROM THE FLOOR 2) IN RECREATION ROOM CENTERED ON RIGHT HAND WALL 70" +/- FROM FLOOR - SEE SKETCH #'S 1 AND 2
949 07Feb22 ** NoCat	1	- BEDROOM 4 AND 5 COMBINED - ADD DOUBLE DOOR CLOSET. CHANGE ACCESS TO ORIGINAL BEDROOM 4 SINGLE DOOR CLOSET INTO BEDROOM 3 BEDROOM 4 & 5 - SEE SKETCH # 4 CARPET - Notification; DRYWALL - notification; ELECTRICAL - notification; FRAMING - notification; HEATING/AIR CONDITIONING - notification; INTERIOR TRIM AND DOORS - Supply and install additional double door closet in combined Bedroom 4 and 5 and modified Bedroom 3 Closet(s); PAINTING - Paint additional double closet door in combined Bedroom 4 and 5
949 314,242 07Feb22	1	KITCHEN - ELECTRICAL - RELOCATION OF SWITCHES/LIGHTS (MUST SPECIFY LOCATION) - NOTE: PLUGS CANNOT BE RELOCATED- MUST PURCHASE ADDITIONAL OUTLET. KITCHEN - RELOCATE STD ELECTRICAL FOR STOVE TO BUILT-IN LOCATION SKETCH # 3
949 07Feb22 ** NoCat	1	LAUNDRY ROOM - STACKED LAUNDRY PAIR AT DRYER LOCATION SKETCH # 4 PLUMBING - Relocation ELECTRICAL - Relocation HEATING - Notify
949 334,723 07Feb22 **	1	MASTER ENSUITE - PLUMBING - OPTION FROM ONE SINK TO DOUBLE SINKS INCLUDING STD CHATEAU FAUCET OVERMOUNT COLONY SINK ONE EXTRA VANITY LIGHT AND CABINET CONVERSION 2D VIKING SKETCH # 3 NOTE: UPGRADED TO BOXE UNDERMOUNT SINKS CABINETRY-2D Convert Viking; ELECTRICAL-Additional Vanity Light; GRANITE-Additional Cutout (see und sink specs)
949 314,340 07Feb22 **	1	- HEATING/AIR - ROUGH-IN GAS LINE FOR GAS STOVE AT MAIN FLOOR (SEE SPECS) (HOOK-UP NOT INCLUDED) LEAVE STANDARD 120 VOLT ELECTRICAL OUTLET ON A SEPARATE CIRCUIT. KITCHEN - RELOCATE 220 TO BUILT-IN LOCATION SKETCCH # 3 SPECS PAGES 48-50 ELECTRICAL - Notification



CONSTRUCTION SUMMARY

19 of 55

Lot: 342
Model: 25-2653 D The Wakefield
Project/Phase: Wallaceton / 3

FORMING

Invoice	Qty.	Description
949 330,898 07Feb22 **	1	- COLD CELLAR - UPG SKETCH # 1 CONCRETE and DRAIN-Notification; DRYWALL-Notification; ELECTRICAL-Supply and install light and switch; FORMING-Notification; FRAMING-Notification; INTERIOR TRIM-Supply and install metal Insulated slab door including hardware;

FRAMING

Invoice	Qty.	Description
949 330,898 07Feb22 **	1	- COLD CELLAR - UPG SKETCH # 1 CONCRETE and DRAIN-Notification; DRYWALL-Notification; ELECTRICAL-Supply and install light and switch; FORMING-Notification; FRAMING-Notification; INTERIOR TRIM-Supply and install metal Insulated slab door including hardware;
949 07Feb22 ** NoCat	1	- BEDROOM 4 AND 5 COMBINED - ADD DOUBLE DOOR CLOSET. CHANGE ACCESS TO ORIGINAL BEDROOM 4 SINGLE DOOR CLOSET INTO BEDROOM 3 BEDROOM 4 & 5 - SEE SKETCH # 4 CARPET - Notificationo; DRYWALL - notification; ELECTRICAL - notification; FRAMING - notification; HEATING/AIR CONDITIONING - notification; INTERIOR TRIM AND DOORS - Supply and install additional double door closet in combined Bedroom 4 and 5 and modified Bedroom 3 Closet(s); PAINTING - Paint additional double closet door in combined Bedroom 4 and 5
949 314,345 07Feb22 **	1	MAIN HALL - INTERIOR TRIM - UPGRADE FROM STANDARD 6 FT 8 INCH 2 PANEL HOLLOW CORE DOUBLE DOORS TO 8 FT 2 PANEL HOLLOW CORE DOUBLE DOORS FRONT HALL CLOSET SKETCH # 2 FRAMING-Notify; DRYWALL-Notify; PAINTING-paint upgraded door and frame
949 314,346 07Feb22 **	1	- INTERIOR TRIM - UPGRADE FROM STANDARD 6 FT 8 INCH 2 PANEL HOLLOW CORE SINGLE DOOR TO 8 FT 2 PANEL HOLLOW CORE SINGLE DOOR POWDER ROOM SKETCH # 2 FRAMING-Notify; DRYWALL-Notify; PAINTING-paint upgraded door and frame

GLASS PRODUCTS / MIRRORS

Invoice	Qty.	Description
949 330,902 07Feb22	1	- MIRRORS/GLASS PRODUCTS - UPG TO FRAMELESS CLEAR GLASS WITH D-RING HANDLE IN CHROME - ENSUITE 5 -
949 330,903 07Feb22	1	- MIRRORS/GLASS PRODUCTS - UPG TO FRAMELESS CLEAR GLASS WITH D-RING HANDLE IN CHROME - ENSUITE MASTER



CONSTRUCTION SUMMARY

20 of 55

Lot: 342

Model: 25-2653 D The Wakefield

Project/Phase: Wallaceton / 3

GRANITE

Invoice	Qty.	Description
949 334,737 07Feb22 **	1	KITCHEN - CABINETRY - CLASSIC PLUS KITCHEN BUILT IN - KITCHEN - UPG SKETCH # 3 GRANITE - delete partial countertop due to Built-in
949 330,907 07Feb22	1	Kitchen / Island / Servery - GRANITE - COUNTERTOP - 3/4" GROUP 4 WITH MITRE EDGE - KITCHEN / ISLAND / SERVERY - UPG KITCHEN
949 330,927 07Feb22	1	Ensuite Master - GRANITE - COUNTERTOP WITH 4" BACKSPLASH - 3/4" GROUP 4 WITH MITRE EDGE - ENSUITE MASTER - UPG MASTER ENSUITE CABINETRY - delete std countertop; GRANITE - see upgraded single hole faucet and undermount Sink
949 314,410 07Feb22 **	1	KITCHEN - PLUMBING - KITCHEN SINK UPGRADE - BLANCO KITCHEN SINK QUATRUS U 1 MAXI #401248 (32 INCH X 18 INCH) UNDERMOUNT 1 BOWL 9 INCH DEEP IN STAINLESS STEEL - KITCHEN SPEC PAGE 30 GRANITE - upgraded kitchen sink
949 314,365 07Feb22 **	2	MASTER ENSUITE - PLUMBING - AMERICAN STANDARD - SINK - UNDERMOUNT SINK - BOXE - WHITE - MODEL 0315 000 020 MASTER ENSUITE SPEC PAGE 33 GRANITE - upgraded sink
949 314,277 07Feb22	1	KITCHEN - GRANITE - GRANITE CUTOUT W/ STRAIGHT EDGE POLISH TO ACCOMMODATE COOK TOP KITCHEN STOVE SPEC PAGES 45-47
949 314,279 07Feb22	1	MASTER ENSUITE - GRANITE - GRANITE CUTOUT W/ STRAIGHT EDGE POLISH TO ACCOMMODATE UNDER MOUNT VANITY SINK SINK SPEC PAGE 33 Master Ensuite opt DOUBLE sinks

HARDWOOD

Invoice	Qty.	Description
949 330,955 07Feb22	1	Kitchen - HARDWOOD - VINTAGE - 5" RED OAK SCULPTED - KITCHEN - UPG CABINETRY - Raise Cabinet; CERAMICS - delete std CERAMICS
949 330,964 07Feb22	1	Great Room - HARDWOOD - VINTAGE - 5" RED OAK UVF OIL - GREAT ROOM - UPG
949 330,963 07Feb22	1	Dining Room - HARDWOOD - VINTAGE - 5" RED OAK UVF OIL - DINING ROOM - UPG
949 330,968 07Feb22	1	Upper Hall - HARDWOOD - VINTAGE - 5" RED OAK UVF OIL - UPPER HALL - UPG CARPET - delete std CARPET; INTERIOR TRIM - supply and install quarter rounds; PAINTING - paint quarter
949 330,966 07Feb22	1	Main Hall - HARDWOOD - VINTAGE - 5" RED OAK UVF OIL - MAIN HALL - UPG



CONSTRUCTION SUMMARY

21 of 55

Lot: 342
Model: 25-2653 D The Wakefield
Project/Phase: Wallaceton / 3

HEATING / AIR CONDITIONING

Invoice	Qty.	Description
949 07Feb22 ** NoCat	1	- BEDROOM 4 AND 5 COMBINED - ADD DOUBLE DOOR CLOSET. CHANGE ACCESS TO ORIGINAL BEDROOM 4 SINGLE DOOR CLOSET INTO BEDROOM 3 BEDROOM 4 & 5 - SEE SKETCH # 4 CARPET - Notificationo; DRYWALL - notification; ELECTRICAL - notification; FRAMING - notification; HEATING/AIR CONDITIONING - notification; INTERIOR TRIM AND DOORS - Supply and install additional double door closet in combined Bedroom 4 and 5 and modified Bedroom 3 Closet(s); PAINTING - Paint additional double closet door in combined Bedroom 4 and 5
949 07Feb22 ** NoCat	1	LAUNDRY ROOM - STACKED LAUNDRY PAIR AT DRYER LOCATION SKETCH # 4 PLUMBING - Relocation ELECTRICAL - Relocation HEATING - Notify
949 314,340 07Feb22	1	- HEATING/AIR - ROUGH-IN GAS LINE FOR GAS STOVE AT MAIN FLOOR (SEE SPECS) (HOOK-UP NOT INCLUDED) LEAVE STANDARD 120 VOLT ELECTRICAL OUTLET ON A SEPARATE CIRCUIT. KITCHEN - RELOCATE 220 TO BUILT-IN LOCATION SKETCCH # 3 SPECS PAGES 48-50 ELECTRICAL - Notification

INTERIOR RAILINGS

Invoice	Qty.	Description
949 330,992 07Feb22	1	- INTERIOR RAILINGS - BLACK METAL - SINGLE COLLAR ALT. PLAIN W/ SHOES WITH 3 1/2" SQUARE/CAP POST(S) AS PER PLAN - MAIN STAIR - UPG



CONSTRUCTION SUMMARY

22 of 55

Lot: 342
Model: 25-2653 D The Wakefield
Project/Phase: Wallaceton / 3

INTERIOR TRIM AND DOORS

Invoice	Qty.	Description
949 330,898 07Feb22 **	1	- COLD CELLAR - UPG SKETCH # 1 CONCRETE and DRAIN-Notification; DRYWALL-Notification; ELECTRICAL-Supply and install light and switch; FORMING-Notification; FRAMING-Notification; INTERIOR TRIM-Supply and install metal Insulated slab door including hardware;
949 07Feb22 ** NoCat	1	- BEDROOM 4 AND 5 COMBINED - ADD DOUBLE DOOR CLOSET. CHANGE ACCESS TO ORIGINAL BEDROOM 4 SINGLE DOOR CLOSET INTO BEDROOM 3 BEDROOM 4 & 5 - SEE SKETCH # 4 CARPET - Notificationo; DRYWALL - notification; ELECTRICAL - notification; FRAMING - notification; HEATING/AIR CONDITIONING - notification; INTERIOR TRIM AND DOORS - Supply and install additional double door closet in combined Bedroom 4 and 5 and modified Bedroom 3 Closet(s); PAINTING - Paint additional double closet door in combined Bedroom 4 and 5
949 330,968 07Feb22 **	1	Upper Hall - HARDWOOD - VINTAGE - 5" RED OAK UVF OIL - UPPER HALL - UPG CARPET - delete std CARPET; INTERIOR TRIM - supply and install quarter rounds; PAINTING - paint quarter
949 314,346 07Feb22	1	- INTERIOR TRIM - UPGRADE FROM STANDARD 6 FT 8 INCH 2 PANEL HOLLOW CORE SINGLE DOOR TO 8 FT 2 PANEL HOLLOW CORE SINGLE DOOR POWDER ROOM SKETCH # 2 FRAMING-Notify; DRYWALL-Notify; PAINTING-paint upgraded door and frame

PLUMBING

Invoice	Qty.	Description
949 314,489 07Feb22	3	- PLUMBING - MOEN -RIZON - LAV - SINGLE HANDLE FAUCET MATTE BLACK (MODEL: 6900BL) - 2X IN MASTER ENSUITE ; POWDER ROOM X 1 SPEC PAGE 37
949 314,410 07Feb22	1	KITCHEN - PLUMBING - KITCHEN SINK UPGRADE - BLANCO KITCHEN SINK QUATRUS U 1 MAXI #401248 (32 INCH X 18 INCH) UNDERMOUNT 1 BOWL 9 INCH DEEP IN STAINLESS STEEL - KITCHEN SPEC PAGE 30 GRANITE - upgraded kitchen sink
949 314,365 07Feb22	2	MASTER ENSUITE - PLUMBING - AMERICAN STANDARD - SINK - UNDERMOUNT SINK - BOXE - WHITE - MODEL 0315 000 020 MASTER ENSUITE SPEC PAGE 33 GRANITE - upgraded sink
949 07Feb22 NoCat	1	LAUNDRY ROOM - STACKED LAUNDRY PAIR AT DRYER LOCATION SKETCH # 4 PLUMBING - Relocation ELECTRICAL - Relocation HEATING - Notify
949 334,723 07Feb22	1	MASTER ENSUITE - PLUMBING - OPTION FROM ONE SINK TO DOUBLE SINKS INCLUDING STD CHATEAU FAUCET OVERMOUNT COLONY SINK ONE EXTRA VANITY LIGHT AND CABINET CONVERSION 2D VIKING SKETCH # 3 NOTE: UPGRADED TO BOXE UNDERMOUNT SINKS CABINETRY-2D Convert Viking; ELECTRICAL-Additional Vanity Light; GRANITE-Additional Cutout (see und sink specs)

STRUCTURED WIRING

Invoice	Qty.	Description
949 314,540 07Feb22	1	GREAT ROOM - STRUCTURED WIRING - CONDUIT PIPE TO ABOVE FIREPLACE ROUGH-IN GREAT ROOM SKETCH # 2
949 314,552 07Feb22	4	- STRUCTURED WIRING - UPGRADE STANDARD CAT5E TO CAT6 1) GREAT ROOM 2) DINING ROOM - RELOCATED FROM KITCHEN 3) MASTER BEDROOM - TO BE LOCATED WITH TV 4) RECREATION ROOM SKETCH #'S 1, 2 AND 4
949 314,546 07Feb22	3	- STRUCTURED WIRING - RELOCATION OF TV/PHONE 1) GREAT ROOM - OPPOSITE SIDE OF FIREPLACE 2) DINING ROOM - FROM KITCHEN 3) MASTER BEDROOM - TO BE BESIDE TV SKETCH #'S 2 AND 4

UK 3 WALLACETON
LOT 342
25-2653 ELEV D
THE WAKEFIELD

25 of 55

Sketch #1

25-2653 ELEV. D

THE WAKEFIELD

ELEVATION C & D | 2657 SQ. FT.

Includes 823 sq. ft. of opt. finished Lower Level

WALLACETON

EST. 1870

Landing and risers on
either side at bottom of
basement staircase

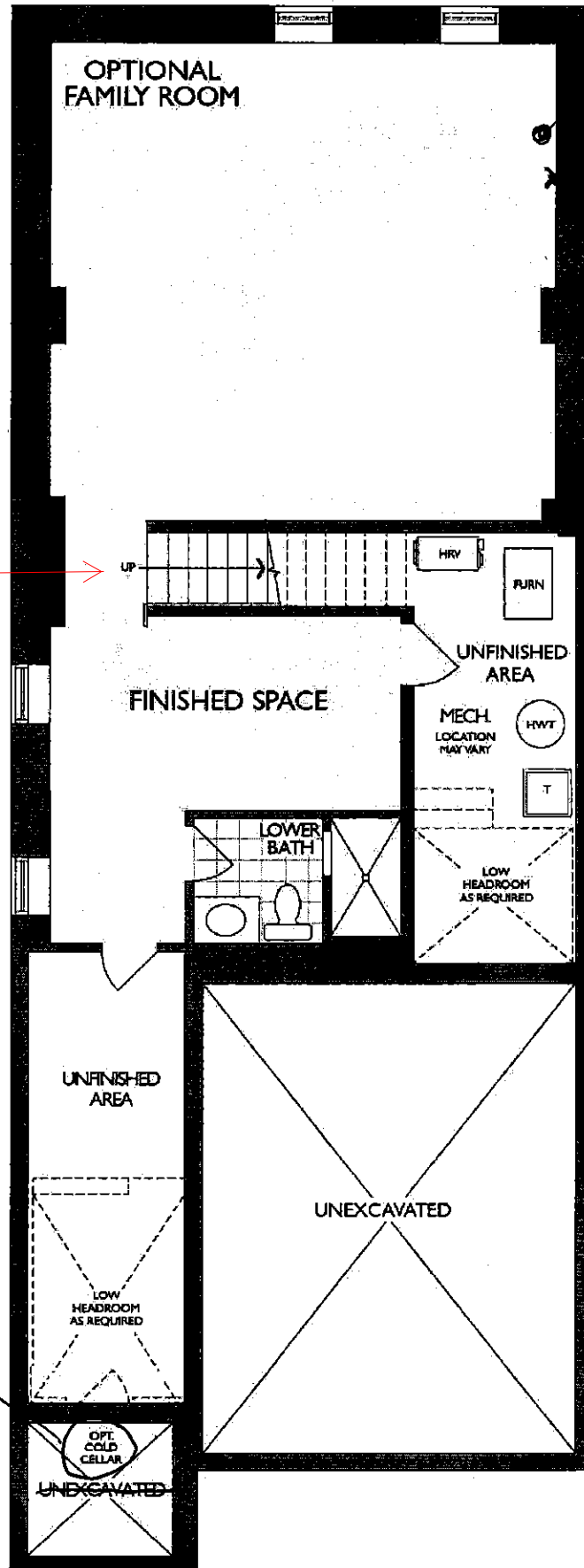
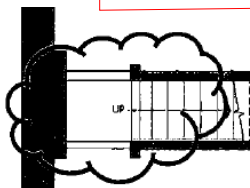

UPGRADED TO
CAT 6

PLUG \pm 1-
70" \pm 1- FROM
FLOOR

OPTIONAL
COLD CELLAR

S.S.

LOWER LEVEL
ELEVATION C & D

Legal Plan Jan. 8, 2021

UK 3 WALLACETON
LOT 342
25-2653 ELEV D
THE WAKEFIELD

26 of 55

Sketch #2

THE WAKEFIELD

25-2653 ELEV. D

ELEVATION C & D | 2657 SQ. FT.
Includes 823 sq. ft. of opt. finished Lower Level
WALLACETON
EST. 1870

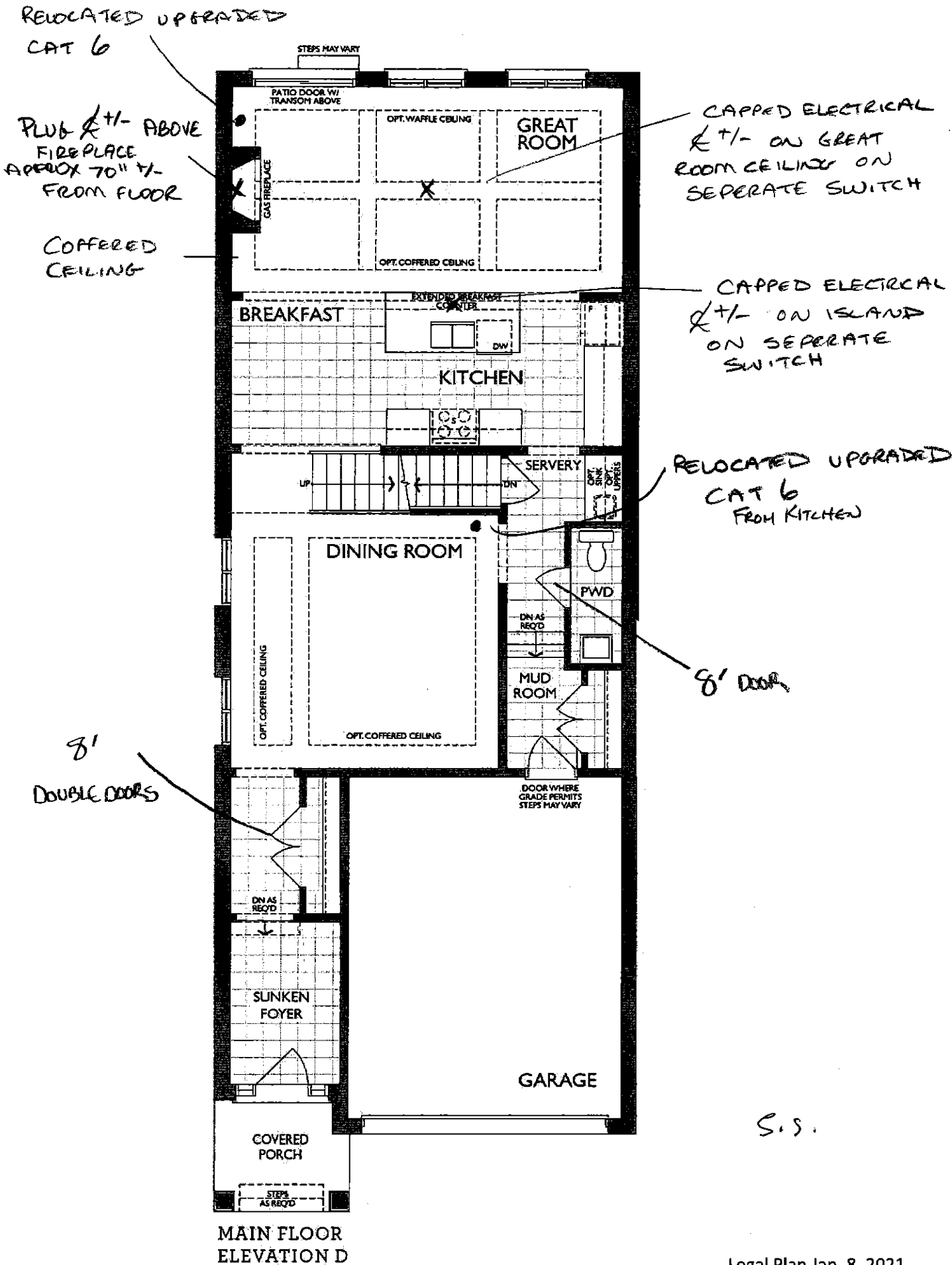

HEATHWOOD HOMES

WALLACETON, KITCHENER O

MODEL: 25-2653 (3110)

STANDARD CONTRACT INCLUDES:

- Appliance Openings**

 - Hood: 30"W builder hood
 - Fridge Opening: 37 3/8 "W X 73 3/8"
 - Fridge cabinet & gables: 66cm Deep
 - **Cooktop: 30"W – Tall Wall Oven: 30"**
 - Dishwasher Opening: 24"

- Standard Kitchens Scope:**

 - 100cm H wall cabinets
 - Std. Blumotion Hinges- **soft close** doc
 - Std. Metabox Drawers- **not soft close**
 - Min 40cm W drawer
 - Base pie cut corner cabinets
 - Backing on all cabinets
 - Countertop by others
 - Upgrade applied paneled fridge & dishwashers supply only (appliance hardware by others)

- Standard Vanity & Laundry Scope:**

 - Powder by others, pedestal
 - Master Ens. – Top by others
 - Remaining vanities inc. laminate top
 - Std. Blumotion Hinges- **not soft close**
 - Std. Metabox Drawers- **not soft close**
 - Master Ens: Top drawers(Sink Full height
 - Mains: Full height doors (top drawers added if Masters can't accommodate
 - Optional laundry base & wall cabine

27 of 55

KITCHEN
(GROUND FLOOR)

Sketch #3

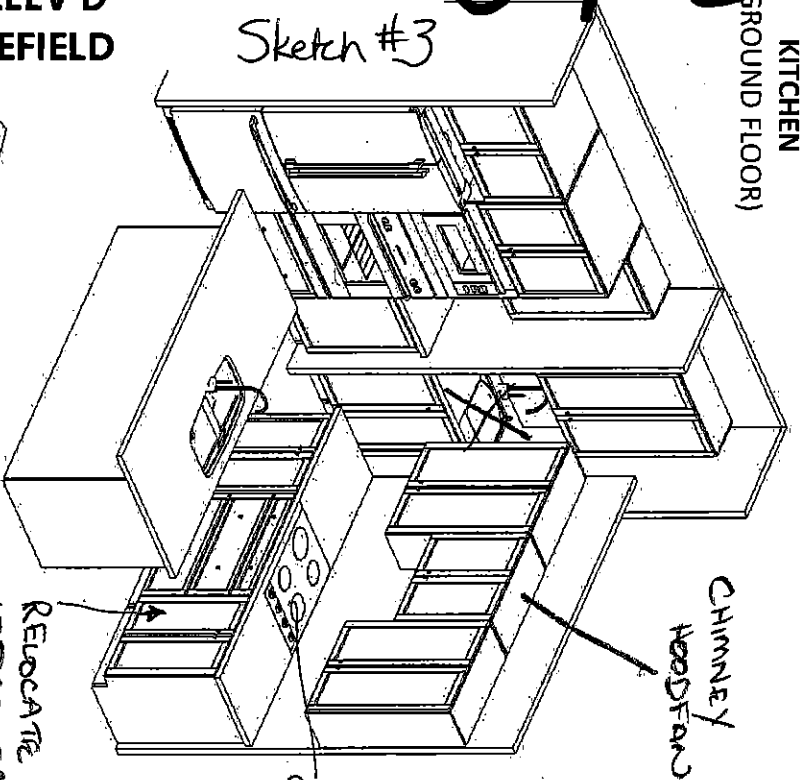

CHIMNEY HOOD/FAN

RELOCATE BANK OF DRAWERS FROM ISLAND

GAS 4/I

SERVERY

*STD. BASE CABINETS

~~*OPT. BAR SINK~~

*OPT. WALL CABINETS ✓

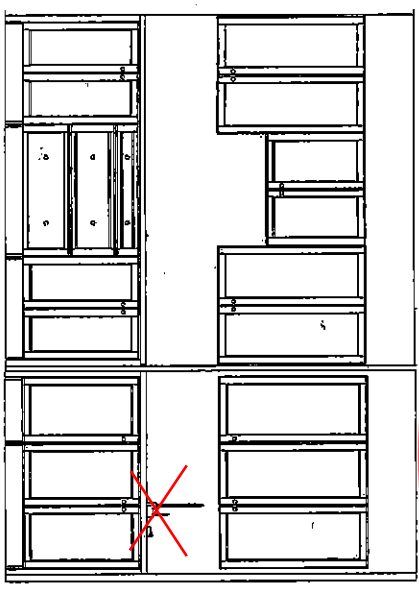

OPT. BASEMENT BATH

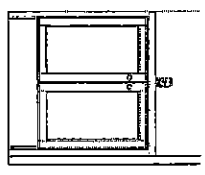

OPT. LAUNDRY UPPIERS
(2ND FLR)

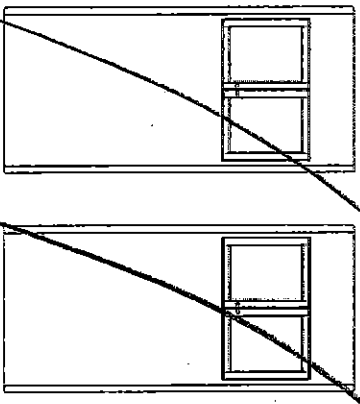

RELOCATE 240V 40AMP FOR BUILT IN OVENS

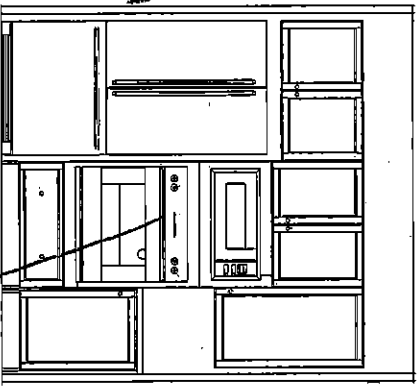

RECYCLE DRAWER & BANK OF MASTER ENSUITE DRAWERS (2ND FLR)

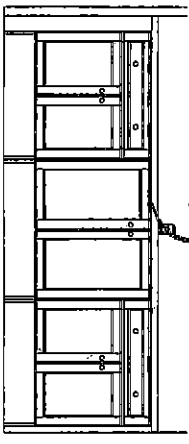

MAIN BATH
(2ND FLR ELEV. A & B)

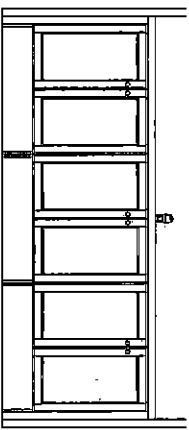

(2ND FLR ELEV. C & D)

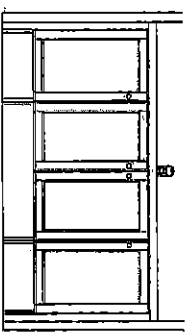

ENSUITE S
(2ND FLR)

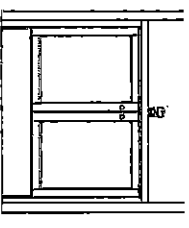

UK-75 WALLACETON
LOT 342
25-2653 D
THE WAKEFIELD

28 of 55
12 x 24
tile direction

UK 3 WALLACETON
LOT 342
25-2653 ELEV D
THE WAKEFIELD

Sketch #4

SECOND FLOOR
ELEVATION D

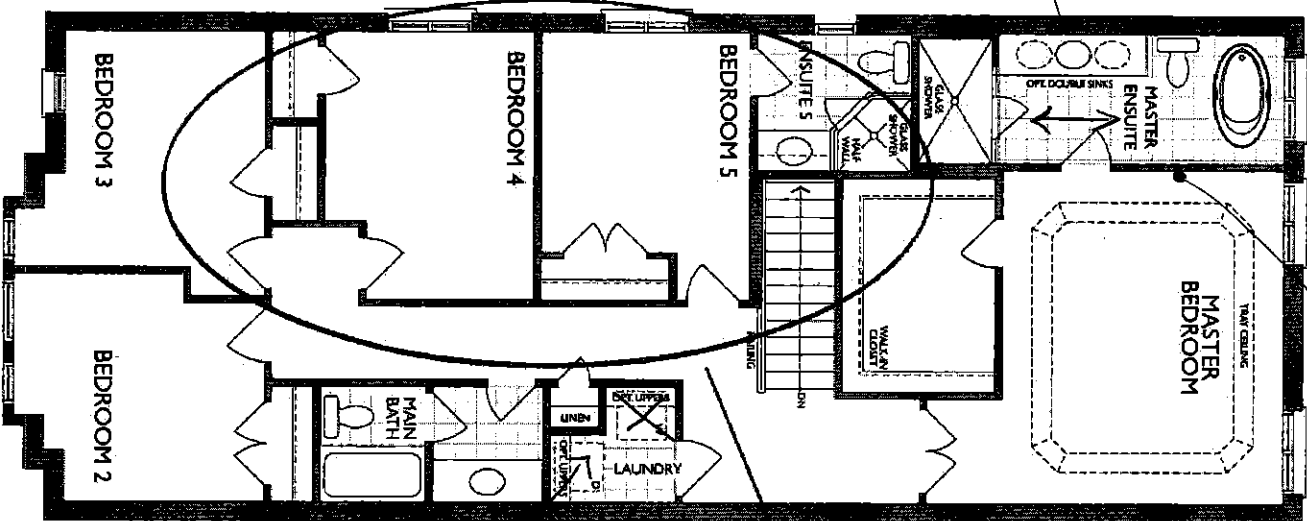

RELOCATE UPGRADED C.A.T.

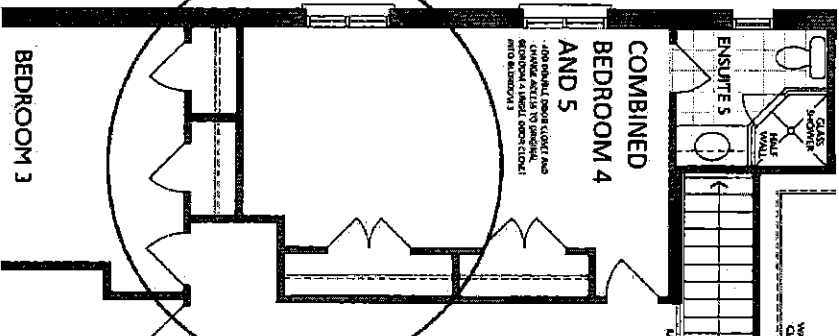

PROVISIONS
FOR STACKED WASHER/DRYER

S.S.

UK 3 WALLACETON
LOT 342
25-2653 ELEV D
THE WAKEFIELD

29 of 55

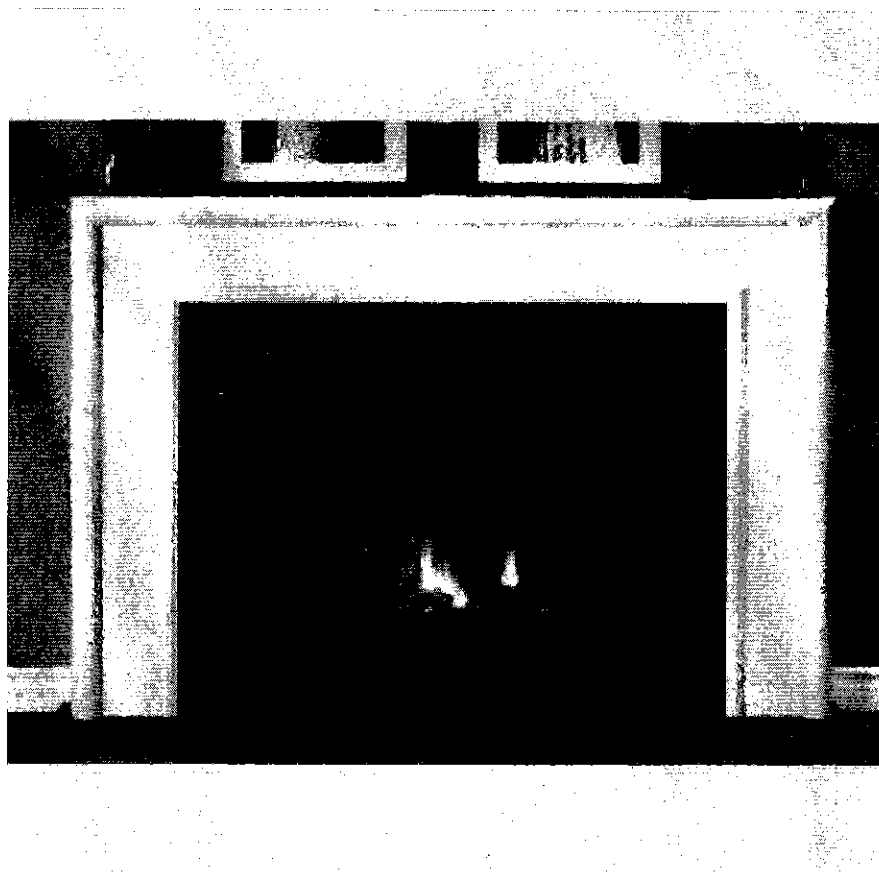

NEAS NF17 Mantel - CABINET

S.S.

UK 3 WALLACETON
LOT 342
25-2653 ELEV D
THE WAKEFIELD

30 of 55

BLANCO

Sink Specifications

Colour	SKU
brushed finish	401248

QUATRUS U 1 SUPER SINGLE
Stainless steel brushed finish

Design and planning tips

- Min cabinet size: 36 in (915 mm)
- Bowl Depth: 9 in (230.0 mm)

Specifications:
Installation clips, Sink template, Installation instructions, 3
1/2" (90 mm) stainless steel strainer

Depending on cabinet construction, a different cabinet
size may be required. Consult the cabinet manufacturer.
Codes/Standards: ASME A112.19.3-2017/ CSA B45.4-17

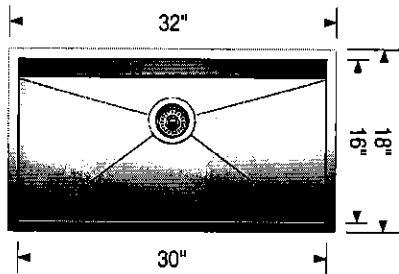

Optional Accessories

Elevated Grid	406346
Workstation	406344
CapFlow	517666
Cutting Board	406345
Sink Grid	402125

Warranty
Limited lifetime warranty on all sinks and faucets. One-year warranty on all accessories and soap dispensers.

Code/Standards Compliance
BLANCO sinks and faucets are third-party tested and certified to CSA, cUPC, ANSI/ASME, IAPMO and NSF standards and listed by applicable certification bodies. For more information on individual product listings, contact our office or listing organization.

 Need support? Learn more by watching our sink & faucet How-to videos:
<https://www.blanco.com/ca-en/support/how-to-videos/how-to-videos-for-sinks/>

	BLANCO Canada Inc 100 Corporation Drive Brampton ON L6S 6B5	Tel & Fax Tel: 905-494-2400 Toll free: 1-877-425-2626 Fax: 905-494-2425 Toll free: 1-877-825-2626
---	---	---

While BLANCO strives to provide accurate information, all images and dimensions in this document are intended for reference only and are subject to change at any time without notice. This document is not intended for use as an installation guide. For technical installation details, refer to installation instructions provided with the product. BLANCO assumes no responsibility for the use of superseded or voided specifications.

S.S.

UK 3 WALLACETON
LOT 342
25-2653 ELEV D
THE WAKEFIELD

31 of 55

MOEN®

There is more than 1 version of this model.
Page down to identify the version you have.

FAUCET DESCRIPTION

- Reflex™ pulldown system offers smooth operation, easy movement and secure docking
- Power Clean™ spray technology
- Metal construction with various finishes identified by suffix
- Duralock™ connect installation
- Pulldown spray with 68" braided hose
- Flexible supply lines with 3/8" compression fittings
- High arc spout provides height and reach to fill or clean large pots while pulldown wand provides the maneuverability for cleaning or rinsing
- 360° rotating spout
- Faucet designed for handle to be mounted on right side only

OPERATION

- Lever style handle
- Temperature controlled by 100° arc of handle travel
- Operates with less than 5 lbs. of force
- Operates in stream or spray mode in the pullout or retracted position

FLOW

- Flow is limited to 1.5 gpm (5.7 L/min) max at 60 psi

CARTRIDGE

- 1255™ Duralast™ cartridge

STANDARDS

- Third party certified to IAPMO Green, ASME A112.18.1/CSA B125.1 and all applicable requirements therein including NSF 61/9G & 372
- Meets CalGreen and Georgia SB370 requirements
- Complies with California Proposition 65 and with the Federal Safe Drinking Water Act
- The backflow protection system in the device consists of two independently operating check valves, a primary and a secondary which prevent backflow

- ADA  for lever handle

WARRANTY

- Lifetime limited warranty against leaks, drips and finish defects to the original homeowner
 - 10 year limited warranty when used in a multifamily installation
 - 5 year limited warranty when used in a commercial installation
- Visit www.moen.com/support for complete details and limitations

Specifications

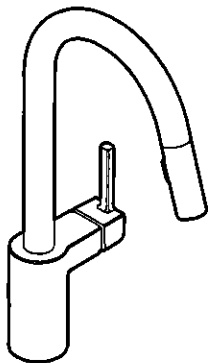

ALIGN™
Single Handle High Arc
Pulldown Kitchen Faucet

Models: 7565 series

NOTE: THIS FAUCET IS DESIGNED TO BE INSTALLED
THROUGH 1 HOLE, 1-1/2" (38mm) MIN. DIA.
(OPTIONAL 3-HOLE ESCUTCHEON 141002 AVAILABLE)

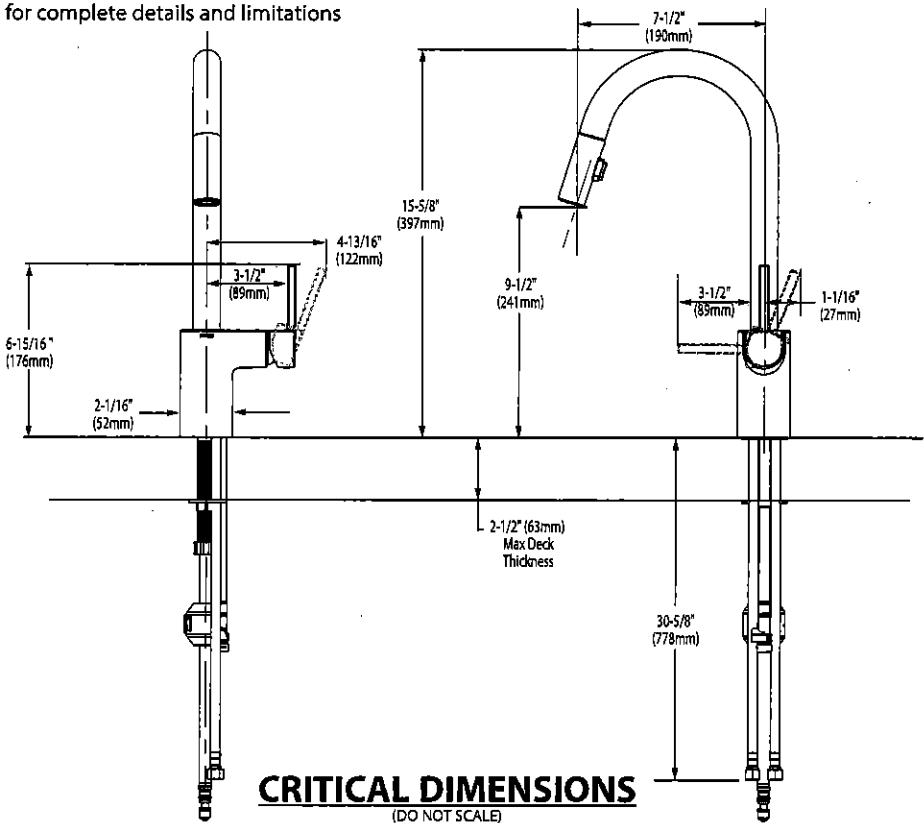

UK 3 WALLACETON
LOT 342
25-2653 ELEV D
THE WAKEFIELD

32 of 55



BARRIER FREE (ABOVE COUNTER OR DROP-IN ONLY)

BOULEVARD®
PEDESTAL SINK
VITREOUS CHINA

BOULEVARD® PEDESTAL SINK

- STD ☐ 0641.800 Faucet holes on 8" (203mm) centers (Illustrated)
- ☐ 0641.400 Faucet holes on 4" (102mm) centers
- ☒ 0641.100 Center hole only ✓
- Classic styled rectangular pedestal lavatory
 - Vitreous china
 - Rear overflow
 - Supplied with mounting kit
 - Right Height® for greater comfort during use
 - Faucet ledge with large deck area (faucet not included)
 - **Design coordinates with Boulevard® Toilet**
 - Basin has flat bottom to also allow use as an **above** counter sink or a **drop-in** sink (with u-shaped cut out)

Nominal Dimensions:
24" x 19" x 35-1/2"
(610 x 483 x 902mm)

- ☐ 0641.008 Pedestal top-8" (203mm) centers
- ☐ 0641.004 Pedestal top-4" (102mm) centers
- ☐ 0641.001 Pedestal top-center hole only
- ☐ 0010.000 Pedestal only

Bowl sizes:
17" (432mm) wide,
12-1/2" (318mm) front to back,
5" (127mm) deep

Compliance Certifications -
Meets or Exceeds the Following Specifications:
• ASME A112.19.2 - 2008/CSA B45.1-08

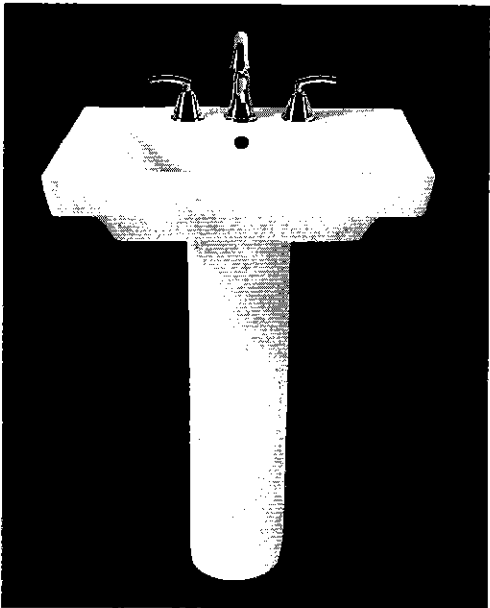

SEE REVERSE FOR ROUGHING-IN DIMENSIONS

<p>To Be Specified:</p> <p><input type="checkbox"/> Color: <input type="checkbox"/> White <input type="checkbox"/> Linen</p> <p><input type="checkbox"/> Faucet Finish:</p> <p><input type="checkbox"/> Supplies:</p> <p><input type="checkbox"/> 1-1/4" Trap:</p> <p><input type="checkbox"/> Nipple:</p>

* See faucet section for additional models available

S.S.

UK 3 WALLACETON
LOT 342
25-2653 ELEV D
THE WAKEFIELD

33 of 55

American Standard
Style That Works Better

 BARRIER FREE

BOXE
UNDERCOUNTER SINK
VITREOUS CHINA

BOXE UNDERCOUNTER SINK

- Vitreous china
- Rectangular undercounter mount sink with rectangular interior and flat bottom design bowl
- Unglazed rim
- Front overflow
- Supplied with template
- Meets OBC requirement when sink is installed with overflow to the rear
- Mounting clips available separately (P031006000) (Faucet not included)

☐ 0315 000 Unglazed Rim
508 x 406mm (20" x 16")

Bowl size:
438mm (17-1/4") wide,
337mm (13-1/4") front to back,
127mm (5") deep

MASTER
ENSUITE
x2

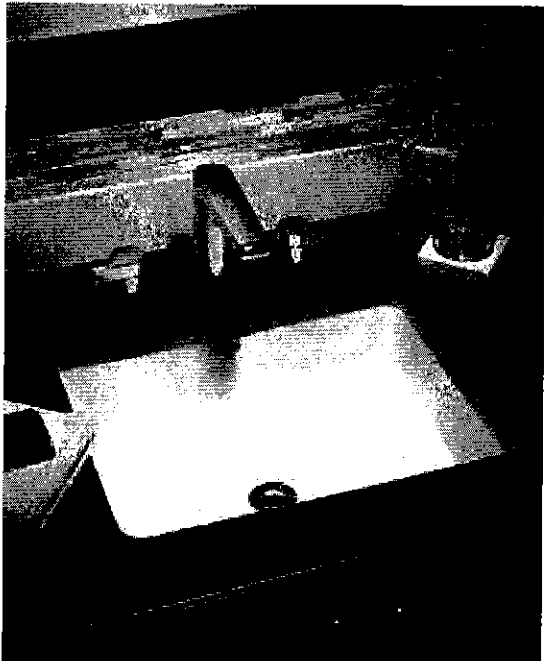

COMPLIANCE CERTIFICATIONS –
Meets or exceeds the following Specifications:
• ASME A112.19.2M for Vitreous China Fixtures.
• CAN/CSA B45 Series.

To Be Specified

- ☐ Colour: ☐ White
- ☐ Faucet*:
- ☐ Faucet Finish:
- ☐ Supplies & Stops:
- ☐ Trap 1-1/4" (32 mm):

* See faucet section for additional models available

 • Countertop 864mm (34") from finished floor. Sink installed 102mm (4") from front edge of countertop. Countertop thickness to be 25mm (1") maximum. **MEETS THE AMERICAN DISABILITIES ACT GUIDELINES AND ANSI A117.1 ACCESSIBLE AND USEABLE BUILDINGS AND FACILITIES - CHECK LOCAL CODES.**

NOTES:
WE RECOMMEND USING SINK AS A TEMPLATE TO DETERMINE PROPER CONTOUR. CUT COUNTERTOP 38MM (1-1/2") INSIDE SINK CONTOUR. FAUCETS NOT INCLUDED AND MUST BE ORDERED SEPARATELY.
★ DIMENSIONS SHOWN FOR LOCATION OF SUPPLIES AND "P" TRAP ARE SUGGESTED.
▼ UNDERCOUNTER MOUNTING KIT SUPPLIED SEPARATELY.
IMPORTANT: Dimensions of fixtures are nominal and may vary within the range of tolerances established by ANSI Standard A112.19.2. These measurements are subject to change or cancellation. No responsibility is assumed for use of superseded or voided pages.

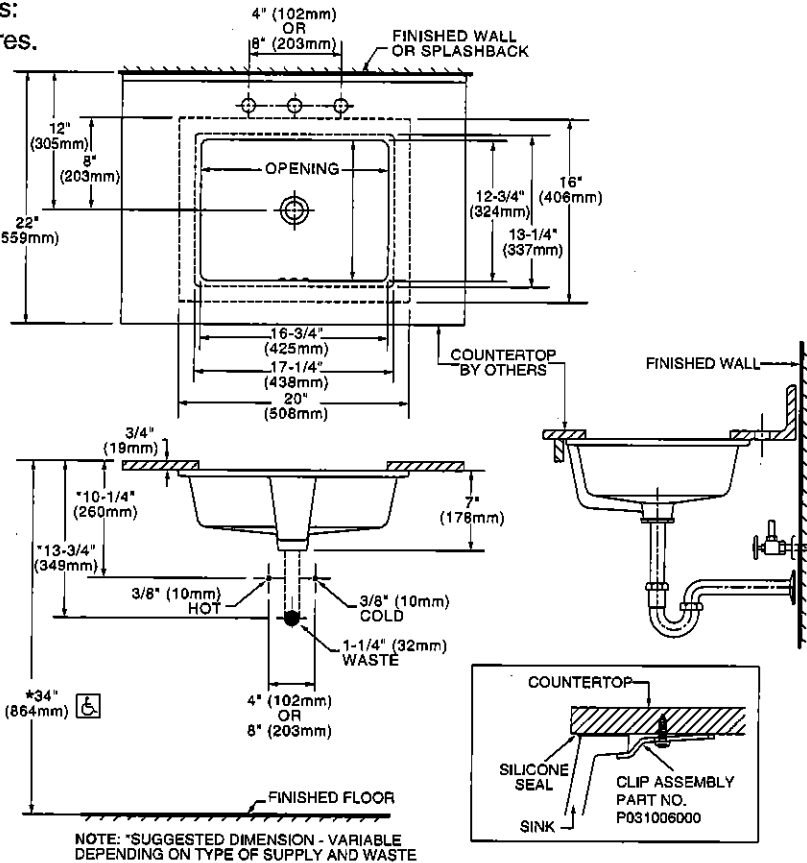

* To comply with ADA standards, overflow hole must face back.

S.S.

UK 3 WALLACETON
LOT 342
25-2653 ELEV D
THE WAKEFIELD

34.55

American Standard

 BARRIER FREE

COLONY™
COUNTERTOP SINK
VITREOUS CHINA

COLONY COUNTERTOP SINK

- Vitreous china
- Self-rimming
- Front overflow
- Supplied with template
- Faucet deck
(Faucet shown not included)

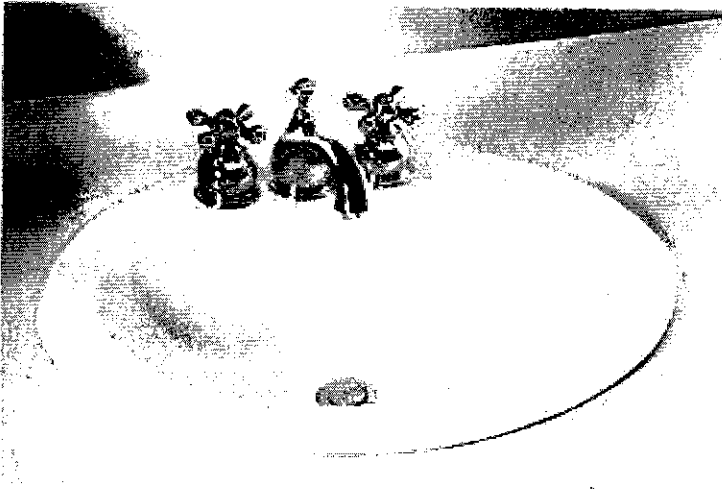

- ☐ 0346 803
Faucet holes on 203mm (8") centres
- ☒ 0346 403 (Illustrated)
Faucet holes on 102mm (4") centres
- ☐ 0346 001
Centre hole only

Nominal Dimensions:
521 x 448mm (20-1/2" x 17-5/8")

Bowl sizes:
422mm (16-5/8") wide, 279mm (11") front to back, 143mm (5-5/8") deep

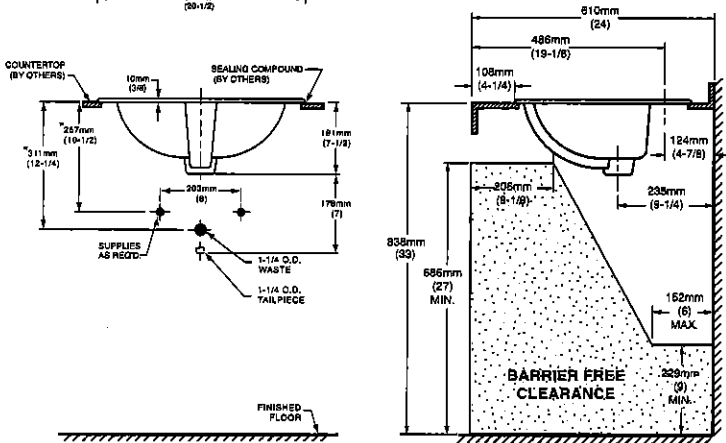
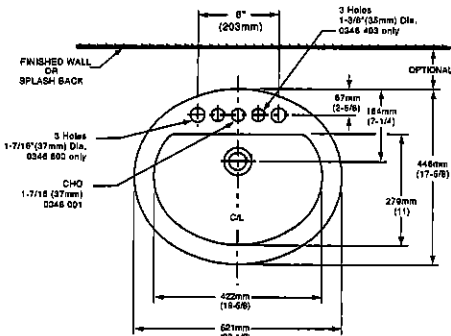

COMPLIANCE CERTIFICATIONS –
Meets or exceeds the following Specifications:
• ASME A112.19.2M for Vitreous China Fixtures.
• CAN/CSA B45 Series.

- To Be Specified
- ☐ Colour: ☐ White ☐ Bone ☐ Silver Gray ☐ Linen
 - ☐ Faucet*:
 - ☐ Faucet Finish:
 - ☐ Supplies & Stops:
 - ☐ Trap 1-1/4" (32 mm):

NOTES:
* DIMENSIONS SHOWN FOR LOCATION OF SUPPLIES AND "P" TRAP ARE SUGGESTED. FOR COUNTERTOP CUTOUT AND INSTALLATION INSTRUCTIONS USE TEMPLATE SUPPLIED WITH SINK. FAUCETS NOT INCLUDED AND MUST BE ORDERED SEPARATELY. IMPORTANT: Dimensions of fixtures are nominal and may vary within the range of tolerances established by ANSI Standard A112.19.2. These measurements are subject to change or cancellation. No responsibility is assumed for use of superseded or voided pages.

* See faucet section for additional models available

8.5.

UK 3 WALLACETON
LOT 342
25-2653 ELEV D
THE WAKEFIELD



35 of 55

DEMI™
Product Specification Sheet

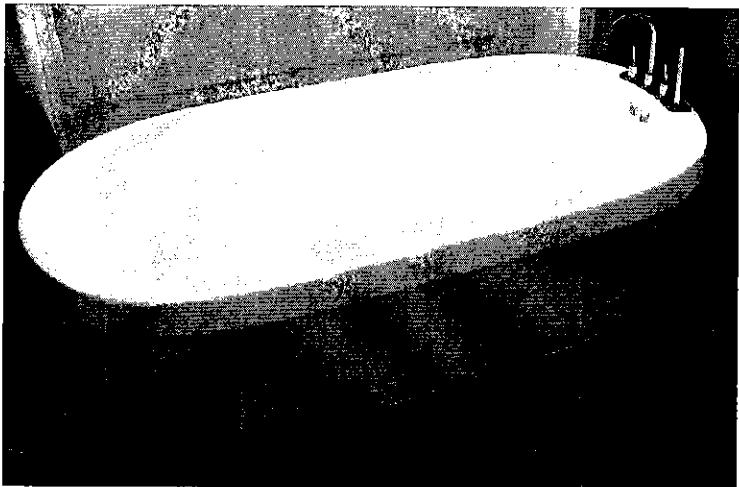

Two Piece Freestanding Collection

CF2007 Two Piece Freestanding Soaker

Size: 60" x 32" x 22"
1524 mm x 813 mm x 559 mm

PRODUCT FEATURES & BENEFITS

- Vacuum formed acrylic reinforced with fiberglass
- Scratch, stain and fade resistant high gloss finish
- Installation friendly two piece design
- Accepts deck mounted faucet
- Includes integral pop up drain and rectangular overflow
- Includes levelling feet

TWO PIECE ASSEMBLY

FRONT VIEW

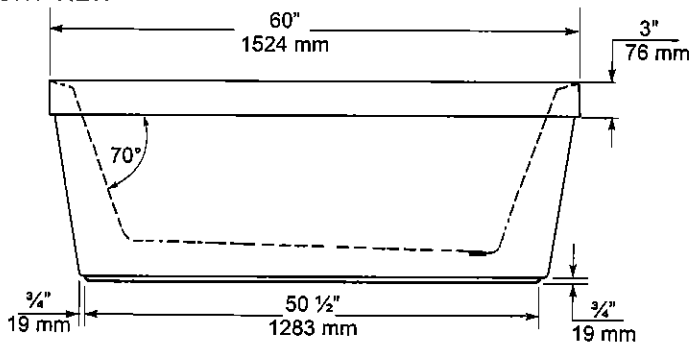

END VIEW

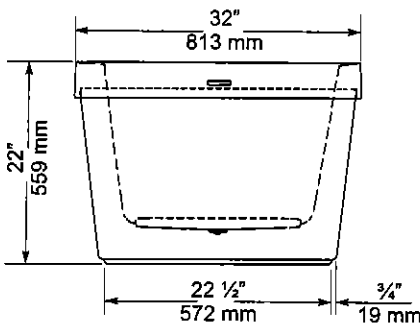

TOP VIEW

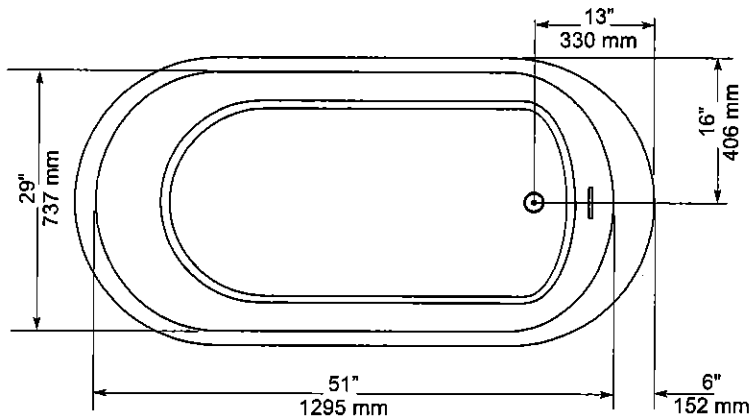

GENERAL SPECIFICATIONS		
Average Weight	90 lb	41 kg
Bathing Well at bottom	43"x 20"	1092 x 508 mm
Capacity Drain to Overflow		195 litres
Water Depth Drain to Overflow	16"	406 mm
Drain Opening (dia.)	2"	51 mm
Overflow Opening	2 1/4"x 1/2"	57 x 13 mm
Drain to Floor Clearance	3 1/4"	83 mm

NOTES: Please confirm measurements on actual product to ensure proper identification. Bathtub to be installed on the floor supported by 5 self levelling feet. Adjust if required to level the bathtub for adequate drainage. Refer to installation instructions for additional information.

IMPORTANT: Dimensions of fixtures are nominal and may vary $\pm 1/4"$ (6 mm). Weight may vary ± 5 lb (2.3 kg). Drawing is not to scale. These measurements are subject to change at manufacturer's discretion.

Compliance Certifications -
Meets or Exceeds the following Specifications:

- CAN/CSA - B45 Series



60 Shorncliffe Rd., Toronto, Ontario M8Z 5K1
Telephone: 416.231.9030 Fax: 416.231.0929
www.mirolin.com

© 2018 Mirolin Industries Corp.

Customer Service: 416.231.5790
Canada, U.S.A.: 800.MIROLIN(647-6546)
Fax, Canada: 800.463.2236

R0084162
25 Sep. 2018

S.S.

UK 3 WALLACETON
LOT 342
25-2653 ELEV D
THE WAKEFIELD

36 of 55

American Standard
Style That Works Better

FloWise™ DUAL FLUSH
ELONGATED TOILET
VITREOUS CHINA

FloWise™ DUAL FLUSH ELONGATED TOILET

- ☐ 2476 216
 - Vitreous china
 - Low-consumption Dual Flush
 - Full flush 6.0 Lpf/1.3 gpf,
 - Partial flush 3.0 Lpf/0.66 gpf.
 - Elongated wash down bowl
 - Internal trapway fully-glazed,
 - 2-1/4" (57mm) ballpass
 - Concealed trapway bowl
 - Chrome-plated top mounted push button actuator
 - Easy to clean sanitary dam on bowl
 - Includes Elongated Slow Close Seat
 - 100% factory flush tested
 - 2 bolt caps

Separate Component Parts:

- ☐ 3067 316 Elongated Bowl with Slow Close Seat
- ☐ 4035 216 Unlined Tank

- ☐ 2476 516 Same as above with Lined tank
 - ☐ 3067 316 Elongated Bowl
 - ☐ 4035 516 Lined Tank

Nominal Dimensions:
794 x 432 x 765mm
(31-1/4" x 17" x 30-1/8")

Compliance Certifications -
Meets or Exceeds the Following Specifications:
• ASME A112.19.2M (and 19.6M)
• CAN/CSA B45 series

- To Be Specified
- ☐ Colour: 020 White
 - ☐ Supply with stop:

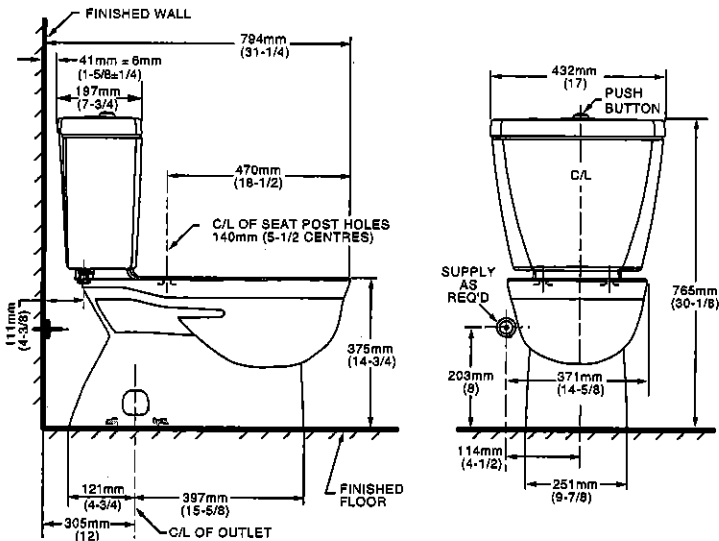

NOTES:
THIS TOILET IS DESIGNED TO ROUGH-IN AT A MINIMUM DIMENSION OF 305MM (12") FROM FINISHED WALL TO C/L OF OUTLET.
SUPPLY NOT INCLUDED WITH FIXTURE AND MUST BE ORDERED SEPARATELY.
* DIMENSION SHOWN FOR LOCATION OF SUPPLY IS SUGGESTED.
FOR ADDITIONAL INFORMATION REFER TO INSTALLATION INSTRUCTIONS SUPPLIED.
IMPORTANT: Dimensions of fixtures are nominal and may vary within the range of tolerance established by ANSI Standard A112.19.2.
These measurements are subject to change or cancellation. No responsibility is assumed for use of superseded or voided pages.

UPGRADED VALUE ADDED FEATURES AT NO EXTRA CHARGE

S.S.

UK 3 WALLACETON
LOT 342
25-2653 ELEV D
THE WAKEFIELD

37 of 55

MOEN®

Specifications

*There is more than one version of this model.
Page down to identify the version you have.*

DESCRIPTION

- Metal construction with various finishes identified by suffix
- Flexible supply lines with 3/8" compression fittings
- Includes metal pop-up waste assembly
- Includes Red/Blue indicators
- Optional 3 hole deck plate (escutcheon) available

OPERATION

- Lever style handle
- Temperature controlled by 100° arc of handle travel

FLOW

- Water usage is limited to these maximum flow rates as indicated by the corresponding product markings
 - ° 1.2 gpm max (4.5L/min) at 60 psi
 - ° 1.5 gpm max (5.7L/min) at 60 psi

CARTRIDGE

- 1255™ Duralast™ cartridge for Single-Handle Faucets

STANDARDS

- Third party certified to WaterSense,® ASME A112.18.1/CSA B125.1, and all applicable requirements referenced therein
- Certified to NSF 61/9 & 372
- Products marked with 1.2 gpm are compliant with California water efficiency regulations
- Complies with California Proposition 65 and with the Federal Safe Drinking Water Act
- **ADA**  for lever handle

WARRANTY

- Lifetime limited warranty against leaks, drips and finish defects to the original homeowner
 - 10 year limited warranty when used in a multifamily installation
 - 5 year limited warranty when used in a commercial installation
- Visit www.moen.com/support for complete details and limitations

MASTER ENSUITE x 2
POWDER ROOM x 1

MATTE BLACK

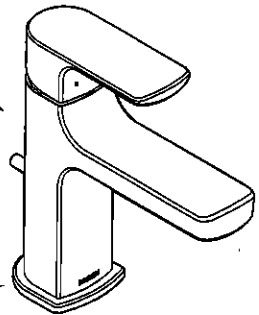

RIZON™

Single-Handle Lavatory Faucet

Model: 6900

**NOTE: THIS FAUCET IS DESIGNED TO BE
INSTALLED THROUGH 1 HOLE, 1-1/8" MIN. DIA.**

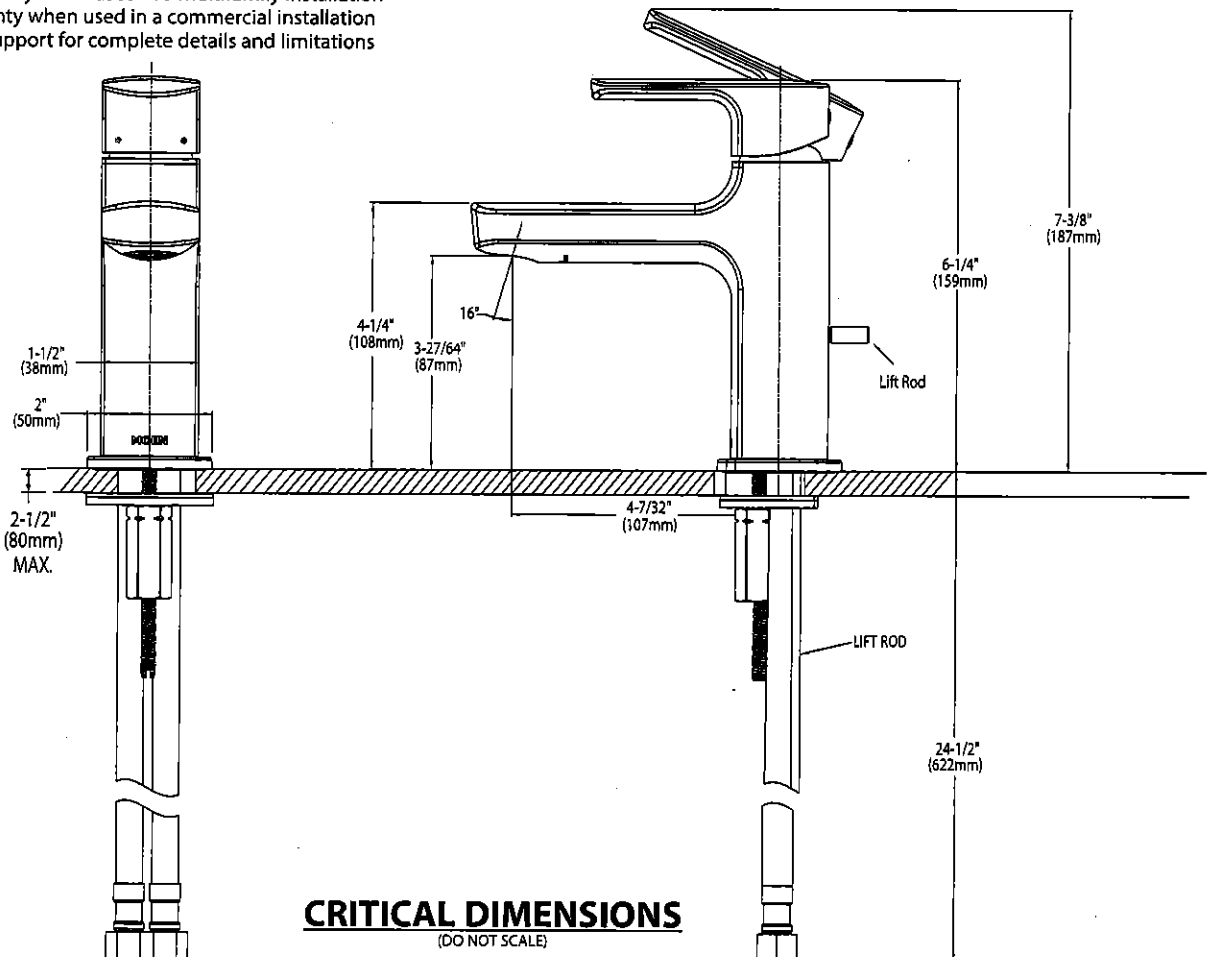

CRITICAL DIMENSIONS
(DO NOT SCALE)

UK 3 WALLACETON
LOT 342
25-2653 ELEV D
THE WAKEFIELD

38 of 55

MOEN®

Specifications

There is more than 1 version of this model.
Page down to identify the version you have.

DESCRIPTION

- Metal construction with various finishes identified by suffix
- Flexible supplies with 3/8" compression fittings
- Includes metal or 50/50 pop-up type waste assembly where noted

OPERATION

- Pivot action lever style handle
- Temperature controlled through 100° degree arc of handle travel

FLOW

- Water usage is limited to these maximum flow rates as indicated by the corresponding product markings
- 1.2 gpm max (4.5L/min) at 60 psi
- 1.5 gpm max (5.7L/min) at 60 psi

CARTRIDGE

- 1255™ Duralast™ cartridge
- Nonmetallic/nonferrous and stainless steel material

STANDARDS

- Third party certified to WaterSense®, ASME A112.18.1/CSA B125.1 and all applicable requirements referenced therein
- Certified to NSF 61/9 & 372
- Products marked with 1.2 gpm are compliant with California water efficiency regulations
- Complies with California Proposition 65 and with the Federal Safe Drinking Water Act

- **ADA**  for lever handle

WARRANTY

- Lifetime limited warranty against leaks, drips and finish defects to the original consumer purchaser
- 5 year warranty if used in commercial installations

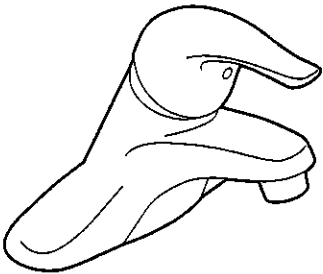

CHATEAU®
Single-Handle Lavatory Faucet

with Metal Waste Assembly

Model: L4625 series
L4631BC

Bulk Packed (12 per carton):
L64624 series

with 50/50 Waste Assembly

Bulk Packed (12 per carton):
L64625 series

Less Waste

Bulk Packed (12 per carton):
L64600 series

NOTE: THIS FAUCET IS DESIGNED TO BE
INSTALLED THRU 3-1" DIA. HOLES, 2" ON CENTER

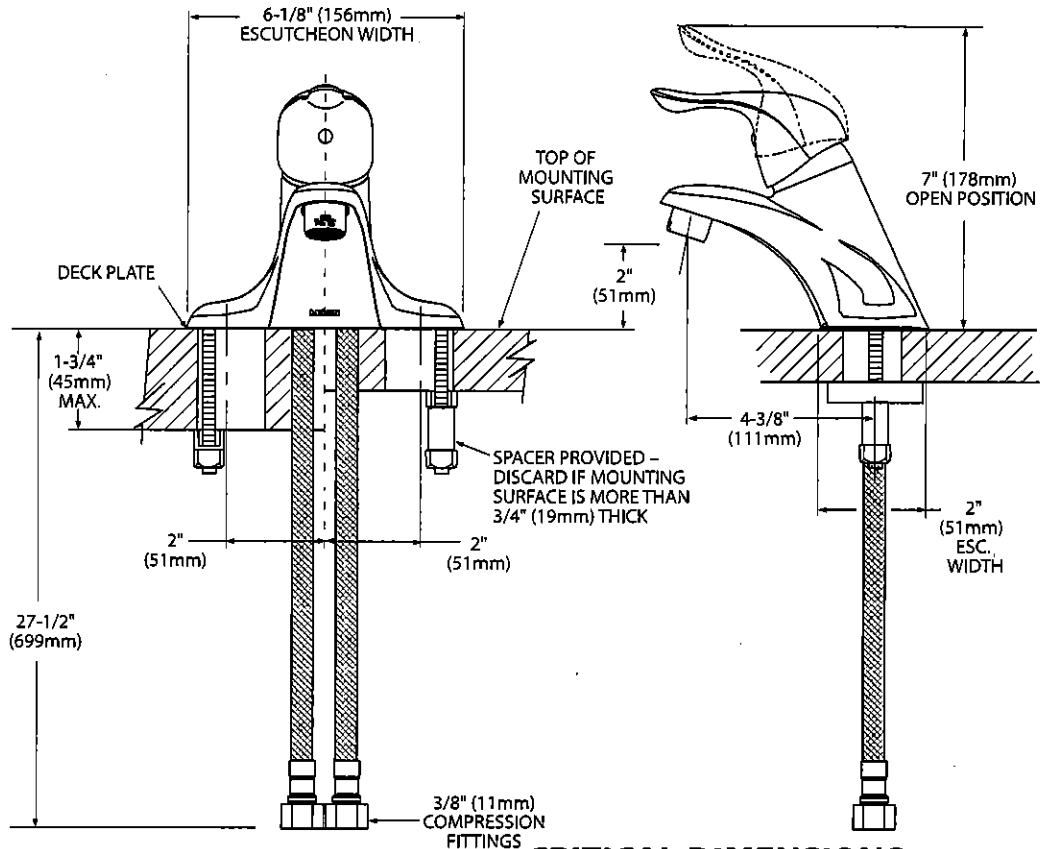

CRITICAL DIMENSIONS
(DO NOT SCALE)



Buy it for looks. Buy it for life.®

There is more than 1 version of this model.
Page down to identify the version you have.

DESCRIPTION

- Metal construction with various finishes identified by suffix
- Includes non-metallic showerhead, arm, flange and non-metallic diverter tub spout

OPERATION

- Handle operates counterclockwise through a 270° arc with off at 6 o'clock and maximum hot at the 9 o'clock position. Shut off in clockwise direction
- Adjustable temperature limit stop to control maximum hot water temperature
- Pressure balancing mechanism maintains selected discharge temperature to ± 3°

FLOW

- Showerhead is limited to 2.5 gpm (9.5 L/min) at 80 psi
- EP suffix models are limited to 1.75 gpm (6.6 L/min) at 80 psi
- NH suffix models contain no showerhead

CARTRIDGE

- 1222 cartridge design
- Accommodates back to back installations
- Nonmetallic/nonferrous and stainless steel material

STANDARDS

- Third party certified to meet ASME A112.18.1/CSA B125.1 and all applicable requirements referenced therein
- EP suffix models are third party certified to WaterSense®
- ADA ♿ for lever handle

WARRANTY

- Lifetime limited warranty against leaks, drips and finish defects to the original consumer purchaser
- 5 year warranty if used in commercial installations

Specifications

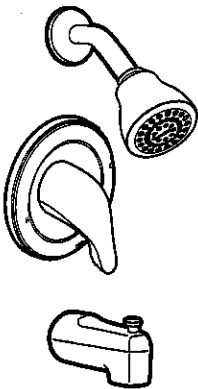

CHATEAU' POSI-TEMP'
Single-Handle Tub/Shower Trim Kit

- Models:
- TL181 series - valve trim only (Bulk Packed 12 per carton)
 - TL182 series - shower trim only (Bulk Packed 12 per carton)
 - TL183 series - tub/shower trim (Bulk Packed 12 per carton)

- Valves:
- 62300 series
 - 2500 series

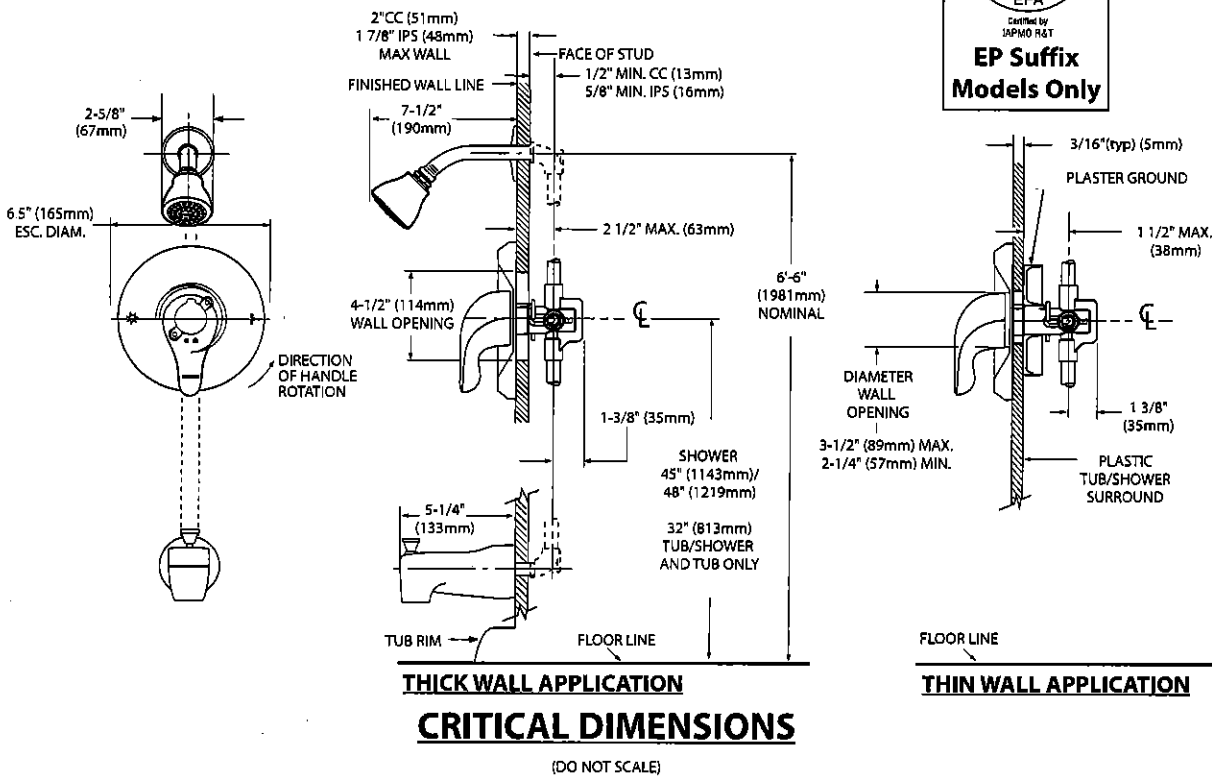

UK 3 WALLACETON
LOT 342
25-2653 ELEV D
THE WAKEFIELD

MOEN®

40 of 55

Specifications

DESCRIPTION

- Metal construction with various finishes identified by suffix

OPERATION

- Lever style handles with hot and cold color indicator
- Rotate hot side handle counterclockwise to open (clockwise to close) and the cold side handle (clockwise to open) and (counterclockwise to close)

STANDARDS

- Third party certified to: ASME A112.18.1/CSA B-125.1, and all applicable requirements referenced therein
- ADA ♿ for lever handles

WARRANTY

- Lifetime limited warranty against leaks, drips and finish defects to the original homeowner
 - 10 year limited warranty when used in a multi-family installation
 - 5 year limited warranty when used in a commercial installation
- Visit www.moen.com/support for complete details and limitations

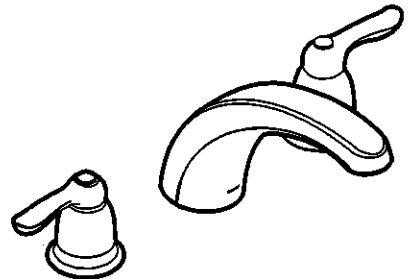

CHATEAU®
Two-Handle Garden Tub Trim

Models: T994 series

Valves: 4792, 4793, 4794, 4796, 4797, 4798

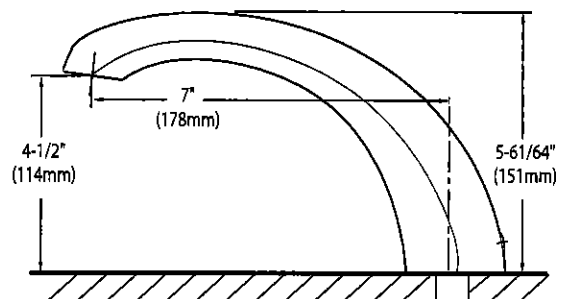
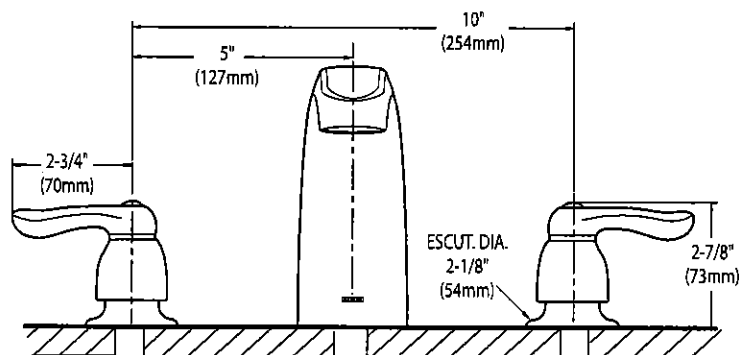

CRITICAL DIMENSIONS

(DO NOT SCALE)

UK 3 WALLACETON
LOT 342
25-2653 ELEV D
THE WAKEFIELD

41 of 55

AVG

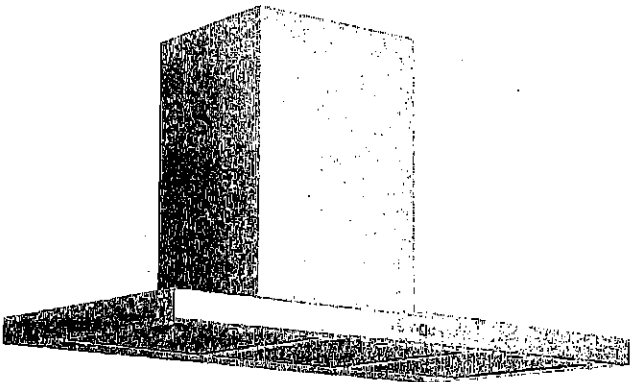
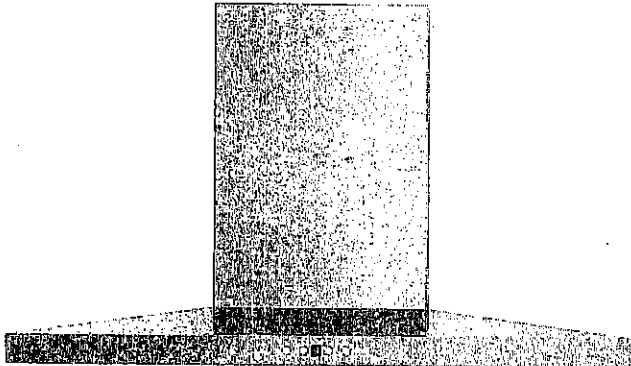

AVH-368CS
36" Wall mounted hood

Selected Model	
Model number	AVH-368CS
Dimensions	
Dimensions	35 1/2" (W) x 19 3/4" (D) x 3 1/4" (H)
Exterior Appearance	
Stainless steel grade	201
Features	
Control	Soft touch with LED display
Lighting	2 bulbs, 3W LED (bulbs included)
Blower type	860 CFM, 6-Speed
Blower performance	Speed 1, 2.4 sones
	Speed 6, 6.2 sones
Filter type	3 aluminium superior micro hole filters and stainless steel baffle filters included
Duct transition	6" Round (Top)
Ducting	Ducted
Chimney (ducted out)	For ceiling heights up to 9'0"
Electrical Requirements	
Electrical requirements	120V / 60Hz / 2.7 Amps
Accessories (optional)	
Optional duct covers	AD-884S (884mm, AVN-AVH compatible)
Warranty	
1-year Warranty	Parts and labour, in-home service

S.S.

UK 3 WALLACETON
LOT 342
25-2653 ELEV D
THE WAKEFIELD

42 of 55

AVH-308CS/368CS

Dimensions

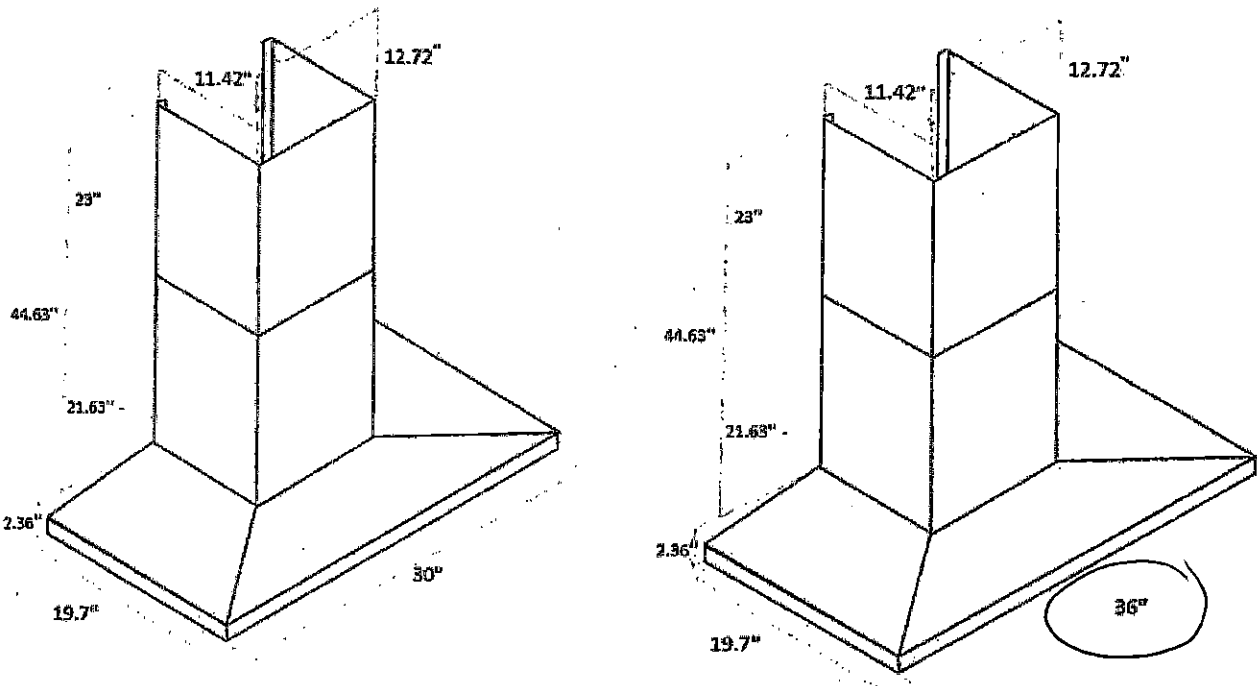

Installation

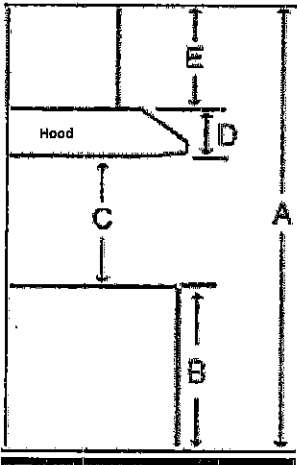

A	Floor to ceiling height	variable
B	Floor to counter top height (standard)	36"
C	Recommended height between cooking surface and bottom of the hood	28" to 30"
D	Hood height	2.36"
E	Chimney height	Max 44.63"

Duct transition

6" round top

The information contained herein is based on sources that we believe to be reliable, but is not guaranteed by us, may be incomplete and/or may change without notice.

Need technical support? 1(888) 651-2534

8.8.

UK 3 WALLACETON

LOT 342

25-2653 ELEV D

THE WAKEFIELD



BOSCH

Invented for life

43 of 55

800 Series French Door Bottom Mount

36" Easy Clean Stainless Steel

B36CL80ENS

★ ★ ★ ★ ☆ 4.5

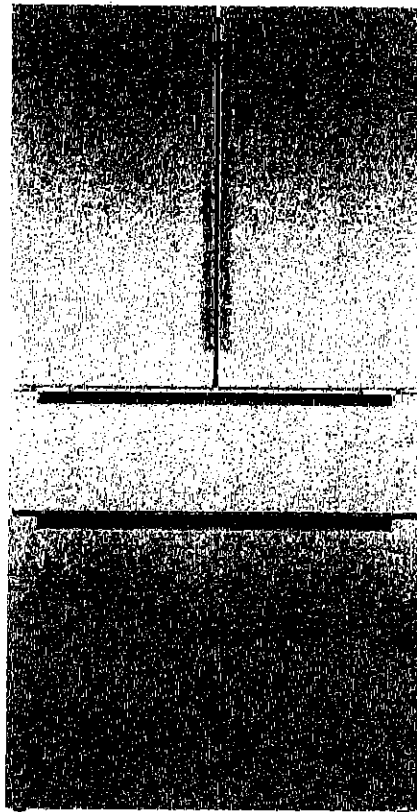

Website Feedback



the Original Freezer

Internal Water Dispenser

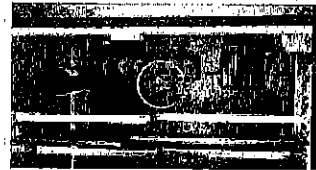

True Cold

Price

☐ Add to product compare

UK 3 WALLACETON
LOT 342
25-2653 ELEV D
THE WAKEFIELD

44 of 55

- Interior shelves are designed with high quality glass and stainless steel.
- Interior stainless steel back wall is made from the highest quality materials.

Performance

- VitaFreshPro™ automatically balances BOTH temperature and humidity via programmed settings.
- FreshProtect™ absorbs naturally occurring ethylene to slow ripening, so produce stays fresher longer.
- AirFresh® Filter and MultiAirFlow™ offer consistent temperature and reduced odors.

Technical Specifications

Find a Store® Qualified for delivery and installation

Compare products

Convenience

- Three separate gallon door bins can accommodate two side-by-side one-gallon containers each.
- Keep your kitchen looking beautiful with an easy to clean stainless steel exterior.
- SuperCool & SuperFreeze® ensure new room-temperature groceries chill quickly.

Capacity

- Generous 21 cu. ft. capacity is even more spacious with flexible storage features like FlexBar™.

Technical Specifications

+ General

Width of the product	905 mm
Appliance Width (in)	35 5/8 "
Height of the product	1,830 mm
Required cutout size (HxWxD) (in)	72 IN x 36 IN x 25 IN ←
Variant color	Easy Clean Stainless Steel
Silence level	40 dB(A) re 1 pW

Door hinge

Website Feedback

UK 3 WALLACETON
LOT 342
25-2653 ELEV D
THE WAKEFIELD

45 of 55

36" Gas Cooktop

Benchmark® Series – Stainless Steel NGMP656UC

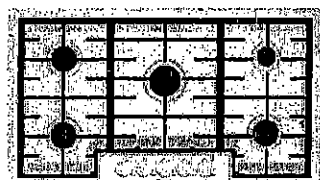

NGMP656UC
Stainless Steel

The 36" Benchmark® Series gas cooktop features a dual-stacked burner that delivers both a low simmer and high heat flame.

Features & Benefits

Dual stacked burner designed for faster boil time (20,000 BTUs) and a low simmer

OptiSim® Burner – simmer delicate sauces and melt chocolate without scorching

Electronic re-ignition will automatically re-ignite the burner in case the flame goes out

Continuous grates make moving heavy pots easier

Distinctive red LED light indicates burners are on

General Properties

Knob material	Metal
Sealed burners	Yes
Grate material	Cast Iron

Element Performance

Total BTU load (NG / LP)	59,500 / 47,300
Power of front left burner (NG / LP)	12,000 / 9,100
Power of back left burner (NG / LP)	10,000 / 9,100
Power of center burner (NG / LP)	20,000 / 15,000
Power of back right burner (NG / LP)	5,500 / 5,000
Power of front right burner (NG / LP)	12,000 / 9,100

Technical Details

Watts	360 W
Circuit breaker	15 A
Volts	120 V
Frequency	60 Hz
Plug type	3 prong
Power cord length	60"
Energy source	Gas
Convertible to LP (kit required)	Yes

Dimensions & Weight

Overall appliance dimensions (HxWxD)	3 13/16" x 37" x 21 1/4"
Required cutout size (HxWxD)	3 13/16" x 34 15/16" x 19 1/8"
Minimum distance from counter front	1 7/8"
Minimum distance from rear wall	3"
Net weight	39 lbs

Accessories – Included

Included	LP conversion kit
----------	-------------------

Accessories – Optional



HEZ298102
Wok ring



HEZGR301
Griddle



For help and assistance with Bosch accessories please visit: www.bosch-eshop.com/eshop/bosch/us or call 1-800-944-2904 Mon-Fri 5am to 6pm PST Sat 6am to 3pm PST

Notes: All height, width and depth dimensions are shown in inches. BSH reserves the absolute and unrestricted right to change product materials and specifications, at any time, without notice. Consult the product's installation instructions for final dimensional data and other details prior to making cutout. Applicable product warranty can be found in accompanying product literature or you may contact your account manager for further details.

Warranties: Bosch warrants that the Product is free from defects in materials and workmanship for a period of three hundred and sixty-five (365) days from the date of purchase. The foregoing timeline begins to run upon the date of purchase, and shall not be stalled, tolled, extended, or suspended, for any reason whatsoever. This Product is also warranted to be free from cosmetic defects in material and workmanship (such as scratches of stainless steel, paint/porcelain blemishes, chip, dents, or other damage) to the finish of the Product, for a period of thirty (30) days from the date of purchase or closing date for new construction. This cosmetic warranty excludes slight color variations due to inherent differences in painted and porcelain parts, as well as differences caused by kitchen lighting, product location, or other similar factors. This cosmetic warranty specifically excludes any display, floor, "As Is", or "B" stock appliances.

For more information on our entire line of products, go to www.bosch-home.com/us or call 1-800-944-2904

© BSH Home Appliances Corporation. All rights reserved. Bosch is a registered trademark of Robert Bosch GmbH.

01/18

S.S.

46 of 55

UK 3 WALLACETON
LOT 342
25-2653 ELEV D
THE WAKEFIELD

47 of 55

36" Gas Cooktop

Benchmark® Series – Stainless Steel NGMP656UC



Installation Details

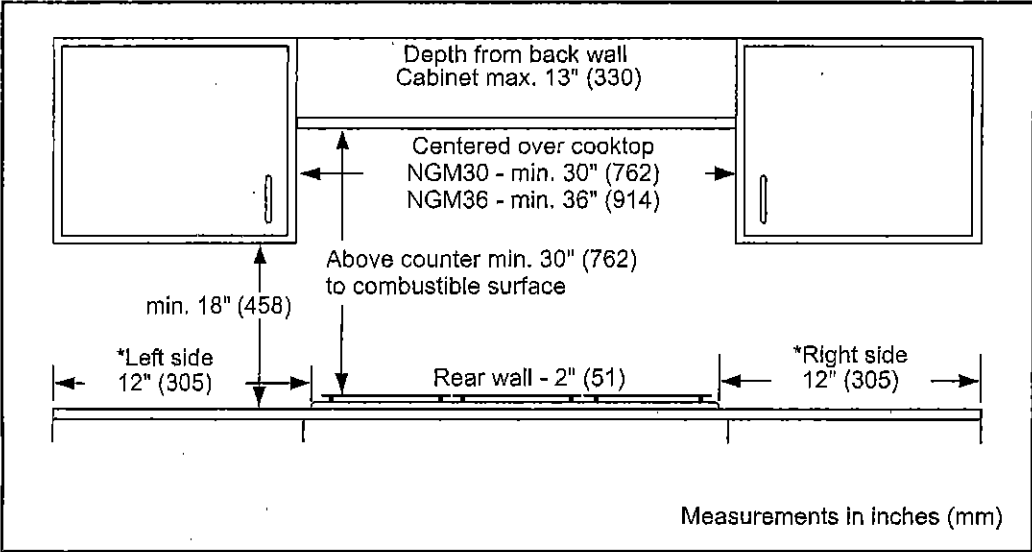

For help and assistance with Bosch accessories please visit: www.bosch-eshop.com/eshop/bosch/us or call 1-800-944-2904 Mon-Fri 5am to 6pm PST Sat 6am to 3pm PST

Notes: All height, width and depth dimensions are shown in inches. BSH reserves the absolute and unrestricted right to change product materials and specifications, at any time, without notice. Consult the product's installation instructions for final dimensional data and other details prior to making cutout. Applicable product warranty can be found in accompanying product literature or you may contact your account manager for further details.

Warranties: Bosch warrants that the Product is free from defects in materials and workmanship for a period of three hundred and sixty-five (365) days from the date of purchase. The foregoing timeline begins to run upon the date of purchase, and shall not be stalled, tolled, extended, or suspended, for any reason whatsoever. This Product is also warranted to be free from cosmetic defects in material and workmanship (such as scratches of stainless steel, paint/porcelain blemishes, chip, dents, or other damage) to the finish of the Product, for a period of thirty (30) days from the date of purchase or closing date for new construction. This cosmetic warranty excludes slight color variations due to inherent differences in painted and porcelain parts, as well as differences caused by kitchen lighting, product location, or other similar factors. This cosmetic warranty specifically excludes any display, floor, "As Is", or "B" stock appliances.

For more information on our entire line of products, go to www.bosch-home.com/us or call 1-800-944-2904

© BSH Home Appliances Corporation. All rights reserved. Bosch is a registered trademark of Robert Bosch GmbH.

UK 3 WALLACETON
LOT 342
25-2653 ELEV D
THE WAKEFIELD

48-55

30" Speed Combination Oven

800 Series – Stainless Steel HBL8753UC

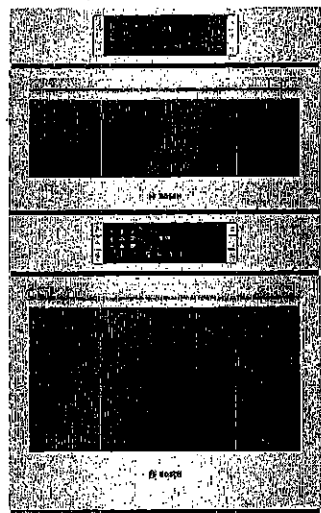

HBL8753UC
Stainless Steel

Also available in:
Black HBL8743UC
Stainless Steel

Bosch speed combination ovens create an all-in-one cooking center with an upper speed oven and a Genuine European Convection oven below.

Features & Benefits

2-in-1 microwave and convection oven with 9 SpeedChef® programs to simplify cooking with fast results.

Lower oven's convection multi-rack mode gives uniform baking results even when using all 3 racks simultaneously.

Oven is equipped with a self-cleaning cycle that easily cleans itself via 2, 3, and 4 hour cycle options.

Download the Home Connect app to remotely monitor and control your Bosch wall oven with your smart phone or tablet.

General Properties	
Home Connect™ – lower cavity (WiFi enabled)	Yes
Cooking modes – upper cavity	Speed oven; 12 Auto Programs (including Auto Defrost, Melt Butter, Soften Ice Cream, Pizza); 9 Sensor Cook Programs; 9 SpeedChef® Programs; Hi & Lo Broil; European Convection; Keep Warm; Frozen Foods
Cooking modes – lower cavity	Bake, Variable Broil (hi & low), Roast, Warm, Sabbath, Proof Dough, Convection Bake, Convection Broil, Convection Roast, Pizza, Multi Rack Genuine European Convection, Convection Conversion, Temperature Probe, Fast Preheat
Cleaning type – lower	Self Clean
Telescopic rack	1
Illumination type	LED (Upper) / Incandescent (Lower)
Interior lights	1 Upper / 2 Lower

Oven Performance	
Microwave power – upper cavity	1000 W
Bake / broil element wattages – upper cavity	600 / 1,750 W
Convection element wattages – upper cavity	1,700 W
Bake / broil element wattages – lower cavity	2,400 / 3,800 W
Convection element wattages – lower cavity	2,000 W

Technical Details	
Watts (W)	9,600 W
Circuit breaker (A)	40 A
Volts (V); Frequency (Hz)	240 V / 208 V; 60 Hz
Power cord length (in)	50"
Plug type	Fixed Connection, No Plug
Energy source	Electric

Dimensions & Weight	
Overall appliance dimensions (HxWxD) (in)	49" x 29 3/4" x 24 1/2"
Required cutout size – Standard (HxWxD) (in)	48 5/8" x 28 1/2" x 23 1/2"
Required cutout size – Flush (HxWxD) (in)	49 1/8" x 30" x 24 1/2"
Speed oven cavity size – upper	1.6 cu. ft.
Overall upper speed oven interior dimensions (HxWxD) (in.)	9 7/8" x 16 1/2" x 16 1/2"
Metal turntable diameter (in)	14 1/8" dia.
Ceramic tray diameter (in)	13 3/4" dia.
Rack – rectangular cookware max. – upper	15" x 12"
Oven cavity size – lower	4.6 cu. ft.
Overall lower oven interior dimensions (HxWxD) (in)	17 13/16" x 24 1/8" x 18"
Usable lower oven interior dimensions (HxWxD) (in)	12 1/4" x 23 1/4" x 15 1/4"
Net weight (lbs)	259 lbs.

Accessories – Included	
Upper Oven:	Metal Turntable, Square rack, Ceramic Cooking Tray
Lower Oven:	1 Telescopic and 2 Standard Oven Racks, Meat Probe

Accessories – Optional



HEZTR301
30" Telescopic Rack

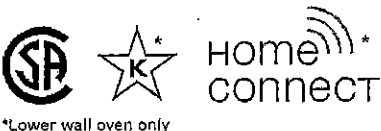

Accessories: To purchase Bosch accessories, cleaners & parts please visit www.bosch-home.com/us/store or call 1-800-944-2904 (Mon to Fri 5 am to 6 pm PST, Sat 6 am to 3 pm PST).
Notes: All height, width and depth dimensions are shown in inches. BSH reserves the absolute and unrestricted right to change product materials and specifications, at any time, without notice. Consult the product's installation instructions for final dimensional data and other details prior to making cutout.
Warranties: Please see Use & Care manual or Bosch website for statement of limited warranty.
For more information on our entire line of products, go to www.bosch-home.com/us or call 1-800-944-2904
© BSH Home Appliances Corporation. All rights reserved. Bosch is a registered trademark of Robert Bosch GmbH.

8.5.

UK 3 WALLACETON
LOT 342
25-2653 ELEV D
THE WAKEFIELD

49.55

30" Speed Combination Oven

800 Series - Stainless Steel HBL8753UC



Installation Details

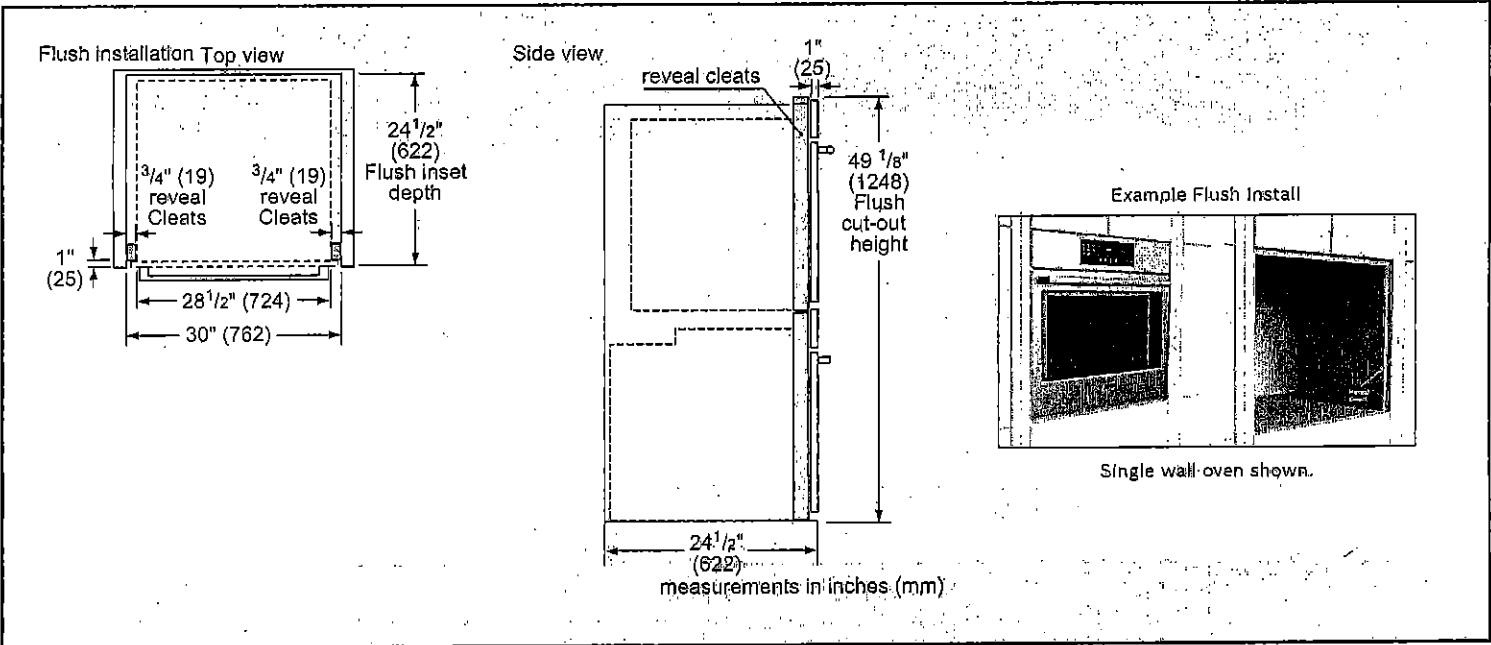
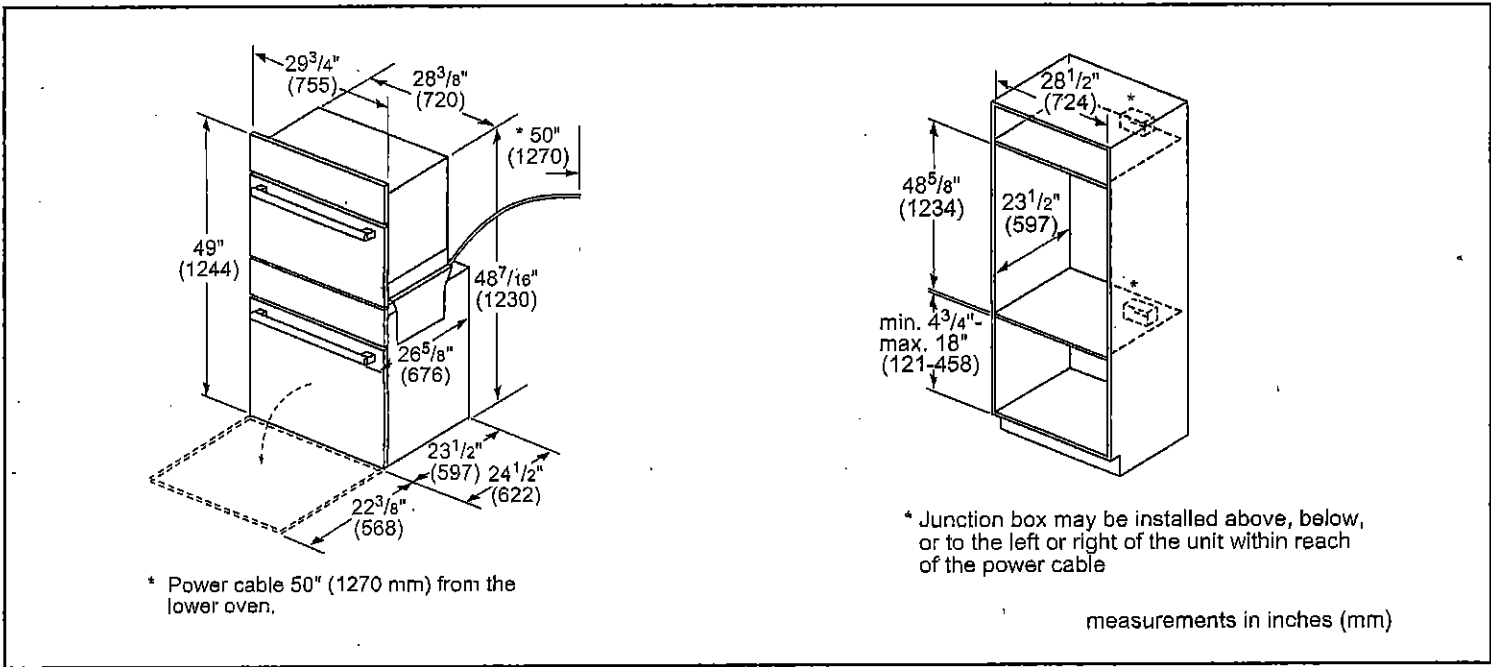

Accessories: To purchase Bosch accessories, cleaners & parts please visit www.bosch-home.com/us/store or call 1-800-944-2904 (Mon to Fri 5 am to 6 pm PST, Sat 6 am to 3 pm PST).
Notes: All height, width and depth dimensions are shown in inches. BSH reserves the absolute and unrestricted right to change product materials and specifications, at any time, without notice. Consult the product's installation instructions for final dimensional data and other details prior to making cutout.
Warranties: Please see Use & Care manual or Bosch website for statement of limited warranty.
For more information on our entire line of products, go to www.bosch-home.com/us or call 1-800-944-2904
© BSH Home Appliances Corporation. All rights reserved. Bosch is a registered trademark of Robert Bosch GmbH.

S.S.

UK 3 WALLACETON
LOT 342
25-2653 ELEV D
THE WAKEFIELD

50 of 55

30" Speed Combination Oven

800 Series – Stainless Steel HBL8753UC



Installation Details

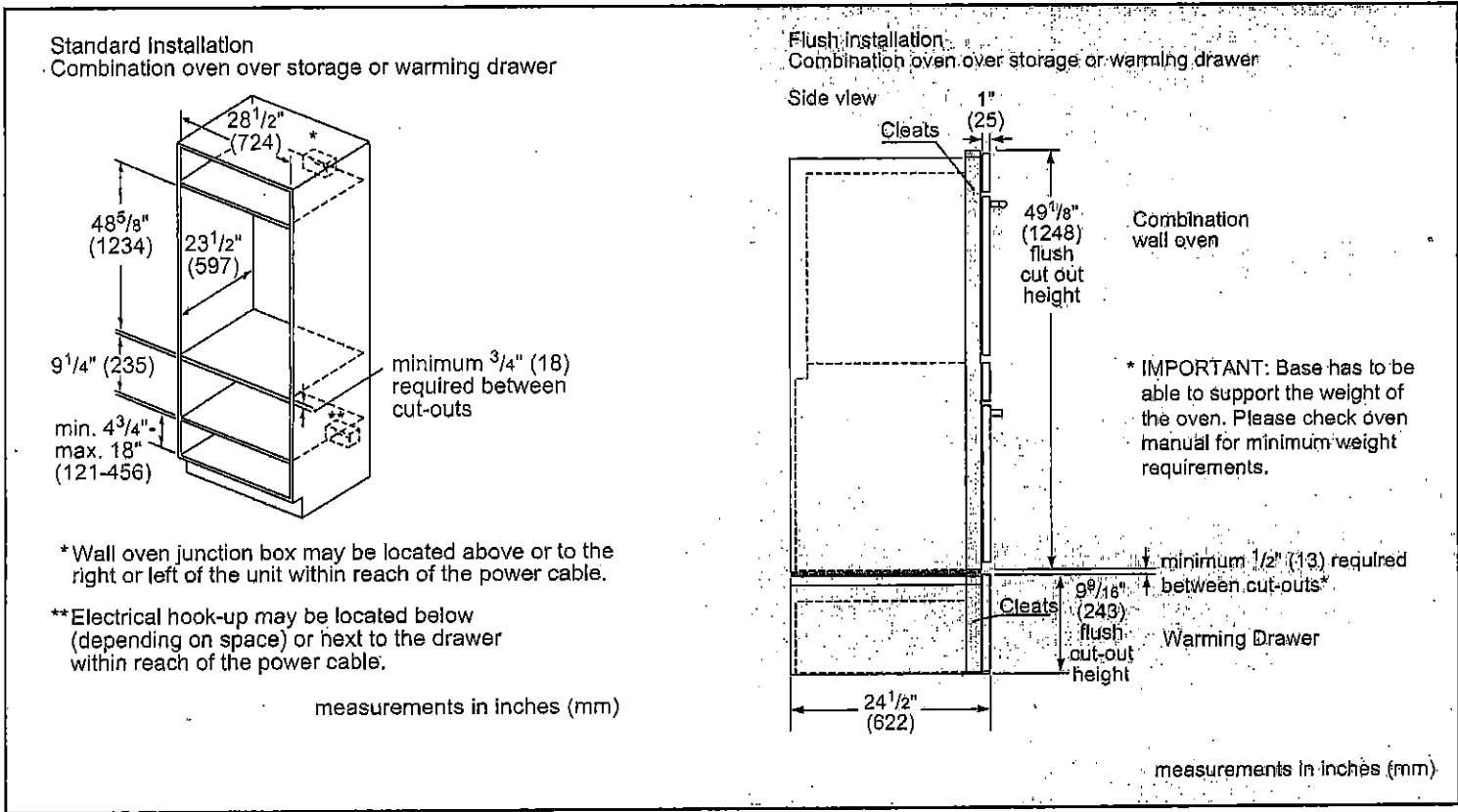

Accessories: To purchase Bosch accessories, cleaners & parts please visit www.bosch-home.com/us/store or call 1-800-944-2904 (Mon to Fri 5 am to 6 pm PST, Sat 6 am to 3 pm PST).

Notes: All height, width and depth dimensions are shown in inches. BSH reserves the absolute and unrestricted right to change product materials and specifications, at any time, without notice. Consult the product's installation instructions for final dimensional data and other details prior to making cutout.

Warranties: Please see Use & Care manual or Bosch website for statement of limited warranty.

For more information on our entire line of products, go to www.bosch-home.com/us or call 1-800-944-2904

© BSH Home Appliances Corporation. All rights reserved. Bosch is a registered trademark of Robert Bosch GmbH.

UK 3 WALLACETON
LOT 342
25-2653 ELEV D
THE WAKEFIELD
 **BOSCH**
Invented for life

51 of 55

✓ An important message from our CEO Christofer von Nagel. Click here to read.

300 Series Dishwasher
24" Stainless steel
SHEM63W55N

★★★★☆ 4.6

Top
Seller

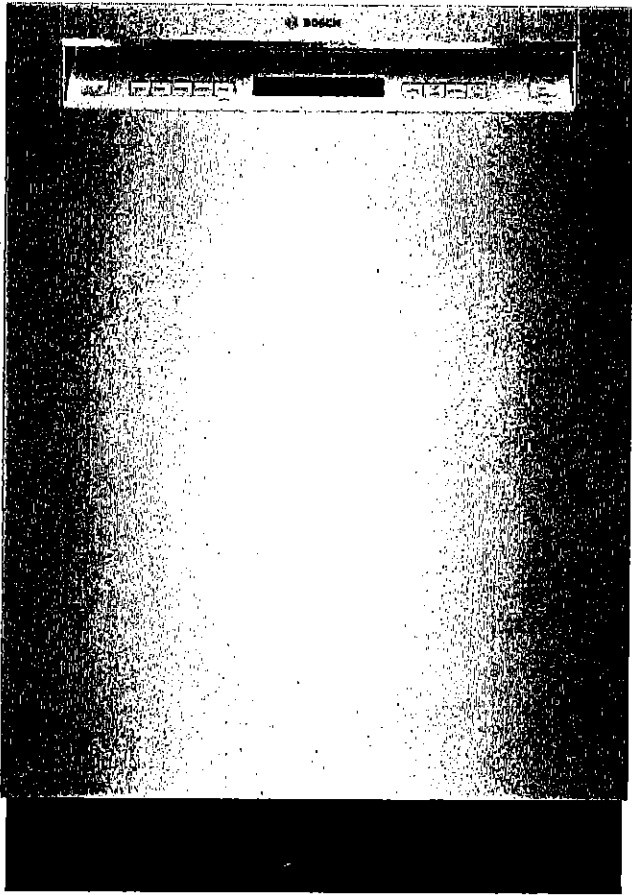

Site Feedback



Price

☐ Compare product

UK 3 WALLACETON
LOT 342
25-2653 ELEV D
THE WAKEFIELD

52 of 55

- Full Size Stainless Steel Tall Tub Installs Perfectly Flush
- 16 Place Setting Capacity
- LED Remaining Time Display

Performance

- 5 Wash Cycles and 4 Options
- Detergent Tray Optimizes Detergent Dissolving
- Speed60® gets your dishes from dirty to dry in about an hour.
- Extra Dry Option for Better Drying Results
- Load Size Sensor Automates Wash Temperature
- Sanitize Option Eliminates Bacteria and Enhances Drying Results

Efficiency

- 269 kWh/yr - Energy Star®

Convenience

- Electronic delay timer: 1-24 hours Delay Start Timer
- Self-Latching Door

Technical details

- 3rd Rack: 3rd Rack 1.0
- Accessories Parts: no
- ADA Compliant: No
- Business field: E31
- ChildLock: Button suspension
- Variant color: Stainless steel
- Tub material: Stainless steel
- Hidden heating element: Yes
- Power cord length: 67"
- Watts (kW): 1440 W
- Current (A): 12 A
- Volts (V): 120 V
- Frequency (Hz): 60 Hz
- Approval certificates: CUL, UL
- Power cord length (cm): 170 cm
- Overall appliance dimensions (HxWxD): 860 x 598 x 602
- Plug type: Nema5-15P
- Overall appliance dimensions (HxWxD): 33 7/8" x

UK 3 WALLACETON

LOT 342

25-2653 ELEV D

THE WAKEFIELD

53 of 55

- Product packaging dimensions (HxWxD): 30 1/2 x 14 1/2 x 660
- Product packaging dimensions (HxWxD): 35 3/4" x 26" x 29 5/16"
- Adjustable feet: Yes - all from front
- Energy Consumption (kWh/yr): 269
- Energy Star® qualified: Yes
- Highlights: Hygiene, varioDrawer
- Filtration type: 3-fold corrugated
- Five-Level Wash: No
- Net weight (kg): 40.825 kg
- Gross weight (kg): 42.6 kg
- Home Connect Connectivity: Not applicable
- Sanitized indicator light: No
- Info Light: Not applicable
- Number of place settings: 16
- Length outlet hose: 78 3/4"
- Load Sensor: Yes
- Program 1: Power Scrub Plus
- Program 5: Rinse & Hold
- Required cutout size (HxWxD): 860-890 x 610 x 610
- Required cutout size (HxWxD): x 33 7/8" x 23 9/16"
- Water softener: No
- Sanitizing wash cycle(s): Yes
- Flip tines in lower rack: 2
- Flip tines in upper rack: 1
- Number of Options: 4
- Start delay time max (h): 24 h
- Panel ready: No
- Status indicator: sanitized LED US, Time remaining Indicator front
- Digital countdown indicator: Yes
- Number of programs: 5
- Cycle Options: , ,
- Remaining Time Projection: No
- Interior light: No
- Adjustable upper rack: Rackmatic 3-stage
- Silverware Basket: Standard

54 OF 55

LG LAUNDRY

WM4500HBA

5.0 cu.ft. Front Load Washer with TurboWash™ 360°
and Built-In Intelligence

5.0 cu. ft. Mega Capacity
TurboWash™ 360° Technology
AI Fabric Sensor/ Smart Pairing™
ezDispense™ Automatic Dispenser
AAFA Certified LG washer
LG ThinQ® Technology / Proactive Customer Care
ColdWash™ Technology
Direct Drive Motor 10-Year Limited Warranty
ENERGY STAR® Certified
Closet Depth
NeverRust™ Stainless Steel Tub and Lifters

AVAILABLE COLORS



Enjoy new ways to control your home with LG smart appliances

- Use the ThinQ® app to start the laundry while you're out
- Get alerts when the cycle is finished
- With Smart Pairing™, the washer can tell the dryer to select a compatible drying cycle

LG ThinQ®

works with the
Google Assistant

WORKS WITH
alexa

SUMMARY

Front Load Washer		Spin Speeds		Extra High, High, Medium, Low, No Spin		NeveRust™ Stainless Steel Drum	
Type	5.0 cu. ft.	Max RPM	1300			Cabinet	PCM
Capacity (cu.ft.)	DLEX4500B	Water Levels	Load Sensing			Control Panel	Plastic
Matching Electric Dryer	DLGX4501B	No. of Soil Levels	5			Top Plate	Painted
Matching Gas Dryer						Door / Rim	Glass/Chrome
Color	Black Steel (B)					Door Cover	Dark Black Tinted Square Cover
						All Available Colors	Black Steel (B)
APPEARANCE		FABRIC CARE FEATURES		CERTIFICATION		CERTIFICATION	
Hard Buttons	Yes	AI DD™	Yes			AAFA	Yes
Touch Buttons	Yes	TurboWash™ 360 Technology	Yes			POWER SOURCE	
Dial-A-Cycle™	Yes	Steam Technology	Yes			Rating	UL Listed
ENERGY		Allergiene™ Cycle	Yes			Electrical Requirements	120V, 10 Amps
ENERGY STAR® Most Efficient 2019	Yes	Sanitary Cycle	Yes			Type	Electric
ENERGY STAR® Qualified	Yes	ColdWash™ Option	Yes			OPTIONS/ACCESSORIES	
CEE Tier	Advanced	SenseClean™ System	Yes			Pedestal	WDP4B
IMEF	3.1	CONVENIENCE FEATURES				Pedestal (WxHxD)	27" x 14 1/8" x 30 3/4" (50 9/16 D with door open)
IWVF	2.9	TrueBalance™ Anti-Vibration System	Yes			LG Sidekick™ Pedestal Washer (WxHxD)	WD100CB
WASH PROGRAMS						LG Sidekick™ Pedestal Washer (WxHxD)	27" x 14 1/8" x 30 3/4" (50 9/16 D with door open)
No. of Programs	14	4 Tray Dispenser				Stacking Kit	KSTK1
	Normal, Heavy Duty, Bedding, Sanitary, Allergiene™, Bright White, Tub Clean, Delicates, Perm. Press, Sportswear, Towels, Speed Wash, Rinse+Spin, Downloaded	LoDecibel™ Quiet Operation	Yes			DIMENSIONS	
Wash Programs		End of Cycle Signal	Yes			Product (WxHxD)	27" x 39" x 33 1/4"
		LoadSense	Yes			Depth with Door Open	(53 1/4" D with door open)
		Child Lock	Yes			Carton (WxHxD)	29 23/32" x 43 4/32" x 33 28/32"
WASH OPTIONS		Auto Suds Removal	Yes			Weight (Product/Carton)	201.5 / 215.2 lbs
No. of Options	15	Leveling Legs	4 Adjustable Legs			LIMITED WARRANTY	
	TurboWash®, Steam, Fresh Care, Pre-wash, Remote Start, Delay Wash, Wi-Fi, Add Item, Extra Rinse, Control Lock, Drum Light, ColdWash, Spin Only, Detergent Level, Softener Level	Easy Loading TiTub™	Yes			Parts and Labor	1 Year
Options		ThinQ™ TECHNOLOGY				Direct Drive Motor	10 Years
		SmartDiagnosis™ (v3.0)	Yes			Drum	3 Years
		Wi-Fi	Yes			UPC CODES	
		Remote Start and Cycle Monitor	Yes			WM4500HBA (Black Steel)	048231026772
WASH DETAILS		Energy Monitoring	Yes				
No. of Wash/Rinse Temps	5	MOTOR AND AGITATOR					
Wash/Rinse Temps	Extra Hot, Hot, Warm, Cold, Tap Cold	Motor Type	Inverter Direct Drive Motor				
		Axis	Horizontal				

© 2020 LG Electronics USA, Inc. All rights reserved. "LG Life's Good" is a registered trademark of LG Corp. All other product and brand names are trademarks or registered trademarks of their respective owners. Design, features and specifications are subject to change without notice. Non-metric weights and measurements are approximate. Some features may require Internet access. Content and services may vary by product and are subject to change without notice. 7/22/20

WASHER / DRYER TO BE STACKED
 LG Life's Good
 STACKING KIT PROVIDED BY PURCHASER

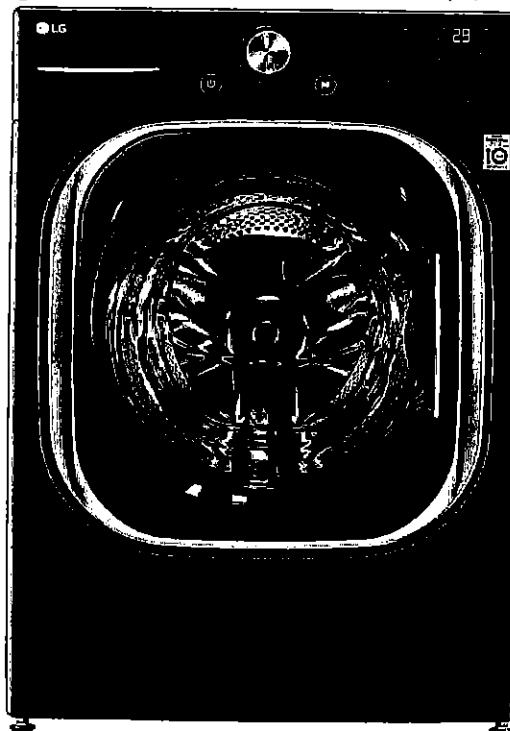

UK 3 WALLACETON
LOT 342
25-2653 ELEV D
THE WAKEFIELD

55 of 55

HOME APPLIANCES

LG LAUNDRY

DLEX4500B / DLGX4501B

7.4 cu.ft. Front Load Dryer with TurboSteam™



KEY FEATURES

- TurboSteam™ Technology
- ThinQ® Technology
- Sensor Dry System
- 7.4 cu. ft. Capacity
- FlowSense™ Duct Clogging Indicator
- ENERGY STAR® Qualified
- Electronic Controls with Dual LED Display
- LoDecibel™ Operation

AVAILABLE COLORS



BLACK STEEL



SMART APPLIANCE

LG ThinQ®

Enjoy new ways to control your home with LG smart appliances

- Start the laundry while you're out shopping
- Get alerts when the cycle is finished
- Works with the LG ThinQ® app

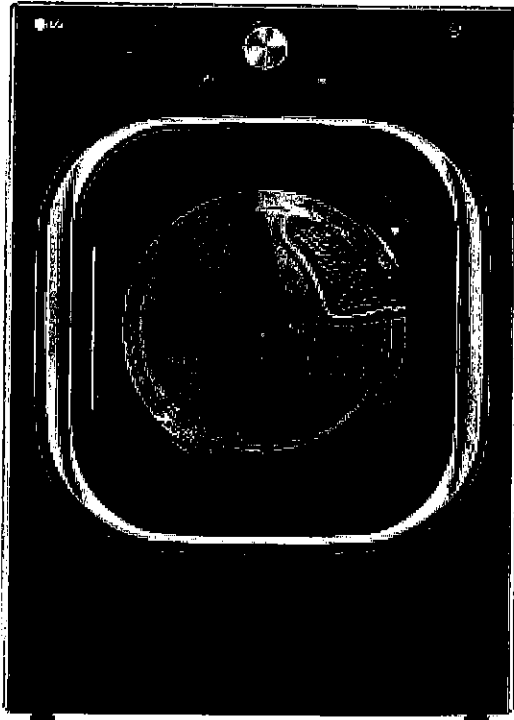

PRODUCT FEATURES

SUMMARY

Series	LG
Type	Front Load Dryer
Capacity	7.4 cu. ft.
Matching Washer	WM4500HBA
Sensor Dry	Yes
Steam	Yes
Colors	Black Steel (8)
APPEARANCE	
Intelligent Electronic Controls with LED Display	Yes
Dial-A-Cycle™	Yes
Touch Buttons	Yes
DRYER PROGRAMS	
No. of Programs	14
Programs (Sensor Dry)	Normal, Perm Press, Bedding, Towels, Delicates, Heavy Duty, SteamFresh™, SteamSanitary™, Anti-Bacterial, Sports Wear, Download, Small Load, Speed Dry (Manual Dry), Air Dry (Manual Dry)
No. of Options	12
Options	More Time, Less Time, Damp Dry Signal, Wrinkle Care, Control Lock, Wi-Fi, Energy Saver, TurboSteam™, Reduce Static, Remote Start, Drum Light
DRYER DETAILS	
Temperature Settings	High, Med.High, Medium, Low, Ultra Low
Drying Levels	Very Dry, More Dry, Normal Dry, Less Dry, Damp Dry
Manual Dry Times	60 min., 50 min., 40 min., 30 min., 20 min., More Time/Less Time

FABRIC CARE FEATURES

Sensor Dry	Yes
Precise Temperature Control with Variable Heater	Yes
Steam	TurboSteam™
CONVENIENCE FEATURES	
3 Minute Installation Check	Yes
LoDecibel™ Quiet Operation	Yes
End of Cycle Signal	Yes
Drum Light	Yes
Reversible Door	Yes
FlowSense™ Duct Clogging Indicator	Yes
Wrinkle Care Option	Yes
Child Lock	Yes
Venting Option	Electric: 4 Way Venting / Gas: 3 Way Venting
4 Adjustable Legs	Yes
Remaining Time Display/Status Indicator(s)	Yes

ThinQ® TECHNOLOGY

SmartDiagnosis™	Yes
Wi-Fi	Yes
Remote Start	Yes (Wi-Fi)
Cycle Monitoring and Notification	Yes
Energy Monitoring	Yes (Wi-Fi)
ENERGY	
ENERGY STAR® Qualified	Yes
CEF	3.94 Electric, 3.49 Gas

MATERIALS AND FINISHES

NeveRust™ Stainless Steel Drum	Yes
Tub Rear	Painted
Cabinet	Painted Steel
Door	Square w/ Chrome trim
All Available Colors	Black Steel (8)

POWER SOURCE

Ratings	CSA Listed
Electrical Requirements	120V, 15 Amps (Gas) / 240V 30 Amps (Electric)
Type	Electric/Gas
BTU Rating	20,000 Feet

OPTIONS

LP Conversion Kit	LPK1
Side Venting Kit	3911EZ9131X
Pedestal	WDP4B
Pedestal (WxHxD)	27 x 14 1/8 x 30 3/4 (50 1/2 D with door open)

DIMENSIONS

Product (WxHxD)	27" x 38 11/16" x 30"
Depth with Door Open	51"
Carton (WxHxD)	29 19/32" x 43 3/8" x 31 3/8"
Weight (Product)	146.8
Weight Carton	160.0

LIMITED WARRANTY

Parts & Labor	1 Year
UPC CODES	
DLEX4500B (Black Steel)	048231026789
DLGX4501B (Black Steel)	048231026796
WM4500HBA (Black Steel)	048231026772