

Sales Selection Sheet  
Checklist

1 of 28

LOT 3191B-10    Model: 20-1790 A The Dunmore  
PURCHASERS: MUHAMMAD, ASIF SHAHZAD/  
VENDOR:        Heathwood Homes (Huron) Limited

DECK LOT

- ☒ FINISHED BASEMENT  
☐ COLD CELLAR

UPGRADED / MODIFIED ELEVATION

- ☐ CORNER UPGRADE  
☐ REAR UPGRADE

CEILING UPGRADE - SMOOTH

- ☐ MAIN FLOOR  
☐ SECOND FLOOR  
☐ BASEMENT

ADDITIONAL ROUGH-INS

- ☐ 200 AMP SERVICE (UPG FOR TOWNS)  
☐ WET BAR ROUGH-IN  
☐ HUMIDIFIER  
☒ AIR CONDITIONING (SITE STD)

GAS ROUGH-IN

- ☐ STOVE  
☐ DRYER  
☐ BBQ  
☐ ADDITIONAL FIREPLACE

KITCHEN: HOODFAN VENTING SIZE

- ☐ 6 IN ROUND DUCT  
☒ 7 IN ROUND DUCT

FULL BASEMENT STAIRS:	N/A
UPPER BASEMENT STAIRS:	All Oak
LOWER BASEMENT STAIRS:	Carpet Grade
MAIN STAIRS:	All Oak
MEDIA STAIRS (if applicable):	N/A
LOFT STAIRS (if applicable):	N/A

MARCH 22/23    Signature on  
Date    Purchaser:    file

Date    Purchaser:

Locked Date:

MARCH 22/23    TINA LEFUR  
Date    Decor Consultant:  
  
-03- 22 2023    mRosen  
Date    Heathwood Homes (Huron) Limited  
Approved

Customer Colours

MUHAMMAD, ASIF SHAHZAD/  
Project: Wallaceton  
Unit: 3191B-10, Phase: 3  
Model: 20-1790 A The Dunmore

Locked:  
Closed:

Kitchen

Cabinet Colour/Style	6265	Viking III-MANCHESTER-SHALE GREY CL-MAPLE ***STD***
Countertop	9069	MSI Quartz GROUP 1 ICED WHITE ***STD***
Countertop Edge	4010	SINGLE POLISHED STRAIGHT EDGE 3/4 INCH ***STD*** 
Cabinet Hardware	7667	12881-HARDWARE ***STD***
Island Cabinet Colour/Style	6265	Viking III-MANCHESTER-SHALE GREY CL-MAPLE ***STD***
Island Countertop	9069	MSI Quartz GROUP 1 ICED WHITE ***STD***
Backsplash	1111	N/A *****
Backsplash Grout	1111	N/A *****
Backsplash Tile Pattern	1111	N/A *****

HoodFan	34	AV1308 Air King 30 STAINLESS STEEL UNDER CABINET RANGE HOOD **STD**	PG 28
---------	----	---	-------

Comment

Kitchen/Breakfast

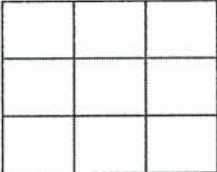
Flooring	9106	GE.MD.WHT.1818.MT Madison Series White Matte 18 X 18 Matte ***1***
Floor Tile Grout	2225	Grout-(27) Silver ***STD***
Floor Tile Pattern	3000	STANDARD SQUARE ***STD*** 

Comment

Foyer

MUHAMMAD, ASIF SHAHZAD/  
Project: Wallaceton  
Unit: 3191B-10, Phase: 3  
Model: 20-1790 A The Dunmore

Created: 3/6/2023 09:56:00  
Locked:  
Closed:

Flooring	9106	GE.MD.WHT.1818.MT Madison Series White Matte 18 X 18 Matte ***1***
Floor Tile Grout	2225	Grout-(27) Silver ***STD***
Floor Tile Pattern	3000	STANDARD SQUARE ***STD*** <div><div></div><div></div><div></div><div></div><div></div><div></div><div></div><div></div><div></div></div>
Comment		

Laundry Room

Flooring	5589	GE.BY.PEN.1313 New Byzantine Pentallc (Grey) 13 x13 ***STD***
Floor Tile Grout	2225	Grout-(27) Silver ***STD***
Floor Tile Pattern	3000	STANDARD SQUARE ***STD*** <div><div></div><div></div><div></div><div></div><div></div><div></div><div></div><div></div><div></div></div>
Comment		

Laundry Room Opt.

Cabinet - Uppers	1111	N/A *****
Cabinet Hardware	1111	N/A *****
Comment		

Mud Room

Flooring	9106	GE.MD.WHT.1818.MT Madison Series White Matte 18 X 18 Matte ***1***
Floor Tile Grout	2225	Grout-(27) Silver ***STD***
Floor Tile Pattern	3000	STANDARD SQUARE ***STD*** <div><div></div><div></div><div></div><div></div><div></div><div></div><div></div><div></div><div></div></div>



Customer Colours

MUHAMMAD, ASIF SHAHZAD/  
Project: Wallaceton  
Unit: 3191B-10, Phase: 3  
Model: 20-1790 A The Dunmore

Locked:  
Closed:



Comment

Powder Room

Flooring 9106

GE.MD.WHT.1818.MT Madison Series White Matte 18 X 18 Matte \*\*\*1\*\*\*

Floor Tile Grout 2225

Grout-(27) Silver \*\*\*STD\*\*\*

Floor Tile Pattern 3000

STANDARD SQUARE \*\*\*STD\*\*\*

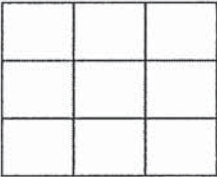

Plumbing Fixture (Colour) 1737

Plumbing Fixtures-WHITE \*\*\*STD\*\*\*

Comment

Hall

Flooring 7502

Red Oak Pearl-Vintage  
Engineered-PEWTER/ECLIPSE-3/4 inch x 3 1/4 inch

Comment

Dining Room

Flooring 7502

Red Oak Pearl-Vintage  
Engineered-PEWTER/ECLIPSE-3/4 inch x 3 1/4 inch

Comment

Great Room

Flooring 7502

Red Oak Pearl-Vintage  
Engineered-PEWTER/ECLIPSE-3/4 inch x 3 1/4 inch

Comment

Upper Hall

Flooring 9507

DY 89418-MINOTAUR-BLACK ICE-40 oz Poly \*\*\*STD\*\*\*

Comment

MUHAMMAD, ASIF SHAHZAD/  
Project: Wallaceton  
Unit: 3191B-10, Phase: 3  
Model: 20-1790 A The Dunmore

Created: 3/6/2023 09:58:55  
Locked:  
Closed:

Finished Basement (Rec) Room/Hall

Flooring9507DY 89418-MINOTAUR-BLACK ICE-40 oz Poly \*\*\*STD\*\*\*

Comment

Master Bedroom

Flooring9507DY 89418-MINOTAUR-BLACK ICE-40 oz Poly \*\*\*STD\*\*\*

Comment

Bedroom 2

Flooring9507DY 89418-MINOTAUR-BLACK ICE-40 oz Poly \*\*\*STD\*\*\*

Comment

Bedroom 3

Flooring9507DY 89418-MINOTAUR-BLACK ICE-40 oz Poly \*\*\*STD\*\*\*

Comment

Master Ensuite

Cabinet Colour/Style6319Viking III-MANCHESTER-CAVIAR CL-MAPLE \*\*\*STD\*\*\*

Countertop88224924-38-Countertop-WHITE CARRARA-Wilsonart \*\*\*STD\*\*\*

Countertop Edge1111N/A \*\*\*\*\*

Cabinet Hardware7672135-HARDWARE \*\*\*STD\*\*\*

Floor Tile9106GE.MD.WHT.1818.MT Madison Series White Matte 18 X 18 Matte \*\*\*1\*\*\*

MUHAMMAD, ASIF SHAHZAD/  
Project: Wallaceton  
Unit: 3191B-10, Phase: 3  
Model: 20-1790 A The Dunmore

Created: 3/6/2023 09:58:55  
Locked:  
Closed:

Floor Tile Grout	2225	Grout-(27) Silver ***STD***									
Floor Tile Pattern	3000	STANDARD SQUARE ***STD*** <table><tr><td></td><td></td><td></td></tr><tr><td></td><td></td><td></td></tr><tr><td></td><td></td><td></td></tr></table>									
Shower Floor Tile	8661	OD.ON.SWT.0202.MT.N-Ontario Series Mosaic-Snow White Matte-2 x 2 ***STD***									
Shower Floor Tile Grout	2226	Grout-(00) White ***STD***									
Shower Floor Tile Pattern	3000	STANDARD SQUARE ***STD*** <table><tr><td></td><td></td><td></td></tr><tr><td></td><td></td><td></td></tr><tr><td></td><td></td><td></td></tr></table>									
Shower Wall Tile	9020	QT.WV.WHT.0810-Weave-White-8 x 10 ***STD***									
Shower Wall Tile Grout	2226	Grout-(00) White ***STD***									
Shower Wall Tile Pattern	3070	HORIZONTAL STACKED ***STD*** <table><tr><td></td><td></td></tr><tr><td></td><td></td></tr><tr><td></td><td></td></tr><tr><td></td><td></td></tr></table>									
Shower Jamb(s) and Sill(s)	8923	Shower Jamb / Sill-Thassos White ***STD***									
Plumbing Fixture (colour)	1737	Plumbing Fixtures-WHITE ***STD***									
Comment											

Main Bathroom

Cabinet Colour/Style	9158	Viking III-SIMCOE-NAVY BLUE-3DL ***STD***	
Countertop	8796	6698-46-Countertop-PALOMA POLAR ETCHINGS FINISH-Formica ***STD***	
Countertop Edge	1111	N/A *****	
Cabinet Hardware	7672	135-HARDWARE ***STD***	
Flooring	9071	GE.BY.AZR.1313 New Byzantine Azzuro 13x13 ***STD***	
Floor Tile Grout	2225	Grout-(27) Silver ***STD***	
Floor Tile Pattern	3000	STANDARD SQUARE ***STD***	



MUHAMMAD, ASIF SHAHZAD/  
Project: Wallaceton  
Unit: 3191B-10, Phase: 3  
Model: 20-1790 A The Dunmore

Created: 3/6/2023 09:58:55  
Locked:  
Closed:

Floor Tile Pattern	3000	STANDARD SQUARE ***STD*** <div><div><div></div><div></div><div></div><div></div><div></div><div></div><div></div><div></div><div></div></div></div>
Wall Tile	8833	QT.UW.WHT.0810-Uniwall-White-8 x 10 ***STD***
Wall Tile Grout	2226	Grout-(00) White ***STD***
Main Bathroom Tile Pattern	3070	HORIZONTAL STACKED ***STD*** <div><div><div></div><div></div><div></div><div></div><div></div><div></div></div></div>
Plumbing Fixture (Colour)	1737	Plumbing Fixtures-WHITE ***STD***
Comment		

Finished Basement Bathroom

Cabinet Colour/Style	9157	Viking III-SIMCOE-MOONLIGHT-3DL ***STD***
Countertop	8796	6698-46-Countertop-PALOMA POLAR ETCHINGS FINISH-Formica ***STD***
Countertop Edge	1111	N/A *****
Cabinet Hardware	7672	135-HARDWARE ***STD***
Flooring	5589	GE.BY.PEN.1313 New Byzantine Pentallie (Grey) 13 x13 ***STD***
Floor Tile Grout	2225	Grout-(27) Silver ***STD***
Floor Tile Pattern	3000	STANDARD SQUARE ***STD*** <div><div><div></div><div></div><div></div><div></div><div></div><div></div><div></div><div></div><div></div></div></div>
Shower Floor Tile	8661	OD.ON.SWT.0202.MT.N-Ontario Series Mosaic-Snow White Matte-2 x 2 ***STD***
Shower Floor Tile Grout	2226	Grout-(00) White ***STD***
Shower Floor Tile Pattern	3000	STANDARD SQUARE ***STD*** <div><div><div></div><div></div><div></div><div></div><div></div><div></div><div></div><div></div><div></div></div></div>

Customer Colours

MUHAMMAD, ASIF SHAHZAD/  
Project: Wallaceton  
Unit: 3191B-10, Phase: 3  
Model: 20-1790 A The Dunmore

Created: 3/6/2023 09:58:00

Locked:

Closed:

Shower Wall Tile	9020	QT.WV.WHT.0810-Weave-White-8 x 10 ***STD***
Shower Wall Tile Grout	2226	Grout-(00) White ***STD***
Shower Wall Tile Pattern	3070	HORIZONTAL STACKED ***STD*** <div><div></div><div></div><div></div><div></div></div>
Shower Jamb(s)	8923	Shower Jamb / Sill-Thassos White ***STD***
Plumbing Fixture (Colour)	1737	Plumbing Fixtures-WHITE ***STD***
Comment		

Great Room Fireplace

Type	8865	Dimplex-Electric Fireplace-PF3033HL ***STD***
Mantle	8891	NF-17-Paint Grade Mantle- Cabinet (Per Plan)-WHITE ***STD***
Surround Opt.	1111	N/A *****
Comment		

PG 18

Basement Stairs

Type	1711	Carpet Grade Stairs ***OPT. FINISHED BASEMENT***
Colour	7922	Eclipse (Pewter) STAIN TO COMPLIMENT HARDWOOD AND WILL VARY FROM FLOORING ***99***
Carpet Runner	1111	N/A *****
Handrail/Pickets/Post Type	9119	Handrail only on closed walls (one or two sides per building code) ***STD***
Handrail/Pickets/Post Colours	1729	Carpet Grade-Stain handrail, pickets, stringers, nosing_pos
Carpet	9507	DY 89418-MINOTAUR-BLACK ICE-40 oz Poly ***STD***
Custom Stain/Paint	1111	N/A *****
Comment		



MUHAMMAD, ASIF SHAHZAD/  
Project: Wallaceton  
Unit: 3191B-10, Phase: 3  
Model: 20-1790 A The Dunmore

Created: 3/6/2023 09:58:55  
Locked:  
Closed:

Basement Stairs Landings (Upper and Lower)

Flooring	7502	Red Oak Pearl-Vintage Engineered-PEWTER/ECLIPSE-3/4 inch x 3 1/4 inch ***3***
Comment		

Main Stairs

Type	1714	Oak Stairs ***STD MAIN STAIRS***
Colour	7922	Eclipse (Pewter) STAIN TO COMPLIMENT HARDWOOD AND WILL VARY FROM FLOORING ***99***
Carpet Runner	1111	N/A *****
Handrail/Pickets/Posts Type	7652	1 5/16 inch Square pickets with 3 1/2? Square/Cap Post(s)-ALL OAK ***STD***
Handrail/Pickets/Posts Colour	1728	Oak Grade-Stain handrail,oak pickets,stringers,treads,risers
Custom Stain/Paint	1111	N/A *****
Comment		

Main Stairs Landing(s)

Flooring	7502	Red Oak Pearl-Vintage Engineered-PEWTER/ECLIPSE-3/4 inch x 3 1/4 inch
Comment		

Throughout

Walls - Paint Colour	1717	22-Wall-WARM GREY ***STD***
Underpad	1079	500 Series-Underpad ***STD***
Thresholds	2232	Metal Thresholds ***STD***
Switches and Plug	5796	Decora White Switches and Plugs ***STD***
Trim Size	8705	4 1/4 Baseboard and 2 3/4 Casings ***STD***
Trim - Paint Colour	1716	Trim-WHITE ***STD***

MUHAMMAD, ASIF SHAHZAD/  
Project: Wallaceton  
Unit: 3191B-10, Phase: 3  
Model: 20-1790 A The Dunmore

Created: 3/6/2023 09:58:55  
Locked:  
Closed:

Comment

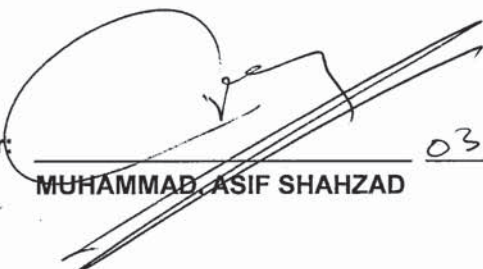
Purchaser:   
MUHAMMAD, ASIF SHAHZAD

Date: 03-06-2023

Decor Consultant:   
Decor Consultant

Date: 03/06/23

Purchaser: \_\_\_\_\_

Date: \_\_\_\_\_

Wallaceton:   
Wallaceton

Date Approved: 03-22-2023



CONSTRUCTION SUMMARY

**Lot: 3191B-10**  
**Model: 20-1790 A The Dunmore**  
**Project/Phase: Wallaceton / 3**

Offer Worksheet	Five Thousand Dollars (\$5,000) at D?cor. (No Cash Value) Townhomes Note:
Offer Worksheet	The Purchaser(s) acknowledge that they have NOT been referred by an existing Heathwood Homeowner and therefor are not entitled to a referral fee under Heathwood Homes Referral program. Note:





CONSTRUCTION SUMMARY

Lot: 3191B-10  
Model: 20-1790 A The Dunmore  
Project/Phase: Wallaceton / 3

ADMIN FEE

Invoice	Qty.	Description
---------	------	-------------

CABINETRY

Invoice	Qty.	Description
1323 313,624 22Mar23	1	KITCHEN - H04-66cm deep fridge enclosure (counter depth) with (1) wall ([1] 66cm deep gable and [1] 66cm deep cabinet) (This is not a zero clearance enclosure. Standard heights and widths will be used.) Viking  KITCHEN SKETCH # 3 <b>DRYWAL-Notify; FRAMING-Modify Bulkhead; PAINTING-Notify</b>
1323 313,768 22Mar23	1	KITCHEN - A11-Upper angle corner per unit Viking  KITCHEN SKETCH # 3 <b>DRYWALL-Notify; FRAMING-Modify Bulkhead; PAINTING-Notify</b>

CERAMICS

Invoice	Qty.	Description
1323 348,261 22Mar23	1	MUD - CERAMICS - MUD - FLOOR - UG 1  MUD ROOM
1323 348,259 22Mar23	1	FOYER - CERAMICS - FOYER - FLOOR - UG 1  FOYER
1323 348,263 22Mar23	1	KITCHEN / BREAKFAST - CERAMICS - KITCHEN / BREAKFAST - FLOOR - UG 1  KITCHEN/BREAKFAST
1323 348,260 22Mar23	1	POWDER - CERAMICS - POWDER - FLOOR - UG 1  POWDER ROOM
1323 348,265 22Mar23	1	MASTER ENSUITE - CERAMICS - MASTER ENSUITE - FLOOR - UG 1  MASTER ENSUITE

DRYWALL

Invoice	Qty.	Description
1323 313,624 22Mar23 **	1	KITCHEN - H04-66cm deep fridge enclosure (counter depth) with (1) wall ([1] 66cm deep gable and [1] 66cm deep cabinet) (This is not a zero clearance enclosure. Standard heights and widths will be used.) Viking  KITCHEN SKETCH # 3 <b>DRYWAL-Notify; FRAMING-Modify Bulkhead; PAINTING-Notify</b>
1323 313,768 22Mar23 **	1	KITCHEN - A11-Upper angle corner per unit Viking  KITCHEN SKETCH # 3 <b>DRYWALL-Notify; FRAMING-Modify Bulkhead; PAINTING-Notify</b>



CONSTRUCTION SUMMARY

Lot: 3191B-10  
Model: 20-1790 A The Dunmore  
Project/Phase: Wallaceton / 3

ELECTRICAL

Invoice	Qty.	Description
1323 314,224 22Mar23	2	- ELECTRICAL - CEILING ROUGH-IN (CAPPED) INCLUDING SWITCH  1X CENTERED +/- WITH OWN SWITCH ON GREAT ROOM CEILING; 1X CENTERED +/- ON ISLAND WITH OWN SWITCH. SEE SKETCH # 2
1323 314,232 22Mar23	1	GREAT ROOM - ELECTRICAL - EXTRA WALL INTERIOR OUTLET ON EXISTING CIRCUIT (DOES NOT INCLUDE KITCHEN OUTLETS)  TO BE CENTERED +/- ABOVE FIREPLACE APPROX. 70 " +/- FROM FLOOR. SEE SKETCH # 2

FRAMING

Invoice	Qty.	Description
1323 313,624 22Mar23 **	1	KITCHEN - H04-66cm deep fridge enclosure (counter depth) with (1) wall ([1] 66cm deep gable and [1] 66cm deep cabinet) (This is not a zero clearance enclosure. Standard heights and widths will be used.) Viking  KITCHEN SKETCH # 3 <b>DRYWAL-Notify; FRAMING-Modify Bulkhead; PAINTING-Notify</b>
1323 313,768 22Mar23 **	1	KITCHEN - A11-Upper angle corner per unit Viking  KITCHEN SKETCH # 3 <b>DRYWALL-Notify; FRAMING-Modify Bulkhead; PAINTING-Notify</b>

PAINTING

Invoice	Qty.	Description
1323 313,624 22Mar23 **	1	KITCHEN - H04-66cm deep fridge enclosure (counter depth) with (1) wall ([1] 66cm deep gable and [1] 66cm deep cabinet) (This is not a zero clearance enclosure. Standard heights and widths will be used.) Viking  KITCHEN SKETCH # 3 <b>DRYWAL-Notify; FRAMING-Modify Bulkhead; PAINTING-Notify</b>
1323 313,768 22Mar23 **	1	KITCHEN - A11-Upper angle corner per unit Viking  KITCHEN SKETCH # 3 <b>DRYWALL-Notify; FRAMING-Modify Bulkhead; PAINTING-Notify</b>

THE DUNMORE

ELEVATION A | 2,242 SQ. FT.

Includes 452 sq. ft. of Finished Lower Level

WALLACETON  
EST. 1870

Sketch #1

20-1790 ELEV. A

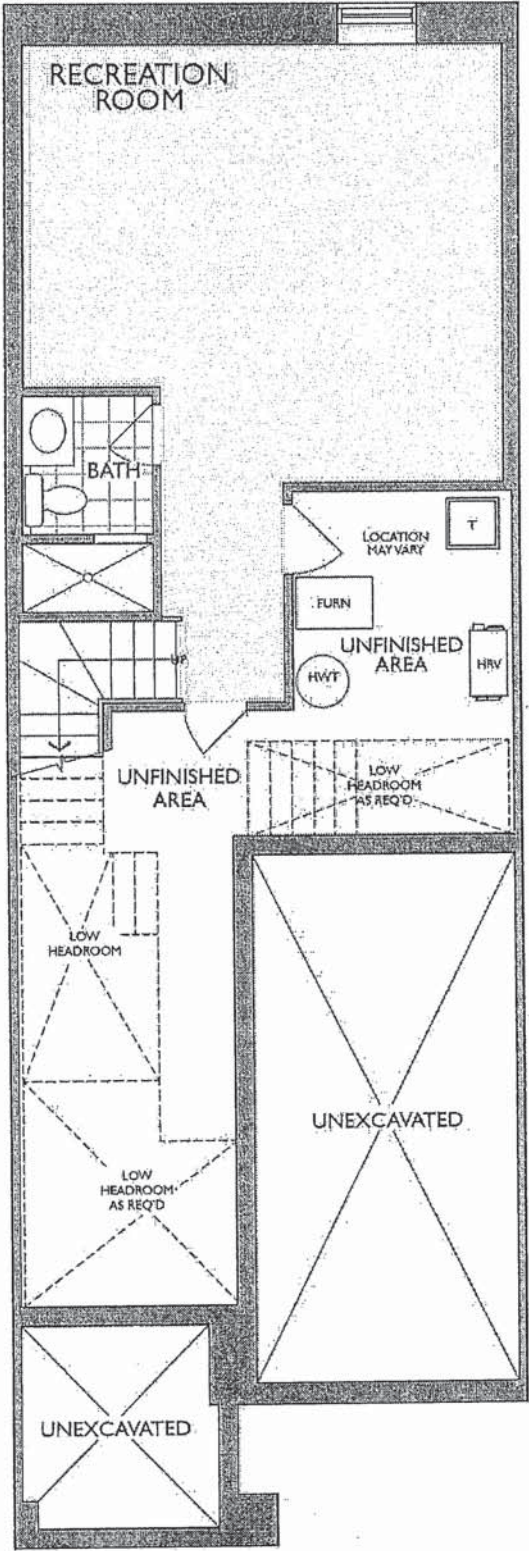

LOWER LEVEL  
ELEVATION A



THE DUNMORE

ELEVATION A | 2,242 SQ. FT.

Includes 452 sq. ft. of Finished Lower Level

WALLACETON  
EST. 1870

Sketch # 2

20-1790 ELEV. A

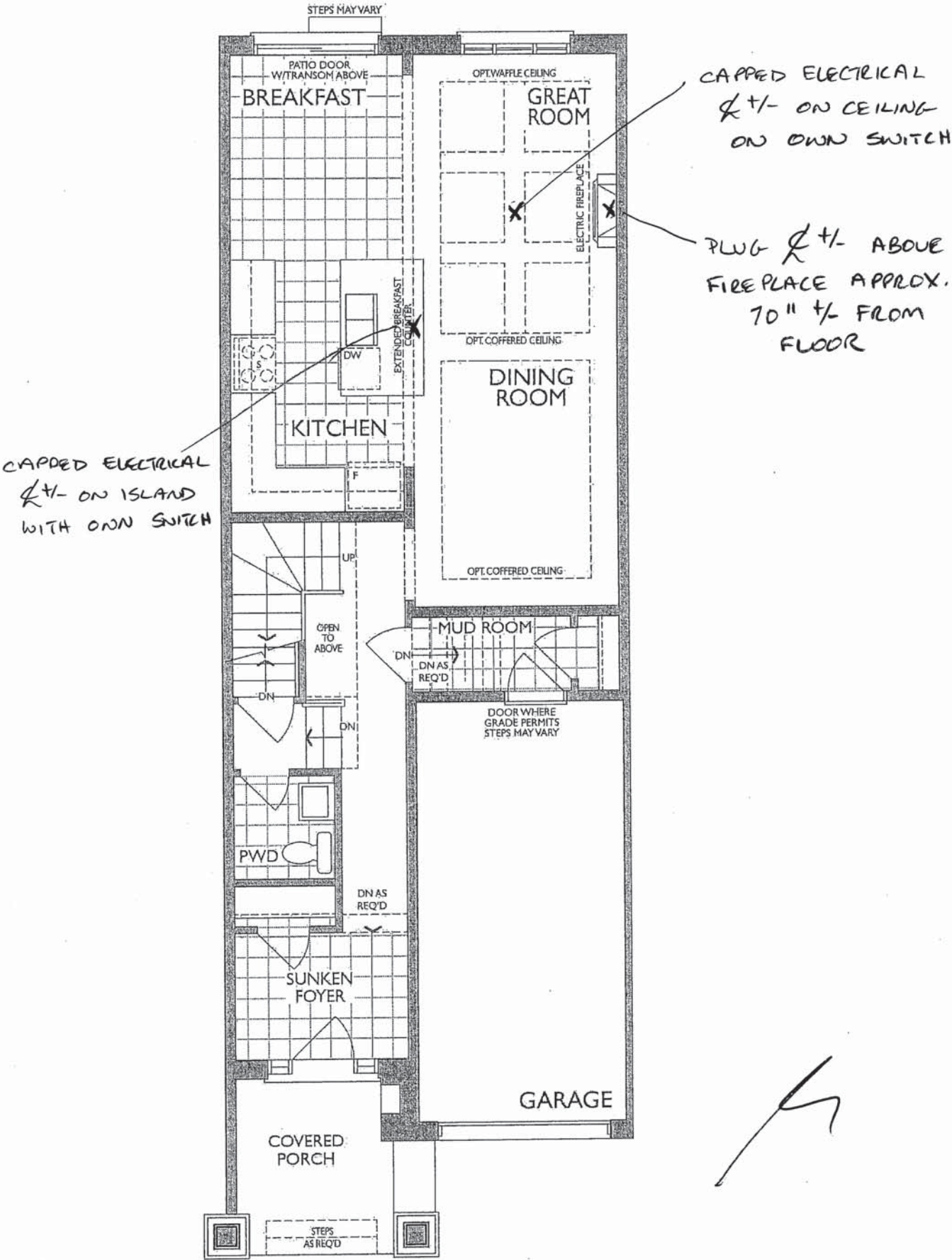

MAIN FLOOR  
ELEVATION A

KITCHEN  
(GROUND FLOOR)

UPPER ANGLE CABINET

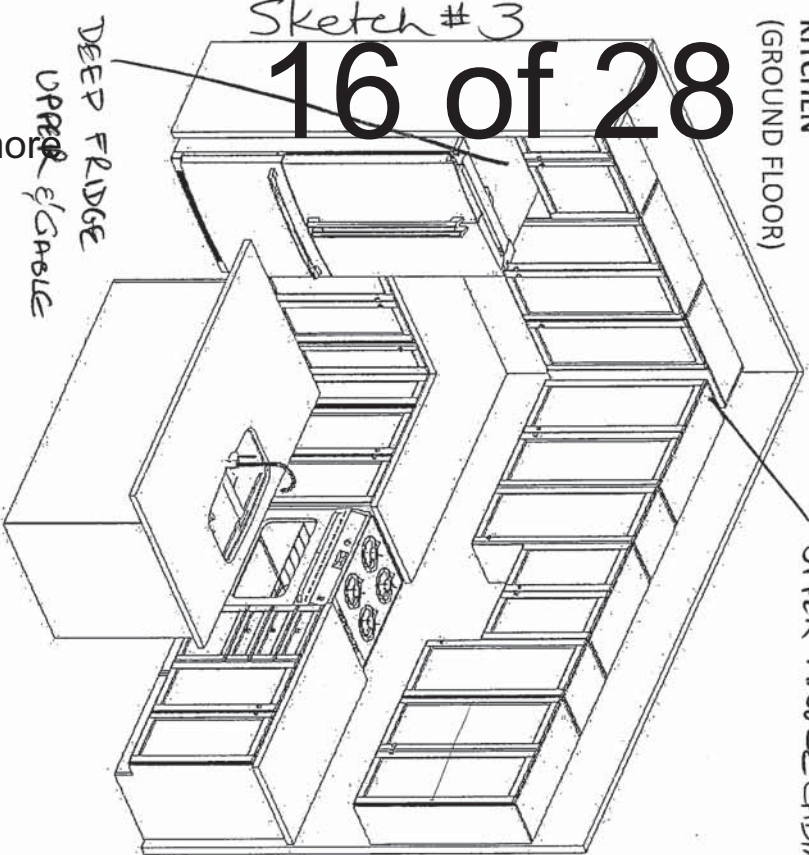

Sketch #3

DEEP FRIDGE  
UPPER & LOWER

Project: Wallaceton  
Unit: 3191B-10, Phase: 3  
Model: 20-1790 A The Dunmore

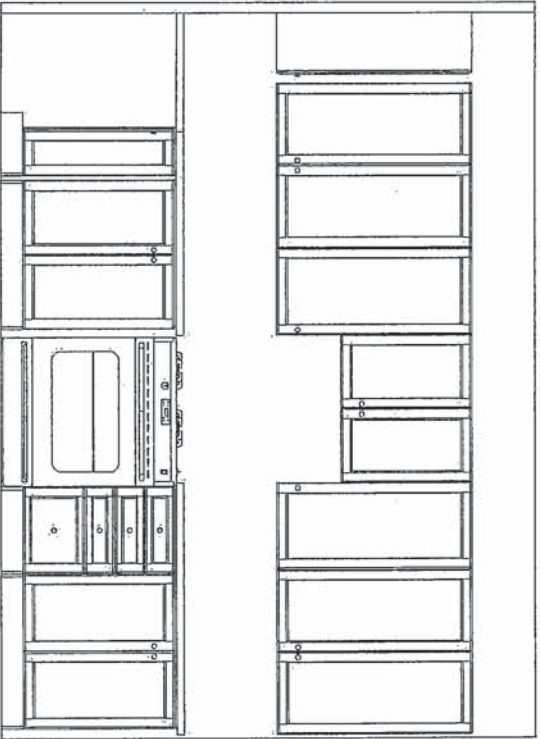
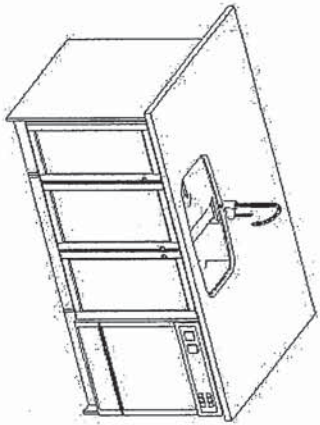
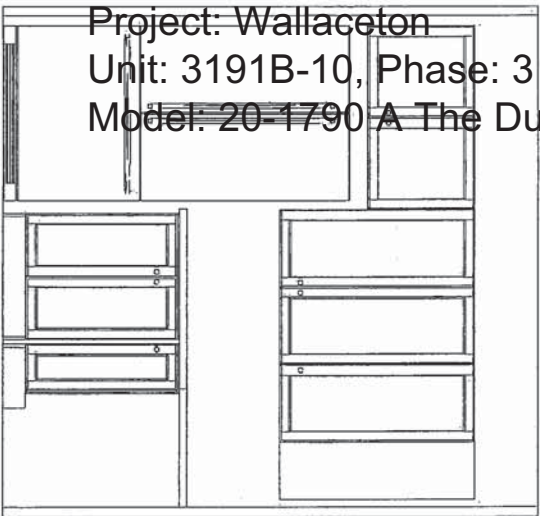

MASTER ENSUITE  
(2ND FLR)

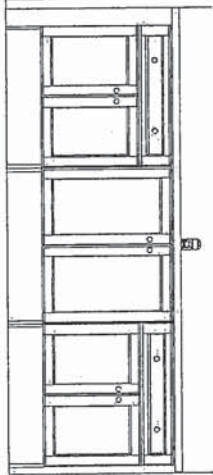

MAIN BATH  
(2ND FLR)

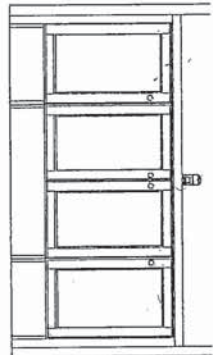

OPT. LAUNDRY UPPEERS  
(2ND FLR)

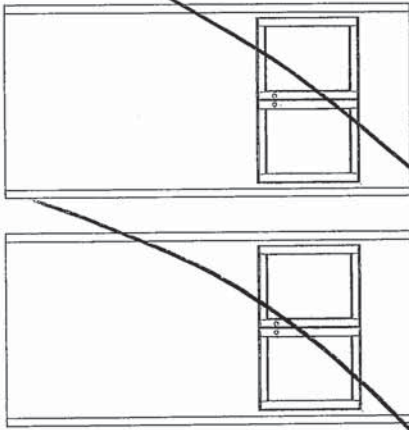

STD. BASEMENT BATH

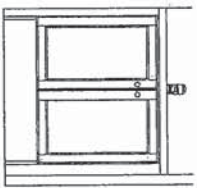

F R I E N D ' S  
K I T C H E N S L I M I T E D  
1350 Shawson Drive, Mississauga, ON L4W 1C5

HEATHWOOD HOMES  
WALLACETON, KITCHENER ON  
MODEL: 20-1790 (2004)

STANDARD CONTRACT INCLUDES:

Appliance Openings

- Hood Opening: 30" W Std. hood
- Fridge Opening: 37 3/8" W X 73 3/8" H
- 30cm deep cabinet over fridge
- Stove Opening: 30" Freestanding
- Dishwasher Opening: 24"

Standard Kitchens Scope:

- 100cm H wall cabinets
- Std. Blumotion Hinges- **soft close**
- Std. Metabox Drawers- **not soft close**
- Min 40cm W drawer
- Base pie cut corner cabinets
- Backing on all cabinets
- Countertop by others
- Upgrade applied paneled fridge & dishwashers supply only (appliance hardware by others)

Standard Vanity & Laundry Scope:

- Powder by others, pedestal
- All vanities include laminate counter
- Std. Blum Hinges- **not soft close**
- Metabox Drawers- **not soft close**
- Master Ensuite: Top drawers (Full height doors at sink)
- Mains: Full height doors (top drawers added if Masters can't accommodate)
- Optional laundry base & wall cabinets

THIS DRAWING IS FOR DESIGN PURPOSES ONLY.  
IT IS NOT AN EXACT RENDERING.

4/29/2022



THE DUNMORE

ELEVATION A | 2,242 SQ. FT.

Includes 452 sq. ft. of Finished Lower Level

WALLACETON  
EST. 1870

Sketch # 4

20-1790 ELEV. A

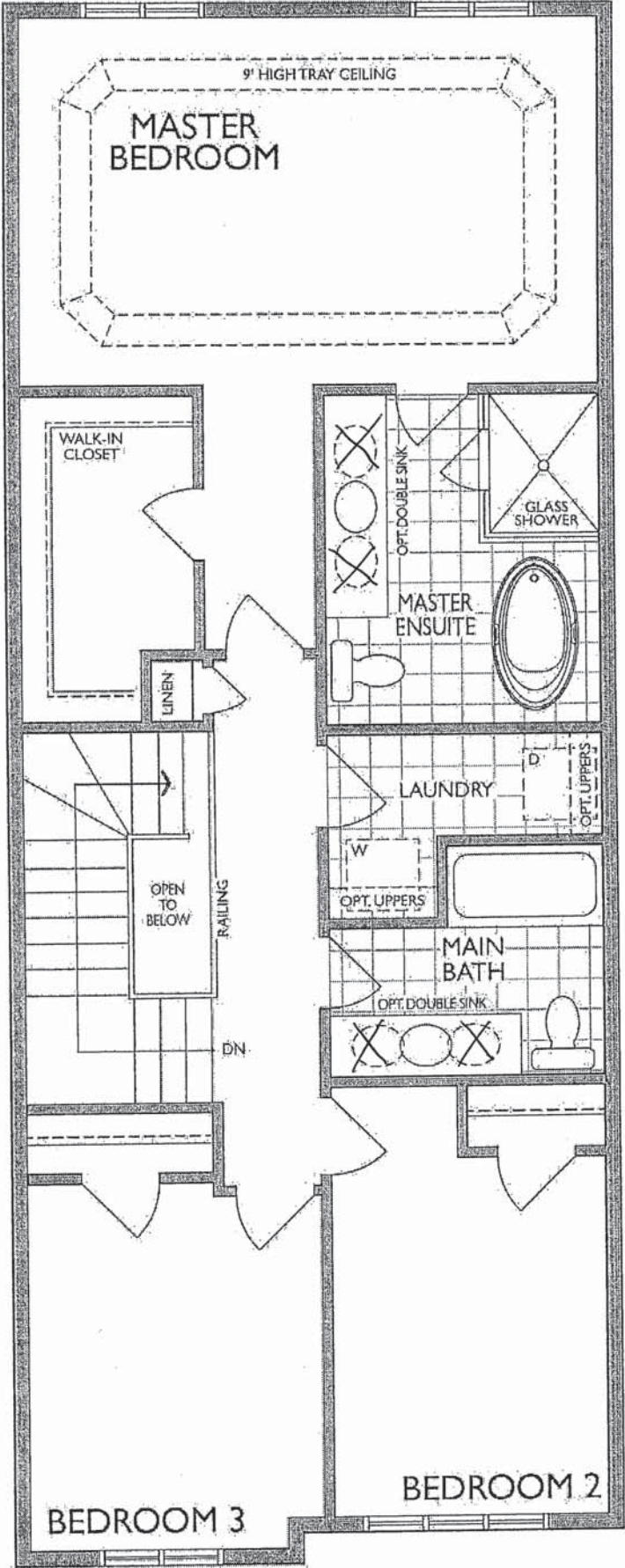

SECOND FLOOR  
ELEVATION A



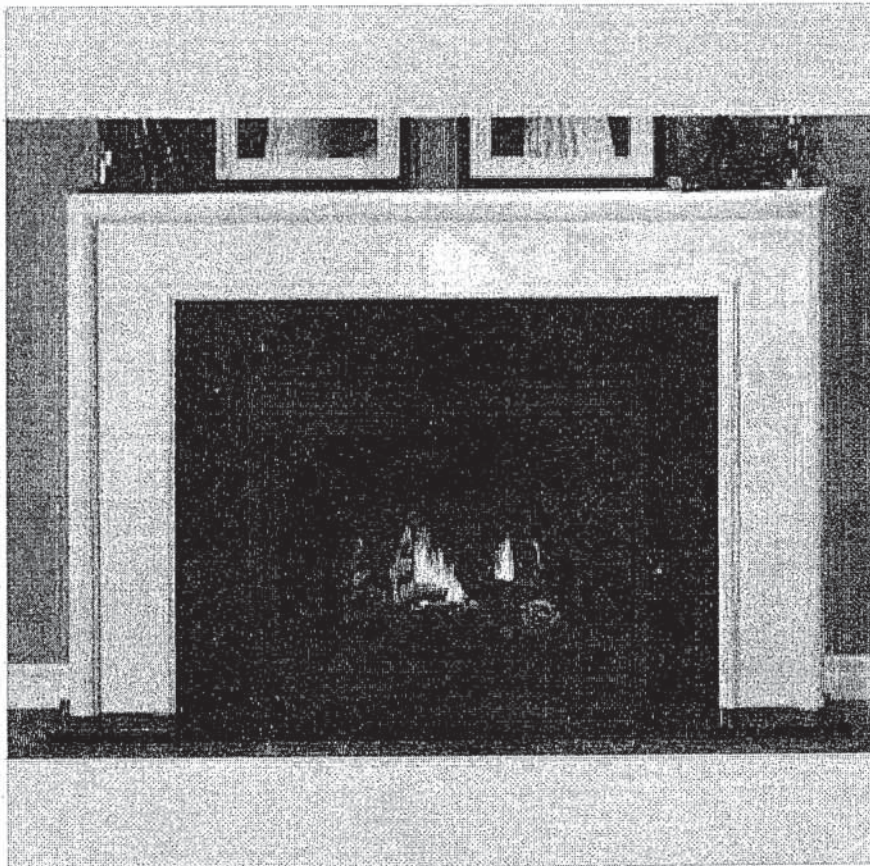

NEAS NF17 Mantel - CABINET

*[Handwritten signature]*



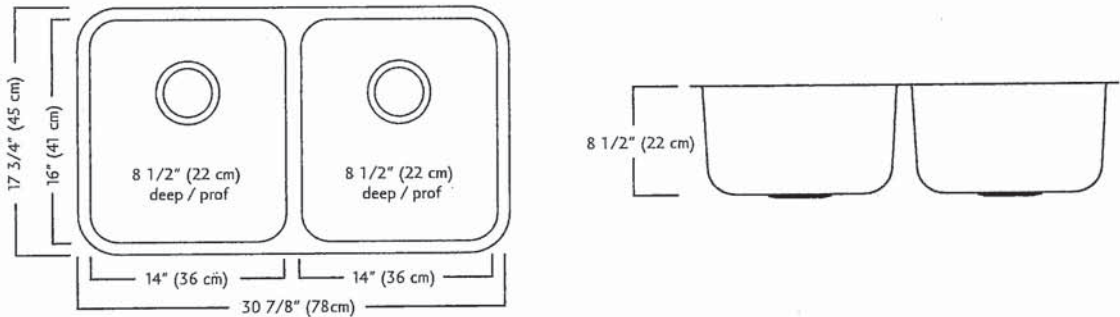
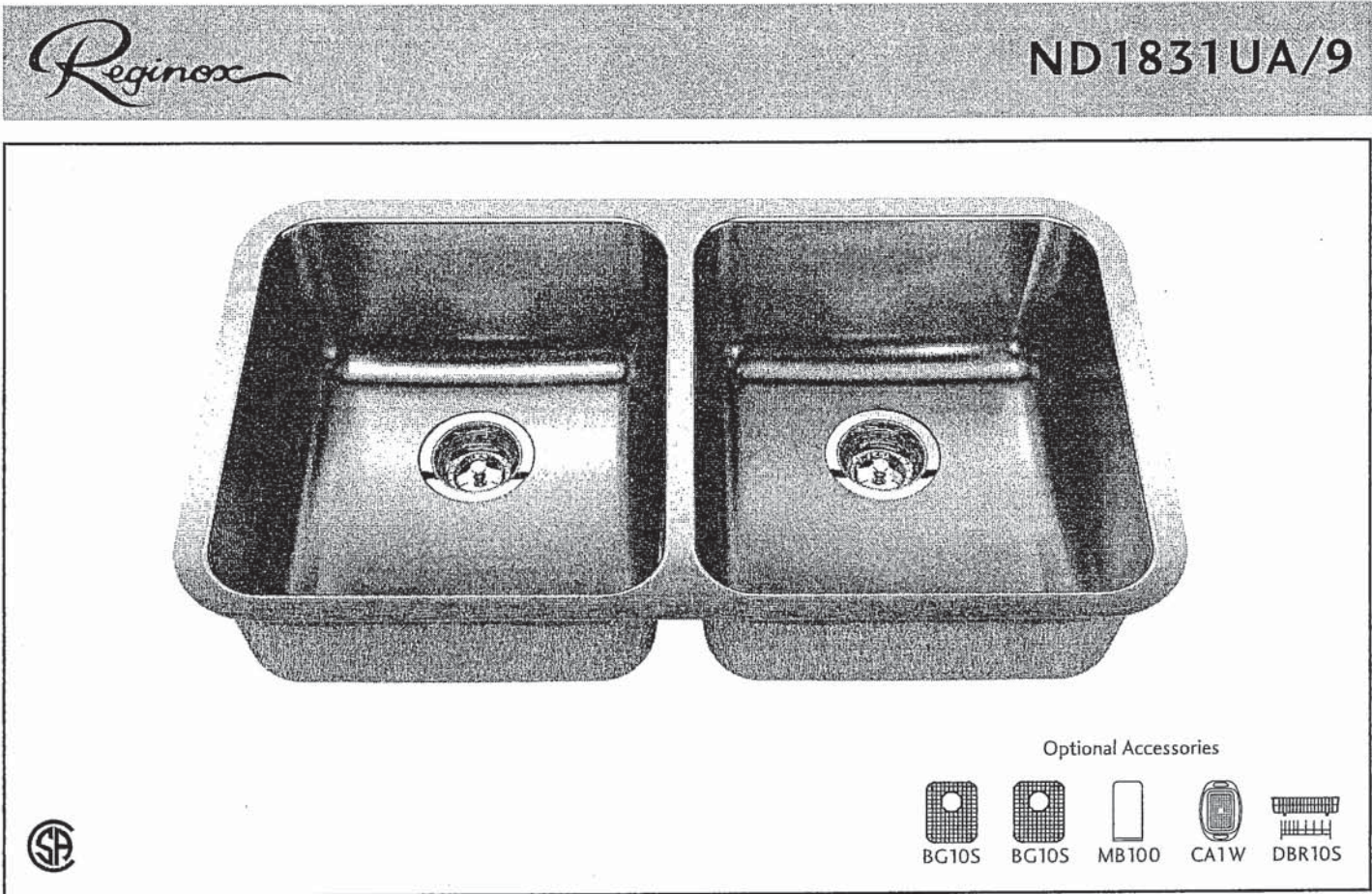

ND1831UA/9 SPECIFICATION

Model ND1831UA/9 is a double (two equal size) bowl undermount sink manufactured by Franke Kindred Canada Limited from 18 gauge stainless steel. Product has silk finished rims and linear brush finished bowls. Sink is fully undercoated. Basket strainer waste fittings (3 1/2", 89 mm) are included. Sink is backed with a limited lifetime warranty.

- O.D. 17 3/4" x 30 7/8" x 8 1/2" (45 x 78 x 22 cm)
- Recommended for minimum 36" cabinet

Franke Kindred Canada Limited  
P.O. Box 190, 1000 Franke Kindred Road, Midland, Ontario, Canada, L4R 4K9 Phone: 866-687-7465 Fax: 800-361-8408

**MOEN®**

There is more than 1 version of this model.  
Page down to identify the version you have.

**FAUCET DESCRIPTION**

- Reflex™ pulldown system offers smooth operation, easy movement and secure docking
- Power Clean™ spray technology
- Metal construction with various finishes identified by suffix
- Duralock™ connect installation
- Pulldown spray with 68" braided hose
- Flexible supply lines with 3/8" compression fittings
- High arc spout provides height and reach to fill or clean large pots while pulldown wand provides the maneuverability for cleaning or rinsing
- 360° rotating spout
- Faucet designed for handle to be mounted on right side only

**OPERATION**

- Lever style handle
- Temperature controlled by 100° arc of handle travel
- Operates with less than 5 lbs. of force
- Operates in stream or spray mode in the pullout or retracted position

**FLOW**

- Flow is limited to 1.5 gpm (5.7 L/min) max at 60 psi

**CARTRIDGE**

- 1255™ Duralast™ cartridge

**STANDARDS**

- Third party certified to IAPMO Green, ASME A112.18.1/CSA B125.1 and all applicable requirements therein including NSF 61/9G & 372
- Meets CalGreen and Georgia SB370 requirements
- Complies with California Proposition 65 and with the Federal Safe Drinking Water Act
- The backflow protection system in the device consists of two independently operating check valves, a primary and a secondary which prevent backflow

- **ADA**  for lever handle

**WARRANTY**

- Lifetime limited warranty against leaks, drips and finish defects to the original homeowner
  - 10 year limited warranty when used in a multifamily installation
  - 5 year limited warranty when used in a commercial installation
- Visit [www.moen.com/support](http://www.moen.com/support) for complete details and limitations

*Specifications*

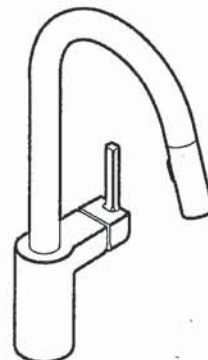

**ALIGN™**  
**Single Handle High Arc**  
**Pulldown Kitchen Faucet**

**Models:** 7565 series

**NOTE:** THIS FAUCET IS DESIGNED TO BE INSTALLED  
THROUGH 1 HOLE, 1-1/2" (38mm) MIN. DIA.  
(OPTIONAL 3-HOLE ESCUTCHEON 141002 AVAILABLE)

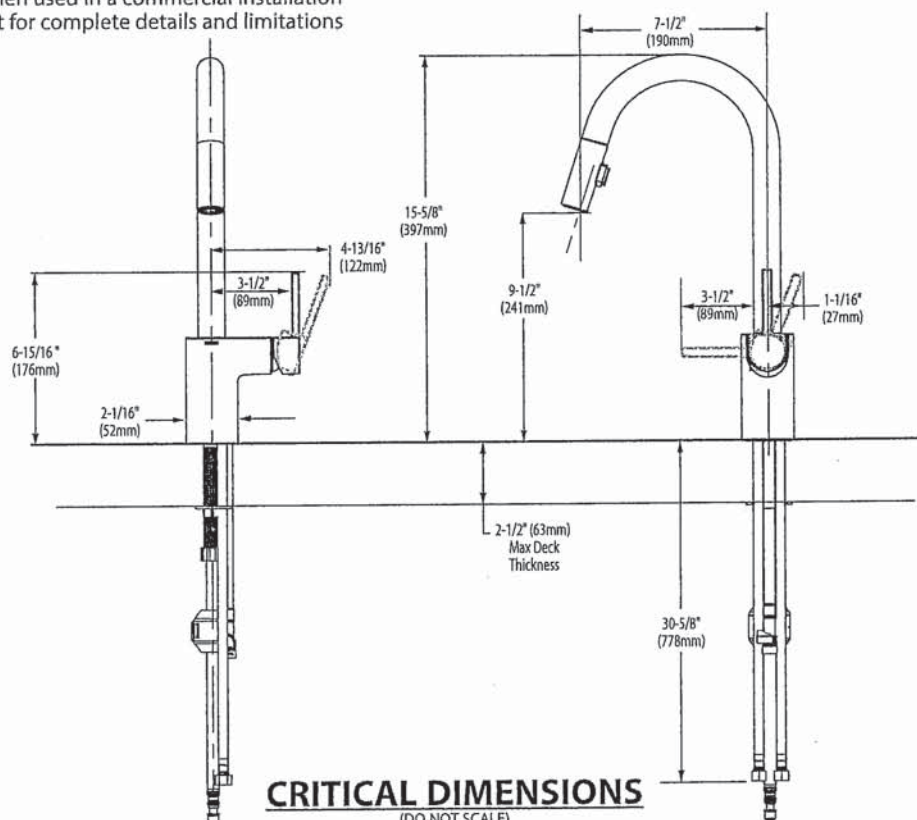





BARRIER FREE (ABOVE COUNTER OR DROP-IN ONLY)

**BOULEVARD®**  
**PEDESTAL SINK**  
VITREOUS CHINA

**BOULEVARD® PEDESTAL SINK**

- STD ☒ **0641.800** Faucet holes on 8" (203mm) centers (Illustrated)  
☒ **0641.400** Faucet holes on 4" (102mm) centers  
☐ **0641.100** Center hole only
- Classic styled rectangular pedestal lavatory
  - Vitreous china
  - Rear overflow
  - Supplied with mounting kit
  - Right Height® for greater comfort during use
  - Faucet ledge with large deck area (faucet not included)
  - **Design coordinates with Boulevard® Toilet**
  - Basin has flat bottom to also allow use as an **above counter sink** or a **drop-in sink** (with u-shaped cut out)

**Nominal Dimensions:**

24" x 19" x 35-1/2"  
(610 x 483 x 902mm)

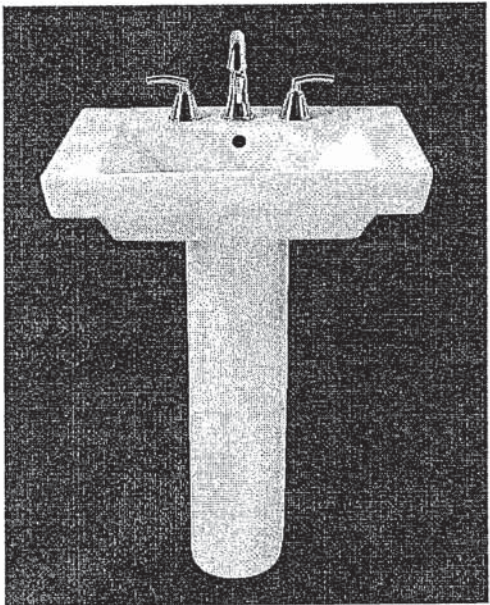

- ☐ **0641.008** Pedestal top-8" (203mm) centers
- ☐ **0641.004** Pedestal top-4" (102mm) centers
- ☐ **0641.001** Pedestal top-center hole only
- ☐ **0010.000** Pedestal only

SEE REVERSE FOR ROUGHING-IN DIMENSIONS

**Bowl sizes:**

17" (432mm) wide,  
12-1/2" (318mm) front to back,  
5" (127mm) deep

**Compliance Certifications -**

**Meets or Exceeds the Following Specifications:**

- ASME A112.19.2 - 2008/CSA B45.1-08

**To Be Specified:**

- ☐ Color: ☐ White ☐ Linen
- ☐ Faucet Finish:
- ☐ Supplies:
- ☐ 1-1/4" Trap:
- ☐ Nipple:

\* See faucet section for additional models available

© 2018 AS America Inc.

American Standard

 BARRIER FREE

COLONY™  
COUNTERTOP SINK  
VITREOUS CHINA

COLONY COUNTERTOP SINK

- Vitreous china
  - Self-rimming
  - Front overflow
  - Supplied with template
  - Faucet deck  
(Faucet shown not included)
- ☐ 0346 803  
Faucet holes on 203mm (8") centres
- ☒ 0346 403 (Illustrated)  
Faucet holes on 102mm (4") centres
- ☐ 0346 001  
Centre hole only

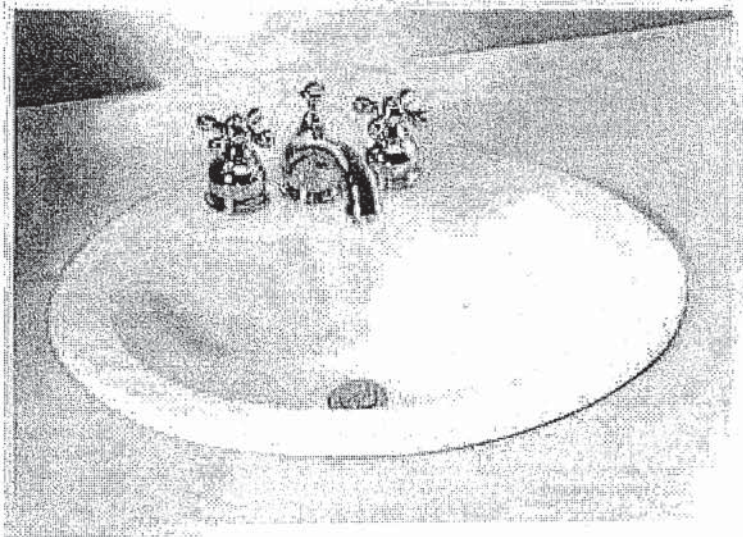

Nominal Dimensions:  
521 x 448mm (20-1/2" x 17-5/8")

Bowl sizes:  
422mm (16-5/8") wide, 279mm (11") front to back, 143mm (5-5/8") deep

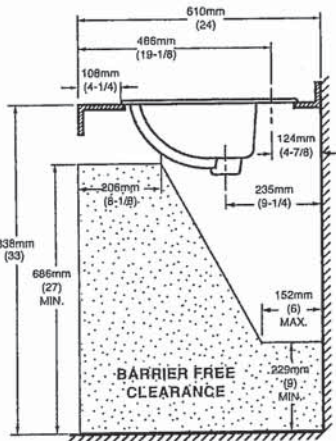
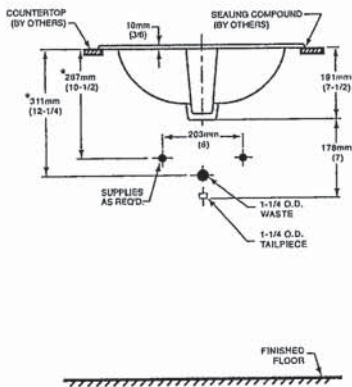
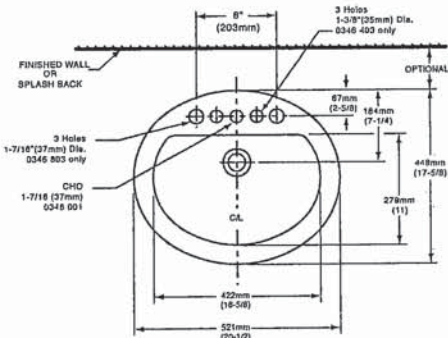

COMPLIANCE CERTIFICATIONS –  
Meets or exceeds the following Specifications:  
• ASME A112.19.2M for Vitreous China Fixtures.  
• CAN/CSA B45 Series.

- To Be Specified
- ☐ Colour: ☐ White ☐ Bone ☐ Silver Gray  
☐ Linen
- ☐ Faucet\*:
- ☐ Faucet Finish:
- ☐ Supplies & Stops:
- ☐ Trap 1-1/4" (32 mm):

NOTES:  
\* DIMENSIONS SHOWN FOR LOCATION OF SUPPLIES AND "P" TRAP ARE SUGGESTED.  
FOR COUNTERTOP CUTOUT AND INSTALLATION INSTRUCTIONS USE TEMPLATE  
SUPPLIED WITH SINK.  
FAUCETS NOT INCLUDED AND MUST BE ORDERED SEPARATELY.  
IMPORTANT: Dimensions of fixtures are nominal and may vary within the range of tolerances  
established by ANSI Standard A112.19.2.  
These measurements are subject to change or cancellation. No responsibility is assumed for use  
of superseded or voided pages.

\* See faucet section for additional models available





DEMI™  
Product Specification Sheet

Two Piece Freestanding Collection

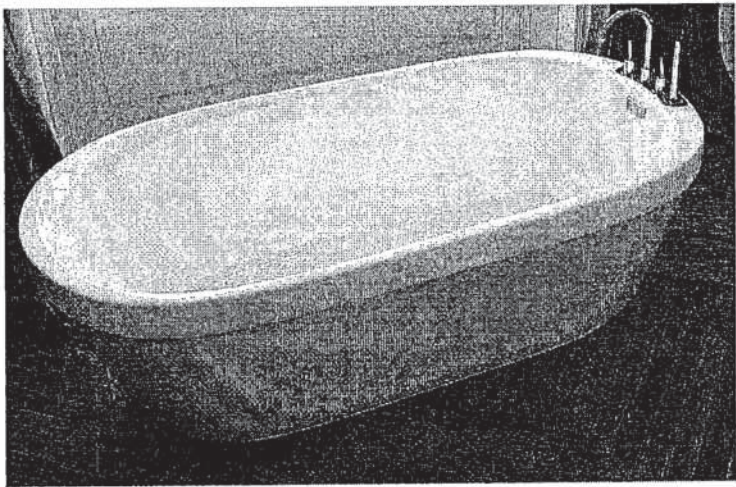

CF2007	Two Piece Freestanding Soaker
Size:	60" x 32" x 22" 1524 mm x 813 mm x 559 mm

PRODUCT FEATURES & BENEFITS

- Vacuum formed acrylic reinforced with fiberglass
- Scratch, stain and fade resistant high gloss finish
- Installation friendly two piece design
- Accepts deck mounted faucet
- Includes integral pop up drain and rectangular overflow
- Includes levelling feet

TWO PIECE ASSEMBLY

FRONT VIEW

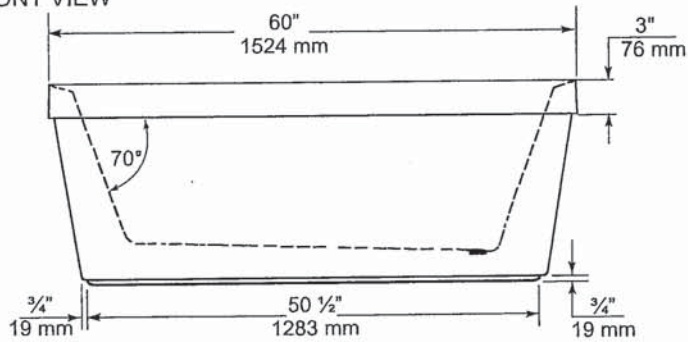

END VIEW

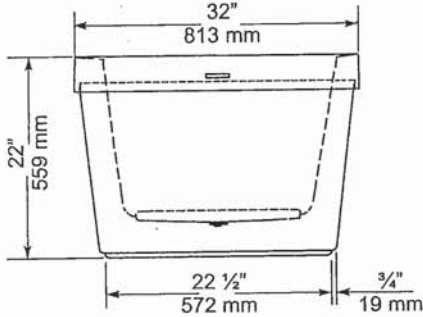

TOP VIEW

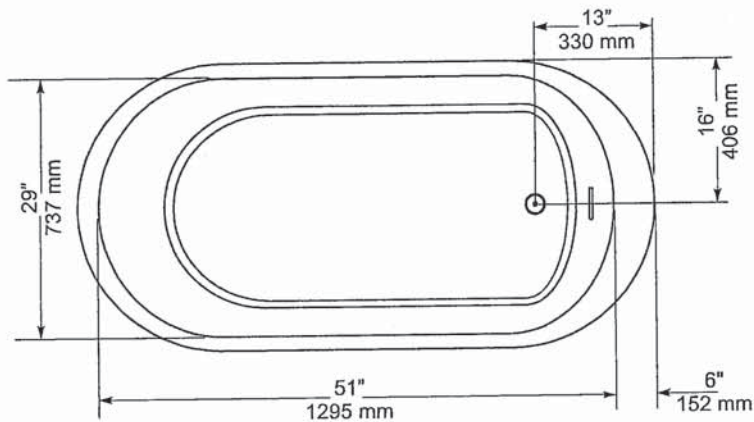

GENERAL SPECIFICATIONS		
Average Weight	90 lb	41 kg
Bathing Well at bottom	43"x 20"	1092 x 508 mm
Capacity Drain to Overflow		195 litres
Water Depth Drain to Overflow	16"	406 mm
Drain Opening (dia.)	2"	51 mm
Overflow Opening	2 1/4"x 1/2"	57 x 13 mm
Drain to Floor Clearance	3 1/4"	83 mm

**NOTES:** Please confirm measurements on actual product to ensure proper identification. Bathtub to be installed on the floor supported by 5 self levelling feet. Adjust if required to level the bathtub for adequate drainage. Refer to installation instructions for additional information.

**IMPORTANT:** Dimensions of fixtures are nominal and may vary ± 1/4" (6 mm). Weight may vary ± 5 lb (2.3 kg). Drawing is not to scale. These measurements are subject to change at manufacturer's discretion.

**Compliance Certifications -**  
Meets or Exceeds the following Specifications:  
• CAN/CSA - B45 Series





## VITREOUS CHINA



**MOEN®**

There is more than 1 version of this model.  
Page down to identify the version you have.

#### DESCRIPTION

- Metal construction with various finishes identified by suffix
- Flexible supplies with 3/8" compression fittings
- Includes metal or 50/50 pop-up type waste assembly where noted

#### OPERATION

- Pivot action lever style handle
- Temperature controlled through 100° degree arc of handle travel

#### FLOW

- Water usage is limited to these maximum flow rates as indicated by the corresponding product markings
- ° 1.2 gpm max (4.5L/min) at 60 psi
- ° 1.5 gpm max (5.7L/min) at 60 psi

#### CARTRIDGE

- 1255™ Duralast™ cartridge
- Nonmetallic/nonferrous and stainless steel material

#### STANDARDS

- Third party certified to WaterSense®, ASME A112.18.1/CSA B125.1 and all applicable requirements referenced therein
- Certified to NSF 61/9 & 372
- Products marked with 1.2 gpm are compliant with California water efficiency regulations
- Complies with California Proposition 65 and with the Federal Safe Drinking Water Act
- **ADA**  for lever handle

#### WARRANTY

- Lifetime limited warranty against leaks, drips and finish defects to the original consumer purchaser
- 5 year warranty if used in commercial installations

## Specifications

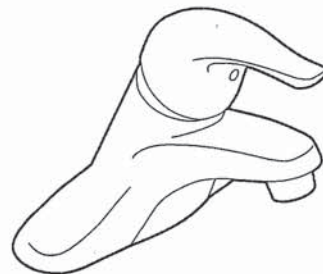

### CHATEAU® Single-Handle Lavatory Faucet

#### with Metal Waste Assembly

Model: L4625 series  
L4631BC

Bulk Packed (12 per carton):  
L64624 series

#### with 50/50 Waste Assembly

Bulk Packed (12 per carton):  
L64625 series

#### Less Waste

Bulk Packed (12 per carton):  
L64600 series

**NOTE:** THIS FAUCET IS DESIGNED TO BE  
INSTALLED THRU 3-1" DIA. HOLES, 2" ON CENTER

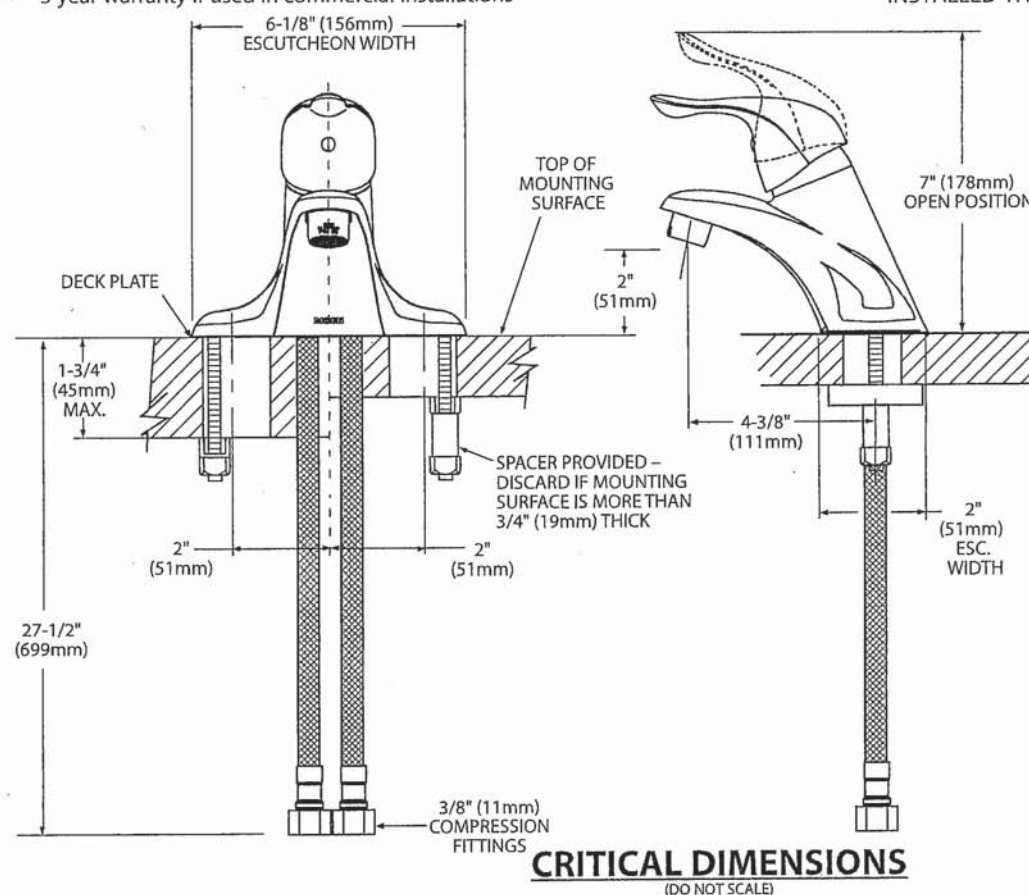

FOR MORE INFORMATION CALL: 1-800-BUY-MOEN  
www.moen.com

Buy it for looks. Buy it for life.®

There is more than 1 version of this model.  
Page down to identify the version you have.

### DESCRIPTION

- Metal construction with various finishes identified by suffix
- Includes non-metallic showerhead, arm, flange and non-metallic diverter tub spout

## OPERATION

- Handle operates counterclockwise through a 270° arc with off at 6 o'clock and maximum hot at the 9 o'clock position. Shut off in clockwise direction
- Adjustable temperature limit stop to control maximum hot water temperature
- Pressure balancing mechanism maintains selected discharge temperature to  $\pm 3^\circ$

## FLOW

- Showerhead is limited to 2.5 gpm (9.5 L/min) at 80 psi
- EP suffix models are limited to 1.75 gpm (6.6 L/min) at 80 psi
- NH suffix models contain no showerhead

## CARTRIDGE

- 1222 cartridge design
- Accommodates back to back installations
- Nonmetallic/nonferrous and stainless steel material

## STANDARDS

- Third party certified to meet ASME A112.18.1/CSA B125.1 and all applicable requirements referenced therein
- EP suffix models are third party certified to WaterSense®

- **ADA**  for lever handle

## WARRANTY

- Lifetime limited warranty against leaks, drips and finish defects to the original consumer purchaser
- 5 year warranty if used in commercial installations

## Specifications



**CHATEAU® POSI-TEMP®**  
**Single-Handle Tub/Shower Trim Kit**

**Models:** TL181 series - valve trim only  
(Bulk Packed 12 per carton)  
TL182 series - shower trim only  
(Bulk Packed 12 per carton)  
TL183 series - tub/shower trim  
(Bulk Packed 12 per carton)

**Valves:** 62300 series  
2500 series

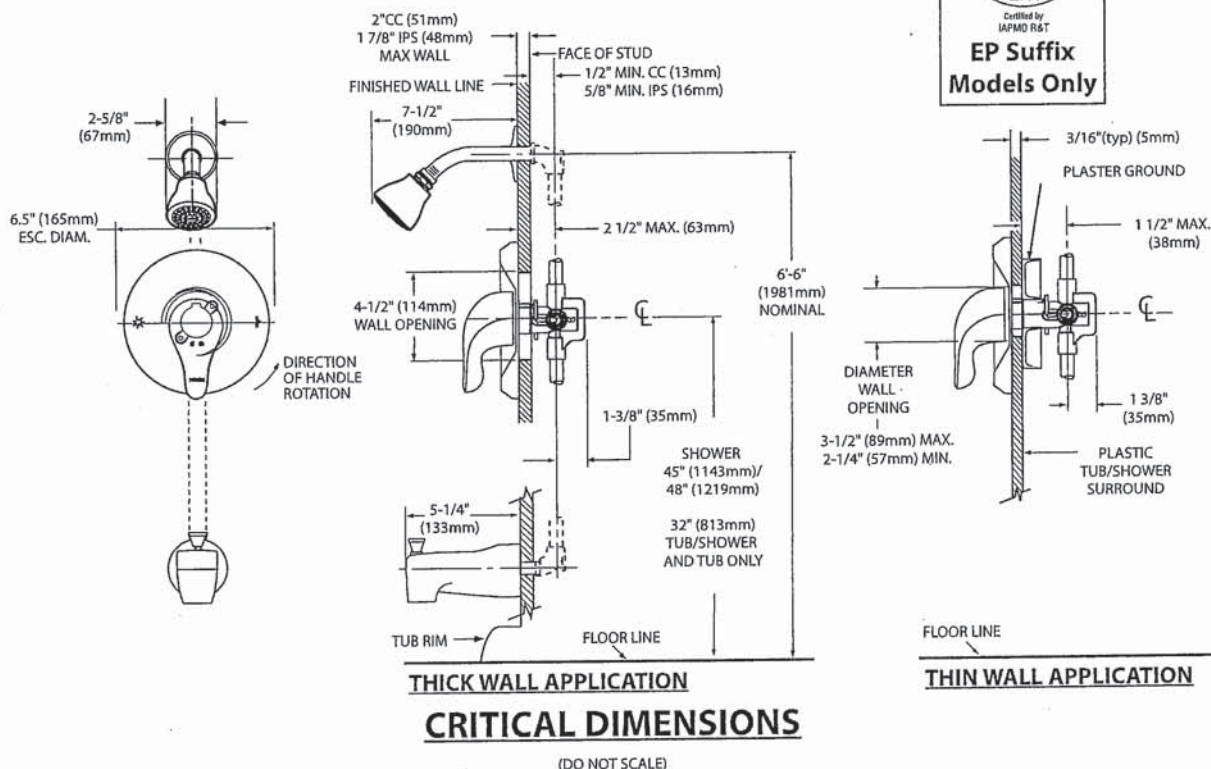



**MOEN®**

## Specifications

### DESCRIPTION

- Metal construction with various finishes identified by suffix

### OPERATION

- Lever style handles with hot and cold color indicator
- Rotate hot side handle counterclockwise to open (clockwise to close) and the cold side handle (clockwise to open) and (counterclockwise to close)

### STANDARDS

- Third party certified to: ASME A112.18.1/CSA B-125.1, and all applicable requirements referenced therein

- ADA  for lever handles

### WARRANTY

- Lifetime limited warranty against leaks, drips and finish defects to the original homeowner
  - 10 year limited warranty when used in a multi-family installation
  - 5 year limited warranty when used in a commercial installation
- Visit [www.moen.com/support](http://www.moen.com/support) for complete details and limitations

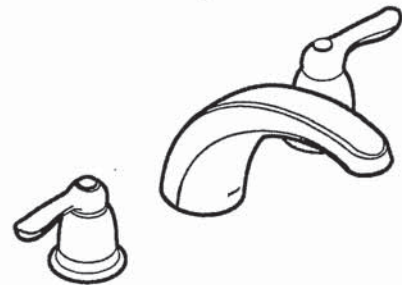

**CHATEAU®**  
Two-Handle Garden Tub Trim

**Models:** T994 series

**Valves:** 4792, 4793, 4794, 4796, 4797, 4798

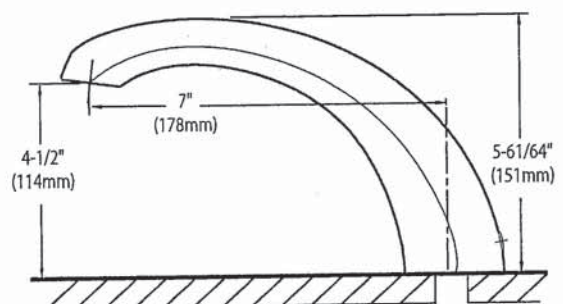
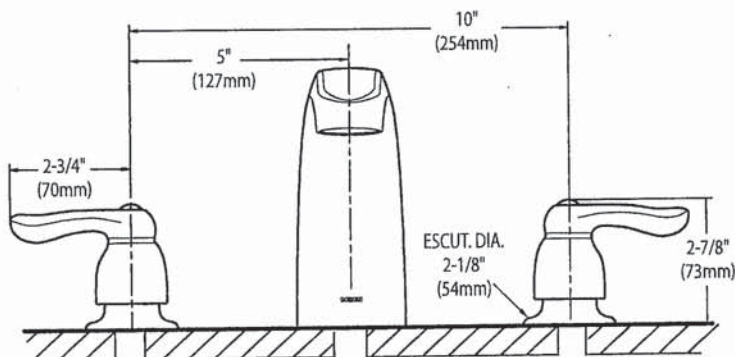

### CRITICAL DIMENSIONS (DO NOT SCALE)





SPECIFICATIONS  
**AV SERIES**  
RANGE HOODS



**180 CFM/7.0 Sones @ 0.10" SP. Horizontal**  
**180 CFM/7.5 Sones @ 0.10" SP. Vertical**

- Dimensions**  
Overall bottom projection - 18 3/8"  
Overall top projection - 12"  
Height - 6"  
Available widths: 21", 24", 30", 36" & 42"
- Hood Body**  
Stainless Steel: 24 gauge, grade 430 stainless steel.  
Painted: 23 gauge cold rolled commercial grade (CRCQ) steel, auto welded, coated with a baked enamel finish.
- Motor**  
2 speed, single coil, thermally protected, permanently lubricated.  
Rated 120 volts, 60 hz. Complete with 200°C lead wires.
- Lighting**  
Single 60 watt cook light capacity (bulb not included).
- Ducting Options**  
Horizontal ducting: 3 1/4"x10" (duct adapter and damper included).  
Vertical ducting: 3 1/4"x10" (duct adapter and damper included).  
Vertical ducting: 7" round (duct adapter and damper not included).  
Ductless: removable front vent (charcoal filter not included).
- Fan Blade**  
One piece polymeric, electronically balanced blade. 6 5/8" diameter with 5 paddles.
- Electrical connection**  
Hood top - 7/8" knockout hole for use with 1/2" cable clamp  
Hood back - 7/8" knockout hole for use with 1/2" cable clamp

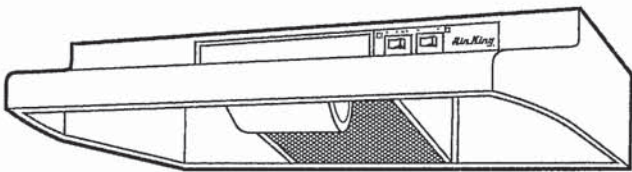

AV SERIES

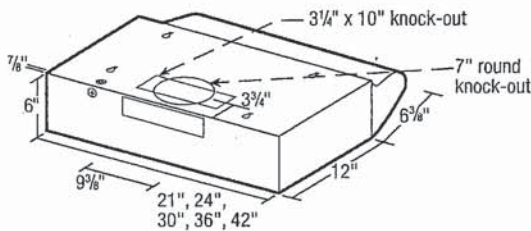

- Filters**  
UL rated, class 2 filter.  
Grease Filter: RF35 - 8 7/8"x10 3/8" (included).  
Charcoal Filter: RF34 (not included).  
Combo Grease/Charcoal: RF55 (not included).
- Available Finishes**  
White, Biscuit, Almond, Black & Stainless Steel.

EXPANDED PERFORMANCE										
Air Flow - CFM	Static Pressure (inches of w.g.)						Sones @ .1 SP	Fan Speed RPM	Power Watts	Apms
	0	0.05	0.1	0.15	0.2	0.25				
Vertical Ducting High	246	232	218	203	181	147	7.5	2973	87.0	2.1
Horizontal Ducting High	225	210	180	175	155	120	7.0	3024	87.0	2.1

PROJECT							ARCHITECT			
LOCATION							ENGINEER			
CONTRACTOR							SUBMITTED BY		DATE	
FAN NUMBER	MODEL NUMBER	CFM	IN W.C.	RPM	WATTS	AMPS	SONES	QTY	OPTIONAL EQUIPMENT & REMARKS	



Air King: 820 Lincoln Avenue  
West Chester, Pennsylvania 19380-4466  
Tel: (610) 692-7400 • 877-304-3785  
Fax: (610) 696-8048

Canada:  
Brampton, Ontario  
Tel: 905-456-2033  
Fax: (905) 456-1015

