



SITE
APPLIANCE CANADA
PRACTICAL ELECTRIC
STONE EDGE

Sales Selection Sheet
Wallaceton

42 of 47

PURCHASERS: NIRAJKUMAR, G DAVE and SUBASHINI DAVE

TEL:

LOT / UNIT	PHASE	MODEL	
3189A-1	3	20-2095 END ALT B The Forbes	

It is herein understood and agreed between the undersigned parties hereto that the following changes shall be made to the above mentioned Agreement of Purchase and Sale in accordance with the agreement and except for such changes noted below, all other terms and conditions in the Agreement of Purchase and Sale shall remain as stated herein: It is further understood that and agreed that all changes and additions shall be installed as per builder's specifications, location and available selections. The Purchaser hereby agrees to purchase the following extras:

APPLIANCES

1	KITCHEN - SEE NEW SPECS FOR LG 30" GAS COOKTOP MDOEL CBJG3027S	Qty: 1
126,975	Note: ORIGINAL COOKTOP SPEC FOR LG MODEL LCG3011ST HAVE BEEN DISCONTINUED.	

Sub Total

HST

Total

1. This Sales Selection Sheet when properly executed forms part of our Agreement of Purchase and Sale.
2. All extras and upgrades listed above are subject to Construction Progress and Architectural and Municipal requirements.
3. In the event the Vendor is unable to incorporate the work approved above in the construction of the house for any reason whatsoever, the Vendor will not be liable to the Purchaser in any way. The monies paid for any changes or optional extras not proceeded with shall be returned to the Purchaser, without interest. The cost of options or extras is non-refundable in all other circumstances. If for any reason whatsoever the Agreement of Purchase and Sale is not completed, the total cost of work approved above will be retained by the Vendor.
4. The Vendor reserves the right to substitute above materials and equipment with that of equal or better quality.
5. Purchaser acknowledges that items may not be exactly as shown. Variations from the Vendor's samples may occur in finished materials due to normal production processes. Vendor is not responsible for shade difference which may occur from different dye lots or wood grains. Variations from the Vendor's samples will occur with natural materials such as wood, marble, granite, hardwood and brick.
6. The Vendor reserves the right to select Grout & Thresholds that best suits the Tile selected.
7. Selections will not be processed unless signed by Heathwood Homes Head Office.
8. The selections made on this schedule are final and cannot be changed once submitted.
9. The Purchaser has checked and acknowledges the accuracy of this schedule.

Payment Summary

Paid By Amount

Total Payment:

PURCHASER:

Signatures on
NIRAJKUMAR, G DAVE

30-Jun-23

DATE

SONIA SHARIF

Decor Consultant

30-Jun-23

DATE

PURCHASER:

file
SUBASHINI DAVE

30-Jun-23

DATE

-06-30-2023

Date Approved Heathwood Homes (Huron) Limited

TAX#:1

PREPARED BY: Marilyn Rosen

PE 1,509-1

SIInvoice.rpt 28may19

HOME APPLIANCES

LG COOKING



CBGJ3027S
30" Smart Gas Cooktop with 22K BTU,
EasyClean® Cooktop, and ThinQ®

- 5 Cooktop Burners
- ThinQ® Technology
- 22K Ultraheat™ Dual Burner
- Weighted LED Illuminated Knobs
- EasyClean® Cooktop
- Heavy Duty Cast Iron Grates
- Cast Iron Griddle

AVAILABLE COLOURS



SUMMARY	
Type	30" Gas Cooktop
Number of Burners	5
Available Colors	Stainless Steel
COOKTOP FEATURES	
Cooktop Burner Type	Sealed Gas Burner
Number of Burners	5
Burner / BTU - Left Rear	10000/7500
Burner / BTU - Right Rear	5000/4000
Burner / BTU - Left Front	10000/7500
Burner/BTU - Right Front	12000/10000
Center (Warming Zone) (BTU)	22000/16000
Burner Simmer / BTU - Left Rear	1270
Burner Simmer / BTU - Right Rear	670
Burner Simmer / BTU - Left Front	1270
Burner Simmer / BTU - Right Front	1270
Center (Warming Zone)	650 / 1270
Auto Re-Ignition	Yes
EasyClean® Cooktop	Yes
CONTROL	
Cooktop Control Type	Weighted LED Illuminated Knobs
Control Location	Front Center
POWER/RATINGS	
kW at 120V	120V 60Hz / 0.12A
Requirements	120 V / 60Hz AC

SMART FEATURES	
ThinQ® (Wi-Fi Enabled)	Yes
Voice Control	No
Smart LG Hood / OTR Connectivity	Yes
ACCESSORIES	
Cast Iron Griddle	Yes
Conversion Kit	Yes
DIMENSIONS / CLEARANCES / WEIGHT	
Product Dimensions (WxHxD)	30" x 3 3/4" x 21 11/16"
Cut-out Dimensions (WxHxD)	28 1/2" x 3 3/4" x 19 5/8"
Shipping Dimensions (WxHxD)	34 21/64" x 10 5/32" x 25 25/32"
Product Weight (lbs.)	47 lbs.
Shipping Weight (lbs.)	63 lbs.
LIMITED WARRANTY	
Parts and Labour (internal/functional parts only)	1 Year
UPC CODES	
CBGJ3027S (Stainless Steel)	048231345224

- To reduce the possibility of gas leaks, apply Teflon tape or a thread compound approved for use with LP or natural gases to all threaded connections.
 - Flexible metal appliance connector (5/8" I.D.) A 3-foot length is recommended for ease of installation but other lengths are acceptable.
- Never use an old connector when installing a new cooktop.
- Flare union adapter for connection to gas supply line (3/4" or 1/2" NPT x 5/8" I.D.)
 - Flare union adapter for connection to pressure regulator on cooktop. (1/4" NPT x 1/2" I.D.)
 - Liquid leak detector or soapy water

Dimensions and Clearances

Provide enough clearance between the cooktop and adjacent combustible surfaces. These dimensions must be met for safe use of your cooktop. The location of the electrical outlet and pipe opening may be adjusted to meet specific requirements.

The cooktop must be placed with at least 2 3/4" of clearance to the back wall.

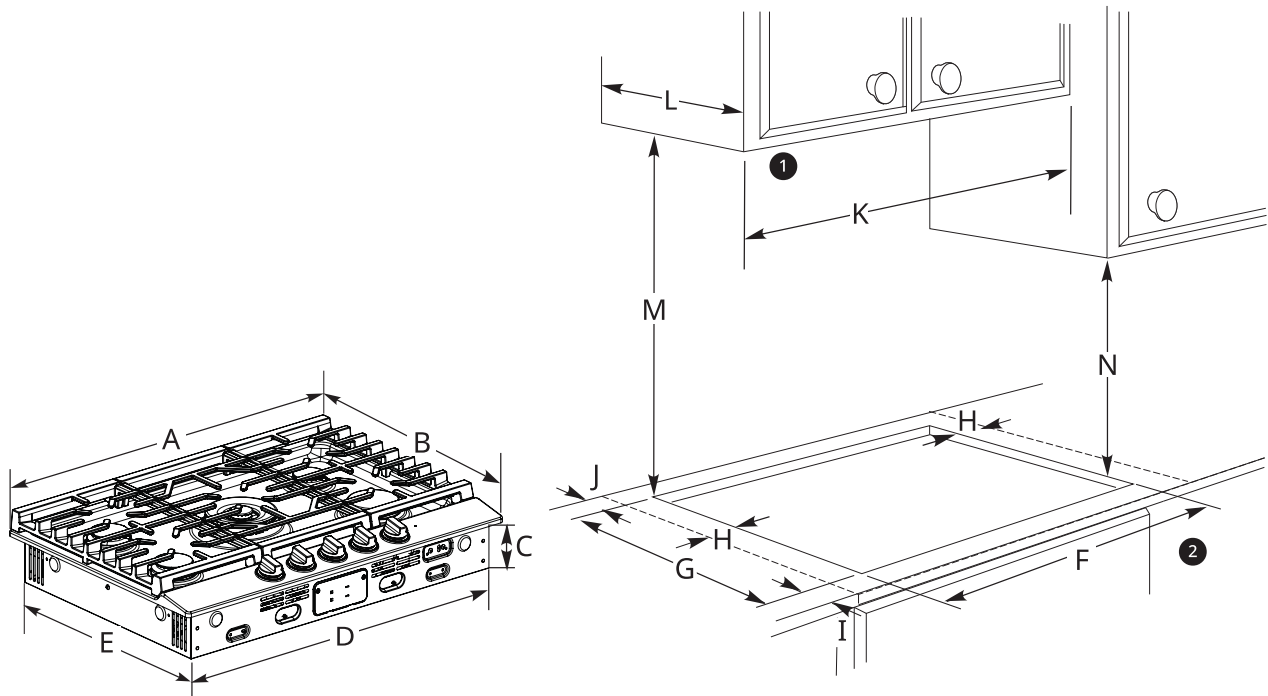

- ❶ Make sure wall coverings, countertop and cabinets around cooktop can withstand the heat (up to 200 °F) generated by the cooktop
- ❷ To ensure accuracy, it is best to make a template when cutting the opening in the counter

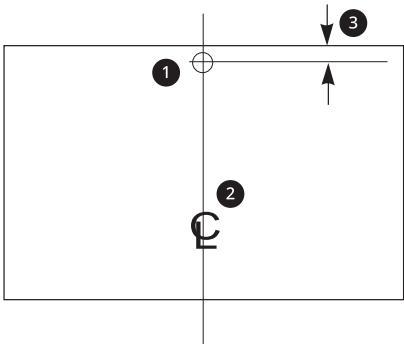

- ❶ Recommended gas supply location
- ❷ From cutout center line
- ❸ 1" min. from back wall

8 INSTALLATION

-	Dimension/Clearance	30" Cooktop	36" Cooktop
A	Width of upper plate	30" (760 mm)	36" (915 mm)
B	Depth of upper plate	21" (533 mm)	
C	Height of cooktop base	3 3/4" (95 mm)	
D	Width of cooktop base	28 1/4" (717 mm)	33 5/8" (854 mm)
E	Depth of cooktop base	19 3/8" (492 mm)	
F	Width of cutout	28 1/2" (724 mm)	33 7/8" (860 mm)
G	Depth of cutout	19 5/8" (498 mm)	
H	Distance from cutout to side wall on the left of unit. / Distance from cutout to side wall on the right of the unit.	≥11 13/16" (300 mm)	
I	Distance from front edge of cutout to front edge of countertop	≥1 5/8" (41 mm)	
J	Distance between cutout and the wall behind the cooktop	≥2 3/4" (69 mm)	
K	Width of unprotected overhead cabinets	≥30" (760 mm)	≥36" (915 mm)
L	Depth of unprotected overhead cabinets	≤13" (330 mm)	
M	Clearance from countertop to unprotected overhead surface	≥30" (760 mm)	
N	Clearance from countertop to nearest cabinet on either side of unit	≥18" (457 mm)	

Installing the Cooktop

Installing the Cooktop Unit

1 Locate the electrical outlet and gas shut-off valve in the cabinet beneath the cooktop. The access cap on the gas regulator must face the front of the cabinet and be easily accessible. Never reuse old flexible connectors. Install a manual shut-off valve 2 in the gas line in an easily accessible location outside the cooktop. Be sure you know how and where to shut off the gas supply to the cooktop. Install the electrical outlet 12" 1 below the countertop.

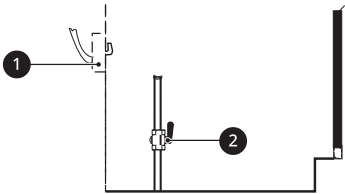

2 Carefully lower the cooktop into the countertop cutout, making sure not to trap any wires.

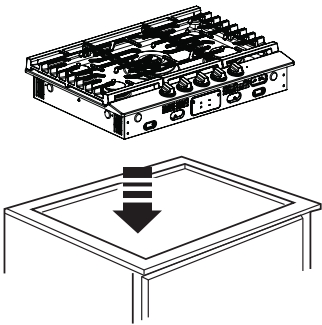

3 Remove the retainer brackets from the literature package.

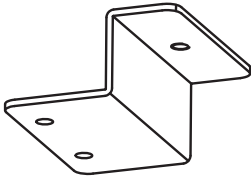

- 4 Install the retainer brackets ❶ to the bottom of the cooktop unit ❸, then snug the screws ❷ against the bottom of the countertop ❹ as shown.

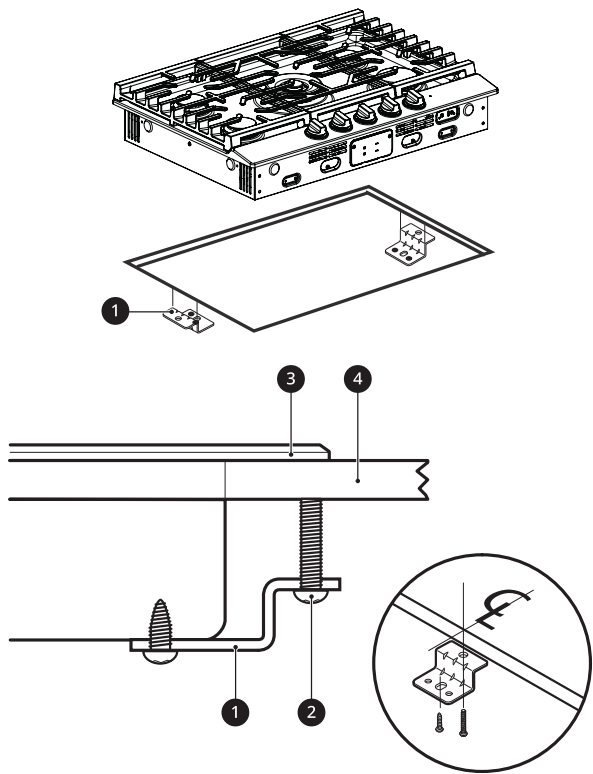

NOTE

- The retainer brackets MUST be installed to meet local codes or, in their absence, the National Electrical Code ANSI/NFPA No. 70, latest edition.

1. Providing Adequate Gas Supply

This cooktop is designed to operate at a pressure of 5" of water column with natural gas or 10" of water column with LP, propane or butane gas. Make sure you are supplying your cooktop with the type of gas for which it is designed.

This cooktop is convertible for use with natural or propane gas. When using this cooktop with LP gas, the conversion must be made by a qualified LP installer before attempting to operate the cooktop using that gas.

For correct operation, the pressure of natural gas supplied to the regulator should be between 5" and 13" of water column.

For LP gas, the pressure supplied must be between 10" and 13" of water column.

When checking for correct operation of the regulator, the inlet pressure must be at least 1" more than the operating (manifold) pressure as given above.

The pressure regulator located at the inlet of the cooktop manifold must remain in the supply line regardless of whether natural or LP gas is being used.

A flexible metal appliance connector used to connect the cooktop to the gas supply line must have an I.D. of 5/8" and must be a maximum of 3 feet in length for easy installation. In Canada, flexible connectors should be single wall metal connectors less than 6 feet in length.

2. Connecting the Cooktop to Gas

Shut off the main gas supply valve before removing the old cooktop and leave it off until the new hook-up has been completed. Don't forget to relight the pilot on other gas appliances when you turn the gas back on.

Because hard piping restricts movement of the cooktop, the use of a CSA International-certified flexible metal appliance connector is recommended unless local codes require a hard-piped connection.

Never reuse an old connector when installing a new cooktop. If the hard piping method is used, you must carefully align the pipe; the cooktop cannot be moved after the connection is made.

To prevent gas leaks, put pipe joint compound on all male (external) pipe threads.

- 1 Install a manual gas line shut-off valve in the gas line in an easily accessed location outside of the cooktop. Be sure everyone operating the cooktop knows where and how to shut off the gas supply to the cooktop.
- 2 Install a male 1/2" flare union adapter to the 1/2" NPT internal thread at the inlet of the pressure regulator. Use a backup wrench on the pressure regulator fitting to prevent damage. Make sure that the access cap on the gas regulator is facing the front of the cabinet and is easily accessible through the cabinet doors.
- 3 Install a male 1/2" or 3/4" flare union adapter to the NPT internal thread of the manual shut-off valve, taking care to back-up the shut-off valve to keep it from turning.
- 4 Connect a flexible metal connector to the adapter on the cooktop. Position the cooktop to permit connection at the shut-off valve.

10 INSTALLATION

5 When all connections have been made, be sure all cooktop controls are in the off position and turn on the main gas supply valve. Check for gas leaks using a manometer. If a manometer is not available, turn the gas supply to the cooktop on and use a liquid leak detector at all joints and connections to check for leaks. Tighten all connections, if necessary, to prevent gas leakage in the cooktop or supply line.

**WARNING**

- DO NOT USE A FLAME TO CHECK FOR GAS LEAKS.
- The appliance and its individual shutoff valve must be disconnected from the gas supply piping system during any pressure testing of that system at test pressures in excess of 1/2 psi (3.5 kPa).
- The appliance must be isolated from the gas supply piping system by closing its individual manual shutoff valve during any pressure testing of the gas supply piping system at test pressures equal to or less than 1/2 psi (3.5 kPa).

Flexible Connector Hookup

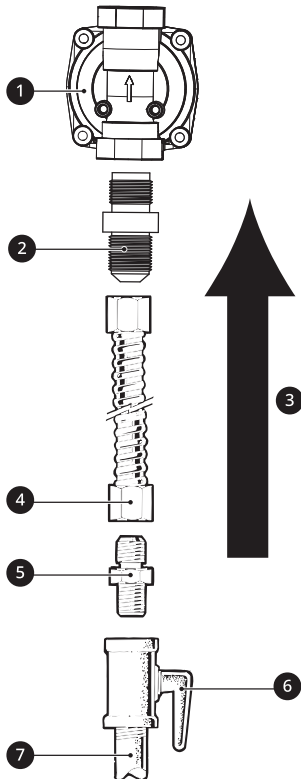

- 1 Pressure Regulator
- 2 Adapter
- 3 Gas Flow into Cooktop
- 4 Flex Connector (3 ft. max. in US, 6 ft. max. in Canada)

- 5 Adapter
- 6 Gas Shut-off Valve
- 7 1/2" or 3/4" Gas Pipe

NOTE

- Installer: Inform the consumer of the location of the gas shut-off valve.

3. Electrical Connections

Electrical Requirements

This cooktop requires a 120 Volt, 60 Hertz, properly grounded dedicated circuit protected by a 15 A or 20 A circuit breaker or time-delay fuse.

The appliance, when installed, must be electrically grounded in accordance with local codes or, in the absence of local codes, with the National Electrical Code, NFPA70 or the Canadian Electric Code, CSA C22.1-02.

Grounding

IMPORTANT: FOR PERSONAL SAFETY, THIS APPLIANCE MUST BE PROPERLY GROUNDED.

Preferred Method

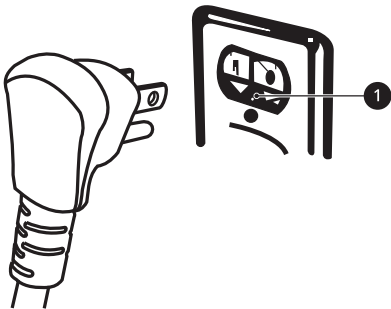

- 1 Ensure proper ground exists before use.

The power cord of this appliance should be equipped with a three-prong (grounding) plug which mates with a standard three-prong grounding wall receptacle to reduce the possibility of electric shock hazard from this appliance.

The customer should have the wall receptacle and circuit checked by a qualified technician to be sure the receptacle is properly grounded.

When connecting this cooktop, it is the personal responsibility and obligation of the customer to have a standard two-prong wall receptacle replaced with a properly grounded three-prong wall receptacle.