

LOT 3132 Model: 28-2444 B THE SOUTHPORT

PURCHASERS: VINOD, KUMAR TIWARI/JEENISHA NARAYAN SINGH BISHT

VENDOR: Heathwood Homes (Huron) Limited

SHARED BATHROOM - OPTION FROM ONE SINK TO DOUBLE SINKS
GREAT ROOM - BUILT OUT WALL ABOVE FIREPLACE

- ☐ WOB
☐ DECK
☒ FINISHED BASEMENT
☐ COLD CELLAR

UPGRADED / MODIFIED ELEVATION

- ☐ CORNER UPGRADE
☐ REAR UPGRADE
☐ SIDE UPGRADE

CEILING UPGRADE - SMOOTH

- ☒ MAIN FLOOR
☐ SECOND FLOOR
☐ BASEMENT

ADDITIONAL ROUGH-INS

- ☒ 200 AMP SERVICE (STD IN SINGLES)
☐ WET BAR ROUGH-IN
☐ HUMIDIFIER
☒ AIR CONDITIONING (SITE STD)

GAS ROUGH-IN

- ☒ STOVE
☐ DRYER
☐ BBQ
☐ ADDITIONAL FIREPLACE

KITCHEN: HOODFAN VENTING SIZE

- ☒ 6 IN ROUND DUCT
☐ 7 IN ROUND DUCT

FULL BASEMENT STAIRS:	N/A
UPPER BASEMENT STAIRS:	All Oak
LOWER LEVEL STAIRS:	Carpet Grade
MAIN STAIRS:	All Oak
MEDIA STAIRS (if applicable):	N/A
LOFT STAIRS (if applicable):	N/A

APRIL 11/24

Date

Purchaser:

Signature
on file

APRIL 11/24

Date

Decor Consultant:

Souma S HARRIF

Date

Purchaser:

04-11-2023

Date

Heathwood Homes (Huron) Limited

mRosen

Locked Date:

Approved

VINOD, KUMAR TIWARI/JEENISHA NARAYAN SINGH BISHT
Project: Wallaceton
Unit: 3132, Phase: 3
Model: 28-2444 B THE SOUTHPORT

Created: 12/07/2022 14:18:09
Locked:
Closed:

Kitchen

Cabinet Colour/Style	9166	Viking III-CHARLESTON-ORCHID-3DL ***STD***
Island Cabinet Colour/Style	9166	Viking III-CHARLESTON-ORCHID-3DL ***STD***
Cabinet Hardware	7667	12881-HARDWARE ***STD***
Countertop	8595	Group 2-Quartz-Caesarstone-OCEAN FOAM #6141-3/4 inch with built-up edge ***2***
Island Countertop	8595	Group 2-Quartz-Caesarstone-OCEAN FOAM #6141-3/4 inch with built-up edge ***2***
Countertop Edge	4005	DOUBLE MITRE 1 1/2 INCH ***UPG***



- Please note some islands may require a seam as per manufacturer and fabricator discretions.

Sink	9495	BLANCO QUATRUS U 1 3/4 LARGE/MEDIUM 401244 (min cabinet 36 in)	PG 27									
HoodFan	9515	SAMSUNG 36 in STAINLESS STEEL CHIMNEY RANGE HOOD Model NK36K7000WS/A2	PG 38-39									
Backsplash	5728	QT.CD.STG.0306.BR-Colour and Dimension Bright-Sterling Grey-3 x 6 ***2***										
Backsplash Grout	2226	Grout-(00) White ***STD***										
Backsplash Tile Pattern	3050	SIDE TO SIDE ***STD*** <table><tr><td></td><td></td></tr><tr><td></td><td></td></tr><tr><td></td><td></td></tr><tr><td></td><td></td></tr></table>										
Flooring	9106	GE.MD.WHT.1818.MT Madison Series White Matte 18 X 18 Matte ***1***										
Floor Tile Grout	2225	Grout-(27) Silver ***STD***										
Floor Tile Pattern	3000	STANDARD SQUARE ***STD*** <table><tr><td></td><td></td><td></td></tr><tr><td></td><td></td><td></td></tr><tr><td></td><td></td><td></td></tr></table>										

- Purchasers have been advised: standard fridge opening is a minimum 37 3/8 x 73 3/8 inches. Ice Waterline Rough-In is included.
- Standard stove opening is 30 inches and standard dishwasher opening is 24 inches. Any gas stove will require backsplash or stainless steel backing to avoid fire hazards.
- Purchasers acknowledge: Heathwood Homes and its contractors will not be responsible for any kitchen cabinet changes due to appliances dimension changes after sign-off.

Comment

Great/Breakfast

Flooring	7502	Red Oak Pearl-Vintage Engineered-PEWTER/ECLIPSE-3/4 inch x 3 1/4 inch
----------	------	---

Comment

VINOD, KUMAR TIWARI/
Project: Wallaceton
Unit: 3132, Phase: 3
Model: 28-2444 B THE SOUTHPORT

Created: 12/8/2022 14:13:09
Locked:
Closed:

Great Room Fireplace

Type	8869	Majestic MERC32 ***STD***
Mantle	8892	NF-17-Paint Grade Mantle-6 inch Deep Mantle (TV above Fireplace-WHITE) ***Upg***
Surround (Opt.)	1111	N/A *****

PG 26

- Purchasers have been advised: heat from the FP can damage TV above a FP and items placed on mantle.

- Heathwood and its contractors will not be liable for any damage on items placed/@installed above a FP after closing.

Comment

Main Hall

Flooring	7502	Red Oak Pearl-Vintage Engineered-PEWTER/ECLIPSE-3/4 inch x 3 1/4 inch ***3***
Floor Tile Grout	1111	N/A *****
Floor Tile Pattern	1111	N/A *****

Comment

Foyer

Flooring	9106	GE.MD.WHT.1818.MT Madison Series White Matte 18 X 18 Matte ***1***
Floor Tile Grout	2225	Grout-(27) Silver ***STD***
Floor Tile Pattern	3000	STANDARD SQUARE ***STD***

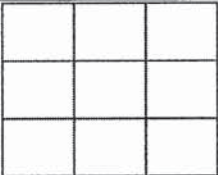

Comment

Powder Room

Flooring	9106	GE.MD.WHT.1818.MT Madison Series White Matte 18 X 18 Matte ***1***
Floor Tile Grout	2226	Grout-(00) White ***STD***
Floor Tile Pattern	3000	STANDARD SQUARE ***STD***

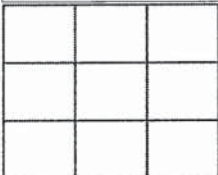

Plumbing Fixture (Colour)	1737	Plumbing Fixtures-WHITE ***STD***
---------------------------	------	-----------------------------------

Comment

57

JB

Customer Colours

VINOD, KUMAR TIWARI/
Project: Wallaceton
Unit: 3132, Phase: 3
Model: 28-2444 B THE SOUTHPORT

Created: 12/9/2022 14:15:09
Locked:
Closed:

Comment

Mud Room

Flooring	9106	GE.MD.WHT.1818.MT Madison Series White Matte 18 X 18 Matte ***1***									
Floor Tile Grout	2225	Grout-(27) Silver ***STD***									
Floor Tile Pattern	3000	STANDARD SQUARE ***STD***									
		<table><tr><td></td><td></td><td></td></tr><tr><td></td><td></td><td></td></tr><tr><td></td><td></td><td></td></tr></table>									

Comment

Hallway and Broom Closet

Flooring	9106	GE.MD.WHT.1818.MT Madison Series White Matte 18 X 18 Matte ***1***									
Floor Tile Grout	2225	Grout-(27) Silver ***STD***									
Floor Tile Pattern	3000	STANDARD SQUARE ***STD***									
		<table><tr><td></td><td></td><td></td></tr><tr><td></td><td></td><td></td></tr><tr><td></td><td></td><td></td></tr></table>									

Comment

Upper Hall

Flooring	9508	16320-MINOTAUR-PAMPA BEIGE-40 oz Poly ***STD***
----------	------	---

Comment

Master Bedroom and Walk-in Closet

Flooring	9508	16320-MINOTAUR-PAMPA BEIGE-40 oz Poly ***STD***
----------	------	---

Comment

Bedroom 2

Flooring	9508	16320-MINOTAUR-PAMPA BEIGE-40 oz Poly ***STD***
----------	------	---

Comment

VT

JB

VINOD, KUMAR TIWARI/
Project: Wallaceton
Unit: 3132, Phase: 3
Model: 28-2444 B THE SOUTHPORT

Created: 12/9/2022 14:15:09
Locked:
Closed:

Bedroom 3

Flooring	9508	16320-MINOTAUR-PAMPA BEIGE-40 oz Poly ***STD***
Comment		

Bedroom 4 and Walk-in Closet

Flooring	9508	16320-MINOTAUR-PAMPA BEIGE-40 oz Poly ***STD***
Comment		

Laundry Room

Floor Tile	9106	GE.MD.WHT.1818.MT Madison Series White Matte 18 X 18 Matte ***1***
Floor Tile Grout	2225	Grout-(27) Silver ***STD***
Floor Tile Pattern	3000	STANDARD SQUARE ***STD*** <div><div></div><div></div><div></div><div></div><div></div><div></div><div></div><div></div><div></div></div>
Opt. Cabinet Colour/Style - Uppers	9166	Viking III-CHARLESTON-ORCHID-3DL ***STD***
Opt. Cabinet Hardware - Uppers	7667	12881-HARDWARE ***STD***
Opt. Countertop	1111	N/A *****
Opt. Countertop Edge	1111	N/A *****
Comment		

Master Ensuite

Cabinet Colour/Style	9169	Viking III-CHARLESTON-NAVY BLUE-3DL ***STD***
Cabinet Hardware	2098	12801-HARDWARE ***STD***
Countertop	9069	MSI Quartz GROUP 1 ICED WHITE ***STD***
Countertop Edge	4010	SINGLE POLISHED STRAIGHT EDGE 3/4 INCH ***STD*** <div><div></div></div>
Floor Tile	9106	GE.MD.WHT.1818.MT Madison Series White Matte 18 X 18 Matte ***1***
Floor Tile Grout	2225	Grout-(27) Silver ***STD***
Floor Tile Pattern	3000	STANDARD SQUARE ***STD*** <div><div></div><div></div><div></div><div></div><div></div><div></div><div></div><div></div><div></div></div>

57

9B

VINOD, KUMAR TIWARI/
Project: Wallaceton
Unit: 3132, Phase: 3
Model: 28-2444 B THE SOUTHPORT

Created: 12/09/2022 14:13:09
Locked:
Closed:

Shower Wall Tile	5411	QT.SP.WHT.0810-Splendour-White-8 inch x 10 inch ***STD***
Shower Wall Tile Grout	2226	Grout-(00) White ***STD***
Shower Wall Tile Pattern	3090	VERTICAL STACKED ***STD*** <div><div></div><div></div><div></div><div></div><div></div><div></div></div>
Shower Floor Tile	8103	OD.ON.SWT.02.HEX.MT-ONTARIO HEXAGON MATTE-SNOW WHITE ***UG2***
Shower Floor Tile Grout	2226	Grout-(00) White ***STD***
Shower Floor Tile Pattern	3120	VERTICAL HEX ***STD*** <div><div></div><div></div><div></div><div></div><div></div><div></div></div>
Shower Jamb(s) and Sill(s)	8923	Shower Jamb / Sill-Thassos White ***STD***
Plumbing Fixture (colour)	1737	Plumbing Fixtures-WHITE ***STD***
Comment		

Shared Ensuite

Cabinet Colour/Style	9168	Viking III-CHARLESTON-MOONLIGHT-3DL ***STD***
Cabinet Hardware	2098	12801-HARDWARE ***STD***
Countertop	8827	4925K-07-Countertop-CALCUTTA MARBLE-Wilsonart ***STD***
Countertop Edge	1111	N/A *****
Floor Tile	9106	GE.MD.WHT.1818.MT Madison Series White Matte 18 X 18 Matte ***1***
Floor Tile Grout	2225	Grout-(27) Silver ***STD***
Floor Tile Pattern	3000	STANDARD SQUARE ***STD*** <div><div></div><div></div><div></div><div></div><div></div><div></div></div>
Shower Wall Tile	5411	QT.SP.WHT.0810-Splendour-White-8 inch x 10 inch ***STD***
Shower Wall Tile Grout	2226	Grout-(00) White ***STD***
Shower Wall Tile Pattern	3090	VERTICAL STACKED ***STD*** <div><div></div><div></div><div></div><div></div><div></div><div></div></div>
Shower Floor Tile	8103	OD.ON.SWT.02.HEX.MT-ONTARIO HEXAGON MATTE-SNOW WHITE ***UG2***

NT

JB

Customer Colours

VINOD, KUMAR TIWARI/
Project: Wallaceton
Unit: 3132, Phase: 3
Model: 28-2444 B THE SOUTHPORT

Created: 12/9/2022 14:13:09
Locked:
Closed:

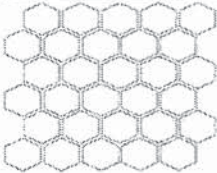
Shower Floor Tile Grout	2226	Grout-(00) White ***STD***
Shower Floor Tile Pattern	3120	VERTICAL HEX ***STD***
		
Shower Jamb(s) and Sill(s)	8923	Shower Jamb / Sill-Thassos White ***STD***
Plumbing Fixture (colour)	1737	Plumbing Fixtures-WHITE ***STD***
Comment		

Ensuite 4

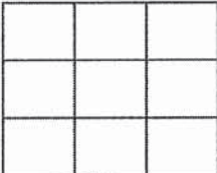
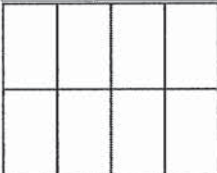
Cabinet Colour/Style	9168	Viking III-CHARLESTON-MOONLIGHT-3DL ***STD***
Cabinet Hardware	2098	12801-HARDWARE ***STD***
Countertop	8827	4925K-07-Countertop-CALCUTTA MARBLE-Wilsonart ***STD***
Countertop Edge	1111	N/A *****
Floor Tile	9106	GE.MD.WHT.1818.MT Madison Series White Matte 18 X 18 Matte ***STD***
Floor Tile Grout	2225	Grout-(27) Silver ***STD***
Floor Tile Pattern	3000	STANDARD SQUARE ***STD***
		
Wall Tile	5411	QT.SP.WHT.0810-Splendour-White-8 inch x 10 inch ***STD***
Wall Tile Grout	2226	Grout-(00) White ***STD***
Wall Tile Pattern	3090	VERTICAL STACKED ***STD***
		
Opt. Shower Floor Tile	1111	N/A *****
Opt. Shower Floor Tile Grout	1111	N/A *****
Opt. Shower Floor Tile Pattern	1111	N/A *****
Opt. Shower Jamb(s) and Sill(s)	1111	N/A *****
Plumbing Fixture (colour)	1737	Plumbing Fixtures-WHITE ***STD***
Comment		

57



VINOD, KUMAR TIWARI/
Project: Wallaceton
Unit: 3132, Phase: 3
Model: 28-2444 B THE SOUTHPORT

Created: 12/9/2022 14:15:09
Locked:
Closed:

Lower Level Recreation Room (Opt. Finis

Flooring	9508	16320-MINOTAUR-PAMPA BEIGE-40 oz Poly ***STD***
Comment		

Lower Level Bathroom (Opt. Finished Bas

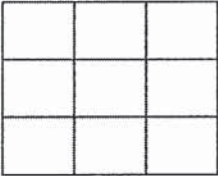
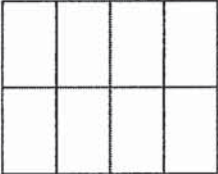
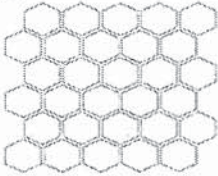
Cabinet Colour/Style	9168	Viking III-CHARLESTON-MOONLIGHT-3DL ***STD***
Cabinet Hardware	2098	12801-HARDWARE ***STD***
Countertop	8827	4925K-07-Countertop-CALCUTTA MARBLE-Wilsonart ***STD***
Countertop Edge	1111	N/A *****
Floor Tile	9106	GE.MD.WHT.1818.MT Madison Series White Matte 18 X 18 Matte ***1***
Floor Tile Grout	2225	Grout-(27) Silver ***STD***
Floor Tile Pattern	3000	STANDARD SQUARE ***STD*** 
Shower Wall Tile	5411	QT.SP.WHT.0810-Splendour-White-8 inch x 10 inch ***STD***
Shower Wall Tile Grout	2226	Grout-(00) White ***STD***
Shower Wall Tile Pattern	3090	VERTICAL STACKED ***STD*** 
Shower Floor Tile	8103	OD.ON.SWT.02.HEX.MT-ONTARIO HEXAGON MATTE-SNOW WHITE ***UG2***
Shower Floor Tile Grout	2226	Grout-(00) White ***STD***
Shower Floor Tile Pattern	3120	VERTICAL HEX ***STD*** 
Shower Jamb(s) and Sill(s)	8923	Shower Jamb / Sill-Thassos White ***STD***
Plumbing Fixture (colour)	1737	Plumbing Fixtures-WHITE ***STD***
Comment		

Main Stairs

Type	1714	Oak Stairs ***STD MAIN STAIRS***
Colour	7922	Eclipse (Pewter) STAIN TO COMPLIMENT HARDWOOD AND WILL VARY FROM FLOORING ***99***
Handrail/Pickets/Posts Type	8148	Single Collar Alt. Plain w/ Shoes with 3 1/2? Square/Cap

57

23

VINOD, KUMAR TIWARI/
Project: Wallaceton
Unit: 3132, Phase: 3
Model: 28-2444 B THE SOUTHPORT

Created: 12/09/2022 14:15:09
Locked:
Closed:

		Post(s)-BLACK ***2***
Handrail/Pickets/Posts Colour	7922	Eclipse (Pewter) STAIN TO COMPLIMENT HARDWOOD AND WILL VARY FROM FLOORING ***99***
Custom Stain/Paint	1111	N/A *****
Landing(s)	7502	Red Oak Pearl-Vintage Engineered-PEWTER/ECLIPSE-3/4 inch x 3 1/4 inch
Opt. Carpet Runner	9508	16320-MINOTAUR-PAMPA BEIGE-40 oz Poly ***STD***
Comment		

Lower Level Stairs

Type	1711	Carpet Grade Stairs ***OPT. FINISHED BASEMENT***
Colour		DY 16320-MINOTAUR-PAMPA BEIGE-40 oz Poly ***STD***
Handrail/Pickets/Posts Type	9508	Handrail only on closed walls (one or two sides per building code) ***STD***
Handrail/Pickets/Posts Colour	7922	Eclipse (Pewter) STAIN TO COMPLIMENT HARDWOOD AND WILL VARY FROM FLOORING ***99***
Custom Stain/Paint	1111	N/A *****
Landing(s)	7502	Red Oak Pearl-Vintage Engineered-PEWTER/ECLIPSE-3/4 inch x 3 1/4 inch
Opt. Carpet Runner	1111	N/A *****
Comment		

Throughout

Switches and Plug	5796	Decora White Switches and Plugs ***STD***
Thresholds	2232	Metal Thresholds ***STD***
Underpad	1079	500 Series-Underpad ***STD***
Trim Size	8705	4 1/4 Baseboard and 2 3/4 Casings ***STD***
Trim - Paint Colour	1716	Trim-WHITE ***STD***

Purchaser:

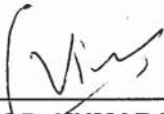

VINOD, KUMAR TIWARI

02/24/2023

Date

Sonia Sharif

Decor Consultant

FEB 24/23

Date

Purchaser:



02/24/2023

Date

Michael Rosen

Wallaceton

-04-11-2023

Date Approved

VT

9/3



CONSTRUCTION SUMMARY

Lot: 3132
Model: 28-2444 B THE SOUTHPORT
Project/Phase: Wallaceton / 3

Offer Worksheet	The Purchaser(s) acknowledge that they have NOT been referred by an existing Heathwood Homeowner and therefor are not entitled to a referral fee under Heathwood Homes Referral program. Note:
Offer Worksheet	Finished Lower Level with finished bathroom- 617 Sq ft (The Southport) Note:
Offer Worksheet	DELETED BY AMENDMENT - Five Appliances: SS Fridge, Stove, Chimney Hood Fan, Dishwasher: White Front Loader Washer/Dryer (Singles) Note:



CONSTRUCTION SUMMARY

Lot: 3132
Model: 28-2444 B THE SOUTHPORT
Project/Phase: Wallaceton / 3

APPLIANCES

Invoice	Qty.	Description
1478	1	KITCHEN - 36" Samsung Range Hood, NK36K7000WS
24Jul23 NoCat		SEE SPECS CABINETRY-delete stove uppers; ELECTRICAL-delete std range hood; HEATING/AIR CONDITIONING-Duct change to 6 in

CABINETRY

Invoice	Qty.	Description
1478	1	KITCHEN - 36" Samsung Range Hood, NK36K7000WS
24Jul23 ** NoCat		SEE SPECS CABINETRY-delete stove uppers; ELECTRICAL-delete std range hood; HEATING/AIR CONDITIONING-Duct change to 6 in
1235 347,680 24Jul23	1	Built In - CABINETRY - OPT. BUILT IN - VIKING II/III - UPG SKETCH # 3 DRYWAL-Notify; FRAMING-Modify Bulkhead; GRANITE-delete partial countertop due to Built-in; PAINTING-
1235 314,277 24Jul23 **	1	KITCHEN - GRANITE - GRANITE CUTOUT W/ STRAIGHT EDGE POLISH TO ACCOMMODATE COOK TOP SKETCH # 3 SEE COOKTOP SPECS
1235 313,904 24Jul23	1	KITCHEN - B17-45cm wide pull-out door base cabinet waste/recycle centre with soft-close ([2] 35L bins per unit) (available only with 45cm wide cabinet) Viking SKETCH # 3
1235 313,796 24Jul23	1	KITCHEN - B10-Pots and pans drawers (width min. 60cm/max. 90cm) (size subject to floor plan) Viking BESIDE THE FRIDGE SEE SKETCH # 3
1235 334,723 24Jul23 **	1	SHARED BATHROOM - PLUMBING - OPTION FROM ONE SINK TO DOUBLE SINKS INCLUDING STD CHATEAU FAUCET OVERMOUNT COLONY SINK ONE EXTRA VANITY LIGHT AND CABINET CONVERSION 2D VIKING SKETCH # 4 AND 5 CABINETRY-2D Convert Cabinetry Viking; ELECTRICAL-Additional Vanity Light
1235 347,673 24Jul23	1	LAUNDRY ROOM - CABINETRY - OPT. LAUNDRY UPPERS - VIKING II/III - UPG SKETCH # 4 AND 5
1235 314,409 24Jul23 **	1	KITCHEN - PLUMBING - KITCHEN SINK UPGRADE - BLANCO KITCHEN SINK QUATRUS U 1 3/4 #401244 (33 INCH X 18 INCH) UNDERMOUNT LARGE/MEDIUM BOWL 9 INCH DEEP IN STAINLESS STEEL - SEE SPEC CABINETRY-upgraded kitchen sink; GRANITE-upgraded kitchen sink



CONSTRUCTION SUMMARY

Lot: 3132
Model: 28-2444 B THE SOUTHPORT
Project/Phase: Wallaceton / 3

CARPET

Invoice	Qty.	Description
1235 348,119 24Jul23	1	- CARPET - CARPET RUNNER - 40OZ POLY - UPG MAIN STAIRS AND STAIRS FROM MAIN TO POWDER ROOM LANDING



CONSTRUCTION SUMMARY

Lot: 3132
Model: 28-2444 B THE SOUTHPORT
Project/Phase: Wallaceton / 3

CERAMICS

Invoice	Qty.	Description
1235 347,214 24Jul23	1	Foyer Floor - CERAMICS - FLOOR - Foyer Floor - UG 1
1235 347,215 24Jul23	1	Powder Floor - CERAMICS - FLOOR - Powder Floor - UG 1
1235 347,217 24Jul23	1	Kitchen/Break - CERAMICS - FLOOR - Kitchen/Break - UG 1
1235 347,216 24Jul23	1	Mud Room - CERAMICS - FLOOR - Mud Room - UG 1
1235 347,218 24Jul23	1	Laundry Room - CERAMICS - FLOOR - Laundry Room - UG 1
1235 347,221 24Jul23	1	M.Ens Bath Floor - CERAMICS - FLOOR - M.Ens Bath Floor - UG 1
1235 347,232 24Jul23	1	Master Shower Floor - CERAMICS - MOSAIC - Master Shower Floor - UG 2
1235 347,219 24Jul23	1	Bath 4 Bath Floor - CERAMICS - FLOOR - Bath 4 Bath Floor - UG 1
1235 347,220 24Jul23	1	Shared 2&3 Bath Floor - CERAMICS - FLOOR - Shared 2&3 Bath Floor - UG 1
1235 347,222 24Jul23	1	Basement Bath Floor - CERAMICS - FLOOR - Basement Bath Floor - UG 1
1235 347,234 24Jul23	1	Basement Shwr Floor - CERAMICS - MOSAIC - Basement Shwr Floor - UG 2
1235 347,233 24Jul23	1	Shared 2&3 Shwr Floor - CERAMICS - MOSAIC - Shared 2&3 Shwr Floor - UG 2
1235 347,244 24Jul23	1	Opt. Kit. Backsplash - CERAMICS - BACKSPLASH - Opt. Kit. Backsplash - UG 2



CONSTRUCTION SUMMARY

Lot: 3132
Model: 28-2444 B THE SOUTHPORT
Project/Phase: Wallaceton / 3

CERAMICS

Invoice	Qty.	Description
1235 314,179 24Jul23	1	- CERAMICS - ADDITIONAL BACKSPLASH DUE TO INSTALL CHIMENEY HOODFAN IN KITCHEN - KITCHEN - UPGRADE 2

DRYWALL

Invoice	Qty.	Description
1235 347,862 24Jul23	1	MAIN FLOOR - DRYWALL - SMOOTH CEILING IN MAIN FLOOR - UPG PAINTING-Paint Smooth Ceiling
1235 347,680 24Jul23 **	1	Built In - CABINETRY - OPT. BUILT IN - VIKING II/III - UPG SKETCH # 3 DRYWAL-Notify; FRAMING-Modify Bulkhead; GRANITE-delete partial countertop due to Built-in; PAINTING-
1235 346,366 24Jul23 **	1	GREAT ROOM - FIREPLACE AND MANTLE - BUILT OUT WALL ABOVE FIREPLACE SKETCH # 2 AND 6 DRYWALL-Notify;ELECTRICAL-Notify;FRAMING-Notify;HARDWOOD-Notify;HEATING-Notify;INTERIOR TRIMS-Notify;PAINTING-Notify
1235 314,238 24Jul23 **	1	- ELECTRICAL - POTLIGHT BUNDLE - 8 X T477GR-W 4 INCH LINE VOLTAGE POTLIGHTS INCLUDES 2 SWITCHESMAIN FLOOR (SEE SLIM LINE FOR BASEMENT) DRYWALL-Drywall/Ceiling cutouts for potlights; FRAMING-Frame to accommodate potlights ALL 8 POT LIGTHS IN GREAT ROOM AND BREAKFAST AREA EVENLY SPACED +/- ON ONE SWITCH USE THE SECOND SWITCH FOR THE 3 X CAPPED LIGHTS ABOVE THE BREAKFAST BAR SKETCH # 2



CONSTRUCTION SUMMARY

Lot: 3132
Model: 28-2444 B THE SOUTHPORT
Project/Phase: Wallaceton / 3

ELECTRICAL

Invoice	Qty.	Description
1478 24Jul23 ** NoCat	1	KITCHEN - 36" Samsung Range Hood, NK36K7000WS SEE SPECS CABINETRY-delete stove uppers; ELECTRICAL-delete std range hood; HEATING/AIR CONDITIONING-Duct change to 6 in
1235 314,340 24Jul23 **	1	KITCHEN - HEATING/AIR - ROUGH-IN GAS LINE FOR GAS STOVE AT MAIN FLOOR (SEE SPECS) (HOOK-UP NOT INCLUDED) LEAVE STANDARD 120 VOLT ELECTRICAL OUTLET ON A SEPARATE CIRCUIT. * SPECIFY IF STANDARD 220V WILL STAY OR BE RELOCATED STANDARD 240V 40 AMP TO BE RELOCATED TO BUILT-IN MICRO/OVEN LOCATION SKETCH # 3 ELECTRICAL-Notify
1235 345,787 24Jul23	1	GREAT ROOM - ELECTRICAL - CEILING ROUGH-IN (CAPPED) +/- TO BE CENTERED IN GREAT ROOM ON EXISTING SWITCH SEE SKETCH # 2
1235 314,232 24Jul23	1	GREAT ROOM - ELECTRICAL - EXTRA WALL INTERIOR OUTLET ON EXISTING CIRCUIT (DOES NOT INCLUDE KITCHEN OUTLETS) +/- 70" FROM FLOOR ABOVE FIREPLACE SKETCH # 2
1235 314,242 24Jul23	1	KITCHEN - ELECTRICAL - RELOCATION OF SWITCHES/LIGHTS (MUST SPECIFY LOCATION) - NOTE: PLUGS CANNOT BE RELOCATED- MUST PURCHASE ADDITIONAL OUTLET. TO RELOCATE STOVE PLUG FOR MICRO/ WALL OVEN COMBO SKETCH # 3
1235 314,277 24Jul23 **	1	KITCHEN - GRANITE - GRANITE CUTOUT W/ STRAIGHT EDGE POLISH TO ACCOMMODATE COOK TOP SKETCH # 3 SEE COOKTOP SPECS
1235 334,723 24Jul23 **	1	SHARED BATHROOM - PLUMBING - OPTION FROM ONE SINK TO DOUBLE SINKS INCLUDING STD CHATEAU FAUCET OVERMOUNT COLONY SINK ONE EXTRA VANITY LIGHT AND CABINET CONVERSION 2D VIKING SKETCH # 4 AND 5 CABINETRY-2D Convert Cabinetry Viking; ELECTRICAL-Additional Vanity Light
1235 345,787 24Jul23	3	KITCHEN - ELECTRICAL - CEILING ROUGH-IN (CAPPED) +/- TO BE CENTERED/ EVENLY SPACED ABOVE BREAKFAST COUNTER ON SEPERATE SWITCH SEE SKETCH # 2
1235 346,366 24Jul23 **	1	GREAT ROOM - FIREPLACE AND MANTLE - BUILT OUT WALL ABOVE FIREPLACE SKETCH # 2 AND 6 DRYWALL-Notify;ELECTRICAL-Notify;FRAMING-Notify;HARDWOOD-Notify;HEATING-Notify;INTERIOR TRIMS-Notify;PAINTING-Notify
1235 314,238 24Jul23	1	- ELECTRICAL - POTLIGHT BUNDLE - 8 X T477GR-W 4 INCH LINE VOLTAGE POTLIGHTS INCLUDES 2 SWITCHESMAIN FLOOR (SEE SLIM LINE FOR BASEMENT) DRYWALL-Drywall/Ceiling cutouts for potlights; FRAMING-Frame to accommodate potlights ALL 8 POT LIGTHS IN GREAT ROOM AND BREAKFAST AREA EVENLY SPACED +/- ON ONE SWITCH USE THE SECOND SWITCH FOR THE 3 X CAPPED LIGHTS ABOVE THE BREAKFAST BAR SKETCH # 2



CONSTRUCTION SUMMARY

Lot: 3132
Model: 28-2444 B THE SOUTHPORT
Project/Phase: Wallaceton / 3

FIREPLACE AND MANTLE

Invoice	Qty.	Description
1235 346,366 24Jul23	1	GREAT ROOM - FIREPLACE AND MANTLE - BUILT OUT WALL ABOVE FIREPLACE SKETCH # 2 AND 6 DRYWALL-Notify;ELECTRICAL-Notify;FRAMING-Notify;HARDWOOD-Notify;HEATING-Notify;INTERIOR TRIMS-Notify;PAINTING-Notify

FRAMING

Invoice	Qty.	Description
1235 347,680 24Jul23 **	1	Built In - CABINETRY - OPT. BUILT IN - VIKING II/III - UPG SKETCH # 3 DRYWALL-Notify; FRAMING-Modify Bulkhead; GRANITE-delete partial countertop due to Built-in; PAINTING-
1235 346,366 24Jul23 **	1	GREAT ROOM - FIREPLACE AND MANTLE - BUILT OUT WALL ABOVE FIREPLACE SKETCH # 2 AND 6 DRYWALL-Notify;ELECTRICAL-Notify;FRAMING-Notify;HARDWOOD-Notify;HEATING-Notify;INTERIOR TRIMS-Notify;PAINTING-Notify
1235 314,238 24Jul23 **	1	- ELECTRICAL - POTLIGHT BUNDLE - 8 X T477GR-W 4 INCH LINE VOLTAGE POTLIGHTS INCLUDES 2 SWITCHESMAIN FLOOR (SEE SLIM LINE FOR BASEMENT) DRYWALL-Drywall/Ceiling cutouts for potlights; FRAMING-Frame to accommodate potlights ALL 8 POT LIGTHS IN GREAT ROOM AND BREAKFAST AREA EVENLY SPACED +/- ON ONE SWITCH USE THE SECOND SWITCH FOR THE 3 X CAPPED LIGHTS ABOVE THE BREAKFAST BAR SKETCH # 2

GLASS PRODUCTS / MIRRORS

Invoice	Qty.	Description
1235 347,868 24Jul23	1	Ensuite Master - GLASS PRODUCTS / MIRRORS - UPGRADE TO FRAMELESS CLEAR GLASS WITH D-RING HANDLE IN CHROME - ENSUITE MASTER - UPG
1235 347,869 24Jul23	1	SHARED BATHROOM - GLASS PRODUCTS / MIRRORS - UPGRADE TO FRAMELESS CLEAR GLASS WITH D-RING HANDLE IN CHROME - MAIN BATHROOM - UPG SHARED BATH



CONSTRUCTION SUMMARY

Lot: 3132
Model: 28-2444 B THE SOUTHPORT
Project/Phase: Wallaceton / 3

GRANITE

Invoice	Qty.	Description
1235 347,913 24Jul23	1	Kitchen / Island / Serv. - GRANITE - KITCHEN / ISLAND / SERV. - GROUP 2 - UPG
1235 347,680 24Jul23 **	1	Built In - CABINETRY - OPT. BUILT IN - VIKING II/III - UPG SKETCH # 3 DRYWAL-Notify; FRAMING-Modify Bulkhead; GRANITE-delete partial countertop due to Built-in; PAINTING-
1235 314,277 24Jul23	1	KITCHEN - GRANITE - GRANITE CUTOUT W/ STRAIGHT EDGE POLISH TO ACCOMMODATE COOK TOP SKETCH # 3 SEE COOKTOP SPECS
1235 314,409 24Jul23 **	1	KITCHEN - PLUMBING - KITCHEN SINK UPGRADE - BLANCO KITCHEN SINK QUATRUS U 1 3/4 #401244 (33 INCH X 18 INCH) UNDERMOUNT LARGE/MEDIUM BOWL 9 INCH DEEP IN STAINLESS STEEL - SEE SPEC CABINETRY-upgraded kitchen sink; GRANITE-upgraded kitchen sink

HEATING / AIR CONDITIONING

Invoice	Qty.	Description
1478 24Jul23 ** NoCat	1	KITCHEN - 36" Samsung Range Hood, NK36K7000WS SEE SPECS CABINETRY-delete stove uppers; ELECTRICAL-delete std range hood; HEATING/AIR CONDITIONING-Duct change to 6 in
1235 314,340 24Jul23	1	KITCHEN - HEATING/AIR - ROUGH-IN GAS LINE FOR GAS STOVE AT MAIN FLOOR (SEE SPECS) (HOOK-UP NOT INCLUDED) LEAVE STANDARD 120 VOLT ELECTRICAL OUTLET ON A SEPARATE CIRCUIT. * SPECIFY IF STANDARD 220V WILL STAY OR BE RELOCATED STANDARD 240V 40 AMP TO BE RELOCATED TO BUILT-IN MICRO/OVEN LOCATION SKETCH # 3 ELECTRICAL-Notify
1235 346,366 24Jul23 **	1	GREAT ROOM - FIREPLACE AND MANTLE - BUILT OUT WALL ABOVE FIREPLACE SKETCH # 2 AND 6 DRYWALL-Notify;ELECTRICAL-Notify;FRAMING-Notify;HARDWOOD-Notify;HEATING-Notify;INTERIOR TRIMS-Notify;PAINTING-Notify

INTERIOR RAILINGS

Invoice	Qty.	Description
1235 348,068 24Jul23	1	- Interior Railings - BLACK METAL - SINGLE COLLAR ALT. PLAIN W/ SHOES WITH 3 1/2 INCH SQUARE/CAP POST(S) AS PER PLAN - MAIN AND 2ND FLOOR - UPG PAINTING-Notify

INTERIOR TRIM AND DOORS

Invoice	Qty.	Description
1235 346,366 24Jul23 **	1	GREAT ROOM - FIREPLACE AND MANTLE - BUILT OUT WALL ABOVE FIREPLACE SKETCH # 2 AND 6 DRYWALL-Notify;ELECTRICAL-Notify;FRAMING-Notify;HARDWOOD-Notify;HEATING-Notify;INTERIOR TRIMS-Notify;PAINTING-Notify



CONSTRUCTION SUMMARY

Lot: 3132
Model: 28-2444 B THE SOUTHPORT
Project/Phase: Wallaceton / 3

PAINTING

Invoice	Qty.	Description
1235 347,862 24Jul23 **	1	MAIN FLOOR - DRYWALL - SMOOTH CEILING IN MAIN FLOOR - UPG PAINTING-Paint Smooth Ceiling
1235 347,680 24Jul23 **	1	Built In - CABINETRY - OPT. BUILT IN - VIKING II/III - UPG SKETCH # 3 DRYWAL-Notify; FRAMING-Modify Bulkhead; GRANITE-delete partial countertop due to Built-in; PAINTING-
1235 348,068 24Jul23 **	1	- Interior Railings - BLACK METAL - SINGLE COLLAR ALT. PLAIN W/ SHOES WITH 3 1/2 INCH SQUARE/CAP POST(S) AS PER PLAN - MAIN AND 2ND FLOOR - UPG PAINTING-Notify
1235 346,366 24Jul23 **	1	GREAT ROOM - FIREPLACE AND MANTLE - BUILT OUT WALL ABOVE FIREPLACE SKETCH # 2 AND 6 DRYWALL-Notify;ELECTRICAL-Notify;FRAMING-Notify;HARDWOOD-Notify;HEATING-Notify;INTERIOR TRIMS-Notify;PAINTING-Notify

PLUMBING

Invoice	Qty.	Description
1235 334,723 24Jul23	1	SHARED BATHROOM - PLUMBING - OPTION FROM ONE SINK TO DOUBLE SINKS INCLUDING STD CHATEAU FAUCET OVERMOUNT COLONY SINK ONE EXTRA VANITY LIGHT AND CABINET CONVERSION 2D VIKING SKETCH # 4 AND 5 CABINETRY-2D Convert Cabinetry Viking; ELECTRICAL-Additional Vanity Light
1235 314,409 24Jul23	1	KITCHEN - PLUMBING - KITCHEN SINK UPGRADE - BLANCO KITCHEN SINK QUATRUS U 1 3/4 #401244 (33 INCH X 18 INCH) UNDERMOUNT LARGE/MEDIUM BOWL 9 INCH DEEP IN STAINLESS STEEL - SEE SPEC CABINETRY-upgraded kitchen sink; GRANITE-upgraded kitchen sink

THE SOUTHPORT

ELEVATION A & B | 2,444 SQ. FT.

617 sq. ft. of opt. finished Lower Level

28-2444 ELEV. B

Sketch #1

WALLACETON
EST. 1870

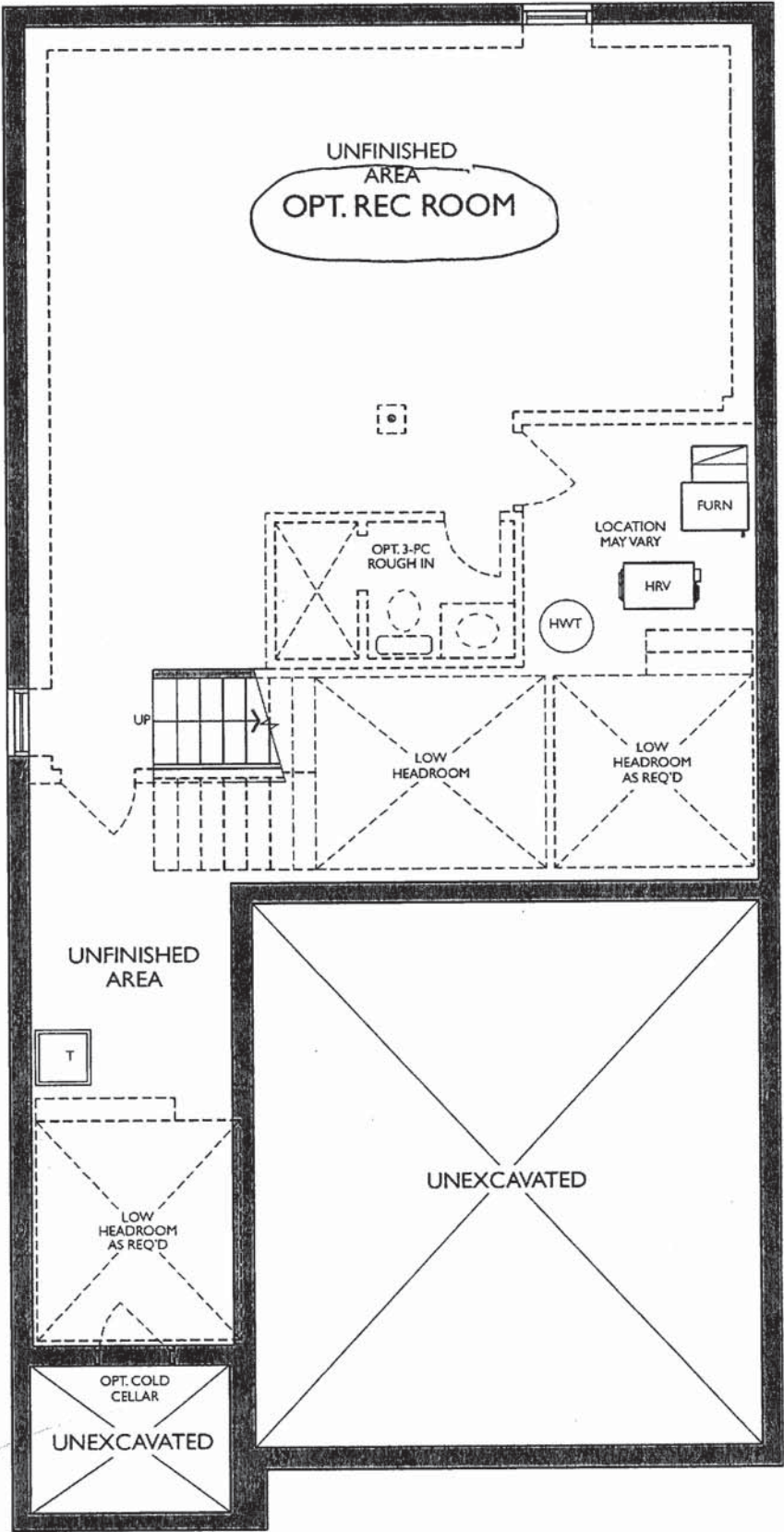

LOWER LEVEL
ELEVATION B & C

Handwritten initials: VT and JB

THE SOUTHPORT

ELEVATION A & B | 2,444 SQ. FT.

617 sq. ft. of opt. finished Lower Level

28-2444 ELEV. B

WALLACETON

EST. 1870

Sketch #2

CEILING ROUGH-IN (CAPPED) +/- TO BE CENTERED IN GREAT ROOM ON EXISTING SWITCH

POTLIGHT BUNDLE ON ONE SWITCH (USE THE SECOND SWITCH FOR THE 3 X CAPPED LIGHTS ABOVE THE BREAKFAST BAR)

OUTLET +/- 70" FROM FLOOR ABOVE FIREPLACE

BUILT OUT WALL ABOVE FIREPLACE

CEILING ROUGH-IN (CAPPED) +/- TO BE CENTERED/ EVENLY SPACED ABOVE BREAKFAST COUNTER ON SEPERATE SWITCH

GAS R/I (36" GAS COOKTOP)

BUILT IN KITCHEN (RELOCATE STOVE PLUG FOR MICRO/ WALL OVEN COMBO)

MAIN STAIRS CARPET RUNNER TO 2ND FLOOR AND TO POWDER ROOM LANDING

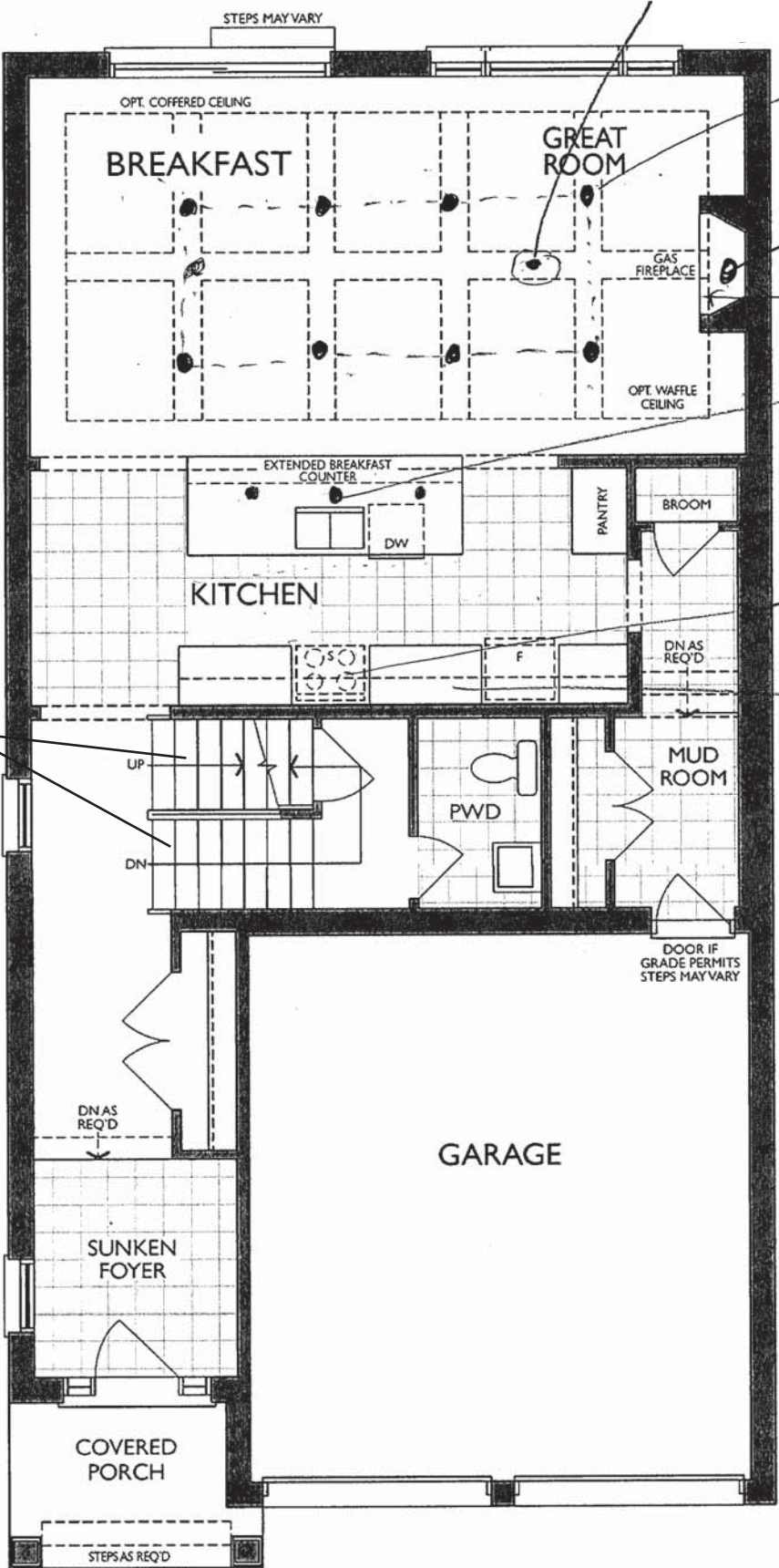

MAIN FLOOR
ELEVATION B & C

POTS AND PANS

KITCHEN
(GROUND FLOOR)

36" CHIMNEY

36" GAS COOKTOP

RELOCATE STOVE
PLUG FOR MICRO/
WALL OVEN COMBO

45CM RECYCLE (2 BINS)

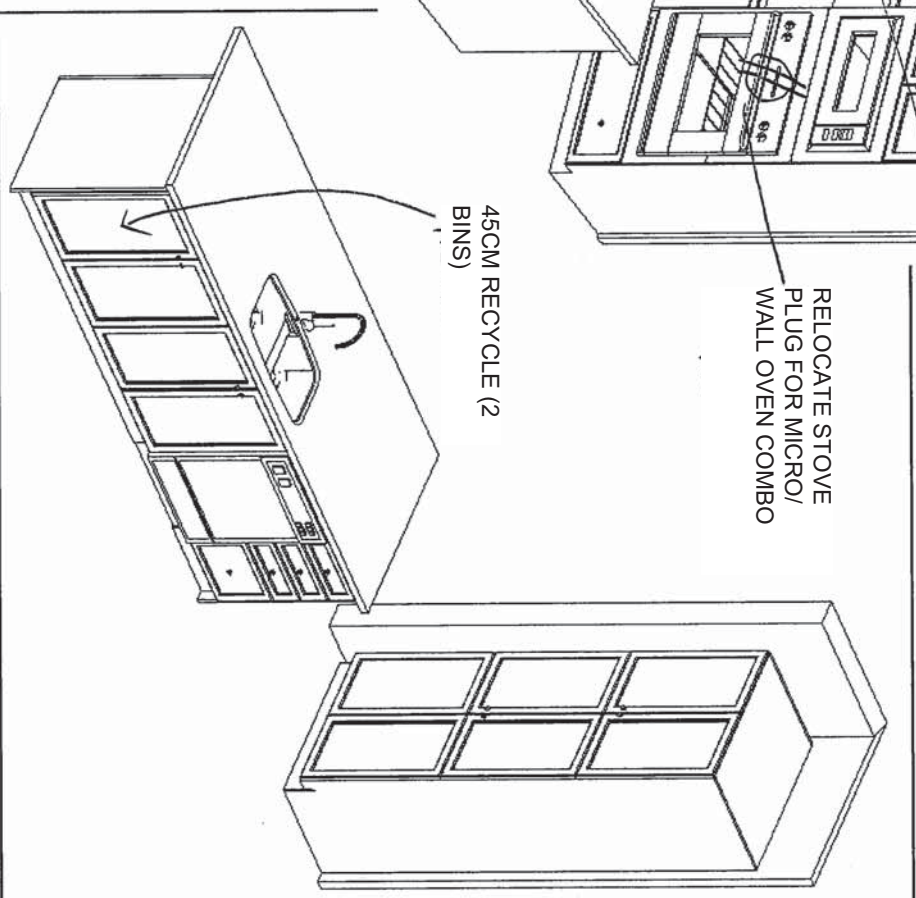

FRENDL
KITCHENS LIMITED

1350 Showson Drive, Mississauga, ON L4W 1C5

Appliance Openings

- ### Standard Kitchens Scope:

- Powder by others, pedestal
- Master Ens. – Top by others
- Remaining vanities inc. laminate top
- Std. Blum Hinges- **not soft close**
- Std. Metabox Drawers- **not soft close**
- Master Ens: Top drawers(Sink Full height)
- Mains: Full height doors (top drawers added if Masters can't accommodate)
- Optional laundry base & wall cabinets

THIS DRAWING IS FOR DESIGN PURPOSES ONLY.
IT IS NOT AN EXACT RENDITION.

THE SOUTHPORT

ELEVATION A & B | 2,444 SQ. FT.

Sketch # 4

617 sq. ft. of opt. finished Lower Level

28-2444 ELEV. B

WALLACETON
EST. 1870

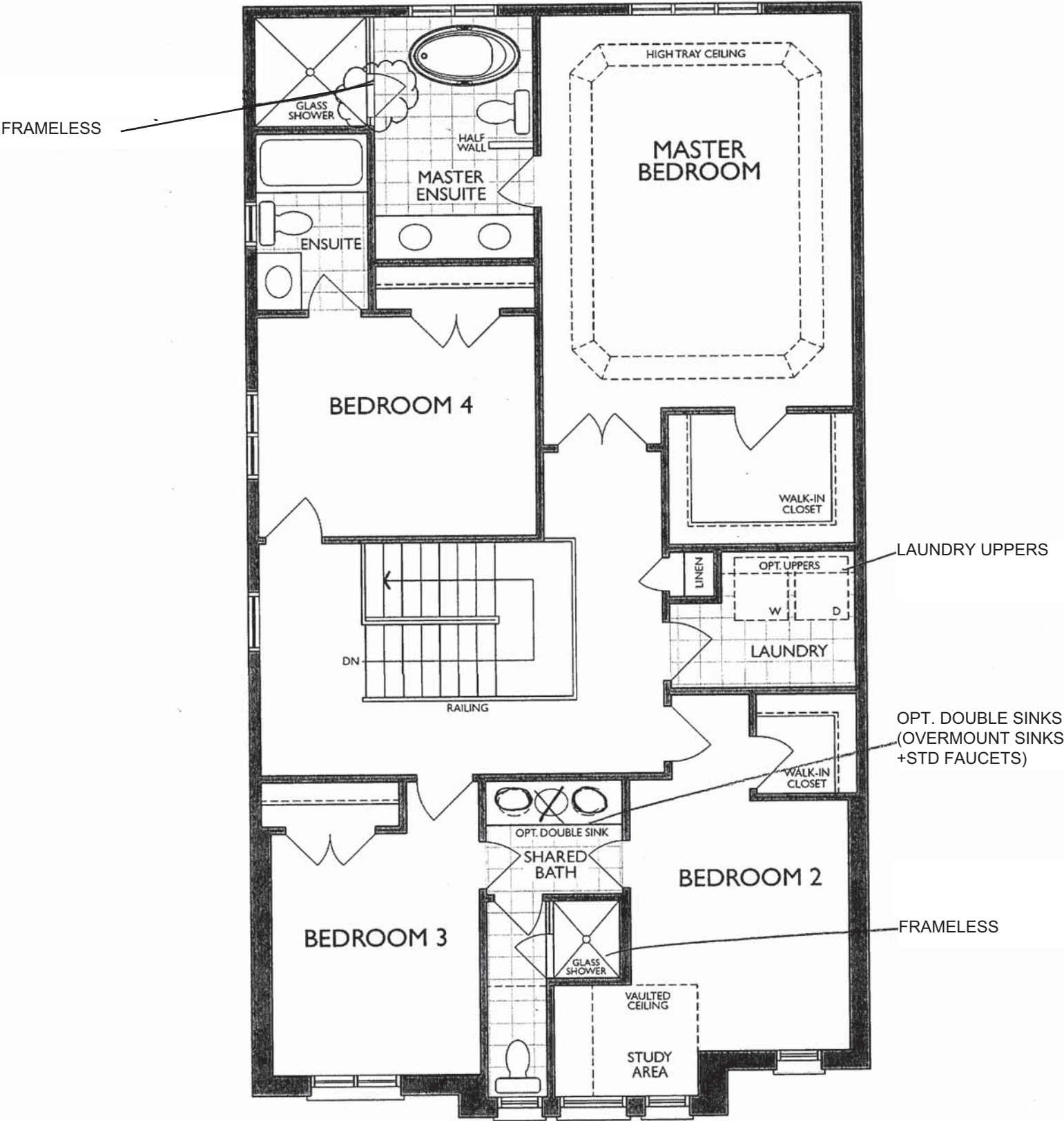

SECOND FLOOR
ELEVATION B

* Master Ensuite Shower Door Swing Changed

51

Handwritten signature

Legal Plan Feb. 17, 2021

Sketch #5

MASTER ENSUITE
(2ND FLR)

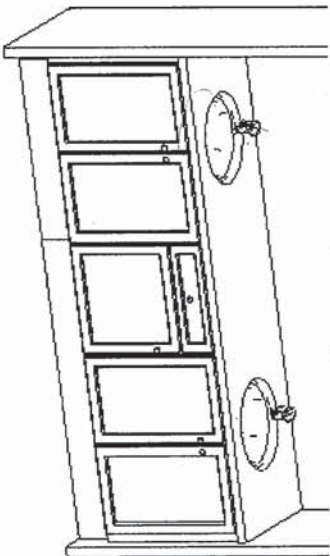

(TOP DRAWER X1)

MAIN BATH
(2ND FLR)

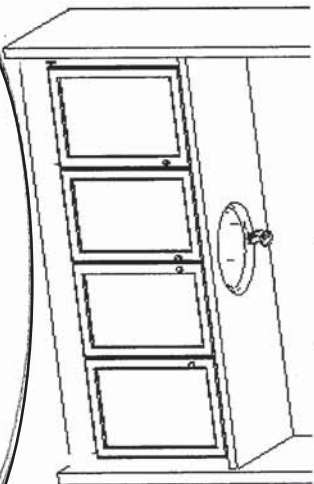

(OPT. DBL SINK V70+V40+V70)
OPT. DOUBLE SINKS (OVERMOUNT
SINKS+STD FAUCETS)

ENSUITE 2
(2ND FLR)

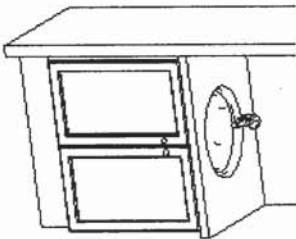

OPT. BASEMENT BATH

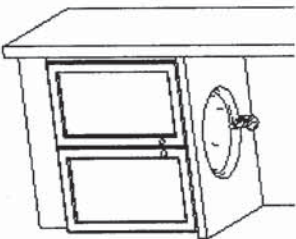

OPT. LAUNDRY UPPERS
(2ND FLR)

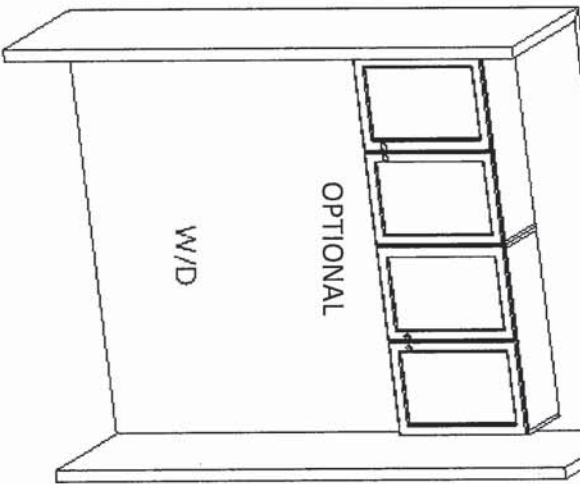

OPTIONAL

W/D

4/29/2022



FRIENDEL
KITCHENS LIMITED
1350 Shawson Drive, Mississauga, ON L4W 1G5

HEATHWOOD HOMES
WALLACETON, KITCHENER ON
MODEL: 28-2444 (3402)

STANDARD CONTRACT INCLUDES:

Appliance Openings

- Hood Opening: 30"W Builder hood
- Fridge Opening: 37 3/8 "W X 73 3/8"
- Fridge cabinet & gables: 66cm Deep
- Stove Opening: 30" Freestanding
- Dishwasher Opening: 24"

Standard Kitchens Scope:

- 100cm H wall cabinets
- Std. Blumotion Hinges- **soft close**
- Std. Metabox Drawers- **not soft close**
- Min 40cm W drawer
- Base pie cut corner cabinets
- Backing on all cabinets
- Countertop by others
- Upgrade applied paneled fridge & dishwashers supply only (appliance hardware by others)

Standard Vanity & Laundry Scope:

- Powder by others, pedestal
- Master Ens. – Top by others
- Remaining vanities inc. laminate top
- Std. Blum Hinges- **not soft close**
- Std. Metabox Drawers- **not soft close**
- Master Ens: Top drawers(Sink Full height)
- Mains: Full height doors (top drawers added if Masters can't accommodate)
- Optional laundry base & wall cabinets

THIS DRAWING IS FOR DESIGN PURPOSES ONLY.
IT IS NOT AN EXACT RENDITION.

NOTE: TOP DRAWER (AND OR SOFT CLOSE OF THE DRAWER) IS **EXTRA CHARGE** AND CAN ONLY BE ADDED IF THE ENTIRE KITCHEN HAS TOP DRAWER THROUGHOUT

18" Wide cabinet : B17-45cm wide pull-out door base cabinet waste/recycle centre with soft-close ([2] 35L bins per unit) (available only with 45cm wide cabinet) ✓

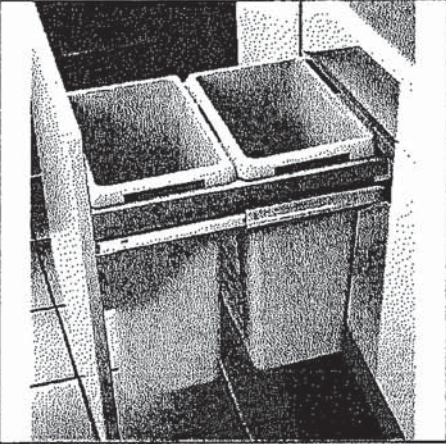

Euro-Cargo Recycling Center

Make your life easier with the Euro-Cargo sliding waste bin. Full-extension slides give you complete access to your bins. The integrated lid remains fixed inside your cabinet, and once the system is closed, the lid covers the bins to prevent odors from escaping.

Product # 3614100 [View list](#)

Total Capacity 76 l

76 l

93 l

Interior Dimensions Required - Width 412 to 418 mm

412 to 418 mm

462 to 468 mm

562 to 568 mm

Bin Quantity 2

2

4

Bin Capacity 2 x 38 liters

2 x 38 L + 2 x 8.5 L

2 x 38 liters

24" wide cabinet : B18-60cm wide pull-out door base cabinet waste/recycle centre with soft-close ([4] bins total, including [2] 35L) (available only with 60cm or 24" wide cabinet)

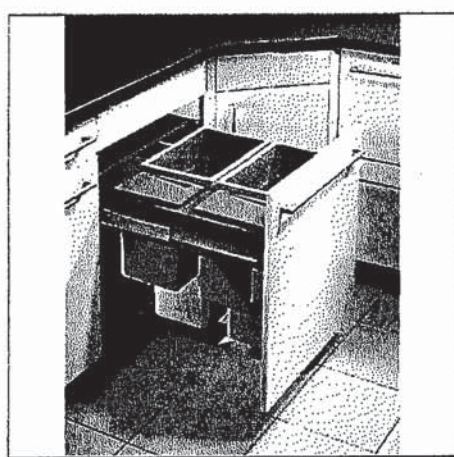

Euro-Cargo Recycling Center

Make your life easier with the Euro-Cargo sliding waste bin. Full-extension slides give you complete access to your bins. The integrated lid remains fixed inside your cabinet, and once the system is closed, the lid covers the bins to prevent odors from escaping.

Product # 361460100 [View list](#)

Total Capacity 93 l

76 l

93 l

Interior Dimensions Required - Width 562 to 568 mm

412 to 418 mm

462 to 468 mm

562 to 568 mm

Bin Quantity 4

2

4

Bin Capacity 2 x 38 L + 2 x 8.5 L

2 x 38 L + 2 x 8.5 L

2 x 38 liters

UP

JB

Project: Wallaceton
Unit: 3132, Phase: 3
Model: 28-2444 B THE SOUTHPORT

Sheet # 6

64" +/-

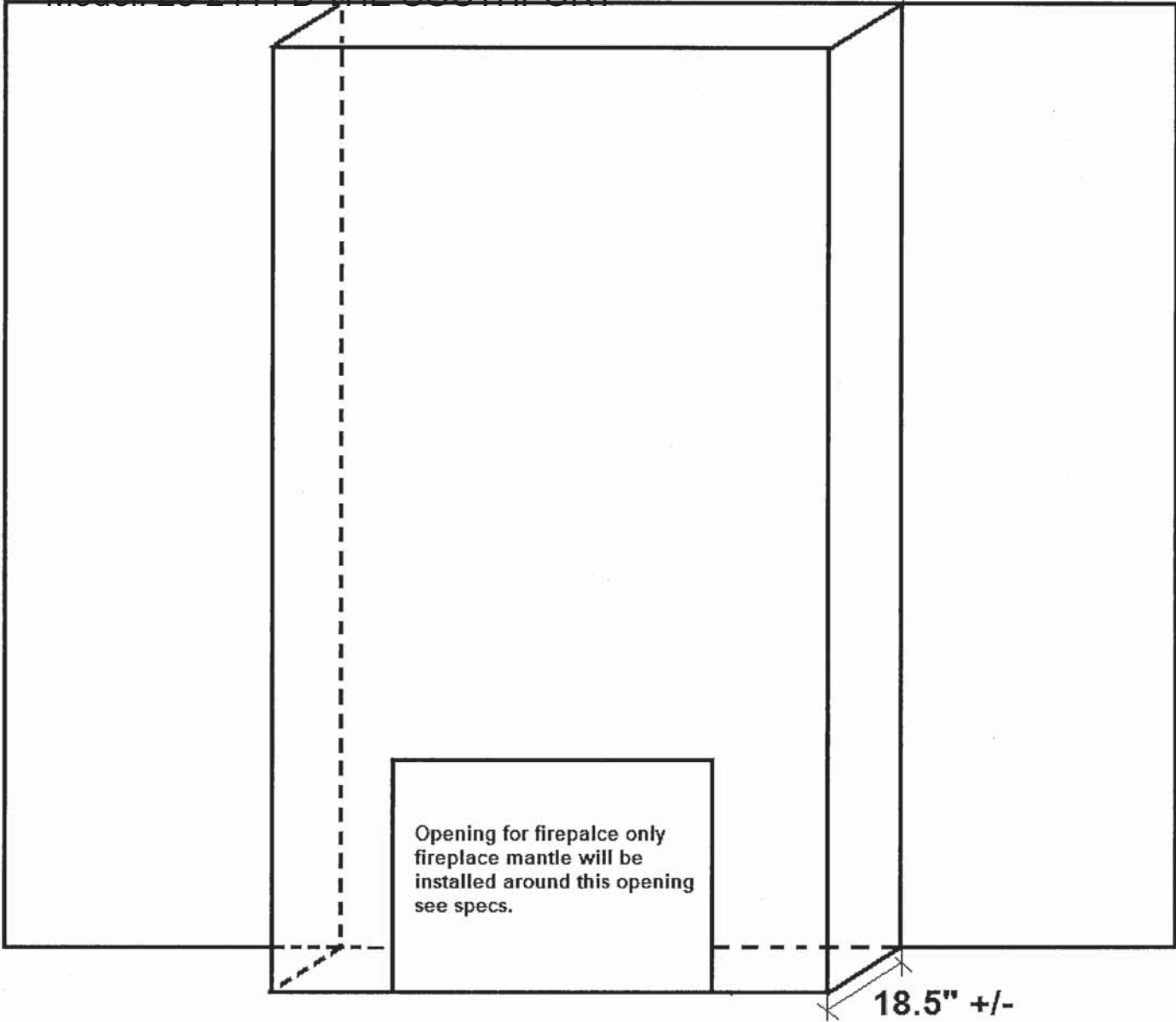

GREAT ROOM FIREPLACE

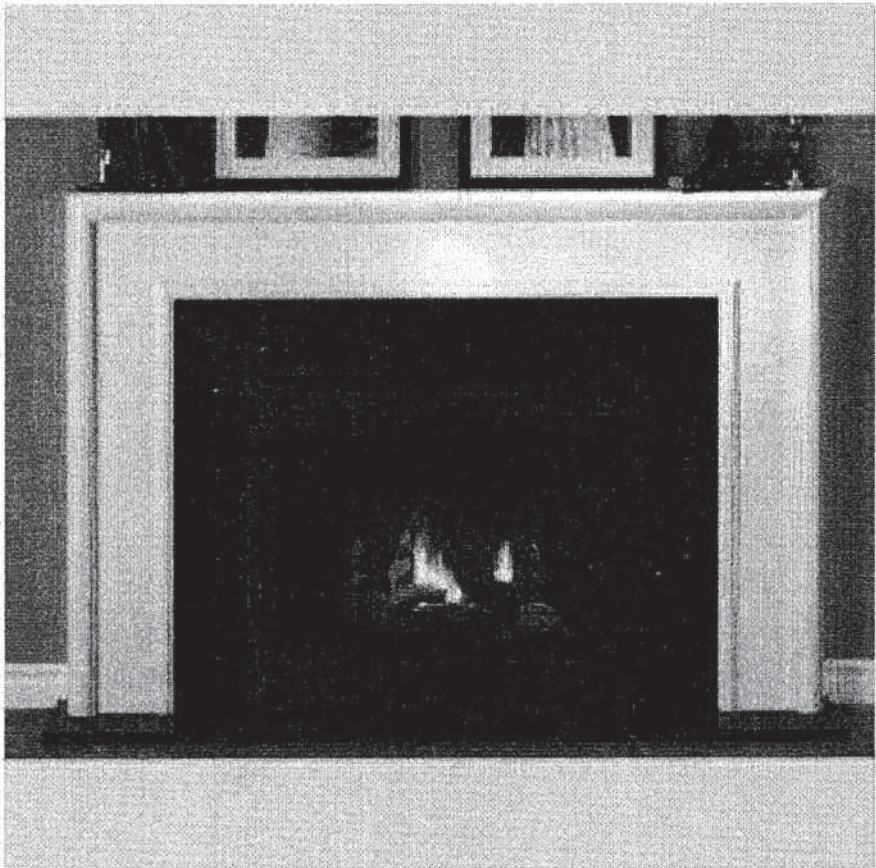

NEAS NF17 Mantel

UT

JB



Sink Specifications

QUATRUS U 1¾

Colour	SKU
brushed finish	401244

Design and planning tips

- Min cabinet size: 36 in (915 mm)
- Bowl Depth: 9 in (230.0 mm)

Specifications:
Installation clips, Sink template, Installation instructions, 3 ½" (90 mm) stainless steel strainers

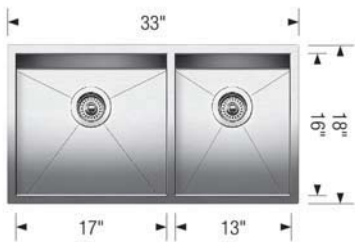

Depending on cabinet construction, a different cabinet size may be required. Consult the cabinet manufacturer.
Codes/Standards: ASME A112.19.3-2017/ CSA B45.4-17

Optional Accessories

Ash Cutting Board	406345
CapFlow Strainer Cover	517666
Sink Grid	402123
Sink Grid	402124

Warranty
Limited lifetime warranty on all sinks and faucets. One-year warranty on all accessories and soap dispensers.

Code/Standards Compliance
BLANCO sinks and faucets are third-party tested and certified to CSA, cUPC, ANSI/ASME, IAPMO and NSF standards and listed by applicable certification bodies. For more information on individual product listings, contact our office or listing organization.

 Need support? Learn more by watching our sink & faucet How-to videos:
<https://www.blanco.com/ca-en/support/how-to-videos/how-to-videos-for-sinks/>

	BLANCO Canada Inc 100 Corporation Drive Brampton ON L6S 6B5	Tel & Fax Tel: 905-494-2400 Toll free: 1-877-425-2626 Fax: 905-494-2425 Toll free: 1-877-825-2626
---	---	---

While BLANCO strives to provide accurate information, all images and dimensions in this document are intended for reference only and are subject to change at any time without notice. This document is not intended for use as an installation guide. For technical installation details, refer to installation instructions provided with the product. BLANCO assumes no responsibility for the use of superseded or voided specifications.

MOEN®

Specifications

FAUCET DESCRIPTION

- Reflex™ pulldown system offers smooth operation, easy movement and secure docking
- Power Clean™ spray technology
- Metal construction with various finishes identified by suffix
- Quick connect installation
- Pulldown spray with 68" braided hose
- Flexible supply lines with 3/8" compression fittings
- High arc spout provides height and reach to fill or clean large pots while pulldown wand provides the maneuverability for cleaning or rinsing
- 360° rotating spout
- Faucet designed for handle to be mounted on right side only

OPERATION

- Lever style handle
- Temperature controlled by 100° arc of handle travel
- Operates with less than 5 lbs. of force
- Operates in stream or spray mode in the pullout or retracted position

FLOW

- Flow is limited to 1.5 gpm (5.7 L/min) max at 60 psi

CARTRIDGE

- 1255™ Duralast™ cartridge

STANDARDS

- Third party certified to IAPMO Green, ASME A112.18.1/CSA B125.1 and all applicable requirements therein including NSF 61/9G & 372
- Meets CalGreen and Georgia SB370 requirements
- Complies with California Proposition 65 and with the Federal Safe Drinking Water Act
- The backflow protection system in the device consists of two independently operating check valves, a primary and a secondary which prevent backflow

- **ADA**  for lever handle

WARRANTY

- Lifetime limited warranty against leaks, drips and finish defects to the original homeowner
 - 10 year limited warranty when used in a multifamily installation
 - 5 year limited warranty when used in a commercial installation
- Visit www.moen.com/support for complete details and limitations

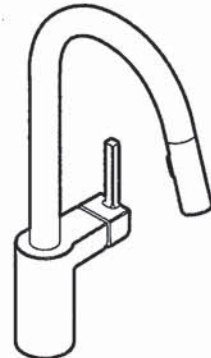

ALIGN™
Single Handle High Arc
Pulldown Kitchen Faucet

Models: 7565 series

NOTE: THIS FAUCET IS DESIGNED TO BE INSTALLED
THROUGH 1 HOLE, 1-1/2" (38mm) MIN. DIA.
(OPTIONAL 3-HOLE ESCUTCHEON 141002 AVAILABLE)

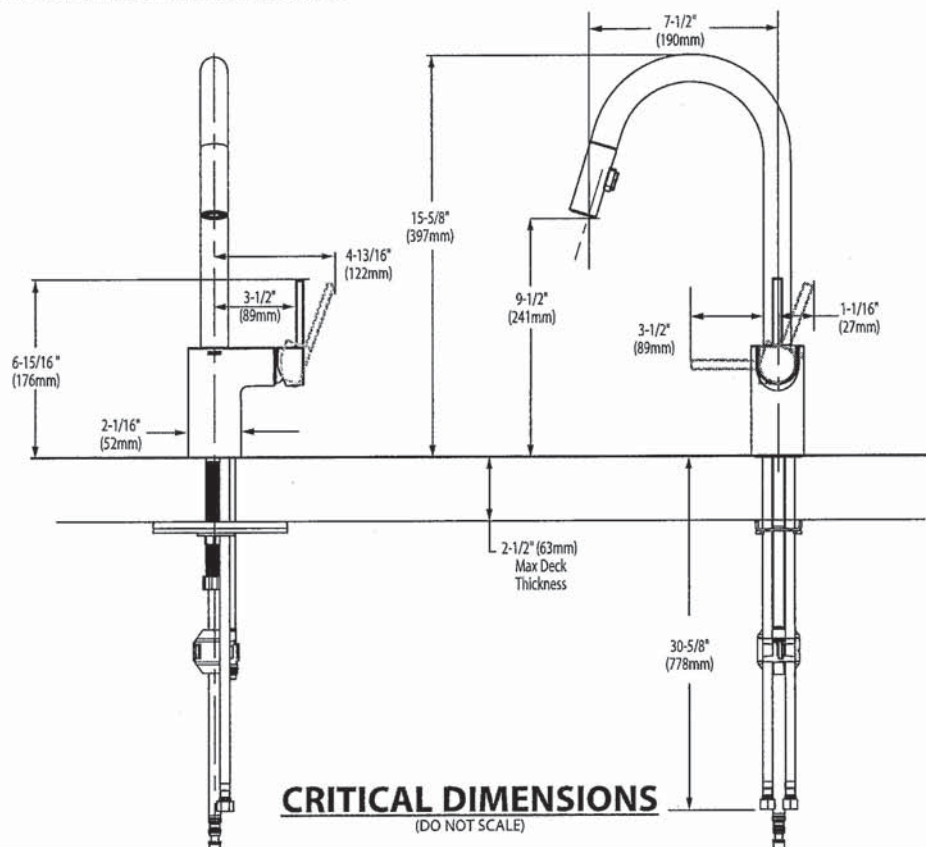

57

JB



BARRIER FREE (ABOVE COUNTER OR DROP-IN ONLY)

**BOULEVARD®
PEDESTAL SINK**
VITREOUS CHINA

BOULEVARD® PEDESTAL SINK

- STD ☒ **0641.800** Faucet holes on 8" (203mm) centers (Illustrated)
- ☒ **0641.400** Faucet holes on 4" (102mm) centers
- ☐ **0641.100** Center hole only
- Classic styled rectangular pedestal lavatory
 - Vitreous china
 - Rear overflow
 - Supplied with mounting kit
 - Right Height® for greater comfort during use
 - Faucet ledge with large deck area (faucet not included)
 - **Design coordinates with Boulevard® Toilet**
 - Basin has flat bottom to also allow use as an **above counter** sink or a **drop-in** sink (with u-shaped cut out)

Nominal Dimensions:

24" x 19" x 35-1/2"
(610 x 483 x 902mm)

- ☐ **0641.008** Pedestal top-8" (203mm) centers
- ☐ **0641.004** Pedestal top-4" (102mm) centers
- ☐ **0641.001** Pedestal top-center hole only
- ☐ **0010.000** Pedestal only

Bowl sizes:

17" (432mm) wide,
12-1/2" (318mm) front to back,
5" (127mm) deep

Compliance Certifications -

Meets or Exceeds the Following Specifications:

- ASME A112.19.2 - 2008/CSA B45.1-08

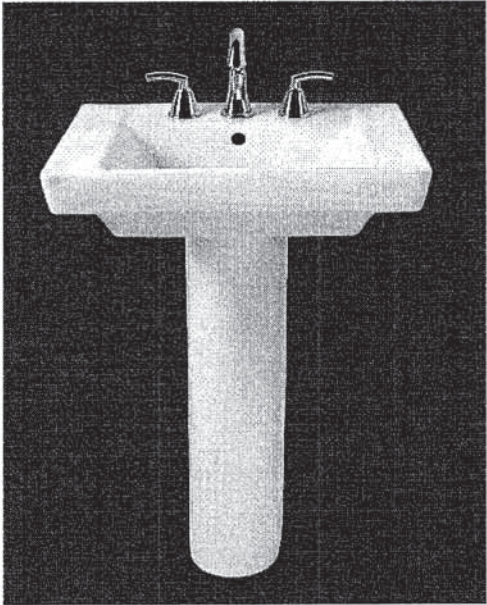

SEE REVERSE FOR ROUGHING-IN DIMENSIONS

To Be Specified:

☐ Color: ☐ White ☐ Linen

☐ Faucet Finish:

☐ Supplies:

☐ 1-1/4" Trap:

☐ Nipple:

* See faucet section for additional models available

VT

American Standard

Style That Works Better



OVALYN™
UNDERCOUNTER SINK
VITREOUS CHINA

OVALYN™ UNDERCOUNTER SINK

- Classic oval undermount sink
- Made from vitreous china
- Front overflow
- Supplied with mounting kit (047194-0070A) and template

☐ **0495.221 Unglazed rim**

435 x 359mm
(17-1/8" x 14-1/8")

☐ **0495.300 Glazed underside**

Bowl size:

382mm (15-1/16") wide
306mm (12-1/16") front to back
140mm (5-1/2") deep

☐ **0496.221 Unglazed rim**

489 x 413mm
(19-1/4" x 16-1/4")

☐ **0496.300 Glazed underside**

Bowl size:

432mm (17") wide
356mm (14") front to back
140mm (5-1/2") deep

☐ **0497.221 Unglazed rim**

546 x 441mm
(21-1/2" x 17-3/8")

☐ **0497.300 Glazed underside**

Bowl size:

483mm (19") wide
391mm (15-3/8") front to back
140mm (5-1/2") deep

Compliance Certifications -

Meets or Exceeds the Following Specifications:

- ASME A112.19.2M for Vitreous China Fixtures
- CAN/CSA B45 series

To Be Specified:

- ☐ Color: ☐ White ☐ Bone ☐ Linen
☐ Silver ☐ Fawn Beige ☐ Black
- ☐ Faucet*:
☐ Faucet Finish:
☐ Supplies:
☐ 1-1/4" Trap:

* See faucet section for additional models available

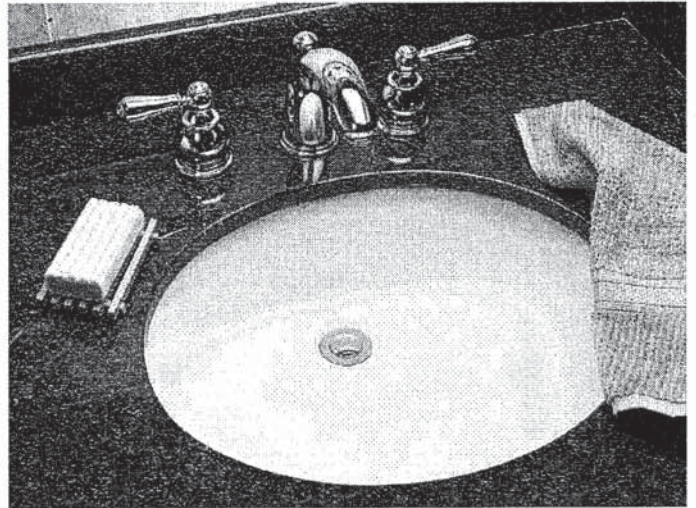

STD Master Ensuite Undermount SINGLES

x 2

SEE REVERSE FOR ROUGHING-IN DIMENSIONS

57

American Standard
Style That Works Better

OVALYN™
UNDERCOUNTER SINK
VITREOUS CHINA

BARRIER FREE

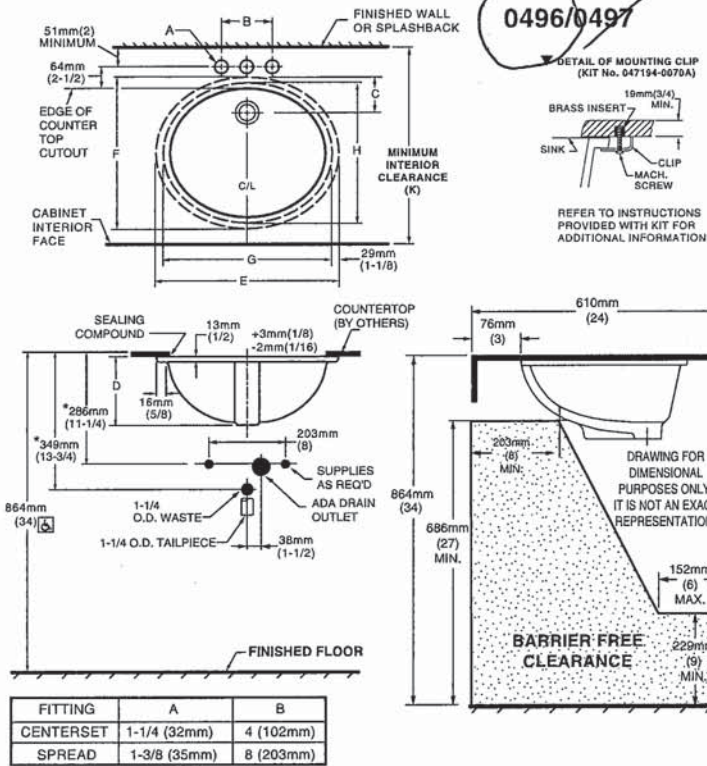

NOTES:
* DIMENSIONS SHOWN FOR LOCATION OF SUPPLIED AND "P" TRAP ARE SUGGESTED.
▼ UNDERCOUNTER MOUNTING KIT SUPPLIED WITH SINK.
PLEASE NOTE MINIMUM INTERIOR CLEARANCE DIMENSION (K). FITTINGS NOT INCLUDED AND MUST BE ORDERED SEPARATELY. USE ENCLOSED TEMPLATE FOR COUNTERTOP CUTOUT SEALING COMPOUND SUPPLIED BY OTHERS.

IMPORTANT: Dimensions of fixtures are nominal and may vary within the range of tolerances established by ANSI Standard A112.19.2. These measurements are subject to change or cancellation. No responsibility is assumed for use of superseded or voided pages.

MEETS THE AMERICANS WITH DISABILITIES ACT GUIDELINES AND ANSI A117.1 ACCESSIBLE AND USEABLE BUILDINGS AND FACILITIES - CHECK LOCAL CODES.
Countertop 864mm (34") from finished floor. Lavatory installed 76mm (3") from front edge of countertop. Countertop thickness to be 25mm (1") maximum.

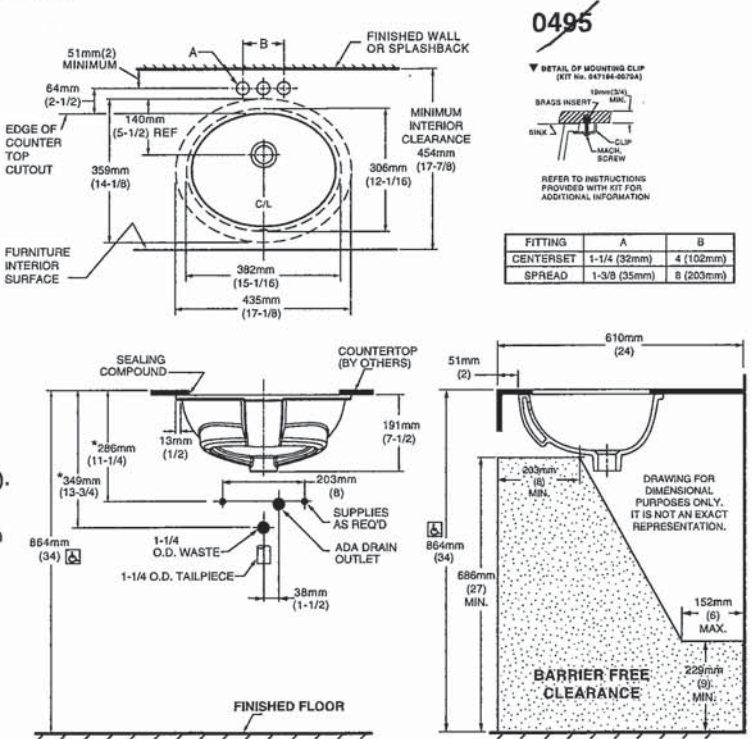

NOTES:
USE ENCLOSED TEMPLATE FOR COUNTER TOP CUTOUT. FITTINGS NOT INCLUDED WITH FIXTURE AND MUST BE ORDERED SEPARATELY.
* DIMENSIONS SHOWN FOR LOCATION OF SUPPLIED AND "P" TRAP ARE SUGGESTED.
▼ UNDERCOUNTER MOUNTING KIT SUPPLIED WITH SINK.
PLEASE NOTE MINIMUM INTERIOR CLEARANCE DIMENSION (K). SEALING COMPOUND SUPPLIED BY OTHERS.

IMPORTANT: Dimensions of fixtures are nominal and may vary within the range of tolerances established by ANSI Standard A112.19.2. These measurements are subject to change or cancellation. No responsibility is assumed for use of superseded or voided pages

MEETS THE AMERICANS WITH DISABILITIES ACT GUIDELINES AND ANSI A117.1 ACCESSIBLE AND USEABLE BUILDINGS AND FACILITIES - CHECK LOCAL CODES.
Countertop 864mm (34") from finished floor. Lavatory installed 51mm (2") from front edge of countertop. Countertop thickness to be 25mm (1") maximum.



COLONY™
COUNTERTOP SINK
VITREOUS CHINA

COLONY COUNTERTOP SINK

- Vitreous china
- Self-rimming
- Front overflow
- Supplied with template
- Faucet deck
(Faucet shown not included)

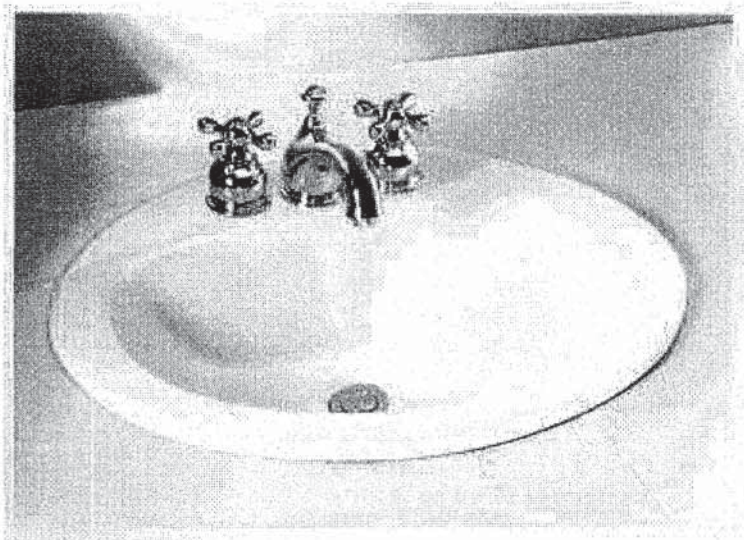

- ☐ 0346 803
Faucet holes on 203mm (8") centres
- ☒ 0346 403 (Illustrated)
Faucet holes on 102mm (4") centres
- ☐ 0346 001
Centre hole only

Nominal Dimensions:
521 x 448mm (20-1/2" x 17-5/8")

Bowl sizes:
422mm (16-5/8") wide, 279mm (11") front to back, 143mm (5-5/8") deep

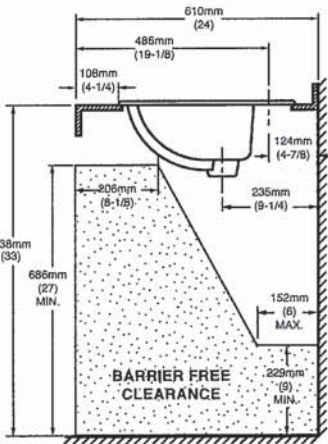
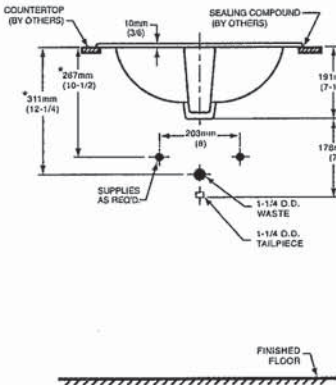
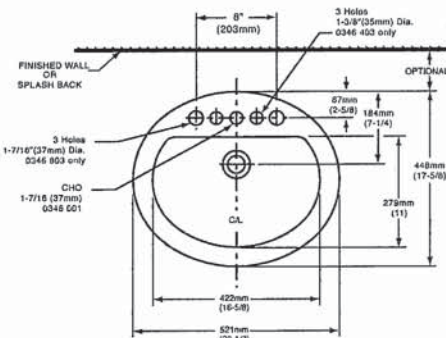

COMPLIANCE CERTIFICATIONS –
Meets or exceeds the following Specifications:
• ASME A112.19.2M for Vitreous China Fixtures.
• CAN/CSA B45 Series.

- To Be Specified
- ☐ Colour: ☐ White ☐ Bone ☐ Silver Gray ☐ Linen
 - ☐ Faucet*:
 - ☐ Faucet Finish:
 - ☐ Supplies & Stops:
 - ☐ Trap 1-1/4" (32 mm):

NOTES:
* DIMENSIONS SHOWN FOR LOCATION OF SUPPLIES AND "P" TRAP ARE SUGGESTED. FOR COUNTERTOP CUTOUT AND INSTALLATION INSTRUCTIONS USE TEMPLATE SUPPLIED WITH SINK.
FAUCETS NOT INCLUDED AND MUST BE ORDERED SEPARATELY.
IMPORTANT: Dimensions of fixtures are nominal and may vary within the range of tolerances established by ANSI Standard A112.19.2.
These measurements are subject to change or cancellation. No responsibility is assumed for use of superseded or voided pages.

* See faucet section for additional models available



DEMI™
Product Specification Sheet

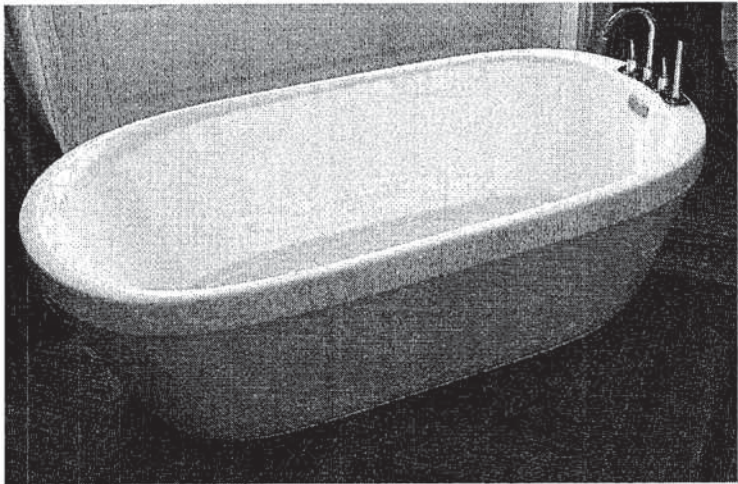

CF2007	Two Piece Freestanding Soaker
Size:	60" x 32" x 22" 1524 mm x 813 mm x 559 mm

PRODUCT FEATURES & BENEFITS

- Vacuum formed acrylic reinforced with fiberglass
- Scratch, stain and fade resistant high gloss finish
- Installation friendly two piece design
- Accepts deck mounted faucet
- Includes integral pop up drain and rectangular overflow
- Includes levelling feet

TWO PIECE ASSEMBLY

FRONT VIEW

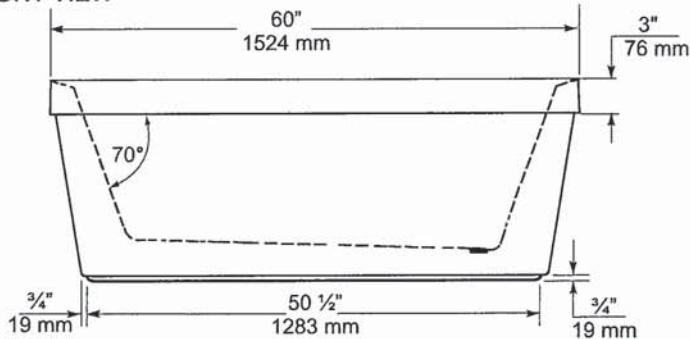

END VIEW

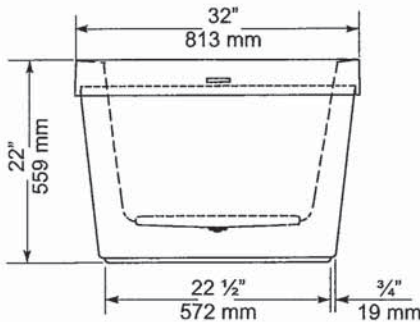

TOP VIEW

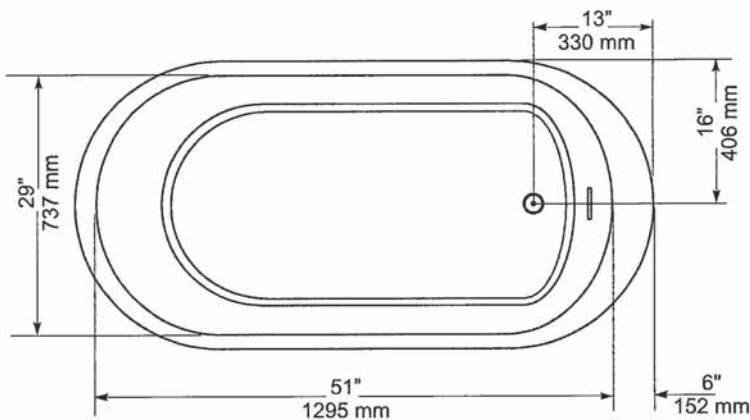

GENERAL SPECIFICATIONS		
Average Weight	90 lb	41 kg
Bathing Well at bottom	43"x 20"	1092 x 508 mm
Capacity Drain to Overflow		195 litres
Water Depth Drain to Overflow	16"	406 mm
Drain Opening (dia.)	2"	51 mm
Overflow Opening	2 1/4"x 1/2"	57 x 13 mm
Drain to Floor Clearance	3 1/4"	83 mm

NOTES: Please confirm measurements on actual product to ensure proper identification. Bathtub to be installed on the floor supported by 5 self levelling feet. Adjust if required to level the bathtub for adequate drainage. Refer to installation instructions for additional information.

IMPORTANT: Dimensions of fixtures are nominal and may vary $\pm \frac{1}{4}$ " (6 mm). Weight may vary ± 5 lb (2.3 kg). Drawing is not to scale. These measurements are subject to change at manufacturer's discretion.

Compliance Certifications -
Meets or Exceeds the following Specifications:

- CAN/CSA - B45 Series



VT

JB

American Standard
Style That Works Better

FloWise™ DUAL FLUSH
ELONGATED TOILET
VITREOUS CHINA

FloWise™ DUAL FLUSH ELONGATED TOILET

- 2476 216
 - Vitreous china
 - Low-consumption Dual Flush
 - Full flush 6.0 Lpf/1.3 gpf,
 - Partial flush 3.0 Lpf/0.66 gpf.
 - Elongated wash down bowl
 - Internal trapway fully-glazed,
 - 2-1/4" (57mm) ballpass
 - Concealed trapway bowl
 - Chrome-plated top mounted push button actuator
 - Easy to clean sanitary dam on bowl
 - Includes Elongated Slow Close Seat
 - 100% factory flush tested
 - 2 bolt caps

Separate Component Parts:

- 3067 316 Elongated Bowl with Slow Close Seat
- 4035 216 Unlined Tank



- 2476 516 Same as above with Lined tank
 - 3067 316 Elongated Bowl
 - 4035 516 Lined Tank

Nominal Dimensions:
794 x 432 x 765mm
(31-1/4" x 17" x 30-1/8")

- Compliance Certifications -
Meets or Exceeds the Following Specifications:
- ASME A112.19.2M (and 19.6M)
 - CAN/CSA B45 series

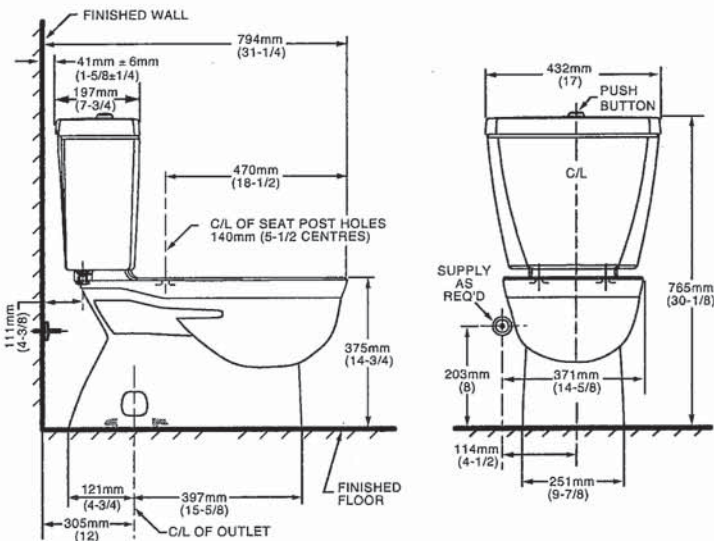

- To Be Specified
- Colour: 020 White
 - Supply with stop:

NOTES:
THIS TOILET IS DESIGNED TO ROUGH-IN AT A MINIMUM DIMENSION OF 305MM (12") FROM FINISHED WALL TO C/L OF OUTLET.
SUPPLY NOT INCLUDED WITH FIXTURE AND MUST BE ORDERED SEPARATELY.
* DIMENSION SHOWN FOR LOCATION OF SUPPLY IS SUGGESTED.
FOR ADDITIONAL INFORMATION REFER TO INSTALLATION INSTRUCTIONS SUPPLIED.
IMPORTANT: Dimensions of fixtures are nominal and may vary within the range of tolerance established by ANSI Standard A112.19.2
These measurements are subject to change or cancellation. No responsibility is assumed for use of superseded or voided pages.

UPGRADED VALUE ADDED FEATURES AT NO EXTRA CHARGE



Specifications

DESCRIPTION

- Metal construction with various finishes identified by suffix
- 16" long 3/8" tubing connections
- Includes metal or 50/50 pop-up type waste assembly where noted

OPERATION

- Pivot action lever style handle
- Temperature controlled through 180° degree arc of handle travel

FLOW

- Flow is limited to 1.5 gpm max (5.7L/min) at 60 psi

CARTRIDGE

- 1225 cartridge design
- Nonmetallic/nonferrous and stainless steel material
- Can accommodate reversed piping and back to back installations

STANDARDS

- Third party certified to WaterSense®, CSA B-125.1, ASME A112.18.1 and all applicable requirements referenced therein including NSF61/9
- Complies with California Proposition 65 and with the Federal Safe Drinking Water Act
- **ADA**  for lever handle

WARRANTY

- Lifetime limited warranty against leaks, drips and finish defects to the original consumer purchaser
- 5 year warranty if used in commercial installations



CHATEAU®
Single-Handle Lavatory Faucet

with Metal Waste Assembly

Model: L4625 series

L4631BC

Bulk Packed (12 per carton):

L64624 series

with 50/50 Waste Assembly

Bulk Packed (12 per carton):

L64625 series

Less Waste

Bulk Packed (12 per carton):

L64600 series

NOTE: THIS FAUCET IS DESIGNED TO BE
INSTALLED THRU 3-1" DIA. HOLES, 2" ON CENTER

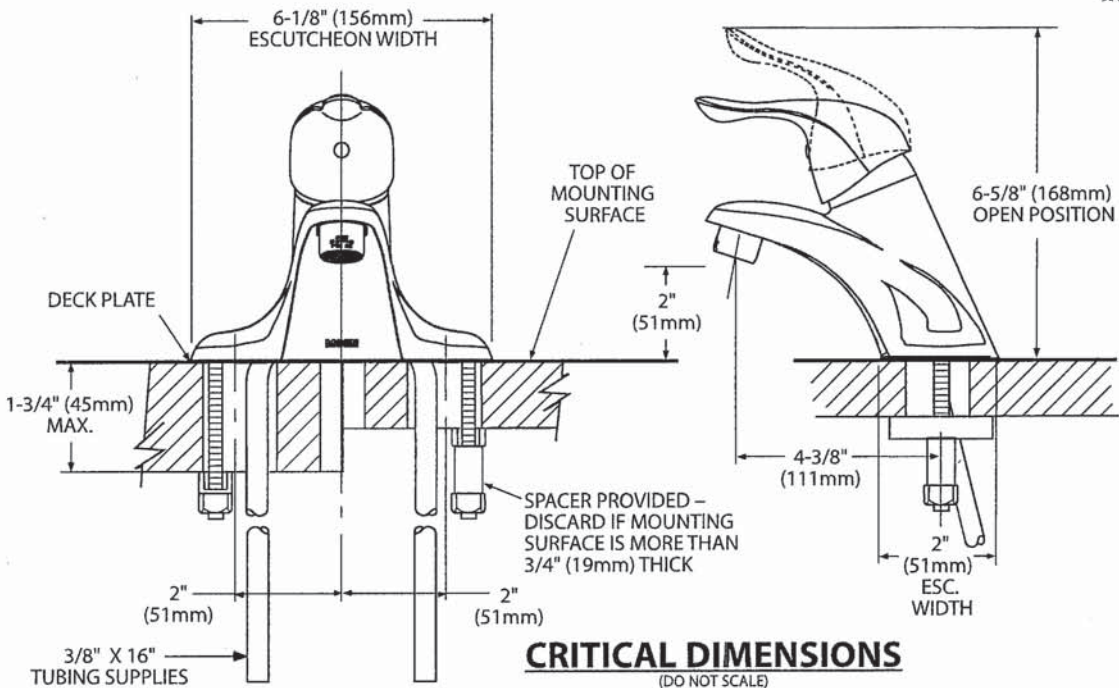

VT



Buy it for looks. Buy it for life.®

Specifications



CHATEAU® POSI-TEMP® Single-Handle Tub/Shower Trim Kit

Models: TL181 series - valve trim only
(Bulk Packed 12 per carton)
TL182 series - shower trim only
(Bulk Packed 12 per carton)
TL183 series - tub/shower trim
(Bulk Packed 12 per carton)

Valves: 62300 series
2500 series



DESCRIPTION

- Metal construction with various finishes identified by suffix
- Includes non-metallic showerhead, arm, flange and non-metallic diverter tub spout

OPERATION

- Handle operates counterclockwise through a 270° arc with off at 6 o'clock and maximum hot at the 9 o'clock position. Shut off in clockwise direction
- Adjustable temperature limit stop to control maximum hot water temperature
- Pressure balancing mechanism maintains selected discharge temperature to $\pm 3^\circ$

FLOW

- Showerhead is limited to 2.5 gpm (9.5 L/min) at 80 psi
- EP suffix models are limited to 1.75 gpm (6.6 L/min) at 80 psi
- NH suffix models contain no showerhead

CARTRIDGE

- 1222 cartridge design
- Accommodates back to back installations
- Nonmetallic/nonferrous and stainless steel material

STANDARDS

- Third party certified to meet ASME A112.18.1/CSA B125.1 and all applicable requirements referenced therein
- EP suffix models are third party certified to WaterSense®
- **ADA** for lever handle

WARRANTY

- Lifetime limited warranty against leaks, drips and finish defects to the original consumer purchaser
- 5 year warranty if used in commercial installations

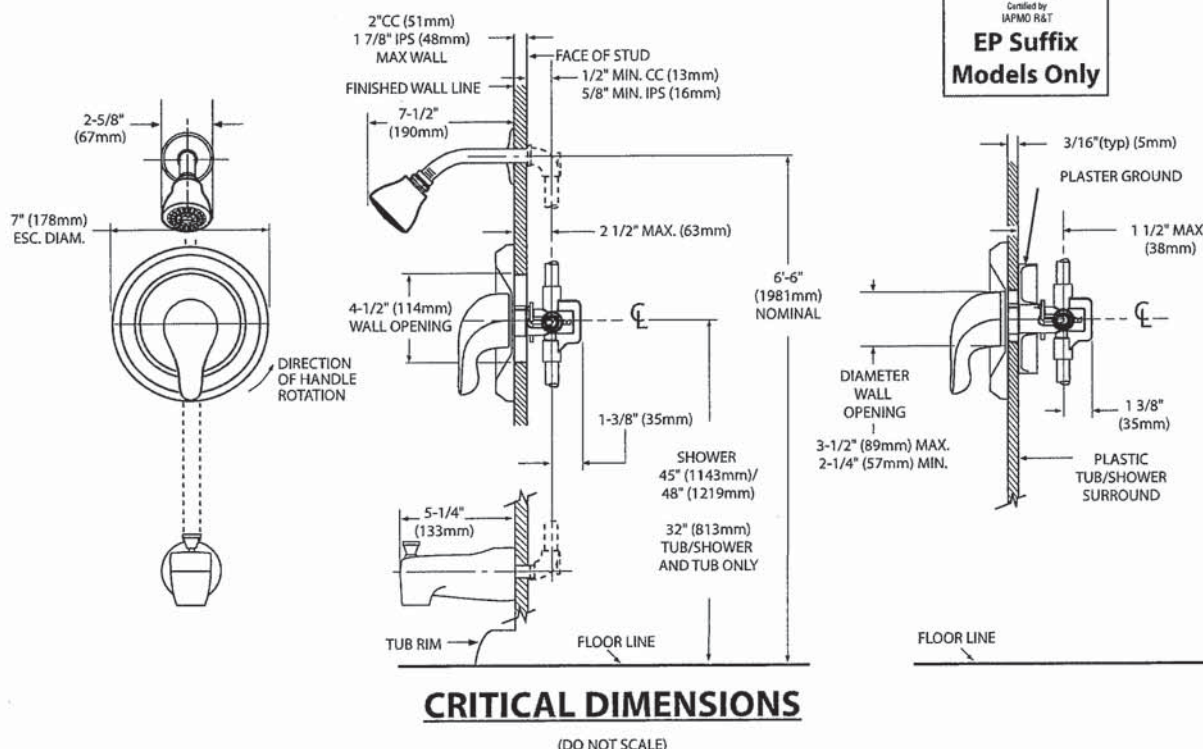

51



Specifications

- DESCRIPTION**
- Metal construction with various finishes identified by suffix
- OPERATION**
- Lever style handles with hot and cold color indicator
 - Rotate hot side handle counterclockwise to open (clockwise to close) and the cold side handle (clockwise to open) and (counterclockwise to close)
- STANDARDS**
- Third party certified to: ASME A112.18.1/CSA B-125.1, and all applicable requirements referenced therein
 - ADA  for lever handles
- WARRANTY**
- Lifetime limited warranty against leaks, drips and finish defects to the original homeowner
 - 10 year limited warranty when used in a multi-family installation
 - 5 year limited warranty when used in a commercial installation
- Visit www.moen.com/support for complete details and limitations

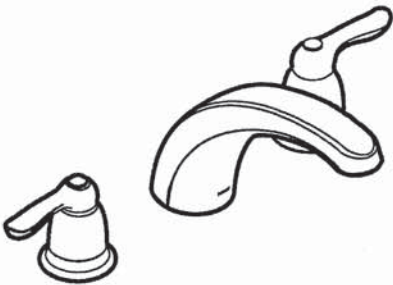

CHATEAU®
Two-Handle Garden Tub Trim

Models: T994 series

Valves: 4792, 4793, 4794, 4796, 4797, 4798

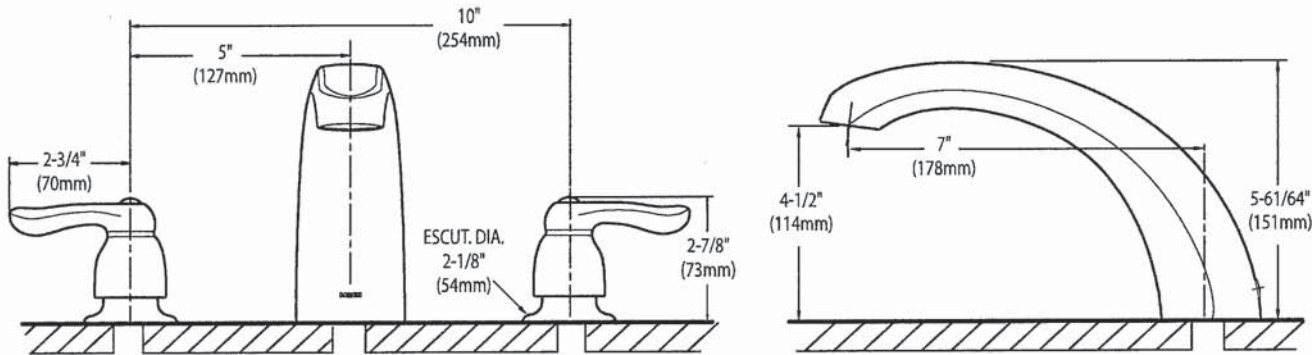

CRITICAL DIMENSIONS
(DO NOT SCALE)

NK36K7000WS

36" Range Hood

Features

- Wi-Fi Monitoring
- ADA Compliant
- 3 Fan Speeds including Booster
- Wall-Mounted Chimney Style
- Digital Touch Control
- Exterior Venting
- 74 dBA Noise Level

Convenience

- LED Lighting

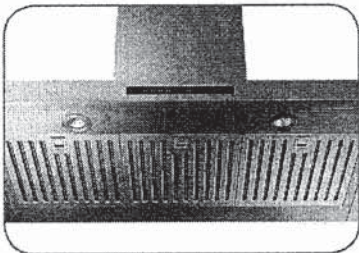
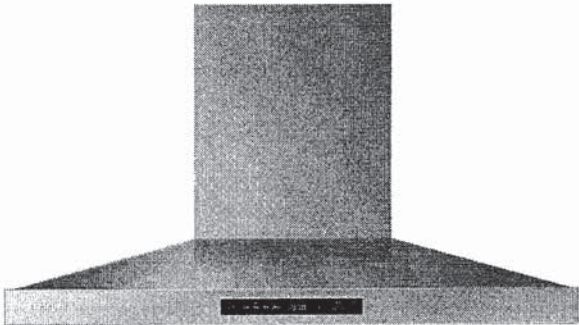

Baffle Filter

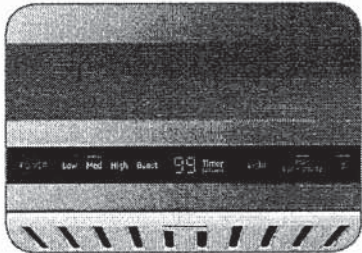

Wi-Fi Monitoring

\$2,450

Available Colors



Stainless Steel (shown)



Black Stainless Steel

Signature Features

BLUETOOTH CONNECTED HOOD

- Automatically sync the fans and the lights with the cooktop through Bluetooth.¹

¹Only on select Samsung cooktops.

BAFFLE FILTER

- Dishwasher-safe metal filters help keep the air clean by drawing grease and odor through the hood.

POWERFUL 600 CFM VENTILATION

- Circulates air to remove odors quickly.

SAMSUNG

NK36K7000WS

36" Range Hood

Venting Methods

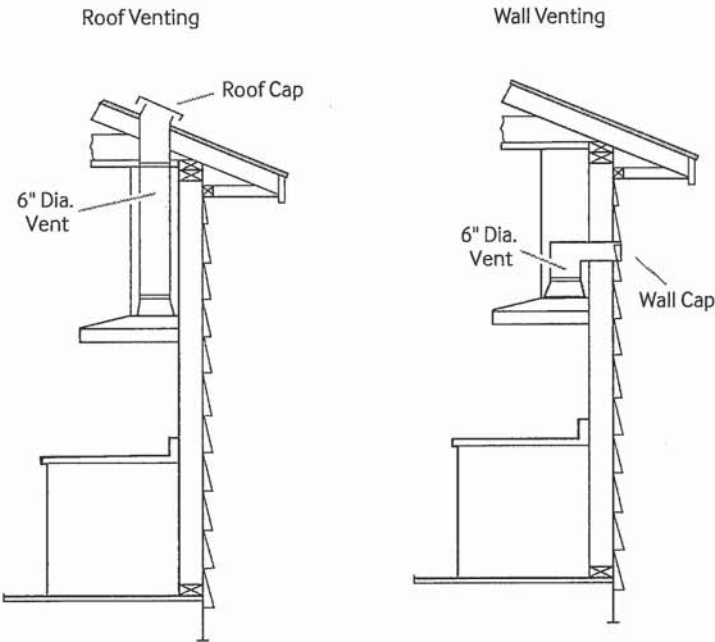

Total Power
220W

Power Source
120V / 60 Hz / 15A

- Range Hood
- 36" Stainless Steel Chimney Hood
 - Vent Fan: 600 CFM
 - Front-Centered, Touch Control
 - 4 Fan Speeds: 3 Step, 1 Booster
 - 74 dBA Noise Level
 - Hood Connectivity Control
 - Bluetooth On/Off Control
 - Mobile Monitoring: Fan Speed, Lighting On/Off, Power Control
 - Removable Baffle Filter
 - LED Lighting

Warranty
One (1) Year All Parts and Labor

Product Dimensions & Weight (WxHxD)
Outside (Max) Hood Dimensions:
36" x 25 25/64" x 19 11/16"

Weight: 48.5 lbs.

Shipping Dimensions & Weight (WxHxD)
Dimensions:
40 3/16" x 26 1/2" x 18 1/16"

Weight: 60.4 lbs.

Dimensions and Clearance

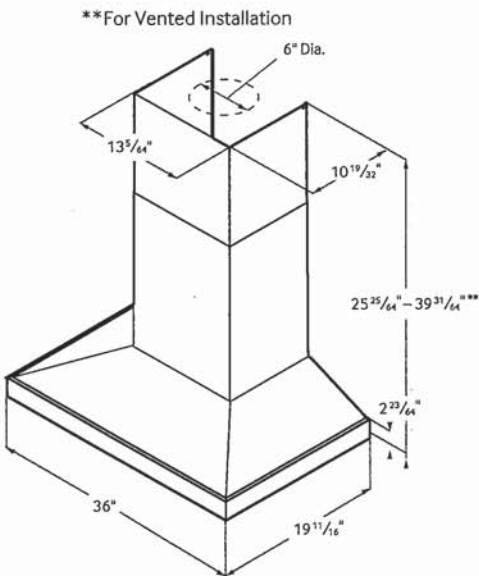

Color	Model #	UPC Code
Stainless Steel	NK36K7000WS	887276182988
Black Stainless Steel	NK36K7000WG	887276182971

SAMSUNG

Actual color may vary. Design, specifications, and color availability are subject to change without notice.
Non-metric weights and measurements are approximate.
©2017 Samsung Electronics America, Inc. 85 Challenger Road, Ridgefield Park, NJ 07660. Tel: 800-SAMSUNG. samsung.com
Samsung is a registered trademark of Samsung Electronics Co., Ltd.

RF23A9771SR

SAMSUNG

4-Door Flex Counter-Depth Family Hub™ Refrigerator with Beverage Center
22.5 cu. ft.



Signature Features

Family Hub™

A fun way to share messages, photos, videos and schedules. You can also listen to music, watch TV¹ and monitor your home all from the Family Hub. It even helps you plan recipes and send instructions to the oven.

Beverage Center™

Consists of a BPA Free² Autofill Water Pitcher that fills up automatically and a regular Water Dispenser for easy access to a glass of cold, flavoured water.

Dual Auto Ice Maker

Be prepared for any occasion with two different types of ice. The Dual auto ice maker makes both cubed ice and ice bites.

UV Deodorizing Filter

New built-in deodorizing filter reduces unpleasant odours caused by bacteria in your fridge. And the UV light in the filter system keeps the filter clean all the time.

Flexible Storage

Keep your food fresh in the right places. The FlexZone™ is an independently controlled compartment with five different temperature modes.

Triple + Metal Cooling

Triple Cooling system optimizes the temperature and humidity in the fridge and freezer with independent cooling. Precise Cooling system minimizes temperature fluctuation and the Metal Cooling plate efficiently reserves cool air inside the fridge.

Available Colours

-  Fingerprint Resistant Stainless Steel (shown)
-  Fingerprint Resistant Black Stainless Steel

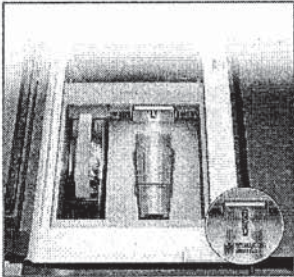

Beverage Center™ with AutoFill™ Water Pitcher

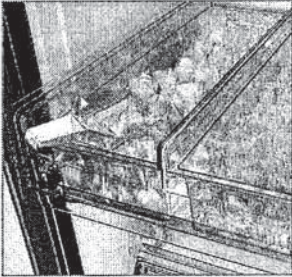

Dual Ice Maker with Cubed Ice and IceBites™

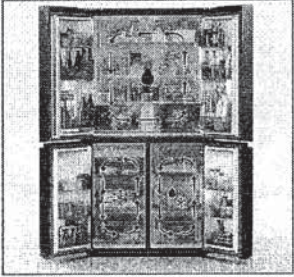

Triple + Metal Cooling

Features

- 24" Family Hub Screen
- 36" Wide
- Large Storage Capacity – 22.5 cu. ft.
- Triple Cooling + Metal Cooling™
- FlexZone™
- FlexCrisper™
- UV Deodorizing Filter
- Tempered Glass Spill-Proof Shelves
- Fingerprint Resistant Finish

Convenience

- Beverage Center
- Autofill Pitcher
- Water Dispenser
- Dual Auto Ice Maker
- Door Alarm
- Wi-Fi Connectivity

Rating



- ENERGY STAR® - Rated
- Energy Consumption (annual) = 631 kWh/yr

¹ Wi-Fi connection required. The SmartThings app is available for download for Android, iOS and Windows. Minimum smartphone requirements: Android 4.0, iOS 7.0, Windows Phone 8.1 or greater.
² Does not contain the chemical Bisphenol A.

VT

JB

RF23A9771SR

SAMSUNG

4-Door Flex Counter-Depth Family Hub™ Refrigerator with Beverage Center
22.5 cu. ft.

Installation Specifications

- 1. Measure the height, width and depth of the opening, making sure to include baseboards, molding tile, countertop overhang, etc. Check to be sure there is enough room to open the door (consider walls, islands or other obstacles when measuring).
- 2. Refer to illustration below to determine dimensions.
- 3. Allow 11 1/8" of clearance on hinge side of refrigerator when installing next to a wall where handle may make contact.
- 4. Allow 2" minimum clearance at rear for proper air circulation and water/ electrical connections. Allow a 3/8" minimum clearance at sides and top for ease of installation.
- 5. Ensure each door and entryway in the home is wide enough for the refrigerator to be moved through easily.

For optimal usage and to be able to open refrigerator doors completely, do not install next to a wall.

Please note: The following dimension and cutout information is for planning purposes only. For complete installation details, consult manual packed with product, or download manual online at samsung.com.

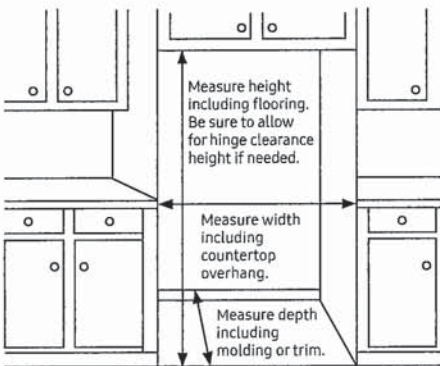

Dimensions

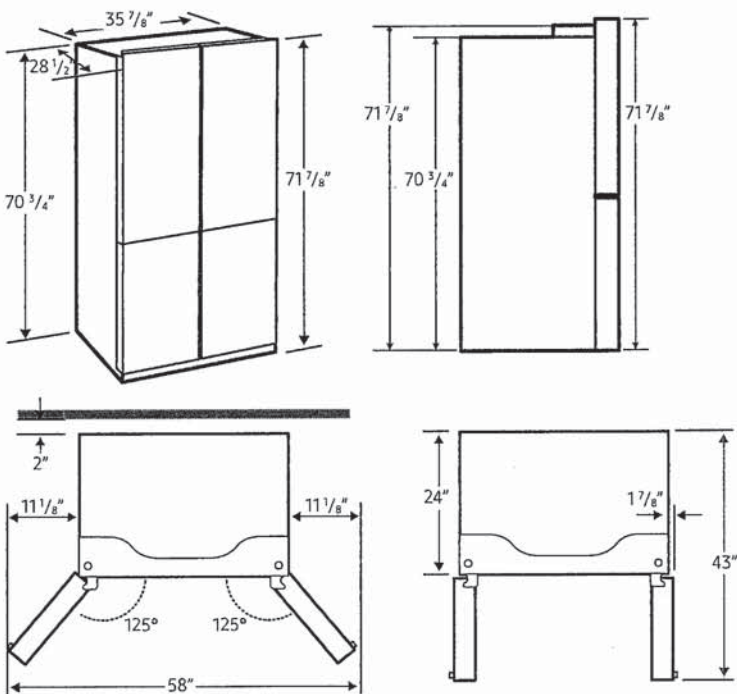

Actual colour may vary. Design, specifications and colour availability are subject to change without notice. Non-metric weights and measurements are approximate.
© 2021 Samsung Electronics Canada Inc. All rights reserved. Samsung is a registered trademark of Samsung Electronics Co., Ltd., used with permission.

Total Capacity: 22.5 cu. ft.

Refrigerator: 13.7 cu. ft.

Left Door Beverage Center

- Autofill Water Pitcher

- Water Dispenser

Triple Cooling and Metal Cooling

2 Crispers (Flex Crisper™, Crisper+)

4 Tempered Glass Shelves

6 Door Bins

UV Deodorizing Filter

Freezer: 8.8 cu. ft.

Right Freezer:

FlexZone™

• -15°C to -23°C (Freeze) • -5°C (Soft Freeze)

• -1°C (Meat · Fish)

• 2°C (Fruits · Veggies)

• 5°C (Chill)

2 Slide-out shelves

1 Drawer Bin

Left Freezer:

Auto Dual Ice Maker (Cubed Ice, IceBites™)

2 Slide-out shelves

1 Drawer Bin

Volt/Amps	115V / 60Hz / 3.5A
Power Cord Length	2 meters

Warranty

One (1) Year Parts and Labour on Refrigerator

Ten (10) Years Parts on Digital Inverter Compressor

Product Dimensions & Weight (WxHxD)

Dimensions (WxHxD with hinges, handles and doors):

35 7/8" x 71 7/8" x 28 1/2"

Dimensions (WxHxD without hinges and door):

35 7/8" x 70 3/4" x 24"

Dimensions (WxHxD with hinge and door, no handle):

35 7/8" x 71 7/8" x 28 1/2"

Weight: 337.3 lbs (153 kg)

Shipping Dimensions & Weight (WxHxD)

Dimensions: 38 1/4" x 77 5/8" x 30 3/5"

Weight: 359.3 lbs (162.98 kg)

Colour	Model #	UPC Code
Stainless Steel	RF23A9771SR	887276525686
(Counter-Depth)		
Black Stainless Steel	RF23A9771SG	887276524689
(Counter-Depth)		
Stainless Steel	RF29A9771SR	887276525808
Black Stainless Steel	RF29A9771SG	887276524696

NA36N7755TS

SAMSUNG

36" Gas Cooktop with 22K BTU Dual Burner

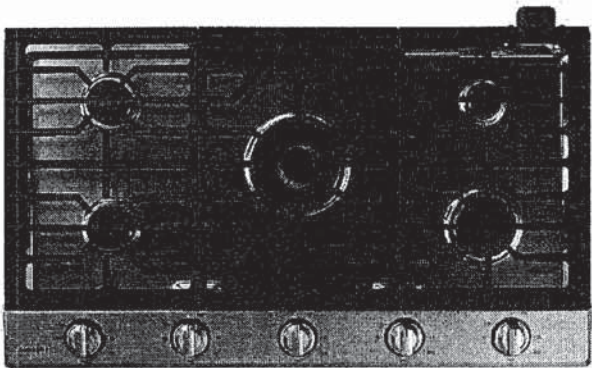

Signature Features

Powerful Burners

- A high power, 22K Dual Burner provides powerful heat and precise control – quickly going from a high heat to a simmer.

Illuminated Knobs

- With illuminated knobs, you can easily check whether you have left the cooktop on, even at a distance.

Grates

- Hexagon Grates enable superior cooking performance by conducting heat efficiently.

Wi-Fi Connectivity

- Wi-Fi Connectivity maximizes safety and offers peace of mind by letting you remotely monitor the cooktop at any time using a smartphone App¹, while setting the cooking timer and receiving alerts when it finishes².

Available Colours



Stainless Steel (shown)



Black Stainless Steel



Powerful Burners

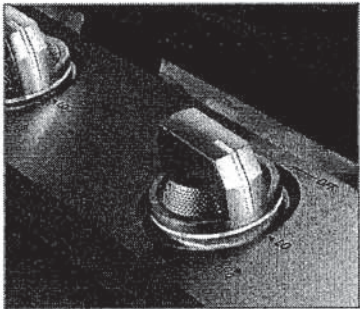

Front Controls / Illuminated Knobs

Features

- Powerful Cooktop
- 4 Burners with 59K BTU
 - Right Front: 13K BTU (Power Burner)
 - Left Front: 9.5K BTU
 - Right Rear: 5K BTU (Simmer)
 - Left Rear: 9.5K BTU
 - Centre Front: 22K BTU
- Bluetooth/Hood Connectivity
- Wi-Fi Enabled
- Cast Iron 3-Piece Grates
- Sealed Burners

Accessories

- Wok Grate
- Cast Iron Griddle

Convenience

- LP Conversion Kit

¹Available on Android and iOS devices. A Wi-Fi connection and a Samsung account are required.
²A Wi-Fi connection is required.

✓

JB

NA36N7755TS

SAMSUNG

36" Gas Cooktop with 22K BTU Dual Burner

Installation Requirements

Countertop cut-out and minimum clearance dimensions:

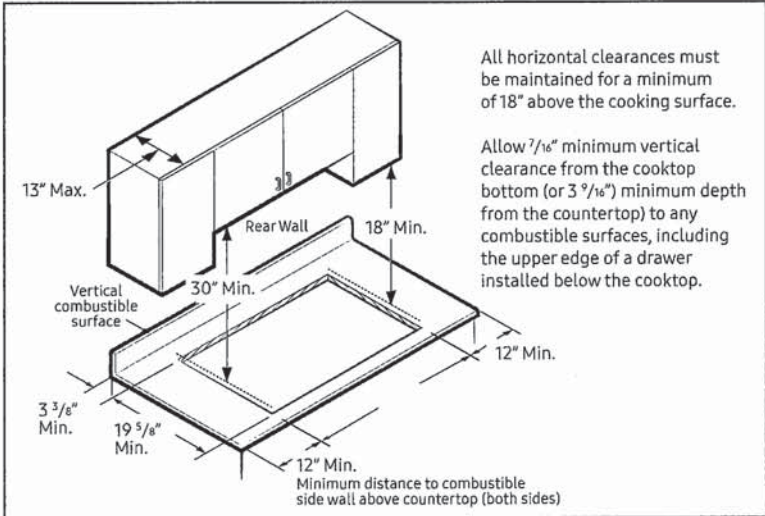

Power Source

120V / 60 Hz / 15A

Gas Cooktop (BTU)

- Total Power: 59K
- Right Front: 13K (Power Burner)
- Left Front: 9.5K
- Right Rear: 5K (Simmer)
- Left Rear: 9.5K
- Centre Front: 22K

Warranty

One (1) Year All Parts and Labour

Product Dimensions & Weight (WxHxD)

Outside (Max) Cooktop Dimensions:

40 1/2" x 10 3/5" x 25 3/5"

Cooktop Cut-Out Dimensions: 33 9/10" x 3 1/8" x 19 1/10"

Weight: 87.7 lbs (39.8 Kg)

Shipping Dimensions & Weight (WxHxD)

Dimensions: 36" x 5 1/5" x 22 2/5"

Weight: 96.3 lbs (43.7 Kg)

Colour

Stainless Steel

Model #

NA36N7755TS

UPC Code

887276281766

Black Stainless Steel

NA36N7755TG

887276281759

Installing Over a Single Oven

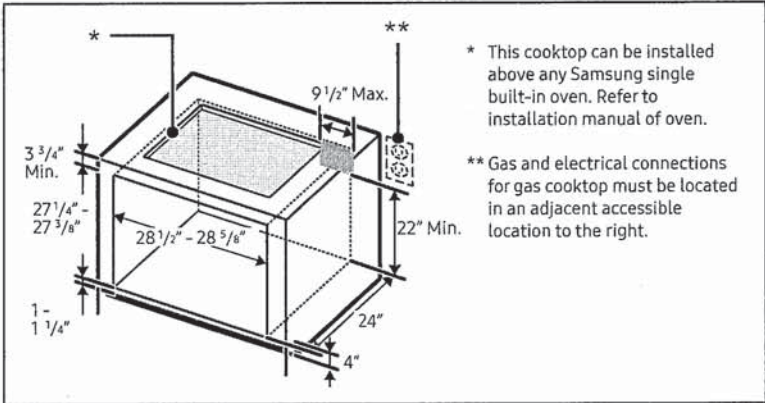

Cooktop Dimensions

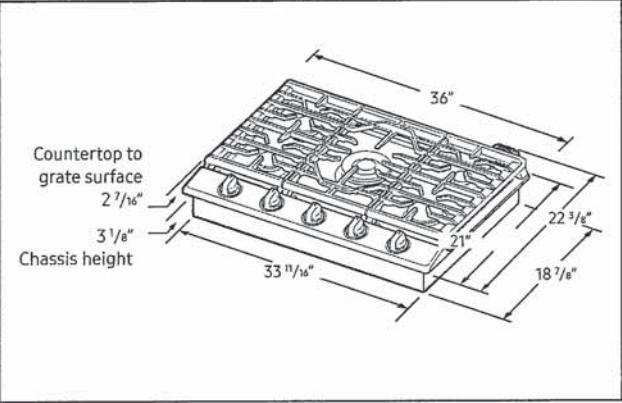

NQ70M7770DS

SAMSUNG

30" Microwave Combination Wall Oven

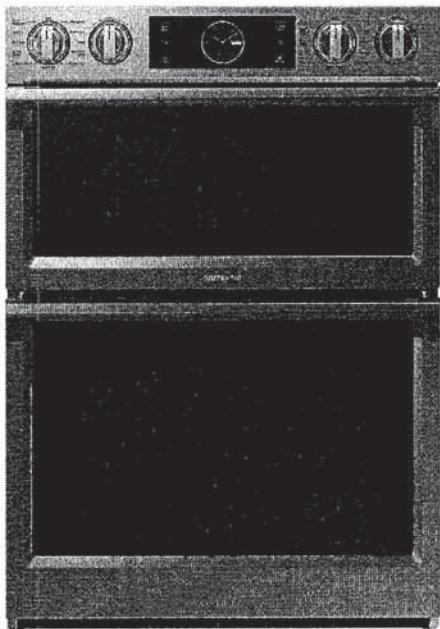

Signature Features

Steam Cook (Oven)

- Delivers moisture at precise times for a crisp, browned outside and tender inside.

Speed Cook (Microwave)

- Cook food faster and more evenly by using power convection.

Flex Duo™ (Oven)

- Cook two dishes at different temperatures simultaneously with the Smart Divider.

Available Colors



Stainless Steel (shown)



Black Stainless Steel

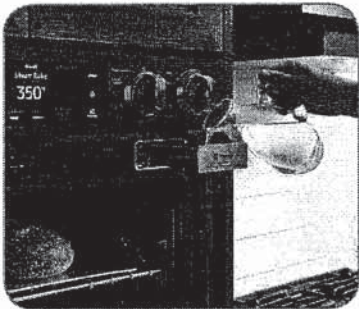

Steam Cook

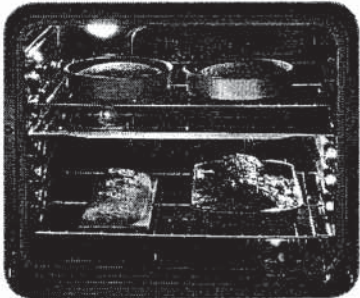

Flex Duo™

Features

- Digital-Analog Controls
- 1.9/5.1 cu. ft. Capacity
- Hybrid Clean and Self-Clean (Oven)
- Gourmet Cook (Oven)
- Dual Convection (Oven)
- Wi-Fi Connectivity
- Wi-Fi Enabled Temperature Probe (Oven)
- LED Spotlights (Oven)
- Easy View Window
- 3 Heavy-Duty Racks including a Gliding Rack (Oven)
- Soft-Close Door (Oven)
- Ceramic Plate (Microwave)
- Rapid Preheat (Oven)
- Auto Latch Microwave Door
- 6 Oven Modes including Steam Bake and Steam Roast
- Blue LED Illuminated Knobs
- Broil Element
- Smart Control Key (Oven)
- 6 Rack Positions (Oven)
- Drop-Down Door Design
- LCD Display

Convenience

- Hidden Heating Element (Oven)
- Sabbath Mode (Oven)
- Delay Start (Oven)
- Proofing (Oven)
- Warming Mode (Oven)
- Kitchen Timer
- Child Safety Lock
- Convection Conversion

57

3

NQ70M7770DS

30" Microwave Combination Wall Oven

SAMSUNG

Cabinet Dimensions

Combination Oven Installed in Cabinet

* Junction Box

** Allow a minimum of 22" for clearance to adjacent corners, drawers, walls, etc. when door is open.

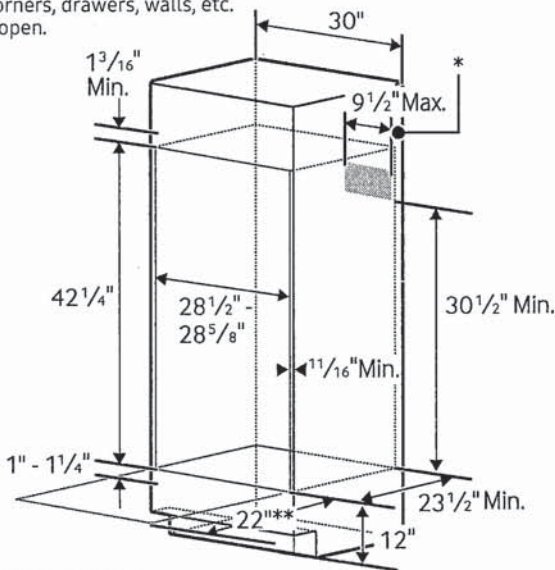

Product Dimensions

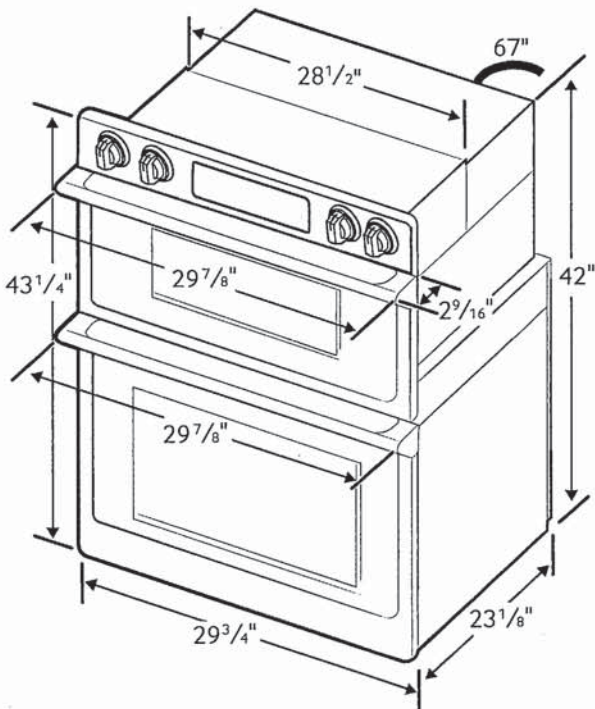

Total Capacity: 1.9/5.1 cu. ft.

- Microwave: 1.9 cu. ft.
- Wall Oven: 5.1 cu. ft. total, 2.8/2.2 cu. ft.
- Hidden Bake Element
- Bake: 175°F–550°F
- Convection Bake: 175°F–550°F
- Convection Roast: 175°F–550°F
- Broil: Low-High
- Steam Bake: 230°F–550°F
- Steam Roast: 230°F–550°F
- Proofing
- Sabbath Mode

Warranty

One (1) Year All Parts and Labor
Ten (10) Years Parts Warranty for Magnetron

Product Dimensions & Weight (WxHxD)

Outside (Max) Combination Oven Dimensions:
29 7/8" x 43 1/4" x 25 11/16"

Combination Oven Cut-Out Dimensions:
28 1/2" x 42 1/4" x 23 1/2"

Weight: 119 lbs.

Shipping Dimensions & Weight (WxHxD)

Dimensions:
33 5/8" x 48 3/16" x 29 51/64"

Weight: 132.5 lbs.

Color

Stainless Steel
Black Stainless Steel

Model #

NQ70M7770DS
NQ70M7770DG

UPC Code

887276195186
887276195162

RATING	
240V	9.5 kW
208V	7.2 kW
BREAKER SIZE	
240V	40 Amps
208V	40 Amps

DW80R9950

SAMSUNG

Samsung LinearWash 39 dBA Dishwasher

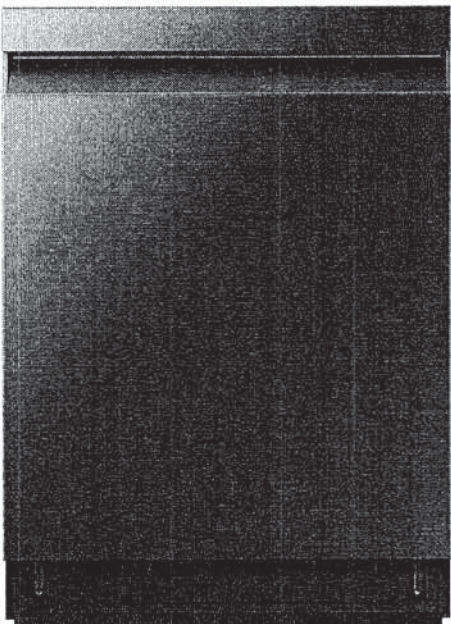

Signature Features

- Linear Wash System**
- AquaBlast™ jets provide corner to corner coverage for superior cleaning.
- Whisper Quiet Cleaning**
- Less noise and less disturbance with virtually silent wash cycles at 39 dBA.
- AutoRelease™ Door**
- At the end of a cycle, the door automatically opens to circulate air and improve drying performance.

Available Colors

-  Fingerprint Resistant Stainless Steel (shown)
-  Fingerprint Resistant Black Stainless Steel
-  Fingerprint Resistant Tuscan Stainless Steel

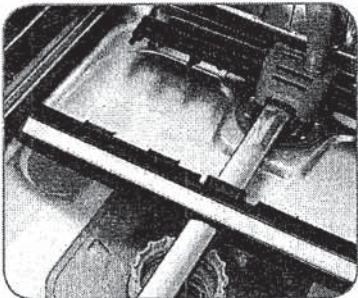

Linear Wash System

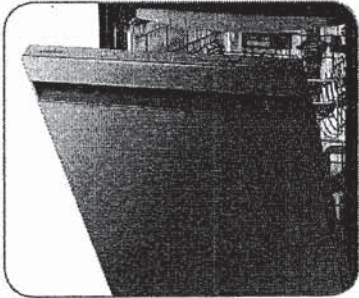

AutoRelease™ Door

Features

- Flexible 3rd Rack
- Fingerprint Resistant Stainless Finish
- Zone Booster™
- Touch Control
- Quiet Operation: 39 dBA
- Wi-Fi Connectivity
- 7 Wash Cycles
- 8 Options
- Half-Load Cycle
- Express Cycle: 60 Minutes
- One-Touch Adjustable Racking System
- Full Stainless Steel Interior
- 15 Place Settings
- 3 Spray Wash Arms (Upper, Middle, Lower)

Convenience

- LED Time Display
- Control Lock
- Delay Start
- Digital Leak Sensor

Rating

ENERGY STAR®-rated:
239 kWh/yr

VT JB

DW80R9950

SAMSUNG

Samsung Linear Wash 39 dBA Dishwasher

Installation Specifications

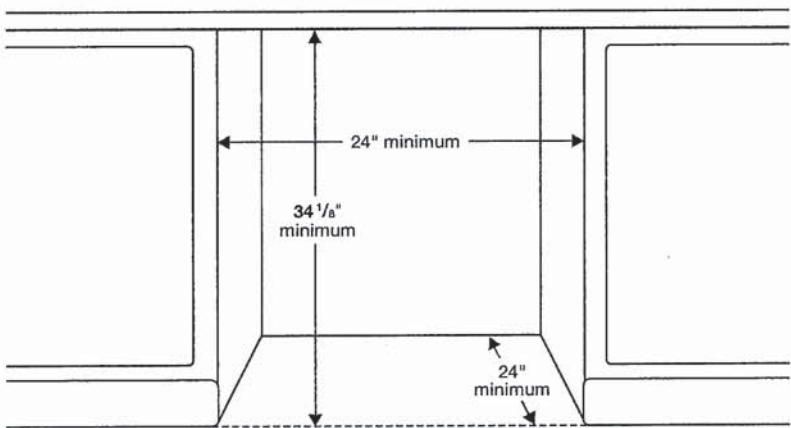

Features

- 7 Wash Cycles: Auto, Normal, Heavy, Delicate, Express 60, Rinse Only, Self Clean
- 8 Options: Half-Load Wash (Lower Rack), Zone Booster™ (Left), Speed Booster, Hi-Temp Wash, Sanitize (Anti-bacterial – NSF), Delay Start, Control Lock, Smart Control (Wi-Fi App)
- AutoRelease™ Door
- Hidden Heat Element
- Stainless Steel Interior Tub

Convenience

- Control Lock
- Digital Water Leakage Sensor
- Flexible Third Rack
- One-Touch Adjustable Racking System
- Silverware Basket
- Upper Rack: Foldable Cup Shelves, 2 Adjustable Tines
- Lower Rack: Fold-Down Tines

Warranty

One (1) Year All Parts and Labor
Five (5) Year Limited on Printed Circuit Board and Interior Nylon Racks

Product Dimensions & Weight (WxHxD)

Dimensions (height is adjustable):
23 7/8" x 33 7/8" – 35" x 25"

Weight: 95 lbs

Shipping Dimensions & Weight (WxHxD)

Dimensions:
26" x 34 3/4" x 29 3/4"

Weight: 101 lbs

Color	Model #	UPC Code
Fingerprint Resistant Stainless Steel	DW80R9950US	887276296647
Fingerprint Resistant Black Stainless Steel	DW80R9950UG	887276296623
Fingerprint Resistant Tuscan Stainless Steel	DW80R9950UT	887276320137

Dimensions

Side View

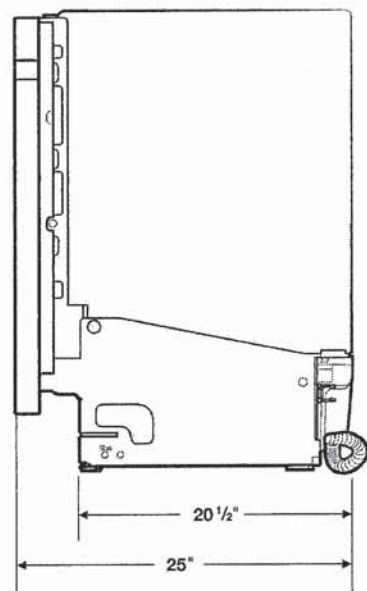

Rear View

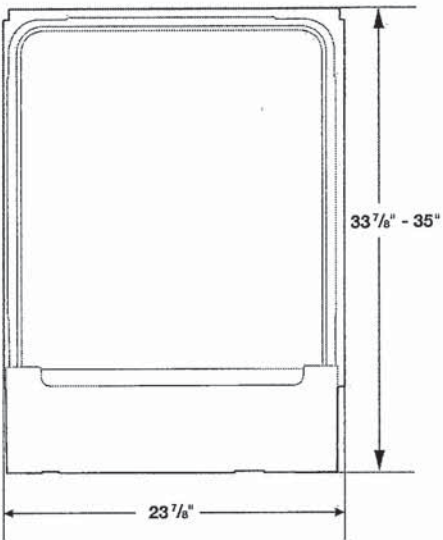

Handwritten marks: "5" and a signature.

WF53BB8900
Bespoke 6.1 cu. ft. Ultra Capacity Front Load Washer
with AI OptiWash™ and Auto Dispense

SAMSUNG

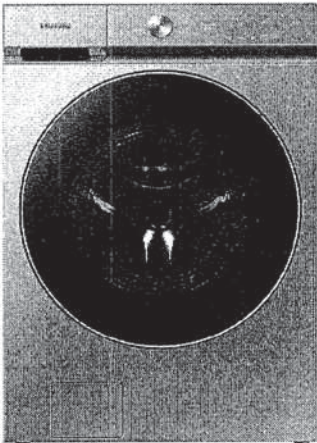

Available Colours



Stainless Steel
WF53BB8900AT

Features

- Bespoke Design
- 6.1 cu. ft. Ultra Capacity
- AI OptiWash™
- Auto Dispense System
- Super Speed Wash
- AI Smart Dial
- MultiControl™
- ENERGY STAR® Most Efficient
- Shallow Closet-Depth Fit¹
- Flexible Installation
- Wi-Fi Connectivity²
- Steam
- Self Clean+
- Premium Tempered Glass Door
- Vibration Reduction Technology+
- Swirl+ Drum Interior
- Internal Drum Light
- 1200 RPM Maximum Spin Speed
- Direct Drive Motor
- 25 Total Washing Cycles
- 18 Options

Convenience

- Child Lock
- Dispenser Trays: Main Wash, Bleach, Auto Detergent, Auto Softener

Ratings



Most Efficient
2022
www.energystar.gov

CEE Tier 3
IMEF = 3.1
IWF = 2.9
103 kWh/yr

Electrical Requirements

120 V / 60 Hz
15 Amps

Specifications

- 25 Total Washing Cycles:**
Normal, AI OptiWash, Heavy Duty, Bedding, Permanent Press, Delicates, Activewear, Wool, Towels, Eco Cold, Rinse + Spin, Self Clean+, Small Load, Colours, Spin Only, Outdoor, Denim, Super Speed, Steam Sanitize, Steam Allergen, Steam Normal, Power Steam, Steam Whites, Steam Bulky, Power Rinse
- 18 Additional Washing Options:**
Presoak, Extra Rinse, My Cycles, Delay End, Smart Control, Super Speed, Drum Light, Dose per Wash, Dose per Rinse, Child Lock, Detergent Concentration Level, Softener Concentration Level, AI Pattern, Alarm, Calibration, Wi-Fi, Language, Factory Reset
- 5 Temperature Settings:**
Extra Hot, Hot, Warm, Cold, Tap Cold

- 7 Spin Settings:**
Extra High, High, Medium, Low, Extra Low, No Spin, No Drain
- 5 Soil Settings:**
Extra Heavy, Heavy, Normal, Light, Extra Light
- Warranty**
One (1) Year Parts and Labour
Twenty (20) Years DD Motor (Part Only)
- Product Dimensions & Weight (WxHxD)**
Dimensions: 27" x 38³/₄" x 34¹/₂"
Weight: 227.1 lbs
- Shipping Dimensions & Weight (WxHxD)**
Dimensions: 29³/₈" x 42¹⁵/₁₆" x 36¹/₄"
Weight: 233.7 lbs

Washer	Model #	UPC Code
Stainless Steel	WF53BB8900AT	887276652269

Matching Electric Dryer		
Stainless Steel	DVE53BB8900T	887276660127

Optional Accessories	Model #	UPC Code
Stainless Steel Pedestal	WE502NT	887276665283
Stainless Steel Bespoke Stacking and MultiControl™ Combo Kit	SKK-9MCT	887276667379

¹ Designed to fit a 38" installation depth.
² Requires wireless network, Samsung account and Samsung SmartThings App. The Samsung SmartThings App supports Android OS 4.0 (ICS) or later which is optimized for Samsung smartphones (Galaxy S and Galaxy Note series). This app also supports iOS 7 or later for iPhone models. Samsung SmartThings App available in App Store and Play Store.

57

JB

WF53BB8900
Bespoke 6.1 cu. ft. Ultra Capacity Front Load Washer
with AI OptiWash™ and Auto Dispense

SAMSUNG

Dimensions

Required dimensions for installation with pedestal:

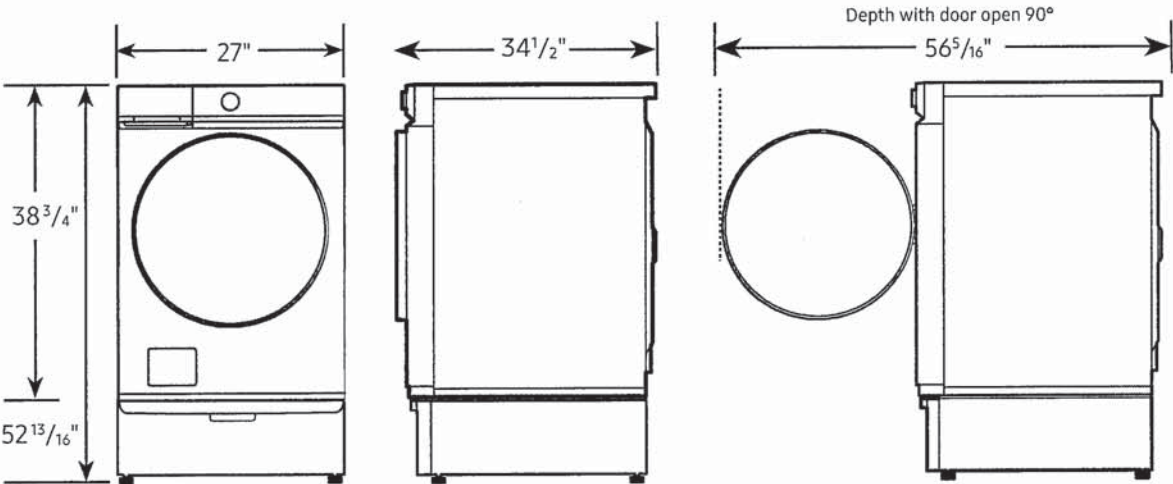

Installation Specifications – Side-by-Side

If the washer and dryer are installed together or the dryer alone, the closet front must have two unobstructed air openings for a combined minimum total area of 72-inch². Your washer alone does not require a specific air opening.

Alcove or closet installation
Minimum clearance for closet and alcove installations:

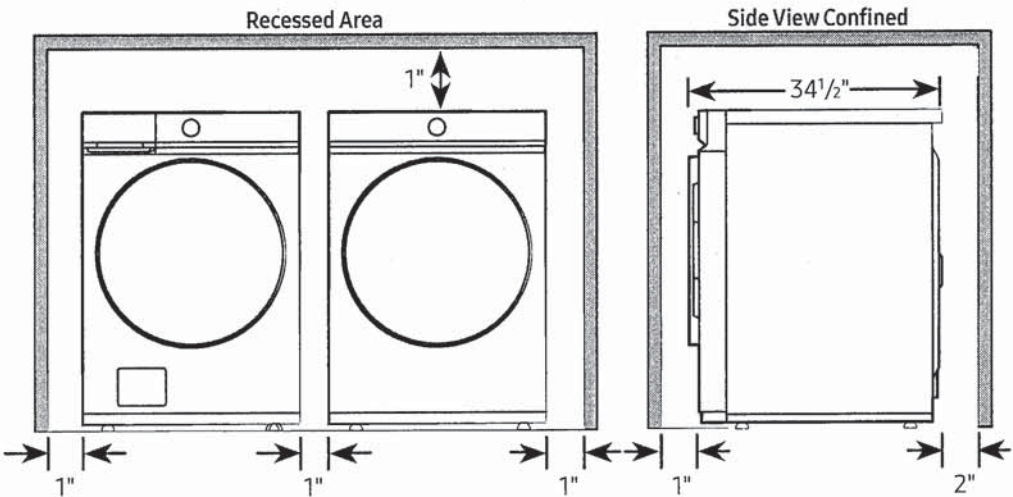

Connection Dimensions

Back view of washer

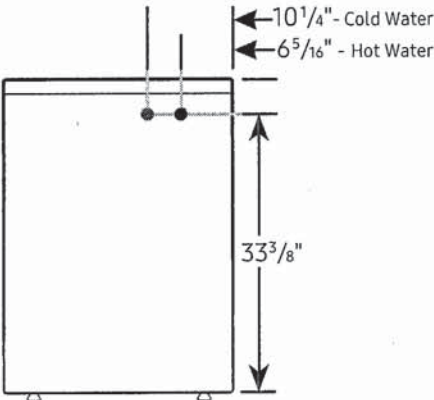

LEGEND:
● Cold Water Connection
● Hot Water Connection

Actual colour may vary. Design, specifications and colour availability are subject to change without notice.
Non-metric weights and measurements are approximate.
© 2022 Samsung Electronics Canada Inc.
All rights reserved. Samsung is a registered trademark of Samsung Electronics Co., Ltd., used with permission.

✓

9/3

WF53BB8900
Bespoke 6.1 cu. ft. Ultra Capacity Front Load Washer
with AI OptiWash™ and Auto Dispense



Installation Specifications – Stacked Pair

Clearances indicated are for stacked pairs. The closet front must have two unobstructed air openings for a combined minimum total area of 72-inch².

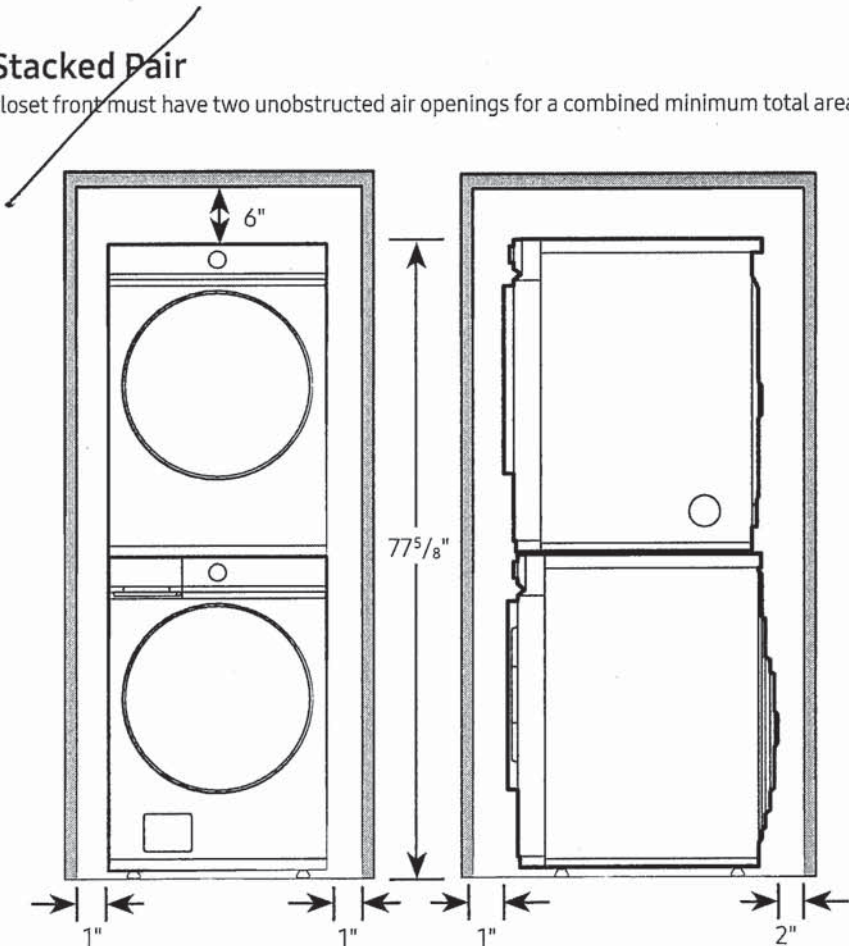

Connection Dimensions
Back and side views of stacked pair

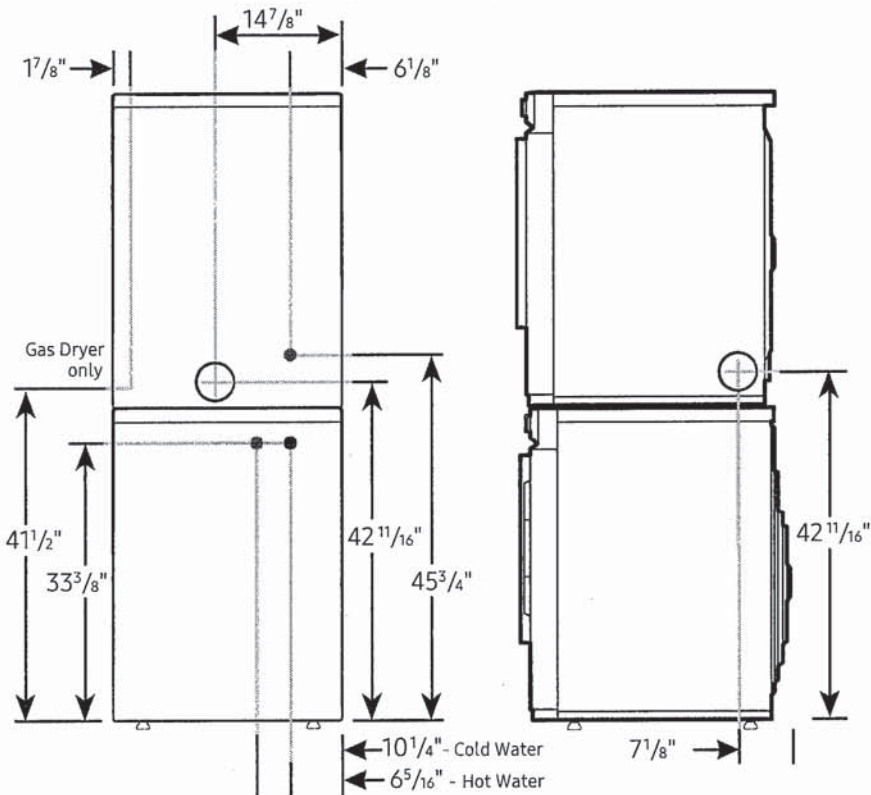

LEGEND:
● Cold Water Connection
● Hot Water Connection

Actual colour may vary. Design, specifications and colour availability are subject to change without notice. Non-metric weights and measurements are approximate.
© 2022 Samsung Electronics Canada Inc. All rights reserved. Samsung is a registered trademark of Samsung Electronics Co., Ltd., used with permission.

✓

JB

DVE53BB8900

SAMSUNG

Bespoke 7.6 cu. ft. Ultra Capacity Electric Dryer
with AI Optimal Dry and Super Speed Dry

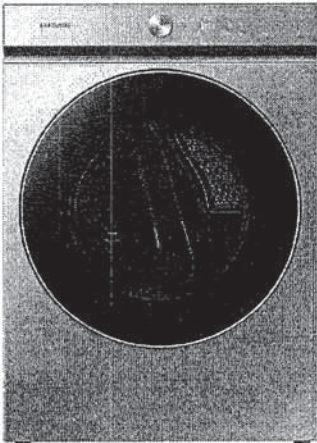

Available Colours



Stainless Steel
DVE53BB8900T

Features

- Bespoke Design
- AI Optimal Dry
- Super Speed Dry
- AI Smart Dial
- MultiControl™
- Steam Sanitize+
- ENERGY STAR® Certified
- Shallow Closet-Depth Fit¹
- Flexible Installation
- Wi-Fi Connectivity²
- Sensor Dry
- 7.6 cu. ft. Ultra Capacity
- Vent Sensor
- Lint Filter Indicator
- Stainless Steel Drum
- Premium Tempered Glass Door
- Internal Drum Light
- Drying Rack
- Reversible Dryer Door
- 20 Total Drying Cycles
- 14 Options
- 5 Temperature Settings
- 4-Way Venting

Convenience

- Child Lock
- Filter Check Indicator

Ratings



ENERGY STAR® Rated:
608 kWh/yr

Electrical Requirements

240 V / 60 Hz
30 Amps

¹Designed to fit a 38" installation depth.
²Requires wireless network, Samsung account and Samsung SmartThings App. The Samsung SmartThings App supports Android OS 4.0 (ICS) or later which is optimized for Samsung smartphones (Galaxy S and Galaxy Note series). This app also supports iOS 7 or later for iPhone models. Samsung SmartThings App available in App Store and Play Store.

Specifications

20 Preset Drying Cycles:
Steam Refresh, Wrinkle Away, Steam Sanitize+, AI Optimal Dry, Super Speed, Eco Normal, Delicates, Normal, Heavy Duty, Towels, Permanent Press, Activewear, Bedding, Wool, Shirts, Denim, Time Dry, Air Fluff, Small Load, Rack Dry

14 Options:
Damp Alert, Wrinkle Prevent, AntiStatic, My Cycles, Smart Control, Eco Dry, Drum Light, Child Lock, Alarm, AI Pattern, Wi-Fi, Language, Vent Blockage Test, Factory Reset

5 Temperature Settings:
High, Medium, Medium Low, Low, Extra Low

5 Dry Levels:
Very Dry, More Dry, Normal Dry, Less Dry, Damp Dry

Warranty
One (1) Year Parts and Labour

Product Dimensions & Weight (WxHxD)
Dimensions: 27" x 38³/₄" x 31⁷/₁₆"
Weight: 125.7 lbs

Shipping Dimensions & Weight (WxHxD)
Dimensions: 29³/₈" x 42¹⁵/₁₆" x 34¹¹/₁₆"
Weight: 132.3 lbs

Electric Dryer	Model #	UPC Code
Stainless Steel	DVE53BB8900T	887276660127

Matching Washer	Model #	UPC Code
Stainless Steel	WF53BG8900AT	887276652269

Optional Accessories	Model #	UPC Code
Stainless Steel Pedestal	WE502NT	887276665283
Stainless Steel Bespoke Stacking and MultiControl™ Combo Kit	SKK-9MCT	887276667379
Vent Kit	DV-2A	887276146416

57

JB

DVE53BB8900

SAMSUNG

Bespoke 7.6 cu. ft. Ultra Capacity Electric Dryer
with AI Optimal Dry and Super Speed Dry

Dimensions

Required dimensions for
installation with pedestal:

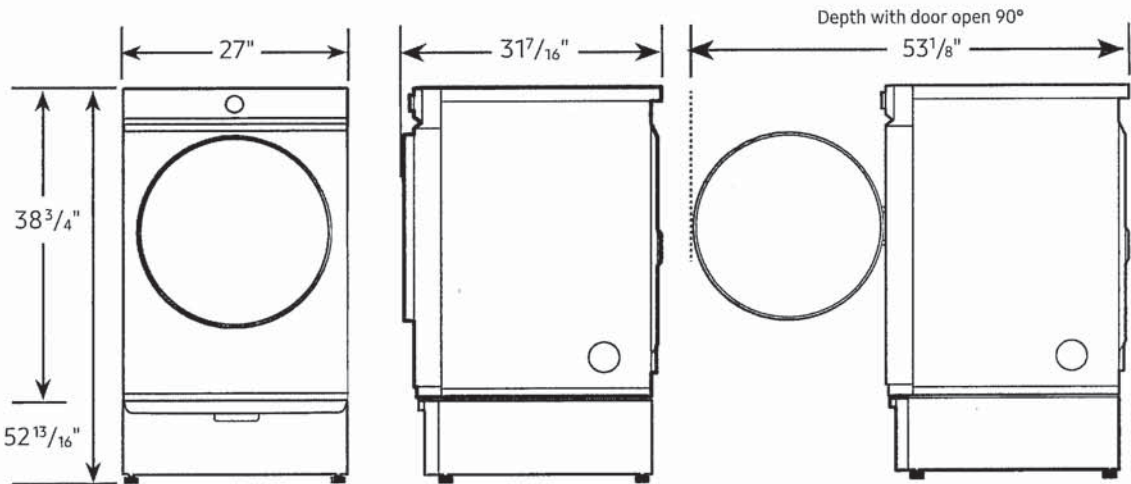

Installation Specifications – Side-by-Side

If the washer and dryer are installed together or the dryer alone, the closet front must have two unobstructed air openings for a combined minimum total area of 72-inch². Your washer alone does not require a specific air opening.

Alcove or closet installation
Minimum clearance for
closet and alcove installations:

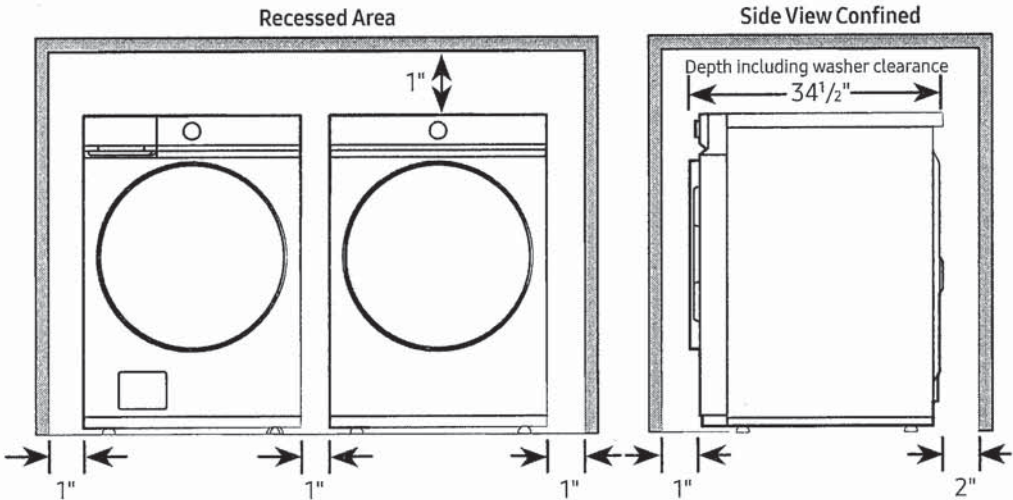

Connection Dimensions

Back and side view of dryer

LEGEND:
● Cold Water Connection

Actual colour may vary. Design, specifications and colour
availability are subject to change without notice.
Non-metric weights and measurements are approximate.

© 2022 Samsung Electronics Canada Inc.
All rights reserved. Samsung is a registered trademark
of Samsung Electronics Co., Ltd., used with permission.

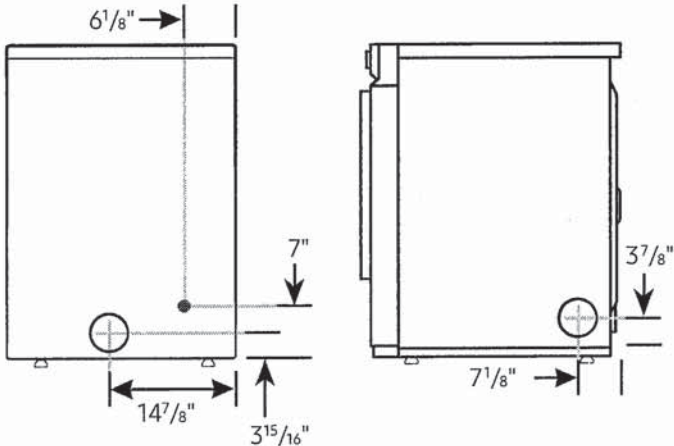

✓

JB

DVE53BB8900

SAMSUNG

Bespoke 7.6 cu. ft. Ultra Capacity Electric Dryer
with AI Optimal Dry and Super Speed Dry

Installation Specifications – Stacked Pair

Clearances indicated are for stacked pairs. The closet front must have two unobstructed air openings for a combined minimum total area of 72-inch².

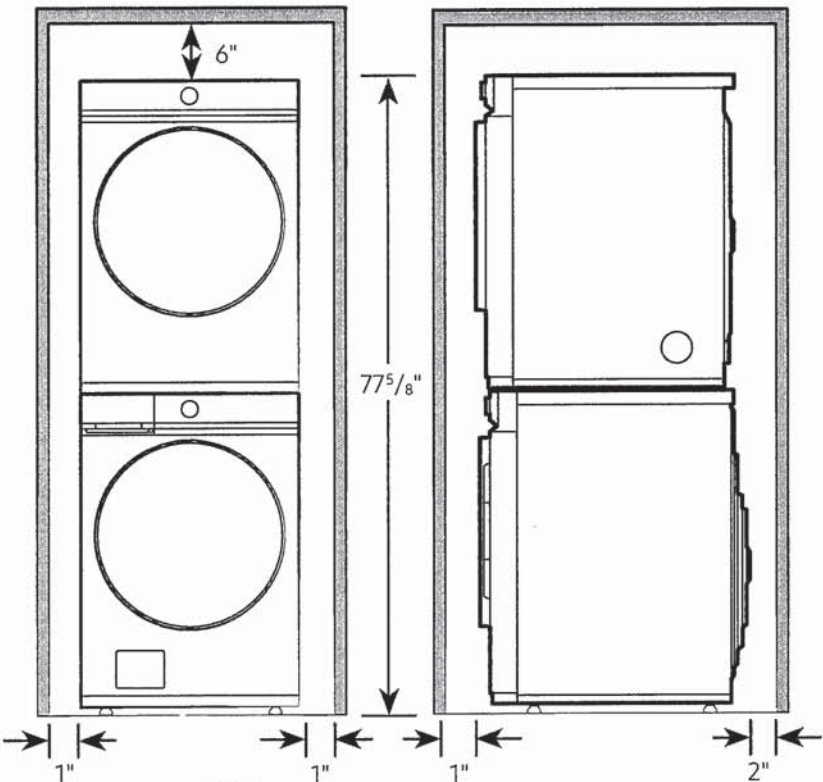

Connection Dimensions

Back and side views of stacked pair

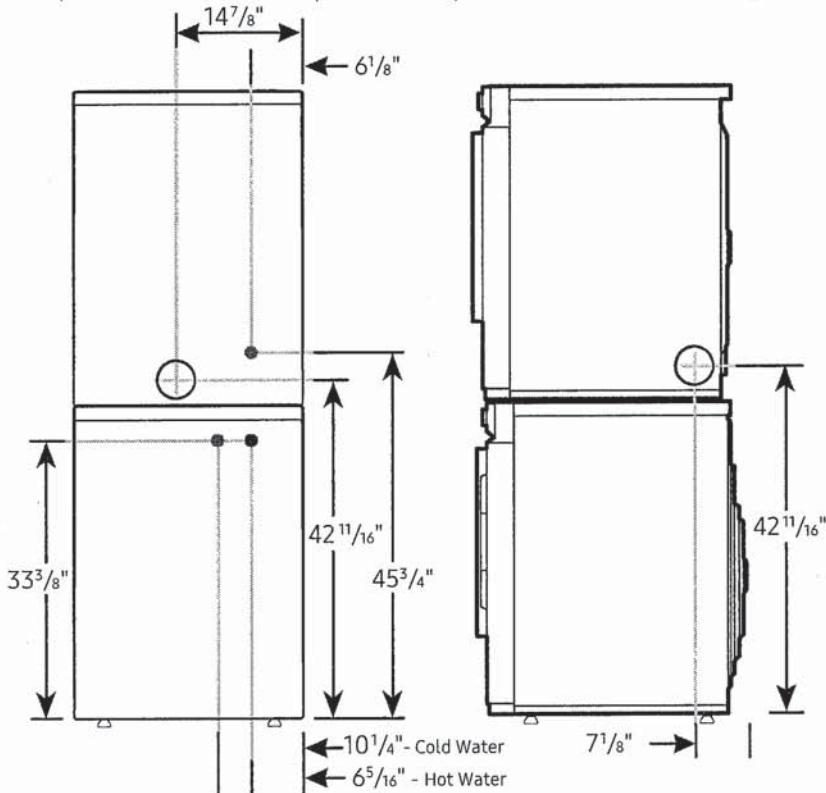

LEGEND:

- Cold Water Connection
- Hot Water Connection

Actual colour may vary. Design, specifications and colour availability are subject to change without notice. Non-metric weights and measurements are approximate.

© 2022 Samsung Electronics Canada Inc.
All rights reserved. Samsung is a registered trademark of Samsung Electronics Co., Ltd., used with permission.

✓

✓