

Sales Selection Sheet  
Checklist

1 of 33

LOT 378    Model: 28-2897 C THE KINGSMERE  
PURCHASERS: S M SHAFUL ULLAH/KHODEZA KASHEM  
VENDOR:        Heathwood Homes (Huron) Limited

- ☐ WOB
- ☐ DECK
- ☐ FINISHED BASEMENT
- ☐ COLD CELLAR

- UPGRADED / MODIFIED ELEVATION
- ☐ CORNER UPGRADE
  - ☐ REAR UPGRADE
  - ☐ SIDE UPGRADE

- CEILING UPGRADE - SMOOTH
- ☐ MAIN FLOOR
  - ☐ SECOND FLOOR
  - ☐ BASEMENT

- ADDITIONAL ROUGH-INS
- ☒ 200 AMP SERVICE (STD IN SINGLES)
  - ☐ WET BAR ROUGH-IN
  - ☐ HUMIDIFIER
  - ☒ AIR CONDITIONING (SITE STD)

- GAS ROUGH-IN
- ☐ STOVE
  - ☐ DRYER
  - ☐ BBQ
  - ☐ ADDITIONAL FIREPLACE

- KITCHEN: HOODFAN VENTING SIZE
- ☒ 6 IN ROUND DUCT
  - ☐ 7 IN ROUND DUCT

FULL BASEMENT STAIRS:	Paint Grade
UPPER BASEMENT STAIRS:	N/A
LOWER LEVEL STAIRS:	N/A
MAIN STAIRS:	All Oak
MEDIA STAIRS (if applicable):	N/A
LOFT STAIRS (if applicable):	N/A

JAN 31/23    Signatures on  
Date    Purchaser:    file

JAN 31/23    SONIA SHARIF  
Date    Decor Consultant:

Date    Purchaser:

~~Signature~~  
-02-01-2023    M. Rosen  
Date    Heathwood Homes (Huron) Limited  
Approved

Locked Date:

S M SHAFUL ULLAH/KHODEZA KASHEM  
Project: Wallaceton  
Unit: 378, Phase: 3  
Model: 28-2897 C THE KINGSMERE

Created: 11/9/2022 13:15:26  
Locked:  
Closed:

Kitchen

Cabinet Colour/Style	9111	Viking III-SIMCOE ORCHID 3DL ***STD***
Island Cabinet Colour/Style	9111	Viking III-SIMCOE ORCHID 3DL ***STD***
Cabinet Hardware	7667	12881-HARDWARE ***STD***
Countertop	8595	Group 2-Quartz-Caesarstone-OCEAN FOAM #6141-3/4 inch with built-up edge ***2***
Island Countertop	8595	Group 2-Quartz-Caesarstone-OCEAN FOAM #6141-3/4 inch with built-up edge ***2***
Countertop Edge	4005	DOUBLE MITRE 1 1/2 INCH ***UPG***

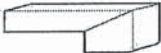

- Please note some islands may require a seam as per manufacturer and fabricator discretions.

Sink	9487	Plumbing-KINDRED Kitchen Sink Collection - Reginox ND1831 U/9-Double (equal size) Bowl Undermount Sink (or equivalent)-Stainless Steel	PG 21
HoodFan	9415	AVH-308CS-AVG 30 inch STAINLESS STEEL CHIMNEY WALL MOUNTED HOODFAN ***UPG***	PG 32-33
Backsplash	1111	N/A *****	
Backsplash Grout	1111	N/A *****	
Backsplash Tile Pattern	1111	N/A *****	
Flooring	7498	Red Oak Pearl-Vintage Engineered-GRYPHON/IRONGATE-3/4 inch x 3 1/4 inch ***8***	
Floor Tile Grout	1111	N/A *****	
Floor Tile Pattern	1111	N/A *****	

- Purchasers have been advised: standard fridge opening is a minimum 37 3/8 x 73 3/8 inches. Ice Waterline Rough-In is included.
- Standard stove opening is 30 inches and standard dishwasher opening is 24 inches. Any gas stove will require backsplash or stainless steel backing to avoid fire hazards.
- Purchasers acknowledge: Heathwood Homes and its contractors will not be responsible for any kitchen cabinet changes due to appliances dimension changes after sign-off.

Comment

SU  
W

Landing and Broom Closet

Flooring	7498	Red Oak Pearl-Vintage Engineered-GRYPHON/IRONGATE-3/4 inch x 3 1/4 inch ***8***
Floor Tile Grout	1111	N/A *****
Floor Tile Pattern	1111	N/A *****



S M SHAIFUL ULLAH/KHODEZA KASHEM  
Project: Wallaceton  
Unit: 378, Phase: 3  
Model: 28-2897 C THE KINGSMERE

Created: 11/9/2022 13:15:29  
Locked:  
Closed:

Comment

Foyer

Flooring

9057

OV.ET.IGY.1224.PL-Eterna-Imperial Grey Polished-12 x 24  
See Tile Direction on Sketch Page \*\*\*5\*\*\*

S 2

Floor Tile Grout

2225

Grout-(27) Silver \*\*\*STD\*\*\*

Floor Tile Pattern

3050

SIDE TO SIDE \*\*\*STD\*\*\*

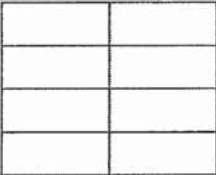

Comment

Powder Room

Flooring

9057

OV.ET.IGY.1224.PL-Eterna-Imperial Grey Polished-12 x 24  
See Tile Direction on Sketch Page \*\*\*5\*\*\*

S 2

Floor Tile Grout

2225

Grout-(27) Silver \*\*\*STD\*\*\*

Floor Tile Pattern

3040

FRONT TO BACK \*\*\*STD\*\*\*

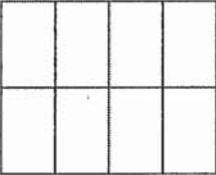

Plumbing Fixture (Colour)

1737

Plumbing Fixtures-WHITE \*\*\*STD\*\*\*

Comment

Dining Room

Flooring

7498

Red Oak Pearl-Vintage  
Engineered-GRYPHON/IRONGATE-3/4 inch x 3 1/4 inch

Comment

Main Hall

Flooring

7498

Red Oak Pearl-Vintage  
Engineered-GRYPHON/IRONGATE-3/4 inch x 3 1/4 inch

Comment

Great/Breakfast

Flooring

7498

Red Oak Pearl-Vintage  
Engineered-GRYPHON/IRONGATE-3/4 inch x 3 1/4 inch

SC  
HK

S M SHAFUL ULLAH/KHODEZA KASHEM  
Project: Wallaceton  
Unit: 378, Phase: 3  
Model: 28-2897 C THE KINGSMERE

Created: 11/9/2022 13:15:29  
Locked:  
Closed:

Comment

Great Room Fireplace

Type	8869	Majestic MERC32 ***STD***
Mantle	8891	NF-17-Paint Grade Mantle- Cabinet (Per Plan)-WHITE ***STD***
Surround (Opt.)	1111	N/A *****

PG 20

- Purchasers have been advised: heat from the FP can damage TV above a FP and items placed on mantle.

- Heathwood and its contractors will not be liable for any damage on items placed/@installed above a FP after closing.

Comment

Mud Room / Laundry

Flooring	9435	TH.CT.DGR.1212.MT-Construct-Dark Grey Matte-12 x 12 STD ***STD***
Floor Tile Grout	2225	Grout-(27) Silver ***STD***
Floor Tile Pattern	3000	STANDARD SQUARE ***STD*** <div><div></div><div></div><div></div><div></div><div></div><div></div><div></div><div></div><div></div></div>
Opt. Cabinet Colour/Style - Uppers	1111	N/A *****
Opt. Cabinet Hardware - Uppers	1111	N/A *****
Opt. Cabinet Colour/Style - Base	1111	N/A *****
Opt. Cabinet Hardware - Base	1111	N/A *****
Opt. Countertop	1111	N/A *****
Opt. Countertop Edge	1111	N/A *****

Comment

Upper Hall

Flooring	9504	87354-MINOTAUR-OVERCAST-40 oz Poly ***STD***
----------	------	--

Comment

Master Bedroom

Flooring	9504	87354-MINOTAUR-OVERCAST-40 oz Poly ***STD***
----------	------	--

Comment

SU  
WU



Customer Colours

S M SHAIFUL ULLAH/KHODEZA KASHEM  
Project: Wallaceton  
Unit: 378, Phase: 3  
Model: 28-2897 C THE KINGSMERE

538

5 of 33

Created: 11/9/2022 13:15:29

Locked:

Closed:

Bedroom 2

Flooring	9504	87354-MINOTAUR-OVERCAST-40 oz Poly ***STD***
Comment		

Bedroom 3

Flooring	9504	87354-MINOTAUR-OVERCAST-40 oz Poly ***STD***
Comment		

Bedroom 4 (Reg. Second Floor)

Flooring	9504	87354-MINOTAUR-OVERCAST-40 oz Poly ***STD***
Comment		

Family Room (Opt. Second Floor)

Flooring	1111	N/A *****
Comment		

Bedroom 5

Flooring	9504	87354-MINOTAUR-OVERCAST-40 oz Poly ***STD***
Comment		

Master Ensuite

Cabinet Colour/Style	6127	Viking I-BELWOOD-ONTARIO WHITE-3DL ***STD***
Cabinet Hardware	7672	135-HARDWARE ***STD***
Countertop	7833	Group 2-Quartz-Caesarstone-ICE SNOW # 9141-3/4 inch with built-up edge ***2***
Countertop Edge	1111	N/A *****
Floor Tile	9115	OV.ET.MGR.1224.PL Eterna Series Medium Grey 12x24 Polished See Tile Direction UPG 5
Floor Tile Grout	2225	Grout-(27) Silver ***STD***
Floor Tile Pattern	3040	FRONT TO BACK ***STD***

S450  
mm

S M SHAIFUL ULLAH/KHODEZA KASHEM  
Project: Wallaceton  
Unit: 378, Phase: 3  
Model: 28-2897 C THE KINGSMERE

Created: 11/3/2022 13:13:29  
Locked:  
Closed:

			<div></div> <div></div>
Shower Wall Tile	9022	QT.WV.TGR.0810-Weave-Tender Grey-8 x 10 ***STD***	
Shower Wall Tile Grout	2226	Grout-(00) White ***STD***	
Shower Wall Tile Pattern	3090	VERTICAL STACKED ***STD***	
			<div></div> <div></div>
Shower Floor Tile	8665	OD.ON.TPE.0202.MT.N-Ontario Series Mosaic-Taupe Matte-2 x 2 ***1***	
Shower Floor Tile Grout	2226	Grout-(00) White ***STD***	
Shower Floor Tile Pattern	3000	STANDARD SQUARE ***STD***	
			<div></div> <div></div>
Shower Jamb(s) and Sill(s)	8923	Shower Jamb / Sill-Thassos White ***STD***	
Plumbing Fixture (colour)	1737	Plumbing Fixtures-WHITE ***STD***	
Comment			

Shared Ensuite

Cabinet Colour/Style	6127	Viking I-BELWOOD-ONTARIO WHITE-3DL ***STD***	
Cabinet Hardware	2098	12801-HARDWARE ***STD***	
Countertop	8801	P-344 LM-Countertop-INUKSHUK GREY-Arborite ***STD***	
Countertop Edge	1111	N/A *****	
Floor Tile	9255	TR.SP.WHITE.1313 SEMPRE White Matte 13 x 13 ***STD***	
Floor Tile Grout	2226	Grout-(00) White ***STD***	
Floor Tile Pattern	3000	STANDARD SQUARE ***STD***	
			<div></div> <div></div>
Shower Wall Tile	9020	QT.WV.WHT.0810-Weave-White-8 x 10 ***STD***	
Shower Wall Tile Grout	2226	Grout-(00) White ***STD***	
Shower Wall Tile Pattern	3090	VERTICAL STACKED ***STD***	
			<div></div> <div></div>

SV  
WH



Customer Colours

S M SHAIFUL ULLAH/KHODEZA KASHEM  
Project: Wallaceton  
Unit: 378, Phase: 3  
Model: 28-2897 C THE KINGSMERE

Created: 11/9/2022 13:15:29  
Locked:  
Closed:

Shower Floor Tile	8661	OD.ON.SWT.0202.MT.N-Ontario Series Mosaic-Snow White Matte-2 x 2 ***STD***									
Shower Floor Tile Grout	2226	Grout-(00) White ***STD***									
Shower Floor Tile Pattern	3000	STANDARD SQUARE ***STD***									
<table border="1"><tr><td></td><td></td><td></td></tr><tr><td></td><td></td><td></td></tr><tr><td></td><td></td><td></td></tr></table>											
Shower Jamb(s) and Sill(s)	8923	Shower Jamb / Sill-Thassos White ***STD***									
Plumbing Fixture (colour)	1737	Plumbing Fixtures-WHITE ***STD***									
Comment											

Ensuite 4 (Reg. Second Floor)

Cabinet Colour/Style	6127	Viking I-BELWOOD-ONTARIO WHITE-3DL ***STD***									
Cabinet Hardware	7672	135-HARDWARE ***STD***									
Countertop	8796	6698-46-Countertop-PALOMA POLAR ETCHINGS FINISH-Formica ***STD***									
Countertop Edge	1111	N/A *****									
Floor Tile	8264	TR.ST.SRK.1313-Serpentine-Syrak/Charcoal-13x13 ***STD***									
Floor Tile Grout	2225	Grout-(27) Silver ***STD***									
Floor Tile Pattern	3000	STANDARD SQUARE ***STD***									
<table border="1"><tr><td></td><td></td><td></td></tr><tr><td></td><td></td><td></td></tr><tr><td></td><td></td><td></td></tr></table>											
Wall Tile	8260	TR.ST.SRK.0810-Serpentine-Syrak/Charcoal-8 x 10 ***STD***									
Wall Tile Grout	2226	Grout-(00) White ***STD***									
Wall Tile Pattern	3090	VERTICAL STACKED ***STD***									
<table border="1"><tr><td></td><td></td><td></td><td></td></tr><tr><td></td><td></td><td></td><td></td></tr></table>											
Opt. Shower Floor Tile	1111	N/A *****									
Opt. Shower Floor Tile Grout	1111	N/A *****									
Opt. Shower Floor Tile Pattern	1111	N/A *****									
Opt. Shower Jamb(s) and Sill(s)	1111	N/A *****									
Plumbing Fixture (colour)	1737	Plumbing Fixtures-WHITE ***STD***									
Comment											

SV  
W

S M SHAFUL ULLAH/KHODEZA KASHEM  
Project: Wallaceton  
Unit: 378, Phase: 3  
Model: 28-2897 C THE KINGSMERE

Created: 11/9/2022 13:15:20  
Locked:  
Closed:

Ensuite 5

Cabinet Colour/Style	6265	Viking III-MANCHESTER-SHALE GREY CL-MAPLE ***STD***
Cabinet Hardware	2098	12801-HARDWARE ***STD***
Countertop	8800	P-345 LM-Countertop-INUKSHUK TAUPE-Arborite ***STD***
Countertop Edge	1111	N/A *****

Floor Tile	5589	GE.BY.PEN.1313 New Byzantine Pentallic (Grey) 13 x13 ***STD***
Floor Tile Grout	2225	Grout-(27) Silver ***STD***
Floor Tile Pattern	3000	STANDARD SQUARE ***STD***

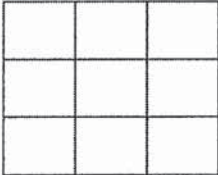

Wall Tile	5411	QT.SP.WHT.0810-Splendour-White-8 inch x 10 inch ***STD***
Wall Tile Grout	2226	Grout-(00) White ***STD***
Wall Tile Pattern	3090	VERTICAL STACKED ***STD***

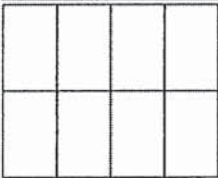

Opt. Shower Floor Tile	1111	N/A *****
Opt. Shower Floor Tile Grout	1111	N/A *****
Opt. Shower Floor Tile Pattern	1111	N/A *****

Opt. Shower Jamb(s) and Sill(s)	1111	N/A *****
Plumbing Fixture (colour)	1737	Plumbing Fixtures-WHITE ***STD***
Comment		

Lower Level Recreation Room (Opt. Finis

Flooring	1111	N/A *****
Comment		

Lower Level Bathroom (Opt. Finished Bas

Cabinet Colour/Style	1111	N/A *****
----------------------	------	-----------

SV  
WU



Customer Colours

S M SHAIFUL ULLAH/KHODEZA KASHEM  
Project: Wallaceton  
Unit: 378, Phase: 3  
Model: 28-2897 C THE KINGSMERE

9 of 33

538

Created: 11/09/2022 13:15:29

Locked:

Closed:

Cabinet Hardware	1111	N/A *****
Countertop	1111	N/A *****
Countertop Edge	1111	N/A *****
Floor Tile	1111	N/A *****
Floor Tile Grout	1111	N/A *****
Floor Tile Pattern	1111	N/A *****
Wall Tile	1111	N/A *****
Wall Tile Grout	1111	N/A *****
Wall Tile Pattern	1111	N/A *****
Opt. Shower Floor Tile	1111	N/A *****
Opt. Shower Floor Tile Grout	1111	N/A *****
Opt. Shower Floor Tile Pattern	1111	N/A *****
Opt. Shower Jamb(s) and Sill(s)	1111	N/A *****
Plumbing Fixture (colour)	1111	N/A *****
Comment		

Main Stairs

Type	1714	Oak Stairs ***STD MAIN STAIRS***
Colour	7912	Irongate (Gryphon) STAIN TO COMPLIMENT HARDWOOD AND WILL VARY FROM FLOORING
Handrail/Pickets/Posts Type	8148	Single Collar Alt. Plain w/ Shoes with 3 1/2? Square/Cap Post(s)-BLACK ***2***
Handrail/Pickets/Posts Colour	7912	Irongate (Gryphon) STAIN TO COMPLIMENT HARDWOOD AND WILL VARY FROM FLOORING
Custom Stain/Paint	1111	N/A *****
Landing(s)	7498	Red Oak Pearl-Vintage Engineered-GRYPHON/IRONGATE-3/4 inch x 3 1/4 inch
Opt. Carpet Runner	1111	N/A *****
Comment		

Customer Colours

S M SHAIFUL ULLAH/KHODEZA KASHEM  
Project: Wallaceton  
Unit: 378, Phase: 3  
Model: 28-2897 C THE KINGSMERE

Created: 11/9/2022 13:15:29  
Locked:  
Closed:

Comment

Lower Level Stairs

Type	1713	Paint Grade Stairs ***STD UNFINISHED BASEMENT STAIR
Colour	1111	N/A *****
Handrail/Pickets/Posts Type	1111	N/A *****
Handrail/Pickets/Posts Colour	1111	N/A *****
Custom Stain/Paint	1111	N/A *****
Landing(s)	1111	N/A *****
Opt. Carpet Runner	1111	N/A *****

Comment

Throughout

Switches and Plug	5796	Decora White Switches and Plugs ***STD***
Thresholds	2232	Metal Thresholds ***STD***
Underpad	1079	500 Series-Underpad ***STD***
Trim Size	8705	4 1/4 Baseboard and 2 3/4 Casings ***STD***
Trim - Paint Colour	1716	Trim-WHITE ***STD***
Walls - Paint Colour	1717	22-Wall-WARM GREY ***STD***

Comment

Purchaser:



S M SHAIFUL ULLAH



Decor Consultant



12/22/22

Date

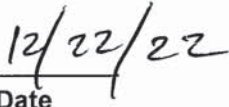

12/22/22

Date

Purchaser:

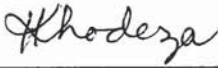

KHODEZA KASHEM



Wallaceton

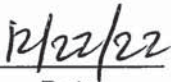

12/22/22

Date



02-01-2023

Date Approved





CONSTRUCTION SUMMARY

**Lot: 378**  
**Model: 28-2897 C THE KINGSMERE**  
**Project/Phase: Wallaceton / 3**

Offer Worksheet	Ten Thousand Dollars (\$10,000) At D?cor. (No Cash Value) Singles Note:
Offer Worksheet	The Purchaser(s) acknowledge that they have NOT been referred by an existing Heathwood Homeowner and therefor are not entitle Note:



CONSTRUCTION SUMMARY

Lot: 378  
Model: 28-2897 C THE KINGSMERE  
Project/Phase: Wallaceton / 3

ADMIN FEE

Invoice	Qty.	Description
---------	------	-------------

APPLIANCES

Invoice	Qty.	Description
1224 345,788 01Feb23	1	KITCHEN - APPLIANCES - AVH-308CS-AVG 30 inch STAINLESS STEEL CHIMNEY WALL MOUNTED HOODFAN ***UPG***  SEE SPECS <b>CABINETRY-delete stove uppers; ELECTRICAL-delete std range hood; HEATING/AIR CONDITIONING-Duct change to 6 in</b>

CABINETRY

Invoice	Qty.	Description
1224 345,788 01Feb23 **	1	KITCHEN - APPLIANCES - AVH-308CS-AVG 30 inch STAINLESS STEEL CHIMNEY WALL MOUNTED HOODFAN ***UPG***  SEE SPECS <b>CABINETRY-delete stove uppers; ELECTRICAL-delete std range hood; HEATING/AIR CONDITIONING-Duct change to 6 in</b>
1224 313,796 01Feb23	2	KITCHEN - B10-Pots and pans drawers (width min. 60cm/max. 90cm) (size subject to floor plan) Viking  ON TWO SIDES OF THE STOVE    SEE SKETCH # 3
1224 346,032 01Feb23 **	1	KITCHEN - HARDWOOD - VINTAGE 3 1/4 IN - KITCHEN - UPG  <b>CABINETRY-Raise Cabinet; CERAMICS-Delete Std Ceramics</b>
1224 343,628 01Feb23	1	- CABINETRY - OPT. LIGHT VALANCE (TRIM ONLY) - VIKING II/III - UPG





CONSTRUCTION SUMMARY

Lot: 378  
Model: 28-2897 C THE KINGSMERE  
Project/Phase: Wallaceton / 3

CERAMICS

Invoice	Qty.	Description
1224 345,515 01Feb23	1	- CERAMICS - FOYER FLOOR - UPG 5
1224 345,516 01Feb23	1	- CERAMICS - POWDER FLOOR - UPG 5
1224 346,032 01Feb23 **	1	KITCHEN - HARDWOOD - VINTAGE 3 1/4 IN - KITCHEN - UPG  <b>CABINETRY-Raise Cabinet; CERAMICS-Delete Std Ceramics</b>
1224 345,522 01Feb23	1	- CERAMICS - M.ENS BATH FLOOR - UPG 5
1224 346,033 01Feb23 **	1	KITCHEN / HALL CLOSET - HARDWOOD - VINTAGE 3 1/4 IN - KITCHEN / HALL CLOSET - UPG  <b>CERAMICS-Delete Std Ceramics</b>
1224 345,421 01Feb23	1	- CERAMICS - MASTER SHOWER FLOOR - UPG 1

ELECTRICAL

Invoice	Qty.	Description
1224 345,788 01Feb23 **	1	KITCHEN - APPLIANCES - AVH-308CS-AVG 30 inch STAINLESS STEEL CHIMNEY WALL MOUNTED HOODFAN ***UPG***  SEE SPECS <b>CABINETRY-delete stove uppers; ELECTRICAL-delete std range hood; HEATING/AIR CONDITIONING-Duct change to 6 in</b>
1224 314,224 01Feb23	1	GREAT ROOM - ELECTRICAL - CEILING ROUGH-IN (CAPPED) INCLUDING SWITCH  TO BE CENTERED +/- IN GREAT ROOM ON A SEPARATE SWITCH SKETCH # 2
1224 314,224 01Feb23	1	KITCHEN - ELECTRICAL - CEILING ROUGH-IN (CAPPED) INCLUDING SWITCH  +/- CENTERED ABOVE THE BREAKFAST COUNTER ON A SEPARATE SWITCH SKETCH # 2
1224 314,232 01Feb23	1	GREAT ROOM - ELECTRICAL - EXTRA WALL INTERIOR OUTLET ON EXISTING CIRCUIT (DOES NOT INCLUDE KITCHEN OUTLETS)  PLUG ABOVE THE FIREPLACE, +/- CENTERED, +/- 70" FROM FLOOR SKETCH # 2



CONSTRUCTION SUMMARY

Lot: 378  
Model: 28-2897 C THE KINGSMERE  
Project/Phase: Wallaceton / 3

GRANITE

Invoice	Qty.	Description
1224 343,168 01Feb23	1	- GRANITE - KITCHEN / ISLAND - GROUP 2 - UPG
1224 343,169 01Feb23	1	- GRANITE - COUNTERTOP WITH 4 IN BACKSPLASH - MASTER ENSUITE - GROUP 2 - UPG

HARDWOOD

Invoice	Qty.	Description
1224 346,032 01Feb23	1	KITCHEN - HARDWOOD - VINTAGE 3 1/4 IN - KITCHEN - UPG  CABINETRY-Raise Cabinet; CERAMICS-Delete Std Ceramics
1224 346,033 01Feb23	1	KITCHEN / HALL CLOSET - HARDWOOD - VINTAGE 3 1/4 IN - KITCHEN / HALL CLOSET - UPG  CERAMICS-Delete Std Ceramics

HEATING / AIR CONDITIONING

Invoice	Qty.	Description
1224 345,788 01Feb23 **	1	KITCHEN - APPLIANCES - AVH-308CS-AVG 30 inch STAINLESS STEEL CHIMNEY WALL MOUNTED HOODFAN ***UPG***  SEE SPECS CABINETRY-delete stove uppers; ELECTRICAL-delete std range hood; HEATING/AIR CONDITIONING-Duct change to 6 in

INTERIOR RAILINGS

Invoice	Qty.	Description
1224 345,767 01Feb23	1	- Interior Railings - BLACK METAL - SINGLE COLLAR ALT. PLAIN W/ SHOES WITH 3 1/2? SQUARE/CAP POST(S) AS PER PLAN - MAIN AND 2ND FLOOR - UPG  PAINTING-Notify

PAINTING

Invoice	Qty.	Description
1224 345,767 01Feb23 **	1	- Interior Railings - BLACK METAL - SINGLE COLLAR ALT. PLAIN W/ SHOES WITH 3 1/2? SQUARE/CAP POST(S) AS PER PLAN - MAIN AND 2ND FLOOR - UPG  PAINTING-Notify

STRUCTURED WIRING

Invoice	Qty.	Description
1224 314,552 01Feb23	1	GREAT ROOM - STRUCTURED WIRING - UPGRADE STANDARD CAT5E TO CAT6  RELOCATE STANDARD RG6 CABLE R/I TO BE CENTERED ABOVE FIREPLACE MANTLE 70" FROM FLOOR +/- SKETCH # 2



THE KINGSMERE

ELEVATION C | 2,894 SQ. FT.

922 sq. ft. of opt. finished Lower Level

WALLACETON  
EST. 1870

28-2897 ELEV. C

Sketch #1

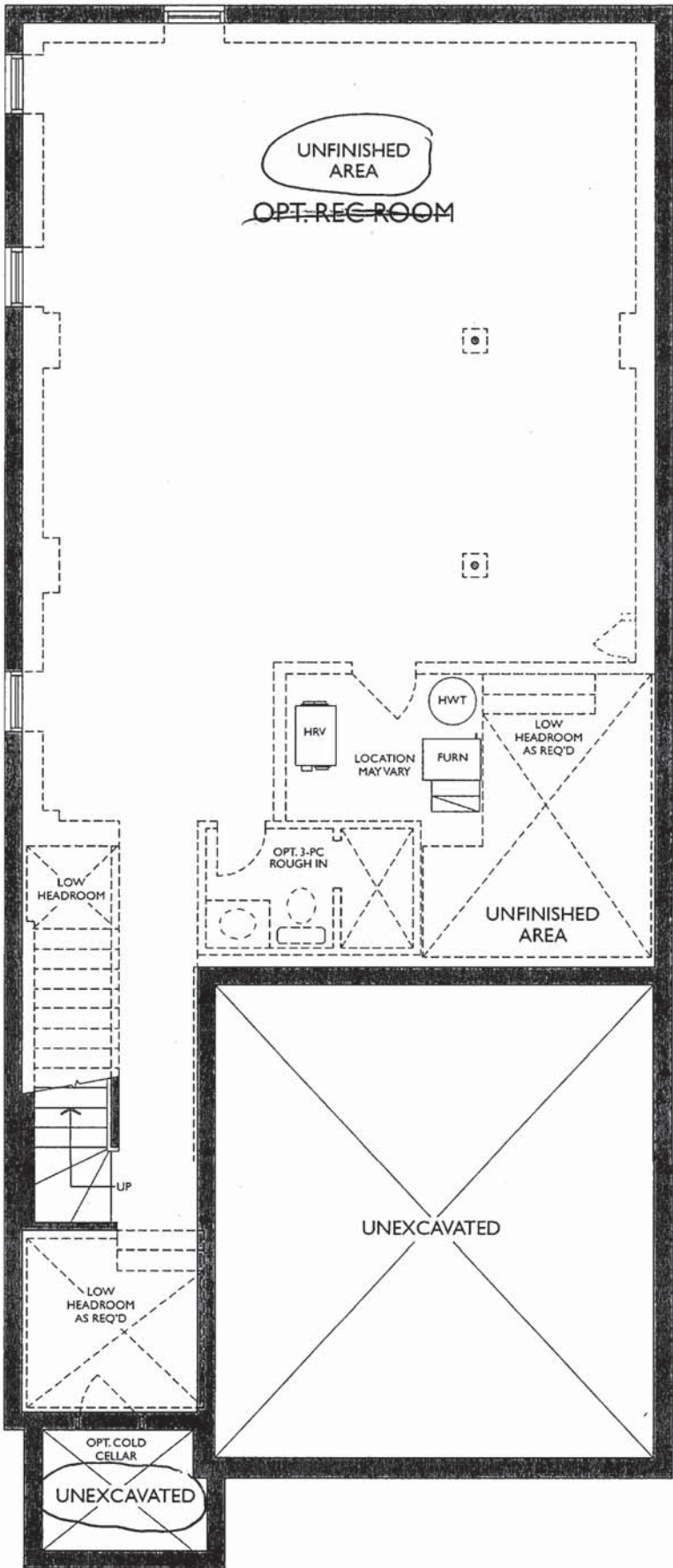

SW  
ME

THE KINGSMERE

ELEVATION C | 2,894 SQ. FT.  
922 sq. ft. of opt. finished Lower Level

WALLACETON

EST. 1870

CEILING ROUGH-IN (CAPPED) ON SEPARATE SWITCH  
CENTERED +/- IN GREAT ROOM

Sketch #2

28-2897 ELEV. C

PLUG ABOVE THE  
FIREPLACE, +/- CENTERED,  
+/- 70" FROM FLOOR

RELOCATE STANDARD RG6  
CABLE R/I TO BE CENTERED  
ABOVE FIREPLACE  
MANTLE 70" FROM FLOOR +/-

CEILING ROUGH-IN  
(CAPPED) ON SEPARATE  
SWITCH +/- CENTERED  
ABOVE THE BREAKFAST  
COUNTER

12 x 24 TILE INSTALL  
DIRECTION

12 x 24 TILE  
INSTALL  
DIRECTION

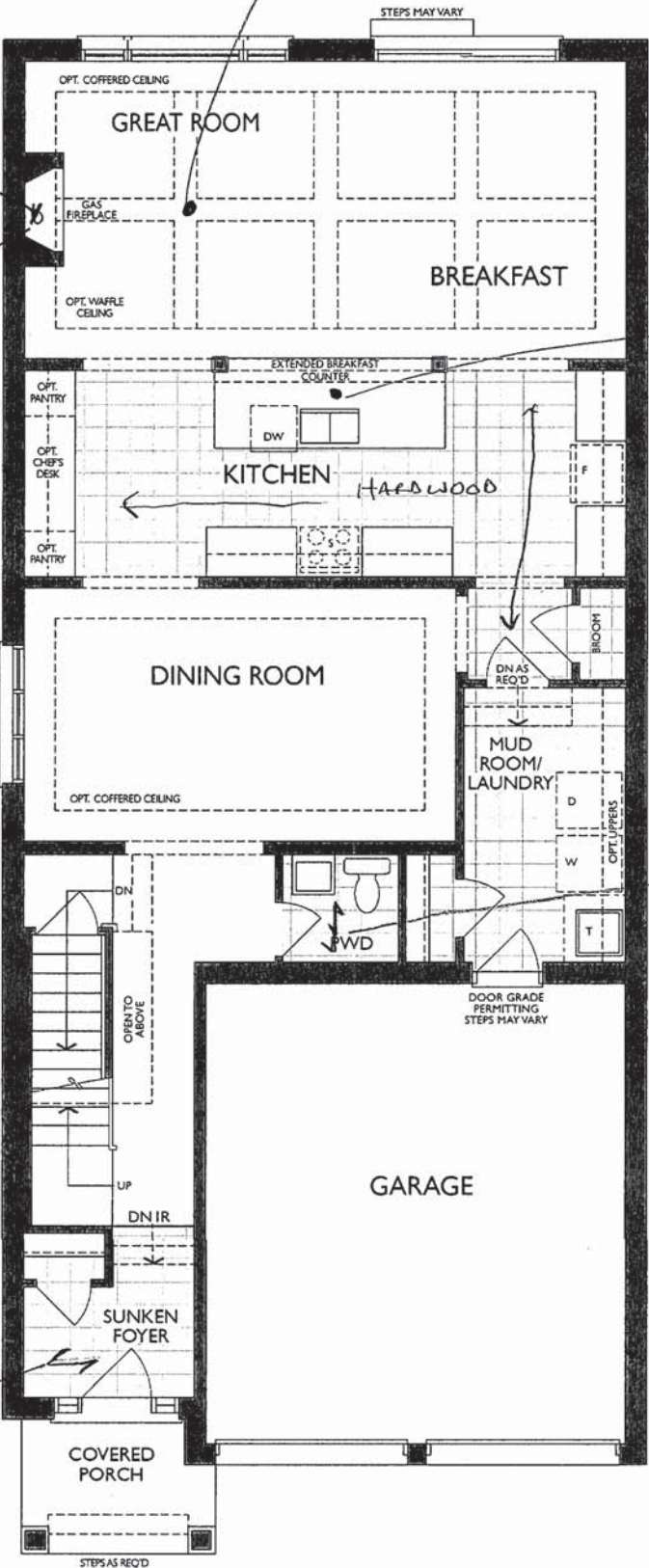

MAIN FLOOR  
ELEVATION C

SV  
um



KITCHEN  
(GROUND FLOOR)

17 of 33

Project: Wallaceton  
Unit: 378, Phase: 3  
Model: 28-2897 C THE KINGSMERE

Sketch #3

30" CHIMNEY  
HOOD/FAN

2 SETS  
POTS AND  
PANS ON  
BOTH  
SIDES OF  
COOKTOP

OPT. LIGHT VALANCE (TRIM ONLY)

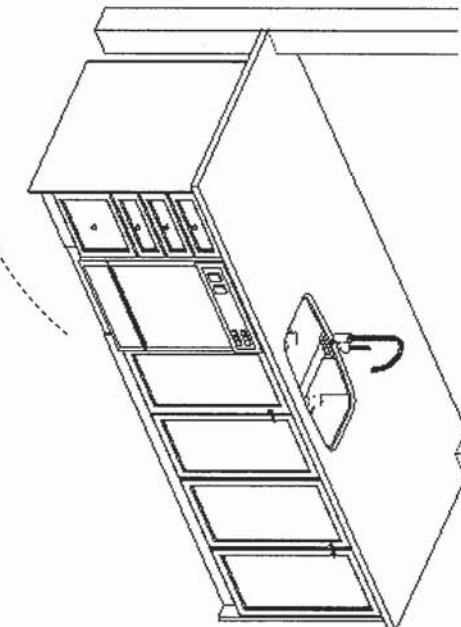
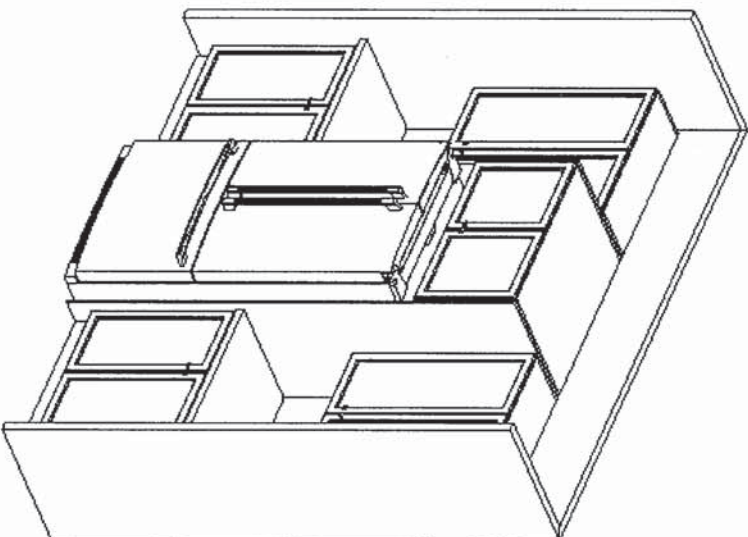

F R E N D E L  
K I T C H E N S L I M I T E D  
1350 Showson Drive, Mississauga, ON L4W 1C5

HEATHWOOD HOMES  
WALLACETON, KITCHENER ON  
MODEL: 28-2897 (3404)

STANDARD CONTRACT INCLUDES:

Appliance Openings

- Hood Opening: 30"W Builder hood
- Fridge Opening: 37 3/8 "W X 73 3/8"
- Fridge cabinet & gables: 66cm Deep
- Stove Opening: 30" Freestanding
- Dishwasher Opening: 24"

Standard Kitchens Scope:

- 100cm H wall cabinets
- Std. Blumotion Hinges- **soft close**
- Std. Metabox Drawers- **not soft close**
- Min 40cm W drawer
- Base pie cut corner cabinets
- Backing on all cabinets
- Countertop by others
- Upgrade applied paneled fridge & dishwashers supply only (appliance hardware by others)

Standard Vanity & Laundry Scope:

- Powder by others, pedestal
- Master Ens. – Top by others
- Remaining vanities inc. laminate top
- Std. Blum Hinges- **not soft close**
- Std. Metabox Drawers- **not soft close**
- Master Ens: Top drawers(Sink Full height)
- Mains: Full height doors (top drawers added if Masters can't accommodate)
- Optional laundry base & wall cabinets

9/20/2022

SV  
W

THIS DRAWING IS FOR DESIGN PURPOSES ONLY.  
IT IS NOT AN EXACT RENDITION.



Sketch # 4

ELEVATION C | 2,894 SQ. FT.  
922 sq. ft. of opt. finished Lower Level

28-2897 ELEV. C

WALLACETON  
EST. 1870

12 x 24 TILE  
INSTALL  
DIRECTION

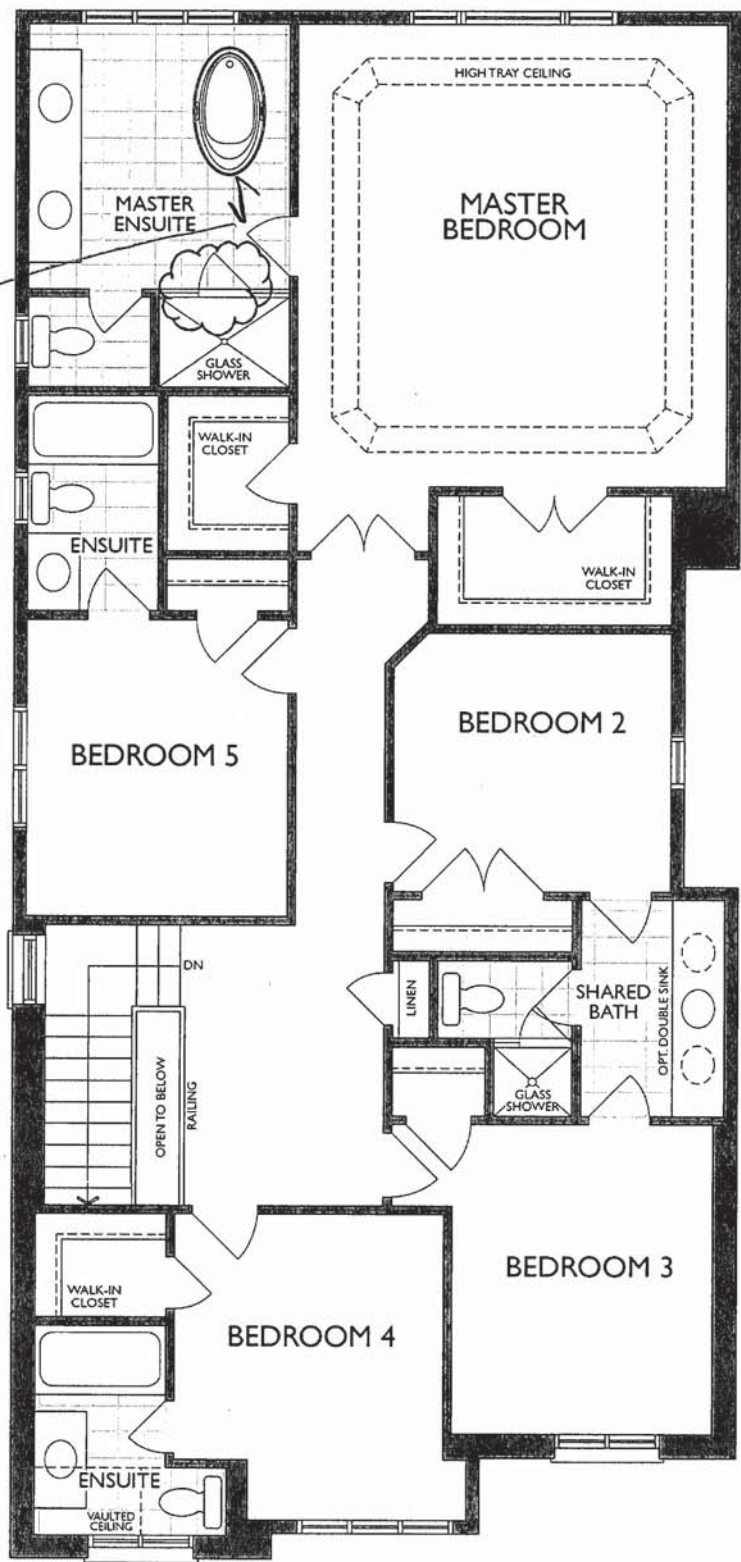

SECOND FLOOR  
ELEVATION C

\*Master Ensuite Shower Door Swing Changed

SV M

(3404) STANDARD 2ND FLOOR

MASTER ENSUITE

(2ND FLR – ELEV: A, B, C)

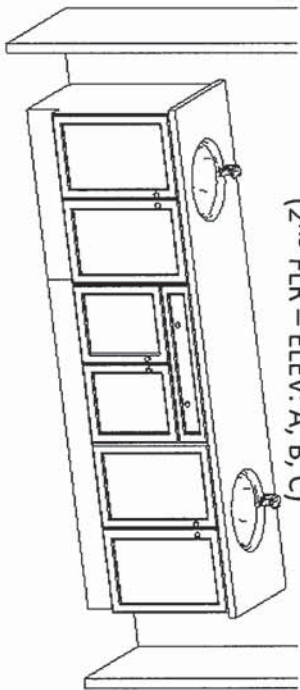

ENSUITE 3

(2ND FLR - ELEV: A, B, C)

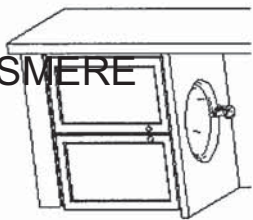

SHARED ENSUITE

(2ND FLR - ELEV: A, B, C)

(OPT-DBL SINK)

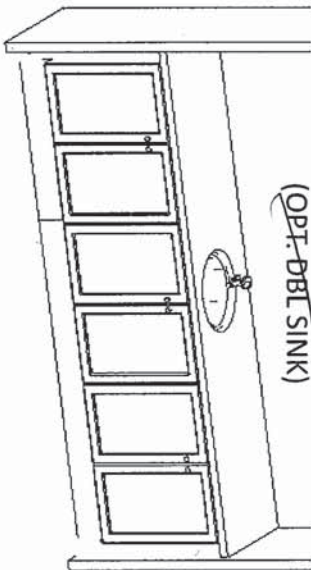

LAUNDRY

(GROUND FLOOR)

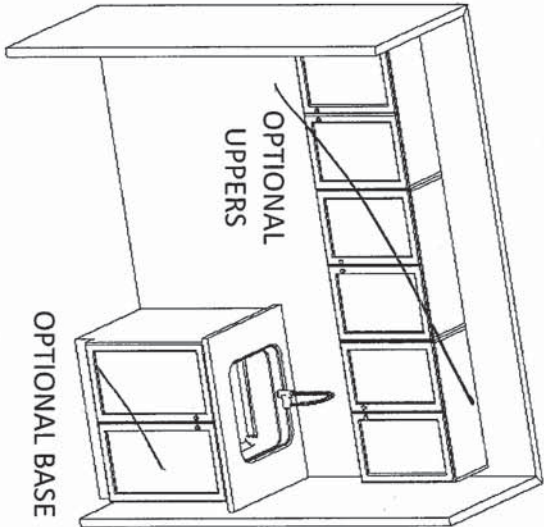

ENSUITE 2

(2ND FLR – ELEV: A)

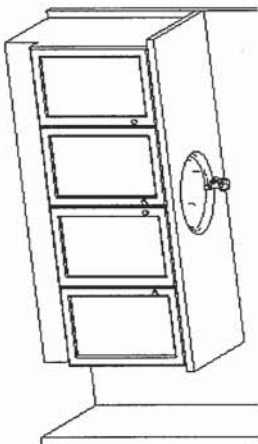

(2ND FLR – ELEV: B, C)

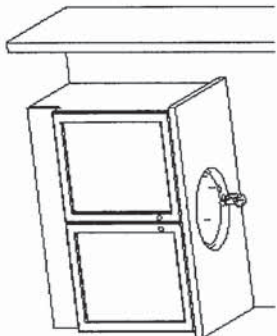

OR

OPT. BASEMENT BATH

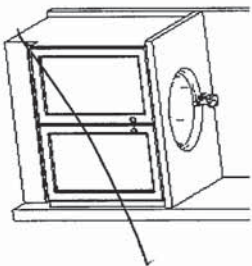

F R E N D E L  
K I T C H E N S L I M I T E D

1350 Shawson Drive, Mississauga, ON L4W 1C5

HEATHWOOD HOMES  
WALLACETON, KITCHENER ON  
MODEL: 28-2897 (3404)

STANDARD CONTRACT INCLUDES:

Appliance Openings

- Hood Opening: 30"W Builder hood
- Fridge Opening: 37 3/8 "W X 73 3/8"
- Fridge cabinet & gables: 66cm Deep
- Stove Opening: 30" Freestanding
- Dishwasher Opening: 24"

Standard Kitchens Scope:

- 100cm H wall cabinets
- Std. Blumotion Hinges- **soft close**
- Std. Metabox Drawers- **not soft close**
- Min 40cm W drawer
- Base pie cut corner cabinets
- Backing on all cabinets
- Countertop by others
- Upgrade applied paneled fridge & dishwashers supply only (appliance hardware by others)

Standard Vanity & Laundry Scope:

- Powder by others, pedestal
- Master Ens. – Top by others
- Remaining vanities inc. laminate top
- Std. Blum Hinges- **not soft close**
- Std. Metabox Drawers- **not soft close**
- Master Ens: Top drawers(sink Full height)
- Mains: Full height doors (top drawers added if Masters can't accommodate)
- Optional laundry base & wall cabinets

Sketch #5



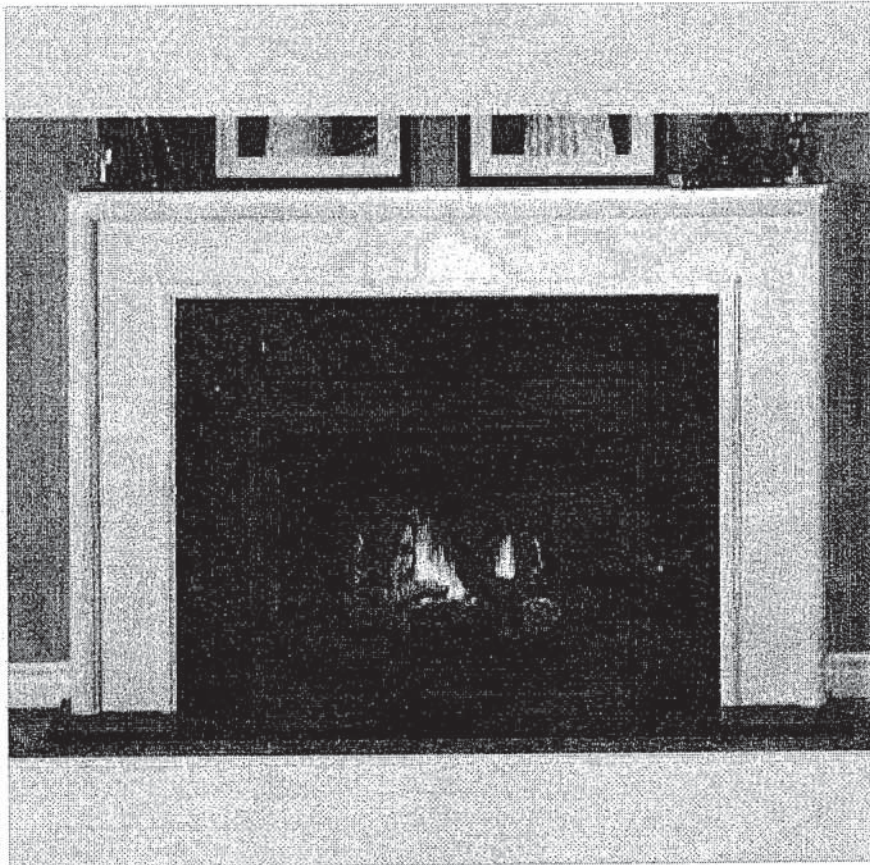

NEAS NF17 Mantel

SV  
W



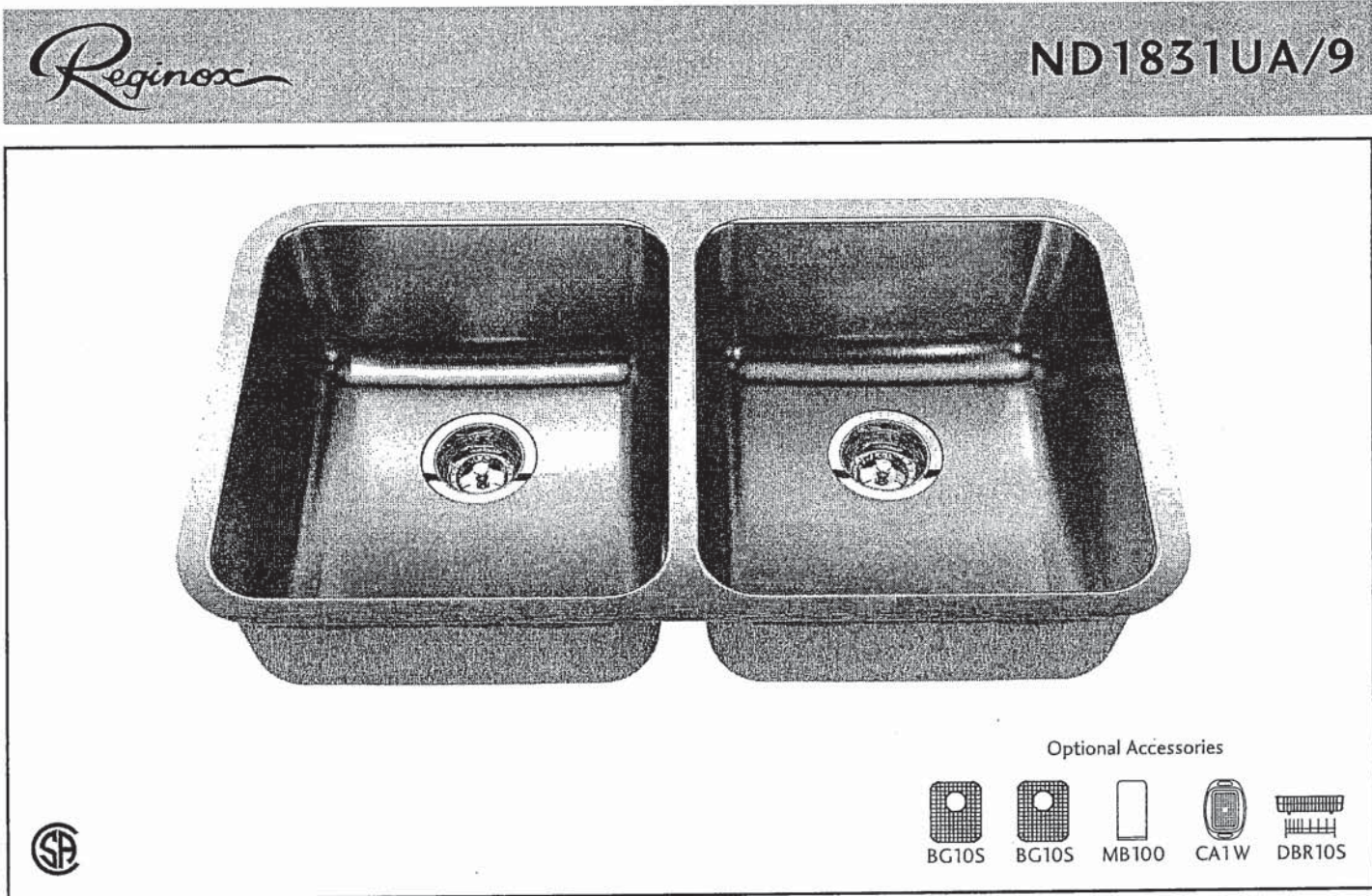



There is more than 1 version of this model.  
Page down to identify the version you have.

FAUCET DESCRIPTION

- Reflex™ pulldown system offers smooth operation, easy movement and secure docking
- Power Clean™ spray technology
- Metal construction with various finishes identified by suffix
- Duralock™ connect installation
- Pulldown spray with 68" braided hose
- Flexible supply lines with 3/8" compression fittings
- High arc spout provides height and reach to fill or clean large pots while pulldown wand provides the maneuverability for cleaning or rinsing
- 360° rotating spout
- Faucet designed for handle to be mounted on right side only

OPERATION

- Lever style handle
- Temperature controlled by 100° arc of handle travel
- Operates with less than 5 lbs. of force
- Operates in stream or spray mode in the pullout or retracted position

FLOW

- Flow is limited to 1.5 gpm (5.7 L/min) max at 60 psi

CARTRIDGE

- 1255™ Duralast™ cartridge

STANDARDS

- Third party certified to IAPMO Green, ASME A112.18.1/CSA B125.1 and all applicable requirements therein including NSF 61/9G & 372
- Meets CalGreen and Georgia SB370 requirements
- Complies with California Proposition 65 and with the Federal Safe Drinking Water Act
- The backflow protection system in the device consists of two independently operating check valves, a primary and a secondary which prevent backflow

- ADA  for lever handle

WARRANTY

- Lifetime limited warranty against leaks, drips and finish defects to the original homeowner
  - 10 year limited warranty when used in a multifamily installation
  - 5 year limited warranty when used in a commercial installation
- Visit [www.moen.com/support](http://www.moen.com/support) for complete details and limitations

Specifications

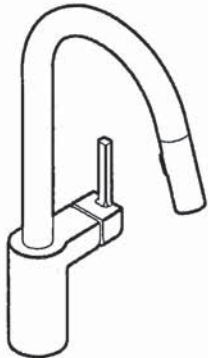

**ALIGN™**  
Single Handle High Arc  
Pulldown Kitchen Faucet

Models: 7565 series

**NOTE:** THIS FAUCET IS DESIGNED TO BE INSTALLED  
THROUGH 1 HOLE, 1-1/2" (38mm) MIN. DIA.  
(OPTIONAL 3-HOLE ESCUTCHEON 141002 AVAILABLE)

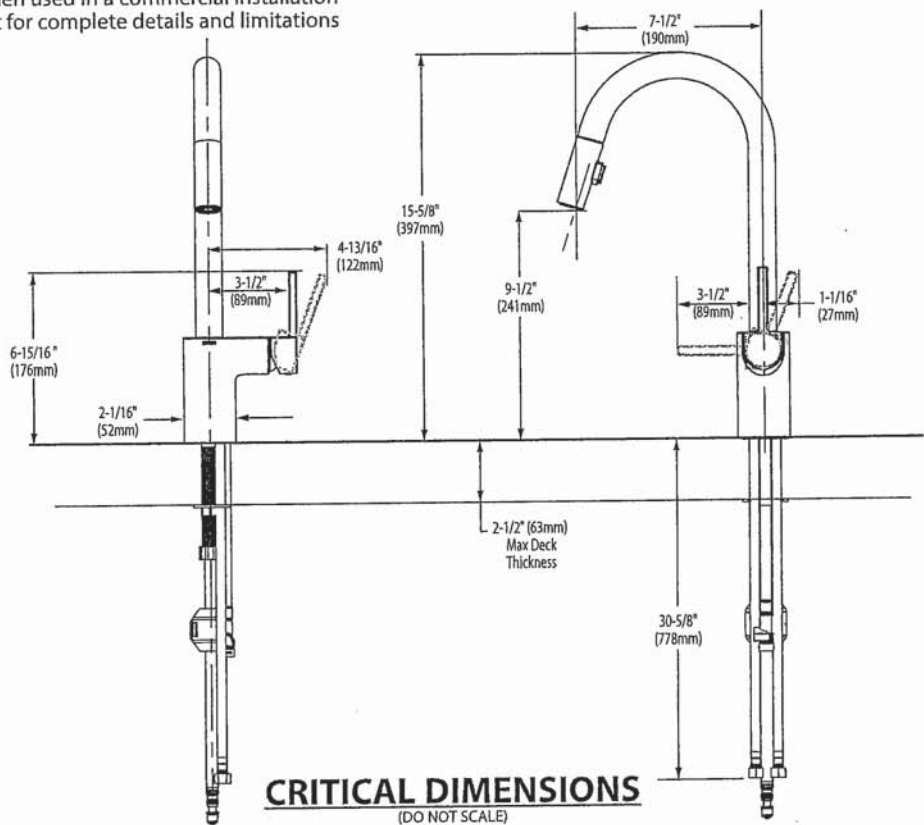

SW  
WU





BARRIER FREE (ABOVE COUNTER OR DROP-IN ONLY)

**BOULEVARD®**  
**PEDESTAL SINK**  
VITREOUS CHINA

**BOULEVARD® PEDESTAL SINK**

- STD ☒ **0641.800** Faucet holes on 8" (203mm) centers (Illustrated)
- ☒ **0641.400** Faucet holes on 4" (102mm) centers
- ☐ **0641.100** Center hole only
- Classic styled rectangular pedestal lavatory
  - Vitreous china
  - Rear overflow
  - Supplied with mounting kit
  - Right Height® for greater comfort during use
  - Faucet ledge with large deck area (faucet not included)
  - **Design coordinates with Boulevard® Toilet**
  - Basin has flat bottom to also allow use as an **above counter** sink or a **drop-in** sink (with u-shaped cut out)

**Nominal Dimensions:**

24" x 19" x 35-1/2"  
(610 x 483 x 902mm)

- ☐ **0641.008** Pedestal top-8" (203mm) centers
- ☐ **0641.004** Pedestal top-4" (102mm) centers
- ☐ **0641.001** Pedestal top-center hole only
- ☐ **0010.000** Pedestal only

**Bowl sizes:**

17" (432mm) wide,  
12-1/2" (318mm) front to back,  
5" (127mm) deep

**Compliance Certifications -**

**Meets or Exceeds the Following Specifications:**

- ASME A112.19.2 - 2008/CSA B45.1-08

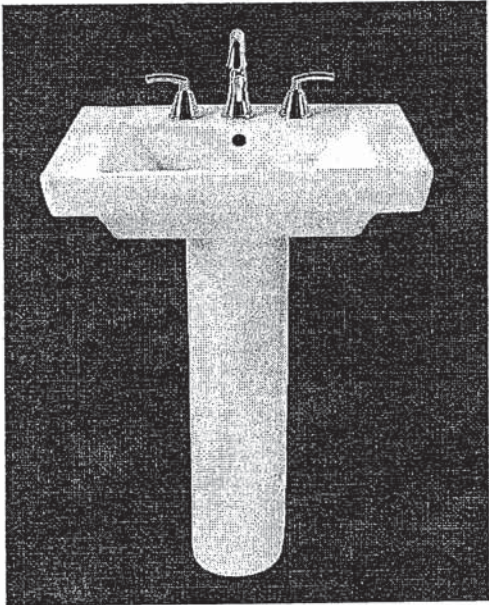

SEE REVERSE FOR ROUGHING-IN DIMENSIONS

**To Be Specified:**

- ☐ Color: ☐ White ☐ Linen
- ☐ Faucet Finish:
- ☐ Supplies:
- ☐ 1-1/4" Trap:
- ☐ Nipple:

\* See faucet section for additional models available

SV  
ML



*American Standard*

Style That Works Better

 BARRIER FREE

**OVALYN™**  
**UNDERCOUNTER SINK**  
VITREOUS CHINA

**OVALYN™ UNDERCOUNTER SINK**

- Classic oval undermount sink
- Made from vitreous china
- Front overflow
- Supplied with mounting kit (047194-0070A) and template

- ☐ **0495.221 Unglazed rim**  
435 x 359mm  
(17-1/8" x 14-1/8")
- ☐ **0495.300 Glazed underside**

**Bowl size:**  
382mm (15-1/16") wide  
306mm (12-1/16") front to back  
140mm (5-1/2") deep

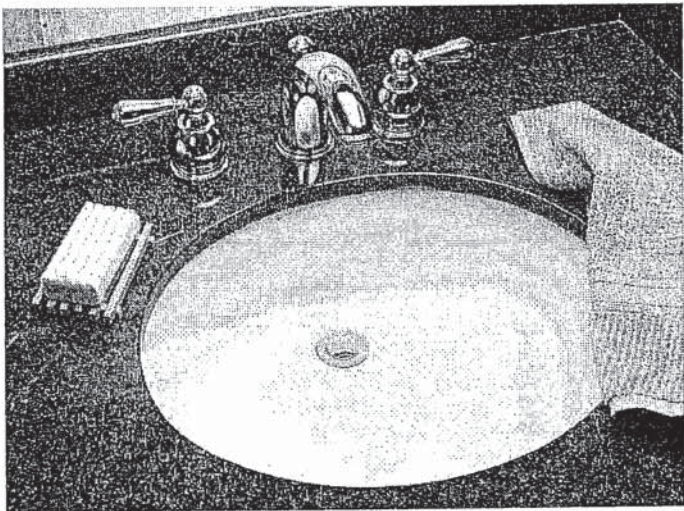

- ☐ **0496.221 Unglazed rim**  
489 x 413mm  
(19-1/4" x 16-1/4")
- ☐ **0496.300 Glazed underside**

**Bowl size:**  
432mm (17") wide  
356mm (14") front to back  
140mm (5-1/2") deep

- ☐ **0497.221 Unglazed rim**  
546 x 441mm  
(21-1/2" x 17-3/8")
- ☐ **0497.300 Glazed underside**

**Bowl size:**  
483mm (19") wide  
391mm (15-3/8") front to back  
140mm (5-1/2") deep

- Compliance Certifications -**  
**Meets or Exceeds the Following Specifications:**
- ASME A112.19.2M for Vitreous China Fixtures
  - CAN/CSA B45 series

**To Be Specified:**

- ☐ Color: ☐ White ☐ Bone ☐ Linen  
☐ Silver ☐ Fawn Beige ☐ Black
- ☐ Faucet\*:
- ☐ Faucet Finish:
- ☐ Supplies:
- ☐ 1-1/4" Trap:

\* See faucet section for additional models available

STD Master Ensuite Undermount SINGLES

SEE REVERSE FOR ROUGHING-IN DIMENSIONS

SV  
W

American Standard

Style That Works Better

BARRIER FREE

OVALYN™  
UNDERCOUNTER SINK  
VITREOUS CHINA

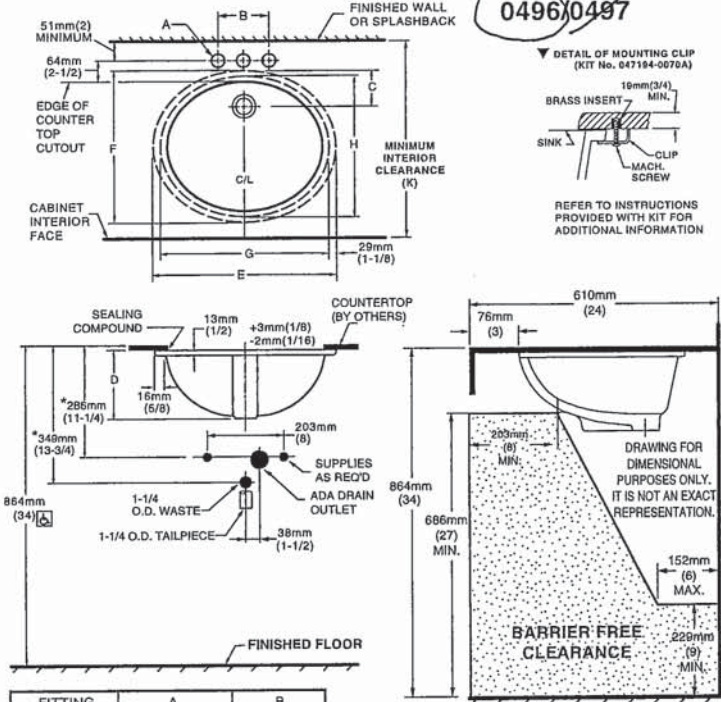

FITTING	A	B
CENTERSET	1-1/4 (32mm)	4 (102mm)
SPREAD	1-3/8 (35mm)	8 (203mm)

CAT. NO.	E	F	G	H	C	D	J	K
0496.221	489mm (19-1/4)	413mm (16-1/4)	432mm (17)	356mm (14)	103mm (4-1/16)	182mm (7-3/16)	16mm (5/8)	500mm (19-11/16)
0497.221	546mm (21-1/2)	441mm (17-3/8)	483mm (19)	391mm (15-3/8)	95mm (3-3/4)	191mm (7-1/2)	19mm (3/4)	534mm (21-1/16)

NOTES:  
\* DIMENSIONS SHOWN FOR LOCATION OF SUPPLIED AND "P" TRAP ARE SUGGESTED.  
▼ UNDERCOUNTER MOUNTING KIT SUPPLIED WITH SINK.  
**PLEASE NOTE MINIMUM INTERIOR CLEARANCE DIMENSION (K).** FITTINGS NOT INCLUDED AND MUST BE ORDERED SEPARATELY. USE ENCLOSED TEMPLATE FOR COUNTERTOP CUTOUT SEALING COMPOUND SUPPLIED BY OTHERS.  
**IMPORTANT:** Dimensions of fixtures are nominal and may vary within the range of tolerances established by ANSI Standard A112.19.2. These measurements are subject to change or cancellation. No responsibility is assumed for use of superseded or voided pages.

MEETS THE AMERICANS WITH DISABILITIES ACT GUIDELINES AND ANSI A117.1 ACCESSIBLE AND USEABLE BUILDINGS AND FACILITIES - CHECK LOCAL CODES.  
Countertop 864mm (34") from finished floor. Lavatory installed 76mm (3") from front edge of countertop. Countertop thickness to be 25mm (1") maximum.

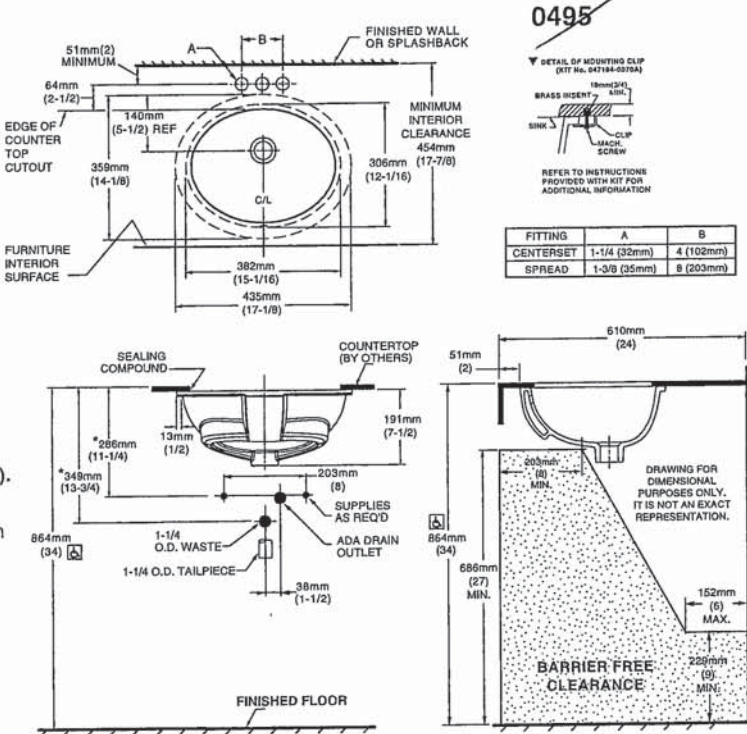

NOTES:  
USE ENCLOSED TEMPLATE FOR COUNTER TOP CUTOUT. FITTINGS NOT INCLUDED WITH FIXTURE AND MUST BE ORDERED SEPARATELY.  
\* DIMENSIONS SHOWN FOR LOCATION OF SUPPLIED AND "P" TRAP ARE SUGGESTED.  
▼ UNDERCOUNTER MOUNTING KIT SUPPLIED WITH SINK.  
**PLEASE NOTE MINIMUM INTERIOR CLEARANCE DIMENSION (K).** SEALING COMPOUND SUPPLIED BY OTHERS.

**IMPORTANT:** Dimensions of fixtures are nominal and may vary within the range of tolerances established by ANSI Standard A112.19.2. These measurements are subject to change or cancellation. No responsibility is assumed for use of superseded or voided pages

MEETS THE AMERICANS WITH DISABILITIES ACT GUIDELINES AND ANSI A117.1 ACCESSIBLE AND USEABLE BUILDINGS AND FACILITIES - CHECK LOCAL CODES.  
Countertop 864mm (34") from finished floor. Lavatory installed 51mm (2") from front edge of countertop. Countertop thickness to be 25mm (1") maximum.

SV  
hu





BARRIER FREE

COLONY™  
COUNTERTOP SINK  
VITREOUS CHINA

COLONY COUNTERTOP SINK

- Vitreous china
- Self-rimming
- Front overflow
- Supplied with template
- Faucet deck  
(Faucet shown not included)

- ☐ 0346 803  
Faucet holes on 203mm (8") centres
- ☒ 0346 403 (Illustrated)  
Faucet holes on 102mm (4") centres
- ☐ 0346 001  
Centre hole only

Nominal Dimensions:  
521 x 448mm (20-1/2" x 17-5/8")

Bowl sizes:  
422mm (16-5/8") wide, 279mm (11") front to back, 143mm (5-5/8") deep

COMPLIANCE CERTIFICATIONS –  
Meets or exceeds the following Specifications:  
• ASME A112.19.2M for Vitreous China Fixtures.  
• CAN/CSA B45 Series.

- To Be Specified
- ☐ Colour: ☐ White ☐ Bone ☐ Silver Gray ☐ Linen
  - ☐ Faucet\*:
  - ☐ Faucet Finish:
  - ☐ Supplies & Stops:
  - ☐ Trap 1-1/4" (32 mm):

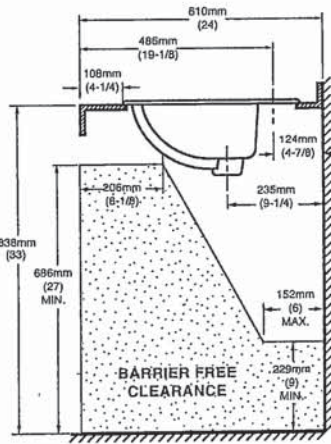
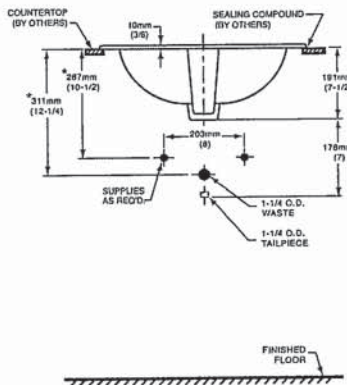
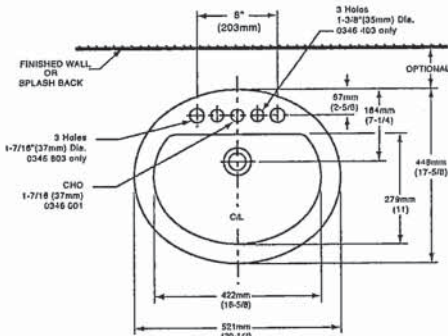
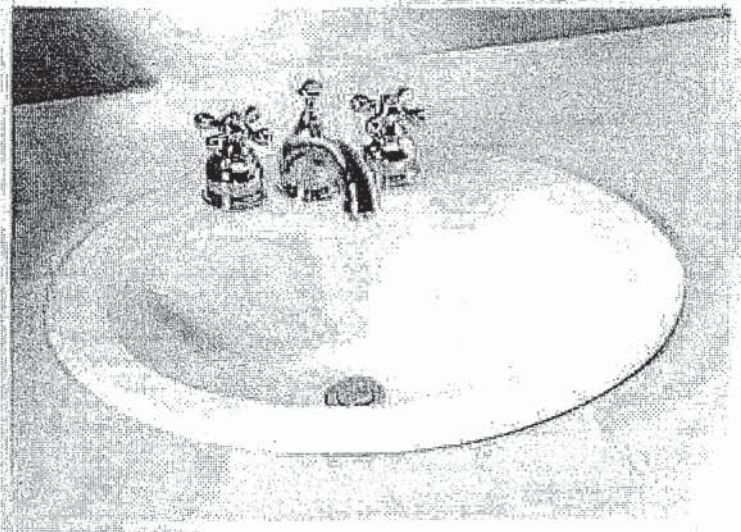

NOTES:  
\* DIMENSIONS SHOWN FOR LOCATION OF SUPPLIES AND "P" TRAP ARE SUGGESTED. FOR COUNTERTOP CUTOUT AND INSTALLATION INSTRUCTIONS USE TEMPLATE SUPPLIED WITH SINK.  
FAUCETS NOT INCLUDED AND MUST BE ORDERED SEPARATELY.  
IMPORTANT: Dimensions of fixtures are nominal and may vary within the range of tolerances established by ANSI Standard A112.19.2.  
These measurements are subject to change or cancellation. No responsibility is assumed for use of superseded or voided pages.

\* See faucet section for additional models available

SW  
u





DEMI™  
Product Specification Sheet

Two Piece Freestanding Collection

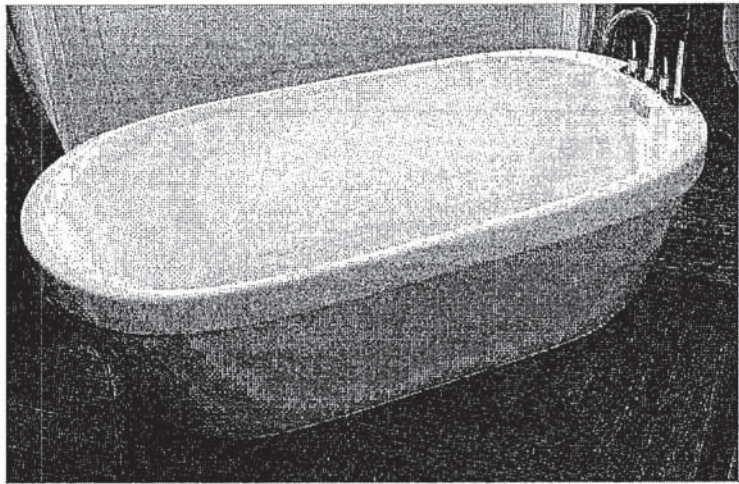

CF2007	Two Piece Freestanding Soaker
Size:	60" x 32" x 22" 1524 mm x 813 mm x 559 mm

PRODUCT FEATURES & BENEFITS

- Vacuum formed acrylic reinforced with fiberglass
- Scratch, stain and fade resistant high gloss finish
- Installation friendly two piece design
- Accepts deck mounted faucet
- Includes integral pop up drain and rectangular overflow
- Includes levelling feet

TWO PIECE ASSEMBLY

FRONT VIEW

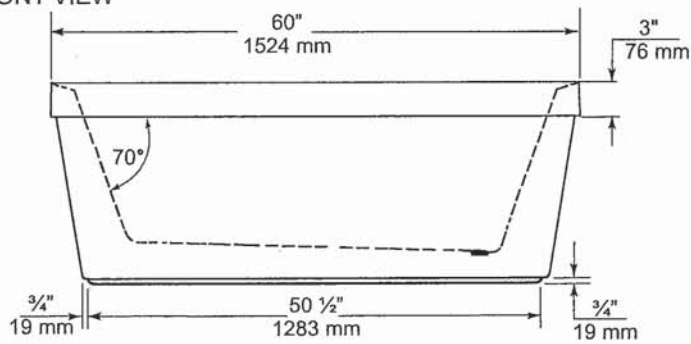

END VIEW

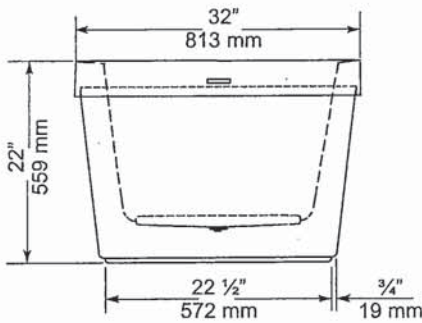

TOP VIEW

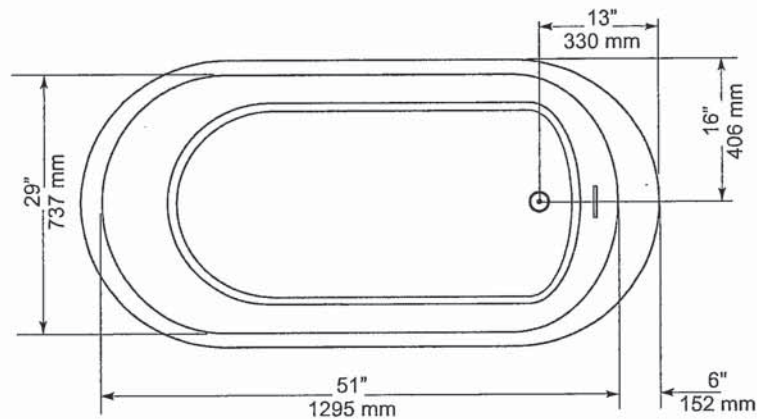

GENERAL SPECIFICATIONS		
Average Weight	90 lb	41 kg
Bathing Well at bottom	43"x 20"	1092 x 508 mm
Capacity Drain to Overflow		195 litres
Water Depth Drain to Overflow	16"	406 mm
Drain Opening (dia.)	2"	51 mm
Overflow Opening	2 1/4"x 1 1/2"	57 x 13 mm
Drain to Floor Clearance	3 1/4"	83 mm

NOTES: Please confirm measurements on actual product to ensure proper identification. Bathtub to be installed on the floor supported by 5 self levelling feet. Adjust if required to level the bathtub for adequate drainage. Refer to installation instructions for additional information.

IMPORTANT: Dimensions of fixtures are nominal and may vary ± 1/4" (6 mm). Weight may vary ± 5 lb (2.3 kg). Drawing is not to scale. These measurements are subject to change at manufacturer's discretion.

Compliance Certifications -  
Meets or Exceeds the following Specifications:  
• CAN/CSA - B45 Series



30  
Wk





FloWise™ DUAL FLUSH  
ELONGATED TOILET  
VITREOUS CHINA

FloWise™ DUAL FLUSH ELONGATED TOILET

- 2476 216
  - Vitreous china
  - Low-consumption Dual Flush
    - Full flush 6.0 Lpf/1.3 gpf,
    - Partial flush 3.0 Lpf/0.66 gpf.
  - Elongated wash down bowl
  - Internal trapway fully-glazed,
    - 2-1/4" (57mm) ballpass
  - Concealed trapway bowl
  - Chrome-plated top mounted push button actuator
  - Easy to clean sanitary dam on bowl
  - Includes Elongated Slow Close Seat
  - 100% factory flush tested
  - 2 bolt caps

Separate Component Parts:

- 3067 316 Elongated Bowl with Slow Close Seat
- 4035 216 Unlined Tank



- 2476 516 Same as above with Lined tank
  - 3067 316 Elongated Bowl
  - 4035 516 Lined Tank

Nominal Dimensions:  
794 x 432 x 765mm  
(31-1/4" x 17" x 30-1/8")

- Compliance Certifications -  
Meets or Exceeds the Following Specifications:
- ASME A112.19.2M (and 19.6M)
  - CAN/CSA B45 series

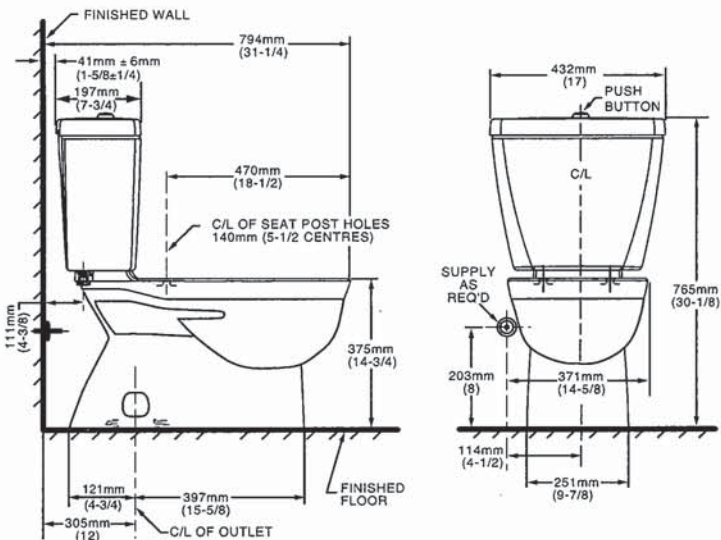

NOTES:  
THIS TOILET IS DESIGNED TO ROUGH-IN AT A MINIMUM DIMENSION OF 305MM (12") FROM FINISHED WALL TO C/L OF OUTLET.  
SUPPLY NOT INCLUDED WITH FIXTURE AND MUST BE ORDERED SEPARATELY.  
\* DIMENSION SHOWN FOR LOCATION OF SUPPLY IS SUGGESTED.  
FOR ADDITIONAL INFORMATION REFER TO INSTALLATION INSTRUCTIONS SUPPLIED.  
IMPORTANT: Dimensions of fixtures are nominal and may vary within the range of tolerance established by ANSI Standard A112.19.2  
These measurements are subject to change or cancellation. No responsibility is assumed for use of superseded or voided pages.

- To Be Specified
- Colour: 020 White
  - Supply with stop:

UPGRADED VALUE ADDED FEATURES AT NO EXTRA CHARGE



There is more than 1 version of this model.  
Page down to identify the version you have.

DESCRIPTION

- Metal construction with various finishes identified by suffix
- Flexible supplies with 3/8" compression fittings
- Includes metal or 50/50 pop-up type waste assembly where noted

OPERATION

- Pivot action lever style handle
- Temperature controlled through 100° degree arc of handle travel

FLOW

- Water usage is limited to these maximum flow rates as indicated by the corresponding product markings
  - ° 1.2 gpm max (4.5L/min) at 60 psi
  - ° 1.5 gpm max (5.7L/min) at 60 psi

CARTRIDGE

- 1255™ Duralast™ cartridge
- Nonmetallic/nonferrous and stainless steel material

STANDARDS

- Third party certified to WaterSense®, ASME A112.18.1/CSA B125.1 and all applicable requirements referenced therein
- Certified to NSF 61/9 & 372
- Products marked with 1.2 gpm are compliant with California water efficiency regulations
- Complies with California Proposition 65 and with the Federal Safe Drinking Water Act
- ADA  for lever handle

WARRANTY

- Lifetime limited warranty against leaks, drips and finish defects to the original consumer purchaser
- 5 year warranty if used in commercial installations

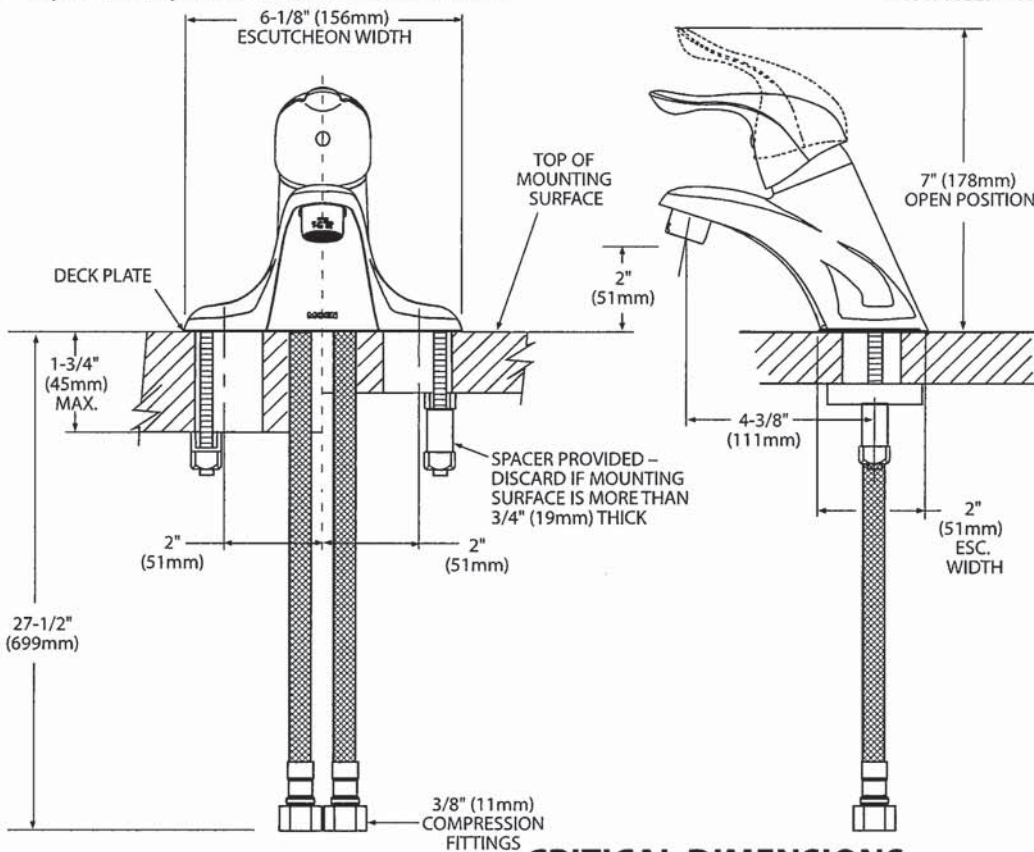

CRITICAL DIMENSIONS  
(DO NOT SCALE)

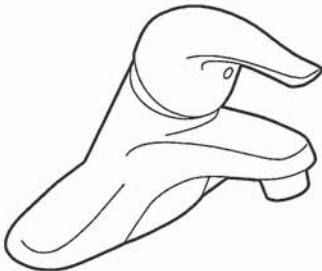

CHATEAU®  
Single-Handle Lavatory Faucet

with Metal Waste Assembly  
Model: L4625 series  
L4631BC  
Bulk Packed (12 per carton):  
L64624 series

with 50/50 Waste Assembly  
Bulk Packed (12 per carton):  
L64625 series

Less Waste  
Bulk Packed (12 per carton):  
L64600 series

NOTE: THIS FAUCET IS DESIGNED TO BE  
INSTALLED THRU 3-1" DIA. HOLES, 2" ON CENTER







Buy it for looks. Buy it for life.®

## DESCRIPTION

- Metal construction with various finishes identified by suffix
- Includes non-metallic showerhead, arm, flange and non-metallic diverter tub spout

## OPERATION

- Handle operates counterclockwise through a 270° arc with off at 6 o'clock and maximum hot at the 9 o'clock position. Shut off in clockwise direction
- Adjustable temperature limit stop to control maximum hot water temperature
- Pressure balancing mechanism maintains selected discharge temperature to  $\pm 3^\circ$

## FLOW

- Showerhead is limited to 2.5 gpm (9.5 L/min) at 80 psi
- EP suffix models are limited to 1.75 gpm (6.6 L/min) at 80 psi
- NH suffix models contain no showerhead

## CARTRIDGE

- 1222 cartridge design
- Accommodates back to back installations
- Nonmetallic/nonferrous and stainless steel material

## STANDARDS

- Third party certified to meet ASME A112.18.1/CSA B125.1 and all applicable requirements referenced therein
- EP suffix models are third party certified to WaterSense®

- ADA for lever handle

## WARRANTY

- Lifetime limited warranty against leaks, drips and finish defects to the original consumer purchaser
- 5 year warranty if used in commercial installations

## Specifications



### CHATEAU® POSI-TEMP® Single-Handle Tub/Shower Trim Kit

**Models:** TL181 series - valve trim only  
(Bulk Packed 12 per carton)  
TL182 series - shower trim only  
(Bulk Packed 12 per carton)  
TL183 series - tub/shower trim  
(Bulk Packed 12 per carton)

**Valves:** 62300 series  
2500 series

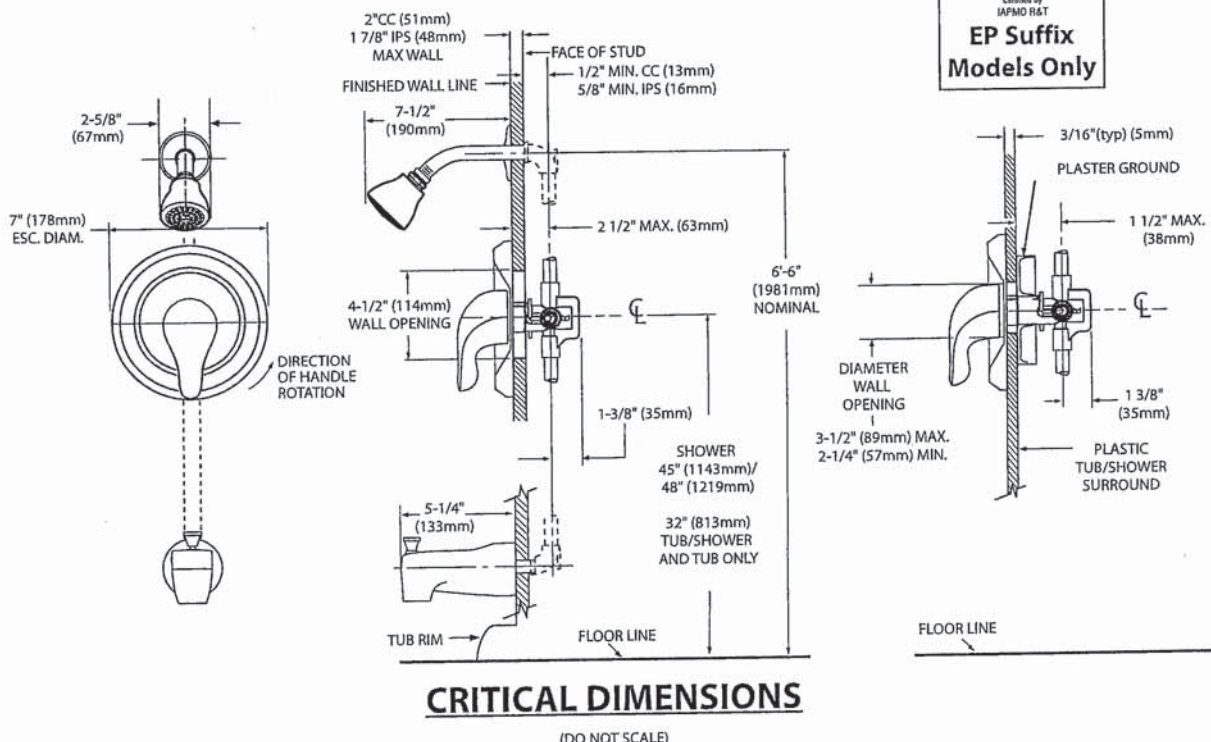

SV  
hu



Specifications

DESCRIPTION

- Metal construction with various finishes identified by suffix

OPERATION

- Lever style handles with hot and cold color indicator
- Rotate hot side handle counterclockwise to open (clockwise to close) and the cold side handle (clockwise to open) and (counterclockwise to close)

STANDARDS

- Third party certified to: ASME A112.18.1/CSA B-125.1, and all applicable requirements referenced therein

- ADA  for lever handles

WARRANTY

- Lifetime limited warranty against leaks, drips and finish defects to the original homeowner
  - 10 year limited warranty when used in a multi-family installation
  - 5 year limited warranty when used in a commercial installation
- Visit [www.moen.com/support](http://www.moen.com/support) for complete details and limitations



CHATEAU®  
Two-Handle Garden Tub Trim

Models: T994 series

Valves: 4792, 4793, 4794, 4796, 4797, 4798

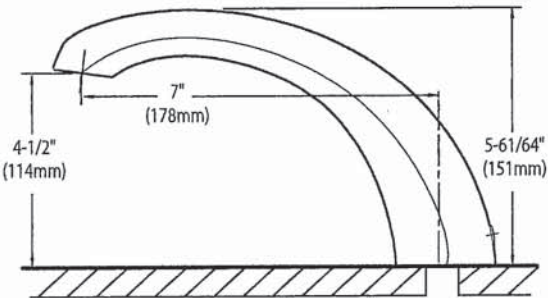
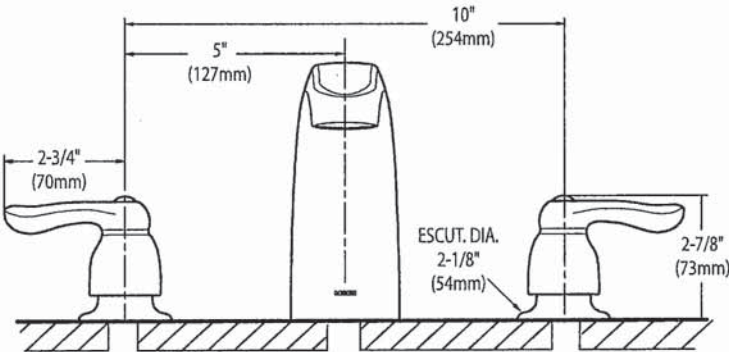

CRITICAL DIMENSIONS

(DO NOT SCALE)

SV  
WU





AVH-308CS  
30" Wall mounted hood

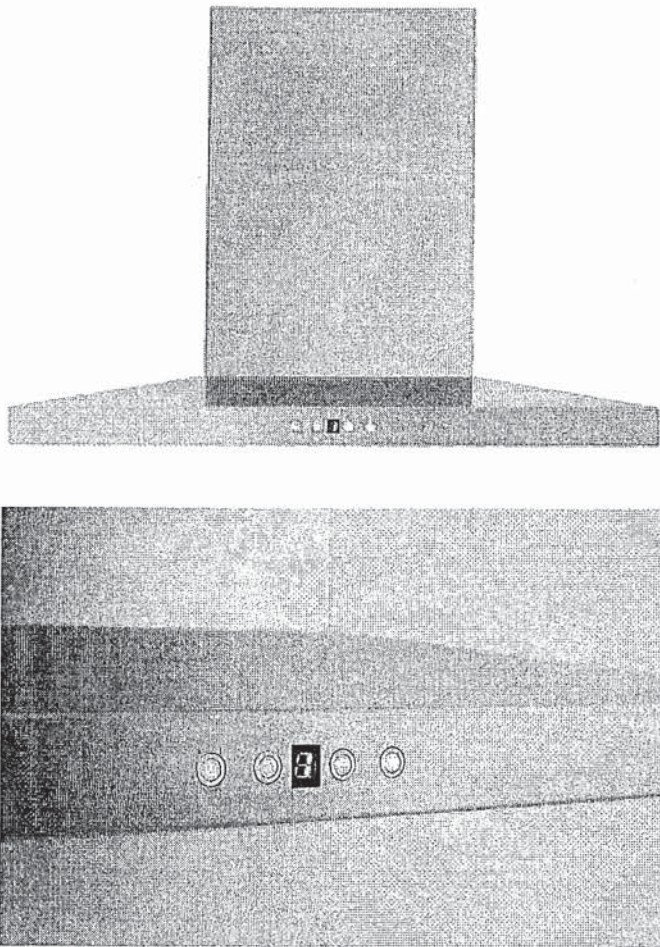

Selected Model	
Model number	AVH-308CS
Dimensions	
Dimensions	29 1/2" (W) x 19 3/4" (D) x 3 1/4" (H)
Exterior Appearance	
Stainless steel grade	201
Features	
Control	Soft touch with LED display
Lighting	2 bulbs, 3W LED (bulbs included)
Blower type	860 CFM, 6-Speed
Blower performance	Speed 1, 2.4 sones
	Speed 6, 6.2 sones
Filter type	2 aluminium micro hole filters (included) 2 Stainless steel baffle filters (included)
Duct transition	6" Round (Top)
Ducting	Ducted
Chimney (ducted out)	For ceiling heights up to 9'0"
Electrical Requirements	
Electrical requirements	120V / 60Hz / 2.7 Amps
Accessories (optionnal)	
Optional duct covers	AD-884S (884mm, AVN-AVH compatible)
Warranty	
1-year Warranty	Parts and labour, in-home service

The information contained herein is based on sources that we believe to be reliable, but is not guaranteed by us, may be incomplete or may change without notice

SV  
Wk

Dimensions

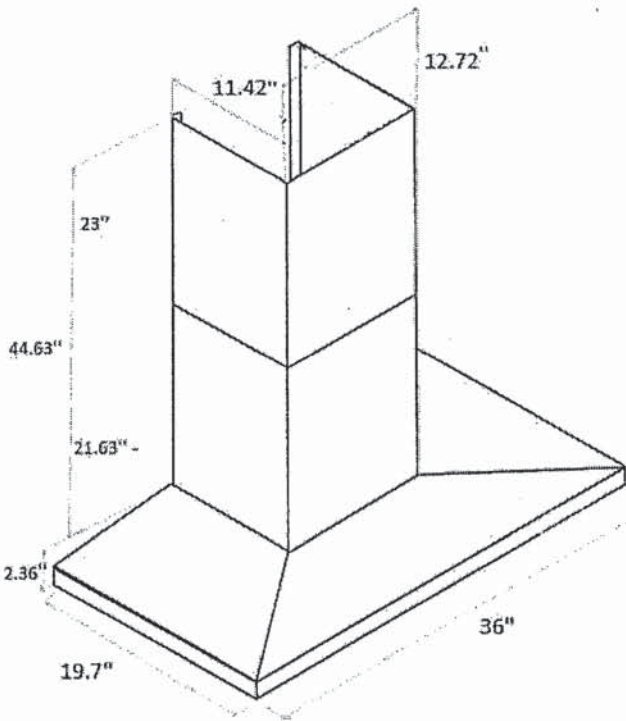
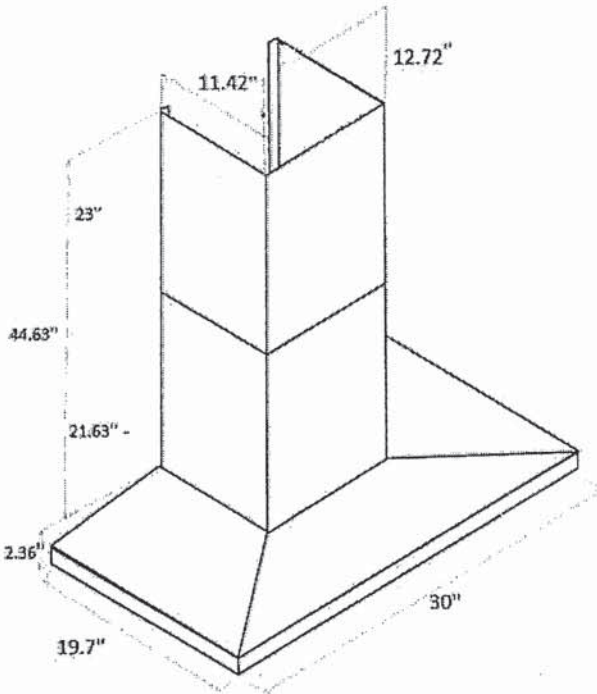

Installation

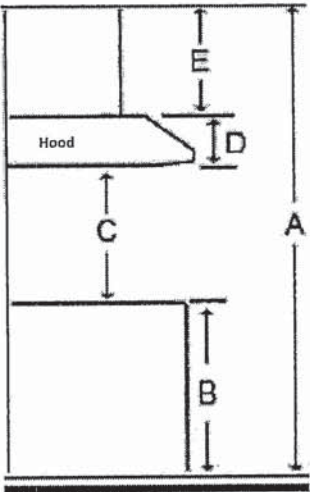

A	Floor to ceiling height	variable
B	Floor to counter top height (standard)	36"
C	Recommended height between cooking surface and bottom of the hood	28" to 30"
D	Hood height	2.36"
E	Chimney height	Max 44.63"

Duct transition

6" round top

The information contained herein is based on sources that we believe to be reliable, but is not guaranteed by us, may be incomplete and/or may change without notice.

Need technical support? 1(888) 651-2534

SJ  
MK