

Sales Selection Sheet
Checklist

1 of 45

LOT 3135 Model: 28-2590 B THE BRISTOL

PURCHASERS: FIDA MUHAMMAD/FAIZA KHAN

VENDOR: Heathwood Homes (Huron) Limited

COFFERED CEILING IN GREAT ROOM

COFFERED CEILING IN DINING ROOM

BUILT OUT WALL ABOVE FIREPLACE

- ☐ WOB
- ☐ DECK
- ☒ FINISHED BASEMENT
- ☐ COLD CELLAR

UPGRADED / MODIFIED ELEVATION

- ☐ CORNER UPGRADE
- ☐ REAR UPGRADE
- ☐ SIDE UPGRADE

CEILING UPGRADE - SMOOTH

- ☒ MAIN FLOOR
- ☐ SECOND FLOOR
- ☐ BASEMENT

ADDITIONAL ROUGH-INS

- ☒ 200 AMP SERVICE (STD IN SINGLES)
- ☐ WET BAR ROUGH-IN
- ☐ HUMIDIFIER
- ☒ AIR CONDITIONING (SITE STD)

GAS ROUGH-IN

- ☐ STOVE
- ☐ DRYER
- ☐ BBQ
- ☐ ADDITIONAL FIREPLACE

KITCHEN: HOODFAN VENTING SIZE

- ☒ 6 IN ROUND DUCT
- ☐ 7 IN ROUND DUCT

FULL BASEMENT STAIRS:

Carpet Grade

UPPER BASEMENT STAIRS:

N/A

LOWER LEVEL STAIRS:

N/A

MAIN STAIRS:

All Oak

MEDIA STAIRS (if applicable):

N/A

LOFT STAIRS (if applicable):

N/A

APRIL 13/23

Date

Signatures

Purchaser:

on file

APRIL 13/23

Date

BRENDA LUKER

Decor Consultant:

Date

Purchaser:

-04- 13 2023

Date

Heathwood Homes (Huron) Limited

Locked Date:

Approved

FIDA MUHAMMAD/FAIZA KHAN
Project: Wallaceton
Unit: 3135, Phase: 3
Model: 28-2590 B THE BRISTOL

Created: 11/30/2022 09:34:56
Locked:
Closed:

Kitchen

Cabinet Colour/Style	9111	Viking III-SIMCOE ORCHID 3DL ***STD***
Island Cabinet Colour/Style	9111	Viking III-SIMCOE ORCHID 3DL ***STD***
Cabinet Hardware	9111	12881-HARDWARE ***STD***
Countertop	9111	Group 4-Quartz-Caesarstone-ORGANIC WHITE #4600-3/4 inch with built-up edge ***4***
Island Countertop	9111	Group 4-Quartz-Caesarstone-ORGANIC WHITE #4600-3/4 inch with built-up edge ***4***
Countertop Edge	4005	DOUBLE MITRE 1 1/2 INCH ***UPG***

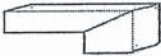

- Please note some islands may require a seam as per manufacturer and fabricator discretions.

Sink	9493	BLANCO QUATRUS U 1 SUPER SINGLE 401248 (min cabinet 36 in)	PG 25
HoodFan	9393	SCB51930-CYCLONE 30 inch CANOPY CHIMNEY HOODFAN-SS	PG 37-38
Backsplash	1111	N/A *****	
Backsplash Grout	1111	N/A *****	
Backsplash Tile Pattern	1111	N/A *****	

- Purchasers have been advised: standard fridge opening is a minimum 37 3/8 x 73 3/8 inches. Ice Waterline Rough-In is included.
- Standard stove opening is 30 inches and standard dishwasher opening is 24 inches. Any gas stove will require backsplash or stainless steel backing to avoid fire hazards.
- Purchasers acknowledge: Heathwood Homes and its contractors will not be responsible for any kitchen cabinet changes due to appliances dimension changes after sign-off.

Kitchen / Breakfast

Flooring	1111	Red Oak Pearl-Vintage Engineered-TITANIUM-3/4 inch x 3 1/4 inch ***UPG***
Floor Tile Grout	1111	N/A *****
Floor Tile Pattern	1111	N/A *****

Comment

Foyer

Flooring	9071	GE.BY.AZR.1313 New Byzantine Azzuro 13x13 ***STD***
Floor Tile Grout	2225	Grout-(27) Silver ***STD***
Floor Tile Pattern	2225	SIDE TO SIDE ***STD***

EM
FK

Customer Colours

FIDA MUHAMMAD/FAIZA KHAN
Project: Wallaceton
Unit: 3135, Phase: 3
Model: 28-2590 B THE BRISTOL

Created: 11/30/2022 09:34:56
Locked:
Closed:

Floor Tile Pattern	2225	SIDE TO SIDE STD
--------------------	------	------------------

Comment

Powder Room

Flooring	9071	GE.BY.AZR.1313 New Byzantine Azzuro 13x13 ***STD***
Floor Tile Grout	2225	Grout-(27) Silver ***STD***
Floor Tile Pattern	2225	SIDE TO SIDE ***STD***

Plumbing Fixture (Colour)	2225	Plumbing Fixtures-WHITE ***STD***
---------------------------	------	-----------------------------------

Comment

Mud Room / Laundry

Flooring	9439	TH.CT.LGR.1212.MT-Construct-Light Grey Matte-12 x 12 STD ***STD***
Floor Tile Grout	9439	Grout-(27) Silver ***STD***
Floor Tile Pattern	9439	STANDARD SQUARE ***STD***

Opt. Cabinet Colour/Style - Uppers	1111	N/A *****
Opt. Cabinet Hardware - Uppers	1111	N/A *****
Cabinet Colour/Style - Base	9156	Viking III-SIMCOE-RAIN CLOUD-3DL ***STD***
Cabinet Hardware - Base	9156	135-HARDWARE ***STD***
Countertop	9156	4925K-07-Countertop-CALCUTTA MARBLE-Wilsonart ***STD***
Countertop Edge	1111	N/A *****

Comment

Main Hall

Flooring	1111	Red Oak Pearl-Vintage Engineered-TITANIUM-3/4 inch x 3 1/4 inch ***STD***
----------	------	---

Comment

Fw
FK.

Customer Colours

FIDA MUHAMMAD/FAIZA KHAN
Project: Wallaceton
Unit: 3135, Phase: 3
Model: 28-2590 B THE BRISTOL

Created: 11/30/2022 09:34:56

Locked:

Closed:

Dining Room

Flooring	1111	Red Oak Pearl-Vintage Engineered-TITANIUM-3/4 inch x 3 1/4 inch ***STD***
Comment		

Great Room

Flooring	1111	Red Oak Pearl-Vintage Engineered-TITANIUM-3/4 inch x 3 1/4 inch ***STD***
Comment		

Great Room Fireplace

Type	1111	Majestic MERC32 ***STD***
Mantle	1435	NF 15-Paint Grade Mantle- Flat (Per Plan)-WHITE ***STD***
Surround (Opt.)	1111	N/A *****

PG 23

- Purchasers have been advised: heat from the FP can damage TV above a FP and items placed on mantle.
 - Heathwood and its contractors will not be liable for any damage on items placed/@installed above a FP after closing.
- Comment FLOOR TO CEILING BUILT OUT WALL

Upper Hall

Flooring	1111	Red Oak Pearl-Vintage Engineered-TITANIUM-3/4 inch x 3 1/4 inch ***STD***
Comment		

Master Bedroom

Flooring	9505	84558-MINOTAUR-BEACH SHELL-40 oz Poly ***STD***
Comment		

Bedroom 2

Flooring	9505	84558-MINOTAUR-BEACH SHELL-40 oz Poly ***STD***
Comment		

Bedroom 3

Flooring	9505	84558-MINOTAUR-BEACH SHELL-40 oz Poly ***STD***
----------	------	---

FK

Customer Colours

FIDA MUHAMMAD/FAIZA KHAN
Project: Wallaceton
Unit: 3135, Phase: 3
Model: 28-2590 B THE BRISTOL

Created: 11/30/2022 09:34:50

Locked:

Closed:

Comment	
---------	--

Bedroom 4

Flooring	9505	84558-MINOTAUR-BEACH SHELL-40 oz Poly ***STD***
----------	------	---

Comment	
---------	--

Master Ensuite

Cabinet Colour/Style	9111	Viking III-SIMCOE ORCHID 3DL ***STD***
----------------------	------	--

Cabinet Hardware	9111	135-HARDWARE ***STD***
------------------	------	------------------------

Countertop	9069	MSI Quartz GROUP 1 ICED WHITE ***STD***
------------	------	---

Countertop Edge	4010	SINGLE POLISHED STRAIGHT EDGE 3/4 INCH ***STD***
-----------------	------	--

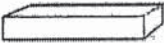

Floor Tile	9437	TH.CT.WHT.1212.MT-Construct-White Matte-12 x 12 STD ***STD***
------------	------	---

Floor Tile Grout	9437	Grout-(27) Silver ***STD***
------------------	------	-----------------------------

Floor Tile Pattern	9437	STANDARD SQUARE ***STD***
--------------------	------	---------------------------

Shower Wall Tile	9437	QT.SP.WHT.0810-Splendour-White-8 inch x 10 inch ***STD***
------------------	------	---

Shower Wall Tile Grout	9437	Grout-(00) White ***STD***
------------------------	------	----------------------------

Shower Wall Tile Pattern	9437	VERTICAL STACKED ***STD***
--------------------------	------	----------------------------

Shower Floor Tile	8661	OD.ON.SWT.0202.MT.N-Ontario Series Mosaic-Snow White Matte-2 x 2 ***STD***
-------------------	------	--

Shower Floor Tile Grout	8661	Grout-(00) White ***STD***
-------------------------	------	----------------------------

Shower Floor Tile Pattern	8661	STANDARD SQUARE ***STD***
---------------------------	------	---------------------------

Shower Jamb(s) and Sill(s)	8661	Shower Jamb / Sill-Thassos White ***STD***
----------------------------	------	--

Plumbing Fixture (colour)	8661	Plumbing Fixtures-WHITE ***STD***
---------------------------	------	-----------------------------------

Comment	
---------	--

Main Bathroom

FK
FM

Customer Colours

FIDA MUHAMMAD/FAIZA KHAN
Project: Wallaceton
Unit: 3135, Phase: 3
Model: 28-2590 B THE BRISTOL

6 of 45 553
Created: 11/20/2022 09:31:56

Locked:
Closed:

Cabinet Colour/Style	9157	Viking III-SIMCOE-MOONLIGHT-3DL ***STD***
Cabinet Hardware	9157	135-HARDWARE ***STD***
Countertop	9157	4925K-07-Countertop-CALCUTTA MARBLE-Wilsonart ***STD***
Countertop Edge	1111	N/A *****
Floor Tile	9439	TH.CT.LGR.1212.MT-Construct-Light Grey Matte-12 x 12 STD ***STD***
Floor Tile Grout	9439	Grout-(27) Silver ***STD***
Floor Tile Pattern	9439	STANDARD SQUARE ***STD***
Shower Wall Tile	9439	QT.SP.DGR.0810-Splendour-Dark Grey-8 inch x 10 inch ***STD***
Shower Wall Tile Grout	9439	Grout-(00) White ***STD***
Shower Wall Tile Pattern	9439	VERTICAL STACKED ***STD***
Shower Floor Tile	8661	OD.ON.SWT.0202.MT.N-Ontario Series Mosaic-Snow White Matte-2 x 2 ***STD***
Shower Floor Tile Grout	8661	Grout-(00) White ***STD***
Shower Floor Tile Pattern	8661	STANDARD SQUARE ***STD***
Shower Jamb(s) and Sill(s)	8661	Shower Jamb / Sill-Thassos White ***STD***
Plumbing Fixture (colour)	8661	Plumbing Fixtures-WHITE ***STD***
Comment		

Shared Ensuite

Cabinet Colour/Style	9157	Viking III-SIMCOE-MOONLIGHT-3DL ***STD***
Cabinet Hardware	9157	135-HARDWARE ***STD***
Countertop	9157	4925K-07-Countertop-CALCUTTA MARBLE-Wilsonart ***STD***
Countertop Edge	1111	N/A *****
Floor Tile	9439	TH.CT.LGR.1212.MT-Construct-Light Grey Matte-12 x 12 STD ***STD***
Floor Tile Grout	9439	Grout-(27) Silver ***STD***
Floor Tile Pattern	9439	STANDARD SQUARE ***STD***

FK
G

Customer Colours

FIDA MUHAMMAD/FAIZA KHAN
Project: Wallaceton
Unit: 3135, Phase: 3
Model: 28-2590 B THE BRISTOL

Created: 11/30/2022 09:31:56
Locked:
Closed:



Wall Tile	9439	QT.SP.DGR.0810-Splendour-Dark Grey-8 inch x 10 inch ***STD***
Wall Tile Grout	9439	Grout-(00) White ***STD***
Wall Tile Pattern	9439	VERTICAL STACKED ***STD***

Opt. Shower Floor Tile	1111	N/A *****
Opt. Shower Floor Tile Grout	1111	N/A *****
Opt. Shower Floor Tile Pattern	1111	N/A *****

Opt. Shower Jamb(s) and Sill(s)	1111	N/A *****
Plumbing Fixture (colour)	1111	Plumbing Fixtures-WHITE ***STD***
Comment		

Lower Level Recreation Room (Opt. Finis

Flooring	9505	84558-MINOTAUR-BEACH SHELL-40 oz Poly ***STD***
Comment		

Lower Level Bathroom (Opt. Finished Bas

Cabinet Colour/Style	9157	Viking III-SIMCOE-MOONLIGHT-3DL ***STD***
Cabinet Hardware	9157	135-HARDWARE ***STD***
Countertop	9157	4925K-07-Countertop-CALCUTTA MARBLE-Wilsonart ***STD***
Countertop Edge	1111	N/A *****
Floor Tile	9439	TH.CT.LGR.1212.MT-Construct-Light Grey Matte-12 x 12 STD ***STD***
Floor Tile Grout	9439	Grout-(27) Silver ***STD***
Floor Tile Pattern	9439	STANDARD SQUARE ***STD***

CM
FK

Customer Colours

FIDA MUHAMMAD/FAIZA KHAN
Project: Wallaceton
Unit: 3135, Phase: 3
Model: 28-2590 B THE BRISTOL

Created: 11/30/2022 09:34:56

Locked:

Closed:

Shower Wall Tile	9439	QT.SP.DGR.0810-Splendour-Dark Grey-8 inch x 10 inch ***STD***
Shower Wall Tile Grout	9439	Grout-(00) White ***STD***
Shower Wall Tile Pattern	9439	VERTICAL STACKED ***STD***
Shower Floor Tile	8661	OD.ON.SWT.0202.MT.N-Ontario Series Mosaic-Snow White Matte-2 x 2 ***STD***
Shower Floor Tile Grout	8661	Grout-(00) White ***STD***
Shower Floor Tile Pattern	8661	STANDARD SQUARE ***STD***
Shower Jamb(s) and Sill(s)	8661	Shower Jamb / Sill-Thassos White ***STD***
Plumbing Fixture (colour)	8661	Plumbing Fixtures-WHITE ***STD***
Comment		

Main Stairs

Type	8661	Oak Stairs ***STD MAIN STAIRS***
Colour	7940	Sambucca STAIN TO COMPLIMENT HARDWOOD AND WILL VARY FROM FLOORING ***99***
Handrail/Pickets/Posts Type	7940	1 5/16 inch Turned pickets with 3 1/2" Turned Post(s)-ALL OAK***STD***
Handrail/Pickets/Posts Colour	7940	Sambucca STAIN TO COMPLIMENT HARDWOOD AND WILL VARY FROM FLOORING ***99***
Custom Stain/Paint	1111	N/A *****
Landing(s)	1111	Red Oak-Vintage 5 inch Pre-Sanded Smooth Unfinished Red Oak-Unfinished-3/4 inch x 5 inch ***1***
Opt. Carpet Runner	1111	N/A *****
Comment		

Lower Level Stairs

Type	1111	Carpet Grade Stairs ***OPT. FINISHED BASEMENT***
Colour	9505	84558-MINOTAUR-BEACH SHELL-40 oz Poly ***STD***
Handrail/Pickets/Posts Type	9507	1 5/16 inch Turned pickets with 3 1/2" Turned Post(s)-ALL OAK***STD***
Handrail/Pickets/Posts Colour	7940	Sambucca STAIN TO COMPLIMENT HARDWOOD AND WILL VARY FROM FLOORING ***99***
Custom Stain/Paint	1111	N/A *****
Landing(s)	1111	N/A *****
Opt. Carpet Runner	1111	N/A *****

FM
FK

Customer Colours

FIDA MUHAMMAD/FAIZA KHAN
Project: Wallaceton
Unit: 3135, Phase: 3
Model: 28-2590 B THE BRISTOL

553
9 of 45
Created: 11/20/2022 09:34:56

Locked:
Closed:

Comment

Throughout

Switches and Plug	1111	Decora White Switches and Plugs ***STD***
Thresholds	1111	Metal Thresholds ***STD***
Underpad	1111	500 Series-Underpad ***STD***
Trim Size	1111	4 ¼ Baseboard and 2 ¾ Casings ***STD***
Trim - Paint Colour	1111	Trim-WHITE ***STD***
Walls - Paint Colour	1111	22-Wall-WARM GREY ***STD***
Comment		

Purchaser:



FIDA MUHAMMAD

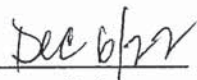

Dec 6/22

Date



Decor Consultant

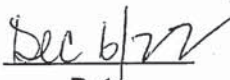

Dec 6/22

Date

Purchaser:



FAIZA KHAN

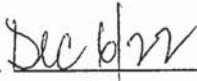

Dec 6/22

Date



Wallaceton



-04- 13 2023

Date Approved

Fm



CONSTRUCTION SUMMARY

Lot: 3135
Model: 28-2590 B THE BRISTOL
Project/Phase: Wallaceton / 3

Offer Worksheet	The Purchaser(s) acknowledge that they have NOT been referred by an existing Heathwood Homeowner and therefor are not entitled to a referral fee under Heathwood Homes Referral program. Note:
Offer Worksheet	Finished Lower Level with finished bathroom- 706 Sq ft (The Bristol) Note:
Offer Worksheet	DELETED BY AMENDMENT DATED JANUARY 3, 2023 ADDED TEN THOUSAND \$10,000 AT DECOR IN UPGRADES NO CASH VALUE - Five Appliances: SS Fridge, Stove, Chimney Hood Fan, Dishwasher: White Front Loader Washer/Dryer (Singles) Note:



CONSTRUCTION SUMMARY

Lot: 3135
Model: 28-2590 B THE BRISTOL
Project/Phase: Wallaceton / 3

ADMIN FEE

Invoice	Qty.	Description
---------	------	-------------

APPLIANCES

Invoice	Qty.	Description
1218 314,277 14Jun23 **	1	KITCHEN - GRANITE - GRANITE CUTOUT W/ STRAIGHT EDGE POLISH TO ACCOMMODATE COOK TOP SKETCH # 3 - SEE 30" COOKTOP SPECS
1218 313,484 14Jun23	1	KITCHEN - APPLIANCES - CYCLONE 30 INCH WALL MOUNT CHIMNEY HOOD SS - SCB51930 CABINETRY-delete stove uppers; ELECTRICAL-delete std range hood; HEATING/AIR CONDITIONING-Duct change to 6 in

CABINETRY

Invoice	Qty.	Description
1218 343,277 14Jun23	1	KITCHEN - CABINETRY - OPT. BUILT IN - VIKING II/III - UPG SKETCH # 3 DRYWAL-Notify; FRAMING-Modify Bulkhead; GRANITE-delete partial countertop due to Built-in; PAINTING-
1218 314,277 14Jun23 **	1	KITCHEN - GRANITE - GRANITE CUTOUT W/ STRAIGHT EDGE POLISH TO ACCOMMODATE COOK TOP SKETCH # 3 - SEE 30" COOKTOP SPECS
1218 343,272 14Jun23	1	KITCHEN - CABINETRY - OPT. LIGHT VALANCE (TRIM ONLY) - VIKING II/III - UPG
1218 343,273 14Jun23	1	KITCHEN - CABINETRY - OPT. CROWN STD HGT - VIKING II/III - UPG
1218 313,484 14Jun23 **	1	KITCHEN - APPLIANCES - CYCLONE 30 INCH WALL MOUNT CHIMNEY HOOD SS - SCB51930 CABINETRY-delete stove uppers; ELECTRICAL-delete std range hood; HEATING/AIR CONDITIONING-Duct change to 6 in
1218 313,976 14Jun23	1	KITCHEN - A25-COMBO: Upper angle corner per unit with glass door and finished interior (specify clear, frosted, or smoked glass) Viking CLEAR GLASS SKETCH # 2 AND 3 DRYWALL-Notify; FRAMING-Modify Bulkhead; PAINTING-Notify
1218 314,410 14Jun23 **	1	- PLUMBING - KITCHEN SINK UPGRADE - BLANCO KITCHEN SINK QUATRUS U 1 MAXI #401248 (32 INCH X 18 INCH) UNDERMOUNT 1 BOWL 9 INCH DEEP IN STAINLESS STEEL - CABINETRY-upgraded kitchen sink; GRANITE-upgraded kitchen sink
1218 345,983 14Jun23 **	1	KITCHEN / BREAKFAST - HARDWOOD - VINTAGE 3 1/4 IN - KITCHEN / BREAKFAST - UPG CABINETRY-Raise Cabinet; CERAMICS-Delete Std Ceramics;
1218 313,732 14Jun23	2	SHARED BATHROOM - B07-Top drawer price (per drawer) (Metabox standard levels 1-7, Tandembox standard levels 8-13) Viking SKETCH # 5



CONSTRUCTION SUMMARY

Lot: 3135
Model: 28-2590 B THE BRISTOL
Project/Phase: Wallaceton / 3

CARPET

Invoice	Qty.	Description
1218 345,982 14Jun23 **	1	UPPER HALL - HARDWOOD - VINTAGE 3 1/4 IN - UPPER HALL - UPG CARPET-delete std carpet; INTERIOR TRIM-supply and install quarter rounds; PAINTING-paint quarter round

CERAMICS

Invoice	Qty.	Description
1218 345,983 14Jun23 **	1	KITCHEN / BREAKFAST - HARDWOOD - VINTAGE 3 1/4 IN - KITCHEN / BREAKFAST - UPG CABINETRY-Raise Cabinet; CERAMICS-Delete Std Ceramics;

COFFERED CEILING

Invoice	Qty.	Description
1218 345,648 14Jun23	1	DINING ROOM - COFFERED CEILING - OPT. COFFERED CEILING - DINING ROOM SKETCH # 2 DRYWALL-Notify; FRAMING-Notify; PAINTING-Notify
1218 345,647 14Jun23	1	GREAT ROOM - COFFERED CEILING - OPT. COFFERED CEILING - GREAT ROOM SKETCH # 2 DRYWALL-Notify; FRAMING-Notify; PAINTING-Notify



CONSTRUCTION SUMMARY

Lot: 3135
Model: 28-2590 B THE BRISTOL
Project/Phase: Wallaceton / 3

DRYWALL

Invoice	Qty.	Description
1218 343,277 14Jun23 **	1	KITCHEN - CABINETRY - OPT. BUILT IN - VIKING II/III - UPG SKETCH # 3 DRYWALL-Notify; FRAMING-Modify Bulkhead; GRANITE-delete partial countertop due to Built-in; PAINTING-
1218 343,273 14Jun23 **	1	KITCHEN - CABINETRY - OPT. CROWN STD HGT - VIKING II/III - UPG
1218 313,976 14Jun23 **	1	KITCHEN - A25-COMBO: Upper angle corner per unit with glass door and finished interior (specify clear, frosted, or smoked glass) Viking CLEAR GLASS SKETCH # 2 AND 3 DRYWALL-Notify; FRAMING-Modify Bulkhead; PAINTING-Notify
1218 346,366 14Jun23 **	1	GREAT ROOM - FIREPLACE AND MANTLE - BUILT OUT WALL ABOVE FIREPLACE SKETCH # 2 AND 6 DRYWALL-notify; ELECTRICAL-notify; FRAMING-notify; HEATING/AIR CONDITIONING-notify; INTERIOR TRIM-notify; PAINTING-notify
1218 345,674 14Jun23	1	MAIN FLOOR - DRYWALL - SMOOTH CEILING IN MAIN FLOOR - UPG PAINTING-Paint Smooth Ceiling
1218 345,648 14Jun23 **	1	DINING ROOM - COFFERED CEILING - OPT. COFFERED CEILING - DINING ROOM SKETCH # 2 DRYWALL-Notify; FRAMING-Notify; PAINTING-Notify
1218 345,647 14Jun23 **	1	GREAT ROOM - COFFERED CEILING - OPT. COFFERED CEILING - GREAT ROOM SKETCH # 2 DRYWALL-Notify; FRAMING-Notify; PAINTING-Notify



CONSTRUCTION SUMMARY

Lot: 3135
Model: 28-2590 B THE BRISTOL
Project/Phase: Wallaceton / 3

ELECTRICAL

Invoice	Qty.	Description
1218 314,277 14Jun23 **	1	KITCHEN - GRANITE - GRANITE CUTOUT W/ STRAIGHT EDGE POLISH TO ACCOMMODATE COOK TOP SKETCH # 3 - SEE 30" COOKTOP SPECS
1218 314,216 14Jun23	1	KITCHEN - ELECTRICAL - ADDITIONAL 40AMP/240V OUTLET, PLEASE SPECIFY LOCATION FOR BUILT IN OVEN / MICRO SKETCH # 3 - SEE SPECS
1218 313,484 14Jun23 **	1	KITCHEN - APPLIANCES - CYCLONE 30 INCH WALL MOUNT CHIMNEY HOOD SS - SCB51930 CABINETRY-delete stove uppers; ELECTRICAL-delete std range hood; HEATING/AIR CONDITIONING-Duct change to 6 in
1218 346,366 14Jun23 **	1	GREAT ROOM - FIREPLACE AND MANTLE - BUILT OUT WALL ABOVE FIREPLACE SKETCH # 2 AND 6 DRYWALL-notify; ELECTRICAL-notify; FRAMING-notify; HEATING/AIR CONDITIONING-notify; INTERIOR TRIM-notify; PAINTING-notify
1218 314,242 14Jun23	1	KITCHEN - ELECTRICAL - RELOCATION OF SWITCHES/LIGHTS (MUST SPECIFY LOCATION) - NOTE: PLUGS CANNOT BE RELOCATED- MUST PURCHASE ADDITIONAL OUTLET. RELOCATE STD KITCHEN LIGHT TO CENTRED OVER ISLAND SKETCH # 2
1218 314,232 14Jun23	1	GREAT ROOM - ELECTRICAL - EXTRA WALL INTERIOR OUTLET ON EXISTING CIRCUIT (DOES NOT INCLUDE KITCHEN OUTLETS) OVER FIREPLACE 70" +/- FROM FLOOR NOTE: BUILT OUT WALL ABOVE FIREPLACE SKETCH # 2 AND 6

FIREPLACE AND MANTLE

Invoice	Qty.	Description
1218 346,366 14Jun23	1	GREAT ROOM - FIREPLACE AND MANTLE - BUILT OUT WALL ABOVE FIREPLACE SKETCH # 2 AND 6 DRYWALL-notify; ELECTRICAL-notify; FRAMING-notify; HEATING/AIR CONDITIONING-notify; INTERIOR TRIM-notify; PAINTING-notify



CONSTRUCTION SUMMARY

Lot: 3135
Model: 28-2590 B THE BRISTOL
Project/Phase: Wallaceton / 3

FRAMING

Invoice	Qty.	Description
1218 343,277 14Jun23 **	1	KITCHEN - CABINETRY - OPT. BUILT IN - VIKING II/III - UPG SKETCH # 3 DRYWAL-Notify; FRAMING-Modify Bulkhead; GRANITE-delete partial countertop due to Built-in; PAINTING-
1218 343,273 14Jun23 **	1	KITCHEN - CABINETRY - OPT. CROWN STD HGT - VIKING II/III - UPG
1218 313,976 14Jun23 **	1	KITCHEN - A25-COMBO: Upper angle corner per unit with glass door and finished interior (specify clear, frosted, or smoked glass) Viking CLEAR GLASS SKETCH # 2 AND 3 DRYWALL-Notify; FRAMING-Modify Bulkhead; PAINTING-Notify
1218 346,366 14Jun23 **	1	GREAT ROOM - FIREPLACE AND MANTLE - BUILT OUT WALL ABOVE FIREPLACE SKETCH # 2 AND 6 DRYWALL-notify; ELECTRICAL-notify; FRAMING-notify; HEATING/AIR CONDITIONING-notify; INTERIOR TRIM-notify; PAINTING-notify
1218 345,648 14Jun23 **	1	DINING ROOM - COFFERED CEILING - OPT. COFFERED CEILING - DINING ROOM SKETCH # 2 DRYWALL-Notify; FRAMING-Notify; PAINTING-Notify
1218 345,647 14Jun23 **	1	GREAT ROOM - COFFERED CEILING - OPT. COFFERED CEILING - GREAT ROOM SKETCH # 2 DRYWALL-Notify; FRAMING-Notify; PAINTING-Notify

GRANITE

Invoice	Qty.	Description
1218 343,277 14Jun23 **	1	KITCHEN - CABINETRY - OPT. BUILT IN - VIKING II/III - UPG SKETCH # 3 DRYWAL-Notify; FRAMING-Modify Bulkhead; GRANITE-delete partial countertop due to Built-in; PAINTING-
1218 314,277 14Jun23	1	KITCHEN - GRANITE - GRANITE CUTOUT W/ STRAIGHT EDGE POLISH TO ACCOMMODATE COOK TOP SKETCH # 3 - SEE 30" COOKTOP SPECS
1218 314,410 14Jun23 **	1	- PLUMBING - KITCHEN SINK UPGRADE - BLANCO KITCHEN SINK QUATRUS U 1 MAXI #401248 (32 INCH X 18 INCH) UNDERMOUNT 1 BOWL 9 INCH DEEP IN STAINLESS STEEL - CABINETRY-upgraded kitchen sink; GRANITE-upgraded kitchen sink
1218 343,050 14Jun23	1	- GRANITE - KITCHEN / ISLAND - GROUP 4 - UPG



CONSTRUCTION SUMMARY

Lot: 3135
Model: 28-2590 B THE BRISTOL
Project/Phase: Wallaceton / 3

HARDWOOD

Invoice	Qty.	Description
1218 345,983 14Jun23	1	KITCHEN / BREAKFAST - HARDWOOD - VINTAGE 3 1/4 IN - KITCHEN / BREAKFAST - UPG CABINETRY-Raise Cabinet; CERAMICS-Delete Std Ceramics;
1218 314,351 14Jun23 **	3	- PAINT - STAIN STAIR LANDING IN SAMBUCCA. LANDING OVER 25 SQ.FT. EACH HARDWOOD-Supply and Install smooth UNFINISHED pre-sanded red oak at stair landing(s)
1218 345,982 14Jun23	1	UPPER HALL - HARDWOOD - VINTAGE 3 1/4 IN - UPPER HALL - UPG CARPET-delete std carpet; INTERIOR TRIM-supply and install quarter rounds; PAINTING-paint quarter round

HEATING / AIR CONDITIONING

Invoice	Qty.	Description
1218 313,484 14Jun23 **	1	KITCHEN - APPLIANCES - CYCLONE 30 INCH WALL MOUNT CHIMNEY HOOD SS - SCB51930 CABINETRY-delete stove uppers; ELECTRICAL-delete std range hood; HEATING/AIR CONDITIONING-Duct change to 6 in
1218 346,366 14Jun23 **	1	GREAT ROOM - FIREPLACE AND MANTLE - BUILT OUT WALL ABOVE FIREPLACE SKETCH # 2 AND 6 DRYWALL-notify; ELECTRICAL-notify; FRAMING-notify; HEATING/AIR CONDITIONING-notify; INTERIOR TRIM-notify; PAINTING-notify

INTERIOR TRIM AND DOORS

Invoice	Qty.	Description
1218 346,366 14Jun23 **	1	GREAT ROOM - FIREPLACE AND MANTLE - BUILT OUT WALL ABOVE FIREPLACE SKETCH # 2 AND 6 DRYWALL-notify; ELECTRICAL-notify; FRAMING-notify; HEATING/AIR CONDITIONING-notify; INTERIOR TRIM-notify; PAINTING-notify
1218 345,982 14Jun23 **	1	UPPER HALL - HARDWOOD - VINTAGE 3 1/4 IN - UPPER HALL - UPG CARPET-delete std carpet; INTERIOR TRIM-supply and install quarter rounds; PAINTING-paint quarter round



CONSTRUCTION SUMMARY

Lot: 3135
Model: 28-2590 B THE BRISTOL
Project/Phase: Wallaceton / 3

PAINTING

Invoice	Qty.	Description
1218 343,277 14Jun23 **	1	KITCHEN - CABINETRY - OPT. BUILT IN - VIKING II/III - UPG SKETCH # 3 DRYWALL-Notify; FRAMING-Modify Bulkhead; GRANITE-delete partial countertop due to Built-in; PAINTING-
1218 343,273 14Jun23 **	1	KITCHEN - CABINETRY - OPT. CROWN STD HGT - VIKING II/III - UPG
1218 313,976 14Jun23 **	1	KITCHEN - A25-COMBO: Upper angle corner per unit with glass door and finished interior (specify clear, frosted, or smoked glass) Viking CLEAR GLASS SKETCH # 2 AND 3 DRYWALL-Notify; FRAMING-Modify Bulkhead; PAINTING-Notify
1218 314,351 14Jun23	3	- PAINT - STAIN STAIR LANDING IN SAMBUCCA. LANDING OVER 25 SQ.FT. EACH HARDWOOD-Supply and Install smooth UNFINISHED pre-sanded red oak at stair landing(s)
1218 346,366 14Jun23 **	1	GREAT ROOM - FIREPLACE AND MANTLE - BUILT OUT WALL ABOVE FIREPLACE SKETCH # 2 AND 6 DRYWALL-notify; ELECTRICAL-notify; FRAMING-notify; HEATING/AIR CONDITIONING-notify; INTERIOR TRIM-notify; PAINTING-notify
1218 345,674 14Jun23 **	1	MAIN FLOOR - DRYWALL - SMOOTH CEILING IN MAIN FLOOR - UPG PAINTING-Paint Smooth Ceiling
1218 345,648 14Jun23 **	1	DINING ROOM - COFFERED CEILING - OPT. COFFERED CEILING - DINING ROOM SKETCH # 2 DRYWALL-Notify; FRAMING-Notify; PAINTING-Notify
1218 345,982 14Jun23 **	1	UPPER HALL - HARDWOOD - VINTAGE 3 1/4 IN - UPPER HALL - UPG CARPET-delete std carpet; INTERIOR TRIM-supply and install quarter rounds; PAINTING-paint quarter rounds
1218 345,647 14Jun23 **	1	GREAT ROOM - COFFERED CEILING - OPT. COFFERED CEILING - GREAT ROOM SKETCH # 2 DRYWALL-Notify; FRAMING-Notify; PAINTING-Notify

PLUMBING

Invoice	Qty.	Description
1218 314,410 14Jun23	1	- PLUMBING - KITCHEN SINK UPGRADE - BLANCO KITCHEN SINK QUATRUS U 1 MAXI #401248 (32 INCH X 18 INCH) UNDERMOUNT 1 BOWL 9 INCH DEEP IN STAINLESS STEEL - CABINETRY-upgraded kitchen sink; GRANITE-upgraded kitchen sink

THE BRISTOL

ELEVATION A & B | 2,590 SQ. FT.

706 sq. ft. of opt. finished Lower Level

WALLACETON
EST. 1870

28-2590 ELEV. B

Sketch #1

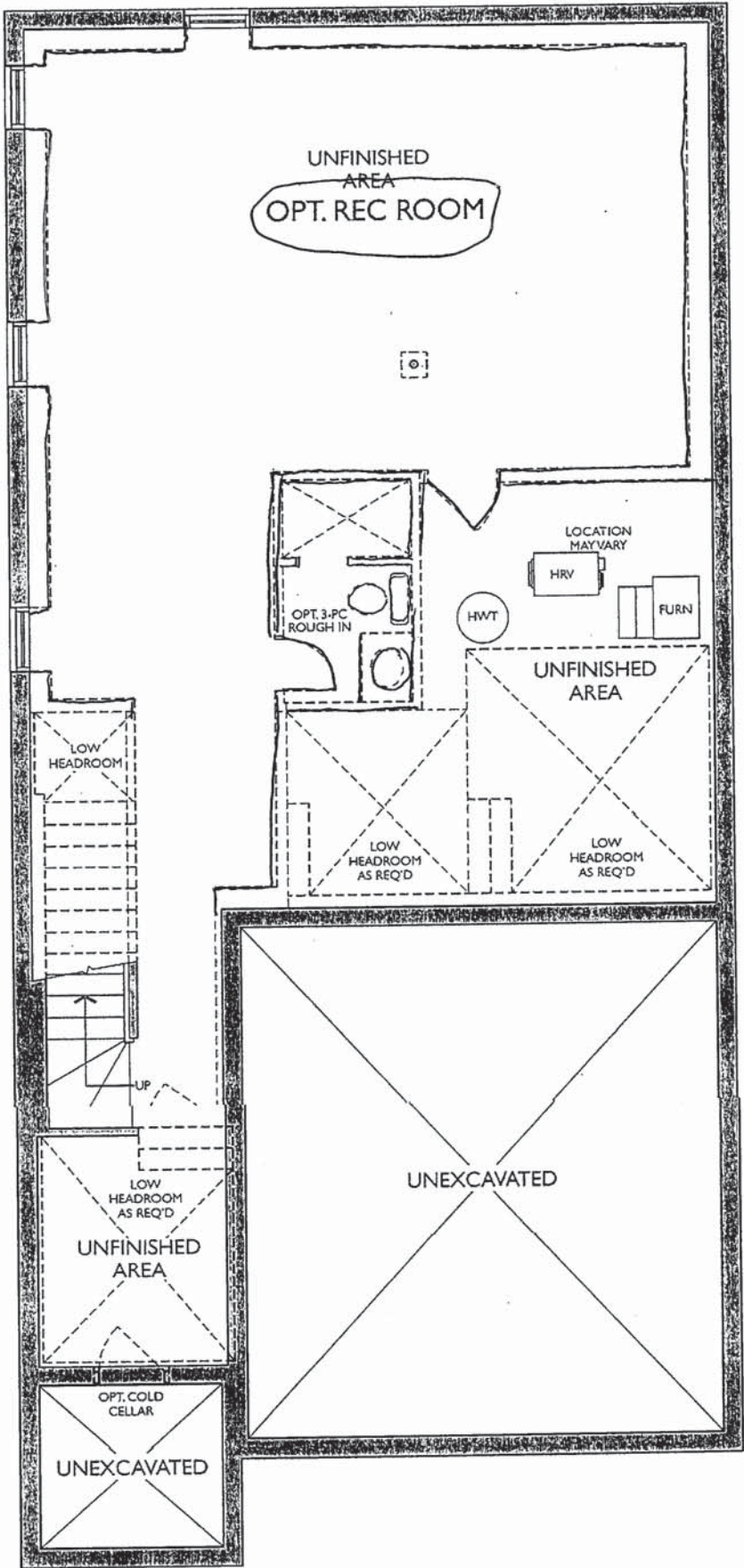

LOWER LEVEL
ELEVATION B & C

THE BRISTOL

ELEVATION A & B | 2,590 SQ. FT.

706 sq. ft. of opt. finished Lower Level

28-2590 ELEV. B

WALLACETON
EST. 1870

Sketch # 2

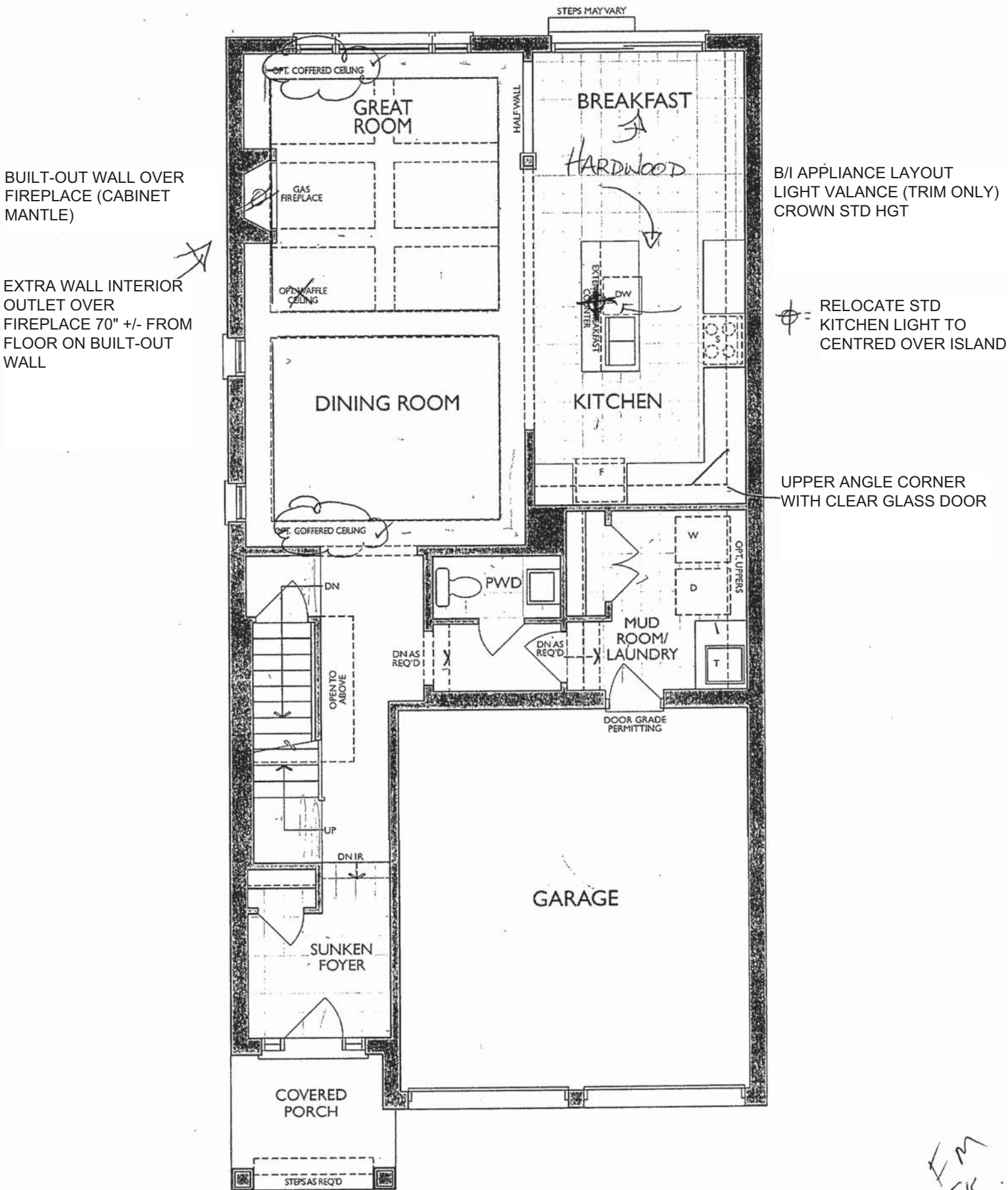

MAIN FLOOR
ELEVATION B & C

UPGRADE KITCHEN - BUILT-IN APPLIANCES:
- 30" COOKTOP POTS & PANS
- 30" WALL OVEN

Project: Wallaceton
Unit: 3135, Phase: 3
Model: 28-2590 B THE BRISTOL

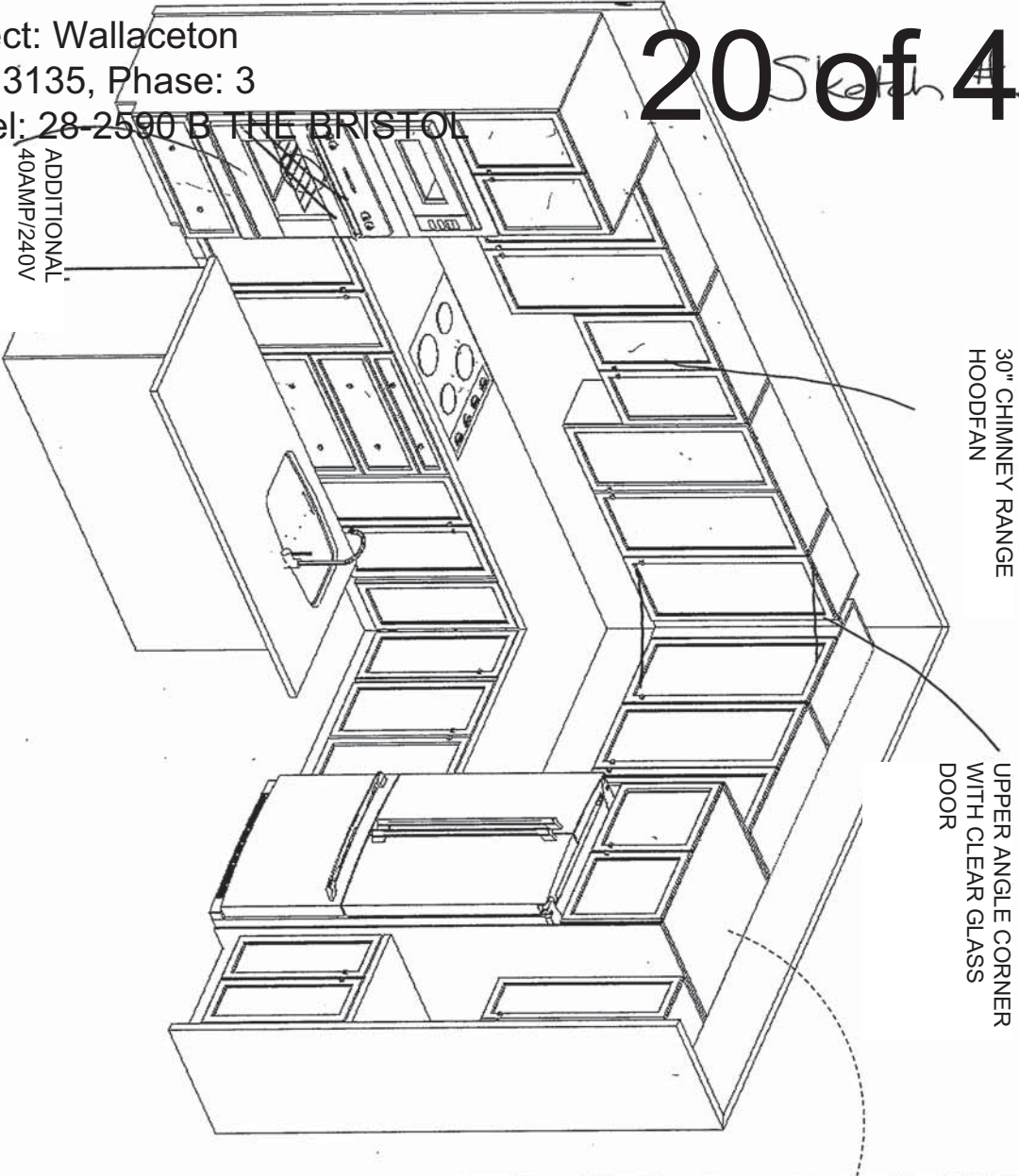

** OPT. LIGHT VALANCE (TRIM ONLY)
** OPT. CROWN STD HGT

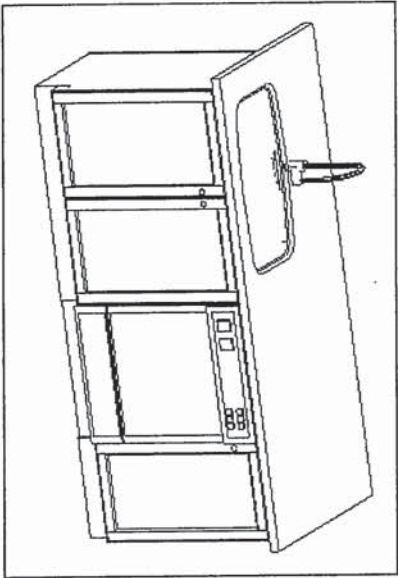
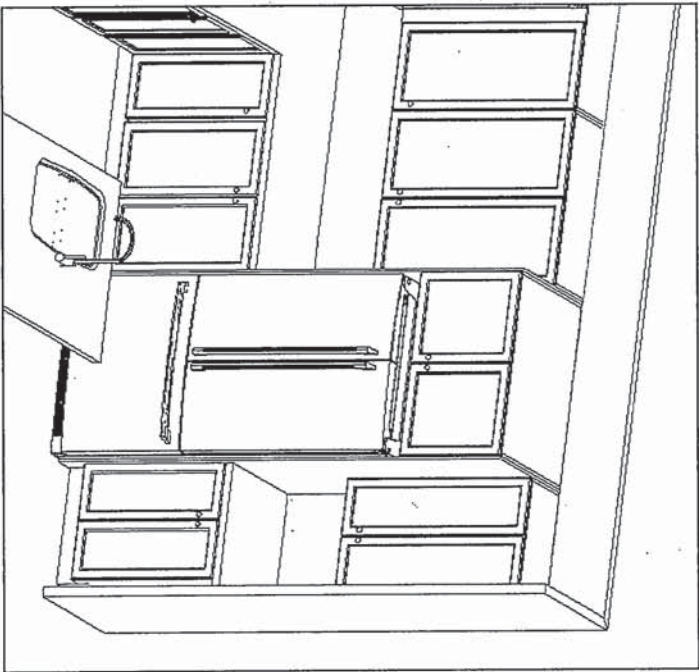

F R E N D E L
K I T C H E N S L I M I T E D
1350 Shawson Drive, Mississauga, ON L4W 1C5

HEATHWOOD HOMES
WALLACETON, KITCHENER ON
MODEL: 28-2590 (3403)

STANDARD CONTRACT INCLUDES:

Appliance Openings

- Hood Opening: 30" W Builder hood
- Fridge Opening: 37 3/8 "W X 73 3/8"
- Fridge cabinet & gables: 66cm Deep
- Stove Opening: 30" Freestanding
- Dishwasher Opening: 24"

Standard Kitchens Scope:

- 100cm H wall cabinets
- Std. Blumotion Hinges- **soft close**
- Std. Metabox Drawers- **not soft close**
- Min 40cm W drawer
- Base pie cut corner cabinets
- Backing on all cabinets
- Countertop by others
- Upgrade applied paneled fridge & dishwashers supply only (appliance hardware by others)

Standard Vanity & Laundry Scope:

- Powder by others, pedestal
- Master Ens. - Top by others
- Remaining vanities inc. laminate top
- Std. Blum Hinges- **not soft close**
- Std. Metabox Drawers- **not soft close**
- Master Ens: Top drawers(Sink Full height)
- Mains: Full height doors (top drawers added if Masters can't accommodate)
- Optional laundry base & wall cabinets

THE BRISTOL

ELEVATION A & B | 2,590 SQ. FT.

706 sq. ft. of opt. finished Lower Level

WALLACETON
EST. 1870

28-2590 ELEV. B

Sketch # 4

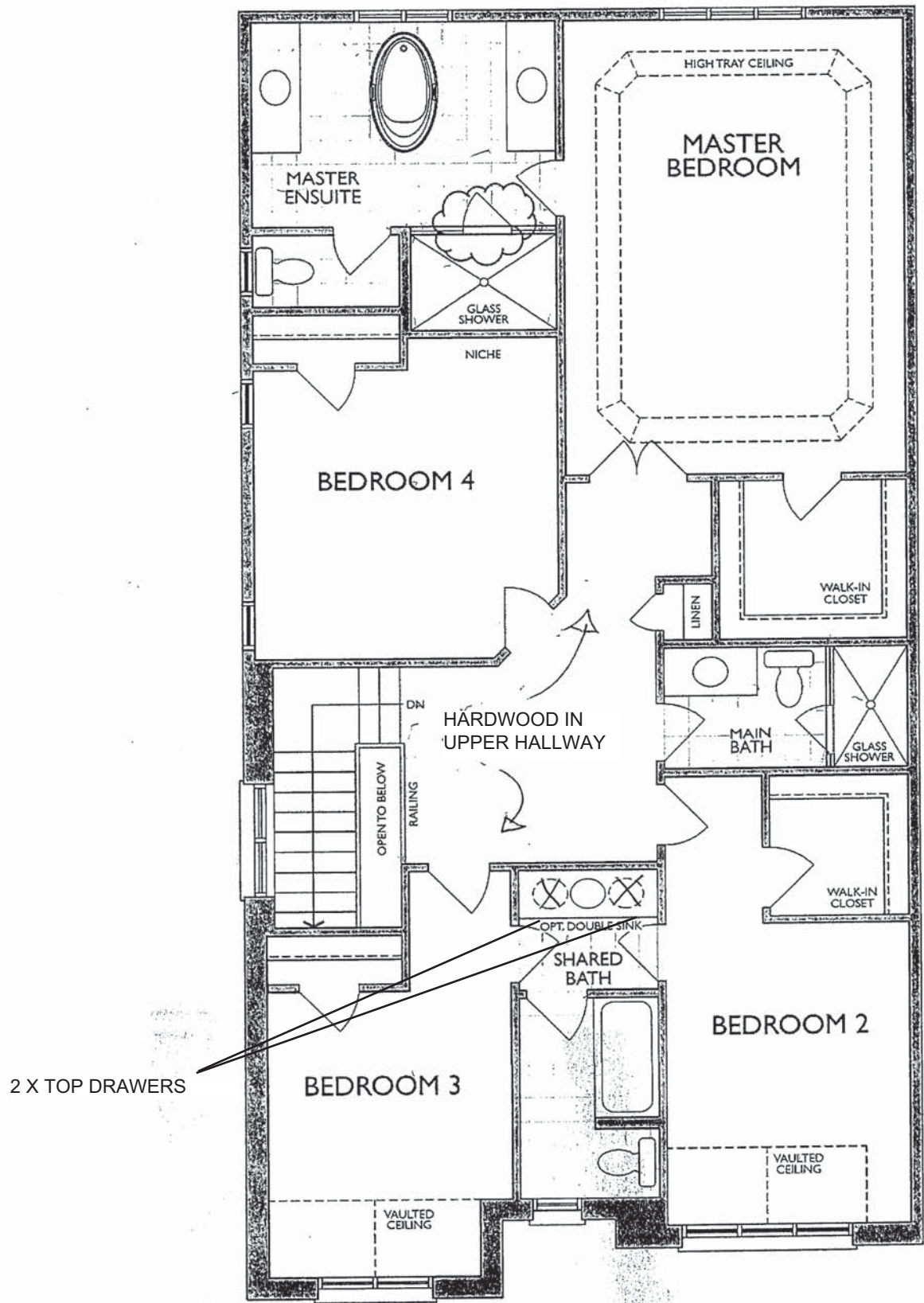

SECOND FLOOR
ELEVATION B

* Master Ensuite Shower Door Swing Changed

9/20/2022

Sketch #5

MASTER ENSUITE
(2ND FLR)

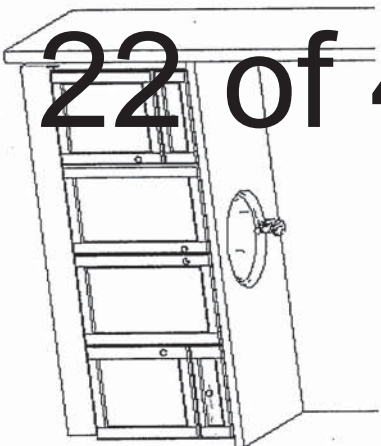

MAIN BATH
(2ND FLR)

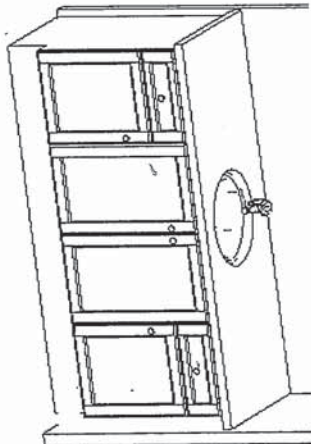

SHARED ENSUITE
(2ND FLR)

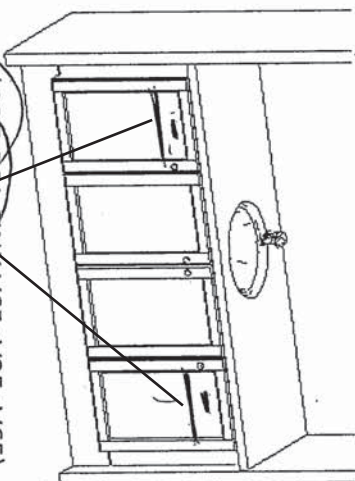

2 X TOP DRAWERS

(OPT. DBL SINK V65+V35+V65)

LAUNDRY
OPT. BASE, OPT. UPPERS
(GROUND FLOOR)

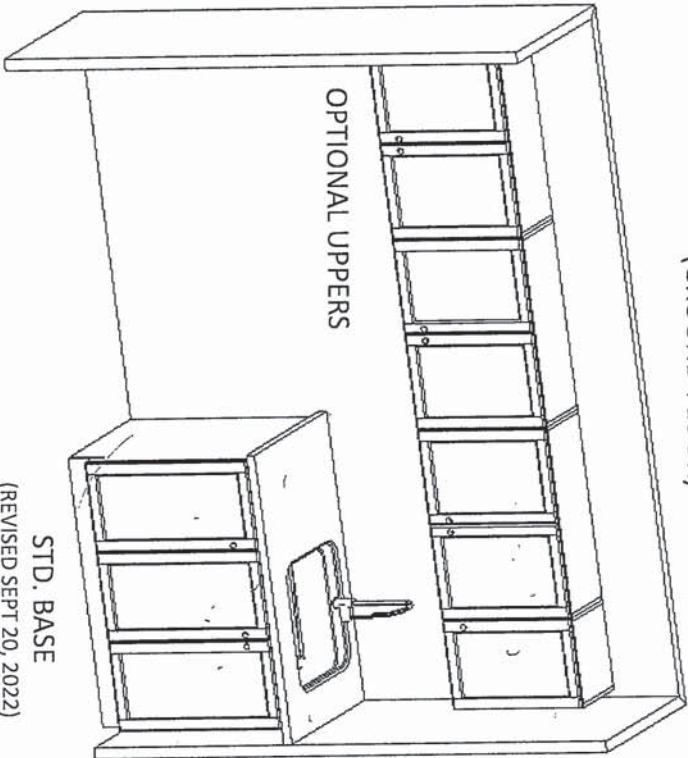

OPT. BASEMENT BATH

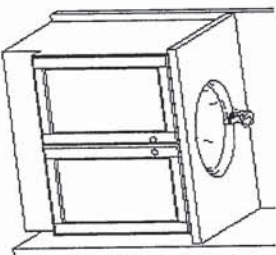

STD. BASE
(REVISED SEPT 20, 2022)



FRIENDEL
KITCHENS LIMITED
1350 Shawson Drive, Mississauga, ON L4W 1G5

HEATHWOOD HOMES
WALLACETON, KITCHENER ON
MODEL: 28-2590 (3403)

STANDARD CONTRACT INCLUDES:

Appliance Openings

- Hood Opening: 30"W Builder hood
- Fridge Opening: 37 3/8 "W X 73 3/8"
- Fridge cabinet & gables: 66cm Deep
- Stove Opening: 30" Freestanding
- Dishwasher Opening: 24"

Standard Kitchens Scope:

- 100cm H wall cabinets
- Std. Blumotion Hinges- **soft close**
- Std. Metabox Drawers- **not soft close**
- Min 40cm W drawer
- Base pie cut corner cabinets
- Backing on all cabinets
- Countertop by others
- Upgrade applied paneled fridge & dishwashers supply only (appliance hardware by others)

Standard Vanity & Laundry Scope:

- Powder by others, pedestal
- Master Ens. - Top by others
- Remaining vanities inc. laminate top
- Std. Blum Hinges- **not soft close**
- Std. Metabox Drawers- **not soft close**
- Master Ens: Top drawers(Sink Full height)
- Mains: Full height doors (top drawers added if Masters can't accommodate)
- Optional laundry base & wall cabinets

Project: Wallaceton
Unit: 3135, Phase: 3
Model: 28-2590 B THE BRISTOL

23 of 45

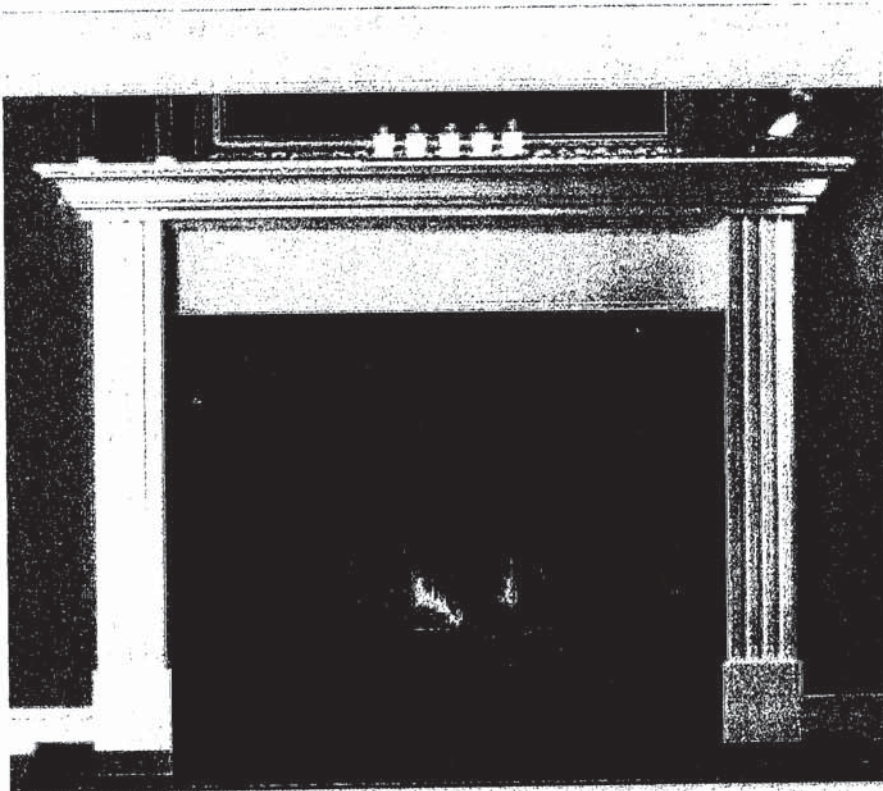

NFAS NF15 Mantel

- CABINET ON BUILT-
OUT WALL SEE NEXT
PAGE FOR SKETCH

FM
FK.

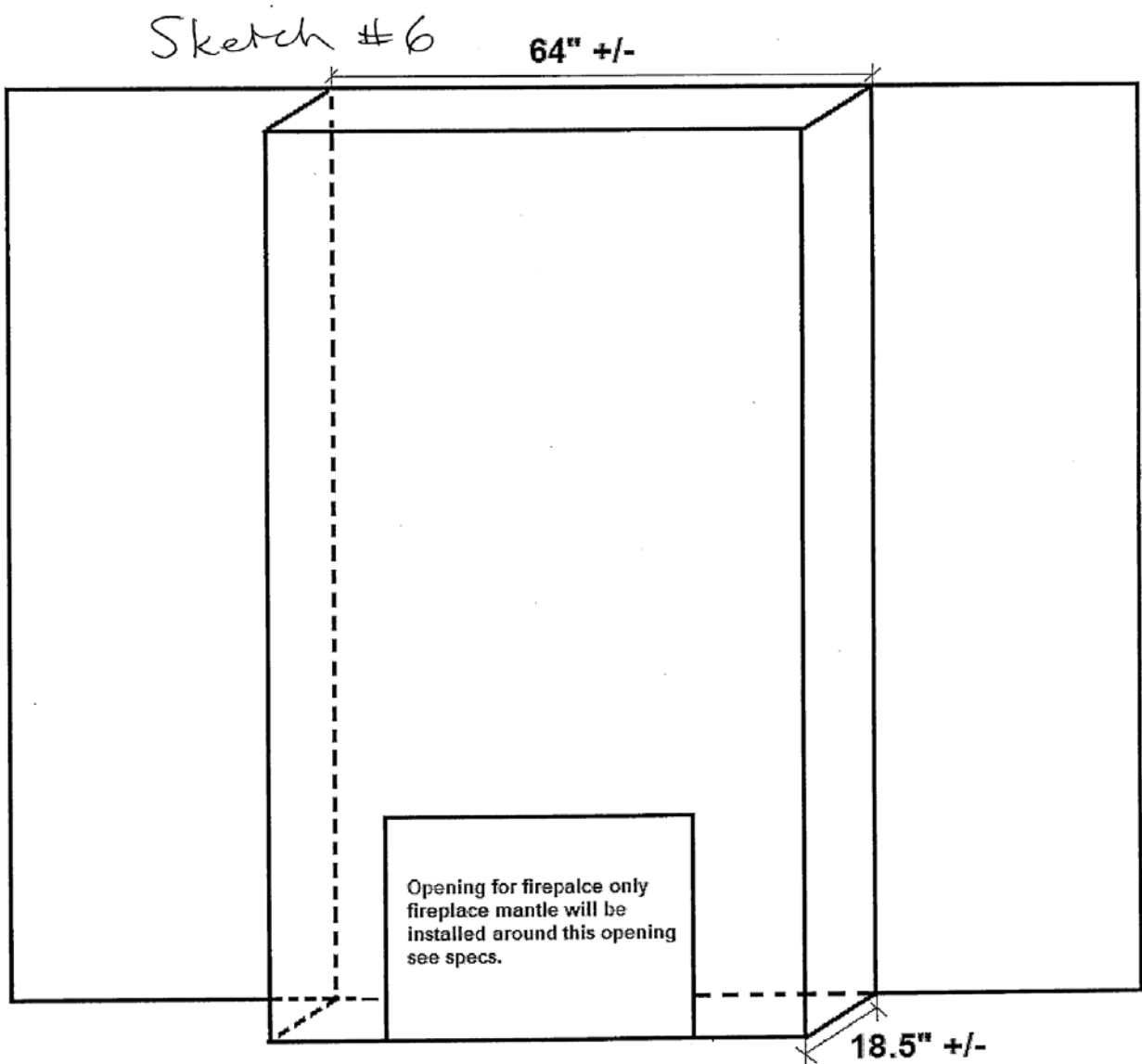

GREAT ROOM FIREPLACE
BUILD OUT WALL



Sink Specifications

Colour	SKU
brushed finish	401248

Design and planning tips

- Min cabinet size: 36 in (915 mm)
- Bowl Depth: 9 in (230.0 mm)

Specifications:
Installation clips, Sink template, Installation instructions, 3 ½" (90 mm) stainless steel strainer

Depending on cabinet construction, a different cabinet size may be required. Consult the cabinet manufacturer.
Codes/Standards: ASME A112.19.3-2017/ CSA B45.4-17

Optional Accessories

Elevated Grid	406346
Workstation	406344
CapFlow Strainer Cover	517666
Ash Cutting Board	406345
Sink Grid	402125

QUATRUS U 1 SUPER SINGLE
Stainless steel brushed finish

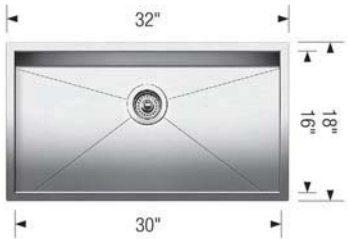

Warranty
Limited lifetime warranty on all sinks and faucets. One-year warranty on all accessories and soap dispensers.

Code/Standards Compliance
BLANCO sinks and faucets are third-party tested and certified to CSA, cUPC, ANSI/ASME, IAPMO and NSF standards and listed by applicable certification bodies. For more information on individual product listings, contact our office or listing organization.

 Need support? Learn more by watching our sink & faucet How-to videos:
<https://www.blanco.com/ca-en/support/how-to-videos/how-to-videos-for-sinks/>

	BLANCO Canada Inc 100 Corporation Drive Brampton ON L6S 6B5	Tel & Fax Tel: 905-494-2400 Toll free: 1-877-425-2626 Fax: 905-494-2425 Toll free: 1-877-825-2626
---	---	---

While BLANCO strives to provide accurate information, all images and dimensions in this document are intended for reference only and are subject to change at any time without notice. This document is not intended for use as an installation guide. For technical installation details, refer to installation instructions provided with the product. BLANCO assumes no responsibility for the use of superseded or voided specifications.



Specifications

FAUCET DESCRIPTION

- Reflex™ pulldown system offers smooth operation, easy movement and secure docking
- Power Clean™ spray technology
- Metal construction with various finishes identified by suffix
- Quick connect installation
- Pulldown spray with 68" braided hose
- Flexible supply lines with 3/8" compression fittings
- High arc spout provides height and reach to fill or clean large pots while pulldown wand provides the maneuverability for cleaning or rinsing
- 360° rotating spout
- Faucet designed for handle to be mounted on right side only

OPERATION

- Lever style handle
- Temperature controlled by 100° arc of handle travel
- Operates with less than 5 lbs. of force
- Operates in stream or spray mode in the pullout or retracted position

FLOW

- Flow is limited to 1.5 gpm (5.7 L/min) max at 60 psi

CARTRIDGE

- 1255™ Duralast™ cartridge

STANDARDS

- Third party certified to IAPMO Green, ASME A112.18.1/CSA B125.1 and all applicable requirements therein including NSF 61/9G & 372
- Meets CalGreen and Georgia SB370 requirements
- Complies with California Proposition 65 and with the Federal Safe Drinking Water Act
- The backflow protection system in the device consists of two independently operating check valves, a primary and a secondary which prevent backflow

- ADA  for lever handle

WARRANTY

- Lifetime limited warranty against leaks, drips and finish defects to the original homeowner
 - 10 year limited warranty when used in a multifamily installation
 - 5 year limited warranty when used in a commercial installation
- Visit www.moen.com/support for complete details and limitations

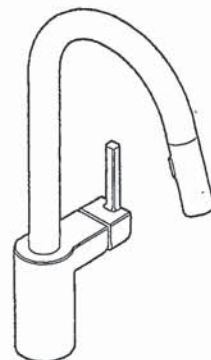

ALIGN™

**Single Handle High Arc
Pulldown Kitchen Faucet**

Models: 7565 series

**NOTE: THIS FAUCET IS DESIGNED TO BE INSTALLED
THROUGH 1 HOLE, 1-1/2" (38mm) MIN. DIA.
(OPTIONAL 3-HOLE ESCUTCHEON 141002 AVAILABLE)**

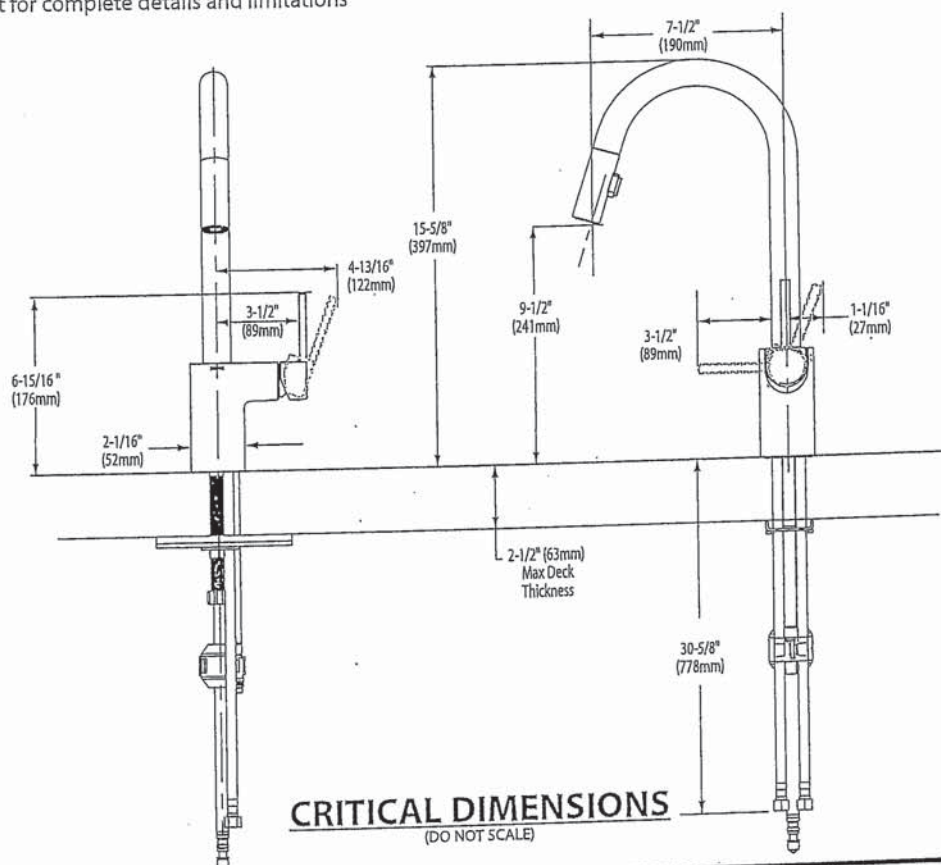

FOR MORE INFORMATION CALL: 1-800-BUY-MOEN
www.moen.com

FK
FM



 **BARRIER FREE (ABOVE COUNTER OR DROP-IN ONLY)**

**BOULEVARD®
PEDESTAL SINK**
VITREOUS CHINA

BOULEVARD® PEDESTAL SINK

- STD
- ☐

~~0641.800~~

~~Faucet holes on 8" (203mm) centers (Illustrated)~~
- ☐

0641.400

Faucet holes on 4" (102mm) centers
- ☐

~~0641.100~~

~~Center hole only~~

- Classic styled rectangular pedestal lavatory
 - Vitreous china
 - Rear overflow
 - Supplied with mounting kit
 - Right Height® for greater comfort during use
 - Faucet ledge with large deck area (faucet not included)
 - **Design coordinates with Boulevard® Toilet**
 - Basin has flat bottom to also allow use as an **above counter** sink or a **drop-in** sink (with u-shaped cut out)

Nominal Dimensions:
24" x 19" x 35-1/2"
(610 x 483 x 902mm)

- ☐

0641.008

Pedestal top-8" (203mm) centers
- ☐

0641.004

Pedestal top-4" (102mm) centers
- ☐

0641.001

Pedestal top-center hole only
- ☐

0010.000

Pedestal only

Bowl sizes:
17" (432mm) wide,
12-1/2" (318mm) front to back,
5" (127mm) deep

**Compliance Certifications -
Meets or Exceeds the Following Specifications:**
• ASME A112.19.2 - 2008/CSA B45.1-08



SEE REVERSE FOR ROUGHING-IN DIMENSIONS

To Be Specified:

- ☐

Color:

☐

White

☐

Linen
- ☐

Faucet Finish:
- ☐

Supplies:
- ☐

1-1/4" Trap:
- ☐

Nipple:

* See faucet section for additional models available

American
Standard

BOULEVARD®
PEDESTAL SINK
VITREOUS CHINA

☐ BARRIER FREE (ABOVE COUNTER OR DROP-IN ONLY)

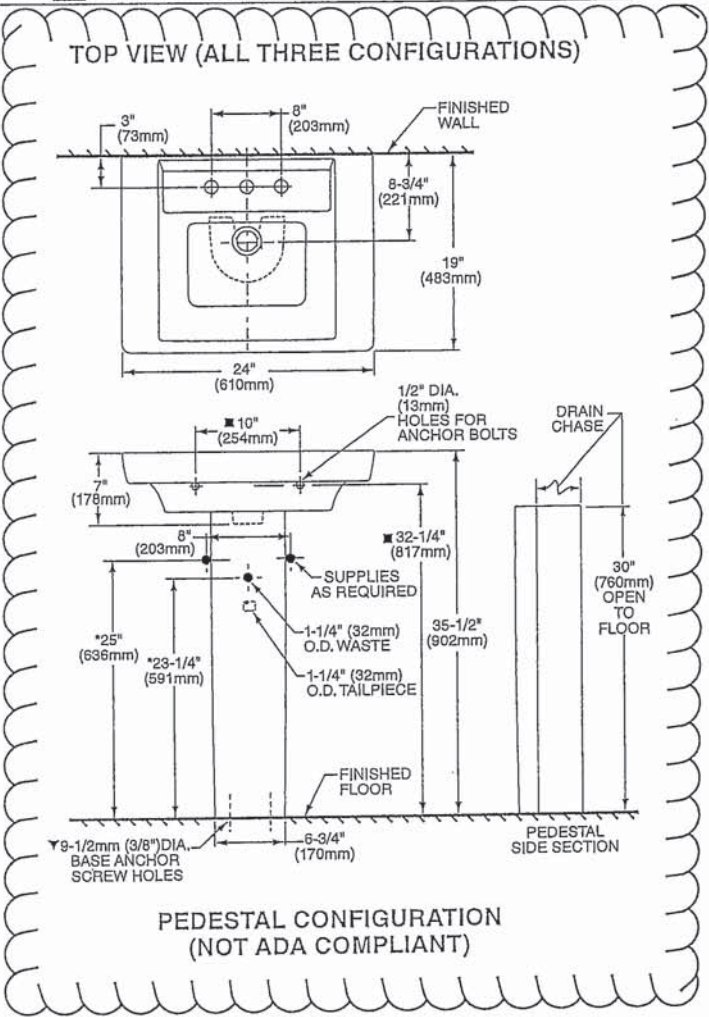

ABOVE COUNTER CONFIGURATION

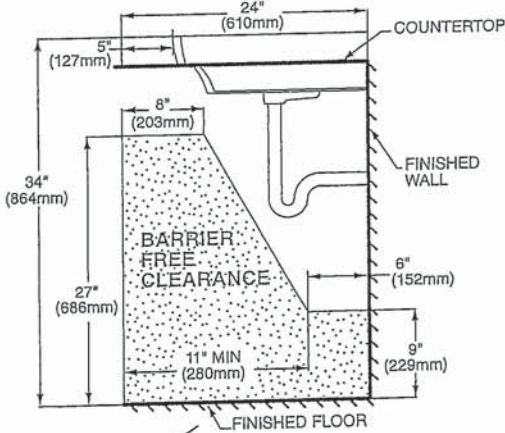
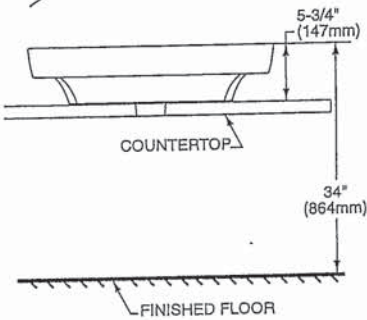

DROP-IN SINK CONFIGURATION



ABOVE COUNTER AND DROP-IN SINK CONFIGURATIONS MEET THE AMERICANS WITH DISABILITIES ACT GUIDELINES AND ANSI A117.1 ACCESSIBLE AND USABLE BUILDINGS AND FACILITIES - CHECK LOCAL CODES.
Top of sink installed at 34" (864mm) height from finished floor.
Sink installed 5" (127mm) minimum from front edge of countertop.
Provide 27" (686mm) knee clearance area.

NOTES:
* DIMENSIONS SHOWN FOR LOCATION OF SUPPLIES AND "P" TRAPS ARE SUGGESTED.
▼ PEDESTAL ANCHORING SCREWS NOT INCLUDED.
■ SUITABLE FOR REINFORCEMENT ONLY. ACTUAL DIMENSIONS MUST BE TAKEN FROM FIXTURE.
FITTING NOT INCLUDED AND MUST BE ORDERED SEPARATELY.
PROVIDE SUITABLE REINFORCEMENT FOR ALL WALL SUPPORTS.
INSTALLATION INSTRUCTIONS SUPPLIED WITH LAVATORY.

IMPORTANT: Dimensions of fixtures are nominal and may vary within the range of tolerance established by ANSI Standard A112.19.2. These measurements are subject to change or cancellation. No responsibility is assumed for use of superseded or voided pages.

FM
FK

American Standard

Style That Works Better

 BARRIER FREE

OVALYN™ UNDERCOUNTER SINK

- Classic oval undermount sink
- Made from vitreous china
- Front overflow
- Supplied with mounting kit (047194-0070A) and template

☐ **0495.221 Unglazed rim**

435 x 359mm
(17-1/8" x 14-1/8")

☐ **0495.300 Glazed underside**

Bowl size:

382mm (15-1/16") wide
306mm (12-1/16") front to back
140mm (5-1/2") deep

☐ **0496.221 Unglazed rim**

489 x 413mm
(19-1/4" x 16-1/4")

☐ **0496.300 Glazed underside**

Bowl size:

432mm (17") wide
356mm (14") front to back
140mm (5-1/2") deep

☐ **0497.221 Unglazed rim**

546 x 441mm
(21-1/2" x 17-3/8")

☐ **0497.300 Glazed underside**

Bowl size:

483mm (19") wide
391mm (15-3/8") front to back
140mm (5-1/2") deep

Compliance Certifications -

Meets or Exceeds the Following Specifications:

- ASME A112.19.2M for Vitreous China Fixtures
- CAN/CSA B45 series

To Be Specified:

- ☐ Color: ☐ White ☐ Bone ☐ Linen
☐ Silver ☐ Fawn Beige ☐ Black
- ☐ Faucet*:
☐ Faucet Finish:
☐ Supplies:
☐ 1-1/4" Trap:

* See faucet section for additional models available

**OVALYN™
UNDERCOUNTER SINK**
VITREOUS CHINA

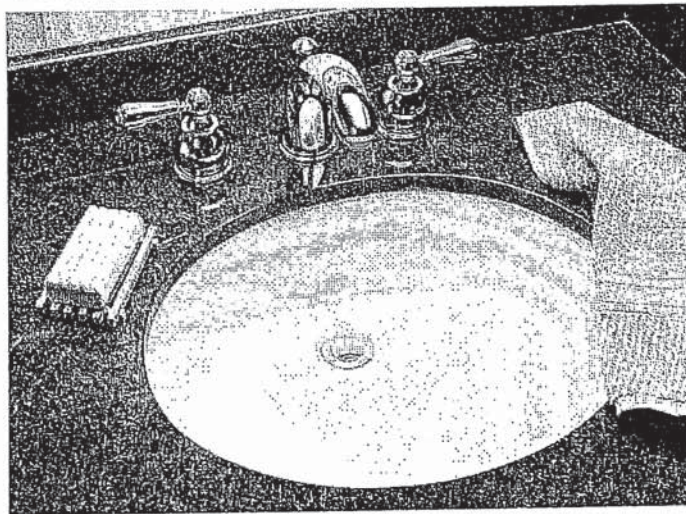

STD Master Ensuite Undermount SINGLES

X 2

SEE REVERSE FOR ROUGHING-IN DIMENSIONS

FK
FM

American Standard
Style That Works Better

OVALYN™
UNDERCOUNTER SINK
VITREOUS CHINA

BARRIER FREE

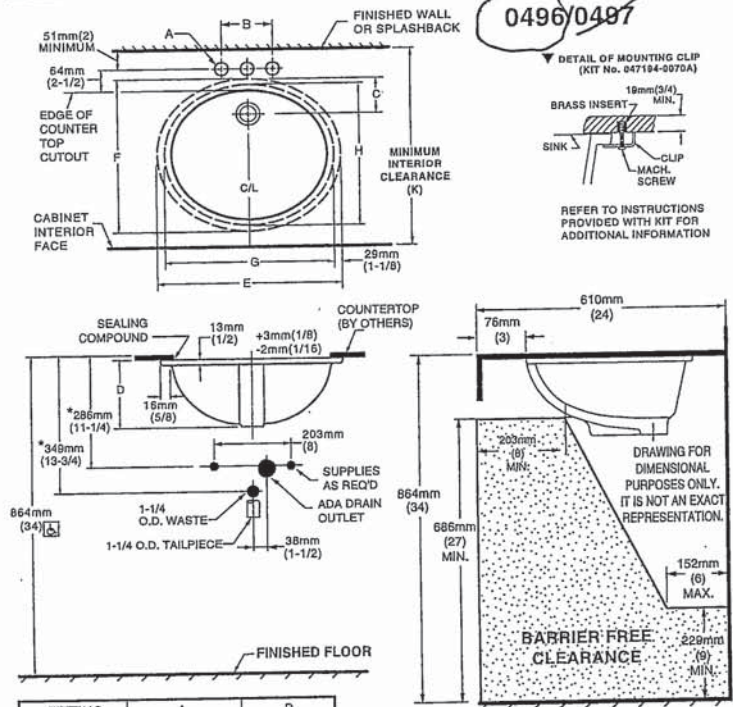

NOTES:
* DIMENSIONS SHOWN FOR LOCATION OF SUPPLIED AND "P" TRAP ARE SUGGESTED.
▼ UNDERCOUNTER MOUNTING KIT SUPPLIED WITH SINK.
PLEASE NOTE MINIMUM INTERIOR CLEARANCE DIMENSION (K). FITTINGS NOT INCLUDED AND MUST BE ORDERED SEPARATELY. USE ENCLOSED TEMPLATE FOR COUNTERTOP CUTOUT SEALING COMPOUND SUPPLIED BY OTHERS.
IMPORTANT: Dimensions of fixtures are nominal and may vary within the range of tolerances established by ANSI Standard A112.19.2. These measurements are subject to change or cancellation. No responsibility is assumed for use of superseded or voided pages.

MEETS THE AMERICANS WITH DISABILITIES ACT GUIDELINES AND ANSI A117.1 ACCESSIBLE AND USEABLE BUILDINGS AND FACILITIES - CHECK LOCAL CODES.
Countertop 864mm (34") from finished floor. Lavatory installed 76mm (3") from front edge of countertop. Countertop thickness to be 25mm (1") maximum.

FITTING	A	B
CENTERSET	1-1/4 (32mm)	4 (102mm)
SPREAD	1-3/8 (35mm)	8 (203mm)

CAT. NO.	E	F	G	H	C	D	J	K
0496.221	489mm (19-1/4)	413mm (16-1/4)	432mm (17)	356mm (14)	103mm (4-1/16)	182mm (7-3/16)	16mm (5/8)	500mm (19-11/16)
0497.221	546mm (21-1/2)	441mm (17-3/8)	483mm (19)	391mm (15-3/8)	95mm (3-3/4)	191mm (7-1/2)	19mm (3/4)	534mm (21-1/16)

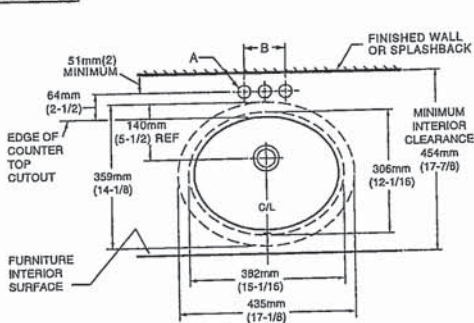

0495

DETAIL OF MOUNTING CLIP (KIT No. 047194-0070A)

BRASS INSERT 16mm (5/8) MIN.

SINK 16mm (5/8) MIN.

CLIP 16mm (5/8) MIN.

MACH. SCREW

REFER TO INSTRUCTIONS PROVIDED WITH KIT FOR ADDITIONAL INFORMATION

FITTING	A	B
CENTERSET	1-1/4 (32mm)	4 (102mm)
SPREAD	1-3/8 (35mm)	8 (203mm)

NOTES:
USE ENCLOSED TEMPLATE FOR COUNTER TOP CUTOUT. FITTINGS NOT INCLUDED WITH FIXTURE AND MUST BE ORDERED SEPARATELY.
* DIMENSIONS SHOWN FOR LOCATION OF SUPPLIED AND "P" TRAP ARE SUGGESTED.
▼ UNDERCOUNTER MOUNTING KIT SUPPLIED WITH SINK.
PLEASE NOTE MINIMUM INTERIOR CLEARANCE DIMENSION (K). SEALING COMPOUND SUPPLIED BY OTHERS.
IMPORTANT: Dimensions of fixtures are nominal and may vary within the range of tolerances established by ANSI Standard A112.19.2. These measurements are subject to change or cancellation. No responsibility is assumed for use of superseded or voided pages

MEETS THE AMERICANS WITH DISABILITIES ACT GUIDELINES AND ANSI A117.1 ACCESSIBLE AND USEABLE BUILDINGS AND FACILITIES - CHECK LOCAL CODES.
Countertop 864mm (34") from finished floor. Lavatory installed 51mm (2") from front edge of countertop. Countertop thickness to be 25mm (1") maximum.

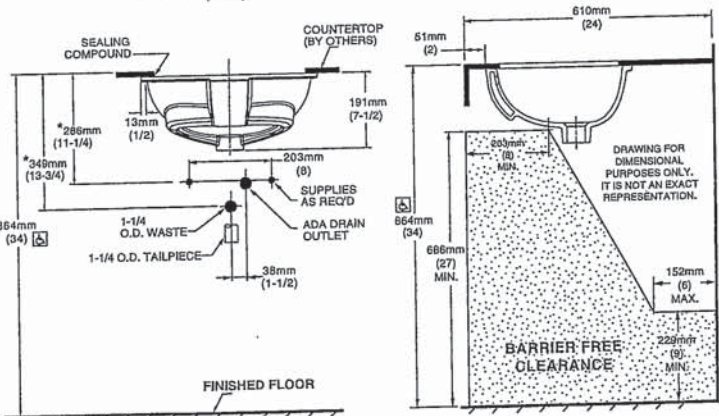

FK
FM



COLONY™
COUNTERTOP SINK
VITREOUS CHINA

COLONY COUNTERTOP SINK

- Vitreous china
- Self-rimming
- Front overflow
- Supplied with template
- Faucet deck
(Faucet shown not included)

- ☐ 0346 803
Faucet holes on 203mm (8") centres
- ☐ 0346 403 (Illustrated)
Faucet holes on 102mm (4") centres
- ☐ 0346 001
Centre hole only



Nominal Dimensions:
521 x 448mm (20-1/2" x 17-5/8")

Bowl sizes:
422mm (16-5/8") wide, 279mm (11") front to back, 143mm (5-5/8") deep

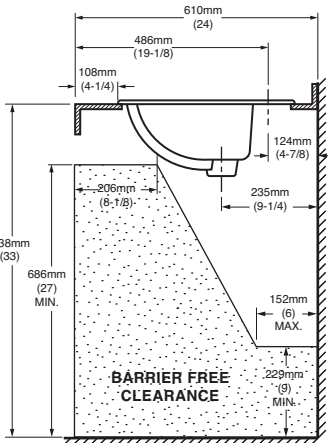
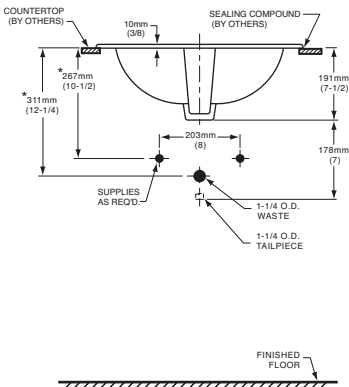
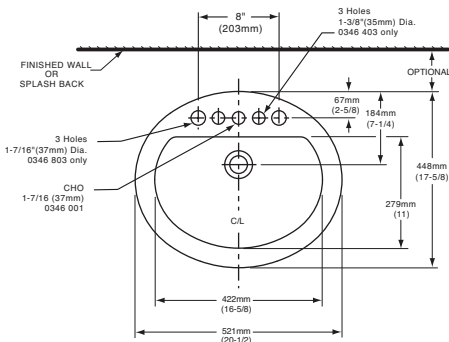

COMPLIANCE CERTIFICATIONS –
Meets or exceeds the following Specifications:
• ASME A112.19.2M for Vitreous China Fixtures.
• CAN/CSA B45 Series.

- To Be Specified
- ☐ Colour:

☐ White

☐ Bone

☐ Silver Gray

☐ Linen
- ☐ Faucet*:
- ☐ Faucet Finish:
- ☐ Supplies & Stops:
- ☐ Trap 1-1/4" (32 mm):

NOTES:
★ DIMENSIONS SHOWN FOR LOCATION OF SUPPLIES AND "P" TRAP ARE SUGGESTED. FOR COUNTERTOP CUTOUT AND INSTALLATION INSTRUCTIONS USE TEMPLATE SUPPLIED WITH SINK.
FAUCETS NOT INCLUDED AND MUST BE ORDERED SEPARATELY.
IMPORTANT: Dimensions of fixtures are nominal and may vary within the range of tolerances established by ANSI Standard A112.19.2.
These measurements are subject to change or cancellation. No responsibility is assumed for use of superseded or voided pages.

* See faucet section for additional models available



DEMI™
Product Specification Sheet



Two Piece Freestanding Collection

CF2007	Two Piece Freestanding Soaker
Size:	60" x 32" x 22" 1524 mm x 813 mm x 559 mm

PRODUCT FEATURES & BENEFITS

- Vacuum formed acrylic reinforced with fiberglass
- Scratch, stain and fade resistant high gloss finish
- Installation friendly two piece design
- Accepts deck mounted faucet
- Includes integral pop up drain and rectangular overflow
- Includes levelling feet

TWO PIECE ASSEMBLY

FRONT VIEW

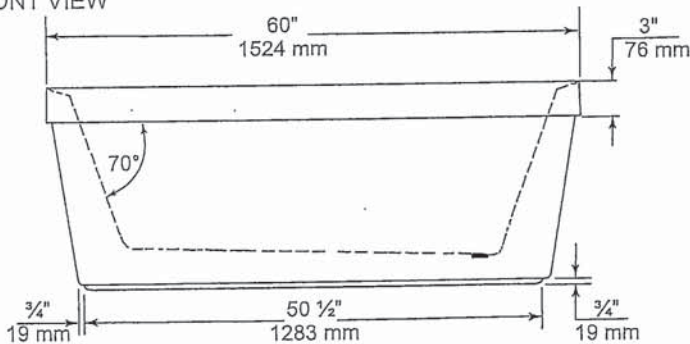

END VIEW

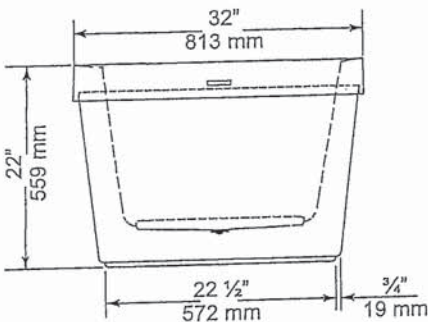

TOP VIEW

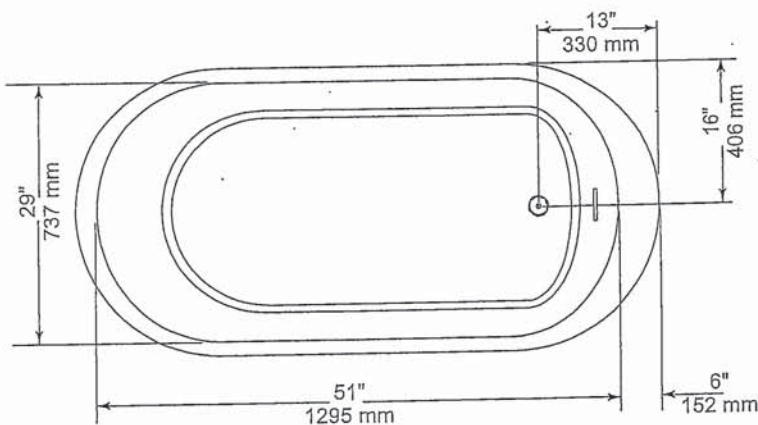

GENERAL SPECIFICATIONS		
Average Weight	90 lb	41 kg
Bathing Well at bottom	43"x 20"	1092 x 508 mm
Capacity Drain to Overflow		195 litres
Water Depth Drain to Overflow	16"	406 mm
Drain Opening (dia.)	2"	51 mm
Overflow Opening	2 1/4"x 1/2"	57 x 13 mm
Drain to Floor Clearance	3 1/4"	83 mm

NOTES: Please confirm measurements on actual product to ensure proper identification. Bathtub to be installed on the floor supported by 5 self levelling feet. Adjust if required to level the bathtub for adequate drainage. Refer to installation instructions for additional information.

IMPORTANT: Dimensions of fixtures are nominal and may vary ± 1/4" (6 mm). Weight may vary ± 5 lb (2.3 kg). Drawing is not to scale. These measurements are subject to change at manufacturer's discretion.

Compliance Certifications -
Meets or Exceeds the following Specifications:
• CAN/CSA - B45 Series



FM
FK

MOEN®

Specifications

DESCRIPTION

- Metal construction with various finishes identified by suffix
- 16" long 3/8" tubing connections
- Includes metal or 50/50 pop-up type waste assembly where noted

OPERATION

- Pivot action lever style handle
- Temperature controlled through 180° degree arc of handle travel

FLOW

- Flow is limited to 1.5 gpm max (5.7L/min) at 60 psi

CARTRIDGE

- 1225 cartridge design
- Nonmetallic/nonferrous and stainless steel material
- Can accommodate reversed piping and back to back installations

STANDARDS

- Third party certified to WaterSense®, CSA B-125.1, ASME A112.18.1 and all applicable requirements referenced therein including NSF61/9
- Complies with California Proposition 65 and with the Federal Safe Drinking Water Act

- ADA  for lever handle

WARRANTY

- Lifetime limited warranty against leaks, drips and finish defects to the original consumer purchaser
- 5 year warranty if used in commercial installations

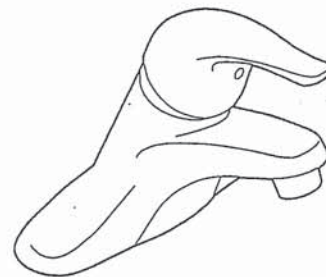

CHATEAU® Single-Handle Lavatory Faucet

with Metal Waste Assembly

Model: L4625 series

L4631BC

Bulk Packed (12 per carton):
L64624 series

with 50/50 Waste Assembly

Bulk Packed (12 per carton):
L64625 series

Less Waste

Bulk Packed (12 per carton):
L64600 series

NOTE: THIS FAUCET IS DESIGNED TO BE
INSTALLED THRU 3-1" DIA. HOLES, 2" ON CENTER

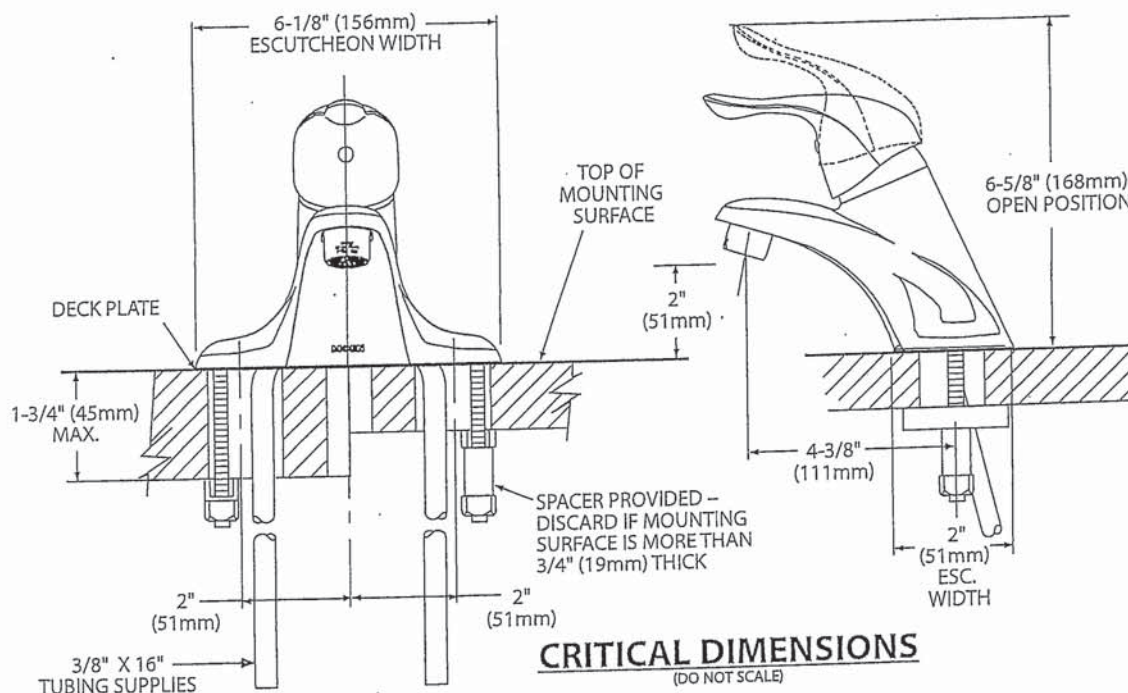

FOR MORE INFORMATION CALL: 1-800-BUY-MOEN
www.moen.com

FK
FM



Buy it for looks. Buy it for life.®

There is more than 1 version of this model.
Page down to identify the version you have.

DESCRIPTION

- Metal construction with various finishes identified by suffix
- Includes non-metallic showerhead, arm, flange and non-metallic diverter tub spout

OPERATION

- Handle operates counterclockwise through a 270° arc with off at 6 o'clock and maximum hot at the 9 o'clock position. Shut off in clockwise direction
- Adjustable temperature limit stop to control maximum hot water temperature
- Pressure balancing mechanism maintains selected discharge temperature to $\pm 3^\circ$

FLOW

- Showerhead is limited to 2.5 gpm (9.5 L/min) at 80 psi
- EP suffix models are limited to 1.75 gpm (6.6 L/min) at 80 psi
- NH suffix models contain no showerhead

CARTRIDGE

- 1222 cartridge design
- Accommodates back to back installations
- Nonmetallic/nonferrous and stainless steel material

STANDARDS

- Third party certified to meet ASME A112.18.1/CSA B125.1 and all applicable requirements referenced therein
- EP suffix models are third party certified to WaterSense®

- ADA for lever handle

WARRANTY

- Lifetime limited warranty against leaks, drips and finish defects to the original consumer purchaser
- 5 year warranty if used in commercial installations

Specifications



CHATEAU® POSI-TEMP® Single-Handle Tub/Shower Trim Kit

Models: TL181 series - valve trim only
(Bulk Packed 12 per carton)
TL182 series - shower trim only
(Bulk Packed 12 per carton)
TL183 series - tub/shower trim
(Bulk Packed 12 per carton)

Valves: 62300 series
2500 series

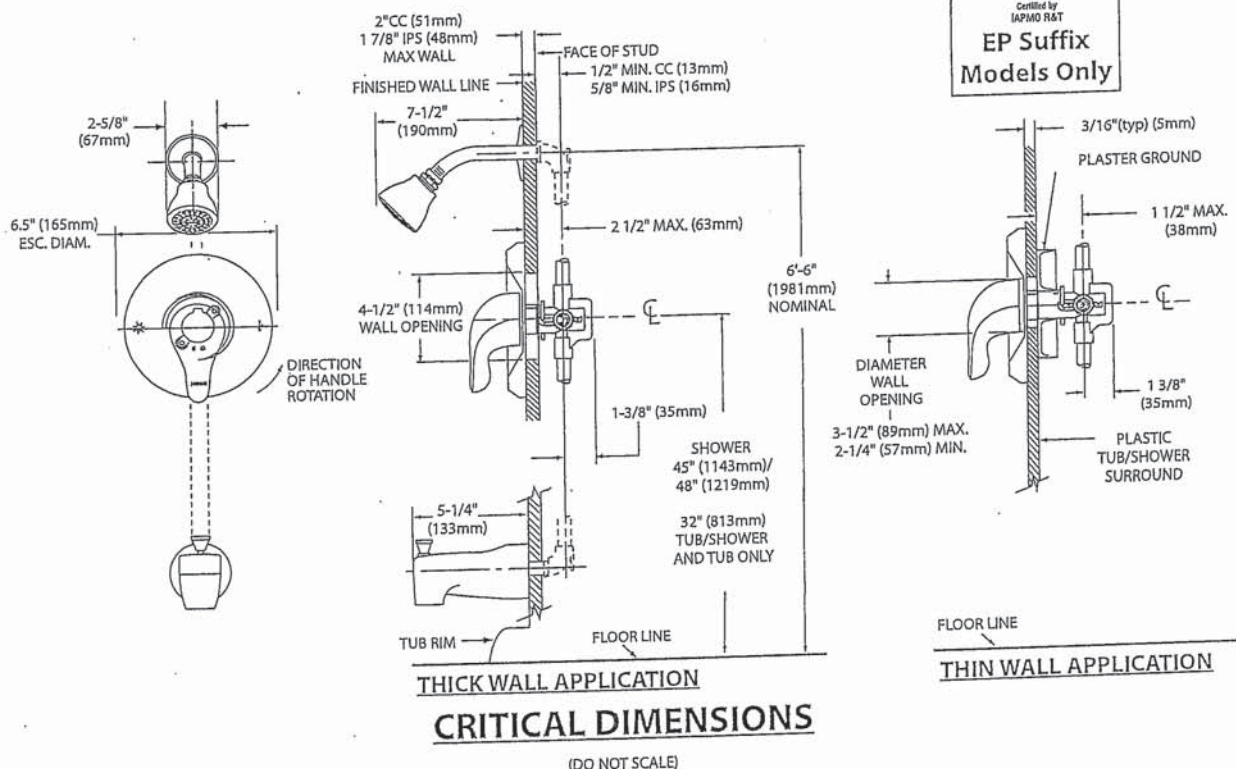

FK
FM



Specifications

DESCRIPTION

- Metal construction with various finishes identified by suffix

OPERATION

- Lever style handles with hot and cold color indicator
- Rotate hot side handle counterclockwise to open (clockwise to close) and the cold side handle (clockwise to open) and (counterclockwise to close)

STANDARDS

- Third party certified to: ASME A112.18.1/CSA B-125.1, and all applicable requirements referenced therein
- ADA  for lever handles

WARRANTY

- Lifetime limited warranty against leaks, drips and finish defects to the original homeowner
 - 10 year limited warranty when used in a multi-family installation
 - 5 year limited warranty when used in a commercial installation
- Visit www.moen.com/support for complete details and limitations

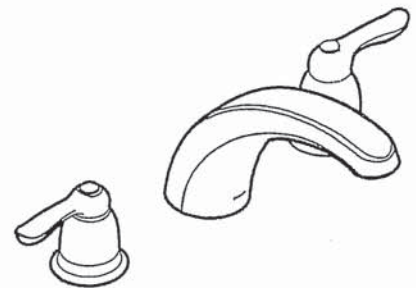

CHATEAU®
Two-Handle Garden Tub Trim

Models: T994 series

Valves: 4792, 4793, 4794, 4796, 4797, 4798

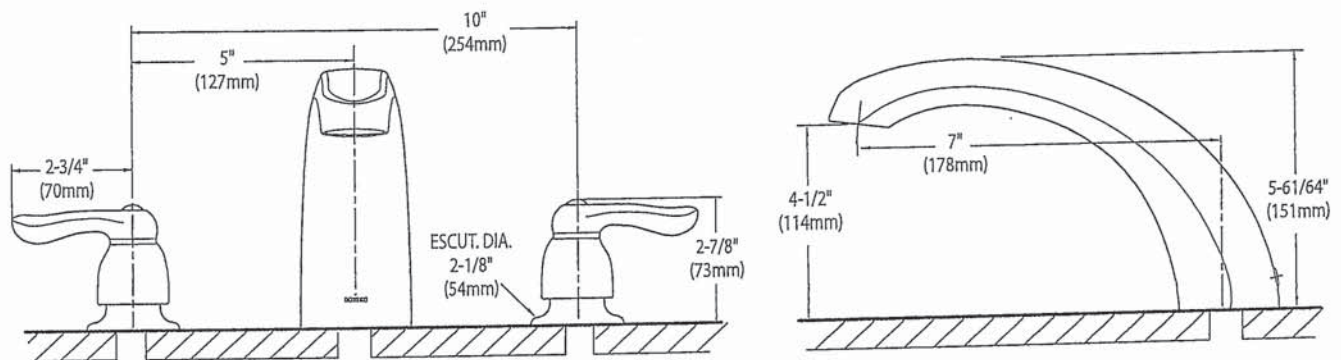

CRITICAL DIMENSIONS

(DO NOT SCALE)

FM
FK

SC(B)519 | ALITO Collection

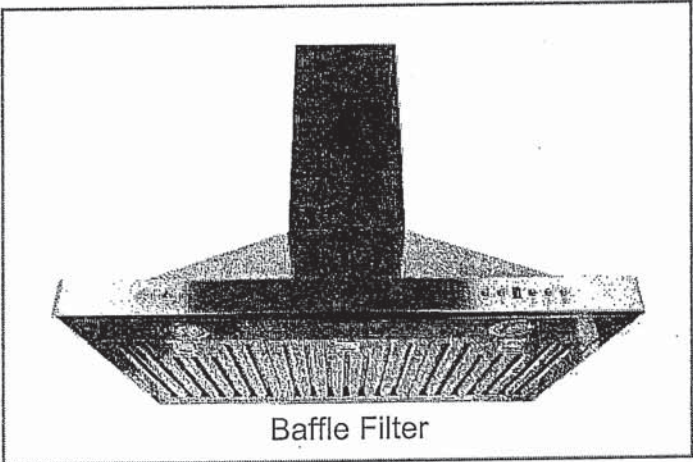

Baffle Filter

Wall Mount

Strong and sturdy with attractive lines and an imposing frame, the SC(B)519 is fitted with a time-delay OFF feature up to nine minutes, a 550 CFM fan, two bright front mounted LED lights and a digital three-speed push button control panel.

Green Features



3 Speed Push Button Control Panel



Long-Lasting LED Lights



Time-Delay OFF Feature



Grease Cup

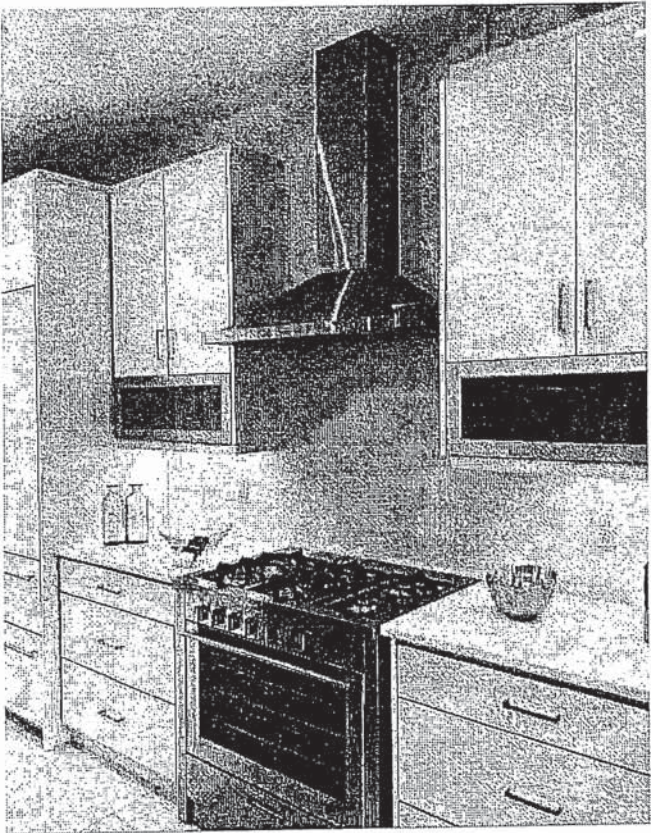

Model	Colour	Ducting	Filters	Size	CFM
SCB51930	Stainless Steel	6"	Baffle	30"	550
SCB51936	Stainless Steel	6"	Baffle	36"	550

Cyclone Range Hoods Inc.

1361 Huntingwood Drive, Unit 16, Toronto, ON, M1S 3J1, Canada.

Toll-Free: 1-888-293-5662 Tel: (416) 293-0933 Fax: (416) 293-4793 Website: www.CycloneRangeHoods.com

FK
FM

SC(B)519 | ALITO Collection



Features

- Wall mount range hood
- 6" round duct adapter
- Non-stick aluminum fan blades
- 3 speed push button control
- 2 LED lights (2 x 1.4W, 4000K)
- Quick release aluminum mesh filters
- Standard chimney fits up to 9 ft. ceiling
- Up to 9 minutes time-delay OFF feature
- Plug-in connection

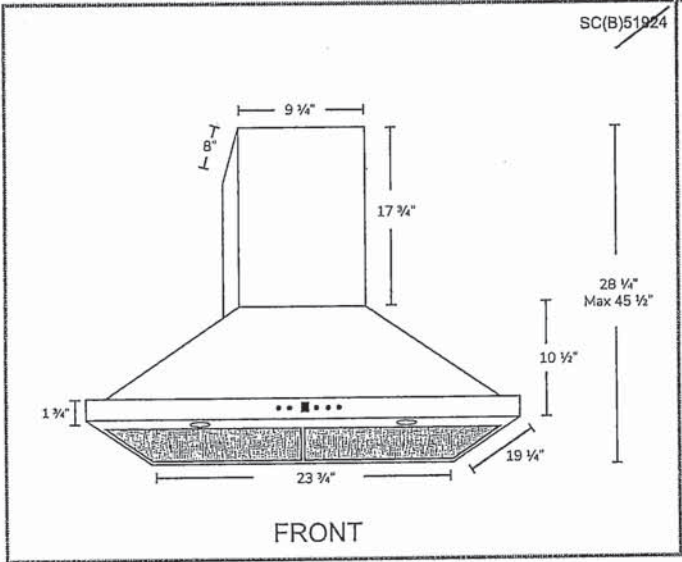
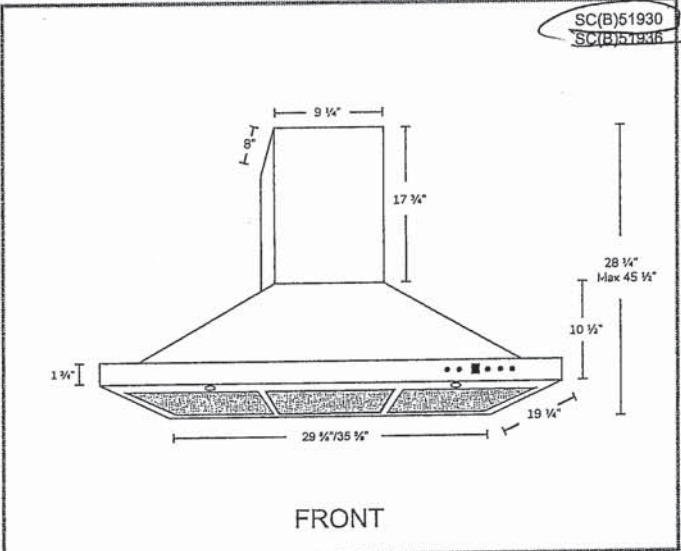

Options

- Filters:

SCB519 - Quick Release Stainless Steel Baffle Filters
- Chimney Flues:
A1.CH10 - short (7'-8' ceilings)
A1.CH18 - standard (8'-9' ceilings)
A1.CH30 - extended (9'-11' ceilings)
- Widths: 24", 30", 36"

Specifications

- | | | |
|--------------------------------------|--------------------------------|-----------------------------|
| ▪ Air Flow Volume: 550 CFM | ▪ Current: 2.5 Amps | ▪ Finishes: Stainless Steel |
| ▪ Electrical Connection: 120 V/60 Hz | ▪ Fan Speed: 1599 RPM | ▪ Ducting: 6" Round |
| ▪ Power Consumption: 300 Watts | ▪ Fan Type: Centrifugal Blower | ▪ Noise Level: Min. 2 Sones |
| | | Max. 6 Sones |



FK
F57

14 INSTALLATION

Dimensions and Clearances

- Check the dimensions of the appliance and the installation path to ensure there is sufficient room to move the refrigerator through doors or narrow openings.
- If an opening is too narrow to fit the refrigerator through, the doors must be removed.
- The installation location chosen for the refrigerator should allow space behind the unit for connections and airflow and space in front to open the doors and drawers.
- Too small of a distance from adjacent items may result in lowered freezing capability and increased electricity consumption charges. Allow at least 24 inches (610 mm) in front of the refrigerator to open the doors, and at least 2 inches (50.8 mm) between the back of the refrigerator and the wall.

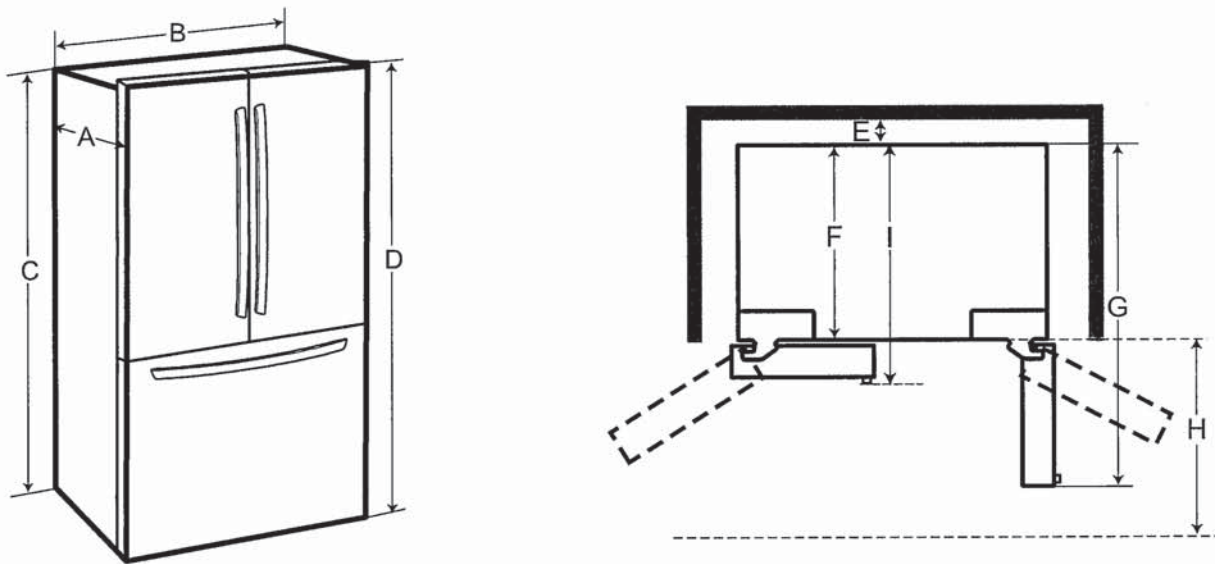

-	List	LFXS28596*/ LMXS28596*	LFXS26596*	LFXC22596*
A	Depth without handle	33 3/4" (857 mm)	32 3/8" (822 mm)	28 3/4" (728 mm)
B	Width	35 3/4" (908 mm)	35 3/4" (908 mm)	35 3/4" (908 mm)
C	Height to Top of Case	68 3/8" (1737 mm)	68 3/8" (1737 mm)	68 3/8" (1737 mm)
D	Height to Top of Hinge	69 3/4" (1772 mm)	69 3/4" (1772 mm)	69 3/4" (1772 mm)
E	Back Clearance	2" (50 mm)	2" (50 mm)	2" (50 mm)
F	Depth without Door	29 7/8" (759 mm)	28 1/2" (724 mm)	24 3/4" (630 mm)
G	Depth (Total with Door Open 90°)	48 1/2" (1232 mm)	47 1/8" (1197 mm)	43 1/2" (1103 mm)
H	Front Clearance	24" (610 mm)	24" (610 mm)	24" (610 mm)
I	Depth With handle	36 1/4" (921 mm)	34 7/8" (886 mm)	31 1/4" (792 mm)

STUDIO SERIES



LSCE305ST
LSCE365ST

30" & 36" Radiant Cooktops



Premium Style
& Great Features

COOKING PERFORMANCE

- Electric Cooktops with 5 Elements
- Steady Heat Elements
- Double RF 9"/6", Double LR 8"/5" (LSCE305ST)
- Triple 12"/9"/6", Double 9"/6" (LSCE365ST)

• STYLE AND DESIGN

- Premium Stainless Steel Trim

CONVENIENCE

- SmoothTouch™ Glass Controls
- Bridge Element – 7" (LSCE365ST)

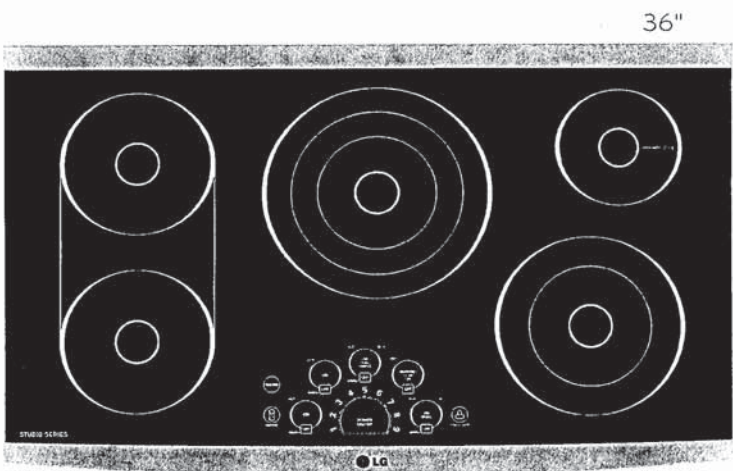
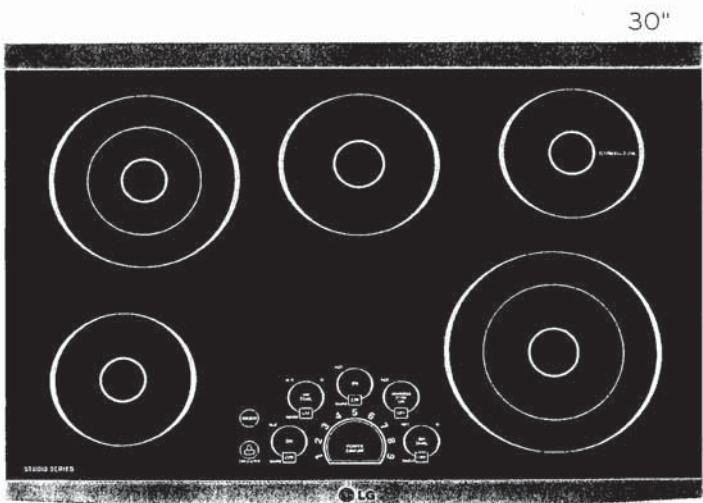

Stainless Steel (ST)



STUDIO SERIES

LSCE305ST
LSCE365ST

30" & 36" Radiant Cooktops

Steady Heat Elements

Steady Heat cooking elements deliver constant heat at any temperature for more precise heat control, and respond quickly to every power setting adjustment.

Dual & Triple Elements

LG's premium cooktops offer versatile elements that fit different sized cookware for convenience and even heating.

SmoothTouch™ Glass Controls

Intuitive SmoothTouch™ Controls are extremely easy to use with just a touch. With just a quick glance of the centralized electronic controls you can see which heating elements are activated, and the smooth surface easily wipes clean.

Bridge Element (LSCE365ST)

In addition to being used separately, the left front and the left rear elements can be joined by the bridge element to evenly heat larger pans.

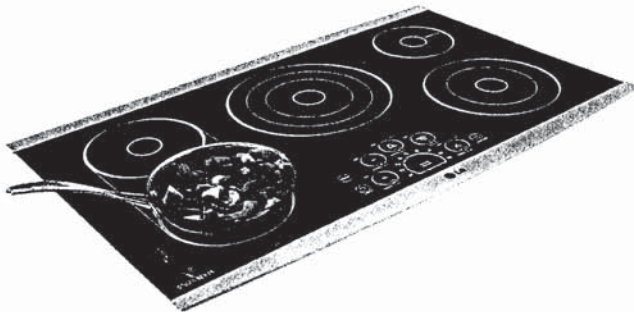

Installation Reference

(See chart at right for measurements)

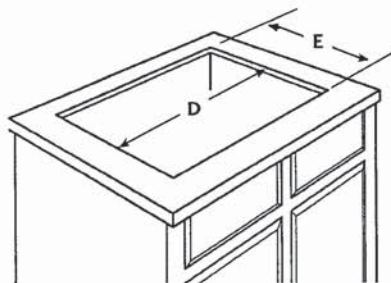
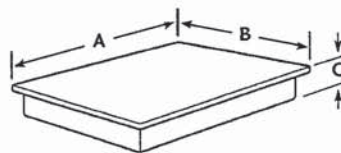

TYPE	Electric
Type	30"
Size (LSCE305ST)	36"
Size (LSCE365ST)	
Cooking Surface	Radiant Glass Surface
Number of Elements	5 (plus bridge element - LSCE365ST)
FEATURES	
Controls Type / Location	SmoothTouch™ / Front Center
Hot Surface Indicator	
Child Lock	
Auto Shut Off	
Under Bench Oven Capable	
Warm Function	
Power Control	Steady Heat
Elements	Ceramic Glass
Surface / Frame Trim	Black / Stainless Steel
CONFIGURATION (LSCE305ST)	
Element Configuration	
Left Front	6" / 1.2kW
Left Rear	8", 5" / 1.9, 0.95kW (Dual)
Center	7" / 1.5kW
Right Front	9", 6" / 3.0, 1.4kW (Dual)
Right Rear	6" / 0.1kW (Warm)
CONFIGURATION (LSCE365ST)	
Element Configuration	
Left Front	7" / 1.8kW
Left Rear	7" / 1.8kW
Center	12", 9", 6" / 3.0, 2.2, 1.1kW (Triple)
Right Front	9", 6" / 3.0, 1.4kW (Dual)
Right Rear	6" / 0.1kW (Warm)
Bridge	7" / 0.8kW (Bridge)
DIMENSIONS (LSCE305ST)	
A: Product Width	30 27/32"
B: Product Depth	21 47/64"
C: Product Height	4"
D: Cut-Out Width	29 3/8"
E: Cut-Out Depth	20 1/4"
Net Weight	34.2 lbs.
DIMENSIONS (LSCE365ST)	
A: Product Width	36 11/16"
B: Product Depth	22 33/64"
C: Product Height	4"
D: Cut-Out Width	34 9/16"
E: Cut-Out Depth	20 3/8"
Net Weight	43 lbs.
POWER SOURCE (LSCE305ST)	
Electrical Requirements	240V/208V, 60Hz AC
Max. Amp Load	40 Amp
Power Cable Location	Right Rear
Total Connected Load	7.7kW @ 240V, 5.8kW @ 208V
POWER SOURCE (LSCE365ST)	
Electrical Requirements	240V/208V, 60Hz AC
Max. Amp Load	50 Amp
Power Cable Location	Right Rear
Total Connected Load	10.5kW @ 240V, 7.9kW @ 208V
WARRANTY	
	2 Years Parts and Labor,
	5 Years Parts on Cooktop and Coils
UPC CODES	
LSCE305ST 30" Radiant Cooktop	48231316620
LSCE365ST 36" Radiant Cooktop	48231316737

www.LG.com

LG Electronics U.S.A., Inc.
1000 Sylvan Avenue Englewood Cliffs, NJ 07632
Customer Service and Technical Support: (800) 243-0000

Dimensions and weights are approximate. Design, features and specifications subject to change without notice.

© 2010 LG Electronics USA, Inc. All rights reserved. "LG Life's Good" is a registered trademark of LG Corp. All other product and brand names are trademarks or registered trademarks of their respective companies. 07/10

HOME APPLIANCES

LG COOKING

LWC3063_

Combi Wall Oven

1.7 cu.ft. Microwave (Speed Oven)
Infrared Heating™
4.7 cu.ft. Oven
True Convection
Steam Cooking
Self+EasyClean
SmartThinQ® Technology

SMART APPLIANCE



Enjoy new ways to control your home with LG smart appliances

- Start or stop your Oven remotely
- Set your Monitor Status from your smartphone
- Works with the LG SmartThinQ® app

 works with the Google Assistant

 WORKS WITH alexa

 inniti

 SIDE CHEF

SUMMARY	
Total Oven Capacity (cu. ft.)	6.4 (Upper & Lower)
Colors	Stainless Steel / Black Stainless Steel
UPPER OVEN FEATURES	
Capacity (cu.ft)	1.7
Interior(Cavity) - Upper MWO / Lower Oven	Stainless / Enamel Coating
Microwave Power output	950W
Microwave mode power consumption	1650W
Convection Bake mode power consumption	1600W
Broil mode power consumption	1300W
Convection Element (W)	1500W (Sheath heater)
Broil Upper Element (W)	1200W (500W + 700W)
Broil Lower Element (W)	375W
Microwave	Yes
Convection Bake	Yes
Broil	Yes
Speed cook	Yes
- # of Defrost (4 Menu)	Meat / Poultry / Fish / Bread
- # of Sensor cook (9Menu)	Beverage / Casserole / Chicken / Pasta / Pizza / Plate of food / Rice / Soup / Vegetable Bacon(regular sliced) / Bagels(frozen) / Baked potatoes(7-9oz/ea) / Brownie / Cod filets(1 lb) / Corn dog(frozen) / Fresh vegetable / Frozen chicken wings / Frozen fries / Frozen chicken nuggets / Frozen pizza(regular crust) / Frozen soft pretzels / Frozen vegetable / Garlic bread(sliced, frozen) / Hamburger(1/2" thick) / Lamb chops(1/2" thick, 6-7oz) / Meat loaf(9" X 5") / Nachos / Oatmeal / Pork chops(1/2" thick, 6-7oz) / Quinoa / Ribeye steak(1" thick 14-15oz) / Rice / Salmon steak(1" thick) / Sausage / Sirloin steak(1" thick, 18-21oz) / Tenderloin / Vegetable-canned
- # of Auto cook (28Menu)	
- # of Soften (4Menu)	Butter / Cream Cheese/ Frosting / Ice Cream
- # of Melt (5Menu)	Butter / Caramel / Cheese / Chocolate / Marshmallow
LOWER OVEN FEATURES	
Capacity (cu.ft)	4.7
EasyClean®	Yes
Self Clean	Yes (3,4,5 hours)
Variable cleaning time	Yes (3,4,5 hours)
Variable broil	Yes (Full,Center / High,Med,Low)
Broil element	2,500 watts inner / 1,500 watts outer
Bake element	2,500 watts
Bake element type	Hidden (8 pass)
# of rack position	5
12 hrs. shut-off	Yes
- # of light	2 (Halogen Lamp)
Convection conversion	Yes
-Convection element	Yes (2,000 watts Sheath heater)
Convection System/Mode/Cooking System	True Convection
Convection Fan	Single Speed
Oven Cooking mode	Conv.Bake / Conv.Roast / Bake / Broil / Steam Bake / Steam Roast / Probe / more mode (Favolite/Warm/Proof)
Oven Control Features	Glass Touch (SmoothTouch™)
Door Lock	Yes

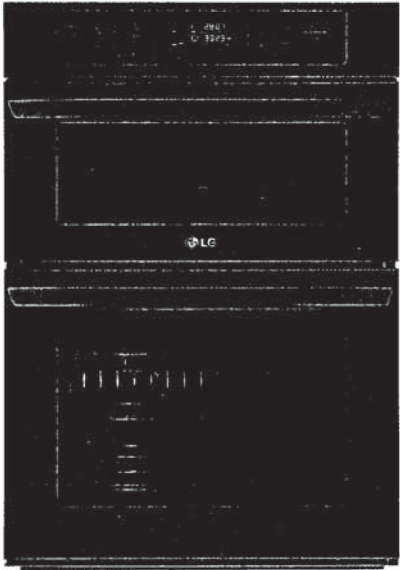

CONTROL	
Oven Control Type	Glass Touch (SmoothTouch™)
Display	White VFD
Language	English / Spanish / French
Smart Function	Wi-Fi / Smart Buzzer
Clock	12 hr or 24 hr (option)
Kitchen Timer	Yes
Timed Cook	Yes
Temperature Unit of Measure	Fahrenheit / Celsius
Cooking Complete Reminder Volume	Beeper (1.Low, 2.Low, 3.Mute)
Sabbath Mode	Yes
APPEARANCE	
Available Colors	Stainless Steel / Black Stainless Steel
Handle/Knobs	Stainless Steel Finish (Aluminum) Black Stainless Steel Finish (Aluminum)
Oven Door Feature	WideView™ Window
Scratch-Resistant	Yes
PrintProof™ Finish	Yes (Black Stainless Steel Only)
SmartThinQ® SMART FEATURES	
SmartDiagnosis™	Yes
Wi-Fi Connectivity	Yes
Works with	Google Assistant and Amazon Alexa
SmartThinQ® with Innit and SideChef	Yes
DIMENSIONS/CLEARANCES/WEIGHT	
Shipping Weight (lbs)	244 lbs
Product Weight (lbs)	194 lbs
Product (W x H x D)	29 3/4" x 43 9/11" x 24 1/2"
Cut-out (W x H x D)	28 1/2" x 43 7/16" x 23 1/2"
Overall Depth (in) - including handle	26 7/8"
Oven Interior Dimensions (Upper) (in) (W x H x D)	20 8/11" x 8 9/25" x 17 5/13"
Oven Interior Dimensions (Lower) (in) (W x H x D)	24 1/2" x 17 5/8" x 18 7/8"
Carton Dimensions (in) (W x H x D)	33" x 30" x 50"
POWER/RATINGS	
Max. Amp load	40A
Rating	7.8KW
Requirements	120 / 240 VAC, 120 / 208 VAC
ACCESSORIES	
Glass Tray(Upper)	Yes
Metal Tray(Upper)	Yes
Rack(Upper)	Yes
Broiler pan & Grid	Yes
Gliding Rack	1
Heavy Duty Rack	2
Meat probe	Yes
Scouring Pad	Yes
WARRANTY	
Parts & Labor	1 Year
UPC CODES	
LWC3063ST (Stainless Steel)	048231339810
LWC3063BD (Black Stainless Steel)	048231339827

HOME APPLIANCES

LG COOKING

LWC3063_

Combi Wall Oven



QUICK INSTALL & CLEARANCES

For full installation directions/clearances please refer to the corresponding User Manual and Installation Guide.

DIMENSIONS / CLEARANCES / WEIGHT	
Product Dimensions (in) (W x H x D)	29 3/4" x 43 9/11" x 24 1/2"
Cut-out (W x H x D)	28 1/2" x 43 7/16" x 23 1/2"
Overall Depth (in) - including handle	26 7/8"
Actual Depth with Door Open (Upper) (in):	37.1"
Actual Depth with Door Open (Lower) (in):	45.7"
Oven Interior Dimensions (Upper) (in) (W x H x D)	20 8/11" x 8 9/25" x 17 5/13"
Oven Interior Dimensions (Lower) (in) (W x H x D)	24 1/2" x 17 5/8" x 18 7/8"
Carton Dimensions (in) (W x H x D)	33" x 30" x 50"
POWER RATINGS	
Max. Amp load	40A
Rating	7.8kW
Requirements	120 / 240 VAC, 120 / 208 VAC

INSTALLATION REQUIREMENTS

- The cabinet base platform must be able to support 202 lbs (91.65 kg) for a Microwave Combination Wall Oven. If the cabinet does not have a solid bottom, two braces or runners must be installed level with the bottom of the cutout to support the weight of the oven. Make sure the base is level and the front of the cabinet is square. If the cabinet base is not level, the oven racks will tend to slide out when opening the door.
- If marks, blemishes or the cutout opening are visible above the installed oven, it may be necessary to add wood shims under the runners and front trim until the marks or opening are covered.
- If the cabinet does not have a front frame and the sides are less than 3/4" (1.9 cm) thick, shim both sides equally to establish the cutout width.
- The junction box must be flush with the rear wall of the cabinet as shown below.
- Allow at least a 23" clearance for the door depth when it is open.
- Kitchen cabinets in contact with the oven must be heat resistant up to 194°F (90°C), and fronts of nearby units up to at least 158°F (70°C).

CUTOUT DIMENSIONS

- Cabinet Width: 30" (762 mm)
- Recommended Minimum Cutout Location from Floor: 12" (304.8 mm)
- Cutout Depth: 23 1/2" Min. (596.9 mm)
- Cutout Width: 28 1/2" Min. (723.9 mm)
28 5/8" Max. (727 mm)
- Cutout Height: 43 7/16" Min. (1103 mm)
43 1/2" Max. (1106 mm)

PRODUCT DIMENSIONS

ELECTRICAL CONNECTIONS

- Be sure the wall oven is installed and grounded properly by a qualified installer or service technician.
- This wall oven must be electrically grounded in accordance with local codes or, in their absence, with the National Electrical Code ANSI/NFPA No.70- latest edition in United States, or with CSA Standard C22.1-1982 and C22.2 No.01982 (or latest edition), Canadian Electrical Code, Part1, and all local codes and ordinances.
- This wall oven must be supplied with the proper voltage and frequency, and connected to an individual, properly grounded branch circuit, protected by a circuit breaker or fuse. For the circuit breaker or fuse required by this model, see the rating plate to find the wattage consumption and refer to the table below to get the circuit breaker or fuse amperage.
- A Microwave Combination Wall Oven can consume up to 7,800 W at 240 VAC. A 50 Amp circuit breaker with wire gauge #8 AWG must be used.
- Do Not ground to a gas pipe.
- Do Not have a fuse in the neutral or grounding circuit.
- A U.L.-listed conduit connector must be provided at the junction box.
- Prepare the electrical connection as follows:
 - Turn off the circuit breaker or remove fuses to the oven branch circuit.
 - With the oven positioned directly in front of the cabinet opening, connect the flexible conduit to the electrical junction box as shown below. Position the conduit in such a manner that it will lie on top of the oven in a natural loop when the oven is installed.
 - If local codes permit connection of the frame grounding conductor to the neutral(white) wire, follow the instructions for a 3-wire circuit connection.
 - If used in mobile homes or new construction, or a recreational vehicle, or local codes do not permit connection of the frame grounding conductor to the neutral(white) wire, follow the instructions for a 4-wire circuit connection.

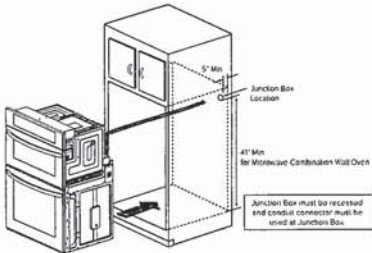

INSTALL THE OVEN

- Install the oven into the cabinet as follows:
 - Slide the oven into the opening.
 - Loop (do not tie) a 36" (91 cm) string around the conduit before the oven is slid into place. Lay the string over the top of the oven and use it to keep the conduit from falling behind the oven.
 - Lift oven into cabinet cutout using the oven opening as a grip. Carefully push against the oven front frame. Do not push against outside edges.
 - While sliding the oven back, pull the string so that the conduit lies on the top of the oven in a natural loop.
 - When you are sure the conduit is out of the way, slide the oven 3/4 way back into the opening. Remove the string by pulling on one end of the loop.
 - Secure the oven.
 - Using the mounting holes on the oven side trim as a guide, drill pilot holes for screws provided. (For securing the Combi Oven, use a minimum of 4 screws, one on each side in both the upper and lower ovens.)
 - Secure the oven to the cabinet with screws provided. If the cabinet is particle board, you must use 3/4" particle board screws. These may be purchased at any hardware store.
- Install the metal bottom trim.
 - Place the metal bottom trim centered over the pre-drilled mounting holes on the lower base.
 - Using 3 screws provided, secure the bottom trim to the bottom edge of the cabinet.
- Reinstall the oven door.

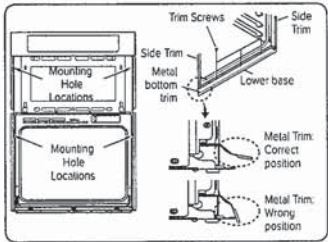

HOME APPLIANCES

LG DISHWASHERS

LDP6797_

Top Control Wi-Fi Enabled Dishwasher with QuadWash® and 3rd Rack



- QuadWash®
- 10-Year Warranty on Inverter Direct Drive Motor
- SmartThinQ® Wi-Fi Connectivity
- Height Adjustable 3rd Rack
- EasyRack™ Plus
- Glide Rail
- Stainless Steel Tub
- LoDecibel™ Quiet Operation (44 dBA)
- Dual Zone Wash
- ENERGY STAR® Qualified

Enjoy new ways to control your home with LG smart appliances

- Get notifications when dishes are clean
- Monitor the cycle time from your smartphone
- Works with the LG SmartThinQ® app



CAPACITY	
Total Place Settings	15
Upper Rack Dish Height Limit	7.1"
Lower Rack Dish Height Limit	12.5"
RACKS AND BASKETS	
Cutlery Baskets	Yes
Cup Rack	Yes
Stemware Holder	Yes
Fold Down Tines	Yes (Half Fold on Upper & Lower)
BPA-Free Nylon Coated Racks and Tines	Yes
Rack Handle	Yes (Upper/Lower)
Glide Rail	Yes (Upper)
EasyRack™ Plus System	Yes
Height Adjustable Upper Rack	Yes (One Touch; 3 Level)
Height-Adjustable 3rd Rack	Yes
STYLE AND DESIGN	
Smudge Resistant Finish	Yes (only LDP6797BD & LDP6797SS)
Control Panel Location	Top
Electronic Controls	Hidden SmoothTouch™ Controls with LED Display
Signalight™ Cycle Indicator Lights	3
Time Remaining Indicator	Yes (LED)
Tub Material	NeveRust™ Stainless Steel
Handle	Flush
Available Finishes	Black Stainless Steel, Smudge Resistant Stainless Steel, Stainless Steel
FEATURES	
QuadWash®	Yes
Inverter Direct Drive Motor	Yes
LoDecibel™ Quiet Operation	44 dB
Number of Wash Cycles	9 (Auto, Heavy, Delicate, Normal, Turbo, Download Cycle, Machine Clean, Rinse, Express)
Number of Options	8 (Dual Zone, Half Load, Energy Saver, High Temp, Extra Dry, Delay Start, Control Lock, Night Dry)
Number of Spray Arms	3 (Top, Upper, Lower)
SenseClean™ Wash System	Yes
Vario Wash	Yes
Detergent and Rinse-Aid Dispenser	Yes
Hybrid Condensing Drying System	Yes
End of Cycle Indicator	Yes (Beeper + END indication on display)
Hidden Water Heater	Yes
Safety Float Switch (Leaks)	Yes

Soil (Turbidity) Sensor	Yes
Tub Insulation (Damping Sheet,	Yes
Sound Absorbing Material (felt), Base)	Yes
BPA-Free Nylon Coated Racks and Tines	Yes
Anti-Bacterial Treatment (Sump, Inner / Outer filter, Drain pump case, Drain hose)	Yes
Balanced Door	Yes
Multi-Level (5) Water Direction	Yes (Top Nozzle (Down), Upper Nozzle (Up/Down), Lower Nozzle (Up/Down))
3-Stage Filtration System	Yes
SmartThinQ® SMART FEATURES	
Wi-Fi Enabled	Yes
Voice Activation	Yes
Works with	Google Assistant and Amazon Alexa
Cycle Complete Notification	Yes
Monitor Cycle Time	Yes
POWER RATINGS	
ENERGY STAR® Qualified	Yes
CEE Tier	1
Energy Use (kWh/Year)	258 kWh
Water Factor (WF)	2.8
DIMENSIONS / CLEARANCES / WEIGHT	
Product Dimensions (in) (W x H x D)	23.75" x 33.6" x 24.6"
Product Weight (lbs)	82 lbs
Depth with Door Closed with Handle (in)	24.6"
Depth with Door Open (in)	50.5"
Carton Dimensions (in) (W x H x D)	28" x 34.7" x 29.6"
Shipping Weight with Carton (lbs)	94.1 lbs
LIMITED WARRANTY	
Labour	1 Year
Parts	1 Year
Control Board, Rack, Stainless Steel Door Liner and Tub	5 Years
Inverter Direct Drive Motor	10 Years
UPC CODES	
LDP6797BD (Black Stainless Steel)	048231022187
LDP6797SS (Smudge Resistant Stainless Steel)	772454071843
LDP6797ST (Stainless Steel)	048231022156

HOME APPLIANCES

LG DISHWASHERS

LDP6797_

Top Control Wi-Fi Enabled Dishwasher

QUICK INSTALL & CLEARANCES

For full installation directions/clearances please refer to the corresponding User Manual and Installation Guide.

RANCES	
Product Dimensions (in) (W x H x D)	23 3/4" x 33 3/5" x 24 3/5"
Depth with Door Closed with Handle (in)	24 5/8"
Depth with Door Open (in)	50 1/2"
Carton Dimensions (in) (W x H x D)	28" x 34 7/10" x 29 3/5"
POWER RATINGS	
ENERGY STAR® Qualified	Yes
CEE Tier	1
Energy Use (kWh/Year)	258 kWh
Water Factor (WF)	2.8

PREPARING CABINET OPENING

- This dishwasher is designed to fit a standard dishwasher opening. An opening may be needed on both sides to route plumbing and electrical connections.
- Select a location as close to the sink as possible for easy connections to water and drain lines.
- To ensure proper drainage, install the dishwasher no more than 12 ft. from the sink.
- If installing the dishwasher in a corner, leave a minimum of 2" between the dishwasher and the adjacent wall.
- To allow for proper clearance of plumbing and electrical, use the template included with the literature to determine the clearance on the side of the cabinet where the cabinet meets the back wall. Using a 2 1/2" diameter hole saw, drill a hole in the target area as shown on the template.

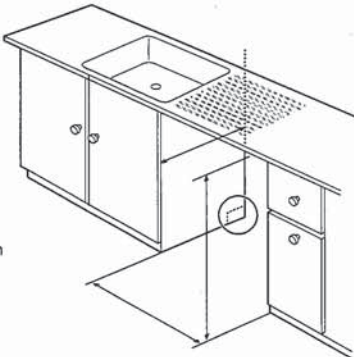

WARNING

Don't use existing holes unless they are in the target area. Otherwise, the water supply and drain hose may be damaged by being crushed or kinked.

CAUTION

Failure to properly locate the hole for the water and drain lines may prevent the dishwasher from installing flush with the cabinets and could result in kinked or damaged lines. Installation damage is not covered by the warranty, and leaks caused by improper installation may result in property damage.



PREPARING ELECTRICAL WIRING

- Operate this appliance with the correct voltage as shown in your User Manual and on the rating plate. Connect it to a dedicated, properly grounded branch circuit which is protected by a time delay fuse. Connect the appliance using 3-wires, including a ground wire.
- If an outlet and other power connector are used, it should be in an accessible location adjacent to and not behind the dishwasher and within 4 ft. of the dishwasher's side.
- The wiring must be grounded properly. If in doubt, have it checked by a qualified electrician. Do not connect any other appliance to the same outlet.
- Route the wiring.
- Make sure the electrical cable is oriented in the right side channel.

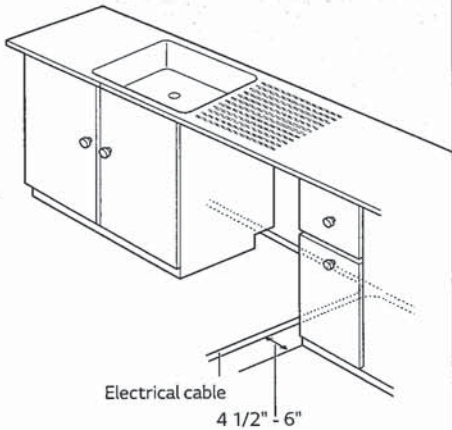

WARNING

- For personal safety, remove house fuse or open circuit breaker before installation.
- Do not use an extension cable or adapter with this dishwasher
- If you find any damage to the dishwasher, contact your retailer or contractor.

PREPARING WATER SUPPLY CONECTION

- Make sure the house water supply is turned off before connecting the dishwasher water lines.
- Connect the dishwasher to a hot water supply with a temperature range between 120 °F (49 °C) and 149 °F (65 °C). This temperature range provides the best washing results and shortest cycle time. To prevent damage to dishes, the temperature should not exceed 149 °F (65 °C).
- When connecting the dishwasher water line, sealing tape or compound should be used on pipe threads to avoid leaks. Tape or compound should not be used on compression fittings.
- The water supply tube must be located in the left side channel.

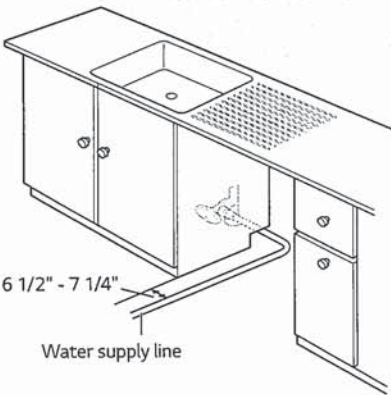

NOTE

Use new hoses when connecting to the water supply. Do not reuse old hoses.