

Sales Selection Sheet
Checklist

1 of 33

LOT 3161 Model: 28-2590 B THE BRISTOL

PURCHASERS: MAREK KOMOR/DAINA, TEODORA BALASA

VENDOR: Heathwood Homes (Huron) Limited

DELETE ALL MIRRORS

- ☐ WOB
- ☐ DECK
- ☐ FINISHED BASEMENT
- ☐ COLD CELLAR

UPGRADED / MODIFIED ELEVATION

- ☐ CORNER UPGRADE
- ☐ REAR UPGRADE
- ☐ SIDE UPGRADE

CEILING UPGRADE - SMOOTH

- ☒ MAIN FLOOR
- ☐ SECOND FLOOR
- ☐ BASEMENT

ADDITIONAL ROUGH-INS

- ☒ 200 AMP SERVICE (STD IN SINGLES)
- ☐ WET BAR ROUGH-IN
- ☐ HUMIDIFIER
- ☒ AIR CONDITIONING (SITE STD)

GAS ROUGH-IN

- ☐ STOVE
- ☐ DRYER
- ☐ BBQ
- ☐ ADDITIONAL FIREPLACE

KITCHEN: HOODFAN VENTING SIZE

- ☒ 6 IN ROUND DUCT
- ☐ 7 IN ROUND DUCT

FULL BASEMENT STAIRS:	Paint Grade
UPPER BASEMENT STAIRS:	N/A
LOWER LEVEL STAIRS:	N/A
MAIN STAIRS:	All Oak
MEDIA STAIRS (if applicable):	N/A
LOFT STAIRS (if applicable):	N/A

APRIL 24/23

Date

Signatures

Purchaser:

APRIL 24/23

Date

SONIA SHARIF

Decor Consultant:

Date

on file

Purchaser:

~~APRIL 24 2023~~

Date

m. Row

Heathwood Homes (Huron) Limited

Locked Date:

Approved

Customer Colours

MAREK KOMOR/DAINA, TEODORA BALASA
Project: Wallaceton
Unit: 3161, Phase: 3
Model: 28-2590 B THE BRISTOL

Created: 1/30/2023 13:18:58
Locked:
Closed:

Kitchen

Cabinet Colour/Style	9176	Viking IV-TRINITY VIVA-WEEKEND GETAWAY ***UPG***
Island Cabinet Colour/Style	9176	Viking IV-TRINITY VIVA-WEEKEND GETAWAY ***UPG***
Cabinet Hardware	7667	12881-HARDWARE ***STD***
Countertop	9069	MSI Quartz GROUP 1 ICED WHITE ***STD***
Island Countertop	9069	MSI Quartz GROUP 1 ICED WHITE ***STD***
Countertop Edge	4005	DOUBLE MITRE 1 1/2 INCH ***UPG***

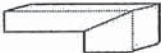

- Please note some islands may require a seam as per manufacturer and fabricator discretions.

Sink	9487	Plumbing-KINDRED Kitchen Sink Collection - Reginox ND1831 U/9-Double (equal size) Bowl Undermount Sink (or equivalent)-Stainless Steel	PG 22
HoodFan	9393	SCB51930-CYCLONE 30 inch CANOPY CHIMNEY HOODFAN-SS	PG 32-33
Backsplash	1111	N/A *****	
Backsplash Grout	1111	N/A *****	
Backsplash Tile Pattern	1111	N/A *****	

- Purchasers have been advised: standard fridge opening is a minimum 37 3/8 x 73 3/8 inches. Ice Waterline Rough-In is included.
- Standard stove opening is 30 inches and standard dishwasher opening is 24 inches. Any gas stove will require backsplash or stainless steel backing to avoid fire hazards.
- Purchasers acknowledge: Heathwood Homes and its contractors will not be responsible for any kitchen cabinet changes due to appliances dimension changes after sign-off.

Kitchen / Breakfast

Flooring	9106	GE.MD.WHT.1818.MT Madison Series White Matte 18 X 18 Matte ***1***
Floor Tile Grout	7705	Grout-(01) Alabaster ***UPG***
Floor Tile Pattern	3000	STANDARD SQUARE ***STD***

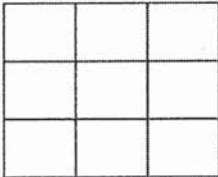

Comment

Foyer

Flooring	9106	GE.MD.WHT.1818.MT Madison Series White Matte 18 X 18 Matte ***1***
Floor Tile Grout	7705	Grout-(01) Alabaster ***UPG***
Floor Tile Pattern	3000	STANDARD SQUARE ***STD***

DB

Customer Colours

MAREK KOMOR/DAINA, TEODORA BALASA
Project: Wallaceton
Unit: 3161, Phase: 3
Model: 28-2590 B THE BRISTOL

Created: 1/30/2025 13:18:55
Locked:
Closed:

Floor Tile Pattern	3000	STANDARD SQUARE STD									
<table><tr><td></td><td></td><td></td></tr><tr><td></td><td></td><td></td></tr><tr><td></td><td></td><td></td></tr></table>											
Comment											

Powder Room											
Flooring	9104	GE.MD.ANT.1818.MT Madison Series Antracite Matte 18 X 18 Matte ***1***									
Floor Tile Grout	7704	Grout-(19) Pearl Gray ***STD***									
Floor Tile Pattern	3000	STANDARD SQUARE ***STD***									
<table><tr><td></td><td></td><td></td></tr><tr><td></td><td></td><td></td></tr><tr><td></td><td></td><td></td></tr></table>											
Plumbing Fixture (Colour)	1737	Plumbing Fixtures-WHITE ***STD***									
Comment											

Mud Room / Laundry											
Flooring	9104	GE.MD.ANT.1818.MT Madison Series Antracite Matte 18 X 18 Matte ***1***									
Floor Tile Grout	7704	Grout-(19) Pearl Gray ***STD***									
Floor Tile Pattern	3000	STANDARD SQUARE ***STD***									
<table><tr><td></td><td></td><td></td></tr><tr><td></td><td></td><td></td></tr><tr><td></td><td></td><td></td></tr></table>											
Opt. Cabinet Colour/Style - Uppers	1111	N/A *****									
Opt. Cabinet Hardware - Uppers	1111	N/A *****									
Cabinet Colour/Style - Base	9162	Viking III-MUSKOKA-NAVY BLUE-3DL ***STD***									
Cabinet Hardware - Base	7667	12881-HARDWARE ***STD***									
Countertop	8806	4987K-07-Countertop-LECHE VESTA-Wilsonart ***STD***									
Opt. Countertop Edge	1111	N/A *****									
Comment											

Main Hall		
Flooring	9358	Red Oak Pearl-Vintage Engineered-TITANIUM-3/4 inch x 3 1/4 inch ***STD***
Comment		

MK
DB

Customer Colours

MAREK KOMOR/DAINA, TEODORA BALASA
Project: Wallaceton
Unit: 3161, Phase: 3
Model: 28-2590 B THE BRISTOL

Created: 1/30/2023 13:18:55
Locked:
Closed:

Dining Room

Flooring	9358	Red Oak Pearl-Vintage Engineered-TITANIUM-3/4 inch x 3 1/4 inch ***STD***
Comment		

Great Room

Flooring	9358	Red Oak Pearl-Vintage Engineered-TITANIUM-3/4 inch x 3 1/4 inch ***STD***
Comment		

Great Room Fireplace

Type	8869	Majestic MERC32 ***STD***
Mantle	9114	NF 15-Paint Grade Mantle- Cabinet (Per Plan)-WHITE ***STD***
Surround (Opt.)	1111	N/A *****

PG 21
(\

- Purchasers have been advised: heat from the FP can damage TV above a FP and items placed on mantle.

- Heathwood and its contractors will not be liable for any damage on items placed/@installed above a FP after closing.

Comment

Upper Hall

Flooring	9507	DY 89418-MINOTAUR-BLACK ICE-40 oz Poly ***STD***
Comment		

Master Bedroom

Flooring	9507	DY 89418-MINOTAUR-BLACK ICE-40 oz Poly ***STD***
Comment		

Bedroom 2

Flooring	9507	DY 89418-MINOTAUR-BLACK ICE-40 oz Poly ***STD***
Comment		

Bedroom 3

Flooring	9507	DY 89418-MINOTAUR-BLACK ICE-40 oz Poly ***STD***
----------	------	--

MK
DB

Customer Colours

MAREK KOMOR/DAINA, TEODORA BALASA
Project: Wallaceton
Unit: 3161, Phase: 3
Model: 28-2590 B THE BRISTOL

Created: 1/30/2023 13:18:58
Locked:
Closed:

Comment

Bedroom 4

Flooring

9507

DY 89418-MINOTAUR-BLACK ICE-40 oz Poly ***STD***

Comment

Master Ensuite

Cabinet Colour/Style

9532

Viking IV-TRINITY VIVA-WINTER FUN M2004 ***UPG***

Cabinet Hardware

7667

12881-HARDWARE ***STD***

Countertop

9069

MSI Quartz GROUP 1 ICED WHITE ***STD***

Countertop Edge

4010

SINGLE POLISHED STRAIGHT EDGE 3/4 INCH ***STD***

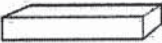

Floor Tile

9104

GE.MD.ANT.1818.MT Madison Series Antracite Matte 18 X 18 Matte ***1***

Floor Tile Grout

7704

Grout-(19) Pearl Gray ***STD***

Floor Tile Pattern

3000

STANDARD SQUARE ***STD***

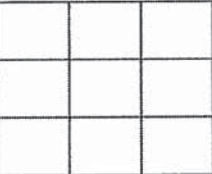

Shower Wall Tile

9440

TH.CT.LGR.0812.GL-Construct-Light Grey Glossy-8 x 12 UPG 1 ***UPG***

Shower Wall Tile Grout

2225

Grout-(27) Silver ***UPG***

Shower Wall Tile Pattern

3070

HORIZONTAL STACKED ***STD***

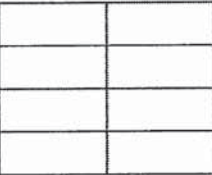

Shower Floor Tile

8108

OD.ON.DGR.02.HEX.MT-ONTARIO HEXAGON MATTE-DARK GREY ***UG2B4***

Shower Floor Tile Grout

2225

Grout-(27) Silver ***STD***

Shower Floor Tile Pattern

3120

VERTICAL HEX ***STD***

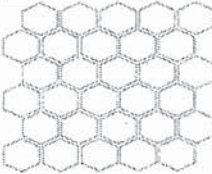

Shower Jamb(s) and Sill(s)

8923

Shower Jamb / Sill-Thassos White ***STD***

Plumbing Fixture (colour)

1737

Plumbing Fixtures-WHITE ***STD***

Comment

Main Bathroom

MK
DB

Customer Colours

MAREK KOMOR/DAINA, TEODORA BALASA
Project: Wallaceton
Unit: 3161, Phase: 3
Model: 28-2590 B THE BRISTOL

Created: 1/30/2025 13:18:55
Locked:
Closed:

Cabinet Colour/Style	9538	Viking II-TRINITY LPL-STAINLESS ***STD***									
Cabinet Hardware	7667	12881-HARDWARE ***STD***									
Countertop	8827	4925K-07-Countertop-CALCUTTA MARBLE-Wilsonart ***STD***									
Countertop Edge	1111	N/A *****									
Floor Tile	9439	TH.CT.LGR.1212.MT-Construct-Light Grey Matte-12 x 12 STD ***STD***									
Floor Tile Grout	2225	Grout-(27) Silver ***STD***									
Floor Tile Pattern	3000	STANDARD SQUARE ***STD*** <table><tr><td></td><td></td><td></td></tr><tr><td></td><td></td><td></td></tr><tr><td></td><td></td><td></td></tr></table>									
Shower Wall Tile	5420	QT.SP.DGR.0810-Splendour-Dark Grey-8 inch x 10 inch ***STD***									
Shower Wall Tile Grout	2225	Grout-(27) Silver ***UPG***									
Shower Wall Tile Pattern	3070	HORIZONTAL STACKED ***STD*** <table><tr><td></td><td></td></tr><tr><td></td><td></td></tr><tr><td></td><td></td></tr><tr><td></td><td></td></tr></table>									
Shower Floor Tile	8661	OD.ON.SWT.0202.MT.N-Ontario Series Mosaic-Snow White Matte-2 x 2 ***STD***									
Shower Floor Tile Grout	2226	Grout-(00) White ***STD***									
Shower Floor Tile Pattern	3000	STANDARD SQUARE ***STD*** <table><tr><td></td><td></td><td></td></tr><tr><td></td><td></td><td></td></tr><tr><td></td><td></td><td></td></tr></table>									
Shower Jamb(s) and Sill(s)	8923	Shower Jamb / Sill-Thassos White ***STD***									
Plumbing Fixture (colour)	1737	Plumbing Fixtures-WHITE ***STD***									
Comment											

Shared Ensuite

Cabinet Colour/Style	9176	Viking IV-TRINITY VIVA-WEEKEND GETAWAY ***UPG***
Cabinet Hardware	7667	12881-HARDWARE ***STD***
Countertop	8822	4924-38-Countertop-WHITE CARRARA-Wilsonart ***STD***
Countertop Edge	1111	N/A *****
Floor Tile	8261	TR.ST.BYZ.1313-Serpentine-Beyaz/White-13x13 ***STD***
Floor Tile Grout	7705	Grout-(01) Alabaster ***UPG***
Floor Tile Pattern	3000	STANDARD SQUARE ***STD***

MK
DB

Customer Colours

MAREK KOMOR/DAINA, TEODORA BALASA
Project: Wallaceston
Unit: 3161, Phase: 3
Model: 28-2590 B THE BRISTOL

Created: 1/30/2023 13:18:55
Locked:
Closed:



Wall Tile

8257

TR.ST.BYZ.0810-Serpentine-Beyaz/White-8 x 10 ***STD***

Wall Tile Grout

7705

Grout-(01) Alabaster ***UPG***

Wall Tile Pattern

3070

HORIZONTAL STACKED ***STD***

Opt. Shower Floor Tile

1111

N/A *****

Opt. Shower Floor Tile Grout

1111

N/A *****

Opt. Shower Floor Tile Pattern

1111

N/A *****

Opt. Shower Jamb(s) and Sill(s)

1111

N/A *****

Plumbing Fixture (colour)

1737

Plumbing Fixtures-WHITE ***STD***

Comment

Lower Level Recreation Room (Opt. Finish)

Flooring

1111

N/A *****

Comment

Lower Level Bathroom (Opt. Finished Bas

Cabinet Colour/Style

1111

N/A *****

Cabinet Hardware

1111

N/A *****

Countertop

1111

N/A *****

Countertop Edge

1111

N/A *****

Floor Tile

1111

N/A *****

Floor Tile Grout

1111

N/A *****

Floor Tile Pattern

1111

N/A *****

MK
JB

Customer Colours

MAREK KOMOR/DAINA, TEODORA BALASA
Project: Wallaceton
Unit: 3161, Phase: 3
Model: 28-2590 B THE BRISTOL

Created: 1/30/2023 13:18:58
Locked:
Closed:

Shower Wall Tile	1111	N/A *****
Shower Wall Tile Grout	1111	N/A *****
Shower Wall Tile Pattern	1111	N/A *****
Shower Floor Tile	1111	N/A *****
Shower Floor Tile Grout	1111	N/A *****
Shower Floor Tile Pattern	1111	N/A *****
Shower Jamb(s) and Sill(s)	1111	N/A *****
Plumbing Fixture (colour)	1111	N/A *****
Comment		

Main Stairs		
Type	1714	Oak Stairs ***STD MAIN STAIRS***
Colour	7940	Sambucca STAIN TO COMPLIMENT HARDWOOD AND WILL VARY FROM FLOORING ***99***
Handrail/Pickets/Posts Type	8148	Single Collar Alt. Plain w/ Shoes with 3 1/2" Square/Cap Post(s)-BLACK ***2***
Handrail/Pickets/Posts Colour	7940	Sambucca STAIN TO COMPLIMENT HARDWOOD AND WILL VARY FROM FLOORING ***99***
Custom Stain/Paint	1111	N/A *****
Landing(s)	9059	Red Oak-Vintage 3 1/4 inch Pre-Sanded Smooth Unfinished Red Oak-Unfinished-3/4 inch x 3 1/4inch
Opt. Carpet Runner	1111	N/A *****
Comment		

Lower Level Stairs		
Type	1713	Paint Grade Stairs ***STD UNFINISHED BASEMENT STAIRS***
Colour	1111	N/A *****
Handrail/Pickets/Posts Type	9119	Handrail only on closed walls (one or two sides per building code) ***STD***
Handrail/Pickets/Posts Colour	1111	N/A *****
Custom Stain/Paint	1111	N/A *****
Landing(s)	1111	N/A *****
Opt. Carpet Runner	1111	N/A *****

MK
DB

Customer Colours

MAREK KOMOR/DAINA, TEODORA BALASA
Project: Wallaceton
Unit: 3161, Phase: 3
Model: 28-2590 B THE BRISTOL



Created: 1/30/2023 13:18:55
Locked:
Closed:

Comment

Throughout		
Switches and Plug	5796	Decora White Switches and Plugs ***STD***
Thresholds	2232	Metal Thresholds ***STD***
Underpad	1079	500 Series-Underpad ***STD***
Trim Size	8705	4 1/4 Baseboard and 2 3/4 Casings ***STD***
Trim - Paint Colour	1716	Trim-WHITE ***STD***
Walls - Paint Colour	1717	22-Wall-WARM GREY ***STD***
Comment		

Purchaser:  2023-02-27 Sonia SHARIF

MAREK KOMOR Date Decor Consultant Date

Purchaser:  2023-02-27  -04- 24 2023

DAINA, TEODORA BALASA Date Wallaceton Date Approved



CONSTRUCTION SUMMARY

Lot: 3161
Model: 28-2590 B THE BRISTOL
Project/Phase: Wallaceton / 3

Offer Worksheet	The Purchaser(s) acknowledge that they have NOT been referred by an existing Heathwood Homeowner and therefor are not entitled to a referral fee under Heathwood Homes Referral program. Note:
Offer Worksheet	ADDED BY AMENDMENT - SCHEDULE E: Ten Thousand (\$10,000) Dollars in upgrades at Decor (No cash Value) Note:
Offer Worksheet	DELETED BY AMENDMENT - Five Appliances: SS Fridge, Stove, Chimney Hood Fan, Dishwasher: White Front Loader Washer/Dryer (Singles) Note:



CONSTRUCTION SUMMARY

Lot: 3161
Model: 28-2590 B THE BRISTOL
Project/Phase: Wallaceton / 3

ADMIN FEE

Invoice	Qty.	Description
---------	------	-------------

APPLIANCES

Invoice	Qty.	Description
1267 313,484 22Oct23	1	KITCHEN - APPLIANCES - CYCLONE 30 INCH WALL MOUNT CHIMNEY HOOD SS - SCB51930 see spec CABINETRY-delete stove uppers; ELECTRICAL-delete std range hood; HEATING/AIR CONDITIONING-Duct change to 6 in

CABINETRY

Invoice	Qty.	Description
1267 343,278 22Oct23	1	KITCHEN - CABINETRY - KITCHEN - VIKING IV - UPG
1267 343,279 22Oct23	1	MASTER ENSUITE - CABINETRY - ENSUITE - VIKING IV - UPG
1267 343,281 22Oct23	1	SHARED BATHROOM - CABINETRY - SHARED BATH - VIKING IV - UPG
1267 313,796 22Oct23	1	KITCHEN - B10-Pots and pans drawers (width min. 60cm/max. 90cm) (size subject to floor plan) Viking SKETCH # 3
1267 313,768 22Oct23	1	KITCHEN - A11-Upper angle corner per unit Viking SKETCH # 2 AND 3 DRYWALL-Notify; FRAMING-Modify Bulkhead; PAINTING-Notify
1267 313,484 22Oct23 **	1	KITCHEN - APPLIANCES - CYCLONE 30 INCH WALL MOUNT CHIMNEY HOOD SS - SCB51930 see spec CABINETRY-delete stove uppers; ELECTRICAL-delete std range hood; HEATING/AIR CONDITIONING-Duct change to 6 in
1267 313,608 22Oct23	2	MASTER ENSUITE - D04-Increase vanity to kitchen height greater than 3 Feet (90cm high, maintains vanity depth) Viking SKETCH # 5



CONSTRUCTION SUMMARY

Lot: 3161
Model: 28-2590 B THE BRISTOL
Project/Phase: Wallaceton / 3

CERAMICS

Invoice	Qty.	Description
1267 344,080 22Oct23	1	KITCHEN - CERAMICS - KITCHEN/BREAK - UPG 1
1267 344,077 22Oct23	1	FOYER - CERAMICS - FOYER FLOOR - UPG 1
1267 344,078 22Oct23	1	POWDER ROOM - CERAMICS - POWDER FLOOR - UPG 1
1267 344,079 22Oct23	1	MUD ROOM - CERAMICS - MUD ROOM - UPG 1
1267 344,083 22Oct23	1	MASTER ENSUITE - CERAMICS - M.ENS BATH FLOOR - UPG 1
1267 344,094 22Oct23	1	MASTER ENSUITE - CERAMICS - MASTER SHOWER FLOOR - UPG 2
1267 344,262 22Oct23	1	SHARED BATHROOM - CERAMICS - SHARED 2&3 BATH FLOOR - UPG GROUT
1267 344,250 22Oct23	1	MASTER ENSUITE - CERAMICS - M.ENS SHWR WALL & CEIL - UPG GROUT
1267 344,248 22Oct23	1	SHARED BATHROOM - CERAMICS - SHARED 2&3 BATH TUB WALL - UPG GROUT
1267 344,070 22Oct23	1	MASTER ENSUITE - CERAMICS - M.ENS SHWR WALL & CEIL - UPG 1
1267 344,257 22Oct23	1	FOYER - CERAMICS - FOYER FLOOR - UPG GROUT
1267 344,260 22Oct23	1	KITCHEN/BREAKFAST - CERAMICS - KITCHEN/BREAK - UPG GROUT
1267 344,246 22Oct23	1	MAIN BATHROOM - CERAMICS - MAIN BATH SHOWER WALL AND CEILING - UPG GROUT



CONSTRUCTION SUMMARY

Lot: 3161
Model: 28-2590 B THE BRISTOL
Project/Phase: Wallaceton / 3

DRYWALL

Invoice	Qty.	Description
1267 345,674 22Oct23	1	MAIN FLOOR - DRYWALL - SMOOTH CEILING IN MAIN FLOOR - UPG PAINTING-Paint Smooth Ceiling
1267 313,768 22Oct23 **	1	KITCHEN - A11-Upper angle corner per unit Viking SKETCH # 2 AND 3 DRYWALL-Notify; FRAMING-Modify Bulkhead; PAINTING-Notify

ELECTRICAL

Invoice	Qty.	Description
1267 345,787 22Oct23	1	KITCHEN - ELECTRICAL - CEILING ROUGH-IN (CAPPED) ABOVE BREAKFAST COUNTER ON SAME SWITCH AS SECOND CAPPED LIGHT ABOVE THE COUNTER SKETCH # 2
1267 314,224 22Oct23	1	KITCHEN - ELECTRICAL - CEILING ROUGH-IN (CAPPED) INCLUDING SWITCH ABOVE BREAKFAST COUNTER FOR TOTAL OF 2 X ABOVE ISLAND SKETCH # 2
1267 345,787 22Oct23	1	GREAT ROOM - ELECTRICAL - CEILING ROUGH-IN (CAPPED) ON EXISTING SWITCH SKETCH # 2
1267 314,242 22Oct23	1	KITCHEN - ELECTRICAL - RELOCATION OF SWITCHES/LIGHTS (MUST SPECIFY LOCATION) - NOTE: PLUGS CANNOT BE RELOCATED- MUST PURCHASE ADDITIONAL OUTLET. RELOCATED KITCHEN LIGHT SKETCH # 2
1267 314,232 22Oct23	1	GREAT ROOM - ELECTRICAL - EXTRA WALL INTERIOR OUTLET ON EXISTING CIRCUIT (DOES NOT INCLUDE KITCHEN OUTLETS) +/- 70" FROM FLOOR , ABOVE THE FIREPLACE SKETCH # 2
1267 345,787 22Oct23	1	KITCHEN - ELECTRICAL - CEILING ROUGH-IN (CAPPED) ON EXISTING SWITCH WITH RELOCATED STD KITCHEN LIGHT SEE SKETCH # 2
1267 313,484 22Oct23 **	1	KITCHEN - APPLIANCES - CYCLONE 30 INCH WALL MOUNT CHIMNEY HOOD SS - SCB51930 see spec CABINETRY-delete stove uppers; ELECTRICAL-delete std range hood; HEATING/AIR CONDITIONING-Duct change to 6 in

FRAMING

Invoice	Qty.	Description
1267 313,768 22Oct23 **	1	KITCHEN - A11-Upper angle corner per unit Viking SKETCH # 2 AND 3 DRYWALL-Notify; FRAMING-Modify Bulkhead; PAINTING-Notify



CONSTRUCTION SUMMARY

Lot: 3161
Model: 28-2590 B THE BRISTOL
Project/Phase: Wallaceton / 3

GLASS PRODUCTS / MIRRORS

Invoice	Qty.	Description
1267 345,695 22Oct23	1	ENSUITE MASTER - GLASS PRODUCTS / MIRRORS - UPGRADE TO FRAMELESS CLEAR GLASS WITH D-RING HANDLE IN CHROME - ENSUITE MASTER - UPG
1267 22Oct23 NoCat	1	- DELETE ALL MIRRORS

GRANITE

Invoice	Qty.	Description
1267 343,074 22Oct23	1	KITCHEN - GRANITE - KITCHEN / ISLAND - GROUP 1 WITH 1 ? IN SQUARE BUILT UP MITERED EDGE - UPG
1267 314,365 22Oct23 **	2	MASTER ENSUITE - PLUMBING - AMERICAN STANDARD - SINK - UNDERMOUNT SINK - BOXE - WHITE - MODEL 0315 000 020 SKETCH # 5 SEE SPECS

HARDWOOD

Invoice	Qty.	Description
1267 314,352 22Oct23 **	3	- PAINT - STAIN STAIR LANDING IN SAMBUCCA. LANDING UNDER 25 SQ.FT. EACH HARDWOOD-Supply and Install smooth UNFINISHED pre-sanded red oak at stair landing(s)

HEATING / AIR CONDITIONING

Invoice	Qty.	Description
1267 313,484 22Oct23 **	1	KITCHEN - APPLIANCES - CYCLONE 30 INCH WALL MOUNT CHIMNEY HOOD SS - SCB51930 see spec CABINETRY-delete stove uppers; ELECTRICAL-delete std range hood; HEATING/AIR CONDITIONING-Duct change to 6 in

INTERIOR RAILINGS

Invoice	Qty.	Description
1267 345,719 22Oct23	1	- Interior Railings - BLACK METAL - SINGLE COLLAR ALT. PLAIN W/ SHOES WITH 3 1/2? SQUARE/CAP POST(S) AS PER PLAN - MAIN AND 2ND FLOOR - UPG PAINTING-Notify



CONSTRUCTION SUMMARY

Lot: 3161
Model: 28-2590 B THE BRISTOL
Project/Phase: Wallaceton / 3

PAINTING

Invoice	Qty.	Description
1267 314,352 22Oct23	3	- PAINT - STAIN STAIR LANDING IN SAMBUCCA. LANDING UNDER 25 SQ.FT. EACH HARDWOOD-Supply and Install smooth UNFINISHED pre-sanded red oak at stair landing(s)
1267 345,674 22Oct23 **	1	MAIN FLOOR - DRYWALL - SMOOTH CEILING IN MAIN FLOOR - UPG PAINTING-Paint Smooth Ceiling
1267 345,719 22Oct23 **	1	- Interior Railings - BLACK METAL - SINGLE COLLAR ALT. PLAIN W/ SHOES WITH 3 1/2" SQUARE/CAP POST(S) AS PER PLAN - MAIN AND 2ND FLOOR - UPG PAINTING-Notify
1267 313,768 22Oct23 **	1	KITCHEN - A11-Upper angle corner per unit Viking SKETCH # 2 AND 3 DRYWALL-Notify; FRAMING-Modify Bulkhead; PAINTING-Notify

PLUMBING

Invoice	Qty.	Description
1267 314,365 22Oct23	2	MASTER ENSUITE - PLUMBING - AMERICAN STANDARD - SINK - UNDERMOUNT SINK - BOXE - WHITE - MODEL 0315 000 020 SKETCH # 5 SEE SPECS

THE BRISTOL

ELEVATION A & B | 2,590 SQ. FT.

706 sq. ft. of opt. finished Lower Level

WALLACETON
EST. 1870

28-2590 ELEV. B *Sketch #1*

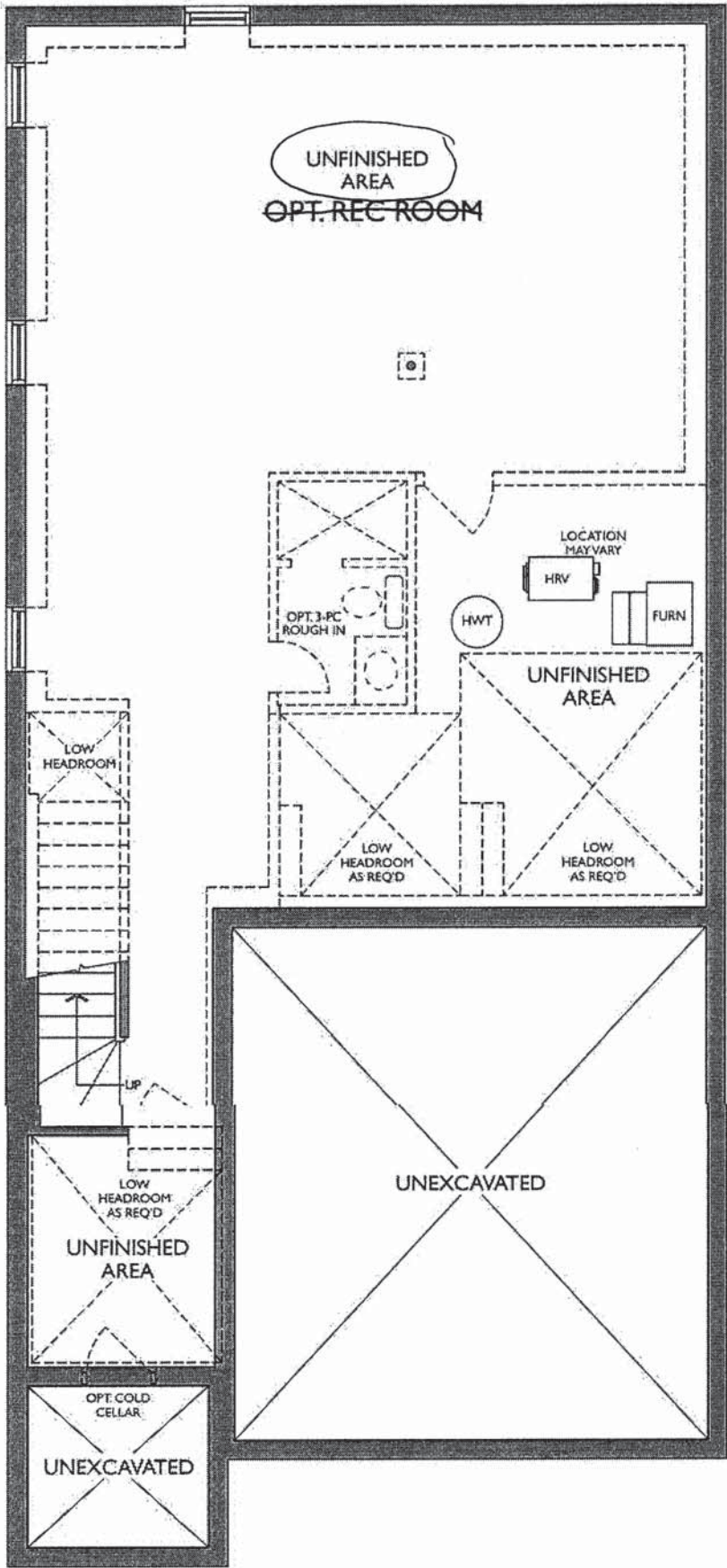

MK
DB

LOWER LEVEL
ELEVATION B & C

THE BRISTOL

ELEVATION A & B | 2,590 SQ. FT.

706 sq. ft. of opt. finished Lower Level

WALLACETON
EST. 1870

28-2590 ELEV. B

Sketch #2

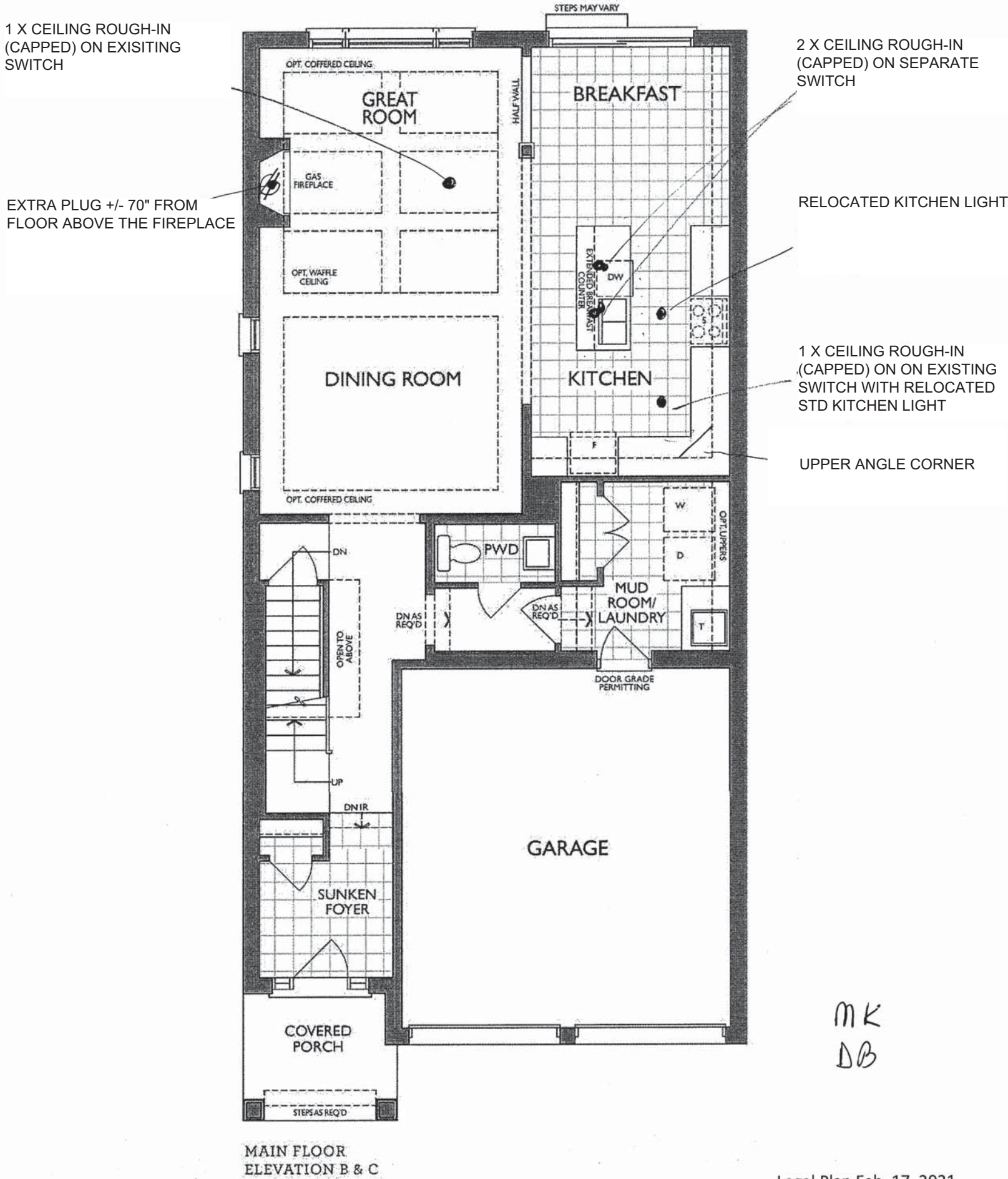

UPPER ANGLE CORNER

POTS AND PANS DRAWERS

30" CHIMNEY HOOD/FAN

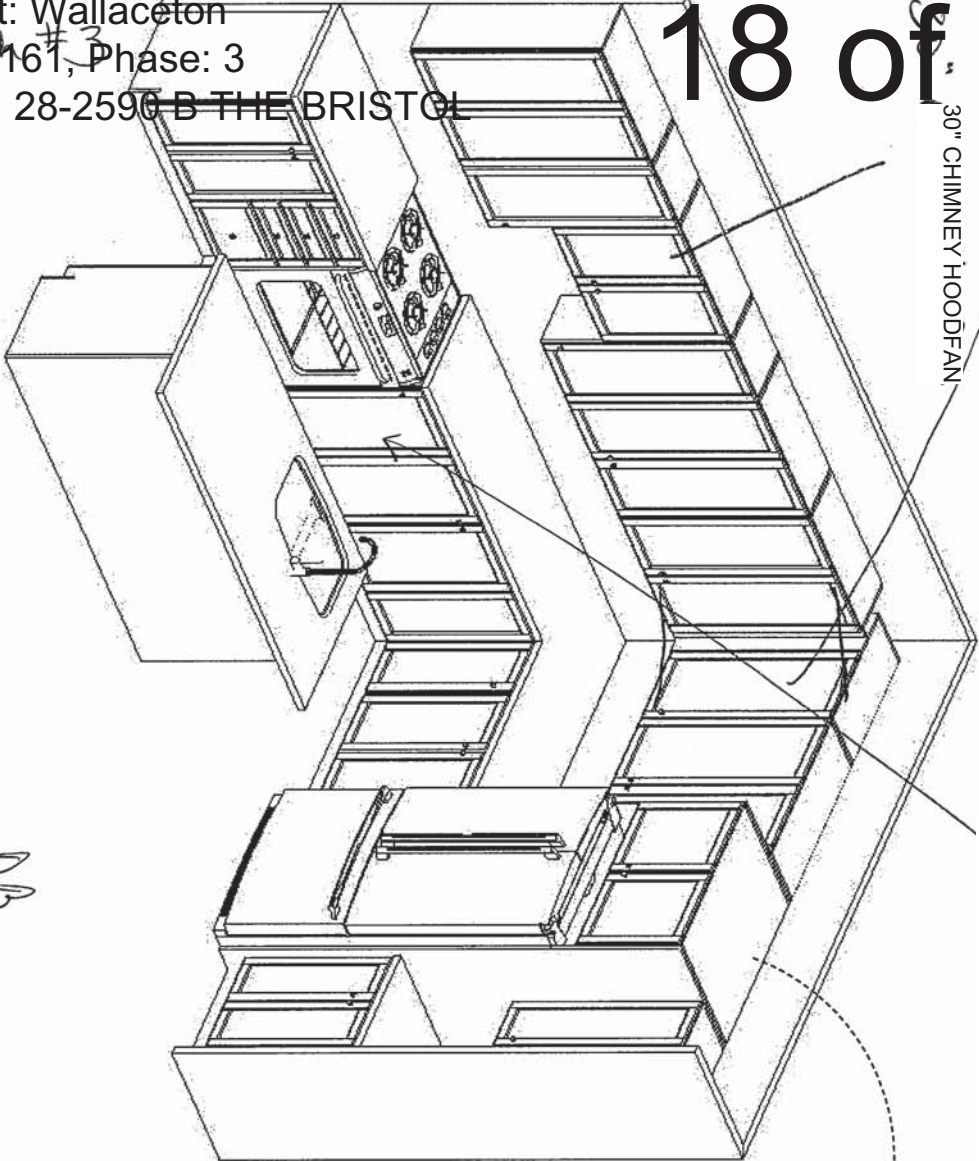

DB
MK

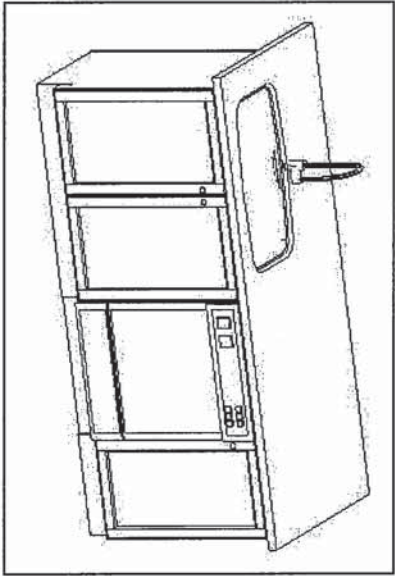
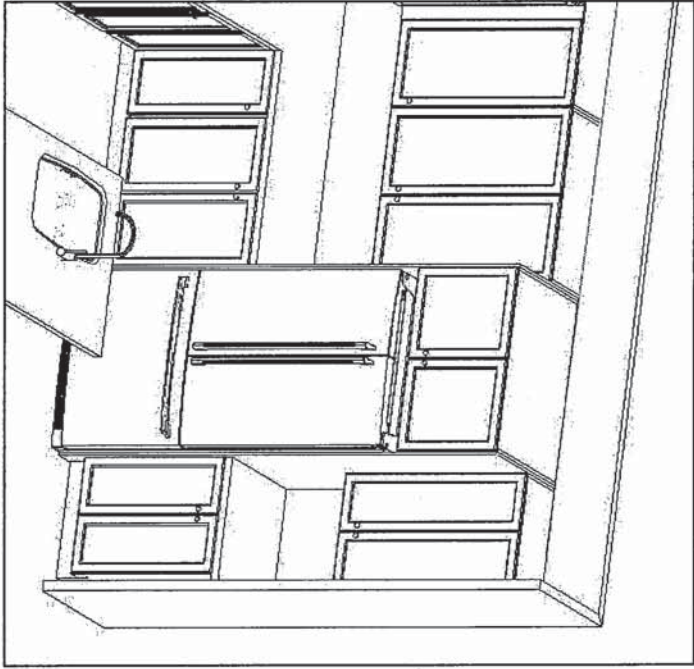

F R E N D E L
K I T C H E N S L I M I T E D
1350 Shawson Drive, Mississauga, ON L4W 1C5

HEATHWOOD HOMES
WALLACEYTON, KITCHENER ON
MODEL: 28-2590 (3403)

STANDARD CONTRACT INCLUDES:

Appliance Openings

- Hood Opening: 30"W Builder hood
- Fridge Opening: 37 3/8 "W X 73 3/8"
- Fridge cabinet & gables: 66cm Deep
- Stove Opening: 30" Freestanding
- Dishwasher Opening: 24"

Standard Kitchens Scope:

- 100cm H wall cabinets
- Std. Blumotion Hinges- **soft close**
- Std. Metabox Drawers- **not soft close**
- Min 40cm W drawer
- Base pie cut corner cabinets
- Backing on all cabinets
- Countertop by others
- Upgrade applied paneled fridge & dishwashers supply only (appliance hardware by others)

Standard Vanity & Laundry Scope:

- Powder by others, pedestal
- Master Ens. – Top by others
- Remaining vanities inc. laminate top
- Std. Blum Hinges- **not soft close**
- Std. Metabox Drawers- **not soft close**
- Master Ens: Top drawers(Sink Full height)
- Mains: Full height doors (top drawers added if Masters can't accommodate)
- Optional laundry base & wall cabinets

Project: Wallaceyton
Unit: 3161, Phase: 3
Model: 28-2590 B THE BRISTOL

THE BRISTOL

ELEVATION A & B | 2,590 SQ. FT.

706 sq. ft. of opt. finished Lower Level

WALLACETON
EST. 1870

Sketch #4

28-2590 ELEV. B

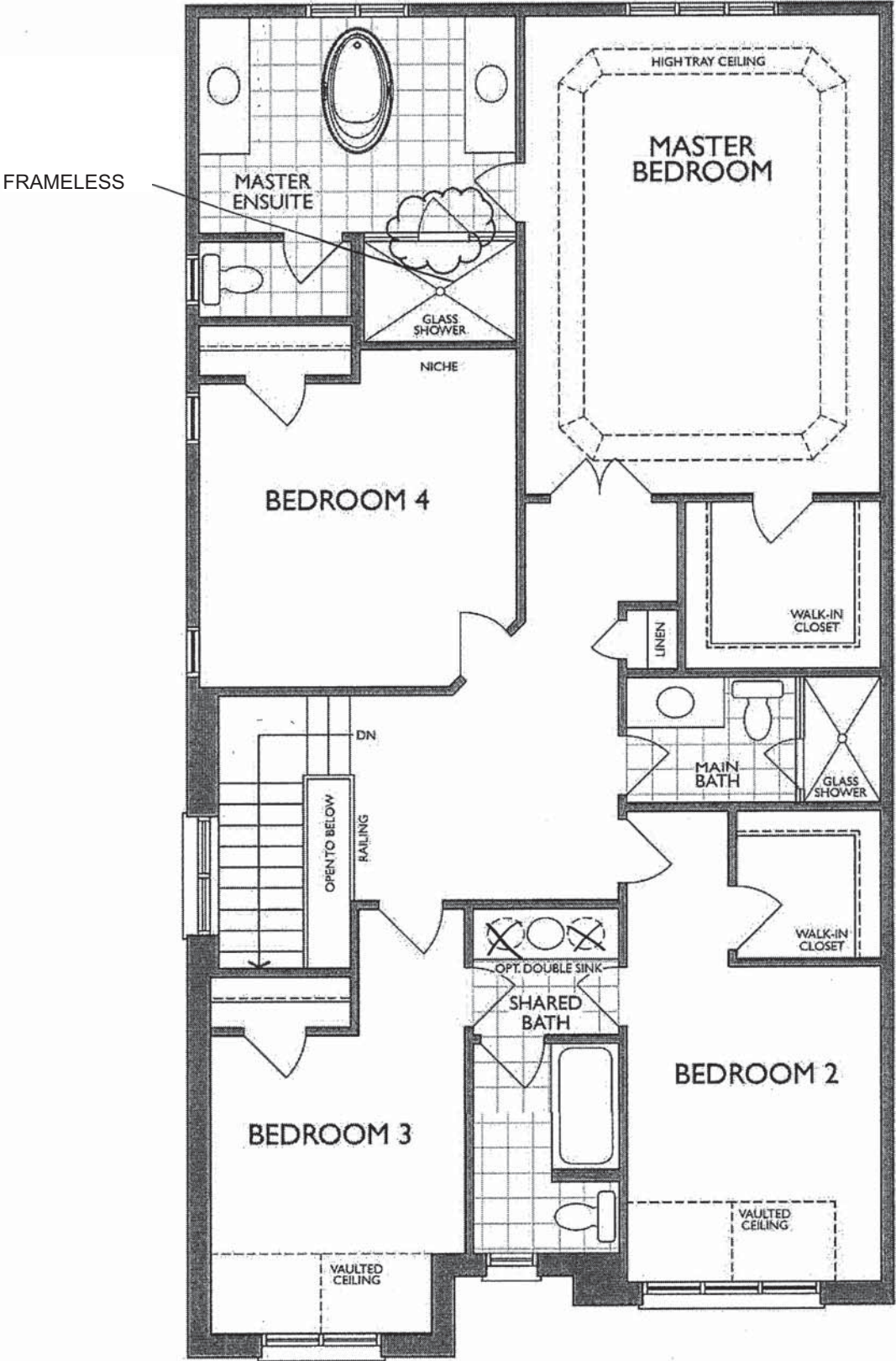

SECOND FLOOR
ELEVATION B
* Master Ensuite Shower Door Swing Changed

9/20/2022

MASTER ENSUITE
(2ND FLR)

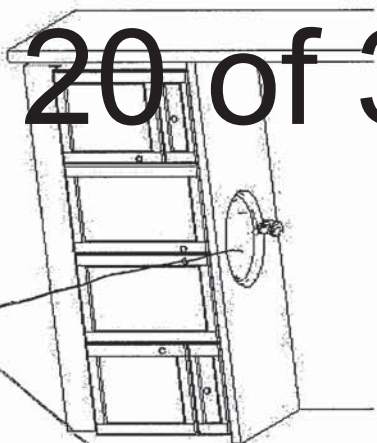

2 X INCREASE VANITY
HEIGHT

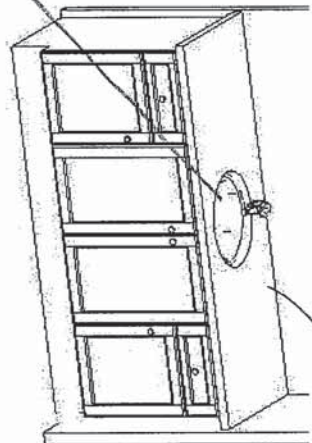

MAIN BATH
(2ND FLR)



SHARED ENSUITE
(2ND FLR)

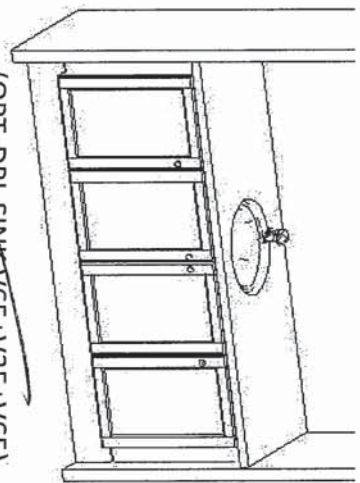

(OPT. DBL SINK V65+V35+V65)

LAUNDRY

OPT. BASE, OPT. UPPERS
(GROUND FLOOR)

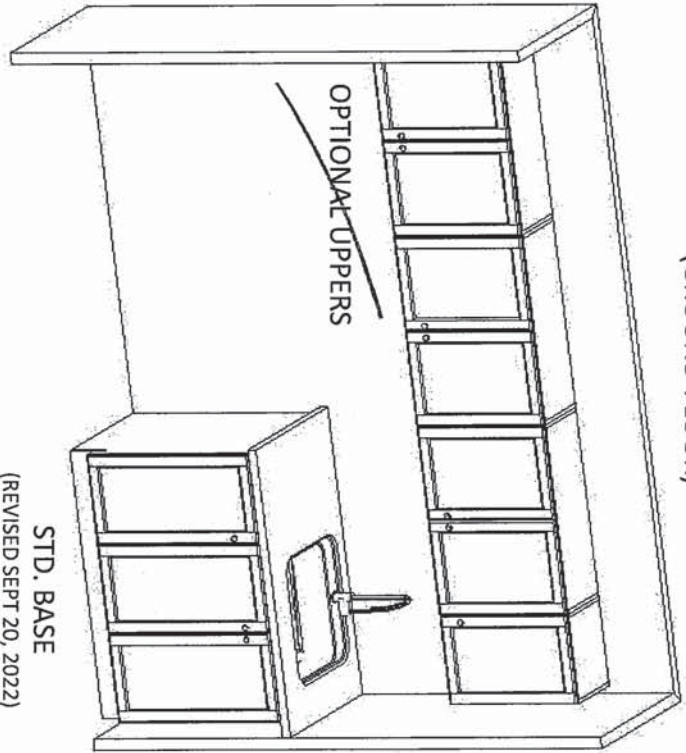

~~OPTIONAL UPPERS~~

STD. BASE
(REVISED SEPT 20, 2022)

~~OPT. BASEMENT BATH~~

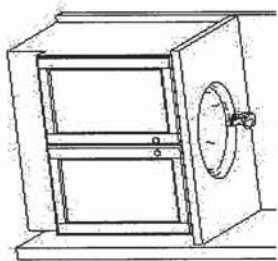

DB
MK



F R E N D E L
K I T C H E N S L I M I T E D
1350 Shawson Drive, Mississauga, ON L4W 1C5

HEATHWOOD HOMES
WALLACEYTON, KITCHENER ON
MODEL: 28-2590 (3403)

STANDARD CONTRACT INCLUDES:

Appliance Openings

- Hood Opening: 30"W Builder hood
- Fridge Opening: 37 3/8 "W X 73 3/8"
- Fridge cabinet & gables: 66cm Deep
- Stove Opening: 30" Freestanding
- Dishwasher Opening: 24"

Standard Kitchens Scope:

- 100cm H wall cabinets
- Std. Blumotion Hinges- **soft close**
- Std. Metabox Drawers- **not soft close**
- Min 40cm W drawer
- Base pie cut corner cabinets
- Backing on all cabinets
- Countertop by others
- Upgrade applied paneled fridge & dishwashers supply only (appliance hardware by others)

Standard Vanity & Laundry Scope:

- Powder by others, pedestal
- Master Ens. – Top by others
- Remaining vanities inc. laminate top
- Std. Blum Hinges- **not soft close**
- Std. Metabox Drawers- **not soft close**
- Master Ens: Top drawers(Sink Full height)
- Mains: Full height doors (top drawers added if Masters can't accommodate)
- Optional laundry base & wall cabinets

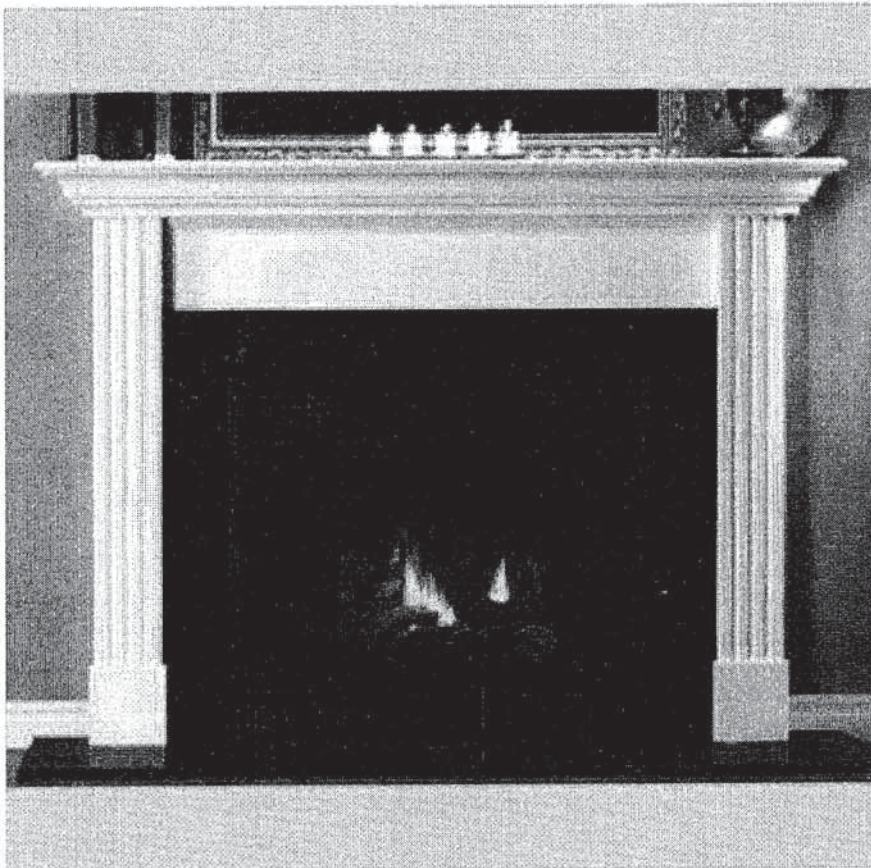

NEAS NF15 Mantel - Cabinet

DB
MK

Reginox

ND1831UA/9

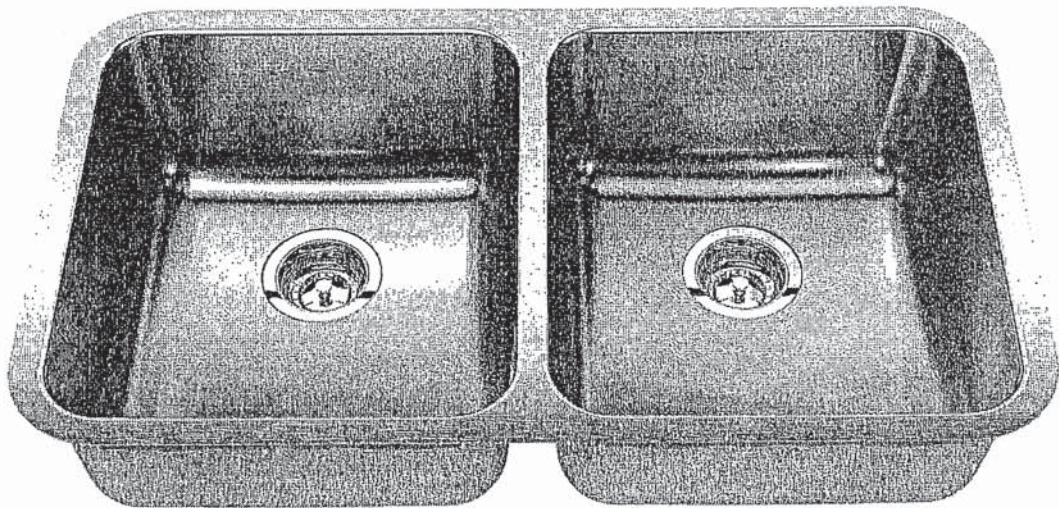

Optional Accessories



BG10S



BG10S



MB100



CA1W



DBR10S

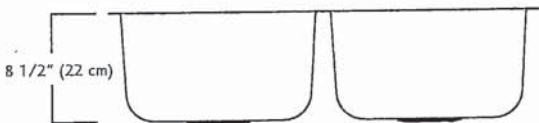
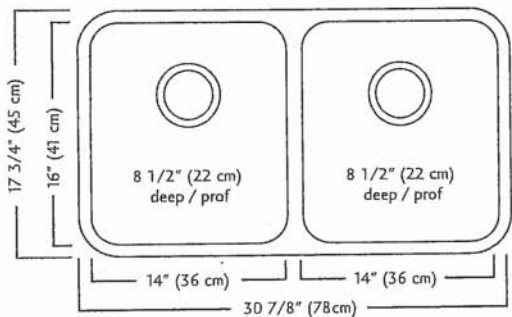

ND1831UA/9 SPECIFICATION

Model ND1831UA/9 is a double (two equal size) bowl undermount sink manufactured by Franke Kindred Canada Limited from 18 gauge stainless steel. Product has silk finished rims and linear brush finished bowls. Sink is fully undercoated. Basket strainer waste fittings (3 1/2", 89 mm) are included. Sink is backed with a limited lifetime warranty.

- O.D. 17 3/4" x 30 7/8" x 8 1/2" (45 x 78 x 22 cm)
- Recommended for minimum 36" cabinet

Franke Kindred Canada Limited
P.O. Box 190, 1000 Franke Kindred Road, Midland, Ontario, Canada, L4R 4K9 Phone: 866-687-7465 Fax: 800-361-8408

DB
MK

Specifications

- Lifetime limited warranty against leaks, drips and finish defects to the original homeowner
- 10 year limited warranty when used in a multifamily installation
- 5 year limited warranty when used in a commercial installation

Visit www.moen.com/support for complete details and limitations



DB
MK



BARRIER FREE (ABOVE COUNTER OR DROP-IN ONLY)

BOULEVARD®
PEDESTAL SINK
VITREOUS CHINA

BOULEVARD® PEDESTAL SINK

- STD ☐ 0641.800 Faucet holes on 8" (203mm) centers (Illustrated)
☒ 0641.400 Faucet holes on 4" (102mm) centers
☐ 0641.100 Center hole only
- Classic styled rectangular pedestal lavatory
 - Vitreous china
 - Rear overflow
 - Supplied with mounting kit
 - Right Height® for greater comfort during use
 - Faucet ledge with large deck area (faucet not included)
 - **Design coordinates with Boulevard® Toilet**
 - Basin has flat bottom to also allow use as an **above counter sink** or a **drop-in sink** (with u-shaped cut out)

Nominal Dimensions:

24" x 19" x 35-1/2"
(610 x 483 x 902mm)

- ☐ 0641.008 Pedestal top-8" (203mm) centers
☐ 0641.004 Pedestal top-4" (102mm) centers
☐ 0641.001 Pedestal top-center hole only
☐ 0010.000 Pedestal only

Bowl sizes:

17" (432mm) wide,
12-1/2" (318mm) front to back,
5" (127mm) deep

Compliance Certifications -

Meets or Exceeds the Following Specifications:

- ASME A112.19.2 - 2008/CSA B45.1-08

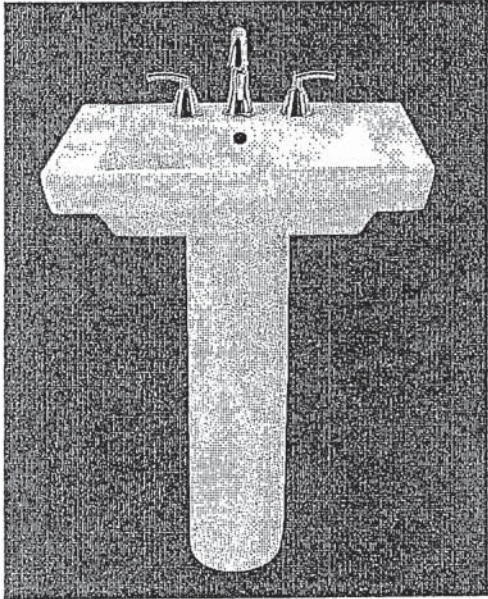

SEE REVERSE FOR ROUGHING-IN DIMENSIONS

To Be Specified:

- ☐ Color: ☐ White ☐ Linen
☐ Faucet Finish:
☐ Supplies:
☐ 1-1/4" Trap:
☐ Nipple:

* See faucet section for additional models available

DB
MK

2 x MASTER ENSUITE

American Standard

Style That Works Better



BOXE UNDERCOUNTER SINK

- Vitreous china
- Rectangular undercounter mount sink with rectangular interior and flat bottom design bowl
- Unglazed rim
- Front overflow
- Supplied with template
- Meets OBC requirement when sink is installed with overflow to the rear
- Mounting clips available separately (P031006000) (Faucet not included)



508 x 406mm (20" x 16")

Bowl size:
438mm (17-1/4") wide,
337mm (13-1/4") front to back,
127mm (5") deep

COMPLIANCE CERTIFICATIONS –

Meets or exceeds the following Specifications:

- ASME A112.19.2M for Vitreous China Fixtures.
- CAN/CSA B45 Series.

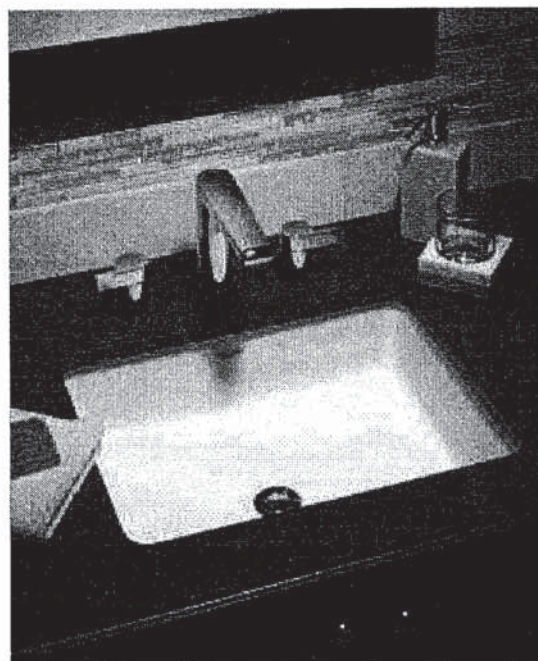

To Be Specified

- ☐ Colour: ☐ White
- ☐ Faucet*:
- ☐ Faucet Finish:
- ☐ Supplies & Stops:
- ☐ Trap 1-1/4" (32 mm):

* See faucet section for additional models available



- Countertop 864mm (34") from finished floor. Sink installed 102mm (4") from front edge of countertop. Countertop thickness to be 25mm (1") maximum.
- MEETS THE AMERICAN DISABILITIES ACT GUIDELINES AND ANSI A117.1 ACCESSIBLE AND USEABLE BUILDINGS AND FACILITIES - CHECK LOCAL CODES.**

NOTES:

NOTES:
WE RECOMMEND USING SINK AS A TEMPLATE TO DETERMINE PROPER
CONTOUR. CUT COUNTERTOP 38MM (1-1/2") INSIDE SINK CONTOUR.
FAUCETS NOT INCLUDED AND MUST BE ORDERED SEPARATELY.

* DIMENSIONS SHOWN FOR LOCATION OF SUPPLIES AND "P" TRAP ARE SUGGESTED.

▼ UNDERCOUNTER MOUNTING KIT SUPPLIED SEPARATELY.

IMPORTANT: Dimensions of fixtures are nominal and may vary within the range of tolerances established by ANSI Standard A112.19.2.

These measurements are subject to change or cancellation. No responsibility is assumed for use of superseded or voided pages.

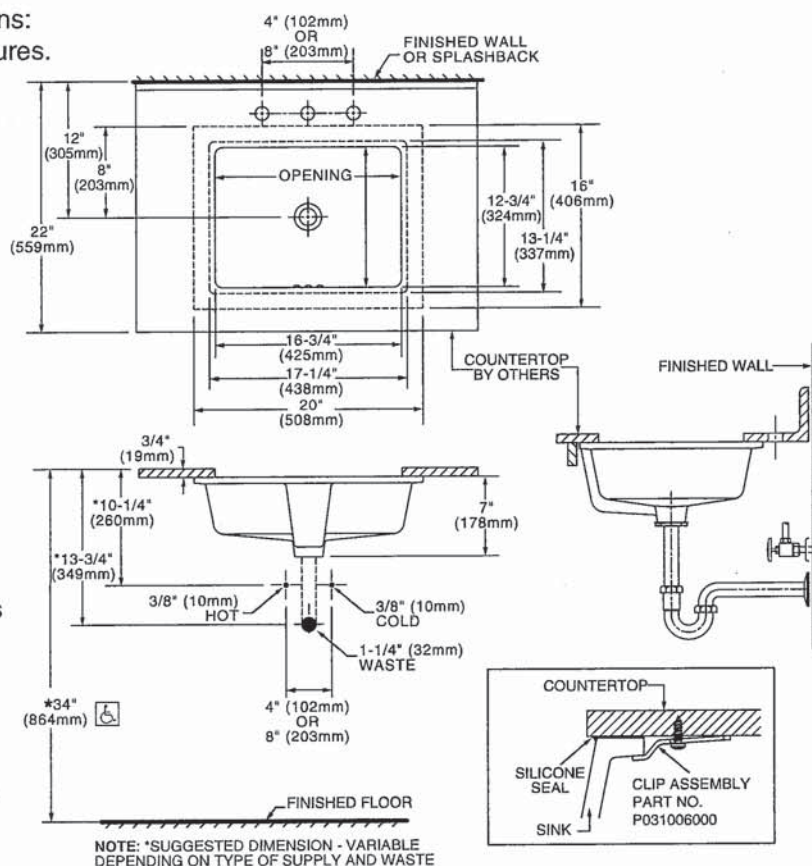

* To comply with ADA standards, overflow hole must face back.

MK
DB



COLONY™
COUNTERTOP SINK
VITREOUS CHINA

COLONY COUNTERTOP SINK

- Vitreous china
- Self-rimming
- Front overflow
- Supplied with template
- Faucet deck
(Faucet shown not included)

- ☐ 0346 803
Faucet holes on 203mm (8") centres
- ☒ 0346 403 (Illustrated)
Faucet holes on 102mm (4") centres
- ☐ 0346 001
Centre hole only

Nominal Dimensions:
521 x 448mm (20-1/2" x 17-5/8")

Bowl sizes:
422mm (16-5/8") wide, 279mm (11") front to back, 143mm (5-5/8") deep

COMPLIANCE CERTIFICATIONS –
Meets or exceeds the following Specifications:
• ASME A112.19.2M for Vitreous China Fixtures.
• CAN/CSA B45 Series.

- To Be Specified
- ☐ Colour: ☐ White ☐ Bone ☐ Silver Gray ☐ Linen
 - ☐ Faucet*:
 - ☐ Faucet Finish:
 - ☐ Supplies & Stops:
 - ☐ Trap 1-1/4" (32 mm):

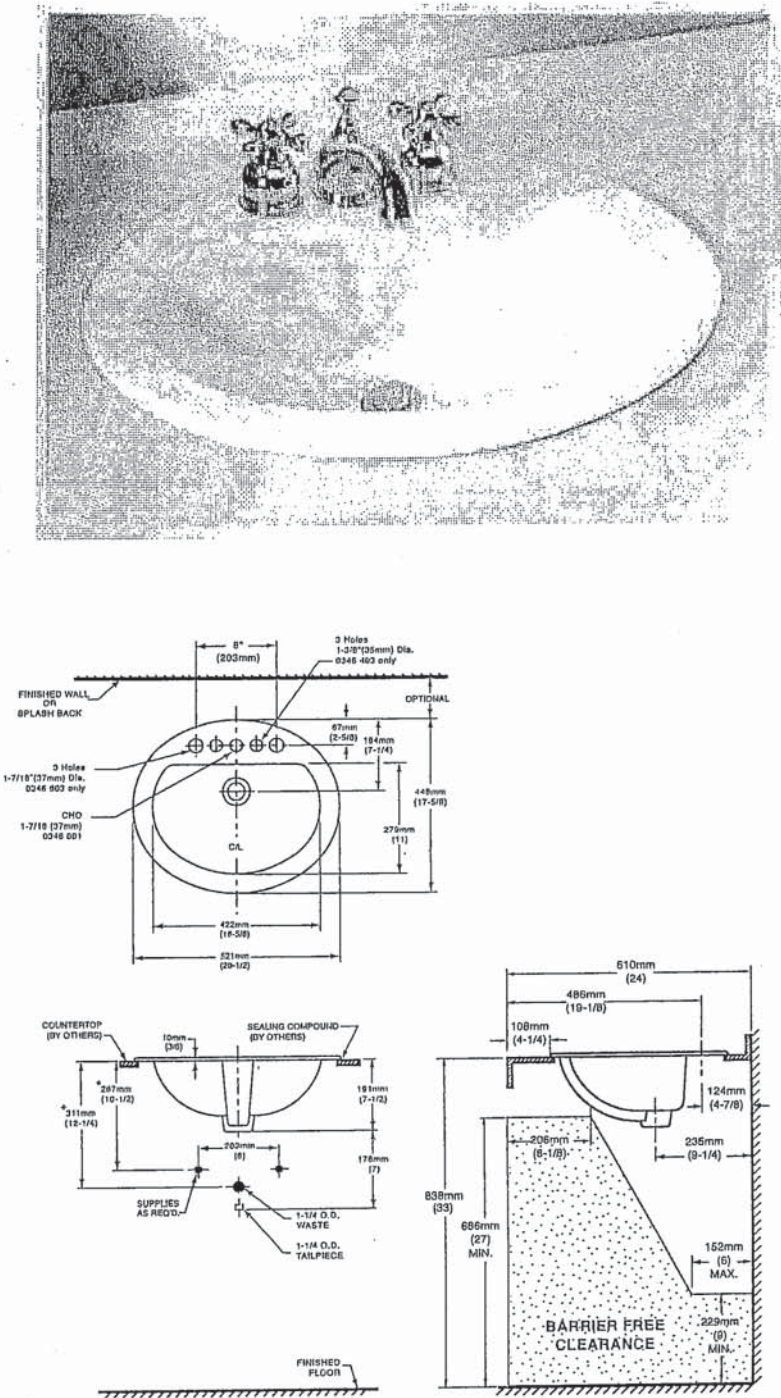

NOTES:
* DIMENSIONS SHOWN FOR LOCATION OF SUPPLIES AND "P" TRAP ARE SUGGESTED. FOR COUNTERTOP CUTOUT AND INSTALLATION INSTRUCTIONS USE TEMPLATE SUPPLIED WITH SINK.
FAUCETS NOT INCLUDED AND MUST BE ORDERED SEPARATELY.
IMPORTANT: Dimensions of fixtures are nominal and may vary within the range of tolerances established by ANSI Standard A112.19.2.
These measurements are subject to change or cancellation. No responsibility is assumed for use of superseded or voided pages.

* See faucet section for additional models available

DB
MK



DEMI™
Product Specification Sheet

Two Piece Freestanding Collection

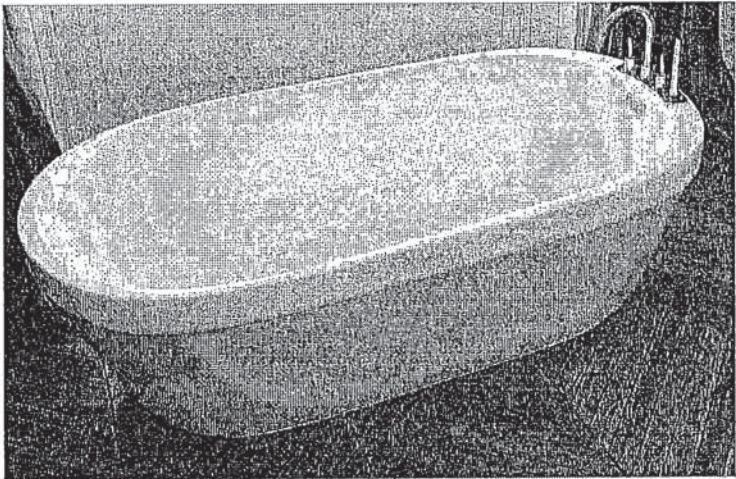

CF2007	Two Piece Freestanding Soaker
Size:	60" x 32" x 22" 1524 mm x 813 mm x 559 mm

PRODUCT FEATURES & BENEFITS

- Vacuum formed acrylic reinforced with fiberglass
- Scratch, stain and fade resistant high gloss finish
- Installation friendly two piece design
- Accepts deck mounted faucet
- Includes integral pop up drain and rectangular overflow
- Includes levelling feet

TWO PIECE ASSEMBLY

FRONT VIEW

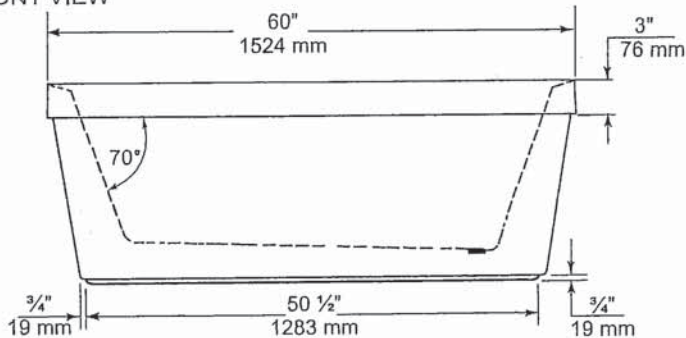

END VIEW

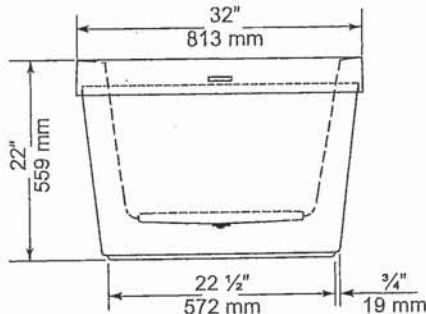

TOP VIEW

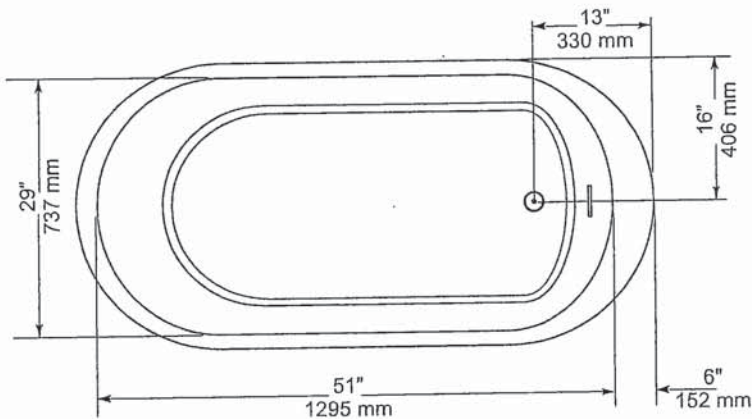

GENERAL SPECIFICATIONS

Average Weight	90 lb	41 kg
Bathing Well at bottom	43"x 20"	1092 x 508 mm
Capacity Drain to Overflow		195 litres
Water Depth Drain to Overflow	16"	406 mm
Drain Opening (dia.)	2"	51 mm
Overflow Opening	2 1/4"x 1/2"	57 x 13 mm
Drain to Floor Clearance	3 1/4"	83 mm

NOTES: Please confirm measurements on actual product to ensure proper identification. Bathtub to be installed on the floor supported by 5 self levelling feet. Adjust if required to level the bathtub for adequate drainage. Refer to installation instructions for additional information.

IMPORTANT: Dimensions of fixtures are nominal and may vary $\pm 1/4"$ (6 mm). Weight may vary ± 5 lb (2.3 kg). Drawing is not to scale. These measurements are subject to change at manufacturer's discretion.

Compliance Certifications -

- Meets or Exceeds the following Specifications:
- CAN/CSA - B45 Series



mirolin

60 Shorncliffe Rd., Toronto, Ontario M8Z 5K1
Telephone: 416.231.9030 Fax: 416.231.0929
www.mirolin.com

© 2018 Mirolin Industries Corp.

Customer Service: 416.231.5790
Canada, U.S.A.: 800.MIROLIN(647-6546)
Fax, Canada: 800.463.2236

R0084162
25 Sep. 2018

DB
MK



FloWise™ DUAL FLUSH
ELONGATED TOILET
VITREOUS CHINA

FloWise™ DUAL FLUSH ELONGATED TOILET

- 2476 216
 - Vitreous china
 - Low-consumption Dual Flush
 - Full flush 6.0 Lpf/1.3 gpf,
 - Partial flush 3.0 Lpf/0.66 gpf.
 - Elongated wash down bowl
 - Internal trapway fully-glazed,
 - 2-1/4" (57mm) ballpass
 - Concealed trapway bowl
 - Chrome-plated top mounted push button actuator
 - Easy to clean sanitary dam on bowl
 - Includes Elongated Slow Close Seat
 - 100% factory flush tested
 - 2 bolt caps



Separate Component Parts:

- 3067 316 Elongated Bowl with Slow Close Seat
- 4035 216 Unlined Tank

- 2476 516 Same as above with Lined tank
 - 3067 316 Elongated Bowl
 - 4035 516 Lined Tank

Nominal Dimensions:
794 x 432 x 765mm
(31-1/4" x 17" x 30-1/8")

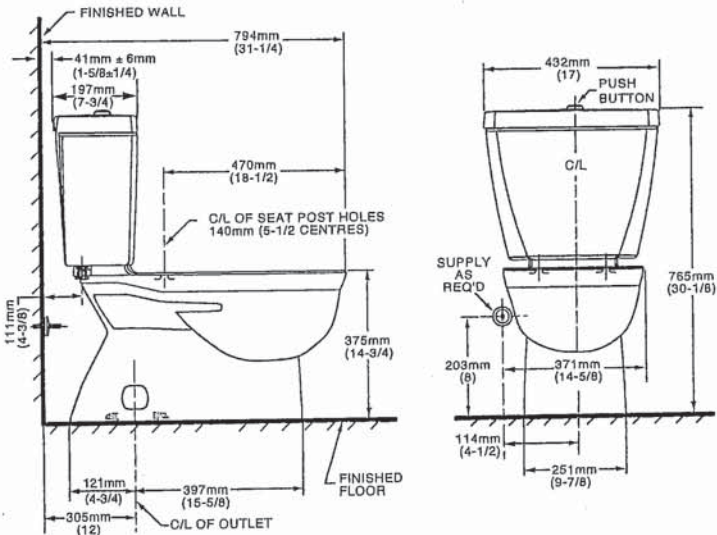

Compliance Certifications -
Meets or Exceeds the Following Specifications:
• ASME A112.19.2M (and 19.6M)
• CAN/CSA B45 series

- To Be Specified
- Colour: 020 White
 - Supply with stop:

NOTES:
THIS TOILET IS DESIGNED TO ROUGH-IN AT A MINIMUM DIMENSION OF 305MM (12") FROM FINISHED WALL TO C/L OF OUTLET.
SUPPLY NOT INCLUDED WITH FIXTURE AND MUST BE ORDERED SEPARATELY.
* DIMENSION SHOWN FOR LOCATION OF SUPPLY IS SUGGESTED.
FOR ADDITIONAL INFORMATION REFER TO INSTALLATION INSTRUCTIONS SUPPLIED.
IMPORTANT: Dimensions of fixtures are nominal and may vary within the range of tolerance established by ANSI Standard A112.19.2
These measurements are subject to change or cancellation. No responsibility is assumed for use of superseded or voided pages.

UPGRADED VALUE ADDED FEATURES AT NO EXTRA CHARGE

DB
MK

MOEN®

Specifications

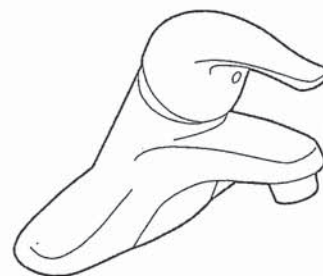

CHATEAU®

Single-Handle Lavatory Faucet

with Metal Waste Assembly

Model: L4625 series

L4631BC

Bulk Packed (12 per carton):

L64624 series

with 50/50 Waste Assembly

Bulk Packed (12 per carton):

L64625 series

Less Waste

Bulk Packed (12 per carton):

L64600 series

NOTE: THIS FAUCET IS DESIGNED TO BE
INSTALLED THRU 3-1" DIA. HOLES, 2" ON CENTER

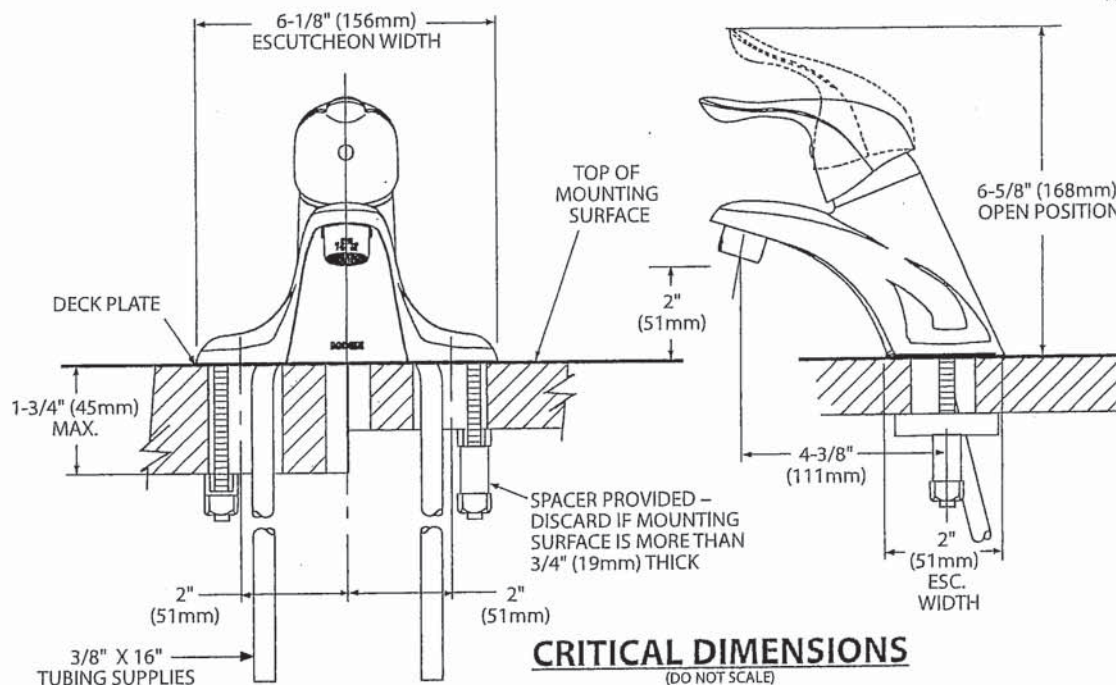

FOR MORE INFORMATION CALL: 1-800-BUY-MOEN
www.moen.com

Rev 8/15

DB
MK



Buy it for looks. Buy it for life.®

There is more than 1 version of this model.
Page down to identify the version you have.

DESCRIPTION

- Metal construction with various finishes identified by suffix
- Includes non-metallic showerhead, arm, flange and non-metallic diverter tub spout

OPERATION

- Handle operates counterclockwise through a 270° arc with off at 6 o'clock and maximum hot at the 9 o'clock position. Shut off in clockwise direction
- Adjustable temperature limit stop to control maximum hot water temperature
- Pressure balancing mechanism maintains selected discharge temperature to $\pm 3^\circ$

FLOW

- Showerhead is limited to 2.5 gpm (9.5 L/min) at 80 psi
- EP suffix models are limited to 1.75 gpm (6.6 L/min) at 80 psi
- NH suffix models contain no showerhead

CARTRIDGE

- 1222 cartridge design
- Accommodates back to back installations
- Nonmetallic/nonferrous and stainless steel material

STANDARDS

- Third party certified to meet ASME A112.18.1/CSA B125.1 and all applicable requirements referenced therein
- EP suffix models are third party certified to WaterSense®

- ADA  for lever handle

WARRANTY

- Lifetime limited warranty against leaks, drips and finish defects to the original consumer purchaser
- 5 year warranty if used in commercial installations

Specifications



CHATEAU® POSI-TEMP® Single-Handle Tub/Shower Trim Kit

Models: TL181 series - valve trim only
(Bulk Packed 12 per carton)
TL182 series - shower trim only
(Bulk Packed 12 per carton)
TL183 series - tub/shower trim
(Bulk Packed 12 per carton)

Valves: 62300 series
2500 series

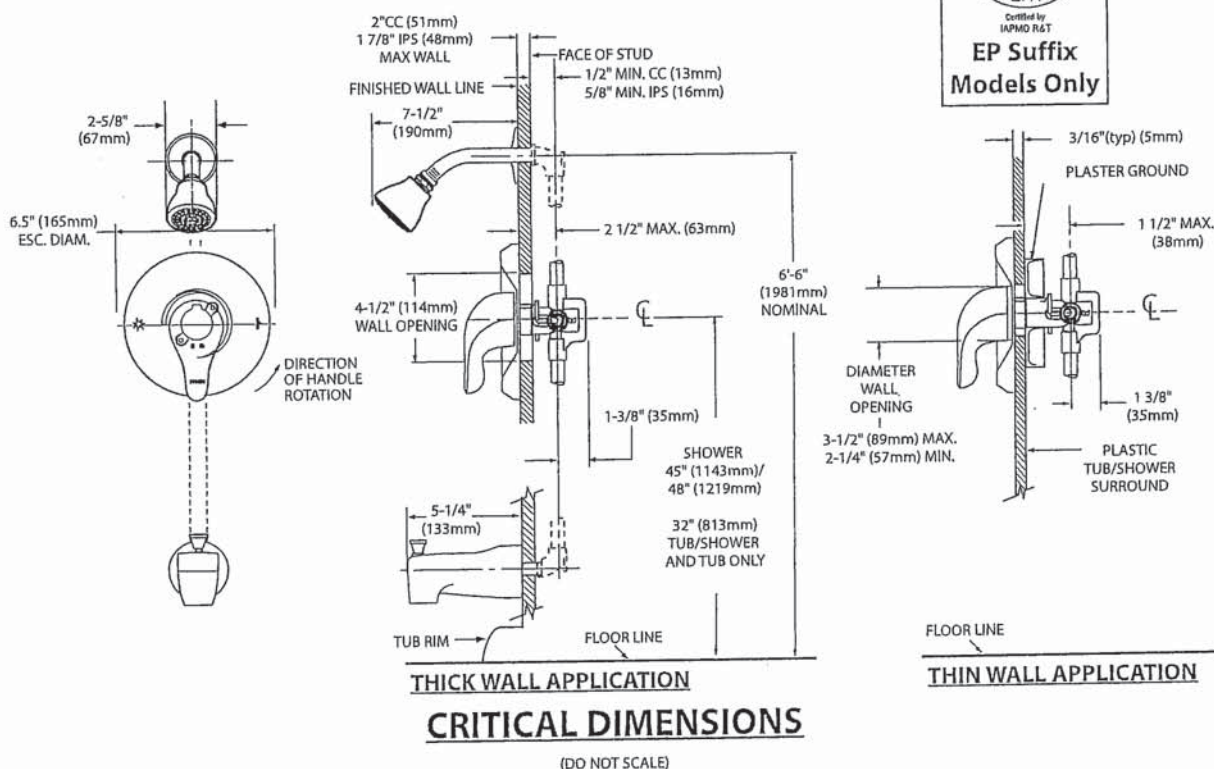

MK
DB

MOEN®

Specifications

DESCRIPTION

- Metal construction with various finishes identified by suffix

OPERATION

- Lever style handles with hot and cold color indicator
- Rotate hot side handle counterclockwise to open (clockwise to close) and the cold side handle (clockwise to open) and (counterclockwise to close)

STANDARDS

- Third party certified to: ASME A112.18.1/CSA B-125.1, and all applicable requirements referenced therein

- ADA  for lever handles

WARRANTY

- Lifetime limited warranty against leaks, drips and finish defects to the original homeowner
- 10 year limited warranty when used in a multi-family installation
- 5 year limited warranty when used in a commercial installation

Visit www.moen.com/support for complete details and limitations

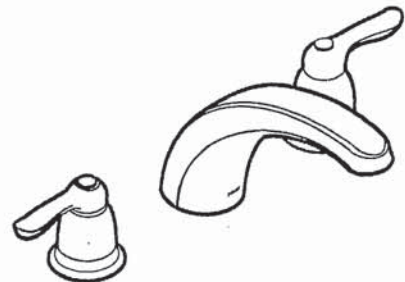

CHATEAU®
Two-Handle Garden Tub Trim

Models: T994 series

Valves: 4792, 4793, 4794, 4796, 4797, 4798

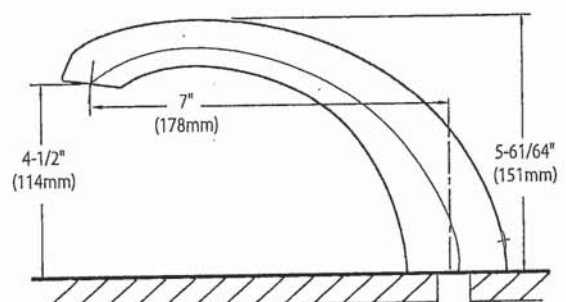
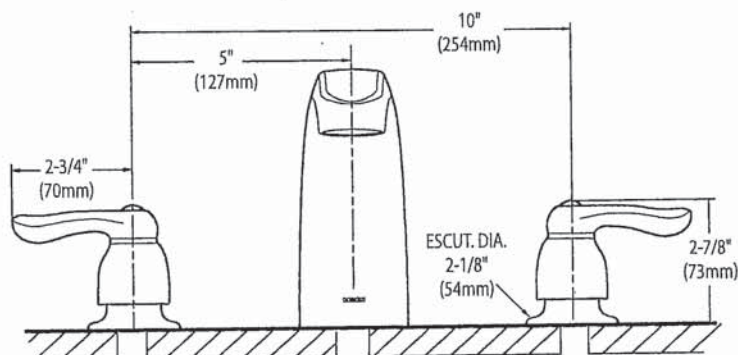

CRITICAL DIMENSIONS

(DO NOT SCALE)

DB
MK

SC(B)519 | ALITO Collection

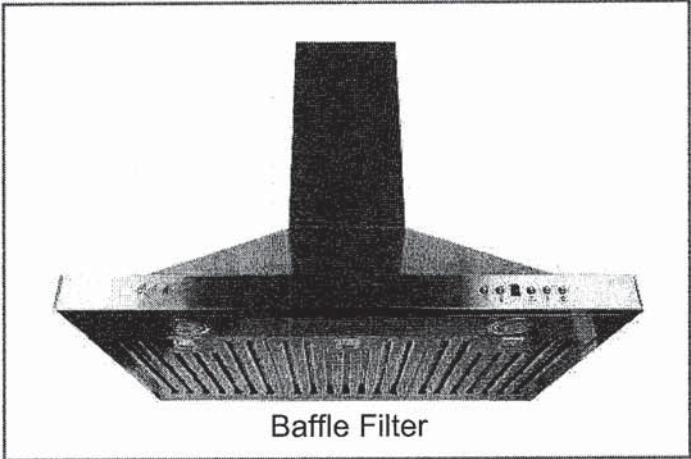

Baffle Filter

Wall Mount

Strong and sturdy with attractive lines and an imposing frame, the SC(B)519 is fitted with a time-delay OFF feature up to nine minutes, a 550 CFM fan, two bright front mounted LED lights and a digital three-speed push button control panel.

Green Features



3 Speed Push Button Control Panel



Long-Lasting LED Lights



Time-Delay OFF Feature



Grease Cup



Model	Colour	Ducting	Filters	Size	CFM
SCB51930	Stainless Steel	6"	Baffle	30"	550
SCB51936	Stainless Steel	6"	Baffle	36"	550

Cyclone Range Hoods Inc.

1361 Huntingwood Drive, Unit 16, Toronto, ON, M1S 3J1, Canada.

Toll Free: 1-888-293-5662 Tel: (416) 293-0933 Fax: (416) 293-4793 Website: www.CycloneRangeHoods.com

DB
MK

SC(B)519 | ALITO Collection



Features

- Wall mount range hood
- 6" round duct adapter
- Non-stick aluminum fan blades
- 3 speed push button control
- 2 LED lights (2 x 1.4W, 4000K)
- Quick release aluminum mesh filters
- Standard chimney fits up to 9 ft. ceiling
- Up to 9 minutes time-delay OFF feature
- Plug-in connection

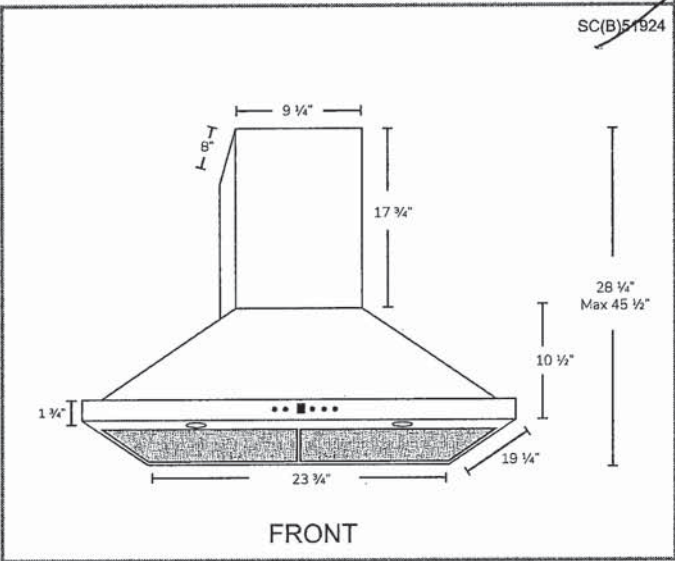
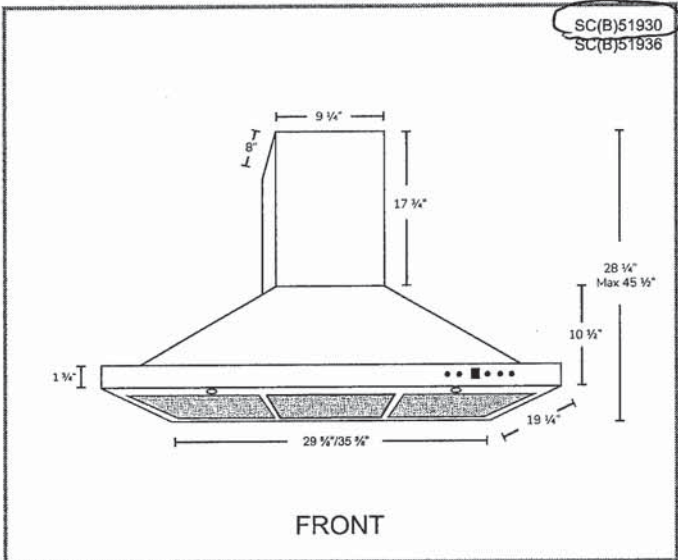

Options

- Filters:

SCB519 - Quick Release Stainless Steel Baffle Filters
- Chimney Flues:
A1.CH10 - short (7'-8' ceilings)
A1.CH18 - standard (8'-9' ceilings)
A1.CH30 - extended (9'-11' ceilings)
- Widths: 24", 30", 36"

Specifications

- | | | |
|--------------------------------------|--------------------------------|---|
| • Air Flow Volume: 550 CFM | • Current: 2.5 Amps | • Finishes: Stainless Steel |
| • Electrical Connection: 120 V/60 Hz | • Fan Speed: 1599 RPM | • Ducting: 6" Round |
| • Power Consumption: 300 Watts | • Fan Type: Centrifugal Blower | • Noise Level: Min. 2 Sones
Max. 6 Sones |



DB
MK