

Sales Selection Sheet
Checklist

1 of 49

LOT 63 Model: 28-2660 B THE LEMONGRASS

PURCHASERS: ADEWALE, KELANI POPOOLA/MOJISOLA, OLUWATOYIN POPOOL

VENDOR: Heathwood Homes (Williamsburg) Limited

COFFERED CEILING IN GREAT ROOM

* DELETE COFFERED CEILING IN DINING ROOM

RELOCATE ELECTRICAL FIREPLACE IN RECREATION ROOM

- ☐ WOB
- ☐ DECK

UPGRADED / MODIFIED ELEVATION

- ☐ CORNER UPGRADE
- ☐ REAR UPGRADE

CEILING UPGRADE - SMOOTH

- ☒ MAIN FLOOR
- ☐ SECOND FLOOR
- ☐ FINISHED LOWER LEVEL

ADDITIONAL ROUGH-INS

- ☒ 200 AMP SERVICE (SITE STD)
- ☐ WET BAR ROUGH-IN
- ☐ HUMIDIFIER
- ☒ HEAT PUMP / AIR CONDITIONING (SITE STD)

GAS ROUGH-IN

- STOVE
- ☐ DRYER
- ☒ BBQ
- ☐ ADDITIONAL GAS FIREPLACE

KITCHEN HOODFAN VENTING SIZE

- ☒ 6 IN ROUND DUCT
- ☐ 7 IN ROUND DUCT

FULL LOWER LEVEL STAIRS	Carpet Grade
UPPER LOWER LEVEL STAIRS	N/A
LOWER LOWER LEVEL STAIRS	N/A
MAIN STAIRS	All Oak

Date	<u>Signatures on</u> Purchaser: <u>file</u>	Date	<u>OCT 25/23</u>	Decor Consultant:	<u>IRIT SALEM</u>
Date	Purchaser:				
Locked Date:			<u>-10- 26 2023</u>	Date Approved	<u>mRosen</u> Heathwood Homes (Williamsburg) Limited

ADEWALE, KELANI POPOOLA/MOJISOLA, OLUWATOYIN POPOOLA
Project: Williamsburg Green
Unit: 63, Phase: 1
Model: 28-2660 B THE LEMONGRASS

Locked:
Closed:

Kitchen

Cabinet Colour/Style	9120	VIKING III-GEORGIAN-ORCHID 3DL ***STD***
Island Cabinet Colour/Style	9120	VIKING III-GEORGIAN-ORCHID 3DL ***STD***
Cabinet Hardware	2098	12801-HARDWARE ***STD***
Countertop	9816	Group 2-Quartz-Caesarstone-DARTON # 7514-3/4 inch with built-up edge ***2***
Island Countertop	9816	Group 2-Quartz-Caesarstone-DARTON # 7514-3/4 inch with built-up edge ***2***
Countertop Edge	4007	GROUP 2 TO 7 - DOUBLE MITRE 1 1/2 INCH ***3***

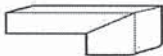

- Please note some islands may require a seam as per manufacturer and fabricator discretions.

Opt. Crumb Vac Colour	1111	N/A *****	
Kitchen Sink	9557	BLANCO SILGRANIT PRECIS U SUPER SINGLE 400890 ANTHRACITE (min cabinet 36 in)	PG 26
HoodFan	9068	KVWB606HBS KITCHEN AID 36 BLACK STAINLESS STEEL CHIMNEY HOOD	PG 39-42
Opt. Backsplash	1111	N/A *****	
Opt. Backsplash Grout	1111	N/A *****	
Opt. Backsplash Tile Pattern	1111	N/A *****	
Flooring	7498	Red Oak Pearl-Vintage Engineered-GRYPHON/IRONGATE-3/4 inch x 3 1/4 inch ***8***	
Floor Tile Grout	1111	N/A *****	
Floor Tile Pattern	1111	N/A *****	

- Purchasers have been advised: standard fridge opening is a minimum 37 3/8 x 73 3/8 inches. Ice Waterline Rough-In is included.
- Standard stove opening is 30 inches and standard dishwasher opening is 24 inches. Any gas stove will require backsplash or stainless steel backing to avoid fire hazards.
- Purchasers acknowledge: Heathwood Homes and its contractors will not be responsible for any kitchen cabinet changes due to appliances dimension changes after sign-off.

Comment

Hall and Closet (from Mud to Kitchen)

Flooring	9244	OV.ET.VLK.2424.PL-Eterna Volkas Polished White 24 x 24 UPG 6 ***UPG***
Floor Tile Grout	2225	Grout-(27) Silver ***STD***

M.O

ADEWALE, KELANI POPOOLA/MOJISOLA, OLUWATOYIN POPOOLA
Project: Williamsburg Green
Unit: 63, Phase: 1
Model: 28-2660 B THE LEMONGRASS

Created: 10/10/2023 12:05:32
Locked:
Closed:

Floor Tile Pattern	3000	STANDARD SQUARE ***STD***									
<table><tr><td></td><td></td><td></td></tr><tr><td></td><td></td><td></td></tr><tr><td></td><td></td><td></td></tr></table>											
Comment											

Foyer

Flooring	9244	OV.ET.VLK.2424.PL-Eterna Volkas Polished White 24 x 24 UPG 6 ***UPG***									
Floor Tile Grout	2225	Grout-(27) Silver ***STD***									
Floor Tile Pattern	3000	STANDARD SQUARE ***STD***									
<table><tr><td></td><td></td><td></td></tr><tr><td></td><td></td><td></td></tr><tr><td></td><td></td><td></td></tr></table>											
Comment											

Powder Room

Flooring	9244	OV.ET.VLK.2424.PL-Eterna Volkas Polished White 24 x 24 UPG 6 ***UPG***									
Floor Tile Grout	2225	Grout-(27) Silver ***STD***									
Floor Tile Pattern	3000	STANDARD SQUARE ***STD***									
<table><tr><td></td><td></td><td></td></tr><tr><td></td><td></td><td></td></tr><tr><td></td><td></td><td></td></tr></table>											
Plumbing Fixture (Colour)	1737	Plumbing Fixtures-WHITE ***STD***									
Opt. Vanity	1111	N/A *****									
Opt. Vanty Hardware	1111	N/A *****									
Opt. Vanity Countertop	1111	N/A *****									

Mud Room

Floor Tile	9244	OV.ET.VLK.2424.PL-Eterna Volkas Polished White 24 x 24 UPG 6 ***UPG***									
Floor Tile Grout	2225	Grout-(27) Silver ***STD***									
Floor Tile Pattern	3000	STANDARD SQUARE ***STD***									
<table><tr><td></td><td></td><td></td></tr><tr><td></td><td></td><td></td></tr><tr><td></td><td></td><td></td></tr></table>											
Comment											

M-O

ADEWALE, KELANI POPOOLA/MOJISOLA, OLUWATOYIN POPOOLA
Project: Williamsburg Green
Unit: 63, Phase: 1
Model: 28-2660 B THE LEMONGRASS

Created: 12/10/2023 12:05:02
Locked:
Closed:

Dining Room

Flooring	7498	Red Oak Pearl-Vintage Engineered-GRYPHON/IRONGATE-3/4 inch x 3 1/4 inch
Comment		

Great Room

Flooring	7498	Red Oak Pearl-Vintage Engineered-GRYPHON/IRONGATE-3/4 inch x 3 1/4 inch
Comment		

Great Room Fireplace

Type	8869	Majestic MERC32 ***STD***
Mantle	8891	NF-17-Paint Grade Mantle- Cabinet (Per Plan)-WHITE ***STD***
Opt. Surround	1111	N/A *****

- Purchasers have been advised: heat from the FP can damage TV above a FP and items placed on mantle.

- Heathwood and its contractors will not be liable for any damage on items placed and / or installed above a FP after closing.

Comment		
---------	--	--

Main Hall (from Foyer to Dining)

Flooring	7498	Red Oak Pearl-Vintage Engineered-GRYPHON/IRONGATE-3/4 inch x 3 1/4 inch
Comment		

Upper Hall

Flooring	9511	16787-MINOTAUR-MYSTIC BEIGE-40 oz Poly ***STD***
Comment		

Laundry Room

Floor Tile	9106	GE.MD.WHT.1818.MT Madison Series White Matte 18 X 18 Matte ***1***
Floor Tile Grout	7705	Grout-Alabaster / Bone ***UPG***
Floor Tile Pattern	3000	STANDARD SQUARE ***STD*** <div><div></div><div></div><div></div><div></div><div></div><div></div><div></div><div></div><div></div></div>
Cabinet Colour/Style - Uppers	9120	VIKING III-GEORGIAN-ORCHID 3DL ***STD***
Cabinet Hardware - Uppers	2098	12801-HARDWARE ***STD***

m.o

ADEWALE, KELANI POPOOLA/MOJISOLA, OLUWATOYIN POPOOLA
Project: Williamsburg Green
Unit: 63, Phase: 1
Model: 28-2660 B THE LEMONGRASS

Locked:
Closed:

Cabinet Colour/Style - Base	9120	VIKING III-GEORGIAN-ORCHID 3DL***STD***
Cabinet Hardware - Base	2098	12801-HARDWARE ***STD***
Countertop	8796	6698-46-Countertop-PALOMA POLAR ETCHINGS FINISH-Formica ***STD***
Opt. Countertop Edge	1111	N/A *****

Comment

Principal Suite and Walk-in Closets

Flooring	9511	16787-MINOTAUR-MYSTIC BEIGE-40 oz Poly ***STD***
Comment		

Bedroom 2 and Walk-in Closet

Flooring	9511	16787-MINOTAUR-MYSTIC BEIGE-40 oz Poly ***STD***
Comment		

Bedroom 3

Flooring	9511	16787-MINOTAUR-MYSTIC BEIGE-40 oz Poly ***STD***
Comment		

Bedroom 4

Flooring	9511	16787-MINOTAUR-MYSTIC BEIGE-40 oz Poly ***STD***
Comment		

Principal Ensuite

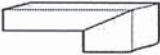
Cabinet Colour/Style	9176	Viking IV-TRINITY VIVA-WEEKEND GETAWAY ***UPG***
Cabinet Hardware	2098	12801-HARDWARE ***STD***
Countertop	9814	Group 2-Quartz-Caesarstone-ASHEN MARBLE # 7512-3/4 inch B/U MITERED EDGE ***2***
Countertop Edge	4007	GROUP 2 TO 7 - DOUBLE MITRE 1 1/2 INCH ***3*** 
Floor Tile	9116	OV.ET.MGR.2424.PL Eterna Series Medium Grey 24x24 ***6***
Floor Tile Grout	2220	Grout-Sahara-Beige / Desert ***UPG***

M-O

Customer Colours

ADEWALE, KELANI POPOOLA/MOJISOLA, OLUWATOYIN POPOOLA
Project: Williamsburg Green
Unit: 63, Phase: 1
Model: 28-2660 B THE LEMONGRASS

Created: 10/10/2023 12:05:38
Locked:
Closed:

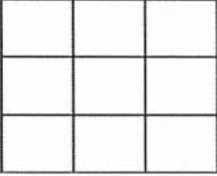
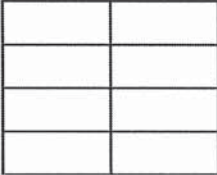
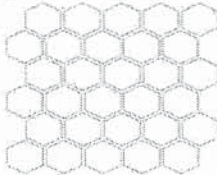
Floor Tile Grout	2220	Grout-Sahara Beige / Desert ***UPG***
Floor Tile Pattern	3000	STANDARD SQUARE ***STD*** 
Shower Wall and Ceiling Tile	9115	OV.ET.MGR.1224.PL Eterna Series Medium Grey 12x24 Polished See Tile Direction UPG 5
Shower Wall and Ceiling Tile Grout	2220	Grout-Sahara Beige / Desert ***UPG***
Shower Wall and Ceiling Tile Pattern	3070	HORIZONTAL STACKED ***STD*** 
Shower Floor Tile	9087	OV.ET.IGY.02.HEX.PL Eterna Series Imperial Grey 2 HEX Polished ***7***
Shower Floor Tile Grout	2225	Grout-(27) Silver ***STD***
Shower Floor Tile Pattern	3120	VERTICAL HEX ***STD*** 
Shower Jamb(s) and Sill(s)	8925	Shower Jamb / Sill-Sky Grey (Light Grey) ***STD***
Plumbing Fixture (colour)	1737	Plumbing Fixtures-WHITE ***STD***
Comment		

Ensuite 4

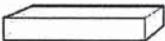
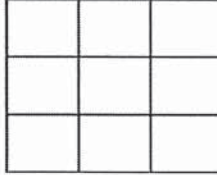
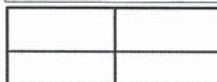
Cabinet Colour/Style	9120	VIKING III-GEORGIAN-ORCHID 3DL ***STD***
Cabinet Hardware	2098	12801-HARDWARE ***STD***
Countertop	9806	Group 1-Quartz-Caesarstone-WHITE SAND # 7041-3/4 inch ***STD IN PRINCIPLAL ENSUITE ONLY***
Opt. Countertop Edge	4010	GROUP 1 - SINGLE POLISHED STRAIGHT EDGE 3/4 INCH ***1*** 
Floor Tile	9103	GE.MD.LGR.1818.MT Madison Series Light Grey Matte 18 X 18 Matte ***1***
Floor Tile Grout	7705	Grout-Alabaster / Bone ***UPG***
Floor Tile Pattern	3000	STANDARD SQUARE ***STD*** 
Wall and Ceiling Tile	9022	QT.WV.TGR.0810-Weave-Tender Grey-8 x 10 ***STD***
Wall and Ceiling Tile Grout	7705	Grout-(01) Alabaster ***UPG***
Wall and Ceiling Tile Pattern	3070	HORIZONTAL STACKED ***STD*** 

ADEWALE, KELANI POPOOLA/MOJISOLA, OLUWATOYIN POPOOLA
Project: Williamsburg Green
Unit: 63, Phase: 1
Model: 28-2660 B THE LEMONGRASS

Created: 10/10/2023 12:05:22
Locked:
Closed:

Shower Floor Tile	8106	OD.ON.TGR.02.HEX.MT-ONTARIO HEXAGON MATTE-TENDER GREY ***UPG 2***
Shower Floor Tile Grout	7705	Grout-Alabaster / Bone ***UPG***
Shower Floor Tile Pattern	3000	STANDARD SQUARE ***STD***
Shower Jamb(s) and Sill(s)	8925	Shower Jamb / Sill-Sky Grey (Light Grey) ***STD***
Plumbing Fixture (colour)	1737	Plumbing Fixtures-WHITE ***STD***
Comment		

Shared Bath

Cabinet Colour/Style	9532	Viking IV-TRINITY VIVA-WINTER FUN M2004 ***UPG***
Lower Level Recreation Room	1111	N/A *****
Cabinet Hardware	2098	12801-HARDWARE ***STD***
Countertop	9807	Group 1-Quartz-Caesarstone-ROCK SALT # 7601-3/4 inch ***STD in PRINCIPLE ENSUITE ONLY***
Opt. Countertop Edge	4010	GROUP 1 - SINGLE POLISHED STRAIGHT EDGE 3/4 INCH ***1***
Floor Tile	9104	GE.MD.ANT.1818.MT Madison Series Antracite Matte 18 X 18 Matte ***1***
Floor Tile Grout	7704	Grout-Pearl Gray / North Sea Grey ***STD***
Floor Tile Pattern	3000	STANDARD SQUARE ***STD***
Wall Tile	9438	TH.CT.WHT.0812.GL-Construct-White Glossy-8 x 12 UPG 1 ***UPG***
Wall Tile Grout	7705	Grout-(01) Alabaster ***UPG***
Wall Tile Pattern	3070	HORIZONTAL STACKED ***STD***
Opt. Shower Floor Tile	1111	N/A *****
Opt. Shower Floor Tile Grout	1111	N/A *****
Opt. Shower Floor Tile Pattern	1111	N/A *****

m.0

Customer Colours

ADEWALE, KELANI POPOOLA/MOJISOLA, OLUWATOYIN POPOOLA
Project: Williamsburg Green
Unit: 63, Phase: 1
Model: 28-2660 B THE LEMONGRASS

8 of 49

Created: 10/10/2023 12:05:08
Locked:
Closed:

Opt. Shower Jamb(s) and Sill(s)	1111	N/A *****
Opt. Wall and Ceiling Tile	1111	N/A *****
Opt. Wall and Ceiling Tile Grout	1111	N/A *****
Opt. Wall and Ceiling Tile Pattern	1111	N/A *****

Plumbing Fixture (colour)	1737	Plumbing Fixtures-WHITE ***STD***
Comment		

Lower Level Recreation Room

Flooring	9511	16787-MINOTAUR-MYSTIC BEIGE-40 oz Poly ***STD***
Comment		

Lower Level Recreation Room Fireplace

Type	8865	Dimplex-Electric Fireplace-PF3033HL ***STD***
Mantle	8891	NF-17-Paint Grade Mantle- Cabinet (Per Plan)-WHITE ***STD***
Opt. Surround	1111	N/A *****

PG 25

- Purchasers have been advised: heat from the FP can damage TV above a FP and items placed on mantle.

- Heathwood and its contractors will not be liable for any damage on items placed and / or installed above a FP after closing.

Comment		
---------	--	--

Lower Level Bathroom

Cabinet Colour/Style	9120	VIKING III-GEORGIAN-ORCHID 3DL***STD***
Cabinet Hardware	2098	12801-HARDWARE ***STD***
Countertop	9806	Group 1-Quartz-Caesarstone-WHITE SAND # 7041-3/4 inch ***STD IN PRINCIPLAL ENSUITE ONLY***
Opt. Countertop Edge	4010	GROUP 1 - SINGLE POLISHED STRAIGHT EDGE 3/4 INCH ***1***
Floor Tile	9106	GE.MD.WHT.1818.MT Madison Series White Matte 18 X 18 Matte ***1***
Floor Tile Grout	2225	Grout-(27) Silver ***STD***
Floor Tile Pattern	3000	STANDARD SQUARE ***STD***

M.O

Customer Colours

ADEWALE, KELANI POPOOLA/MOJISOLA, OLUWATOYIN POPOOLA
Project: Williamsburg Green
Unit: 63, Phase: 1
Model: 28-2660 B THE LEMONGRASS

Locked:
Closed:

Shower wall and Ceiling Tile	5411	QT.SP.WHT.0810-Splendour-white-8 inch x 10 inch ***STD***
Shower Wall and Ceiling Grout	2226	Grout-(00) White ***STD***
Shower Wall and Ceiling Pattern	3090	VERTICAL STACKED ***STD*** <div><div></div><div></div><div></div><div></div><div></div><div></div><div></div><div></div></div>
Shower Floor Tile	8664	OD.ON.TGR.0202.MT.N-Ontario Series Mosaic-Tender Grey Matte-2 x 2 ***1***
Shower Floor Tile Grout	7705	Grout-Alabaster / Bone ***UPG***
Shower Floor Tile Pattern	3000	STANDARD SQUARE ***STD*** <div><div></div><div></div><div></div><div></div><div></div><div></div><div></div><div></div></div>
Shower Jamb(s) and Sill(s)	8923	Shower Jamb / Sill-Thassos White ***STD***
Plumbing Fixture (colour)	1737	Plumbing Fixtures-WHITE ***STD***
Comment		

Main Stairs

Type	1714	Oak Stairs ***STD MAIN STAIRS***
Colour	7912	Irongate (Gryphon) STAIN TO COMPLIMENT HARDWOOD AND WILL VARY FROM FLOORING
Handrail/Pickets/Posts Type	7652	1 5/16 inch Square pickets with 3 1/2 Square/Cap Post(s)-ALL OAK ***STD***
Handrail/Pickets/Posts Location	1728	Oak Grade-Stain handrail,oak pickets,stringers,treads,risers
Custom Stain/Paint	1111	N/A *****
Landing(s)	7498	Red Oak Pearl-Vintage Engineered-GRYPHON/IRONGATE-3/4 inch x 3 1/4 inch
Opt. Carpet Runner	1111	N/A *****
Comment		

Lower Level Stairs

Type

Colour	9511	DY 16787-MINOTAUR-MYSTIC BEIGE-40 oz Poly ***STD***
Handrail/Pickets/Posts Type	9119	Handrail only on closed walls (one or two sides per building code) ***STD***
Handrail/Pickets/Posts Location	7762	Carpet Grade-Stain handrail, stringers, nosing _post(s). (Me
Custom Stain/Paint	1111	N/A *****
Landing(s)	7498	Red Oak Pearl-Vintage Engineered-GRYPHON/IRONGATE-3/4 inch x 3 1/4 inch ***3***
Opt. Carpet Runner	1111	N/A *****

M-0

Customer Colours

ADEWALE, KELANI POPOOLA/MOJISOLA, OLUWATOYIN POPOOLA
Project: Williamsburg Green
Unit: 63, Phase: 1
Model: 28-2660 B THE LEMONGRASS

Created: 10/10/2023 12:05:03
Locked:
Closed:

Comment

Throughout

Switches and Plug	5796	Decora White Switches and Plugs ***STD***
Thresholds	2232	Metal Thresholds ***STD***
Underpad	1079	500 Series-Underpad ***STD***
Trim Size	8705	4 1/4 Baseboard and 2 3/4 Casings ***STD***
Trim - Paint Colour	1716	Trim-WHITE ***STD***
Walls - Paint Colour	1717	22-Wall-WARM GREY ***STD***

Comment

Purchaser:

ADEWALE, KELANI POPOOLA

Oct 25, 2023

Date

Decor Consultant

Oct 25, 2023

Date

Purchaser:

MOJISOLA, OLUWATOYIN PO

Oct 25, 2023

Date

Williamsburg Green

-10- 26 2023

Date Approved



CONSTRUCTION SUMMARY

Lot: 63
Model: 28-2660 B THE LEMONGRASS
Project/Phase: Williamsburg Green / 1

Offer	Finished Lower Level Complete with Finished Bathroom.
Worksheet	Note:

Offer	Ten Thousand Dollars (\$10,000) At D?cor. (No Cash Value) Singles
Worksheet	Note:



CONSTRUCTION SUMMARY

Lot: 63
Model: 28-2660 B THE LEMONGRASS
Project/Phase: Williamsburg Green / 1

ADMIN FEE

Invoice	Qty.	Description
---------	------	-------------

APPLIANCES

Invoice	Qty.	Description
1576 362,466 06Dec23	1	KITCHEN - APPLIANCES-KITCHENAID 36 INCH CHIMNEY HOOD BLACK SS-KVWB606HBS SEE SPECS CABINETRY-Notify; ELECTRICAL-delete std range hood; HEATING/AIR CONDITIONING-Duct Size change to

CABINETRY

Invoice	Qty.	Description
1576 362,466 06Dec23	1	KITCHEN - APPLIANCES-KITCHENAID 36 INCH CHIMNEY HOOD BLACK SS-KVWB606HBS SEE SPECS CABINETRY-Notify; ELECTRICAL-delete std range hood; HEATING/AIR CONDITIONING-Duct Size change to
1576 375,631 06Dec23	1	KITCHEN - CABINETRY - OPT.BUILT IN CABINET (SEE SEPARATE CHARGE ON COOKTOP CUTOUT) - VIKING - UPG SKETCH # 3 SEE APPLIANCE SPECS DRYWAL-Notify; FRAMING-Modify Bulkhead; GRANITE-delete partial countertop due to Built-in; PAINTING-
1576 362,522 06Dec23	1	KITCHEN - CABINETRY-B18-PER UNIT 60CM WIDE PULL-OUT DOOR BASE CABINET WASTE/RECYCLE CENTRE WITH SOFT-CLOSE ([4] BINS TOTAL, INCLUDING [2] 35L) (AVAILABLE ONLY WITH 60CM WIDE CABINET) VIKING TO BE INSTALLED IN THE ISLAND BESIDE THE SINK SEE SKETCH #3
1576 363,163 06Dec23	1	KITCHEN - PLUMBING-BLANCO-SILGRANIT PRECIS U SUPER SINGLE MODEL 400890-ANTHRACITE SEE SPEC
1576 364,342 06Dec23	1	Opt. Bed 4 ensuite - GRANITE-GROUP 1-OPT. BED 4 ENSUITE-UPG CABINETRY-delete std countertop; GRANITE-see upgraded single hole faucet and undermount sink specs
1576 364,326 06Dec23	1	Opt. Lower Bath - GRANITE-GROUP 1-OPT. LOWER BATH-UPG CABINETRY-delete std countertop; GRANITE-see upgraded single hole faucet and undermount sink specs
1576 364,334 06Dec23	1	Opt. Shared Bath - GRANITE-GROUP 1-OPT. SHARED BATH-UPG CABINETRY-delete std countertop; GRANITE-see upgraded single hole faucet and undermount sink specs
1576 373,270 06Dec23	1	Opt. Kitchen/Breakfast - HARDWOOD-3/4 x 3 1/4 IN RED OAK NSS SELECT V-OPT. KITCHEN/BREAKFAST CABINETRY-Raise Cabinet; CERAMICS-Delete Std Ceramics; Interior Stairs-Adjust riser height where applicabl
1576 374,240 06Dec23	1	MASTER ENSUITE - CABINETRY-PRINCIPAL ENSUITE-VIKING IV-UPG
1576 374,241 06Dec23	1	SHARED BATHROOM - CABINETRY-SHARED BATH-VIKING IV-UPG



CONSTRUCTION SUMMARY

Lot: 63
Model: 28-2660 B THE LEMONGRASS
Project/Phase: Williamsburg Green / 1

CERAMIC

Invoice	Qty.	Description
1576 371,337 06Dec23	1	FOYER - CERAMICS-FLOOR -UG 6-FOYER
1576 371,357 06Dec23	1	MUDROOM and Hallway in Front of Powder - CERAMICS-FLOOR -UG 6-MUDROOM AND HALLWAY IN FRONT OF POWDER
1576 371,347 06Dec23	1	POWDER ROOM - CERAMICS-FLOOR -UG 6-POWDER ROOM
1576 371,387 06Dec23	1	PRINCIPAL ENSUITE - CERAMICS-FLOOR -UG 6-PRINCIPAL ENSUITE
1576 371,470 06Dec23	1	PRINCIPAL ENSUITE SHOWER - CERAMICS-SHOWER FLOOR-UG 7-PRINCIPAL ENSUITE SHOWER
1576 371,456 06Dec23	1	LOWER BATH SHOWER - CERAMICS-SHOWER FLOOR-UG 1-LOWER BATH SHOWER
1576 371,372 06Dec23	1	SHARED BATH - CERAMICS-FLOOR -UG 1-SHARED BATH
1576 371,402 06Dec23	1	ENSUITE 4 - CERAMICS-FLOOR -UG 1-ENSUITE 4
1576 371,509 06Dec23	1	PRINCIPAL ENSUITE SHOWER INCLUDING CEILING - CERAMICS-WALL-GROUT-PRINCIPAL ENSUITE SHOWER INCLUDING CEILING
1576 371,479 06Dec23	1	ENSUITE 4 - SHOWER - CERAMICS-SHOWER FLOOR-GROUT-ENSUITE 4-SHOWER
1576 371,439 06Dec23	1	PRINCIPAL ENSUITE SHOWER INCLUDING CEILING - CERAMICS-FLOOR ON WALL-UG 5-PRINCIPAL ENSUITE SHOWER INCLUDING CEILING
1576 371,322 06Dec23	1	LOWER BATH - CERAMICS-FLOOR -UG 1-LOWER BATH
1576 371,391 06Dec23	1	PRINCIPAL ENSUITE - CERAMICS-FLOOR -GROUT-PRINCIPAL ENSUITE



CONSTRUCTION SUMMARY

Lot: 63
Model: 28-2660 B THE LEMONGRASS
Project/Phase: Williamsburg Green / 1

CERAMIC

Invoice	Qty.	Description
1576 371,463 06Dec23	1	LOWER BATH SHOWER - CERAMICS-SHOWER FLOOR-GROUT-LOWER BATH SHOWER
1576 371,392 06Dec23	1	LAUNDRY - CERAMICS-FLOOR -UG 1-LAUNDRY
1576 371,401 06Dec23	1	LAUNDRY - CERAMICS-FLOOR -GROUT-LAUNDRY
1576 371,411 06Dec23	1	ENSUITE 4 - CERAMICS-FLOOR -GROUT-ENSUITE 4
1576 371,473 06Dec23	1	ENSUITE 4 - SHOWER - CERAMICS-SHOWER FLOOR-UG 2-ENSUITE 4-SHOWER
1576 371,433 06Dec23	1	SHARED BATH TUB - CERAMICS-FLOOR ON WALL-GROUT-SHARED BATH TUB
1576 371,490 06Dec23	1	SHARED BATH TUB - CERAMICS-WALL-UG 1-SHARED BATH TUB
1576 371,519 06Dec23	1	ENSUITE 4 - SHOWER INCLUDING CEILING - CERAMICS-WALL-GROUT-ENSUITE 4-SHOWER INCLUDING CEILING

CERAMICS

Invoice	Qty.	Description
1576 373,270 06Dec23 **	1	Opt. Kitchen/Breakfast - HARDWOOD-3/4 x 3 1/4 IN RED OAK NSS SELECT V-OPT. KITCHEN/BREAKFAST CABINETRY-Raise Cabinet; CERAMICS-Delete Std Ceramics; Interior Stairs-Adjust riser height where applicabl



CONSTRUCTION SUMMARY

Lot: 63
Model: 28-2660 B THE LEMONGRASS
Project/Phase: Williamsburg Green / 1

COFFERED CEILING

Invoice	Qty.	Description
1548 363,404 26Oct23	1	DINING ROOM - COFFERED CEILING - OPT. COFFERED CEILING - DINING ROOM - UPG SKETCH # 2 DRYWALL-Notify; FRAMING-Notify; PAINTING-Notify
1548 363,401 26Oct23	1	GREAT ROOM - COFFERED CEILING - OPT. COFFERED CEILING - GREAT ROOM - UPG SKETCH # 2 DRYWALL-Notify; FRAMING-Notify; PAINTING-Notify
1576 363,404 06Dec23	-1	- COFFERED CEILING - OPT. COFFERED CEILING - DINING ROOM - UPG DRYWALL-Notify; FRAMING-Notify; PAINTING-Notify

DRYWALL

Invoice	Qty.	Description
1548 363,404 26Oct23 **	1	DINING ROOM - COFFERED CEILING - OPT. COFFERED CEILING - DINING ROOM - UPG SKETCH # 2 DRYWALL-Notify; FRAMING-Notify; PAINTING-Notify
1548 363,401 26Oct23 **	1	GREAT ROOM - COFFERED CEILING - OPT. COFFERED CEILING - GREAT ROOM - UPG SKETCH # 2 DRYWALL-Notify; FRAMING-Notify; PAINTING-Notify
1548 363,410 26Oct23 **	1	- CLASSIC COLLECTION SCHEDULE A - Choice of 20 LED pot lights in finished areas (Second Floor Potlight(s) Require Smooth Ceiling) DRYWALL-Drywall Ceiling cutouts for potlights FRAMING-Frame to accommodate potlights 8X GREAT ROOM- ON SEPARATE SWITCH 6X KITCHEN - (RELOCATE 3 STANDARD LIGHTS ABOVE ISLAND (CAPPED ON SEPARATE SWITCH) - USE EXISTING 3 WAY KITCHEN SWITCH FOR POT LIGHTS 6X DINING ROOM -KEEP STD. LIGHT - ON SEPARATE SWITCH SKETCH # 2
1576 375,631 06Dec23 **	1	KITCHEN - CABINETRY - OPT.BUILT IN CABINET (SEE SEPARATE CHARGE ON COOKTOP CUTOUT) - VIKING - UPG SKETCH # 3 SEE APPLIANCE SPECS DRYWAL-Notify; FRAMING-Modify Bulkhead; GRANITE-delete partial countertop due to Built-in; PAINTING-
1576 363,404 06Dec23 **	-1	- COFFERED CEILING - OPT. COFFERED CEILING - DINING ROOM - UPG DRYWALL-Notify; FRAMING-Notify; PAINTING-Notify



CONSTRUCTION SUMMARY

Lot: 63
Model: 28-2660 B THE LEMONGRASS
Project/Phase: Williamsburg Green / 1

ELECTRICAL

Invoice	Qty.	Description
1548 363,261 26Oct23	3	KITCHEN - ELECTRICAL-RELOCATION OF SWITCHES/LIGHTS RELOCATE STANDARD KITCHEN LIGHTS TO BE ROUGH IN CAP LIGHT ABOVE THE BREAKFAST BAR SKETCH # 2
1548 363,222 26Oct23	2	THROUGHOUT - ELECTRICAL-INTERIOR DUPLEX OUTLET ON EXISTING CIRCUIT 1X GREAT ROOM-TO BE INSTALLED ABOVE THE FIRE PLACE 70"+- FROM FLOOR 1X RECREATION ROOM-TO BE INSTALLED ABOVE THE STANDARD RG6 CABLE R/I 70"+- FROM FLOOR SKETCH # 1 AND 2
1548 363,410 26Oct23	1	- CLASSIC COLLECTION SCHEDULE A - Choice of 20 LED pot lights in finished areas (Second Floor Potlight(s) Require Smooth Ceiling) DRYWALL-Drywall Ceiling cutouts for potlights FRAMING-Frame to accommodate potlights 8X GREAT ROOM- ON SEPARATE SWITCH 6X KITCHEN - (RELOCATE 3 STANDARD LIGHTS ABOVE ISLAND (CAPPED ON SEPARATE SWITCH) - USE EXISTING 3 WAY KITCHEN SWITCH FOR POT LIGHTS 6X DINING ROOM -KEEP STD. LIGHT - ON SEPARATE SWITCH SKETCH # 2
1576 362,466 06Dec23 **	1	KITCHEN - APPLIANCES-KITCHENAID 36 INCH CHIMNEY HOOD BLACK SS-KVWB606HBS SEE SPECS CABINETRY-Notify; ELECTRICAL-delete std range hood; HEATING/AIR CONDITIONING-Duct Size change to
1576 363,230 06Dec23	1	KITCHEN - ELECTRICAL-ADDITIONAL 240V 40AMP DIRECT LINE FOR ADDITIONAL APPLIANCE TO BE USE FOR THE BUILT IN WALL OVEN/MICROWAVE SEE SPEC

FRAMING

Invoice	Qty.	Description
1548 363,404 26Oct23 **	1	DINING ROOM - COFFERED CEILING - OPT. COFFERED CEILING - DINING ROOM - UPG SKETCH # 2 DRYWALL-Notify; FRAMING-Notify; PAINTING-Notify
1548 363,401 26Oct23 **	1	GREAT ROOM - COFFERED CEILING - OPT. COFFERED CEILING - GREAT ROOM - UPG SKETCH # 2 DRYWALL-Notify; FRAMING-Notify; PAINTING-Notify
1548 363,410 26Oct23 **	1	- CLASSIC COLLECTION SCHEDULE A - Choice of 20 LED pot lights in finished areas (Second Floor Potlight(s) Require Smooth Ceiling) DRYWALL-Drywall Ceiling cutouts for potlights FRAMING-Frame to accommodate potlights 8X GREAT ROOM- ON SEPARATE SWITCH 6X KITCHEN - (RELOCATE 3 STANDARD LIGHTS ABOVE ISLAND (CAPPED ON SEPARATE SWITCH) - USE EXISTING 3 WAY KITCHEN SWITCH FOR POT LIGHTS 6X DINING ROOM -KEEP STD. LIGHT - ON SEPARATE SWITCH SKETCH # 2
1576 375,631 06Dec23 **	1	KITCHEN - CABINETRY - OPT.BUILT IN CABINET (SEE SEPARATE CHARGE ON COOKTOP CUTOUT) - VIKING - UPG SKETCH # 6 SEE APPLIANCE SPECS DRYWAL-Notify; FRAMING-Modify Bulkhead; GRANITE-delete partial countertop due to Built-in; PAINTING-
1576 363,404 06Dec23 **	-1	- COFFERED CEILING - OPT. COFFERED CEILING - DINING ROOM - UPG DRYWALL-Notify; FRAMING-Notify; PAINTING-Notify



CONSTRUCTION SUMMARY

Lot: 63
Model: 28-2660 B THE LEMONGRASS
Project/Phase: Williamsburg Green / 1

GLASS PRODUCTS / MIRRORS

Invoice	Qty.	Description
1576 375,667 06Dec23	1	- MIRRORS/GLASS PRODUCTS - CHANGE THE HARDWARE FOR 10MM FRAMELESS SHOWERS TO MATTE BLACK

GRANITE

Invoice	Qty.	Description
1576 362,789 06Dec23	1	KITCHEN - GRANITE-GRANITE CUTOUT FOR ELECTRICAL PLUG ON ISLAND DUE TO WATERFALL END SEE SKETCH # 6
1576 362,839 06Dec23	1	KITCHEN - GRANITE-WATERFALL END 4 FT ISLAND TWO SIDES 1 1/2 INCH MITERED EDGE-GROUP 2 SKETCH # 6
1576 375,631 06Dec23 **	1	KITCHEN - CABINETRY - OPT.BUILT IN CABINET (SEE SEPARATE CHARGE ON COOKTOP CUTOUT) - VIKING - UPG SKETCH # 6 SEE APPLIANCE SPECS DRYWAL-Notify; FRAMING-Modify Bulkhead; GRANITE-delete partial countertop due to Built-in; PAINTING-
1576 362,792 06Dec23	1	KITCHEN - GRANITE-GRANITE CUTOUT W/ STRAIGHT EDGE POLISH TO ACCOMMODATE COOK TOP FOR 36" COOKTOP SEE SPECS
1576 362,794 06Dec23	3	THROUGHOUT - GRANITE-GRANITE CUTOUT WITH STRAIGHT EDGE POLISH TO ACCOMMODATE UNDER MOUNT VANITY SINK SFOR SHARED BATH, ENSUITE 4 AND FINISHED LOWER LEVEL BATHROOMS see sink specs
1576 364,313 06Dec23	1	Kitchen - GRANITE-GROUP 2 WITH 1 1/2 IN MITER EDGE-KITCHEN-UPG
1576 363,163 06Dec23 **	1	KITCHEN - PLUMBING-BLANCO-SILGRANIT PRECIS U SUPER SINGLE MODEL 400890-ANTHRACITE SEE SPEC
1576 364,342 06Dec23	1	Opt. Bed 4 ensuite - GRANITE-GROUP 1-OPT. BED 4 ENSUITE-UPG CABINETRY-delete std countertop; GRANITE-see upgraded single hole faucet and undermount sink specs
1576 364,326 06Dec23	1	Opt. Lower Bath - GRANITE-GROUP 1-OPT. LOWER BATH-UPG CABINETRY-delete std countertop; GRANITE-see upgraded single hole faucet and undermount sink specs
1576 364,334 06Dec23	1	Opt. Shared Bath - GRANITE-GROUP 1-OPT. SHARED BATH-UPG CABINETRY-delete std countertop; GRANITE-see upgraded single hole faucet and undermount sink specs
1576 364,320 06Dec23	1	Principle Ensuite - GRANITE-GROUP 2 WITH 1 1/2 IN MITER EDGE-PRINCIPLE ENSUITE-UPG



CONSTRUCTION SUMMARY

Lot: 63
Model: 28-2660 B THE LEMONGRASS
Project/Phase: Williamsburg Green / 1

HARDWOOD

Invoice	Qty.	Description
1576 373,270 06Dec23	1	Opt. Kitchen/Breakfast - HARDWOOD-3/4 x 3 1/4 IN RED OAK NSS SELECT V-OPT. KITCHEN/BREAKFAST CABINETRY-Raise Cabinet; CERAMICS-Delete Std Ceramics; Interior Stairs-Adjust riser height where applicabl

HEATING / AIR CONDITIONING

Invoice	Qty.	Description
1548 362,855 26Oct23	1	- HEATING / AIR CONDITIONING-ROUGH-IN GAS LINE FOR BBQ AT MAIN FLOOR UP TO 40 FT (QUICK CONNECT NOT INCLUDED); ELECTR ICAL OUTLET PRICED SEPARATELY IF REQUIRED SKETCH # 2
1576 362,466 06Dec23 **	1	KITCHEN - APPLIANCES-KITCHENAID 36 INCH CHIMNEY HOOD BLACK SS-KVWB606HBS SEE SPECS CABINETRY-Notify; ELECTRICAL-delete std range hood; HEATING/AIR CONDITIONING-Duct Size change t

PAINTING

Invoice	Qty.	Description
1548 363,404 26Oct23 **	1	DINING ROOM - COFFERED CEILING - OPT. COFFERED CEILING - DINING ROOM - UPG SKETCH # 2 DRYWALL-Notify; FRAMING-Notify; PAINTING-Notify
1548 363,401 26Oct23 **	1	GREAT ROOM - COFFERED CEILING - OPT. COFFERED CEILING - GREAT ROOM - UPG SKETCH # 2 DRYWALL-Notify; FRAMING-Notify; PAINTING-Notify
1576 375,631 06Dec23 **	1	KITCHEN - CABINETRY - OPT.BUILT IN CABINET (SEE SEPARATE CHARGE ON COOKTOP CUTOUT) - VIKING - UPG SKETCH # 6 SEE APPLIANCE SPECS DRYWAL-Notify; FRAMING-Modify Bulkhead; GRANITE-delete partial countertop due to Built-in; PAINTING-
1576 363,404 06Dec23 **	-1	- COFFERED CEILING - OPT. COFFERED CEILING - DINING ROOM - UPG DRYWALL-Notify; FRAMING-Notify; PAINTING-Notify



CONSTRUCTION SUMMARY

Lot: 63
Model: 28-2660 B THE LEMONGRASS
Project/Phase: Williamsburg Green / 1

PLUMBING

Invoice	Qty.	Description
1576 363,040 06Dec23	3	THROUGHOUT - PLUMBING-MOEN -RIZON-LAV-SINGLE HANDLE FAUCET MATTE BLACK (MODEL: 6900BL) - 2X MASTER ENSUITE, 1X POWDER ROOM SEE SPEC
1576 363,054 06Dec23	1	MASTER ENSUITE - PLUMBING-MOEN -RIZON-ROMAN TUB-3 PIECE MATTE BLACK (MODEL: 4796/T935 BL) - SEE SPEC
1576 362,896 06Dec23	1	POWDER ROOM - PLUMBING-AMERICAN STANDARD-PEDESTAL SINK-OPT POWDER ROOM BOULEVARD- WHITE MODEL 0641 100 020 CENTRE HOLE ONLY - SEE SPEC
1576 362,901 06Dec23	3	THROUGHOUT - PLUMBING-AMERICAN STANDARD-SINK OPTIONS-UNDERMOUNT SINK-OVALYN MODEL 0496 221 020 (19 INCH X 16 INCH) - ALL BATHROOMS (NOTE: 2 ARE STANDARD IN PRINCIPAL ENSUITE) SEE SPEC
1576 363,163 06Dec23	1	KITCHEN - PLUMBING-BLANCO-SILGRANIT PRECIS U SUPER SINGLE MODEL 400890-ANTHRACITE SEE SPEC
1576 363,034 06Dec23	1	MASTER ENSUITE - PLUMBING-MOEN -RIZON- POSI-TEMP TUB/SHOWER WITH 3 FUNCTION DIVERTER VALVE, SLIDE BAR WITH HANDHELD AND SHOWERHEAD MATTE BLACK (MODEL: T2813EPBL/U361CI/UT2081BL/62320/3669EPBL/A725WR) SEE SPEC
1576 06Dec23 NoCat	1	KITCHEN - SUPPLY AND INSTALL PLUMBING MOEN ALIGN SINGLE HANDLE PULLDOWN KITCHEN FAUCET IN MATTE BLACK MODEL 7565 MT

SECURITY

Invoice	Qty.	Description
1548 363,189 26Oct23	1	- SECURITY-SECURITY CAMERA ROUGH-IN TO BE INSTALLED ON THE EXTERIOR BACK WALL SKETCH # 2

STRUCTURED WIRING

Invoice	Qty.	Description
1548 363,195 26Oct23	1	GREAT ROOM - STRUCTURED WIRING-CONDUIT PIPE TO ABOVE FIREPLACE ROUGH-IN IGREAT ROOM-TO BE INSTALLED ABOVE THE FIRE PLACE 70"+- FROM FLOOR BESIDE ELECTRICAL PLUG SKETCH # 2

THE LEMONGRASS

ELEVATION A | 3,526 SQ. FT.

Including 866 sq. ft. of Finished Lower Level

WILLIAMSBURG
GREEN

Sketch #2

28-2660 ELEV. B
Main Level

SECURITY CAMERA
ROUGH-IN

GAS R/I FOR BBQ

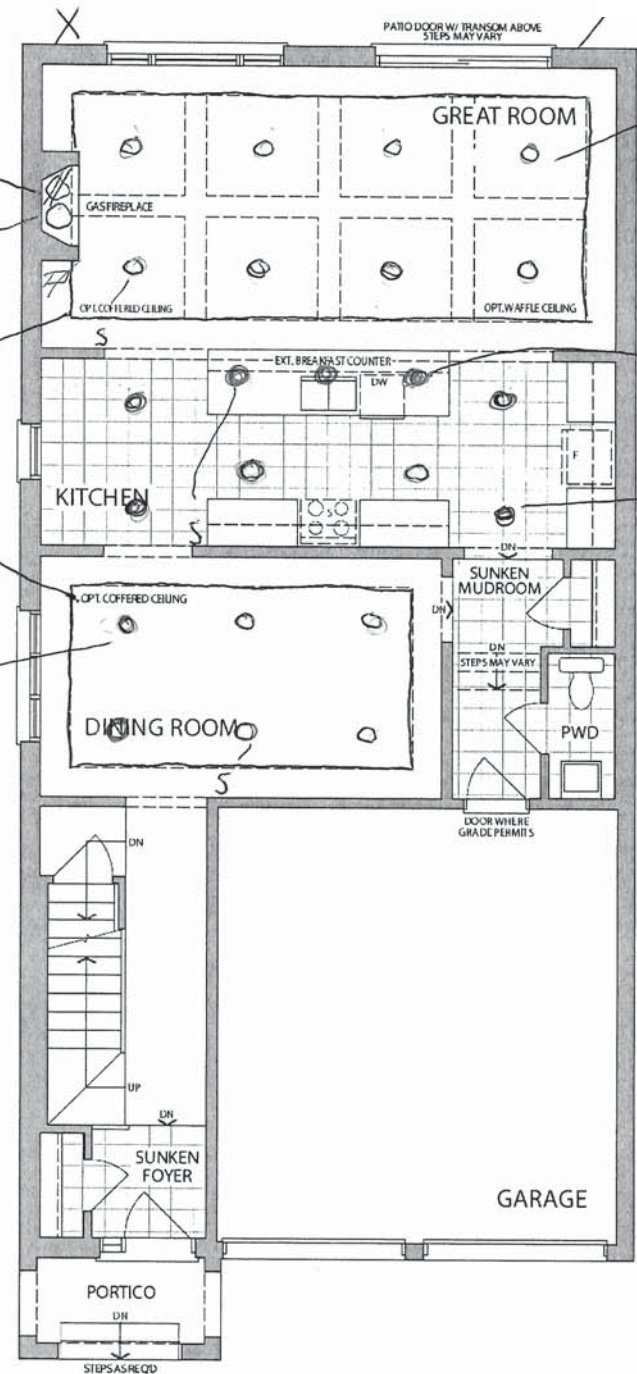

MAIN LEVEL
ELEVATION B

* Floor plan may vary due to grading conditions.

KITCHEN – GROUND FLR

UPGRADE KITCHEN

- 30" COOKTOP POTS & PANS
- 30" TALL BUILT-IN OVEN

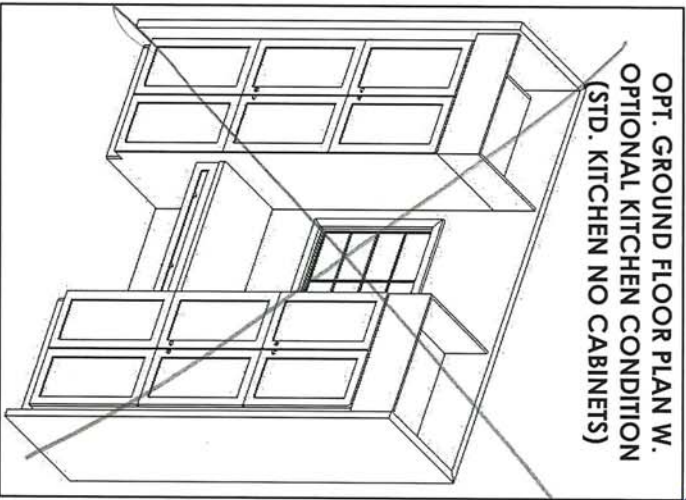
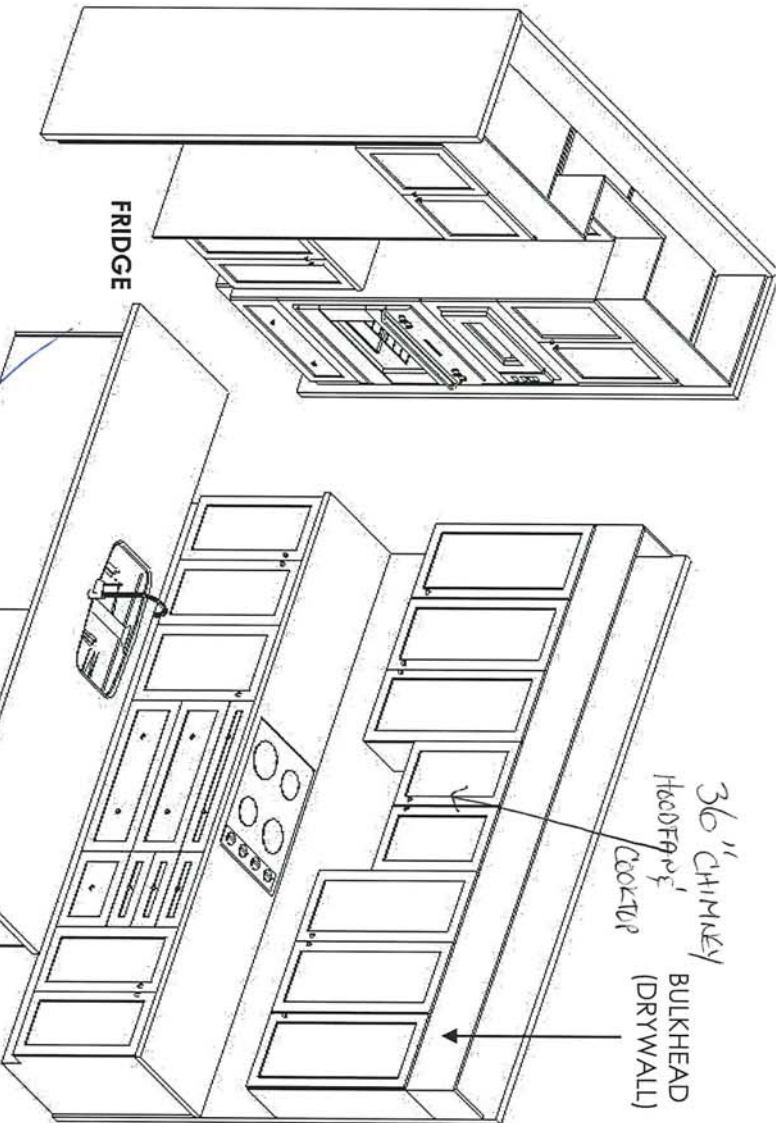
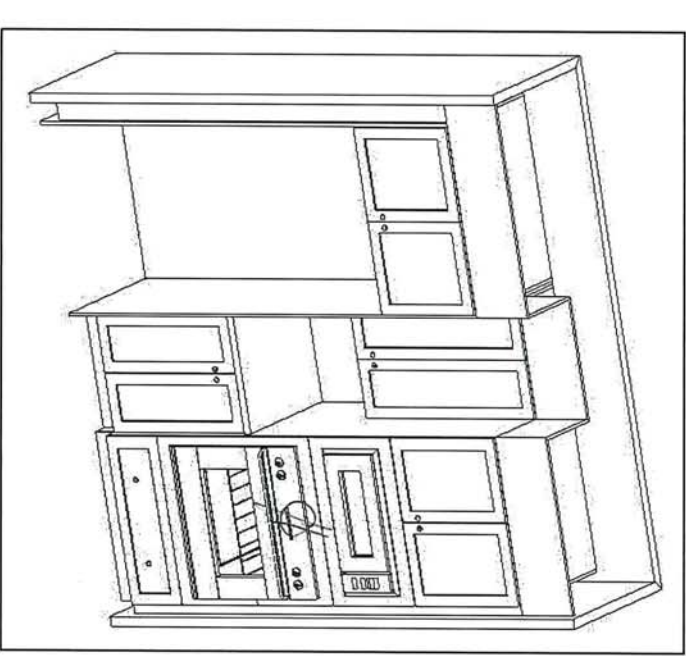
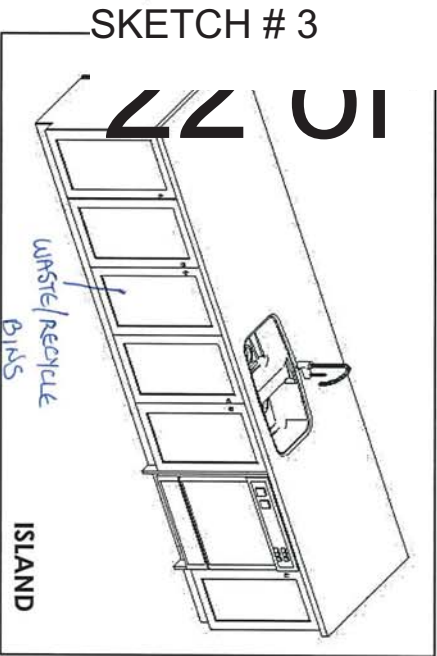

WATERFALL EDGES

This sketch is for DESIGN PURPOSES ONLY – It is not meant to be an exact rendition.



F R E N D E L
KITCHENS LIMITED
1350 Showson Drive, Mississauga, ON L4W 1C5

HEATHWOOD HOMES

WILLIAMSBURG

MODEL: LEMONGRASS

28-2660 (3404)

STANDARD CONTRACT INCLUDES:

Appliance Openings

- Hood: 30"W Builder Hood
- Fridge Opening: 37 3/8 "W X 73 3/8"
- Fridge cabinet & gables: 66cm Deep
- Stove Opening: 30" Freestanding
- Dishwasher Opening: 24"

Standard Scope Kitchen, Vanity, Laundry:

- 100cm H wall Cabinets
- Base Pie Cut Corner Cabinets
- Std. Blumotion Hinges-**Soft Close Doors**
- Std. Metabox Drawers-**Not Soft Close**
- Top Drawer In Principal Ensuite (Qty x1)
- Std. Laundry Uppers - 61cm H
- Std. Laundry Base
- Std. Basement Baths
- Backing on All - Except Sink Cabinets
- Countertop by Others for Kitchen & Principal Ensuite

Drawn By: Sepideh B
Date: August 25, 2023
Scale: Not To Scale

THIS DRAWING IS FOR DESIGN PURPOSES ONLY.
IT IS NOT AN EXACT RENDITION.

THE LEMONGRASS

ELEVATION A | 3,526 SQ. FT.

Including 866 sq. ft. of Finished Lower Level



28-2660 ELEV. B
Second Level

SKETCH # 4

BLACK FRAMLESS

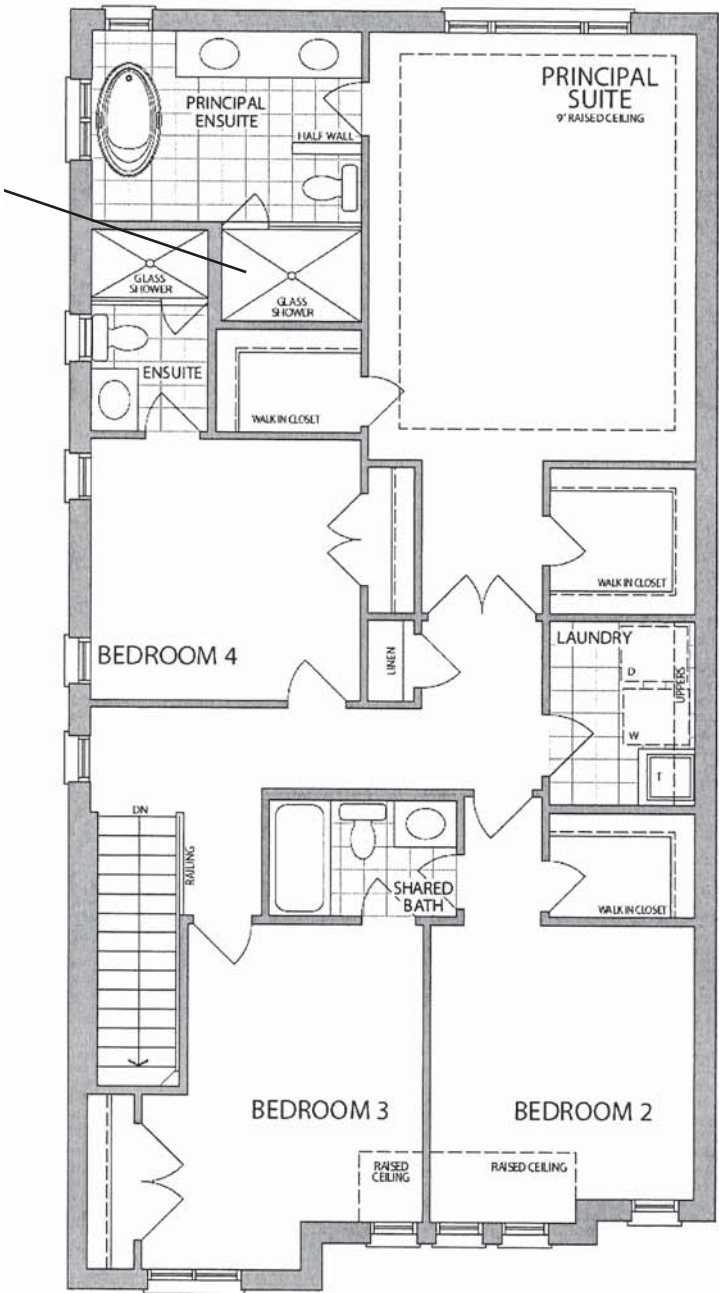

SECOND LEVEL
ELEVATION B

* Floor plan may vary due to grading conditions.

2ND FLOOR CABINETRY

f 49

SKETCH #5

PRINCIPAL ENSUITE

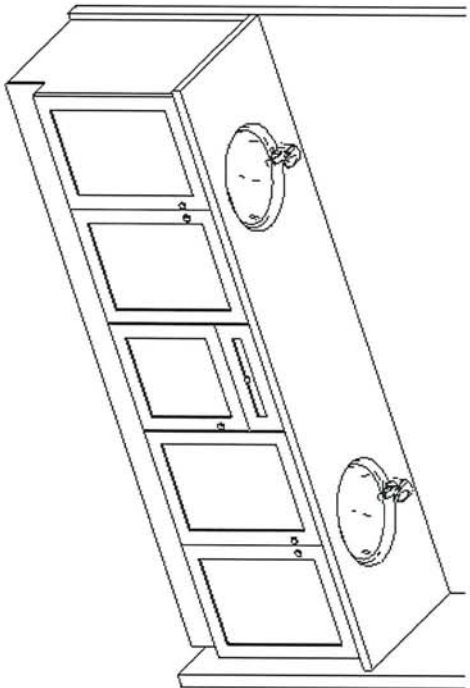

ENSUITE 4

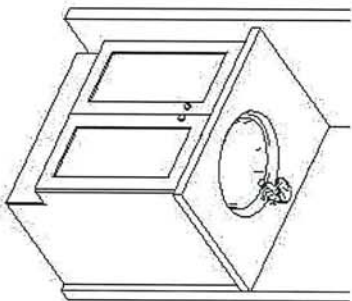

SHARED BATH

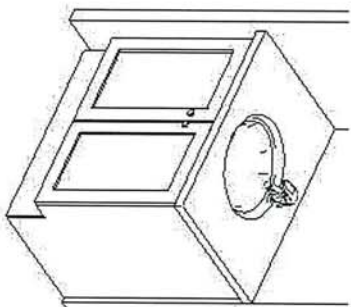

BASEMENT

~~Opt.~~ FINISHED BASEMENT

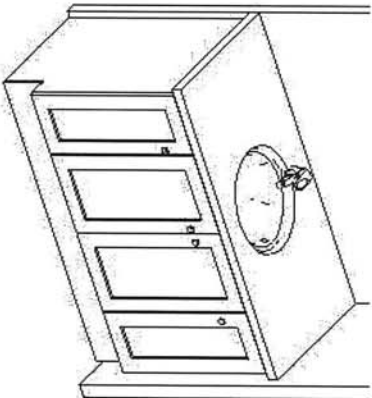

LAUNDRY

STD. LAUNDRY BASE
STD. LAUNDRY UPPERS

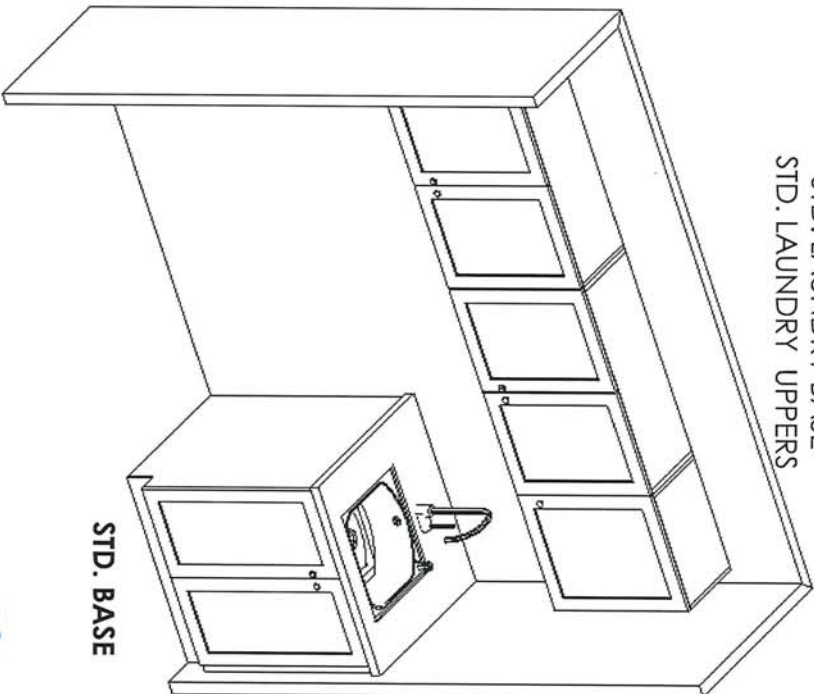

STD. BASE

This sketch is for DESIGN PURPOSES ONLY – It is not meant to be an exact rendition.



F R E N D E L
K I T C H E N S L I M I T E D
1350 Shawson Drive, Mississauga, ON L4W 1C5

HEATHWOOD HOMES
WILLIAMSBURG
MODEL: LEMONGRASS
28-2660 (3404)

STANDARD CONTRACT INCLUDES:

Appliance Openings

- Hood: 30"W Builder Hood
- Fridge Opening: 37 3/8 "W X 73 3/8"
- Fridge cabinet & gables: 66cm Deep
- Stove Opening: 30" Freestanding
- Dishwasher Opening: 24"

Standard Scope Kitchen, Vanity, Laundry:

- 100cm H wall Cabinets
- Base Pie Cut Corner Cabinets
- Std. Blumotion Hinges-**Soft Close Doors**
- Std. Metabox Drawers-**Not Soft Close**
- Top Drawer In Principal Ensuite (Qty x1)
- Std. Laundry Uppers - 61 cm H
- Std. Laundry Base
- Std. Basement Baths
- Backing on All - Except Sink Cabinets
- Countertop by Others for Kitchen & Principal Ensuite

Drawn By: Sepideh B

Date: August 25, 2023

Scale: Not To Scale

THIS DRAWING IS FOR DESIGN PURPOSES ONLY.
IT IS NOT AN EXACT RENDITION.

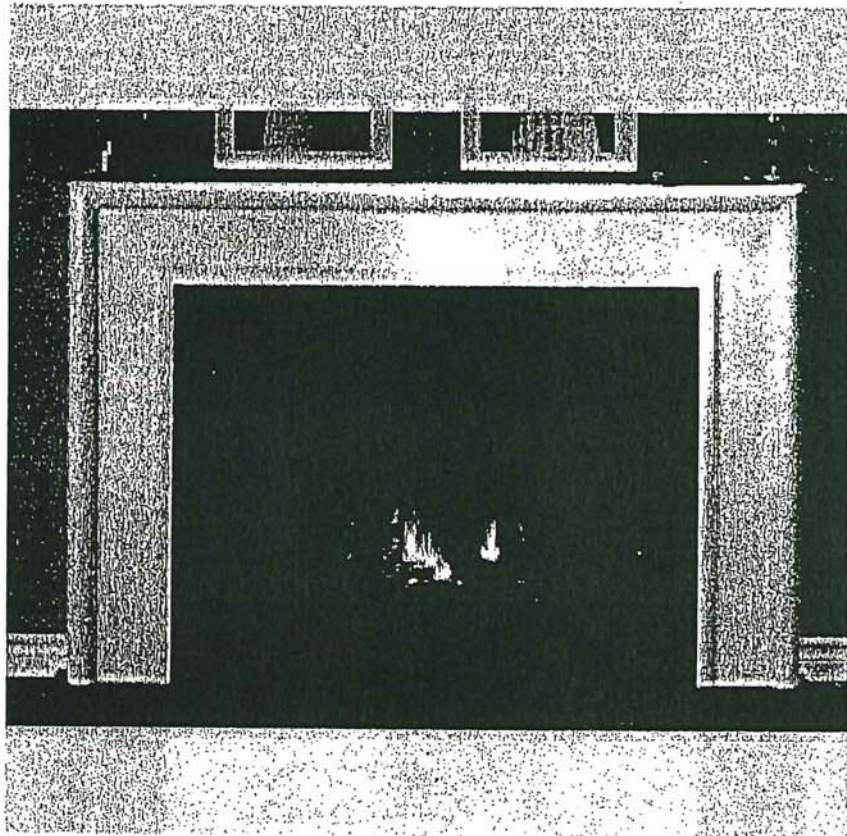

NEAS NF17 Mantel

M.O

BLANCO

Sink Specifications

PRECIS U SUPER SINGLE
SILGRANIT

Colour	SKU
Café	400889
Anthracite	400890
Truffle	401143
Cinder	401397
Metallic Grey	401683
White	401820
Concrete Grey	402266
Coal Black	402660

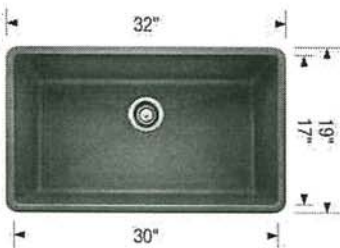

Design and planning tips

- Min cabinet size: 36 in (915 mm)
- Bowl Depth: 9,5 in (240.0 mm)

Specifications:
Mounting clips, Sink template, Installation instructions, 3½" (90 mm) stainless steel strainer(s), Limited Lifetime Warranty

To protect from damage, this model should be shipped on a pallet.
Depending on cabinet construction, a different cabinet size may be required. Consult the cabinet manufacturer.
Codes/Standards: CSA B45.8-18/ IAPMO Z403-2018

Optional Accessories

CapFlow Strainer Cover	517666
Floating Grid	406535
Sink Grid	406446
Mesh Basket	406399

Warranty
Limited lifetime warranty on all sinks and faucets. One-year warranty on all accessories and soap dispensers.

Code/Standards Compliance
BLANCO sinks and faucets are third-party tested and certified to CSA, cUPC, ANSI/ASME, IAPMO and NSF standards and listed by applicable certification bodies. For more information on individual product listings, contact our office or listing organization.

 Need support? Learn more by watching our sink & faucet How-to videos:
<https://www.blanco.com/ca-en/support/how-to-videos/how-to-videos-for-sinks/>

	BLANCO Canada Inc 100 Corporation Drive Brampton ON L6S 6B5	Tel & Fax Tel: 905-494-2400 Toll free: 1-877-425-2626 Fax: 905-494-2425 Toll free: 1-877-825-2626
---	---	---

While BLANCO strives to provide accurate information, all images and dimensions in this document are intended for reference only and are subject to change at any time without notice. This document is not intended for use as an installation guide. For technical installation details, refer to installation instructions provided with the product. BLANCO assumes no responsibility for the use of superseded or voided specifications.

M-0

MOEN®

There is more than 1 version of this model.
Page down to identify the version you have.

FAUCET DESCRIPTION

- Reflex™ pulldown system offers smooth operation, easy movement and secure docking
- Power Clean™ spray technology
- Metal construction with various finishes identified by suffix
- Duralock™ connect installation
- Pulldown spray with 68" braided hose
- Flexible supply lines with 3/8" compression fittings
- High arc spout provides height and reach to fill or clean large pots while pulldown wand provides the maneuverability for cleaning or rinsing
- 360° rotating spout
- Faucet designed for handle to be mounted on right side only

OPERATION

- Lever style handle
- Temperature controlled by 100° arc of handle travel
- Operates with less than 5 lbs. of force
- Operates in stream or spray mode in the pullout or retracted position

FLOW

- Flow is limited to 1.5 gpm (5.7 L/min) max at 60 psi

CARTRIDGE

- 1255™ Duralast™ cartridge

STANDARDS

- Third party certified to IAPMO Green, ASME A112.18.1/CSA B125.1 and all applicable requirements therein including NSF 61/9G & 372
- Meets CalGreen and Georgia SB370 requirements
- Complies with California Proposition 65 and with the Federal Safe Drinking Water Act
- The backflow protection system in the device consists of two independently operating check valves, a primary and a secondary which prevent backflow

- **ADA**  for lever handle

WARRANTY

- Lifetime limited warranty against leaks, drips and finish defects to the original homeowner
 - 10 year limited warranty when used in a multifamily installation
 - 5 year limited warranty when used in a commercial installation
- Visit www.moen.com/support for complete details and limitations

Specifications



ALIGN™
Single Handle High Arc
Pulldown Kitchen Faucet

Models: 7565 series

7565BL MATTE BLACK

NOTE: THIS FAUCET IS DESIGNED TO BE INSTALLED
THROUGH 1 HOLE, 1-1/2" (38mm) MIN. DIA.
(OPTIONAL 3-HOLE ESCUTCHEON 141002 AVAILABLE)

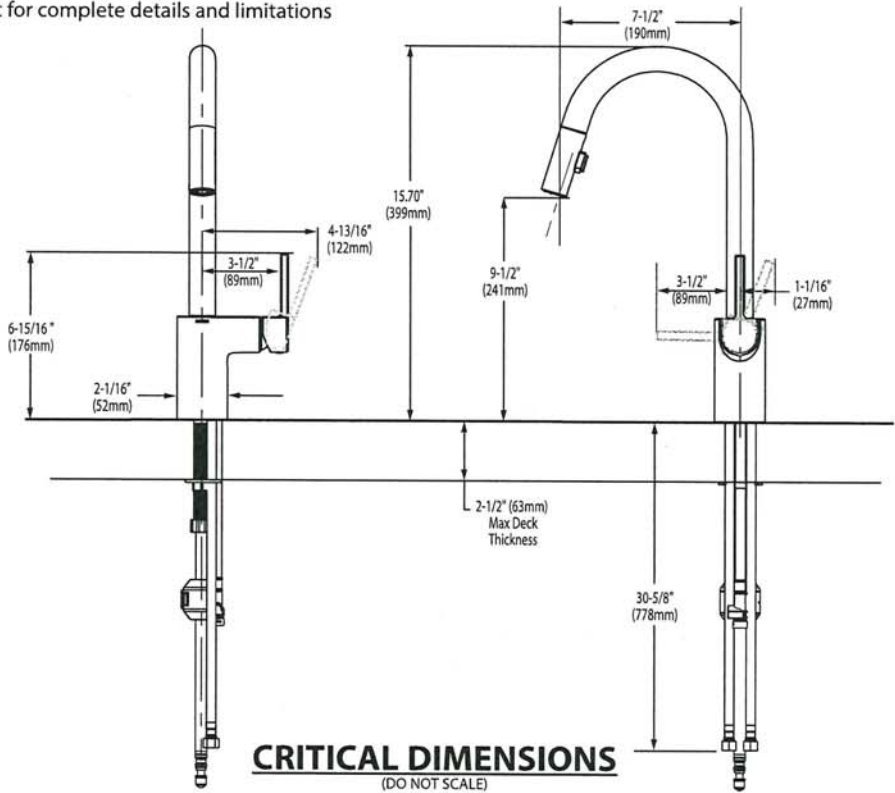

M.O



BARRIER FREE (ABOVE COUNTER OR DROP-IN ONLY)

POWDER ROOM
CENTRE HOLE

**BOULEVARD®
PEDESTAL SINK**
VITREOUS CHINA

BOULEVARD® PEDESTAL SINK

- ~~☐ 0641.800 Faucet holes on 8" (203mm) centers (Illustrated)~~
STD ☐ 0641.400 Faucet holes on 4" (102mm) centers
~~☐ 0641.100 Center hole only~~
- Classic styled rectangular pedestal lavatory
 - Vitreous china
 - Rear overflow
 - Supplied with mounting kit
 - Right Height® for greater comfort during use
 - Faucet ledge with large deck area (faucet not included)
 - **Design coordinates with Boulevard® Toilet**
 - Basin has flat bottom to also allow use as an **above counter sink** or a **drop-in sink** (with u-shaped cut out)

Nominal Dimensions:
24" x 19" x 35-1/2"
(610 x 483 x 902mm)

- ☐ 0641.008 Pedestal top-8" (203mm) centers
☐ 0641.004 Pedestal top-4" (102mm) centers
☒ 0641.001 Pedestal top-center hole only
☐ 0010.000 Pedestal only

Bowl sizes:
17" (432mm) wide,
12-1/2" (318mm) front to back,
5" (127mm) deep

Compliance Certifications -
Meets or Exceeds the Following Specifications:
• ASME A112.19.2 - 2008/CSA B45.1-08

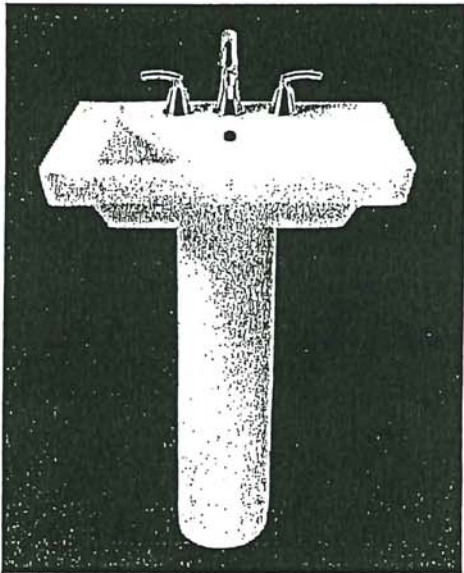

SEE REVERSE FOR ROUGHING-IN DIMENSIONS

- To Be Specified:**
- ☐ Color: ☐ White ☐ Linen
 - ☐ Faucet Finish:
 - ☐ Supplies:
 - ☐ 1-1/4" Trap:
 - ☐ Nipple:

* See faucet section for additional models available



**BOULEVARD®
PEDESTAL SINK**
VITREOUS CHINA

BARRIER FREE (ABOVE COUNTER OR DROP-IN ONLY)

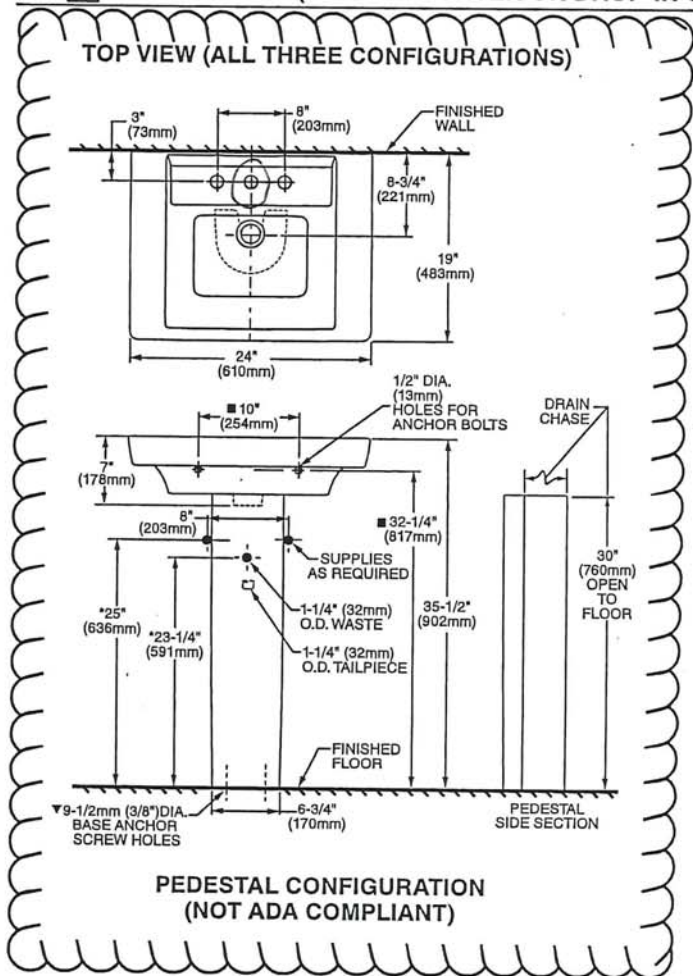

ABOVE COUNTER CONFIGURATION

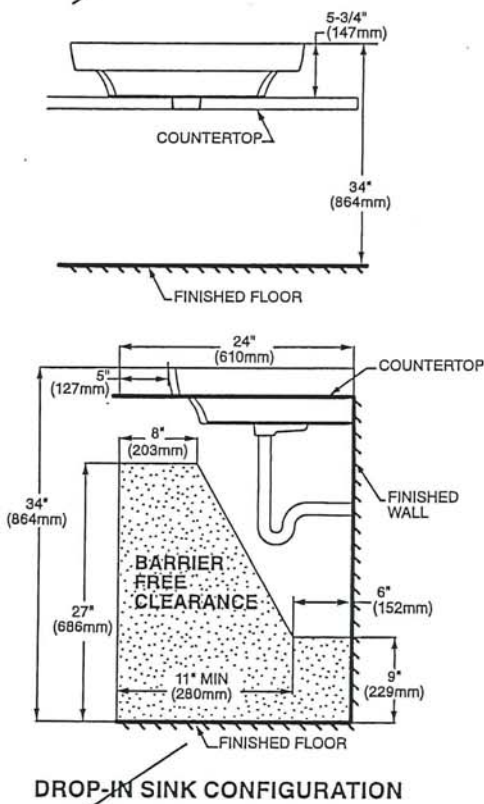

**ABOVE COUNTER AND DROP-IN SINK CONFIGURATIONS
MEET THE AMERICANS WITH DISABILITIES ACT GUIDELINES
AND ANSI A117.1 ACCESSIBLE AND USABLE
BUILDINGS AND FACILITIES - CHECK LOCAL CODES.**

Top of sink installed at 34" (864mm) height from finished floor.
Sink installed 5" (127mm) minimum from front edge of countertop.
Provide 27" (686mm) knee clearance area.

NOTES:
* DIMENSIONS SHOWN FOR LOCATION OF SUPPLIES AND "P" TRAPS ARE SUGGESTED.
▼ PEDESTAL ANCHORING SCREWS NOT INCLUDED.
■ SUITABLE FOR REINFORCEMENT ONLY. ACTUAL DIMENSIONS MUST BE TAKEN FROM FIXTURE.
FITTING NOT INCLUDED AND MUST BE ORDERED SEPARATELY.
PROVIDE SUITABLE REINFORCEMENT FOR ALL WALL SUPPORTS.
INSTALLATION INSTRUCTIONS SUPPLIED WITH LAVATORY.

IMPORTANT: Dimensions of fixtures are nominal and may vary within the range of tolerance established by ANSI Standard A112.19.2
These measurements are subject to change or cancellation. No responsibility is assumed for use of superseded or voided pages.

M-0

ALL BATHROOMS.

American Standard

Style That Works Better

 BARRIER FREE

OVALYN™
UNDERCOUNTER SINK
VITREOUS CHINA

OVALYN™ UNDERCOUNTER SINK

- Classic oval undermount sink
- Made from vitreous china
- Front overflow
- Supplied with mounting kit (047194-0070A) and template

☐ **0495.221 Unglazed rim**
435 x 359mm
(17-1/8" x 14-1/8")

☐ **0495.300 Glazed underside**

Bowl size:

382mm (15-1/16") wide
306mm (12-1/16") front to back
140mm (5-1/2") deep

☒ **0496.221 Unglazed rim**
489 x 413mm
(19-1/4" x 16-1/4")

☐ **0496.300 Glazed underside**

Bowl size:

432mm (17") wide
356mm (14") front to back
140mm (5-1/2") deep

☐ **0497.221 Unglazed rim**
546 x 441mm
(21-1/2" x 17-3/8")

☐ **0497.300 Glazed underside**

Bowl size:

483mm (19") wide
391mm (15-3/8") front to back
140mm (5-1/2") deep

Compliance Certifications -

Meets or Exceeds the Following Specifications:

- ASME A112.19.2M for Vitreous China Fixtures
- CAN/CSA B45 series

To Be Specified:

- ☐ Color: ☐ White ☐ Bone ☐ Linen
☐ Silver ☐ Fawn Beige ☐ Black
- ☐ Faucet*:
☐ Faucet Finish:
☐ Supplies:
☐ 1-1/4" Trap:

* See faucet section for additional models available

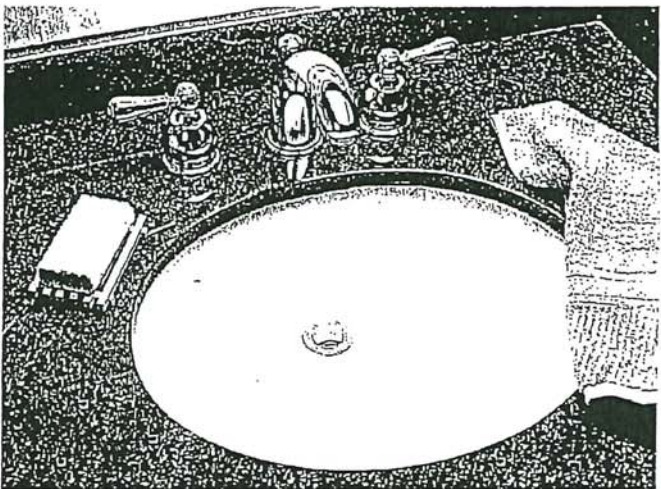

SEE REVERSE FOR ROUGHING-IN DIMENSIONS

M-0

American Standard
Style That Works Better

BARRIER FREE

OVALYN™
UNDERCOUNTER SINK
VITREOUS CHINA

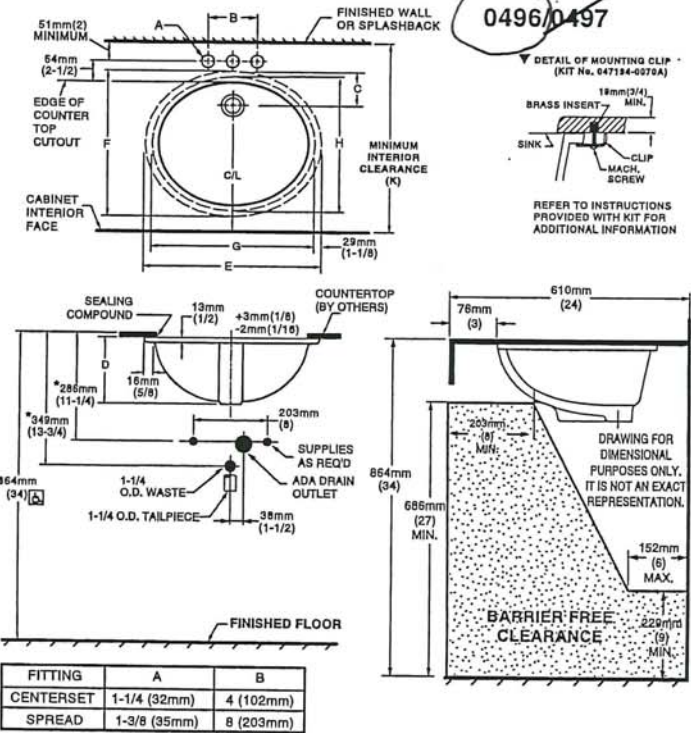

NOTES:
* DIMENSIONS SHOWN FOR LOCATION OF SUPPLIED AND "P" TRAP ARE SUGGESTED.
▼ UNDERCOUNTER MOUNTING KIT SUPPLIED WITH SINK.
PLEASE NOTE MINIMUM INTERIOR CLEARANCE DIMENSION (K). FITTINGS NOT INCLUDED AND MUST BE ORDERED SEPARATELY. USE ENCLOSED TEMPLATE FOR COUNTERTOP CUTOUT SEALING COMPOUND SUPPLIED BY OTHERS.
IMPORTANT: Dimensions of fixtures are nominal and may vary within the range of tolerances established by ANSI Standard A112.19.2. These measurements are subject to change or cancellation. No responsibility is assumed for use of superseded or voided pages.

MEETS THE AMERICANS WITH DISABILITIES ACT GUIDELINES AND ANSI A117.1 ACCESSIBLE AND USEABLE BUILDINGS AND FACILITIES - CHECK LOCAL CODES.
Countertop 864mm (34") from finished floor. Lavatory installed 76mm (3") from front edge of countertop. Countertop thickness to be 25mm (1") maximum.

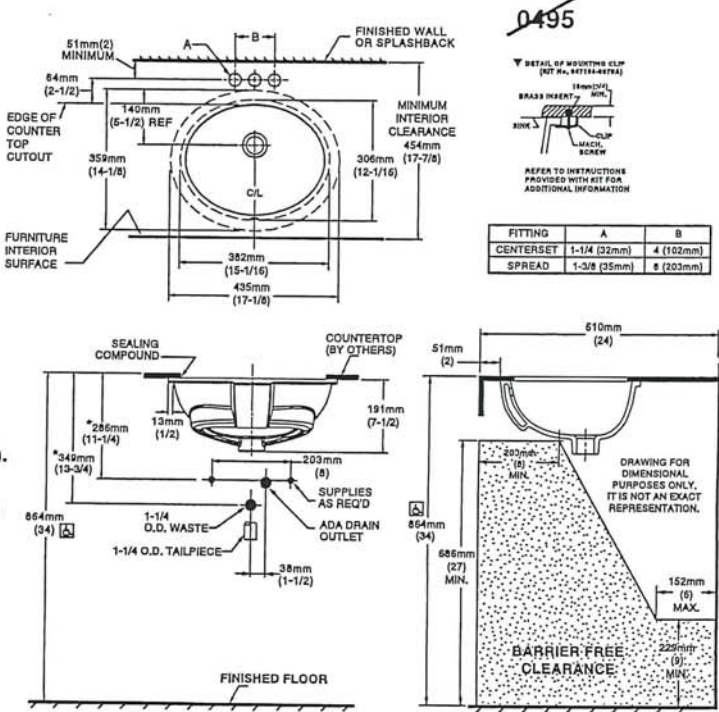

NOTES:
USE ENCLOSED TEMPLATE FOR COUNTER TOP CUTOUT. FITTINGS NOT INCLUDED WITH FIXTURE AND MUST BE ORDERED SEPARATELY.
* DIMENSIONS SHOWN FOR LOCATION OF SUPPLIED AND "P" TRAP ARE SUGGESTED.
▼ UNDERCOUNTER MOUNTING KIT SUPPLIED WITH SINK.
PLEASE NOTE MINIMUM INTERIOR CLEARANCE DIMENSION (K). SEALING COMPOUND SUPPLIED BY OTHERS.
IMPORTANT: Dimensions of fixtures are nominal and may vary within the range of tolerances established by ANSI Standard A112.19.2. These measurements are subject to change or cancellation. No responsibility is assumed for use of superseded or voided pages

MEETS THE AMERICANS WITH DISABILITIES ACT GUIDELINES AND ANSI A117.1 ACCESSIBLE AND USEABLE BUILDINGS AND FACILITIES - CHECK LOCAL CODES.
Countertop 864mm (34") from finished floor. Lavatory installed 51mm (2") from front edge of countertop. Countertop thickness to be 25mm (1") maximum.

M-0



DEMI™
Product Specification Sheet

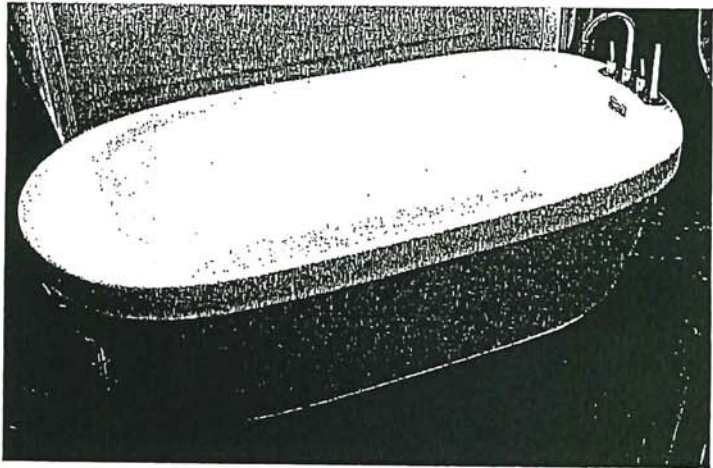

Two Piece Freestanding Collection

CF2007	Two Piece Freestanding Soaker
Size:	60" x 32" x 22" 1524 mm x 813 mm x 559 mm

PRODUCT FEATURES & BENEFITS

- Vacuum formed acrylic reinforced with fiberglass
- Scratch, stain and fade resistant high gloss finish
- Installation friendly two piece design
- Accepts deck mounted faucet
- Includes integral pop up drain and rectangular overflow
- Includes levelling feet

TWO PIECE ASSEMBLY

FRONT VIEW

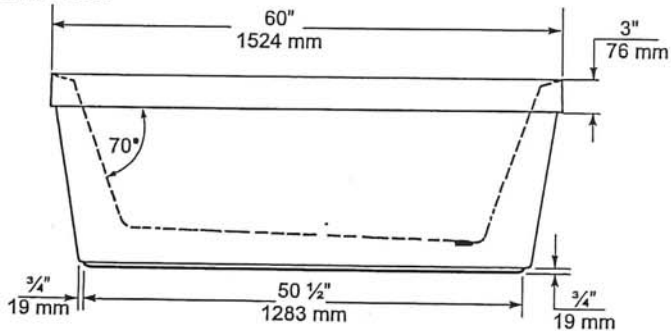

END VIEW

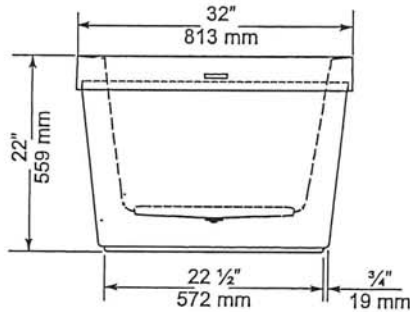

TOP VIEW

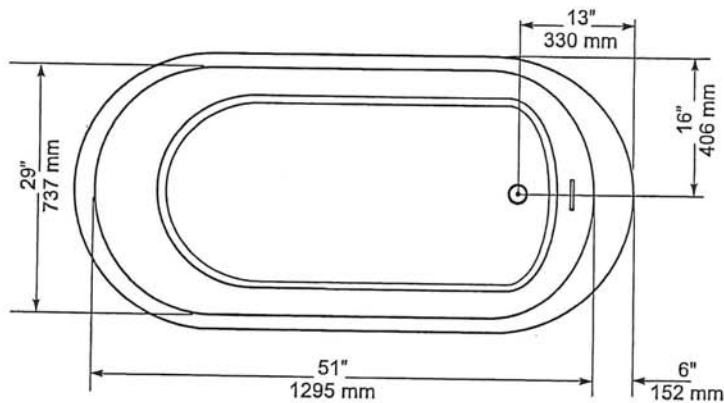

GENERAL SPECIFICATIONS		
Average Weight	90 lb	41 kg
Bathing Well at bottom	43"x 20"	1092 x 508 mm
Capacity Drain to Overflow		195 litres
Water Depth Drain to Overflow	16"	406 mm
Drain Opening (dia.)	2"	51 mm
Overflow Opening	2 1/4"x 1/2"	57 x 13 mm
Drain to Floor Clearance	3 1/4"	83 mm

NOTES: Please confirm measurements on actual product to ensure proper identification. Bathtub to be installed on the floor supported by 5 self levelling feet. Adjust if required to level the bathtub for adequate drainage. Refer to installation instructions for additional information.

IMPORTANT: Dimensions of fixtures are nominal and may vary ± 1/4" (6 mm). Weight may vary ± 5 lb (2.3 kg). Drawing is not to scale. These measurements are subject to change at manufacturer's discretion.

Compliance Certifications -
Meets or Exceeds the following Specifications:
• CAN/CSA - B45 Series



M-0



☐ 238AA.114

- VorMax flushing technology cleans two times better than conventional toilets**
- Combination bowl and tank, less seat
- 12" (305 mm) rough-in
- Right Height elongated siphon action bowl
- Ultra-high efficiency toilet (UHET) 1.0 gpf/3.8 Lpf
- Meets EPA WaterSense® and MaP Premium criteria
- EverClean® Antimicrobial Surface
- Transitional styling
- Includes EZ-Install Tools
- CleanCurve™ rim eliminates rim area where dirt and build-up hide
- 16-1/2" (419 mm) rim height for accessible applications
- 2-1/16" (52 mm) trapway
- Dual injection flush valves
- Chrome trip lever
- Two color-matched bolt caps
- 10 year warranty

- ☐ **238AA.115** Same as above except trip lever on right hand side
- ☐ **3385A.101** Right Height® Elongated Bowl
- ☐ **4385A.114** UHET Tank

Nominal Dimensions:

30-3/16" x 17-7/8" x 32-1/4"
(767 x 453 x 820mm)

Fixture only, seat and supply sold separately

Alternative Tank Configuration Available:

- ☐ **4385A.115** Tank complete with trip lever located on right side

Compliance Certifications -

Meets or Exceeds the Following Specifications:

- ASME A112.19.2/CSA B45.1 for Vitreous China Fixtures
- US EPA WaterSense® Specification for UHETs

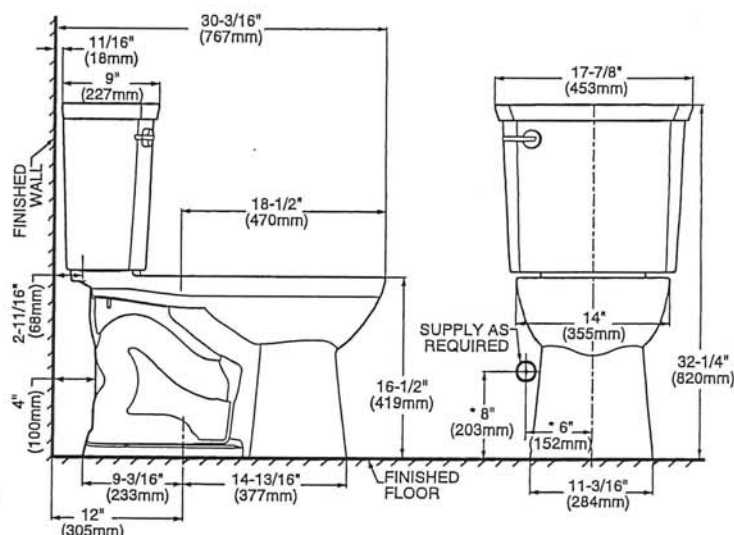
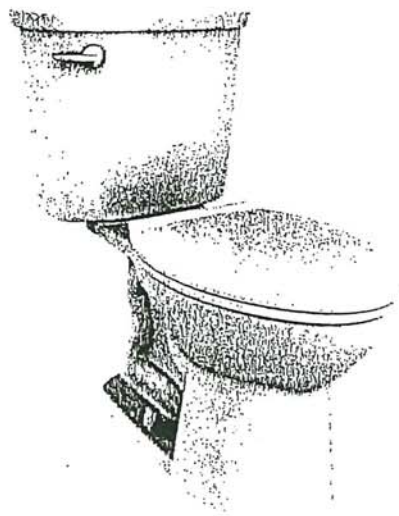

NOTES:

NOTES:
THIS TOILET IS DESIGNED TO ROUGH-IN AT A MINIMUM DIMENSION OF 305MM (12") FROM FINISHED WALL TO C/L OF OUTLET.
SUPPLY NOT INCLUDED WITH FIXTURE AND MUST BE ORDERED SEPARATELY

* DIMENSION SHOWN FOR LOCATION OF SUPPLY IS SUGGESTED.

IMPORTANT: Dimensions of fixtures are nominal and may vary within the range of tolerances established by ANSI Standard A112.19.2. These measurements are subject to change or cancellation. No responsibility is assumed for use of superseded or voided pages.

To Be Specified:

- ☐ Color: ☐ White
- ☐ Seat: #5055A.65C Elongated Slow Close solid plastic seat and cover
- ☐ Supply with stop:

****Source:** IAPMO R&T Labs Test Report No. 109-141486-002, comparing VorMax against conventional under-the-rim-water-dispersal toilets from major retailers.



MEETS THE AMERICANS WITH DISABILITIES ACT GUIDELINES
AND ICC ANSI A117.1 REQUIREMENTS FOR ACCESSIBLE AND
USABLE BUILDING FACILITIES-CHECK LOCAL CODES.

EVERCLEAN[®]
Surface



M-O

1x POWDER ROOM
2x PRINCIPAL ENSUITE

MOEN®

There is more than one version of this model.
Page down to identify the version you have.

DESCRIPTION

- Metal construction with various finishes identified by suffix
- Flexible supply lines with 3/8" compression fittings
- Includes metal pop-up waste assembly
- Includes Red/Blue indicators
- Optional 3 hole deck plate (escutcheon) available

OPERATION

- Lever style handle
- Temperature controlled by 100° arc of handle travel

FLOW

- Water usage is limited to these maximum flow rates as indicated by the corresponding product markings
 - ° 1.2 gpm max (4.5L/min) at 60 psi
 - ° 1.5 gpm max (5.7L/min) at 60 psi

CARTRIDGE

- 1255™ Duralast™ cartridge for Single-Handle Faucets

STANDARDS

- Third party certified to WaterSense,® ASME A112.18.1/CSA B125.1, and all applicable requirements referenced therein
- Certified to NSF 61/9 & 372
- Products marked with 1.2 gpm are compliant with California water efficiency regulations
- Complies with California Proposition 65 and with the Federal Safe Drinking Water Act
- ADA  for lever handle

WARRANTY

- Lifetime limited warranty against leaks, drips and finish defects [Click here to join the meeting](#)
 - 10 year limited warranty when used in a multifamily installation
 - 5 year limited warranty when used in a commercial installation
- Visit www.moen.com/support for complete details and limitations

Specifications



Single-Handle Lavatory Faucet

Model: 6900

NOTE: THIS FAUCET IS DESIGNED TO BE INSTALLED THROUGH 1 HOLE, 1-1/8" MIN. DIA.

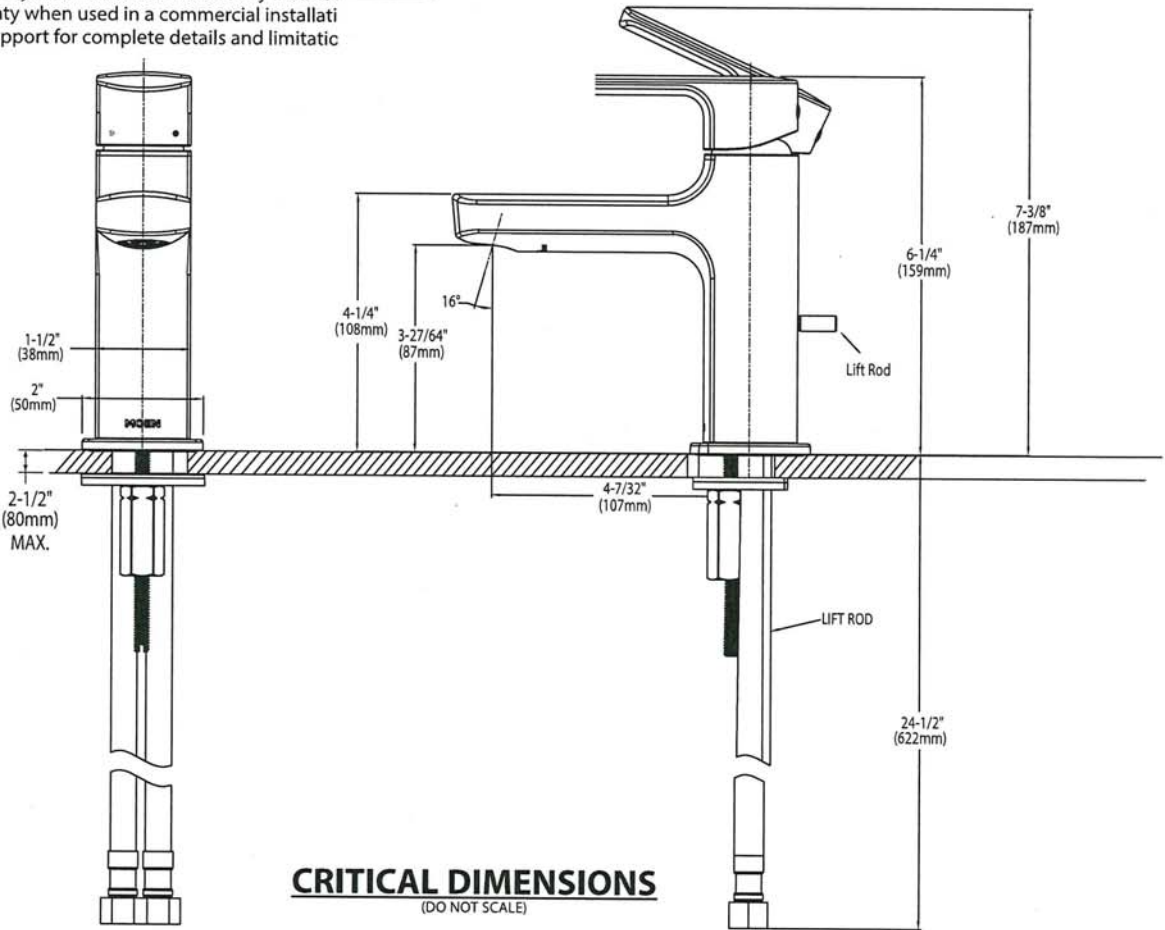

CRITICAL DIMENSIONS
(DO NOT SCALE)

M-O

PRINCIPAL ENSUITE
11" TUB



Buy it for looks. Buy it for life.®

Specifications

DESCRIPTION

- Metal construction with various finishes identified by suffix.
- Includes hot and cold temperature indicator

OPERATION

- Lever style handles
- Rotate hot side handle counterclockwise to open (clockwise to close) and the cold side handle clockwise to open and (counterclockwise to close)

STANDARDS

- Third party certified to CSA B-125.1, ASME A112.18.1, and all applicable requirements referenced therein

- ADA  for lever handles

WARRANTY

- Lifetime limited warranty against leaks, drips and finish defects to the original consumer purchaser
- 5 year warranty if used in commercial installations



RIZON™
Two-Handle Roman Tub Faucet Trim

Models: T935 series

Valves: 4792, 4796, 4798

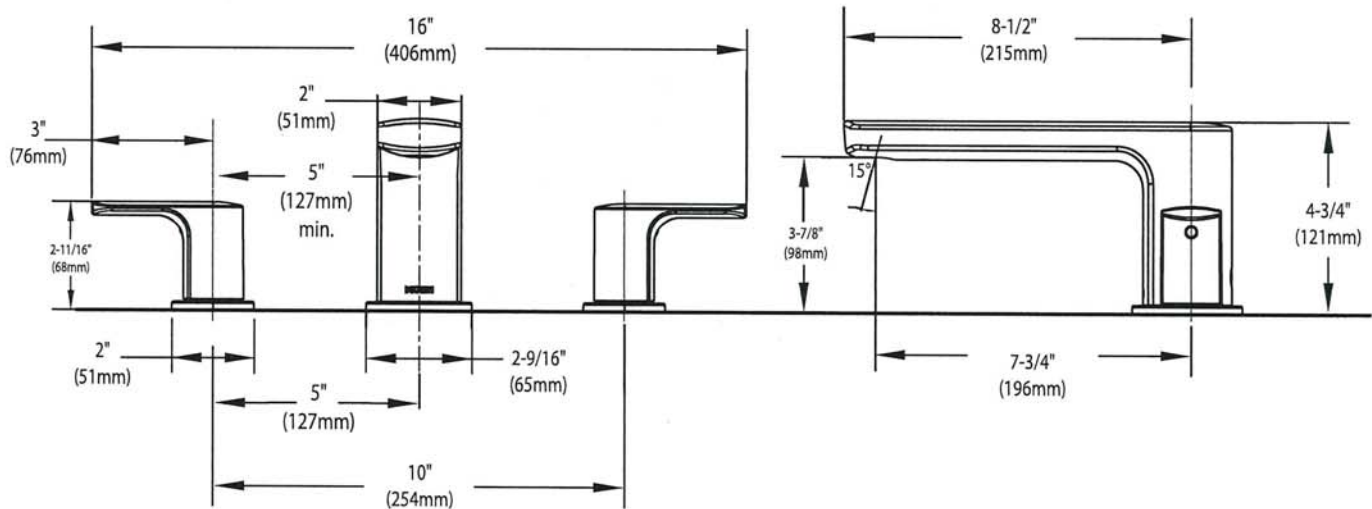

CRITICAL DIMENSIONS

(DO NOT SCALE)

M-0

PRINCIPAL ENSUITE
SHOWER

Rizon™

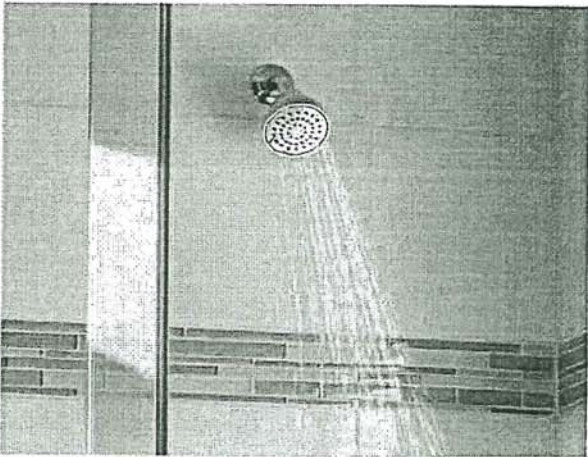

POSI-TEMP®

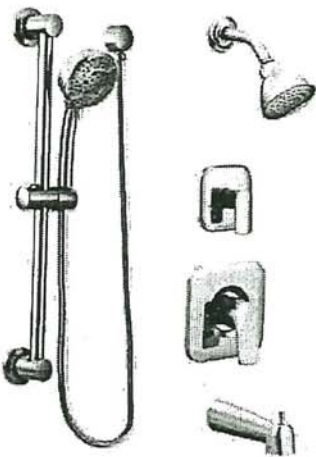

Posi-Temp® Tub/Shower Faucet with
3 Function Transfer Valve/Trim and
Slide Bar with Hand Shower*
T2813EP / U361CI / UT2081 / 62320 /
3669EP / A725



Posi-Temp® Shower Only with 3
Function Transfer Valve/Trim and
Slide Bar with Hand Shower*
T2812EP / U361CI / UT2081 / 62320 /
3669EP / A725
MATTE BLACK

RIZON FINISH OPTIONS | To order, combine the model

MATTE BLACK

M-0

MOEN®

Specifications

 $m - 0$



Buy it for looks. Buy it for life.®

There is more than 1 version of this model.
Page down to identify the version you have.

DESCRIPTION

- Metal construction with various finishes identified by suffix
- Includes non-metallic showerhead, arm, flange and non-metallic diverter tub spout

OPERATION

- Handle operates counterclockwise through a 270° arc with off at 6 o'clock and maximum hot at the 9 o'clock position. Shut off in clockwise direction
- Adjustable temperature limit stop to control maximum hot water temperature
- Pressure balancing mechanism maintains selected discharge temperature to $\pm 3^\circ$

FLOW

- Showerhead is limited to 2.5 gpm (9.5 L/min) at 80 psi
- EP suffix models are limited to 1.75 gpm (6.6 L/min) at 80 psi
- NH suffix models contain no showerhead

CARTRIDGE

- 1222 cartridge design
- Accommodates back to back installations
- Nonmetallic/nonferrous and stainless steel material

STANDARDS

- Third party certified to meet ASME A112.18.1/CSA B125.1 and all applicable requirements referenced therein
- EP suffix models are third party certified to WaterSense®
- ADA  for lever handle

WARRANTY

- Lifetime limited warranty against leaks, drips and finish defects to the original consumer purchaser
- 5 year warranty if used in commercial installations

SHARED BATH

ENSUITE 4

LOWER LEVEL BATHROOMS

Specifications



CHATEAU® POSI-TEMP® Single-Handle Tub/Shower Trim Kit

Models: TL181 series - valve trim only
(Bulk Packed 12 per carton)
TL182 series - shower trim only
(Bulk Packed 12 per carton)
TL183 series - tub/shower trim
(Bulk Packed 12 per carton)

Valves: 62300 series
2500 series

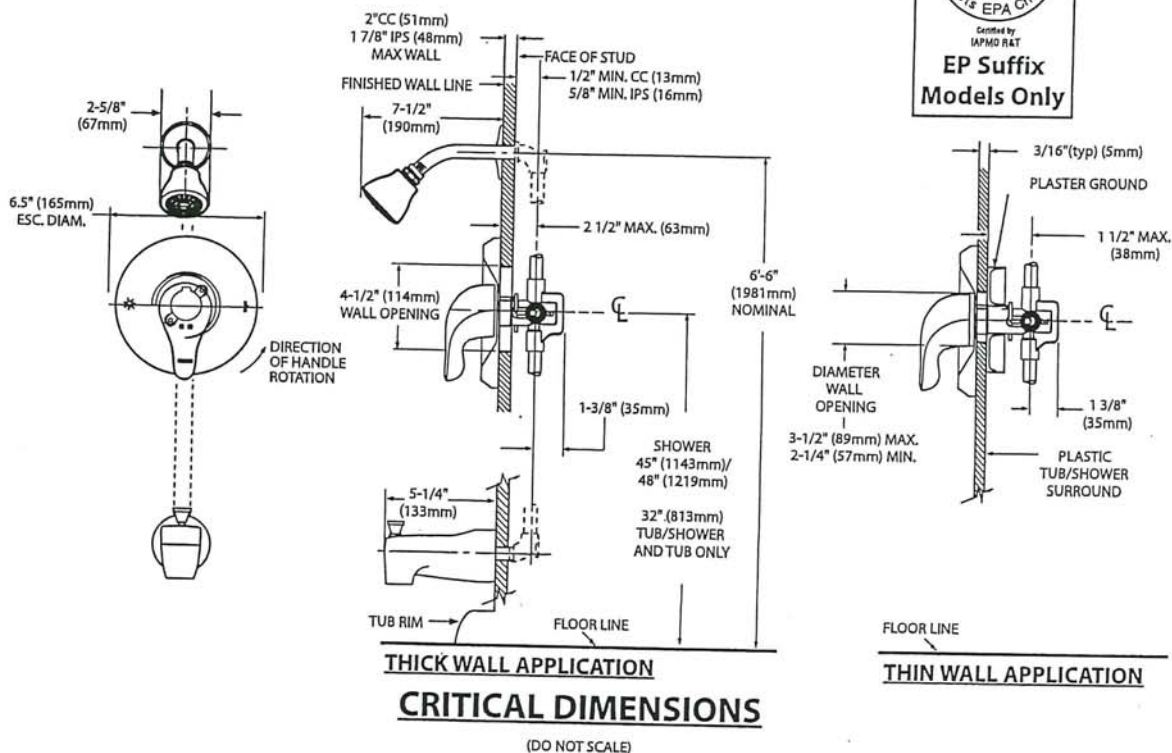

M-O



Home > Major Kitchen Appliances > Hoods & Vents > Wall Mount Hoods and Vents > KVWB600HBS

36"

30" Wall-Mount, 3-Speed Canopy Hood

Model: KVWB600HBS

KVWB606HBS

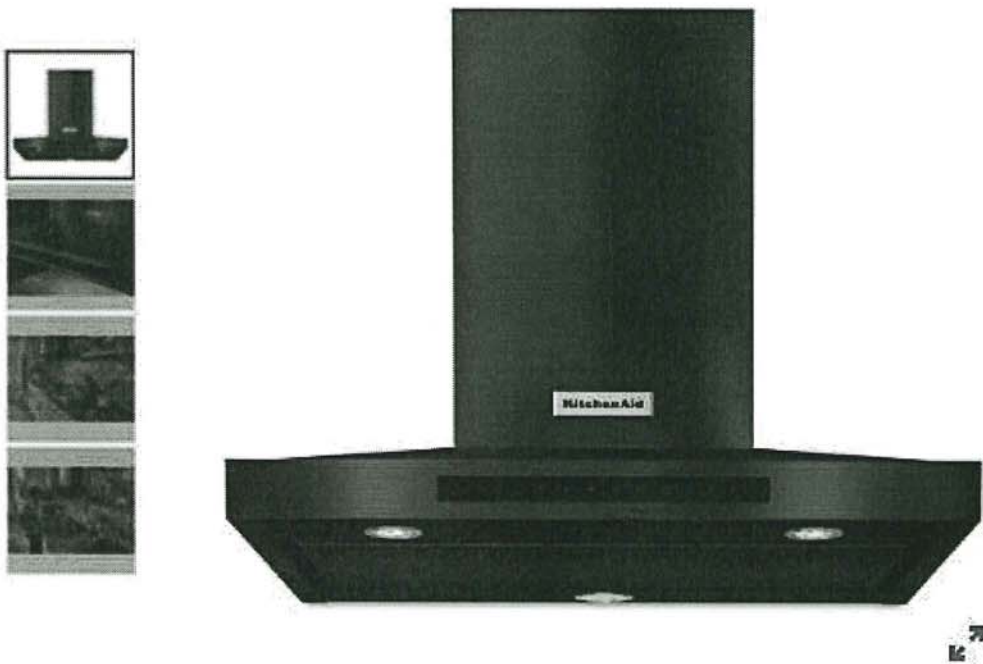

Key Features

- 4-Speed Electronic Glass Touch Control
- Power Boost Function
- Auto Speed Setting
- Automatic Turn On
- Removable Filters

Color

Black Stainless Steel with PrintShield™ Finish ✓



M-O

36"

INSTALLATION REQUIREMENTS

Tools and Parts

Gather the required tools and parts before starting installation. Read and follow the instructions provided with any tools listed here.

Tools Needed

- Level
- Drill with 1¼" (3.0 cm), 3/8" (9.5 mm), and 5/16" (7.9 mm) drill bits
- Pencil
- Wire stripper or utility knife
- Tape measure or ruler
- Pliers
- Caulking gun and weatherproof caulking compound
- Vent clamps
- Jigsaw or keyhole saw
- Flat-blade screwdriver
- Metal snips
- Phillips screwdriver

Parts Needed

- Home power supply cable
- 1/2" (13 mm) UL listed or CSA approved strain relief
- Three UL Listed wire connectors

For Vented Installations, You Will Also Need:

- One wall or roof cap
- Metal vent system

For Non-Vented (Recirculating) Installations, You Will Also Need:

- Recirculation Kit Part Number W10692908 for non-vented (recirculating) installations only. See the "Assistance or Service" section to order.
- 6" (15.2 cm) diameter round metal vent duct—length required is determined by ceiling height.

Parts Supplied

Remove parts from packages. Check that all parts are included.

- Hood canopy assembly with ventilator and LED and halogen lights installed
- Vent transition with back draft dampers installed
- Metal grease filter(s)—depending on model and size
- Vent cover support bracket
- Mounting template
- Two-piece vent cover
- Four 4.2 x 8 screws
- Six 5 x 45 mm mounting screws
- Two D6.4 x 18 mm washers
- Two 8 x 40 mm wall anchors
- Four 10 x 60 mm wall anchors
- Four 5.4 x 75 mm screws (for 10 x 60 mm wall anchors)
- Two 3.5 x 9.5 mm sheet metal screws
- T10® TORX®† adapter

†®TORX and T10® are registered trademarks of Acument Intellectual Properties, LLC.

Location Requirements

IMPORTANT: Observe all governing codes and ordinances. Have a qualified technician install the range hood. It is the installer's responsibility to comply with installation clearances specified on the model/serial/rating plate. The model/serial/rating plate is located behind the left filter on the rear wall of the vent hood.

Canopy hood location should be away from strong draft areas, such as windows, doors and strong heating vents.

Cabinet opening dimensions that are shown must be used. Given dimensions provide minimum clearance.

This range hood is recommended for use with cooktops with a maximum total rating of 65,000 BTUs or less.

Grounded electrical outlet is required. See the "Electrical Requirements" section.

The canopy hood is factory-set for venting through the roof or wall. For non-vented (recirculating) installation see "For nonvented (recirculating) installation only" in the "Connect Vent System" section. Recirculation Kit Part Number W10692908 is available from your dealer or an authorized parts distributor.

All openings in ceiling and wall where canopy hood will be installed must be sealed.

For Mobile Home Installations

The installation of this range hood must conform to the Manufactured Home Construction Safety Standards, Title 24 CFR, Part 328 (formerly the Federal Standard for Mobile Home Construction and Safety, Title 24, HUD, Part 280) or when such standard is not applicable, the standard for Manufactured Home Installation 1982 (Manufactured Home Sites, Communities and Setups) ANSI A225.1/NFPA 501A, or latest edition, or with local codes.

Product Dimensions

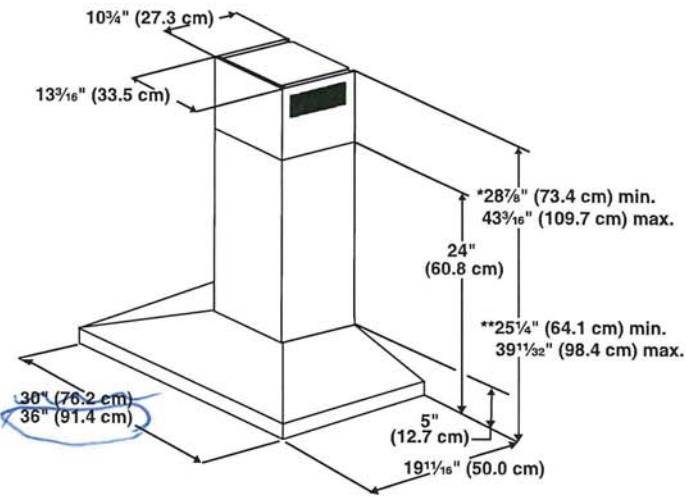

*For non-vented (recirculating) installations

**For vented installations

M.O

36"

Cabinet Dimensions

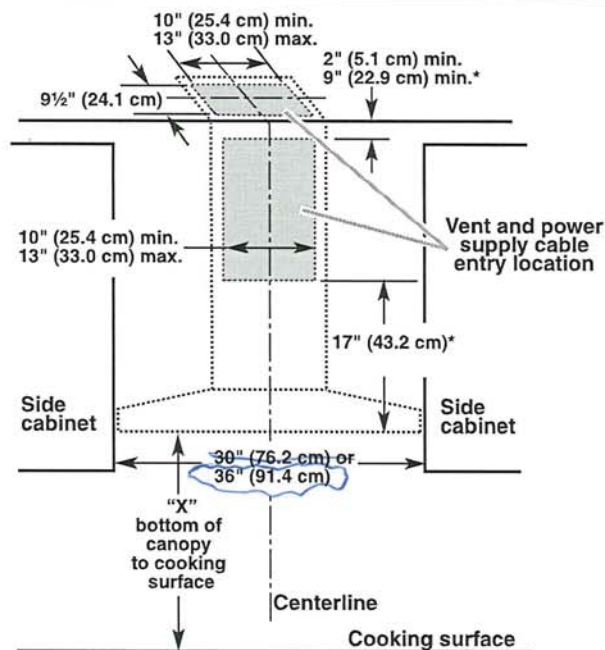

*For non-vented (recirculating) installations

IMPORTANT:

Minimum distance "X": 24" (61.0 cm) from electric cooking surface.

Minimum distance "X": 27" (68.6 cm) from gas cooking surfaces.

Suggested maximum distance "X": 36" (91.4 cm)

The chimneys can be adjusted for different ceiling heights. See the following chart.

Vented Installations		
	Min. ceiling height	Max. ceiling height
Electric cooking surface	7' 1" (2.16 m)	9' 3" (2.82 m)
Gas cooking surface	7' 4" (2.23 m)	9' 3" (2.82 m)

Non-vented (recirculating) Installations		
	Min. ceiling height	Max. ceiling height
Electric cooking surface	7' 5" (2.23 m)	9' 7" (2.9 m)
Gas cooking surface	7' 8" (2.33 m)	9' 7" (2.9 m)

NOTE: The range hood chimneys are adjustable and designed to meet varying ceiling or soffit heights depending on the distance "X" between the bottom of the range hood and the cooking surface. For higher ceilings, a Chimney Extension Kit is available from your dealer or an authorized parts distributor. The chimney extension replaces the chimney shipped with the range hood. To order, see the "Assistance or Service" section.

Venting Requirements
(Vented Models Only)

- Vent system must terminate to the outdoors except for non-vented (recirculating) installations.
- Do not terminate the vent system in an attic or other enclosed area.
- Do not use 4" (10.2 cm) laundry-type wall caps.
- Use metal vent only. Rigid metal vent is recommended. Plastic or metal foil vent is not recommended.
- The length of vent system and number of elbows should be kept to a minimum to provide efficient performance.

For the Most Efficient and Quiet Operation:

- Use no more than three 90° elbows.
- Make sure there is a minimum of 24" (61.0 cm) of straight vent between the elbows if more than one elbow is used.
- Do not install two elbows together.
- Use clamps to seal all joints in the vent system.
- The vent system must have a damper. If the roof or wall cap has a damper, do not use the damper supplied with the range hood.
- Use caulking to seal exterior wall or roof opening around the cap.
- The size of the vent should be uniform.

Cold Weather Installations

An additional back draft damper should be installed to minimize backward cold air flow and a thermal break should be installed to minimize conduction of outside temperatures as part of the vent system. The damper should be on the cold air side of the thermal break.

The break should be as close as possible to where the vent system enters the heated portion of the house.

Makeup Air

Local building codes may require the use of makeup air systems when using ventilation systems greater than specified CFM of air movement. The specified CFM varies from locale to locale. Consult your HVAC professional for specific requirements in your area.

Venting Methods

This canopy range hood is factory set for venting through the roof or through the wall.

A 6" (15.2 cm) round vent system is needed for installation (not included). The hood exhaust opening is 6" (15.2 cm) round.

NOTE: Flexible vent is not recommended. Flexible vent creates back pressure and air turbulence that greatly reduce performance.

Vent system can terminate either through the roof or wall. To vent through a wall, a 90° elbow is needed.

Rear Discharge

A 90° elbow may be installed immediately above the hood.

M.O

36"

For Non-Vented (Recirculating) Installations

If it is not possible to vent cooking fumes and vapors to the outside, the hood can be used in the non-vented (recirculating) version using a Recirculation Kit (which includes charcoal filters and a deflector). To order, see the "Assistance or Service" section.

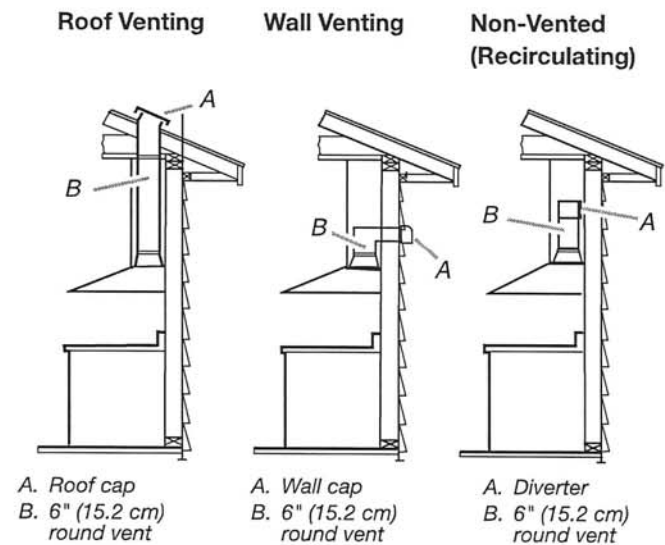

Calculating Vent System Length

To calculate the length of the system you need, add the equivalent feet (meters) for each vent piece used in the system.

Vent Piece	6" (15.2 cm) Round
45° elbow	2.5 ft (0.8 m)
90° elbow	5.0 ft (1.5 m)

Maximum equivalent vent length is 35 ft (10.7 m).

Example Vent System

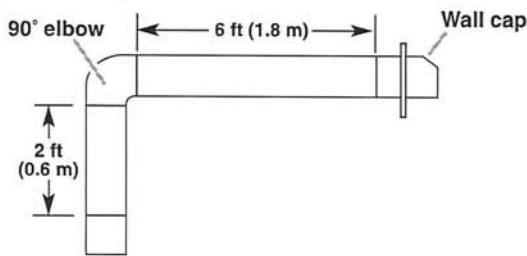

The following example falls within the maximum recommended vent length of 35 ft (10.7 m).

1 - 90° elbow	= 5.0 ft (1.5 m)
1 - wall cap	= 0.0 ft (0.0 m)
8 ft (2.4 m) straight	= 8.0 ft (2.4 m)
Length of system	= 13.0 ft (3.9 m)

Electrical Requirements

Observe all governing codes and ordinances.
Ensure that the electrical installation is adequate and in conformance with National Electrical Code, ANSI/NFPA 70 (latest edition), or CSA Standards C22.1-94, Canadian Electrical Code, Part 1 and C22.2 No. 0-M91 (latest edition) and all local codes and ordinances.

If codes permit and a separate ground wire is used, it is recommended that a qualified electrician determine that the ground path is adequate.
A copy of the above code standards can be obtained from:

National Fire Protection Association
1 Batterymarch Park
Quincy, MA 02169-7471
CSA International
8501 East Pleasant Valley Road
Cleveland, OH 44131-5575

- A 120 V, 60 Hz, AC only, 15-amp, fused electrical circuit is required.
- If the house has aluminum wiring, follow the procedure below:
Connect the aluminum wiring using special connectors and/or tools designed and UL listed for joining copper to aluminum.
Follow the electrical connector manufacturer's recommended procedure. Aluminum/copper connection must conform with local codes and industry accepted wiring practices.
- Wire sizes and connections must conform with the rating of the appliance as specified on the model/serial/rating plate. The model/serial/rating plate is located behind the left filter on the rear wall of the range hood.
- Wire sizes must conform to the requirements of the National Electrical Code, ANSI/NFPA 70 (latest edition), or CSA Standards C22. 1-94, Canadian Electrical Code, Part 1 and C22.2 No. 0-M91 (latest edition) and all local codes and ordinances.

HOME APPLIANCES

LG REFRIGERATION

LRYXC2606

26 cu. ft. Counter Depth MAX Refrigerator

- Industry's Largest 26 cu. ft. Counter Depth Capacity
- Bucket Handle Design with Welcome Light
- Industry's First 3 Built-in Ice maker
- Market First 4 Types of Ice
- Cool Guard™ with Premium Backlit Lighting

Call before 18th Oct to family pricing.

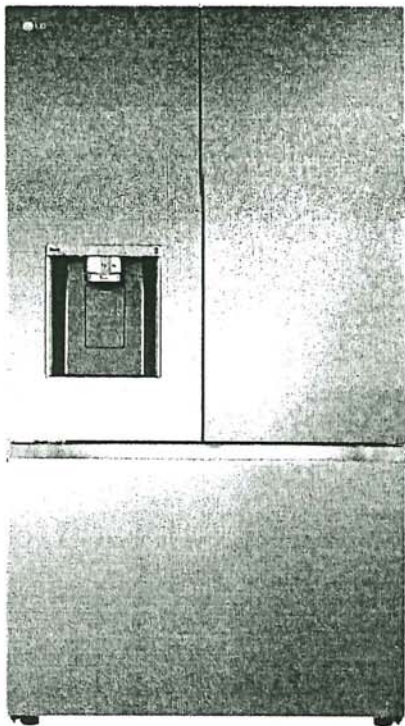

AVAILABLE COLORS



ThinQ Care

Proactive Smart Alerts to Keep Your Appliances Running Smoothly

- Preventative Alerts help you stay a step ahead of potential issues to find proactive solutions before problems arise.
- Avoid preventable repairs and service calls with real-time diagnostics for a hassle-free experience.
- Integrated within LG's ThinQ app—a smart home hub for managing your smart devices and appliances.

CAPACITY		REFRIGERATOR		DIMENSIONS/CLEARANCES/WEIGHTS	
Refrigerator (cu. ft.)	16.9 cu. ft.	No. of Shelves	4 split (3 Fixed + 1 Retractable)	Product (W x H x D)	35 3/4" x 70 1/4" x 31 5/8"
Freezer (cu. ft.)	8.6 cu. ft.	Shelf Construction	Spill Protector/Tempered Glass	Width	35 3/4"
Total Capacity (cu. ft.)	25.5 cu. ft.	Shelf Trim	Metallic Décor	Height (to Top of Hinge)	70 1/4"
ENERGY		No. of Crisper Bins	2	Depth (with Handles)	29 1/8"
ENERGY STAR® Qualified	Yes	Pantry (Glide N Serve)	Yes (Temp. Control)	Width (Door Open 90° without Handle)	40"
Energy Consumption (kWh/Year)	699	CoolGuard™	Yes	Width (Door Open 90° with Handle)	44 7/8"
WATER & ICE SYSTEM		Fresh Air Filter	Yes	Width (Door Fully Open without Handle)	56 3/4"
Ice & Water Dispenser	Yes	Light	Yes	Height (to Top of Case)	68 7/8"
Water Dispenser (l/min)	Yes	Light (Back lit lighting)	Yes	Depth without Door	24 3/4"
In-door ice maker	Yes (1)	REFRIGERATOR DOOR		Depth without Handles	29 1/8"
In-door ice maker Ice Type	Cubed / Crushed	No. of Bins	4 (Left Door), 4 (Right Door)	Depth (to Hinge Cover)	18 1/4"
In-door ice maker Daily Production	3.0 / 3.3 (IcePlus) lbs.	Door Shape	Flat	Depth (Total with Door Open)	43 5/8"
In-door ice maker Storage Capacity	3.0 lbs.	Handle Type	Pocket	Depth (Draw Open Fully without Handle)	48 7/8"
Ice Dispenser Ice Maker	Yes (2)	Handle Light	Yes	Installation Clearance	Sides 1/8", Top 1", Back 2"
Freezer ice maker Ice Type	Craft & Mini Cubed	FREEZER		Carton Dimensions (WxHxD)	38" x 72" x 31"
Freezer ice maker Daily Production	3 or 6 ea & 1.5 / 1.7 (IcePlus) lbs.	Door Type	Pull Drawer	Weight (Unit/Carton)	291 lbs. / 313 lbs.
Freezer ice maker Storage Capacity	2 / ea / 4.0 lbs.	Handle Type	Smart Pull™ Handle	LIMITED WARRANTY	
Ice Bin	Yes	Drawers / Shelves	3-Tier Organization	Parts & Labor	1 Year
Electronic System	1 stage	Freezer Light	LED Lighting	Sealed System (Parts & Labor)	5 Years
Filter	111000P	Upper	No	Compressor (Parts & Labor)	5 Years
Dispenser Light Decoration	Yes	Lower	No	Linear Compressor (Parts & Labor)	6 - 10 Years
COOLING		SMART TECHNOLOGY		UPC CODES	
Compressor Type	Smart Inverter	Smart Diagnosis	Yes	LRYXC2606S (PrintProof™ Stainless Steel)	195174037690
Evaporator	Yes (1)	Wi-Fi	Yes	LRYXC2606D (PrintProof™ Black Stainless Steel)	195174037706
Multi Air Flow Cooling	Yes	ThinQ®	Yes		
Temperature Sensors	3	ThinQ® Care	Yes		
Refrigerant	Low GWP, Zero ODP and More Energy Efficient Refrigerant (R600a / 57g / 2.01oz)	MATERIALS AND FINISHES			
CONVENIENCE		Hidden Hinges	Yes		
Display Type	Smooth Touch Control / White LED	All Available Colors	PrintProof™ Stainless Steel, PrintProof™ Black Stainless Steel		
Temperature Controls	Electronic/Digital	Insulation	Low GWP and Zero ODP Blowing Agent		
Ice Maker	Yes				
Quick Cool	Yes				
Anti-Closing Door Hinge	Yes				
Self-Clean Mode	Yes				
ADA Compliant	Yes				

Prepared by
Joshua Dasilva
jdasilva@taappllance.com



Kitchenaid® 36-Inch 5-Element Sensor Induction Cooktop

KCIG556JBL

Available Finishes/Colours

 KCIG556JSS Stainless Steel	 KCIG556JBL Black
---	---



Dimensions		Electrical	
Depth	21.31	208v Compatible	Yes
Height	2.31		
Width	35.56		

Controls		Features	
Control Location	Front	Digital Display	Yes
Control Type	Manual	Griddle	N/A
		Heating Element On Indicator Light	Yes
		Hot Surface Indicator Light	Yes

Specifications			
Country Of Origin	USA	LP Convertible	No
Optional Accessories	W11463464	Power Outage Compatible	No
		Automatic Pan Detection	Yes
		Automatic Pan Size Adjustment	Yes

Electrical	
Amps	40
Power Cord Included	Yes
Volts	240
Hz	60
Watts	11,880

Level up everyday cooking adventures with the speed and precision of this 36 KitchenAid® Sensor Induction Cooktop. Sensor Induction Technology generates heat directly within cookware, reaching high temperatures quickly and cooling down rapidly for precise control that enables a full range of cooking techniques.

- Top Features
- Sensor Induction Technology

Auto Presets for Melt, Simmer, Keep Warm and Boil

Assisted Cooking Modes for Boil, Fry and Grill

Manuals & Literature:

[Dimension Guide](#)

[Installation Guide](#)

[Owner Manual](#)

[Warranty Information](#)

M-0

DIMENSIONS

1 of 21

INDUCTION COOKTOP
PRODUCT DIMENSIONS

MODEL #	30" Cooktop KCIG550JBL/SS KCIG950JBL/SS		36" Cooktop KCIG556JBL/SS KCIG956JBL/SS	
	in	cm	in	cm
Overall Width with Frame (A)	31 ³ / ₁₆	79.2	36 ¹¹ / ₁₆	93.2
Depth with Frame (B)	21 ²³ / ₃₂	55.1	21 ²³ / ₃₂	55.1
Overall Width without Frame (C)	30 ³ / ₄	78.2	36 ⁵ / ₁₆	92.2
Depth without Frame (D)	21 ¹ / ₄	54.1	21 ⁵ / ₁₆	54.1

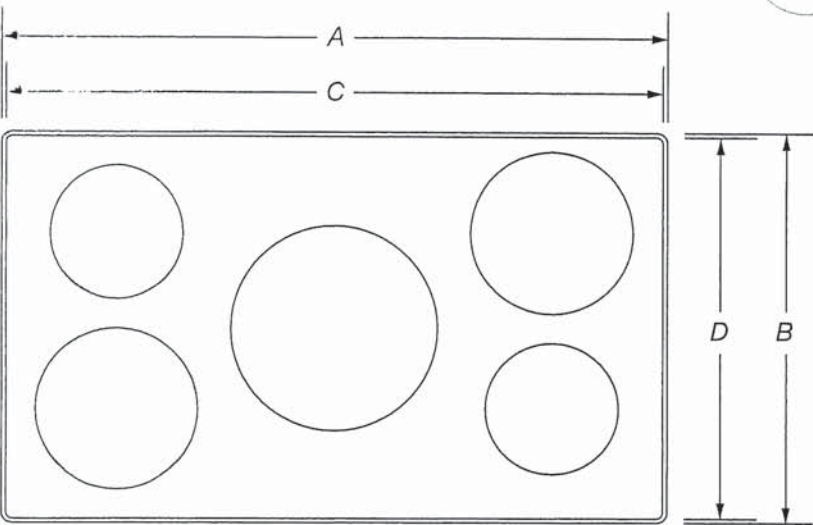

TOP VIEW

IMPORTANT: Dimensional specifications are provided for planning purposes only.
Do not make any cutouts based on this information. Refer to the Installation Guide before selecting cabinetry, verifying electrical/gas connections, making cutouts or beginning installation.
All KitchenAid® appliances are appropriately UL, CUL or CSA approved.

MO

DIMENSIONS

2 of 21

INDUCTION COOKTOP
PRODUCT DIMENSIONS

MODEL #	30" Cooktop KCIG550JBL/SS KCIG950JBL/SS		36" Cooktop KCIG556JBL/SS KCIG956JBL/SS	
	in	cm	in	cm
Glass Width (E)*	30 ³⁵ / ₃₂	78.2	36 ⁵ / ₁₆	92.2
Electric Inlet to Surface (F)	3 ²⁹ / ₃₂	9.9	3 ²⁹ / ₃₂	9.9
Center to Electric Inlet (G)	13 ³ / ₃₂	33.2	13 ²⁵ / ₃₂	35.0
Recessed Cooktop Width (H)	29 ¹¹ / ₃₂	74.5	35 ⁵ / ₁₆	89.7

*Includes width of grates and griddle.

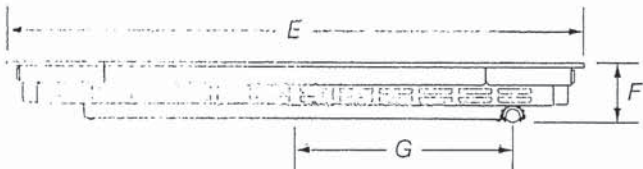

FRONT VIEW

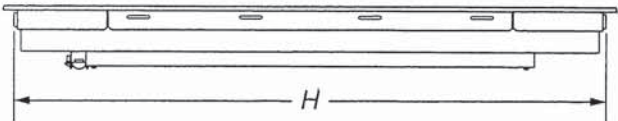

BACK VIEW

DISCLAIMER: Dimensional specifications are provided for planning purposes only.
Do not make any cutouts based on this information. Refer to the Installation Guide before
installing cabinetry, verifying electrical/gas connections, making cutouts or beginning installation.
All KitchenAid® appliances are appropriately UL, CUL or CSA approved.

M-0

Prepared by
Joshua Dasilva
jdasilva@taappliance.com

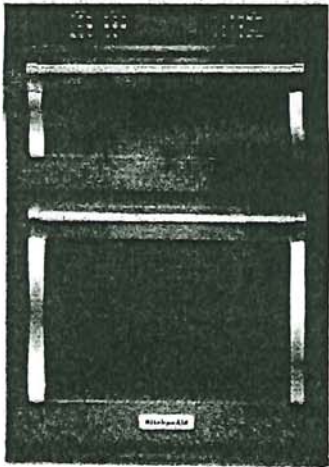

This 30 Combination Wall Oven with Even-Heat™ True Convection provides consistent heating and even cooking. A unique how-tie shaped design and convection fan helps ensure there are no burnt edges or undercooked centers. Its upper Microwave Convection Cooking Oven combines a 900 watt microwave with a 1200 watt convection element for high speed cooking. Bold design details are the perfect balance of elegance and functionality.

- Top Features
- Even-Heat™ True Convection Oven (Lower Oven)
- Microwave Convection Cooking (upper oven)
- Temperature Probe

- Manuals & Literature:
- Dimension Guide

Installation Guide

Owner Manual

Warranty Information

Kitchenaid® 30 Combination Wall Oven with Even-Heat™ True Convection (Lower Oven)

KOCE500EBS

Available Finishes/Colours

- KOCE500EBL

Black
- KOCE500ESS

Stainless Steel
- KOCE500EBS

Black Stainless Steel with PrintShield™ Finish
- KOCE500EWH

White

Dimensions		Specifications	
Depth	27.13	Country Of Origin	USA
Height	42.5	Optional Accessories	W11173704
Width	30.0	Sabbath Mode	Yes
Microwave Details		Electrical	
Cooking Power Watts	900	Amps	40 ✓
Convection	Yes	Power Cord Included	No
Convection Power Watts	1200	Volts	240 ✓
Grill	Yes	Hz	60
Grill Power Watts	1600	Exterior	
Interior Light	Yes, Halogen	Handle Color	Stainless Steel
Turntable	Yes	Handle Material	Metal
Turntable Diameter Size In	14.13	Configuration and Overview	
Door Swing	Drop Down	Fuel Type	Electric
Microwave Capacity Cu Ft	1.4	Configuration	
Controls		Oven Configuration	Microwave Combination
Control Type	Electronic	Details	
Display Color	White	Bake Element Power	2800W

M-0

HOME APPLIANCES

LG LAUNDRY

WM6700HBA

5.0 cu. ft. Mega Capacity Smart Front Load Washer with TurboWash™ 360° and AI Built-in Intelligence

- 5.0 cu. ft. Mega Capacity
- LED Display and Dial A Cycle™ Knob with Touch Buttons
- ezDispense™ Automatic Dispenser
- TurboWash™ 360° Technology
- AI Fabric & Soil Level Sensors & Smart Pairing™
- LG ThinQ™ Technology with ThinQ Care
- AAFA Certified with Allergiene™ Cycle
- ColdWash™ Technology
- NeveRust™ Stainless Steel Drum
- ENERGY STAR® Certified
- Direct Drive Motor 10-Year Limited Warranty

AVAILABLE COLORS

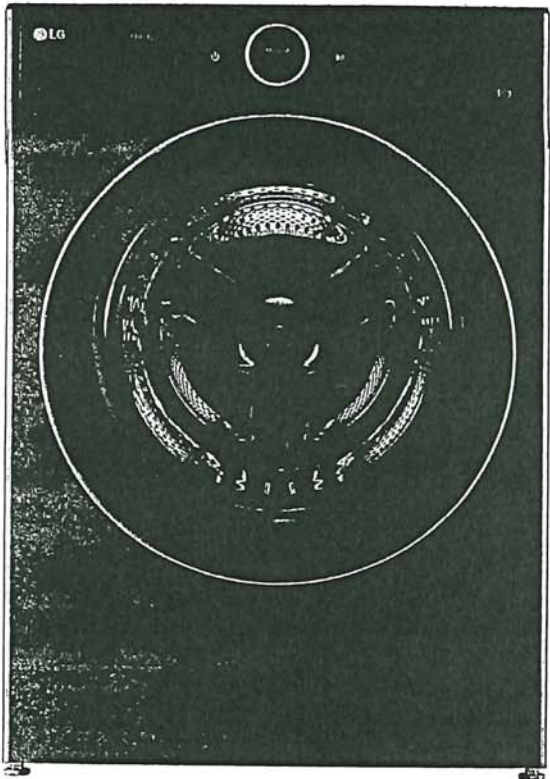

ThinQ Care

Proactive Smart Alerts to Keep Your Appliances Running Smoothly

- Preventative Alerts help you stay a step ahead of potential issues to find proactive solutions before problems arise.
- Avoid preventable repairs and service calls with real-time diagnostics for a hassle-free experience.
- Integrated within LG's ThinQ app - a smart home hub for managing your smart devices and appliances.

SUMMARY

Type	Front Load Washer
Capacity (cu. ft.)	5.0 cu. ft.
Matching Electric Dryer	HE1 (Electric)
Matching Gas Dryer	DLGX6701B
Color	Black Steel (B)

APPEARANCE

LED Display	Yes
Touch Buttons	Yes
Door A Cycle™ Knob	Yes

ENERGY

ENERGY STAR® Listed (Efficient)	Yes
ENERGY STAR® Certified	Yes
AI DD™	Advanced

WASH PROGRAMS

Wash Programs	24
Wash Programs	Normal, AI Wash, Bedding, Delicates, Towels, Quick Wash, Heavy Duty, Allergiene™, Perm. Press, Tub Clean, Bright Whites™, Sanitary, Rinse + Spin, Spin Only, Hand/Wool, Active Wear, Swimwear, Kids Wear, Jeans, Dresses, Color Care, Sweat Stains, Small Load, Large Load, X Large Load
Wash Programs	15
Wash Programs	ThinQ Wash™, Steam, Fresh Care, Pre-Wash, Remote Start, Delay Wash, Wi-Fi, Add Item, Extra Rinse, Control Lock, Drum Light, Cold Wash, Spin Only, Detergent Level, Softener Level, Signal, Cycle List Edit, Cycle Optimization, Softener Tank Use

WASH DETAILS

No. of Wash/Rinse Temps	5
Wash/Rinse Temps	Extra Hot, Hot, Warm, Cold, Tap Cold
No. of Spin Speeds	5

Spin Speeds	Extra High, High, Medium, Low, No Spin
Max RPM	1300
Water Levels	Load Sensing
No. of Soil Levels	5

FABRIC CARE FEATURES

AI DD™	Yes
TurboWash™ 360 Technology	Yes
Steam Technology	Yes
Allergiene™ Cycle	Yes
Sanitary Cycle	Yes
ColdWash™ Option	Yes
Soil Level Sensor	Yes

CONVENIENCE FEATURES

Vibration sensing (Cabinet Vibration Sensor)	Yes
TrueBalance™ Anti-Vibration System	Yes
4 Tray Dispenser	Yes
End of Cycle Signal	Yes
LoadSense	Yes
Control Lock	Yes
Auto Suds Removal	Yes
Leveling Legs	4 Adjustable Legs
Drumlight	Yes

THINQ™ TECHNOLOGY

ThinQ Care	Yes
SmartDiagnosis™ (v3.0)	Yes
Wi-Fi	Yes
Energy Monitoring	Yes
Tub Clean Coach	Yes

MOTOR AND AGITATOR

Motor Type	Inverter Direct Drive Motor
Axis	Horizontal

MATERIALS AND FINISHES

NeverRust™ Stainless Steel Drum	Yes
Cabinet	Painted Steel
Control Panel	Painted Steel
Top Plate	Painted Steel
Door / Rim	Glass / Chrome
Door Cover	Tempered Glass Door
All Available Colors	Black Steel (B)

CERTIFICATION

AAFA	Yes
------	-----

POWER SOURCE

Ratings	UL Listed
Electrical Requirements	120V, 10 Amps
Type	Electric

OPTIONS/ACCESSORIES

Pedestal	WDP6B
Pedestal (WxHxD)	27" x 13 5/8" x 28" (43 7/8" D with door open)
LG Sidekick™ Pedestal Washer	WD300CB
LG Sidekick™ Pedestal Washer (WxHxD)	27" x 14 1/8" x 30 3/4" (50 1/2" D with drawer open)
Stacking Kit	KSTK1
DIMENSIONS	
Product (WxHxD)	27" x 39" x 33 1/4"
Depth with Door Open	(55" D with door open)
Carton (WxHxD)	29 3/4" x 43 1/8" x 33 7/8"
Weight (Product/Carton)	209.5 / 222.7 lbs.

LIMITED WARRANTY

Parts and Labor	1 Year
Direct Drive Motor	10 Years
Drum	3 Years

UPC CODES

WM6700HBA (Black Steel)	195174037058
-------------------------	--------------

M-0

HOME APPLIANCES

LG LAUNDRY

DLEX6700B / DLGX6701B

7.4 cu. ft. Ultra Large Capacity Smart Front Load
Dryer with TurboSteam™ and AI Sensor Dry™

- 7.4 cu. ft. Ultra Large Capacity
- LCD Display and Dial-A Cycle™ Knob with Touch Buttons
- TurboSteam™ Technology
- AI Fabric Sensor & Smart Pairing™
- LG ThinQ™ Technology with ThinQ Care
- Wrinkle Care Option
- Reversible Door
- Sensor Dry System
- FlowSense™ Duct Clogging Indicator
- NeveRust™ Stainless Steel Drum
- Tempered Glass Door
- ENERGY STAR™ Certified

AVAILABLE COLORS

 Black



ThinQ Care

Proactive Smart Alerts to Keep Your Appliances Running Smoothly

- Proactive Alerts help you stay a step ahead of potential issues to find proactive solutions before problems arise.
- Avoid preventable repairs and service calls with real-time diagnostics for a hassle-free experience.
- Integrated within LG's ThinQ app—a smart home hub for managing your smart devices and appliances.

SUMMARY		FABRIC CARE FEATURES	
Model	Front Load Dryer	AI Sensor Dry™	Yes
Vent Type	Vented	Sensor Dry	Yes
Dryer Type	Electric / DLEX6700B Gas / DLGX6701B	Precise Temperature Control with Variable Heater	Yes
Capacity	7.4 cu. ft.	Steam	TurboSteam™
Matching Washer	WM6700HBA	CONVENIENCE FEATURES	
Smart Dry	Yes	3 Minute Installation Check	Yes
Steam	Yes	End of Cycle Signal	Yes
Color	Black Steel (B)	Drum Light (Door Open)	Yes
APPEARANCE		Reversible Door	Yes
Refrigerator	Yes	FlowSense™ Duct Clogging Indicator	Yes
Washer	Yes	Wrinkle Care Option	Yes
Washing Machine	Yes	Control Lock	Yes
DRYER PROGRAMS		Venting Option	Electric: 4 Way Venting / Gas: 3 Way Venting
Standard Dry Programs	73	4 Adjustable Legs	Yes
	Normal, All Dry, Bedding, Delicates, Towels, Quick Dry, Timed Dry, Antibacterial, Perm. Press, SteamFresh™, Heavy Duty, Air Dry, Steam Sanitary™, Super Dry, Active Wear, Jeans, Blanket Refresh, Low Temp Dry, Overnight Dry, Easy Ironing, Small Load, Large Load Dry, X Large Load Dry	Remaining Time Display / Status Indicator(s)	Yes
Programs (Sensor Dry)		ThinQ™ TECHNOLOGY	
Auto Cycle Sense	11	ThinQ Care	Yes
	Cycle Optimization, Damp Dry Signal, Wrinkle Care, Control Lock, Wi-Fi, Energy Saver, TurboSteam™, Reduce Static, Remote Start, Drum Light, Signal High, Med. High, Medium, Low, Ultra Low	SmartDiagnosis™ (v3.0)	Yes
Options		Wi-Fi	Yes
Drum	Very Dry, More Dry, Normal Dry, Less Dry, Damp Dry	Remote Start and Cycle Monitor	Yes
Drying Times	10 min - 100 min (Every 10 min)	Energy Monitoring	Yes

POWER SOURCE	
Ratings	CSA Listed
Electrical Requirements	Electric: 240V, 30 Amps / Gas: 120V, 15 Amps
Type	Electric, Gas
BTU Rating	Gas: 20,000
OPTIONS	
LP Conversion Kit	383EEL3002D
Side Venting Kit	3911EZ9131X
Drying Rack	3750EL1001A
Pedestal	WDP6B
Pedestal (WxHxD)	27" x 13 5/8" x 28" (43 7/8" D with door open)
DIMENSIONS	
Product (WxHxD)	27" x 39" x 30 1/8"
Depth with Door Open	51 3/8"
Carton (WxHxD)	29 5/8" x 43 5/16" x 31 9/16"
Product Weight (lbs.)	Electric: 123.7 lbs. / Gas: 134 lbs.
Carton Weight (lbs.)	Electric: 135.1 lbs. / Gas: 145.7 lbs.
LIMITED WARRANTY	
Parts & Labor	1 Year
Drum	3 Years
UPC CODES	
DLEX6700B (Black Steel)	195174036976
DLGX6701B (Black Steel)	195174036983