

Sales Selection Sheet
Checklist

1 of 28

LOT 3191A-5 Model: 20-1606 B The Grassfield

PURCHASERS: JINGXUAN YU/XI LIU

VENDOR: Heathwood Homes (Huron) Limited

DECK LOT

- ☒ FINISHED BASEMENT
☐ COLD CELLAR

UPGRADED / MODIFIED ELEVATION

- ☐ CORNER UPGRADE
☐ REAR UPGRADE

CEILING UPGRADE - SMOOTH

- ☐ MAIN FLOOR
☐ SECOND FLOOR
☐ BASEMENT

ADDITIONAL ROUGH-INS

- ☐ 200 AMP SERVICE
☐ WET BAR ROUGH-IN
☐ HUMIDIFIER
☒ AIR CONDITIONING

GAS ROUGH-IN

- ☐ STOVE
☐ DRYER
☐ BBQ
☐ ADDITIONAL FIREPLACE

KITCHEN: HOODFAN VENTING SIZE

- ☐ 6 IN ROUND DUCT
☒ 7 IN ROUND DUCT

FULL BASEMENT STAIRS:	N/A
UPPER BASEMENT STAIRS:	All Oak
LOWER BASEMENT STAIRS:	Carpet Grade
MAIN STAIRS:	All Oak
MEDIA STAIRS (if applicable):	N/A
LOFT STAIRS (if applicable):	N/A

May 3/23
Date
Signature
Purchaser:
on file

May 3/23
Date
BRENDA LUKER
Decor Consultant:

Date
Purchaser:

-05-03-2023
Date
Approved
Heathwood Homes (Huron) Limited

Locked Date:

Customer Colours

JINGXUAN YU/XI LIU
Project: Wallace-ton
Unit: 3191A-5, Phase: 3
Model: 20-1606 B The Grassfield

Kitchen

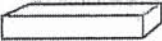
Cabinet Colour/Style	6265	Viking III-MANCHESTER-SHALE GREY CL-MAPLE ***STD***
Countertop	9069	MSI Quartz GROUP 1 ICED WHITE ***STD***
Countertop Edge	4010	SINGLE POLISHED STRAIGHT EDGE 3/4 INCH ***STD*** 
Cabinet Hardware	7669	169-HARDWARE ***STD***
Island Cabinet Colour/Style	6265	Viking III-MANCHESTER-SHALE GREY CL-MAPLE ***STD***
Island Countertop	9069	MSI Quartz GROUP 1 ICED WHITE ***STD***
Backsplash	1111	N/A *****
Backsplash Grout	1111	N/A *****
Backsplash Tile Pattern	1111	N/A *****

HoodFan	34	AV1308 Air King 30 STAINLESS STEEL UNDER CABINET RANGE HOOD **STD**	PG 28
---------	----	---	-------

Comment	
---------	--

Kitchen/Breakfast

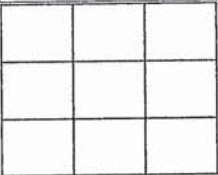
Flooring	9071	GE.BY.AZR.1313 New Byzantine Azzuro 13x13 ***STD***
Floor Tile Grout	7705	Grout-(01) Alabaster ***UPG***
Floor Tile Pattern	3000	STANDARD SQUARE ***STD*** 

Comment	
---------	--

Foyer

5/2/23
7/4

Customer Colours

JINGXUAN YU/XI LIU
Project: Wallaceton
Unit: 3191A-5, Phase: 3
Model: 20-1606 B The Grassfield

3 of 28

227

Create: 3/20/2023 09:08:14

Locked:

Closed:

Flooring	9071	GE.BY.AZR.1313 New Byzantine Azzuro 13x13 ***STD***									
Floor Tile Grout	7705	Grout-(01) Alabaster ***UPG***									
Floor Tile Pattern	3000	STANDARD SQUARE ***STD***									
<table><tr><td></td><td></td><td></td></tr><tr><td></td><td></td><td></td></tr><tr><td></td><td></td><td></td></tr></table>											
Comment											

Laundry Room

Flooring	9071	GE.BY.AZR.1313 New Byzantine Azzuro 13x13 ***STD***									
Floor Tile Grout	7705	Grout-(01) Alabaster ***UPG***									
Floor Tile Pattern	3000	STANDARD SQUARE ***STD***									
<table><tr><td></td><td></td><td></td></tr><tr><td></td><td></td><td></td></tr><tr><td></td><td></td><td></td></tr></table>											
Comment											

Mud Room

Flooring	9071	GE.BY.AZR.1313 New Byzantine Azzuro 13x13 ***STD***									
Floor Tile Grout	7705	Grout-(01) Alabaster ***UPG***									
Floor Tile Pattern	3000	STANDARD SQUARE ***STD***									
<table><tr><td></td><td></td><td></td></tr><tr><td></td><td></td><td></td></tr><tr><td></td><td></td><td></td></tr></table>											
Comment											

Powder Room

Flooring	9071	GE.BY.AZR.1313 New Byzantine Azzuro 13x13 ***STD***
----------	------	---

2/2/23
2/2

Customer Colours

JINGXUAN YU/XI LIU
Project: Wallaceton
Unit: 3191A-5, Phase: 3
Model: 20-1606 B The Grassfield

Locked:
Closed:

Floor Tile Grout	7705	Grout-(01) Alabaster ***UPG***
Floor Tile Pattern	3000	STANDARD SQUARE ***STD*** <div><div></div><div></div><div></div><div></div><div></div><div></div><div></div><div></div><div></div></div>
Plumbing Fixture (Colour)	1737	Plumbing Fixtures-WHITE ***STD***
Comment		

Hall

Flooring	9071	GE.BY.AZR.1313 New Byzantine Azzuro 13x13 ***STD***
Grout	7705	Grout-(01) Alabaster ***UPG***
Floor Tile Pattern	3000	STANDARD SQUARE ***STD*** <div><div></div><div></div><div></div><div></div><div></div><div></div><div></div><div></div><div></div></div>
Comment		

Great Room

Flooring	7498	Red Oak Pearl-Vintage Engineered-GRYPHON/IRONGATE-3/4 inch x 3 1/4 inch
Comment		

Upper Hall

Flooring	9507	DY 89418-MINOTAUR-BLACK ICE-40 oz Poly ***STD***
Comment		

Finished Basement (Rec) Room/Hall

Flooring	9507	DY 89418-MINOTAUR-BLACK ICE-40 oz Poly ***STD***
Comment		

2/23
7/4

Customer Colours

JINGXUAN YU/XI LIU
Project: Wallaceton
Unit: 3191A-5, Phase: 3
Model: 20-1606 B The Grassfield

5 of 28

527

Created: 3/20/2023 09:08:14

Locked:

Closed:

Master Bedroom

Flooring

9507

DY 89418-MINOTAUR-BLACK ICE-40 oz Poly ***STD***

Comment

Bedroom 2

Flooring

9507

DY 89418-MINOTAUR-BLACK ICE-40 oz Poly ***STD***

Comment

Bedroom 3

Flooring

9507

DY 89418-MINOTAUR-BLACK ICE-40 oz Poly ***STD***

Comment

Master Ensuite

Cabinet Colour/Style

9160

Viking III-MUSKOKA-RAIN CLOUD-3DL ***STD***

Countertop

8822

4924-38-Countertop-WHITE CARRARA-Wilsonart
STD

Countertop Edge

1111

N/A *****

Cabinet Hardware

7669

169-HARDWARE ***STD***

Floor Tile

9071

GE.BY.AZR.1313 New Byzantine Azzuro 13x13 ***STD***

Floor Tile Grout

7705

Grout-(01) Alabaster ***UPG***

Floor Tile Pattern

3000

STANDARD SQUARE ***STD***

Shower Floor Tile

8661

OD.ON.SWT.0202.MT.N-Ontario Series Mosaic-Snow
White Matte-2 x 2 ***STD***

2/2/2023
29

Customer Colours

JINGXUAN YU/XI LIU
Project: Wallaceton
Unit: 3191A-5, Phase: 3
Model: 20-1606 B The Grassfield

6 of 28

027

Created: 3/20/2021 09:08:14

Locked:

Closed:

Shower Floor Tile Grout	2226	Grout-(00) White ***STD***
Shower Floor Tile Pattern	3000	STANDARD SQUARE ***STD*** <div><div></div></div>
Shower Wall Tile	5411	QT.SP.WHT.0810-Splendour-White-8 inch x 10 inch ***STD***
Shower Wall Tile Grout	2226	Grout-(00) White ***STD***
Shower Wall Tile Pattern	3090	VERTICAL STACKED ***STD*** <div><div></div></div>
Shower Jamb(s) and Sill(s)	8923	Shower Jamb / Sill-Thassos White ***STD***
Plumbing Fixture (colour)	1737	Plumbing Fixtures-WHITE ***STD***
Comment		

Main Bathroom

Cabinet Colour/Style	9160	Viking III-MUSKOKA-RAIN CLOUD-3DL ***STD***
Countertop	8822	4924-38-Countertop-WHITE CARRARA-Wilsonart ***STD***
Countertop Edge	1111	N/A *****
Cabinet Hardware	7669	169-HARDWARE ***STD***
Flooring	9071	GE.BY.AZR.1313 New Byzantine Azzuro 13x13 ***STD***
Floor Tile Grout	7705	Grout-(01) Alabaster ***UPG***
Floor Tile Pattern	3000	STANDARD SQUARE ***STD*** <div><div></div></div>
Wall Tile	5411	QT.SP.WHT.0810-Splendour-White-8 inch x 10 inch ***STD***
Wall Tile Grout	2226	Grout-(00) White ***STD***

2/2/21
2/4

Customer Colours

JINGXUAN YU/XI LIU
Project: Wallaceton
Unit: 3191A-5, Phase: 3
Model: 20-1606 B The Grassfield

7 of 28

027

Created: 3/20/2023 09:08:14

Locked:

Closed:

Main Bathroom Tile Pattern	3090	VERTICAL STACKED ***STD***								
		<table><tr><td></td><td></td><td></td><td></td></tr><tr><td></td><td></td><td></td><td></td></tr></table>								
Plumbing Fixture (Colour)										
Comment										

Finished Basement Bathroom

Cabinet Colour/Style	9160	Viking III-MUSKOKA-RAIN CLOUD-3DL ***STD***									
Countertop	8822	4924-38-Countertop-WHITE CARRARA-Wilsonart ***STD***									
Countertop Edge	1111	N/A *****									
Cabinet Hardware	7669	169-HARDWARE ***STD***									
Flooring	9071	GE.BY.AZR.1313 New Byzantine Azzuro 13x13 ***STD***									
Floor Tile Grout	7705	Grout-(01) Alabaster ***UPG***									
Floor Tile Pattern	3000	STANDARD SQUARE ***STD***									
		<table><tr><td></td><td></td><td></td></tr><tr><td></td><td></td><td></td></tr><tr><td></td><td></td><td></td></tr></table>									
Shower Floor Tile	8661	OD.ON.SWT.0202.MT.N-Ontario Series Mosaic-Snow White Matte-2 x 2 ***STD***									
Shower Floor Tile Grout	2226	Grout-(00) White ***STD***									
Shower Floor Tile Pattern	3000	STANDARD SQUARE ***STD***									
		<table><tr><td></td><td></td><td></td></tr><tr><td></td><td></td><td></td></tr><tr><td></td><td></td><td></td></tr></table>									
Shower Wall Tile	5411	QT.SP.WHT.0810-Splendour-White-8 inch x 10 inch ***STD***									
Shower Wall Tile Grout	2226	Grout-(00) White ***STD***									
Shower Wall Tile Pattern	3090	VERTICAL STACKED ***STD***									
		<table><tr><td></td><td></td><td></td><td></td></tr><tr><td></td><td></td><td></td><td></td></tr></table>									

2/2/23
2/2

Customer Colours

JINGXUAN YU/XI LIU
Project: Wallaceton
Unit: 3191A-5, Phase: 3
Model: 20-1606 B The Grassfield

8 of 28

627

Created: 3/29/2023 09:00:11

Locked:

Closed:

Shower Jamb(s)	8923	Shower Jamb / Sill-Thassos White ***STD***
Plumbing Fixture (Colour)	1737	Plumbing Fixtures-WHITE ***STD***
Comment		

Great Room Fireplace

Type	8865	Dimplex-Electric Fireplace-PF3033HL ***STD***	
Mantle	8891	NF-17-Paint Grade Mantle- Cabinet (Per Plan)-WHITE ***STD***	PG 17
Surround Opt.	1111	N/A *****	
Comment			

Basement Stairs

Type	1711	Carpet Grade Stairs ***OPT. FINISHED BASEMENT***	
Colour	7912	Irongate (Gryphon) STAIN TO COMPLIMENT HARDWOOD AND WILL VARY FROM FLOORING	
Carpet Runner	1111	N/A *****	
Handrail/Pickets/Post Type	9119	Handrail only on closed walls (one or two sides per building code) ***STD***	
Handrail/Pickets/Post Colours	1729	Carpet Grade-Stain handrail, pickets, stringers, nosing_pos	
Carpet	9507	DY 89418-MINOTAUR-BLACK ICE-40 oz Poly ***STD***	
Custom Stain/Paint	1111	N/A *****	
Comment			

Basement Stairs Landings (Upper and Lower)

Flooring	7498	Red Oak Pearl-Vintage Engineered-GRYPHON/IRONGATE-3/4 inch x 3 1/4 inch ***3***	
Comment			

Customer Colours

JINGXUAN YU/XI LIU
Project: Wallaceton
Unit: 3191A-5, Phase: 3
Model: 20-1606 B The Grassfield

9 of 28

627

Created: 3/10/2023 09:08:14

Locked:

Closed:

Main Stairs

Type	1714	Oak Stairs ***STD MAIN STAIRS***
Colour	7912	Irongate (Gryphon) STAIN TO COMPLIMENT HARDWOOD AND WILL VARY FROM FLOORING
Carpet Runner	1111	N/A *****
Handrail/Pickets/Posts Type	7652	1 5/16 inch Square pickets with 3 1/2? Square/Cap Post(s)-ALL OAK ***STD***
Handrail/Pickets/Posts Colour	1728	Oak Grade-Stain handrail,oak pickets,stringers,treads,risers
Custom Stain/Paint	1111	N/A *****
Comment		

Main Stairs Landing(s)

Flooring	7498	Red Oak Pearl-Vintage Engineered-GRYPHON/IRONGATE-3/4 inch x 3 1/4 inch
Comment		

Throughout

Walls - Paint Colour	1717	22-Wall-WARM GREY ***STD***
Underpad	1079	500 Series-Underpad ***STD***
Thresholds	2232	Metal Thresholds ***STD***
Switches and Plug	5796	Decora White Switches and Plugs ***STD***
Trim Size	8705	4 1/4 Baseboard and 2 3/4 Casings ***STD***
Trim - Paint Colour	1716	Trim-WHITE ***STD***
Comment		

Purchaser:

JINGXUAN YU

3.20.23

Date

Decor Consultant

3.20.23

Date

20/3/23

Customer Colours

JINGXUAN YU/XI LIU
Project: Wallaceton
Unit: 3191A-5, Phase: 3
Model: 20-1606 B The Grassfield

Created: 3/20/2023 09:08:14
Locked:
Closed:

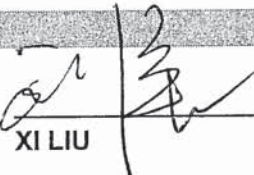
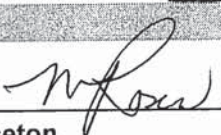
Purchaser:		<u>3.20.23</u>		<u>05-03-2023</u>
	XI LIU	Date	Wallaceton	Date Approved



CONSTRUCTION SUMMARY

Lot: 3191A-5
Model: 20-1606 B The Grassfield
Project/Phase: Wallaceton / 3

Offer Worksheet	Five Thousand Dollars (\$5,000) at D?cor. (No Cash Value) Townhomes Note:
Offer Worksheet	The Purchaser(s) acknowledge that they have NOT been referred by an existing Heathwood Homeowner and therefor are not entitled to a referral fee under Heathwood Homes Referral program. Note:



CONSTRUCTION SUMMARY

Lot: 3191A-5
Model: 20-1606 B The Grassfield
Project/Phase: Wallaceton / 3

ADMIN FEE

Invoice Qty. Description

CABINETRY

Invoice Qty. Description

1346 352,783 04May23	1	- CABINETRY - OPT. LIGHT VALANCE (INCLUDING LIGHT) - VIKING II/III - UPG ELECTRICAL-Complete Kitchen valance light including switch (Luminiz LED slimline strip light)
1346 351,620 04May23	1	KITCHEN - CABINETRY - OPT. DEEP FR & GABLES - VIKING II/III - UPG SKETCH # 2 DRYWAL-Notify; FRAMING-Modify Bulkhead; PAINTING-Notify

CERAMICS

Invoice Qty. Description

1346 354,605 04May23	1	Foyer - CERAMICS - FLOOR GROUT - FOYER - GROUT
1346 354,608 04May23	1	Main Hall - CERAMICS - FLOOR GROUT - MAIN HALL - GROUT
1346 354,609 04May23	1	Mud Room - CERAMICS - FLOOR GROUT - MUD ROOM - GROUT
1346 354,610 04May23	1	Powder Room - CERAMICS - FLOOR GROUT - POWDER ROOM - GROUT
1346 04May23 NoCat	1	KITCHEN/BREAKFAST - UPGRADE GROUT - FLOOR KITCHEN / BREAKFAST AREA
1346 354,606 04May23	1	Laundry Room - CERAMICS - FLOOR GROUT - LAUNDRY ROOM - GROUT
1346 354,603 04May23	1	Ensuite Master - CERAMICS - FLOOR GROUT - ENSUITE MASTER - GROUT
1346 354,607 04May23	1	Main Bathroom - CERAMICS - FLOOR GROUT - MAIN BATHROOM - GROUT
1346 354,604 04May23	1	Finished Basement Bathroom - CERAMICS - FLOOR GROUT - FINISHED BASEMENT BATHROOM - GROUT



CONSTRUCTION SUMMARY

Lot: 3191A-5
Model: 20-1606 B The Grassfield
Project/Phase: Wallaceton / 3

DRYWALL

Invoice	Qty.	Description
1346 314,346 04May23 **	4	- INTERIOR TRIM - UPGRADE FROM STANDARD 6 FT 8 INCH 2 PANEL HOLLOW CORE SINGLE DOOR TO 8 FT 2 PANEL HOLLOW CORE SINGLE DOOR MAIN FLOOR SKETCH # 2 EXCEPT POWDER AND DOOR TO BASEMENT DRYWALL-Notify;FRAMING-Notify;PAINTING-paint upgraded door and frame
1346 351,620 04May23 **	1	KITCHEN - CABINETRY - OPT. DEEP FR & GABLES - VIKING II/III - UPG SKETCH # 2 DRYWAL-Notify; FRAMING-Modify Bulkhead; PAINTING-Notify

ELECTRICAL

Invoice	Qty.	Description
1346 352,783 04May23 **	1	- CABINETRY - OPT. LIGHT VALANCE (INCLUDING LIGHT) - VIKING II/III - UPG ELECTRICAL-Complete Kitchen valance light including switch (Luminiz LED slimline strip light)
1346 345,787 04May23	1	GREAT ROOM - ELECTRICAL - CEILING ROUGH-IN (CAPPED) CENTRED IN THE ROOM USE EXISITNG SWITCH SKETCH # 2
1346 314,224 04May23	1	KITCHEN - ELECTRICAL - CEILING ROUGH-IN (CAPPED) INCLUDING SWITCH CENTRED OVER ISLAND SKETCH # 2

FRAMING

Invoice	Qty.	Description
1346 314,346 04May23 **	4	- INTERIOR TRIM - UPGRADE FROM STANDARD 6 FT 8 INCH 2 PANEL HOLLOW CORE SINGLE DOOR TO 8 FT 2 PANEL HOLLOW CORE SINGLE DOOR MAIN FLOOR SKETCH # 2 EXCEPT POWDER AND DOOR TO BASEMENT DRYWALL-Notify;FRAMING-Notify;PAINTING-paint upgraded door and frame
1346 351,620 04May23 **	1	KITCHEN - CABINETRY - OPT. DEEP FR & GABLES - VIKING II/III - UPG SKETCH # 2 DRYWAL-Notify; FRAMING-Modify Bulkhead; PAINTING-Notify

INTERIOR TRIM AND DOORS

Invoice	Qty.	Description
1346 314,346 04May23	4	- INTERIOR TRIM - UPGRADE FROM STANDARD 6 FT 8 INCH 2 PANEL HOLLOW CORE SINGLE DOOR TO 8 FT 2 PANEL HOLLOW CORE SINGLE DOOR MAIN FLOOR SKETCH # 2 EXCEPT POWDER AND DOOR TO BASEMENT DRYWALL-Notify;FRAMING-Notify;PAINTING-paint upgraded door and frame

PAINTING

Invoice	Qty.	Description
1346 314,346 04May23 **	4	- INTERIOR TRIM - UPGRADE FROM STANDARD 6 FT 8 INCH 2 PANEL HOLLOW CORE SINGLE DOOR TO 8 FT 2 PANEL HOLLOW CORE SINGLE DOOR MAIN FLOOR SKETCH # 2 EXCEPT POWDER AND DOOR TO BASEMENT DRYWALL-Notify;FRAMING-Notify;PAINTING-paint upgraded door and frame
1346 351,620 04May23 **	1	KITCHEN - CABINETRY - OPT. DEEP FR & GABLES - VIKING II/III - UPG SKETCH # 2 DRYWAL-Notify; FRAMING-Modify Bulkhead; PAINTING-Notify

THE GRASSFIELD

ELEVATION B | 1,986 SQ. FT.

Includes 380 sq. ft. of Finished Lower Level.

WALLACETON

EST. 1870

Sketch #1

20-1606 ELEV. B

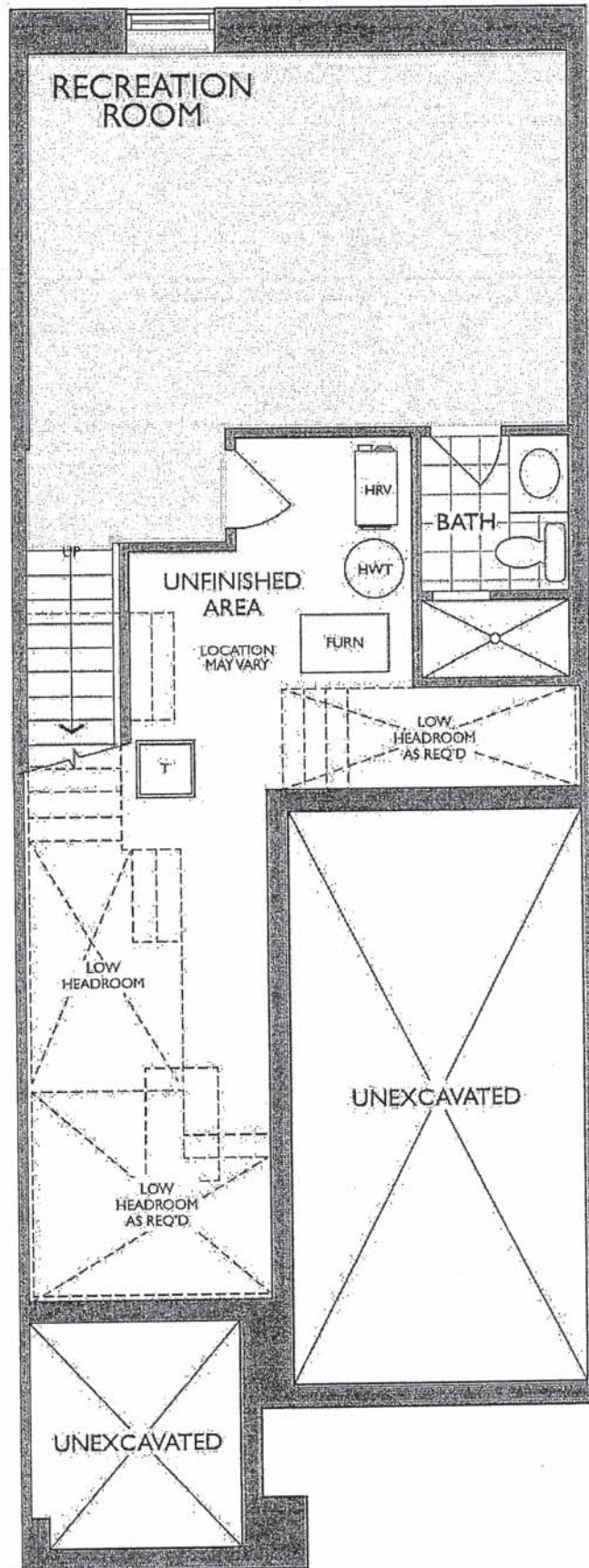

LOWER LEVEL
ELEVATION A & B

Handwritten signature and date: 2/4

THE GRASSFIELD

Sketch #2

ELEVATION B | 1,986 SQ. FT.

Includes 380 sq. ft. of Finished Lower Level

20-1606 ELEV. B

WALLACETON
EST. 1870

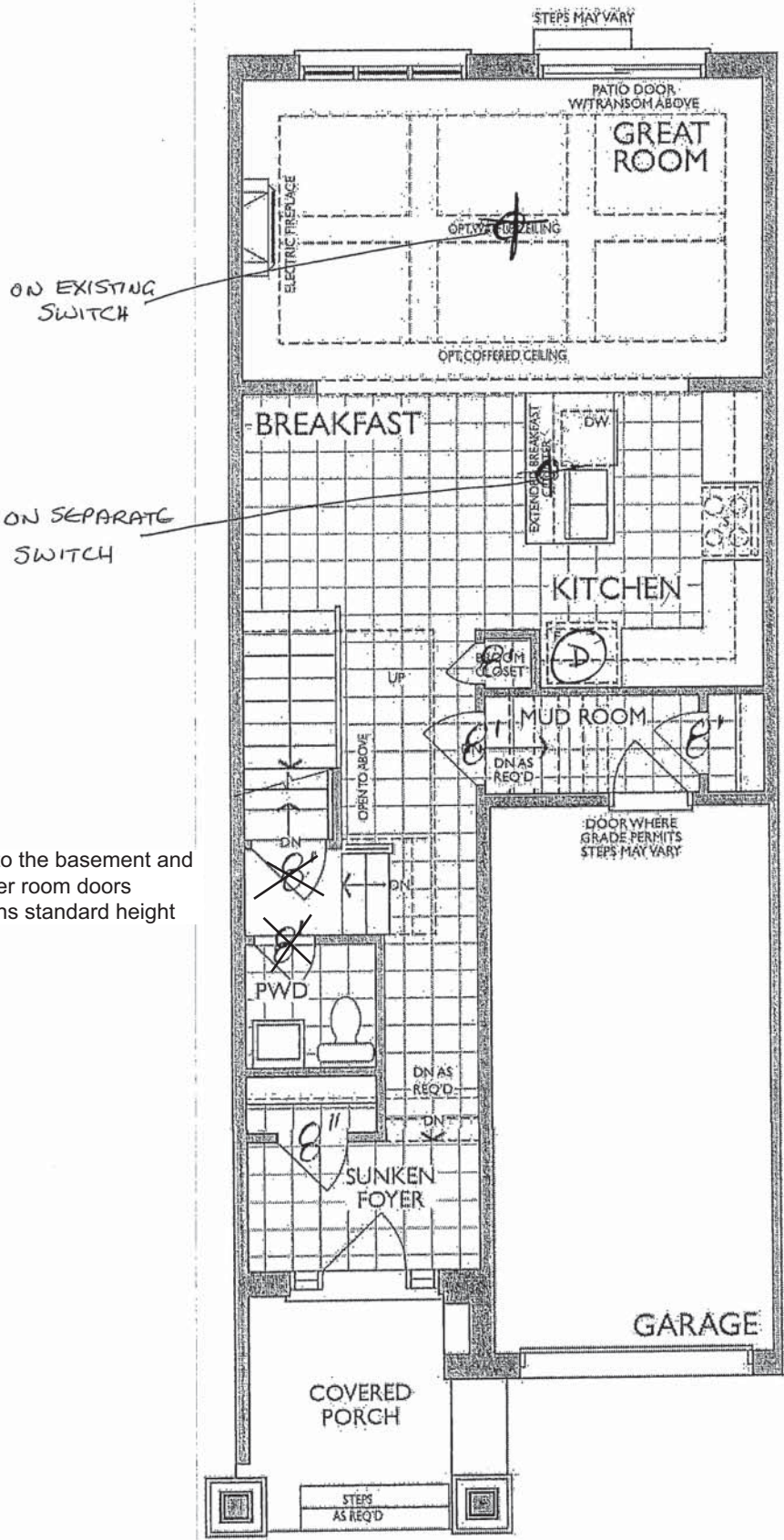

⊕ - CAPPED CEILING
OUTLET

VALANCE/LIGHTING
Ⓢ = DEEP CABINET

8' = 8' FT DOORS
(total of 4 on main floor)

Door to the basement and
Powder room doors
remains standard height

MAIN FLOOR
ELEVATION B

Handwritten signature

* Floor plan may vary due to grading conditions.

THE GRASSFIELD

Sketch # 3

ELEVATION B | 1,986 SQ. FT.
Includes 380 sq. ft. of Finished Lower Level

20-1606 ELEV. B

WALLACETON
EST. 1870

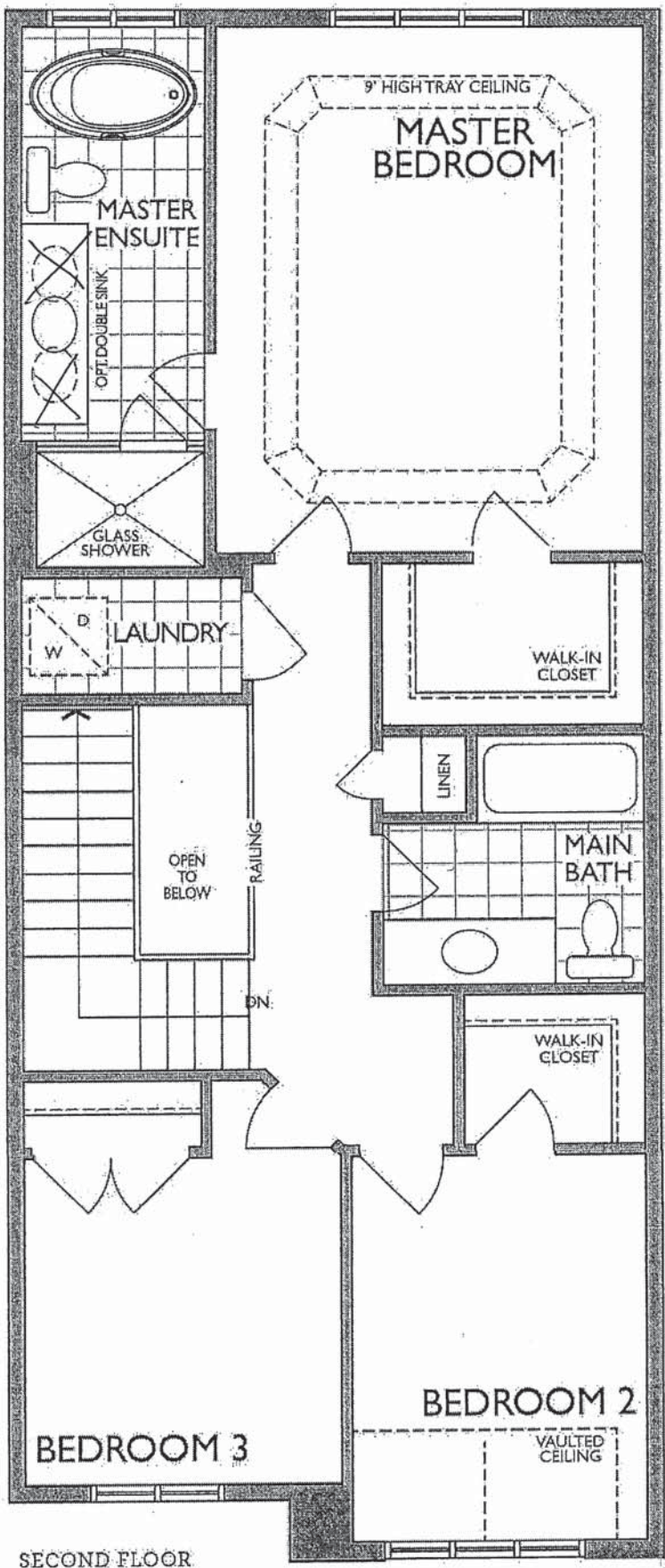

SECOND FLOOR
ELEVATION B

Handwritten signature/initials



NEAS NE17 Mantel

2/4

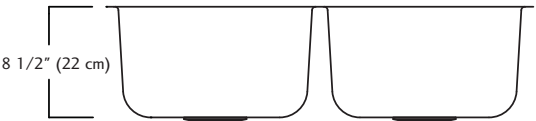
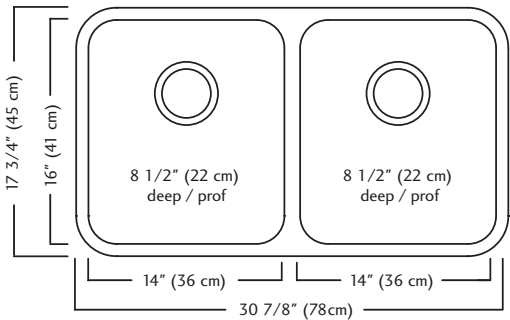

ND1831UA/9 SPECIFICATION

Model ND1831UA/9 is a double (two equal size) bowl undermount sink manufactured by Franke Kindred Canada Limited from 18 gauge stainless steel. Product has silk finished rims and linear brush finished bowls. Sink is fully undercoated. Basket strainer waste fittings (3 1/2", 89 mm) are included. Sink is backed with a limited lifetime warranty.

- O.D. 17 3/4" x 30 7/8" x 8 1/2" (45 x 78 x 22 cm)
- **Recommended for minimum 36" cabinet**

MOEN®

Specifications

FAUCET DESCRIPTION

- Reflex™ pulldown system offers smooth operation, easy movement and secure docking
- Power Clean™ spray technology
- Metal construction with various finishes identified by suffix
- Quick connect installation
- Pulldown spray with 68" braided hose
- Flexible supply lines with 3/8" compression fittings
- High arc spout provides height and reach to fill or clean large pots while pulldown wand provides the maneuverability for cleaning or rinsing
- 360° rotating spout
- Faucet designed for handle to be mounted on right side only

OPERATION

- Lever style handle
- Temperature controlled by 100° arc of handle travel
- Operates with less than 5 lbs. of force
- Operates in stream or spray mode in the pullout or retracted position

FLOW

- Flow is limited to 1.5 gpm (5.7 L/min) max at 60 psi

CARTRIDGE

- 1255™ Duralast™ cartridge

STANDARDS

- Third party certified to IAPMO Green, ASME A112.18.1/CSA B125.1 and all applicable requirements therein including NSF 61/9G & 372
- Meets CalGreen and Georgia SB370 requirements
- Complies with California Proposition 65 and with the Federal Safe Drinking Water Act
- The backflow protection system in the device consists of two independently operating check valves, a primary and a secondary which prevent backflow

- ADA  for lever handle

WARRANTY

- Lifetime limited warranty against leaks, drips and finish defects to the original homeowner
 - 10 year limited warranty when used in a multifamily installation
 - 5 year limited warranty when used in a commercial installation
- Visit www.moen.com/support for complete details and limitations

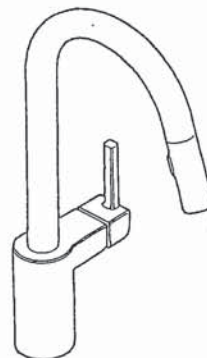

ALIGN™

Single Handle High Arc
Pulldown Kitchen Faucet

Models: 7565 series

NOTE: THIS FAUCET IS DESIGNED TO BE INSTALLED
THROUGH 1 HOLE, 1-1/2" (38mm) MIN. DIA.
(OPTIONAL 3-HOLE ESCUTCHEON 141002 AVAILABLE)

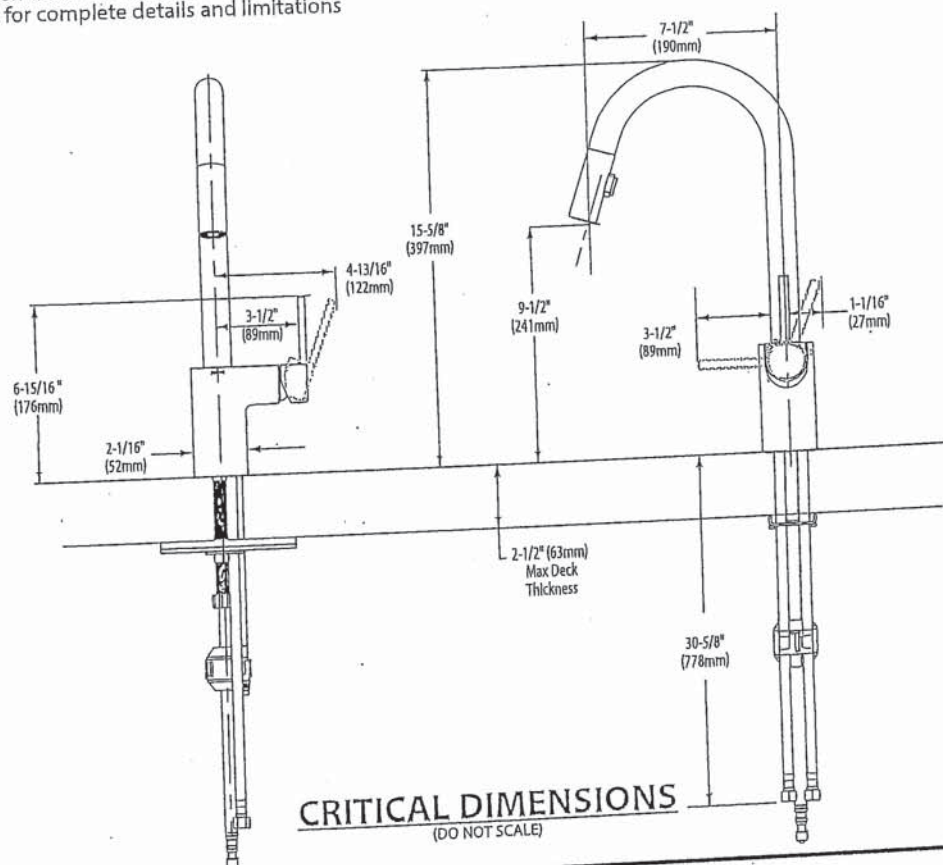

FOR MORE INFORMATION CALL: 1-800-BUY-MOEN
www.moen.com



 **BARRIER FREE (ABOVE COUNTER OR DROP-IN ONLY)**

**BOULEVARD®
PEDESTAL SINK**
VITREOUS CHINA

BOULEVARD® PEDESTAL SINK

- STD
- ☐

~~0641.800~~

~~Faucet holes on 8" (203mm) centers (illustrated)~~
- ☐

0641.400

Faucet holes on 4" (102mm) centers
- ☐

~~0641.100~~

~~Center hole only~~

- Classic styled rectangular pedestal lavatory
 - Vitreous china
 - Rear overflow
 - Supplied with mounting kit
 - Right Height® for greater comfort during use
 - Faucet ledge with large deck area (faucet not included)
 - **Design coordinates with Boulevard® Toilet**
 - Basin has flat bottom to also allow use as an **above counter** sink or a **drop-in** sink (with u-shaped cut out)

Nominal Dimensions:
24" x 19" x 35-1/2"
(610 x 483 x 902mm)

- ☐

0641.008

Pedestal top-8" (203mm) centers
- ☐

0641.004

Pedestal top-4" (102mm) centers
- ☐

0641.001

Pedestal top-center hole only
- ☐

0010.000

Pedestal only

Bowl sizes:
17" (432mm) wide,
12-1/2" (318mm) front to back,
5" (127mm) deep

**Compliance Certifications -
Meets or Exceeds the Following Specifications:**
• ASME A112.19.2 - 2008/CSA B45.1-08



SEE REVERSE FOR ROUGHING-IN DIMENSIONS

To Be Specified:

- ☐

Color:

☐

White

☐

Linen
- ☐

Faucet Finish:
- ☐

Supplies:
- ☐

1-1/4" Trap:
- ☐

Nipple:

* See faucet section for additional models available

American
Standard

BOULEVARD®
PEDESTAL SINK
VITREOUS CHINA

 BARRIER FREE (ABOVE COUNTER OR DROP-IN ONLY)

TOP VIEW (ALL THREE CONFIGURATIONS)

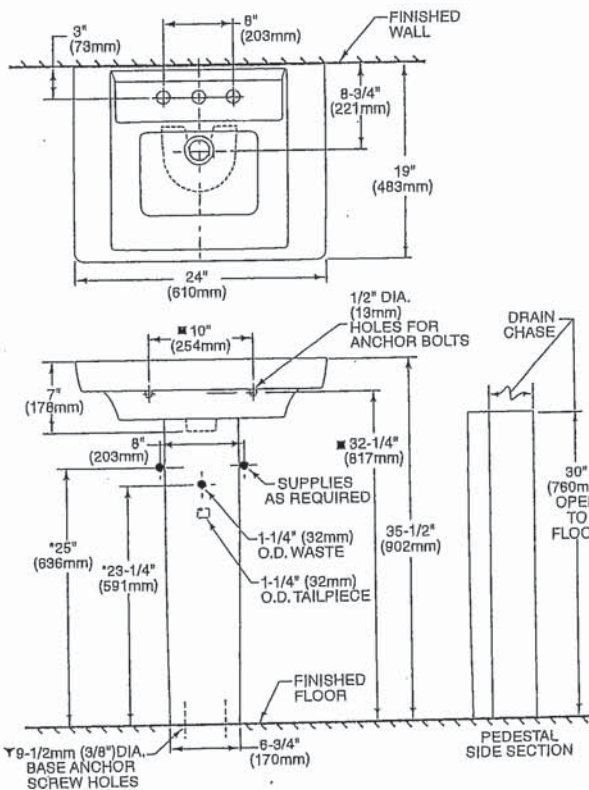

PEDESTAL CONFIGURATION
(NOT ADA COMPLIANT)

ABOVE COUNTER CONFIGURATION

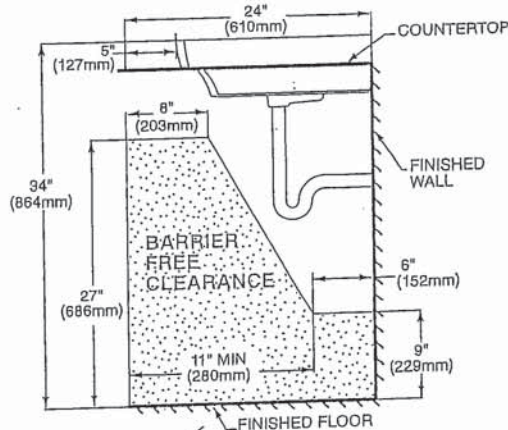
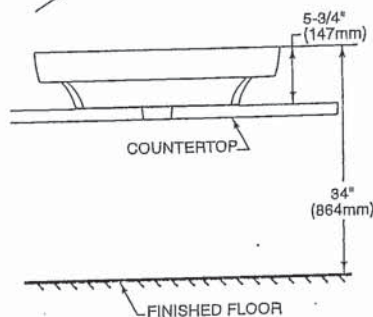

DROP-IN SINK CONFIGURATION



ABOVE COUNTER AND DROP-IN SINK CONFIGURATIONS
MEET THE AMERICANS WITH DISABILITIES ACT GUIDELINES
AND ANSI A117.1 ACCESSIBLE AND USABLE
BUILDINGS AND FACILITIES - CHECK LOCAL CODES.
Top of sink installed at 34" (864mm) height from finished floor.
Sink installed 5" (127mm) minimum from front edge of countertop.
Provide 27" (686mm) knee clearance area.

NOTES:
* DIMENSIONS SHOWN FOR LOCATION OF SUPPLIES AND "P" TRAPS ARE SUGGESTED.
▼ PEDESTAL ANCHORING SCREWS NOT INCLUDED.
■ SUITABLE FOR REINFORCEMENT ONLY. ACTUAL DIMENSIONS MUST BE TAKEN FROM FIXTURE.
FITTING NOT INCLUDED AND MUST BE ORDERED SEPARATELY.
PROVIDE SUITABLE REINFORCEMENT FOR ALL WALL SUPPORTS.
INSTALLATION INSTRUCTIONS SUPPLIED WITH LAVATORY.

IMPORTANT: Dimensions of fixtures are nominal and may vary within the range of tolerance established by ANSI Standard A112.19.2
These measurements are subject to change or cancellation. No responsibility is assumed for use of superseded or voided pages.

© 2018 AS America Inc.

J8

spec_0641_BoulevardPedSink Rev 2/18

PART OF LIXIL

Handwritten signature and date: 2/2/18



COLONY™
COUNTERTOP SINK
VITREOUS CHINA

COLONY COUNTERTOP SINK

- Vitreous china
- Self-rimming
- Front overflow
- Supplied with template
- Faucet deck
(Faucet shown not included)

- ☐ 0346 803
Faucet holes on 203mm (8") centres
- ☐ 0346 403 (Illustrated)
Faucet holes on 102mm (4") centres
- ☐ 0346 001
Centre hole only



Nominal Dimensions:
521 x 448mm (20-1/2" x 17-5/8")

Bowl sizes:
422mm (16-5/8") wide, 279mm (11") front to back, 143mm (5-5/8") deep

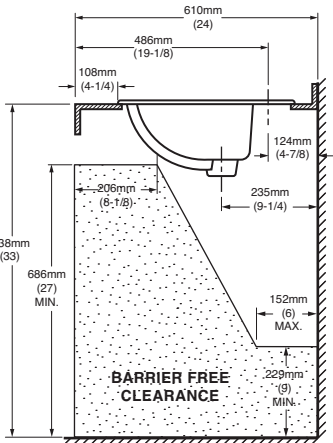
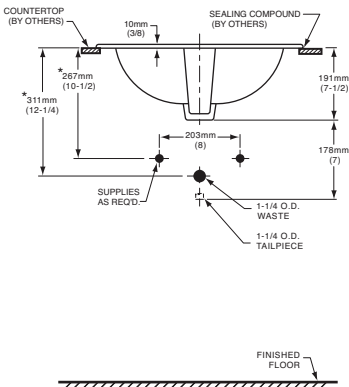
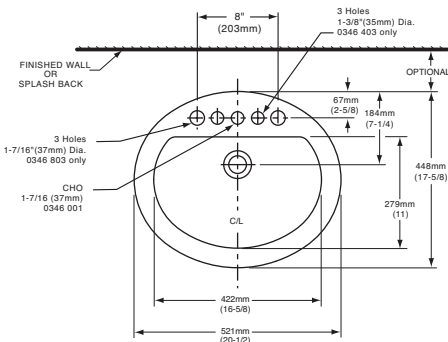

COMPLIANCE CERTIFICATIONS –
Meets or exceeds the following Specifications:
• ASME A112.19.2M for Vitreous China Fixtures.
• CAN/CSA B45 Series.

- To Be Specified
- ☐ Colour:

☐ White

☐ Bone

☐ Silver Gray

☐ Linen
- ☐ Faucet*:
- ☐ Faucet Finish:
- ☐ Supplies & Stops:
- ☐ Trap 1-1/4" (32 mm):

NOTES:
★ DIMENSIONS SHOWN FOR LOCATION OF SUPPLIES AND "P" TRAP ARE SUGGESTED. FOR COUNTERTOP CUTOUT AND INSTALLATION INSTRUCTIONS USE TEMPLATE SUPPLIED WITH SINK.
FAUCETS NOT INCLUDED AND MUST BE ORDERED SEPARATELY.
IMPORTANT: Dimensions of fixtures are nominal and may vary within the range of tolerances established by ANSI Standard A112.19.2.
These measurements are subject to change or cancellation. No responsibility is assumed for use of superseded or voided pages.

* See faucet section for additional models available



DEMI™
Product Specification Sheet



Two Piece Freestanding Collection

CF2007	Two Piece Freestanding Soaker
Size:	60" x 32" x 22" 1524 mm x 813 mm x 559 mm

PRODUCT FEATURES & BENEFITS

- Vacuum formed acrylic reinforced with fiberglass
- Scratch, stain and fade resistant high gloss finish
- Installation friendly two piece design
- Accepts deck mounted faucet
- Includes integral pop up drain and rectangular overflow
- Includes levelling feet

TWO PIECE ASSEMBLY

FRONT VIEW

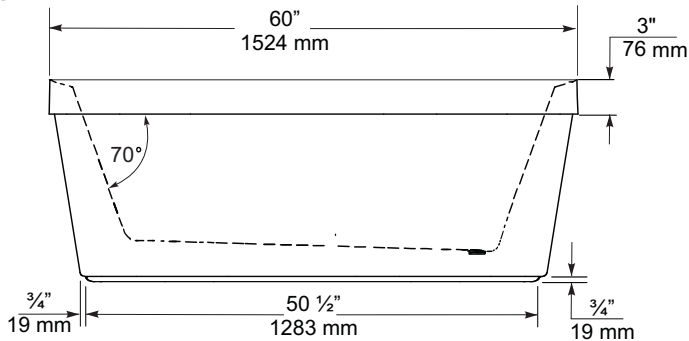

END VIEW

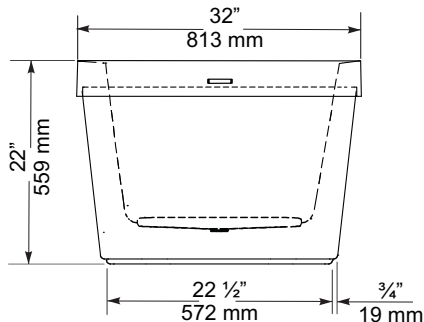

TOP VIEW

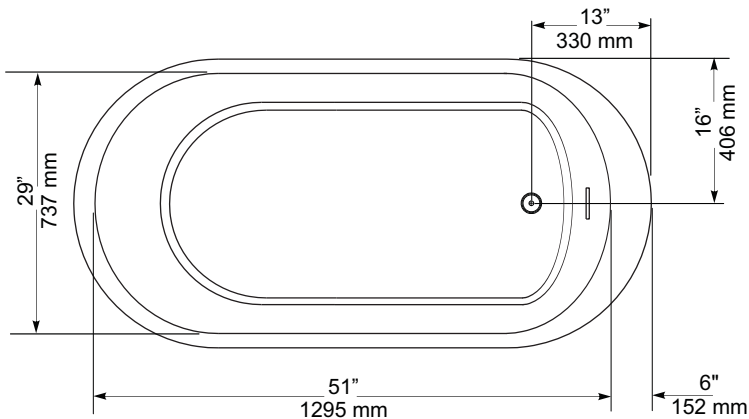

GENERAL SPECIFICATIONS		
Average Weight	90 lb	41 kg
Bathing Well at bottom	43"x 20"	1092 x 508 mm
Capacity Drain to Overflow		195 litres
Water Depth Drain to Overflow	16"	406 mm
Drain Opening (dia.)	2"	51 mm
Overflow Opening	2 1/4"x 1/2"	57 x 13 mm
Drain to Floor Clearance	3 1/4"	83 mm

NOTES: Please confirm measurements on actual product to ensure proper identification. Bathtub to be installed on the floor supported by 5 self levelling feet. Adjust if required to level the bathtub for adequate drainage. Refer to installation instructions for additional information.

IMPORTANT: Dimensions of fixtures are nominal and may vary ± 1/4" (6 mm). Weight may vary ± 5 lb (2.3 kg). Drawing is not to scale. These measurements are subject to change at manufacturer's discretion.

Compliance Certifications -
Meets or Exceeds the following Specifications:
• CAN/CSA - B45 Series



American Standard

Style That Works Better

FloWise™ DUAL FLUSH
ELONGATED TOILET

VITREOUS CHINA

FloWise™ DUAL FLUSH ELONGATED TOILET

- ☐ 2476 216
- Vitreous china
 - Low-consumption Dual Flush
Full flush 6.0 Lpf/1.3 gpf,
Partial flush 3.0 Lpf/0.66 gpf.
 - Elongated wash down bowl
 - Internal trapway fully-glazed,
2-1/4" (57mm) ballpass
 - Concealed trapway bowl
 - Chrome-plated top mounted
push button actuator
 - Easy to clean sanitary dam on bowl
 - Includes Elongated Slow Close Seat
 - 100% factory flush tested
 - 2 bolt caps

Separate Component Parts:

- ☐ 3067 316 Elongated Bowl with Slow Close Seat
☐ 4035 216 Unlined Tank

- ☐ 2476 516 Same as above with Lined tank
- ☐ 3067 316 Elongated Bowl
☐ 4035 516 Lined Tank

Nominal Dimensions:
794 x 432 x 765mm
(31-1/4" x 17" x 30-1/8")

Compliance Certifications -
Meets or Exceeds the Following Specifications:
• ASME A112.19.2M (and 19.6M)
• CAN/CSA B45 series

To Be Specified

- ☐ Colour: 020 White
☐ Supply with stop:

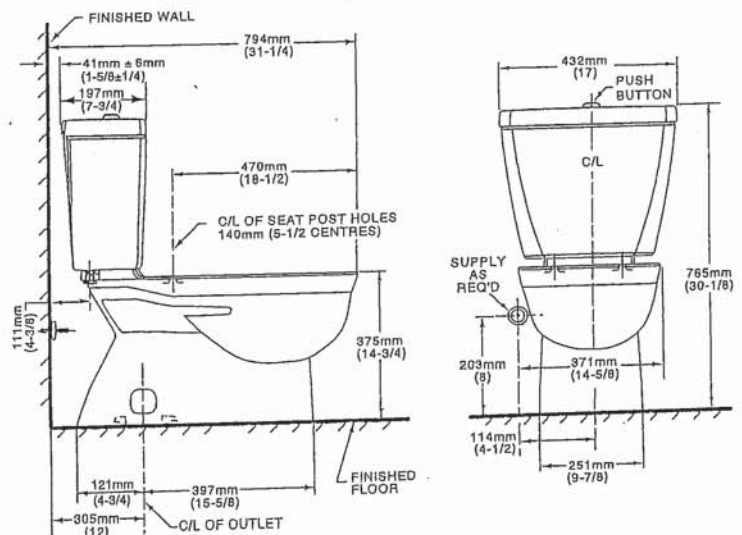
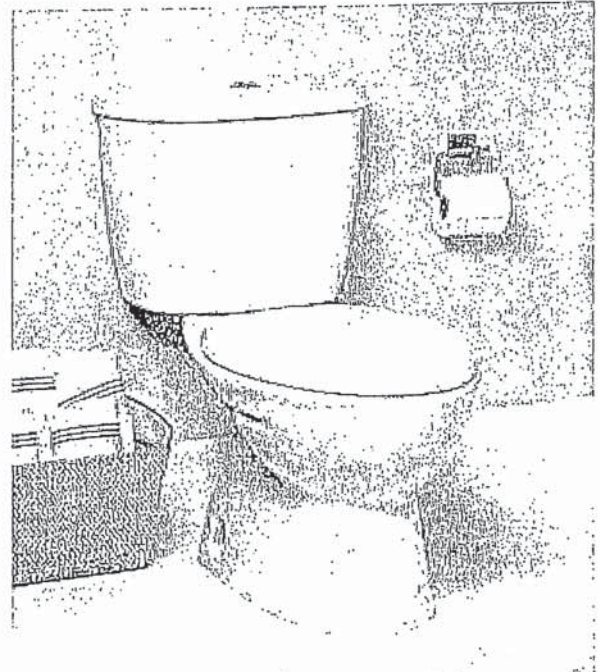

NOTES:
THIS TOILET IS DESIGNED TO ROUGH-IN AT A MINIMUM DIMENSION OF 305MM (12") FROM FINISHED WALL TO C/L OF OUTLET.
SUPPLY NOT INCLUDED WITH FIXTURE AND MUST BE ORDERED SEPARATELY.
* DIMENSION SHOWN FOR LOCATION OF SUPPLY IS SUGGESTED.
FOR ADDITIONAL INFORMATION REFER TO INSTALLATION INSTRUCTIONS SUPPLIED.
IMPORTANT: Dimensions of fixtures are nominal and may vary within the range of tolerance established by ANSI Standard A112.19.2
These measurements are subject to change or cancellation. No responsibility is assumed for use of superseded or voided pages.

UPGRADED VALUE ADDED FEATURES AT NO EXTRA CHARGE

3/24

MOEN®

Specifications

DESCRIPTION

- Metal construction with various finishes identified by suffix
- 16" long 3/8" tubing connections
- Includes metal or 50/50 pop-up type waste assembly where noted

OPERATION

- Pivot action lever style handle
- Temperature controlled through 180° degree arc of handle travel

FLOW

- Flow is limited to 1.5 gpm max (5.7L/min) at 60 psi

CARTRIDGE

- 1225 cartridge design
- Nonmetallic/nonferrous and stainless steel material
- Can accommodate reversed piping and back to back installations

STANDARDS

- Third party certified to WaterSense®, CSA B-125.1, ASME A112.18.1 and all applicable requirements referenced therein including NSF61/9
- Complies with California Proposition 65 and with the Federal Safe Drinking Water Act

- ADA  for lever handle

WARRANTY

- Lifetime limited warranty against leaks, drips and finish defects to the original consumer purchaser
- 5 year warranty if used in commercial installations

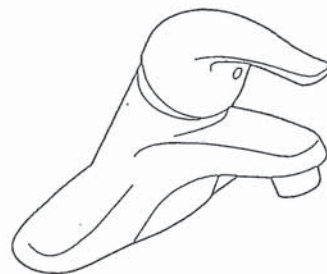

CHATEAU®
Single-Handle Lavatory Faucet

with Metal Waste Assembly

Model: L4625 series

L4631BC

Bulk Packed (12 per carton):

L64624 series

with 50/50 Waste Assembly

Bulk Packed (12 per carton):

L64625 series

Less Waste

Bulk Packed (12 per carton):

L64600 series

NOTE: THIS FAUCET IS DESIGNED TO BE
INSTALLED THRU 3-1" DIA. HOLES, 2" ON CENTER

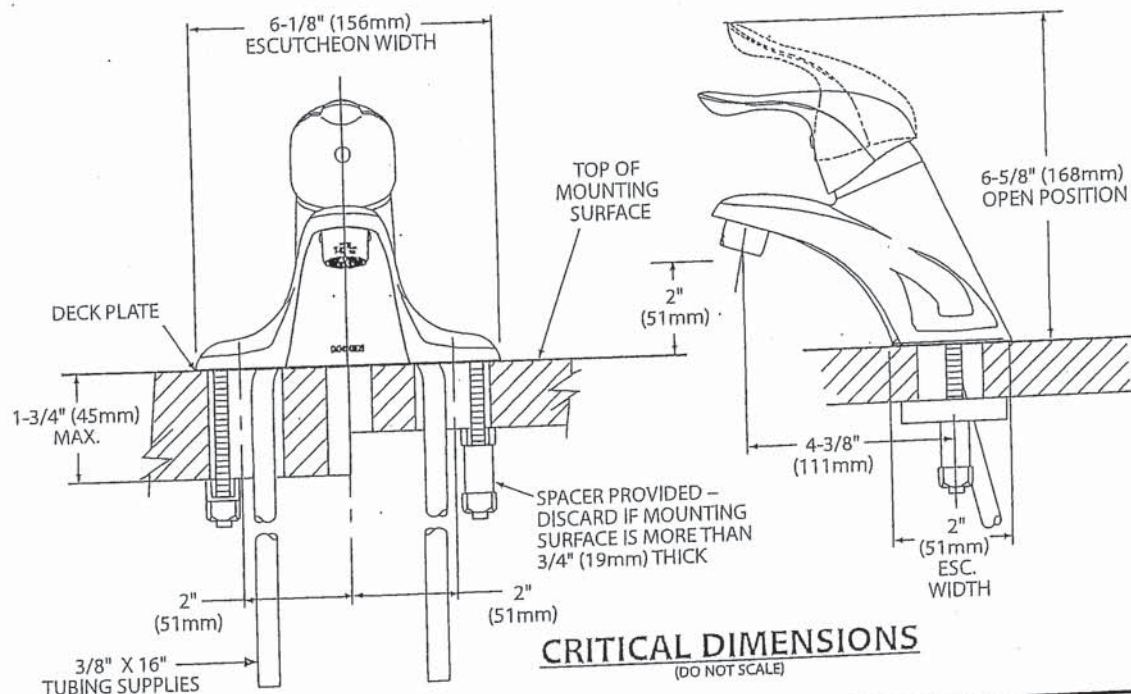

FOR MORE INFORMATION CALL: 1-800-BUY-MOEN
www.moen.com

Handwritten signature/initials



Buy it for looks. Buy it for life.®

There is more than 1 version of this model.
Page down to identify the version you have.

DESCRIPTION

- Metal construction with various finishes identified by suffix
- Includes non-metallic showerhead, arm, flange and non-metallic diverter tub spout

OPERATION

- Handle operates counterclockwise through a 270° arc with off at 6 o'clock and maximum hot at the 9 o'clock position. Shut off in clockwise direction
- Adjustable temperature limit stop to control maximum hot water temperature
- Pressure balancing mechanism maintains selected discharge temperature to $\pm 3^\circ$

FLOW

- Showerhead is limited to 2.5 gpm (9.5 L/min) at 80 psi
- EP suffix models are limited to 1.75 gpm (6.6 L/min) at 80 psi
- NH suffix models contain no showerhead

CARTRIDGE

- 1222 cartridge design
- Accommodates back to back installations
- Nonmetallic/nonferrous and stainless steel material

STANDARDS

- Third party certified to meet ASME A112.18.1/CSA B125.1 and all applicable requirements referenced therein
- EP suffix models are third party certified to WaterSense®

- ADA for lever handle

WARRANTY

- Lifetime limited warranty against leaks, drips and finish defects to the original consumer purchaser
- 5 year warranty if used in commercial installations

Specifications



CHATEAU® POSI-TEMP® Single-Handle Tub/Shower Trim Kit

Models: TL181 series - valve trim only
(Bulk Packed 12 per carton)
TL182 series - shower trim only
(Bulk Packed 12 per carton)
TL183 series - tub/shower trim
(Bulk Packed 12 per carton)

Valves: 62300 series
2500 series

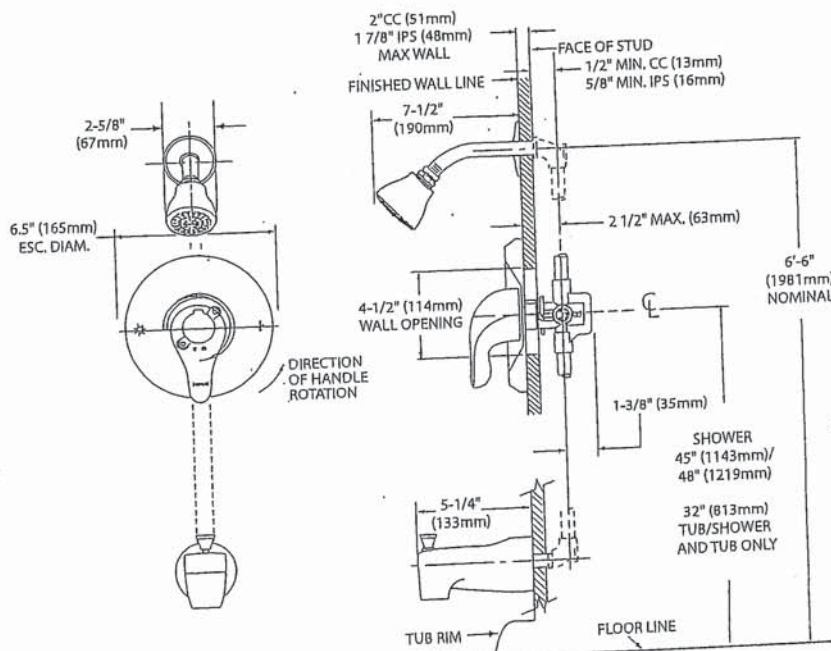
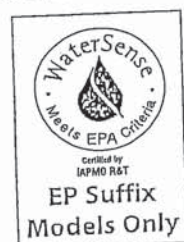

CRITICAL DIMENSIONS

(DO NOT SCALE)

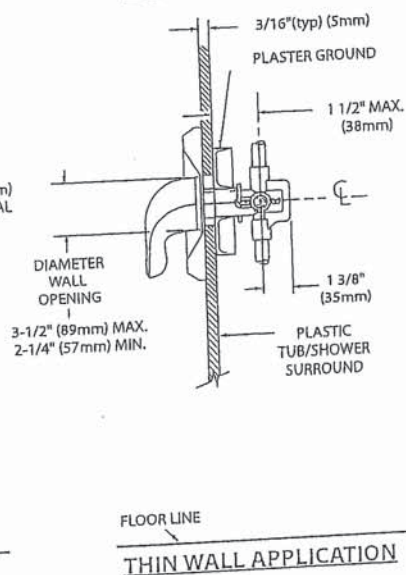

FOR MORE INFORMATION CALL: 1-800-BUY-MOEN
www.moen.com

Handwritten signature and date 5/24



Specifications

DESCRIPTION

- Metal construction with various finishes identified by suffix

OPERATION

- Lever style handles with hot and cold color indicator
- Rotate hot side handle counterclockwise to open (clockwise to close) and the cold side handle (clockwise to open) and (counterclockwise to close)

STANDARDS

- Third party certified to: ASME A112.18.1/CSA B-125.1, and all applicable requirements referenced therein
- ADA  for lever handles

WARRANTY

- Lifetime limited warranty against leaks, drips and finish defects to the original homeowner
 - 10 year limited warranty when used in a multi-family installation
 - 5 year limited warranty when used in a commercial installation
- Visit www.moen.com/support for complete details and limitations

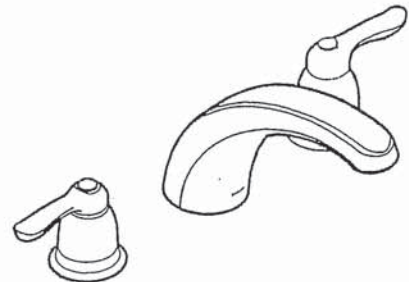

CHATEAU®
Two-Handle Garden Tub Trim

Models: T994 series

Valves: 4792, 4793, 4794, 4796, 4797, 4798

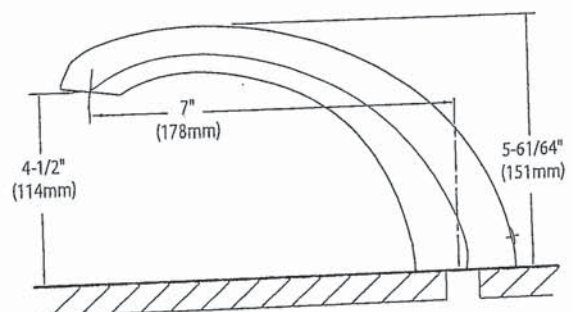
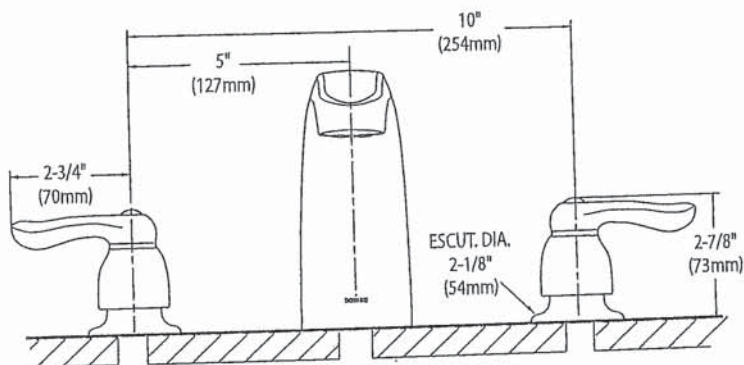

CRITICAL DIMENSIONS

(DO NOT SCALE)

FOR MORE INFORMATION CALL: 1-800-BUY-MOEN
www.moen.com



SPECIFICATIONS
AV SERIES
RANGE HOODS

180 CFM/7.0 Sones @ 0.10" SP. Horizontal
180 CFM/7.5 Sones @ 0.10" SP. Vertical

- Dimensions**
Overall bottom projection - 18³/₈"
Overall top projection -12"
Height - 6"
Available widths: 21", 24", 30", 36" & 42"
- Hood Body**
Stainless Steel: 24 gauge, grade 430 stainless steel.
Painted: 23 gauge cold rolled commercial grade (CRCQ) steel, auto welded, coated with a baked enamel finish.
- Motor**
2 speed, single coil, thermally protected, permanently lubricated.
Rated 120 volts, 60 hz. Complete with 200°C lead wires.
- Lighting**
Single 60 watt cook light capacity (bulb not included).
- Ducting Options**
Horizontal ducting: 3¹/₄"x10" (duct adapter and damper included).
Vertical ducting: 3¹/₄"x10" (duct adapter and damper included).
Vertical ducting: 7" round (duct adapter and damper not included).
Ductless: removable front vent (charcoal filter not included).
- Fan Blade**
One piece polymeric, electronically balanced blade. 6⁵/₈" diameter with 5 paddles.
- Electrical connection**
Hood top - 7/8" knockout hole for use with 1/2" cable clamp
Hood back - 7/8" knockout hole for use with 1/2" cable clamp

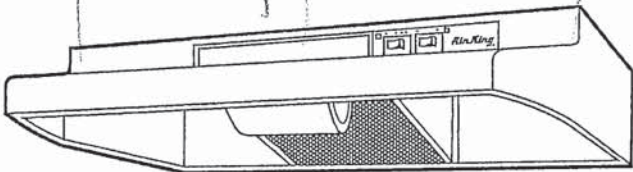

AV SERIES

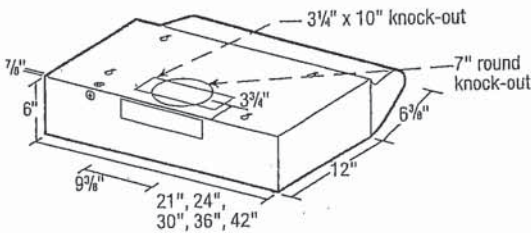

- Filters**
UL rated, class 2 filter.
Grease Filter: RF35 - 8⁷/₈"x10³/₈" (included).
Charcoal Filter: RF34 (not included).
Combo Grease/Charcoal: RF55 (not included).
- Available Finishes**
White, Biscuit, Almond, Black & Stainless Steel.

EXPANDED PERFORMANCE										
Air Flow - CFM	Static Pressure (inches of w.g.)						Sones @ .1 SP	Fan Speed RPM	Power Watts	Amps
	0	0.05	0.1	0.15	0.2	0.25				
Vertical Ducting High	246	232	218	203	181	147	7.5	2973	87.0	2.1
Horizontal Ducting High	225	210	180	175	155	120	7.0	3024	87.0	2.1

PROJECT				ARCHITECT						
LOCATION				ENGINEER						
CONTRACTOR				SUBMITTED BY				DATE		
FAN NUMBER	MODEL NUMBER	CFM	IN W.G.	RPM	WATTS	AMPS	SONES	QTY	OPTIONAL EQUIPMENT & REMARKS	



Air King: 820 Lincoln Avenue
West Chester, Pennsylvania 19380-4466
Tel: (610) 692-7400 • 877-304-3785
Fax: (610) 696-8048

Canada:
Brampton, Ontario
Tel: 905-456-2033
Fax: (905) 456-1015

Handwritten signature and initials