

Sales Selection Sheet
Checklist

1 of 53

LOT 3158 Model: 28-2897 B THE KINGSMERE

PURCHASERS: AH HUSSAIN, ALI SHAHNOOR, ALI AFSANA

VENDOR: Heathwood Homes (Huron) Limited

FIREPLACE BUILT OUT WALL

- ☐ OPTIONAL 4 BEDROOM PLAN WITH SECOND FLOOR FAMILY ROOM
- ☐ OPT. COFFERED CEILING IN GREAT ROOM & BREAKFAST ROOM
- ☐ OPT COFFERED CEILING IN DINING ROOM
- ☐ WOB
- ☐ DECK
- ☐ FINISHED BASEMENT
- ☐ COLD CELLAR

UPGRADED / MODIFIED ELEVATION

- ☐ CORNER UPGRADE
- ☐ REAR UPGRADE
- ☐ SIDE UPGRADE

CEILING UPGRADE - SMOOTH

- ☒ MAIN FLOOR
- ☐ SECOND FLOOR
- ☐ BASEMENT

ADDITIONAL ROUGH-INS

- ☒ 200 AMP SERVICE (STD IN SINGLES)
- ☐ WET BAR ROUGH-IN
- ☐ HUMIDIFIER
- ☒ AIR CONDITIONING (SITE STD)

GAS ROUGH-IN

- ☒ STOVE
- ☐ DRYER
- ☒ BBQ
- ☐ ADDITIONAL FIREPLACE

KITCHEN: HOODFAN VENTING SIZE

- ☒ 6 IN ROUND DUCT
- ☐ 7 IN ROUND DUCT

FULL BASEMENT STAIRS:

Paint Grade

UPPER BASEMENT STAIRS:

N/A

LOWER LEVEL STAIRS:

N/A

MAIN STAIRS:

All Oak

MEDIA STAIRS (if applicable):

N/A

LOFT STAIRS (if applicable):

N/A

May 10/23

Date

Purchaser:

May 10/23

Date

Decor Consultant:

SONIA SHARIF

Date

Purchaser:

Date

Heathwood Homes (Huron) Limited

Locked Date:

Approved

ALI HUSSAIN/
Project: Wallaceton
Unit: 3158, Phase: 3
Model: 28-2897 B THE KINGSMERE

Created: 11/3/2022 13:18:15
Locked:
Closed:

Kitchen

Cabinet Colour/Style	9166	Viking III-CHARLESTON-ORCHID-3DL ***STD***
Island Cabinet Colour/Style	9166	Viking III-CHARLESTON-NAVY BLUE-3DL ***STD***
Cabinet Hardware	9147	12817 BN NICKEL-HARDWARE ***2***
Countertop	8898	Group 6-Quartz-Caesarstone-MONT BLANC #5043-3/4 inch with built-up edge ***6***
Island Countertop	8898	Group 6-Quartz-Caesarstone-MONT BLANC #5043-3/4 inch with built-up edge ***6***
Countertop Edge	4005	DOUBLE MITRE 1 1/2 INCH ***UPG***

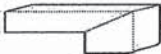

- Please note some islands may require a seam as per manufacturer and fabricator discretions.

Sink	9493	BLANCO QUATRUS U 1 SUPER SINGLE 401248 (min cabinet 36 in)	PG 30
HoodFan	8910	KVWB606DSS-KITCHEN AID 36 inch STAINLESS CHIMNEY HOOD-STAINLESS STEEL-36 inch ***Upg***	PG 41
Backsplash	1111	N/A *****	
Backsplash Grout	1111	N/A *****	
Backsplash Tile Pattern	1111	N/A *****	

Flooring	9556	Red Oak UVF-Vintage Solid Sawn Sculpted Character-TITANIUM-3/4 in x 5 in ***UPG***
Floor Tile Grout	1111	N/A *****
Floor Tile Pattern	1111	N/A *****

- Purchasers have been advised: standard fridge opening is a minimum 37 3/8 x 73 3/8 inches. Ice Waterline Rough-In is included.
- Standard stove opening is 30 inches and standard dishwasher opening is 24 inches. Any gas stove will require backsplash or stainless steel backing to avoid fire hazards.
- Purchasers acknowledge: Heathwood Homes and its contractors will not be responsible for any kitchen cabinet changes due to appliances dimension changes after sign-off.

Comment

Landing and Broom Closet

Flooring	9556	Red Oak UVF-Vintage Solid Sawn Sculpted Character-TITANIUM-3/4 in x 5 in ***UPG***
Floor Tile Grout	1111	N/A *****
Floor Tile Pattern	1111	N/A *****

AA
SA

ALI HUSSAIN/
Project: Wallaceton
Unit: 3158, Phase: 3
Model: 28-2897 B THE KINGSMERE

Created: 11/9/2022 13:18:15
Locked:
Closed:



Comment

Foyer

Flooring	9244	OV.ET.VLK.2424.PL-Eterna Volkas Polished White 24 x 24 UPG 6 ***UPG***
Floor Tile Grout	9244	Grout-(27) Silver ***STD***
Floor Tile Pattern	9244	STANDARD SQUARE ***STD***

Comment

Powder Room

Flooring	9244	OV.ET.VLK.2424.PL-Eterna Volkas Polished White 24 x 24 UPG 6 ***UPG***
Floor Tile Grout	9244	Grout-(27) Silver ***STD***
Floor Tile Pattern	9244	STANDARD SQUARE ***STD***

Plumbing Fixture (Colour)	9244	Plumbing Fixtures-WHITE ***STD***
---------------------------	------	-----------------------------------

Comment

Dining Room

Flooring	9556	Red Oak UVF-Vintage Solid Sawn Sculpted Character-TITANIUM-3/4 in x 5 in ***UPG***
----------	------	--

Comment

Main Hall

Flooring	9556	Red Oak UVF-Vintage Solid Sawn Sculpted Character-TITANIUM-3/4 in x 5 in ***UPG***
----------	------	--

Comment

Great/Breakfast

Flooring	9556	Red Oak UVF-Vintage Solid Sawn Sculpted Character-TITANIUM-3/4 in x 5 in ***UPG***
----------	------	--

AA
SA

ALI HUSSAIN/
Project: Wallaceton
Unit: 3158, Phase: 3
Model: 28-2897 B THE KINGSMERE

Created: 11/5/2022 13:16:15
Locked:
Closed:

Comment	5494
---------	------

Great Room Fireplace

Type	9556	Majestic MERC32 ***STD***
Mantle	8892	NF-17-Paint Grade Mantle-6 inch Deep Mantle (TV above Fireplace-WHITE) ***Upg***
Surround (Opt.)	1111	N/A *****

PG 29

- Purchasers have been advised: heat from the FP can damage TV above a FP and items placed on mantle.

- Heathwood and its contractors will not be liable for any damage on items placed/@installed above a FP after closing.

Comment	
---------	--

Mud Room / Laundry

Flooring	5494	GE.NA.GRY.1313-New Albion-Grey-13 x 13 ***STD***									
Floor Tile Grout	2225	Grout-(27) Silver ***STD***									
Floor Tile Pattern	3000	STANDARD SQUARE ***STD***									
		<table><tr><td></td><td></td><td></td></tr><tr><td></td><td></td><td></td></tr><tr><td></td><td></td><td></td></tr></table>									
Opt. Cabinet Colour/Style - Uppers	1111	N/A *****									
Opt. Cabinet Hardware - Uppers	1111	N/A *****									
Opt. Cabinet Colour/Style - Base	1111	N/A *****									
Opt. Cabinet Hardware - Base	1111	N/A *****									
Opt. Countertop	1111	N/A *****									
Opt. Countertop Edge	1111	N/A *****									

Comment	
---------	--

Upper Hall

Flooring	9504	87354-MINOTAUR-OVERCAST-40 oz Poly ***STD***
----------	------	--

Comment	
---------	--

Master Bedroom

Flooring	9504	87354-MINOTAUR-OVERCAST-40 oz Poly ***STD***
----------	------	--

Comment	
---------	--

AA
SA

ALI HUSSAIN/
Project: Wallaceton
Unit: 3158, Phase: 3
Model: 28-2897 B THE KINGSMERE

Created: 11/01/2022 13:18:48
Locked:
Closed:

Bedroom 2

Flooring	9504	87354-MINOTAUR-OVERCAST-40 oz Poly ***STD***
Comment		

Bedroom 3

Flooring	9504	87354-MINOTAUR-OVERCAST-40 oz Poly ***STD***
Comment		

Bedroom 4 (Reg. Second Floor)

Flooring	9504	87354-MINOTAUR-OVERCAST-40 oz Poly ***STD***
Comment		

Family Room (Opt. Second Floor)

Flooring	9504	87354-MINOTAUR-OVERCAST-40 oz Poly ***STD***
Comment		

Bedroom 5

Flooring	1111	N/A *****
Comment		

Master Ensuite

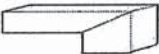
Cabinet Colour/Style	9111	Viking III-SIMCOE ORCHID 3DL ***STD***
Cabinet Hardware	7672	135-HARDWARE ***STD***
Countertop	8603	Group 3-Quartz-Caesarstone-STONE GREY#4030-3/4 inch with built-up edge ***3***
Countertop Edge	4005	DOUBLE MITRE 1 1/2 INCH ***UPG***
		
Floor Tile	9056	OV.ET.IGY.2424.PL-Eterna-Imperial Grey Polished-24 x 24 ***6***
Floor Tile Grout	2225	Grout-(27) Silver ***STD***
Floor Tile Pattern	3000	STANDARD SQUARE ***STD***

AA
SA

ALI HUSSAIN/ALI SHAHNOOR // ALI AFSANA
Project: Wallaceton
Unit: 3158, Phase: 3
Model: 28-2897 B THE KINGSMERE

Created: 11/9/2022 13:18:15
Locked:
Closed:

		<div></div>
Shower Wall Tile	9022	QT.WV.TGR.0810-Weave-Tender Grey-8 x 10 ***STD***
Shower Wall Tile Grout	2226	Grout-(00) White ***STD***
Shower Wall Tile Pattern	3090	VERTICAL STACKED ***STD***
		<div></div>
Shower Floor Tile	8104	OD.ON.TPE.02.HEX.MT-ONTARIO HEXAGON MATTE-TAUPE ***UG2B4***
Shower Floor Tile Grout	2226	Grout-(00) White ***STD***
Shower Floor Tile Pattern	3120	VERTICAL HEX ***STD***
		<div></div>
Shower Jamb(s) and Sill(s)	3120	Shower Jamb / Sill-Thassos White ***STD***
Plumbing Fixture (colour)	3120	Plumbing Fixtures-WHITE ***STD***
Comment		

Shared Ensuite

Cabinet Colour/Style	9111	Viking III-SIMCOE ORCHID 3DL ***STD***
Cabinet Hardware	7672	135-HARDWARE ***STD***
Countertop	8604	Group 3-Quartz-Caesarstone-RAVEN # 4120-3/4 inch with built-up edge ***4***
Countertop Edge	4007	GROUP 2 TO 7 - DOUBLE MITRE 1 1/2 INCH ***3***
		<div></div>
Floor Tile	9104	GE.MD.ANT.1818.MT Madison Series Antracite Matte 18 X 18 Matte ***1***
Floor Tile Grout	2225	Grout-(27) Silver ***STD***
Floor Tile Pattern	3000	STANDARD SQUARE ***STD***
		<div></div>
Shower Wall Tile	5411	QT.SP.WHT.0810-Splendour-White-8 inch x 10 inch ***STD***
Shower Wall Tile Grout	2226	Grout-(00) White ***STD***
Shower Wall Tile Pattern	3090	VERTICAL STACKED ***STD***
		<div></div>

SA AA

ALI HUSSAIN/ALI SHAHNOOR // ALI AFSANA
Project: Wallaceton
Unit: 3158, Phase: 3
Model: 28-2897 B THE KINGSMERE

Created: 11/9/2022 13:18:15
Locked:
Closed:

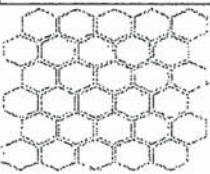
Shower Floor Tile	8108	OD.ON.DGR.02.HEX.MT-ONTARIO HEXAGON MATTE-DARK GREY ***UG2B4***
Shower Floor Tile Grout	2226	Grout-(00) White ***STD***
Shower Floor Tile Pattern	3120	VERTICAL HEX ***STD***
		
Shower Jamb(s) and Sill(s)	3120	Shower Jamb / Sill-Thassos White ***STD***
Plumbing Fixture (colour)	3120	Plumbing Fixtures-WHITE ***STD***
Comment		

Ensuite 4 (Reg. Second Floor)

Cabinet Colour/Style	1111	N/A *****
Cabinet Hardware	1111	N/A *****
Countertop	1111	N/A *****
Countertop Edge	1111	N/A *****
Floor Tile	1111	N/A *****
Floor Tile Grout	1111	N/A *****
Floor Tile Pattern	1111	N/A *****
Wall Tile	1111	N/A *****
Wall Tile Grout	1111	N/A *****
Wall Tile Pattern	1111	N/A *****
Opt. Shower Floor Tile	1111	N/A *****
Opt. Shower Floor Tile Grout	1111	N/A *****
Opt. Shower Floor Tile Pattern	1111	N/A *****
Opt. Shower Jamb(s) and Sill(s)	1111	N/A *****
Plumbing Fixture (colour)	1111	N/A *****
Comment		

SA AA

Customer Colours

ALI HUSSAIN/ALI SHAHNOOR // ALI AFSANA
Project: Wallaceton
Unit: 3158, Phase: 3
Model: 28-2897 B THE KINGSMERE

Created: 11/9/2022 13:18:15
Locked:
Closed:

Ensuite 5

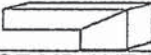
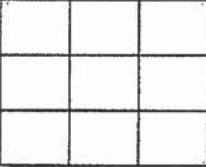
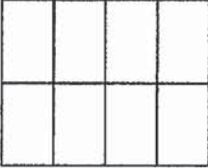
Cabinet Colour/Style	9111	Viking III-SIMCOE ORCHID 3DL ***STD***
Cabinet Hardware	7672	135-HARDWARE ***STD***
Countertop	8604	Group 3-Quartz-Caesarstone-RAVEN # 4120-3/4 inch with built-up edge ***4***
Countertop Edge	4007	GROUP 2 TO 7 - DOUBLE MITRE 1 1/2 INCH ***3***
Floor Tile	9104	 GE.MD.ANT.1818.MT Madison Series Antracite Matte 18 X 18 Matte ***1***
Floor Tile Grout	2225	Grout-(27) Silver ***STD***
Floor Tile Pattern	3000	STANDARD SQUARE ***STD*** 
Wall Tile	5411	QT.SP.WHT.0810-Splendour-White-8 inch x 10 inch ***STD***
Wall Tile Grout	2226	Grout-(00) White ***STD***
Wall Tile Pattern	3090	VERTICAL STACKED ***STD*** 
Opt. Shower Floor Tile	1111	N/A *****
Opt. Shower Floor Tile Grout	1111	N/A *****
Opt. Shower Floor Tile Pattern	1111	N/A *****
Opt. Shower Jamb(s) and Sill(s)	1111	N/A *****
Plumbing Fixture (colour)	1737	Plumbing Fixtures-WHITE ***STD***
Comment		

Lower Level Recreation Room (Opt. Finis

Flooring	1111	N/A *****
Comment		

Lower Level Bathroom (Opt. Finished Bas

Cabinet Colour/Style	1111	N/A *****
----------------------	------	-----------

SA AA

Customer Colours

ALI HUSSAIN/
Project: Wallaceton
Unit: 3158, Phase: 3
Model: 28-2897 B THE KINGSMERE

Created: 11/5/2022 13:18:10
Locked:
Closed:

Cabinet Hardware	1111	N/A *****
Countertop	1111	N/A *****
Countertop Edge	1111	N/A *****
Floor Tile	1111	N/A *****
Floor Tile Grout	1111	N/A *****
Floor Tile Pattern	1111	N/A *****
Wall Tile	1111	N/A *****
Wall Tile Grout	1111	N/A *****
Wall Tile Pattern	1111	N/A *****
Opt. Shower Floor Tile	1111	N/A *****
Opt. Shower Floor Tile Grout	1111	N/A *****
Opt. Shower Floor Tile Pattern	1111	N/A *****
Opt. Shower Jamb(s) and Sill(s)	1111	N/A *****
Plumbing Fixture (colour)	1111	N/A *****
Comment		

Main Stairs

Type	1714	Oak Stairs ***STD MAIN STAIRS***
Colour	7940	Sambucca STAIN TO COMPLIMENT HARDWOOD AND WILL VARY FROM FLOORING ***99***
Handrail/Pickets/Posts Type		
Handrail/Pickets/Posts Colour	7940	Sambucca STAIN TO COMPLIMENT HARDWOOD AND WILL VARY FROM FLOORING ***99***
Custom Stain/Paint	1111	N/A *****
Landing(s)	9059	Red Oak-Vintage 3 1/4 inch Pre-Sanded Smooth Unfinished Red Oak-Unfinished-3/4 inch x 3 1/4inch
Opt. Carpet Runner	9504	87354-MINOTAUR-OVERCAST-40 oz Poly ***STD***
Comment		

AA
SA

Customer Colours

ALI HUSSAIN/
Project: Wallaceton
Unit: 3158, Phase: 3
Model: 28-2897 B THE KINGSMERE

Created: 11/9/2022 13:18:10
Locked:
Closed:

Comment

Lower Level Stairs

Type	1713	Paint Grade Stairs ***STD UNFINISHED BASEMENT STAIRS
Colour	1111	N/A *****
Handrail/Pickets/Posts Type	1111	N/A *****
Handrail/Pickets/Posts Colour	1111	N/A *****
Custom Stain/Paint	1111	N/A *****
Landing(s)	1111	N/A *****
Opt. Carpet Runner	1111	N/A *****

Comment

Throughout

Switches and Plug	5796	Decora White Switches and Plugs ***STD***
Thresholds	2232	Metal Thresholds ***STD***
Underpad	1079	500 Series-Underpad ***STD***
Trim Size	8705	4 1/4 Baseboard and 2 3/4 Casings ***STD***
Trim - Paint Colour	1716	Trim-WHITE ***STD***
Walls - Paint Colour	1717	22-Wall-WARM GREY ***STD***

Comment

Purchaser: 

ALI HUSSAIN

14-Jan-23

Date



Decor Consultant

JAN 14, 2023.

Date

Purchaser: 

Wallaceton

14-Jan-23

Date



Wallaceton

-04-24-2023

Date Approved



CONSTRUCTION SUMMARY

Lot: 3158

Model: 28-2897 B THE KINGSMERE

Project/Phase: Wallaceton / 3

Offer	DELETED BY AMENDMENT - Five Appliances: SS Fridge, Stove, Chimney Hood Fan, Dishwasher: White Front Loader
Worksheet	Washer/Dryer (Singles) Note:
Offer	The Purchaser(s) acknowledge that they have NOT been referred by an existing Heathwood Homeowner and therefor are not entitled to a referral fee under Heathwood Homes Referral program.
Worksheet	Note:
Offer	ADDED BY AMENDMENT - SCHEDULE E: TEN THOUSAND (\$10,000) DOLLARS IN UPGRADES AT DECOR (NO CASH VALUE)
Worksheet	Note:
Offer	Optional 4 Bedroom plan with 2nd Floor Family room (The Kingsmere)
Worksheet	Note:



CONSTRUCTION SUMMARY

Lot: 3158
Model: 28-2897 B THE KINGSMERE
Project/Phase: Wallaceton / 3

ADMIN FEE

Invoice	Qty.	Description
---------	------	-------------

APPLIANCES

Invoice	Qty.	Description
1215 314,277 08Jan24 **	1	KITCHEN - GRANITE - GRANITE CUTOUT W/ STRAIGHT EDGE POLISH TO ACCOMMODATE COOK TOP SKETCH # 3 SEE 36" GAS COOKTOP SPECS
1215 313,490 08Jan24	1	KITCHEN - APPLIANCES - KITCHENAID 36 INCH CHIMNEY HOOD SS - KVWB606DSS SEE SPEC CABINETRY-delete stove uppers; ELECTRICAL-delete std range hood; HEATING/AIR CONDITIONING-Duct S change to 6 in

CABINETRY

Invoice	Qty.	Description
1445 313,832 10May23	-4	- D18-Upgrade levels 1-4, 5-7 drawers from Metabox to Tandembox per drawer. VBD x 3, VT x 1, DSK x 1 (Partial conversions on rooms not allowed.) Viking
1445 313,748 10May23	7	KITCHEN - B08-Upgrade levels 1-4, 5-7 drawers from Metabox to Tandembox per drawer. BD x 4, BPP x 3, BT x 1 (Partial conversions on rooms not allowed, pull-outs must also be converted.) Viking FOR BANK OF DRAWER (X4) AND BUILT-IN LAYOUT (X3) SKETCH # 3
1445 343,132 10May23 **	1	- GRANITE - COUNTERTOP WITH 4 IN BACKSPLASH - BED 5 ENS.5- GROUP 3 - UPG CABINETRY-delete std countertop; GRANITE-see std faucet and upgraded undermount sink specs
1445 10May23 NoCat	1	KITCHEN - REMOVE UPPER CABINETS AS PER SKETCH # 2 AND 3. CREDIT FOR PORTION OF VALANCE TRIM AND LIGHTING IN THIS AREA. DRYWAL-Notify; FRAMING-Modify Bulkhead; PAINTING-Notify
1215 313,552 08Jan24	1	KITCHEN - G02-Upgrade hardware for kitchen in a SINGLE or DETACHED model (stacked upper hardware is an additional charge see line G04 if applicable) Viking
1215 343,575 08Jan24	1	KITCHEN - CABINETRY - OPT. BUILT IN - VIKING II/III - UPG SKETCH # 3 SEE SPECS DRYWAL-Notify; FRAMING-Modify Bulkhead; GRANITE-delete partial countertop due to Built-in; PAINTING-
1215 314,124 08Jan24	1	- L01-Two-tone colour/style selection for island (must be of equal or lower level to main selection) Viking
1215 313,904 08Jan24	1	KITCHEN - B17-45cm wide pull-out door base cabinet waste/recycle centre with soft-close ([2] 35L bins per unit) (available only with 45cm wide cabinet) Viking SKETCH # 3 AND 6
1215 346,347 08Jan24	1	KITCHEN - CABINETRY - OPT LIGHT VALANCE (INCLUDE LIGHTING) - KITCHEN (ALL DOOR STYLES) - UPG ELECTRICAL-Complete Kitchen valance light including switch (Luminiz LED slimline strip light)



CONSTRUCTION SUMMARY

Lot: 3158
Model: 28-2897 B THE KINGSMERE
Project/Phase: Wallaceton / 3

CABINETRY

Invoice	Qty.	Description
1215 314,277 08Jan24 **	1	KITCHEN - GRANITE - GRANITE CUTOUT W/ STRAIGHT EDGE POLISH TO ACCOMMODATE COOK TOP SKETCH # 3 SEE 36" GAS COOKTOP SPECS
1215 313,490 08Jan24 **	1	KITCHEN - APPLIANCES - KITCHENAID 36 INCH CHIMNEY HOOD SS - KVWB606DSS SEE SPEC CABINETRY-delete stove uppers; ELECTRICAL-delete std range hood; HEATING/AIR CONDITIONING-Duct S change to 6 in
1215 314,279 08Jan24 **	2	- GRANITE - GRANITE CUTOUT W/ STRAIGHT EDGE POLISH TO ACCOMMODATE UNDER MOUNT VANITY SINK 1X SHARED ENSUITE 1X ENSUITE 5 SKETCH # 4 SEE SPECS
1215 313,832 08Jan24	4	KITCHEN - D18-Upgrade levels 1-4, 5-7 drawers from Metabox to Tandembox per drawer. VBD x 3, VT x 1, DSK x 1 (Partial conversions on rooms not allowed.) Viking UPGRADE THE BANK OF DRAWERS TO SOFT CLOSE, 4X DRAWERS SKETCH # 3
1215 346,756 08Jan24 **	1	KITCHEN - HARDWOOD - VINTAGE 5 IN RED OAK - UVF OIL OR SCULPTED - KITCHEN - UPG CABINETRY-Raise Cabinet; CERAMICS-Delete Std Ceramics
1215 314,410 08Jan24 **	1	- PLUMBING - KITCHEN SINK UPGRADE - BLANCO KITCHEN SINK QUATRUS U 1 MAXI #401248 (32 INCH X 18 INCH) UNDERMOUNT 1 BOWL 9 INCH DEEP IN STAINLESS STEEL - CABINETRY-see specs for upgraded kitchen sink; GRANITE-see specs for upgraded kitchen sink
1215 343,130 08Jan24 **	1	- GRANITE - COUNTERTOP WITH 4 IN BACKSPLASH - SHARED BATH - GROUP 3 - UPG CABINETRY-delete std countertop; GRANITE-see std faucet and upgraded undermount sink specs

CARPET

Invoice	Qty.	Description
1215 348,119 08Jan24	1	- CARPET - CARPET RUNNER - 400Z POLY - UPG



CONSTRUCTION SUMMARY

Lot: 3158
Model: 28-2897 B THE KINGSMERE
Project/Phase: Wallaceton / 3

CERAMICS

Invoice	Qty.	Description
1445 345,193 10May23	1	- CERAMICS - BATH 5 FLOOR - UPG 1
1445 345,194 10May23	1	- CERAMICS - SHARED BATH 2/3 FLOOR - UPG 1
1215 346,757 08Jan24 **	1	KITCHEN / HALL CLOSET - HARDWOOD - VINTAGE 5 IN RED OAK - UVF OIL OR SCULPTED - KITCHEN / HALL CLOSET - UPG CABINETRY-Raise Cabinet; CERAMICS-Delete Std Ceramics; Interior Stairs-Adjust riser height where applicabl
1215 345,304 08Jan24	1	- CERAMICS - FOYER FLOOR - UPG 6
1215 345,305 08Jan24	1	- CERAMICS - POWDER FLOOR - UPG 6
1215 345,311 08Jan24	1	- CERAMICS - M.ENS BATH FLOOR - UPG 6
1215 346,756 08Jan24 **	1	KITCHEN - HARDWOOD - VINTAGE 5 IN RED OAK - UVF OIL OR SCULPTED - KITCHEN - UPG CABINETRY-Raise Cabinet; CERAMICS-Delete Std Ceramics
1215 345,210 08Jan24	1	- CERAMICS - MASTER SHOWER FLOOR - UPG 2
1215 345,209 08Jan24	1	- CERAMICS - SHARED 2/3 SHOWER FLOOR - UPG 2

COFFERED CEILING

Invoice	Qty.	Description
1215 345,658 08Jan24	1	DINING ROOM - COFFERED CEILING - OPT. COFFERED CEILING - DINING ROOM SKETCH # 2 DRYWALL-Notify; FRAMING-Notify; PAINTING-Notify
1215 345,657 08Jan24	1	GREAT ROOM AND BREAKFAST - COFFERED CEILING - OPT. COFFERED CEILING - GREAT ROOM AND BREAKFAST SKETCH # 2 DRYWALL-Notify; FRAMING-Notify; PAINTING-Notify



CONSTRUCTION SUMMARY

Lot: 3158
Model: 28-2897 B THE KINGSMERE
Project/Phase: Wallaceton / 3

DRYWALL

Invoice	Qty.	Description
1445 10May23 ** NoCat	1	KITCHEN - REMOVE UPPER CABINETS AS PER SKETCH # 2 AND 3. CREDIT FOR PORTION OF VALANCE TRIM AND LIGHTING IN THIS AREA. DRYWAL-Notify; FRAMING-Modify Bulkhead; PAINTING-Notify
1215 345,689 08Jan24	1	MAIN FLOOR - DRYWALL - SMOOTH CEILING IN MAIN FLOOR - UPG PAINTING-Paint Smooth Ceiling
1215 343,575 08Jan24 **	1	KITCHEN - CABINETRY - OPT. BUILT IN - VIKING II/III - UPG SKETCH # 3 SEE SPECS DRYWAL-Notify; FRAMING-Modify Bulkhead; GRANITE-delete partial countertop due to Built-in; PAINTING-
1215 314,346 08Jan24 **	3	- INTERIOR TRIM - UPGRADE FROM STANDARD 6 FT 8 INCH 2 PANEL HOLLOW CORE SINGLE DOOR TO 8 FT 2 PANEL HOLLOW CORE SINGLE DOOR DRYWALL-Notify;FRAMING-Notify;PAINTING-paint upgraded door and frame 1X FRONT FOYER CLOSET DOOR 1X POWDER ROOM DOOR 1X DOOR TO THE BASEMENT SEE SKETCH # 2
1215 345,658 08Jan24 **	1	DINING ROOM - COFFERED CEILING - OPT. COFFERED CEILING - DINING ROOM SKETCH # 2 DRYWALL-Notify; FRAMING-Notify; PAINTING-Notify
1215 345,657 08Jan24 **	1	GREAT ROOM AND BREAKFAST - COFFERED CEILING - OPT. COFFERED CEILING - GREAT ROOM AND BREAKFAST SKETCH # 2 DRYWALL-Notify; FRAMING-Notify; PAINTING-Notify
1215 346,366 08Jan24 **	1	GREAT ROOM - FIREPLACE AND MANTLE - BUILT OUT WALL ABOVE FIREPLACE SKETCH # 2 AND 7 DRYWALL-notify; ELECTRICAL-notify; FRAMING-notify; HEATING/AIR CONDITIONING-notify; INTERIOR TRIM-notify; PAINTING-notify



CONSTRUCTION SUMMARY

Lot: 3158
Model: 28-2897 B THE KINGSMERE
Project/Phase: Wallaceton / 3

ELECTRICAL

Invoice	Qty.	Description
1445 314,242 10May23	1	BREAKFAST - ELECTRICAL - RELOCATION OF SWITCHES/LIGHTS (MUST SPECIFY LOCATION) - NOTE: PLUGS CANNOT BE RELOCATED- MUST PURCHASE ADDITIONAL OUTLET. RELOCATE STANDARD LIGHT 2.5 FROM REAR OF ROOM AND 3.0 FROM SIDE OF ROOM SKETCH # 2
1215 345,787 08Jan24	2	KITCHEN - ELECTRICAL - CEILING ROUGH-IN (CAPPED) 3x R/I CAPPED LIGHT, EVENLY SPACED ABOVE BREAKFAST COUNTER SKETCH # 2
1215 314,224 08Jan24	1	KITCHEN - ELECTRICAL - CEILING ROUGH-IN (CAPPED) INCLUDING SWITCH ABOVE BREAKFAST COUNTER, EVENLY SPACED TOTAL OF 3 ON ONE SEPARATE SWITCH SKETCH # 2
1215 346,347 08Jan24 **	1	KITCHEN - CABINETRY - OPT LIGHT VALANCE (INCLUDE LIGHTING) - KITCHEN (ALL DOOR STYLES) - UPG ELECTRICAL-Complete Kitchen valance light including switch (Luminiz LED slimline strip light)
1215 314,277 08Jan24 **	1	KITCHEN - GRANITE - GRANITE CUTOUT W/ STRAIGHT EDGE POLISH TO ACCOMMODATE COOK TOP SKETCH # 3 SEE 36" GAS COOKTOP SPECS
1215 313,490 08Jan24 **	1	KITCHEN - APPLIANCES - KITCHENAID 36 INCH CHIMNEY HOOD SS - KVWB606DSS SEE SPEC CABINETRY-delete stove uppers; ELECTRICAL-delete std range hood; HEATING/AIR CONDITIONING-Duct S change to 6 in
1215 314,340 08Jan24 **	1	- HEATING/AIR - ROUGH-IN GAS LINE FOR GAS STOVE AT MAIN FLOOR (SEE SPECS) (HOOK-UP NOT INCLUDED) LEAVE STANDARD 120 VOLT ELECTRICAL OUTLET ON A SEPARATE CIRCUIT. * SPECIFY IF STANDARD 220V WILL STAY OR BE RELOCATED ELECTRICAL-Notify
1215 314,242 08Jan24	1	KITCHEN - ELECTRICAL - RELOCATION OF SWITCHES/LIGHTS (MUST SPECIFY LOCATION) - NOTE: PLUGS CANNOT BE RELOCATED- MUST PURCHASE ADDITIONAL OUTLET. RELOCATE STD 220V PLUG TO BUILT IN OVEN/MICRO LOCATION SKETCH # 3 SEE SPECS
1215 314,232 08Jan24	1	GREAT ROOM - ELECTRICAL - EXTRA WALL INTERIOR OUTLET ON EXISTING CIRCUIT (DOES NOT INCLUDE KITCHEN OUTLETS) +/- CENTERED ABOVE FIREPLACE, +/- 70" FROM FLOOR SKETCH # 2
1215 346,366 08Jan24 **	1	GREAT ROOM - FIREPLACE AND MANTLE - BUILT OUT WALL ABOVE FIREPLACE SKETCH # 2 AND 7 DRYWALL-notify; ELECTRICAL-notify; FRAMING-notify; HEATING/AIR CONDITIONING-notify; INTERIOR TRIM-notify; PAINTING-notify

FIREPLACE AND MANTLE

Invoice	Qty.	Description
1215 346,366 08Jan24	1	GREAT ROOM - FIREPLACE AND MANTLE - BUILT OUT WALL ABOVE FIREPLACE SKETCH # 2 AND 7 DRYWALL-notify; ELECTRICAL-notify; FRAMING-notify; HEATING/AIR CONDITIONING-notify; INTERIOR TRIM-notify; PAINTING-notify



CONSTRUCTION SUMMARY

Lot: 3158
Model: 28-2897 B THE KINGSMERE
Project/Phase: Wallaceton / 3

FRAMING

Invoice	Qty.	Description
1445 10May23 ** NoCat	1	KITCHEN - REMOVE UPPER CABINETS AS PER SKETCH # 2 AND 3. CREDIT FOR PORTION OF VALANCE TRIM AND LIGHTING IN THIS AREA. DRYWAL-Notify; FRAMING-Modify Bulkhead; PAINTING-Notify
1215 343,575 08Jan24 **	1	KITCHEN - CABINETRY - OPT. BUILT IN - VIKING II/III - UPG SKETCH # 3 SEE SPECS DRYWAL-Notify; FRAMING-Modify Bulkhead; GRANITE-delete partial countertop due to Built-in; PAINTING-
1215 314,346 08Jan24 **	3	- INTERIOR TRIM - UPGRADE FROM STANDARD 6 FT 8 INCH 2 PANEL HOLLOW CORE SINGLE DOOR TO 8 FT 2 PANEL HOLLOW CORE SINGLE DOOR DRYWALL-Notify;FRAMING-Notify;PAINTING-paint upgraded door and frame 1X FRONT FOYER CLOSET DOOR 1X POWDER ROOM DOOR 1X DOOR TO THE BASEMENT SEE SKETCH # 2
1215 345,658 08Jan24 **	1	DINING ROOM - COFFERED CEILING - OPT. COFFERED CEILING - DINING ROOM SKETCH # 2 DRYWALL-Notify; FRAMING-Notify; PAINTING-Notify
1215 345,657 08Jan24 **	1	GREAT ROOM AND BREAKFAST - COFFERED CEILING - OPT. COFFERED CEILING - GREAT ROOM AND BREAKFAST SKETCH # 2 DRYWALL-Notify; FRAMING-Notify; PAINTING-Notify
1215 346,366 08Jan24 **	1	GREAT ROOM - FIREPLACE AND MANTLE - BUILT OUT WALL ABOVE FIREPLACE SKETCH # 2 AND 7 DRYWALL-notify; ELECTRICAL-notify; FRAMING-notify; HEATING/AIR CONDITIONING-notify; INTERIOR TRIM-notify; PAINTING-notify

GLASS PRODUCTS / MIRRORS

Invoice	Qty.	Description
1215 345,705 08Jan24	1	- GLASS PRODUCTS / MIRRORS - UPGRADE TO FRAMELESS CLEAR GLASS WITH D-RING HANDLE IN CHROME - ENSUITE MASTER - UPG
1215 345,706 08Jan24	1	- GLASS PRODUCTS / MIRRORS - UPGRADE TO FRAMELESS CLEAR GLASS WITH D-RING HANDLE IN CHROME - SHARED BATHROOM - UPG



CONSTRUCTION SUMMARY

Lot: 3158
Model: 28-2897 B THE KINGSMERE
Project/Phase: Wallaceton / 3

GRANITE

Invoice	Qty.	Description
1445 343,132 10May23	1	- GRANITE - COUNTERTOP WITH 4 IN BACKSPLASH - BED 5 ENS.5- GROUP 3 - UPG CABINETRY-delete std countertop; GRANITE-see std faucet and upgraded undermount sink specs
1445 314,369 10May23 **	2	- PLUMBING - AMERICAN STANDARD - SINK OPTIONS - UNDERMOUNT SINK - OVALYN MODEL 0496 221 020 (19 ¼ INCH X 16 ¼ INCH) - FOR SHARED BATHROOM AND ENSUITE 5 BATHROOM GRANITE-see upgraded undermount sink specs
1215 343,575 08Jan24 **	1	KITCHEN - CABINETRY - OPT. BUILT IN - VIKING II/III - UPG SKETCH # 3 SEE SPECS DRYWAL-Notify; FRAMING-Modify Bulkhead; GRANITE-delete partial countertop due to Built-in; PAINTING-
1215 314,277 08Jan24	1	KITCHEN - GRANITE - GRANITE CUTOUT W/ STRAIGHT EDGE POLISH TO ACCOMMODATE COOK TOP SKETCH # 3 SEE 36" GAS COOKTOP SPECS
1215 314,279 08Jan24	2	- GRANITE - GRANITE CUTOUT W/ STRAIGHT EDGE POLISH TO ACCOMMODATE UNDER MOUNT VANITY SINK 1X SHARED ENDSUITE 1X ENSUITE 5 SKETCH # 4 SEE SPECS
1215 314,410 08Jan24 **	1	- PLUMBING - KITCHEN SINK UPGRADE - BLANCO KITCHEN SINK QUATRUS U 1 MAXI #401248 (32 INCH X 18 INCH) UNDERMOUNT 1 BOWL 9 INCH DEEP IN STAINLESS STEEL - CABINETRY-see specs for upgraded kitchen sink; GRANITE-see specs for upgraded kitchen sink
1215 314,272 08Jan24	1	KITCHEN - GRANITE - DRILL ADDITIONAL HOLE ON COUNTERTOP FOR FUTURE SOAP DISPENSER ON THE LEFT SIDE OF THE KITCHEN FAUCET SKETCH # 3 SEE SPEC GRANITE-see specs
1215 343,129 08Jan24	1	- GRANITE - COUNTERTOP WITH 4 IN BACKSPLASH - MASTER ENSUITE - GROUP 3 - UPG
1215 343,130 08Jan24	1	- GRANITE - COUNTERTOP WITH 4 IN BACKSPLASH - SHARED BATH - GROUP 3 - UPG CABINETRY-delete std countertop; GRANITE-see std faucet and upgraded undermount sink specs
1215 343,146 08Jan24	1	- GRANITE - KITCHEN / ISLAND - GROUP 6 - UPG



CONSTRUCTION SUMMARY

Lot: 3158
Model: 28-2897 B THE KINGSMERE
Project/Phase: Wallaceton / 3

HARDWOOD

Invoice	Qty.	Description
1215 346,757 08Jan24	1	KITCHEN / HALL CLOSET - HARDWOOD - VINTAGE 5 IN RED OAK - UVF OIL OR SCULPTED - KITCHEN / HALL CLOSET - UPG CABINETRY-Raise Cabinet; CERAMICS-Delete Std Ceramics; Interior Stairs-Adjust riser height where applicable
1215 345,859 08Jan24	1	MAIN HALL - HARDWOOD - VINTAGE 5 IN RED OAK - UVF OIL OR SCULPTED - MAIN HALL - UPG
1215 314,351 08Jan24 **	3	- PAINT - STAIN STAIR LANDING IN SAMBUCCA. LANDING OVER 25 SQ.FT. EACH HARDWOOD-Supply and Install smooth UNFINISHED pre-sanded red oak at stair landing(s)
1215 346,756 08Jan24	1	KITCHEN - HARDWOOD - VINTAGE 5 IN RED OAK - UVF OIL OR SCULPTED - KITCHEN - UPG CABINETRY-Raise Cabinet; CERAMICS-Delete Std Ceramics
1215 345,857 08Jan24	1	GREAT ROOM / BREAKFAST - HARDWOOD - VINTAGE 5 IN RED OAK - UVF OIL OR SCULPTED - GREAT ROOM / BREAKFAST - UPG
1215 345,858 08Jan24	1	DINING ROOM - HARDWOOD - VINTAGE 5 IN RED OAK - UVF OIL OR SCULPTED - DINING ROOM - UPG

HEATING / AIR CONDITIONING

Invoice	Qty.	Description
1215 313,490 08Jan24 **	1	KITCHEN - APPLIANCES - KITCHENAID 36 INCH CHIMNEY HOOD SS - KVWB606DSS SEE SPEC CABINETRY-delete stove uppers; ELECTRICAL-delete std range hood; HEATING/AIR CONDITIONING-Duct S change to 6 in
1215 314,340 08Jan24	1	- HEATING/AIR - ROUGH-IN GAS LINE FOR GAS STOVE AT MAIN FLOOR (SEE SPECS) (HOOK-UP NOT INCLUDED) LEAVE STANDARD 120 VOLT ELECTRICAL OUTLET ON A SEPARATE CIRCUIT. * SPECIFY IF STANDARD 220V WILL STAY OR BE RELOCATED ELECTRICAL-Notify
1215 314,337 08Jan24	1	- HEATING/AIR - ROUGH-IN GAS LINE FOR BBQ AT MAIN FLOOR UP TO 40 FT (QUICK CONNECT NOT INCLUDED); ELECTR ICAL OUTLET PRICED SEPARATELY IF REQUIRED
1215 346,366 08Jan24 **	1	GREAT ROOM - FIREPLACE AND MANTLE - BUILT OUT WALL ABOVE FIREPLACE SKETCH # 2 AND 7 DRYWALL-notify; ELECTRICAL-notify; FRAMING-notify; HEATING/AIR CONDITIONING-notify; INTERIOR TRIM-notify; PAINTING-notify

INTERIOR STAIRS

Invoice	Qty.	Description
1215 346,757 08Jan24 **	1	KITCHEN / HALL CLOSET - HARDWOOD - VINTAGE 5 IN RED OAK - UVF OIL OR SCULPTED - KITCHEN / HALL CLOSET - UPG CABINETRY-Raise Cabinet; CERAMICS-Delete Std Ceramics; Interior Stairs-Adjust riser height where applicable



CONSTRUCTION SUMMARY

Lot: 3158
Model: 28-2897 B THE KINGSMERE
Project/Phase: Wallaceton / 3

INTERIOR TRIM AND DOORS

Invoice	Qty.	Description
1215 314,346 08Jan24	3	- INTERIOR TRIM - UPGRADE FROM STANDARD 6 FT 8 INCH 2 PANEL HOLLOW CORE SINGLE DOOR TO 8 FT 2 PANEL HOLLOW CORE SINGLE DOOR DRYWALL-Notify;FRAMING-Notify;PAINTING-paint upgraded door and frame 1X FRONT FOYER CLOSET DOOR 1X POWDER ROOM DOOR 1X DOOR TO THE BASEMENT SEE SKETCH # 2
1215 346,366 08Jan24 **	1	GREAT ROOM - FIREPLACE AND MANTLE - BUILT OUT WALL ABOVE FIREPLACE SKETCH # 2 AND 7 DRYWALL-notify; ELECTRICAL-notify; FRAMING-notify; HEATING/AIR CONDITIONING-notify; INTERIOR TRIM-notify; PAINTING-notify

PAINTING

Invoice	Qty.	Description
1445 10May23 ** NoCat	1	KITCHEN - REMOVE UPPER CABINETS AS PER SKETCH # 2 AND 3. CREDIT FOR PORTION OF VALANCE TRIM AND LIGHTING IN THIS AREA. DRYWAL-Notify; FRAMING-Modify Bulkhead; PAINTING-Notify
1215 345,689 08Jan24 **	1	MAIN FLOOR - DRYWALL - SMOOTH CEILING IN MAIN FLOOR - UPG PAINTING-Paint Smooth Ceiling
1215 343,575 08Jan24 **	1	KITCHEN - CABINETRY - OPT. BUILT IN - VIKING II/III - UPG SKETCH # 3 SEE SPECS DRYWAL-Notify; FRAMING-Modify Bulkhead; GRANITE-delete partial countertop due to Built-in; PAINTING-
1215 314,351 08Jan24	3	- PAINT - STAIN STAIR LANDING IN SAMBUCCA. LANDING OVER 25 SQ.FT. EACH HARDWOOD-Supply and Install smooth UNFINISHED pre-sanded red oak at stair landing(s)
1215 314,346 08Jan24 **	3	- INTERIOR TRIM - UPGRADE FROM STANDARD 6 FT 8 INCH 2 PANEL HOLLOW CORE SINGLE DOOR TO 8 FT 2 PANEL HOLLOW CORE SINGLE DOOR DRYWALL-Notify;FRAMING-Notify;PAINTING-paint upgraded door and frame 1X FRONT FOYER CLOSET DOOR 1X POWDER ROOM DOOR 1X DOOR TO THE BASEMENT SEE SKETCH # 2
1215 345,658 08Jan24 **	1	DINING ROOM - COFFERED CEILING - OPT. COFFERED CEILING - DINING ROOM SKETCH # 2 DRYWALL-Notify; FRAMING-Notify; PAINTING-Notify
1215 345,657 08Jan24 **	1	GREAT ROOM AND BREAKFAST - COFFERED CEILING - OPT. COFFERED CEILING - GREAT ROOM AND BREAKFAST SKETCH # 2 DRYWALL-Notify; FRAMING-Notify; PAINTING-Notify
1215 346,366 08Jan24 **	1	GREAT ROOM - FIREPLACE AND MANTLE - BUILT OUT WALL ABOVE FIREPLACE SKETCH # 2 AND 7 DRYWALL-notify; ELECTRICAL-notify; FRAMING-notify; HEATING/AIR CONDITIONING-notify; INTERIOR TRIM-notify; PAINTING-notify



CONSTRUCTION SUMMARY

Lot: 3158
Model: 28-2897 B THE KINGSMERE
Project/Phase: Wallaceton / 3

PLUMBING

Invoice	Qty.	Description
1445 314,369 10May23	2	- PLUMBING - AMERICAN STANDARD - SINK OPTIONS - UNDERMOUNT SINK - OVALYN MODEL 0496 221 020 (19 ¼ INCH X 16 ¼ INCH) - FOR SHARED BATHROOM AND ENSUITE 5 BATHROOM GRANITE-see upgraded undermount sink specs
1215 314,410 08Jan24	1	- PLUMBING - KITCHEN SINK UPGRADE - BLANCO KITCHEN SINK QUATRUS U 1 MAXI #401248 (32 INCH X 18 INCH) UNDERMOUNT 1 BOWL 9 INCH DEEP IN STAINLESS STEEL - CABINETRY-see specs for upgraded kitchen sink; GRANITE-see specs for upgraded kitchen sink
1215 314,506 08Jan24	1	- PLUMBING - MOEN -SOAP DISPENSERS - CHROME (MODEL: 3942) - GRANITE-see specs

THE KINGSMERE

ELEVATION B | 2,888 SQ. FT.

922 sq. ft. of opt. finished Lower Level

WALLACETON
EST. 1870

28-2897 ELEV. B

Sketch #1

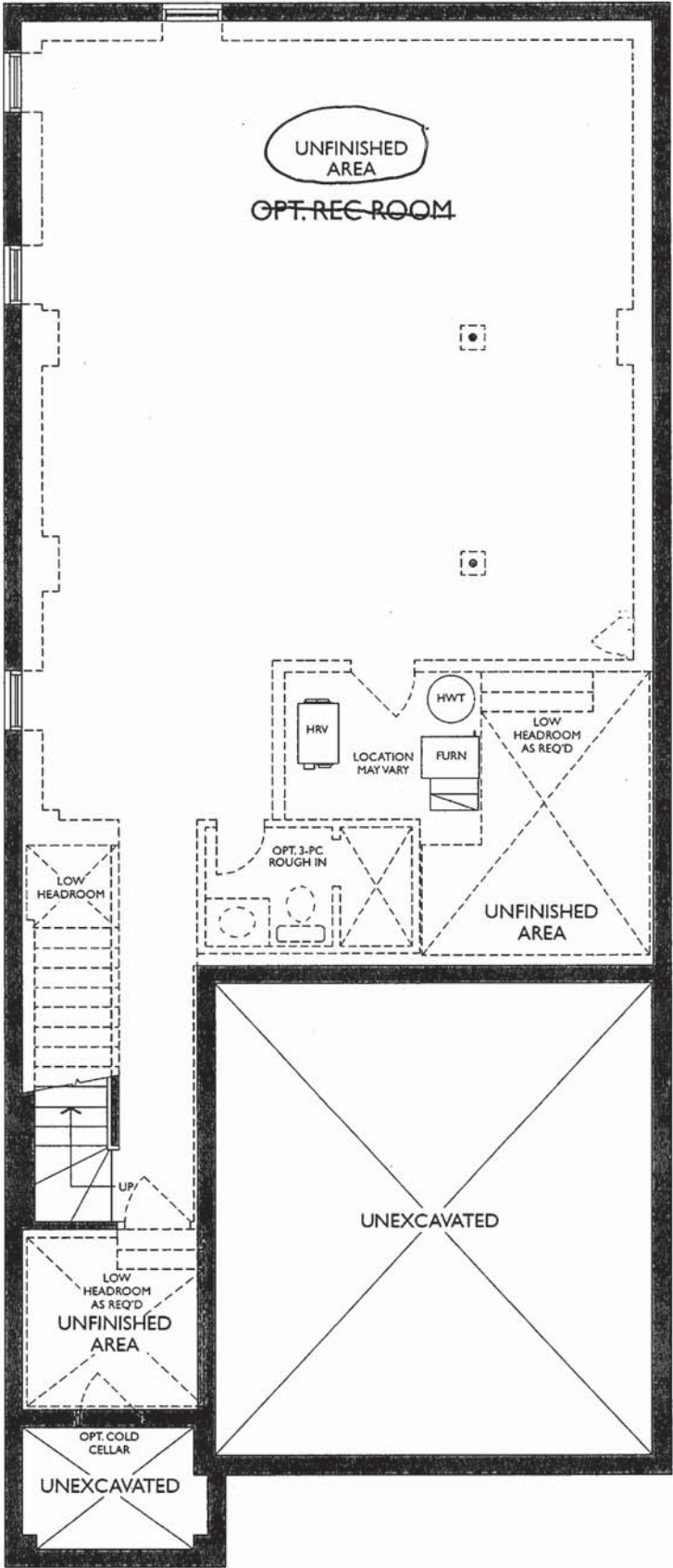

LOWER LEVEL
ELEVATION A & B

AA
SA

THE KINGSMERE

ELEVATION B | 2,888 SQ. FT.
922 sq. ft. of opt. finished Lower Level

28-2897 ELEV. B

Sketch #2

WALLACETON
EST. 1870

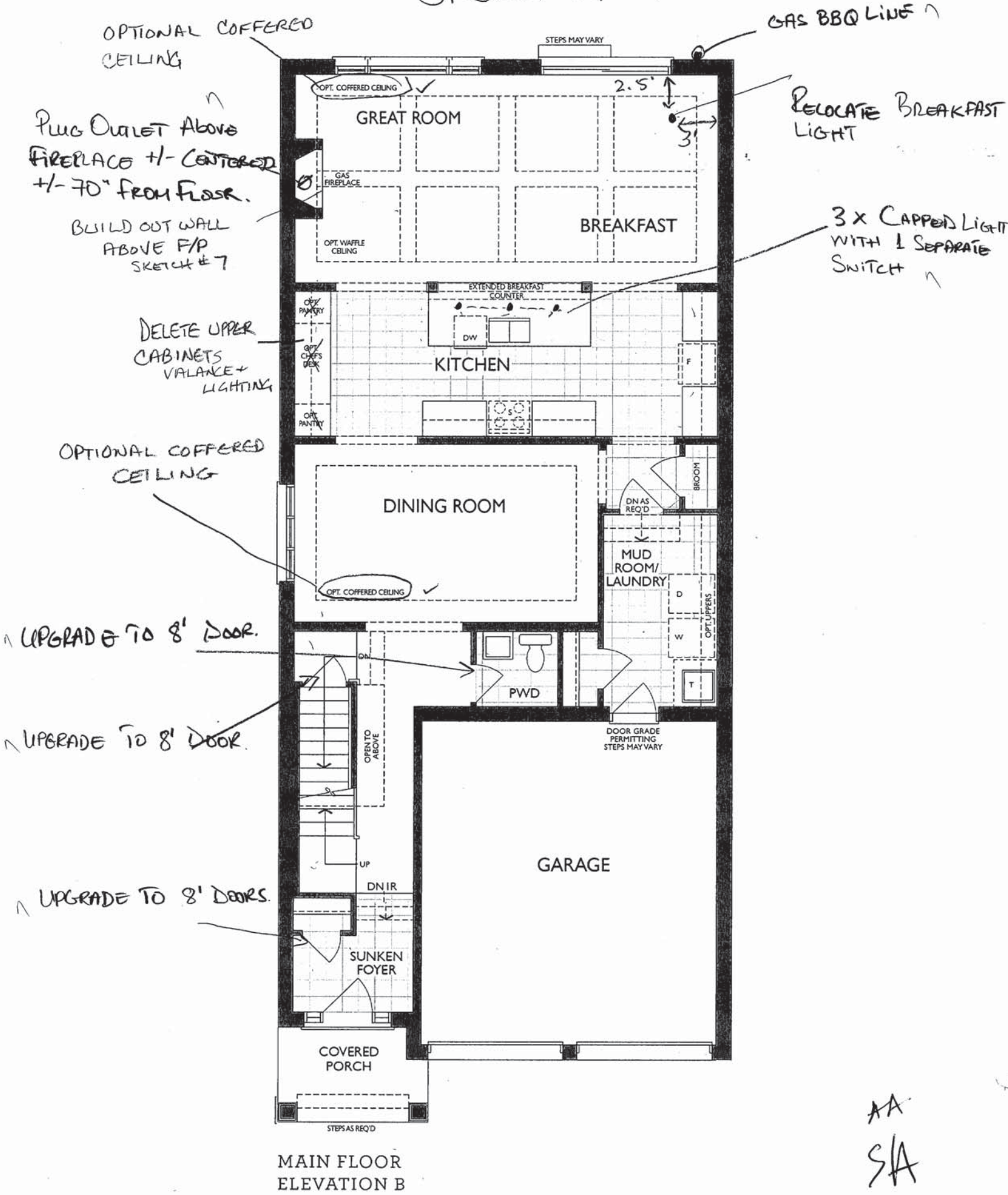

AA
S/A

UPGRADE KITCHEN - BUILT-IN APPLIANCES:
- 30" COOKTOP POTS & PANS
- 30" WALL OVEN

24 of 53

Project: Wallaceton
Unit: 3158, Phase: 3
Model: 28-2897 B THE KINGSMERE

9/20/2022

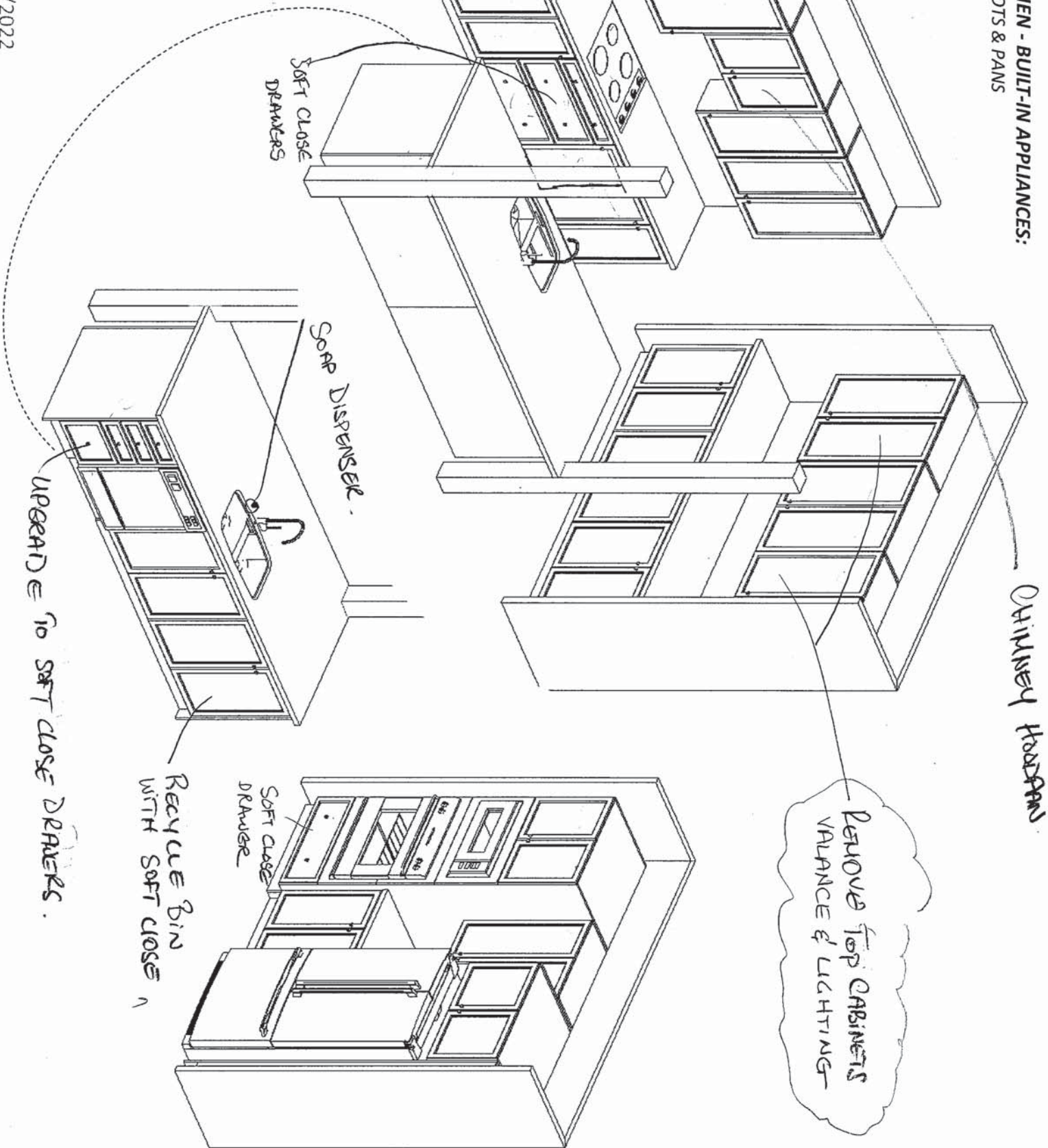

F R E N D E L
K I T C H E N S L I M I T E D
1350 Shawson Drive, Mississauga, ON L4W 1C5

HEATHWOOD HOMES
WALLACETON, KITCHENER ON
MODEL: 28-2897 (3404)

STANDARD CONTRACT INCLUDES:

Appliance Openings

- Hood Opening: 30" W Builder hood
- Fridge Opening: 37 3/8 "W X 73 3/8"
- Fridge cabinet & gables: 66cm Deep
- Stove Opening: 30" Freestanding
- Dishwasher Opening: 24"

Standard Kitchens Scope:

- 100cm H wall cabinets
- Std. Blumotion Hinges- **soft close**
- Std. Metabox Drawers- **not soft close**
- Min 40cm W drawer
- Base pie cut corner cabinets
- Backing on all cabinets
- Countertop by others
- Upgrade applied paneled fridge & dishwashers supply only (appliance hardware by others)

Standard Vanity & Laundry Scope:

- Powder by others, pedestal
- Master Ens. - Top by others
- Remaining vanities inc. laminate top
- Std. Blum Hinges- **not soft close**
- Std. Metabox Drawers- **not soft close**
- Master Ens: Top drawers(Sink Full height)
- Mains: Full height doors (top drawers added if Masters can't accommodate)
- Optional laundry base & wall cabinets

THE KINGSMERE

ELEVATION B | 2,888 SQ. FT.

922 sq. ft. of opt. finished Lower Level

WALLACETON
EST. 1870

28-2897 ELEV. B

Sketch #4

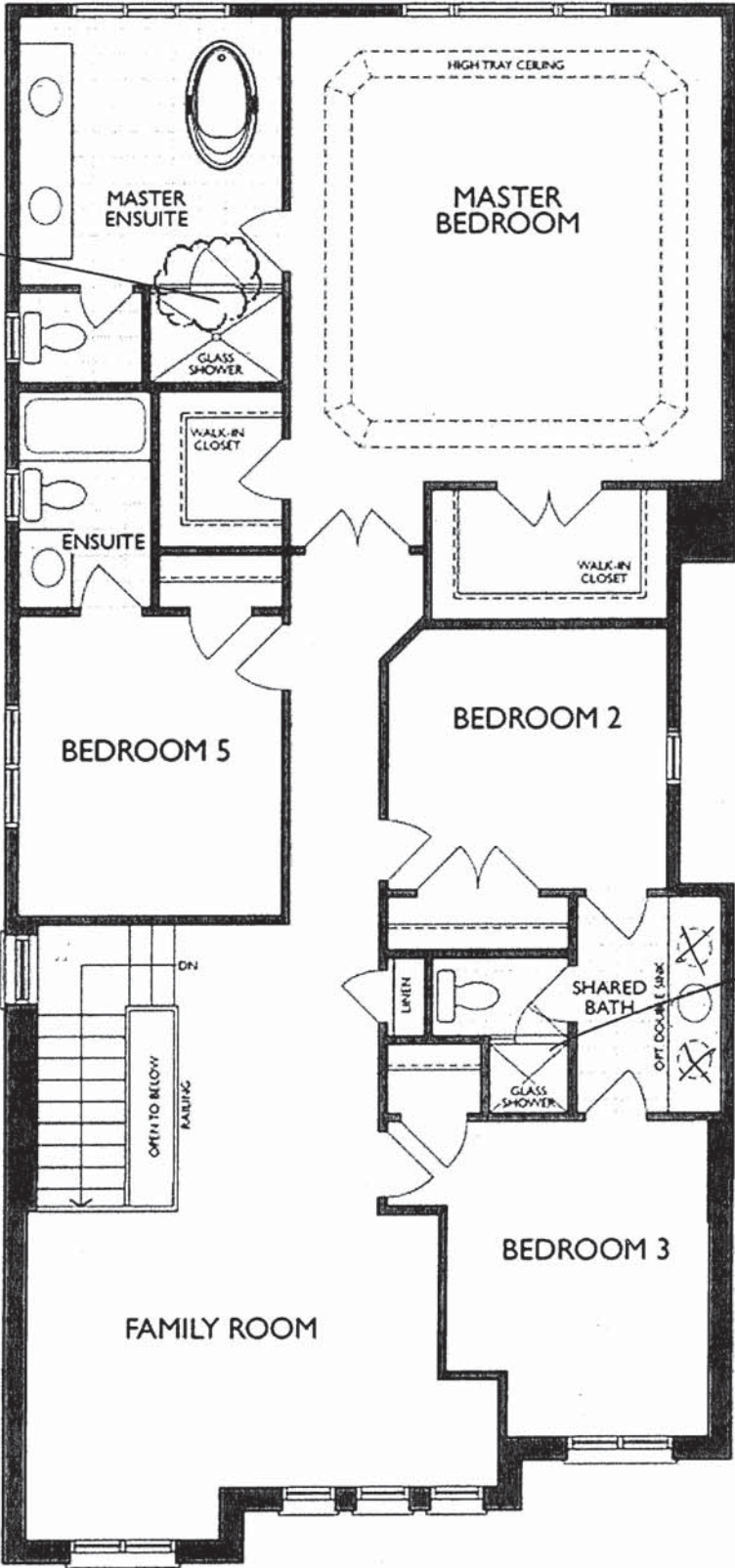

OPT. SECOND FLOOR
WITH 4 BEDROOM & FAMILY ROOM
ELEVATION B

* Master Ensuite Shower Door Swing Changed

AA
SA

(3404) STANDARD 2ND FLOOR

MASTER ENSUITE

(2ND FLR - ELEV: A, B, C)

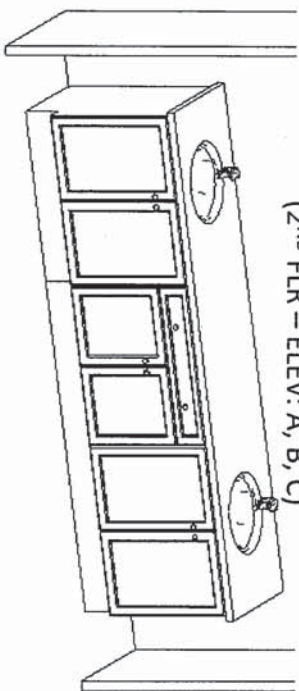

ENSUITE 3

(2ND FLR - ELEV: A, B, C)

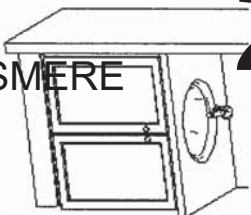

SHARED ENSUITE

(2ND FLR - ELEV: A, B, C)

(OPT. DBL SINK)

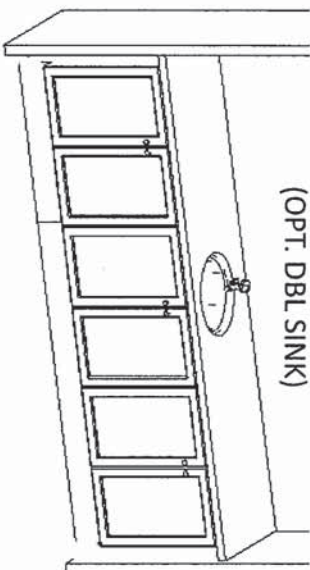

LAUNDRY

(GROUND FLOOR)

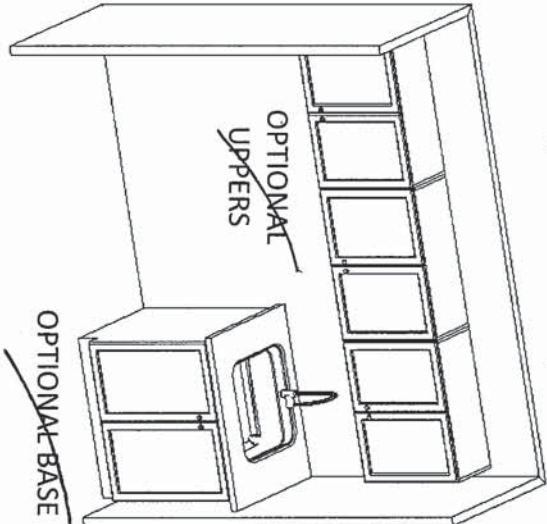

ENSUITE 2

(2ND FLR - ELEV: A)

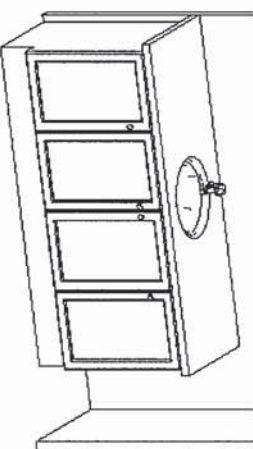

(2ND FLR - ELEV: B, C)

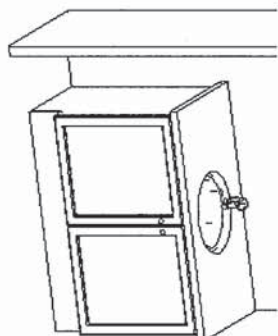

OR

OPT. BASEMENT BATH

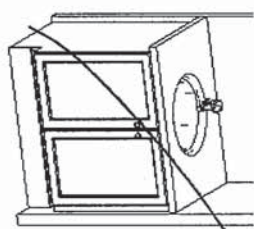



F R E N D L E
K I T C H E N S L I M I T E D
1350 Shawson Drive, Mississauga, ON L4W 1C5

HEATHWOOD HOMES
WALLACETON, KITCHENER ON
MODEL: 28-2897 (3404)

STANDARD CONTRACT INCLUDES:

Appliance Openings

- Hood Opening: 30"W Builder hood
- Fridge Opening: 37 3/8 "W X 73 3/8"
- Fridge cabinet & gables: 66cm Deep
- Stove Opening: 30" Freestanding
- Dishwasher Opening: 24"

Standard Kitchens Scope:

- 100cm H wall cabinets
- Std. Blumotion Hinges- **soft close**
- Std. Metabox Drawers- **not soft close**
- Min 40cm W drawer
- Base pie cut corner cabinets
- Backing on all cabinets
- Countertop by others
- Upgrade applied paneled fridge & dishwashers supply only (appliance hardware by others)

Standard Vanity & Laundry Scope:

- Powder by others, pedestal
- Master Ens. - Top by others
- Remaining vanities inc. laminate top
- Std. Blum Hinges- **not soft close**
- Std. Metabox Drawers- **not soft close**
- Master Ens: Top drawers(Sink Full height)
- Mains: Full height doors (top drawers added if Masters can't accommodate)
- Optional laundry base & wall cabinets

THIS DRAWING IS FOR DESIGN PURPOSES ONLY.
IT IS NOT AN EXACT RENDITION.

Project: Wallaceton
Unit: 3158, Phase: 3
Model: 28-2897 B THE KINGSMERE

Sketch #5

Sketch #6

NOTE: TOP DRAWER (AND OR SOFT CLOSE OF THE DRAWER) IS **EXTRA CHARGE** AND CAN ONLY BE ADDED IF THE ENTIRE KITCHEN HAS TOP DRAWER THROUGHOUT

18" Wide cabinet : B17-45cm wide pull-out door base cabinet waste/recycle centre with soft-close ([2] 35L bins per unit) (available only with 45cm wide cabinet)

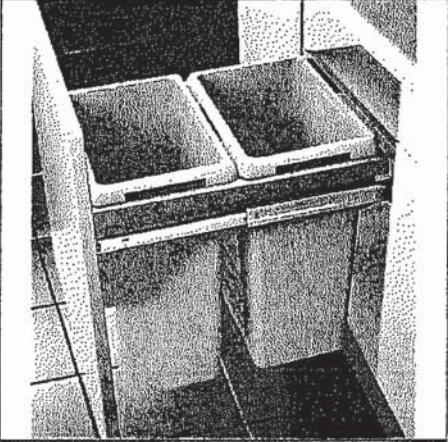

Euro-Cargo Recycling Center

Make your life easier with the Euro-Cargo sliding waste bin. Full-extension slides give you complete access to your bins. The integrated lid remains fixed inside your cabinet, and once the system is closed, the lid covers the bins to prevent odors from escaping.

Product # 3614100 [View list](#)

Total Capacity 76 l

76 l

93 l

Interior Dimensions Required - Width 412 to 418 mm

412 to 418 mm

462 to 468 mm

562 to 568 mm

Bin Quantity 2

2

4

Bin Capacity 2 x 38 liters

2 x 38 L + 2 x 8.5 L

2 x 38 liters

24" wide cabinet : B18-60cm wide pull-out door base cabinet waste/recycle centre with soft-close ([4] bins total, including [2] 35L) (available only with 60cm or 24" wide cabinet)

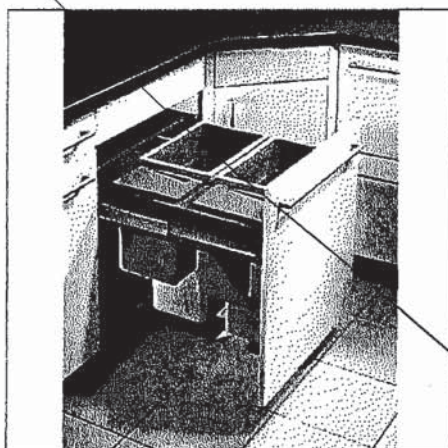

Euro-Cargo Recycling Center

Make your life easier with the Euro-Cargo sliding waste bin. Full-extension slides give you complete access to your bins. The integrated lid remains fixed inside your cabinet, and once the system is closed, the lid covers the bins to prevent odors from escaping.

Product # 361460100 [View list](#)

Total Capacity 93 l

76 l

93 l

Interior Dimensions Required - Width 562 to 568 mm

412 to 418 mm

462 to 468 mm

562 to 568 mm

Bin Quantity 4

2

4

Bin Capacity 2 x 38 L + 2 x 8.5 L

2 x 38 L + 2 x 8.5 L

2 x 38 liters

AA
S/A

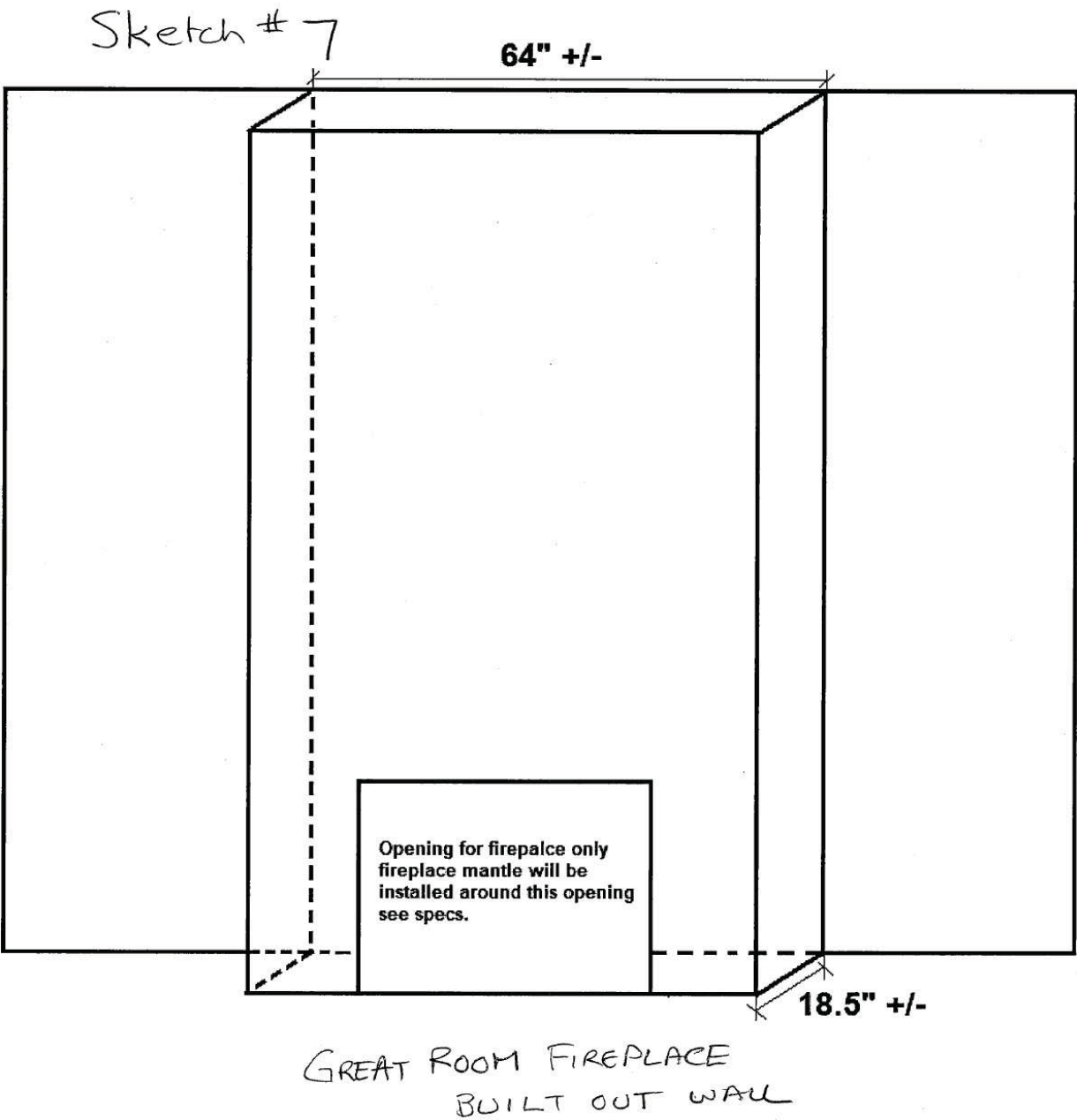



NEAS NF17 Mantel

BUILT OUT WALL ABOVE FIREPLACE

AA

SA



Sink Specifications

Colour	SKU
brushed finish	401248

Design and planning tips

- Min cabinet size: 36 in (915 mm)
- Bowl Depth: 9 in (230.0 mm)

Specifications:
Installation clips, Sink template, Installation instructions, 3 ½" (90 mm) stainless steel strainer

Depending on cabinet construction, a different cabinet size may be required. Consult the cabinet manufacturer.
Codes/Standards: ASME A112.19.3-2017/ CSA B45.4-17

Optional Accessories

Elevated Grid	406346
Workstation	406344
CapFlow Strainer Cover	517666
Ash Cutting Board	406345
Sink Grid	402125

QUATRUS U 1 SUPER SINGLE
Stainless steel brushed finish

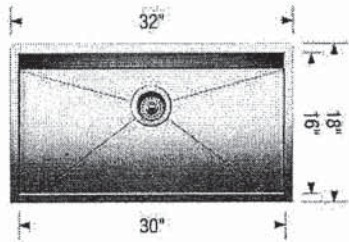

Warranty
Limited lifetime warranty on all sinks and faucets. One-year warranty on all accessories and soap dispensers.

Code/Standards Compliance
BLANCO sinks and faucets are third-party tested and certified to CSA, cUPC, ANSI/ASME, IAPMO and NSF standards and listed by applicable certification bodies. For more information on individual product listings, contact our office or listing organization.

 Need support? Learn more by watching our sink & faucet How-to videos:
<https://www.blanco.com/ca-en/support/how-to-videos/how-to-videos-for-sinks/>

	BLANCO Canada Inc 100 Corporation Drive Brampton ON L6S 6B5	Tel & Fax Tel: 905-494-2400 Toll free: 1-877-425-2626 Fax: 905-494-2425 Toll free: 1-877-825-2626
---	---	---

While BLANCO strives to provide accurate information, all images and dimensions in this document are intended for reference only and are subject to change at any time without notice. This document is not intended for use as an installation guide. For technical installation details, refer to installation instructions provided with the product. BLANCO assumes no responsibility for the use of superseded or voided specifications.

AA

SA



There is more than 1 version of this model.
Page down to identify the version you have.

FAUCET DESCRIPTION

- Reflex™ pulldown system offers smooth operation, easy movement and secure docking
- Power Clean™ spray technology
- Metal construction with various finishes identified by suffix
- Duralock™ connect installation
- Pulldown spray with 68" braided hose
- Flexible supply lines with 3/8" compression fittings
- High arc spout provides height and reach to fill or clean large pots while pulldown wand provides the maneuverability for cleaning or rinsing
- 360° rotating spout
- Faucet designed for handle to be mounted on right side only

OPERATION

- Lever style handle
- Temperature controlled by 100° arc of handle travel
- Operates with less than 5 lbs. of force
- Operates in stream or spray mode in the pullout or retracted position

FLOW

- Flow is limited to 1.5 gpm (5.7 L/min) max at 60 psi

CARTRIDGE

- 1255™ Duralast™ cartridge

STANDARDS

- Third party certified to IAPMO Green, ASME A112.18.1/CSA B125.1 and all applicable requirements therein including NSF 61/9G & 372
- Meets CalGreen and Georgia SB370 requirements
- Complies with California Proposition 65 and with the Federal Safe Drinking Water Act
- The backflow protection system in the device consists of two independently operating check valves, a primary and a secondary which prevent backflow

- ADA  for lever handle

WARRANTY

- Lifetime limited warranty against leaks, drips and finish defects to the original homeowner
 - 10 year limited warranty when used in a multifamily installation
 - 5 year limited warranty when used in a commercial installation
- Visit www.moen.com/support for complete details and limitations

Specifications

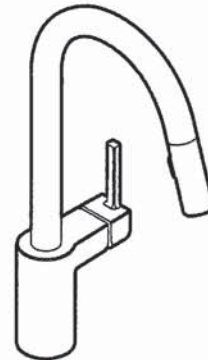

ALIGN™
Single Handle High Arc
Pulldown Kitchen Faucet

Models: 7565 series

NOTE: THIS FAUCET IS DESIGNED TO BE INSTALLED
THROUGH 1 HOLE, 1-1/2" (38mm) MIN. DIA.
(OPTIONAL 3-HOLE ESCUTCHEON 141002 AVAILABLE)

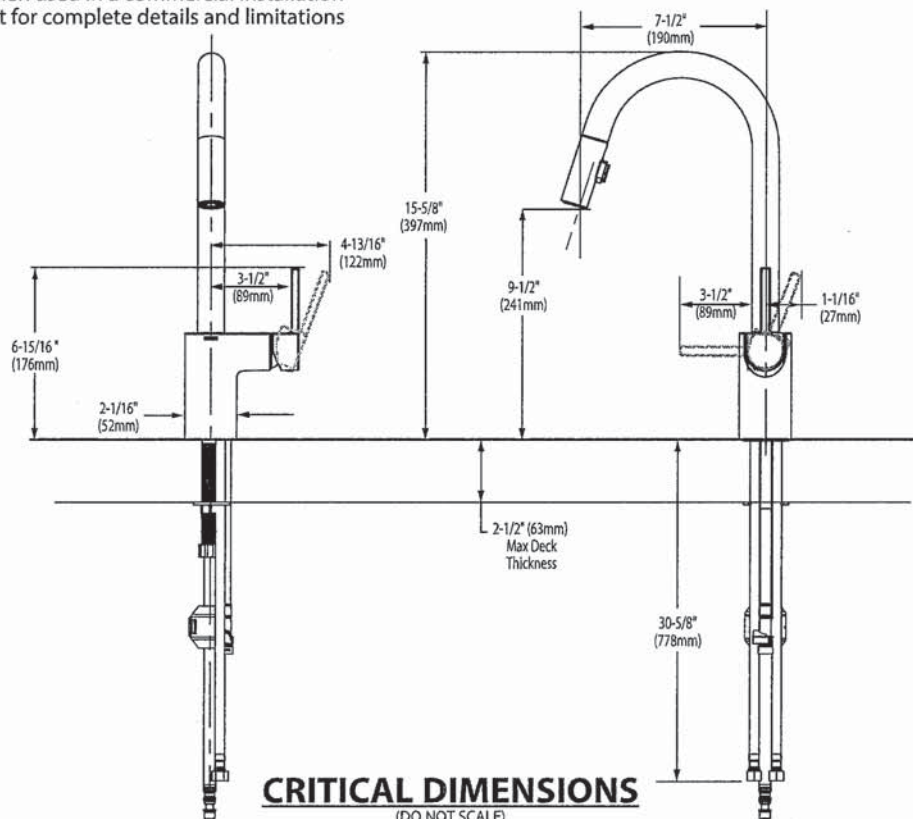

AA

SA

Save 10% on Select Faucets and Showerheads November 23-30 |

Promotional Terms

SHOP NOW

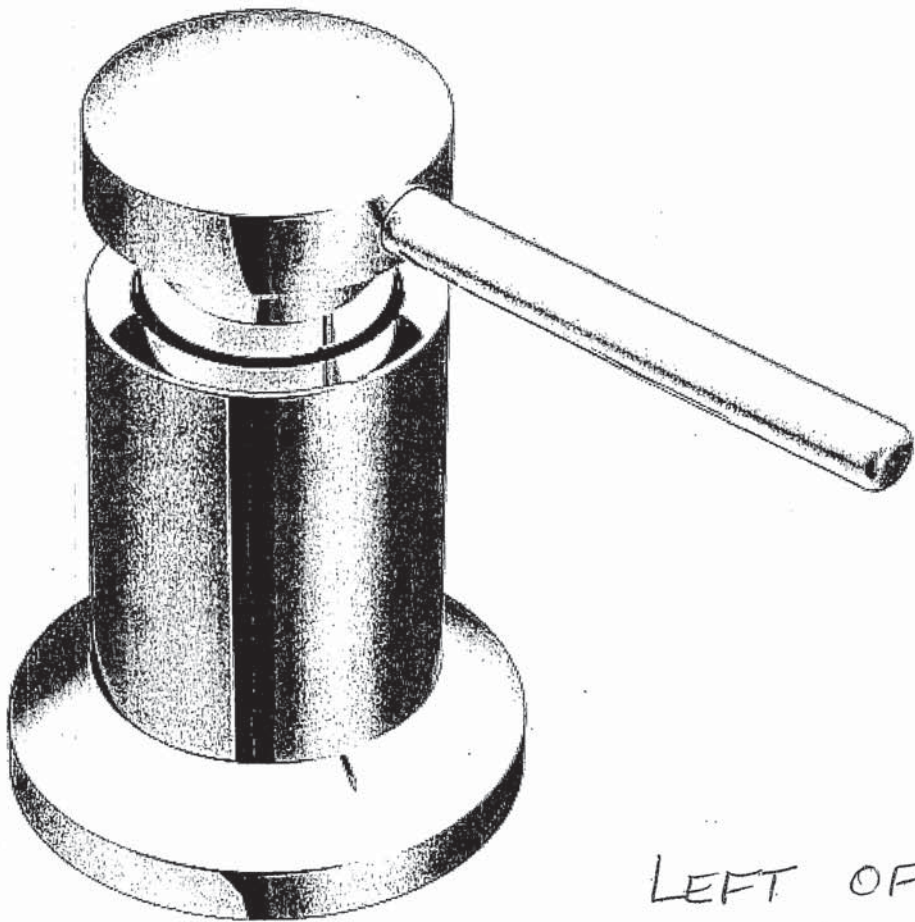

LEFT OF
FAUCET

Model: 3942

Soap Dispenser Chrome

★★★★☆ 3.9 | 109 Reviews

60 out of 80 (75%) reviewers recommend this product

18 questions and 14 answers for this product

Write a review Ask a question

The convenient and versatile MOEN Soap/Lotion Dispenser offers a way to customize the look of your sink area with beauty and functionality. This refillable dispenser opens from the top and can hold up to 18 oz. of liquid. This soap dispenser offers a look that can complement most Bath

We use cookies on this website. We use these cookies to enhance your user experience, improve the quality of our site, and to show you marketing that is more likely to be relevant to your interests. We also allow third parties, including our advertising partners, to place cookies on our websites. By continuing to use this website, you consent to the placement and use of cookies as described in our [Privacy Policy](#). If you would like to disable the use of all cookies, including those placed by advertisers, please use your browser's settings to reject cookies on this site.

ACCEPT

Feedback



BARRIER FREE (ABOVE COUNTER OR DROP-IN ONLY)

BOULEVARD®
PEDESTAL SINK
VITREOUS CHINA

BOULEVARD® PEDESTAL SINK



SEE REVERSE FOR ROUGHING-IN DIMENSIONS

- STD ☒ **0641.800** Faucet holes on 8" (203mm) centers (Illustrated)
- ☒ **0641.400** Faucet holes on 4" (102mm) centers
- ☐ **0641.100** Center hole only
- Classic styled rectangular pedestal lavatory
 - Vitreous china
 - Rear overflow
 - Supplied with mounting kit
 - Right Height® for greater comfort during use
 - Faucet ledge with large deck area (faucet not included)
 - **Design coordinates with Boulevard® Toilet**
 - Basin has flat bottom to also allow use as an **above counter** sink or a **drop-in** sink (with u-shaped cut out)

Nominal Dimensions:

24" x 19" x 35-1/2"
(610 x 483 x 902mm)

- ☐ **0641.008** Pedestal top-8" (203mm) centers
- ☐ **0641.004** Pedestal top-4" (102mm) centers
- ☐ **0641.001** Pedestal top-center hole only
- ☐ **0010.000** Pedestal only

Bowl sizes:

17" (432mm) wide,
12-1/2" (318mm) front to back,
5" (127mm) deep

Compliance Certifications -

Meets or Exceeds the Following Specifications:

- ASME A112.19.2 - 2008/CSA B45.1-08

To Be Specified:

- ☐ Color: ☐ White ☐ Linen
- ☐ Faucet Finish:
- ☐ Supplies:
- ☐ 1-1/4" Trap:
- ☐ Nipple:

* See faucet section for additional models available

AA
5A

American Standard
Style That Works Better

 BARRIER FREE

OVALYN™ UNDERCOUNTER SINK

- Classic oval undermount sink
- Made from vitreous china
- Front overflow
- Supplied with mounting kit (047194-0070A) and template

☐ 0495.221 Unglazed rim
435 x 359mm
(17-1/8" x 14-1/8")

☐ 0495.300 Glazed underside

Bowl size:
382mm (15-1/16") wide
306mm (12-1/16") front to back
140mm (5-1/2") deep

☐ 0496.221 Unglazed rim
489 x 413mm
(19-1/4" x 16-1/4")

☐ 0496.300 Glazed underside

Bowl size:
432mm (17") wide
356mm (14") front to back
140mm (5-1/2") deep

☐ 0497.221 Unglazed rim
546 x 441mm
(21-1/2" x 17-3/8")

☐ 0497.300 Glazed underside

Bowl size:
483mm (19") wide
391mm (15-3/8") front to back
140mm (5-1/2") deep

**Compliance Certifications -
Meets or Exceeds the Following Specifications:**

- ASME A112.19.2M for Vitreous China Fixtures
- CAN/CSA B45 series

To Be Specified:

- ☐ Color: ☐ White ☐ Bone ☐ Linen
☐ Silver ☐ Fawn Beige ☐ Black
- ☐ Faucet*:
☐ Faucet Finish:
☐ Supplies:
☐ 1-1/4" Trap:

* See faucet section for additional models available

4 x
2x MASTER Ensuite STD
1x shared
1x Ensuite 5

OVALYN™
UNDERCOUNTER SINK
VITREOUS CHINA

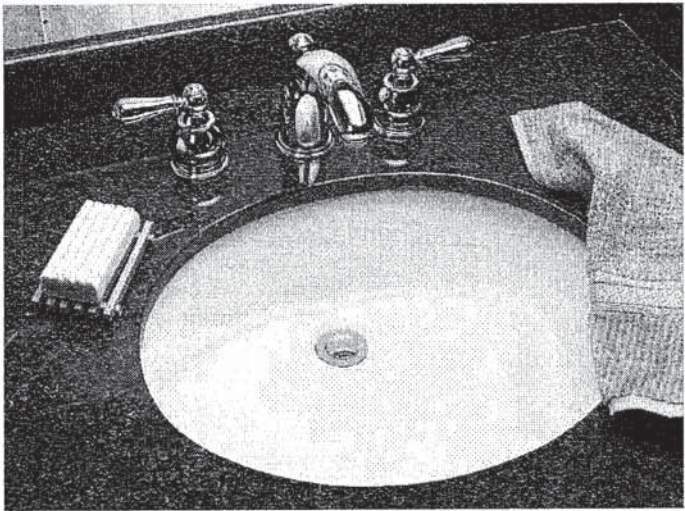

STD Master Ensuite Undermount SINGLES

SEE REVERSE FOR ROUGHING-IN DIMENSIONS

AA
SA

American Standard
Style That Works Better

Barrier Free

OVALYN™
UNDERCOUNTER SINK
VITREOUS CHINA

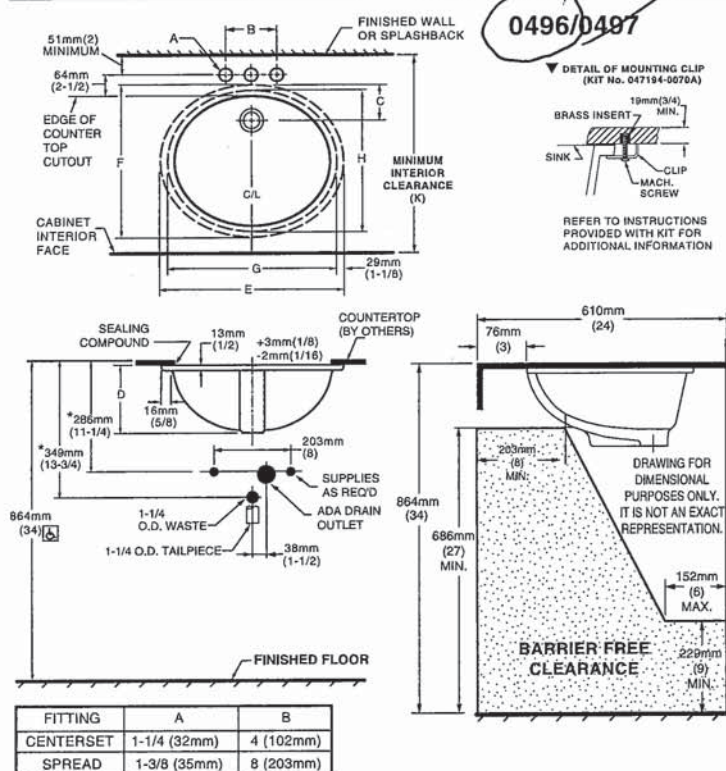

NOTES:
* DIMENSIONS SHOWN FOR LOCATION OF SUPPLIED AND "P" TRAP ARE SUGGESTED.
▼ UNDERCOUNTER MOUNTING KIT SUPPLIED WITH SINK.
PLEASE NOTE MINIMUM INTERIOR CLEARANCE DIMENSION (K). FITTINGS NOT INCLUDED AND MUST BE ORDERED SEPARATELY. USE ENCLOSED TEMPLATE FOR COUNTERTOP CUTOUT SEALING COMPOUND SUPPLIED BY OTHERS.

IMPORTANT: Dimensions of fixtures are nominal and may vary within the range of tolerances established by ANSI Standard A112.19.2. These measurements are subject to change or cancellation. No responsibility is assumed for use of superseded or voided pages.

MEETS THE AMERICANS WITH DISABILITIES ACT GUIDELINES AND ANSI A117.1 ACCESSIBLE AND USEABLE BUILDINGS AND FACILITIES - CHECK LOCAL CODES.
Countertop 864mm (34") from finished floor. Lavatory installed 76mm (3") from front edge of countertop. Countertop thickness to be 25mm (1") maximum.

CAT. NO.	E	F	G	H	C	D	J	K
0496.221	489mm (19-1/4)	413mm (16-1/4)	432mm (17)	356mm (14)	103mm (4-1/16)	182mm (7-3/16)	16mm (5/8)	500mm (19-11/16)
0497.221	546mm (21-1/2)	441mm (17-3/8)	483mm (19)	391mm (15-3/8)	95mm (3-3/4)	191mm (7-1/2)	19mm (3/4)	534mm (21-1/16)

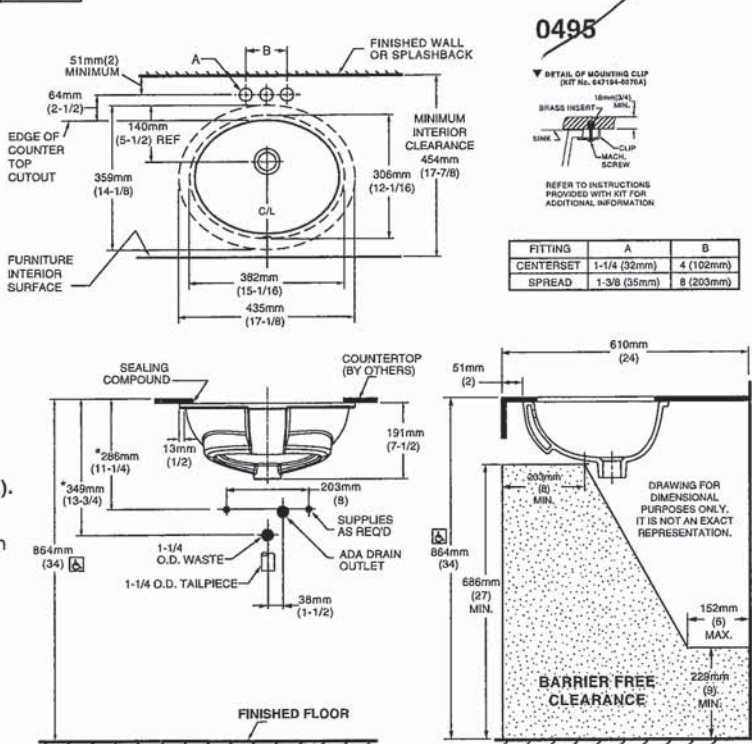

NOTES:
USE ENCLOSED TEMPLATE FOR COUNTER TOP CUTOUT. FITTINGS NOT INCLUDED WITH FIXTURE AND MUST BE ORDERED SEPARATELY.
* DIMENSIONS SHOWN FOR LOCATION OF SUPPLIED AND "P" TRAP ARE SUGGESTED.
▼ UNDERCOUNTER MOUNTING KIT SUPPLIED WITH SINK.
PLEASE NOTE MINIMUM INTERIOR CLEARANCE DIMENSION (K). SEALING COMPOUND SUPPLIED BY OTHERS.

IMPORTANT: Dimensions of fixtures are nominal and may vary within the range of tolerances established by ANSI Standard A112.19.2. These measurements are subject to change or cancellation. No responsibility is assumed for use of superseded or voided pages

MEETS THE AMERICANS WITH DISABILITIES ACT GUIDELINES AND ANSI A117.1 ACCESSIBLE AND USEABLE BUILDINGS AND FACILITIES - CHECK LOCAL CODES.
Countertop 864mm (34") from finished floor. Lavatory installed 51mm (2") from front edge of countertop. Countertop thickness to be 25mm (1") maximum.

AA
SA



DEMI™
Product Specification Sheet



Two Piece Freestanding Collection

CF2007	Two Piece Freestanding Soaker
Size:	60" x 32" x 22" 1524 mm x 813 mm x 559 mm

PRODUCT FEATURES & BENEFITS

- Vacuum formed acrylic reinforced with fiberglass
- Scratch, stain and fade resistant high gloss finish
- Installation friendly two piece design
- Accepts deck mounted faucet
- Includes integral pop up drain and rectangular overflow
- Includes levelling feet

TWO PIECE ASSEMBLY

FRONT VIEW

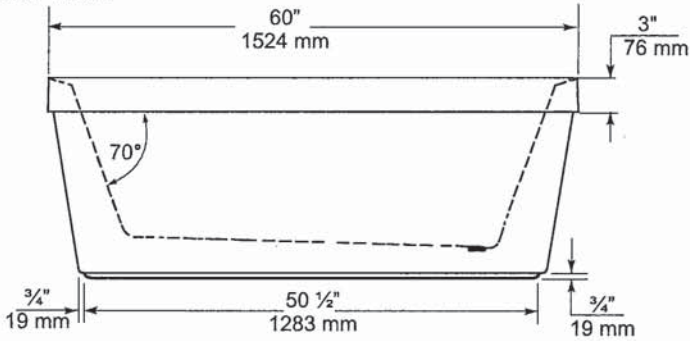

END VIEW

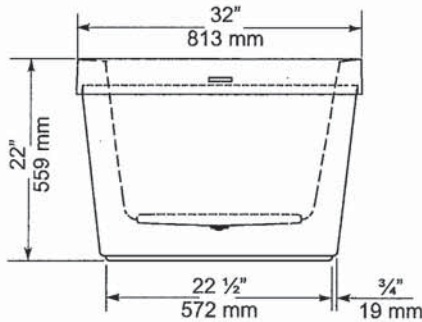

TOP VIEW

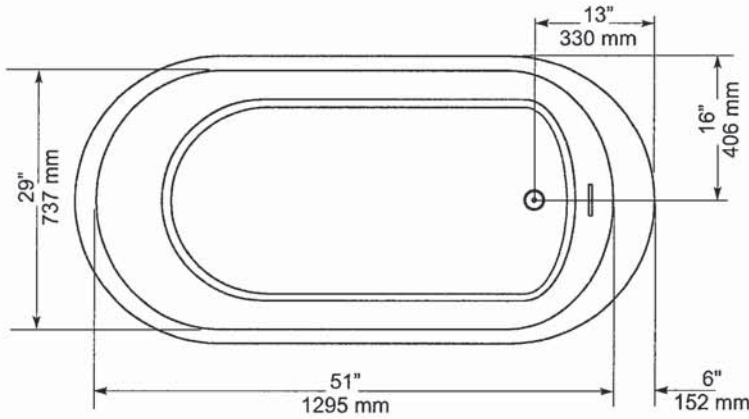

GENERAL SPECIFICATIONS		
Average Weight	90 lb	41 kg
Bathing Well at bottom	43"x 20"	1092 x 508 mm
Capacity Drain to Overflow		195 litres
Water Depth Drain to Overflow	16"	406 mm
Drain Opening (dia.)	2"	51 mm
Overflow Opening	2 1/4"x 1/2"	57 x 13 mm
Drain to Floor Clearance	3 1/4"	83 mm

NOTES: Please confirm measurements on actual product to ensure proper identification. Bathtub to be installed on the floor supported by 5 self levelling feet. Adjust if required to level the bathtub for adequate drainage. Refer to installation instructions for additional information.

IMPORTANT: Dimensions of fixtures are nominal and may vary ± 1/4" (6 mm). Weight may vary ± 5 lb (2.3 kg). Drawing is not to scale. These measurements are subject to change at manufacturer's discretion.

Compliance Certifications -
Meets or Exceeds the following Specifications:
• CAN/CSA - B45 Series



AA
SA

American Standard
Style That Works Better

FloWise™ DUAL FLUSH
ELONGATED TOILET
VITREOUS CHINA

FloWise™ DUAL FLUSH ELONGATED TOILET

- 2476 216
 - Vitreous china
 - Low-consumption Dual Flush
 - Full flush 6.0 Lpf/1.3 gpf,
 - Partial flush 3.0 Lpf/0.66 gpf.
 - Elongated wash down bowl
 - Internal trapway fully-glazed,
 - 2-1/4" (57mm) ballpass
 - Concealed trapway bowl
 - Chrome-plated top mounted push button actuator
 - Easy to clean sanitary dam on bowl
 - Includes Elongated Slow Close Seat
 - 100% factory flush tested
 - 2 bolt caps

Separate Component Parts:

- 3067 316 Elongated Bowl with Slow Close Seat
- 4035 216 Unlined Tank

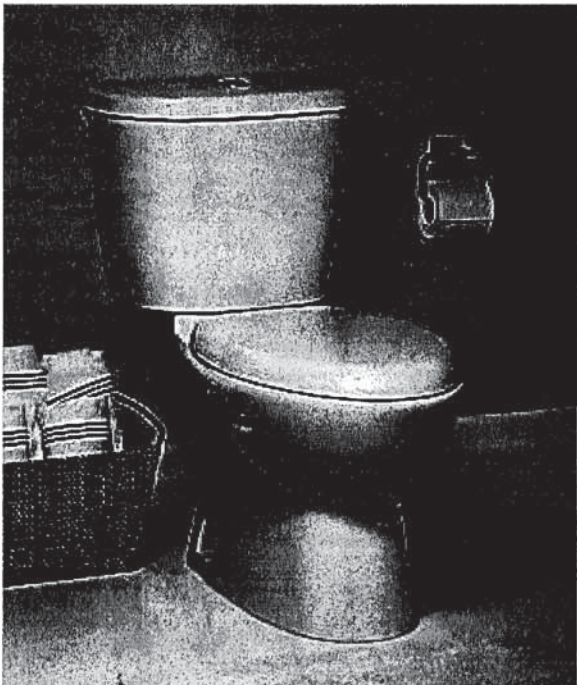

- 2476 516 Same as above with Lined tank
 - 3067 316 Elongated Bowl
 - 4035 516 Lined Tank

Nominal Dimensions:
794 x 432 x 765mm
(31-1/4" x 17" x 30-1/8")

- Compliance Certifications -
Meets or Exceeds the Following Specifications:
- ASME A112.19.2M (and 19.6M)
 - CAN/CSA B45 series

- To Be Specified
- Colour: 020 White
 - Supply with stop:

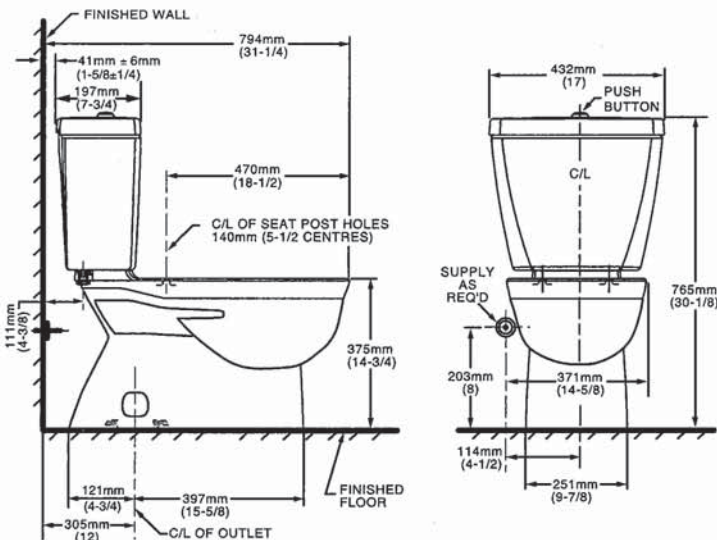

NOTES:
THIS TOILET IS DESIGNED TO ROUGH-IN AT A MINIMUM DIMENSION OF 305MM (12") FROM FINISHED WALL TO C/L OF OUTLET.
SUPPLY NOT INCLUDED WITH FIXTURE AND MUST BE ORDERED SEPARATELY.
* DIMENSION SHOWN FOR LOCATION OF SUPPLY IS SUGGESTED.
FOR ADDITIONAL INFORMATION REFER TO INSTALLATION INSTRUCTIONS SUPPLIED.
IMPORTANT: Dimensions of fixtures are nominal and may vary within the range of tolerance established by ANSI Standard A112.19.2
These measurements are subject to change or cancellation. No responsibility is assumed for use of superseded or voided pages.

UPGRADED VALUE ADDED FEATURES AT NO EXTRA CHARGE

MOEN®

Specifications

There is more than 1 version of this model.
Page down to identify the version you have.

DESCRIPTION

- Metal construction with various finishes identified by suffix
- Flexible supplies with 3/8" compression fittings
- Includes metal or 50/50 pop-up type waste assembly where noted

OPERATION

- Pivot action lever style handle
- Temperature controlled through 100° degree arc of handle travel

FLOW

- Water usage is limited to these maximum flow rates as indicated by the corresponding product markings
- ° 1.2 gpm max (4.5L/min) at 60 psi
- ° 1.5 gpm max (5.7L/min) at 60 psi

CARTRIDGE

- 1255™ Duralast™ cartridge
- Nonmetallic/nonferrous and stainless steel material

STANDARDS

- Third party certified to WaterSense®, ASME A112.18.1/CSA B125.1 and all applicable requirements referenced therein
- Certified to NSF 61/9 & 372
- Products marked with 1.2 gpm are compliant with California water efficiency regulations
- Complies with California Proposition 65 and with the Federal Safe Drinking Water Act
- **ADA**  for lever handle

WARRANTY

- Lifetime limited warranty against leaks, drips and finish defects to the original consumer purchaser
- 5 year warranty if used in commercial installations

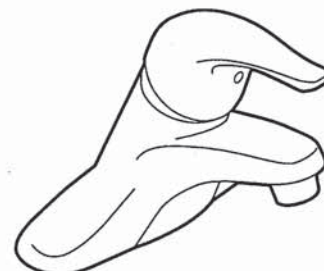

CHATEAU® Single-Handle Lavatory Faucet

with Metal Waste Assembly

Model: L4625 series

L4631BC

Bulk Packed (12 per carton):
L64624 series

with 50/50 Waste Assembly

Bulk Packed (12 per carton):
L64625 series

Less Waste

Bulk Packed (12 per carton):
L64600 series

NOTE: THIS FAUCET IS DESIGNED TO BE
INSTALLED THRU 3-1" DIA. HOLES, 2" ON CENTER

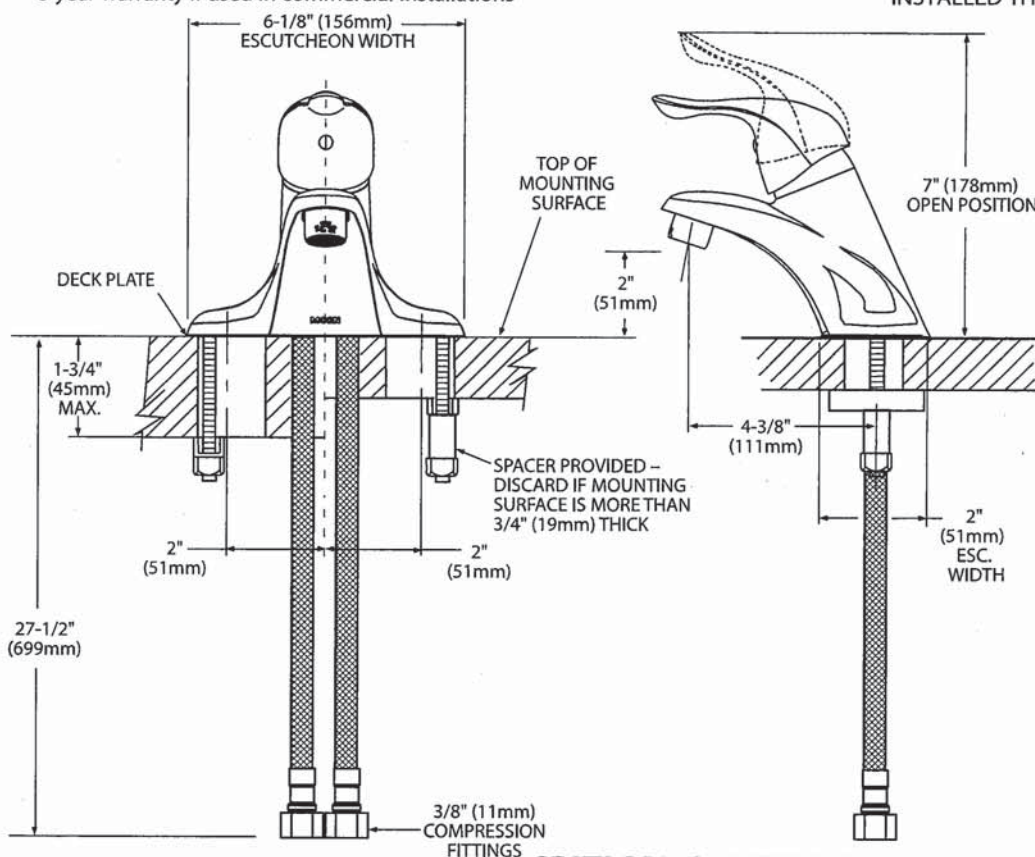

CRITICAL DIMENSIONS (DO NOT SCALE)





Buy it for looks. Buy it for life.®

DESCRIPTION

- Metal construction with various finishes identified by suffix
- Includes non-metallic showerhead, arm, flange and non-metallic diverter tub spout

OPERATION

- Handle operates counterclockwise through a 270° arc with off at 6 o'clock and maximum hot at the 9 o'clock position. Shut off in clockwise direction
- Adjustable temperature limit stop to control maximum hot water temperature
- Pressure balancing mechanism maintains selected discharge temperature to ± 3°

FLOW

- Showerhead is limited to 2.5 gpm (9.5 L/min) at 80 psi
- EP suffix models are limited to 1.75 gpm (6.6 L/min) at 80 psi
- NH suffix models contain no showerhead

CARTRIDGE

- 1222 cartridge design
- Accommodates back to back installations
- Nonmetallic/nonferrous and stainless steel material

STANDARDS

- Third party certified to meet ASME A112.18.1/CSA B125.1 and all applicable requirements referenced therein
- EP suffix models are third party certified to WaterSense®

- ADA  for lever handle

WARRANTY

- Lifetime limited warranty against leaks, drips and finish defects to the original consumer purchaser
- 5 year warranty if used in commercial installations

Specifications



CHATEAU® POSI-TEMP®
Single-Handle Tub/Shower Trim Kit

- Models:
- TL181 series - valve trim only
(Bulk Packed 12 per carton)
 - TL182 series - shower trim only
(Bulk Packed 12 per carton)
 - TL183 series - tub/shower trim
(Bulk Packed 12 per carton)

- Valves:
- 62300 series
 - 2500 series

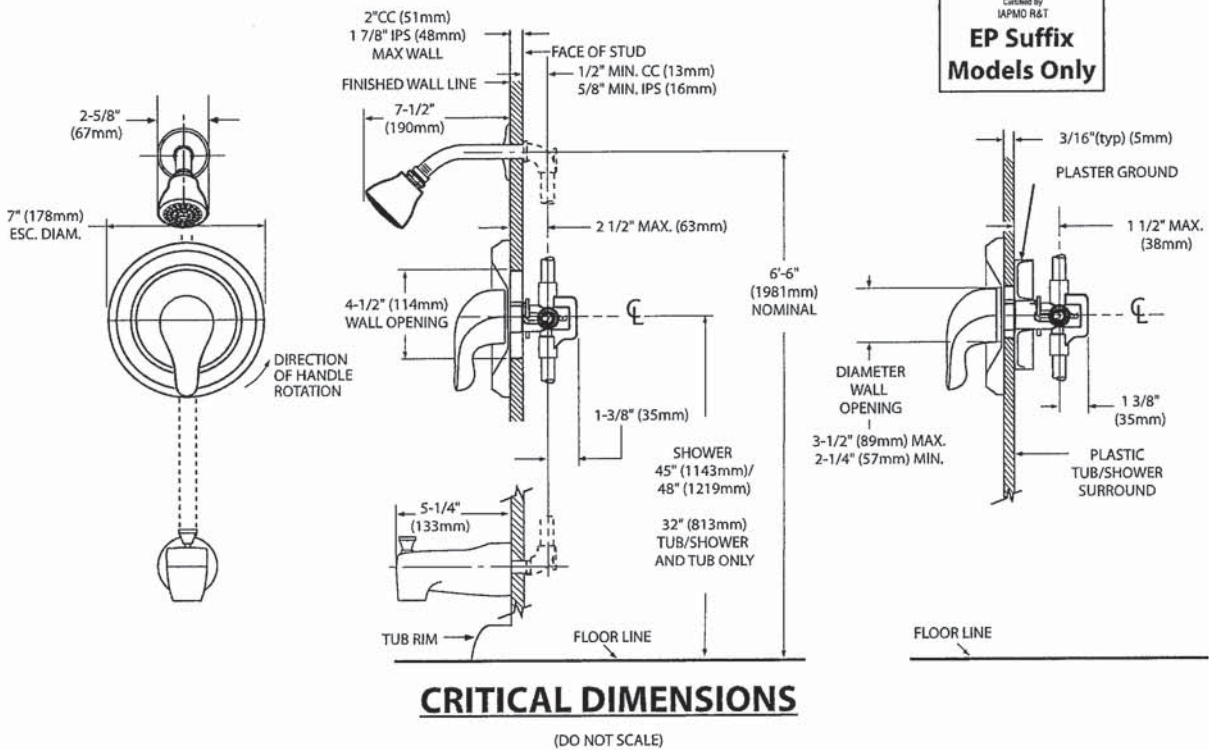

AA
SA



Specifications

DESCRIPTION

- Metal construction with various finishes identified by suffix

OPERATION

- Lever style handles with hot and cold color indicator
- Rotate hot side handle counterclockwise to open (clockwise to close) and the cold side handle (clockwise to open) and (counterclockwise to close)

STANDARDS

- Third party certified to: ASME A112.18.1/CSA B-125.1, and all applicable requirements referenced therein

- ADA  for lever handles

WARRANTY

- Lifetime limited warranty against leaks, drips and finish defects to the original homeowner
 - 10 year limited warranty when used in a multi-family installation
 - 5 year limited warranty when used in a commercial installation
- Visit www.moen.com/support for complete details and limitations

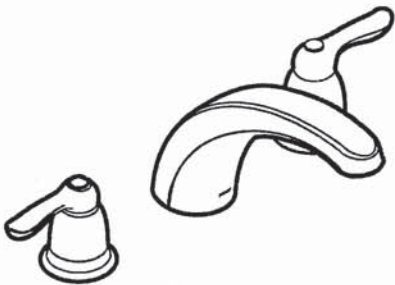

CHATEAU®
Two-Handle Garden Tub Trim

Models: T994 series

Valves: 4792, 4793, 4794, 4796, 4797, 4798

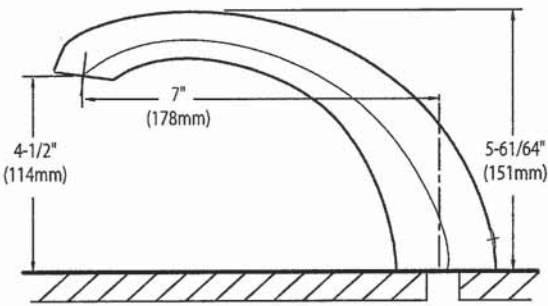
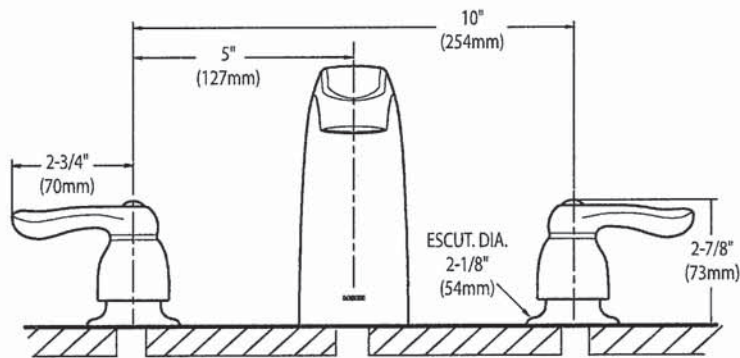

CRITICAL DIMENSIONS
(DO NOT SCALE)

AA

SA

KitchenAid®

36" Wall-Mount Canopy Hood
KVWB606D

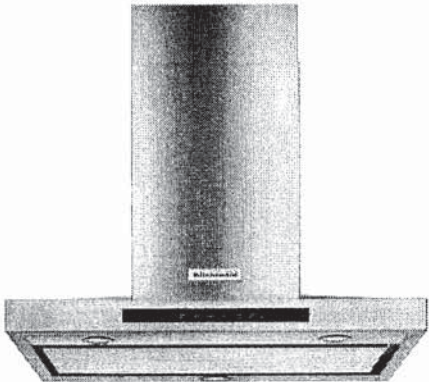

Stainless Steel
KVWB606DSS

General Features & Properties

- LED Task Lights
- Halogen Night Lights
- Easy In-line Conversion
- Whisper Quiet® System @ 49 dBA (1.5 Sones) at Low Speed
- Dishwasher Safe Commercial-Style Baffle Filters
- 3-Speed Electronic Glass Touch Control with Boost Function (10 Min.)

Electrical Details

Amps	15
Volts	120

Technical Details

Blower Power	Centrifugal
Hood Type	Wall Mount
CFMs	600
Lighting Type	LED
Number of Speeds	3
Venting Type	Exterior or Recirculating

Dimensions

Product Dimensions (H x W x D)	24-5/8" x 36" x 19-11/16"
--------------------------------	---------------------------

Reference Material

- [Dimension Guide](#)
- [Install Guide](#)
- [Use & Care Guide](#)
- [Warranty](#)

Key Features & Benefits

600 CFM/65K BTU Threshold
Allows installation over any KitchenAid® regular 36- or 30-inch range or cooktop, and some commercial-style cooking surfaces with outputs up to 65K BTU.

Perimeter Ventilation
Increases ventilation system efficiency by pulling air from the edges of the hood and speeding up the movement of air at the center, allowing it to efficiently handle up to a 65K BTU total output.

Auto Speed Setting
Takes the guesswork out of protecting cabinets from steam, grease, and moisture by automatically adjusting fan speed to ventilation needs depending on the heat being produced.

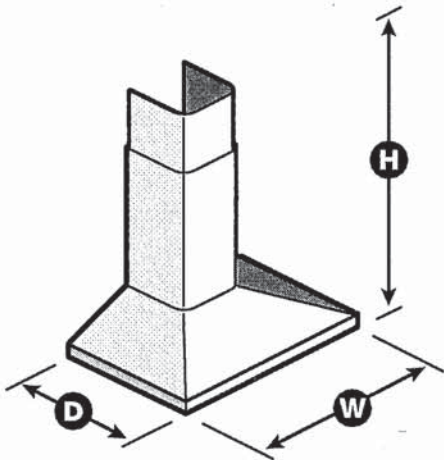

NOTE: Dimensions are for planning purposes only. For complete details, see Installation Instructions packed with product. Specifications subject to change without notice.

®/™ © 2020. All rights reserved. Printed in the U.S.A. D200104XXE. KVWB606DSpecSheetV01.

AA

SA

PRODUCT MODEL NUMBERS

KRFC704F KRFC604F

Electrical: A 115-volt, 60 Hz, AC-only 15- or 20-amp fused, grounded electrical supply is required. It is recommended that a separate circuit serving only your refrigerator and approved accessories be provided. Use an outlet that cannot be turned off by a switch. Do not use an extension cord.

Water: A cold water supply with water pressure between 35 and 120 psi (241 and 827 kPa) is required to operate the water dispenser and ice maker. If you have questions about your water pressure, call a licensed, qualified plumber.

NOTE: If the water pressure is less than what is required, the flow of water from the water dispenser could decrease or ice cubes could be hollow or irregular shaped.

Reverse Osmosis Water Supply:

IMPORTANT: The pressure of the water supply coming out of a reverse osmosis system going to the water inlet valve of the refrigerator needs to be between 35 and 120 psi (241 and 827 kPa).

If a reverse osmosis water filtration system is connected to your cold water supply, the water pressure to the reverse osmosis system needs to be a minimum of 40 to 60 psi (276 to 414 kPa).

PRODUCT DIMENSIONS

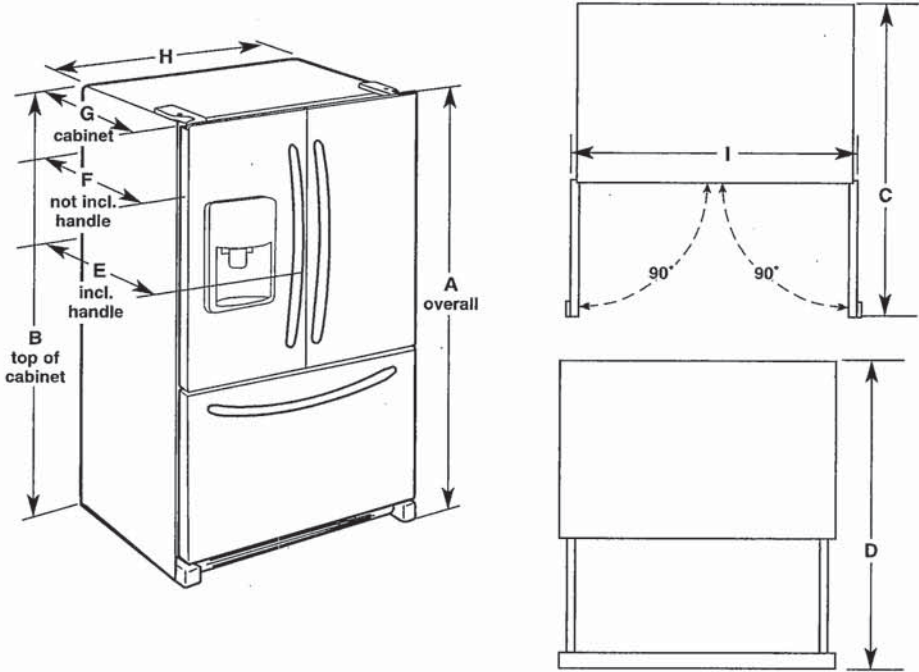

Model Size	Height - Overall "A"	Height - Top of Cabinet "B"	Depth - Door Open 90° "C"	Depth - Drawer Open "D"	Depth - With Handles "E"	Depth - Without Handles "F"	Depth - Cabinet Only "G"	Width - Cabinet "H"	Width - Door Open 90° "I"
23.8 cu. ft	71 ¹ / ₈ " (182.6 cm)	70 ⁷ / ₈ " (180.0 cm)	43 ³ / ₄ " (111.1 cm)	45 ⁷ / ₈ " (116.5 cm)	31 ¹ / ₂ " (80.0 cm)	28 ⁷ / ₈ " (73.3 cm)	24 ³ / ₈ " (61.9 cm)	35 ⁵ / ₈ " (90.5 cm)	43 ⁵ / ₈ " (110.8 cm)

LOCATION REQUIREMENTS

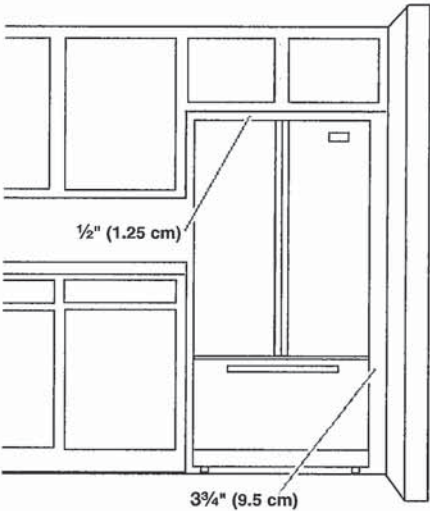

IMPORTANT: This refrigerator is designed for indoor, household use only.

To ensure proper ventilation for your refrigerator, allow for a 1/2" (1.25 cm) of space on each side and at the top. Allow for a 1" (2.54 cm) space behind the refrigerator. If your refrigerator has an ice maker, allow extra space at the back for the water line connections. When installing your refrigerator next to a fixed wall, leave a 3 3/4" (9.5 cm) minimum space between the refrigerator and wall to allow the door to swing open.

NOTE: This refrigerator is intended for use in a location where the temperature ranges from a minimum of 55°F (13°C) to a maximum of 110°F (43°C). The preferred room temperature range for optimum performance, which reduces electricity usage and provides superior cooling, is between 60°F (15°C) and 90°F (32°C). It is recommended that you do not install the refrigerator near a heat source, such as an oven or radiator.

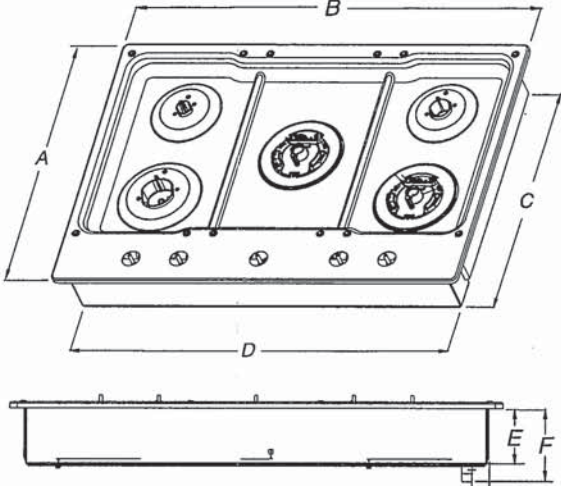

A. 21" (53.3 cm)
B. 30" (76.2 cm)
C. 19 3/8" (49.2 cm)
D. 28 3/8" (72.1 cm)
E. 3 3/8" (9.2 cm)
F. 4 9/16" (11.6 cm)
G. 1 3/8" (3.4 cm)

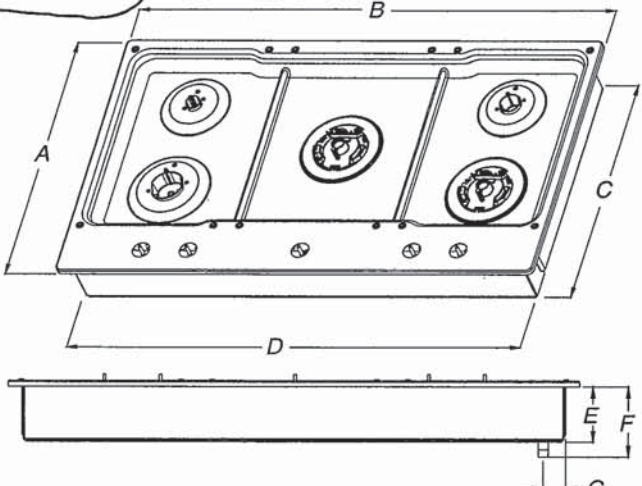

A. 21" (53.3 cm)
B. 36 1/4" (92.0 cm)
C. 19 3/8" (49.2 cm)
D. 34 3/8" (88.1 cm)
E. 3 3/8" (9.2 cm)
F. 4 9/16" (11.6 cm)
G. 1 7/8" (3.6 cm)

All Other 30" (76.2 cm) Models

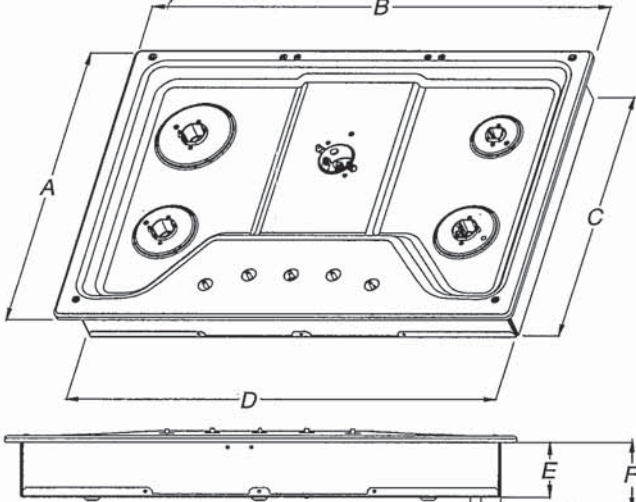

A. 21" (53.3 cm)
B. 30" (76.2 cm)
C. 18 7/8" (48.0 cm)
D. 28 3/8" (72.1 cm)
E. 3 3/8" (8.6 cm)
F. 4 1/8" (10.5 cm)
G. 1 1/2" (3.8 cm)

All Other 36" (91.4 cm) Models

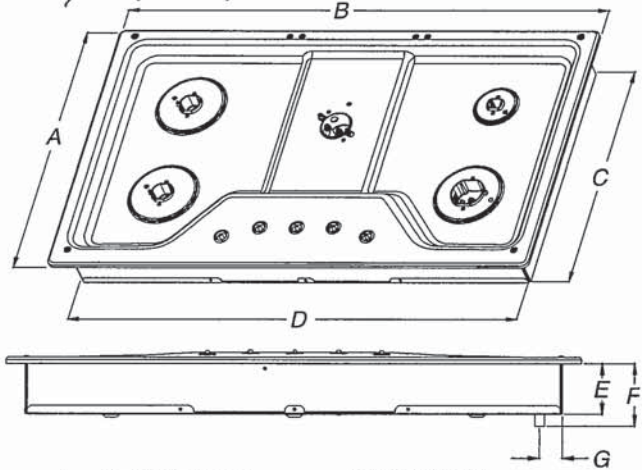

A. 21" (53.3 cm)
B. 36" (91.4 cm)
C. 18 7/8" (48.0 cm)
D. 33 3/4" (85.7 cm)
E. 3 3/8" (8.6 cm)
F. 4 1/8" (10.5 cm)
G. 1 1/2" (3.8 cm)

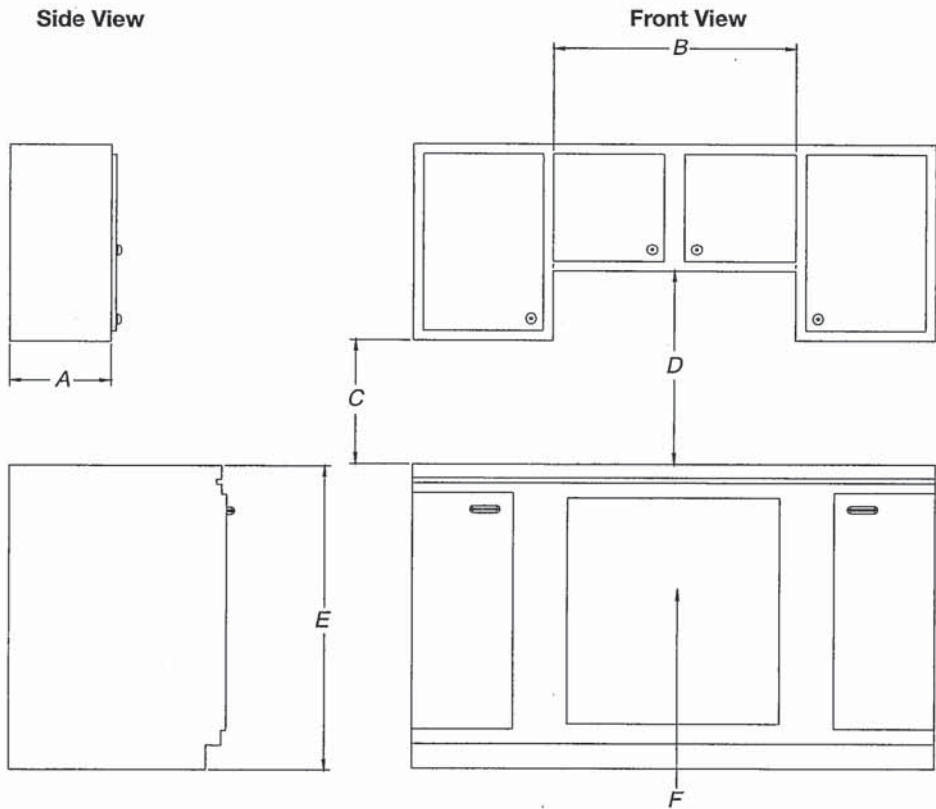

- A. 13" (33.0 cm) recommended upper cabinet depth.
- B. 30" (76.2 cm) for 30" models; 36" (91.4 cm) for 36" models.
- C. 18" (45.7 cm) minimum clearance from upper cabinet to countertop within minimum horizontal clearances to cooktop.
- D. 30" (76.2 cm) minimum clearance between top of cooktop platform and bottom of uncovered wood or metal cabinet. 24" [61 cm] minimum clearance if bottom of wood or metal cabinet is covered by not less than ¼" [0.6 cm] flame retardant millboard covered with not less than No. 28 MSG sheet steel, 0.015" [0.04 cm] stainless steel, or 0.024" [0.06 cm] aluminum or 0.020" [0.05 cm] copper.
- E. 36" (91.4 cm) top of countertop to floor.
- F. Gas line opening - Wall: anywhere 5" (12.7 cm) below underside of countertop. Cabinet floor: anywhere within 6" (15.2 cm) of rear wall is recommended.

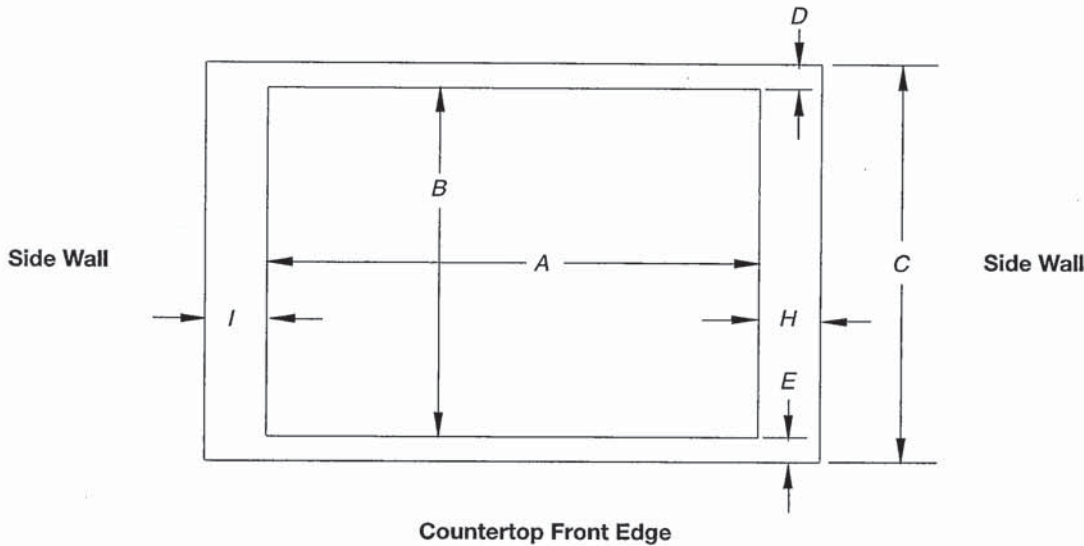

Cutout (Product Opening) Dimensions						
30" (76.2 cm) Models						
Models	A			B		
	Min	Recommended	Max	Min	Recommended	Max
KCGS550 and KCGS950	28 1/2" (72.4 cm)	28 7/8" (73.4 cm)	29 9/16" (74.3 cm)	19 1/2" (49.5 cm)	19 13/16" (50.2 cm)	20" (50.8 cm)
All Other 30" (76.2 cm) Models	28 1/2" (72.4 cm)	28 7/8" (73.4 cm)	29 9/16" (74.3 cm)	19" (48.3 cm)	19 1/2" (49.5 cm)	20" (50.8 cm)
36" (91.4 cm) Models						
KCGS556 and KCGS956	34 7/8" (88.4 cm)	35 3/16" (89.4 cm)	35 5/8" (90.3 cm)	19 1/2" (49.5 cm)	19 13/16" (50.2 cm)	20" (50.8 cm)
All Other 36" (91.4 cm) Models	33 7/8" (86.0 cm)	34 5/16" (87.0 cm)	35 1/4" (89.5 cm)	19" (48.3 cm)	19 1/2" (49.5 cm)	20" (50.8 cm)

Side Walls (Combustible Surfaces)	
Models	H and I
KCGS5 and KCGS9	H and I added together must be at least 48" (122.0 cm), with each side individually being at least 8" (20.3 cm).
KCGS350, KCGS356, MGC9536, WCG97US0, WCG97US6	H and I added together must be at least 48" (122.0 cm), with each side individually being at least 12" (30.5 cm).
All Other Models	Both have to be 8" (20.3 cm) or more.

Back Wall and Countertop Front Dimensions			
Models	C	D	E
KCGS550 and KCGS950	25" (63.5 cm)	2 7/8" (7.3 cm)	2 3/4" (6.9 cm)
All Other Models			3 1/8" (7.9 cm)

NOTES: After making the countertop cutout, some installations may require notching down the base cabinet side walls to clear the cooktop base. To avoid this modification, use a base cabinet with sidewalls wider than the cutout.

If cabinet has a drawer, a 4" (10.2 cm) depth clearance from the countertop to the top of the drawer (or other obstruction) in base cabinet is required. The drawer depth may need to be shortened to avoid interfering with the regulator.

IMPORTANT: If a built-in wall oven is to be installed below this cooktop, the grounded outlet and gas supply piping must be located in an adjacent cabinet.

This cooktop and its gas and electrical supply sources must be installed before the undercounter built-in wall oven is installed.

30" (76.2 CM) AND 36" (91.4 CM) GAS BUILT-IN COOKTOP

Model: 28-2897 B THE KINGSMERE

PRODUCT MODEL NUMBERS

KCGS350E	KCGS950E	MGC9530D	WCG75US0D
KCGS356E	KCGS956E	MGC9536D	WCG97US0D
KCGS550E	MGC7430D	WCG51US0D	WCG97US6D
KCGS556E	MGC7536D	WCG51US6D	

GAS SUPPLY REQUIREMENTS

Type of Gas

Natural Gas:

This cooktop is design-certified by CSA International for use with Natural gas or, after proper conversion, for use with LP gas.

- This cooktop is factory set for use with Natural gas. If converting to LP gas, see the "LP Gas Conversion" instructions provided in the package containing literature. The model/serial rating plate located on the underside of the cooktop base has information on the types of gas that can be used. If the types of gas listed do not include the type of gas available, check with the local gas supplier.

LP Gas Conversion:

Conversion must be done by a qualified service technician.

No attempt shall be made to convert the cooktop from the gas specified on the model/serial rating plate for use with a different gas without consulting the serving gas supplier. See the Gas Conversion instructions provided in the package containing literature.

Gas Supply Line

- Provide a gas supply line of 3/4" (1.9 cm) rigid pipe to the cooktop location. A smaller size pipe on longer runs may result in insufficient gas supply. Pipe-joint compounds that resist the action of LP gas must be used. Do not use TEFLON® tape. With LP gas, piping or tubing size should be 1/2" minimum. Usually, LP gas suppliers determine the size and materials used in the system.

Flexible metal appliance connector:

- If local codes permit, use a 1/2" or 3/4" I.D. flexible stainless steel tubing gas connector, designed by CSA to connect the cooktop to the rigid gas supply line.

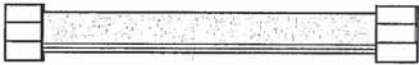

- A 1/2" male pipe thread is needed for connection to the female pipe threads of the inlet to the cooktop pressure regulator.
- Do not kink or damage the flexible metal tubing when moving the cooktop.

- Must include a shutoff valve:
The supply line must be equipped with a manual shutoff valve. This valve should be located in the same room but external to the cooktop opening, such as an adjacent cabinet. It must be accessible without removing the cooktop, and it should be in a location that allows ease of opening and closing. Do not block access to shutoff valve. The valve is for turning on or shutting off gas to the cooktop.

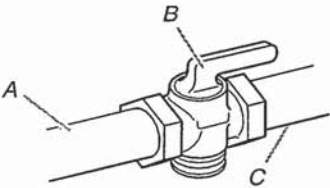

A. Gas supply line
B. Shutoff valve "open" position
C. To cooktop

®TEFLON is a registered trademark of E.I. Du Pont De Nemours and Company.

ELECTRICAL REQUIREMENTS

- A 120 volt, 60 Hz, AC only, 15-amp, fused electrical circuit is required. A time-delay fuse or circuit breaker is also recommended. It is recommended that a separate circuit serving only this cooktop be provided.
- Electronic ignition systems operate within wide voltage limits, but proper grounding and polarity are necessary. Check that the outlet provides 120-volt power and is correctly grounded.

Project: Wallaceton

Unit: 3158, Phase: 3

KitchenAid

27" (68.6 cm) and 30" (76.2 cm)

47 of 53

Model: 26-2897 B THE KINGSWARE® Over Combination

PRODUCT MODEL NUMBERS

KEMS309E

KOCE500E

KOCE507E

ELECTRICAL CONNECTION

If codes permit and a separate ground wire is used, it is recommended that a qualified electrical installer determine that the ground path and the wire gauge are in accordance with local codes. Check with a qualified electrical installer if you are not sure the oven is properly grounded.

This oven must be connected to a grounded metal, permanent wiring system.

Be sure that the electrical connection and wire size are adequate and in conformance with the National Electrical Code, ANSI/NFPA 70-latest edition or CSA Standards C22.1-94, Canadian Electrical Code, Part 1 and C22.2 No. O-M91-latest edition, and all local codes and ordinances.

To properly install your oven, you must determine the type of electrical connection you will be using and follow the instructions provided for it here.

- Oven must be connected to the proper electrical voltage and frequency as specified on the model/serial/rating plate. See the following illustration.

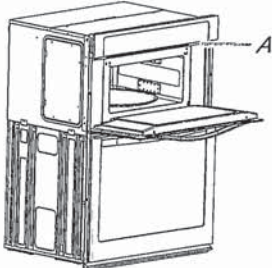

A. Model/serial/rating plate

- Models rated from 7.3 to 9.6 kW at 240 volts (5.4 to 7.4 kW at 208 volts) require a separate 40-amp circuit. Models rated at 4.8 kW and below at 240 volts (3.6 kW and below at 208 volts) require a separate 30-amp circuit.
- A circuit breaker is recommended.
- Connect directly to the fused disconnect (or circuit breaker box) through flexible, armored or nonmetallic sheathed, copper cable (with grounding wire). See "Make Electrical Connection" section.
- Flexible conduit from the oven should be connected directly to the junction box.
- Do not cut the conduit. The length of conduit provided is for serviceability of the oven.
- A UL listed or CSA approved conduit connector must be provided.
- If the house has aluminum wiring, follow the procedure below:
 1. Connect a section of solid copper wire to the pigtail leads.
 2. Connect the aluminum wiring to the added section of copper wire using special connectors and/or tools designed and UL listed for joining copper to aluminum.

Follow the electrical connector manufacturer's recommended procedure. Aluminum/copper connection must conform with local codes and industry accepted wiring practices.

For power requirements, refer to the following table.

Model	Voltage	Amperage (L1)*	Amperage (L2)*	Rating (W)
KOCE507E/KOCE500E	120/240	32	30	8000
KOCE507E/KOCE500E	120/208	30	28	6600

*Amperage values noted above are for information purposes only: the units are rated in watts.

Because Whirlpool Corporation includes a continues commitment to improve our products, we reserve the right to change materials and specifications without notice.

PRODUCT DIMENSIONS

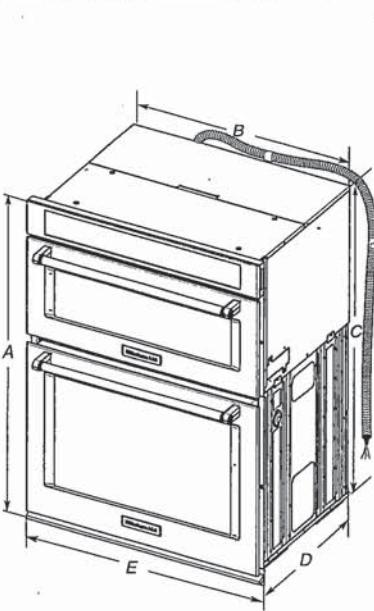

- 27" (68.6 cm) models**
- A. 42³/₁₆" (108.0 cm) overall height
 - B. 25⁷/₁₆" (64.6 cm) recessed width
 - C. 41" (104.1 cm) recessed height
 - D. 23³/₄" (59.1 cm) max. recessed depth
 - E. 27" (68.6 cm) overall width
 - F. 48" (121.9 cm) flexible conduit length measured from the conduit clamp located at the rear of the oven. Do not remove the conduit clamp.
- 30" (76.2 cm) models**
- A. 42³/₁₆" (108.0 cm) overall height
 - B. 28⁷/₁₆" (72.3 cm) recessed width
 - C. 41" (104.1 cm) recessed height
 - D. 23³/₄" (59.1 cm) max. recessed depth
 - E. 30" (76.2 cm) overall width
 - F. 48" (121.9 cm) flexible conduit length measured from the conduit clamp located at the rear of the oven. Do not remove the conduit clamp.

Cabinet Dimensions

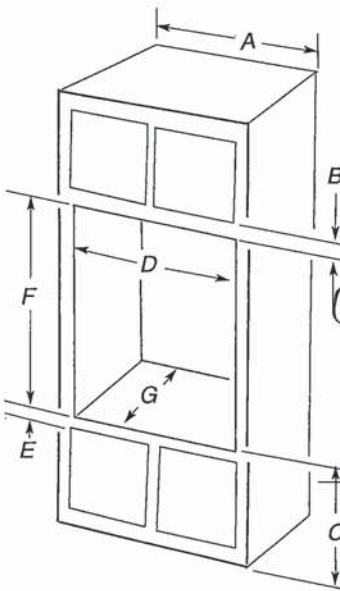

- 27" (68.6 cm) models**
- A. 27" (68.6 cm) min. cabinet width
 - B. 1" (2.5 cm) top of cutout to bottom of upper cabinet door
 - C. 19¹/₄" (48.9 cm) bottom of cutout to floor is recommended. 4"-19¹/₄" (10.2-48.9 cm) bottom of cutout to floor is acceptable.
 - D. 25¹/₂" (64.8 cm) cutout width
 - E. 1¹/₂" (3.8 cm) min. bottom of cutout to top of cabinet door
 - F. 41¹/₁₆" (105 cm)* recommended cutout height
 - G. 24" (60.7 cm) cutout depth
- 30" (76.2 cm) models**
- A. 30" (76.2 cm) min. cabinet width
 - B. 1" (2.5 cm) top of cutout to bottom
 - C. 19¹/₄" (48.9 cm) bottom of cutout to floor is recommended. 4"-19¹/₄" (10.2-48.9 cm) bottom of cutout to floor is acceptable.
 - D. 28¹/₂" (72.4 cm) cutout width
 - E. 1¹/₂" (3.8 cm) min. bottom of cutout
 - F. 41¹/₁₆" (105 cm)* recommended cutout
 - G. 24" (60.7 cm) cutout depth

* NOTE: The cabinet height can be between 41" (104.1 cm) and 41¹/₂" (105.6 cm) for microwave/oven combination.

Dimensions are for planning purposes only. For complete details, see Installation Instructions packed with product. Specifications subject to change without notice.

Ref. W10725683B
2/10/15

Project: Wallaceton
Unit: 3158, Phase: 3
Model: 28-2897 B THE KINGSMERE



24" Dishwasher

DETAILED PLANNING DIMENSIONS GUIDE

Applies to all model numbers starting with;
KDFE104K, KDFE204K, KDTE204K, KDTE204LPA, KDFM404K,
KDTM404K, KDPM604K, KDTM604K, KDPM704K, KDTM704K,
KDTM704LPA, KDPM804K, KDTM804K

PRODUCT DIMENSIONS

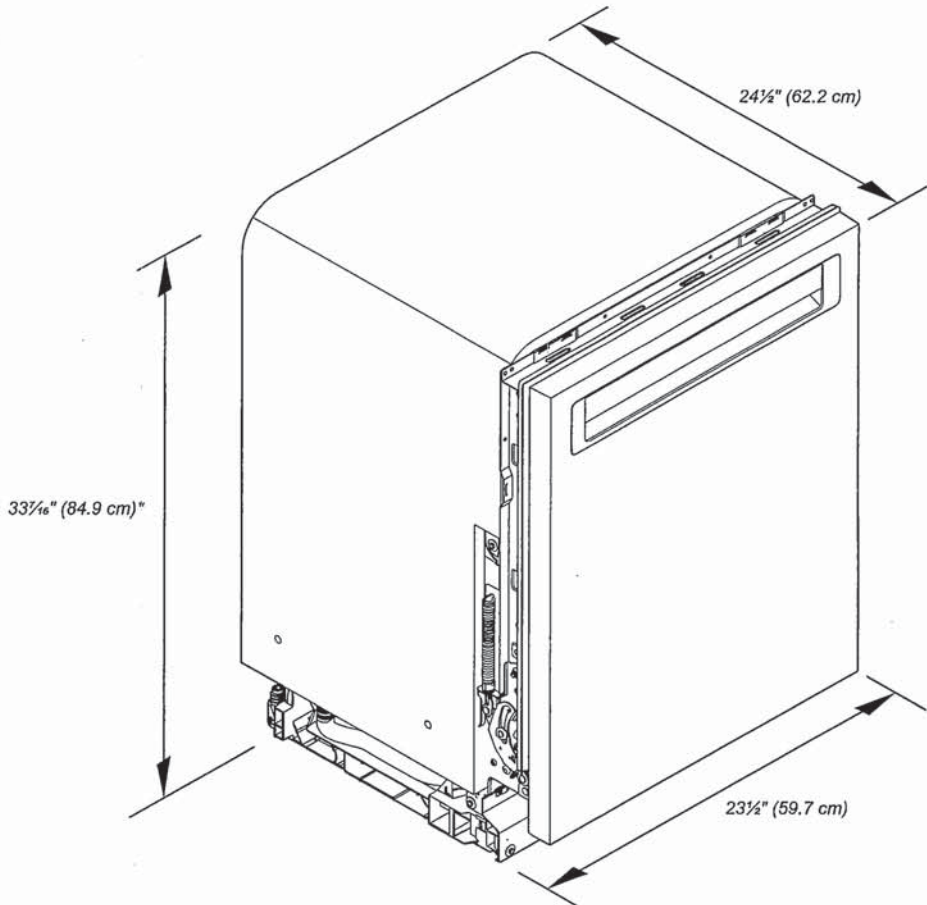

*Dishwasher can be raised 1 1/8" (3.7 cm) with feet fully extended.

Because Whirlpool Corporation policy includes a continuous commitment to improve our products, we reserve the right to change materials and specifications without notice.

Dimensions are for planning purposes only. For complete details, see Installation Instructions packed with product. Specifications subject to change without notice.

KitchenAid®

24" Dishwasher
DETAILED PLANNING DIMENSIONS GUIDE

PRODUCT DIMENSIONS (CONTD.)

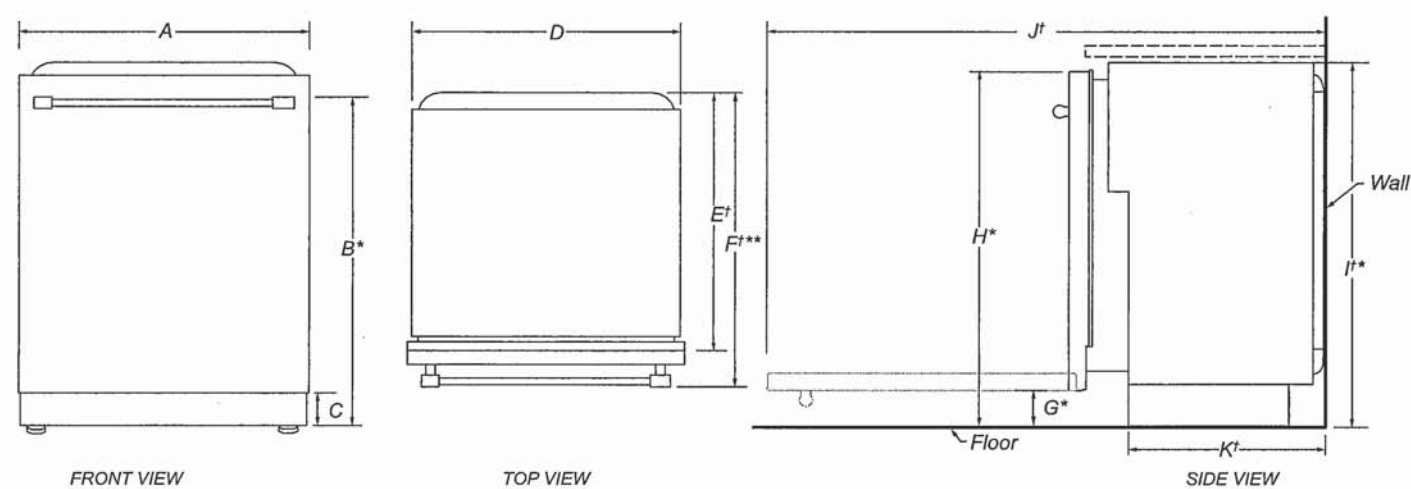

	DESCRIPTION	DIMENSIONS
A	Width of door	23½" (59.7 cm)
B*	Height to top of handle	30⅜" (78.3 cm)
C	Height of adjustable toe kick	3⅞" (8.4 cm) - min. 4⅞" (11.8 cm) - max.
D	Width of recessed dishwasher	22⅝" (57.4 cm)
E	Depth without door	22⅝" (57.5 cm)
E††	Depth with Towel Bar Handle	26⅞" (68.3 cm)
	Depth with Pocket Handle	24½" (62.6 cm)
	Depth of Panel-Ready Models	24" (61.0 cm)
G	Height to bottom of door (min.)	3⅞" (8.4 cm)
H*	Height to top of door (min.)	33⅞" (84.9 cm)
I*	Height of recessed dishwasher (min.)	33⅝" (85.4 cm)
J†	Depth with door fully open (min.)	50⅞" (127.4 cm)
K†	Depth with toe kick (min.)	20⅜" (52.9 cm)

†Insulation blanket thickness adds up to 11/16" (1.8 cm) but can crush up to 1/8" (0.3 cm).
*Dishwasher can be raised 1⅞" (3.7 cm) with feet fully extended.
**For panel-ready models, dishwasher depth is 24" (61.0 cm), not including the 3/4" (1.9 cm) custom door panel.

Because Whirlpool Corporation policy includes a continuous commitment to improve our products, we reserve the right to change materials and specifications without notice.

Dimensions are for planning purposes only. For complete details, see Installation Instructions packed with product. Specifications subject to change without notice.

KitchenAid®

24" Dishwasher
DETAILED PLANNING DIMENSIONS GUIDE

OPENING/CLEARANCE DIMENSIONS

IMPORTANT: Check that all surfaces have no protrusions that would prohibit dishwasher installation.

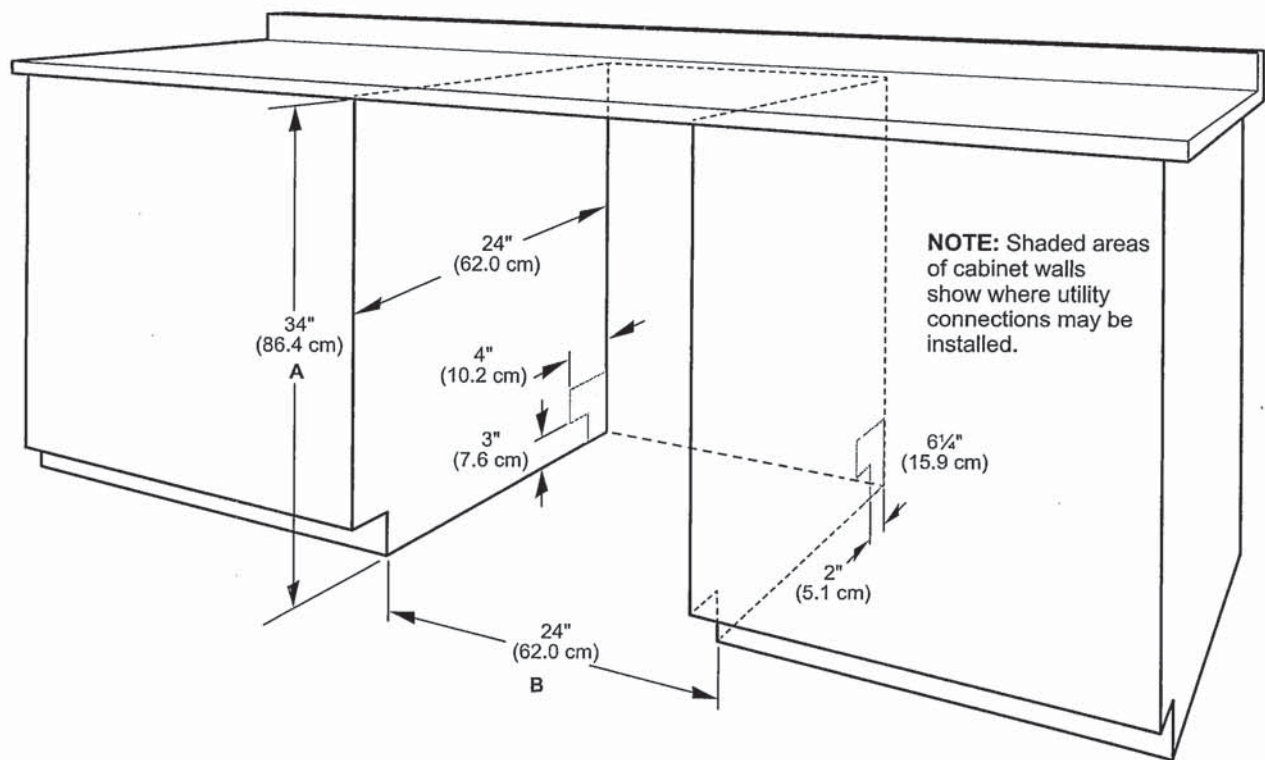

- A. Measured from the lowest point on the underside of the countertop. May be reduced to 33 1/2" (85.1 cm) by removing the wheels and perforated area of insulation (blanket) on dishwasher.
- B. Minimum, measured from narrowest point of opening.
- NOTE:** Corner locations require a 2" (5.1 cm) minimum clearance between the side of the dishwasher door and the wall or cabinet.

Because Whirlpool Corporation policy includes a continuous commitment to improve our products, we reserve the right to change materials and specifications without notice.

Dimensions are for planning purposes only. For complete details, see Installation Instructions packed with product. Specifications subject to change without notice.

DRAIN REQUIREMENTS

- A new drain hose is supplied with your dishwasher. If drain hose is not long enough, use a new drain hose with a maximum length of 12 ft (3.7 m) that meets all current AHAM/ IAPMO test standards, is resistant to heat and detergent, and fits the 1" (2.5 cm) drain connector of the dishwasher.

NOTE: Do not connect multiple drain hoses together.

- Make sure to connect drain hose to waste tee or disposer inlet above drain trap in house plumbing and 20" (50.8 cm) minimum above the floor. It is recommended that the drain hose either be looped up and securely fastened to the underside of the counter or be connected to an air gap.
- Make sure to use an air gap if the drain hose is connected to house plumbing lower than 20" (50.8 cm) above subfloor or floor.

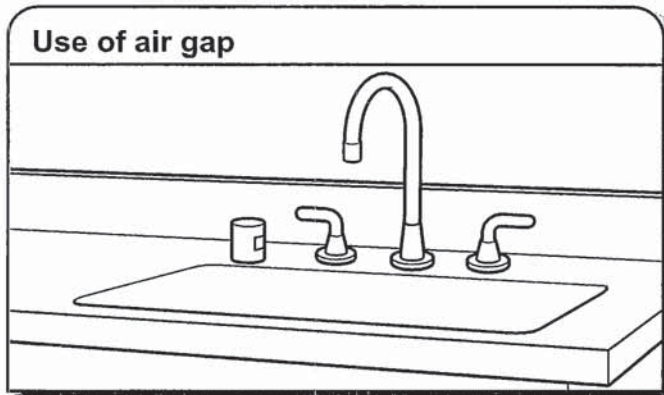

- If required, the air gap should be installed in accordance with the air gap installation instructions. When you are connecting the air gap, a rubber hose (not provided) will be needed to connect to the waste tee or disposer inlet.
- Use 1/2" (1.3 cm) minimum I.D. drain line fittings.

WATER SUPPLY REQUIREMENTS

- This dishwasher has a water heating feature and also requires a connection to a hot water supply line.
 - A hot water line with 20 psi to 120 psi (138 kPa to 862 kPa) water pressure can be verified by a licensed plumber.
 - 120°F (49°C) water at dishwasher.
 - 3/8" (0.95 cm) O.D. copper tubing with compression fitting or flexible braided water supply line.
- NOTE:** 1/2" (1.3 cm) minimum plastic tubing is not recommended.
- A 90° elbow with 3/4" (0.95 cm) hose connection with rubber washer.
 - Do not solder within 6" (15.2 cm) of the water inlet valve.
 - If installed in new construction, make sure the house water supply lines have been flushed prior to connecting the dishwasher to remove any debris that may exist in the supply line.

NOTE: If replacing an existing dishwasher, it is recommended to install a new water line and drain hose (supplied) with the new dishwasher.

ELECTRICAL REQUIREMENTS

⚠ WARNING**Electrical Shock Hazard**

Plug into a grounded 3 prong outlet.

Do not remove ground prong.

Do not use an adapter.

Do not use an extension cord.

Failure to follow these instructions can result in death, fire, or electrical shock.

Be sure that the electrical connection and wire size are adequate and in conformance with the National Electrical Code, ANSI/NFPA 70 - latest edition, and all local codes and ordinances.

A copy of the above code standards can be obtained from:

National Fire Protection Association
1 Batterymarch Park
Quincy, MA 02169-7471

You Must Have:

- 120 V, 60 Hz, AC only, 15 A or 20 A, fused electrical supply
- Copper wire only
- A maximum of 2 field wiring supply conductors (12 AWG largest size) plus 1 grounding conductor are permitted in the terminal box.

We Recommend:

- A time-delay fuse or circuit breaker.

Circuit Requirements:

- The dishwasher may be installed on the same circuit as a garbage disposal providing that the branch circuit cannot exceed rated circuit load and must comply with all governing codes and regulations such as but not limited to National Electrical Code, ANSI/NFPA 70 - latest edition.
- No electrical connections other than the dishwasher power and ground connections can be made inside of the dishwasher terminal box.

If connecting dishwasher with a power supply cord:

- Use UL Listed power cord kit marked for use with dishwasher.
- Plug into a grounded 3 prong outlet. Outlet must meet all local codes and ordinances.

**If connecting dishwasher with direct wiring:**

- Use flexible, armored, or nonmetallic sheathed copper wire with grounding wire that meets the wiring requirements for your home and local codes and ordinances.
- Use a UL Listed/CSA Approved metallic strain relief.

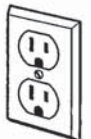

Project: Wallaceton
Unit: 3158, Phase: 3

HOME APPLIANCES
LG LAUNDRY
WM3850HVA
5.2 cu. ft. Capacity Front Load Washer

- AI DD™
- Steam Technology
- ENERGY STAR® Qualified
- SmartDiagnosis™
- Touch Control Panel
- ThinQ™ Technology (Wi-Fi Enabled)

SMART APPLIANCE

Enjoy new ways to control your home with LG smart appliances

LG ThinQ™

- Start the laundry while you're out shopping
- Get alerts when the cycle is finished
- Works with the LG ThinQ® app

works with the Google Assistant

WORKS WITH alexa

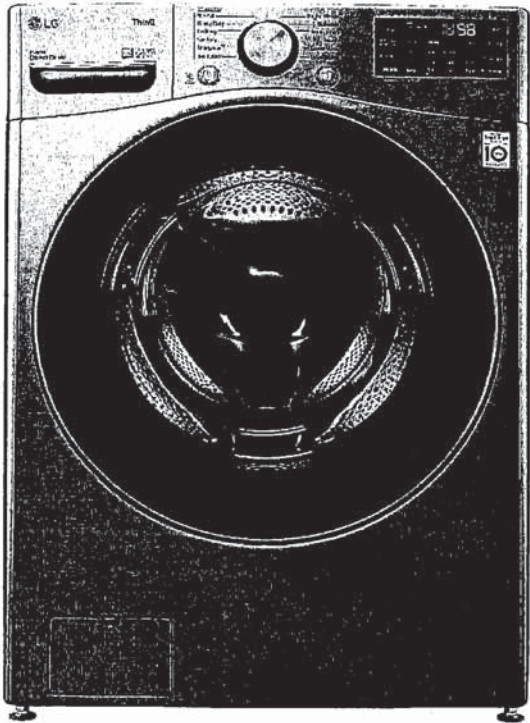

CAPACITY	
Capacity (cu.ft.)	5.2
APPEARANCE	
Design Look	Front Control
Intelligent Electronic Controls with LED Display	•
Touch Buttons	•
Dial-A-Cycle™	•
ENERGY	
ENERGY STAR® Qualified	•
CEE Tier	2
DRYING PROGRAMS	
No. of Programs - 12	Normal, Perm. Press, Heavy Duty, Delicates, Towels, Speed Wash, Bedding, Tub Clean, Bright Whites™, Sanitary, Allergiene™, Downloaded
No. of Options - 13	Steam, Fresh Care, Pre-wash, Remote Start, Delay Wash, Wi-Fi, Add Item, Cold Wash, Extra Rinse, Rinse+Spin, Control Lock, Spin Only, Signal
Temperature Settings	5 Extra Hot, Hot, Warm, Cold, Tap Cold
Spin Speeds	5 Extra High, High, Medium, Low, No Spin
Water Levels	Load Sensing
Soil Levels	5
FABRIC CARE FEATURES	
AI DD™	•
Steam Technology	•
Allergiene™ Cycle	•
Sanitary Cycle	•
ColdWash™ Option	•
CONVENIENCE FEATURES	
4 Tray Dispenser	Prewash, Main Wash (with liquid detergent cup), Bleach, Fabric Softener
TrueBalance™ Anti-Vibration System	•
Load Sense	•
Control Lock	•
Auto Suds Removal	•
Leveling Legs	4 Adjustable Legs
ThinQ® TECHNOLOGY	
SmartDiagnosis™ (v3.0)	•

Wi-Fi	•
Remote Start and Cycle Monitor	•
Energy Monitoring	•
Tub Clean Coach	•
MOTOR	
Motor Type	Inverter Direct Drive Motor
Motor Speed	Variable
Max RPM	1,300
Axis	Horizontal
MATERIALS AND FINISHES	
NeveRust™ Stainless Steel Drum	•
Cabinet	PCM
Control Panel	Plastic
Top Plate	Painted
Door Cover	Tempered Glass Door
Door / Rim	Glass / Shiny Rose Gold
All Available Colours	Graphite Steel (V)
POWER SOURCE	
Ratings	UL Listed
Electrical Requirements	120V, 10 Amps
Type	Electric
OPTIONS	
Pedestal	WDP4V 27" x 14 1/8" x 30 3/4"
SideKick™ Pedestal Washer	WD100CV 27" x 14 1/8" x 30 3/4"
Stacking Kit	KSTK1
DIMENSIONS	
Product (WxHxD)	27" x 39" x 30 1/4" 55" (With door open)
Carton (WxHxD)	29 23/32" x 42 27/32" x 31 17/32"
Weight (Product/Carton)	198.4 lbs / 212.1 lbs
LIMITED WARRANTY	
	1 Year Parts and Labour, 3 Years on Drum, 10 Years on Direct Drive Motor
UPC CODES	
WM3850HVA	772454073625
DLEX3850V	772454073304
WD100CV	772454052866
WDP4V	048231015165
KSTK1	772454059896

DLEX3850V
7.4 cu.ft. Capacity Electric Dryer

- TurboSteam™ Technology
- AI Sensor Dry™
- Aluminized Alloy Steel Drum
- Touch Control Panel
- ENERGY STAR® Qualified
- ThinQ Technology (Wi-Fi Enabled)
- FlowSense™ Duct Clogging Indicator

Enjoy new ways to control your home with LG smart appliances

LG ThinQ™

- Start the laundry while you're out shopping
- Get alerts when the cycle is finished
- Works with the LG ThinQ® app

works with the Google Assistant

works with alexa

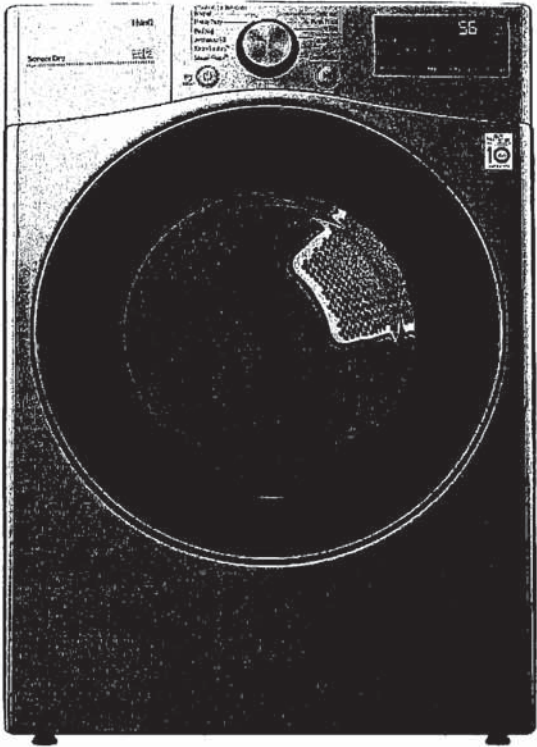

CAPACITY	
Capacity (cu.ft.)	7.4
APPEARANCE	
Design Look	Front Control
Intelligent Electronic Controls with LED Display	•
Touch Buttons	•
Dial-A-Cycle™	•
ENERGY	
ENERGY STAR® Qualified	•
DRYING PROGRAMS	
No. of Programs - 12	Normal, Heavy Duty, Bedding, Anti Bacterial, SteamSanitary™, SteamFresh™, Perm Press, Delicates, Towels, Speed Dry (Manual Dry), Air Dry (Manual Dry), Downloaded
No. of Options - 12	More Time, Less Time, Damp Dry Signal, Wrinkle Care, Control Lock, Wi-Fi, Energy Saver, TurboSteam™, Reduce Static, Remote Start, Drum Light, Signal
Temperature Settings	5 High, Mid High, Medium, Low, Ultra Low
Drying Levels	5 Very, More, Normal, Less, Damp
Manual Dry Times	60 min, 50 min, 40 min, 30 min, 20 min, More Time/Less Time
FABRIC CARE FEATURES	
AI Sensor Dry™	•
TurboSteam™	•
Precise Temperature Control and Variable Heater	•
CONVENIENCE FEATURES	
3 Minute Installation Check	•
LoDecibel™ Quiet Operation	•
End of Cycle Signal	•
Drum Light	•
Reversible Door	•
FlowSense™ Duct Clogging Indicator	•
Wrinkle Care Option	•
Control Lock	•
Venting Option	Electric: 4 Way Venting
Leveling Legs	4 Adjustable Legs
Remaining Time Display/Status Indicator(s)	•

ThinQ® TECHNOLOGY	
SmartDiagnosis™ (v3.0)	•
Wi-Fi	•
Remote Start and Cycle Monitor	•
Energy Monitoring	•
MATERIALS AND FINISHES	
Aluminized Alloy Steel Drum	•
Cabinet	Painted Steel
Control Panel	Plastic
Door	Tempered Glass
All Available Colours	Graphite Steel (V)
POWER SOURCE	
Ratings	CSA Listed
Electrical Requirements	Electric: 240V, 30 Amps
Type	Electric
BTU Rating	10,000 ft.
OPTIONS	
Pedestal	WDP4V
Pedestal (WxHxD)	27" x 14 1/8" x30 3/4"
Stacking Kit	KSTK1
DIMENSIONS	
Product (WxHxD)	27" x 39" x 30 1/8" 51 3/8" (With door open)
Carton (WxHxD)	29 1/2" x 42 1/4" x 31 1/4"
Weight (Product/Carton)	126.2 lbs / 139.4 lbs
LIMITED WARRANTY	
1 Year Parts and Labour, 3 Years on Drum	
UPC CODES	
WM3850HVA	772454073625
DLEX3850V	772454073304
WD100CV	772454052866
WDP4V	048231015165
KSTK1	772454059896