

Sales Selection Sheet
Checklist

1 of 42

LOT 786 Model: 30-2794 D The Willowglen
PURCHASERS: VIJAYARATNARAJA THAYALAN/SASIKALA THAYALAN
VENDOR: Heathwood Homes (Whitby) Limited

- ☐ COLD CELLAR
- ☐ DECK

UPGRADED / MODIFIED ELEVATION

- ☐ CORNER UPGRADE
- ☐ REAR UPGRADE

CEILING UPGRADE - SMOOTH

- ☒ MAIN FLOOR (STD)
- ☐ SECOND FLOOR WITH RESILIENCE CHANEL
- ☒ LOWER LEVEL

ADDITIONAL ROUGH-INS

- ☒ 200 AMP SERVICE (STD)
- ☒ WET BAR ROUGH-IN
- ☒ HUMIDIFIER (STD)
- ☒ AIR CONDITIONING (STD)

GAS ROUGH-IN

- ☒ STOVE
- ☐ DRYER
- ☐ BBQ
- ☐ ADDITIONAL GAS FIREPLACE

KITCHEN HOODFAN VENTING SIZE

- ☒ 6 IN ROUND DUCT (STD WITH APPLIANCE PACKAGE)
- ☐ 7 IN ROUND DUCT

FULL LOWER LEVEL STAIRS	All Oak
UPPER LOWER LEVEL STAIRS	N/A
LOWER LOWER LEVEL STAIRS	N/A
MAIN STAIRS	All Oak

May 14/24
Date Purchaser: *on file*

Date Purchaser:

May 14/24 TINA LEFUR
Date Decor Consultant:

m. Rosen
-05- 14 2024
Date Heathwood Homes (Whitby) Limited
Approved

Locked Date:

VIJAYARATNARAJA THAYALAN/SASIKALA THAYALAN
Project: Country Lane
Unit: 786, Phase: 7
Model: 30-2794 D The Willowglen

Created: 3/11/2024 13:10:59
Locked:
Closed:

Kitchen/Breakfast

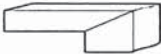
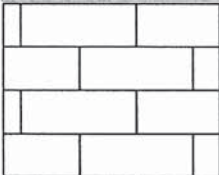
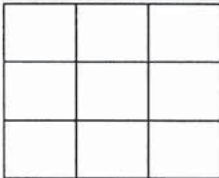
Cabinet Colour/Style	9829	Viking IV-WESTPORT-MACADAMIA ***UPG***
Island Cabinet Colour/Style	9829	Viking IV-WESTPORT-MACADAMIA ***UPG***
Cabinet Hardware	2086	9677-HARDWARE ***STD***
Countertop	9815	Group 2-Quartz-Caesarstone-GOLDEN SKY # 7524-3/4 inch B/U MITERED EDGE ***2***
Island Countertop	9815	Group 2-Quartz-Caesarstone-GOLDEN SKY # 7524-3/4 inch B/U MITERED EDGE ***2***
Countertop Edge	4005	DOUBLE MITRE 1 1/2 INCH ***STD IN KITCHEN ONLY*** 
Sink	9493	BLANCO QUATRUS U 1 SUPER SINGLE 401248 (min cabinet 36 in) PG 22
Crumb Vac Color	9482	Vacuum-Crumb Vac (Dust Pan)-White
HoodFan	9413	AVN-308CS-AVG 30 inch STAINLESS STEEL CHIMNEY WALL MOUNTED HOODFAN PG 32-33
Backsplash	5722	QT.CD.TPE.0306.BR-Colour and Dimension Bright-Taupe-3 x 6 ***1***
Backsplash Grout	9837	Grout-Warm Grey #5093 ***STD***
Backsplash Tile Pattern	3060	HORIZONTAL BRICK ***STD IN KITCHEN ONLY*** 
Flooring	9244	OV.ET.VLK.2424.PL-Eterna Volkas Polished White 24 x 24 UPG 6 ***UPG***
Floor Tile Grout	9837	Grout-Warm Grey #5093 ***STD***
Floor Tile Pattern	3000	STANDARD SQUARE ***STD*** 

- Purchasers have been advised: standard fridge opening is a minimum 37 3/8 x 73 3/8 inches. Ice Waterline Rough-In is included.
- Standard stove opening is 30 inches and standard dishwasher opening is 24 inches. Any gas stove will require backsplash or stainless steel backing to avoid fire hazards.
- Purchasers acknowledge: Heathwood Homes and its contractors will not be responsible for any kitchen cabinet changes due to appliances dimension changes after sign-off.

Comment

Servery

Cabinet Colour/Style	9829	Viking IV-WESTPORT-MACADAMIA ***UPG***
Cabinet Hardware	2086	9677-HARDWARE ***STD***
Opt. Cabinet Colour/Style - Uppers	9829	Viking IV-WESTPORT-MACADAMIA ***UPG***
Opt. Cabinet Hardware - Uppers	2086	9677-HARDWARE ***STD***

VIJAYARATNARAJA THAYALAN/SASIKALA THAYALAN
Project: Country Lane
Unit: 786, Phase: 7
Model: 30-2794 D The Willowglen

Created: 3/11/2024 13:10:59
Locked:
Closed:

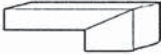
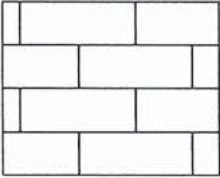
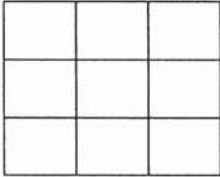
Opt. Cabinet Hardware - Uppers	2060	9077-HARDWARE STD
Countertop	9815	Group 2-Quartz-Caesarstone-GOLDEN SKY # 7524-3/4 inch B/U MITERED EDGE ***2***
Countertop Edge	4005	DOUBLE MITRE 1 1/2 INCH ***UPG*** 
Opt. Sink	1111	N/A *****
Opt. Backsplash	5722	QT.CD.TPE.0306.BR-Colour and Dimension Bright-Taupe-3 x 6 ***1***
Opt. Backsplash Grout	9837	Grout-Warm Grey #5093 ***STD***
Opt. Backsplash Tile Pattern	3060	HORIZONTAL BRICK ***STD IN KITCHEN ONLY*** 
Flooring	9244	OV.ET.VLK.2424.PL-Eterna Volkas Polished White 24 x 24 UPG 6 ***UPG***
Floor Tile Grout	9837	Grout-Warm Grey #5093 ***STD***
Floor Tile Pattern	3000	STANDARD SQUARE ***STD*** 
Comment		

Foyer

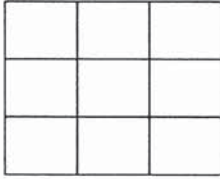
Flooring	9244	OV.ET.VLK.2424.PL-Eterna Volkas Polished White 24 x 24 UPG 6 ***UPG***
Floor Tile Grout	9837	Grout-Warm Grey #5093 ***STD***
Floor Tile Pattern	3000	STANDARD SQUARE ***STD*** 
Comment		

Powder Room

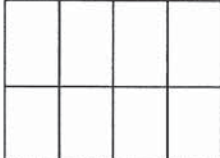
Flooring	9242	OV.ET.VLK.1224.PL-Eterna Volkas Polished White 12 x 24 floor tile directions SEE SKETCH UPG 5 ***UPG***	S 2
Floor Tile Grout	9837	Grout-Warm Grey #5093 ***STD***	
Floor Tile Pattern	3040	FRONT TO BACK ***STD*** 	

VIJAYARATNARAJA THAYALAN/SASIKALA THAYALAN
Project: Country Lane
Unit: 786, Phase: 7
Model: 30-2794 D The Willowglen

Created: 3/11/2024 13:10:59
Locked:
Closed:

Plumbing Fixture (Colour)	1737	Plumbing Fixtures-WHITE ***STD***
Comment		

Dining Room

Flooring	8499	Red Oak UVF-Vintage Red Oak Solid Sculpted-PEWTER-3/4 inch X 5 inch **STD ***
Comment		

Great Room

Flooring	8499	Red Oak UVF-Vintage Red Oak Solid Sculpted-PEWTER-3/4 inch X 5 inch **STD ***
Comment		

Great Room Fireplace

Type	8869	Majestic MERC32 ***STD***
Mantle	1439	NF 17-Paint Grade Mantle-Flat Wall-WHITE ***STD***
Surround (STD)	8874	3 pc- 4 inch Marble Surround-Grigio Carnico ***STD***

- Purchasers have been advised: heat from the FP can damage TV above a FP and items placed on mantle.

- Heathwood and its contractors will not be liable for any damage on items placed/@installed above a FP after closing.

Comment

Mud Room

Flooring	5609	GE.SU.GRY.1313 Sauble Grey 13 x13 ***STD***
Floor Tile Grout	7704	Grout-Pearl Gray / North Sea Grey ***STD***
Floor Tile Pattern	3000	STANDARD SQUARE ***STD***

Comment

Main Hall

Flooring	8499	Red Oak UVF-Vintage Red Oak Solid Sculpted-PEWTER-3/4 inch X 5 inch **STD ***
Comment		

VIJAYARATNARAJA THAYALAN/SASIKALA THAYALAN
Project: Country Lane
Unit: 786, Phase: 7
Model: 30-2794 D The Willowglen

Created: 3/11/2024 13:10:59
Locked:
Closed:

upper hall

Flooring	8499	Red Oak UVF-Vintage Red Oak Solid Sculpted-PEWTER-3/4 inch X 5 inch ** STD ***
Comment		

Master Bedroom

Flooring	9246	DY 84558-Dynasty Tex-BEACH SHELL-40 oz Poly***STD***
Comment		

Bedroom 2

Flooring	9246	DY 84558-Dynasty Tex-BEACH SHELL-40 oz Poly***STD***
Comment		

Bedroom 3

Flooring	9246	DY 84558-Dynasty Tex-BEACH SHELL-40 oz Poly***STD***
Comment		

Bedroom 4

Flooring	9246	DY 84558-Dynasty Tex-BEACH SHELL-40 oz Poly***STD***
Comment		

Master Ensuite

Cabinet Colour/Style	9111	Viking III-SIMCOE ORCHID 3DL ***STD***									
Cabinet Hardware	7676	12843-HARDWARE ***STD***									
Countertop	8796	6698-46-Countertop-PALOMA POLAR ETCHINGS FINISH-Formica ***STD***									
Countertop Edge	1111	N/A *****									
Floor Tile	9104	GE.MD.ANT.1818.MT Madison Series Antracite Matte 18 X 18 Matte ***1***									
Floor Tile Grout	7704	Grout-Pearl Gray / North Sea Grey ***STD***									
Floor Tile Pattern	3000	STANDARD SQUARE ***STD***									
		<table><tr><td></td><td></td><td></td></tr><tr><td></td><td></td><td></td></tr><tr><td></td><td></td><td></td></tr></table>									

VIJAYARATNARAJA THAYALAN/SASIKALA THAYALAN
Project: Country Lane
Unit: 786, Phase: 7
Model: 30-2794 D The Willowglen

Created: 3/11/2024 13:10:59
Locked:
Closed:

Shower Wall Tile	8833	QT.UW.WHT.0810-Uniwall-White-8 x 10 ***STD***
Shower Wall Tile Grout	2226	Grout-(00) White ***STD***
Shower Wall Tile Pattern	3070	HORIZONTAL STACKED ***STD***
		<div></div>
Shower Floor Tile	8108	OD.ON.DGR.02.HEX.MT-ONTARIO HEXAGON MATTE-DARK GREY ***UPG 2***
Shower Floor Tile Grout	7704	Grout-Pearl Gray / North Sea Grey ***STD***
Shower Floor Tile Pattern	3000	STANDARD SQUARE ***STD***
		<div></div>
Shower Jamb(s) and Sill(s)	8923	Shower Jamb / Sill-Thassos White ***STD***
Plumbing Fixture (colour)	1737	Plumbing Fixtures-WHITE ***STD***
Comment		

Shared Ensuite

Cabinet Colour/Style	9157	Viking III-SIMCOE-MOONLIGHT-3DL ***STD***
Cabinet Hardware	7672	135-HARDWARE ***STD***
Countertop	8796	6698-46-Countertop-PALOMA POLAR ETCHINGS FINISH-Formica ***STD***
Countertop Edge	1111	N/A *****
Floor Tile	5589	GE.BY.PEN.1313 New Byzantine Pentallic (Grey) 13 x13 ***STD***
Floor Tile Grout	9837	Grout-Warm Grey #5093 ***STD***
Floor Tile Pattern	3000	STANDARD SQUARE ***STD***
		<div></div>
Wall Tile	9022	QT.WV.TGR.0810-Weave-Tender Grey-8 x 10 ***STD***
Wall Tile Grout	2226	Grout-(00) White ***STD***
Wall Tile Pattern	3070	HORIZONTAL STACKED ***STD***
		<div></div>
Opt. Shower Floor Tile	1111	N/A *****
Opt. Shower Floor Tile Grout	1111	N/A *****

VIJAYARATNARAJA THAYALAN/SASIKALA THAYALAN
Project: Country Lane
Unit: 786, Phase: 7
Model: 30-2794 D The Willowglen

Created: 3/11/2024 13:10:59
Locked:
Closed:

Opt. Shower Floor Tile Pattern	1111	N/A *****
Opt. Shower Jamb(s) and Sill(s)	1111	N/A *****
Plumbing Fixture (colour)	1737	Plumbing Fixtures-WHITE ***STD***
Comment		

Ensuite 4

Cabinet Colour/Style	9157	Viking III-SIMCOE-MOONLIGHT-3DL ***STD***									
Cabinet Hardware	7672	135-HARDWARE ***STD***									
Countertop	8822	4924-38-Countertop-WHITE CARRARA-Wilsonart ***STD***									
Countertop Edge	1111	N/A *****									
Floor Tile	5589	GE.BY.PEN.1313 New Byzantine Pentallc (Grey) 13 x13 ***STD***									
Floor Tile Grout	9837	Grout-Warm Grey #5093 ***STD***									
Floor Tile Pattern	3000	STANDARD SQUARE ***STD*** <table><tr><td></td><td></td><td></td></tr><tr><td></td><td></td><td></td></tr><tr><td></td><td></td><td></td></tr></table>									
Shower Wall Tile	9025	QT.UW.TGR.0810-Uniwall-Tender Grey-8 x 10 ***STD***									
Shower Wall Tile Grout	2226	Grout-(00) White ***STD***									
Shower Wall Tile Pattern	3070	HORIZONTAL STACKED ***STD*** <table><tr><td></td><td></td></tr><tr><td></td><td></td></tr><tr><td></td><td></td></tr><tr><td></td><td></td></tr></table>									
Shower Floor Tile	8104	OD.ON.TPE.02.HEX.MT-ONTARIO HEXAGON MATTE-TAUPE ***UPG 2***									
Shower Floor Tile Grout	7704	Grout-Pearl Gray / North Sea Grey ***STD***									
Shower Floor Tile Pattern	3000	STANDARD SQUARE ***STD*** <table><tr><td></td><td></td><td></td></tr><tr><td></td><td></td><td></td></tr><tr><td></td><td></td><td></td></tr></table>									
Shower Jamb(s) and Sill(s)	8923	Shower Jamb / Sill-Thassos White ***STD***									
Plumbing Fixture (colour)	1737	Plumbing Fixtures-WHITE ***STD***									
Comment											

VIJAYARATNARAJA THAYALAN/SASIKALA THAYALAN
Project: Country Lane
Unit: 786, Phase: 7
Model: 30-2794 D The Willowglen

Created: 3/11/2024 13:10:59
Locked:
Closed:

Flooring	5609	GE.SU.GRY.1313 Sauble Grey 13 x13 ***STD***									
Floor Tile Grout	7704	Grout-Pearl Gray / North Sea Grey ***STD***									
Floor Tile Pattern	3000	STANDARD SQUARE ***STD*** <table><tr><td></td><td></td><td></td></tr><tr><td></td><td></td><td></td></tr><tr><td></td><td></td><td></td></tr></table>									
Opt. Cabinet Colour/Style - Uppers	1111	N/A *****									
Opt. Cabinet Hardware - Uppers	1111	N/A *****									
Comment											

Lower Level Finished Foyer

Flooring	9246	DY 84558-Dynasty Tex-BEACH SHELL-40 oz Poly***STD***
Comment		

Lower Level Recreation Room

Flooring	9246	DY 84558-Dynasty Tex-BEACH SHELL-40 oz Poly***STD***
Comment	NF-17 WHIATE PAINT GRADE CABINET MANTEL FOR STANDARD ELECTRIC FIREPLACE	

PG 21

Lower Level Bedroom

Flooring	9246	DY 84558-Dynasty Tex-BEACH SHELL-40 oz Poly***STD***
Comment		

Lower Level Bathroom

Cabinet Colour/Style	9111	Viking III-SIMCOE ORCHID 3DL ***STD***									
Cabinet Hardware	7676	12843-HARDWARE ***STD***									
Countertop	8796	6698-46-Countertop-PALOMA POLAR ETCHINGS FINISH-Formica ***STD***									
Countertop Edge	1111	N/A *****									
Floor Tile	8262	TR.ST.GRY.1313-Serpentine-Grey-13x13 ***STD***									
Floor Tile Grout	7704	Grout-Pearl Gray / North Sea Grey ***STD***									
Floor Tile Pattern	3000	STANDARD SQUARE ***STD*** <table><tr><td></td><td></td><td></td></tr><tr><td></td><td></td><td></td></tr><tr><td></td><td></td><td></td></tr></table>									

VIJAYARATNARAJA THAYALAN/SASIKALA THAYALAN
Project: Country Lane
Unit: 786, Phase: 7
Model: 30-2794 D The Willowglen

Created: 3/11/2024 13:10:59
Locked:
Closed:

Shower Wall Tile	9020	QT.WV.WHT.0810-Weave-White-8 x 10 ***STD***	
Shower Wall Tile Grout	2226	Grout-(00) White ***STD***	
Shower Wall Tile Pattern	3070	HORIZONTAL STACKED ***STD***	
Shower Floor Tile	8661	OD.ON.SWT.0202.MT.N-Ontario Series Mosaic-Snow White Matte-2 x 2 ***STD***	
Shower Floor Tile Grout	2226	Grout-(00) White ***STD***	
Shower Floor Tile Pattern	3000	STANDARD SQUARE ***STD***	
Shower Jamb(s) and Sill(s)	8923	Shower Jamb / Sill-Thassos White ***STD***	
Plumbing Fixture (colour)	1737	Plumbing Fixtures-WHITE ***STD***	
Comment			

Main Stairs

Type	1712	Oak Stairs ***STD***
Colour	7922	Eclipse (Pewter) STAIN TO COMPLIMENT HARDWOOD AND WILL VARY FROM FLOORING ***99***
Handrail/Pickets/Posts Type	8148	Single Collar Alt. Plain w/ Shoes with 3 1/2 Square/Cap Post(s)-BLACK ***STD ***
Handrail/Pickets/Posts Colour	7922	Eclipse (Pewter) STAIN TO COMPLIMENT HARDWOOD AND WILL VARY FROM FLOORING ***99***
Custom Stain/Paint	1111	N/A *****
Landing(s)	8499	Red Oak UVF-Vintage Red Oak Solid Sculpted-PEWTER-3/4 inch X 5 inch **STD ***
Opt. Carpet Runner	1111	N/A *****
Comment		

Lower Level Stairs

Type	1712	Oak Stairs ***STD***
Colour	7922	Eclipse (Pewter) STAIN TO COMPLIMENT HARDWOOD AND WILL VARY FROM FLOORING ***99***
Handrail/Pickets/Posts Type	8148	Single Collar Alt. Plain w/ Shoes with 3 1/2 Square/Cap Post(s)-BLACK ***STD ***
Handrail/Pickets/Posts Colour	7922	Eclipse (Pewter) STAIN TO COMPLIMENT HARDWOOD AND WILL VARY FROM FLOORING ***99***
Custom Stain/Paint	1111	N/A *****

Customer Colours

VIJAYARATNARAJA THAYALAN/SASIKALA THAYALAN
Project: Country Lane
Unit: 786, Phase: 7
Model: 30-2794 D The Willowglen

10 of 42

Created: 3/11/2024 13:10:59

Locked:

Closed:

Landing(s)	8499	Red Oak UVF-Vintage Red Oak Solid Sculpted-PEWTER-3/4 inch X 5 inch **STD ***
Opt. Carpet Runner	1111	N/A *****
Comment		

Throughout

Switches and Plug	5796	Decora White Switches and Plugs ***STD***
Thresholds	2232	Metal Thresholds ***STD***
Underpad	1079	500 Series-Underpad ***STD***
Trim Size	8704	5 1/4 inch Baseboard and 3 inch Integrated Backbend Casings ***UPG*** / ***STD in Singles***
Trim - Paint Colour	1716	Trim-WHITE ***STD***
Walls - Paint Colour	1717	22-Wall-WARM GREY ***STD***
Comment		

Purchaser:



VIJAYARATNARAJA THAYALA

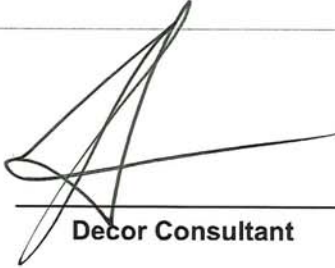

Decor Consultant



04/22/24

Date



04/22/24

Date

Purchaser:



SASIKALA THAYALAN



Country Lane

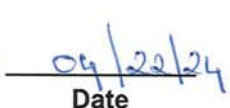

04/22/24

Date



-05-14 2024

Date Approved



CONSTRUCTION SUMMARY

Lot: 786
Model: 30-2794 D The Willowglen
Project/Phase: Country Lane / 7

Offer Worksheet	Supply and Install Central Air Conditioning Note:
Offer Worksheet	Two Men and a Truck Credit of One Thousand Dollars (\$1000.00) for moving services only, Into your Heathwood Home (No Cash Value) The Credit is Non-Transferable and cannot be combined with any other offer. - Singles Note:
Offer Worksheet	Classic Collection: Five Appliances: SS Fridge, Stove, Dishwasher: White Front Loader Washer/Dryer (Singles) Note:
Offer Worksheet	The Purchaser(s) acknowledge that they have NOT been referred by an existing Heathwood Homeowner and therefor are not entitled to a referral fee under Heathwood Homes Referral program. Note:



CONSTRUCTION SUMMARY

Lot: 786
Model: 30-2794 D The Willowglen
Project/Phase: Country Lane / 7

APPLIANCES

Invoice	Qty.	Description
1662 390,077 17Sep24	1.0	KITCHEN - AVN-308CS-AVG 30 inch STAINLESS STEEL CHIMNEY WALL MOUNTED HOODFAN ***UPG*** SEE SPEC CABINETRY-delete stove uppers; ELECTRICAL-Notify; HEATING/AIR CONDITIONING-Duct Size remains 6

CABINETRY

Invoice	Qty.	Description
1662 389,866 17Sep24 **	1.0	KITCHEN - PLUMBING - KITCHEN SINK UPGRADE - BLANCO QUATRUS U 1 SUPER SINGLE 401248 (MIN CABINET 36 IN) KITCHEN SEE SPECS CABINETRY-upgraded kitchen sink; GRANITE-upgraded kitchen sink
1662 391,818 17Sep24	1.0	Kitchen - Cabinetry - VIKING IV - Kitchen - UPG KITCHEN
1662 391,823 17Sep24	1.0	Servery - Cabinetry - VIKING IV - Opt. Servery Uppers - UPG SKETCH # 3
1662 390,077 17Sep24 **	1.0	KITCHEN - AVN-308CS-AVG 30 inch STAINLESS STEEL CHIMNEY WALL MOUNTED HOODFAN ***UPG*** SEE SPEC CABINETRY-delete stove uppers; ELECTRICAL-Notify; HEATING/AIR CONDITIONING-Duct Size remains 6

CERAMICS

Invoice	Qty.	Description
1662 392,128 17Sep24	1.0	SERVERY ONLY - CERAMICS - SERVERY BACKSPLASH SINGLES SERVERY - UG 1
1662 391,989 17Sep24	1.0	POWDER ROOM - CERAMICS - POWDER FLOOR - UG 5
1662 392,010 17Sep24	1.0	KITCHEN/BREAKFAST - CERAMICS - KITCHEN/BREAKFAST FLOOR - UG 6
1662 392,007 17Sep24	1.0	FOYER - CERAMICS - FOYER FLOOR - UG 6
1662 392,011 17Sep24	1.0	SERVERY ONLY - CERAMICS - SERVERY FLOOR - UG 6
1662 391,921 17Sep24	1.0	MASTER ENSUITE - CERAMICS - PRINCIPAL BATH FLOOR - UG 1 PRINCIPAL ENSUITE



CONSTRUCTION SUMMARY

Lot: 786
Model: 30-2794 D The Willowglen
Project/Phase: Country Lane / 7

CERAMICS

Invoice	Qty.	Description
1662 391,928 17Sep24	1.0	MASTER ENSUITE - CERAMICS - PRINCIPAL SHOWER SHOWER FLOOR - UG 2 PRINCIPAL ENSUITE
1662 391,929 17Sep24	1.0	ENSUITE 4 - CERAMICS - MAIN BATH 4 SHOWER FLOOR - UG 2 ENSUITE 4 BATH

CONCRETE AND DRAIN

Invoice	Qty.	Description
1662 389,561 17Sep24 **	1.0	FINISHED BASEMENT FAMILY (REC) ROOM - PLUMBING - OPTIONAL EXTRA - ROUGH- IN FOR FUTURE WET BAR - BASEMENT - SEE SKETCH # 1 FOR LOCATION

DRYWALL

Invoice	Qty.	Description
1662 391,844 17Sep24	1.0	- Drywall - Smooth Ceilings - Basement - UPG PAINTING-Paint smooth ceiling
1662 395,461 17Sep24 **	1.0	- CLASSIC COLLECTION SCHEDULE A - Choice of 20 LED (3000K) pot lights in finished areas (Second Floor Potlight(s) Require Smooth Ceiling) DRYWALL-Drywall Ceiling cutouts for potlights FRAMING-Frame to accommodate potlights INSTALL 4 X GREAT ROOM ON SEPARATE SWITCH 3 X BREAKFAST ROOM ON EXISTING 3 WAY SWITCH 3 X KITCHEN ON SEPARATE SWITCH 4 X DINING ROOM ON SEPARATE SWITCH 5 X MAIN HALL USE STANDARD 3 WAY SWITCH AND 1 X RECREATION ROOM ON SEPARATE SWITCH SKETCH # 1 AND 2



CONSTRUCTION SUMMARY

Lot: 786
Model: 30-2794 D The Willowglen
Project/Phase: Country Lane / 7

ELECTRICAL

Invoice	Qty.	Description
1662 389,800 17Sep24 **	1.0	KITCHEN - HEATING/AIR - ROUGH-IN GAS LINE FOR GAS STOVE AT MAIN FLOOR (SEE SPECS) (HOOK-UP NOT INCLUDED) LEAVE STANDARD 120 VOLT ELECTRICAL OUTLET ON A SEPARATE CIRCUIT. * SPECIFY IF STANDARD 220V WILL STAY OR BE RELOCATED ELECTRICAL-Notify KITCHEN- STANDARD 240V 40 AMP TO STAY -PURCHASER GOING WITH ELECTRIC STOVE BUT MAY CHANGE TO GAS LATER
1662 390,529 17Sep24	2.0	- ELECTRICAL-SUPPLY AND INSTALL RECESSED PLUG ON EXISTING CIRCUIT 1X TO BE CENTERED +/- ABOVE FIREPLACE IN GREAT ROOM APPROX. 70" +/- FROM FLOOR; 1X TO BE CENTERED +/- ABOVE ELECTRIC FIREPLACE IN RECREATION ROOM APPROX. 70" +/- FROM FLOOR. SEE SKETCH # 1 AND 2
1662 390,528 17Sep24	4.0	- ELECTRICAL-RELOCATION OF SWITCHES/LIGHTS (MUST SPECIFY LOCATION)-NOTE: PLUGS CANNOT BE RELOCATED- MUST PURCHASE ADDITIONAL OUTLET. 1)1X BREAKFAST LIGHT TO BE RELOCATED AS CAPPED ELECTRICAL AND CENTERED +/- ON ISLAND; 2) 1X STD KITCHEN TO BE CENTERED +/- ON ISLAND;3) STD HALLWAY LIGHT AS CAPPED ELECTRICAL ON ISLAND; 4) 1X HALLWAY LIGHT RELOCATED TO BE CENTERED +/- ON SECOND FLOOR CEILING IN STAIRWELL- PURCHASER ACKNOWLEDGES FIXTURE CANNOT EXCEED 75LBS.. SEE SKETCH # 2 AND 4
1662 390,077 17Sep24 **	1.0	KITCHEN - AVN-308CS-AVG 30 inch STAINLESS STEEL CHIMNEY WALL MOUNTED HOODFAN ***UPG*** SEE SPEC CABINETRY-delete stove uppers; ELECTRICAL-Notify; HEATING/AIR CONDITIONING-Duct Size remains 6
1662 395,461 17Sep24	1.0	- CLASSIC COLLECTION SCHEDULE A - Choice of 20 LED (3000K) pot lights in finished areas (Second Floor Potlight(s) Require Smooth Ceiling) DRYWALL-Drywall Ceiling cutouts for potlights FRAMING-Frame to accommodate potlights INSTALL 4 X GREAT ROOM ON SEPARATE SWITCH 3 X BREAKFAST ROOM ON EXISTING 3 WAY SWITCH 3 X KITCHEN ON SEPARATE SWITCH 4 X DINING ROOM ON SEPARATE SWITCH 5 X MAIN HALL USE STANDARD 3 WAY SWITCH AND 1 X RECREATION ROOM ON SEPARATE SWITCH SKETCH # 1 AND 2

FRAMING

Invoice	Qty.	Description
1662 395,461 17Sep24 **	1.0	- CLASSIC COLLECTION SCHEDULE A - Choice of 20 LED (3000K) pot lights in finished areas (Second Floor Potlight(s) Require Smooth Ceiling) DRYWALL-Drywall Ceiling cutouts for potlights FRAMING-Frame to accommodate potlights INSTALL 4 X GREAT ROOM ON SEPARATE SWITCH 3 X BREAKFAST ROOM ON EXISTING 3 WAY SWITCH 3 X KITCHEN ON SEPARATE SWITCH 4 X DINING ROOM ON SEPARATE SWITCH 5 X MAIN HALL USE STANDARD 3 WAY SWITCH AND 1 X RECREATION ROOM ON SEPARATE SWITCH SKETCH # 1 AND 2

GRANITE

Invoice	Qty.	Description
1662 389,866 17Sep24 **	1.0	KITCHEN - PLUMBING - KITCHEN SINK UPGRADE - BLANCO QUATRUS U 1 SUPER SINGLE 401248 (MIN CABINET 36 IN) KITCHEN SEE SPECS CABINETRY-upgraded kitchen sink; GRANITE-upgraded kitchen sink
1662 391,848 17Sep24	1.0	Kitchen/Servery - Granite - Countertop - 3/4? GROUP 2 with double edge - Kitchen/Servery - UPG KITCHEN



CONSTRUCTION SUMMARY

Lot: 786
Model: 30-2794 D The Willowglen
Project/Phase: Country Lane / 7

HEATING / AIR CONDITIONING

Invoice	Qty.	Description
1662 389,800 17Sep24	1.0	KITCHEN - HEATING/AIR - ROUGH-IN GAS LINE FOR GAS STOVE AT MAIN FLOOR (SEE SPECS) (HOOK-UP NOT INCLUDED) LEAVE STANDARD 120 VOLT ELECTRICAL OUTLET ON A SEPARATE CIRCUIT. * SPECIFY IF STANDARD 220V WILL STAY OR BE RELOCATED ELECTRICAL-Notify KITCHEN- STANDARD 240V 40 AMP TO STAY -PURCHASER GOING WITH ELECTRIC STOVE BUT MAY CHANGE TO GAS LATER
1662 390,077 17Sep24 **	1.0	KITCHEN - AVN-308CS-AVG 30 inch STAINLESS STEEL CHIMNEY WALL MOUNTED HOODFAN ***UPG*** SEE SPEC CABINETRY-delete stove uppers; ELECTRICAL-Notify; HEATING/AIR CONDITIONING-Duct Size remains 6

PAINTING

Invoice	Qty.	Description
1662 391,844 17Sep24 **	1.0	- Drywall - Smooth Ceilings - Basement - UPG PAINTING-Paint smooth ceiling

PLUMBING

Invoice	Qty.	Description
1662 389,866 17Sep24	1.0	KITCHEN - PLUMBING - KITCHEN SINK UPGRADE - BLANCO QUATRUS U 1 SUPER SINGLE 401248 (MIN CABINET 36 IN) KITCHEN SEE SPECS CABINETRY-upgraded kitchen sink; GRANITE-upgraded kitchen sink
1662 389,561 17Sep24	1.0	FINISHED BASEMENT FAMILY (REC) ROOM - PLUMBING - OPTIONAL EXTRA - ROUGH- IN FOR FUTURE WET BAR - BASEMENT - SEE SKETCH # 1 FOR LOCATION

STRUCTURED WIRING

Invoice	Qty.	Description
1662 389,571 17Sep24	2.0	- STRUCTURED WIRING - CONDUIT PIPE TO ABOVE FIREPLACE ROUGH-IN 1) 1X TO BE CENTERED +/- ABOVE FIREPLACE IN GREAT ROOM APPROX. 70" +/- FROM FLOOR; 2) 1X TO BE CENTERED +/- ABOVE ELECTRIC FIREPLACE IN RECREATION ROOM APPROX. 70" +/- FROM FLOOR. SEE SKETCH # 1 AND 2



30-2794 ELEV. D

The Willowglen

Sketch # 1

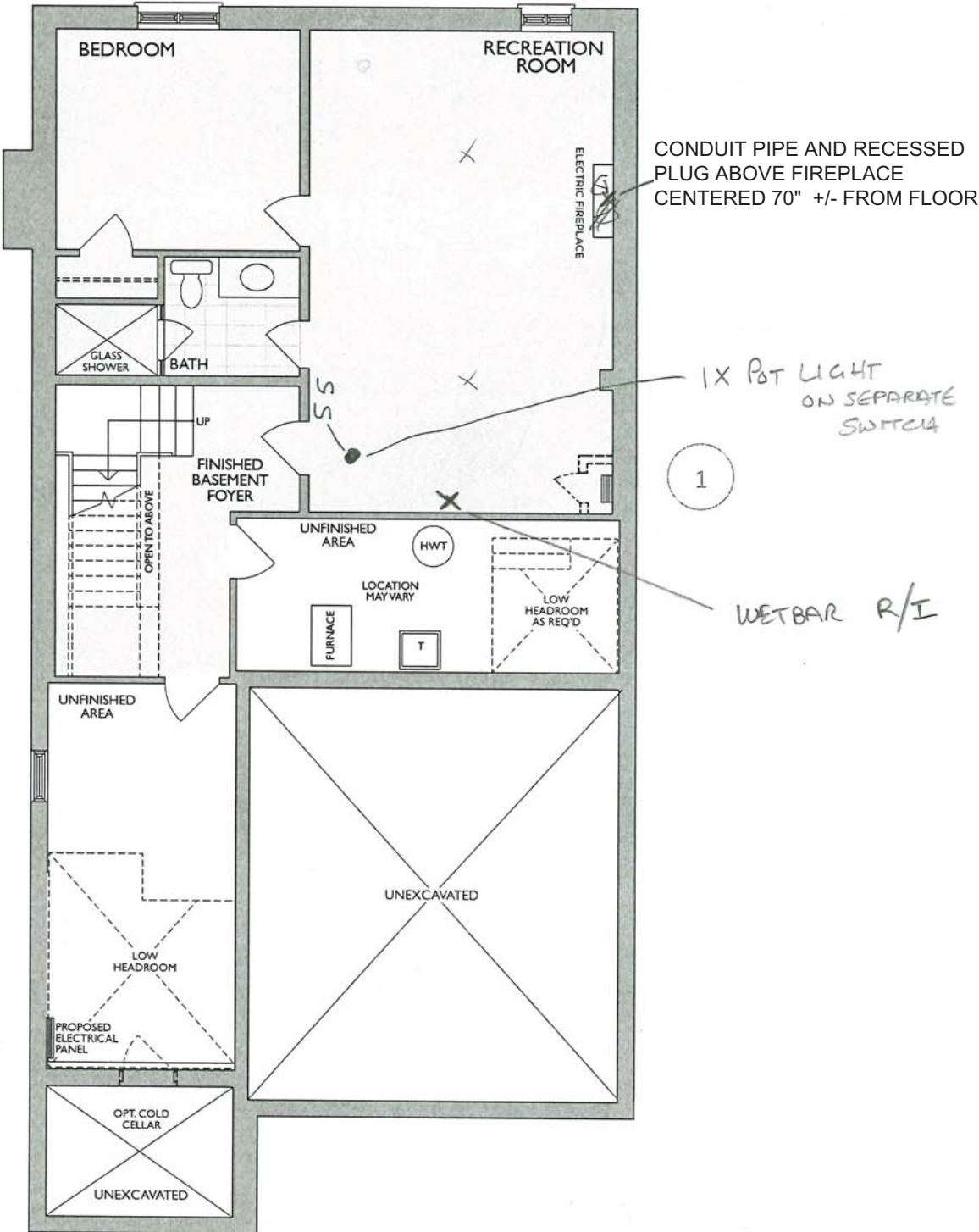

FINISHED LOWER LEVEL
ELEV. D

Changes made to match the Architectural plan:

- 1. Hydro closet when required

* Floor plan may vary due to grading conditions.

Sketch #2



30-2794 ELEV. D

The Willowglen

4 X POTLIGHTS IN GREAT ROOM ON SEPARATE SWITCH CENTERED +/- FOR FUTURE WAFFLE CEILING

CONDUIT PIPE AND RECESSED PLUG ABOVE FIREPLACE CENTERED 70" +/- FROM FLOOR

5 X POTLIGHTS IN MAIN HALLWAY ON EXISTING 3-WAY SWITCH

12 X 24 TILE DIRECTION

RELOCATE STD KITCHEN/ BREAKFAST/HALL LIGHTS TO BE CAPPED OVER ISLAND ON EXISTING SWITCH

4 X POTLIGHTS IN DINING ROOM ON SEPARATE SWITCH

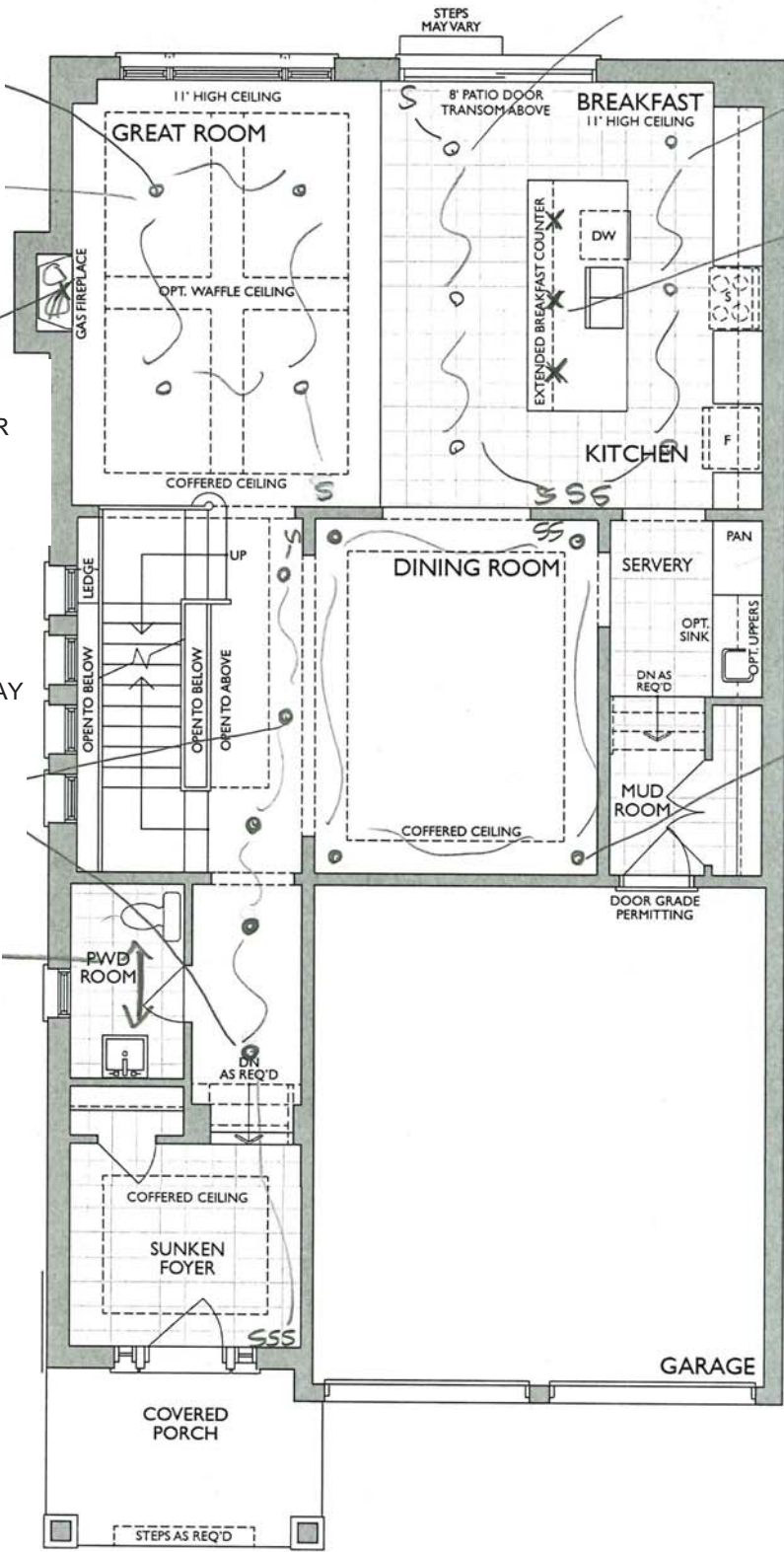

MAIN LEVEL
ELEV. D

* Floor plan may vary due to grading conditions.

Project: Country Lane
Unit: 786, Phase: 7
Model: 30-2794 D The Willow Glen

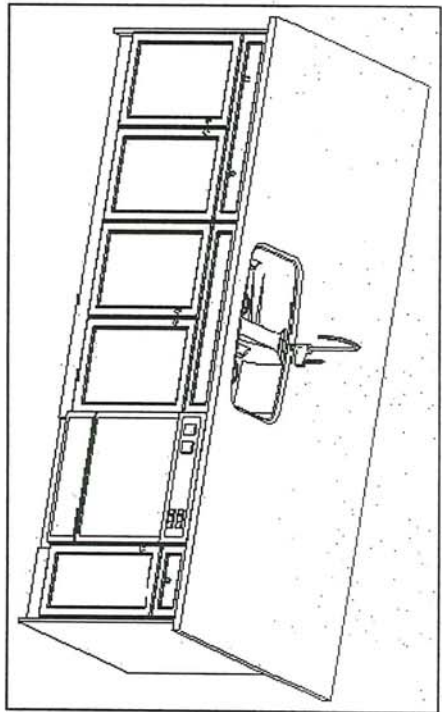
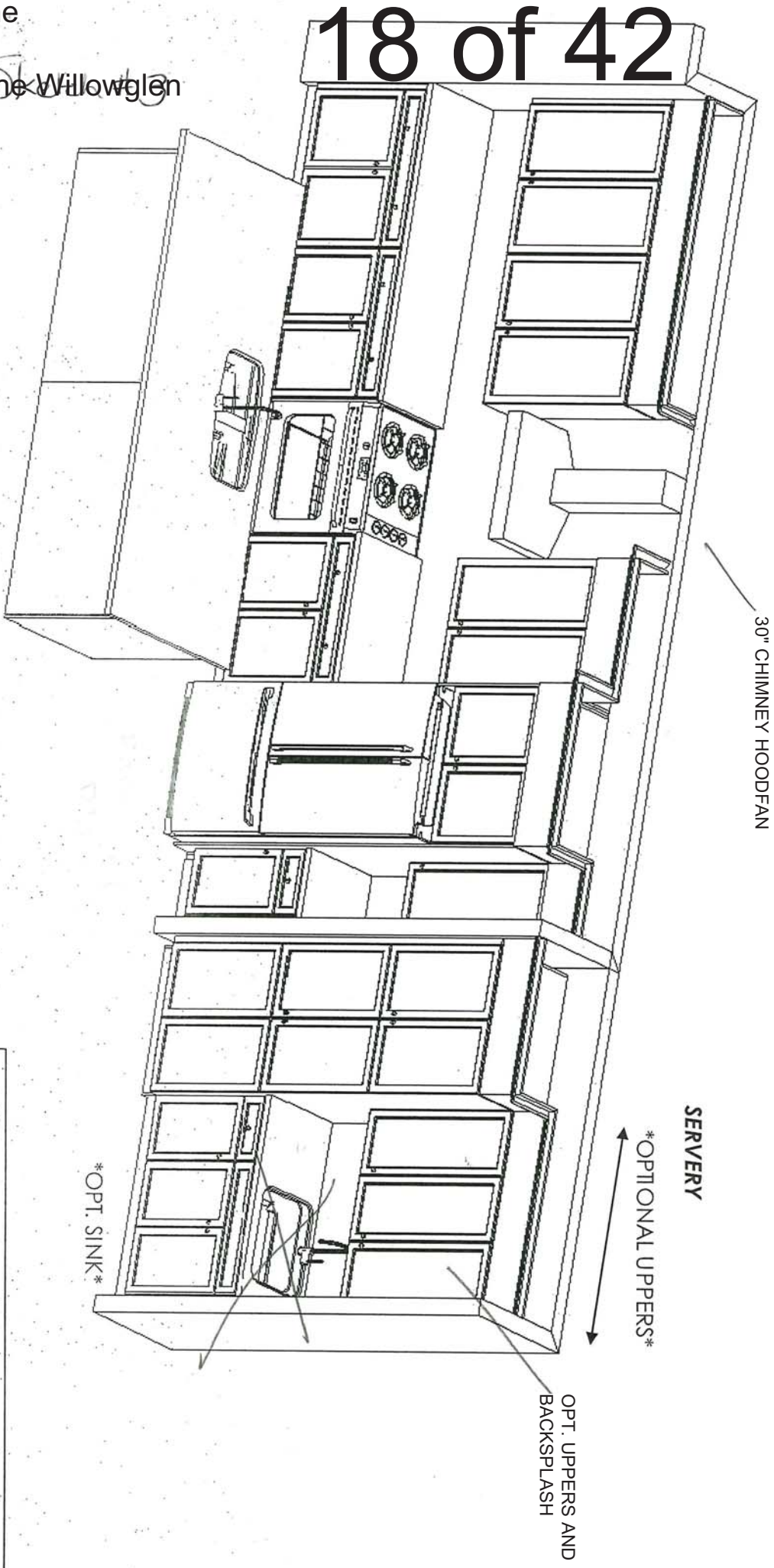

This sketch is for DESIGN PURPOSES ONLY – It is not meant to be an exact rendition.

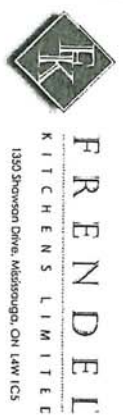

Heathwood Homes
Country Lane, Whitby

Model:
30-2794 (3604)
The Classic Series

Standard Features:

- Tandem Box Soft Close Drawers
- Blumotion Hinges for Doors
- Crown Moulding & fascia
- Top Drawer Construction
- Deep Fridge Upper w/Deep Panel
- Tall upper Cabinets

Drawn By: Sepideh B
Date: July 12, 2023
Revision:
Scale: Not To Scale

Approved By Builder:

Date:

Sketch #4



30-2794 ELEV. D

The Willowglen

RELOCATE 1 STD MAIN
HALLWAY LIGHT TO BE
CENTERED +/- ON 2ND FLOOR
OPEN TO ABOVE IN STAIRWELL
ON EXISTING 3-WAY SWITCH
FOR UPPER HALL LIGHTS

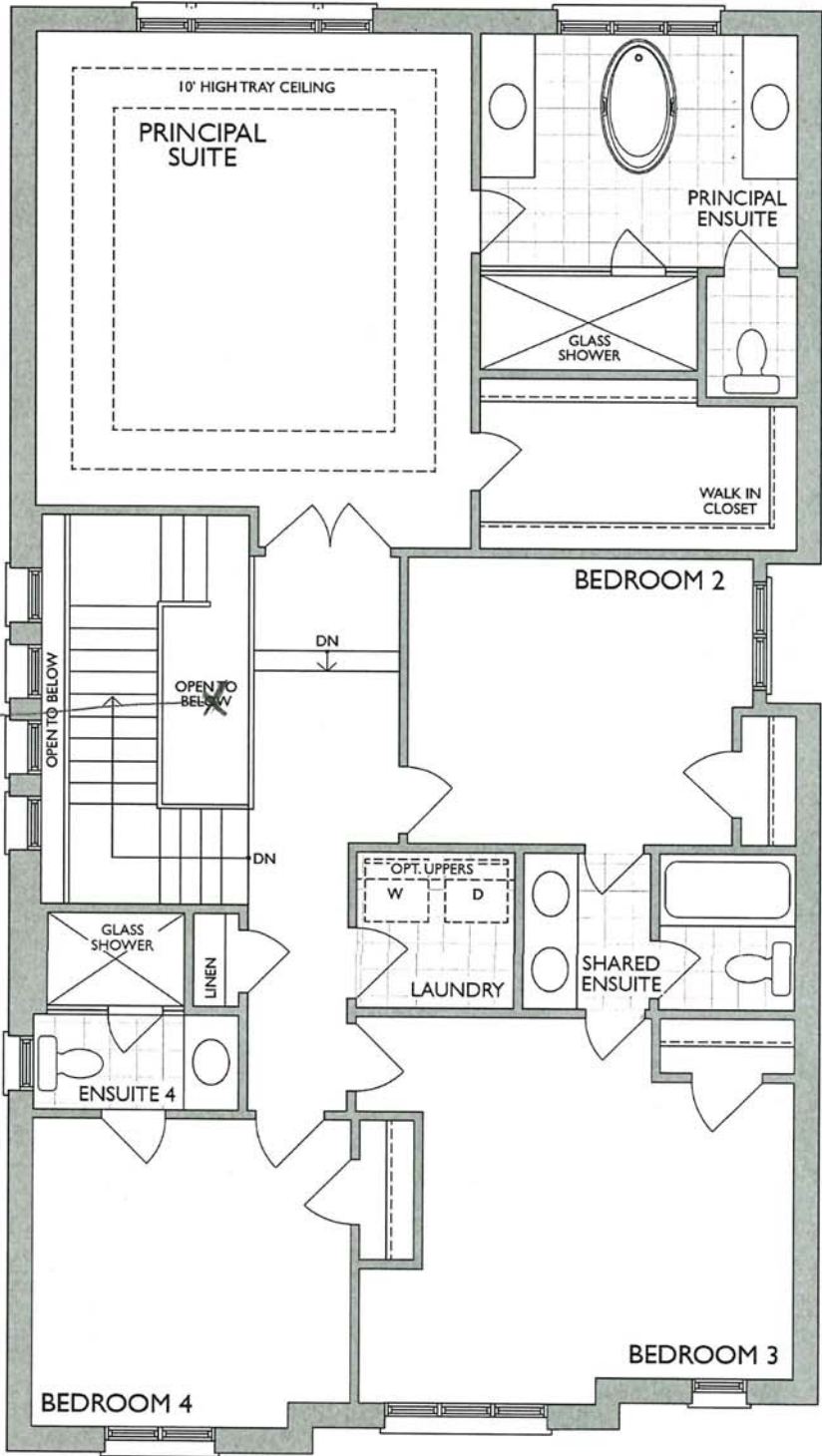

SECOND LEVEL
ELEV. D

* Floor plan may vary due to grading conditions.

Project: Country Lane
Unit: 786, Phase: 7
Model: 30-2794 D The Willowglen

Sketch #5

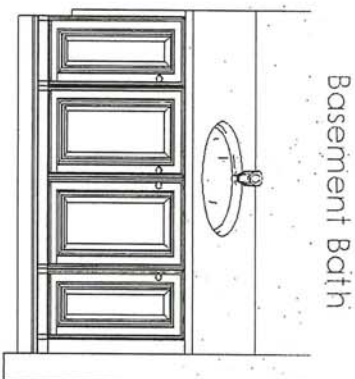
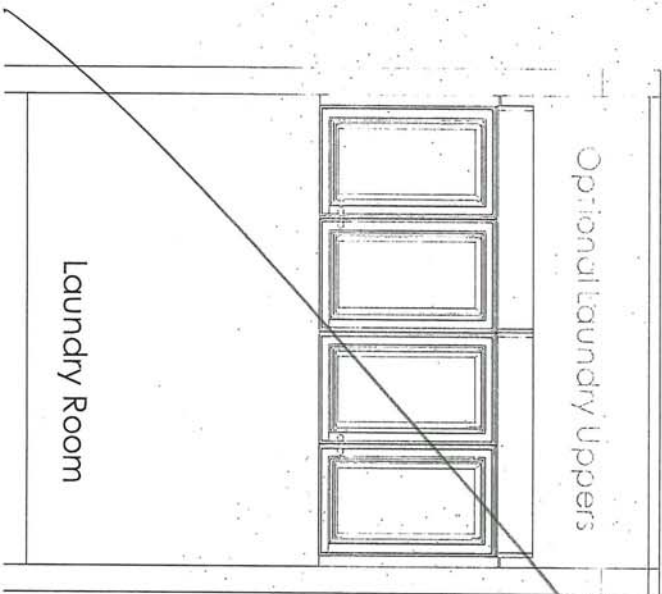
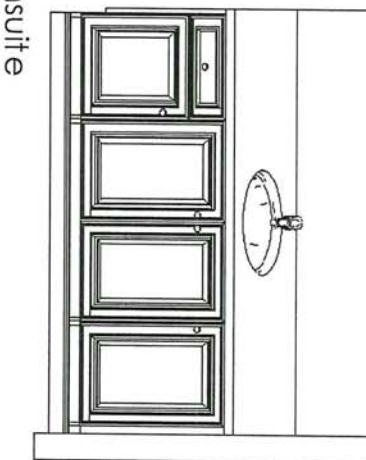
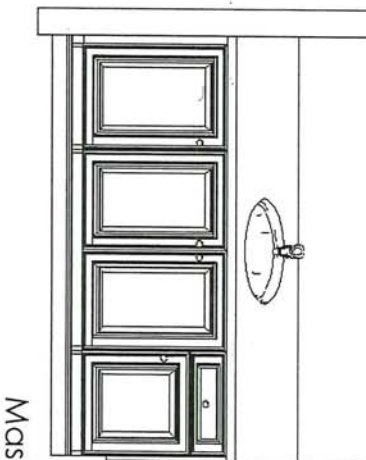
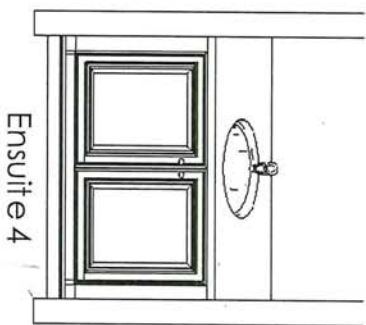
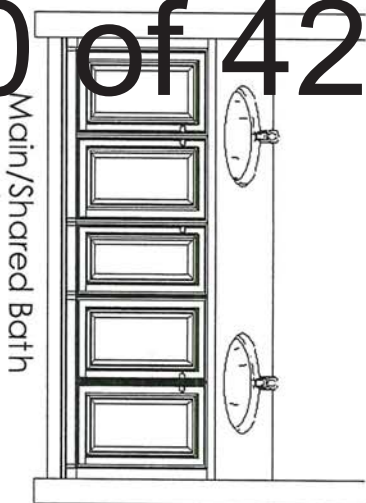

2.3
7.1

This sketch is for DESIGN PURPOSES ONLY – It is not meant to be an exact rendition.



F R E N D E L
K I T C H E N S L I M I T E D
1350 Sheppard Drive, Mississauga, ON L4W 1C5

Heathwood Homes
Country Lane, Whitby

Model:
30-2794 (3604)
The Classic Series

Standard Features:

- Blum Metabox Drawers
- Blum Clip On Hinges
- Top Drawer in Master Ensuite

Drawn By: Sepideh B
Date: July 12, 2023
Revision:
Scale: Not To Scale

Approved By Builder:

Date:



NEAS NF17 Mantel

GREAT ROOM E. FLAT WALL
RECREATION ROOM-CABINET

V.T.
7.3

BLANCO

Sink Specifications

Colour	SKU
brushed finish	401248

QUATRUS U 1 SUPER SINGLE

Stainless steel brushed finish

Design and planning tips

- Min cabinet size: 36 in (915 mm)
- Bowl Depth: 9 in (230.0 mm)

Specifications:
Installation clips, Sink template, Installation instructions, 3 ½" (90 mm) stainless steel strainer

Depending on cabinet construction, a different cabinet size may be required. Consult the cabinet manufacturer.
Codes/Standards: ASME A112.19.3-2017/ CSA B45.4-17

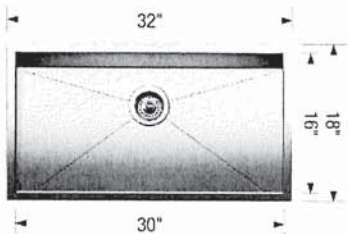

Optional Accessories

Elevated Grid	406346
Workstation	406344
CapFlow Strainer Cover	517666
Ash Cutting Board	406345
Sink Grid	402125

Warranty
Limited lifetime warranty on all sinks and faucets. One-year warranty on all accessories and soap dispensers.

Code/Standards Compliance
BLANCO sinks and faucets are third-party tested and certified to CSA, cUPC, ANSI/ASME, IAPMO and NSF standards and listed by applicable certification bodies. For more information on individual product listings, contact our office or listing organization.

 Need support? Learn more by watching our sink & faucet How-to videos:
<https://www.blanco.com/ca-en/support/how-to-videos/how-to-videos-for-sinks/>

	BLANCO Canada Inc 100 Corporation Drive Brampton ON L6S 6B5	Tel & Fax Tel: 905-494-2400 Toll free: 1-877-425-2626 Fax: 905-494-2425 Toll free: 1-877-825-2626
---	---	---

While BLANCO strives to provide accurate information, all images and dimensions in this document are intended for reference only and are subject to change at any time without notice. This document is not intended for use as an installation guide. For technical installation details, refer to installation instructions provided with the product. BLANCO assumes no responsibility for the use of superseded or voided specifications.

MOEN®

Specifications

FAUCET DESCRIPTION

- Reflex™ pulldown system offers smooth operation, easy movement and secure docking
- Power Clean™ spray technology
- Metal construction with various finishes identified by suffix
- Quick connect installation
- Pulldown spray with 68" braided hose
- Flexible supply lines with 3/8" compression fittings
- High arc spout provides height and reach to fill or clean large pots while pulldown wand provides the maneuverability for cleaning or rinsing
- 360° rotating spout
- Faucet designed for handle to be mounted on right side only

OPERATION

- Lever style handle
- Temperature controlled by 100° arc of handle travel
- Operates with less than 5 lbs. of force
- Operates in stream or spray mode in the pullout or retracted position

FLOW

- Flow is limited to 1.5 gpm (5.7 L/min) max at 60 psi

CARTRIDGE

- 1255™ Duralast™ cartridge

STANDARDS

- Third party certified to IAPMO Green, ASME A112.18.1/CSA B125.1 and all applicable requirements therein including NSF 61/9G & 372
- Meets CalGreen and Georgia SB370 requirements
- Complies with California Proposition 65 and with the Federal Safe Drinking Water Act
- The backflow protection system in the device consists of two independently operating check valves, a primary and a secondary which prevent backflow

- ADA  for lever handle

WARRANTY

- Lifetime limited warranty against leaks, drips and finish defects to the original homeowner
 - 10 year limited warranty when used in a multifamily installation
 - 5 year limited warranty when used in a commercial installation
- Visit www.moen.com/support for complete details and limitations

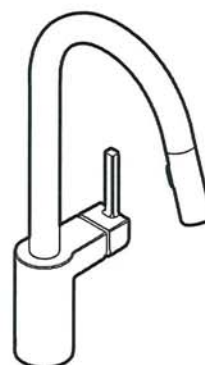

ALIGN™

**Single Handle High Arc
Pulldown Kitchen Faucet**

Models: 7565 series

NOTE: THIS FAUCET IS DESIGNED TO BE INSTALLED
THROUGH 1 HOLE, 1-1/2" (38mm) MIN. DIA.
(OPTIONAL 3-HOLE ESCUTCHEON 141002 AVAILABLE)

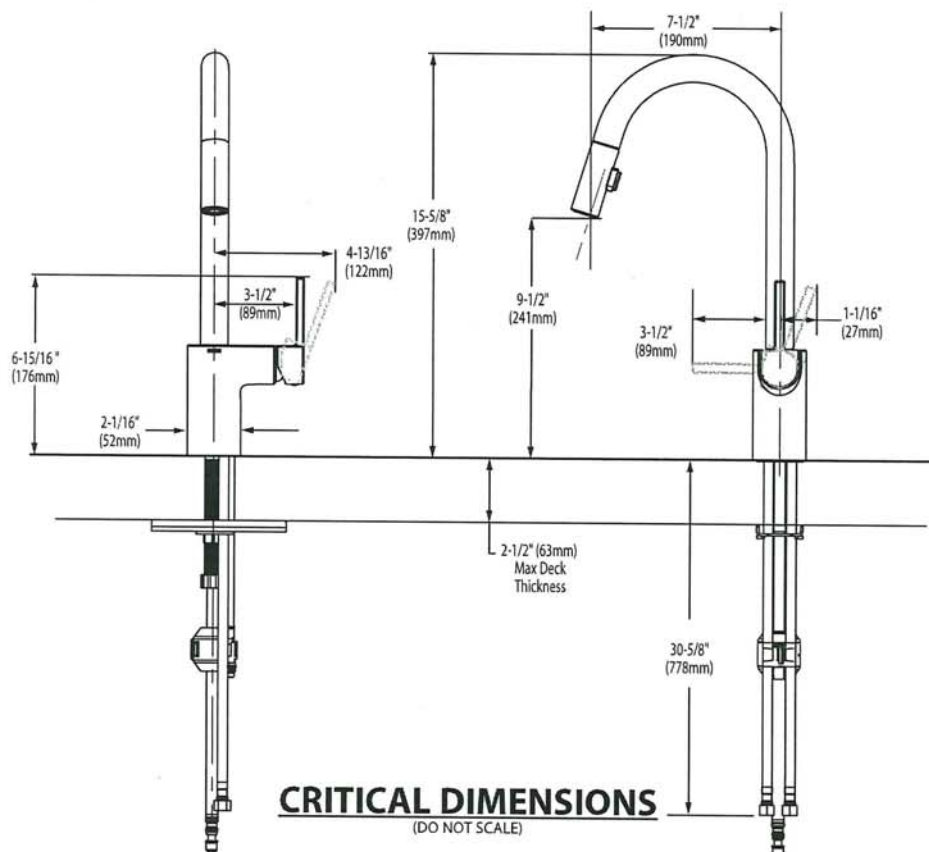

V.T.
13



BARRIER FREE (ABOVE COUNTER OR DROP-IN ONLY)

**BOULEVARD®
PEDESTAL SINK**
VITREOUS CHINA

BOULEVARD® PEDESTAL SINK

- STD ☒ ~~0641.800~~ Faucet holes on 8" (203mm) centers (Illustrated)
☒ **0641.400** Faucet holes on 4" (102mm) centers
☒ ~~0641.100~~ Center hole only
- Classic styled rectangular pedestal lavatory
 - Vitreous china
 - Rear overflow
 - Supplied with mounting kit
 - Right Height® for greater comfort during use
 - Faucet ledge with large deck area (faucet not included)
 - **Design coordinates with Boulevard® Toilet**
 - Basin has flat bottom to also allow use as an **above counter** sink or a **drop-in** sink (with u-shaped cut out)

Nominal Dimensions:

24" x 19" x 35-1/2"
(610 x 483 x 902mm)

- ☐ **0641.008** Pedestal top-8" (203mm) centers
- ☐ **0641.004** Pedestal top-4" (102mm) centers
- ☐ **0641.001** Pedestal top-center hole only
- ☐ **0010.000** Pedestal only

Bowl sizes:

17" (432mm) wide,
12-1/2" (318mm) front to back,
5" (127mm) deep

Compliance Certifications -

Meets or Exceeds the Following Specifications:

- ASME A112.19.2 - 2008/CSA B45.1-08

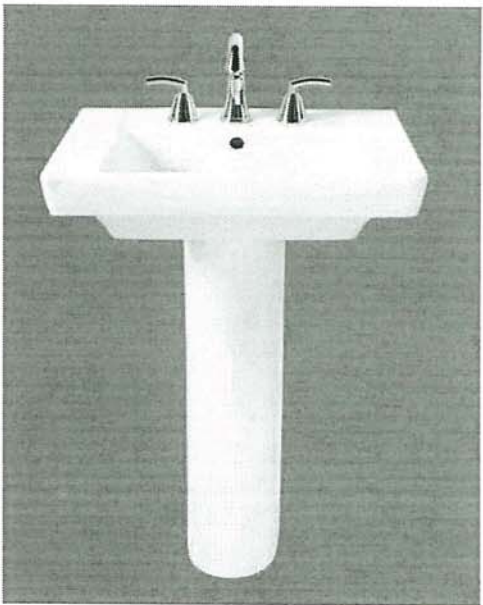

SEE REVERSE FOR ROUGHING-IN DIMENSIONS

To Be Specified:

- ☐ Color: ☐ White ☐ Linen
- ☐ Faucet Finish:
- ☐ Supplies:
- ☐ 1-1/4" Trap:
- ☐ Nipple:

* See faucet section for additional models available

V.T.
1.9

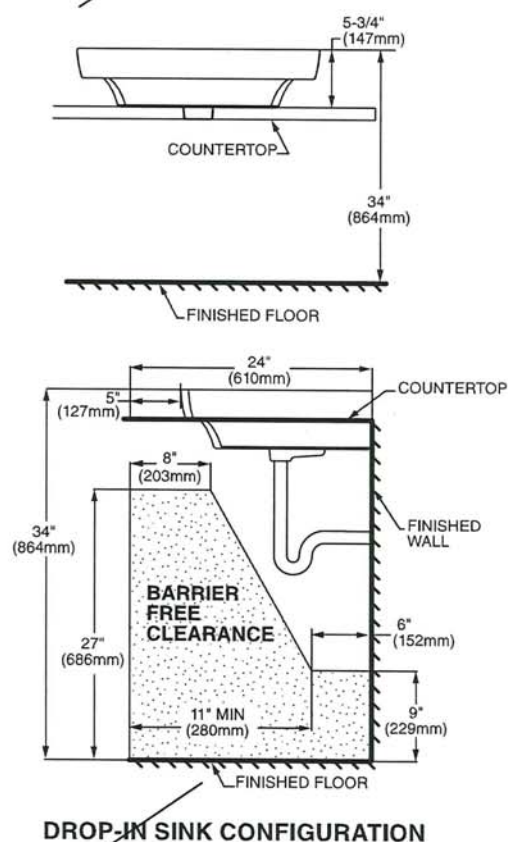

Top of sink installed at 34" (864mm) height from finished floor.
Sink installed 5" (127mm) minimum from front edge of countertop.
Provide 27" (686mm) knee clearance area.

NOTES:

NOTES:
 * DIMENSIONS SHOWN FOR LOCATION OF SUPPLIES AND "P" TRAPS ARE SUGGESTED.
 ▼ PEDESTAL ANCHORING SCREWS NOT INCLUDED.
 ■ SUITABLE FOR REINFORCEMENT ONLY. ACTUAL DIMENSIONS MUST BE TAKEN FROM FIXTURE.
 FITTING NOT INCLUDED AND MUST BE ORDERED SEPARATELY.
 PROVIDE SUITABLE REINFORCEMENT FOR ALL WALL SUPPORTS.
 INSTALLATION INSTRUCTIONS SUPPLIED WITH LAVATORY.

IMPORTANT: Dimensions of fixtures are nominal and may vary within the range of tolerance established by ANSI Standard A112.19.2. These measurements are subject to change or cancellation. No responsibility is assumed for use of superseded or voided pages.

V.T.
A.S



COLONY™
COUNTERTOP SINK
VITREOUS CHINA

COLONY COUNTERTOP SINK

- Vitreous china
- Self-rimming
- Front overflow
- Supplied with template
- Faucet deck
(Faucet shown not included)



- ☐ 0346 803
Faucet holes on 203mm (8") centres
- ☒ 0346 403 (Illustrated)
Faucet holes on 102mm (4") centres
- ☐ 0346 001
Centre hole only

Nominal Dimensions:
521 x 448mm (20-1/2" x 17-5/8")

Bowl sizes:
422mm (16-5/8") wide, 279mm (11") front to back, 143mm (5-5/8") deep

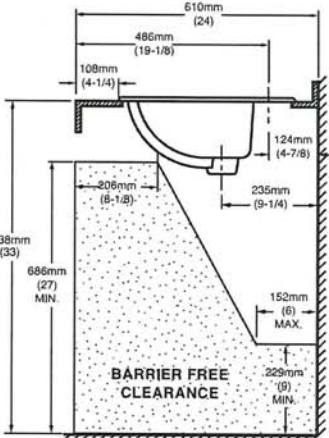
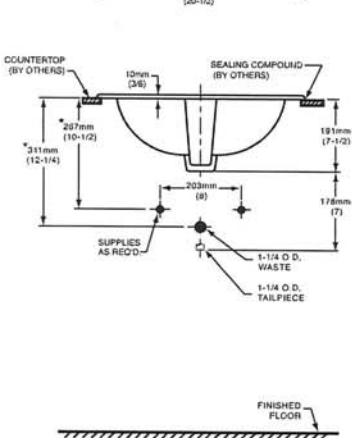
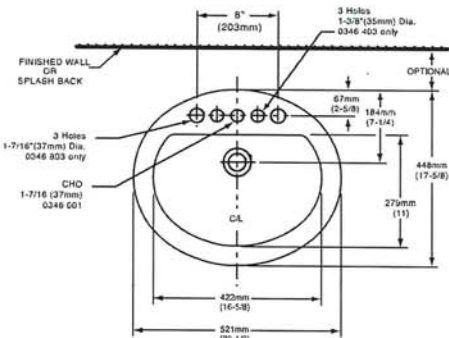

COMPLIANCE CERTIFICATIONS –
Meets or exceeds the following Specifications:
• ASME A112.19.2M for Vitreous China Fixtures.
• CAN/CSA B45 Series.

- To Be Specified
- ☐ Colour: ☐ White ☐ Bone ☐ Silver Gray ☐ Linen
 - ☐ Faucet*:
 - ☐ Faucet Finish:
 - ☐ Supplies & Stops:
 - ☐ Trap 1-1/4" (32 mm):

NOTES:
* DIMENSIONS SHOWN FOR LOCATION OF SUPPLIES AND "P" TRAP ARE SUGGESTED. FOR COUNTERTOP CUTOUT AND INSTALLATION INSTRUCTIONS USE TEMPLATE SUPPLIED WITH SINK.
FAUCETS NOT INCLUDED AND MUST BE ORDERED SEPARATELY.
IMPORTANT: Dimensions of fixtures are nominal and may vary within the range of tolerances established by ANSI Standard A112.19.2.
These measurements are subject to change or cancellation. No responsibility is assumed for use of superseded or voided pages.

* See faucet section for additional models available

V-1
-18



DEMI™
Product Specification Sheet



Two Piece Freestanding Collection

CF2007	Two Piece Freestanding Soaker
Size:	60" x 32" x 22" 1524 mm x 813 mm x 559 mm

PRODUCT FEATURES & BENEFITS

- Vacuum formed acrylic reinforced with fiberglass
- Scratch, stain and fade resistant high gloss finish
- Installation friendly two piece design
- Accepts deck mounted faucet
- Includes integral pop up drain and rectangular overflow
- Includes levelling feet

TWO PIECE ASSEMBLY

FRONT VIEW

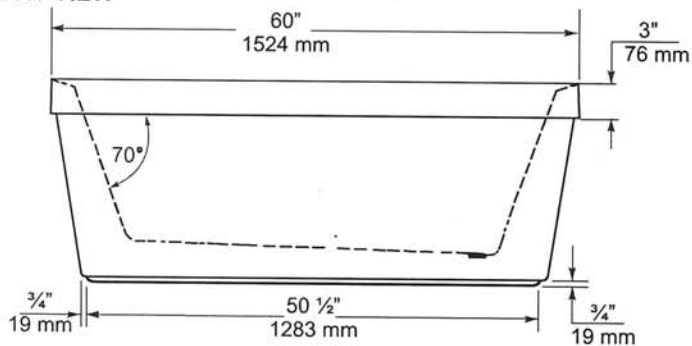

END VIEW

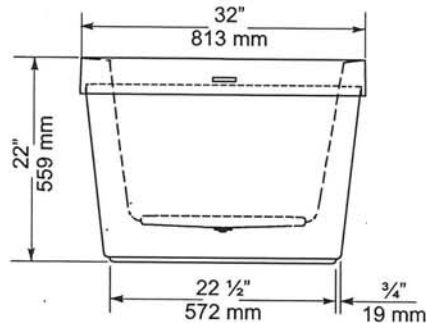

TOP VIEW

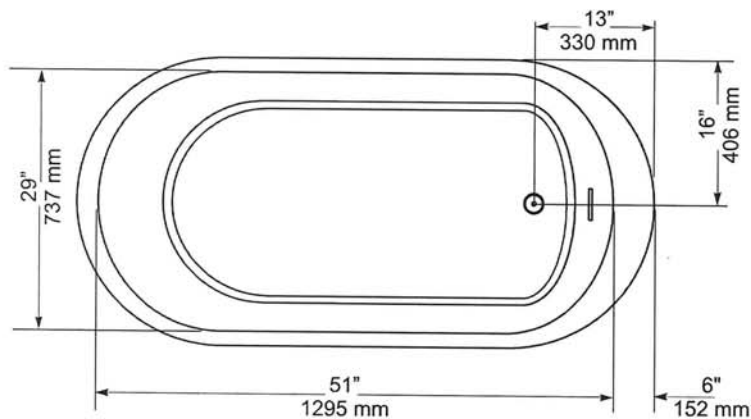

GENERAL SPECIFICATIONS		
Average Weight	90 lb	41 kg
Bathing Well at bottom	43"x 20"	1092 x 508 mm
Capacity Drain to Overflow		195 litres
Water Depth Drain to Overflow	16"	406 mm
Drain Opening (dia.)	2"	51 mm
Overflow Opening	2 1/4"x 1/2"	57 x 13 mm
Drain to Floor Clearance	3 1/4"	83 mm

NOTES: Please confirm measurements on actual product to ensure proper identification. Bathtub to be installed on the floor supported by 5 self levelling feet. Adjust if required to level the bathtub for adequate drainage. Refer to installation instructions for additional information.

IMPORTANT: Dimensions of fixtures are nominal and may vary $\pm 1/4"$ (6 mm). Weight may vary ± 5 lb (2.3 kg). Drawing is not to scale. These measurements are subject to change at manufacturer's discretion.

Compliance Certifications -
Meets or Exceeds the following Specifications:
• CAN/CSA - B45 Series



V.T 7.3

American Standard
Style That Works Better

FloWise™ DUAL FLUSH
ELONGATED TOILET
VITREOUS CHINA

FloWise™ DUAL FLUSH ELONGATED TOILET

- 2476 216
 - Vitreous china
 - Low-consumption Dual Flush
 - Full flush 6.0 Lpf/1.3 gpf,
 - Partial flush 3.0 Lpf/0.66 gpf.
 - Elongated wash down bowl
 - Internal trapway fully-glazed,
 - 2-1/4" (57mm) ballpass
 - Concealed trapway bowl
 - Chrome-plated top mounted
 - push button actuator
 - Easy to clean sanitary dam on bowl
 - Includes Elongated Slow Close Seat
 - 100% factory flush tested
 - 2 bolt caps

Separate Component Parts:

- 3067 316 Elongated Bowl with Slow Close Seat
- 4035 216 Unlined Tank



- 2476 516 Same as above with Lined tank
 - 3067 316 Elongated Bowl
 - 4035 516 Lined Tank

Nominal Dimensions:
794 x 432 x 765mm
(31-1/4" x 17" x 30-1/8")

Compliance Certifications -
Meets or Exceeds the Following Specifications:

- ASME A112.19.2M (and 19.6M)
- CAN/CSA B45 series

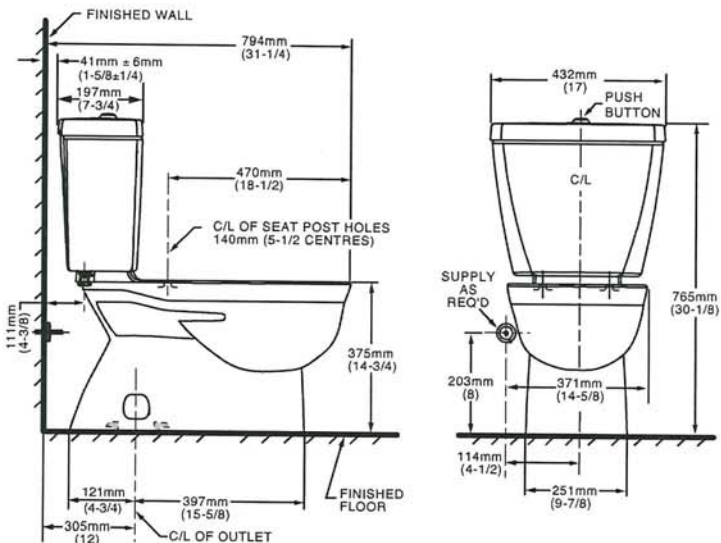

NOTES:
THIS TOILET IS DESIGNED TO ROUGH-IN AT A MINIMUM DIMENSION OF 305MM (12") FROM FINISHED WALL TO C/L OF OUTLET.
SUPPLY NOT INCLUDED WITH FIXTURE AND MUST BE ORDERED SEPARATELY.
* DIMENSION SHOWN FOR LOCATION OF SUPPLY IS SUGGESTED.
FOR ADDITIONAL INFORMATION REFER TO INSTALLATION INSTRUCTIONS SUPPLIED.
IMPORTANT: Dimensions of fixtures are nominal and may vary within the range of tolerance established by ANSI Standard A112.19.2
These measurements are subject to change or cancellation. No responsibility is assumed for use of superseded or voided pages.

- To Be Specified
- Colour: 020 White
 - Supply with stop:

UPGRADED VALUE ADDED FEATURES AT NO EXTRA CHARGE

V.T.
7.9

MOEN®

Specifications

DESCRIPTION

- Metal construction with various finishes identified by suffix
- 16" long 3/8" tubing connections
- Includes metal or 50/50 pop-up type waste assembly where noted

OPERATION

- Pivot action lever style handle
- Temperature controlled through 180° degree arc of handle travel

FLOW

- Flow is limited to 1.5 gpm max (5.7L/min) at 60 psi

CARTRIDGE

- 1225 cartridge design
- Nonmetallic/nonferrous and stainless steel material
- Can accommodate reversed piping and back to back installations

STANDARDS

- Third party certified to WaterSense®, CSA B-125.1, ASME A112.18.1 and all applicable requirements referenced therein including NSF61/9
- Complies with California Proposition 65 and with the Federal Safe Drinking Water Act

- **ADA**  for lever handle

WARRANTY

- Lifetime limited warranty against leaks, drips and finish defects to the original consumer purchaser
- 5 year warranty if used in commercial installations

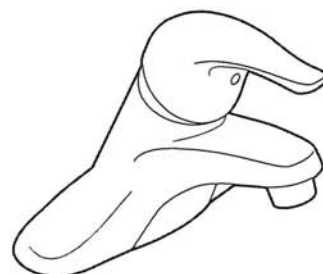

CHATEAU®
Single-Handle Lavatory Faucet

with Metal Waste Assembly

Model: L4625 series

L4631BC

Bulk Packed (12 per carton):
L64624 series

with 50/50 Waste Assembly

Bulk Packed (12 per carton):
L64625 series

Less Waste

Bulk Packed (12 per carton):
L64600 series

NOTE: THIS FAUCET IS DESIGNED TO BE
INSTALLED THRU 3-1" DIA. HOLES, 2" ON CENTER

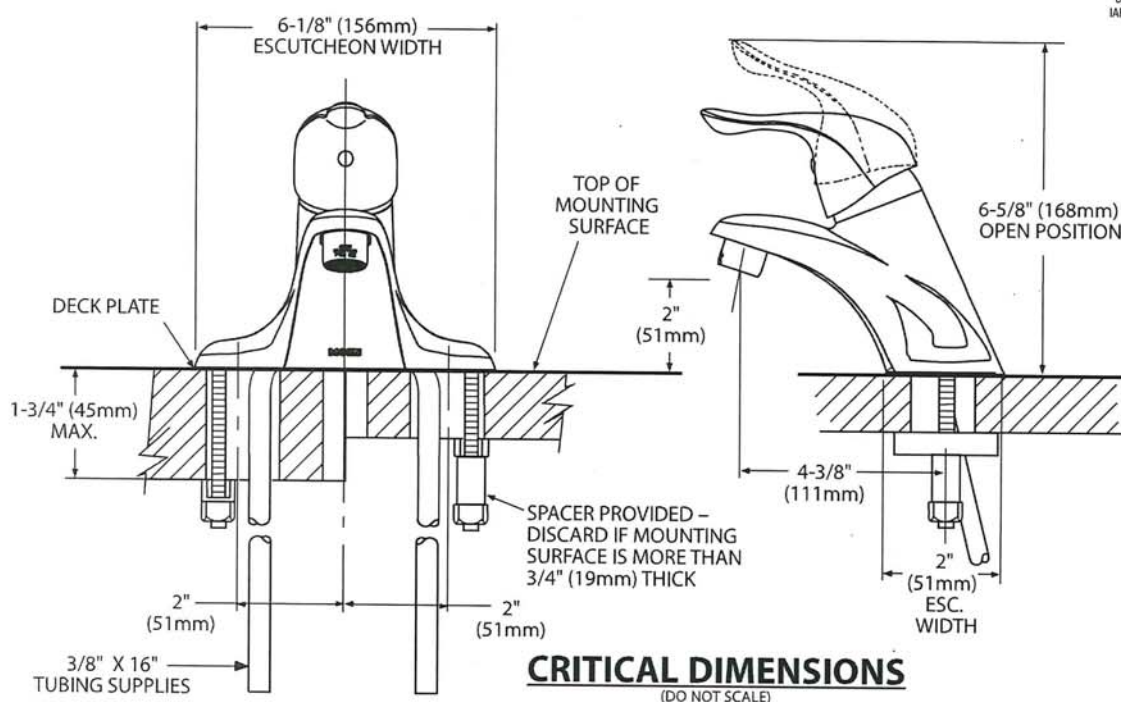

CRITICAL DIMENSIONS
(DO NOT SCALE)

V.T.
1.5



Buy it for looks. Buy it for life.®

There is more than 1 version of this model.
Page down to identify the version you have.

DESCRIPTION

- Metal construction with various finishes identified by suffix
- Includes non-metallic showerhead, arm, flange and non-metallic diverter tub spout

OPERATION

- Handle operates counterclockwise through a 270° arc with off at 6 o'clock and maximum hot at the 9 o'clock position. Shut off in clockwise direction
- Adjustable temperature limit stop to control maximum hot water temperature
- Pressure balancing mechanism maintains selected discharge temperature to $\pm 3^\circ$

FLOW

- Showerhead is limited to 2.5 gpm (9.5 L/min) at 80 psi
- EP suffix models are limited to 1.75 gpm (6.6 L/min) at 80 psi
- NH suffix models contain no showerhead

CARTRIDGE

- 1222 cartridge design
- Accommodates back to back installations
- Nonmetallic/nonferrous and stainless steel material

STANDARDS

- Third party certified to meet ASME A112.18.1/CSA B125.1 and all applicable requirements referenced therein
- EP suffix models are third party certified to WaterSense®

- ADA for lever handle

WARRANTY

- Lifetime limited warranty against leaks, drips and finish defects to the original consumer purchaser
- 5 year warranty if used in commercial installations

Specifications



CHATEAU' POSI-TEMP' Single-Handle Tub/Shower Trim Kit

Models: TL181 series - valve trim only
(Bulk Packed 12 per carton)
TL182 series - shower trim only
(Bulk Packed 12 per carton)
TL183 series - tub/shower trim
(Bulk Packed 12 per carton)

Valves: 62300 series
2500 series

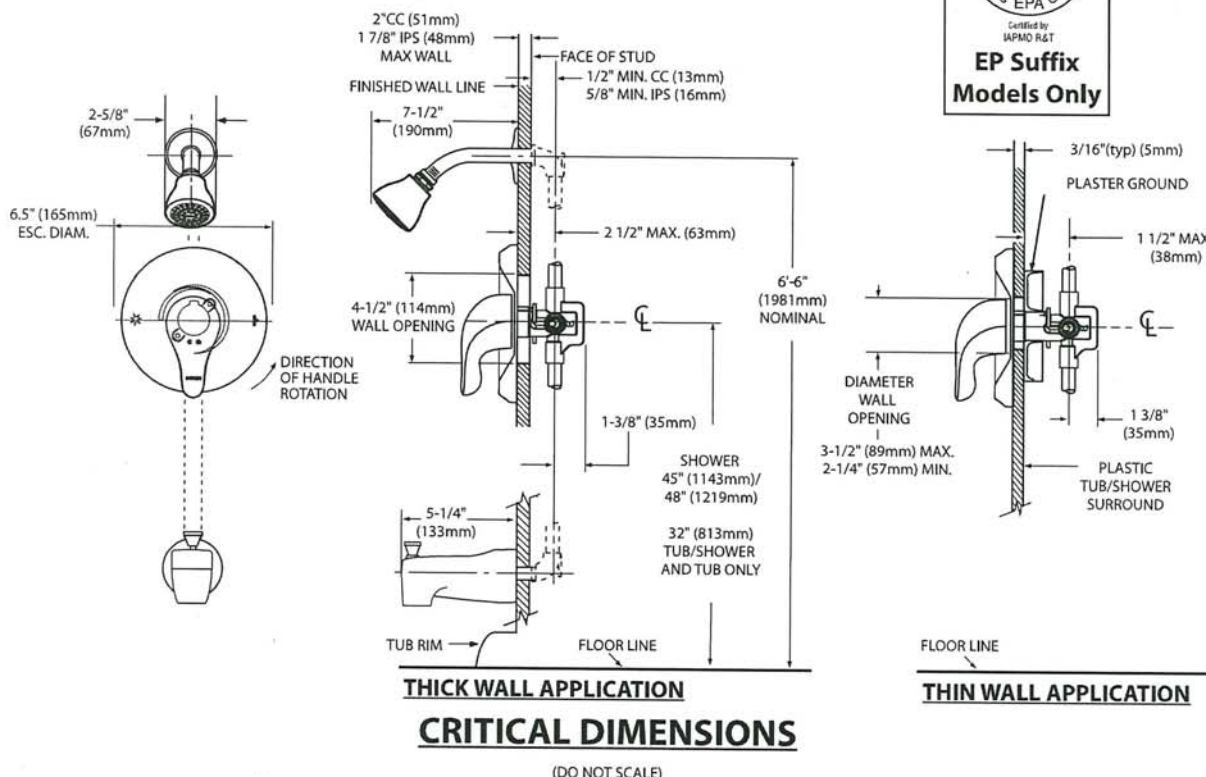

V.T.
13



Specifications

DESCRIPTION

- Metal construction with various finishes identified by suffix

OPERATION

- Lever style handles with hot and cold color indicator
- Rotate hot side handle counterclockwise to open (clockwise to close) and the cold side handle (clockwise to open) and (counterclockwise to close)

STANDARDS

- Third party certified to: ASME A112.18.1/CSA B-125.1, and all applicable requirements referenced therein

- ADA  for lever handles

WARRANTY

- Lifetime limited warranty against leaks, drips and finish defects to the original homeowner
 - 10 year limited warranty when used in a multi-family installation
 - 5 year limited warranty when used in a commercial installation
- Visit www.moen.com/support for complete details and limitations

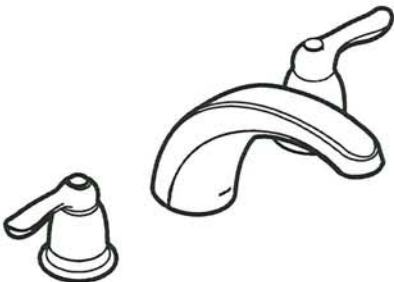

CHATEAU®
Two-Handle Garden Tub Trim

Models: T994 series

Valves: 4792, 4793, 4794, 4796, 4797, 4798

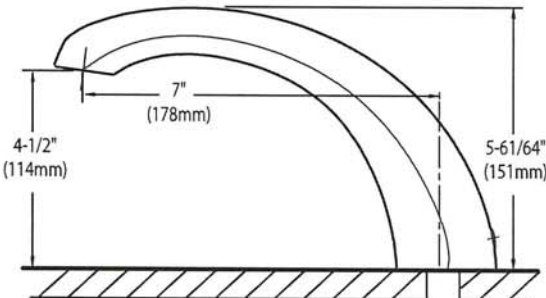
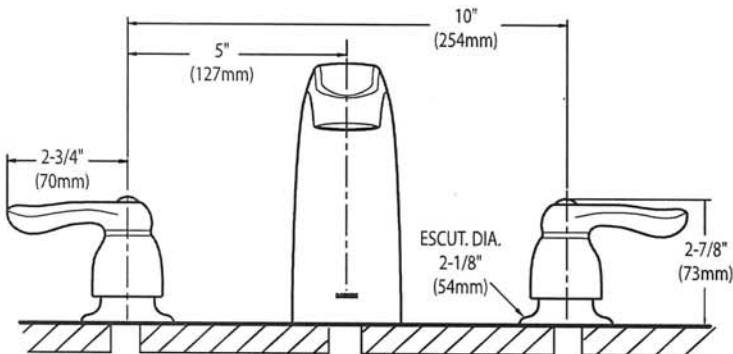

CRITICAL DIMENSIONS
(DO NOT SCALE)

V.T
1.5



AVN-308CS

30" Wall mount hood - Professional design

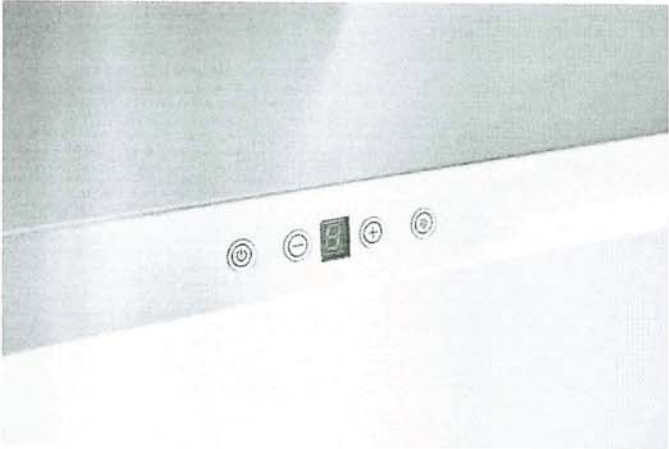
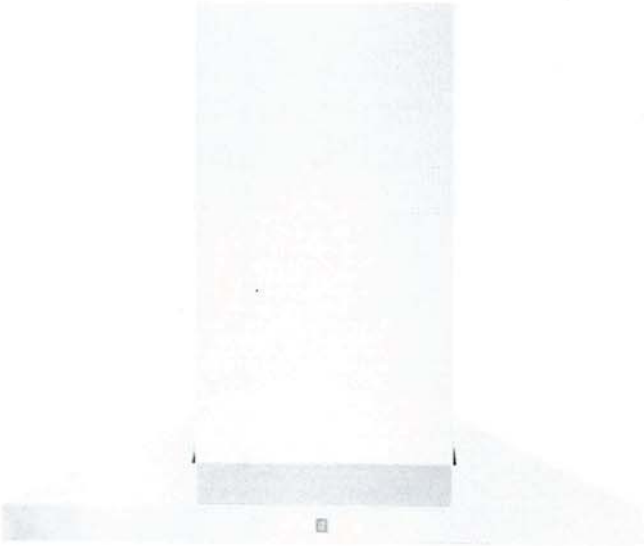

Selected Model	
Model number	AVN-308CS
Dimensions	
Dimensions	29 1/2" (W) x 19 3/4" (D) x 7 1/3" (H)
Exterior Appearance	
Stainless steel grade	201
Features	
Control	Soft touch with LED display
Lighting	2 bulbs, 3W LED (bulbs included)
Blower type	860 CFM, 6-Speed
Blower performance	Speed 1, 0.7 sones
	Speed 6, 6.5 sones
Filter type	2 Stainless steel baffle filters (included)
Duct transition	6" Round (Top)
Ducting	Ducted
Electrical Requirements	
Electrical requirements	120V / 60Hz / 2.7 Amps
Accessories (optionnal)	
Optional duct covers	AD-884S (884mm, AVN-AVH compatible)
Warranty	
1-year Warranty	Parts and labour, in-home service

AVN-308/368CS

Dimensions

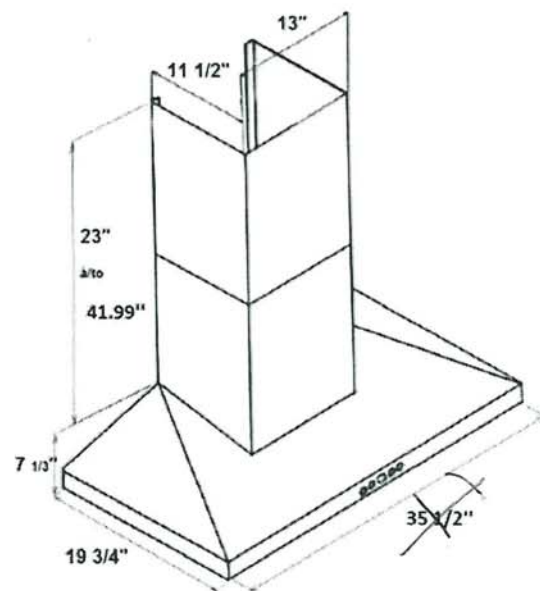
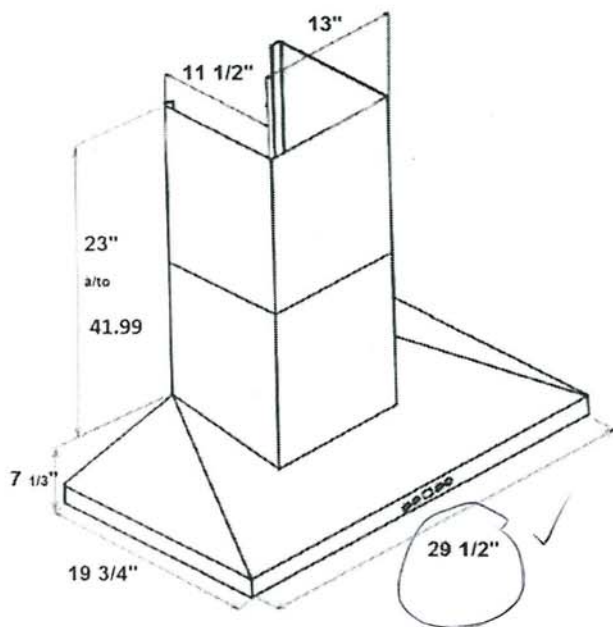

Installation

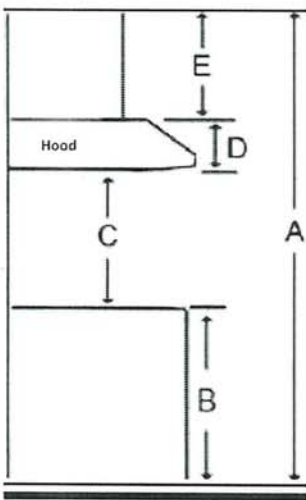

A	Floor to ceiling height	variable
B	Floor to counter top height (standard)	36"
C	Recommended height between cooking surface and bottom of the hood	28" to 30"
D	Hood height	7 1/3"
E	Chimney height	19" to 41.99"

Duct transition

Top 6" round



The information contained herein is based on sources that we believe to be reliable, but is not guaranteed by us, may be incomplete and/or may change without notice.

Need technical support? 1(888) 651-2534

7.8 v.1

HOME APPLIANCES

LG REFRIGERATION

LRFLC2706S

3-Door French Door Refrigerator

- Largest Counter Depth Capacity
- Modern Sleek Design
- Internal Water Dispenser
- Single Ice Maker
- Cool Guard
- Door Cooling+
- LG ThinQ
- ENERGY STAR® Qualified
- Sabbath Mode

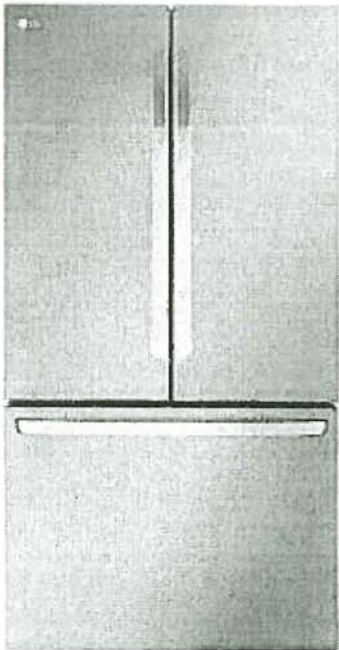

AVAILABLE COLORS



Proactive Smart Alerts to Keep Your Appliances Running Smoothly

ThinQ Care

- Preventative Alerts help you stay a step ahead of potential issues to find proactive solutions before problems arise.
- Avoid preventable repairs and service calls with real-time diagnostics for a hassle-free experience.
- Integrated within LG's ThinQ app—a smart home hub for managing your smart devices and appliances.

CAPACITY

Refrigerator (cu.ft.)	17.8 cu.ft.
Freezer (cu.ft.)	8.7 cu.ft.
Total Capacity (cu.ft.)	26.5 cu.ft.

ENERGY

ENERGY STAR® Qualified	ENERGY STAR®
Energy Consumption (kWh/Year)	632

WATER & ICE SYSTEM

Dispenser Type	Internal with Dispenser
Daily Ice Production	2.5 lbs. (F/Cubed)
Ice Storage Capacity	4.0 lbs.
Cube & Crushed Ice	Cubed only
IcePlus™	Yes
Water Filter	LT1000P

COOLING

Temperature Sensors	9
Compressor Type	Smart Inverter Compressor
Refrigerant	Low GWP, Zero ODP and More Energy Efficient Refrigerant (R600a / 57g ± 2.01oz)
Fresh Air Filter	Yes
Evaporator	1

CONVENIENCE

Display Type	Smooth Touch Control / White LED
Temperature Controls	Electronic / Digital
Door Alarm	Yes
Child Lock	Yes
Decibel™ Quiet Operation	Yes
Smart Diagnosis™	Yes
Auto Closing Door Hinge	Yes (Only left door)
Wi-Fi Enabled	Yes
ThinQ®	Yes
PCC (Proactive Customer Care)	Yes
Special Features	Door Cooling+
Sabbath	Yes
REFRIGERATOR	
No. of Shelves	4 Split (4 Fixed)
Canilevered Shelves	Hybrid Canilevered
Spill Protector™ Tempered Glass	Yes
Crisper Bins	2 Crisper
Glide N' Serve™ Drawer	Yes
CoolGuard	Yes
Handle Type	Bar
Refrigerator Light	Yes

REFRIGERATOR DOOR

No. of Bins	8 Total (2 Adjustable Gallon Sized)
Door Bin Construction	1 Piece (Clear)
FREEZER	
Door Type	Pull Drawer
Drawers / Shelves	2 Tier Organization
Durabase™ Solid Drawer Base	Yes
Drawer Divider	Yes
Freezer Light	LED Light(in)
Freezer Handle	SmartPull™ Handle
Ice Bin / In Door Ice	Yes

MATERIALS AND FINISHES

Flat Type Door	Yes
Hidden Hinges	Yes
Surface	Smooth
Handles	Matching Commercial Handles
All Available Colors	Stainless Steel
Insulation	Low GWP and Zero ODP Blowing Agent

DIMENSIONS/CLEARANCES/WEIGHTS

Depth with Handles	31 5/8"
Depth without Handles	29 1/4"
Depth without Door	24 7/8"
Depth (Total with Door Open 90°)	43 1/2"
Height to Top of Hinge	70 1/4"
Height to Top of Case	68 7/8"
Width	35 3/4"
Installation Clearance	Sides 1/8", Top 1", Back 2"
Weight (Unit/Car ton)	322 lbs / 352 lbs
Carton Dimensions (WxHxD)	38" x 73" x 32"

LIMITED WARRANTY

Parts & Labor	1 Year
Sealed System (Parts & Labor)	5 Years
Compressor (Parts & Labor)	5 Years
Linear Compressor (Parts & Labor)	6 - 10 Years

UPC CODES

LRFLC2706S (Stainless Steel)	195174039274
------------------------------	--------------

From Tina

V.T.

1.3

DIMENSION GUIDE

WARNING: To reduce the risk of fire, electric shock, or injury to persons, read the IMPORTANT SAFETY INSTRUCTIONS, located in your appliance's Owner's Manual, before operating this appliance.

This manual covers several models. Your model may have some or all of the items listed. Refer to this manual or the Frequently Asked Questions section of our website at www.whirlpool.com for more detailed instructions. In Canada, reference the Customer Service section at www.whirlpool.ca.

PRODUCT MODEL NUMBERS

WEE745H0L, YWEE745H0L

PRODUCT DIMENSIONS

This manual covers several models. Your model may appear different from the models depicted. Dimensions given are maximum dimensions across all models.

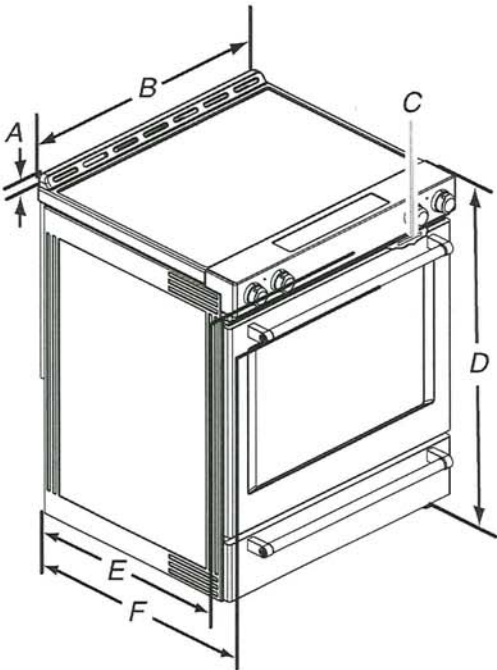

- A. 1³/₁₆" (3.0 cm) height from cooktop to top of vent
- B. 29⁷/₈" (75.9 cm)
- C. Model/serial/rating plate (located behind the oven door on the top right-hand side of the oven frame)
- D. 36" (91.4 cm) height to top of cooktop edge with leveling legs screwed all the way in*
- E. 28⁵/₁₆" (71.9 cm) maximum depth from front of console to back of range
- F. 28⁷/₈" (73.3 cm) maximum depth from handle to back of range

IMPORTANT: Range must be level after installation. Follow the instructions in the "Level Range" section of your Owner's Manual. Using the cooktop as a reference for leveling the range is not recommended.

*Range can be raised approximately 1" (2.5 cm) by adjusting the leveling legs.

V.T 7.5

Whirlpool®

53 dBA* Front Control Dishwasher
WDF540PAD

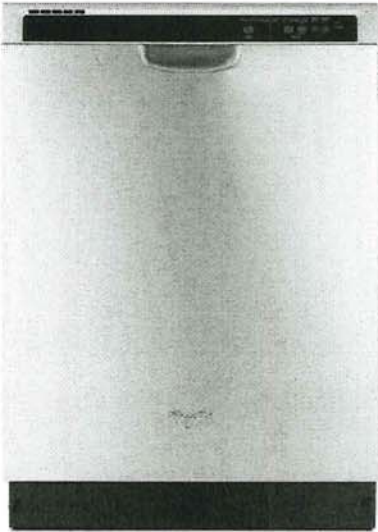

Monochromatic Stainless Steel
WDF540PADM

Also available in:

- ☐ White
- WDF540PADW
- ☐ Black
- WDF540PADB

Capacity	
Total Place Settings	15
General Features & Properties	
Soil Sensor	
In-Door Silverware Basket	
Sani Rinse Option	
Normal Cycle	
Heavy Cycle	
High Temperature Wash Option	
Heated Dry Option	
ENERGY STAR® Certified	
Industry's Best Selling Dishwasher Brand†	
Electrical Details	
Amps	15
Volts	120
Hz	60
Certifications	
ENERGY STAR® Certified	Yes

Technical Details	
Dishwasher Type	Built-in
Control Location	Front
Control Type	Electronic
Number of Wash Cycles	5
Number of Options	5
dBA*	53
Number of Racks	2
Tub Material	Plastic
Wash System	Filter
Wash System Type	Removable Filter
Number of Wash Arms	3
Dimensions	
Product Dimensions (H x W x D)	34-1/2" x 23-7/8" x 24-1/2"
Depth with Door Open 90°	49-1/2"
Reference Material	

- [Dimension Guide](#)
- [Install Guide](#)
- [Use & Care Guide](#)
- [Energy Guide](#)
- [Warranty](#)

Key Features & Benefits

Sensor Cycle

Automatically get the right wash and dry settings for each load with two sensors that measure temperature, soil level and load size during prewash and the wash cycle.

1-Hour Wash Cycle

Clean the dishes you need fast with a cycle that thoroughly takes care of plates, pans and glasses in just an hour.**

Cycle Memory

Quickly start your dishwasher with one button. It automatically remembers the last cycle you picked so it's stored and ready to go.

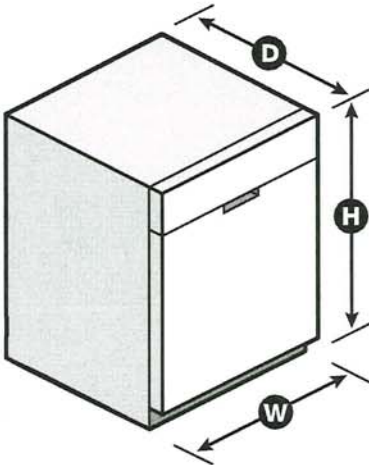

*Per IEC standards. **Compared to Normal cycle with lightly soiled loads. †Based on 12-month average of unit sales. TraQline 2018. NOTE: Dimensions are for planning purposes only. For complete details, see Installation Instructions packed with product. Specifications subject to change without notice. ©/™ © 2020. All rights reserved. Printed in the U.S.A. D200052XXA. WDF540PADSPECSHEETV01.

Handwritten notes: "V-T." and "1-3"

Whirlpool® Undercounter Dishwasher

PRODUCT MODEL NUMBERS

WDF110PAB	WDF310PLA	WDF530PSY
WDF111PAB	WDF320PAD	WDF540PAD
WDF120PAF	WDF510PAY	WDF730PAY
WDF121PAF	WDF520PAD	WDT710PAY
WDF310PAA	WDF530PAY	WDT720PAD
WDF310PCA	WDF530PLY	WDT770PAY

Electrical Requirements: 120-volt, 60-Hz, AC only, 15- or 20-amp. fused electrical supply. Copper wire only. A time delay fuse or circuit breaker and separate circuit is recommended.

If direct wiring dishwasher: Use flexible, armored, or nonmetallic, sheathed copper wire with grounding wire that meets the wiring requirements for your home and local codes and ordinances. Use a UL listed or CSA approved conduit connector.

If connecting dishwasher with a power supply cord: Use Power Supply Cord Kit (Part No. 4317824) marked for use with dishwashers. Follow the kit instructions for installing the power supply cord.

Power supply cord must plug into a grounded 3 prong, outlet, located in the cabinet next to the dishwasher opening. Outlet must meet all local codes and ordinances.

Water Supply Requirements: A hot water line with 20 to 120 psi (138 to 862 kPa) water pressure. Water temperature must be 120°F (49°C) water at dishwasher. Use 3/8" O.D. copper tubing with compression fitting or flexible braided water supply line (1/2" minimum plastic tubing is not recommended). Use a 90° elbow with 1/4"N.P.T. external pipe threads on one end. Do not solder within 6" (15.2 cm) from water inlet valve.

Drain Requirements: A new drain hose is supplied with your dishwasher. If this is not long enough, use a new drain hose with a maximum length of 12' (3.7 m) (Part No. 3385556) that meets all current AHAM/IAPMO test standards, is resistant to heat and detergent, and fits the 1" (2.5 cm) drain connector of the dishwasher.

Make sure to connect the drain hose to waste tee or disposer inlet above drain trap in house plumbing and 20" (50.8 cm) minimum above the floor. It is recommended

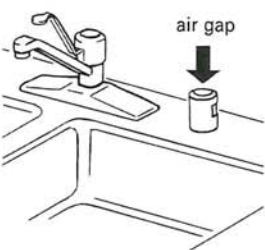

that the drain hose either be looped up and securely fastened to the underside of the counter or be connected to an air gap.

Make sure to use an air gap if the drain hose is connected to house plumbing lower than 20" (50.8 cm) above subfloor or floor.

Use 1/2" (1.3 cm) minimum I.D. drain line fittings.

If required, the air gap should be installed in accordance with the air gap installation instructions. When connecting the air gap, a rubber hose (not provided) will be needed to connect to the waste tee or disposer inlet.

PRODUCT DIMENSIONS

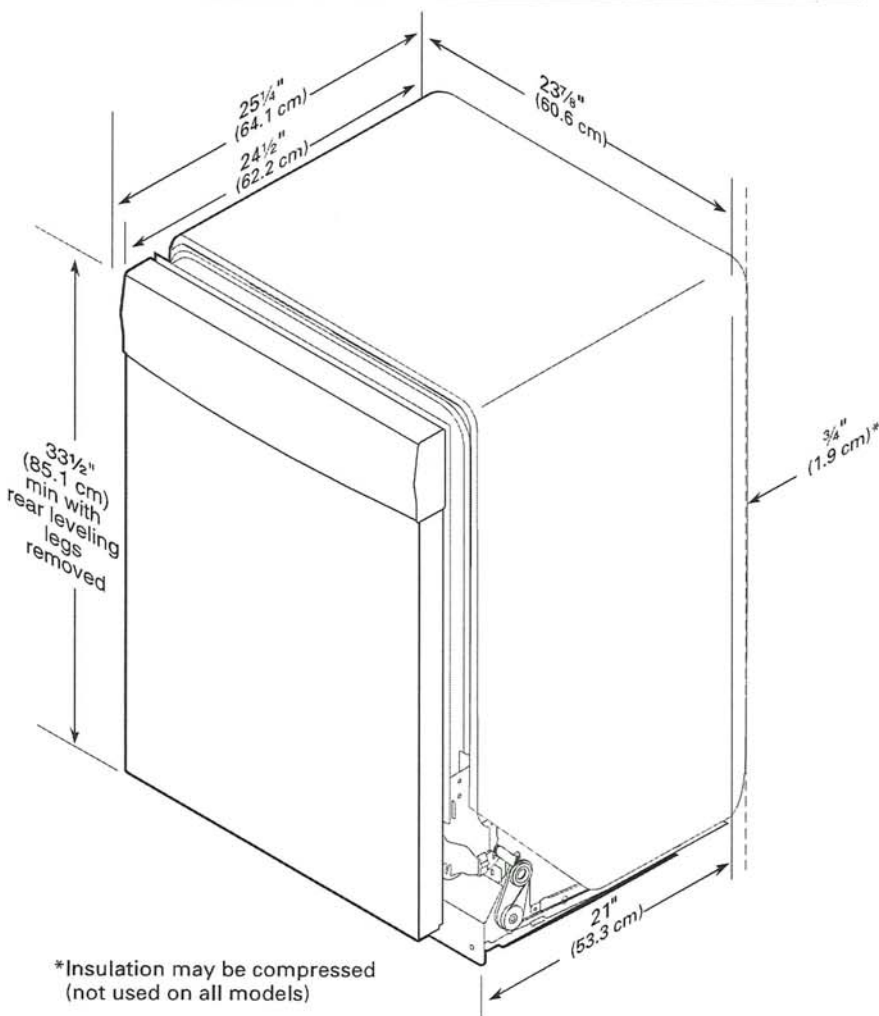

CABINET CUTOUT DIMENSIONS

NOTE: Shaded areas of cabinet walls show where utility connections may be installed.

*Measure from the lowest point on the underside of the countertop. May be reduced to 33½" (85.1 cm) by removing the rear leveling legs from dishwasher.

**Minimum, measured from narrowest point of opening.

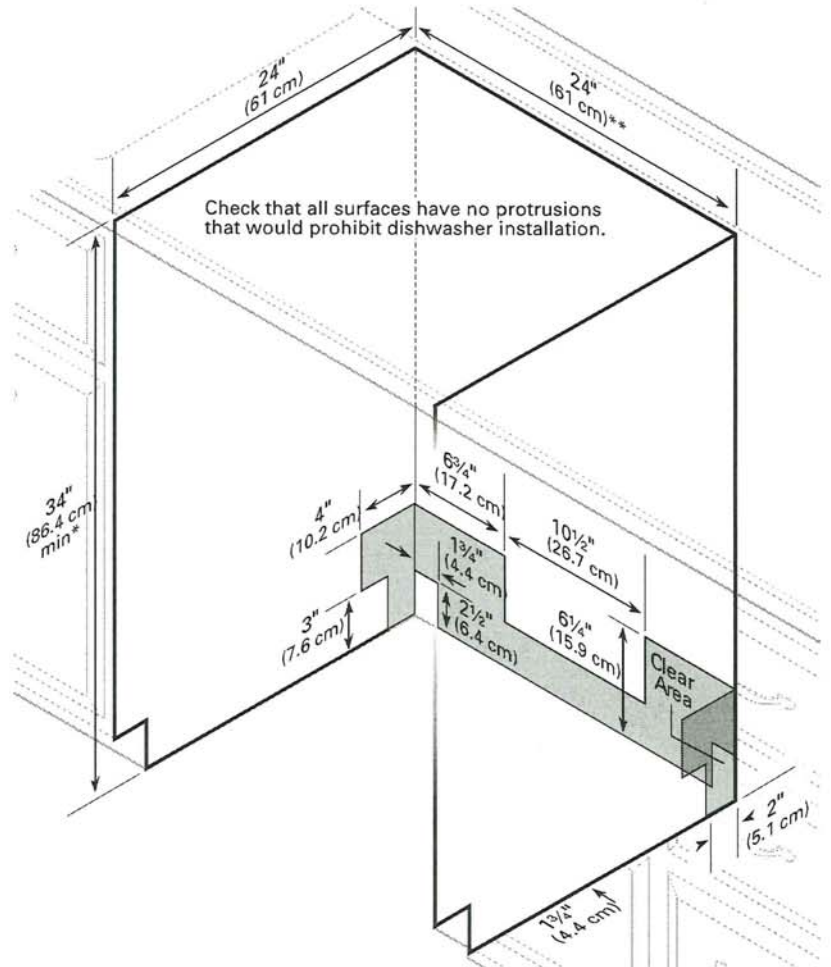

V.T. 7.9

DETAILED PLANNING DIMENSION

2 of 15

WHIRLPOOL® FRONT LOAD WASHER WITH INTUITIVE CONTROLS - 4.3 cu ft

ELECTRICAL REQUIREMENTS

WARNING: To reduce the risk of fire, electric shock, or injury to persons, read the IMPORTANT SAFETY INSTRUCTIONS and INSTALLATION INSTRUCTIONS, located in your appliance's Owner's Manual, before installing and operating this appliance.

Electrical Requirements	
WFW560CHW	4.3 cu ft DOE (US)/5.0 cu ft IEC (CAN)
Minimum Circuit Amperage Rating	15 A
Maximum Ampere Draw	10.36 A
Operating Voltage	120 V AC only
Operating Frequency	60 Hz

PRODUCT DIMENSIONS

WFW560CHW	4.3 cu ft DOE (US)/5.0 cu ft IEC (CAN)			
Unit of Measurement	in (minimum)	mm (minimum)	in (maximum)	mm (maximum)
Height (with feet) (A)	38 ^{5⁄8}	981	40	1016
Product Width (B)	27	686	-	-

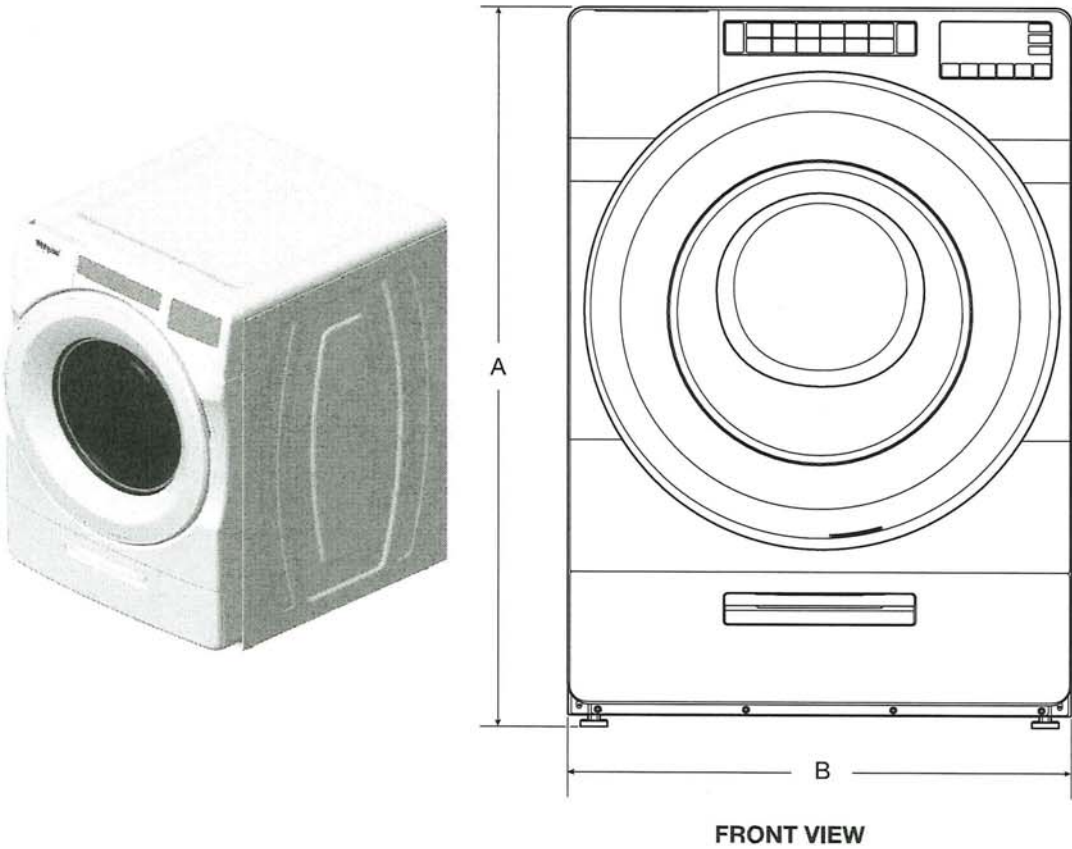

IMPORTANT: Dimensional specifications are provided for planning purposes only.



V.T 7.3

DETAILED PLANNING DIMENSION

3 of 15

WHIRLPOOL® FRONT LOAD WASHER WITH INTUITIVE CONTROLS - 4.3 cu ft

PRODUCT DIMENSIONS

WFW560CHW	4.3 cu ft DOE (US)/5.0 cu ft IEC (CAN)			
Unit of Measurement	in (minimum)	mm (minimum)	in (maximum)	mm (maximum)
Door Width (C)	25 ¹¹ / ₁₆	652	-	-
Product Depth (D)	31 ⁹ / ₁₆	802	-	-
Product Depth with Door Open (E)	54 ⁷ / ₈	1393	-	-
Door Height (F)	25 ¹¹ / ₁₆	652	-	-
Height to Bottom of Door (G)	9 ¹ / ₂	241	-	-

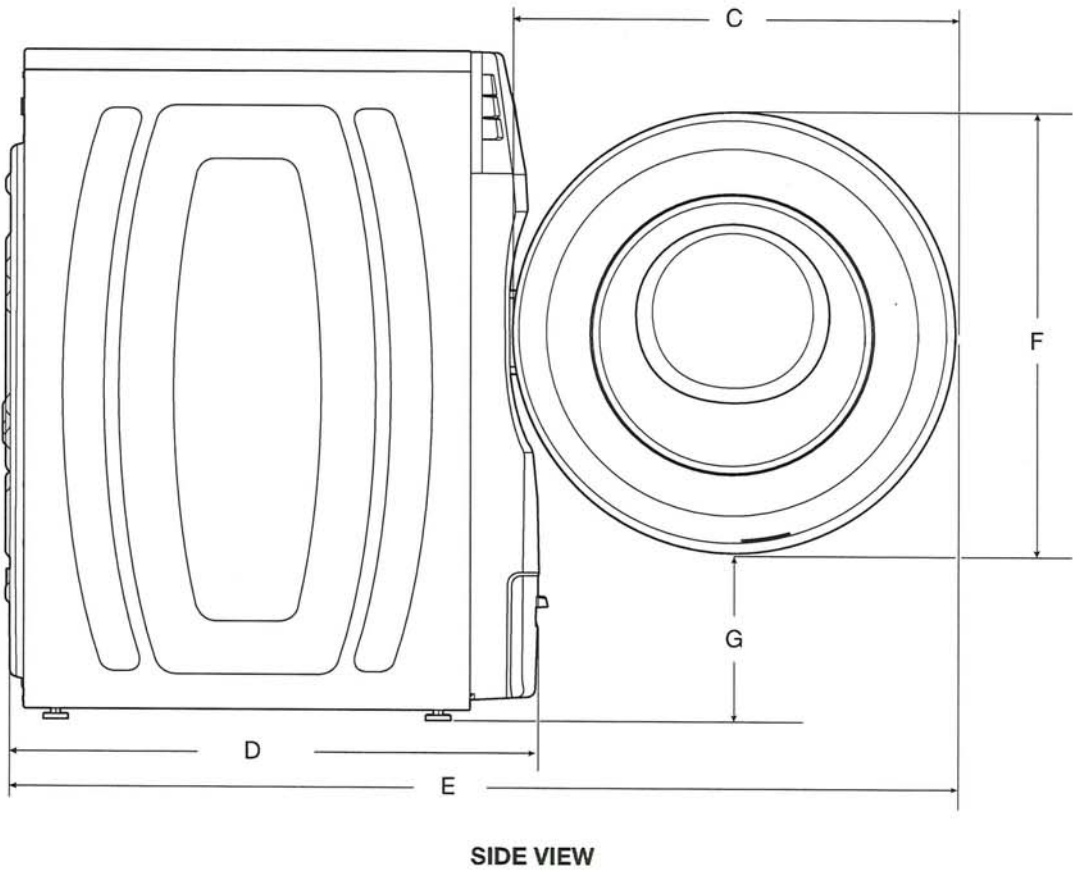

IMPORTANT: Dimensional specifications are provided for planning purposes only.



V.T.
T.S

DETAILED PLANNING DIMENSION

4 of 15

WHIRLPOOL® FRONT LOAD WASHER WITH INTUITIVE CONTROLS - 4.3 cu ft

PRODUCT DIMENSIONS

WFW560CHW	4.3 cu ft DOE (US)/5.0 cu ft IEC (CAN)			
Unit of Measurement	in (minimum)	mm (minimum)	in (maximum)	mm (maximum)
Position of Power Cord (H)	35 ⁵ / ₁₆	897	-	-
Power Cord Length	72	1830	-	-
Position of Water Inlet Valves (I)	35 ⁵ / ₁₆	897	-	-
Position of Drain Hose (J)	8	205	-	-
Drain Hose Length	52	1321	-	-
Diameter of Drain Hose	1	26	-	-

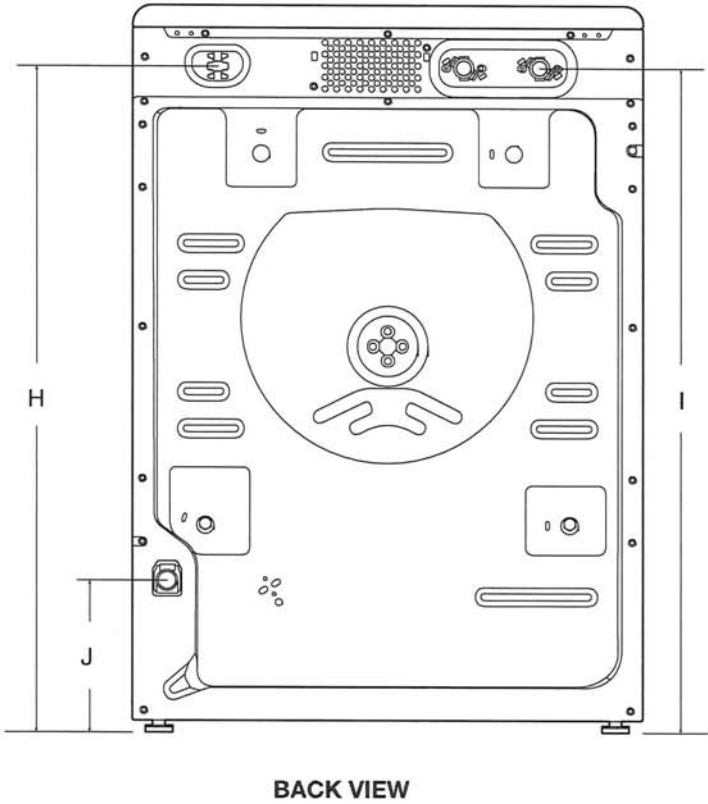

IMPORTANT: Dimensional specifications are provided for planning purposes only.



V.T.
P.S

WHIRLPOOL DRYER Model #: YWED5620HW

Whirlpool Brand Canada English | Washer and Dryers | Dryers | Electric Dryers | YWED5620HW

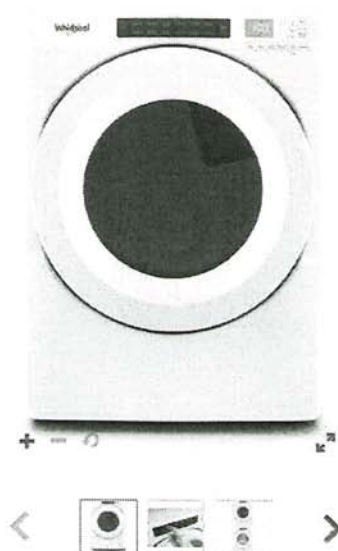

Define
Your Style

7.4 cu. ft. Front Load Electric
Dryer with Intuitive Touch
Controls

Whirlpool 7.4 cu. ft. Front Load Electric Dryer with Intuitive Touch Controls
Model #: YWED5620HW

Dimensions

Depth	78.74 cm, 31.0 in
Depth With Door Open 90 Degree	138.43 cm, 54-1/2 in
Height	98.42 cm, 38-3/4 in
Width	68.58 cm, 27.0 in

Configuration and Overview

Fuel Type	Electric
-----------	----------

Cycles and Options

Cycle Time Remaining	Yes
Lint Filter Indicator	No
Number of Dryer Cycles	36
Number of Dryness Levels	3

Ventilation System

Long Vent	No
Maximum Vent Length	64
Venting Direction	Left, Right, Bottom, Rear

Electrical

Hz	60
Power Cord Included	Yes

V.T.
T.S.