



SITE
APPLIANCE CANADA
PRENDEL KITCHENS
PRACTICAL ELECTRIC

Sales Selection Sheet
Williamsburg Green

69 of 73

PURCHASER: INVENTORY HOME_55

TEL:

LOT / UNIT	PHASE	MODEL	
55	1	28-2660 C THE LEMONGRASS	

It is herein understood and agreed between the undersigned parties hereto that the following changes shall be made to the above mentioned Agreement of Purchase and Sale in accordance with the agreement and except for such changes noted below, all other terms and conditions in the Agreement of Purchase and Sale shall remain as stated herein: It is further understood that and agreed that all changes and additions shall be installed as per builder's specifications, location and available selections. The Purchaser hereby agrees to purchase the following extras:

APPLIANCES

1	FINISHED BASEMENT FAMILY (REC) ROOM - V-2 PLAN SUPPLY AND INSTALL NEW PANASONIC COUNTERTOP STAINLESS MICROWAVE MODEL NN-ST67KS FOR NEW REVISED MICROWAVE SHELF SEE SPEC DELETE - DO NOT SUPPLY OR INSTALL WHIRLPOOL OTR AS PER ORIGINAL COLOUR CHART	Qty: 1.0000
150,669	Note:	

CABINETRY

*2 362,655	FINISHED BASEMENT FAMILY (REC) ROOM - CABINETRY-H34-WALL CABINET WITH SHELF FOR MICROWAVE (FINISHED INTERIOR) (OPENING 24INW X 13 3/4INH X 17IND) (NOT AVAILABLE IN SOME LAMINATES) VIKING	Qty: 1.0000
150,670	Note: V-2 PLAN DELETE DO NOT SUPPLY OR INSTALL OTR CABINET AS PER ORIGINAL COLOUR CHART- SUPPLY NEW MICROWAVE CABINET (VIKING III TRINITY LPL FREE SPIRITL580K CABINETS)	
	SKETCH # 7	

ELECTRICAL

3	FINISHED BASEMENT FAMILY (REC) ROOM - V-2 PLAN RELOCATE ELECTRICAL PLUG IF REQUIRED FROM DELETED OTR CABINET FOR NEW MICROWAVE SHELF	Qty: 1.0000
150,672	Note:	

Sub Total
HST
Total

1. This Sales Selection Sheet when properly executed forms part of our Agreement of Purchase and Sale.
2. All extras and upgrades listed above are subject to Construction Progress and Architectural and Municipal requirements.
3. In the event the Vendor is unable to incorporate the work approved above in the construction of the house for any reason whatsoever, the Vendor will not be liable to the Purchaser in any way. The monies paid for any changes or optional extras not proceeded with shall be returned to the Purchaser, without interest. The cost of options or extras is non-refundable in all other circumstances. If for any reason whatsoever the Agreement of Purchase and Sale is not completed, the total cost of work approved above will be retained by the Vendor.
4. The Vendor reserves the right to substitute above materials and equipment with that of equal or better quality.
5. Purchaser acknowledges that items may not be exactly as shown. Variations from the Vendor's samples may occur in finished materials due to normal production processes. Vendor is not responsible for shade difference which may occur from different dye lots or wood grains. Variations from the Vendor's samples will occur with natural materials such as wood, marble, granite, hardwood and brick.
6. The Vendor reserves the right to select Grout & Thresholds that best suits the Tile selected.
7. Selections will not be processed unless signed by Heathwood Homes Head Office.
8. The selections made on this schedule are final and cannot be changed once submitted.
9. The Purchaser has checked and acknowledges the accuracy of this schedule.

Initials: TR

TAX#:1

PREPARED BY: Marilyn Rosen

PE 1,819-1

SInvoice.rpt 28may19



Sales Selection Sheet
Williamsburg Green

70 of 73

PURCHASER: INVENTORY HOME_55

TEL:

LOT / UNIT 55	PHASE 1	MODEL 28-2660 C THE LEMONGRASS	
------------------	------------	-----------------------------------	--

Payment Summary

<u>Paid By</u>	<u>Amount</u>
<u>Total Payment:</u>	

PURCHASER:

UNSOLD INVENTORY
INVENTORY HOME_55

12-Feb-25
DATE

MARILYN ROSEN - DECOR
Decor Consultant

12-Feb-25
DATE

-02- 12 2025
Date Approved
Limited

M. Rosen
Heathwood Homes (Williamsburg)
Limited

Sketch #: 7

BATH
BASEMENT

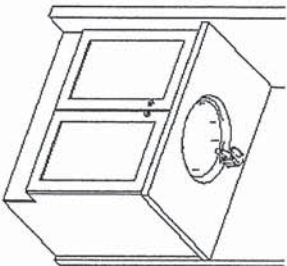
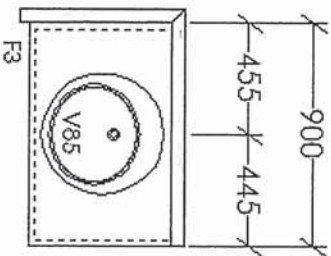

KITCHENETTE
BASEMENT

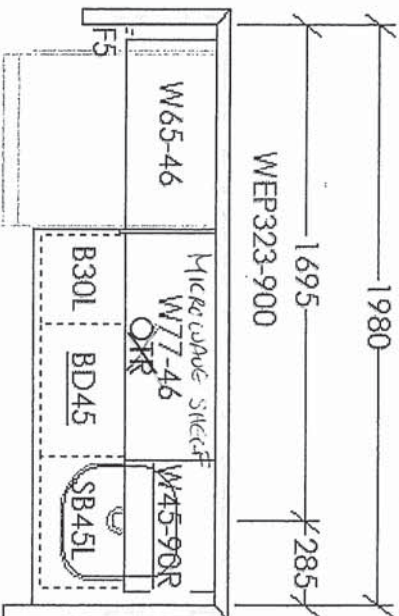

REMOVE
CTR
CABINET
ATTACH TO NEW
MICROWAVE SILENT

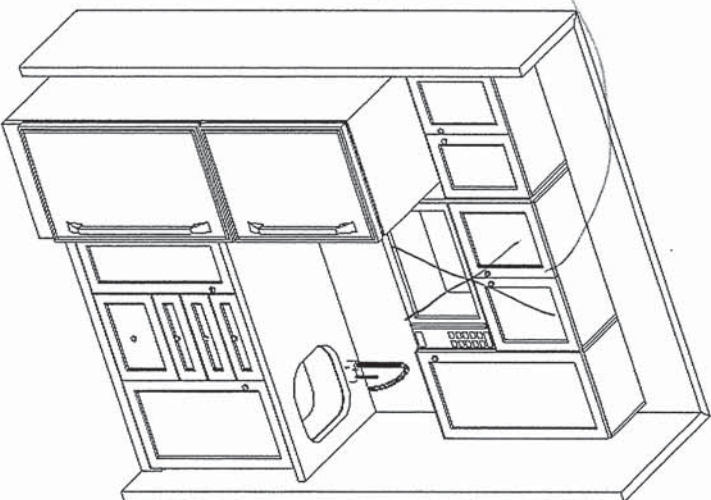

This sketch is for DESIGN PURPOSES ONLY – It is not meant to be an exact rendition.



F R E N D E L
K I T C H E N S L I M I T E D
1350 Shawson Drive, Mississippi, ON L4W 1C5

HEATHWOOD HOMES
WILLIAMSBURG
MODEL: LEMONGRASS
28-2660 (3404)

STANDARD CONTRACT INCLUDES:

Appliance Openings

- Hood: 30"W Builder Hood
- Fridge Opening: 37 3/8 "W X 73 3/8"
- Fridge cabinet & gables: 66cm Deep
- Stove Opening: 30" Freestanding
- Dishwasher Opening: 24"

Standard Scope Kitchen, Vanity, Laundry:

- 100cm H wall Cabinets
- Base Pie Cut Corner Cabinets
- std. Blumotion Hinges-Soft Close Doors
- Std. Metabox Drawers-Not Soft Close
- Top Drawer In Principal Ensuite (Qty x1)
- Std. Laundry Uppers - 61cm H
- Std. Laundry Base
- Std. Basement Baths
- Backing on All - Except Sink Cabinets
- Countertop by Others for Kitchen & Principal Ensuite

Drawn By: Sepideh B
Date: August 22, 2024
Scale: Not To Scale

THIS DRAWING IS FOR DESIGN PURPOSES ONLY.
IT IS NOT AN EXACT RENDITION.

2/11/25, 10:54 AM

about:blank



Countertop NN-ST67KS

MODEL & SIZE	Model Number		NN-ST67KS
	Type		Mid-size
	Oven Capacity		1.2 cu. ft.
	Power Source		120 V / 60 Hz
	Technology		Inverter®
DESIGN	Power	Microwave	1200W
	Colour		Silver
	Door		Side Open
	Door Release		Push Open
	Control Panel Design		Touch pad
PROGRAMMABLE FEATURES	Display Type		New 4 Digit + Icon
	Display Color		White
	Sensor		Yes
	Microwave Power Level		11 (P0-P10) P0 keep warm
	Cook time		99min 99sec
SPECIFICATIONS	Kitchen Timer		Yes (99min 99sec)
	Standing Time		Yes (99min 99sec)
	Delay Start		Yes (99min 99sec)
	Clock		12 H
	Stage Cooking		3 Stage
	Outside Dimensions (H x W x D)		310 x 525 x 401 mm
	Oven Dimensions (H x W x D)		251 x 355 x 365 mm

2/11/25, 10:54 AM

about:blank

MENU

Net Weight	11.5 kg
Turbo Defrost	Yes (0.1-3.0 kg)
Popcorn	3.2 oz. (91 g) / 2.75 oz. (78 g) / 1.5 oz. (42 g)
Keep Warm	Yes in microwave power (up to 30 min)
Add Time	Yes (Manual)
Quick 30	Yes (up to 5 min)
Serving / Weight	No
More/Less	Yes
Recipe Store / Memory	No
Auto Reheat	Sensor Reheat
Beverage	Coffee/Milk
Auto Cook categories	15

TRIM KIT

NN-TK621SSAP/TK612GSSAP

© 2025 Panasonic Canada Inc. All rights reserved.