

Sales Selection Sheet
Checklist

1 of 55

LOT 7122 Model: 39-3611 A The Beechfield

PURCHASERS: NAVEEN KUMAR NETHI//SWAPNA NETHI

VENDOR: Heathwood Homes (Whitby) Limited

BUILT-IN KITCHEN LAYOUT

- ☐ COLD CELLAR
- ☒ DECK

UPGRADED / MODIFIED ELEVATION

- ☐ CORNER UPGRADE
- ☐ SIDE UPGRADE

CEILING UPGRADE - SMOOTH

- ☒ MAIN FLOOR (STD)
- ☐ SECOND FLOOR WITH RESILIENCE CHANEL
- ☐ LOWER LEVEL

ADDITIONAL ROUGH-INS

- ☒ 200 AMP SERVICE (STD)
- ☐ WET BAR ROUGH-IN
- ☒ HUMIDIFIER (STD)
- ☒ AIR CONDITIONING (STD)

GAS ROUGH-IN

- ☒ STOVE
- ☐ DRYER
- ☐ BBQ
- ☐ ADDITIONAL GAS FIREPLACE

KITCHEN HOODFAN VENTING SIZE

- ☒ 6 IN ROUND DUCT (STD WITH APPLIANCE PACKAGE)
- ☐ 7 IN ROUND DUCT

FULL LOWER LEVEL STAIRS	All Oak
UPPER LOWER LEVEL STAIRS	N/A
LOWER LOWER LEVEL STAIRS	N/A
MAIN STAIRS	All Oak

Dec 23/24 Signatures on
Date Purchaser: file

Date Purchaser:

Locked Date:

Dec 23/24 IRIT SALEM
Date Decor Consultant:

-12- 23 2024 mRow
Date Heathwood Homes (Whitby) Limited
Approved

NAVEEN KUMAR NETHI/SWAPNA NETHI
Project: Country Lane
Unit: 7122, Phase: 7
Model: 39-3611 A The Beechfield

Created: 3/5/2024 13:56:24
Locked:
Closed:

Kitchen/Breakfast

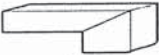
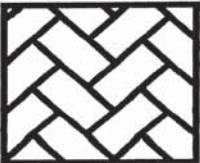
Cabinet Colour/Style	6860	Classic Plus-OTTAWA-WINTER WHITE-PAINT MDF ***UPG***
Island Cabinet Colour/Style	6860	Classic Plus-OTTAWA-WINTER WHITE-PAINT MDF ***UPG***
Cabinet Hardware	7676	12843-HARDWARE ***STD***
Countertop	9857	Group 6-Quartz-Caesarstone-CELESTIAL SKY #5132 -3/4 inch B/U Mitered Edge ***UPG***
Island Countertop	9857	Group 6-Quartz-Caesarstone-CELESTIAL SKY #5132 -3/4 inch B/U Mitered Edge ***UPG***
Countertop Edge	4005	DOUBLE MITRE 1 1/2 INCH ***UPG*** 
Sink	9493	BLANCO QUATRUS U 1 SUPER SINGLE 401248 (min cabinet 36 in) PG 29
Crumb Vac Color	9482	Vacuum-Crumb Vac (Dust Pan)-White
HoodFan	9864	AVW-368CS-AVG 36 inch STAINLESS STEEL CHIMNEY WALL MOUNTED HOODFAN-Stainless Steel-36 inch-UPG PG 42-43
Backsplash	5721	QT.CD.ARW.0306.BR-Colour and Dimension Bright-Arctic White-3 x 6 ***1***
Backsplash Grout	9836	Grout-Eggshell #5220 ***STD***
Backsplash Tile Pattern	3100	VERTICAL HERRINGBONE ***UPG*** 
Flooring	9009	Red Oak PEARL-Vintage Red Oak Solid Sculpted Character PEARL-HILLSIDE-3/4 inch X 5 inch ***STD***
Floor Tile Grout	1111	N/A *****
Floor Tile Pattern	1111	N/A *****

- Purchasers have been advised: standard fridge opening is a minimum 37 3/8 x 73 3/8 inches. Ice Waterline Rough-In is included.
- Standard stove opening is 30 inches and standard dishwasher opening is 24 inches. Any gas stove will require backsplash or stainless steel backing to avoid fire hazards.
- Purchasers acknowledge: Heathwood Homes and its contractors will not be responsible for any kitchen cabinet changes due to appliances dimension changes after sign-off.

Comment

....

Walk in Pantry

Flooring	9009	Red Oak PEARL-Vintage Red Oak Solid Sculpted Character PEARL-HILLSIDE-3/4 inch X 5 inch ***STD***
Floor Tile Grout	1111	N/A *****
Floor Tile Pattern	1111	N/A *****

Customer Colours

NAVEEN KUMAR NETHI/SWAPNA NETHI
Project: Country Lane
Unit: 7122, Phase: 7
Model: 39-3611 A The Beechfield

3 of 55

678

Created: 3/5/2024 13:56:24

Locked:

Closed:

Comment

Servery

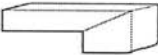
Cabinet Colour/Style	6860	Classic Plus-OTTAWA-WINTER WHITE-PAINT MDF ***UPG***
Cabinet Hardware	7676	12843-HARDWARE ***STD***
Opt. Cabinet Colour/Style - Uppers	1111	N/A *****
Opt. Cabinet Hardware - Uppers	1111	N/A *****
Countertop	9857	Group 6-Quartz-Caesarstone-CELESTIAL SKY #5132 -3/4 inch B/U Mitered Edge ***UPG***
Countertop Edge	4005	DOUBLE MITRE 1 1/2 INCH ***UPG*** 
Opt. Sink	1111	N/A *****
Opt. Backsplash	1111	N/A *****
Opt. Backsplash Grout	1111	N/A *****
Opt. Backsplash Tile Pattern	1111	N/A *****

Flooring	9009	Red Oak PEARL-Vintage Red Oak Solid Sculpted Character PEARL-HILLSIDE-3/4 inch X 5 inch ***STD***
Floor Tile Grout	1111	N/A *****
Floor Tile Pattern	1111	N/A *****

Comment

Foyer

Flooring	8243	OV.CX.WHT.1224.MT-Carrara X-White Matte-12 x 24 See Tile Direction on Sketch Page ***5***								
Floor Tile Grout	9837	Grout-Warm Grey #5093 ***STD***								
Floor Tile Pattern	3050	SIDE TO SIDE ***STD*** <table><tr><td></td><td></td></tr><tr><td></td><td></td></tr><tr><td></td><td></td></tr><tr><td></td><td></td></tr></table>								

S 2

NN

SN

NAVEEN KUMAR NETHI/SWAPNA NETHI
Project: Country Lane
Unit: 7122, Phase: 7
Model: 39-3611 A The Beechfield

Created: 3/5/2024 13:56:24
Locked:
Closed:

Comment

Powder Room

Flooring	9255	TR.SP.WHITE.1313 SEMPRE White Matte 13 x 13 ***STD***									
Floor Tile Grout	9837	Grout-Warm Grey #5093 ***STD***									
Floor Tile Pattern	3000	STANDARD SQUARE ***STD***									
<table><tr><td></td><td></td><td></td></tr><tr><td></td><td></td><td></td></tr><tr><td></td><td></td><td></td></tr></table>											

Plumbing Fixture (Colour)	1737	Plumbing Fixtures-WHITE ***STD***
Comment		

Dining Room and Hall

Flooring	9009	Red Oak PEARL-Vintage Red Oak Solid Sculpted Character PEARL-HILLSIDE-3/4 inch X 5 inch ***STD***
Comment		

Great Room

Flooring	9009	Red Oak PEARL-Vintage Red Oak Solid Sculpted Character PEARL-HILLSIDE-3/4 inch X 5 inch ***STD***
Comment		

Great Room Fireplace

Type	8869	Majestic MERC32 ***STD***
Mantle	7736	NF 16-Paint Grade Mantle-WHITE ***Upg***
Surround (STD)	8874	3 pc- 4 inch Marble Surround-Grigio Carnico ***STD***

- Purchasers have been advised: heat from the FP can damage TV above a FP and items placed on mantle.

- Heathwood and its contractors will not be liable for any damage on items placed/@installed above a FP after closing.

Comment

Living Room

Flooring	9009	Red Oak PEARL-Vintage Red Oak Solid Sculpted Character PEARL-HILLSIDE-3/4 inch X 5 inch ***STD***
Comment		

PG 27

NN
SN

NAVEEN KUMAR NETHI/SWAPNA NETHI
Project: Country Lane
Unit: 7122, Phase: 7
Model: 39-3611 A The Beechfield

Created: 3/5/2024 13:56:24
Locked:
Closed:

Study

Flooring	9009	Red Oak PEARL-Vintage Red Oak Solid Sculpted Character PEARL-HILLSIDE-3/4 inch X 5 inch ***STD***
Comment		

Mud Room

Flooring	9255	TR.SP.WHITE.1313 SEMPRE White Matte 13 x 13 ***STD***									
Floor Tile Grout	9837	Grout-Warm Grey #5093 ***STD***									
Floor Tile Pattern	3000	STANDARD SQUARE ***STD***									
		<table><tr><td></td><td></td><td></td></tr><tr><td></td><td></td><td></td></tr><tr><td></td><td></td><td></td></tr></table>									
Opt. Bench Cabinet Colour/Style	1111	N/A *****									
Opt. Bench Cabinet Hardware	1111	N/A *****									
Comment											

Main Hall

Flooring	9009	Red Oak PEARL-Vintage Red Oak Solid Sculpted Character PEARL-HILLSIDE-3/4 inch X 5 inch ***STD***
Comment		

Upper Hall

Flooring	9009	Red Oak PEARL-Vintage Red Oak Solid Sculpted Character PEARL-HILLSIDE-3/4 inch X 5 inch ***STD***
Comment		

Master Bedroom

Flooring	9504	87354-MINOTAUR-OVERCAST-40 oz Poly ***STD***
Comment		

Bedroom 2

Flooring	9504	87354-MINOTAUR-OVERCAST-40 oz Poly ***STD***
Comment		

Bedroom 3

Flooring	9504	87354-MINOTAUR-OVERCAST-40 oz Poly ***STD***
----------	------	--

NW
SW

NAVEEN KUMAR NETHI/SWAPNA NETHI
Project: Country Lane
Unit: 7122, Phase: 7
Model: 39-3611 A The Beechfield

Created: 3/5/2024 13:56:24
Locked:
Closed:

Comment

Bedroom 4

Flooring 9504 87354-MINOTAUR-OVERCAST-40 oz Poly ***STD***

Comment

Master Ensuite

Cabinet Colour/Style 9167 Viking III-CHARLESTON-RAIN CLOUD-3DL ***STD***

Cabinet Hardware 2086 9677-HARDWARE ***STD***

Countertop 9811 Group 1-Quartz-Caesarstone-ROCK SALT # 7601-3/4 inch B/U MITERED EDGE ***UPG***

Countertop Edge 4010 GROUP 1 - SINGLE POLISHED STRAIGHT EDGE 3/4 INCH ***1***

Floor Tile 5490  GE.LR.GRY.1313-La Riserva-Grey-13 x 13 ***STD***

Floor Tile Grout 9837 Grout-Warm Grey #5093 ***STD***

Floor Tile Pattern 3000 STANDARD SQUARE ***STD***

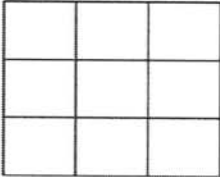

Shower Wall Tile 5426 GE.LR.GRY.0810-La Riserva-Grey-8 inch x 10 inch ***STD***

Shower Wall Tile Grout 9836 Grout-Eggshell #5220 ***STD***

Shower Wall Tile Pattern 3090 VERTICAL STACKED ***STD***

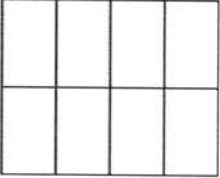

Shower Floor Tile 8661 OD.ON.SWT.0202.MT.N-Ontario Series Mosaic-Snow White Matte-2 x 2 ***STD***

Shower Floor Tile Grout 9836 Grout-Eggshell #5220 ***STD***

Shower Floor Tile Pattern 3000 STANDARD SQUARE ***STD***

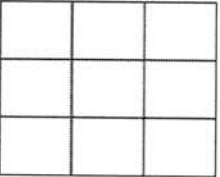

Shower Jamb(s) and Sill(s) 8923 Shower Jamb / Sill-Thassos White ***STD***

Plumbing Fixture (colour) 1737 Plumbing Fixtures-WHITE ***STD***

Comment

NN
SN

NAVEEN KUMAR NETHI/SWAPNA NETHI
Project: Country Lane
Unit: 7122, Phase: 7
Model: 39-3611 A The Beechfield

Created: 3/5/2024 13:56:24
Locked:
Closed:

Shared Ensuite

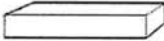
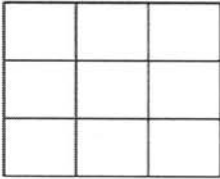
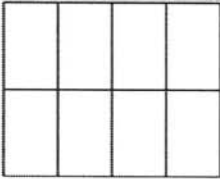
Cabinet Colour/Style	9167	Viking III-CHARLESTON-RAIN CLOUD-3DL ***STD***
Cabinet Hardware	2086	9677-HARDWARE ***STD***
Countertop	9811	Group 1-Quartz-Caesarstone-ROCK SALT # 7601-3/4 inch B/U MITERED EDGE ***UPG***
Countertop Edge	4010	GROUP 1 - SINGLE POLISHED STRAIGHT EDGE 3/4 INCH ***1***
		
Floor Tile	5490	GE.LR.GRY.1313-La Riserva-Grey-13 x 13 ***STD***
Floor Tile Grout	9837	Grout-Warm Grey #5093 ***STD***
Floor Tile Pattern	3000	STANDARD SQUARE ***STD***
		
Wall Tile	5426	GE.LR.GRY.0810-La Riserva-Grey-8 inch x 10 inch ***STD***
Wall Tile Grout	9836	Grout-Eggshell #5220 ***STD***
Wall Tile Pattern	3090	VERTICAL STACKED ***STD***
		
Opt. Shower Floor Tile	1111	N/A *****
Opt. Shower Floor Tile Grout	1111	N/A *****
Opt. Shower Floor Tile Pattern	1111	N/A *****

Opt. Shower Jamb(s) and Sill(s)	1111	N/A *****
Plumbing Fixture (colour)	1737	Plumbing Fixtures-WHITE ***STD***
Comment		

Ensuite 2

Cabinet Colour/Style	9167	Viking III-CHARLESTON-RAIN CLOUD-3DL ***STD***
Cabinet Hardware	2086	9677-HARDWARE ***STD***
Countertop	9811	Group 1-Quartz-Caesarstone-ROCK SALT # 7601-3/4 inch B/U MITERED EDGE ***UPG***
Countertop Edge	4010	GROUP 1 - SINGLE POLISHED STRAIGHT EDGE 3/4 INCH ***1***
		
Floor Tile	5490	GE.LR.GRY.1313-La Riserva-Grey-13 x 13 ***STD***
Floor Tile Grout	9837	Grout-Warm Grey #5093 ***STD***

NW
SW

NAVEEN KUMAR NETHI/SWAPNA NETHI
Project: Country Lane
Unit: 7122, Phase: 7
Model: 39-3611 A The Beechfield

Created: 3/5/2024 13:56:24
Locked:
Closed:

Floor Tile Grout	9037	Grout-Warm Grey #5093 STD
Floor Tile Pattern	3000	STANDARD SQUARE ***STD*** <div><div></div><div></div><div></div><div></div><div></div><div></div><div></div><div></div><div></div></div>
Shower Wall Tile	9020	QT.WV.WHT.0810-Weave-White-8 x 10 ***STD***
Shower Wall Tile Grout	9836	Grout-Eggshell #5220 ***STD***
Shower Wall Tile Pattern	3090	VERTICAL STACKED ***STD*** <div><div></div><div></div><div></div><div></div><div></div><div></div><div></div><div></div><div></div></div>
Shower Floor Tile	8661	OD.ON.SWT.0202.MT.N-Ontario Series Mosaic-Snow White Matte-2 x 2 ***STD***
Shower Floor Tile Grout	9836	Grout-Eggshell #5220 ***STD***
Shower Floor Tile Pattern	3000	STANDARD SQUARE ***STD*** <div><div></div><div></div><div></div><div></div><div></div><div></div><div></div><div></div><div></div></div>
Shower Jamb(s) and Sill(s)	8923	Shower Jamb / Sill-Thassos White ***STD***
Plumbing Fixture (colour)	1737	Plumbing Fixtures-WHITE ***STD***
Comment		

Laundry Room

Flooring	5490	GE.LR.GRY.1313-La Riserva-Grey-13 x 13 ***STD***
Floor Tile Grout	9837	Grout-Warm Grey #5093 ***STD***
Floor Tile Pattern	3000	STANDARD SQUARE ***STD*** <div><div></div><div></div><div></div><div></div><div></div><div></div><div></div><div></div><div></div></div>
Opt. Cabinet Colour/Style - Uppers	1111	N/A *****
Opt. Cabinet Hardware - Uppers	1111	N/A *****
Cabinet Colour/Style - Base	9111	VIKING III SIMCOE ORCHID 3DL ***STD***
Cabinet Hardware - Base	2086	9677-HARDWARE ***STD***
Comment	STD. COUNTER TOP: 8822 :CARRARA WILSONART	

NN
SN

Lower Level Recreation Room

Flooring	9504	87354-MINOTAUR-OVERCAST-40 oz Poly ***STD***
Comment		

NAVEEN KUMAR NETHI/SWAPNA NETHI
Project: Country Lane
Unit: 7122, Phase: 7
Model: 39-3611 A The Beechfield

Created: 3/5/2024 13:56:24
Locked:
Closed:

STD. DIMPLEX ELECTRIC PF3033 HL. NF 17 MANTLE NO SURROUND

PG 28

Lower Level Bedroom

Flooring	9504	87354-MINOTAUR-OVERCAST-40 oz Poly ***STD***
Comment		

Lower Level Bathroom

Cabinet Colour/Style	9167	Viking III-CHARLESTON-RAIN CLOUD-3DL ***STD***
Cabinet Hardware	2086	9677-HARDWARE ***STD***
Countertop	8822	4924-38-Countertop-WHITE CARRARA-Wilsonart ***STD***
Countertop Edge	1111	N/A *****

Floor Tile	5490	GE.LR.GRY.1313-La Riserva-Grey-13 x 13 ***STD***
------------	------	--

Floor Tile Grout	9837	Grout-Warm Grey #5093 ***STD***
------------------	------	---------------------------------

Floor Tile Pattern	3000	STANDARD SQUARE ***STD***
<div><div></div><div></div><div></div></div> <div><div></div><div></div><div></div></div> <div><div></div><div></div><div></div></div>		

Wall Tile	5426	GE.LR.GRY.0810-La Riserva-Grey-8 inch x 10 inch ***STD***
-----------	------	---

Wall Tile Grout	9836	Grout-Eggshell #5220 ***STD***
-----------------	------	--------------------------------

Wall Tile Pattern	3090	VERTICAL STACKED ***STD***
<div><div></div><div></div><div></div><div></div></div> <div><div></div><div></div><div></div><div></div></div>		

Opt. Shower Floor Tile	1111	N/A *****
------------------------	------	-----------

Opt. Shower Floor Tile Grout	1111	N/A *****
------------------------------	------	-----------

Opt. Shower Floor Tile Pattern	1111	N/A *****
--------------------------------	------	-----------

Opt. Shower Jamb(s) and Sill(s)	1111	N/A *****
---------------------------------	------	-----------

Plumbing Fixture (colour)	1737	Plumbing Fixtures-WHITE ***STD***
---------------------------	------	-----------------------------------

Comment		
---------	--	--

NN
SN

Main Stairs

Type	1712	Oak Stairs ***STD***
------	------	----------------------

NAVEEN KUMAR NETHI/SWAPNA NETHI
Project: Country Lane
Unit: 7122, Phase: 7
Model: 39-3611 A The Beechfield

Created: 3/5/2024 13:56:24
Locked:
Closed:

Type	1712	Oak Stairs ***STD***
Colour	9796	Hillside STAIN TO COMPLIMENT HARDWOOD AND WILL VARY FROM FLOORING ***99***-STD
Handrail/Pickets/Posts Type	8148	Single Collar Alt. Plain w/ Shoes with 3 1/2 Square/Cap Post(s)-BLACK ***STD***
Handrail/Pickets/Posts Colour	9796	Hillside STAIN TO COMPLIMENT HARDWOOD AND WILL VARY FROM FLOORING ***99***-STD
Custom Stain/Paint	1111	N/A *****
Landing(s)	9009	Red Oak PEARL-Vintage Red Oak Solid Sculpted Character PEARL-HILLSIDE-3/4 inch X 5 inch ***STD***
Opt. Carpet Runner	1111	N/A *****
Comment		

Lower Level Stairs

Type	1712	Oak Stairs ***STD***
Colour	9796	Hillside STAIN TO COMPLIMENT HARDWOOD AND WILL VARY FROM FLOORING ***99***-STD
Handrail/Pickets/Posts Type	8148	Single Collar Alt. Plain w/ Shoes with 3 1/2 Square/Cap Post(s)-BLACK ***STD***
Handrail/Pickets/Posts Colour	9796	Hillside STAIN TO COMPLIMENT HARDWOOD AND WILL VARY FROM FLOORING ***99***-STD
Custom Stain/Paint	1111	N/A *****
Landing(s)	9009	Red Oak PEARL-Vintage Red Oak Solid Sculpted Character PEARL-HILLSIDE-3/4 inch X 5 inch ***STD***
Opt. Carpet Runner	1111	N/A *****
Comment		

Throughout

Switches and Plug	5796	Decora White Switches and Plugs ***STD***
Thresholds	2232	Metal Thresholds ***STD***
Underpad	1079	500 Series-Underpad ***STD***
Trim Size	8704	5 1/4 inch Baseboard and 3 inch Integrated Backbend Casings ***UPG*** / ***STD in Singles***
Trim - Paint Colour	1716	Trim-WHITE ***STD***
Walls - Paint Colour	1717	22-Wall-WARM GREY ***STD***
Comment		

NW
SN

Purchaser:



NAVEEN KUMAR NETHI

Sep 30 2024

Date



Decor Consultant

Sep 30. 24



Date

Customer Colours

11 of 55

NAVEEN KUMAR NETHI/SWAPNA NETHI
Project: Country Lane
Unit: 7122, Phase: 7
Model: 39-3611 A The Beechfield

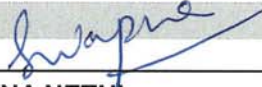
Created: 3/5/2024 13:56:24
Locked:
Closed:

Purchaser:			
	SWAPNA NETHI	Date	Country Lane
			
			Date Approved
			-12- 23 2024

NN
SN



CONSTRUCTION SUMMARY

Lot: 7122
Model: 39-3611 A The Beechfield
Project/Phase: Country Lane / 7

Offer Worksheet	Supply and Install Central Air Conditioning Note:
Offer Worksheet	Two Men and a Truck Credit of One Thousand Dollars (\$1000.00) for moving services only, Into your Heathwood Home (No Cash Value) The Credit is Non-Transferable and cannot be combined with any other offer. - Singles Note:
Offer Worksheet	Classic Collection: Five Appliances: SS Fridge, Stove, Dishwasher: White Front Loader Washer/Dryer (Singles) Note:
Offer Worksheet	The Purchaser(s) acknowledge that they have NOT been referred by an existing Heathwood Homeowner and therefor are not entitled to a referral fee under Heathwood Homes Referral program. Note:
Offer Worksheet	This is a Deck Grading Condition that includes a deck with steps to grade. Note:



CONSTRUCTION SUMMARY

Lot: 7122
Model: 39-3611 A The Beechfield
Project/Phase: Country Lane / 7

APPLIANCES

Invoice	Qty.	Description
1745 389,736 03Apr25 **	1.0	KITCHEN - GRANITE - GRANITE CUTOUT w/ STRAIGHT EDGE POLISH TO ACCOMMODATE COOK TOP SKETCH # 3 SEE COOKTOP SPECS
1745 714,386 03Apr25	1.0	KITCHEN - APPLIANCES - CYCLONE 36 INCH WALL MOUNT CHIMNEY HOOD SS - SCB51436 CHANGED TO AVW 36" WALL MOUNTED CHIMNEY HOODFAN - SEE SPECS CABINETRY-delete stove uppers; ELECTRICAL-Notify; HEATING/AIR CONDITIONING-Duct Size remains 6 i

CABINETRY

Invoice	Qty.	Description
1745 714,395 03Apr25	1.0	KITCHEN - CABINETRY-CLASSIC PLUS-OPT. BUILT-INS + 8B INCLUDING SOFT-CLOSE TANDEMBOX POTS AND PANS (2) DRAWERS (WIDTH MIN. 60CM/MAX. 90CM) (SIZE SUBJECT TO FLOOR PLAN)-UPG SKETCH # 3 SEE APPLIANCE SPECS DRYWAL-Notify; FRAMING-Modify Bulkhead; GRANITE-delete partial countertop due to Built-in; PAINTING-
1745 714,447 03Apr25	2.0	THROUGHOUT - CABINETRY - 13D-VANITY TOP DRAWER/LOWER DRAWER (PER DRAWER) (METABOX STANDARD LEVELS 1-7, SOFT-CLOSE TANDEMBOX STANDARD LEVELS 8-13)-VIKING SHARED AND ENS. 2 BATH SEE SKETCH # 4 AND 5
1745 389,826 03Apr25 **	3.0	- PLUMBING - AMERICAN STANDARD - SINK OPTIONS - UNDERMOUNT SINK - OVALYN MODEL 0496 221 020” (19 ” INCH X 16 ” INCH) - 2X SHARED 1X ENS.2 BATHROOMS SEE SPEC CABINETRY-upgraded vanity sink; GRANITE-cutout to accommodate undermount sinks
1745 389,827 03Apr25 **	2.0	MASTER ENSUITE - PLUMBING - AMERICAN STANDARD - SINK OPTIONS - UNDERMOUNT SINK - STUDIO - WHITE - MODEL 0614 000 020 (21 ” INCH X 15 ” INCH) - 2X MASTER BATH SEE SPEC CABINETRY-upgraded vanity sink; GRANITE-cutout to accommodate undermount sinks
1745 389,736 03Apr25 **	1.0	KITCHEN - GRANITE - GRANITE CUTOUT w/ STRAIGHT EDGE POLISH TO ACCOMMODATE COOK TOP SKETCH # 3 SEE COOKTOP SPECS
1745 712,315 03Apr25 **	1.0	- GRANITE - MAIN BATH - GROUP 1 - UPG CABINETRY-delete std countertop; GRANITE-see upgraded single hole faucet and undermount sink
1745 389,866 03Apr25 **	1.0	KITCHEN - PLUMBING - KITCHEN SINK UPGRADE - BLANCO QUATRUS U 1 SUPER SINGLE 401248 (MIN CABINET 36 IN) SEE SPEC CABINETRY-upgraded kitchen sink; GRANITE-upgraded kitchen sink
1745 700,851 03Apr25	1.0	- CABINETRY - KIT/SERVERY -CLASSIC PLUS-UPG
1745 712,331 03Apr25 **	1.0	- GRANITE - ENSUITE BED 2 - GROUP 1 - UPG CABINETRY-delete std countertop; GRANITE-see upgraded single hole faucet and undermount sink
1745 712,323 03Apr25 **	1.0	- GRANITE - PRINCIPAL ENSUITE - GROUP 1 - UPG CABINETRY-delete std countertop; GRANITE-see upgraded single hole faucet and undermount sink



CONSTRUCTION SUMMARY

Lot: 7122
Model: 39-3611 A The Beechfield
Project/Phase: Country Lane / 7

CABINETRY

Invoice	Qty.	Description
1745 714,386 03Apr25 **	1.0	KITCHEN - APPLIANCES - CYCLONE 36 INCH WALL MOUNT CHIMNEY HOOD SS - SCB51436 CHANGED TO AVW 36" WALL MOUNTED CHIMNEY HOODFAN - SEE SPECS CABINETRY-delete stove uppers; ELECTRICAL-Notify; HEATING/AIR CONDITIONING-Duct Size remains 6 i
1745 714,515 03Apr25	1.0	KITCHEN - CABINETRY - 15B-45CM WIDE PULL-OUT DOOR BASE CABINET WASTE/RECYCLE CENTRE WITH SOFT-CLOSE ([2] 35L BINS) (AVAILABLE ONLY WITH 45CM WIDE CABINET) -CLASSIC SKETCH # 3 SEE SPEC
1745 714,131 03Apr25 **	1.0	- HARDWOOD - KITCHEN/BRK - 5 IN VINTAGE SCULPTED NSS RED OAK (CHARACTER GRADE) UVF OIL OR PEARL - UPG CABINETRY-Raise Cabinet; CERAMICS-Delete Std Ceramics
1745 714,132 03Apr25 **	1.0	- HARDWOOD - SERVERY - 5 IN VINTAGE SCULPTED NSS RED OAK (CHARACTER GRADE) UVF OIL OR PEARL - UPG CABINETRY-Raise Cabinet; CERAMICS-Delete Std Ceramics; INTERIOR STAIRS-Notify (Servery)

CERAMICS

Invoice	Qty.	Description
1745 705,868 03Apr25	1.0	KITCHEN - CERAMIC - KITCHEN - BACKSPLASH SINGLES - HERRINGBONE - UPG
1745 705,801 03Apr25	1.0	Foyer - CERAMIC - FOYER - FLOOR - UG 5 - UPG
1745 714,131 03Apr25 **	1.0	- HARDWOOD - KITCHEN/BRK - 5 IN VINTAGE SCULPTED NSS RED OAK (CHARACTER GRADE) UVF OIL OR PEARL - UPG CABINETRY-Raise Cabinet; CERAMICS-Delete Std Ceramics
1745 714,132 03Apr25 **	1.0	- HARDWOOD - SERVERY - 5 IN VINTAGE SCULPTED NSS RED OAK (CHARACTER GRADE) UVF OIL OR PEARL - UPG CABINETRY-Raise Cabinet; CERAMICS-Delete Std Ceramics; INTERIOR STAIRS-Notify (Servery)



CONSTRUCTION SUMMARY

Lot: 7122
Model: 39-3611 A The Beechfield
Project/Phase: Country Lane / 7

DRYWALL

Invoice	Qty.	Description
1745 395,461 03Apr25 **	1.0	THROUGHOUT - CLASSIC COLLECTION SCHEDULE A - Choice of 20 LED (3000K) pot lights in finished areas (Second Floor Potlight(s) Require Smooth Ceiling) DRYWALL-Drywall Ceiling cutouts for potlights FRAMING-Frame to accommodate potlights 6X GREAT ROOM- USE SEPARATE SWITCH 5X KITCHEN - USE SEPARATE SWITCH, RELOCATE STD. KITCHEN LIGHT 4X LIVING ROOM USE SEPARATE.SWITCH 4X DINING ROOM- USE SEPARATE SWITCH KEEP STD. LIGHT 1X POWDER ROOM LANDING -USE STD. SWITCH RELOCATE STD.LIGHT SEE SKETCH # 2
1745 392,130 03Apr25 **	1.0	GREAT ROOM - FIREPLACE AND MANTLE - UPGRADE TO NF-16 WHITE PAINT GRADE MANTLE (NO MARBLE SURROUND UNLESS ON FLAT WALL) SEE SPEC DRYWALL-notify; ELECTRICAL-notify; FRAMING-notify; HEATING/AIR CONDITIONING-notify; INTERIOR TRIM-notify; PAINTING-notify
1745 714,395 03Apr25 **	1.0	KITCHEN - CABINETRY-CLASSIC PLUS-OPT. BUILT-INS + 8B INCLUDING SOFT-CLOSE TANDEMBOX POTS AND PANS (2) DRAWERS (WIDTH MIN. 60CM/MAX. 90CM) (SIZE SUBJECT TO FLOOR PLAN)-UPG SKETCH # 3 SEE APPLIANCE SPECS DRYWAL-Notify; FRAMING-Modify Bulkhead; GRANITE-delete partial countertop due to Built-in; PAINTING-



CONSTRUCTION SUMMARY

Lot: 7122
Model: 39-3611 A The Beechfield
Project/Phase: Country Lane / 7

ELECTRICAL

Invoice	Qty.	Description
1745 395,461 03Apr25	1.0	THROUGHOUT - CLASSIC COLLECTION SCHEDULE A - Choice of 20 LED (3000K) pot lights in finished areas (Second Floor Potlight(s) Require Smooth Ceiling) DRYWALL-Drywall Ceiling cutouts for potlights FRAMING-Frame to accommodate potlights 6X GREAT ROOM- USE SEPARATE SWITCH 5X KITCHEN - USE SEPARATE SWITCH, RELOCATE STD. KITCHEN LIGHT 4X LIVING ROOM USE SEPARATE SWITCH 4X DINING ROOM- USE SEPARATE SWITCH KEEP STD. LIGHT 1X POWDER ROOM LANDING -USE STD. SWITCH RELOCATE STD.LIGHT SEE SKETCH # 2
1745 392,130 03Apr25 **	1.0	GREAT ROOM - FIREPLACE AND MANTLE - UPGRADE TO NF-16 WHITE PAINT GRADE MANTLE (NO MARBLE SURROUND UNLESS ON FLAT WALL) SEE SPEC DRYWALL-notify; ELECTRICAL-notify; FRAMING-notify; HEATING/AIR CONDITIONING-notify; INTERIOR TRIM-notify; PAINTING-notify
1745 390,529 03Apr25	2.0	THROUGHOUT - ELECTRICAL-SUPPLY AND INSTALL RECESSED PLUG ON EXISTING CIRCUIT 1X GREAT ROOM, 1X RECREATION ROOM BOTH TO BE INSTALLED ABOVE THE FIRE PLACE 70"+- FROM FLOOR SEE SKETCH # 1 AND 2
1745 390,494 03Apr25	1.0	- ELECTRICAL-CAR CHARGER-2 INCH CONDUIT WITH 8X8 BOX FOR FUTURE CAR CHARGER
1745 389,800 03Apr25 **	1.0	KITCHEN - HEATING/AIR - ROUGH-IN GAS LINE FOR GAS STOVE AT MAIN FLOOR (SEE SPECS) (HOOK-UP NOT INCLUDED) LEAVE STANDARD 120 VOLT ELECTRICAL OUTLET ON A SEPARATE CIRCUIT. * SPECIFY IF STANDARD 220V WILL STAY OR BE RELOCATED STANDARD 220V RELOCATED TO B/I MICRO/STOVE LOCATION SKETCH # 3 SEE APPLIANCE SPECS ELECTRICAL-Notify
1745 390,496 03Apr25	1.0	LIVING ROOM - ELECTRICAL-CEILING ROUGH-IN (CAPPED) TO BE INSTALLED IN THE CENTRE OF THE ROOM - USE EXISTING SWITCH PLUG SEE SKETCH # 2
1745 389,736 03Apr25 **	1.0	KITCHEN - GRANITE - GRANITE CUTOUT w/ STRAIGHT EDGE POLISH TO ACCOMMODATE COOK TOP SKETCH # 3 SEE COOKTOP SPECS
1745 390,528 03Apr25	3.0	THROUGHOUT - ELECTRICAL-RELOCATION OF SWITCHES/LIGHTS (MUST SPECIFY LOCATION)-NOTE: PLUGS CANNOT BE RELOCATED- MUST PURCHASE ADDITIONAL OUTLET. RELOCATE STD. POWDER LANDING AND KITCHEN LIGHT TO BE ABOVE THE ISLAND USE STD. KITCHEN SWITCH RELOCATE STD. STOVE ELECTRICAL TO BUILT IN WALL OVEN SEE SKETCH # 2
1745 714,386 03Apr25 **	1.0	KITCHEN - APPLIANCES - CYCLONE 36 INCH WALL MOUNT CHIMNEY HOOD SS - SCB51436 CHANGED TO AVW 36" WALL MOUNTED CHIMNEY HOODFAN - SEE SPECS CABINETRY-delete stove uppers; ELECTRICAL-Notify; HEATING/AIR CONDITIONING-Duct Size remains 6 i



CONSTRUCTION SUMMARY

Lot: 7122
Model: 39-3611 A The Beechfield
Project/Phase: Country Lane / 7

FIREPLACE AND MANTLE

Invoice	Qty.	Description
1745 392,130 03Apr25	1.0	GREAT ROOM - FIREPLACE AND MANTLE - UPGRADE TO NF-16 WHITE PAINT GRADE MANTLE (NO MARBLE SURROUND UNLESS ON FLAT WALL) SEE SPEC DRYWALL-notify; ELECTRICAL-notify; FRAMING-notify; HEATING/AIR CONDITIONING-notify; INTERIOR TRIM-notify; PAINTING-notify

FRAMING

Invoice	Qty.	Description
1745 395,461 03Apr25 **	1.0	THROUGHOUT - CLASSIC COLLECTION SCHEDULE A - Choice of 20 LED (3000K) pot lights in finished areas (Second Floor Potlight(s) Require Smooth Ceiling) DRYWALL-Drywall Ceiling cutouts for potlights FRAMING-Frame to accommodate potlights 6X GREAT ROOM- USE SEPARATE SWITCH 5X KITCHEN - USE SEPARATE SWITCH, RELOCATE STD. KITCHEN LIGHT 4X LIVING ROOM USE SEPARATE.SWITCH 4X DINING ROOM- USE SEPARATE SWITCH KEEP STD. LIGHT 1X POWDER ROOM LANDING -USE STD. SWITCH RELOCATE STD.LIGHT SEE SKETCH # 2
1745 392,130 03Apr25 **	1.0	GREAT ROOM - FIREPLACE AND MANTLE - UPGRADE TO NF-16 WHITE PAINT GRADE MANTLE (NO MARBLE SURROUND UNLESS ON FLAT WALL) SEE SPEC DRYWALL-notify; ELECTRICAL-notify; FRAMING-notify; HEATING/AIR CONDITIONING-notify; INTERIOR TRIM-notify; PAINTING-notify
1745 714,395 03Apr25 **	1.0	KITCHEN - CABINETRY-CLASSIC PLUS-OPT. BUILT-INS + 8B INCLUDING SOFT-CLOSE TANDEMBOX POTS AND PANS (2) DRAWERS (WIDTH MIN. 60CM/MAX. 90CM) (SIZE SUBJECT TO FLOOR PLAN)-UPG SKETCH # 3 SEE APPLIANCE SPECS DRYWAL-Notify; FRAMING-Modify Bulkhead; GRANITE-delete partial countertop due to Built-in; PAINTING-



CONSTRUCTION SUMMARY

Lot: 7122
Model: 39-3611 A The Beechfield
Project/Phase: Country Lane / 7

GRANITE

Invoice	Qty.	Description
1745 714,395 03Apr25 **	1.0	KITCHEN - CABINETRY-CLASSIC PLUS-OPT. BUILT-INS + 8B INCLUDING SOFT-CLOSE TANDEMBOX POTS AND PANS (2) DRAWERS (WIDTH MIN. 60CM/MAX. 90CM) (SIZE SUBJECT TO FLOOR PLAN)-UPG SKETCH # 3 SEE APPLIANCE SPECS DRYWAL-Notify; FRAMING-Modify Bulkhead; GRANITE-delete partial countertop due to Built-in; PAINTING-
1745 389,826 03Apr25 **	3.0	- PLUMBING - AMERICAN STANDARD - SINK OPTIONS - UNDERMOUNT SINK - OVALYN MODEL 0496 221 020” (19 ” INCH X 16 ” INCH) - 2X SHARED 1X ENS.2 BATHROOMS SEE SPEC CABINETRY-upgraded vanity sink; GRANITE-cutout to accommodate undermount sinks
1745 389,827 03Apr25 **	2.0	MASTER ENSUITE - PLUMBING - AMERICAN STANDARD - SINK OPTIONS - UNDERMOUNT SINK - STUDIO - WHITE - MODEL 0614 000 020 (21 ” INCH X 15 ” INCH) - 2X MASTER BATH SEE SPEC CABINETRY-upgraded vanity sink; GRANITE-cutout to accommodate undermount sinks
1745 389,736 03Apr25	1.0	KITCHEN - GRANITE - GRANITE CUTOUT w/ STRAIGHT EDGE POLISH TO ACCOMMODATE COOK TOP SKETCH # 3 SEE COOKTOP SPECS
1745 389,738 03Apr25	5.0	THROUGHOUT - GRANITE - GRANITE CUTOUT WITH STRAIGHT EDGE POLISH TO ACCOMMODATE UNDER MOUNT VANITY SINK 2X MASTER, 2X SHARED 1X ENS.2 BATHROOMS
1745 712,315 03Apr25	1.0	- GRANITE - MAIN BATH - GROUP 1 - UPG CABINETRY-delete std countertop; GRANITE-see upgraded single hole faucet and undermount sink
1745 389,866 03Apr25 **	1.0	KITCHEN - PLUMBING - KITCHEN SINK UPGRADE - BLANCO QUATRUS U 1 SUPER SINGLE 401248 (MIN CABINET 36 IN) SEE SPEC CABINETRY-upgraded kitchen sink; GRANITE-upgraded kitchen sink
1745 712,331 03Apr25	1.0	- GRANITE - ENSUITE BED 2 - GROUP 1 - UPG CABINETRY-delete std countertop; GRANITE-see upgraded single hole faucet and undermount sink
1745 712,323 03Apr25	1.0	- GRANITE - PRINCIPAL ENSUITE - GROUP 1 - UPG CABINETRY-delete std countertop; GRANITE-see upgraded single hole faucet and undermount sink
1745 712,313 03Apr25	1.0	KITCHEN - GRANITE - KITCHEN - GROUP 6 WITH 1 1/2 IN MITER EDGE - UPG

HARDWOOD

Invoice	Qty.	Description
1745 714,131 03Apr25	1.0	- HARDWOOD - KITCHEN/BRK - 5 IN VINTAGE SCULPTED NSS RED OAK (CHARACTER GRADE) UVF OIL OR PEARL - UPG CABINETRY-Raise Cabinet; CERAMICS-Delete Std Ceramics
1745 714,132 03Apr25	1.0	- HARDWOOD - SERVERY - 5 IN VINTAGE SCULPTED NSS RED OAK (CHARACTER GRADE) UVF OIL OR PEARL - UPG CABINETRY-Raise Cabinet; CERAMICS-Delete Std Ceramics; INTERIOR STAIRS-Notify (Servery)



CONSTRUCTION SUMMARY

Lot: 7122
Model: 39-3611 A The Beechfield
Project/Phase: Country Lane / 7

HEATING / AIR CONDITIONING

Invoice	Qty.	Description
1745 392,130 03Apr25 **	1.0	GREAT ROOM - FIREPLACE AND MANTLE - UPGRADE TO NF-16 WHITE PAINT GRADE MANTLE (NO MARBLE SURROUND UNLESS ON FLAT WALL) SEE SPEC DRYWALL-notify; ELECTRICAL-notify; FRAMING-notify; HEATING/AIR CONDITIONING-notify; INTERIOR TRIM-notify; PAINTING-notify
1745 389,800 03Apr25	1.0	KITCHEN - HEATING/AIR - ROUGH-IN GAS LINE FOR GAS STOVE AT MAIN FLOOR (SEE SPECS) (HOOK-UP NOT INCLUDED) LEAVE STANDARD 120 VOLT ELECTRICAL OUTLET ON A SEPARATE CIRCUIT. * SPECIFY IF STANDARD 220V WILL STAY OR BE RELOCATED STANDARD 220V RELOCATED TO B/I MICRO/STOVE LOCATION SKETCH # 3 SEE APPLIANCE SPECS ELECTRICAL-Notify
1745 714,386 03Apr25 **	1.0	KITCHEN - APPLIANCES - CYCLONE 36 INCH WALL MOUNT CHIMNEY HOOD SS - SCB51436 CHANGED TO AVW 36" WALL MOUNTED CHIMNEY HOODFAN - SEE SPECS CABINETRY-delete stove uppers; ELECTRICAL-Notify; HEATING/AIR CONDITIONING-Duct Size remains 6 i

INTERIOR STAIRS

Invoice	Qty.	Description
1745 714,132 03Apr25 **	1.0	- HARDWOOD - SERVERY - 5 IN VINTAGE SCULPTED NSS RED OAK (CHARACTER GRADE) UVF OIL OR PEARL - UPG CABINETRY-Raise Cabinet; CERAMICS-Delete Std Ceramics; INTERIOR STAIRS-Notify (Servery)

INTERIOR TRIM AND DOORS

Invoice	Qty.	Description
1745 392,130 03Apr25 **	1.0	GREAT ROOM - FIREPLACE AND MANTLE - UPGRADE TO NF-16 WHITE PAINT GRADE MANTLE (NO MARBLE SURROUND UNLESS ON FLAT WALL) SEE SPEC DRYWALL-notify; ELECTRICAL-notify; FRAMING-notify; HEATING/AIR CONDITIONING-notify; INTERIOR TRIM-notify; PAINTING-notify

PAINTING

Invoice	Qty.	Description
1745 392,130 03Apr25 **	1.0	GREAT ROOM - FIREPLACE AND MANTLE - UPGRADE TO NF-16 WHITE PAINT GRADE MANTLE (NO MARBLE SURROUND UNLESS ON FLAT WALL) SEE SPEC DRYWALL-notify; ELECTRICAL-notify; FRAMING-notify; HEATING/AIR CONDITIONING-notify; INTERIOR TRIM-notify; PAINTING-notify
1745 714,395 03Apr25 **	1.0	KITCHEN - CABINETRY-CLASSIC PLUS-OPT. BUILT-INS + 8B INCLUDING SOFT-CLOSE TANDEMBOX POTS AND PANS (2) DRAWERS (WIDTH MIN. 60CM/MAX. 90CM) (SIZE SUBJECT TO FLOOR PLAN)-UPG SKETCH # 3 SEE APPLIANCE SPECS DRYWAL-Notify; FRAMING-Modify Bulkhead; GRANITE-delete partial countertop due to Built-in; PAINTING-



CONSTRUCTION SUMMARY

Lot: 7122
Model: 39-3611 A The Beechfield
Project/Phase: Country Lane / 7

PLUMBING

Invoice	Qty.	Description
1745 389,826 03Apr25	3.0	- PLUMBING - AMERICAN STANDARD - SINK OPTIONS - UNDERMOUNT SINK - OVALYN MODEL 0496 221 020” (19 ” INCH X 16 ” INCH) - 2X SHARED 1X ENS.2 BATHROOMS SEE SPEC CABINETRY-upgraded vanity sink; GRANITE-cutout to accommodate undermount sinks
1745 389,827 03Apr25	2.0	MASTER ENSUITE - PLUMBING - AMERICAN STANDARD - SINK OPTIONS - UNDERMOUNT SINK - STUDIO - WHITE - MODEL 0614 000 020 (21 ” INCH X 15 ” INCH) - 2X MASTER BATH SEE SPEC CABINETRY-upgraded vanity sink; GRANITE-cutout to accommodate undermount sinks
1745 389,866 03Apr25	1.0	KITCHEN - PLUMBING - KITCHEN SINK UPGRADE - BLANCO QUATRUS U 1 SUPER SINGLE 401248 (MIN CABINET 36 IN) SEE SPEC CABINETRY-upgraded kitchen sink; GRANITE-upgraded kitchen sink

Sketch #1



39-3611 ELEV. A

The Beechfield

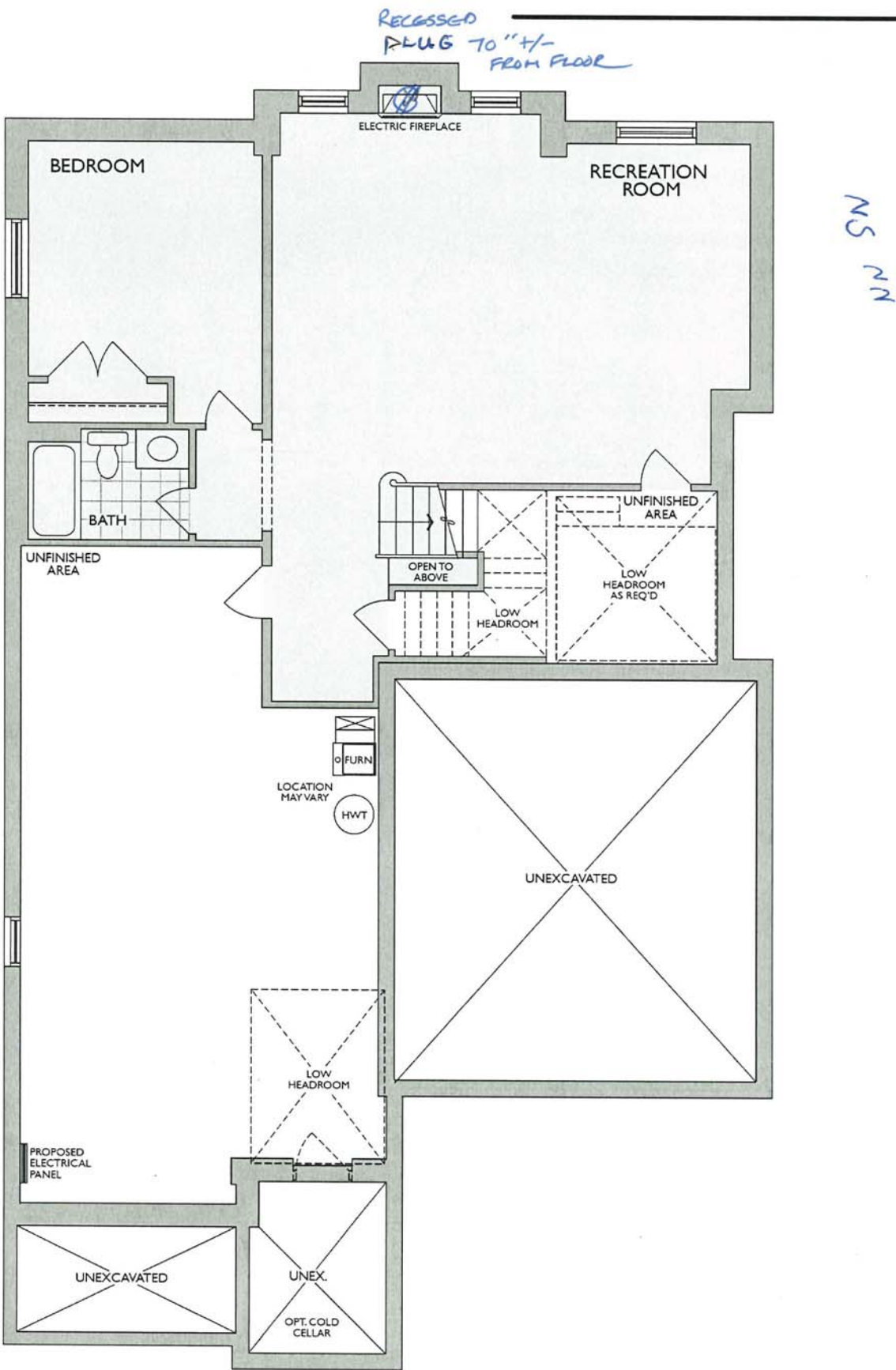

FINISHED LOWER LEVEL
ELEV. A

* Floor plan may vary due to grading conditions.

39-3611 ELEV. A
Lot 7170

Sketch #2

TRADITIONS
OF COUNTRY LANE

The Beechfield

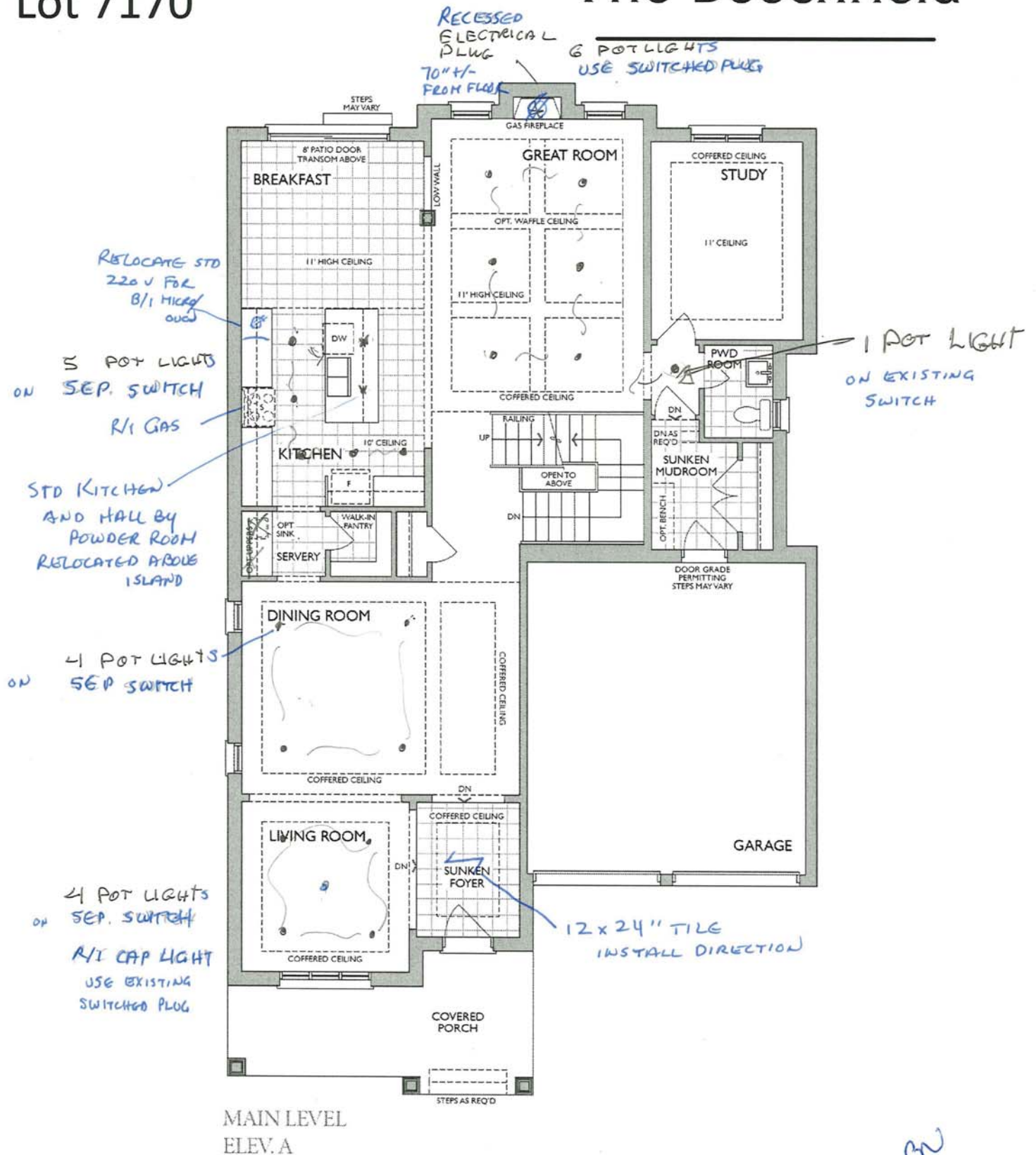

22 52

Project: Country Lane
Unit: 7122, Phase: 7
Model: 39-3611 A The Beechfield

Sketch # 3

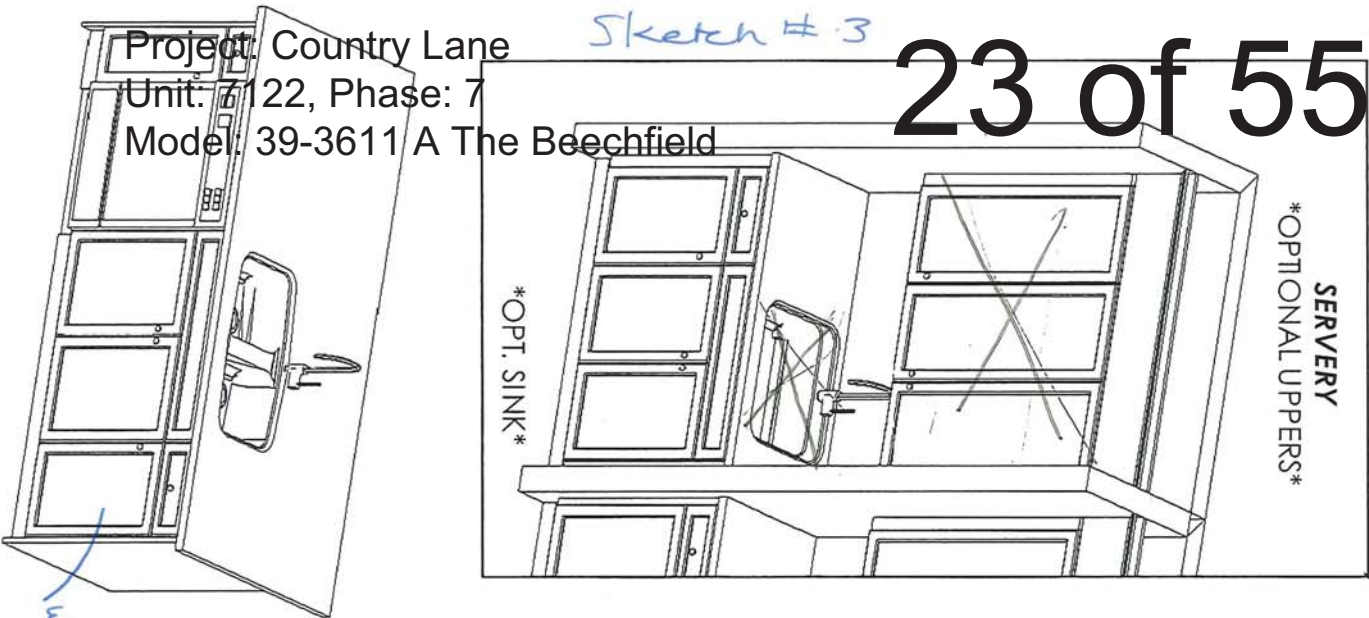

WASTE/RECYCLE
CABINET

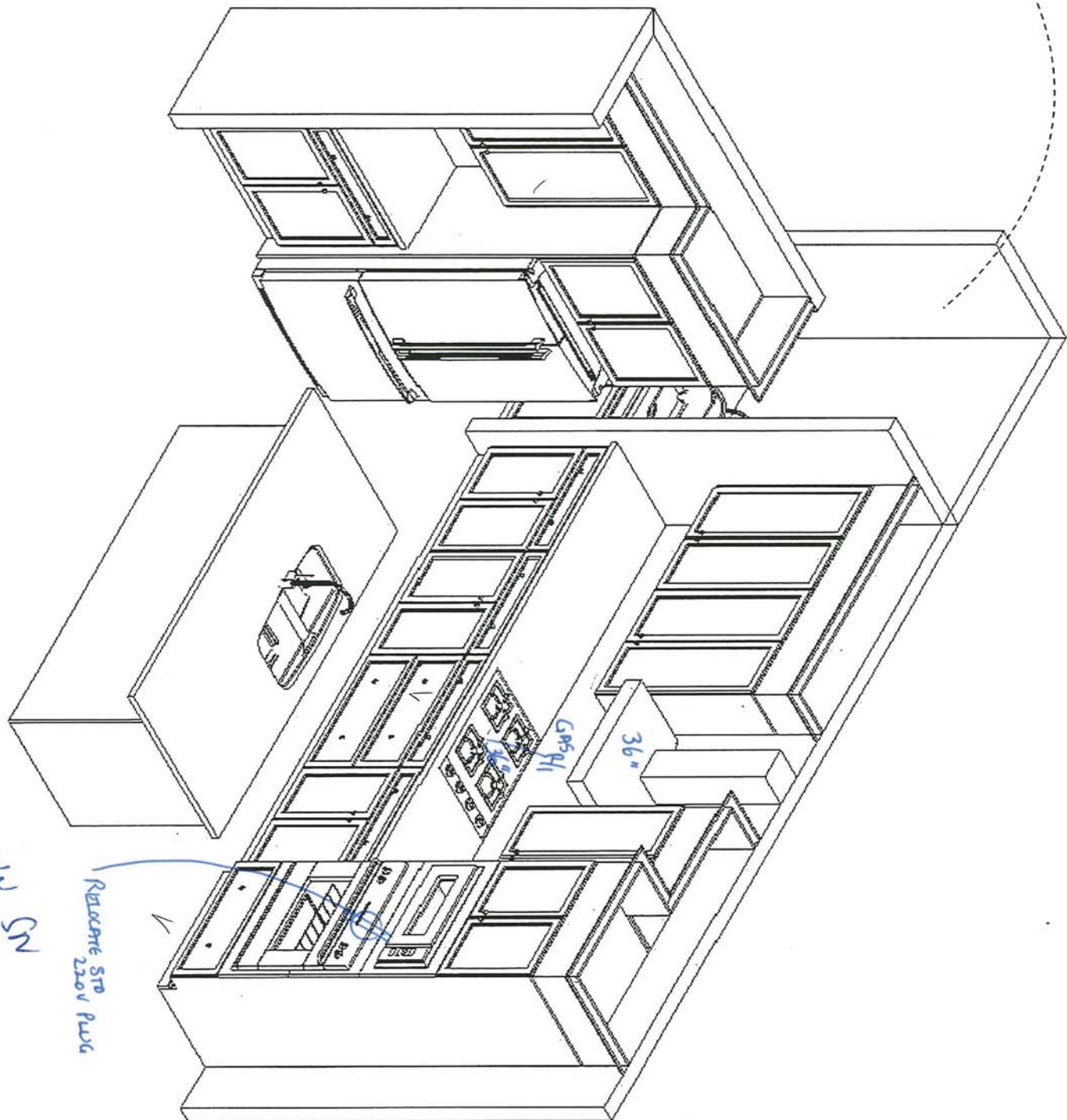

Refrigerate STD
220V Plug

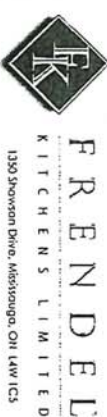

Heathwood Homes
Country Lane, Whitby

Model:
39-3611 (4505)
The Classic Series

- Standard Features:
- Tandem Box Soft Close Drawers
 - Blumotion Hinges for Doors
 - Crown Moulding & fascia
 - Top Drawer Construction
 - Deep Fridge Upper w/Deep Panel
 - Tall upper Cabinets

Drawn By: Sepideh B
Date: July 12, 2023
Revision:
Scale: Not To Scale

Approved By Builder:

Date:

This sketch is for DESIGN PURPOSES ONLY – It is not meant to be an exact rendition.

Sketch # 4



39-3611 ELEV. A

The Beechfield

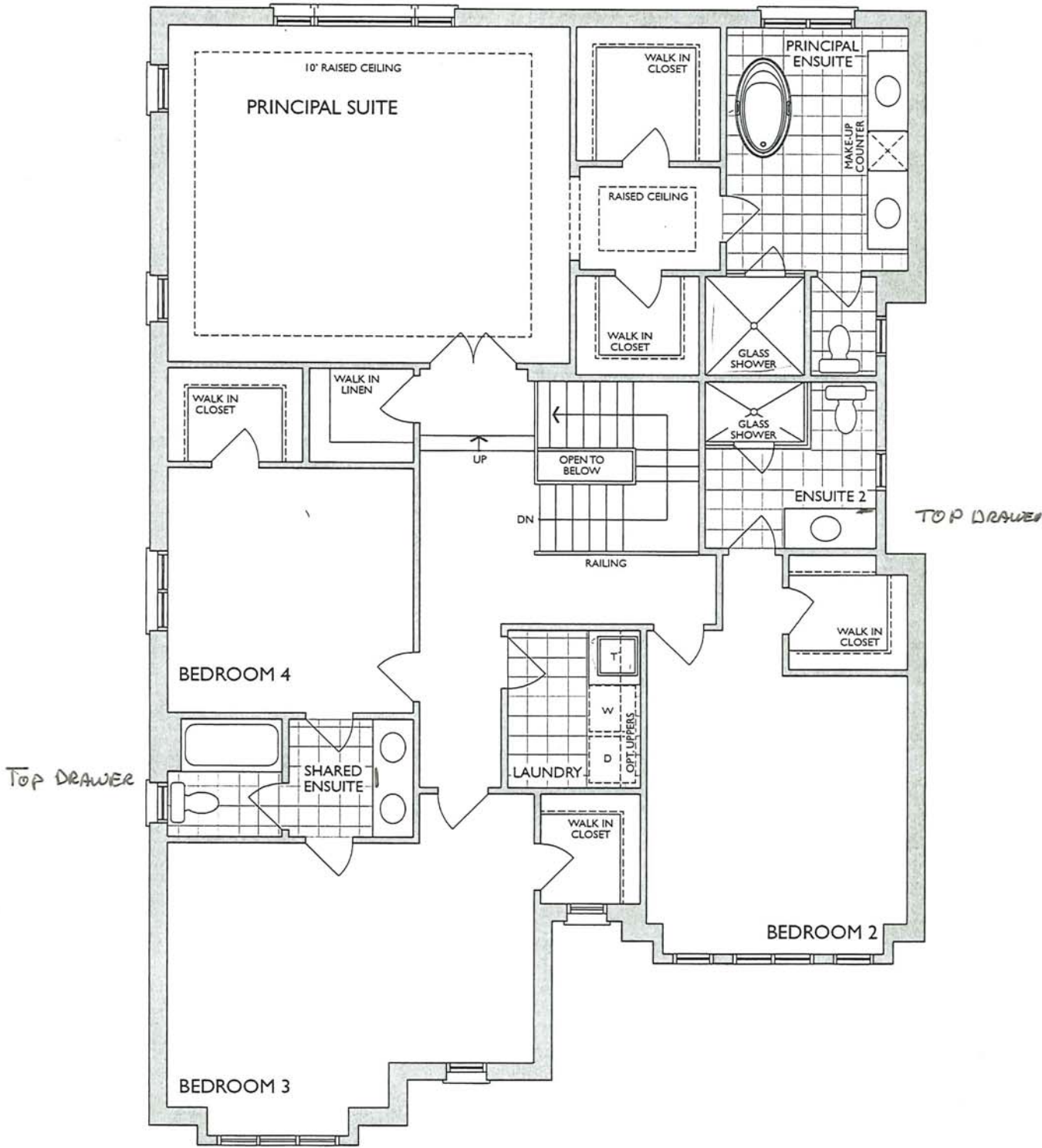

SECOND LEVEL
ELEV. A

NN SW

* Floor plan may vary due to grading conditions.

MASTER ENSUITE
2nd FLR

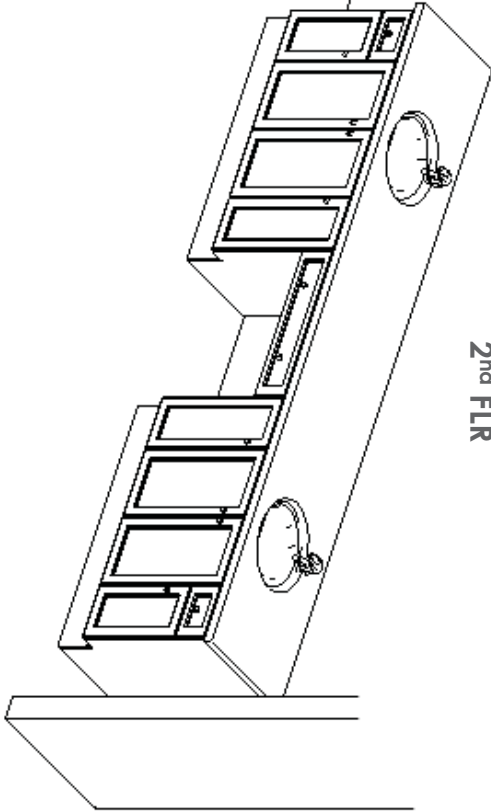

MAIN/SHARED BATH
2nd FLR

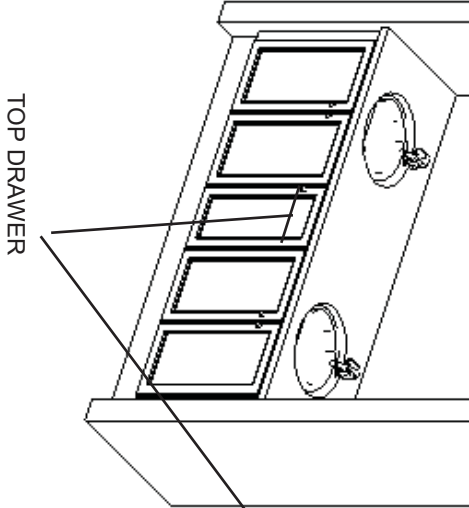

ENSUITE 2
2nd FLR

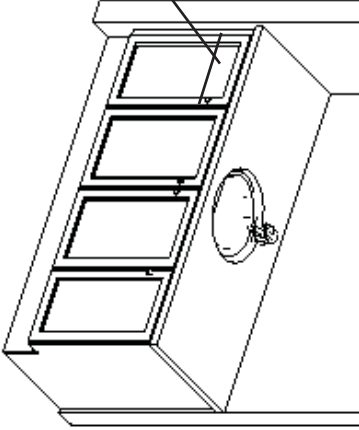

LAUNDRY
2nd FLR

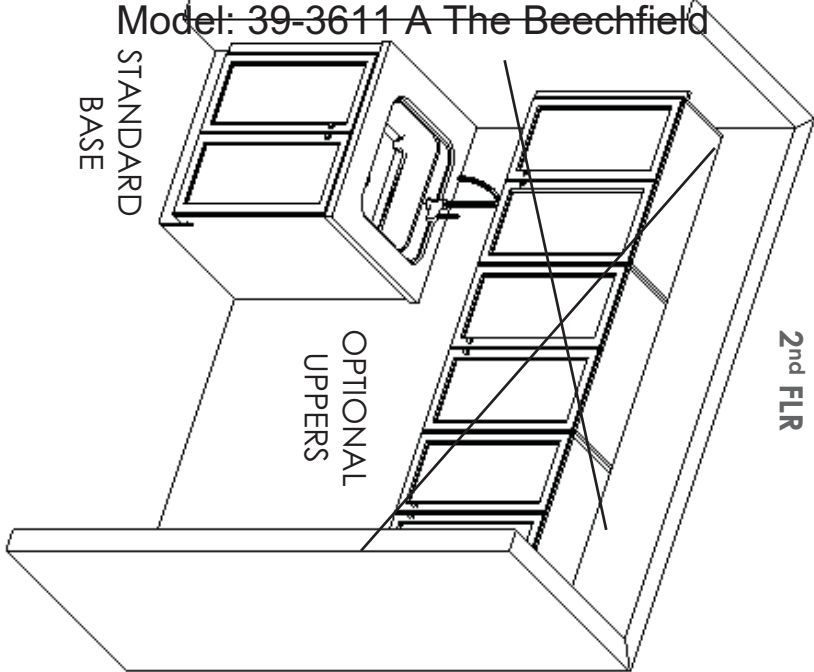

BASEMENT
BATH

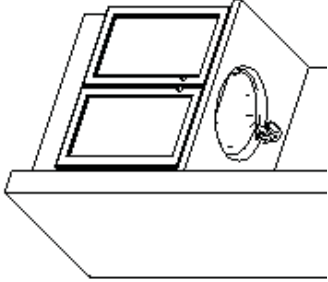

Project: Country Lane
Unit: 7122, Phase: 7
Model: 39-3611 A The Beechfield

SKETCH #5

STANDARD
BASE

OPTIONAL
UPPERS

This sketch is for DESIGN PURPOSES ONLY – It is not meant to be an exact rendition.



F R E N D E L
K I T C H E N S L I M I T E D
1350 Shawson Drive, Mississauga, ON L4W 1G5

HEATHWOOD HOMES
COUNTRY LANE, WHITBY
TRADITIONS
MODEL: 39-3611 (4505)
THE CLASSIC SERIES

Standard Features:

- Blum Metabox Drawers
- Blum Clip On Hinges
- Top Drawer in Master Ensuite

Drawn By: Sepideh B
Date: July 25, 2024
Revision:
Scale: Not To Scale

Approved By Builder:

Date:

NOTE: **TOP DRAWER** (AND OR SOFT CLOSE OF THE DRAWER) IS **EXTRA CHARGE** AND CAN ONLY BE ADDED IF THE ENTIRE KITCHEN HAS TOP DRAWER THROUGHOUT

TOP DRAWER

18" Wide cabinet : 15B-45cm wide pull-out door base cabinet waste/recycle centre with soft-close ([2] 35L bins per unit) (available only with 45cm wide cabinet)

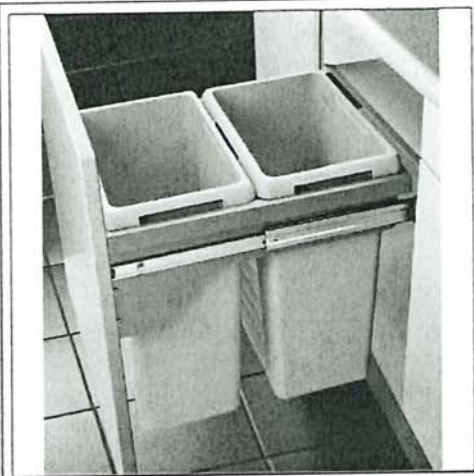

Euro-Cargo Recycling Center

Make your life easier with the Euro-Cargo sliding waste bin. Full-extension slides give you complete access to your bins. The integrated lid remains fixed inside your cabinet, and once the system is closed, the lid covers the bins to prevent odors from escaping.

Product # 3614100

[View list](#)

Total Capacity 76 l

76 l 93 l

Interior Dimensions Required - Width 412 to 418 mm

412 to 418 mm 462 to 468 mm 562 to 568 mm

Bin Quantity 2

2 4

Bin Capacity 2 x 38 liters

2 x 38 L + 2 x 8.5 L 2 x 38 liters

24" wide cabinet : 16B-60cm wide pull-out door base cabinet waste/recycle centre with soft-close ([4] bins total, including [2] 35L) (available only with 60cm or 24" wide cabinet)

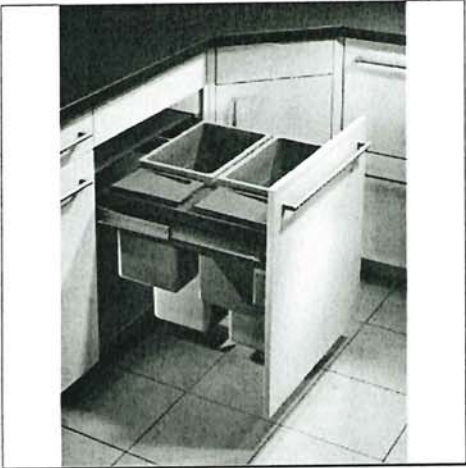

Euro-Cargo Recycling Center

Make your life easier with the Euro-Cargo sliding waste bin. Full-extension slides give you complete access to your bins. The integrated lid remains fixed inside your cabinet, and once the system is closed, the lid covers the bins to prevent odors from escaping.

Product # 361460100

[View list](#)

Total Capacity 93 l

76 l 93 l

Interior Dimensions Required - Width 562 to 568 mm

412 to 418 mm 462 to 468 mm 562 to 568 mm

Bin Quantity 4

2 4

Bin Capacity 2 x 38 L + 2 x 8.5 L

2 x 38 L + 2 x 8.5 L 2 x 38 liters



NEAS NF16 Mantel

GREAT ROOM
Flat Wall
white Paint Grade

NN SN



LOWGR LEVEL REC ROOM
ELECTRIC FIREPLACE

NFAS NF17 Mantel

FlatWall

NW SN

BLANCO

Sink Specifications

Colour	SKU
brushed finish	401248

Design and planning tips

- Min cabinet size: 36 in (915 mm)
- Bowl Depth: 9 in (230.0 mm)

Specifications:
Installation clips, Sink template, Installation instructions, 3 ½" (90 mm) stainless steel strainer

Depending on cabinet construction, a different cabinet size may be required. Consult the cabinet manufacturer.
Codes/Standards: ASME A112.19.3-2017/ CSA B45.4-17

Optional Accessories

Elevated Grid	406346
Workstation	406344
CapFlow Strainer Cover	517666
Ash Cutting Board	406345
Sink Grid	402125

QUATRUS U 1 SUPER SINGLE
Stainless steel brushed finish

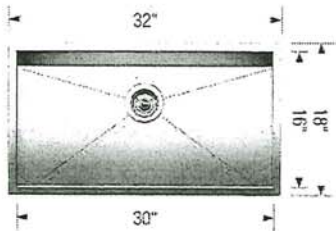

Warranty
Limited lifetime warranty on all sinks and faucets. One-year warranty on all accessories and soap dispensers.

Code/Standards Compliance
BLANCO sinks and faucets are third-party tested and certified to CSA, cUPC, ANSI/ASME, IAPMO and NSF standards and listed by applicable certification bodies. For more information on individual product listings, contact our office or listing organization.

 Need support? Learn more by watching our sink & faucet How-to videos:
<https://www.blanco.com/ca-en/support/how-to-videos/how-to-videos-for-sinks/>

	BLANCO Canada Inc 100 Corporation Drive Brampton ON L6S 6B5	Tel & Fax Tel: 905-494-2400 Toll free: 1-877-425-2626 Fax: 905-494-2425 Toll free: 1-877-825-2626
---	---	---

While BLANCO strives to provide accurate information, all images and dimensions in this document are intended for reference only and are subject to change at any time without notice. This document is not intended for use as an installation guide. For technical installation details, refer to installation instructions provided with the product. BLANCO assumes no responsibility for the use of superseded or voided specifications.

NN SN

MOEN®

Specifications

FAUCET DESCRIPTION

- Reflex™ pulldown system offers smooth operation, easy movement and secure docking
- Power Clean™ spray technology
- Metal construction with various finishes identified by suffix
- Quick connect installation
- Pulldown spray with 68" braided hose
- Flexible supply lines with 3/8" compression fittings
- High arc spout provides height and reach to fill or clean large pots while pulldown wand provides the maneuverability for cleaning or rinsing
- 360° rotating spout
- Faucet designed for handle to be mounted on right side only

OPERATION

- Lever style handle
- Temperature controlled by 100° arc of handle travel
- Operates with less than 5 lbs. of force
- Operates in stream or spray mode in the pullout or retracted position

FLOW

- Flow is limited to 1.5 gpm (5.7 L/min) max at 60 psi

CARTRIDGE

- 1255™ Duralast™ cartridge

STANDARDS

- Third party certified to IAPMO Green, ASME A112.18.1/CSA B125.1 and all applicable requirements therein including NSF 61/9G & 372
- Meets CalGreen and Georgia SB370 requirements
- Complies with California Proposition 65 and with the Federal Safe Drinking Water Act
- The backflow protection system in the device consists of two independently operating check valves, a primary and a secondary which prevent backflow

- ADA  for lever handle

WARRANTY

- Lifetime limited warranty against leaks, drips and finish defects to the original homeowner
 - 10 year limited warranty when used in a multifamily installation
 - 5 year limited warranty when used in a commercial installation
- Visit www.moen.com/support for complete details and limitations

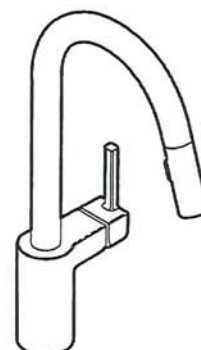

ALIGN™
Single Handle High Arc
Pulldown Kitchen Faucet

Models: 7565 series

NOTE: THIS FAUCET IS DESIGNED TO BE INSTALLED
THROUGH 1 HOLE, 1-1/2" (38mm) MIN. DIA.
(OPTIONAL 3-HOLE ESCUTCHEON 141002 AVAILABLE)

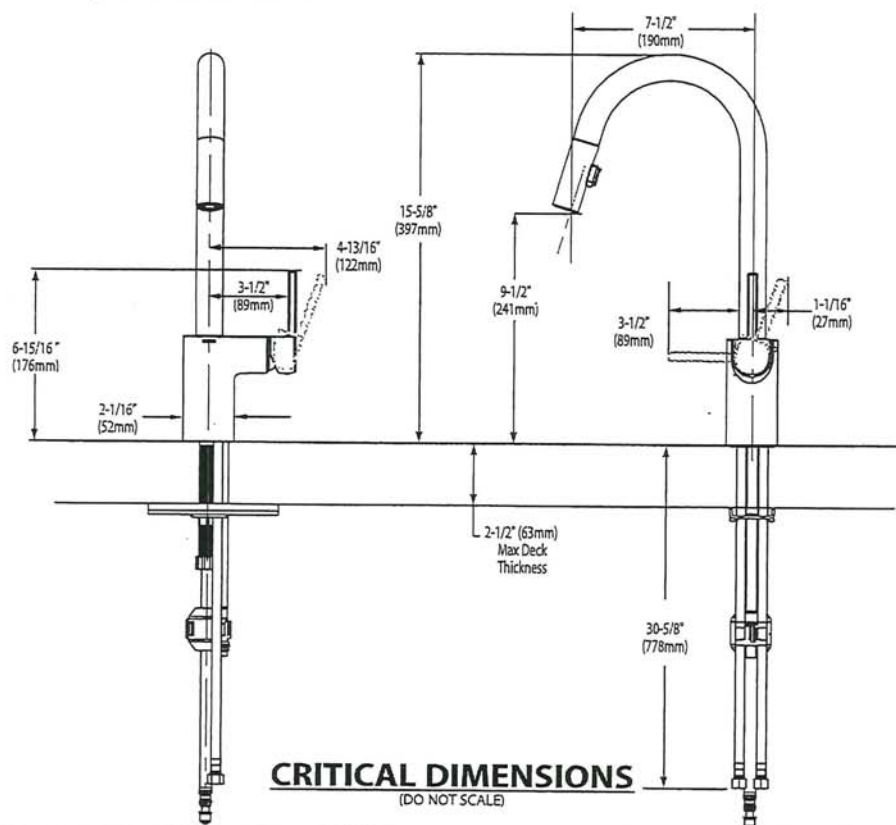

NN SN



BARRIER FREE (ABOVE COUNTER OR DROP-IN ONLY)

BOULEVARD®
PEDESTAL SINK
VITREOUS CHINA

BOULEVARD® PEDESTAL SINK

- STD ☒ ~~0641.800~~ Faucet holes on 8" (203mm) centers (Illustrated)
☒ **0641.400** Faucet holes on 4" (102mm) centers
☒ ~~0641.100~~ Center hole only
- Classic styled rectangular pedestal lavatory
 - Vitreous china
 - Rear overflow
 - Supplied with mounting kit
 - Right Height® for greater comfort during use
 - Faucet ledge with large deck area (faucet not included)
 - **Design coordinates with Boulevard® Toilet**
 - Basin has flat bottom to also allow use as an **above counter** sink or a **drop-in** sink (with u-shaped cut out)

Nominal Dimensions:

24" x 19" x 35-1/2"
(610 x 483 x 902mm)

- ☐ **0641.008** Pedestal top-8" (203mm) centers
- ☐ **0641.004** Pedestal top-4" (102mm) centers
- ☐ **0641.001** Pedestal top-center hole only
- ☐ **0010.000** Pedestal only

Bowl sizes:

17" (432mm) wide,
12-1/2" (318mm) front to back,
5" (127mm) deep

Compliance Certifications -

Meets or Exceeds the Following Specifications:

- ASME A112.19.2 - 2008/CSA B45.1-08

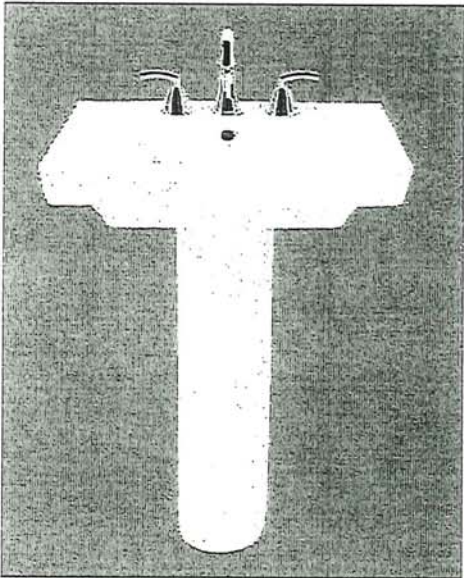

SEE REVERSE FOR ROUGHING-IN DIMENSIONS

To Be Specified:

- ☐ Color: ☐ White ☐ Linen
- ☐ Faucet Finish:
- ☐ Supplies:
- ☐ 1-1/4" Trap:
- ☐ Nipple:

* See faucet section for additional models available

NN SN

American
Standard

BOULEVARD®
PEDESTAL SINK
VITREOUS CHINA

 BARRIER FREE (ABOVE COUNTER OR DROP-IN ONLY)

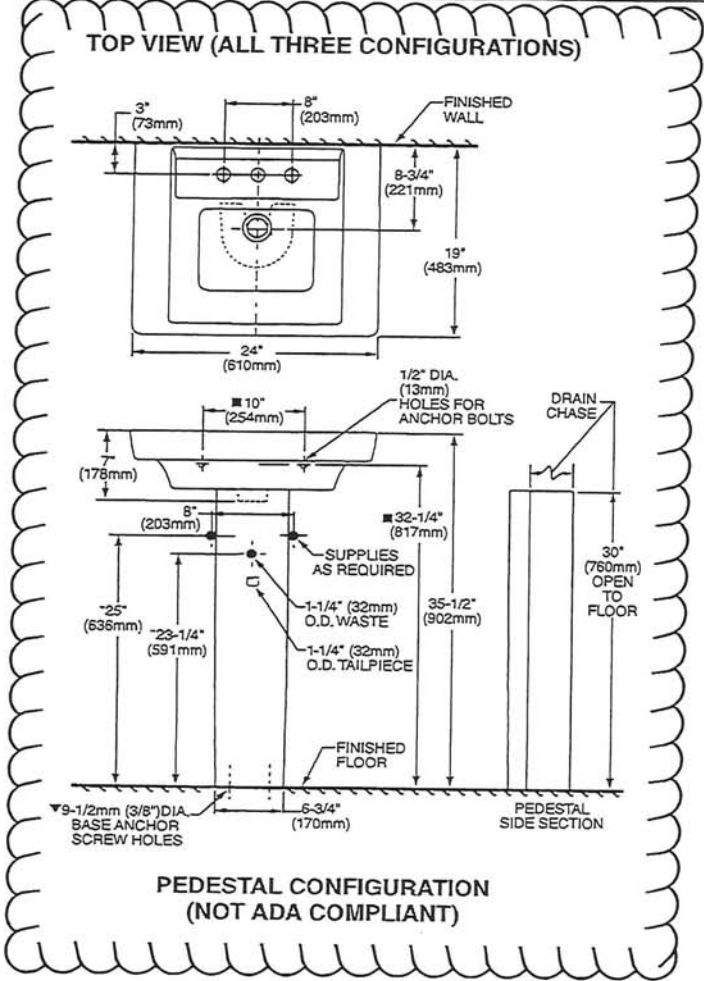

ABOVE COUNTER CONFIGURATION

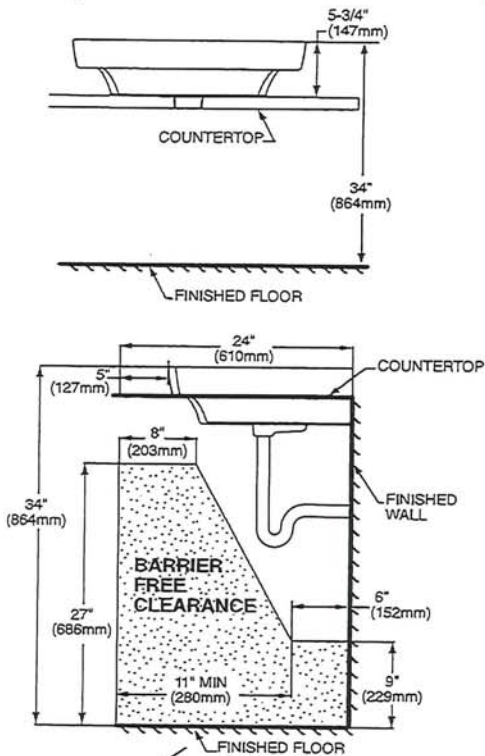

 ABOVE COUNTER AND DROP-IN SINK CONFIGURATIONS
MEET THE AMERICANS WITH DISABILITIES ACT GUIDELINES
AND ANSI A117.1 ACCESSIBLE AND USABLE
BUILDINGS AND FACILITIES - CHECK LOCAL CODES.
Top of sink installed at 34" (864mm) height from finished floor.
Sink installed 5" (127mm) minimum from front edge of countertop.
Provide 27" (686mm) knee clearance area.

NOTES:
* DIMENSIONS SHOWN FOR LOCATION OF SUPPLIES AND "P" TRAPS ARE SUGGESTED.
▼ PEDESTAL ANCHORING SCREWS NOT INCLUDED.
■ SUITABLE FOR REINFORCEMENT ONLY. ACTUAL DIMENSIONS MUST BE TAKEN FROM FIXTURE.
FITTING NOT INCLUDED AND MUST BE ORDERED SEPARATELY.
PROVIDE SUITABLE REINFORCEMENT FOR ALL WALL SUPPORTS.
INSTALLATION INSTRUCTIONS SUPPLIED WITH LAVATORY.

IMPORTANT: Dimensions of fixtures are nominal and may vary within the range of tolerance established by ANSI Standard A112.19.2
These measurements are subject to change or cancellation. No responsibility is assumed for use of superseded or voided pages.

NN SN

PRINCIPAL ENSUITE X 2

American Standard

Style That Works Better

BARRIER FREE

STUDIO™
UNDERCOUNTER SINK
VITREOUS CHINA

STUDIO™ UNDERCOUNTER SINK

- Rectangular undercounter mount sink
- Made from vitreous china
- Front overflow
- Supplied with mounting kit (047194-0070A) and template

- ☐ 0614.000 Unglazed Rim
540 x 387mm
(21-1/4" x 15-1/4")
- ☐ 0614.300 Glazed underside

Bowl size:
464mm (18-1/4") wide
308mm (12-1/8") front to back
171mm (6-3/4") deep

- ☐ 0618.000 Unglazed Rim
600 x 422mm
(23-5/8" x 16-5/8")
- ☐ 0618.300 Glazed underside

Bowl size:
537mm (21-1/8") wide
356mm (14") front to back
152mm (6") deep

Compliance Certifications -
Meets or Exceeds the
Following Specifications:

- ASME A112.19.2M for Vitreous China Fixtures
- CAN/CSA B45 series

To Be Specified:

- ☐ Color: ☐ White ☐ Bone
☐ Linen ☐ Black
- ☐ Faucet*:
- ☐ Faucet Finish:
- ☐ Supplies:
- ☐ 1-1/4" Trap:

* See faucet section for additional models available

MEETS THE AMERICANS WITH DISABILITIES ACT GUIDELINES
AND ANSI A117.1 ACCESSIBLE AND USABLE
BUILDINGS AND FACILITIES - CHECK LOCAL CODES.

- Countertop 864mm (34") from finished floor. Lavatory installed 102mm (4") from front edge of countertop. Countertop thickness to be 25mm (1") maximum.

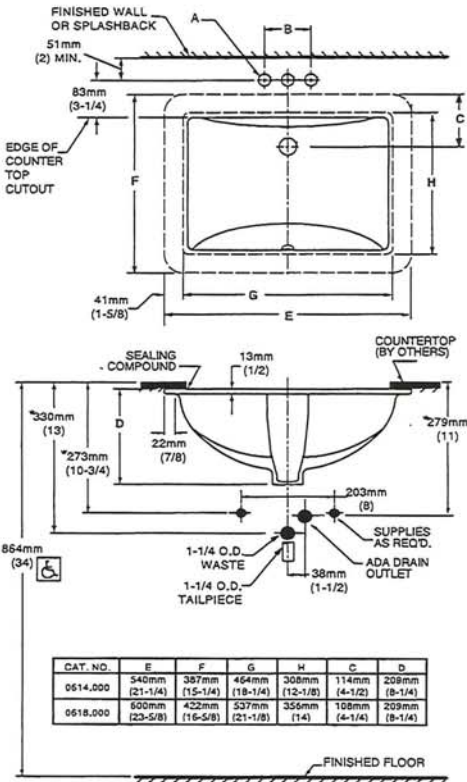
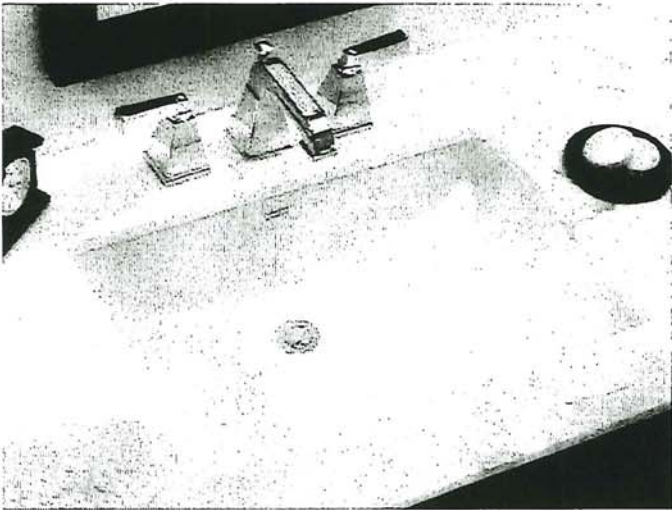

FITTING	A	B
CENTER-SET	1-1/16 (27mm)	4 (102mm)
SPREAD	1-1/4 (32mm)	8 (203mm)

DETAIL OF MOUNTING CLIP
(KIT No. 047194-0070A)

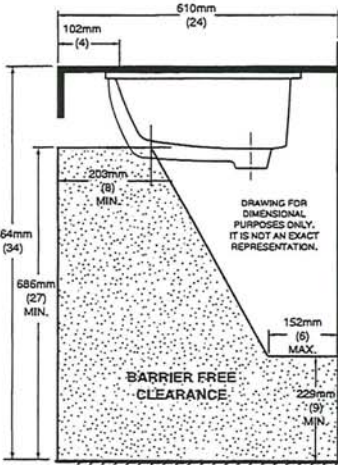
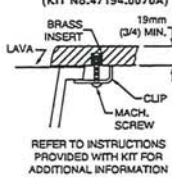

NOTES:
WE RECOMMEND USING BASIN AS A TEMPLATE TO DETERMINE PROPER CONTOUR. CUT COUNTERTOP 38MM (1-1/2") INSIDE BASIN CONTOUR.
* DIMENSIONS SHOWN FOR LOCATION OF SUPPLIED AND "P" TRAP ARE SUGGESTED.
▼ UNDERCOUNTER MOUNTING KIT SUPPLIED WITH SINK.
FITTINGS NOT INCLUDED WITH FIXTURE AND MUST BE ORDERED SEPARATELY.
SEALING COMPOUND SUPPLIED BY OTHERS.

IMPORTANT: Dimensions of fixtures are nominal and may vary within the range of tolerances established by ANSI Standard A112.19.2. These measurements are subject to change or cancellation. No responsibility is assumed for use of superseded or voided pages.

NN SN

ENSUITE 2 X 1
SHARED X 1

American Standard

Style That Works Better

 BARRIER FREE

OVALYN™ UNDERCOUNTER SINK

- Classic oval undermount sink
- Made from vitreous china
- Front overflow
- Supplied with mounting kit (047194-0070A) and template

☐ **0495.221 Unglazed rim**

435 x 359mm
(17-1/8" x 14-1/8")

☐ **0495.300 Glazed underside**

Bowl size:

382mm (15-1/16") wide
306mm (12-1/16") front to back
140mm (5-1/2") deep

☐ **0496.221 Unglazed rim**

489 x 413mm
(19-1/4" x 16-1/4")

☐ **0496.300 Glazed underside**

Bowl size:

432mm (17") wide
356mm (14") front to back
140mm (5-1/2") deep

☐ **0497.221 Unglazed rim**

546 x 441mm
(21-1/2" x 17-3/8")

☐ **0497.300 Glazed underside**

Bowl size:

483mm (19") wide
391mm (15-3/8") front to back
140mm (5-1/2") deep

Compliance Certifications -

Meets or Exceeds the Following Specifications:

- ASME A112.19.2M for Vitreous China Fixtures
- CAN/CSA B45 series

To Be Specified:

- ☐ Color: ☐ White ☐ Bone ☐ Linen
☐ Silver ☐ Fawn Beige ☐ Black
- ☐ Faucet*:
☐ Faucet Finish:
☐ Supplies:
☐ 1-1/4" Trap:

* See faucet section for additional models available

**OVALYN™
UNDERCOUNTER SINK
VITREOUS CHINA**



SEE REVERSE FOR ROUGHING-IN DIMENSIONS

NN SN

American Standard
Style That Works Better

BARRIER FREE

OVALYN™
UNDERCOUNTER SINK
VITREOUS CHINA

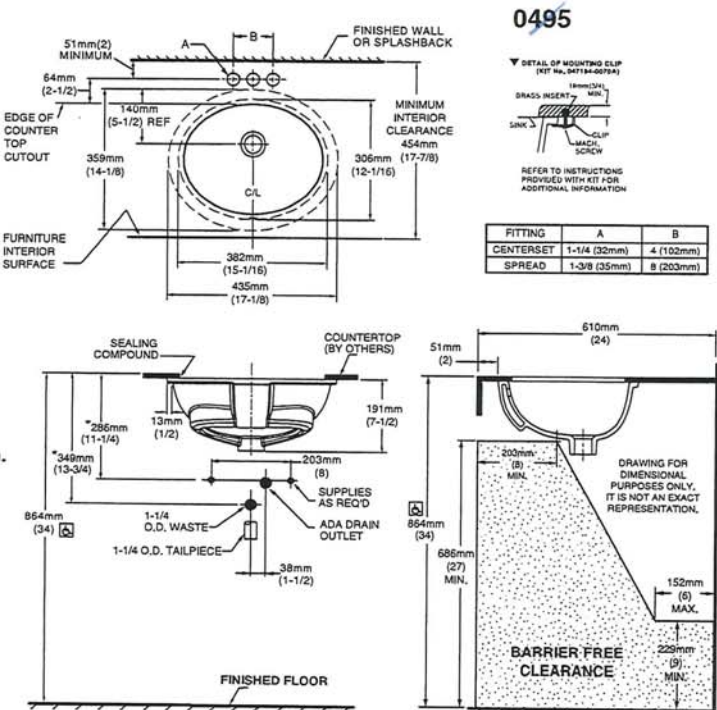
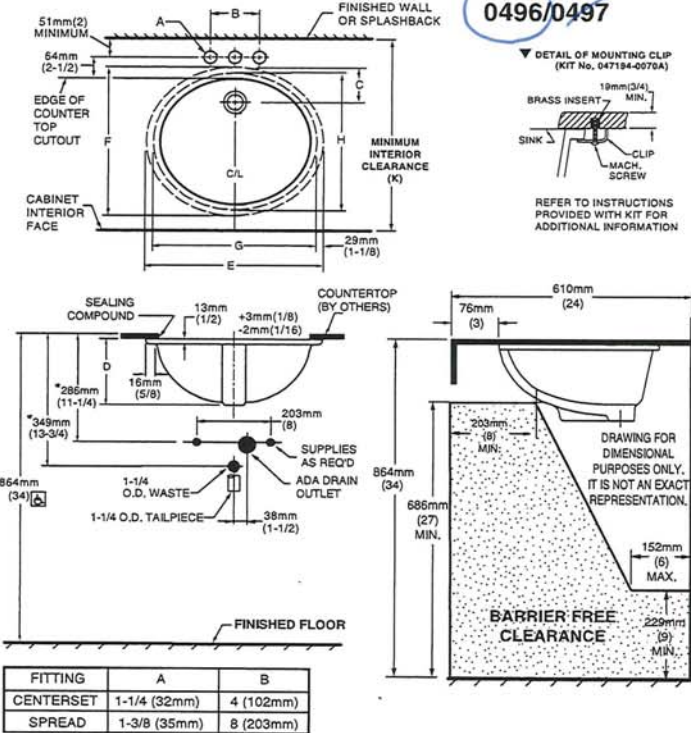

NN SN

American Standard



BARRIER FREE

COLONY™

COUNTERTOP SINK

VITREOUS CHINA

COLONY COUNTERTOP SINK

- Vitreous china
 - Self-rimming
 - Front overflow
 - Supplied with template
 - Faucet deck
- (Faucet shown not included)

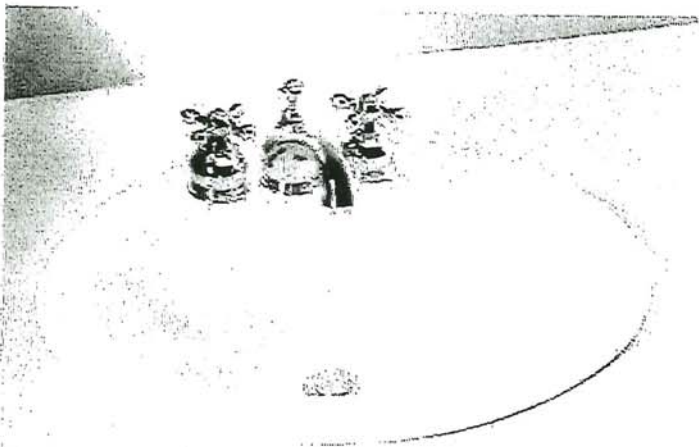

☐ 0346 803

Faucet holes on 203mm (8") centres

☒ 0346 403 (Illustrated)

Faucet holes on 102mm (4") centres

☐ 0346 001

Centre hole only

Nominal Dimensions:
521 x 448mm (20-1/2" x 17-5/8")

Bowl sizes:
422mm (16-5/8") wide, 279mm (11") front to back, 143mm (5-5/8") deep

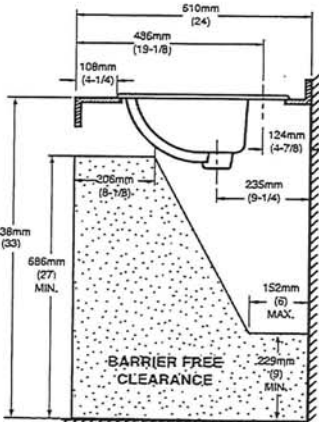
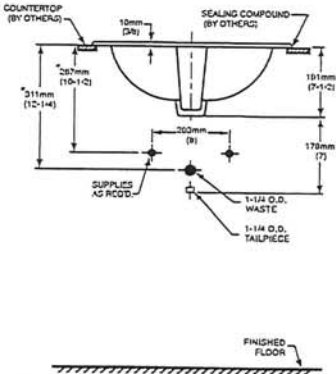
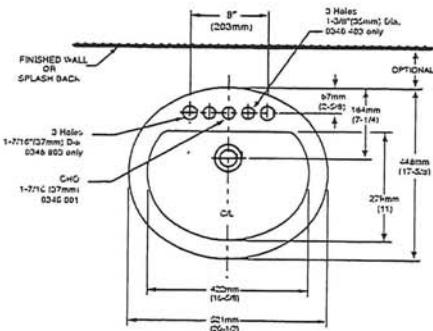

COMPLIANCE CERTIFICATIONS –
Meets or exceeds the following Specifications:
• ASME A112.19.2M for Vitreous China Fixtures.
• CAN/CSA B45 Series.

To Be Specified

- ☐ Colour: ☐ White ☐ Bone ☐ Silver Gray ☐ Linen
- ☐ Faucet*:
- ☐ Faucet Finish:
- ☐ Supplies & Stops:
- ☐ Trap 1-1/4" (32 mm):

NOTES:
* DIMENSIONS SHOWN FOR LOCATION OF SUPPLIES AND "P" TRAP ARE SUGGESTED. FOR COUNTERTOP CUTOUT AND INSTALLATION INSTRUCTIONS USE TEMPLATE SUPPLIED WITH SINK.
FAUCETS NOT INCLUDED AND MUST BE ORDERED SEPARATELY.
IMPORTANT: Dimensions of fixtures are nominal and may vary within the range of tolerances established by ANSI Standard A112.19.2.
These measurements are subject to change or cancellation. No responsibility is assumed for use of superseded or voided pages.

* See faucet section for additional models available

NN SW



DEMI™
Product Specification Sheet

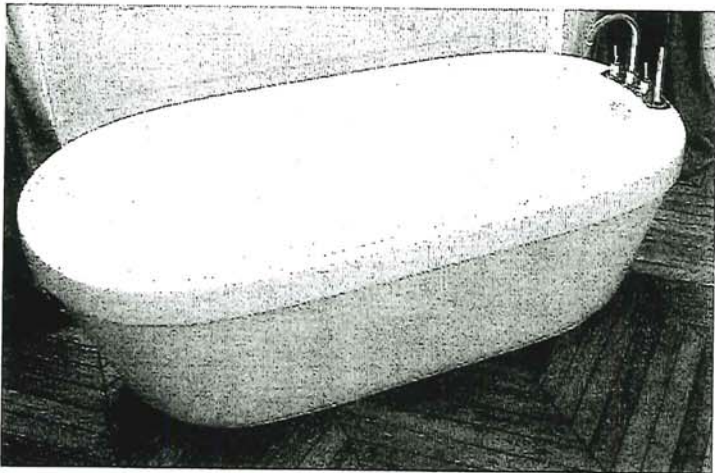

Two Piece Freestanding Collection

CF2007	Two Piece Freestanding Soaker
Size:	60" x 32" x 22" 1524 mm x 813 mm x 559 mm

PRODUCT FEATURES & BENEFITS

- Vacuum formed acrylic reinforced with fiberglass
- Scratch, stain and fade resistant high gloss finish
- Installation friendly two piece design
- Accepts deck mounted faucet
- Includes integral pop up drain and rectangular overflow
- Includes levelling feet

TWO PIECE ASSEMBLY

FRONT VIEW

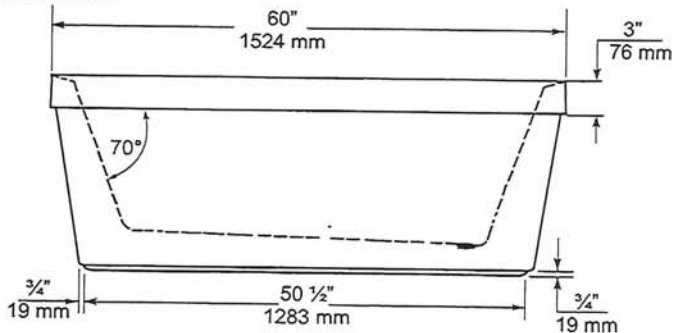

END VIEW

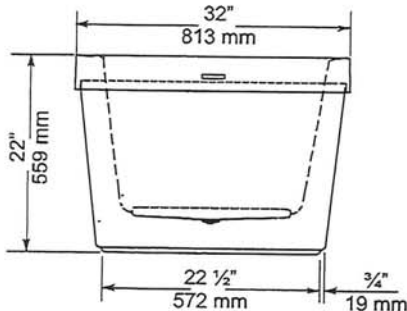

TOP VIEW

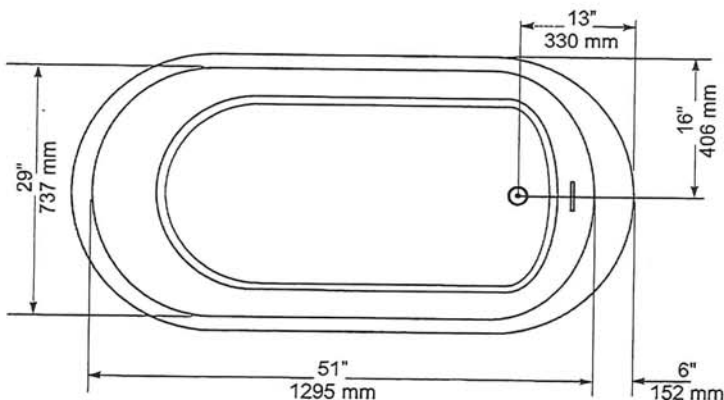

GENERAL SPECIFICATIONS		
Average Weight	90 lb	41 kg
Bathing Well at bottom	43"x 20"	1092 x 508 mm
Capacity Drain to Overflow		195 litres
Water Depth Drain to Overflow	16"	406 mm
Drain Opening (dia.)	2"	51 mm
Overflow Opening	2 1/4"x 1/2"	57 x 13 mm
Drain to Floor Clearance	3 1/4"	83 mm

NOTES: Please confirm measurements on actual product to ensure proper identification. Bathtub to be installed on the floor supported by 5 self levelling feet. Adjust if required to level the bathtub for adequate drainage. Refer to installation instructions for additional information.

IMPORTANT: Dimensions of fixtures are nominal and may vary ± 1/4" (6 mm). Weight may vary ± 5 lb (2.3 kg). Drawing is not to scale. These measurements are subject to change at manufacturer's discretion.

Compliance Certifications -
Meets or Exceeds the following Specifications:
• CAN/CSA - B45 Series



NW SN



H2OPTION® SIPHONIC DUAL FLUSH
ELONGATED TOILET
VITREOUS CHINA

H2OPTION® SIPHONIC DUAL FLUSH
ELONGATED TOILET

- ☐ **2887.218**
 - Vitreous china
 - Ultra high efficiency
 - Full Flush (4.8 Lpf/1.28 gpf)
 - Partial Flush (3.4 Lpf/0.92 gpf)
 - Elongated siphon action bowl with direct-fed jet
 - Meets EPA WaterSense® criteria
 - MaP PREMIUM listed
 - Includes EverClean® antimicrobial surface
 - PowerWash® rim scrubs bowl with each flush
 - 305mm (12") rough-in
 - Fully glazed 2" Trapway
 - Generous 9" x 8" water surface area
 - Chrome plated top mounted push button actuator
 - Sanitary bar on bowl
 - 2 color matched bolt caps
 - Limited lifetime warranty on chinaware and limited five year warranty on all mechanical parts

- ☐ **2887.518** Same as above, except with Tank with AquaGuard Liner

Separate Component Parts:

- ☐ **3706.216** Bowl
- ☐ **4133A.218** Tank
- ☐ **4133A.518** Tank with AquaGuard Liner

Nominal Dimensions:
756 x 380 x 762mm
(29-3/4" x 15" x 30")

Fixture only, seat and supply by others

- Compliance Certifications -
Meets or Exceeds the Following Specifications:
- ASME A112.19.2-2008/CSA B45.1-08 for Vitreous China Fixtures
 - CALGreen and California Energy Commission (CEC) Compliant
 - US EPA WaterSense® criteria for UHETs

To Be Specified:

- ☐ Color: ☐ White ☐ Bone ☐ Linen
- ☐ Seat: American Standard #5257A.65C Easy Lift and Clean Elongated Seat with Cover and Slow Close hinges
- ☐ Alternate Seat:
- ☐ Supply with stop:

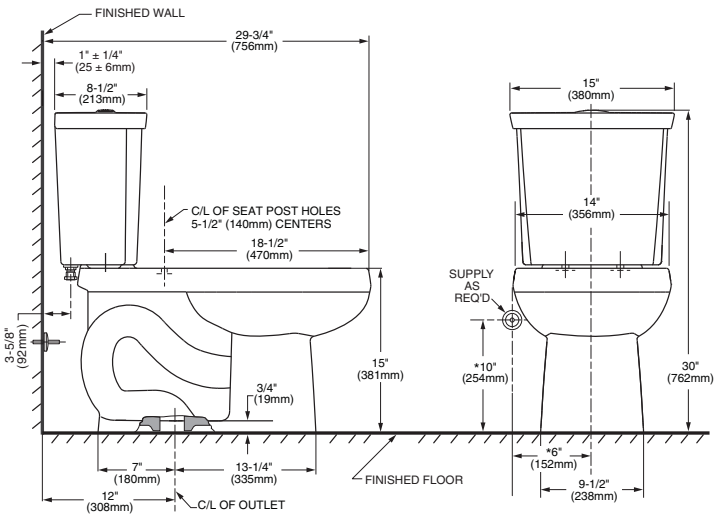

NOTES:
THIS COMBINATION IS DESIGNED TO ROUGH-IN AT A MINIMUM DIMENSION OF 305MM (12") FROM FINISHED WALL TO C/L OF OUTLET.
* DIMENSION SHOWN FOR LOCATION OF SUPPLY IS SUGGESTED. SUPPLY NOT INCLUDED WITH FIXTURE AND MUST BE ORDERED SEPARATELY.

IMPORTANT: Dimensions of fixtures are nominal and may vary within the range of tolerance established by ANSI Standard A112.19.2. These measurements are subject to change or cancellation. No responsibility is assumed for use of superseded or voided pages.



MOEN®

Specifications

DESCRIPTION

- Metal construction with various finishes identified by suffix
- 16" long 3/8" tubing connections
- Includes metal or 50/50 pop-up type waste assembly where noted

OPERATION

- Pivot action lever style handle
- Temperature controlled through 180° degree arc of handle travel

FLOW

- Flow is limited to 1.5 gpm max (5.7L/min) at 60 psi

CARTRIDGE

- 1225 cartridge design
- Nonmetallic/nonferrous and stainless steel material
- Can accommodate reversed piping and back to back installations

STANDARDS

- Third party certified to WaterSense®, CSA B-125.1, ASME A112.18.1 and all applicable requirements referenced therein including NSF61/9
- Complies with California Proposition 65 and with the Federal Safe Drinking Water Act
- **ADA**  for lever handle

WARRANTY

- Lifetime limited warranty against leaks, drips and finish defects to the original consumer purchaser
- 5 year warranty if used in commercial installations

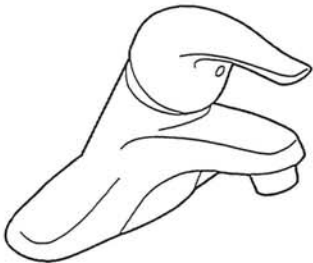

CHATEAU®
Single-Handle Lavatory Faucet

with Metal Waste Assembly

Model: L4625 series

L4631BC

Bulk Packed (12 per carton):
L64624 series

with 50/50 Waste Assembly

Bulk Packed (12 per carton):
L64625 series

Less Waste

Bulk Packed (12 per carton):
L64600 series

NOTE: THIS FAUCET IS DESIGNED TO BE
INSTALLED THRU 3-1" DIA. HOLES, 2" ON CENTER

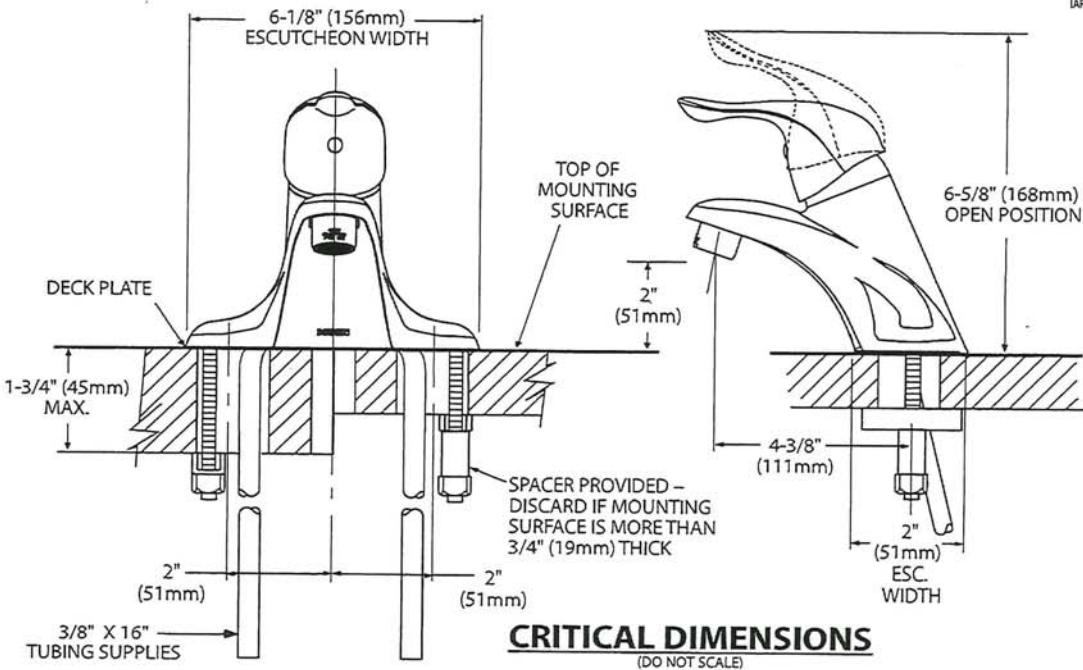

NW SW



Buy it for looks. Buy it for life.®

There is more than 1 version of this model.
Page down to identify the version you have.

DESCRIPTION

- Metal construction with various finishes identified by suffix
- Includes non-metallic showerhead, arm, flange and non-metallic diverter tub spout

OPERATION

- Handle operates counterclockwise through a 270° arc with off at 6 o'clock and maximum hot at the 9 o'clock position. Shut off in clockwise direction
- Adjustable temperature limit stop to control maximum hot water temperature
- Pressure balancing mechanism maintains selected discharge temperature to ± 3°

FLOW

- Showerhead is limited to 2.5 gpm (9.5 L/min) at 80 psi
- EP suffix models are limited to 1.75 gpm (6.6 L/min) at 80 psi
- NH suffix models contain no showerhead

CARTRIDGE

- 1222 cartridge design
- Accommodates back to back installations
- Nonmetallic/nonferrous and stainless steel material

STANDARDS

- Third party certified to meet ASME A112.18.1/CSA B125.1 and all applicable requirements referenced therein
- EP suffix models are third party certified to WaterSense®

- ADA ♿ for lever handle

WARRANTY

- Lifetime limited warranty against leaks, drips and finish defects to the original consumer purchaser
- 5 year warranty if used in commercial installations

Specifications



CHATEAU® POSI-TEMP®
Single-Handle Tub/Shower Trim Kit

- Models: TL181 series - valve trim only
(Bulk Packed 12 per carton)
TL182 series - shower trim only
(Bulk Packed 12 per carton)
TL183 series - tub/shower trim
(Bulk Packed 12 per carton)

- Valves: 62300 series
2500 series

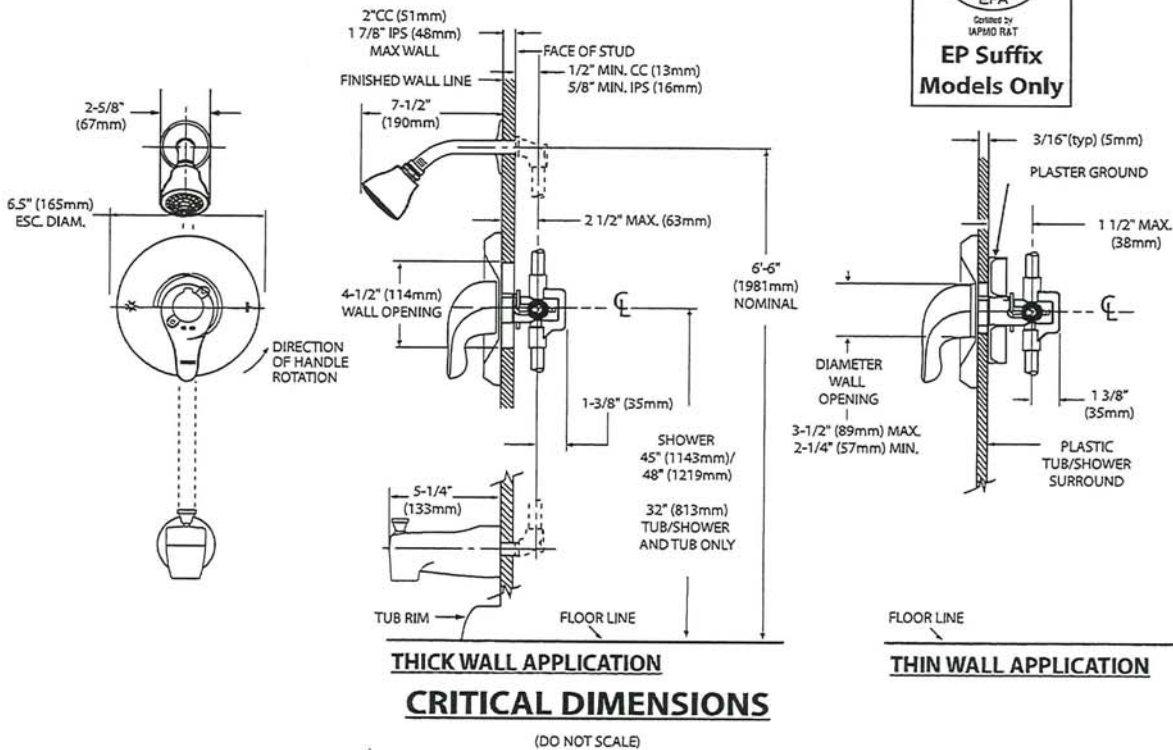

NN SN



Specifications

DESCRIPTION

- Metal construction with various finishes identified by suffix

OPERATION

- Lever style handles with hot and cold color indicator
- Rotate hot side handle counterclockwise to open (clockwise to close) and the cold side handle (clockwise to open) and (counterclockwise to close)

STANDARDS

- Third party certified to: ASME A112.18.1/CSA B-125.1, and all applicable requirements referenced therein

- ADA  for lever handles

WARRANTY

- Lifetime limited warranty against leaks, drips and finish defects to the original homeowner
 - 10 year limited warranty when used in a multi-family installation
 - 5 year limited warranty when used in a commercial installation
- Visit www.moen.com/support for complete details and limitations

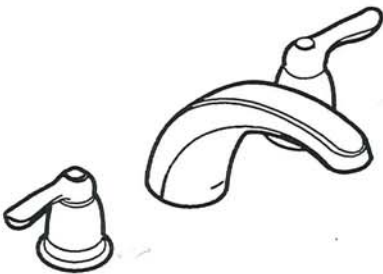

CHATEAU®
Two-Handle Garden Tub Trim

Models: T994 series

Valves: 4792, 4793, 4794, 4796, 4797, 4798

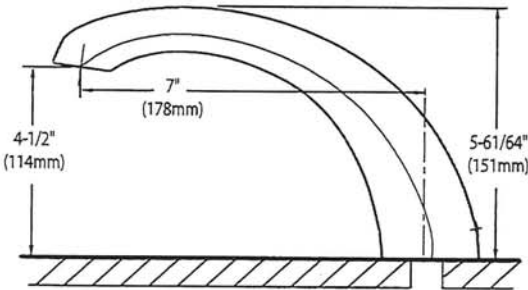
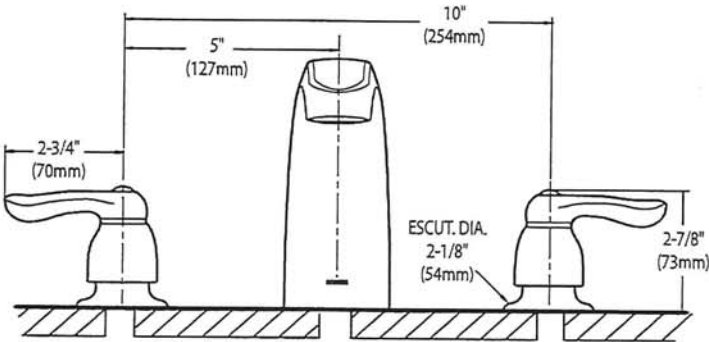

CRITICAL DIMENSIONS
(DO NOT SCALE)

NN SN



AVW-368CS
36" Wall Mounted hood - MSRP: \$839.00

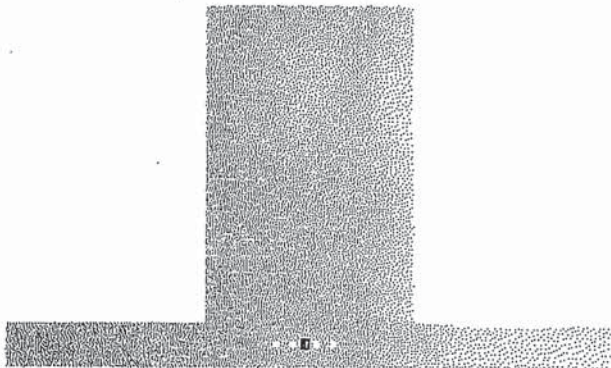

Model		AVW-368CS
Features		
Control	Soft touch with LED display	
Lighting	2 bulbs, 3W LED (bulbs included)	
Blower type	860 CFM, 6-Speed	
Blower performance	Speed 1, 2.4 sones	
	Speed 6, 6.2 sones	
Filter type	3 aluminium micro hole filters (included)	
	3 filters chicane (inox)	
Duct transition	6" Round (Top)	
Ducting	Ducted	
Chimney (ducted out)	For ceiling heights up to 9'0"	
Exterior Appearance		
Stainless steel grade	201	
Electrical Requirements		
Electrical requirements	120V / 60Hz / 2.7 Amps	
Dimensions		
Dimensions	35 1/2"(W) x 19 3/4"(D) x 2 3/4"(H)	
Warranty		
1-year Warranty	Parts and labour, in-home service	

Dimensions

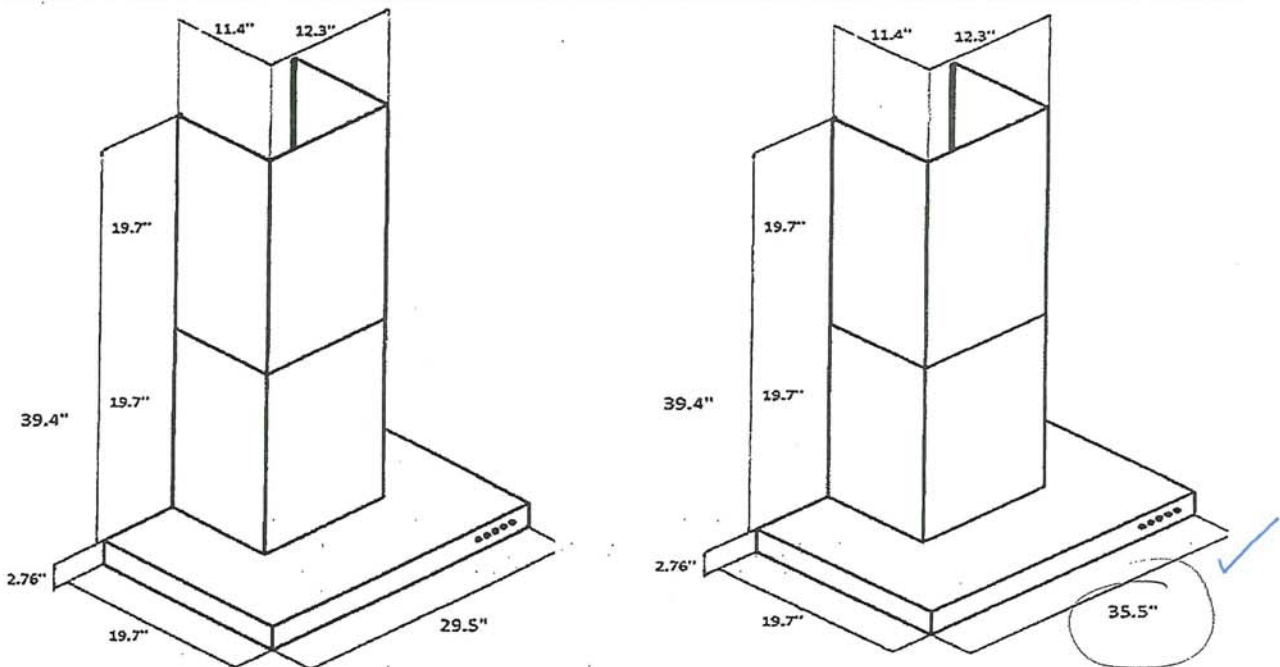

Installation

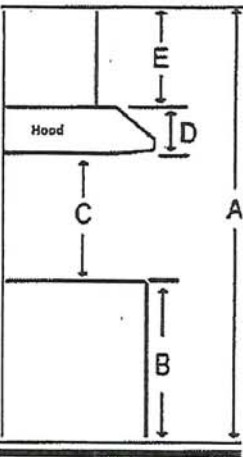

A	Floor to ceiling height	Variable
B	Floor to counter top height (standard)	36"
C	Recommended height between cooking surface and bottom of the hood	28" to 30"
D	Hood height	2.76"
E	Chimney height	19.7" to 39.4"

Duct transition

6" round top

The information contained herein is based on sources that we believe to be reliable, but is not guaranteed by us, may be incomplete and/or may change without notice.

55

LRFLC2706S

LG Pro Builder

26.5 cu. ft. Counter-Depth MAX™
French Door Refrigerator



- Counter-Depth MAX™
- 26.5 cu. ft. Capacity
- Single Ice Maker
- Internal Water Dispenser
- Door Cooling+
- Cool Guard Stainless Steel Back Wall
- LED Lighting
- LG ThinQ® Technology (Wi-Fi)
- ThinQ Care

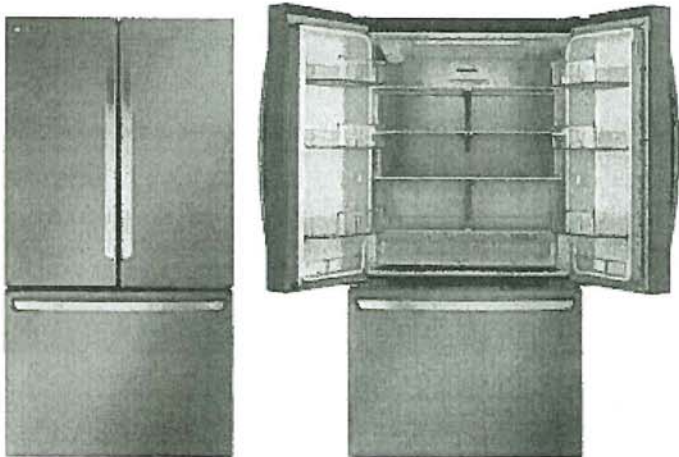

COLOR AVAILABILITY	
● LRFLC2706S - PrintProof® Stainless Steel	
CAPACITY	
Refrigerator (cu. ft.)	17.8
Freezer (cu. ft.)	8.7
Total Capacity (cu. ft.)	26.5
ENERGY	
Energy Consumption (kWh / Year)	632
ENERGY STAR® Certified	Yes
WATER & ICE SYSTEM	
In-Door Dispenser	No
Internal Water Dispenser	Yes
In-Door Ice System	No
Freezer Ice Maker	Yes (1)
Freezer Ice Maker - Ice Type	Cubed
Freezer Ice Maker - Daily Ice Production	2.5 / 2.7 (IcePlus) lbs
Freezer Ice Maker - Ice Storage Capacity	4.0 lbs.
Measured Fill	No
Water Filter	LT1000P (NSF-Certified*)
COOLING	
Compressor Type	Smart Inverter Compressor
Dual Evaporators	No
Multi-Air Flow System	Yes
Door Cooling+	Yes
Temperature Sensors	9
Fresh Air Filter	Yes

CONVENIENCE	
Display Type	Smooth Touch Control / White LED
Temperature Controls	Electronic / Digital
Door Alarm	Yes
Child Lock	Yes
Auto Closing Door Hinge	Yes (Left Door Only)
ADA Compliant	Yes
Sabbath Mode	Yes (Star-K-Certified)
LoDecibel® Quiet Operation	Yes
REFRIGERATOR	
No. of Shelves	4 Split
Cantilevered Shelves	Hybrid Cantilevered
Shelf Construction	Spill Protector™ Tempered Glass
Crisper Bins	2 Crispers
Glide N' Serve® Pantry Drawer	Yes
Cool Guard	Yes
Refrigerator Light	Ceiling LED
REFRIGERATOR DOOR	
Edge-to-Edge InstaView®	No
InstaView™ Door-in-Door®	No
Door-in-Door® with ColdSaver® Panel	No
No. of Door Bins	8 Total (2 Adjustable Gallon Sized)
Door Bin Construction	1 Piece (Clear)
FREEZER	
Freezer Type	Pull Drawer
Freezer Drawers	2-Tier Organization
DuraBase® Solid Drawer Base	Yes
Drawer Divider	Yes
Ice Storage	Ice Maker & Ice Bin in Freezer
Freezer Light	LED Lighting
Freezer Handle	SmartPull® Handle

NW SN

LRFLC2706S

LG Pro Builder

SMART FEATURES	
Wi-Fi Enabled	Yes
ThinQ® Technology	Yes
ThinQ Care	Yes
Voice Control	Google Assistant, Amazon Alexa
SmartDiagnosis™	Yes
Remote Monitoring	Yes

MATERIALS AND FINISHES	
Hidden Hinges	Yes
Surface	Smooth
Fingerprint & Smudge Resistant Exterior	Yes
Handles	Matching Handles

ACCESSORIES	
Replacement Water Filter	LT1000P
Replacement Fresh Air Filter	LT120F

TECHNICAL SPECS	
Required Power Supply	115 V, 60 Hz, 15 Amp
Plug Type	3-Prong
Power Cord Location	Back
Min. / Max. Water Pressure	20 - 120 psi

DIMENSIONS / CLEARANCES / WEIGHTS	
Depth with Handles	31 5/8"
Depth without Handles	29 1/8"
Depth without Door	24 3/4"
Depth (Total with Door Open)	43 5/8"
Height to Top of Case	68 7/8"
Height to Top of Door Hinge	70 1/4"
Width	35 3/4"
Width (Door Open 90° with Handle)	44 7/8"
Width (Door Open 90° without Handle)	40"
Door Edge Clearance with Handle	4 1/2"
Door Edge Clearance without Handle	2 1/4"
Installation Clearance	Sides 1/8", Top 1", Back 2"
Approx. Weight (Product / Carton)	322 lbs. / 352 lbs.
Carton Dimensions (WxHxD)	38" x 73" x 32"

LIMITED WARRANTY	
Parts & Labor	1 Year
Sealed System (Parts & Labor)	5 Years
Compressor (Parts & Labor)	5 Years
Smart Inverter Compressor (Parts Only)	6 - 10 Years

 *System tested and certified by NSF® International against NSF / ANSI Standard 42, Standard 53 and Standard 401.

DIMENSIONS / CLEARANCES

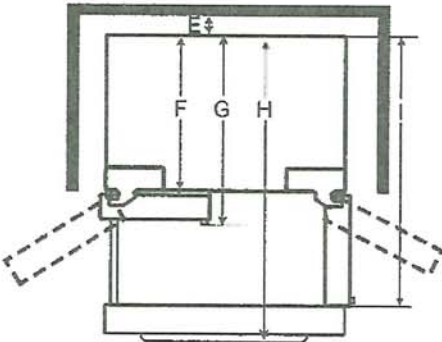
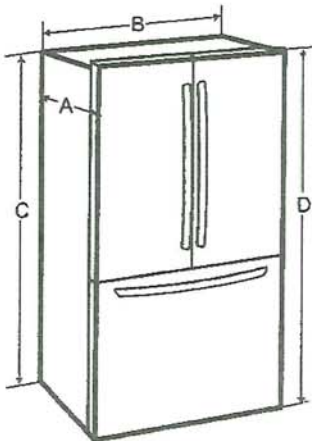

DIMENSIONS / CLEARANCES		
A	Depth without Handle	29 1/8" (739 mm)
B	Width	35 3/4" (908 mm)
C	Height to Top of Case	68 7/8" (1750 mm)
D	Height to Top of Hinge	70 1/4" (1785 mm)
E	Back Clearance	2" (50 mm)
F	Depth without Door	24 3/4" (628 mm)
G	Depth with Handle	31 5/8" (802 mm)
H	Depth (Total with Freezer Drawer Open)	48 7/8" (1239 mm)
I	Depth (Total with Door Open 90°)	43 5/8" (1106 mm)

INSTALLATION NOTES

- The installation location chosen for the refrigerator should allow space behind the unit for connections and airflow and space in front to open the doors and drawers.
- Too small of a distance from adjacent items may result in lowered freezing capability and increased electricity consumption charges. Allow at least 24 inches (610 mm) in front of the refrigerator to open the doors, and at least 2 inches (50.8 mm) between the back of the refrigerator and the wall.

AN SN

NA36N7755TS

36" Gas Cooktop



Stainless Steel
(Shown)



Black Stainless Steel

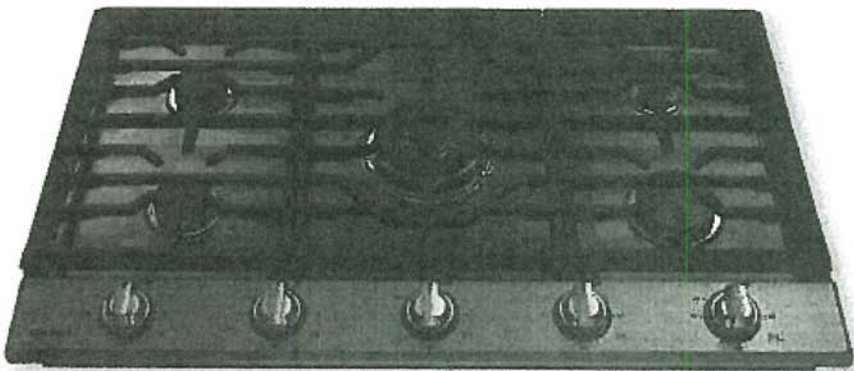

Features

- Bluetooth Connected to Hood
- WiFi Connectivity
- Powerful Cooktop
 - Right Front: 13K BTU
 - Left Front: 9.5K BTU
 - Right Rear: 5K BTU
 - Left Rear: 9.5K BTU
 - Center: Dual, 22K BTU (Oval)
- Cast Iron 3-Piece Grates
- Sealed Burners
- Burner On/Off Monitoring

Convenience

- Wok Grate
- Dishwasher Safe Grates
- LP Conversion Kit



22K True Dual Power Burner

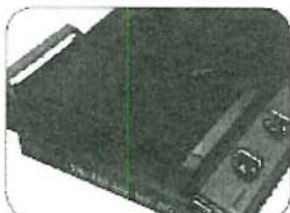

Cast Iron Griddle

Signature Features

22K BTU True Dual Power Burner

- Two independent burners offer intense heat and precise control to quickly boil water or temper chocolate.

LED Illuminated Backlit Knobs

- Visually lets you know your cooktop is on, even at a distance.

Cast Iron Griddle

- Cook breakfast foods, grill sandwiches, or sauté vegetables on the griddle.

NN SN

SAMSUNG

NA36N7755TS

36" Gas Cooktop

Installing Your Cooktop

Can be installed over a single oven.

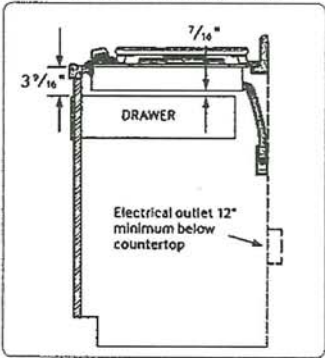

All horizontal clearances must be maintained for a minimum of 18" above the cooking surface.

Allow 7/16" minimum vertical clearance from the cooktop bottom (or 39/16" minimum depth from the countertop) to any combustible surfaces, including the upper edge of a drawer installed below the cooktop.

See built-in oven installation for complete installation instructions.

Maintain the following minimum clearance dimensions.

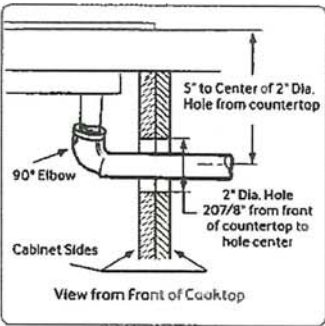
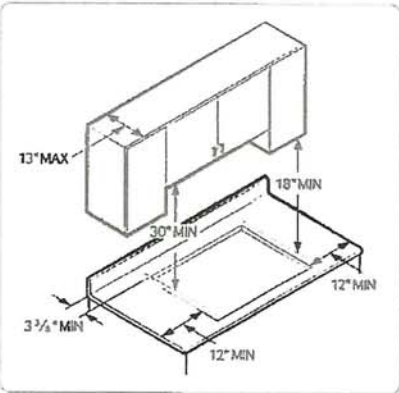

Dimensions

Cooktop Dimensions

Refer to installation manual for more details.

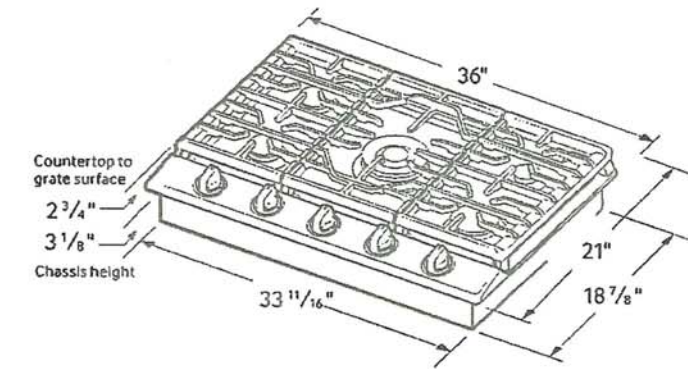

Cut-out Dimensions of Countertop

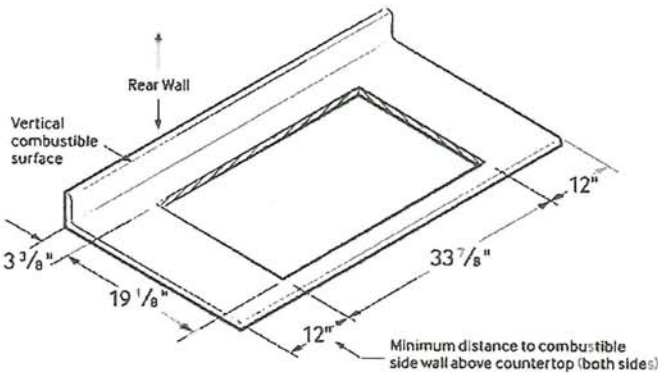

COLOUR	MODEL #	UPC CODE
Stainless Steel	NA36N7755TS	887276183572
Black Stainless Steel	NA36N7755TG	887276183503

NN SN

PLEASE VISIT SAMSUNG.COM FOR OUR LATEST UPDATES.

Actual colour may vary. Design, specifications, and colour availability are subject to change without notice.

Non-metric weights and measurements are approximate.

© 2016 Samsung Electronics Canada Inc. All rights reserved. Samsung is a registered trademark of Samsung Electronics Co., Ltd., used with permission.

SAMSUNG

HOME APPLIANCES



LG COOKING

WCEP6423_

1.7 / 4.7 cu. ft. Smart Combination Wall Oven with Convection, Air Fry and EasyClean®

- 6.4 cu. ft. Large Capacity
- ThinQ® Technology with ThinQ Care
- Convection Technology with Air Fry
- EasyClean® and Self Clean
- SmoothTouch® Glass Controls
- WideView™ Window

AVAILABLE COLORS

PRINTPROOF® STAINLESS STEEL

PRINTPROOF® BLACK STAINLESS STEEL

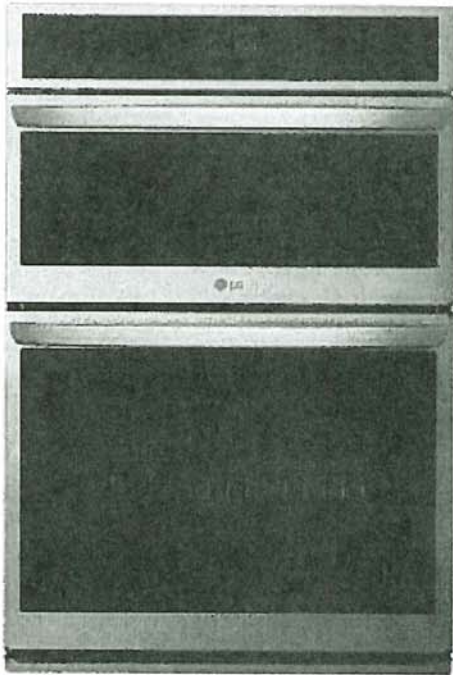

ThinQ Care

Proactive Smart Alerts to Keep Your Appliances Running Smoothly

- Preventative Alerts help you stay a step ahead of potential issues to find proactive solutions before problems arise.
- Avoid preventable repairs and service calls with real-time diagnostics for a hassle-free experience.
- Integrated within LG's ThinQ app—a smart home hub for managing your smart devices and appliances.

SUMMARY		LOWER OVEN FEATURES		ACCESSORIES	
Type	Combination Wall Oven	Capacity (cu.ft.)	4.7	Glass Tray (Upper Oven)	Yes
Total Oven Capacity (cu. ft.)	6.4 (1.7 Upper / 4.7 Lower)	EasyClean®	Yes (10mins)	Metal Tray (Upper Oven)	Yes
Available Colors	PrintProof™ Stainless Steel / PrintProof™ Black Stainless Steel	Self Clean	Yes (3, 4, 5 hours)	Rack (Upper Oven)	Yes
PrintProof® Finish	Yes	Convection Type	Fan Convection	Temperature probe	No
UPPER OVEN FEATURES		Convection Conversion	No	Heavy Duty Rack	Yes (2)
Capacity (cu. ft.)	1.7	Bake Element Power	2500W	Air Fry Tray	Yes
Interior	Stainless Steel	Variable Warm	Yes (High, Mid, Low)	POWER/RATINGS	
Speed Oven	No	Broil Element Power	2,500W inner / 1,500W outer	Amp at 240V	40A
Convection Technology	Yes	Variable Broil	Yes (Full, Center / Low, Med, High)	kW at 240V	7.8kW
Microwave Power Output	950W	Number of Rack Position	3	Required Power Supply	120 / 240 VAC 120 / 208 VAC
Convection Element Power	1500W	12 hrs. Auto Shut-off	Yes	DIMENSIONS & WEIGHT	
Broil Element Power	1200W	InstaView®	No	Product Dimensions (WxDxD)	29 3/4" x 43 13/16" x 23 3/8"
Bake Element Power	375W	Air Fry	Yes	Standard Cut-out Dimensions (WxHxD)	Min. 28 1/2" x 43 7/16" x 24" Max. 28 5/8" x 43 1/2" x 24"
Air Fry	Yes	Steam Assist	No	Flush Cut-out Dimensions (WxHxD)	30" x 44" x 25"
Dehydrate	No	Oven Modes	Air Fry / Convection Bake / Convection Roast / Bake / Broil / Frozen Meal / Warm / Proof / Favorite	Shipping Dimensions (WxHxD)	33" x 50" x 30"
Defrost Presets	Meat, Poultry, Fish, Bread	Maintenance Modes	EasyClean® / Self Clean	Product Weight (lbs.)	192 lbs.
Oven Modes	Auto Cook, Broil, Convection Bake, Defrost, Melt, Microwave, Popcorn, Proof, Sensor Cook, Soften, Warm, Air Fry, Dehydrate	CONTROL		Shipping Weight (lbs.)	225 lbs.
Sensor Cook	Beveridge, Casserole, Chicken, Pasta, Pizza, Dinner Plate, Rice, Soup, Vegetable	Oven Control Type	SmoothTouch™ Glass Controls	LIMITED WARRANTY	
Auto Cook	Bacon, Bagels, Baked Potatoe, Brownie, Canned Vegetable, Cod fillets, Corn Dog, Fresh Vegetable, Frozen Chicken Wings, Frozen Fries, Frozen Chicken Nuggets, Frozen Pizza, Frozen Soft Pretzels, Frozen Vegetable, Garlic Bread, Hamburger, Lamb chops, Meat Loaf, Nachos, Oatmeal, Pork Chops, Quinoa, Ribeye Steak, Rice, Salmon Steak, Sausage Sirloin Steak, Tenderloin	Display	LCD Display	Parts & Labor	1 Year
Soften	Butter, Cream Cheese, Frosting, Ice Cream	Language	English	UPC CODES	
Melt	Butter, Caramel, Cheese, Chocolate Marshmallow	Clock	12 hr or 24 hr	WCEP6423F (PrintProof® Stainless Steel)	048231344753
		Temperature Unit of Measure	Fahrenheit / Celsius	WCEP6423D (PrintProof® Black Stainless Steel)	048231345323
		Certified Sabbath Mode	Yes		
		SMART FEATURES			
		ThinQ® (Wi-Fi Enabled)	Yes		
		Check & Control	Yes		
		Voice Control	Yes (Google, Alexa)		
		Smart Recipe (3rd Party Recipe App)	S dechef		
		ThinQ Care	Yes		
		SmartDiagnosis™	Yes		

Dimensions and Clearances

Measure the current cutout dimensions and compare them to the cutout dimensions shown below. Little or no cabinet work may be necessary. The image may differ from the actual model.

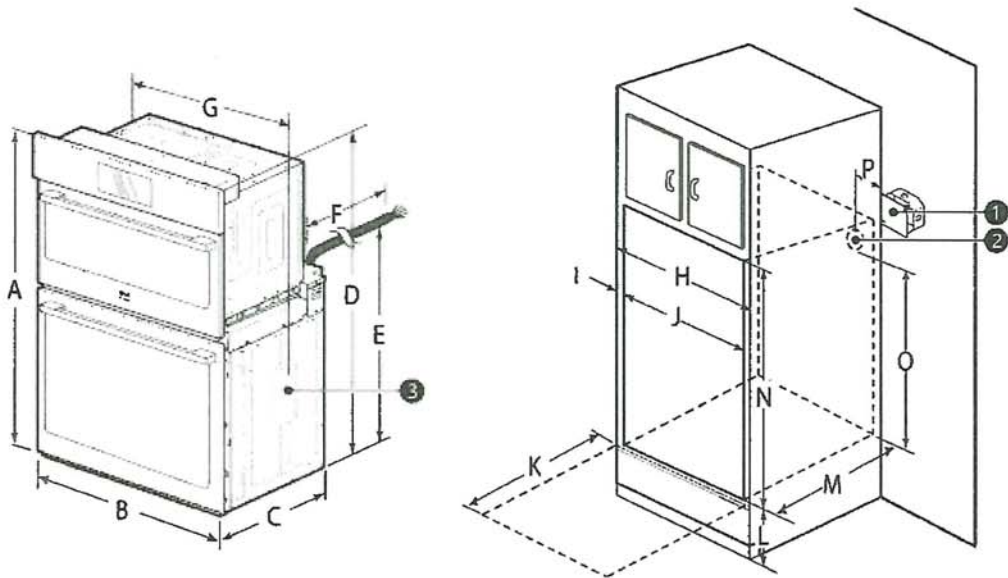

ENGLISH

List		Dimensions
A	Height	43 13/16" (111.3 cm)
B	Width	29 3/4" (75.5 cm)
C	Depth	23 3/8" (59.3 cm)
D	Height (standard installation)	43 3/16" (109.7 cm)
E	Height (power cord)	25 7/8" (65.6 cm)
F	Length (power cord)	60" (152.4 cm)
G	Width (standard installation)	28 7/16" (72.2 cm)
H	Cabinet width	30" (76.2 cm)
I	Overlap of oven	1" (2.5 cm)
J	Cutout width	28 1/2" Min. (72.4 cm) 28 5/8" Max. (72.7 cm)
K	Depth of open door	23" (58.4 cm)
L	Cutout location from floor	12" (30.5 cm)
M	Cutout depth	24" Min. (61.0 cm)
N	Cutout height	43 7/16" Min. (110.3 cm) 43 1/2" Max. (110.5 cm)
O	Height of conduit opening from floor of cutout	39 27/32" (101.2 cm)
P	Distance of conduit opening from side of cabinet	5" (12.7 cm)

NN SN

HOME APPLIANCES

LG DISHWASHERS

LDFN454HT

Front Control Dishwasher with Quadwash™



- QuadWash™ System
- 3rd Rack
- 15 Place Settings
- EasyRack™ Plus
- Dynamic Dry™
- NeveRust™ Stainless Steel Tub
- LoDecibel™ Operation (48 dB)
- NFC Tag On Technology
- NSF Certified



CAPACITY	
Total Place Settings	15
Upper Rack Dish Height Limit	9.0"
Lower Rack Dish Height Limit	12.5"
RACKS AND BASKETS	
Cutlery Baskets	Yes
Fold Down Tines	Yes (Half Fold on Upper & Half Fold on Lower)
BPA-Free Nylon Coated Racks and Tines	Yes
Rack Handle	Yes (Upper)
EasyRack™ Plus System	Yes
Height Adjustable Upper Rack	Yes
3rd Rack (Fixed)	Yes
STYLE AND DESIGN	
Control Panel Location	Front Control
Electronic Controls	Fully Integrated Control Panel
Tub Material	NeveRust™ Stainless Steel
Handle	Pocket Handle
All Available Colors	Stainless Steel
FEATURES	
QuadWash®	Yes
Inverter Direct Drive Motor	Yes
LoDecibel™ Quiet Operation	48dBA
Number of Wash Cycles	9 (Auto, Heavy, Delicate, Normal, Turbo, Download Cycle, Machine Clean, Rinse, Express)
Number of Options	8 (Dual Zone, Half Load, Energy Saver, High Temp, Extra Dry, Delay Start, Control Lock, Night Dry)
Number of Spray Arms	3 (Top, Upper, Lower)
SenseClean™ Wash System	Yes
Vario Wash	Yes
Detergent and Rinse-Aid Dispenser	Yes
Drying System	Dynamic Dry
End of Cycle Indicator	Yes (Beeper + END indication on display)
Hidden Water Heater	Yes
Safety Float Switch (Leaks)	Yes
Soil (Turbidity) Sensor	Yes
Tub Insulation (Damping Sheet, Sound Absorbing Material (felt), Base)	Yes
BPA-Free Nylon Coated Racks and Tines	Yes
Anti-Bacterial Treatment (Sump, Inner / Outer Filter, Drain pump case, Drain hose)	Yes
Balanced Door	Yes
3-Stage Filtration System	Yes
SMART FEATURES	
NFC Tag On	Yes

CERTIFICATIONS	
NSF® Certified	Yes
POWER RATINGS	
ENERGY STAR® Qualified	Yes
CEE Tier	1
Energy Use (kWh/Year)	258 kWh/Year
Water Factor (WF)	2.9
DIMENSIONS / CLEARANCES / WEIGHT	
Product Dimensions (in) (W x H x D)	23 3/4" x 33 5/8" x 24 5/8"
Product Weight (lbs)	75 lbs
Depth with Door Closed with Handle (in)	24 5/8"
Depth with Door Open (in)	49 1/4"
Carton Dimensions (in) (W x H x D)	28" x 34 7/8" x 29 5/8"
Shipping Weight with Carton (lbs)	88.2 lbs
LIMITED WARRANTY	
Labor	1 Year
Parts	1 Year
Control Board and Rack Parts	5 Years
Direct Drive Motor	10 Years
Stainless Steel Door Liner or Tub	Lifetime
UPC CODES	
LDFN454HT (Stainless Steel)	048231342209

NW SW

5.0 cu.ft I.E.C. Closet-Depth Front Load Washer with Intuitive Controls
Model: WFW560CHW

- Overview
- Specifications
- Reviews
- You May Also Like
- Help And Resources
- Find In Store



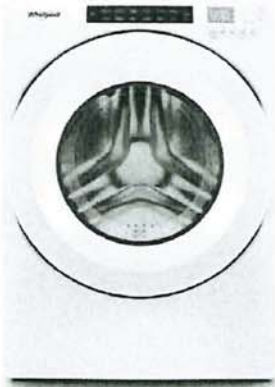

Key Features

- #1 in Customer Satisfaction in the J.D. Power 2020 Laundry Appliances Satisfaction Study
- 5.0 cu. ft. I.E.C. Capacity
- ENERGY STAR® Certified
- Intuitive Controls
- Sanitize Cycle with Oxi

Color

White



Specifications

Width: 6858.00, 27.0” Centimeters, Inches	Depth: 8016.88, 31-9/16” Centimeters, Inches
---	--

Dimensions

Capacity	4-3/10
Depth	8016.88 cm, 31-9/16 in
Gross Weight	97068688.00 kg, 214 lbs
Net Weight	92532768.00 kg, 204 lbs
Width	6858.00 cm, 27.0 in

Appearance

LCD Touch Screen	No
Window	Yes

Details

Advanced Vibration Control™	No
Dispense System	Detergent, Fabric Softener & Bleach
Eco Monitor/Efficiency Monitor	No
Hoses Included	4ft 4in Drain Hose Included
Internal Heater	No
Maximum Spin Speed	1160
Out Of Balance Sensing	Yes
Water Factor	3-1/5

Cycles and Options

Number Of Wash Cycles	35
-----------------------	----

Electrical

Power Cord Included	Yes
---------------------	-----

Controls

Automatic Temperature Controls	Yes
Control Location	Front
LCD Touch Screen	No

Compatibility

Works With	No
------------	----

Options

Number Of Washer Options	7
--------------------------	---

Features

Stackable	Yes
Water Faucet	No

Cycles

Number Of Wash Cycles	35
-----------------------	----

Exterior

Lid/Door Lock	Yes
Lid/Door Swing	Left

Modifiers

Delay Start	No
Number Of Rinse Options	2
Number Of Soil Levels	3
Number Of Spin Speeds	4
Number Of Wash/Rinse Temperatures	4
Pre Soak	Yes
Temperature Selections	Hot, Cold, Cool, Warm

NW SN

Recessed area or closet installation (stacked washer and dryer)

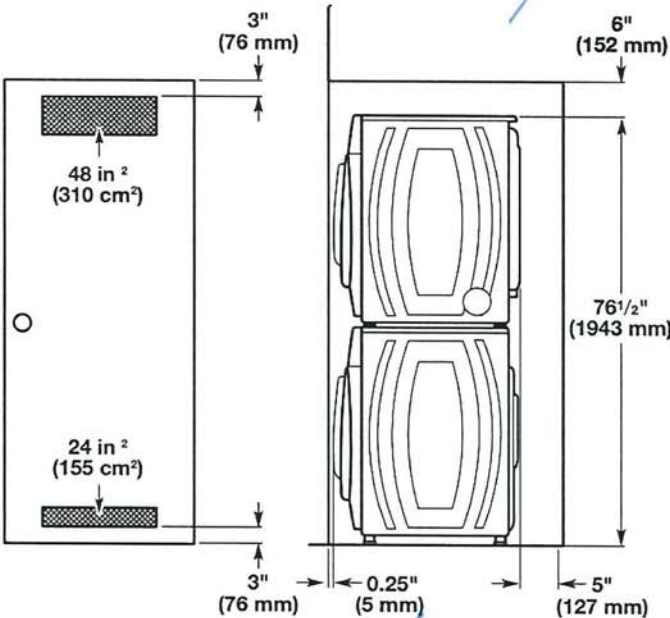

Custom under counter installation

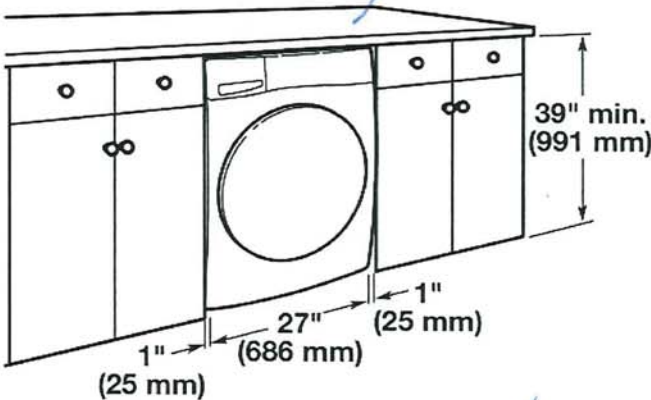

Recessed area or closet installation (washer only)

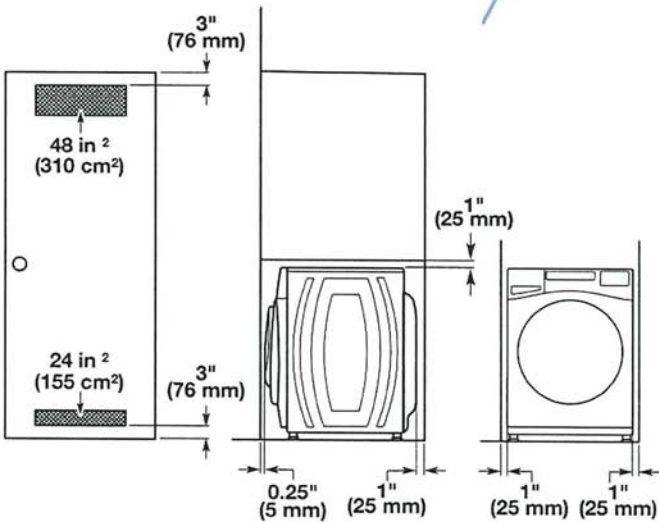

Custom cabinet installation

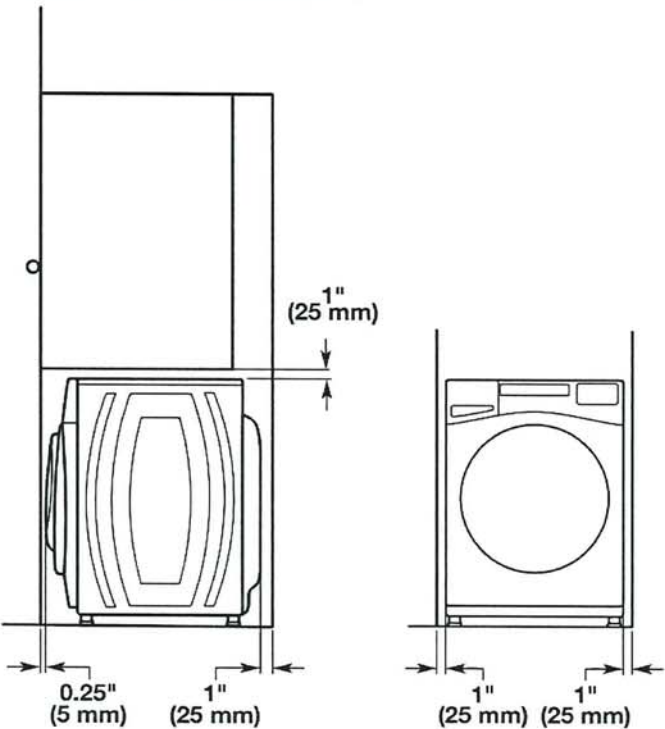

Drain System

It is the responsibility of the installer to install and secure the drain hose in to the provided plumbing/drain in a manner that will avoid the drain hose coming out of or leaking from the plumbing/drain.

Drain system can be installed using a floor drain, wall standpipe, floor standpipe, or laundry tub. Select the method you need.

IMPORTANT: To avoid siphoning, only 4.5" (114 mm) of drain hose should be inside standpipe. Always secure drain hose with cable tie.

Floor standpipe drain system

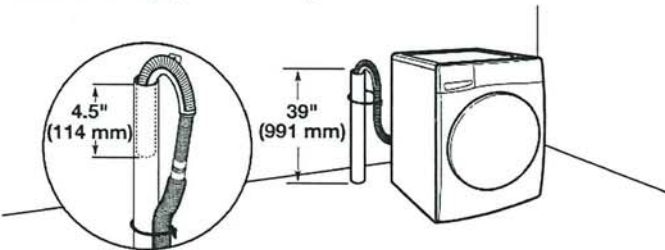

Minimum diameter for a standpipe drain: 2" (51 mm). Minimum carry-away capacity: 17 gallons (64 L) per minute. A 1/4" (6 mm) diameter to 1" (25 mm) diameter Standpipe Adapter Kit is available; refer to the Quick Start Guide for online ordering information. Top of standpipe must be at least 39" (762 mm) high; install no higher than 96" (2.4 m) from bottom of washer. If you have an overhead sewer and need to pump higher than 96" (2.4 m), a sump pump and associated hardware are needed. See "Alternate Parts."

NN SN

Wall standpipe drain system

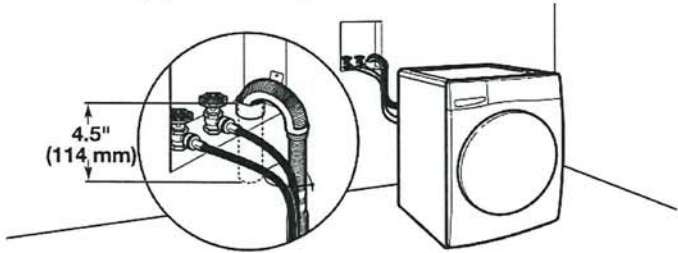

See requirements in "Floor standpipe drain system."

Laundry tub drain system

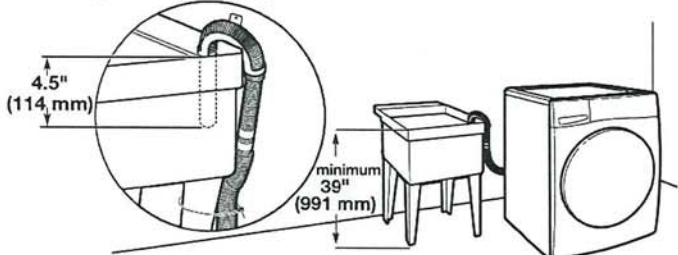

Minimum capacity: 20 gallons (76 L). Top of laundry tub must be at least 39" (991 mm) from the floor; install no higher than 96" (2.4 m) from bottom of washer.

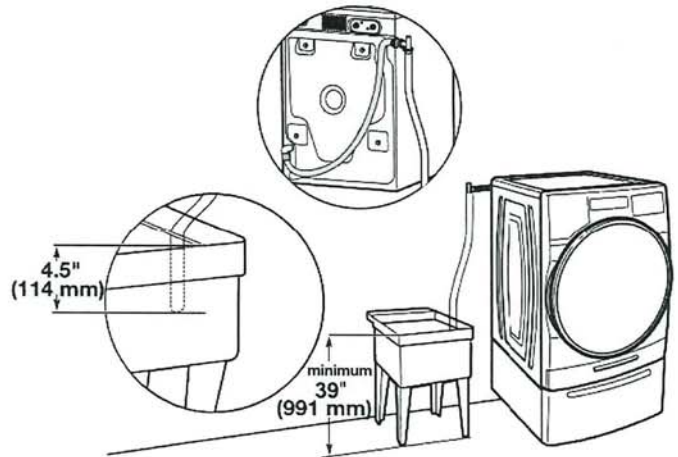

Floor drain system

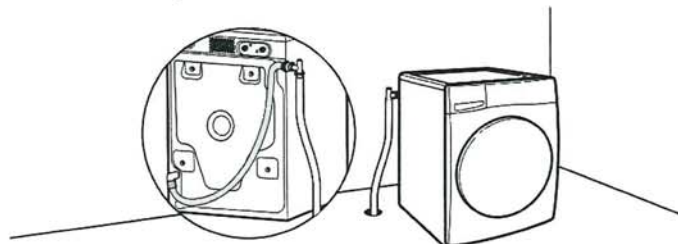

Floor drain system requires a Siphon Break Kit, 2 Connector Kits, and an Extension Drain Hose that may be purchased separately; refer to the Quick Start Guide for online ordering information. Minimum siphon break height: 28" (710 mm) from bottom of washer. (Additional hoses may be needed.)

Electrical Requirements

⚠ WARNING



Electrical Shock Hazard

- Plug into a grounded 3 prong outlet.
- Do not remove ground prong.
- Do not use an adapter.
- Do not use an extension cord.
- Failure to follow these instructions can result in death, fire, or electrical shock.

- A 120 V, 60 Hz, AC only, 15 or 20 A, fused electrical supply is required. A time-delay fuse or circuit breaker is recommended. It is recommended that a separate circuit breaker serving only this appliance be provided.
- This washer is equipped with a power supply cord having a 3-prong grounding plug.
- To minimize possible shock hazard, the cord must be plugged into a mating, 3-prong, grounding-type outlet, grounded in accordance with local codes and ordinances. If a mating outlet is not available, it is the personal responsibility and obligation of the customer to have the properly grounded outlet installed by a qualified electrician.
- If codes permit and a separate ground wire is used, it is recommended that a qualified electrician determine that the ground path is adequate.
- Do not ground to a gas pipe.
- Check with a qualified electrician if you are not sure the washer is properly grounded.
- Do not have a fuse in the neutral or ground circuit.

GROUNDING INSTRUCTIONS

For a grounded, cord-connected appliance:
This appliance must be grounded. In the event of a malfunction or breakdown, grounding will reduce the risk of electric shock by providing a path of least resistance for electric current. This appliance is equipped with a cord having an equipment-grounding conductor and a grounding plug. The plug must be plugged into an appropriate outlet that is properly installed and grounded in accordance with all local codes and ordinances.

WARNING: Improper connection of the equipment-grounding conductor can result in a risk of electric shock. Check with a qualified electrician or serviceman if you are in doubt as to whether the appliance is properly grounded. Do not modify the plug provided with the appliance: If it will not fit the outlet, have a proper outlet installed by a qualified electrician.

For a permanently connected appliance:
This appliance must be connected to a grounded metal, permanent wiring system, or an equipment-grounding conductor must be run with the circuit conductors and connected to the equipment-grounding terminal or lead on the appliance.

SAVE THESE INSTRUCTIONS

NW SN

5.0 cu.ft I.E.C. Closet-Depth Front Load Washer with Intuitive Controls
Model: WFW560CHW

Overview

Specifications

Reviews

You May Also Like

Help And Resources

Find In Store

Key Features

- #1 in Customer Satisfaction in the J.D. Power 2020 Laundry Appliances Satisfaction Study
- 5.0 cu. ft. I.E.C. Capacity
- ENERGY STAR® Certified
- Intuitive Controls
- Sanitize Cycle with Oxi

Color

White

Specifications

Width: 6858.00, 27.0" Centimeters, Inches	Depth: 8016.88, 31-9/16" Centimeters, Inches
---	--

Dimensions

Capacity	4.3/10
Depth	8016.88 cm, 31-9/16 in
Gross Weight	97068688.00 kg, 214 lbs
Net Weight	92532768.00 kg, 204 lbs
Width	6858.00 cm, 27.0 in

Appearance

LCD Touch Screen	No
Window	Yes

Details

Advanced Vibration Control™	No
Dispense System	Detergent, Fabric Softener & Bleach
Eco Monitor/Efficiency Monitor	No
Hoses Included	4ft 4in Drain Hose Included
Internal Heater	No
Maximum Spin Speed	1160
Out Of Balance Sensing	Yes
Water Factor	3-1/5

Cycles and Options

Number Of Wash Cycles	35
-----------------------	----

Electrical

Power Cord Included	Yes
---------------------	-----

Controls

Automatic Temperature Controls	Yes
Control Location	Front
LCD Touch Screen	No

Compatibility

Works With	No
------------	----

Options

Number Of Washer Options	7
--------------------------	---

Features

Stackable	Yes
Water Faucet	No

Cycles

Number Of Wash Cycles	35
-----------------------	----

Exterior

Lid/Door Lock	Yes
Lid/Door Swing	Left

Modifiers

Delay Start	No
Number Of Rinse Options	2
Number Of Soil Levels	3
Number Of Spin Speeds	4
Number Of Wash/Rinse Temperatures	4
Pre Soak	Yes
Temperature Selections	Hot, Cold, Cool, Warm

NN SN

Recessed area or closet installation (stacked washer and dryer)

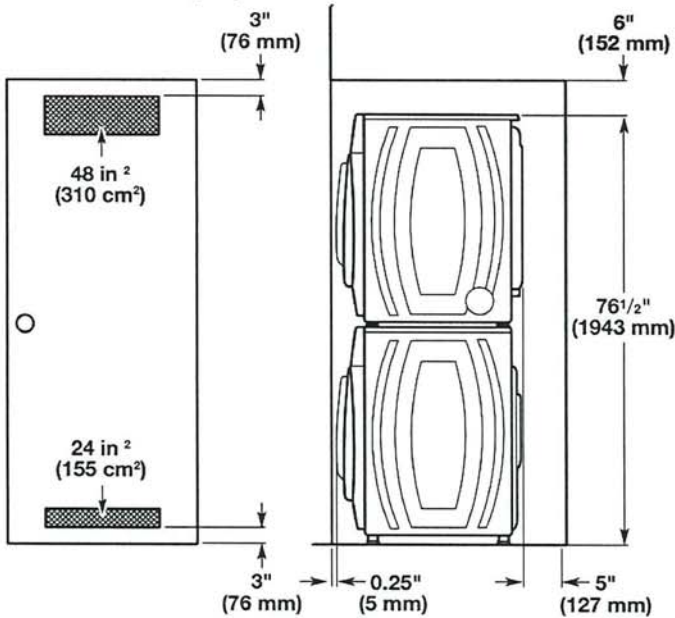

Custom under counter installation

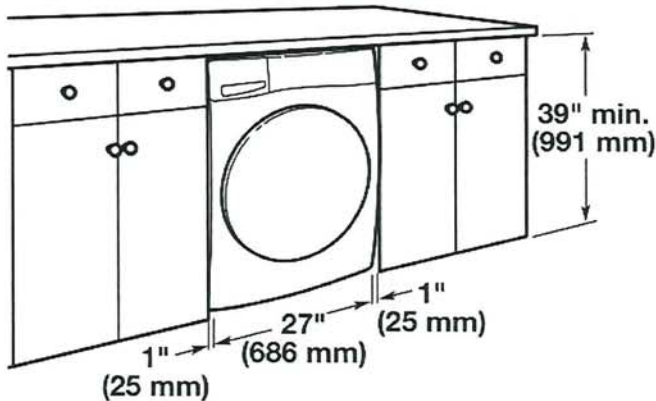

Recessed area or closet installation (washer only)

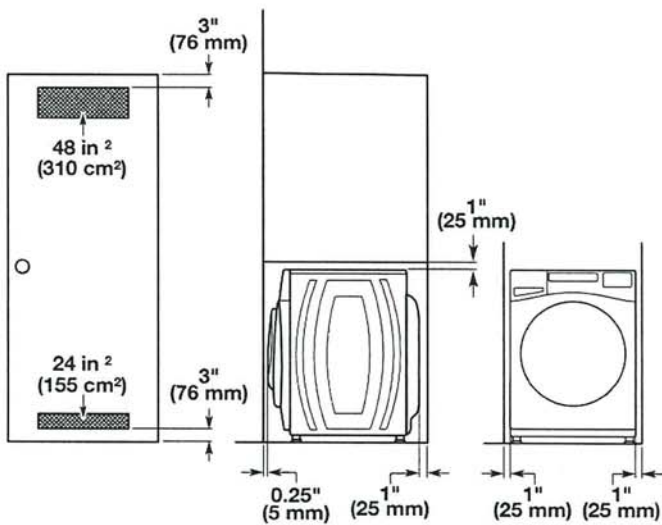

Custom cabinet installation

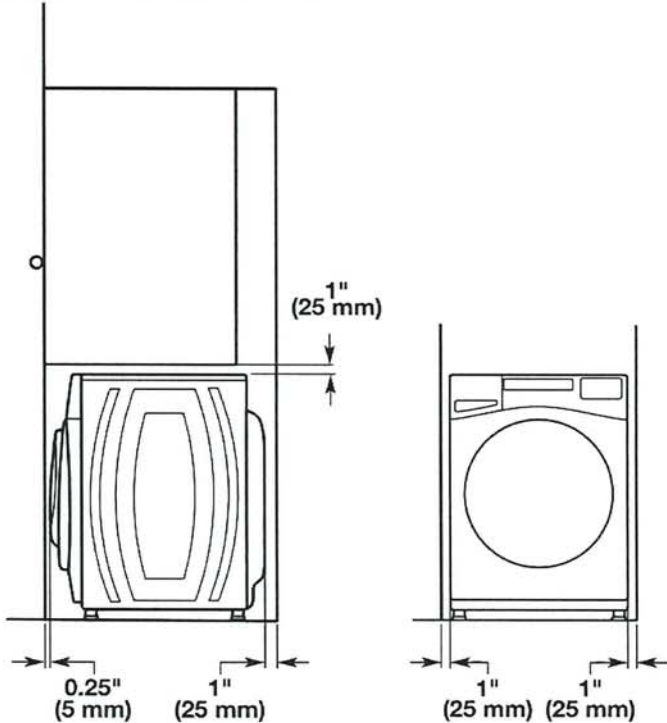

Drain System

It is the responsibility of the installer to install and secure the drain hose in to the provided plumbing/drain in a manner that will avoid the drain hose coming out of or leaking from the plumbing/drain.

Drain system can be installed using a floor drain, wall standpipe, floor standpipe, or laundry tub. Select the method you need.

IMPORTANT: To avoid siphoning, only 4.5" (114 mm) of drain hose should be inside standpipe. Always secure drain hose with cable tie.

Floor standpipe drain system

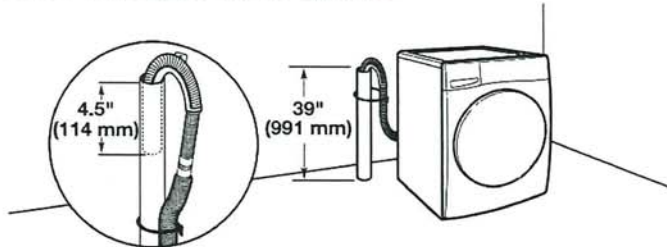

Minimum diameter for a standpipe drain: 2" (51 mm). Minimum carry-away capacity: 17 gallons (64 L) per minute. A 1/4" (6 mm) diameter to 1" (25 mm) diameter Standpipe Adapter Kit is available; refer to the Quick Start Guide for online ordering information. Top of standpipe must be at least 39" (762 mm) high; install no higher than 96" (2.4 m) from bottom of washer. If you have an overhead sewer and need to pump higher than 96" (2.4 m), a sump pump and associated hardware are needed. See "Alternate Parts."

NN SN