

LOT 7123    Model: 30-2794 A The Willowglen

PURCHASERS: THURSHIKAH NAGARATNAM/MADUN THAYANITHY

VENDOR:        Heathwood Homes (Whitby) Limited

TWO TONE KITCHEN CABINETS- ACCENT COLOUR ON ISLAND  
STACKED UPPER CABINETS IN KITCHEN AND SERVERY PANTRY

- ☐ COLD CELLAR
- ☒ DECK

UPGRADED / MODIFIED ELEVATION

- ☐ CORNER UPGRADE
- ☐ REAR UPGRADE

CEILING UPGRADE - SMOOTH

- ☒ MAIN FLOOR (STD)
- ☐ SECOND FLOOR WITH RESILIENCE CHANEL
- ☐ LOWER LEVEL

ADDITIONAL ROUGH-INS

- ☒ 200 AMP SERVICE (STD)
- ☐ WET BAR ROUGH-IN
- ☒ HUMIDIFIER (STD)
- ☒ AIR CONDITIONING (STD)

GAS ROUGH-IN

- ☐ STOVE
- ☐ DRYER
- ☐ BBQ
- ☐ ADDITIONAL GAS FIREPLACE

KITCHEN HOODFAN VENTING SIZE

- ☒ 6 IN ROUND DUCT (STD WITH APPLIANCE PACKAGE)
- ☐ 7 IN ROUND DUCT

FULL LOWER LEVEL STAIRS	All Oak
UPPER LOWER LEVEL STAIRS	N/A
LOWER LOWER LEVEL STAIRS	N/A
MAIN STAIRS	All Oak

DEC 20/24

Date

Signatures on file

Purchaser:

Date

Purchaser:

Locked Date:

DEC. 20/24

Date

IRIT SALEM

Decor Consultant:

-12- 20 2024

Date

m. Rosen

Heathwood Homes (Whitby) Limited

Approved



THURSHIKAH NAGARATNAM/MADUN THAYANITHY  
Project: Country Lane  
Unit: 7123, Phase: 7  
Model: 30-2794 A The Willowglen

Created: 7/22/2024 14:28:38  
Locked:  
Closed:

Kitchen/Breakfast

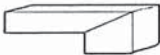
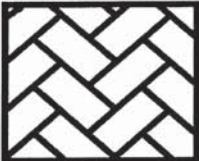
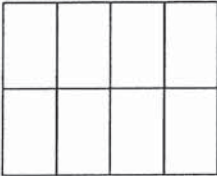
Cabinet Colour/Style	6469	Classic II-MANCHESTER-WINTER WHITE-PAINT MDF ***UPG***	
Island Cabinet Colour/Style	6467	Classic II-MANCHESTER-MACADAMIA-PAINT MDF ***UPG***	
Cabinet Hardware	2086	9677-HARDWARE ***STD***	
Countertop	9814	Group 2-Quartz-Caesarstone-ASHEN MARBLE # 7512-3/4 inch B/U MITERED EDGE ***2***	
Island Countertop	9814	Group 2-Quartz-Caesarstone-ASHEN MARBLE # 7512-3/4 inch B/U MITERED EDGE ***2***	
Countertop Edge	4005	DOUBLE MITRE 1 1/2 INCH ***UPG***	
Sink	9493	BLANCO QUATRUS U 1 SUPER SINGLE 401248 (min cabinet 36 in)	PG 22
Crumb Vac Color	9482	Vacuum-Crumb Vac (Dust Pan)-White	
HoodFan	8894	SCB51430-CYCLONE 30 inch CANOPY CHIMNEY HOODFAN-STAINLESS STEEL *****	PG 32-33
Backsplash	5730	QT.CD.ARW.0306MT-Colour and Dimension Matte-Arctic White-3 x 6 ***1***	
Backsplash Grout	9838	Grout-Bone #5015 ***STD***	
Backsplash Tile Pattern	3100	VERTICAL HERRINGBONE ***UPG***	
Flooring	9760	NA.SP.WHC.1224-Spendid-White Cloud-12 x 24 floor tile directions SEE SKETCH ***3***	S 2
Floor Tile Grout	9837	Grout-Warm Grey #5093 ***STD***	
Floor Tile Pattern	3040	FRONT TO BACK ***STD***	

- Purchasers have been advised: standard fridge opening is a minimum 37 3/8 x 73 3/8 inches. Ice Waterline Rough-In is included.
- Standard stove opening is 30 inches and standard dishwasher opening is 24 inches. Any gas stove will require backsplash or stainless steel backing to avoid fire hazards.
- Purchasers acknowledge: Heathwood Homes and its contractors will not be responsible for any kitchen cabinet changes due to appliances dimension changes after sign-off.

Comment

Servery

Cabinet Colour/Style	6469	Classic II-MANCHESTER-WINTER WHITE-PAINT MDF ***UPG***
Cabinet Hardware	2086	9677-HARDWARE ***STD***
Opt. Cabinet Colour/Style - Uppers	1111	N/A *****
Opt. Cabinet Hardware - Uppers	4111	N/A *****



Customer Colours

THURSHIKAH NAGARATNAM/MADUN THAYANITHY  
Project: Country Lane  
Unit: 7123, Phase: 7  
Model: 30-2794 A The Willowglen

Created: 7/22/2024 14:28:38  
Locked:  
Closed:

Opt. Cabinet hardware - Uppers	1111	N/A
Countertop	9814	Group 2-Quartz-Caesarstone-ASHEN MARBLE # 7512-3/4 inch B/U MITERED EDGE ***2***
Countertop Edge	4005	DOUBLE MITRE 1 1/2 INCH ***UPG*** 
Opt. Sink	1111	N/A *****
Opt. Backsplash	1111	N/A *****
Opt. Backsplash Grout	1111	N/A *****
Opt. Backsplash Tile Pattern	1111	N/A *****

Flooring	9760	NA.SP.WHC.1224-Spendid-White Cloud-12 x 24 floor tile directions SEE SKETCH ***3***	S 2
Floor Tile Grout	9837	Grout-Warm Grey #5093 ***STD***	
Floor Tile Pattern	3040	FRONT TO BACK ***STD*** 	
Comment			

Foyer

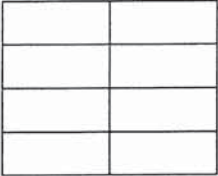
Flooring	9760	NA.SP.WHC.1224-Spendid-White Cloud-12 x 24 floor tile directions SEE SKETCH ***3***	S 2
Floor Tile Grout	9837	Grout-Warm Grey #5093 ***STD***	
Floor Tile Pattern	3050	SIDE TO SIDE ***STD*** 	
Comment			

Powder Room

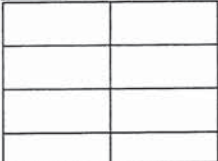
Flooring	9760	NA.SP.WHC.1224-Spendid-White Cloud-12 x 24 floor tile directions SEE SKETCH ***3***	S 2
Floor Tile Grout	9837	Grout-Warm Grey #5093 ***STD***	
Floor Tile Pattern	3050	SIDE TO SIDE ***STD*** 	



THURSHIKAH NAGARATNAM/MADUN THAYANITHY  
Project: Country Lane  
Unit: 7123, Phase: 7  
Model: 30-2794 A The Willowglen

Created: 7/22/2024 14:28:38  
Locked:  
Closed:

Plumbing Fixture (Colour)	1737	Plumbing Fixtures-WHITE ***STD***
Comment		

Dining Room		
Flooring	9009	Red Oak PEARL-Vintage Red Oak Solid Sculpted Character PEARL-HILLSIDE-3/4 inch X 5 inch ***STD***
Comment		

Great Room		
Flooring	9009	Red Oak PEARL-Vintage Red Oak Solid Sculpted Character PEARL-HILLSIDE-3/4 inch X 5 inch ***STD***
Comment		

Great Room Fireplace		
Type	8869	Majestic MERC32 ***STD***
Mantle	1439	NF 17-Paint Grade Mantle-Flat Wall-WHITE ***STD***
Surround (STD)	8873	3 pc- 4 inch Marble Surround-Nero Marquina ***STD***
- Purchasers have been advised: heat from the FP can damage TV above a FP and items placed on mantle.		
- Heathwood and its contractors will not be liable for any damage on items placed/@installed above a FP after closing.		
Comment		

PG 21

Mud Room											
Flooring	9437	TH.CT.WHT.1212.MT-Construct-White Matte-12 x 12 STD ***STD***									
Floor Tile Grout	9840	Grout-Pearl Gray #5019 ***STD***									
Floor Tile Pattern	3000	STANDARD SQUARE ***STD***									
<table><tr><td></td><td></td><td></td></tr><tr><td></td><td></td><td></td></tr><tr><td></td><td></td><td></td></tr></table>											
Comment											

Main Hall		
Flooring	9009	Red Oak PEARL-Vintage Red Oak Solid Sculpted Character PEARL-HILLSIDE-3/4 inch X 5 inch ***STD***
Comment		



THURSHIKAH NAGARATNAM/MADUN THAYANITHY  
Project: Country Lane  
Unit: 7123, Phase: 7  
Model: 30-2794 A The Willowglen

Created: 7/22/2024 14:28:38  
Locked:  
Closed:

Upper Hall											
Flooring	9009	Red Oak PEARL-Vintage Red Oak Solid Sculpted Character PEARL-HILLSIDE-3/4 inch X 5 inch ***STD***									
Comment											
Master Bedroom											
Flooring	9505	84558-MINOTAUR-BEACH SHELL-40 oz Poly ***STD***									
Comment											
Bedroom 2											
Flooring	9505	84558-MINOTAUR-BEACH SHELL-40 oz Poly ***STD***									
Comment											
Bedroom 3											
Flooring	9505	84558-MINOTAUR-BEACH SHELL-40 oz Poly ***STD***									
Comment											
Bedroom 4											
Flooring	9505	84558-MINOTAUR-BEACH SHELL-40 oz Poly ***STD***									
Comment											
Master Ensuite											
Cabinet Colour/Style	6467	Classic II-MANCHESTER-MACADAMIA-PAINT MDF ***UPG***									
Cabinet Hardware	2093	9671-HARDWARE ***STD***									
Countertop	8822	4924-38-Countertop-WHITE CARRARA-Wilsonart ***STD***									
Countertop Edge	1111	N/A *****									
Floor Tile	9103	GE.MD.LGR.1818.MT Madison Series Light Grey Matte 18 X 18 Matte ***1***									
Floor Tile Grout	9837	Grout-Warm Grey #5093 ***STD***									
Floor Tile Pattern	3000	STANDARD SQUARE ***STD***									
		<table><tr><td></td><td></td><td></td></tr><tr><td></td><td></td><td></td></tr><tr><td></td><td></td><td></td></tr></table>									



THURSHIKAH NAGARATNAM/MADUN THAYANITHY  
Project: Country Lane  
Unit: 7123, Phase: 7  
Model: 30-2794 A The Willowglen

Created: 7/22/2024 14:28:08  
Locked:  
Closed:

Shower Wall Tile	9020	QT.WV.WHT.0810-Weave-White-8 x 10 ***STD***
Shower Wall Tile Grout	9836	Grout-Eggshell #5220 ***STD***
Shower Wall Tile Pattern	3090	VERTICAL STACKED ***STD*** <div></div>
Shower Floor Tile	8661	OD.ON.SWT.0202.MT.N-Ontario Series Mosaic-Snow White Matte-2 x 2 ***STD***
Shower Floor Tile Grout	9840	Grout-Pearl Gray #5019 ***STD***
Shower Floor Tile Pattern	3000	STANDARD SQUARE ***STD*** <div></div>
Shower Jamb(s) and Sill(s)	8923	Shower Jamb / Sill-Thassos White ***STD***
Plumbing Fixture (colour)	1737	Plumbing Fixtures-WHITE ***STD***
Comment		

Shared Ensuite

Cabinet Colour/Style	9533	Viking III-TRINITY LPL-FREE SPIRIT L580K ***STD***
Cabinet Hardware	7672	135-HARDWARE ***STD***
Countertop	8801	P-344 LM-Countertop-INUKSHUK GREY-Arborite ***STD***
Countertop Edge	1111	N/A *****
Floor Tile	5494	GE.NA.GRY.1313-New Albion-Grey-13 x 13 ***STD***
Floor Tile Grout	9837	Grout-Warm Grey #5093 ***STD***
Floor Tile Pattern	3000	STANDARD SQUARE ***STD*** <div></div>
Wall Tile	5442	GE.NA.GRY.0810-New Albion-Grey-8 x 10 ***STD***
Wall Tile Grout	9836	Grout-Eggshell #5220 ***STD***
Wall Tile Pattern	3090	VERTICAL STACKED ***STD*** <div></div>
Opt. Shower Floor Tile	1111	N/A *****
Opt. Shower Floor Tile Grout	1111	N/A *****



THURSHIKAH NAGARATNAM/MADUN THAYANITHY  
Project: Country Lane  
Unit: 7123, Phase: 7  
Model: 30-2794 A The Willowglen

Created: 7/22/2024 14:28:38  
Locked:  
Closed:

Opt. Shower Floor Tile Pattern	1111	N/A *****
Opt. Shower Jamb(s) and Sill(s)	1111	N/A *****
Plumbing Fixture (colour)	1737	Plumbing Fixtures-WHITE ***STD***
Comment		

Ensuite 4

Cabinet Colour/Style	6261	Viking III-MANCHESTER-OYSTER CL-MAPLE ***STD***									
Cabinet Hardware	7669	169-HARDWARE ***STD***									
Countertop	8796	6698-46-Countertop-PALOMA POLAR ETCHINGS FINISH-Formica ***STD***									
Countertop Edge	1111	N/A *****									
Floor Tile	8228	GE.NA.TPE.1313-New Albion-Taupe-13 x 13 ***STD***									
Floor Tile Grout	9840	Grout-Pearl Gray #5019 ***STD***									
Floor Tile Pattern	3000	STANDARD SQUARE ***STD*** <table><tr><td></td><td></td><td></td></tr><tr><td></td><td></td><td></td></tr><tr><td></td><td></td><td></td></tr></table>									
Shower Wall Tile	8624	GE.NA.TPE.0810-New Albion-Taupe-8 inch x 10 inch ***STD***									
Shower Wall Tile Grout	9836	Grout-Eggshell #5220 ***STD***									
Shower Wall Tile Pattern	3090	VERTICAL STACKED ***STD*** <table><tr><td></td><td></td><td></td><td></td></tr><tr><td></td><td></td><td></td><td></td></tr></table>									
Shower Floor Tile	8661	OD.ON.SWT.0202.MT.N-Ontario Series Mosaic-Snow White Matte-2 x 2 ***STD***									
Shower Floor Tile Grout	9840	Grout-Pearl Gray #5019 ***STD***									
Shower Floor Tile Pattern	3000	STANDARD SQUARE ***STD*** <table><tr><td></td><td></td><td></td></tr><tr><td></td><td></td><td></td></tr><tr><td></td><td></td><td></td></tr></table>									
Shower Jamb(s) and Sill(s)	8923	Shower Jamb / Sill-Thassos White ***STD***									
Plumbing Fixture (colour)	1737	Plumbing Fixtures-WHITE ***STD***									
Comment											



THURSHIKAH NAGARATNAM/MADUN THAYANITHY  
Project: Country Lane  
Unit: 7123, Phase: 7  
Model: 30-2794 A The Willowglen

Created: 7/22/2024 14:28:38  
Locked:  
Closed:

Flooring	8262	TR.ST.GRY.1313-Serpentine-Grey-13x13 ***STD***									
Floor Tile Grout	9840	Grout-Pearl Gray #5019 ***STD***									
Floor Tile Pattern	3000	STANDARD SQUARE ***STD***									
		<table><tr><td></td><td></td><td></td></tr><tr><td></td><td></td><td></td></tr><tr><td></td><td></td><td></td></tr></table>									
Opt. Cabinet Colour/Style - Uppers	1111	N/A *****									
Opt. Cabinet Hardware - Uppers	1111	N/A *****									
Comment											

Lower Level Finished Foyer

Flooring	9505	84558-MINOTAUR-BEACH SHELL-40 oz Poly ***STD***
Comment		

Lower Level Recreation Room

Flooring	9505	84558-MINOTAUR-BEACH SHELL-40 oz Poly ***STD***
Comment	REC ROOM FIRE PLACE; STD ELECTRIC NF 17 NO SURROUND	

PG 21

Lower Level Bedroom

Flooring	9505	84558-MINOTAUR-BEACH SHELL-40 oz Poly ***STD***
Comment		

Lower Level Bathroom

Cabinet Colour/Style	6319	Viking III-MANCHESTER-CAVIAR CL-MAPLE ***STD***						
Cabinet Hardware	2093	9671-HARDWARE ***STD***						
Countertop	8827	4925K-07-Countertop-CALCUTTA MARBLE-Wilsonart ***STD***						
Countertop Edge	1111	N/A *****						
Floor Tile	8073	GE.RF.WHT.1313-Reflex-White-13 x 13 ***STD***						
Floor Tile Grout	9838	Grout-Bone #5015 ***STD***						
Floor Tile Pattern	3000	STANDARD SQUARE ***STD***						
		<table><tr><td></td><td></td><td></td></tr><tr><td></td><td></td><td></td></tr></table>						



THURSHIKAH NAGARATNAM/MADUN THAYANITHY  
Project: Country Lane  
Unit: 7123, Phase: 7  
Model: 30-2794 A The Willowglen

Created: 7/22/2024 14:28:38  
Locked:  
Closed:

Shower Wall Tile	9021	QT.WV.IVO.0810-Weave-Ivory-8 x 10 ***STD***	
Shower Wall Tile Grout	9836	Grout-Eggshell #5220 ***STD***	
Shower Wall Tile Pattern	3090	VERTICAL STACKED ***STD***	
Shower Floor Tile	8661	OD.ON.SWT.0202.MT.N-Ontario Series Mosaic-Snow White Matte-2 x 2 ***STD***	
Shower Floor Tile Grout	9838	Grout-Bone #5015 ***STD***	
Shower Floor Tile Pattern	3000	STANDARD SQUARE ***STD***	
Shower Jamb(s) and Sill(s)	8924	Shower Jamb / Sill-Vienna Beige ***STD***	
Plumbing Fixture (colour)	1737	Plumbing Fixtures-WHITE ***STD***	
Comment			

Main Stairs

Type	1712	Oak Stairs ***STD***
Colour	9796	Hillside STAIN TO COMPLIMENT HARDWOOD AND WILL VARY FROM FLOORING ***99***-STD
Handrail/Pickets/Posts Type	8148	Single Collar Alt. Plain w/ Shoes with 3 1/2 Square/Cap Post(s)-BLACK ***STD***
Handrail/Pickets/Posts Colour	9796	Hillside STAIN TO COMPLIMENT HARDWOOD AND WILL VARY FROM FLOORING ***99***-STD
Custom Stain/Paint	1111	N/A *****
Landing(s)	9009	Red Oak PEARL-Vintage Red Oak Solid Sculpted Character PEARL-HILLSIDE-3/4 inch X 5 inch ***STD***
Opt. Carpet Runner	1111	N/A *****
Comment		

Lower Level Stairs

Type	1712	Oak Stairs ***STD***
Colour	9796	Hillside STAIN TO COMPLIMENT HARDWOOD AND WILL VARY FROM FLOORING ***99***-STD
Handrail/Pickets/Posts Type	8148	Single Collar Alt. Plain w/ Shoes with 3 1/2 Square/Cap Post(s)-BLACK ***STD***
Handrail/Pickets/Posts Colour	9796	Hillside STAIN TO COMPLIMENT HARDWOOD AND WILL VARY FROM FLOORING ***99***-STD
Custom Stain/Paint	1111	N/A *****



Customer Colours

THURSHIKAH NAGARATNAM/MADUN THAYANITHY  
Project: Country Lane  
Unit: 7123, Phase: 7  
Model: 30-2794 A The Willowglen

10 of 44





Created: 7/22/2024 14:28:30

Locked:  
Closed:

Landing(s)	9009	Red Oak PEARL-Vintage Red Oak Solid Sculpted Character PEARL-HILLSIDE-3/4 inch X 5 inch ***STD***
Opt. Carpet Runner	1111	N/A *****
Comment		

Throughout

Switches and Plug	5796	Decora White Switches and Plugs ***STD***
Thresholds	2232	Metal Thresholds ***STD***
Underpad	1079	500 Series-Underpad ***STD***
Trim Size	8704	5 1/4 inch Baseboard and 3 inch Integrated Backbend Casings ***UPG*** / ***STD in Singles***
Trim - Paint Colour	1716	Trim-WHITE ***STD***
Walls - Paint Colour	1717	22-Wall-WARM GREY ***STD***
Comment		

Purchaser:		11/11/2024		Nov. 11 24
	THURSHIKAH NAGARATNAM	Date	Decor Consultant	Date
				
Purchaser:		11/11/24		-12- 05 2024
	MADUN THAYANITHY	Date	Country Lane	Date Approved





CONSTRUCTION SUMMARY

Lot: 7123  
Model: 30-2794 A The Willowglen  
Project/Phase: Country Lane / 7

Offer Worksheet	Classic Collection: Five Appliances: SS Fridge, Stove, Dishwasher: White Front Loader Washer/Dryer (Singles) Note:
Offer Worksheet	This is a Deck Grading Condition that includes a deck with steps to grade. Note:
Offer Worksheet	Supply and Install Central Air Conditioning Note:
Offer Worksheet	NINE THOUSAND (\$9,000.00) DOLLARS AT DECOR. (NO CASH VALUE) Note:
Offer Worksheet	Two Men and a Truck Credit of One Thousand Dollars (\$1000.00) for moving services only, Into your Heathwood Home (No Cash Value) The Credit is Non-Transferable and cannot be combined with any other offer. - Singles Note:
Offer Worksheet	The Purchaser(s) are a 2nd Time Heathwood buyer, whom lived or have lived at (COUNTRY LANE- PHASE 4, 32 GILLIVARY DR, LOT #544) and are entitled to \$1000 to spend at The Decor Store( No Cash Value). Note:





CONSTRUCTION SUMMARY

Lot: 7123  
Model: 30-2794 A The Willowglen  
Project/Phase: Country Lane / 7

ADMIN FEE

Invoice	Qty.	Description
---------	------	-------------

APPLIANCES

Invoice	Qty.	Description
1792	1.0	KITCHEN/BREAKFAST - APPLIANCES - STD CYCLONE SCB 51430
03Apr25 NoCat		SUPPLY AND INSTALL EXTENSION TO CHIMNEY DUE TO STACKED UPPER CABINETS IN THIS MODEL

CABINETRY

Invoice	Qty.	Description
1732 714,488 03Apr25	1.0	KITCHEN - CABINETRY - 1L-TWO-TONE COLOUR/STYLE SELECTION FOR ISLAND (MUST BE OF EQUAL OR LOWER LEVEL TO MAIN SELECTION)-VIKING  VIKING IV CHANGED TO CLASSIC II MANCHESTER AT NO ADDITIONAL COST TO PURCHASER AS PER FRENDEL. VIKING IV WESTPORT CABINETS HAVE BEEN DISCONTINUED AFTER SELECTION WAS MADE
1732 389,866 03Apr25 **	1.0	KITCHEN - PLUMBING - KITCHEN SINK UPGRADE - BLANCO QUATRUS U 1 SUPER SINGLE 401248 (MIN CABINET 36 IN)  SEE SPECS <b>CABINETRY-upgraded kitchen sink; GRANITE-upgraded kitchen sink</b>
1732 714,472 03Apr25	1.0	KITCHEN - CABINETRY - 32H-WALL CABINET WITH SHELF FOR MICROWAVE (FINISHED INTERIOR) (OPENING 24inW X 13 3/4inH X 17inD) (NOT AVAILABLE IN SOME LAMINATES)-VIKING  CABINETS HAVE BEEN UPGRADED FROM VIKING IV WESTPORT WINTER WHITE TO CLASSIC II MANCHESTER WINTER WHITE AT NO COST TO PURCHASER PER FRENDEL AS WESTPORT CABINET HAS BEEN DISCONTINUED SEE SKETCH # 3
1732 714,590 03Apr25	1.0	KITCHEN/SERVERY - CABINETRY-3A-Stacked upper for 30cm standard depth (includes stack moulding between cabinets) -Standard Plan including Pantry in Servery (66cm at deep fridge uppers) VIKING  SKETCH # 3 <b>Appliance-Extension to Chimney Hoodfan</b>
1732 700,097 03Apr25	1.0	KITCHEN/SERVERY/BREAKFAST - CABINETRY - KIT/SERVERY -VIKING IV-UPG  SELECTION HAS BEEN UPGRADED TO CLASSIC II MANCHESTER PAINT CABINETS AT NO ADDITIONAL COST TO PURCHASER AS PER FRENDEL DUE TO ORIGINAL VIKING IV WESTPORT CABINETRY DISCONTINUED AFTER SELECTION WAS MADE BY PURCHASER
1732 714,446 03Apr25	2.0	MASTER ENSUITE - CABINETRY - 4D-INCREASE VANITY TO KITCHEN HEIGHT GREATER THAN 3ft (90CM HIGH, MAINTAINS VANITY DEPTH)-VIKING  SKETCH # 5
1732 700,100 03Apr25	1.0	MASTER ENSUITE - CABINETRY - PRINCIPAL ENSUITE-VIKING IV-UPG  VIKING IV WESTPORT IS DISCONTINUED CLASSIC II MANCHESTER MACADAMIA PAINTED MDF DOOR TO REPLACE AT NO ADDITIONAL CHARGE TO PURCHASER





CONSTRUCTION SUMMARY

Lot: 7123  
Model: 30-2794 A The Willowglen  
Project/Phase: Country Lane / 7

CERAMICS

Invoice	Qty.	Description
1732 702,668 03Apr25	1.0	Kitchen - CERAMIC - KITCHEN - BACKSPLASH SINGLES - HERRINGBONE - UPG
1732 702,554 03Apr25	1.0	Kitchen/Breakfast - CERAMIC - KITCHEN/BREAKFAST - FLOOR - UG 3 - UPG
1732 702,522 03Apr25	1.0	Master Bath - CERAMIC - MASTER BATH - FLOOR - UG 1 - UPG
1732 702,555 03Apr25	1.0	Servery - CERAMIC - SERVERY - FLOOR - UG 3 - UPG
1732 702,551 03Apr25	1.0	Foyer - CERAMIC - FOYER - FLOOR - UG 3 - UPG
1732 702,552 03Apr25	1.0	Powder - CERAMIC - POWDER - FLOOR - UG 3 - UPG

DRYWALL

Invoice	Qty.	Description
1732 714,607 03Apr25 **	1.0	THROUGHOUT - CLASSIC COLLECTION SCHEDULE A - Choice of 20 LED (4000K) pot lights in finished areas (Second Floor Potlight(s) Require Smooth Ceiling) DRYWALL-Drywall Ceiling cutouts for potlights FRAMING-Frame to accommodate potlights 4X GREAT ROOM, USE STD. SWITCH PLUG 3X KITCHEN- USE SEPARATE SWITCH , RELOCATE STD. LIGHT 3X BREAKFAST ROOM, USE EXISTING SWITCH, RELOCATE STD. LIGHT 4X DINING ROOM-USE SEPARATE SWITCH KEEP STD. R/I CAP LIGHT 4X HALL WAY, USE EXISTING 3 WAY SWITCH, RELOCATE 1 LIGHT (POWDER ROOM LANDING) 1X POWDER ROOM- USE TOGETHER WITH STD. LIGHT , KEEP STD. LIGH T 1X UPPRT BASEMENT STAIR LANDING - USE STD. BASEMENT 3 WAY SWITCH SEE SKETCH # 2





CONSTRUCTION SUMMARY

Lot: 7123  
Model: 30-2794 A The Willowglen  
Project/Phase: Country Lane / 7

ELECTRICAL

Invoice	Qty.	Description
1732 390,516 03Apr25	1.0	KITCHEN - ELECTRICAL-OUTLET-EXTRA WALL INTERIOR OUTLET (120V/15A) ON A SEPARATE CIRCUIT (ON ARCAFAULT)  TO BE USED FOR THE MICROWAVE SHELF SEE SKETCH # 2 AND 3
1732 390,519 03Apr25	2.0	THROUGHOUT - ELECTRICAL-OUTLET-EXTRA WALL INTERIOR OUTLET ON EXISTING CIRCUIT (DOES NOT INCLUDE KITCHEN OUTLETS)  1X GREAT ROOM 1X REC ROOM TO BE INSTALLED ABOVE THE FIRE PLACE 70+- FROM FLOOR SEE SKETCH # 1 AND 2
1732 390,528 03Apr25	3.0	THROUGHOUT - ELECTRICAL-RELOCATION OF SWITCHES/LIGHTS (MUST SPECIFY LOCATION)-NOTE: PLUGS CANNOT BE RELOCATED- MUST PURCHASE ADDITIONAL OUTLET.  RLOCATE HALLWAY LIGHT (POWDER ROOM LANDING ) TO BE ABOVE THE SECOND FLOOR STAIRS- USE STD. UPPER HALL WAY 3 WAY SWITCH RELOCATE KITCHEN AND BREAKFAST ROOM LIGHT TO BE ABOVE THE ISLAND -USE STD. KITCHEN SWITCH SEE SKETCH #S 2 AND 4
1732 390,496 03Apr25	1.0	KITCHEN/BREAKFAST - ELECTRICAL-CEILING ROUGH-IN (CAPPED)  TO BE INSTALLED ABOVE THE BREAKFAST BAR-SWITCH TOGETHER WITH RELOCATED LIGHT SEE SKETCH # 2
1732 714,607 03Apr25	1.0	THROUGHOUT - CLASSIC COLLECTION SCHEDULE A - Choice of 20 LED (4000K) pot lights in finished areas (Second Floor Potlight(s) Require Smooth Ceiling) DRYWALL-Drywall Ceiling cutouts for potlights FRAMING-Frame to accommodate potlights 4X GREAT ROOM, USE STD. SWITCH PLUG 3X KITCHEN- USE SEPARATE SWITCH , RELOCATE STD. LIGHT 3X BREAKFAST ROOM, USE EXISTING SWITCH, RELOCATE STD. LIGHT 4X DINING ROOM-USE SEPARATE SWITCH KEEP STD. R/I CAP LIGHT 4X HALL WAY, USE EXISTING 3 WAY SWITCH, RELOCATE 1 LIGHT (POWDER ROOM LANDING) 1X POWDER ROOM- USE TOGETHER WITH STD. LIGHT , KEEP STD. LIGH T 1X UPPRT BASEMENT STAIR LANDING - USE STD. BASEMENT 3 WAY SWITCH SEE SKETCH # 2

FRAMING

Invoice	Qty.	Description
1732 714,607 03Apr25 **	1.0	THROUGHOUT - CLASSIC COLLECTION SCHEDULE A - Choice of 20 LED (4000K) pot lights in finished areas (Second Floor Potlight(s) Require Smooth Ceiling) DRYWALL-Drywall Ceiling cutouts for potlights FRAMING-Frame to accommodate potlights 4X GREAT ROOM, USE STD. SWITCH PLUG 3X KITCHEN- USE SEPARATE SWITCH , RELOCATE STD. LIGHT 3X BREAKFAST ROOM, USE EXISTING SWITCH, RELOCATE STD. LIGHT 4X DINING ROOM-USE SEPARATE SWITCH KEEP STD. R/I CAP LIGHT 4X HALL WAY, USE EXISTING 3 WAY SWITCH, RELOCATE 1 LIGHT (POWDER ROOM LANDING) 1X POWDER ROOM- USE TOGETHER WITH STD. LIGHT , KEEP STD. LIGH T 1X UPPRT BASEMENT STAIR LANDING - USE STD. BASEMENT 3 WAY SWITCH SEE SKETCH # 2

GRANITE

Invoice	Qty.	Description
1732 389,866 03Apr25 **	1.0	KITCHEN - PLUMBING - KITCHEN SINK UPGRADE - BLANCO QUATRUS U 1 SUPER SINGLE 401248 (MIN CABINET 36 IN)  SEE SPECS <b>CABINETRY-upgraded kitchen sink; GRANITE-upgraded kitchen sink</b>
1732 711,585 03Apr25	1.0	KITCHEN/SERVERY - GRANITE - KITCHEN - GROUP 2 WITH 1 1/2 IN MITER EDGE - UPG





CONSTRUCTION SUMMARY

Lot: 7123  
Model: 30-2794 A The Willowglen  
Project/Phase: Country Lane / 7

PLUMBING

Invoice	Qty.	Description
1732 389,866 03Apr25	1.0	KITCHEN - PLUMBING - KITCHEN SINK UPGRADE - BLANCO QUATRUS U 1 SUPER SINGLE 401248 (MIN CABINET 36 IN)  SEE SPECS <b>CABINETRY-upgraded kitchen sink; GRANITE-upgraded kitchen sink</b>

STRUCTURED WIRING

Invoice	Qty.	Description
1732 389,577 03Apr25	1.0	GREAT ROOM - STRUCTURED WIRING - RELOCATION OF TV/PHONE  RELOCATE CAT6E TO BE ABOVE THE FIRE PLACE 70" FROM FLOOR SEE SKETCH # 2



Sketch # 1



30-2794 ELEV. A

The Willowglen

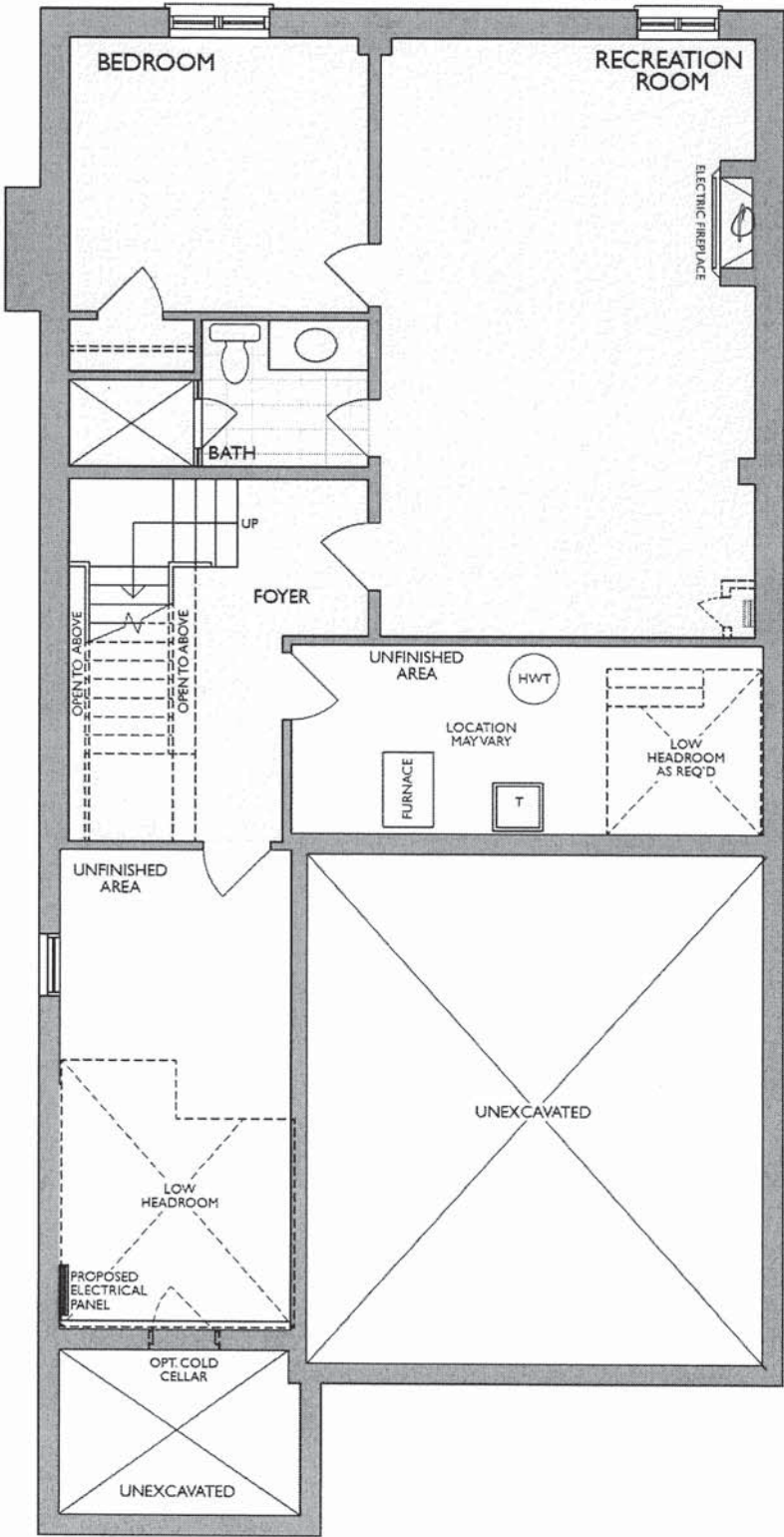

ELECTRICAL OUTLET  
ABOVE THE FIREPLACE 70  
+/- FROM FLOOR

FINISHED LOWER LEVEL  
ELEV. A & B

- Changes made to match the Architectural plan:**
- 1. Hydro closet when required

\* Floor plan may vary due to grading conditions.

MT 8



TRADITIONS  
OF COUNTRY LANE

30-2794 ELEV. A

Sketch #2

The Willowglen

3 POTLIGHTS ON STD 3 WAY SWITCH

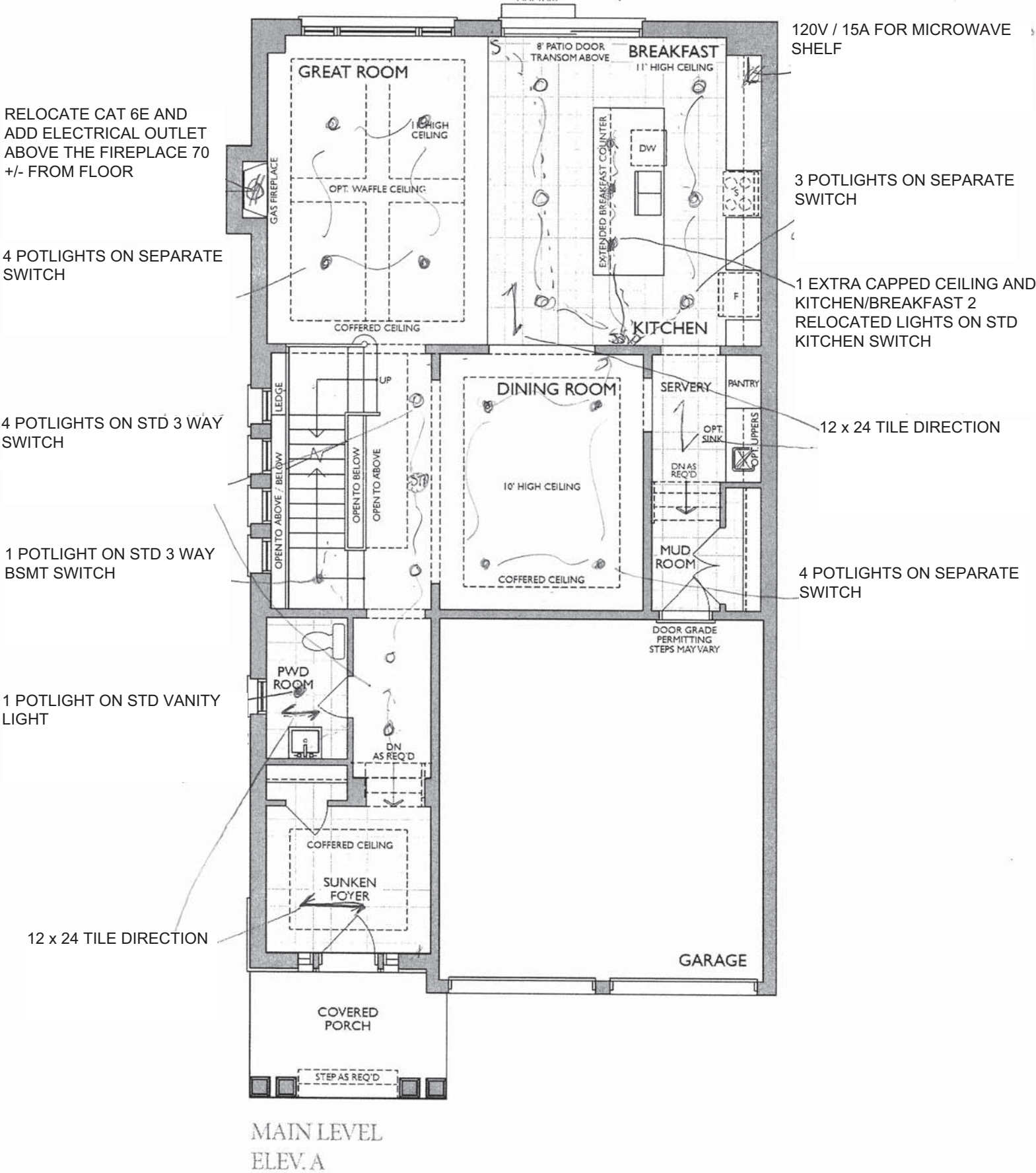

\* Floor plan may vary due to grading conditions.

MT 8



Project: Country Lane  
Unit: 7123, Phase: 7  
Model: 30-2794 A The Willowglen

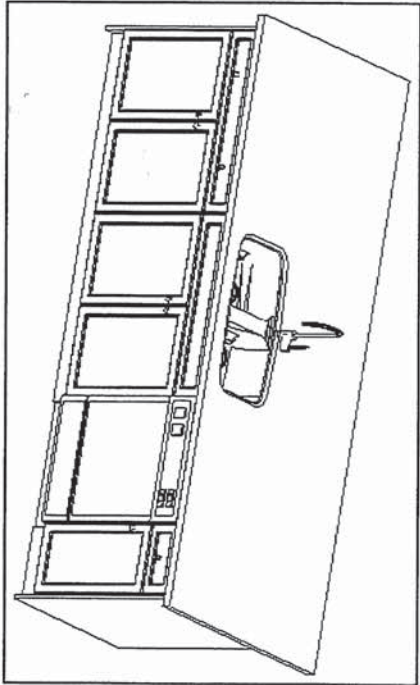
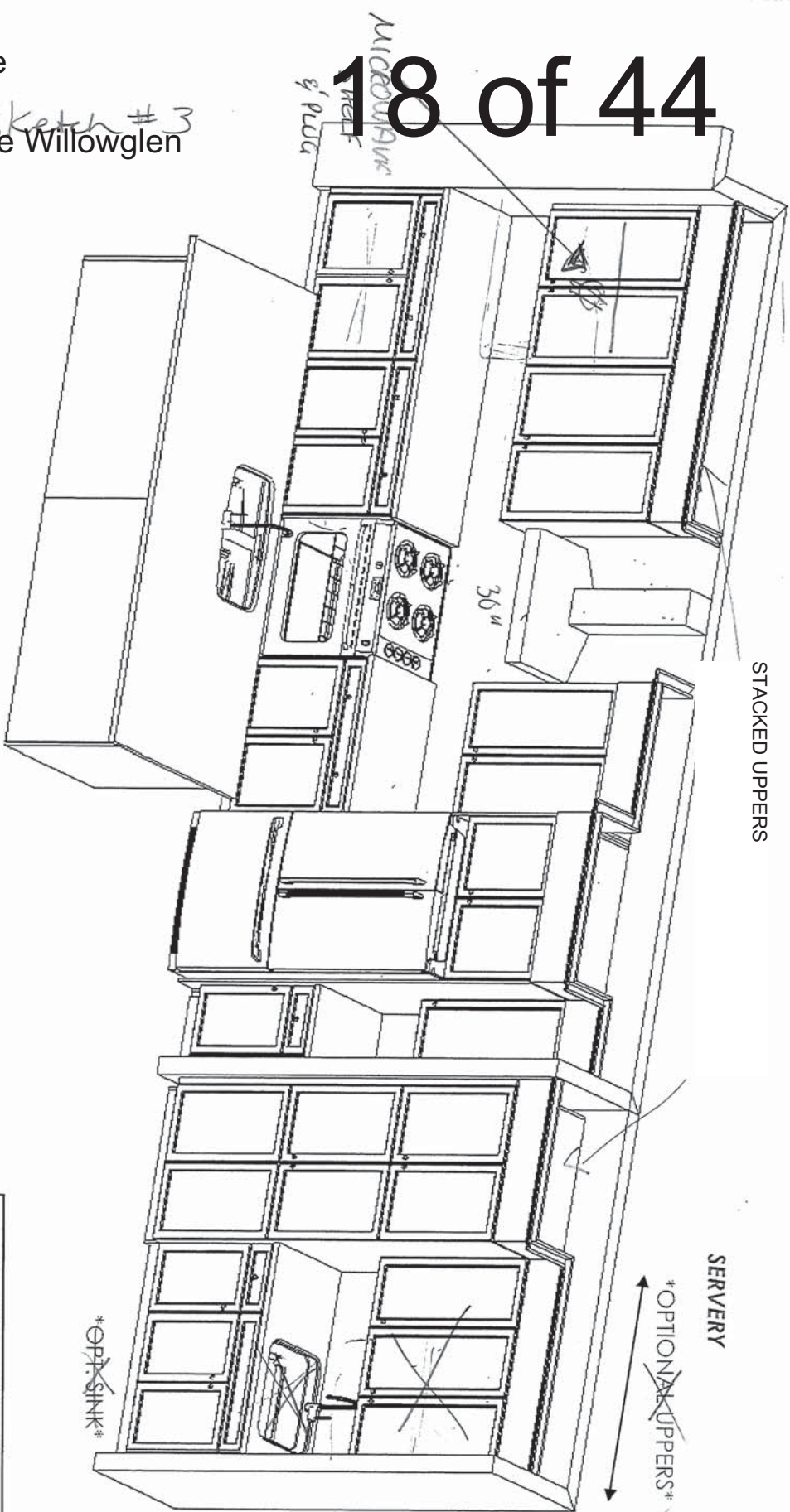

This sketch is for DESIGN PURPOSES ONLY – It is not meant to be an exact rendition.

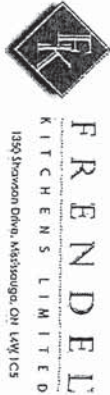

HEATHWOOD HOMES  
COUNTRY LANE, WHITBY  
TRADITIONS  
MODEL: 30-2794 (3604)  
THE CLASSIC SERIES

- Standard Features:
- Tandem Box Soft Close Drawers
  - Blumotion Hinges for Doors
  - Crown Moulding & fascia
  - Top Drawer Construction
  - Deep Fridge Upper w/Deep Panel
  - Tall upper Cabinets

Drawn By: Sepideh B  
Date: April 8, 2024  
Revision:  
Scale: Not To Scale

Approved By Builder:

Date:



Sketch # 4



30-2794 ELEV. A

The Willowglen

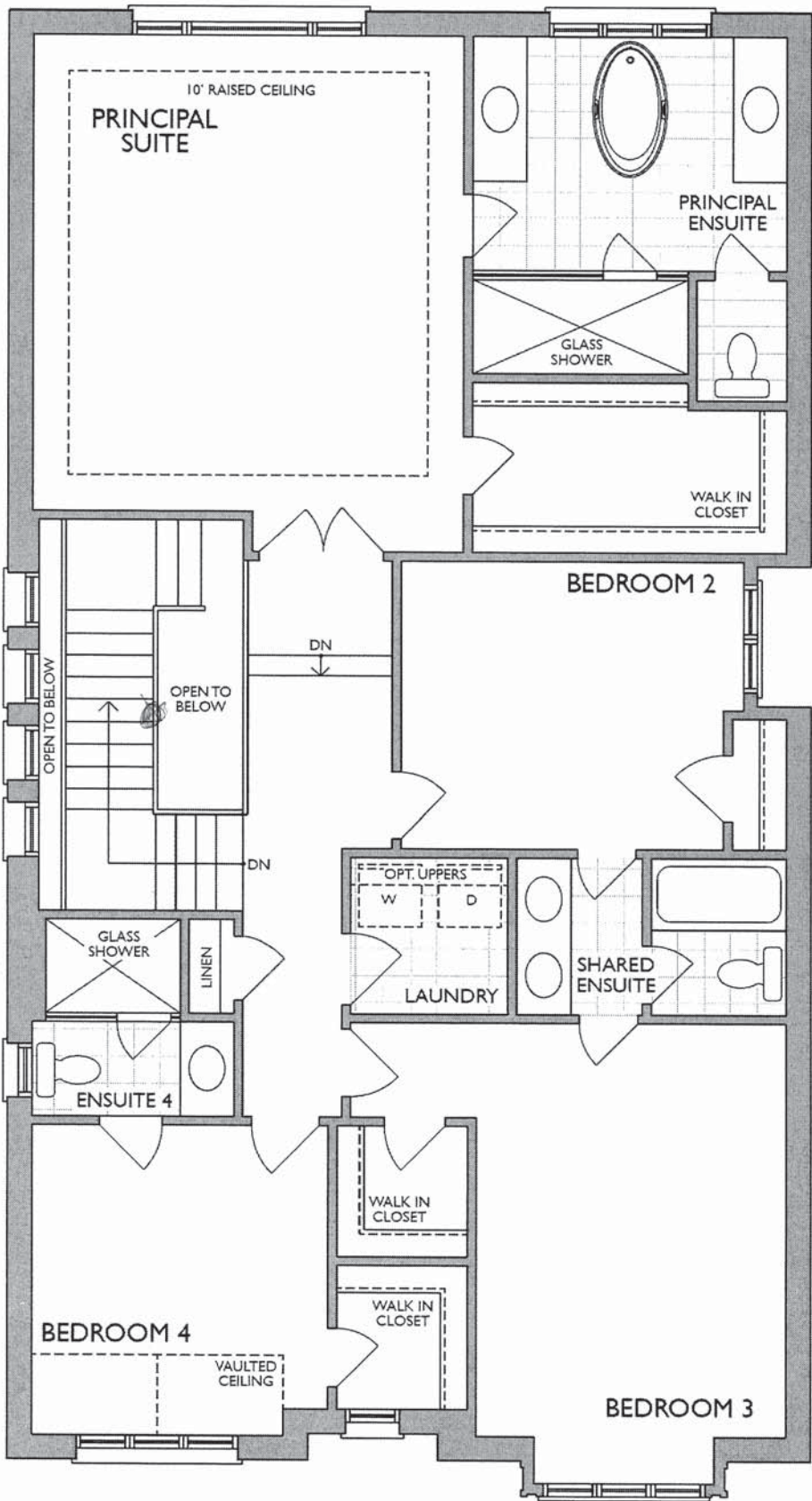

CAPPED LIGHT AT OPEN TO BELOW RELOCATED FROM MAIN HALL ON STD 3 WAY SWITCH FOR UPPER HALL LIGHTS

SECOND LEVEL  
ELEV. A

\* Floor plan may vary due to grading conditions.

MS 8



Project: Country Lane  
Unit: 7123, Phase: 7  
Model: 30-2794 A The Willowglen

Sketch #5

MASTER ENSUITE  
2nd FLR

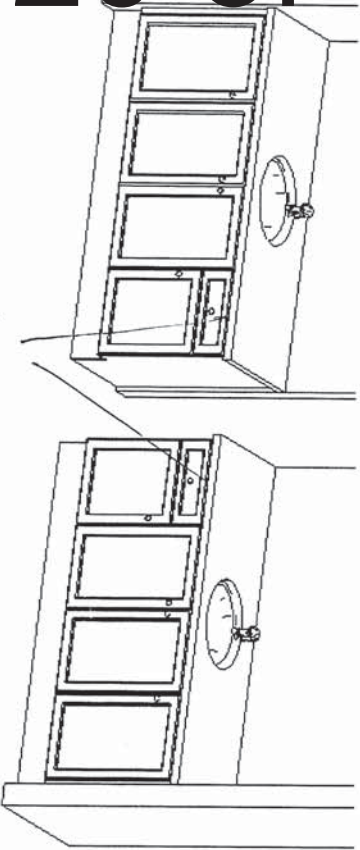

INCREASE TO KITCHEN HEIGHT

MAIN/SHARED BATH  
2nd FLR

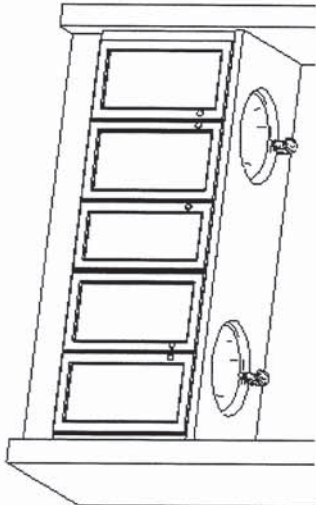

ENSUITE 4  
2nd FLR

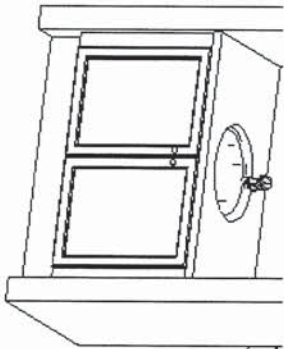

BASEMENT BATH

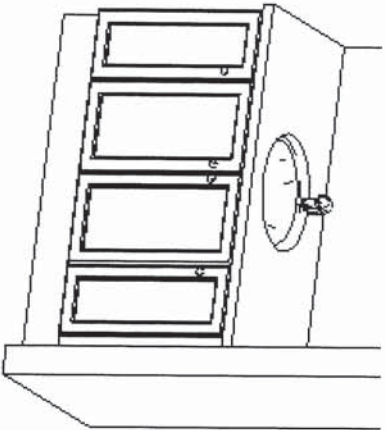

LAUNDRY  
2nd FLR

OPTIONAL LAUNDRY UPPERS

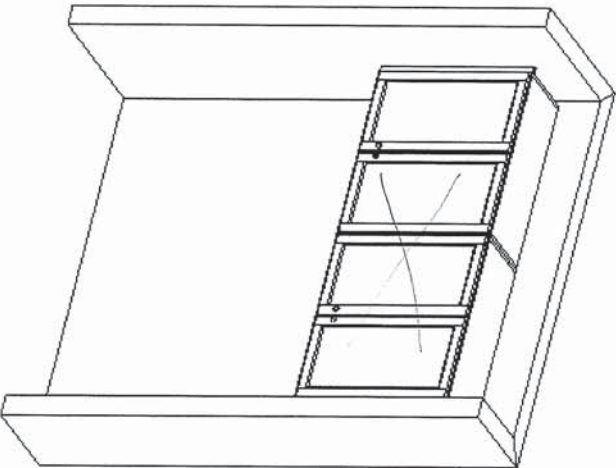

This sketch is for DESIGN PURPOSES ONLY – It is not meant to be an exact rendition.

MT

 F R E N D E L K I T C H E N ' S L I M I T E D 1350 Brown Drive, Mississauga, ON L4W 1C5	HEATHWOOD HOMES COUNTRY LANE, WHITBY TRADITIONS MODEL: 30-2794 (3604) THE CLASSIC SERIES	Standard Features: <ul style="list-style-type: none"><li>• Blum Metabox Drawers</li><li>• Blum Clip On Hinges</li><li>• Top drawer in Master Ensuite</li><li>• Laminate tops</li></ul>	Drawn By: Sepideh B Date: April 8, 2024 Revision: Scale: Not To Scale	Approved By Builder:   Date:   
--	--	--	--	---





NEAS NF17 Mantel

FLAT WALL FOR GREAT ROOM

CABINET FOR LOWER REC ROOM ELECTRIC  
FIREPLACE



BLANCO

Sink Specifications

Colour	SKU
brushed finish	401248

Design and planning tips

- Min cabinet size: 36 in ( 915 mm )
- Bowl Depth: 9 in ( 230.0 mm )

Specifications:  
Installation clips, Sink template, Installation instructions, 3 ½" (90 mm) stainless steel strainer

Depending on cabinet construction, a different cabinet size may be required. Consult the cabinet manufacturer.

Codes/Standards: ASME A112.19.3-2017/ CSA B45.4-17

Optional Accessories

Elevated Grid	406346
Workstation	406344
CapFlow Strainer Cover	517666
Ash Cutting Board	406345
Sink Grid	402125

QUATRUS U 1 SUPER SINGLE  
Stainless steel brushed finish

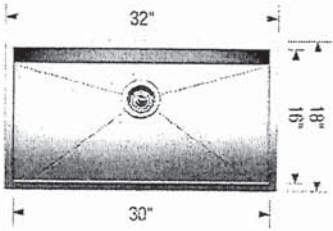

Warranty  
Limited lifetime warranty on all sinks and faucets. One-year warranty on all accessories and soap dispensers.

Code/Standards Compliance  
BLANCO sinks and faucets are third-party tested and certified to CSA, cUPC, ANSI/ASME, IAPMO and NSF standards and listed by applicable certification bodies. For more information on individual product listings, contact our office or listing organization.

 Need support? Learn more by watching our sink & faucet How-to videos:  
<https://www.blanco.com/ca-en/support/how-to-videos/how-to-videos-for-sinks/>

	BLANCO Canada Inc 100 Corporation Drive Brampton ON L6S 6B5	Tel & Fax Tel: 905-494-2400 Toll free: 1-877-425-2626 Fax: 905-494-2425 Toll free: 1-877-825-2626
---	---	---

While BLANCO strives to provide accurate information, all images and dimensions in this document are intended for reference only and are subject to change at any time without notice. This document is not intended for use as an installation guide. For technical installation details, refer to installation instructions provided with the product. BLANCO assumes no responsibility for the use of superseded or voided specifications.



**MOEN®**

## Specifications

### FAUCET DESCRIPTION

- Reflex™ pulldown system offers smooth operation, easy movement and secure docking
- Power Clean™ spray technology
- Metal construction with various finishes identified by suffix
- Quick connect installation
- Pulldown spray with 68" braided hose
- Flexible supply lines with 3/8" compression fittings
- High arc spout provides height and reach to fill or clean large pots while pulldown wand provides the maneuverability for cleaning or rinsing
- 360° rotating spout
- Faucet designed for handle to be mounted on right side only

### OPERATION

- Lever style handle
- Temperature controlled by 100° arc of handle travel
- Operates with less than 5 lbs. of force
- Operates in stream or spray mode in the pullout or retracted position

### FLOW

- Flow is limited to 1.5 gpm (5.7 L/min) max at 60 psi

### CARTRIDGE

- 1255™ Duralast™ cartridge

### STANDARDS

- Third party certified to IAPMO Green, ASME A112.18.1/CSA B125.1 and all applicable requirements therein including NSF 61/9G & 372
- Meets CalGreen and Georgia SB370 requirements
- Complies with California Proposition 65 and with the Federal Safe Drinking Water Act
- The backflow protection system in the device consists of two independently operating check valves, a primary and a secondary which prevent backflow
- ADA  for lever handle

### WARRANTY

- Lifetime limited warranty against leaks, drips and finish defects to the original homeowner
  - 10 year limited warranty when used in a multifamily installation
  - 5 year limited warranty when used in a commercial installation
- Visit [www.moen.com/support](http://www.moen.com/support) for complete details and limitations

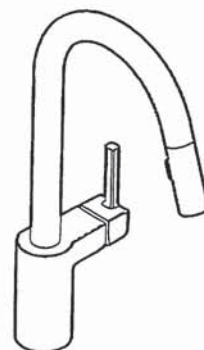

**ALIGN™**  
**Single Handle High Arc**  
**Pulldown Kitchen Faucet**

**Models:** 7565 series

**NOTE:** THIS FAUCET IS DESIGNED TO BE INSTALLED  
THROUGH 1 HOLE, 1-1/2" (38mm) MIN. DIA.  
(OPTIONAL 3-HOLE ESCUTCHEON 141002 AVAILABLE)

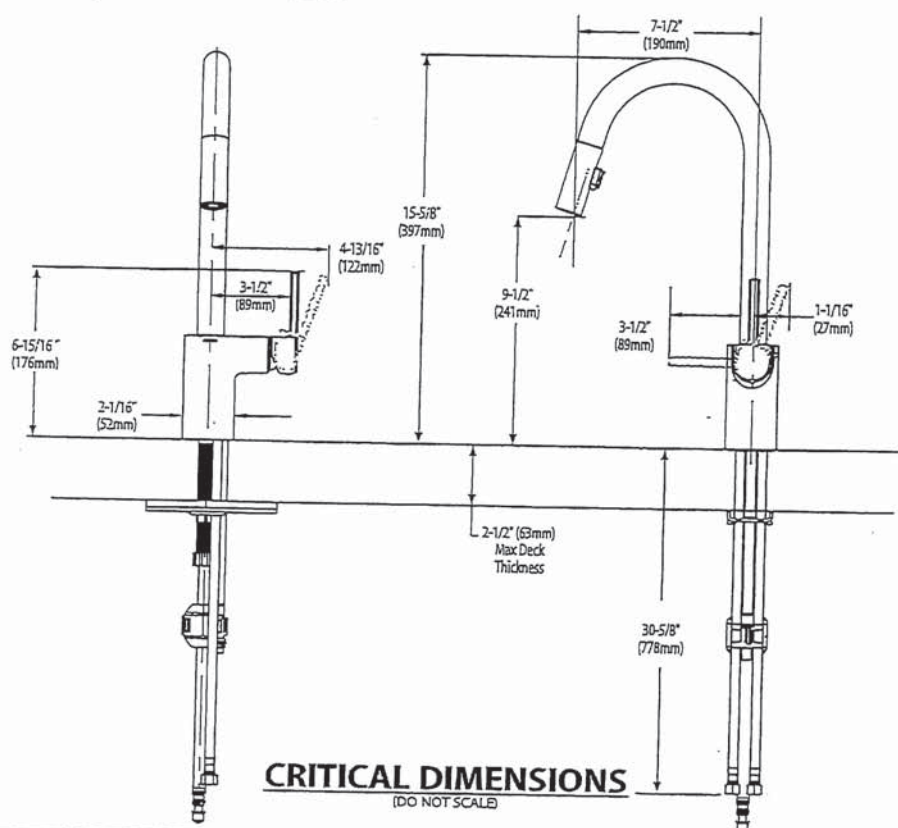



*American  
Standard*

 BARRIER FREE (ABOVE COUNTER OR DROP-IN ONLY)

**BOULEVARD®**  
**PEDESTAL SINK**  
VITREOUS CHINA

**BOULEVARD® PEDESTAL SINK**

- STD ☒ ~~0641.800~~ Faucet holes on 8" (203mm) centers (Illustrated)
- ☒ ~~0641.400~~ Faucet holes on 4" (102mm) centers
- ☒ ~~0641.100~~ Center hole only
- Classic styled rectangular pedestal lavatory
  - Vitreous china
  - Rear overflow
  - Supplied with mounting kit
  - Right Height® for greater comfort during use
  - Faucet ledge with large deck area (faucet not included)
  - **Design coordinates with Boulevard® Toilet**
  - Basin has flat bottom to also allow use as an **above counter** sink or a **drop-in** sink (with u-shaped cut out)

**Nominal Dimensions:**

24" x 19" x 35-1/2"

(610 x 483 x 902mm)

- ☐ **0641.008** Pedestal top-8" (203mm) centers
- ☐ **0641.004** Pedestal top-4" (102mm) centers
- ☐ **0641.001** Pedestal top-center hole only
- ☐ **0010.000** Pedestal only

**Bowl sizes:**

17" (432mm) wide,

12-1/2" (318mm) front to back,

5" (127mm) deep

**Compliance Certifications -**

**Meets or Exceeds the Following Specifications:**

- ASME A112.19.2 - 2008/CSA B45.1-08

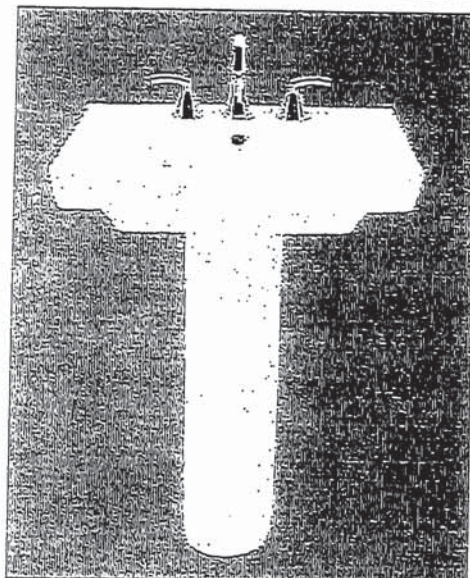

SEE REVERSE FOR ROUGHING-IN DIMENSIONS

**To Be Specified:**

- ☐ Color: ☐ White ☐ Linen
- ☐ Faucet Finish:
- ☐ Supplies:
- ☐ 1-1/4" Trap:
- ☐ Nipple:

\* See faucet section for additional models available

8 11.5



American  
Standard

 BARRIER FREE (ABOVE COUNTER OR DROP-IN ONLY)

BOULEVARD®  
PEDESTAL SINK  
VITREOUS CHINA

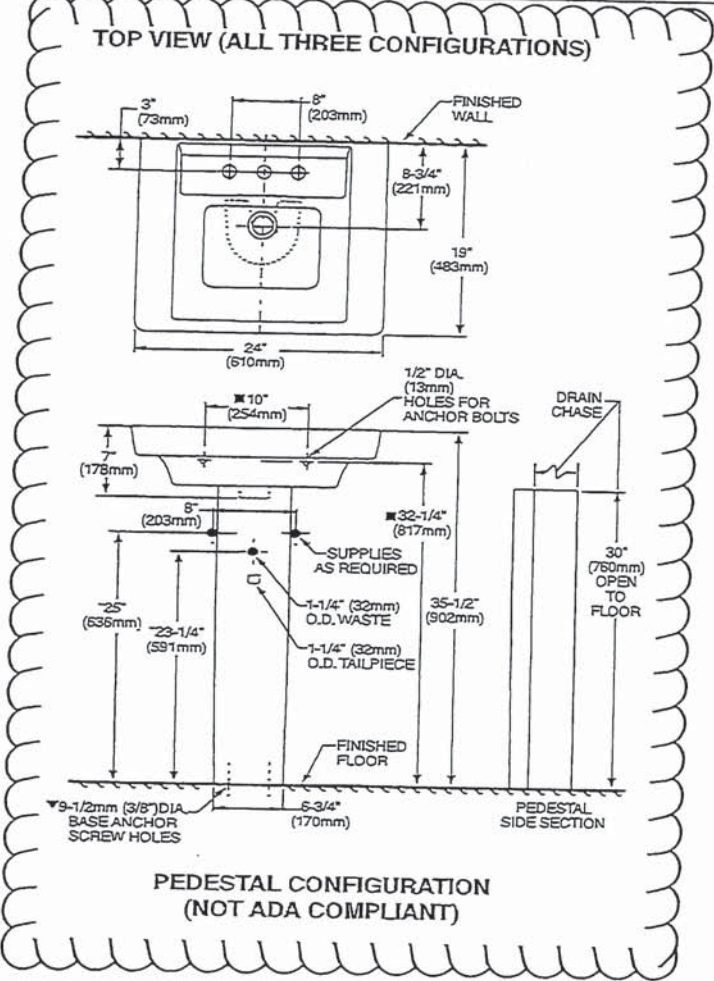

ABOVE COUNTER CONFIGURATION

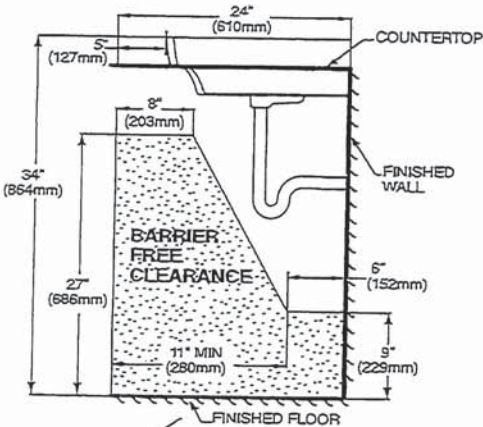
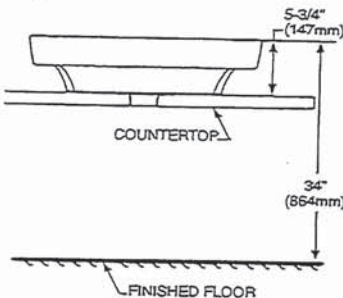

DROP-IN SINK CONFIGURATION



ABOVE COUNTER AND DROP-IN SINK CONFIGURATIONS  
MEET THE AMERICANS WITH DISABILITIES ACT GUIDELINES  
AND ANSI A117.1 ACCESSIBLE AND USABLE  
BUILDINGS AND FACILITIES - CHECK LOCAL CODES.  
Top of sink installed at 34" (864mm) height from finished floor.  
Sink installed 5" (127mm) minimum from front edge of countertop.  
Provide 27" (686mm) knee clearance area.

NOTES:  
\* DIMENSIONS SHOWN FOR LOCATION OF SUPPLIES AND "P" TRAPS ARE SUGGESTED.  
▼ PEDESTAL ANCHORING SCREWS NOT INCLUDED.  
■ SUITABLE FOR REINFORCEMENT ONLY. ACTUAL DIMENSIONS MUST BE TAKEN FROM FIXTURE.  
FITTING NOT INCLUDED AND MUST BE ORDERED SEPARATELY.  
PROVIDE SUITABLE REINFORCEMENT FOR ALL WALL SUPPORTS.  
INSTALLATION INSTRUCTIONS SUPPLIED WITH LAVATORY.

IMPORTANT: Dimensions of fixtures are nominal and may vary within the range of tolerance established by ANSI Standard A112.19.2  
These measurements are subject to change or cancellation. No responsibility is assumed for use of superseded or voided pages.

MT 8



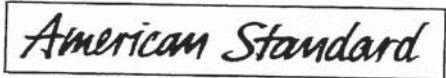

**BARRIER FREE**

**COLONY™**  
**COUNTERTOP SINK**  
VITREOUS CHINA

**COLONY COUNTERTOP SINK**

- Vitreous china
- Self-rimming
- Front overflow
- Supplied with template
- Faucet deck
- (Faucet shown not included)

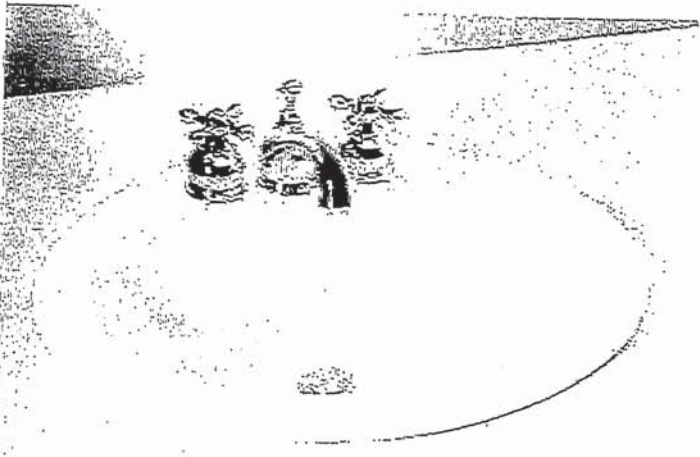

☐ **0346 803**

Faucet holes on 203mm (8") centres

☐ **0346 403 (Illustrated)**

Faucet holes on 102mm (4") centres

☐ **0346 001**

Centre hole only

Nominal Dimensions:  
521 x 448mm (20-1/2" x 17-5/8")

Bowl sizes:  
422mm (16-5/8") wide, 279mm (11") front to back, 143mm (5-5/8") deep

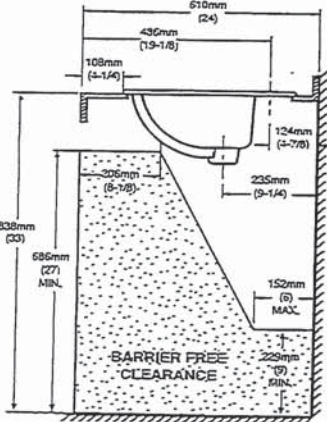
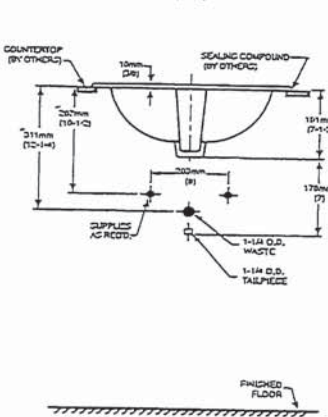
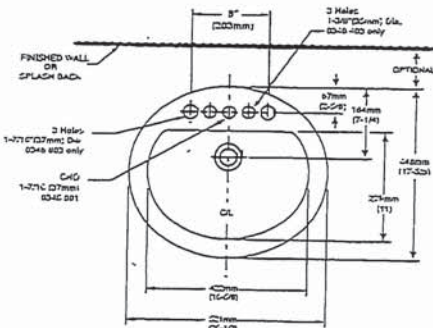

**COMPLIANCE CERTIFICATIONS –**  
Meets or exceeds the following Specifications:  
• ASME A112.19.2M for Vitreous China Fixtures.  
• CAN/CSA B45 Series.

To Be Specified

☐ Colour: ☐ White ☐ Bone ☐ Silver Gray ☐ Linen

☐ Faucet\*:

☐ Faucet Finish:

☐ Supplies & Stops:

☐ Trap 1-1/4" (32 mm):

**NOTES:**  
\* DIMENSIONS SHOWN FOR LOCATION OF SUPPLIES AND "P" TRAP ARE SUGGESTED. FOR COUNTERTOP CUTOUT AND INSTALLATION INSTRUCTIONS USE TEMPLATE SUPPLIED WITH SINK.  
FAUCETS NOT INCLUDED AND MUST BE ORDERED SEPARATELY.  
IMPORTANT: Dimensions of fixtures are nominal and may vary within the range of tolerances established by ANSI Standard A112.19.2.  
These measurements are subject to change or cancellation. No responsibility is assumed for use of superseded or voided pages.

\* See faucet section for additional models available

M.T





DEMI™  
Product Specification Sheet

Two Piece Freestanding Collection

CF2007	Two Piece Freestanding Soaker
Size:	60" x 32" x 22" 1524 mm x 813 mm x 559 mm

PRODUCT FEATURES & BENEFITS

- Vacuum formed acrylic reinforced with fiberglass
- Scratch, stain and fade resistant high gloss finish
- Installation friendly two piece design
- Accepts deck mounted faucet
- Includes integral pop up drain and rectangular overflow
- Includes levelling feet

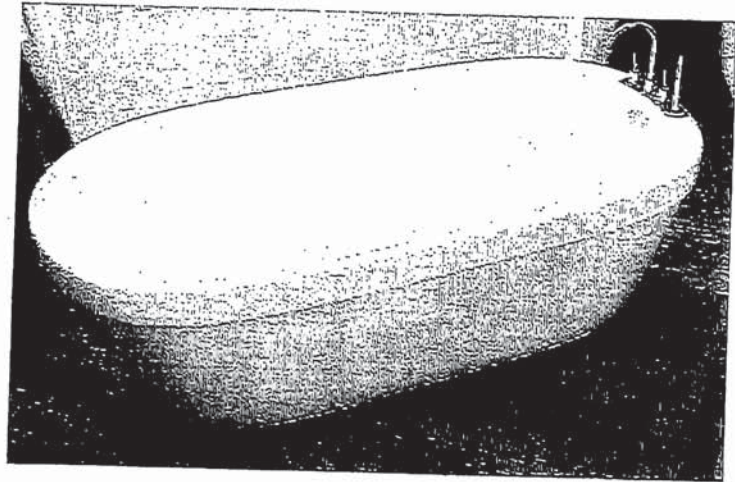

TWO PIECE ASSEMBLY

FRONT VIEW

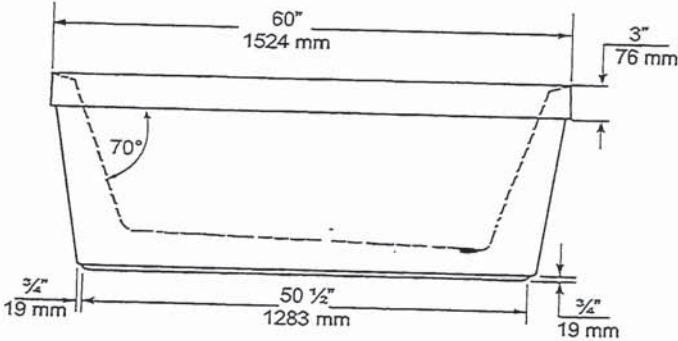

END VIEW

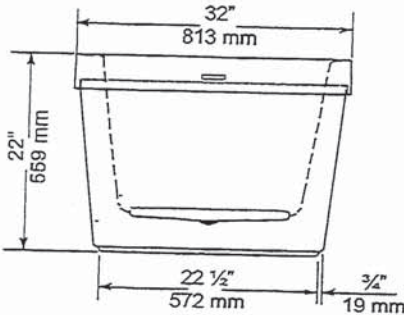

TOP VIEW

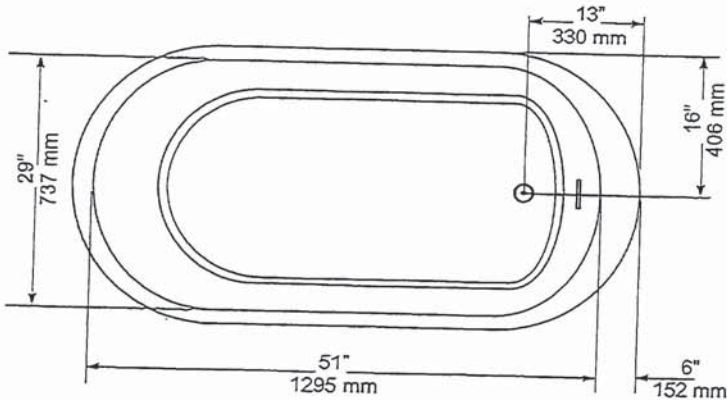

GENERAL SPECIFICATIONS		
Average Weight	90 lb	41 kg
Bathing Well at bottom	43"x 20"	1092 x 508 mm
Capacity Drain to Overflow		195 litres
Water Depth Drain to Overflow	16"	406 mm
Drain Opening (dia.)	2"	51 mm
Overflow Opening	2 1/4"x 1 1/2"	57 x 13 mm
Drain to Floor Clearance	3 1/4"	83 mm

NOTES: Please confirm measurements on actual product to ensure proper identification. Bathtub to be installed on the floor supported by 5 self levelling feet. Adjust if required to level the bathtub for adequate drainage. Refer to installation instructions for additional information.

IMPORTANT: Dimensions of fixtures are nominal and may vary  $\pm \frac{1}{4}$ " (6 mm). Weight may vary  $\pm 5$  lb (2.3 kg). Drawing is not to scale. These measurements are subject to change at manufacturer's discretion.

Compliance Certifications -  
Meets or Exceeds the following Specifications:  
• CAN/CSA - B45 Series



M.T 8





H2OPTION® SIPHONIC DUAL FLUSH  
ELONGATED TOILET  
VITREOUS CHINA

H2OPTION® SIPHONIC DUAL FLUSH  
ELONGATED TOILET

- ☐ **2887.218**
  - Vitreous china
  - Ultra high efficiency
    - Full Flush (4.8 Lpf/1.28 gpf)
    - Partial Flush (3.4 Lpf/0.92 gpf)
  - Elongated siphon action bowl with direct-fed jet
  - Meets EPA WaterSense® criteria
  - MaP PREMIUM listed
  - Includes EverClean® antimicrobial surface
  - PowerWash® rim scrubs bowl with each flush
  - 305mm (12") rough-in
  - Fully glazed 2" Trapway
  - Generous 9" x 8" water surface area
  - Chrome plated top mounted push button actuator
  - Sanitary bar on bowl
  - 2 color matched bolt caps
  - Limited lifetime warranty on chinaware and limited five year warranty on all mechanical parts

- ☐ **2887.518** Same as above, except with Tank with AquaGuard Liner

Separate Component Parts:

- ☐ **3706.216** Bowl
- ☐ **4133A.218** Tank
- ☐ **4133A.518** Tank with AquaGuard Liner

Nominal Dimensions:  
756 x 380 x 762mm  
(29-3/4" x 15" x 30")

Fixture only, seat and supply by others

- Compliance Certifications -  
Meets or Exceeds the Following Specifications:
- ASME A112.19.2-2008/CSA B45.1-08 for Vitreous China Fixtures
  - CALGreen and California Energy Commission (CEC) Compliant
  - US EPA WaterSense® criteria for UHETs

To Be Specified:

- ☐ Color: ☐ White ☐ Bone ☐ Linen
- ☐ Seat: American Standard #5257A.65C Easy Lift and Clean Elongated Seat with Cover and Slow Close hinges
- ☐ Alternate Seat:
- ☐ Supply with stop:

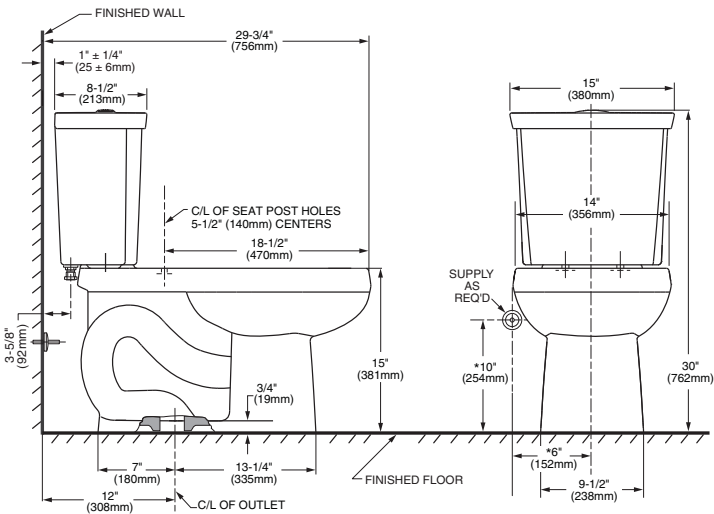

NOTES:  
THIS COMBINATION IS DESIGNED TO ROUGH-IN AT A MINIMUM DIMENSION OF 305MM (12") FROM FINISHED WALL TO C/L OF OUTLET.  
\* DIMENSION SHOWN FOR LOCATION OF SUPPLY IS SUGGESTED. SUPPLY NOT INCLUDED WITH FIXTURE AND MUST BE ORDERED SEPARATELY.  
  
IMPORTANT: Dimensions of fixtures are nominal and may vary within the range of tolerance established by ANSI Standard A112.19.2. These measurements are subject to change or cancellation. No responsibility is assumed for use of superseded or voided pages.





**MOEN®**

## Specifications

### DESCRIPTION

- Metal construction with various finishes identified by suffix
- 16" long 3/8" tubing connections
- Includes metal or 50/50 pop-up type waste assembly where noted

### OPERATION

- Pivot action lever style handle
- Temperature controlled through 180° degree arc of handle travel

### FLOW

- Flow is limited to 1.5 gpm max (5.7L/min) at 60 psi

### CARTRIDGE

- 1225 cartridge design
- Nonmetallic/nonferrous and stainless steel material
- Can accommodate reversed piping and back to back installations

### STANDARDS

- Third party certified to WaterSense®, CSA B-125.1, ASME A112.18.1 and all applicable requirements referenced therein including NSF61/9
- Complies with California Proposition 65 and with the Federal Safe Drinking Water Act
- ADA  for lever handle

### WARRANTY

- Lifetime limited warranty against leaks, drips and finish defects to the original consumer purchaser
- 5 year warranty if used in commercial installations

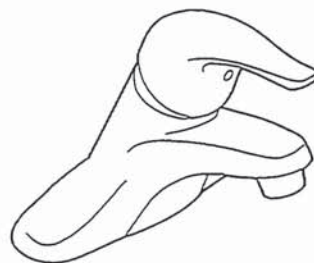

### CHATEAU®

#### Single-Handle Lavatory Faucet

#### with Metal Waste Assembly

Model: L4625 series

L4631BC

**Bulk Packed (12 per carton):**  
L64624 series

#### with 50/50 Waste Assembly

**Bulk Packed (12 per carton):**  
L64625 series

#### Less Waste

**Bulk Packed (12 per carton):**  
L64600 series

**NOTE:** THIS FAUCET IS DESIGNED TO BE  
INSTALLED THRU 3-1" DIA. HOLES, 2" ON CENTER

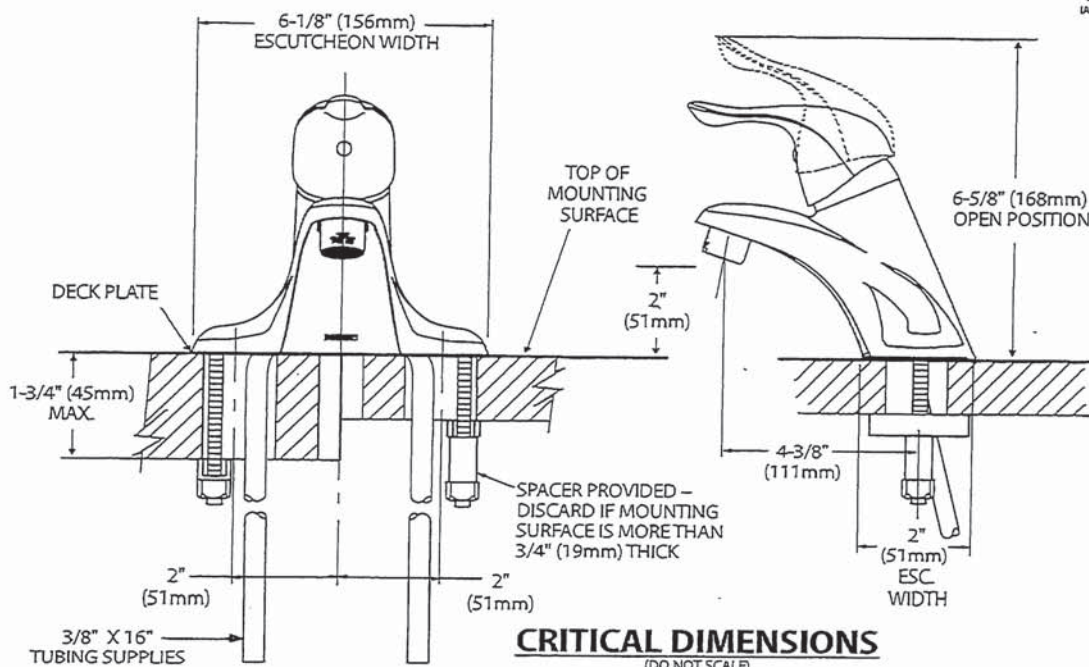

FOR MORE INFORMATION CALL: 1-800-BUY-MOEN

www.moen.com





Buy it for looks. Buy it for life.®

*There is more than 1 version of this model.  
Page down to identify the version you have.*

#### DESCRIPTION

- Metal construction with various finishes identified by suffix
- Includes non-metallic showerhead, arm, flange and non-metallic diverter tub spout

#### OPERATION

- Handle operates counterclockwise through a 270° arc with off at 6 o'clock and maximum hot at the 9 o'clock position. Shut off in clockwise direction
- Adjustable temperature limit stop to control maximum hot water temperature
- Pressure balancing mechanism maintains selected discharge temperature to  $\pm 3^\circ$

#### FLOW

- Showerhead is limited to 2.5 gpm (9.5 L/min) at 80 psi
- EP suffix models are limited to 1.75 gpm (6.6 L/min) at 80 psi
- NH suffix models contain no showerhead

#### CARTRIDGE

- 1222 cartridge design
- Accommodates back to back installations
- Nonmetallic/nonferrous and stainless steel material

#### STANDARDS

- Third party certified to meet ASME A112.18.1/CSA B125.1 and all applicable requirements referenced therein
- EP suffix models are third party certified to WaterSense®

- ADA  for lever handle

#### WARRANTY

- Lifetime limited warranty against leaks, drips and finish defects to the original consumer purchaser
- 5 year warranty if used in commercial installations

## Specifications



### CHATEAU® POSI-TEMP® Single-Handle Tub/Shower Trim Kit

**Models:** TL181 series - valve trim only  
(Bulk Packed 12 per carton)  
TL182 series - shower trim only  
(Bulk Packed 12 per carton)  
TL183 series - tub/shower trim  
(Bulk Packed 12 per carton)

**Valves:** 62300 series  
2500 series

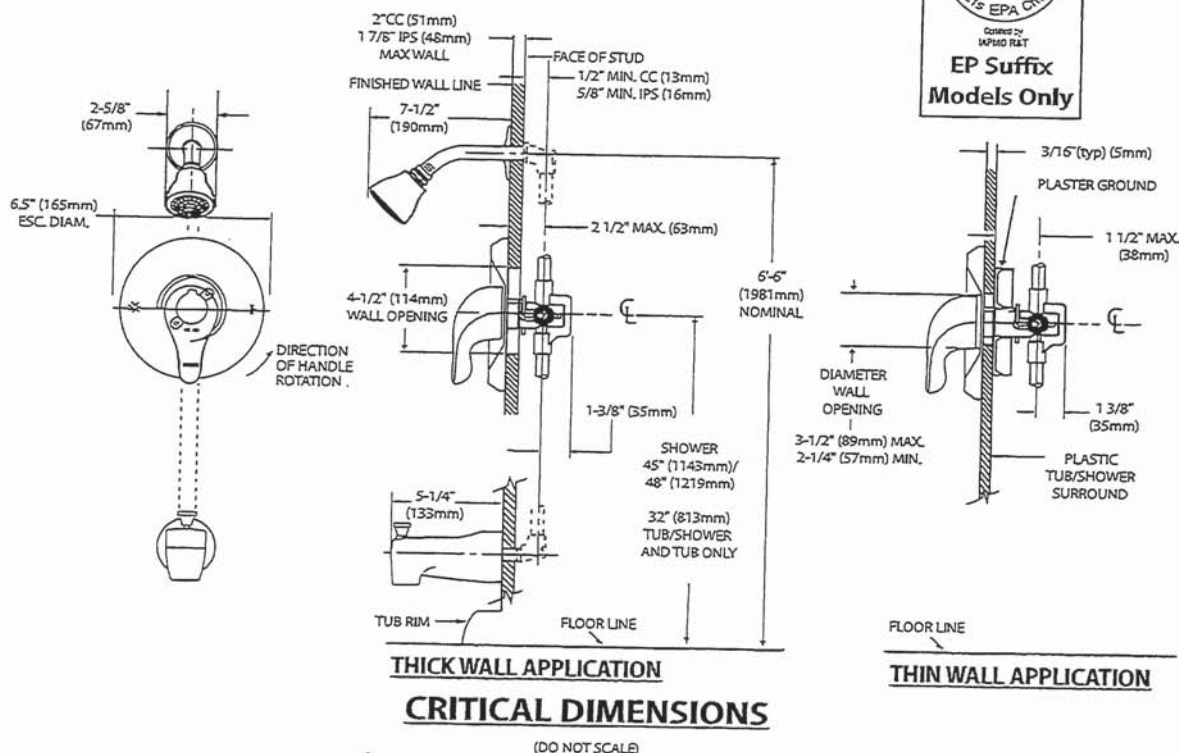

MT 3



**MOEN®**

## Specifications

### DESCRIPTION

- Metal construction with various finishes identified by suffix

### OPERATION

- Lever style handles with hot and cold color indicator
- Rotate hot side handle counterclockwise to open (clockwise to close) and the cold side handle (clockwise to open) and (counterclockwise to close)

### STANDARDS

- Third party certified to: ASME A112.18.1/CSA B-125.1, and all applicable requirements referenced therein
- ADA  for lever handles

### WARRANTY

- Lifetime limited warranty against leaks, drips and finish defects to the original homeowner
  - 10 year limited warranty when used in a multi-family installation
  - 5 year limited warranty when used in a commercial installation
- Visit [www.moen.com/support](http://www.moen.com/support) for complete details and limitations

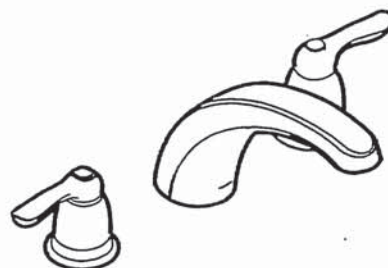

### CHATEAU®

#### Two-Handle Garden Tub Trim

Models: T994 series

Valves: 4792, 4793, 4794, 4796, 4797, 4798

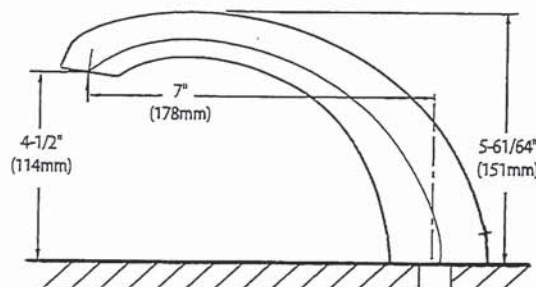
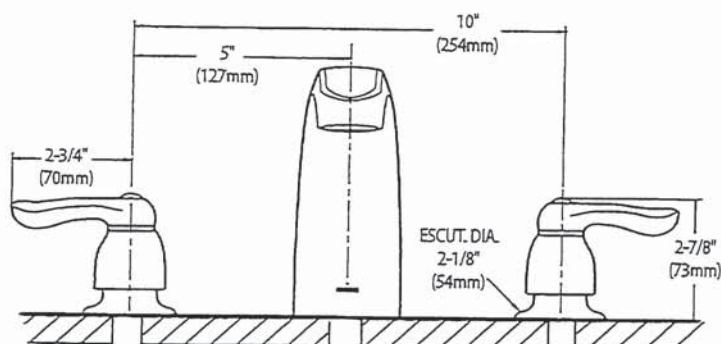

### CRITICAL DIMENSIONS

(DO NOT SCALE)



SC(B)514 | ALITO Collection

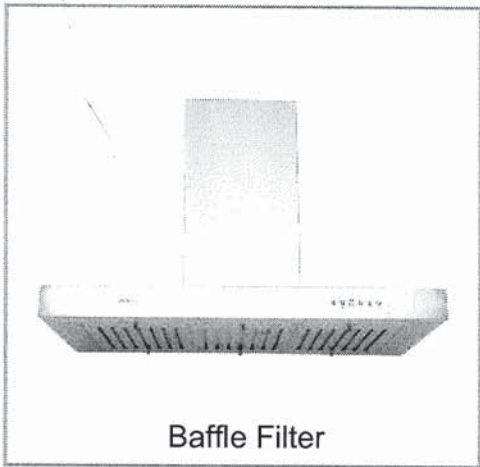

Wall Mount

The SC(B)514 makes a statement of strength and power with a bold frame and 550 CFM fan. Features mesh or baffle filters, two bright LED lights and a three-speed panel for total control. It is also fitted with a time-delay OFF feature up to nine minutes.

Green Features



3 Speed Push Button  
Control Panel



Long-Lasting  
LED Lights



Time-Delay  
OFF Feature



Grease Cup



Model	Colour	Ducting	Filters	Size	CFM
SCB51430	Stainless Steel	6"	Baffle	30"	550
SCB51436	Stainless Steel	6"	Baffle	36"	550

Cyclone Range Hoods Inc.

1361 Huntingwood Drive, Unit 16. Toronto, ON. M1S 3J1. Canada.

Toll Free: 1-888-293-5662 Tel: (416) 293-0933 Fax: (416) 293-4793 Website: [www.CycloneRangeHoods.com](http://www.CycloneRangeHoods.com)

MIT 8



SC(B)514 | ALITO Collection



Features

- Wall mount range hood
- 6" round duct adapter
- Non-stick aluminum fan blades
- 3 speed push button control
- 2 LED lights (2 x 1.4W, 4000K)
- Quick release aluminum mesh filters
- Standard chimney fits up to 9 ft. ceiling
- Up to 9 minutes time-delay OFF feature
- Plug-in connection

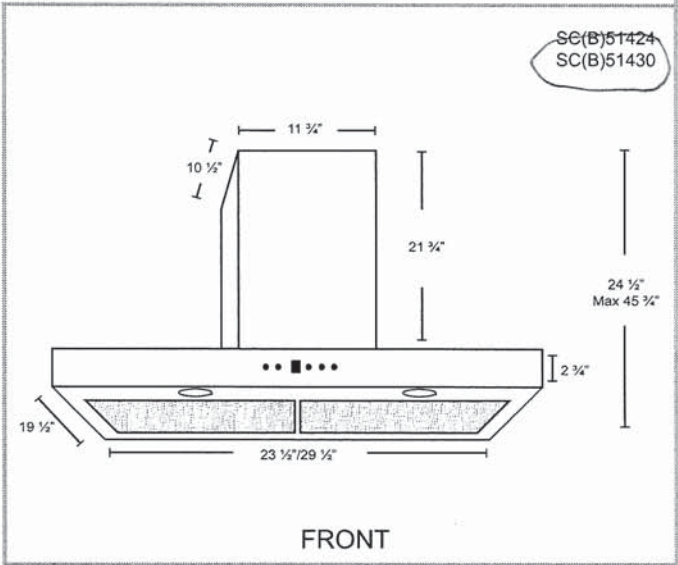
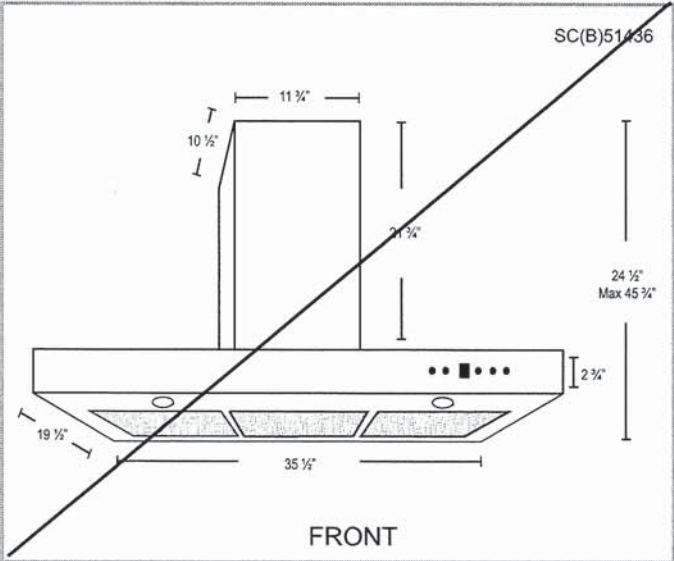

Options

- Filters:  
  
SCB514 - Quick Release Stainless Steel Baffle Filters
- Chimney Flues:  
B2.CH16 - short (7'-8' ceilings)  
B2.CH22 - standard (8'-9' ceilings)  
B2.CH32 - extended (9'-11' ceilings)
- Widths: 30", 36"

Specifications

- |                                      |                                |   |
|--------------------------------------|--------------------------------|---|
| ▪ Air Flow Volume: 550 CFM           | ▪ Current: 2.5 Amps            | ▪ Finishes: Stainless Steel                 |
| ▪ Electrical Connection: 120 V/60 Hz | ▪ Fan Speed: 1599 RPM          | ▪ Ducting: 6" Round                         |
| ▪ Power Consumption: 300 Watts       | ▪ Fan Type: Centrifugal Blower | ▪ Noise Level: Min. 2 Sones<br>Max. 6 Sones |



MT 8



36" Counter-Depth 3-Door Refrigerator

800 Series – Stainless Steel B36CT80SNS

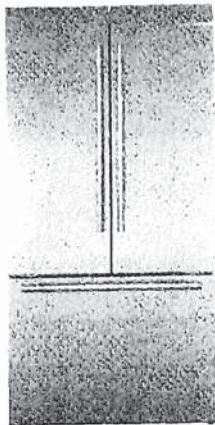

B36CT80SNS  
Stainless Steel

Also available in:  
Black Stainless Steel  
B36CT80SNB

Innovative VitaFreshPro<sup>®</sup> technology helps keep food fresh up to 3x longer.\* Enjoy less food waste, new innovative features and more thoughtful design.

Features & Benefits

VitaFreshPro<sup>®</sup> provides pre-programmed freshness settings to optimize temperature and humidity to keep meat, fish, and produce fresher, longer.

Interior Water Dispenser is thoughtfully placed inside for refreshing water at the touch of a button or a push of a nozzle.

FlexBar<sup>®</sup> utilizes typically unused space in the upper refrigerator cavity.

General Properties	
Full 72" height and true counter depth for built-in appearance	Yes
Easy Clean Stainless Steel	Yes
Lighting	Recessed LED light bars
Number of compressors/evaporators	2 / 2
Defrost process refrigerator section	Frost-free
Number of shelves – refrigerator	5
Adjustable shelves – refrigerator	4 half-width
Shelf material – refrigerator	Tempered glass
Type of shelves – refrigerator	Frameless split shelves with metal trim
Flexible storage bar	FlexBar <sup>®</sup>
Gallon storage bins	2
Humidity control compartments	2
Full width temp. & humidity controlled drawer	VitaFreshPro <sup>®</sup>
Ice maker	Yes
Water filter	UltraClarityPro <sup>®</sup>
Internal water dispenser	Yes
Touch control panel	Yes
AirFresh <sup>®</sup> filter	Yes
FreshProtect <sup>®</sup> ethylene filter	Yes
MultiAirFlow <sup>™</sup>	Yes
Stainless steel back wall	Yes
Defrost process freezer section	Automatic
Number of drawers – freezer	3
Wi-Fi enabled	Yes, Home Connect <sup>®</sup> app

Capacity	
Total capacity	20.8 cu. ft.
Refrigerator capacity	14.8 cu. ft.
Freezer capacity	6 cu. ft.

Technical Details	
Current	15 A
Volts	115 V
Frequency	60 Hz
Power cord length	67"
Plug type	120V-3 prong

Dimensions & Weight	
Appliance dimensions with hinges, handles and doors (HxWxD)	72"* x 35 5/8" x 31 1/8"
Appliance dimensions without hinges and doors (HxWxD)	71 1/2" x 35 5/8" x 24***
Appliance dimensions with hinges and doors, no handles (HxWxD)	72"* x 35 5/8" x 28 3/4"
Required cutout size (HxWxD)	72" x 36" x 25"
Net weight	350 lbs

Efficiency	
Energy consumption	570 kWh/yr
ENERGY STAR <sup>®</sup> Certified	Yes

Accessories	
UltraClarityPro <sup>®</sup> Water Filter: BORPLFTR55	
Ethylene Filter Kit: FPETHKT50	
Ethylene Filter Refill Kit: FPETHRF50	
90 Degree Door Stopper: 10012733	



\*As compared to a Bosch refrigerator without VitaFreshPro<sup>®</sup> technology. Results may vary among different foods.  
\*\*When leveling legs are fully extended, add 5/8" to overall height, total 31 5/8".  
\*\*\*The cutout depth of 25" includes the required 1" airflow. The electrical covers on the back of unit do not require additional depth.  
Accessories: To purchase Bosch accessories, cleaners & parts please visit [www.bosch-home.com/us/store](http://www.bosch-home.com/us/store) or call 1-800-944-2904 (Mon to Fri 5 am to 6 pm PST, Sat 6 am to 3 pm PST).  
Notes: All height, width and depth dimensions are shown in inches. BSH reserves the absolute and unrestricted right to change product materials and specifications, at any time, without notice. Consult the product's installation instructions for final dimensional data and other details prior to making cutout.  
Warranties: Please see Use & Care manual or Bosch website for statement of limited warranty.  
For more information on our entire line of products, go to [www.bosch-home.com/us](http://www.bosch-home.com/us) or call 1-800-944-2904  
© BSH Home Appliances Corporation. All rights reserved. Bosch is a registered trademark of Robert Bosch GmbH.



36" Counter-Depth 3-Door Refrigerator

800 Series – Stainless Steel B36CT80SNS



Installation Details

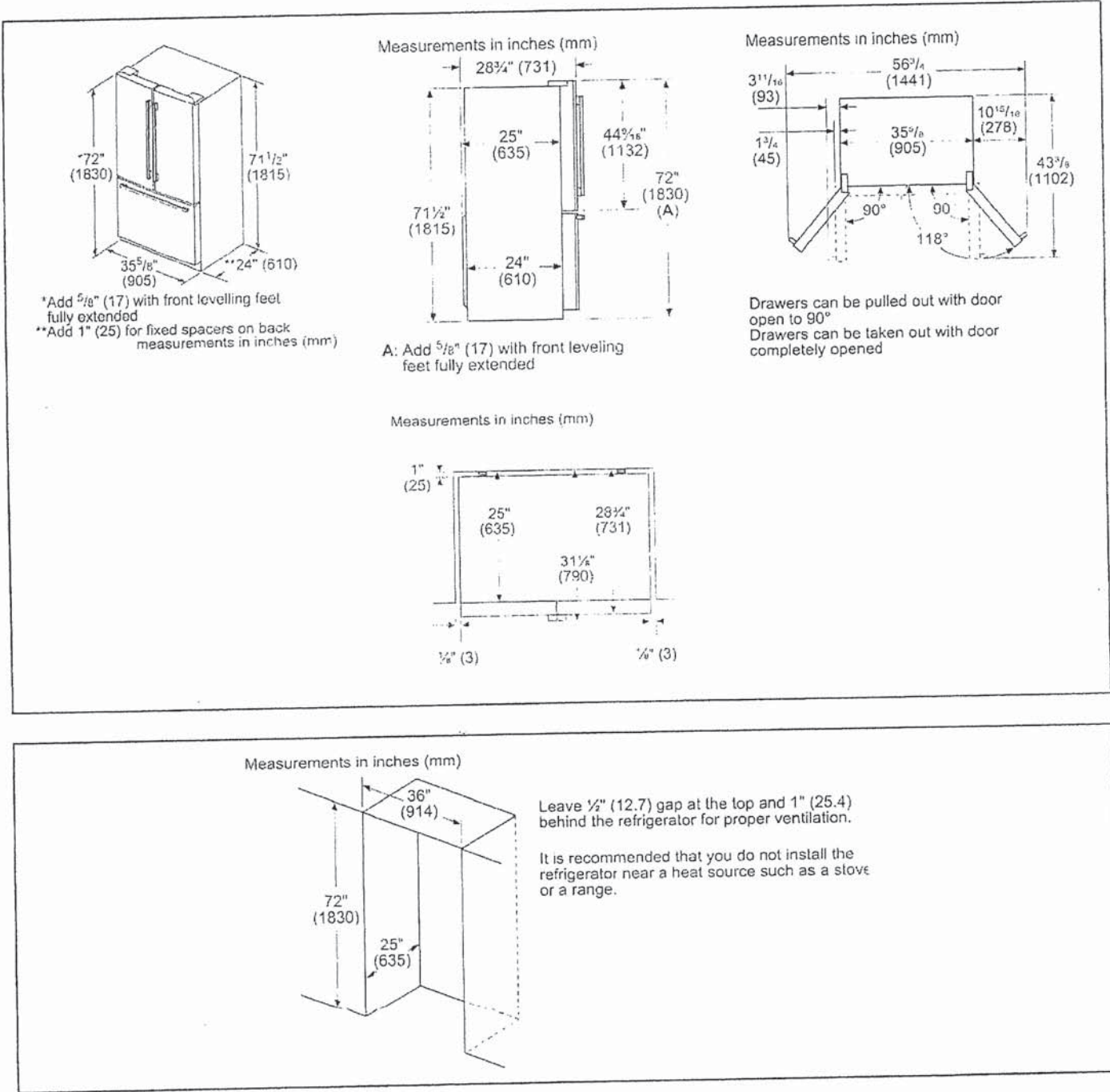

Accessories: To purchase Bosch accessories, cleaners & parts please visit [www.bosch-home.com/us/store](http://www.bosch-home.com/us/store) or call 1-800-944-2904 (Mon to Fri 5 am to 6 pm PST, Sat 8 am to 3 pm PST).

Notes: All height, width and depth dimensions are shown in inches. BSH reserves the absolute and unrestricted right to change product materials and specifications, at any time, without notice. Consult the product's installation instructions for final dimensional data and other details prior to making cutout.

Warranties: Please see Use & Care manual or Bosch website for statement of limited warranty.

For more information on our entire line of products, go to [www.bosch-home.com/us](http://www.bosch-home.com/us) or call 1-800-944-2904

© BSH Home Appliances Corporation. All rights reserved. Bosch is a registered trademark of Robert Bosch GmbH



30" Induction Slide-in Range

800 Series – Stainless Steel HII8057C



HII8057C  
Stainless Steel

Also available in:  
Black Stainless Steel HII8047C

The full-depth induction slide-in range allows fast & efficient cooking and has an oven that provides consistent, even baking.

Features & Benefits

Induction cooking is faster and more efficient than gas and electric.

The warming drawer keeps your meals warm and ready to serve.

Convection Pro combines a third heating element with a back fan for even browning and time savings by using multiple racks at one time.

General Properties

Cooking modes	Bake, Variable Broil (hi & low), Roast, Warm, Proof Dough, Convection Bake, Convection Broil, Convection Roast, Convection Multi-Rack, Convection Conversion, Pizza, Fast Preheat, Sabbath
Cleaning type	Self clean
Interior light	1
Kitchen timer	Yes
Drawer type	Warming drawer

Oven Performance

Bake / broil element watts	2,400 / 3,800 W
Convection element watts	2,000 W

Element Performance

Total cooktop elements	4
Power of front left element watts	1,400 W (2,200 w/ boost)
Power of back left element watts	2,200 W (3,700 w/ boost)
Power of back right element watts	2,600 W (3,700 w/ boost)
Power of front right element watts	1,400 W (2,200 w/ boost)

Element Size

Dimension of front left heating element	6"
Dimension of back left heating element	9"
Dimension of back right heating element	11"
Dimension of front right heating element	6"

Technical Details

Watts	11,700 / 14,000 W
Circuit breaker	40 or 50 A*
Volts	208 V / 240 V
Frequency	60 Hz
Power cord length	1.5 meter
Plug type	208/240V - 4 prong
Energy source	Electric

Dimensions & Weight

Overall appliance dimensions (HxWxD)	36 1/2"-38" x 31 1/2" x 28 7/8"
Required cutout size (HxWxD)	35 1/2"-37" x 30" x 25"
Adjustable range height	1 1/2"
Oven cavity size	4.6 cu. ft.
Overall oven interior dimensions (HxWxD)	17 13/16" x 24 1/8" x 18"
Usable oven interior dimensions (HxWxD)	12 5/16" x 23 1/4" x 15 1/4"
Net weight	239 lbs

Accessories-Included

Use and care manual, installation guide, temperature probe, 3 standard racks

Accessories-Optional



HEZTR301  
30" Telescopic rack



HEZBS301  
4" Low backguard (stainless steel)



\*Varies by location, check local code

Accessories: To purchase Bosch accessories, cleaners & parts please call 1-800-944-2904 (Mon to Fri 9 am to 6 pm PST, Sat 9 am to 3 pm PST).

Notes: All height, width and depth dimensions are shown in inches. BSH reserves the absolute and unrestricted right to change product materials and specifications, at any time, without notice. Consult the product's installation instructions for final dimensional data and other details prior to making purchase.

Warranties: Please see Use & Care manual or Bosch website for statement of limited warranty.

For more information on our entire line of products, go to [www.bosch-home.ca](http://www.bosch-home.ca) or call 1-800-944-2904

© BSH Home Appliances Corporation. All rights reserved. Bosch is a registered trademark of Robert Bosch GmbH.





30" Induction Slide-in Range

800 Series – Stainless Steel HII8057C

Installation Details

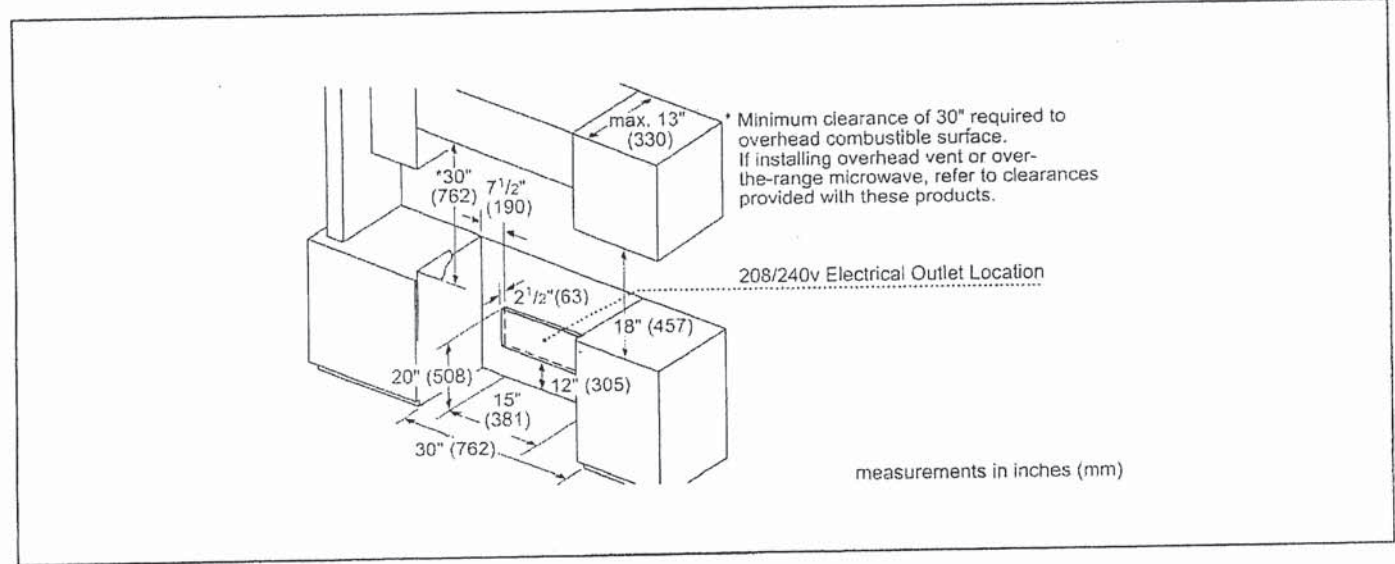
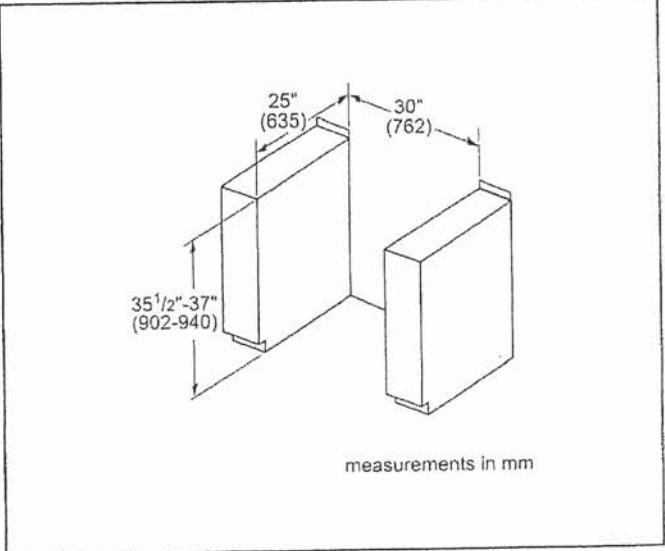
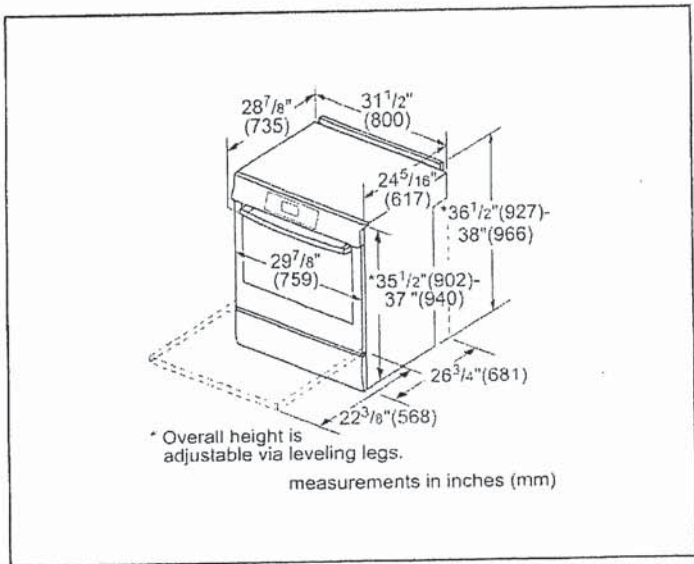

Accessories: To purchase Bosch accessories, cleaners & parts please call 1-800-944-2904 (Mon to Fri 9 am to 6 pm PST, Sat 9 am to 3 pm PST).

Notes: All height, width and depth dimensions are shown in inches. BSH reserves the absolute and unrestricted right to change product materials and specifications, at any time, without notice. Consult the product's installation instructions for final dimensional data and other details prior to making cutout.

Warranties: Please see Use & Care manual or Bosch website for statement of limited warranty.

For more information on our entire line of products, go to [www.bosch-home.ca](http://www.bosch-home.ca) or call 1-800-944-2904

© BSH Home Appliances Corporation. All rights reserved. Bosch is a registered trademark of Robert Bosch GmbH.



24" Recessed Handle Dishwasher

300 Series – Stainless Steel SHE53B75UC



IMAGE SHOWN IS NOT FINAL

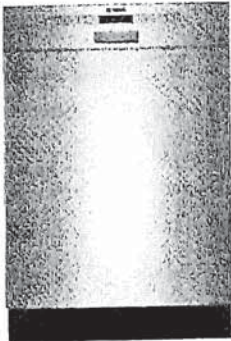

SHE53B75UC  
Stainless Steel

The 3rd rack provides the perfect space for silverware and large utensils while its V shape leaves room below for taller items.

Features & Benefits

46 dBA: dishwasher runs quietly so your kitchen conversations aren't interrupted.

With PrecisionWash®, intelligent sensors and precision spray arms target every item of every load, so dishes come out sparkling clean every time.

Connect to WiFi and enable Home Connect™ to reorder dish tabs via Amazon\*, plus get alerts when dishes are done.

The AquaStop® leak protection system contains leaks through a precisely engineered system, giving you the ultimate peace of mind whether you are away or at home.

The Favorite button allows you to easily access your preferred cycle/option combination with 1 touch.

General Properties	
Number of wash cycles	6
Number of options	6
dBA	46
Drying system	PureDry®
Third rack	Standard 3rd Rack
Rack adjustability	Rackmatic®
Tub material	Stainless Steel
Control type	Buttons
Concealed water heating element	Yes
Leak protection system	24/7 AquaStop® Plus
Sanitize option	Yes
Water softener	Yes
Five-level wash	Yes
ChildLock	Yes
Home Connect™ (WiFi enabled)	Yes
Special features	Extra Dry option, Speed 60 cycle

Efficiency	
Water usage per cycle	3.5
Energy efficiency class	Tier 1
ENERGY STAR® qualified	Yes
Total annual energy consumption	269 kWh
Total annual water consumption	623.5 g

Home Connect



Capacity	
Number of place settings	15
Technical Details	
Watts	1440 W
Current	12 A
Volts	120 V
Frequency	60 Hz
Power cord full length	67"
Power cord install length from edge of unit when facing the door	Left – 47 1/4" Right – 47 1/4"
Minimum water pressure	14 lb/sin
Length outlet hose	74 3/4"

Dimensions & Weight	
Overall appliance dimensions (HxWxD)	34 1/16" x 23 9/16" x 22 9/16"
Required cutout size (HxWxD)	34 1/16" x 24" x 24"
Adjustable feet	Yes
Net weight	90 lbs

Accessories—Optional	
Junction Box	SMZPCJB1UC
Drain Hose Extension Kit	SGZ1010UC
Dishwasher Accessory Kit	SMZ5000
Edge Protector + Power Cord Clip Install Kit	SMZEPCC1UC

\*Smart reordering via the Amazon Alexa app. Only available in participating countries.

Accessories: To purchase Bosch accessories, cleaners & parts please visit [www.bosch-home.com/us/store](http://www.bosch-home.com/us/store) or call 1-800-944-2904 (Mon to Fri 5 am to 6 pm PST, Sat 6 am to 3 pm PST).  
Notes: All height, width and depth dimensions are shown in inches. BSH reserves the absolute and unrestricted right to change product materials and specifications, at any time, without notice. Consult the product's installation instructions for final dimensional data and other details prior to making cutout.

Warranties: Please see Use & Care manual or Bosch website for statement of limited warranty.  
For more information on our entire line of products, go to [www.bosch-home.com/us](http://www.bosch-home.com/us) or call 1-800-944-2904  
© BSH Home Appliances Corporation. All rights reserved. Bosch is a registered trademark of Robert Bosch GmbH.



24" Recessed Handle Dishwasher

300 Series – Stainless Steel SHE53B75UC



Installation Details

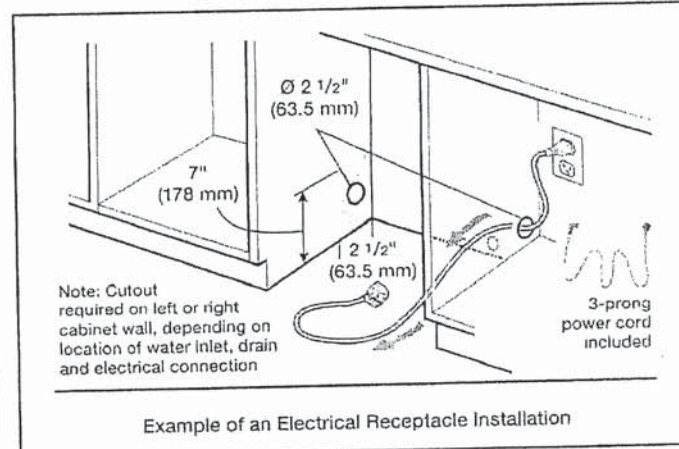
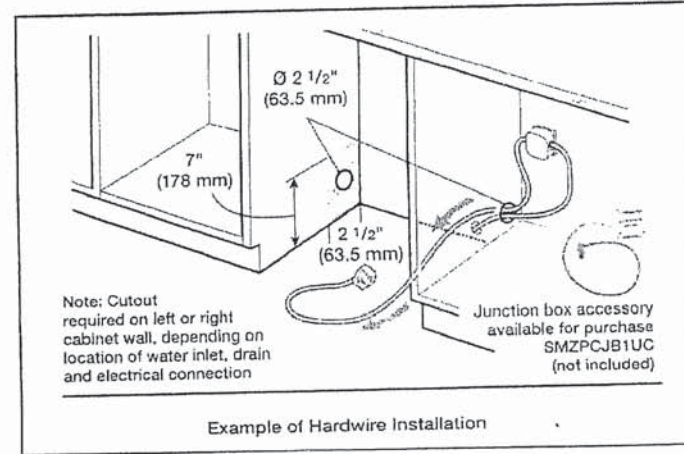
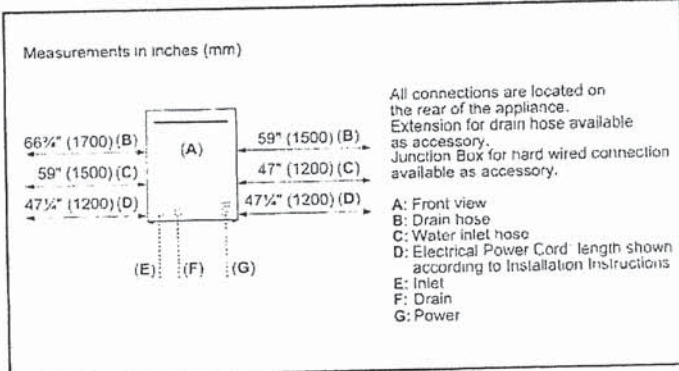
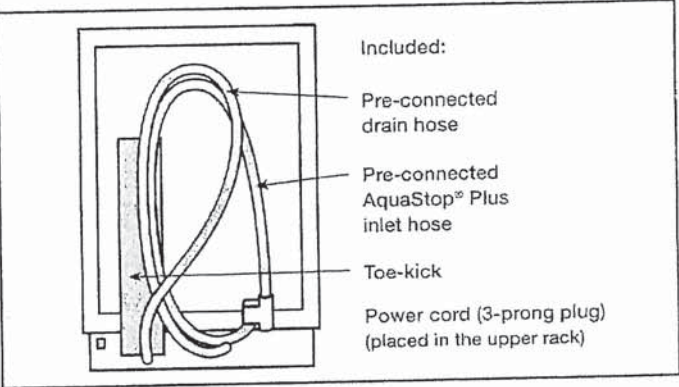
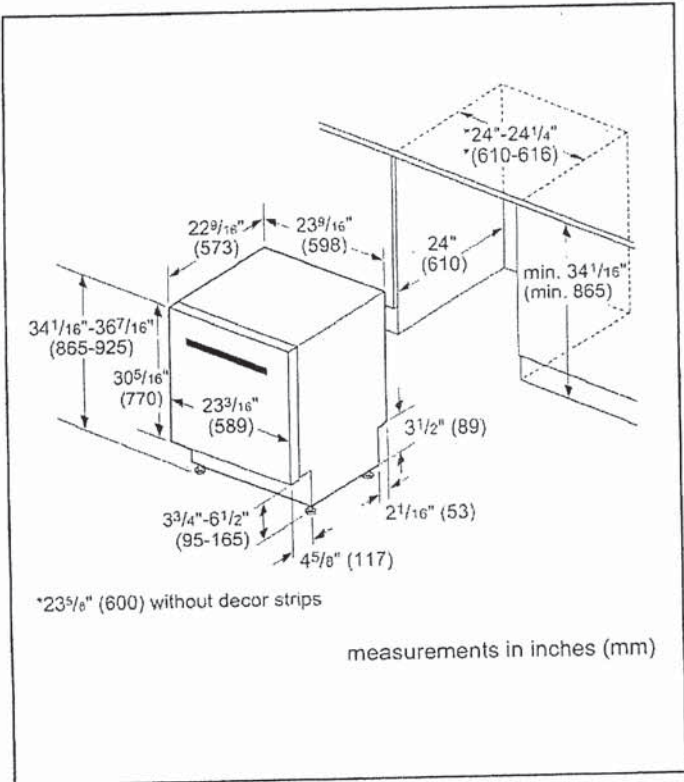

**Accessories:** To purchase Bosch accessories, cleaners & parts please visit [www.bosch-home.com/us/store](http://www.bosch-home.com/us/store) or call 1-800-944-2904 (Mon to Fri 5 am to 6 pm PST, Sat 6 am to 3 pm PST)

**Notes:** All height, width and depth dimensions are shown in inches. BSH reserves the absolute and unrestricted right to change product materials and specifications, at any time, without notice. Consult the product's installation instructions for final dimensional data and other details prior to making cutout.

**Warranties:** Please see Use & Care manual or Bosch website for statement of limited warranty

**For more information on our entire line of products, go to [www.bosch-home.com/us](http://www.bosch-home.com/us) or call 1-800-944-2904**

© BSH Home Appliances Corporation. All rights reserved. Bosch is a registered trademark of Robert Bosch GmbH.



24" Recessed Handle Dishwasher

300 Series – Stainless Steel SHE53B75UC



Installation Details

Note: Plumbing installations will vary - refer to local codes. Drain hose included is 79" (201 cm) and can be extended to a maximum of 155 3/4" (396 cm).

Always use the approved drain hose extension kit (SGZ1010UC).

Ensure a portion of the drain hose is raised between min. 33" (84 cm) and max. 43" (110 cm) above the cabinet floor.

**Accessories:** To purchase Bosch accessories, cleaners & parts please visit [www.bosch-home.com/us/store](http://www.bosch-home.com/us/store) or call 1-800-944-2904 (Mon to Fri 5 am to 6 pm PST, Sat 6 am to 3 pm PST).

**Notes:** All height, width and depth dimensions are shown in inches. BSH reserves the absolute and unrestricted right to change product materials and specifications, at any time, without notice. Consult the product's installation instructions for final dimensional data and other details prior to making cutout.

**Warranties:** Please see Use & Care manual or Bosch website for statement of limited warranty.

For more information on our entire line of products, go to [www.bosch-home.com/us](http://www.bosch-home.com/us) or call 1-800-944-2904

© BSH Home Appliances Corporation. All rights reserved. Bosch is a registered trademark of Robert Bosch GmbH.



5.0 cu.ft I.E.C. Closet-Depth Front Load Washer with Intuitive Controls  
Model: WFW560CHW

- Overview
- Specifications
- Reviews
- You May Also Like
- Help And Resources
- Find In Store

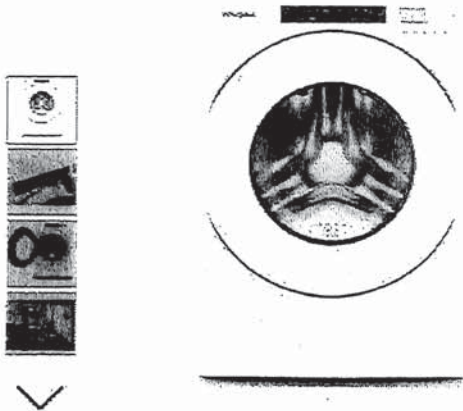

- Key Features
- #1 in Customer Satisfaction in the J.D. Power 2020 Laundry Appliances Satisfaction Study
  - 5.0 cu. ft. I.E.C. Capacity
  - ENERGY STAR® Certified
  - Intuitive Controls
  - Sanitize Cycle with Oxi

Color

White

Specifications

Width:  
6858.00, 27.0”  
Centimeters, Inches

Depth:  
8016.88, 31-9/16”  
Centimeters, Inches

Dimensions

Capacity	4-3/10
Depth	8016.88 cm, 31-9/16 in
Gross Weight	97068688.00 kg, 214 lbs
Net Weight	92532768.00 kg, 204 lbs.
Width	8859.00 cm, 27.0 in

Appearance

LCD Touch Screen	No
Window	Yes

Details

Advanced Vibration Control™	No
Dispense System	Detergent, Fabric Softener & Bleach
Eco Monitor/Efficiency Monitor	No
Hoses Included	4ft 4in Drain Hose Included
Internal Heater	No
Maximum Spin Speed	1160
Out Of Balance Sensing	Yes
Water Factor	3-1/5

Cycles and Options

Number Of Wash Cycles	35
-----------------------	----

Electrical

Power Cord Included	Yes
---------------------	-----

Controls

Automatic Temperature Controls	Yes
Control Location	Front
LCD Touch Screen	No

Compatibility

Works With	No
------------	----

Options

Number Of Washer Options	7
--------------------------	---

Features

Stackable	Yes
Water Faucet	No

Cycles

Number Of Wash Cycles	35
-----------------------	----

Exterior

Lid/Door Lock	Yes
Lid/Door Swing	Left

Modifiers

Delay Start	No
Number Of Rinse Options	2
Number Of Soil Levels	3
Number Of Spin Speeds	4
Number Of Wash/Rinse Temperatures	4
Pre Soak	Yes
Temperature Selections	Hot, Cold, Cool, Warm

MIT 8



Recessed area or closet installation (stacked washer and dryer)

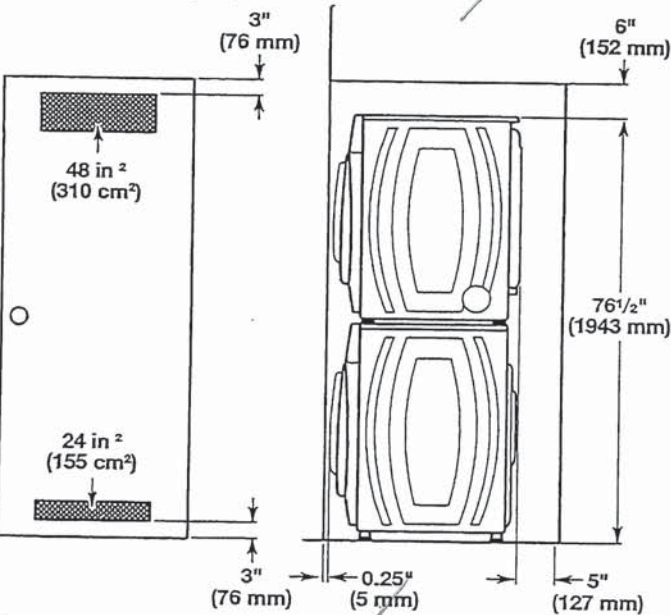

Custom cabinet installation

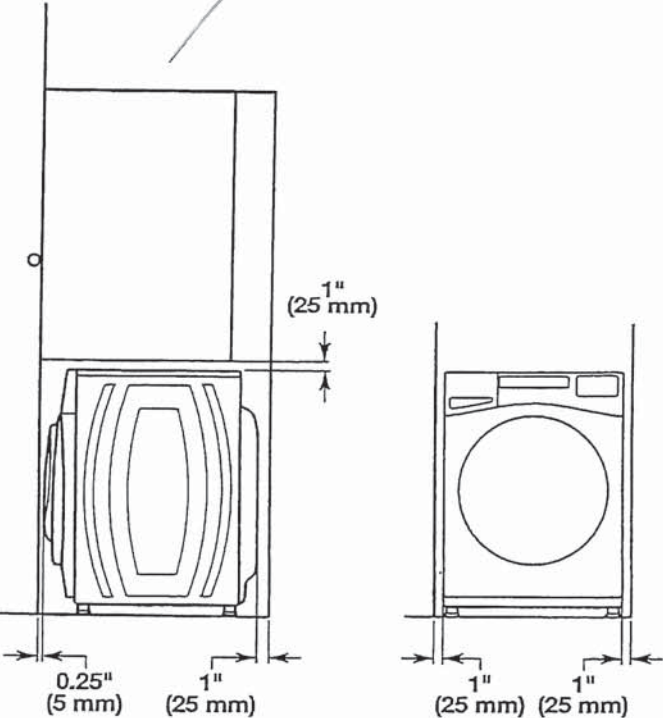

Custom under counter installation

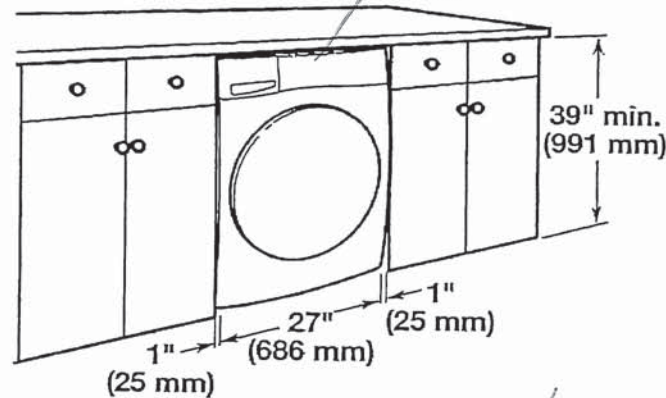

### Drain System

It is the responsibility of the installer to install and secure the drain hose in to the provided plumbing/drain in a manner that will avoid the drain hose coming out of or leaking from the plumbing/drain.

Drain system can be installed using a floor drain, wall standpipe, floor standpipe, or laundry tub. Select the method you need.

**IMPORTANT:** To avoid siphoning, only 4.5" (114 mm) of drain hose should be inside standpipe. Always secure drain hose with cable tie.

### Floor standpipe drain system

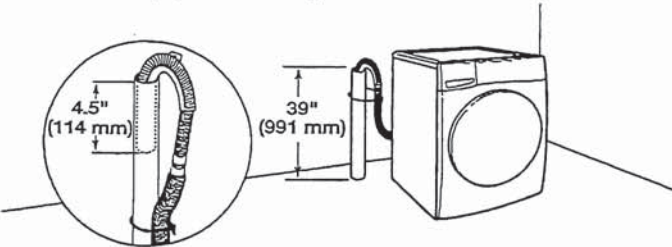

Minimum diameter for a standpipe drain: 2" (51 mm). Minimum carry-away capacity: 17 gallons (64 L) per minute. A 1/4" (6 mm) diameter to 1" (25 mm) diameter Standpipe Adapter Kit is available; refer to the Quick Start Guide for online ordering information. Top of standpipe must be at least 39" (762 mm) high; install no higher than 96" (2.4 m) from bottom of washer. If you have an overhead sewer and need to pump higher than 96" (2.4 m), a sump pump and associated hardware are needed. See "Alternate Parts."



### Wall standpipe drain system

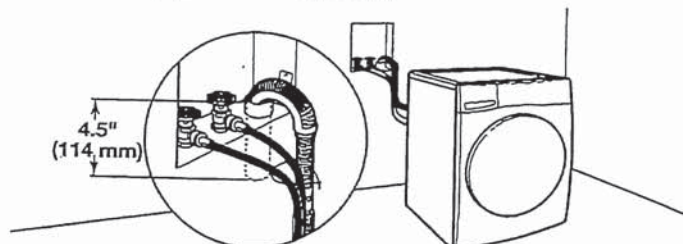

See requirements in "Floor standpipe drain system."

### Laundry tub drain system

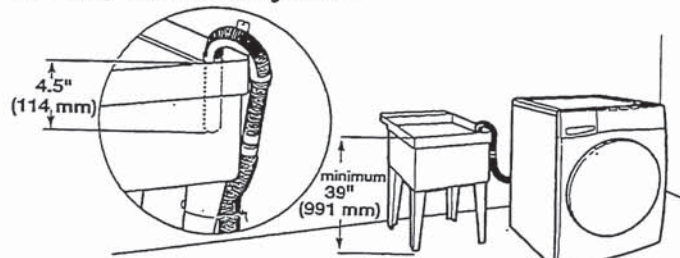

Minimum capacity: 20 gallons (76 L). Top of laundry tub must be at least 39" (991 mm) from the floor; install no higher than 96" (2.4 m) from bottom of washer.

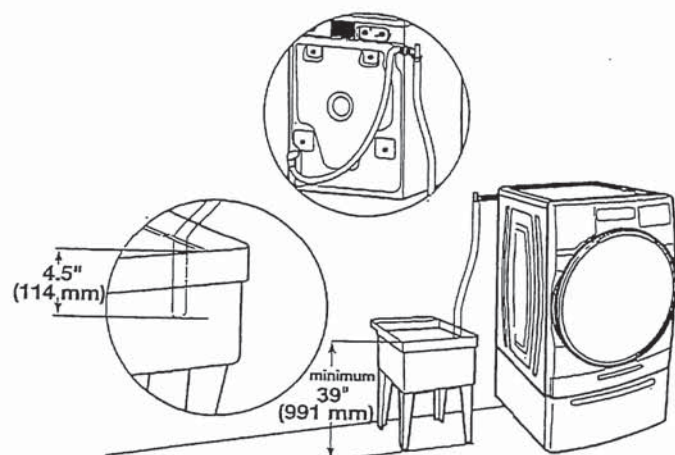

### Floor drain system

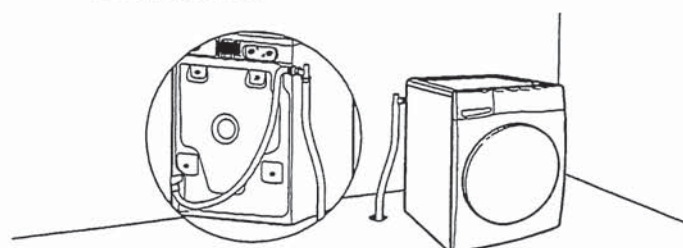

Floor drain system requires a Siphon Break Kit, 2 Connector Kits, and an Extension Drain Hose that may be purchased separately; refer to the Quick Start Guide for online ordering information. Minimum siphon break height: 28" (710 mm) from bottom of washer. (Additional hoses may be needed.)

## Electrical Requirements

### ⚠ WARNING



#### Electrical Shock Hazard

Plug into a grounded 3 prong outlet.

Do not remove ground prong.

Do not use an adapter.

Do not use an extension cord.

Failure to follow these instructions can result in death, fire, or electrical shock.

- A 120 V, 60 Hz, AC only, 15 or 20 A, fused electrical supply is required. A time-delay fuse or circuit breaker is recommended. It is recommended that a separate circuit breaker serving only this appliance be provided.
- This washer is equipped with a power supply cord having a 3-prong grounding plug.
- To minimize possible shock hazard, the cord must be plugged into a mating, 3-prong, grounding-type outlet, grounded in accordance with local codes and ordinances. If a mating outlet is not available, it is the personal responsibility and obligation of the customer to have the properly grounded outlet installed by a qualified electrician.
- If codes permit and a separate ground wire is used, it is recommended that a qualified electrician determine that the ground path is adequate.
- Do not ground to a gas pipe.
- Check with a qualified electrician if you are not sure the washer is properly grounded.
- Do not have a fuse in the neutral or ground circuit.

### GROUNDING INSTRUCTIONS

#### For a grounded, cord-connected appliance:

This appliance must be grounded. In the event of a malfunction or breakdown, grounding will reduce the risk of electric shock by providing a path of least resistance for electric current. This appliance is equipped with a cord having an equipment-grounding conductor and a grounding plug. The plug must be plugged into an appropriate outlet that is properly installed and grounded in accordance with all local codes and ordinances.

**WARNING:** Improper connection of the equipment-grounding conductor can result in a risk of electric shock. Check with a qualified electrician or serviceman if you are in doubt as to whether the appliance is properly grounded. Do not modify the plug provided with the appliance: If it will not fit the outlet, have a proper outlet installed by a qualified electrician.

#### For a permanently connected appliance:

This appliance must be connected to a grounded metal, permanent wiring system, or an equipment-grounding conductor must be run with the circuit conductors and connected to the equipment-grounding terminal or lead on the appliance.

### SAVE THESE INSTRUCTIONS

MT S



WHIRLPOOL DRYER Model #: YWED5620HW

Whirlpool Brand Canada English | Washer and Dryers | Dryers | Electric Dryers | YWED5620HW



Define  
Your Style

7.4 cu. ft. Front Load Electric  
Dryer with Intuitive Touch  
Controls

Whirlpool 7.4 cu. ft. Front Load Electric Dryer with Intuitive Touch Controls  
Model #: YWED5620HW

Dimensions

Depth	78.74 cm, 31.0 in
Depth With Door Open 90 Degree	138.43 cm, 54-1/2 in
Height	98.42 cm, 38-3/4 in
Width	68.58 cm, 27.0 in

Configuration and Overview

Fuel Type	Electric
-----------	----------

Cycles and Options

Cycle Time Remaining	Yes
Lint Filter Indicator	No
Number of Dryer Cycles	36
Number of Dryness Levels	3

Ventilation System

Long Vent	No
Maximum Vent Length	64
Venting Direction	Left, Right, Bottom, Rear

Electrical

Hz	60
Power Cord Included	Yes

MIT 8