

Sales Selection Sheet
Checklist

1 of 46

LOT 710 Model: 30-2794 B The Willowglen
PURCHASERS: LOUIS, ANTHONY MCLEAN/DIANA, O MORRIS MCLEAN
VENDOR: Heathwood Homes (Whitby) Limited

BUILT-IN KITCHEN LAYOUT
OPTIONAL SERVERY SINK AND OPTIONAL SERVERY UPPER CABINETS

- ☐ COLD CELLAR
- ☒ DECK

UPGRADED / MODIFIED ELEVATION

- ☐ CORNER UPGRADE
- ☒ REAR UPGRADE

CEILING UPGRADE - SMOOTH

- ☒ MAIN FLOOR (STD)
- ☐ SECOND FLOOR WITH RESILIENCE CHANEL
- ☐ LOWER LEVEL

ADDITIONAL ROUGH-INS

- ☒ 200 AMP SERVICE (STD)
- ☐ WET BAR ROUGH-IN
- ☐ HUMIDIFIER (STD)
- ☒ AIR CONDITIONING (STD)

GAS ROUGH-IN

- ☐ STOVE
- ☐ DRYER
- ☒ BBQ
- ☐ ADDITIONAL GAS FIREPLACE

KITCHEN HOODFAN VENTING SIZE

- ☒ 6 IN ROUND DUCT (STD WITH APPLIANCE PACKAGE)
- ☐ 7 IN ROUND DUCT

FULL LOWER LEVEL STAIRS	All Oak
UPPER LOWER LEVEL STAIRS	N/A
LOWER LOWER LEVEL STAIRS	N/A
MAIN STAIRS	All Oak

Aug 27/24 *Signatures*
Date Purchaser: *on file*

"
Date Purchaser:

Aug 27/24 IRIT SALEM
Date Decor Consultant:

[Signature]
-08- 29 2024
Date Heathwood Homes (Whitby) Limited
Approved

Locked Date:

LOUIS, ANTHONY MCLEAN/DIANA, O MORRIS MCLEAN
Project: Country Lane
Unit: 710, Phase: 7
Model: 30-2794 B The Willowglen

Created: 7/29/2024 10:12:15
Locked:
Closed:

Kitchen/Breakfast

Cabinet Colour/Style	9157	Viking III-SIMCOE-MOONLIGHT-3DL ***STD***
Island Cabinet Colour/Style	9111	Viking III-SIMCOE ORCHID 3DL ***STD***
Cabinet Hardware	7676	12843-HARDWARE ***STD***
Countertop	9811	Group 1-Quartz-Caesarstone-ROCK SALT # 7601-3/4 inch B/U MITERED EDGE ***STD in KITCHEN ONLY***
Island Countertop	9811	Group 1-Quartz-Caesarstone-ROCK SALT # 7601-3/4 inch B/U MITERED EDGE ***STD in KITCHEN ONLY***
Countertop Edge	4005	DOUBLE MITRE 1 1/2 INCH ***UPG***



Sink	9487	Plumbing-KINDRED Kitchen Sink Collection - Reginox ND1831 U/9-Double (equal size) Bowl Undermount Sink (or equivalent)-Stainless Steel	PG 26
Crumb Vac Color	9482	Vacuum-Crumb Vac (Dust Pan)-White	
HoodFan	8896	SCB51436-CYCLONE 36 inch STAINLESS CANOPY CHIMNEY HOODFAN-STAINLESS STEEL ***Upg***	PG 39-40
Backsplash	5721	QT.CD.ARW.0306.BR-Colour and Dimension Bright-Arctic White-3 x 6 ***1***	
Backsplash Grout	9836	Grout-Eggshell #5220 ***STD***	
Backsplash Tile Pattern	3100	VERTICAL HERRINGBONE ***UPG***	

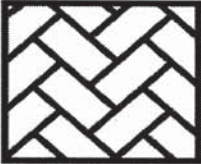

Flooring	8248	OV.CX.WHT.2424.PL-Carrara X-White Polished-24 x 24 ***6***
Floor Tile Grout	9837	Grout-Warm Grey #5093 ***STD***
Floor Tile Pattern	3000	STANDARD SQUARE ***STD***

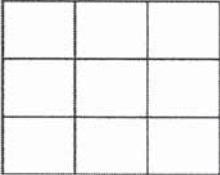

- Purchasers have been advised: standard fridge opening is a minimum 37 3/8 x 73 3/8 inches. Ice Waterline Rough-In is included.
- Standard stove opening is 30 inches and standard dishwasher opening is 24 inches. Any gas stove will require backsplash or stainless steel backing to avoid fire hazards.
- Purchasers acknowledge: Heathwood Homes and its contractors will not be responsible for any kitchen cabinet changes due to appliances dimension changes after sign-off.

Comment

Servery

Cabinet Colour/Style	9157	Viking III-SIMCOE-MOONLIGHT-3DL ***STD***
Cabinet Hardware	7676	12843-HARDWARE ***STD***
Opt. Cabinet Colour/Style - Uppers	9157	Viking III-SIMCOE-MOONLIGHT-3DL ***STD***
Opt. Cabinet Hardware - Uppers	7676	12843-HARDWARE ***STD***

Lm
[Signature]

Customer Colours

LOUIS, ANTHONY MCLEAN/DIANA, O MORRIS MCLEAN
Project: Country Lane
Unit: 710, Phase: 7
Model: 30-2794 B The Willowglen

3 of 46

702

Created: 7/29/2024 10:12:15

Locked:

Closed:

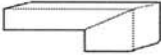
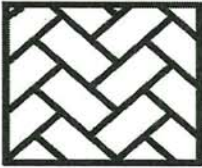
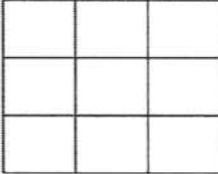
Opt. Cabinet Hardware - Uppers	7070	12043-HARDWARE STD
Countertop	9811	Group 1-Quartz-Caesarstone-ROCK SALT # 7601-3/4 inch B/U MITERED EDGE ***STD in KITCHEN ONLY***
Countertop Edge	4005	DOUBLE MITRE 1 1/2 INCH ***UPG***
		
Opt. Sink	9866	PLUMBING-BOSCO Servery Sink Model 207029 (min 15 in cabinet)-Single Bowl Undermount Sink (or equivalent)-Stainless Steel
Opt. Backsplash	5721	QT.CD.ARW.0306.BR-Colour and Dimension Bright-Arctic White-3 x 6 ***1***
Opt. Backsplash Grout	9836	Grout-Eggshell #5220 ***STD***
Opt. Backsplash Tile Pattern	3100	VERTICAL HERRINGBONE ***UPG***
		
Flooring	8248	OV.CX.WHT.2424.PL-Carrara X-White Polished-24 x 24 ***6***
Floor Tile Grout	9837	Grout-Warm Grey #5093 ***STD***
Floor Tile Pattern	3000	STANDARD SQUARE ***STD***
		
Comment		

Foyer

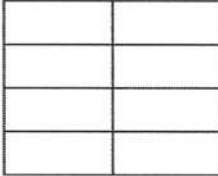
Flooring	8913	UN.BL.BIA.1224-Biel-Bianco (White)-12 x 24 See Tile Direction on Sketch Page ***2***
Floor Tile Grout	9837	Grout-Warm Grey #5093 ***STD***
Floor Tile Pattern	3050	SIDE TO SIDE ***STD***
		
Comment		

Powder Room

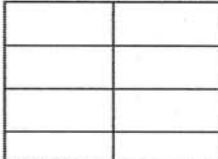
Flooring	8913	UN.BL.BIA.1224-Biel-Bianco (White)-12 x 24 See Tile Direction on Sketch Page ***2***
Floor Tile Grout	9837	Grout-Warm Grey #5093 ***STD***
Floor Tile Pattern	3050	SIDE TO SIDE ***STD***
		

Customer Colours

LOUIS, ANTHONY MCLEAN/DIANA, O MORRIS MCLEAN
Project: Country Lane
Unit: 710, Phase: 7
Model: 30-2794 B The Willowglen

Created: 7/29/2021 10:12:15
Locked:
Closed:

Plumbing Fixture (Colour)	1737	Plumbing Fixtures-WHITE ***STD***
Comment		

Dining Room		
Flooring	9009	Red Oak PEARL-Vintage Red Oak Solid Sculpted Character PEARL-HILLSIDE-3/4 inch X 5 inch ***STD***
Comment		

Great Room		
Flooring	9009	Red Oak PEARL-Vintage Red Oak Solid Sculpted Character PEARL-HILLSIDE-3/4 inch X 5 inch ***STD***
Comment		

Great Room Fireplace		
Type	8869	Majestic MERC32 ***STD***
Mantle	1439	NF 17-Paint Grade Mantle-Flat Wall-WHITE ***STD***
Surround (STD)	8873	3 pc- 4 inch Marble Surround-Nero Marquina ***STD***

PG 24

- Purchasers have been advised: heat from the FP can damage TV above a FP and items placed on mantle.

- Heathwood and its contractors will not be liable for any damage on items placed/@installed above a FP after closing.

Comment

Mud Room											
Flooring	8248	OV.CX.WHT.2424.PL-Carrara X-White Polished-24 x 24 ***6***									
Floor Tile Grout	9837	Grout-Warm Grey #5093 ***STD***									
Floor Tile Pattern	3000	STANDARD SQUARE ***STD***									
		<table><tr><td></td><td></td><td></td></tr><tr><td></td><td></td><td></td></tr><tr><td></td><td></td><td></td></tr></table>									
Comment											

Main Hall		
Flooring	9009	Red Oak PEARL-Vintage Red Oak Solid Sculpted Character PEARL-HILLSIDE-3/4 inch X 5 inch ***STD***
Comment		

Lm
JPM

LOUIS, ANTHONY MCLEAN/DIANA, O MORRIS MCLEAN
Project: Country Lane
Unit: 710, Phase: 7
Model: 30-2794 B The Willowglen

Created: 7/29/2024 10:12:15
Locked:
Closed:

upper hall

Flooring	9009	Red Oak PEARL-Vintage Red Oak Solid Sculpted Character PEARL-HILLSIDE-3/4 inch X 5 inch ***STD***
Comment		

Master Bedroom

Flooring	9506	DY 16611-MINOTAUR-SANDY BEIGE-40 oz Poly ***STD***
Comment		

Bedroom 2

Flooring	9506	DY 16611-MINOTAUR-SANDY BEIGE-40 oz Poly ***STD***
Comment		

Bedroom 3

Flooring	9506	DY 16611-MINOTAUR-SANDY BEIGE-40 oz Poly ***STD***
Comment		

Bedroom 4

Flooring	9506	DY 16611-MINOTAUR-SANDY BEIGE-40 oz Poly ***STD***
Comment		

Master Ensuite



Cabinet Colour/Style	9111	Viking III-SIMCOE ORCHID 3DL ***STD***
Cabinet Hardware	7672	135-HARDWARE ***STD***
Countertop	8822	4924-38-Countertop-WHITE CARRARA-Wilsonart ***STD***
Countertop Edge	1111	N/A *****
Floor Tile	9255	TR.SP.WHITE.1313 SEMPRE White Matte 13 x 13 ***STD***
Floor Tile Grout	9837	Grout-Warm Grey #5093 ***STD***
Floor Tile Pattern	3000	STANDARD SQUARE ***STD***

Lm
Jm

Customer Colours

LOUIS, ANTHONY MCLEAN/DIANA, O MORRIS MCLEAN
Project: Country Lane
Unit: 710, Phase: 7
Model: 30-2794 B The Willowglen

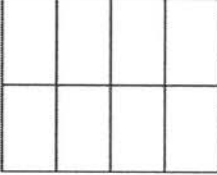
Created: 7/29/2024 10:12:15
Locked:
Closed:

Shower Wall Tile	9022	QT.WV.TGR.0810-Weave-Tender Grey-8 x 10 ***STD***
Shower Wall Tile Grout	9837	Grout-Warm Grey #5093 ***UPG***
Shower Wall Tile Pattern	3090	VERTICAL STACKED ***STD*** 
Shower Floor Tile	8106	OD.ON.TGR.02.HEX.MT-ONTARIO HEXAGON MATTE-TENDER GREY ***UPG 2***
Shower Floor Tile Grout	9837	Grout-Warm Grey #5093 ***STD***
Shower Floor Tile Pattern	3120	VERTICAL HEX ***STD*** 
Shower Jamb(s) and Sill(s)	8923	Shower Jamb / Sill-Thassos White ***STD***
Plumbing Fixture (colour)	1737	Plumbing Fixtures-WHITE ***STD***
Comment	SHOWER NICHE OD.ON. 02 HEX MT ONTARIO MATT TENDER GRET	

Shared Ensuite

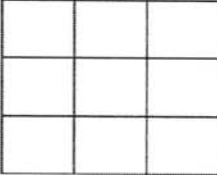
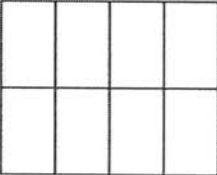
Cabinet Colour/Style	9157	Viking III-SIMCOE-MOONLIGHT-3DL ***STD***
Cabinet Hardware	7672	135-HARDWARE ***STD***
Countertop	8801	P-344 LM-Countertop-INUKSHUK GREY-Arborite ***STD***
Countertop Edge	1111	N/A *****
Floor Tile	8262	TR.ST.GRY.1313-Serpentine-Grey-13x13 ***STD***
Floor Tile Grout	9840	Grout-Pearl Gray #5019 ***STD***
Floor Tile Pattern	3000	STANDARD SQUARE ***STD*** 
Wall Tile	8258	TR.ST.GRY.0810-Serpentine-Grey-8 x 10 ***STD***
Wall Tile Grout	9840	Grout-Pearl Gray #5019 ***UPG***
Wall Tile Pattern	3090	VERTICAL STACKED ***STD*** 
Opt. Shower Floor Tile	1111	N/A *****
Opt. Shower Floor Tile Grout	1111	N/A *****

LM
[Signature]

LOUIS, ANTHONY MCLEAN/DIANA, O MORRIS MCLEAN
Project: Country Lane
Unit: 710, Phase: 7
Model: 30-2794 B The Willowglen

Created: 7/29/2024 10:12:15
Locked:
Closed:

Opt. Shower Floor Tile Pattern	1111	N/A *****
Opt. Shower Jamb(s) and Sill(s)	1111	N/A *****
Plumbing Fixture (colour)	1737	Plumbing Fixtures-WHITE ***STD***
Comment		

Ensuite 4

Cabinet Colour/Style	8379	Viking III-TORONTO-POPPY SEED-MAPLE ***STD***									
Cabinet Hardware	7676	12843-HARDWARE ***STD***									
Countertop	8825	4588K-07-Countertop-KALAHARI TOPAZ-Wilsonart ***STD***									
Countertop Edge	1111	N/A *****									
Floor Tile	8261	TR.ST.BYZ.1313-Serpentine-Beyaz/White-13x13 ***STD***									
Floor Tile Grout	9837	Grout-Warm Grey #5093 ***STD***									
Floor Tile Pattern	3000	STANDARD SQUARE ***STD*** <table><tr><td></td><td></td><td></td></tr><tr><td></td><td></td><td></td></tr><tr><td></td><td></td><td></td></tr></table>									
Shower Wall Tile	8257	TR.ST.BYZ.0810-Serpentine-Beyaz/White-8 x 10 ***STD***									
Shower Wall Tile Grout	9836	Grout-Eggshell #5220 ***STD***									
Shower Wall Tile Pattern	3090	VERTICAL STACKED ***STD*** <table><tr><td></td><td></td><td></td><td></td></tr><tr><td></td><td></td><td></td><td></td></tr></table>									
Shower Floor Tile	8661	OD.ON.SWT.0202.MT.N-Ontario Series Mosaic-Snow White Matte-2 x 2 ***STD***									
Shower Floor Tile Grout	9836	Grout-Eggshell #5220 ***STD***									
Shower Floor Tile Pattern	3000	STANDARD SQUARE ***STD*** <table><tr><td></td><td></td><td></td></tr><tr><td></td><td></td><td></td></tr><tr><td></td><td></td><td></td></tr></table>									
Shower Jamb(s) and Sill(s)	8923	Shower Jamb / Sill-Thassos White ***STD***									
Plumbing Fixture (colour)	1737	Plumbing Fixtures-WHITE ***STD***									
Comment											

Lm
DM

LOUIS, ANTHONY MCLEAN/DIANA, O MORRIS MCLEAN
Project: Country Lane
Unit: 710, Phase: 7
Model: 30-2794 B The Willowglen

Created: 7/29/2021 12:15
Locked:
Closed:

Flooring	9757	TR.AP.GRY.1313-Alpes-Grey-13 x 13 ***STD***									
Floor Tile Grout	9840	Grout-Pearl Gray #5019 ***STD***									
Floor Tile Pattern	3000	STANDARD SQUARE ***STD***									
		<table><tr><td></td><td></td><td></td></tr><tr><td></td><td></td><td></td></tr><tr><td></td><td></td><td></td></tr></table>									
Opt. Cabinet Colour/Style - Uppers	1111	N/A *****									
Opt. Cabinet Hardware - Uppers	1111	N/A *****									
Comment											

Lower Level Finished Foyer

Flooring	9251	88664 MINOTAUR MORNING LIGHT 40 OZ POLY ***STD***
Comment	DIFFERENT COLOUR CARPET IN BASEMNET	

Lower Level Recreation Room

Flooring	9251	88664 MINOTAUR MORNING LIGHT 40 OZ POLY ***STD***
Comment	STD ELECTRICAL FIREPLACE:DIPLEX ELECTRIC FIRE PLACE PF3033, NE 17 GRADE MANTLE (PER PLAN) WHITE STD, NO SURROUND.	

PG 24

Lower Level Bedroom

Flooring	9251	88664 MINOTAUR MORNING LIGHT 40 OZ POLY ***STD***
Comment		

Lower Level Bathroom

Cabinet Colour/Style	6319	Viking III-MANCHESTER-CAVIAR CL-MAPLE ***STD***						
Cabinet Hardware	7672	135-HARDWARE ***STD***						
Countertop	8796	6698-46-Countertop-PALOMA POLAR ETCHINGS FINISH-Formica ***STD***						
Countertop Edge	1111	N/A *****						
Floor Tile	8264	TR.ST.SRK.1313-Serpentine-Syrak/Charcoal-13x13 ***STD***						
Floor Tile Grout	9840	Grout-Pearl Gray #5019 ***STD***						
Floor Tile Pattern	3000	STANDARD SQUARE ***STD***						
		<table><tr><td></td><td></td><td></td></tr><tr><td></td><td></td><td></td></tr></table>						

LM
[Signature]

Customer Colours

LOUIS, ANTHONY MCLEAN/DIANA, O MORRIS MCLEAN
Project: Country Lane
Unit: 710, Phase: 7
Model: 30-2794 B The Willowglen

Created: 7/29/2021 10:12:15
Locked:
Closed:

Shower Wall Tile	8260	TR.ST.SRK.0810-Serpentine-Syrak/Charcoal-8 x 10 ***STD***	
Shower Wall Tile Grout	9845	Grout-Charcoal #5047 ***UPG***	
Shower Wall Tile Pattern	3000	STANDARD SQUARE ***STD***	
Shower Floor Tile	8666	OD.ON.DGR.0202.MT.N-Ontario Series Mosaic-Dark Grey-2 x 2 ***1***	
Shower Floor Tile Grout	9840	Grout-Pearl Gray #5019 ***STD***	
Shower Floor Tile Pattern	3000	STANDARD SQUARE ***STD***	
Shower Jamb(s) and Sill(s)	8923	Shower Jamb / Sill-Thassos White ***STD***	
Plumbing Fixture (colour)	1737	Plumbing Fixtures-WHITE ***STD***	
Comment			

Main Stairs

Type	1712	Oak Stairs ***STD***
Colour	9796	Hillside STAIN TO COMPLIMENT HARDWOOD AND WILL VARY FROM FLOORING ***99***-STD
Handrail/Pickets/Posts Type	8148	Single Collar Alt. Plain w/ Shoes with 3 1/2 Square/Cap Post(s)-BLACK ***STD***
Handrail/Pickets/Posts Colour	9796	Hillside STAIN TO COMPLIMENT HARDWOOD AND WILL VARY FROM FLOORING ***99***-STD
Custom Stain/Paint	1111	N/A *****
Landing(s)	9009	Red Oak PEARL-Vintage Red Oak Solid Sculpted Character PEARL-HILLSIDE-3/4 inch X 5 inch ***STD***
Opt. Carpet Runner	1111	N/A *****
Comment		

Lower Level Stairs

Type	1712	Oak Stairs ***STD***
Colour	9796	Hillside STAIN TO COMPLIMENT HARDWOOD AND WILL VARY FROM FLOORING ***99***-STD
Handrail/Pickets/Posts Type	8148	Single Collar Alt. Plain w/ Shoes with 3 1/2 Square/Cap Post(s)-BLACK ***STD***
Handrail/Pickets/Posts Colour	9796	Hillside STAIN TO COMPLIMENT HARDWOOD AND WILL VARY FROM FLOORING ***99***-STD
Custom Stain/Paint	1111	N/A *****

LM
[Signature]

Customer Colours

LOUIS, ANTHONY MCLEAN/DIANA, O MORRIS MCLEAN
Project: Country Lane
Unit: 710, Phase: 7
Model: 30-2794 B The Willowglen

Created: 7/29/2024 10:12:15
Locked:
Closed:

Landing(s)	9009	Red Oak PEARL-Vintage Red Oak Solid Sculpted Character PEARL-HILLSIDE-3/4 inch X 5 inch ***STD***
Opt. Carpet Runner	1111	N/A *****
Comment		

Throughout

Switches and Plug	5796	Decora White Switches and Plugs ***STD***
Thresholds	2232	Metal Thresholds ***STD***
Underpad	1079	500 Series-Underpad ***STD***
Trim Size	8704	5 1/4 inch Baseboard and 3 inch Integrated Backbend Casings ***UPG*** / ***STD in Singles***
Trim - Paint Colour	1716	Trim-WHITE ***STD***
Walls - Paint Colour	1717	22-Wall-WARM GREY ***STD***
Comment		

Purchaser: L McLean
LOUIS, ANTHONY MCLEAN

26/8/24
Date

[Signature]
Decor Consultant

Aug. 26. 2024
Date

Purchaser: [Signature]
DIANA, O MORRIS MCLEAN

26/08/24
Date

[Signature]
Country Lane

-08- 29 2024
Date Approved



CONSTRUCTION SUMMARY

Lot: 710
Model: 30-2794 B The Willowglen
Project/Phase: Country Lane / 7

Offer Worksheet	Supply and Install Central Air Conditioning Note:
Offer Worksheet	Two Men and a Truck Credit of One Thousand Dollars (\$1000.00) for moving services only, Into your Heathwood Home (No Cash Value) The Credit is Non-Transferable and cannot be combined with any other offer. - Singles Note:
Offer Worksheet	Classic Collection: Five Appliances: SS Fridge, Stove, Dishwasher: White Front Loader Washer/Dryer (Singles) Note:
Offer Worksheet	The Purchaser(s) acknowledge that they have NOT been referred by an existing Heathwood Homeowner and therefor are not entitled to a referral fee under Heathwood Homes Referral program. Note:
Offer Worksheet	This is Possibly a Deck Grading Condition that includes a deck with steps to grade. (Standard Finished Lower Level Plan) Note:
Offer Worksheet	This House requires a Rear Elevation Upgrade Due to Architect Control. Note:



CONSTRUCTION SUMMARY

Lot: 710
Model: 30-2794 B The Willowglen
Project/Phase: Country Lane / 7

APPLIANCES

Invoice	Qty.	Description
1737 389,736 29Aug24 **	1.0	KITCHEN - GRANITE - GRANITE CUTOUT w/ STRAIGHT EDGE POLISH TO ACCOMMODATE COOK TOP SKETCH # 3 SEE COOKTOP SPECS
1737 714,386 29Aug24	1.0	KITCHEN - APPLIANCES - CYCLONE 36 INCH WALL MOUNT CHIMNEY HOOD SS - SCB51436 SEE SPECS CABINETRY-delete stove uppers; ELECTRICAL-Notify; HEATING/AIR CONDITIONING-Duct Size remains 6 i

CABINETRY

Invoice	Qty.	Description
1737 700,010 29Aug24	1.0	SERVERY ONLY - CABINETRY - OPT SERVERY UPPER-VIKING II/III-UPG SKETCH # 3 DRYWAL-Notify; FRAMING-Modify Bulkhead; PAINTING-Notify
1737 714,396 29Aug24	1.0	KITCHEN - CABINETRY-VIKING II/III-OPT. BUILT-INS + 8B INCLUDING SOFT-CLOSE TANDEMBOX POTS AND PANS (2) DRAWERS (WIDTH MIN. 60CM/MAX. 90CM) (SIZE SUBJECT TO FLOOR PLAN)-UPG SKETCH # 3 SEE APPLIANCE SPECS DRYWAL-Notify; FRAMING-Modify Bulkhead; GRANITE-delete partial countertop due to Built-in; PAINTING-
1737 389,736 29Aug24 **	1.0	KITCHEN - GRANITE - GRANITE CUTOUT w/ STRAIGHT EDGE POLISH TO ACCOMMODATE COOK TOP SKETCH # 3 SEE COOKTOP SPECS
1737 714,424 29Aug24	1.0	KITCHEN - CABINETRY - 16B-60CM WIDE PULL-OUT DOOR BASE CABINET WASTE/RECYCLE CENTRE WITH SOFT-CLOSE ([4] BINS TOTAL, INCLUDING [2] 35L) (AVAILABLE ONLY WITH 60CM WIDE CABINET)-VIKING TO BE INSTALLED IN THE ISLAND BESIDE THE SINK SKETCH # 3
1737 389,832 29Aug24 **	1.0	SERVERY ONLY - PLUMBING - BAR SINK - COMPLETE BAR SINK FOR SERVERY INCLUDES PLUMBING ROUGH-IN AND MOEN ALIGN BAR PREP FAUCET (MODEL: 5965) AND BOSCO UNDERMOUNT SINK 207029 (INCLUDING GRANITE SINK CUTOUT/POLISH) - SKETCH # 3 SEE SPECS CABINETRY-Accommodate Servery Sink; CONCRETE AND DRAIN-Additional Stack; GRANITE-Additional Cu
1737 714,386 29Aug24 **	1.0	KITCHEN - APPLIANCES - CYCLONE 36 INCH WALL MOUNT CHIMNEY HOOD SS - SCB51436 SEE SPECS CABINETRY-delete stove uppers; ELECTRICAL-Notify; HEATING/AIR CONDITIONING-Duct Size remains 6 i
1737 714,488 29Aug24	1.0	KITCHEN - CABINETRY - 1L-TWO-TONE COLOUR/STYLE SELECTION FOR ISLAND (MUST BE OF EQUAL OR LOWER LEVEL TO MAIN SELECTION)-VIKING

CARPET

Invoice	Qty.	Description
1773 389,476 09Oct24	1.0	THROUGHOUT - CARPET - DIFFERENT COLOUR CARPET IN BASEMNET; NEED TO SPECIFY DETAILS SUPPLY AND INSTALL STD. 88664 MINOTAUR MORNING LIGHT 40 OZ in LIEU OF STD. MINOTAUR SANDY BEIGE IN : LOWER LEVEL FINISHED FOYER LOWER LEVEL RECREATION ROOM LOWER LEVEL BEDROOM.



CONSTRUCTION SUMMARY

Lot: 710
Model: 30-2794 B The Willowglen
Project/Phase: Country Lane / 7

CERAMICS

Invoice	Qty.	Description
1737 702,872 29Aug24	1.0	KITCHEN - CERAMIC - KITCHEN - BACKSPLASH SINGLES - HERRINGBONE - UPG
1737 702,815 29Aug24	1.0	Kitchen/Breakfast - CERAMIC - KITCHEN/BREAKFAST - FLOOR - UG 6 - UPG
1737 702,873 29Aug24	1.0	Servery - CERAMIC - SERVERY - BACKSPLASH SINGLES SERVERY - HERRINGBONE - UPG
1737 702,914 29Aug24	1.0	Servery - CERAMIC - SERVERY - BACKSPLASH SINGLES SERVERY - UG 1 - UPG
1737 702,816 29Aug24	1.0	Servery - CERAMIC - SERVERY - FLOOR - UG 6 - UPG
1737 702,736 29Aug24	1.0	Foyer - CERAMIC - FOYER - FLOOR - UG 2 - UPG
1737 702,814 29Aug24	1.0	Mud Room - CERAMIC - MUD ROOM - FLOOR - UG 6 - UPG
1737 702,737 29Aug24	1.0	Powder - CERAMIC - POWDER - FLOOR - UG 2 - UPG
1737 707,741 29Aug24	1.0	Master Shower - CERAMIC - MASTER SHOWER - WALL - GROUT - UPG
1737 390,162 29Aug24	1.0	MASTER ENSUITE - CERAMICS - SHOWER NICHE 12 in X 24 in X 4 in ON INTERIOR SHOWER WALL WITH MATCHING JAMBS (CHOICE OF SHOWER WALL OR FLOOR TILE AS BACKING; NO SHELVE) SKETCH # 4 FRAMING-accommodate shower niche
1737 707,719 29Aug24	1.0	Basement Bath - CERAMIC - BASEMENT BATH - WALL - GROUT - UPG
1737 707,758 29Aug24	1.0	Main/Shrd Bath - CERAMIC - MAIN/SHRD BATH - WALL - GROUT - UPG
1737 702,715 29Aug24	1.0	Basement Shower - CERAMIC - BASEMENT SHOWER - MOSAIC - UG 1 - UPG



CONSTRUCTION SUMMARY

Lot: 710
Model: 30-2794 B The Willowglen
Project/Phase: Country Lane / 7

CERAMICS

Invoice	Qty.	Description
1737 702,733 29Aug24	1.0	Master Shower - CERAMIC - MASTER SHOWER - MOSAIC - UG 2 - UPG

CONCRETE AND DRAIN

Invoice	Qty.	Description
1737 389,832 29Aug24 **	1.0	SERVERY ONLY - PLUMBING - BAR SINK - COMPLETE BAR SINK FOR SERVERY INCLUDES PLUMBING ROUGH-IN AND MOEN ALIGN BAR PREP FAUCET (MODEL: 5965) AND BOSCO UNDERMOUNT SINK 207029 (INCLUDING GRANITE SINK CUTOUT/POLISH) - SKETCH # 3 SEE SPECS CABINETRY-Accommodate Servery Sink; CONCRETE AND DRAIN-Additional Stack; GRANITE-Additional Cu

DRYWALL

Invoice	Qty.	Description
1737 700,010 29Aug24 **	1.0	SERVERY ONLY - CABINETRY - OPT SERVERY UPPER-VIKING II/III-UPG SKETCH # 3 DRYWAL-Notify; FRAMING-Modify Bulkhead; PAINTING-Notify
1737 714,396 29Aug24 **	1.0	KITCHEN - CABINETRY-VIKING II/III-OPT. BUILT-INS + 8B INCLUDING SOFT-CLOSE TANDEMBOX POTS AND PANS (2) DRAWERS (WIDTH MIN. 60CM/MAX. 90CM) (SIZE SUBJECT TO FLOOR PLAN)-UPG SKETCH # 3 SEE APPLIANCE SPECS DRYWAL-Notify; FRAMING-Modify Bulkhead; GRANITE-delete partial countertop due to Built-in; PAINTING-
1737 395,461 29Aug24 **	1.0	THROUGHOUT - CLASSIC COLLECTION SCHEDULE A - Choice of 20 LED (3000K) pot lights in finished areas (Second Floor Potlight(s) Require Smooth Ceiling) DRYWALL-Drywall Ceiling cutouts for potlights FRAMING-Frame to accommodate potlights 3 X KITCHEN -USE STD. KITCHEN SWITCH- RELOCATE STD. LIGHT 3 X BREAKFAST ROOM, USE SEPARATE SWITCH- RELOCATE STD. LIGHT 4 X GREAT ROOM- USE SEPARATE SWITCH 4 X HALL WAY- USE 3 WAY HALLWAY SWITCH- RELOCATE POWDER LANDING HALLWAY LIGHT, KEEP DINING ROOM LANDING LIGHT 4 X DINING ROOM USE SEPARATE SWITCH- KEEP STD. R/I CAP LIGHT 2 X MUDROOM USE STD. 3 WAY SWITCH- RELOCATE STD. LIGHT SEE SKETCH # 2



CONSTRUCTION SUMMARY

Lot: 710
Model: 30-2794 B The Willowglen
Project/Phase: Country Lane / 7

ELECTRICAL

Invoice	Qty.	Description
1737 389,736 29Aug24 **	1.0	KITCHEN - GRANITE - GRANITE CUTOUT w/ STRAIGHT EDGE POLISH TO ACCOMMODATE COOK TOP SKETCH # 3 SEE COOKTOP SPECS
1737 395,461 29Aug24	1.0	THROUGHOUT - CLASSIC COLLECTION SCHEDULE A - Choice of 20 LED (3000K) pot lights in finished areas (Second Floor Potlight(s) Require Smooth Ceiling) DRYWALL-Drywall Ceiling cutouts for potlights FRAMING-Frame to accommodate potlights 3 X KITCHEN -USE STD. KITCHEN SWITCH- RELOCATE STD. LIGHT 3 X BREAKFAST ROOM, USE SEPARATE SWITCH- RELOCATE STD. LIGHT 4 X GREAT ROOM- USE SEPARATE SWITCH 4 X HALL WAY- USE 3 WAY HALLWAY SWITCH- RELOCATE POWDER LANDING HALLWAY LIGHT, KEEP DINING ROOM LANDING LIGHT 4 X DINING ROOM USE SEPARATE SWITCH- KEEP STD. R/I CAP LIGHT 2 X MUDROOM USE STD. 3 WAY SWITCH- RELOCATE STD. LIGHT SEE SKETCH # 2
1737 390,519 29Aug24	3.0	THROUGHOUT - ELECTRICAL-OUTLET-EXTRA WALL INTERIOR OUTLET ON EXISTING CIRCUIT (DOES NOT INCLUDE KITCHEN OUTLETS) 1X GREAT ROOM- TO BE INSTALL ABOVE THE FIRE PLACE 70"+- FROM FLOOR 1X FAMILY(REC) ROOM-TO BE INSTALL ABOVE THE FIRE PLACE 70"+- FROM FLOOR 1X MASTER BEDROOM ON WALL 70"+- FROM FLOOR SEE SKETCH # 'S 1, 2 AND 4
1737 390,528 29Aug24	4.0	THROUGHOUT - ELECTRICAL-RELOCATION OF SWITCHES/LIGHTS (MUST SPECIFY LOCATION)-NOTE: PLUGS CANNOT BE RELOCATED- MUST PURCHASE ADDITIONAL OUTLET. RELOCATE KITCHEN, BREAKFAST ROOM AND HALL WAY LIGHT (POWDER ROOM LANDING) TO BE ABOVE THE BREAKFAST BAR- USE KITCHEN LIGHT SWITCH SKETCH # 2 RELOCATE MUDROOM LIGHT TO BE ABOVE THE STAIRS -USE THE SAME 3 WAY AS UPPER HALLWAY LIGHT SWITCH SEE SKETCH # 4
1737 714,386 29Aug24 **	1.0	KITCHEN - APPLIANCES - CYCLONE 36 INCH WALL MOUNT CHIMNEY HOOD SS - SCB51436 SEE SPECS CABINETRY-delete stove uppers; ELECTRICAL-Notify; HEATING/AIR CONDITIONING-Duct Size remains 6 i
1737 390,528 29Aug24	1.0	LAUNDRY ROOM - ELECTRICAL-RELOCATION OF SWITCHES/LIGHTS (MUST SPECIFY LOCATION)-NOTE: PLUGS CANNOT BE RELOCATED- MUST PURCHASE ADDITIONAL OUTLET. RELOCATE LAUNDRY ROOM ELECTRICAL FOR STACKED WASHER AND DRYER SKETCH # 4
1737 390,509 29Aug24	1.0	KITCHEN - ELECTRICAL-OUTLET-40AMP/240V ADDITIONAL, PLEASE SPECIFY LOCATION TO BE USED FOR THE WALL OVENS SKETCH # 3 SEE SPECS
1737 714,599 29Aug24	1.0	SERVERY ONLY - ELECTRICAL-OUTLET-CHANGE EXISITING INTERIOR DUPLEX OUTLET TO G.F.I. ON AN EXISTING CIRCUIT SKETCH # 3



CONSTRUCTION SUMMARY

Lot: 710
Model: 30-2794 B The Willowglen
Project/Phase: Country Lane / 7

FRAMING

Invoice	Qty.	Description
1737 700,010 29Aug24 **	1.0	SERVERY ONLY - CABINETRY - OPT SERVERY UPPER-VIKING II/III-UPG SKETCH # 3 DRYWAL-Notify; FRAMING-Modify Bulkhead; PAINTING-Notify
1737 714,396 29Aug24 **	1.0	KITCHEN - CABINETRY-VIKING II/III-OPT. BUILT-INS + 8B INCLUDING SOFT-CLOSE TANDEMBOX POTS AND PANS (2) DRAWERS (WIDTH MIN. 60CM/MAX. 90CM) (SIZE SUBJECT TO FLOOR PLAN)-UPG SKETCH # 3 SEE APPLIANCE SPECS DRYWAL-Notify; FRAMING-Modify Bulkhead; GRANITE-delete partial countertop due to Built-in; PAINTING-
1737 395,461 29Aug24 **	1.0	THROUGHOUT - CLASSIC COLLECTION SCHEDULE A - Choice of 20 LED (3000K) pot lights in finished areas (Second Floor Potlight(s) Require Smooth Ceiling) DRYWALL-Drywall Ceiling cutouts for potlights FRAMING-Frame to accommodate potlights 3 X KITCHEN -USE STD. KITCHEN SWITCH- RELOCATE STD. LIGHT 3 X BREAKFAST ROOM, USE SEPARATE SWITCH- RELOCATE STD. LIGHT 4 X GREAT ROOM- USE SEPARATE SWITCH 4 X HALL WAY- USE 3 WAY HALLWAY SWITCH- RELOCATE POWDER LANDING HALLWAY LIGHT, KEEP DINING ROOM LANDING LIGHT 4 X DINING ROOM USE SEPARATE SWITCH- KEEP STD. R/I CAP LIGHT 2 X MUDROOM USE STD. 3 WAY SWITCH- RELOCATE STD. LIGHT SEE SKETCH # 2

GRANITE

Invoice	Qty.	Description
1737 714,396 29Aug24 **	1.0	KITCHEN - CABINETRY-VIKING II/III-OPT. BUILT-INS + 8B INCLUDING SOFT-CLOSE TANDEMBOX POTS AND PANS (2) DRAWERS (WIDTH MIN. 60CM/MAX. 90CM) (SIZE SUBJECT TO FLOOR PLAN)-UPG SKETCH # 3 SEE APPLIANCE SPECS DRYWAL-Notify; FRAMING-Modify Bulkhead; GRANITE-delete partial countertop due to Built-in; PAINTING-
1737 389,736 29Aug24	1.0	KITCHEN - GRANITE - GRANITE CUTOUT w/ STRAIGHT EDGE POLISH TO ACCOMMODATE COOK TOP SKETCH # 3 SEE COOKTOP SPECS
1737 389,832 29Aug24 **	1.0	SERVERY ONLY - PLUMBING - BAR SINK - COMPLETE BAR SINK FOR SERVERY INCLUDES PLUMBING ROUGH-IN AND MOEN ALIGN BAR PREP FAUCET (MODEL: 5965) AND BOSCO UNDERMOUNT SINK 207029 (INCLUDING GRANITE SINK CUTOUT/POLISH) - SKETCH # 3 SEE SPECS CABINETRY-Accommodate Servery Sink; CONCRETE AND DRAIN-Additional Stack; GRANITE-Additional Cu

HEATING / AIR CONDITIONING

Invoice	Qty.	Description
1737 389,796 29Aug24	1.0	- HEATING/AIR - ROUGH-IN GAS LINE FOR BBQ AT MAIN FLOOR UP TO 40 FT (QUICK CONNECT NOT INCLUDED); ELECTRICAL OUTLET PRICED SEPARATELY IF REQUIRED SKETCH # 2
1737 714,386 29Aug24 **	1.0	KITCHEN - APPLIANCES - CYCLONE 36 INCH WALL MOUNT CHIMNEY HOOD SS - SCB51436 SEE SPECS CABINETRY-delete stove uppers; ELECTRICAL-Notify; HEATING/AIR CONDITIONING-Duct Size remains 6 i



CONSTRUCTION SUMMARY

Lot: 710
Model: 30-2794 B The Willowglen
Project/Phase: Country Lane / 7

PAINTING

Invoice	Qty.	Description
1737 700,010 29Aug24 **	1.0	SERVERY ONLY - CABINETRY - OPT SERVERY UPPER-VIKING II/III-UPG SKETCH # 3 DRYWAL-Notify; FRAMING-Modify Bulkhead; PAINTING-Notify
1737 714,396 29Aug24 **	1.0	KITCHEN - CABINETRY-VIKING II/III-OPT. BUILT-INS + 8B INCLUDING SOFT-CLOSE TANDEMBOX POTS AND PANS (2) DRAWERS (WIDTH MIN. 60CM/MAX. 90CM) (SIZE SUBJECT TO FLOOR PLAN)-UPG SKETCH # 3 SEE APPLIANCE SPECS DRYWAL-Notify; FRAMING-Modify Bulkhead; GRANITE-delete partial countertop due to Built-in; PAINTING-

PLUMBING

Invoice	Qty.	Description
1737 389,564 29Aug24	1.0	LAUNDRY ROOM - PLUMBING - RELOCATE LAUNDRY TUB RELOCATE LAUNDRY TUB FROM BASEMENT TO SECOND FLOOR LAUNDRY ROOM NO BASE CABINET SKETCH # 4
1737 389,832 29Aug24	1.0	SERVERY ONLY - PLUMBING - BAR SINK - COMPLETE BAR SINK FOR SERVERY INCLUDES PLUMBING ROUGH-IN AND MOEN ALIGN BAR PREP FAUCET (MODEL: 5965) AND BOSCO UNDERMOUNT SINK 207029 (INCLUDING GRANITE SINK CUTOUT/POLISH) - SKETCH # 3 SEE SPECS CABINETRY-Accommodate Servery Sink; CONCRETE AND DRAIN-Additional Stack; GRANITE-Additional Cu
1737 389,456 29Aug24	1.0	MASTER ENSUITE - PLUMBING - MOEN -CHATEAU - POSI-TEMP SHOWER WITH 3 FUNCTION DIVERTER VALVE, SLIDE BAR WITH HANDHELD (MODEL: 62320/U361CI/UT2721/TL182EP/3669EP/A725) SEE SPEC

Sketch #1



30-2794 ELEV. B

The Willowglen

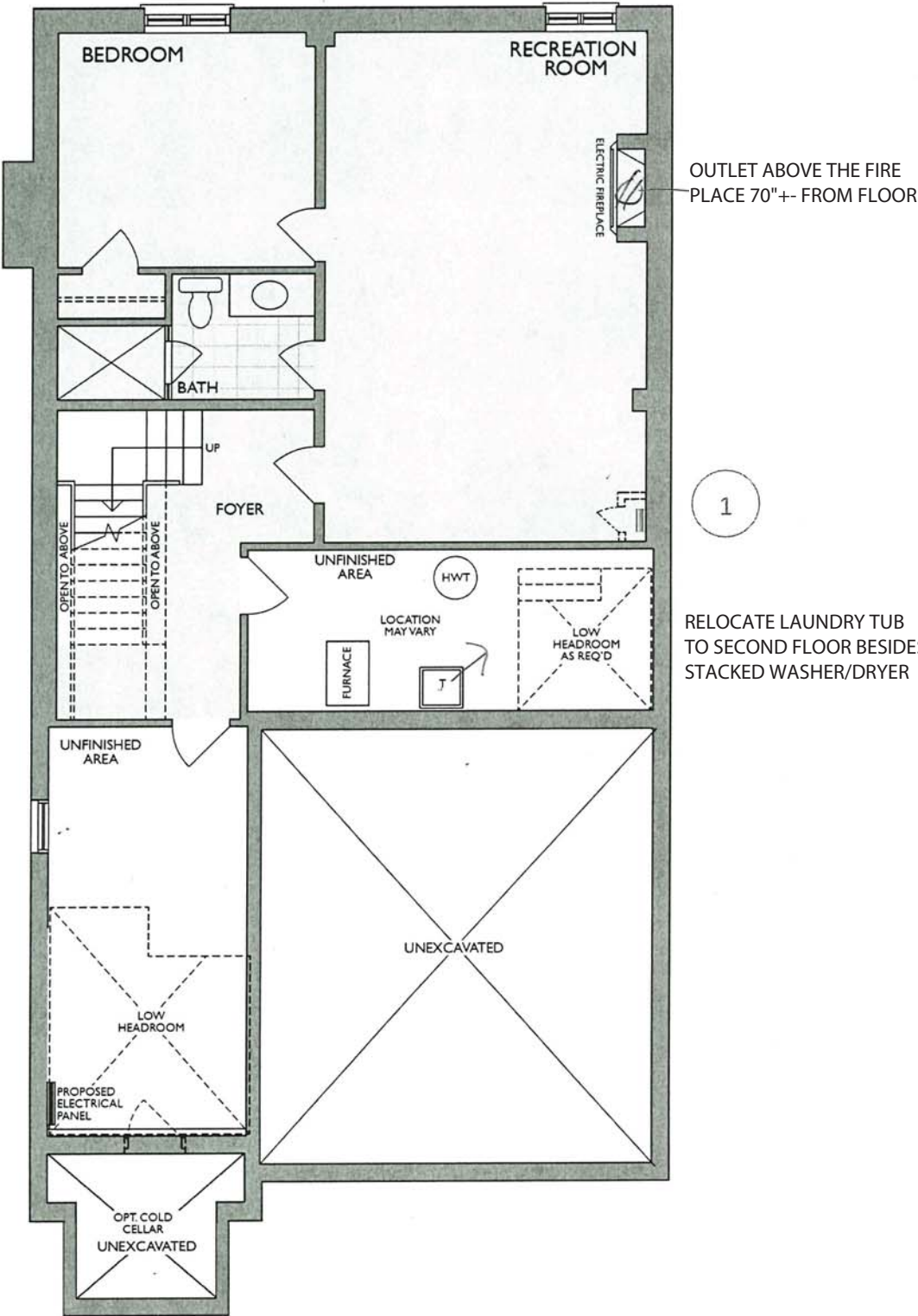

FINISHED LOWER LEVEL
ELEV. A & B

- Changes made to match the Architectural plan:**
- 1. Hydro closet when required

LmLean



Sketch #2

30-2794 ELEV. B

The Willowglen

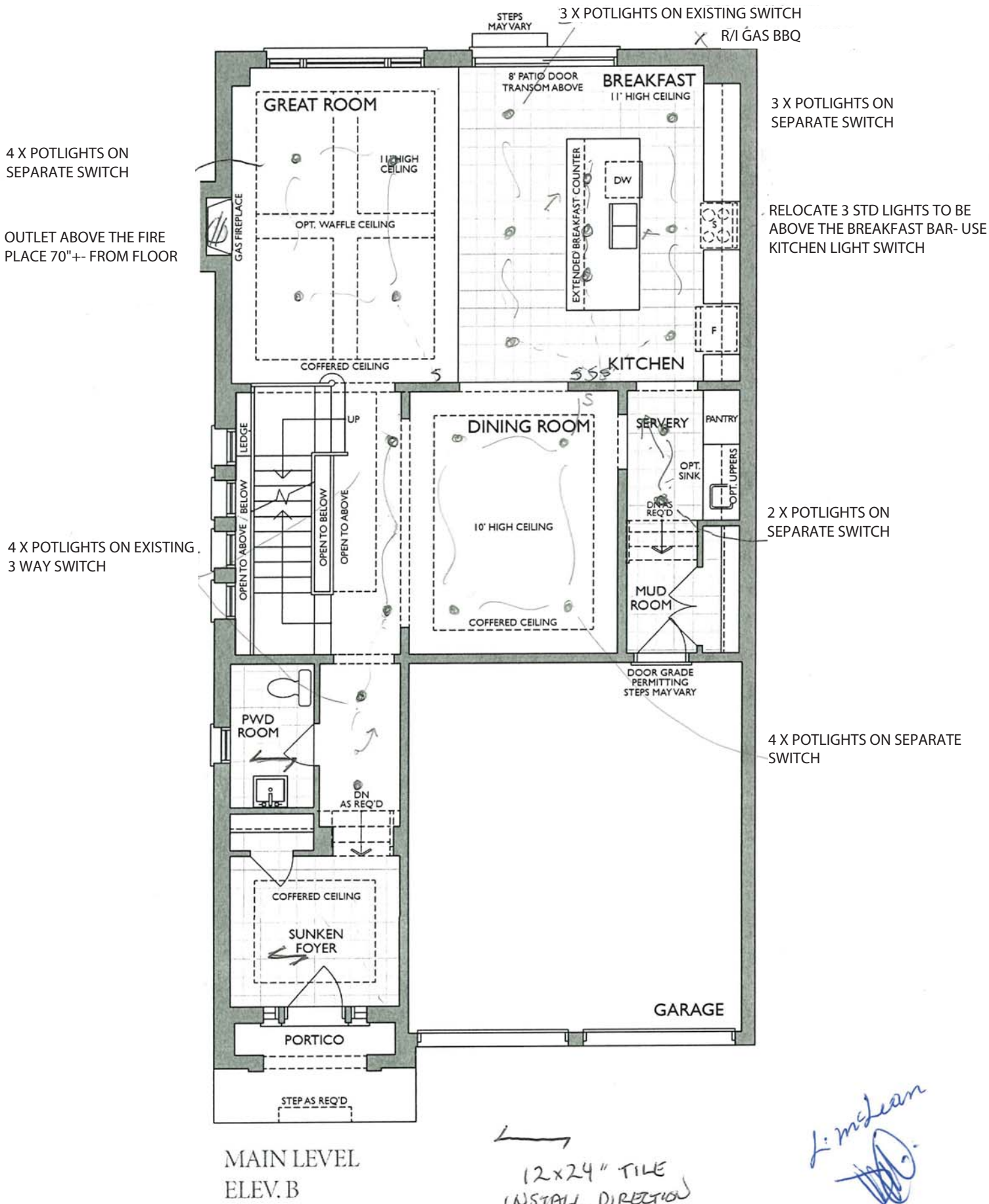

Handwritten signature: L. McLean

* Floor plan may vary due to grading conditions.

Project: Country Lane
Unit: 710, Phase: 7
Model: 30-2794 B The Willowglen

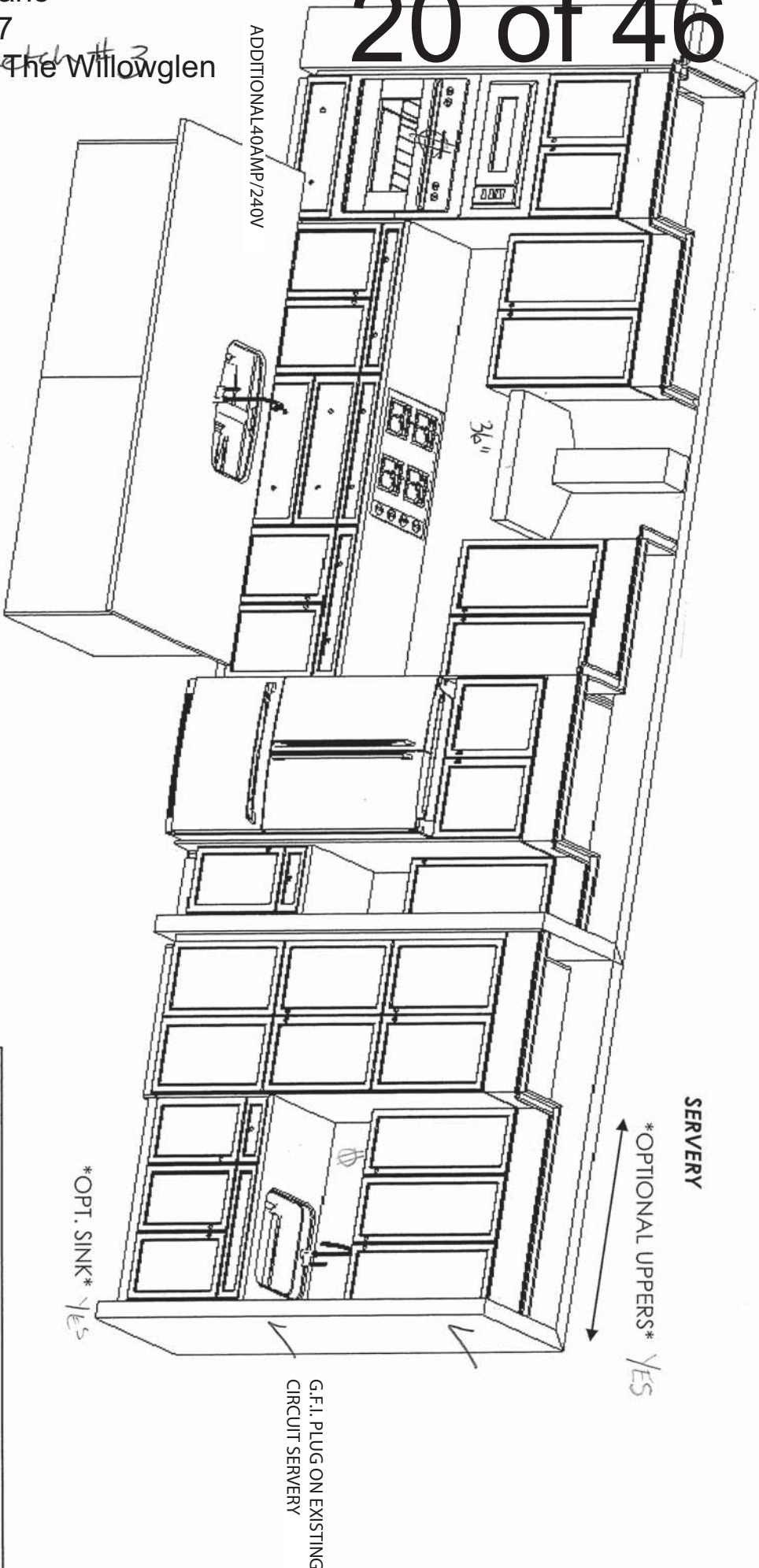

60CM WIDE (4 BINS) WASTE/
RECYCLE CENTRE (INCLUDE TOP
DRAWER)

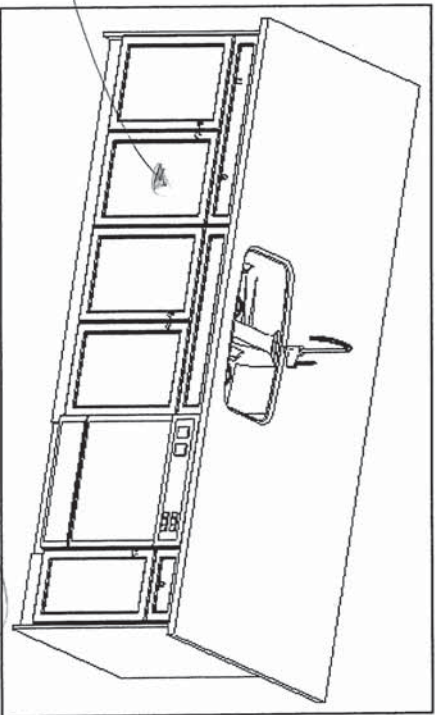

F R E N D E L
K I T C H E N S L I M I T E D
1350 Shearson Drive, Mississauga, ON L4W 1G5

HEATHWOOD HOMES
COUNTRY LANE, WHITBY
TRADITIONS
MODEL: 30-2794 (3604)
THE CLASSIC SERIES

Standard Features:

- Tandem Box Soft Close Drawers
- Blumotion Hinges for Doors
- Crown Moulding & fascia
- Top Drawer Construction
- Deep Fridge Upper w/Deep Panel
- Tall upper Cabinets

Drawn By: Sepideh B
Date: April 8, 2024
Revision:
Scale: Not To Scale

Approved By Builder:

Date:

Sketch #4



30-2794 ELEV. B

The Willowglen

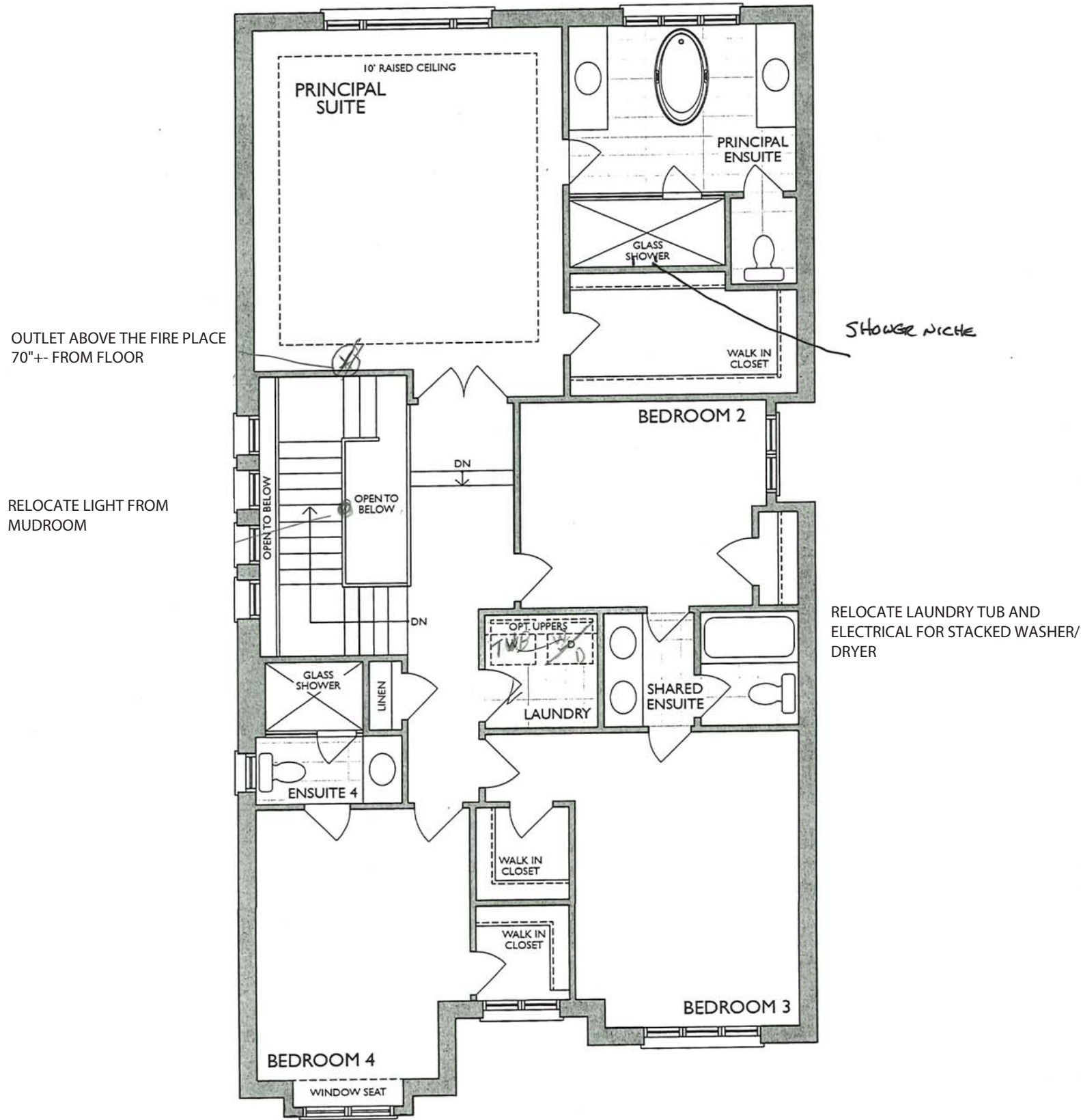

SECOND LEVEL
ELEV. B

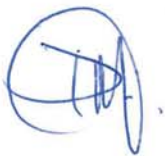

* Floor plan may vary due to grading conditions.

Project: Country Lane
Unit: 710, Phase 5
Model: 30-2794 B The Willowglen

MASTER ENSUITE
2nd FLR

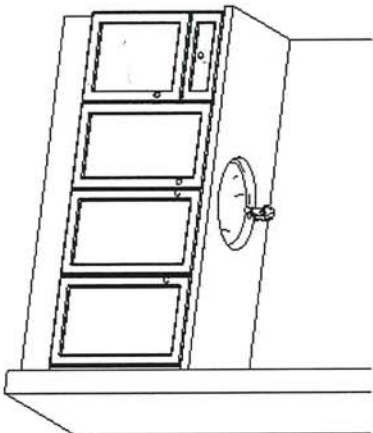
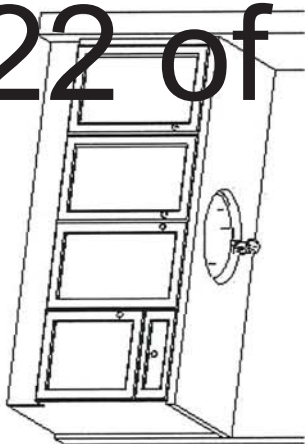

MAIN/SHARED BATH
2nd FLR

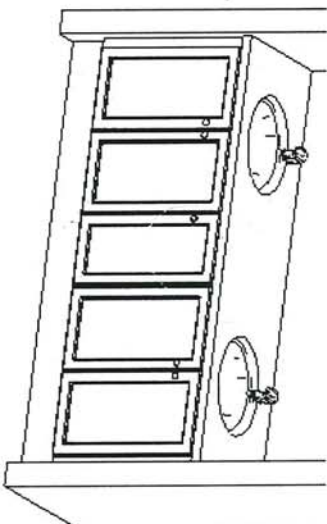

ENSUITE 4
2nd FLR

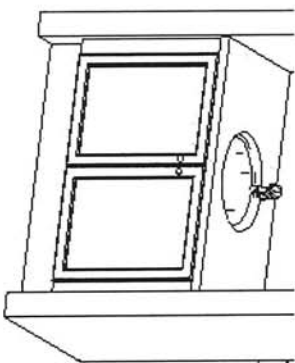

BASEMENT BATH

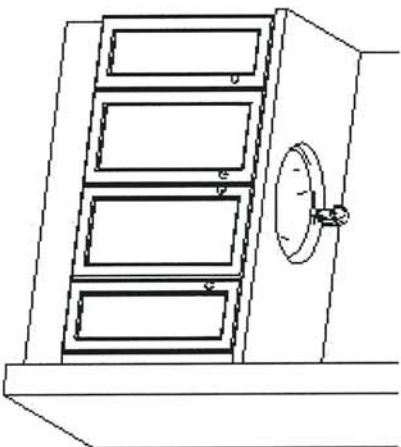

LAUNDRY
2nd FLR
~~OPTIONAL LAUNDRY UPPERS~~

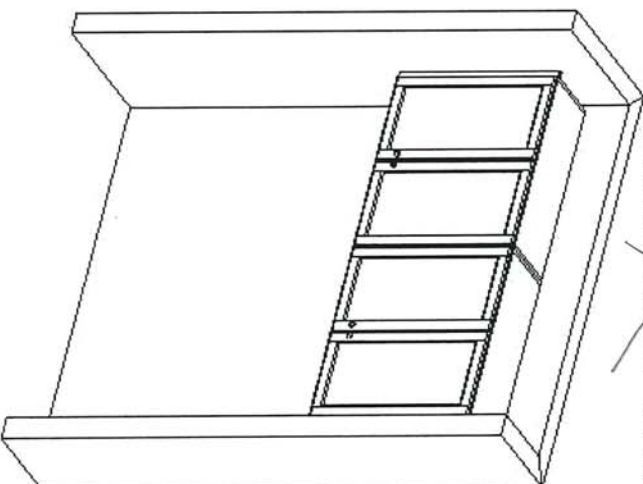

L McLean



F R E N D E L
KITCHENS LIMITED
1350 Shawson Drive, Mississauga, ON L4W 1C5

HEATHWOOD HOMES
COUNTRY LANE, WHITBY
TRADITIONS

MODEL: 30-2794 (3604)

THE CLASSIC SERIES

Standard Features:

- Blum Metabox Drawers
- Blum Clip On Hinges
- Top drawer in Master Ensuite
- Laminate tops

Drawn By: Sepideh B
Date: April 8, 2024
Revision:
Scale: Not To Scale

Approved By Builder:

Date:

PRINCIPAL ENSUITE

Sketch #6

2 inches
D.D.

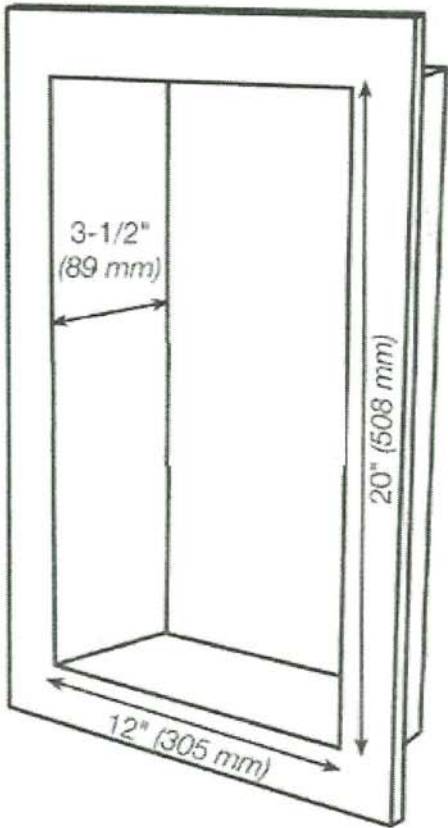



NEAS NF17 Mantel

FLAT WALL - GREAT ROOM
CABINET - REC ROOM FOR
ELECTRIC FIREPLACE

2 inches

[Handwritten signature]

18" Wide cabinet : B17-45cm wide pull-out door base cabinet waste/recycle centre with soft-close ([2] 35L bins per unit) (available only with 45cm wide cabinet)

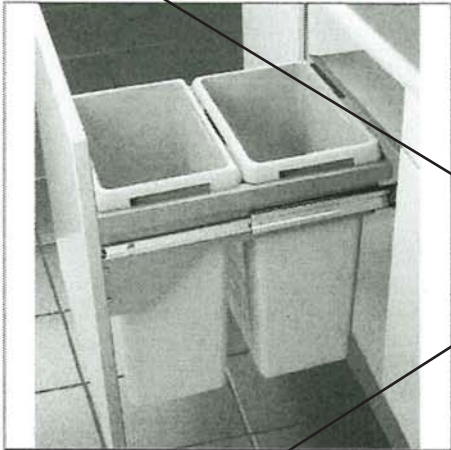

Euro-Cargo Recycling Center

Make your life easier with the Euro-Cargo sliding waste bin. Full-extension slides give you complete access to your bins. The integrated lid remains fixed inside your cabinet, and once the system is closed, the lid covers the bins to prevent odors from escaping.

Product # 3614100 [View list](#)

Total Capacity 76 l

76 l

93 l

Interior Dimensions Required - Width 412 to 418 mm

412 to 418 mm

462 to 468 mm

562 to 568 mm

Bin Quantity 2

2

4

Bin Capacity 2 x 38 liters

2 x 38 L + 2 x 8.5 L

2 x 38 liters

16 B
24" wide cabinet : B18-60cm wide pull-out door base cabinet waste/recycle centre with soft-close ([4] bins total, including [2] 35L) (available only with 60cm or 24" wide cabinet)



Euro-Cargo Recycling Center

Make your life easier with the Euro-Cargo sliding waste bin. Full-extension slides give you complete access to your bins. The integrated lid remains fixed inside your cabinet, and once the system is closed, the lid covers the bins to prevent odors from escaping.

Product # 361460100 [View list](#)

Total Capacity 93 l

76 l

93 l

Interior Dimensions Required - Width 562 to 568 mm

412 to 418 mm

462 to 468 mm

562 to 568 mm

Bin Quantity 4

2

4

Bin Capacity 2 x 38 L + 2 x 8.5 L

2 x 38 L + 2 x 8.5 L

2 x 38 liters

TOP DRAWER

✓
Linclean
[Signature]

SEE REVISED PGS 47-48 CHANGED TO SINGLE BOWL

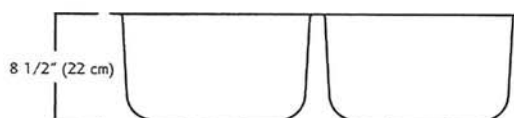
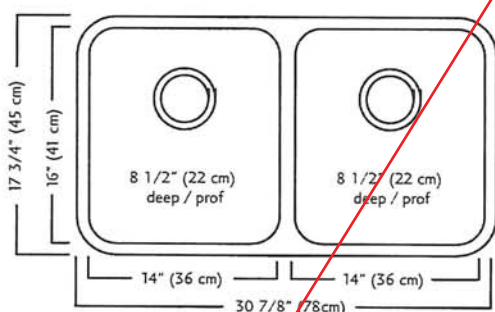
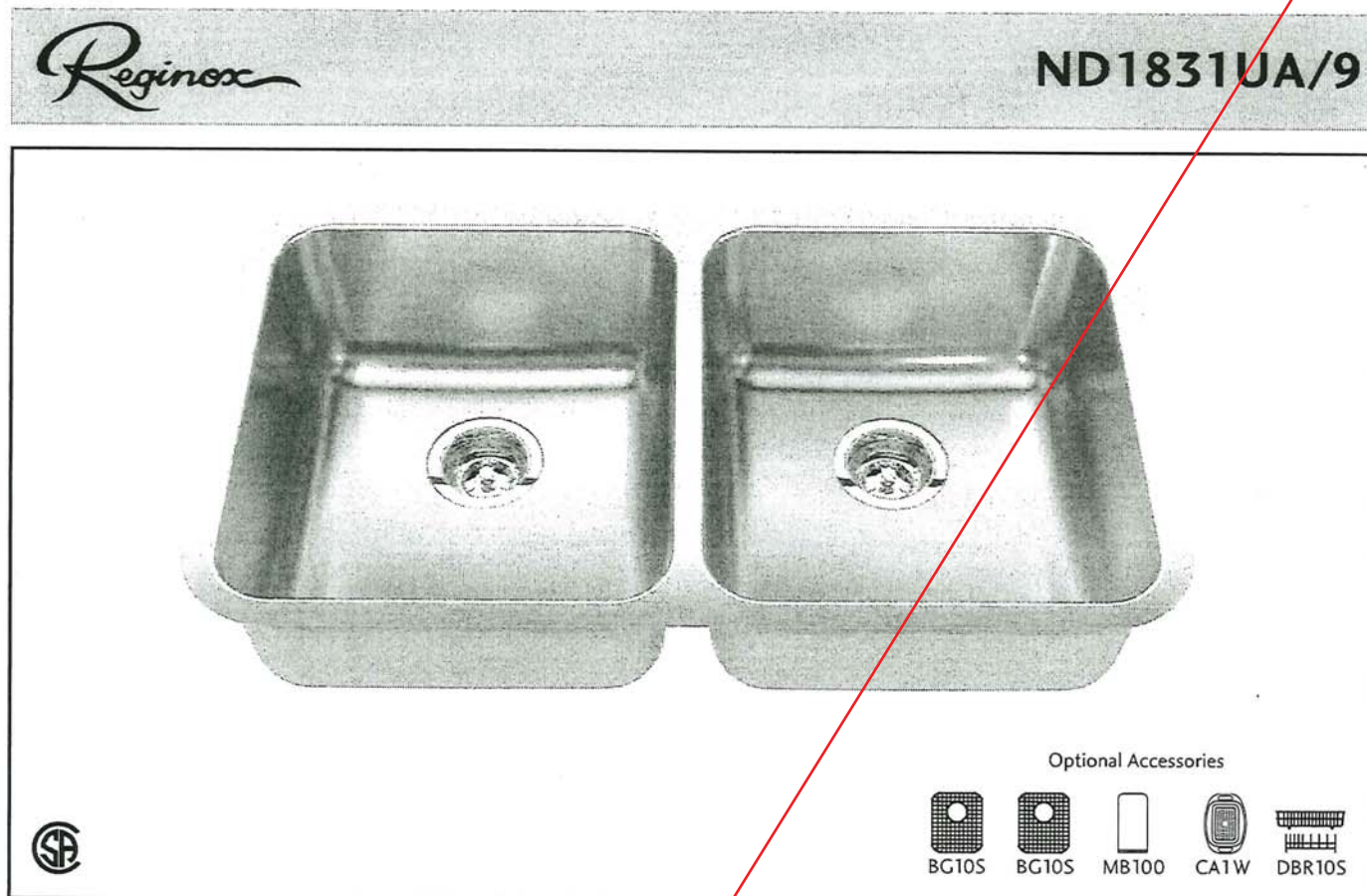

Lincoln

ND1831UA/9 SPECIFICATION

Model ND1831UA/9 is a double (two equal size) bowl undermount sink manufactured by Franke Kindred Canada Limited from 18 gauge stainless steel. Product has silk finished rims and linear brush finished bowls. Sink is fully undercoated. Basket strainer waste fittings (3 1/2\", 89 mm) are included. Sink is backed with a limited lifetime warranty.

- O.D. 17 3/4\" x 30 7/8\" x 8 1/2\" (45 x 78 x 22 cm)
- Recommended for minimum 36\" cabinet

Franke Kindred Canada Limited
P.O. Box 190, 1000 Franke Kindred Road, Midland, Ontario, Canada, L4R 4K9 Phone: 866-687-7465 Fax: 800-361-8408

MOEN®

Specifications

FAUCET DESCRIPTION

- Reflex™ pulldown system offers smooth operation, easy movement and secure docking
- Power Clean™ spray technology
- Metal construction with various finishes identified by suffix
- Quick connect installation
- Pulldown spray with 68" braided hose
- Flexible supply lines with 3/8" compression fittings
- High arc spout provides height and reach to fill or clean large pots while pulldown wand provides the maneuverability for cleaning or rinsing
- 360° rotating spout
- Faucet designed for handle to be mounted on right side only

OPERATION

- Lever style handle
- Temperature controlled by 100° arc of handle travel
- Operates with less than 5 lbs. of force
- Operates in stream or spray mode in the pullout or retracted position

FLOW

- Flow is limited to 1.5 gpm (5.7 L/min) max at 60 psi

CARTRIDGE

- 1255™ Duralast™ cartridge

STANDARDS

- Third party certified to IAPMO Green, ASME A112.18.1/CSA B125.1 and all applicable requirements therein including NSF 61/9G & 372
- Meets CalGreen and Georgia SB370 requirements
- Complies with California Proposition 65 and with the Federal Safe Drinking Water Act
- The backflow protection system in the device consists of two independently operating check valves, a primary and a secondary which prevent backflow

- **ADA**  for lever handle

WARRANTY

- Lifetime limited warranty against leaks, drips and finish defects to the original homeowner
 - 10 year limited warranty when used in a multifamily installation
 - 5 year limited warranty when used in a commercial installation
- Visit www.moen.com/support for complete details and limitations

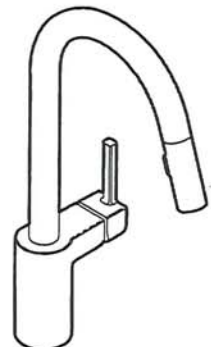

ALIGN™
Single Handle High Arc
Pulldown Kitchen Faucet

Models: 7565 series

NOTE: THIS FAUCET IS DESIGNED TO BE INSTALLED
THROUGH 1 HOLE, 1-1/2" (38mm) MIN. DIA.
(OPTIONAL 3-HOLE ESCUTCHEON 141002 AVAILABLE)

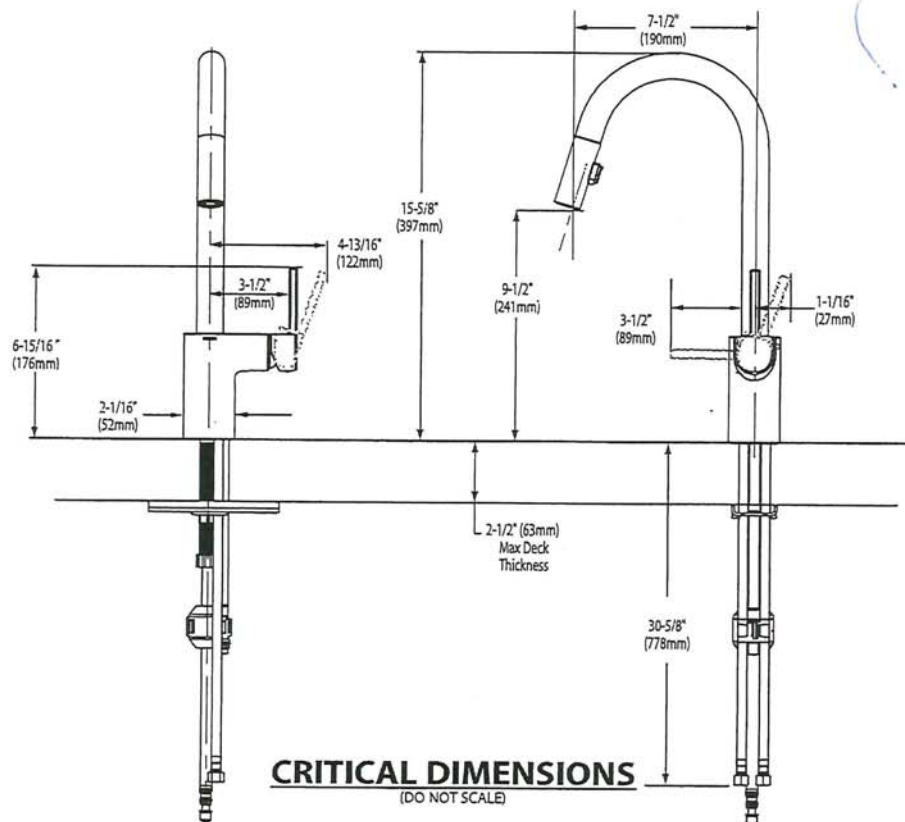

Lmcliam

SERVERY SINK



Phone: 416-742-1888 | Fax: 416-742-6888
www.boscocanada.com | info@boscocanada.com
5171 Steeles Avenue West | Toronto, Ontario M9L 1R5

Builder Series - Model:207029
Undermount

Rear positioned drain holes to maximize usable bowl and cabinet storage space below

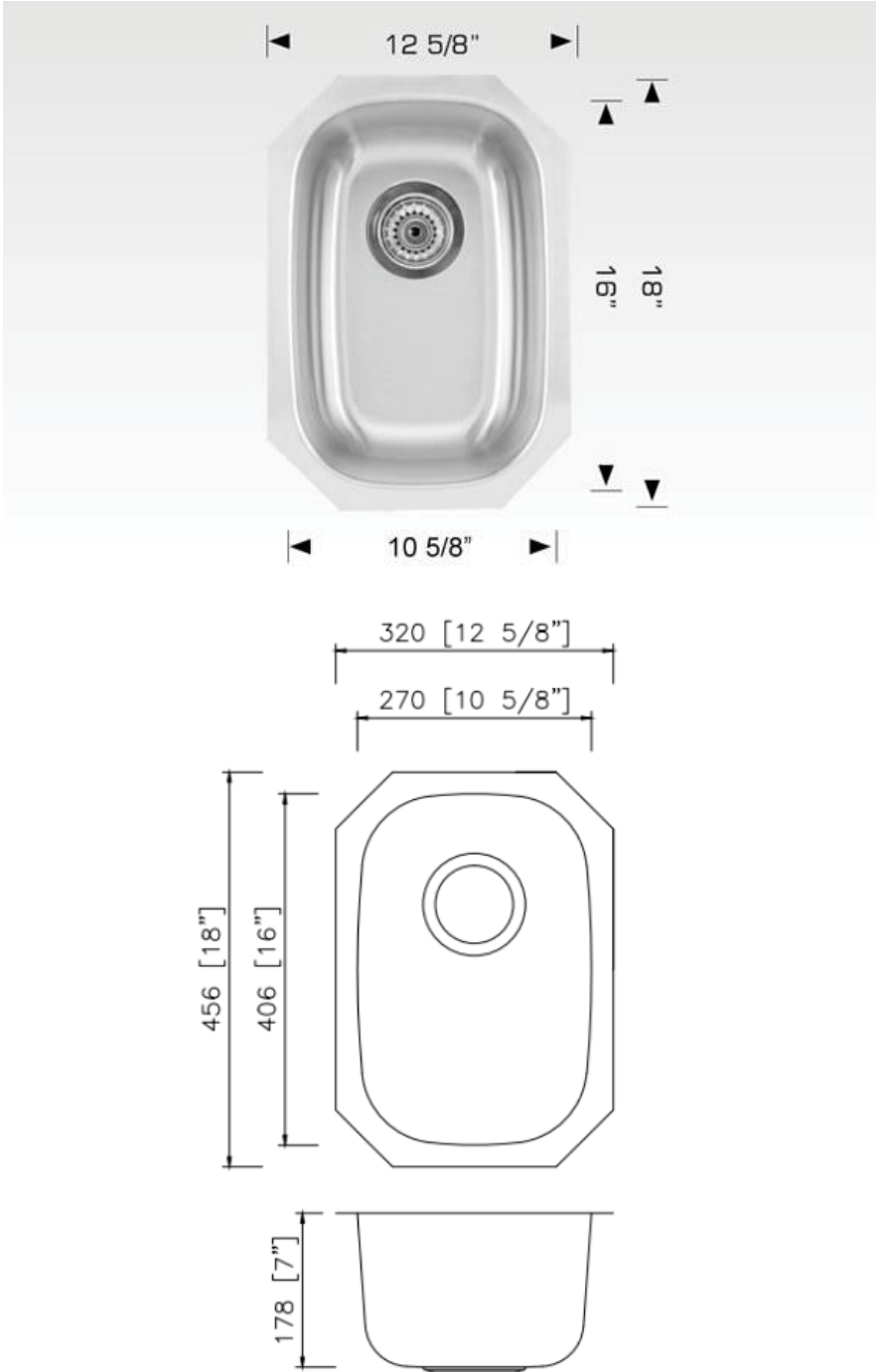

Specifications:

- 304 Stainless Steel
- 18 Gauge
- Strainer
- Undermount Clips
- 7" Deep

Outside:
12 5/8" x 18" x 7"
Inside:
10 5/8" x 16" x 7"

Minimum cabinet size 15"

Certification/Warranty

- ASME A 112.19.3
- CSA B45.4
- Limited Lifetime Warranty

Optional Accessories



Model: G207029
Grid

Bosco Canada Inc. is known around the world for producing high quality kitchen sinks that incorporate modern design and functional superiority in every piece they manufacture.



Specifications

FAUCET DESCRIPTION

- Reflex™ pulldown system offers smooth operation, easy movement and secure docking
- Power Clean™ spray technology
- Metal construction with various finishes identified by suffix
- Quick connect installation
- Pulldown spray with 68" braided hose
- Flexible supply lines with 3/8" compression fittings
- High arc spout provides the perfect height and reach for prep sinks while the pulldown feature provides maneuverability for food preparation tasks
- 360° rotating spout provides ability to install handle on either side
- Faucet designed for handle to be mounted on right side

OPERATION

- Lever style handle
- Temperature controlled by 100° arc of handle travel
- Operates with less than 5 lbs. of force
- Operates in stream or spray mode in the pullout or retracted position

FLOW

- Flow is limited to 1.5 gpm (5.7 L/min) max at 60 psi

CARTRIDGE

- 1255™ Duralast™ cartridge for Single-Handle Faucets

STANDARDS

- Third party certified to IAPMO Green, ASME A112.18.1/CSA B125.1 and all applicable requirements referenced therein including NSF 61/9G & 372
- Meets CalGreen and Georgia SB370 requirements
- Complies with California Proposition 65 and with the Federal Safe Drinking Water Act
- The backflow protection system in the device consists of two independently operating check valves, a primary and a secondary which prevent backflow

- ADA  for lever handle

WARRANTY

- Lifetime limited warranty against leaks, drips and finish defects to the original homeowner
 - 10 year limited warranty when used in a multifamily installation
 - 5 year limited warranty when used in a commercial installation
- Visit www.moen.com/support for complete details and limitations

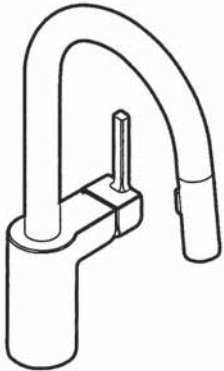

ALIGN™
Single Handle High Arc
Pulldown Prep/Bar Faucet

Models: 5965 series

NOTE: THIS FAUCET IS DESIGNED TO BE INSTALLED
THROUGH 1 HOLE, 1-1/2" (38mm) MIN. DIA.
(OPTIONAL 3-HOLE ESCUTCHEON 141002 AVAILABLE)

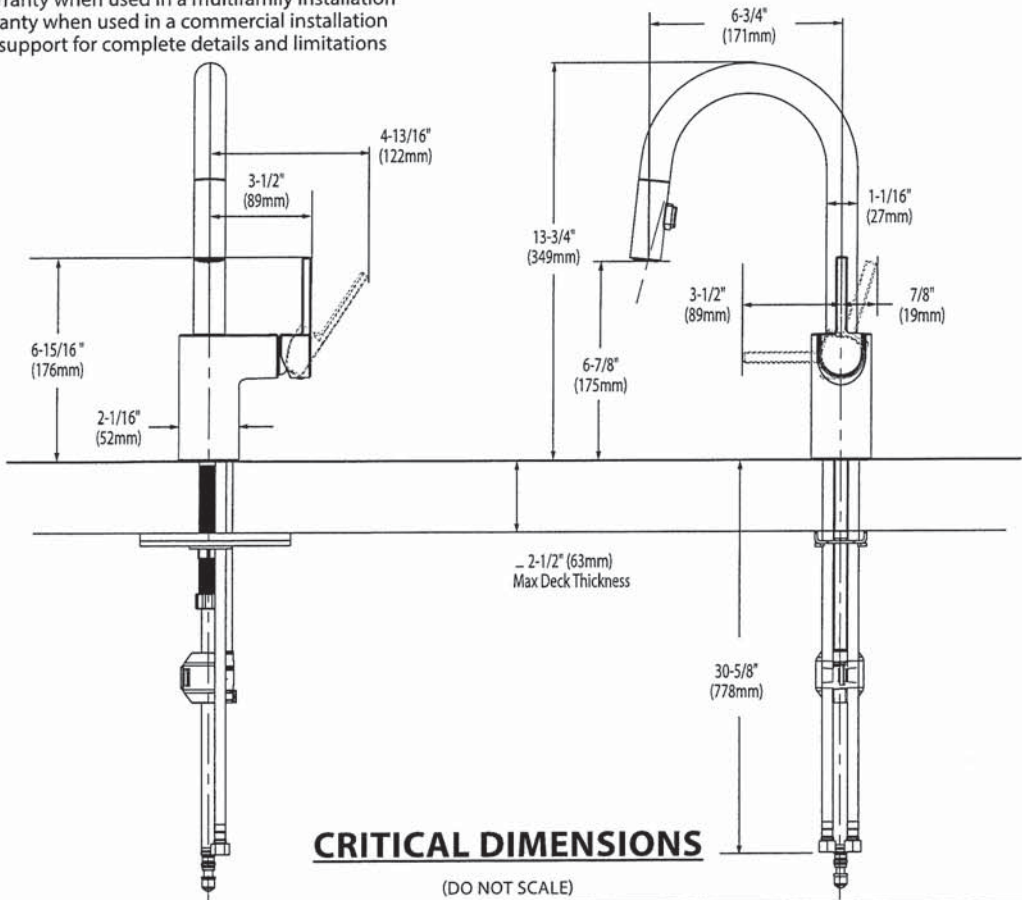



BARRIER FREE (ABOVE COUNTER OR DROP-IN ONLY)

BOULEVARD®
PEDESTAL SINK
VITREOUS CHINA

BOULEVARD® PEDESTAL SINK

- STD ☐ ~~0641.800~~ Faucet holes on 8" (203mm) centers (Illustrated)
- ☒ **0641.400** Faucet holes on 4" (102mm) centers
- ☐ ~~0641.100~~ Center hole only
- Classic styled rectangular pedestal lavatory
 - Vitreous china
 - Rear overflow
 - Supplied with mounting kit
 - Right Height® for greater comfort during use
 - Faucet ledge with large deck area (faucet not included)
 - **Design coordinates with Boulevard® Toilet**
 - Basin has flat bottom to also allow use as an **above counter** sink or a **drop-in** sink (with u-shaped cut out)

Nominal Dimensions:

24" x 19" x 35-1/2"
(610 x 483 x 902mm)

- ☐ **0641.008** Pedestal top-8" (203mm) centers
- ☐ **0641.004** Pedestal top-4" (102mm) centers
- ☐ **0641.001** Pedestal top-center hole only
- ☐ **0010.000** Pedestal only

Bowl sizes:

17" (432mm) wide,
12-1/2" (318mm) front to back,
5" (127mm) deep

Compliance Certifications -

- Meets or Exceeds the Following Specifications:**
- ASME A112.19.2 - 2008/CSA B45.1-08

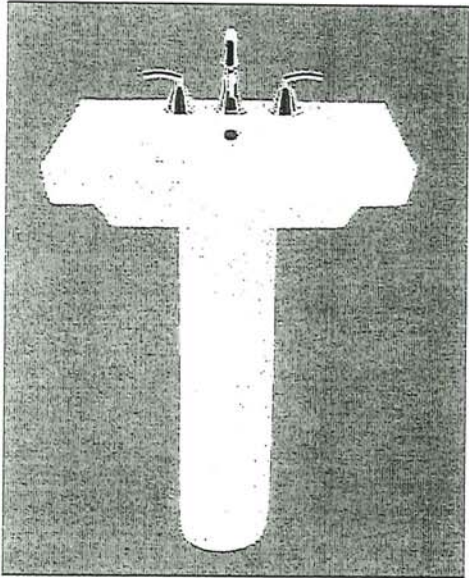

SEE REVERSE FOR ROUGHING-IN DIMENSIONS

To Be Specified:

- ☐ Color: ☐ White ☐ Linen
- ☐ Faucet Finish:
- ☐ Supplies:
- ☐ 1-1/4" Trap:
- ☐ Nipple:

* See faucet section for additional models available

J. McLean

American
Standard

 BARRIER FREE (ABOVE COUNTER OR DROP-IN ONLY)

BOULEVARD®
PEDESTAL SINK
VITREOUS CHINA

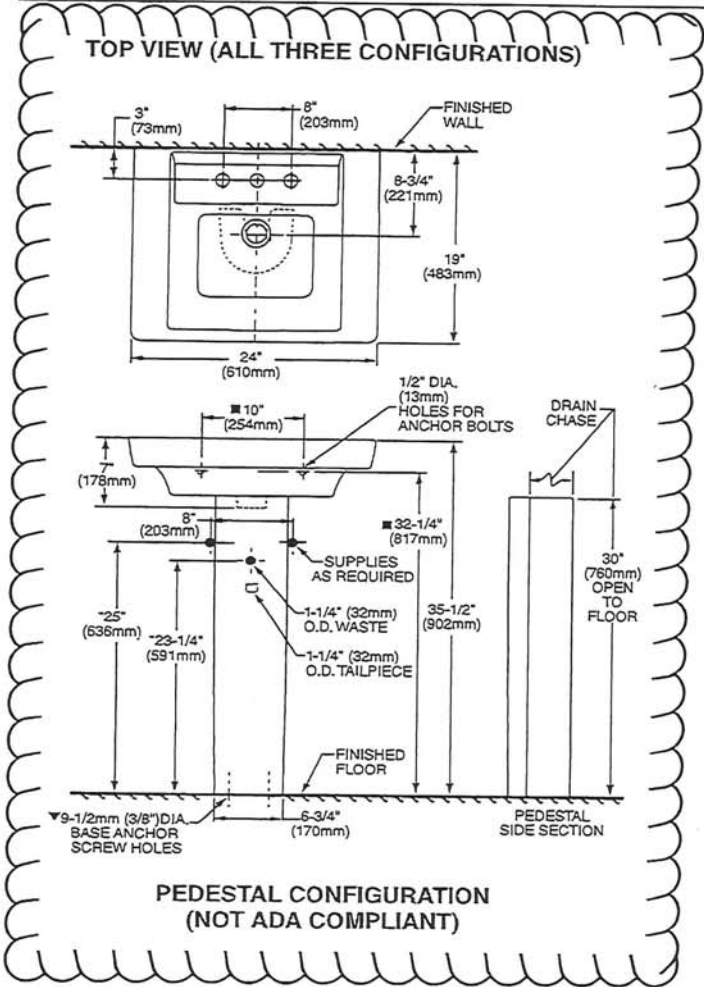

ABOVE COUNTER CONFIGURATION

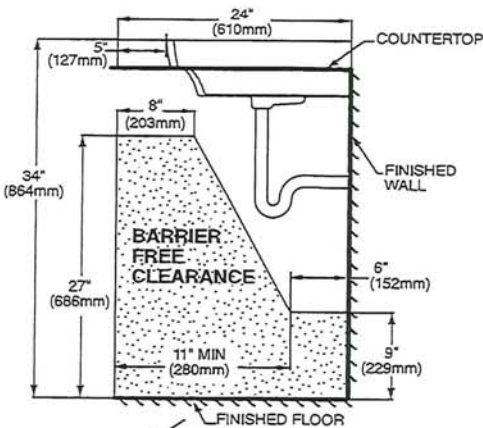
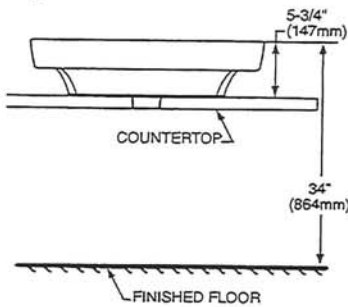

DROP-IN SINK CONFIGURATION



ABOVE COUNTER AND DROP-IN SINK CONFIGURATIONS
MEET THE AMERICANS WITH DISABILITIES ACT GUIDELINES
AND ANSI A117.1 ACCESSIBLE AND USABLE
BUILDINGS AND FACILITIES - CHECK LOCAL CODES.

Top of sink installed at 34" (864mm) height from finished floor.

Sink installed 5" (127mm) minimum from front edge of countertop.

Provide 27" (686mm) knee clearance area.

NOTES:

* DIMENSIONS SHOWN FOR LOCATION OF SUPPLIES AND "P" TRAPS ARE SUGGESTED.

▼ PEDESTAL ANCHORING SCREWS NOT INCLUDED.

■ SUITABLE FOR REINFORCEMENT ONLY. ACTUAL DIMENSIONS MUST BE TAKEN FROM FIXTURE.

FITTING NOT INCLUDED AND MUST BE ORDERED SEPARATELY.

PROVIDE SUITABLE REINFORCEMENT FOR ALL WALL SUPPORTS.

INSTALLATION INSTRUCTIONS SUPPLIED WITH LAVATORY.

IMPORTANT: Dimensions of fixtures are nominal and may vary within the range of tolerance established by ANSI Standard A112.19.2
These measurements are subject to change or cancellation. No responsibility is assumed for use of superseded or voided pages.

Handwritten signature



BARRIER FREE

COLONY™
COUNTERTOP SINK
VITREOUS CHINA

COLONY COUNTERTOP SINK

- Vitreous china
- Self-rimming
- Front overflow
- Supplied with template
- Faucet deck
(Faucet shown not included)

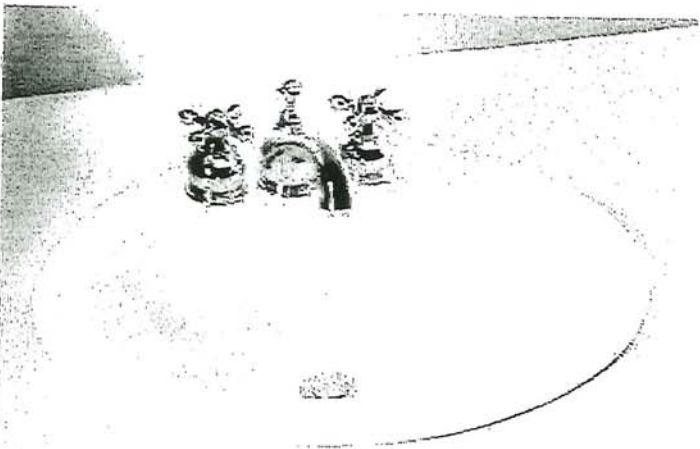

- ☐ **0346 803**
Faucet holes on 203mm (8") centres
- STD** ☒ **0346 403 (Illustrated)**
Faucet holes on 102mm (4") centres
- ☐ **0346 001**
Centre hole only

Nominal Dimensions:
521 x 448mm (20-1/2" x 17-5/8")

Bowl sizes:
422mm (16-5/8") wide, 279mm (11") front to back, 143mm (5-5/8") deep

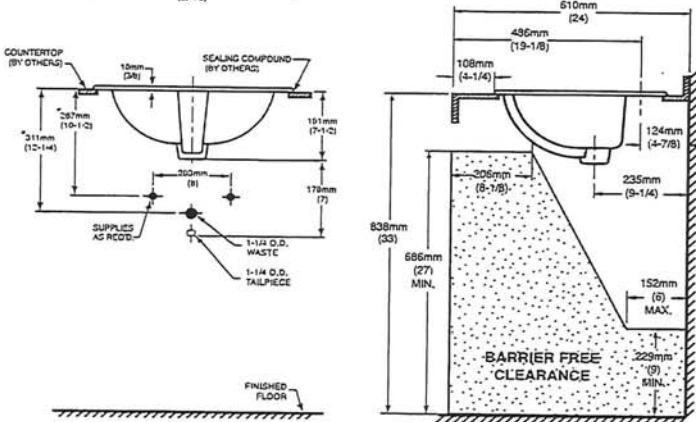
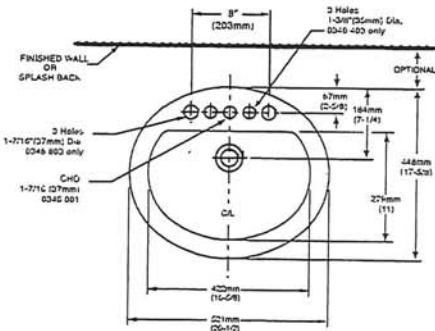

COMPLIANCE CERTIFICATIONS –
Meets or exceeds the following Specifications:
• ASME A112.19.2M for Vitreous China Fixtures.
• CAN/CSA B45 Series.

To Be Specified

- ☐ Colour: ☐ White ☐ Bone ☐ Silver Gray
☐ Linen
- ☐ Faucet*:
- ☐ Faucet Finish:
- ☐ Supplies & Stops:
- ☐ Trap 1-1/4" (32 mm):

NOTES:
* DIMENSIONS SHOWN FOR LOCATION OF SUPPLIES AND "P" TRAP ARE SUGGESTED. FOR COUNTERTOP CUTOUT AND INSTALLATION INSTRUCTIONS USE TEMPLATE SUPPLIED WITH SINK.
FAUCETS NOT INCLUDED AND MUST BE ORDERED SEPARATELY.
IMPORTANT: Dimensions of fixtures are nominal and may vary within the range of tolerances established by ANSI Standard A112.19.2.
These measurements are subject to change or cancellation. No responsibility is assumed for use of superseded or voided pages.

* See faucet section for additional models available

Lmclean



DEMI™
Product Specification Sheet

Two Piece Freestanding Collection

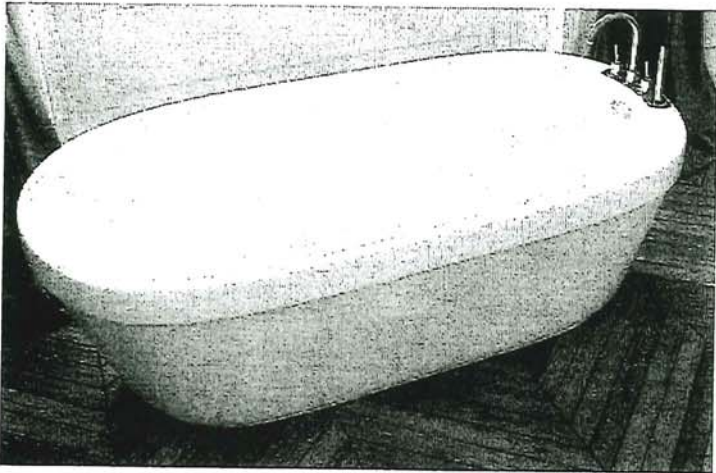

CF2007	Two Piece Freestanding Soaker
Size:	60" x 32" x 22" 1524 mm x 813 mm x 559 mm

PRODUCT FEATURES & BENEFITS

- Vacuum formed acrylic reinforced with fiberglass
- Scratch, stain and fade resistant high gloss finish
- Installation friendly two piece design
- Accepts deck mounted faucet
- Includes integral pop up drain and rectangular overflow
- Includes levelling feet

TWO PIECE ASSEMBLY

FRONT VIEW

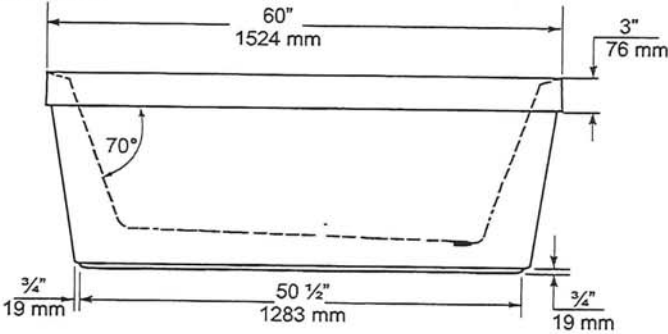

END VIEW

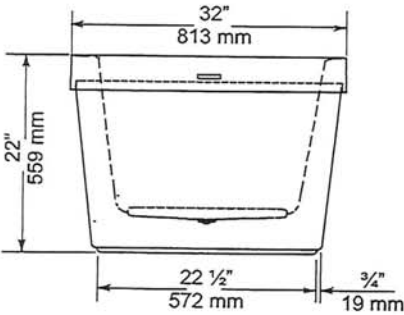

TOP VIEW

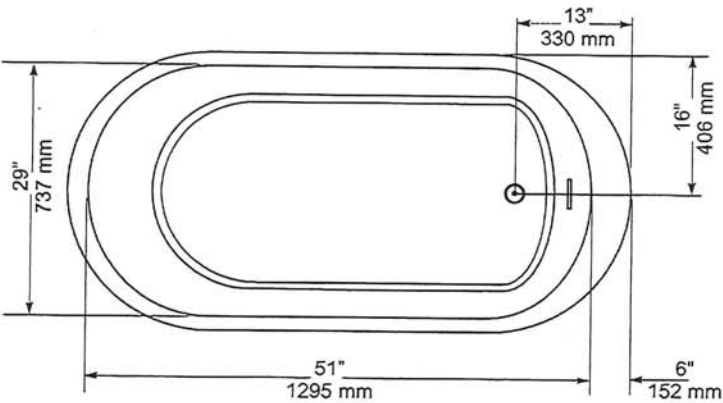

GENERAL SPECIFICATIONS		
Average Weight	90 lb	41 kg
Bathing Well at bottom	43"x 20"	1092 x 508 mm
Capacity Drain to Overflow		195 litres
Water Depth Drain to Overflow	16"	406 mm
Drain Opening (dia.)	2"	51 mm
Overflow Opening	2 1/4"x 1 1/2"	57 x 13 mm
Drain to Floor Clearance	3 1/4"	83 mm

NOTES: Please confirm measurements on actual product to ensure proper identification. Bathtub to be installed on the floor supported by 5 self levelling feet. Adjust if required to level the bathtub for adequate drainage. Refer to installation instructions for additional information.

IMPORTANT: Dimensions of fixtures are nominal and may vary ± 1/4" (6 mm). Weight may vary ± 5 lb (2.3 kg). Drawing is not to scale. These measurements are subject to change at manufacturer's discretion.

Compliance Certifications -
Meets or Exceeds the following Specifications:
• CAN/CSA - B45 Series



McLean



H2OPTION® SIPHONIC DUAL FLUSH
ELONGATED TOILET
VITREOUS CHINA

H2OPTION® SIPHONIC DUAL FLUSH
ELONGATED TOILET

- ☐ **2887.218**
 - Vitreous china
 - Ultra high efficiency
 - Full Flush (4.8 Lpf/1.28 gpf)
 - Partial Flush (3.4 Lpf/0.92 gpf)
 - Elongated siphon action bowl with direct-fed jet
 - Meets EPA WaterSense® criteria
 - MaP PREMIUM listed
 - Includes EverClean® antimicrobial surface
 - PowerWash® rim scrubs bowl with each flush
 - 305mm (12") rough-in
 - Fully glazed 2" Trapway
 - Generous 9" x 8" water surface area
 - Chrome plated top mounted push button actuator
 - Sanitary bar on bowl
 - 2 color matched bolt caps
 - Limited lifetime warranty on chinaware and limited five year warranty on all mechanical parts

- ☐ **2887.518** Same as above, except with Tank with AquaGuard Liner

Separate Component Parts:

- ☐ **3706.216** Bowl
- ☐ **4133A.218** Tank
- ☐ **4133A.518** Tank with AquaGuard Liner

Nominal Dimensions:
756 x 380 x 762mm
(29-3/4" x 15" x 30")

Fixture only, seat and supply by others

- Compliance Certifications -
Meets or Exceeds the Following Specifications:
- ASME A112.19.2-2008/CSA B45.1-08 for Vitreous China Fixtures
 - CALGreen and California Energy Commission (CEC) Compliant
 - US EPA WaterSense® criteria for UHETs

To Be Specified:

- ☐ Color: ☐ White ☐ Bone ☐ Linen
- ☐ Seat: American Standard #5257A.65C Easy Lift and Clean Elongated Seat with Cover and Slow Close hinges
- ☐ Alternate Seat:
- ☐ Supply with stop:

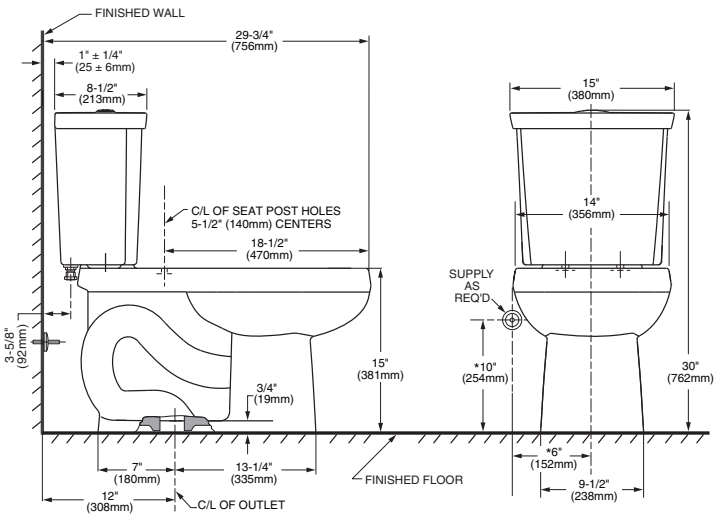

NOTES:
THIS COMBINATION IS DESIGNED TO ROUGH-IN AT A MINIMUM DIMENSION OF 305MM (12") FROM FINISHED WALL TO C/L OF OUTLET.
* DIMENSION SHOWN FOR LOCATION OF SUPPLY IS SUGGESTED. SUPPLY NOT INCLUDED WITH FIXTURE AND MUST BE ORDERED SEPARATELY.

IMPORTANT: Dimensions of fixtures are nominal and may vary within the range of tolerance established by ANSI Standard A112.19.2. These measurements are subject to change or cancellation. No responsibility is assumed for use of superseded or voided pages.



Specifications

- OPERATION**

- ## FLOW

- ## CARTRIDGE

- ## STANDARDS

- **ADA**  for lever handle

- Lifetime limited warranty against leaks, drips and finish defects to the original consumer purchaser
- 5 year warranty if used in commercial installations

Less Waste
Bulk Packed (12 per carton):
L64600 series

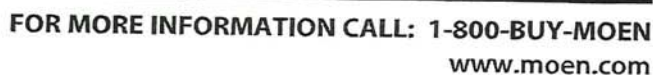

2mclan



PRINCIPAL ENSUITE

Chateau®

POSI-TEMP®



Posi-Temp® Tub/Shower Faucet with 3 Function Transfer Valve/Trim and Slide Bar with Hand Shower*
TL183EP / U361CI / UT2721 / 3669EP / A725 / 62320



Posi-Temp® Shower Only with 3 Function Transfer Valve/Trim and Slide Bar with Hand Shower*
TL182EP / U361CI / UT2721 / 3669EP / A725 / 62320

Lindean
[Signature]



Posi-Temp® Tub/Shower Faucet with 4 Function Hand Shower*
TL2359EP / 62320

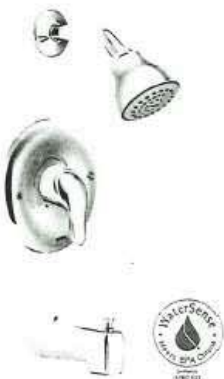

Eco-Performance Posi-Temp® Tub/Shower Faucet*
TL183EP / 62320



Eco-Performance Posi-Temp® Shower Only*
TL182EP / 62320

CHATEAU
FINISH OPTION



Chrome

To order Chrome (C) model, use model number only.
* Refer to the Shower Design Guide for Installation Instructions.



Buy it for looks. Buy it for life.®

There is more than 1 version of this model.
Page down to identify the version you have.

DESCRIPTION

- Metal construction with various finishes identified by suffix
- Includes non-metallic showerhead, arm, flange and non-metallic diverter tub spout

OPERATION

- Handle operates counterclockwise through a 270° arc with off at 6 o'clock and maximum hot at the 9 o'clock position. Shut off in clockwise direction
- Adjustable temperature limit stop to control maximum hot water temperature
- Pressure balancing mechanism maintains selected discharge temperature to $\pm 3^\circ$

FLOW

- Showerhead is limited to 2.5 gpm (9.5 L/min) at 80 psi
- EP suffix models are limited to 1.75 gpm (6.6 L/min) at 80 psi
- NH suffix models contain no showerhead

CARTRIDGE

- 1222 cartridge design
- Accommodates back to back installations
- Nonmetallic/nonferrous and stainless steel material

STANDARDS

- Third party certified to meet ASME A112.18.1/CSA B125.1 and all applicable requirements referenced therein
- EP suffix models are third party certified to WaterSense®

- ADA  for lever handle

WARRANTY

- Lifetime limited warranty against leaks, drips and finish defects to the original consumer purchaser
- 5 year warranty if used in commercial installations

Specifications



CHATEAU® POSI-TEMP® Single-Handle Tub/Shower Trim Kit

Models: TL181 series - valve trim only
(Bulk Packed 12 per carton)
TL182 series - shower trim only
(Bulk Packed 12 per carton)
TL183 series - tub/shower trim
(Bulk Packed 12 per carton)

Valves: 62300 series
2500 series

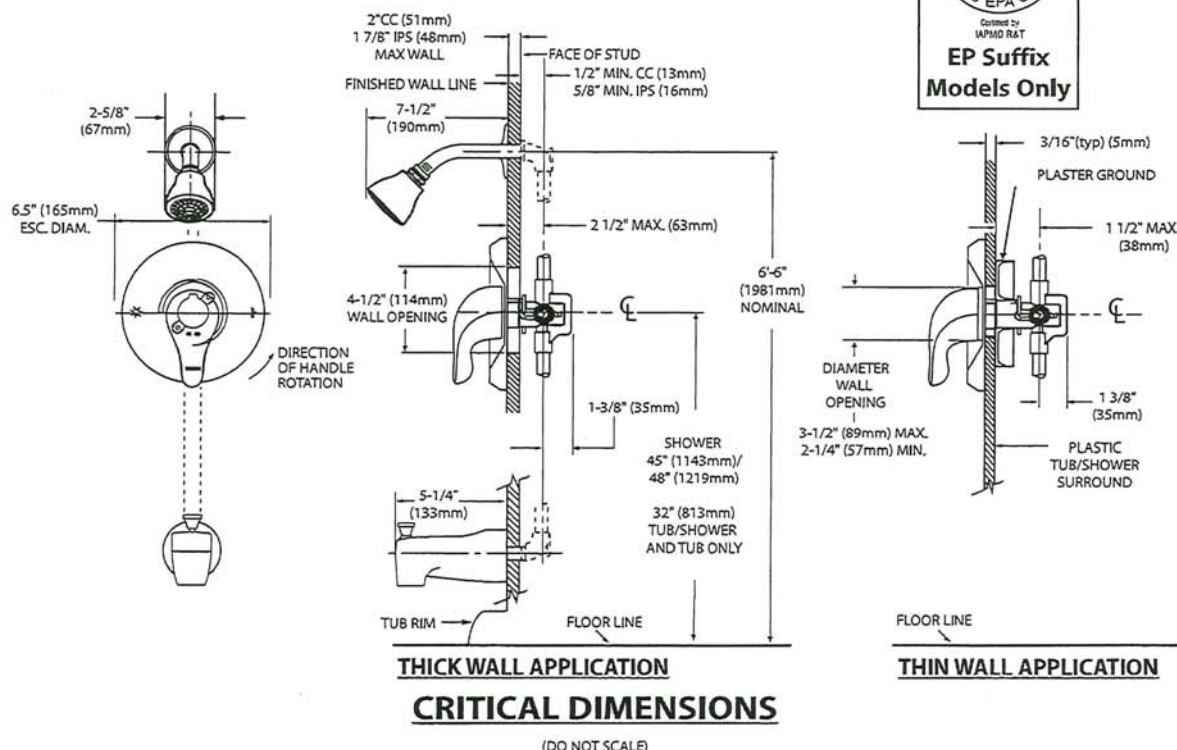

L. McLean



Specifications

DESCRIPTION

- Metal construction with various finishes identified by suffix

OPERATION

- Lever style handles with hot and cold color indicator
- Rotate hot side handle counterclockwise to open (clockwise to close) and the cold side handle (clockwise to open) and (counterclockwise to close)

STANDARDS

- Third party certified to: ASME A112.18.1/CSA B-125.1, and all applicable requirements referenced therein

- ADA  for lever handles

WARRANTY

- Lifetime limited warranty against leaks, drips and finish defects to the original homeowner
 - 10 year limited warranty when used in a multi-family installation
 - 5 year limited warranty when used in a commercial installation
- Visit www.moen.com/support for complete details and limitations

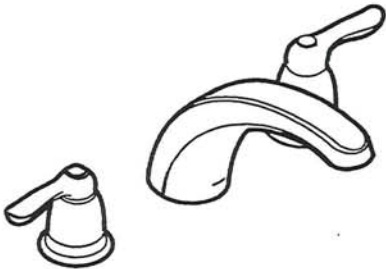

CHATEAU®

Two-Handle Garden Tub Trim

Models: T994 series

Valves: 4792, 4793, 4794, 4796, 4797, 4798

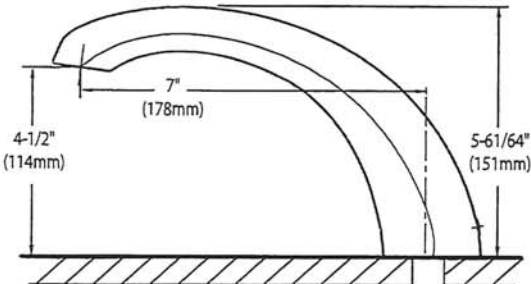
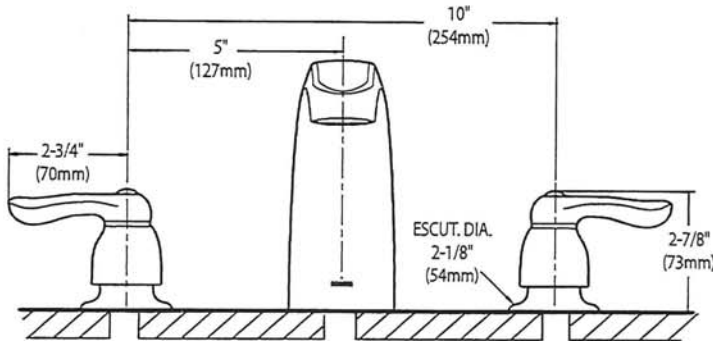

CRITICAL DIMENSIONS
(DO NOT SCALE)

Lmclean

SC(B)514 | ALITO Collection

36"

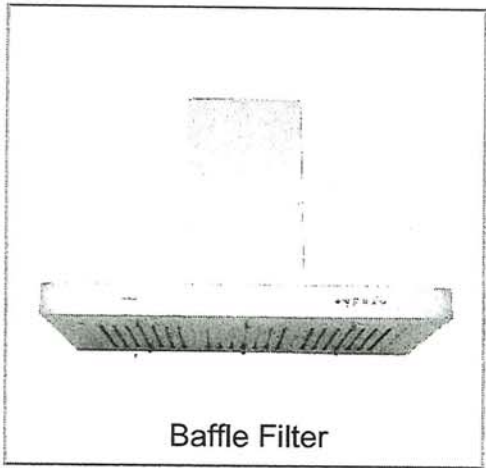

Baffle Filter

Wall Mount

The SC(B)514 makes a statement of strength and power with a bold frame and 550 CFM fan. Features mesh or baffle filters, two bright LED lights and a three-speed panel for total control. It is also fitted with a time-delay OFF feature up to nine minutes.

Green Features



3 Speed Push Button
Control Panel



Long-Lasting
LED Lights



Time-Delay
OFF Feature



Grease Cup

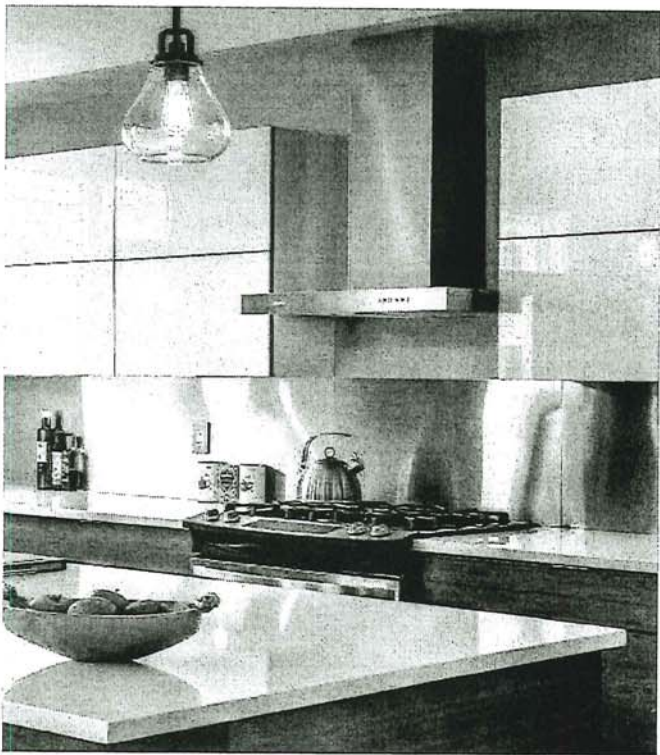

Model	Colour	Ducting	Filters	Size	CFM
SCB51430	Stainless Steel	6"	Baffle	30"	550
SCB51436	Stainless Steel	6"	Baffle	36"	550

Cyclone Range Hoods Inc.

1361 Huntingwood Drive, Unit 16. Toronto, ON. M1S 3J1. Canada.

Toll Free: 1-888-293-5662 Tel: (416) 293-0933 Fax: (416) 293-4793 Website: www.CycloneRangeHoods.com

Imclean

36"

SC(B)514 | ALITO Collection



Features

- Wall mount range hood
- 6" round duct adapter
- Non-stick aluminum fan blades
- 3 speed push button control
- 2 LED lights (2 x 1.4W, 4000K)
- Quick release aluminum mesh filters
- Standard chimney fits up to 9 ft. ceiling
- Up to 9 minutes time-delay OFF feature
- Plug-in connection

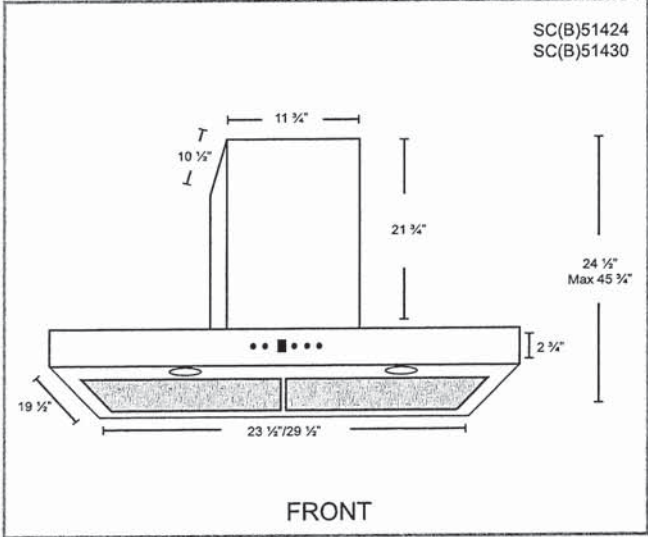
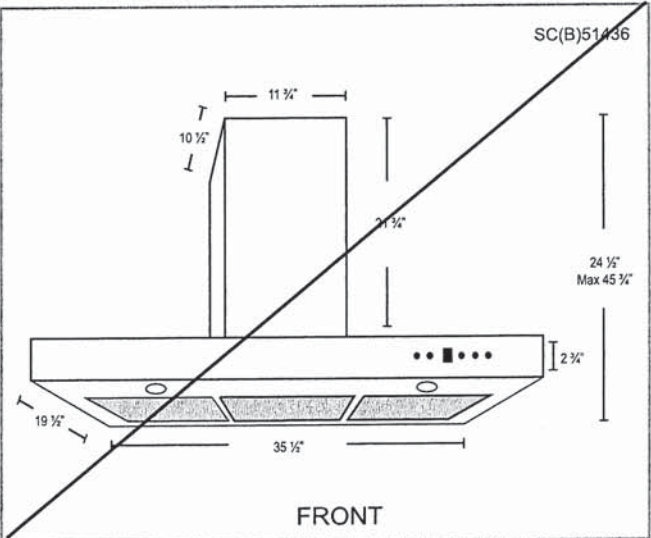

Options

- Filters:

SCB514 - Quick Release Stainless Steel Baffle Filters
- Chimney Flues:
B2.CH16 - short (7'-8' ceilings)
B2.CH22 - standard (8'-9' ceilings)
B2.CH32 - extended (9'-11' ceilings)
- Widths: 30", 36"

Specifications

- | | | |
|--------------------------------------|--------------------------------|---|
| • Air Flow Volume: 550 CFM | • Current: 2.5 Amps | • Finishes: Stainless Steel |
| • Electrical Connection: 120 V/60 Hz | • Fan Speed: 1599 RPM | • Ducting: 6" Round |
| • Power Consumption: 300 Watts | • Fan Type: Centrifugal Blower | • Noise Level: Min. 2 Sones
Max. 6 Sones |



Project: Country Lane
Unit: 710 Phase: 7
LG REFRIGERATION
Model: LRFLC2706S The Willowbrook
LRFLC2706_
3-Door French Door Refrigerator

- Largest Counter Depth Capacity
- Modern Sleek Design
- Internal Water Dispenser
- Single Ice Maker
- Cool Guard
- Door Cooling+
- LG ThinQ
- ENERGY STAR® Qualified
- Sabbath Mode

AVAILABLE COLORS



STAINLESS STEEL



BLACK STAINLESS STEEL

LG ThinQ®

Enjoy new ways to control your home with LG smart appliances

- Get an alert when kids forget to close the door
- Make more ice while you're at work
- Works with the LG ThinQ® app



works with the Google Assistant



works with Alexa

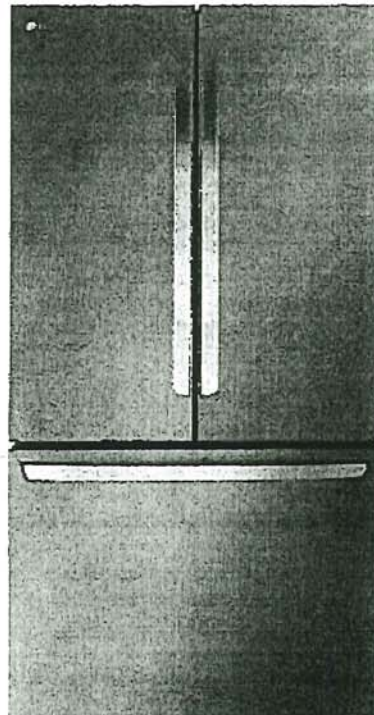

CAPACITY

Refrigerator (cu.ft.)	17.8 cu.ft.
Freezer (cu.ft.)	8.7 cu.ft.
Total Capacity (cu.ft.)	26.5 cu.ft.

ENERGY

ENERGY STAR® Qualified	ENERGY STAR®
Energy Consumption (kWh/Year)	632

WATER & ICE SYSTEM

Dispenser Type	Internal with Dispenser
Daily Ice Production	2.5 lbs (F/Cubed);
Ice Storage Capacity	4.0 lbs
Cube & Crushed Ice	Cubed only
IcePlus™	Yes
Water Filter	LT1000P

COOLING

Temperature Sensors	9
Compressor Type	Smart Inverter Compressor
Refrigerant	Low GWP, Zero ODP and More Energy Efficient Refrigerant (R600a / 57g / 2.01oz)
Fresh Air Filter Evaporator	Yes 1

CONVENIENCE

Display Type	Smooth Touch Control / White LED
Temperature Controls	Electronic/Digital
Door Alarm	Yes
Child Lock	Yes
Decibel™ Quiet Operation	Yes
Smart Diagnosis™	Yes
Auto Closing Door Hinge	Yes (Only left door)
Wi-Fi Enabled	Yes
ThinQ®	Yes
PCC (Proactive Customer Care)	Yes
Special Features	Door Cooling+
Sabbath	Yes

REFRIGERATOR

No. of Shelves	4 Split (4 Fixed)
Cantilevered Shelves	Hybrid Cantilevered
Shelf Construction	Spill Protector™ Tempered Glass
Crisper Bins	2 Crispers
Glide N' Serve™ Drawer	Yes
CoolGuard	Yes
Handle Type	Bar
Refrigerator Light	Yes

REFRIGERATOR DOOR

No. of Bins	8 Total (2 Adjustable Gallon Sized);
Door Bin Construction	1 Piece (Clear)
FREEZER	
Door Type	Pull Drawer
Drawers / Shelves	2-Tier Organization
Durabase™ Solid Drawer Base	Yes
Drawer Divider	Yes
Freezer Light	LED Lighting
Freezer Handle	SmartPull™ Handle
Ice Bin / In Door Ice	Yes

MATERIALS AND FINISHES

Flat Type Door	Yes
Hidden Hinges	Yes
Surface	Smooth
Handles	Matching Commercial Handles
All Available Colors	Stainless Steel Black Stainless Steel
Insulation	Low GWP and Zero ODP Blowing Agent

DIMENSIONS/CLEARANCES/WEIGHTS

Depth with Handles	31 5/8"
Depth without Handles	29 1/4"
Depth without Door	24 7/8"
Depth (Total with Door Open 90°)	43 1/2"
Height to Top of Hinge	70 1/4"
Height to Top of Case	68 7/8"
Width	35 3/4"
Installation Clearance	Sides 1/8", Top 1", Back 2"
Weight (Unit/ Carton)	322 lbs / 352 lbs
Carton Dimensions (WxHxD)	38" x 73" x 32"

LIMITED WARRANTY

Parts & Labor	1 Year
Sealed System (Parts & Labor)	5 Years
Compressor (Parts & Labor)	5 Years
Linear Compressor (Parts & Labor)	6 - 10 Years

UPC CODES

LRFLC2706S (Stainless Steel)	195174039274
LRFLC2706D (Black Stainless Steel)	195174039281

Lmclean

Model: 30-2794 B The Willowglen

36" Induction Cooktop

Induction Cooktop

Available Products: GCCI3667AB

Available Colors: Black

Version: 03/24



Product Specifications

Cooktop Performance

Right Front Element Burner Size	8"
Right Rear Element Burner Size	6"
Left Front Element Burner Size	7"
Left Rear Element Burner Size	7"
Center Element Burner Size	8"
Right Front Element Burner	2,300 / 3,600 Watts (Boost)
Right Rear Element Burner	1,450 / 2,500 Watts (Boost)
Left Front Element Burner	1,800 / 2,600 Watts (Boost)
Left Rear Element Burner	1,800 / 2,600 Watts (Boost)
Center Element Burner	2,300 / 3,600 Watts (Boost)

Dimensions and Volume

Height	2 7/8"
Width	36 3/4"
Depth	21 3/8"
Cutout Height	3 5/8"
Minimum Cutout Width	33 7/8"
Minimum Cutout Depth	19 1/8"
Maximum Cutout Width	36 1/8"
Maximum Cutout Depth	20 1/2"

General Specifications

Frigidaire Fit Promise	Yes
Prop 65 Label	Yes
Warranty - Labor	1 Year
Warranty - Parts	1 Year
AB-1200	Information available at frigidaire.com/en/ab1200

Performance Certifications and Approvals

ENERGY STAR Certified	Yes
-----------------------	-----

Display

Control Location	Front
Display Interface Co.or	Red
Display Type	Capacitive Touch

Electrical Specifications

Amps @ 240 Volts	40 Amps
Minimum Circuit Required	40 Amps

Certifications and Approvals

ADA Compliant	Yes
---------------	-----

Safety Certifications and Approvals

UL Listed	Yes
cUL Listed	Yes
RoHS	Yes

40 AMP's
L. McLean
[Signature]

For planning purposes only. We reserve the right to change specifications or discontinue models without notice.
Refer to Product Installation Guide for detailed installation instructions on the web at frigidaire.com / frigidaire.ca
Electrolux Major Appliances, N.A.

USA • 10200 David Taylor Drive • Charlotte, NC 28262 • Charlotte, NC 28262 • 1-877-4electrolux (1-877-435-3287) • frigidaire.com
CANADA • 5855 Terry Fox Way • Mississauga, ON L5V 3E4 • 1-800-265-8352 • frigidaire.ca

Installation Diagram

Cooktop Dimensions

Cooktop Cutout Dimensions

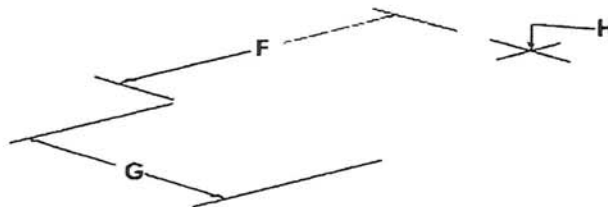
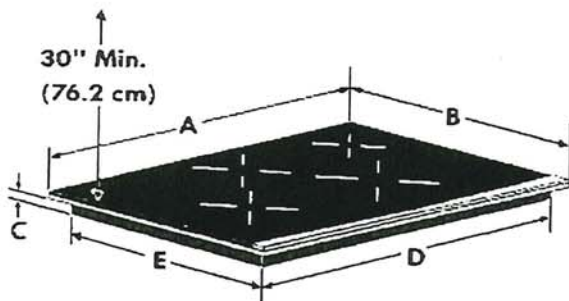

COOKTOP DIMENSIONS					CUTOUT DIMENSIONS				
A. WIDTH	B. DEPTH	C. HEIGHT	D. WIDTH	E. DEPTH	F. WIDTH		G. DEPTH		H. HEIGHT
					Min	Max	Min	Max	
36 ⁷ / ₈ (93.4)	21 ¹ / ₈ (54.4)	2 ⁷ / ₈ (7.3)	33 ⁷ / ₈ (85.4)	18 ⁷ / ₈ (47.9)	33 ⁷ / ₈ (86.0)	36 ⁷ / ₈ (91.8)	19 ¹ / ₈ (48.6)	20 ¹ / ₈ (52.1)	3 ¹ / ₈ (9.2)

L. McLean

WCEP6423_

1.7 / 4.7 cu. ft. Smart Combination Wall Oven with Convection, Air Fry and EasyClean®

- 6.4 cu. ft. Large Capacity
- ThinQ® Technology with ThinQ Care
- Convection Technology with Air Fry
- EasyClean® and Self Clean
- SmoothTouch® Glass Controls
- WideView™ Window

AVAILABLE COLORS



PRINTPROOF® STAINLESS STEEL



PRINTPROOF® BLACK STAINLESS STEEL

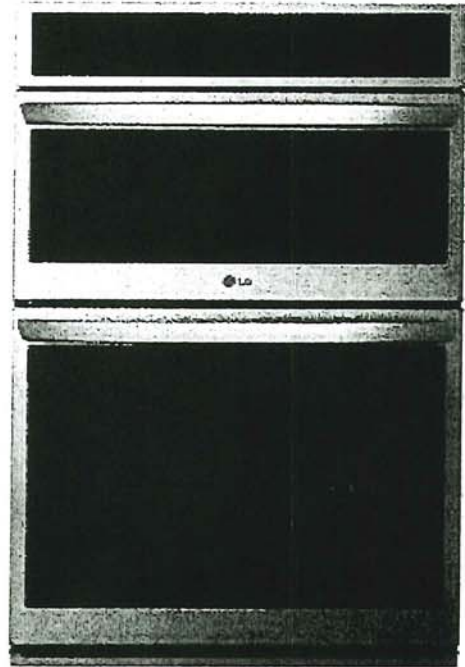

Proactive Smart Alerts to Keep Your Appliances Running Smoothly

ThinQ care

- Preventative Alerts help you stay a step ahead of potential issues to find proactive solutions before problems arise.
- Avoid preventable repairs and service calls with real-time diagnostics for a hassle-free experience.
- Integrated with LG's ThinQ app—a smart home hub for managing your smart devices and appliances.

SUMMARY

Type	Combination Wall Oven
Total Oven Capacity (cu. ft.)	6.4 (1.7 Upper / 4.7 Lower)
Available Colors	PrintProof® Stainless Steel / PrintProof® Black Stainless Steel
PrintProof® Finish	Yes
UPPER OVEN FEATURES	
Capacity (cu. ft.)	1.7
Interior	Stainless Steel
Speed Oven	No
Convection Technology	Yes
Microwave Power Output	950W
Convection Element Power	1500W
Broil Element Power	1200W
Bake Element Power	375W
Air Fry	Yes
Dehydrate	No
Defrost Presets	Meat, Poultry, Fish, Bread
Oven Modes	Auto Cook, Broil, Convection Bake, Defrost, Melt, Microwave, Popcorn, Proof, Sensor Cook, Soften, Warm, Air Fry, Dehydrate
Sensor Cook	Beverage, Casserole, Chicken, Pasta, Pizza, Dinner Plate, Rice, Soup, Vegetable
Auto Cook	Bacon, Bagels, Baked Potatoes, Browns, Canned Vegetable, Cod Filets, Corn Dog, Fresh Vegetable, Frozen Chicken Wings, Frozen Fries, Frozen Chicken Nuggets, Frozen Pizza, Frozen Soft Pretzels, Frozen Vegetable, Garlic Bread, Hamburger, Lamb chops, Meat Loaf, Nachos, Oatmeal, Pork Chops, Quinoa, Ribeye Steak, Rice, Salmon Steak, Sausage, Sirloin Steak, Tenderloin
Soften	Butter, Cream Cheese, Frosting, Ice Cream
Melt	Butter, Caramel, Cheese, Chocolate, Marshmallow

LOWER OVEN FEATURES

Capacity (cu. ft.)	4.7
EasyClean®	Yes (10mins)
Self Clean	Yes (3, 4, 5 hours)
Convection Type	Fan Convection
Convection Conversion	No
Bake Element Power	2500W
Variable Warm	Yes (High, Med, Low)
Broil Element Power	2,500W inner / 1,500W outer
Variable Broil	Yes (Full, Center / Low, Med, High)
Number of Rack Position	5
12 hrs. Auto Shut-off	Yes
InstaView®	No
Air Fry	Yes
Steam Assist	No
Oven Modes	Air Fry / Convection Bake / Convection Roast / Bake / Broil / Frozen Meal / Warm / Proof / Favorite
Maintenance Modes	EasyClean® / Self Clean
CONTROL	
Oven Control Type	SmoothTouch™ Glass Controls
Display	LED Display
Language	English
Clock	12 hr or 24 hr
Temperature Unit of Measure	Fahrenheit / Celsius
Certified Sabbath Mode	Yes
SMART FEATURES	
ThinQ® (Wi-Fi Enabled)	Yes
Check & Control	Yes
Voice Control	Yes (Google, Alexa)
Smart Recipe (3rd Party Recipe App)	SideChef
ThinQ Care	Yes
SmartDiagnosis™	Yes

ACCESSORIES

Glass Tray (Upper Oven)	Yes
Melting Tray (Upper Oven)	Yes
Rack (Upper Oven)	Yes
Temperature probe	No
Heavy Duty Rack	Yes (2)
Air Fry Tray	Yes

POWER/RATINGS

Amperage at 240V	40A
kW at 240V	7.8kW
Required Power Supply	120 / 240 VAC, 120 / 208 VAC

DIMENSIONS & WEIGHT

Product Dimensions (WxHxD)	29 3/4" x 43 13/16" x 23 3/8"
Standard Cut-out Dimensions (WxHxD)	Min. 28 1/2" x 43 7/16" x 24" Max. 28 5/8" x 43 1/2" x 24"
Flush Cut-out Dimensions (WxHxD)	30" x 44" x 25"
Shipping Dimensions (WxHxD)	33" x 50" x 30"
Product Weight (lbs.)	197 lbs.
Shipping Weight (lbs.)	225 lbs.

LIMITED WARRANTY

Part & Labor	1 Year
UPC CODES	
WCEP6423F (PrintProof® Stainless Steel)	048231344753
WCEP6423D (PrintProof® Black Stainless Steel)	048231345323

40 AMPs.

McLean

Measure the current cutout dimensions and compare them to the cutout dimensions shown below. Little or no cabinet work may be necessary. The image may differ from the actual model.

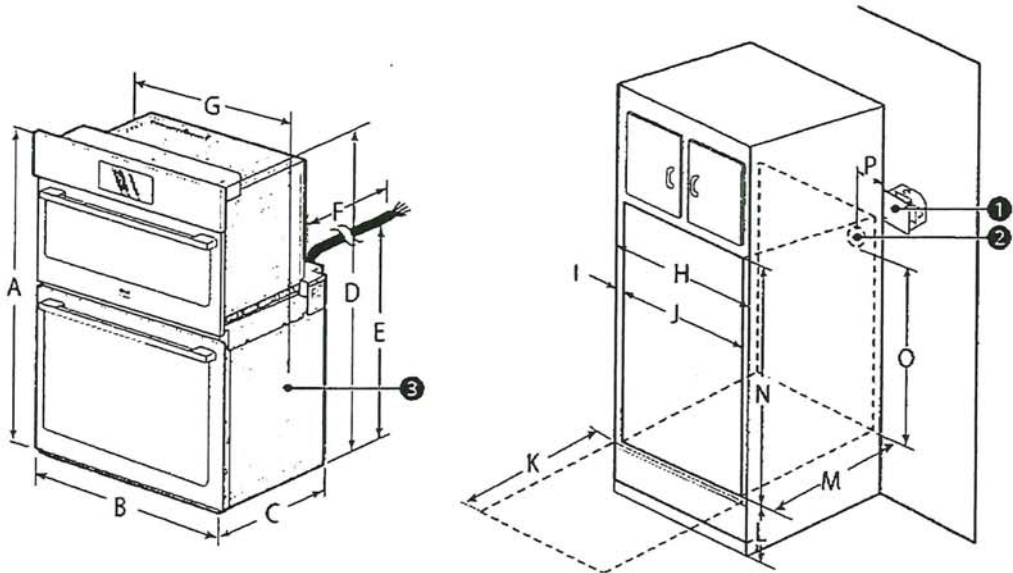

List		Dimensions
A	Height	43 13/16" (111.3 cm)
B	Width	29 3/4" (75.5 cm)
C	Depth	23 3/8" (59.3 cm)
D	Height (standard installation)	43 3/16" (109.7 cm)
E	Height (power cord)	25 7/8" (65.6 cm)
F	Length (power cord)	60" (152.4 cm)
G	Width (standard installation)	28 7/16" (72.2 cm)
H	Cabinet width	30" (76.2 cm)
I	Overlap of oven	1" (2.5 cm)
J	Cutout width	28 1/2" Min. (72.4 cm) 28 5/8" Max. (72.7 cm)
K	Depth of open door	23" (58.4 cm)
L	Cutout location from floor	12" (30.5 cm)
M	Cutout depth	24" Min. (61.0 cm)
N	Cutout height	43 7/16" Min. (110.3 cm) 43 1/2" Max. (110.5 cm)
O	Height of conduit opening from floor of cutout	39 27/32" (101.2 cm)
P	Distance of conduit opening from side of cabinet	5" (12.7 cm)

Imchan

GE® 4.8 cu. ft. Capacity Front Load ENERGY STAR® Steam Washer with SmartDispense™ and UltraFresh Vent System with OdorBlock™

GE® 4.8 cu. ft. Capacity Front Load ENERGY STAR® Steam Washer with SmartDispense™ and UltraFresh Vent System with OdorBlock™

SPECIAL INSTALLATION REQUIREMENTS:

STACKED INSTALLATION: ✓

-Brackets for stacking dryer over washer are not included with the washer. Order part no. GFA28KITN.

ALCOVE OR CLOSET INSTALLATION:

- If your dryer is approved for installation in an alcove or closet, it will be stated on a label on the dryer back.
- The dryer MUST be exhausted to the outside.
- Minimum clearances between dryer cabinet and adjacent walls or other surfaces are: 0" all sides and top.*
- Closet doors must be louvered or otherwise ventilated and must contain a minimum of 60 sq. in. of open area equally distributed. If this closet contains both a washer and a dryer, doors must contain a minimum of 120 sq. in. of open area equally distributed.
- No other fuel-burning appliance shall be installed in the same closet with a gas dryer.

BATHROOM OR BEDROOM INSTALLATION:

- The dryer MUST be exhausted to the outdoors.
- The installation must conform with the local codes, or in the absence of local codes, with the National Electric Code and National Fuel Gas Code, ANSI Z223.

MINIMUM CLEARANCE OTHER THAN ALCOVE OR CLOSET INSTALLATIONS:

- Minimum clearances to combustible surfaces 0" all sides and top.*

FOR MORE INFORMATION ON VENTING KITS AND ACCESSORIES, PLEASE CALL 1-800-GE-CARES.

*For improved performance, a 1/2" clearance is suggested on each side.



For answers to your Monogram, GE Café®, GE Profile™ or GE Appliances product questions, visit our website at geappliances.com or call GE Answer Center® Service, 800.626.2000.

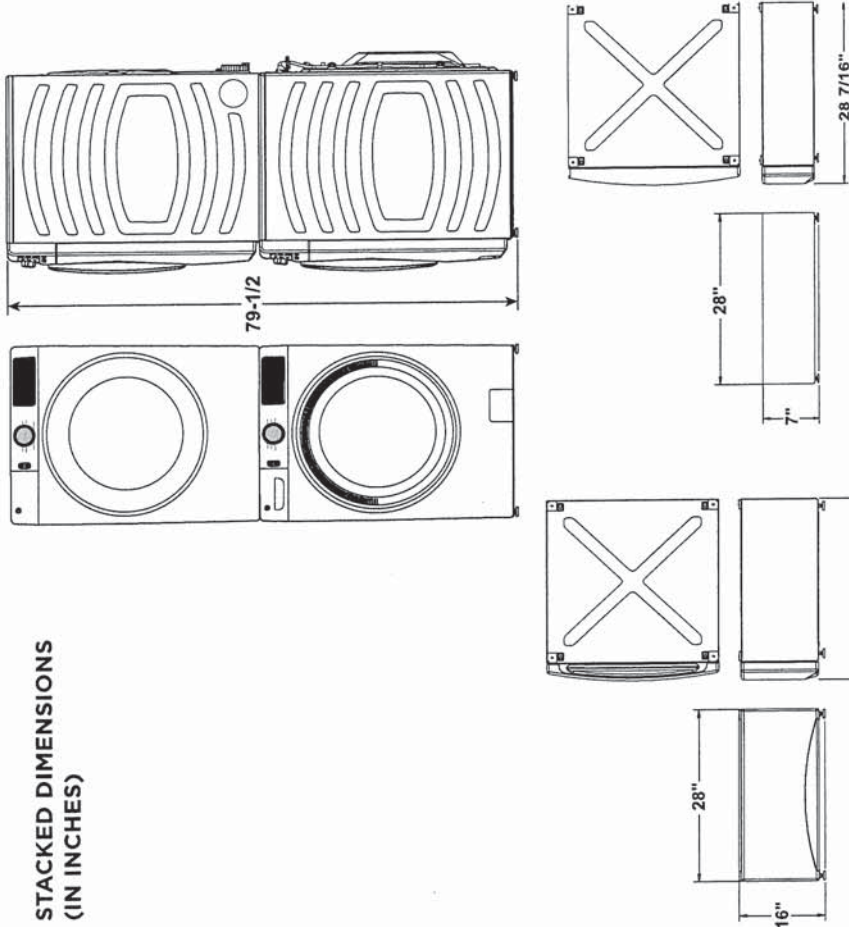

PEDESTAL DIMENSIONS (IN INCHES)

GFP1528PNSN - SATIN NICKEL
GFP1528PTDS - CARBON GRAPHITE
GFP1528SNWW - WHITE

This optional 16" pedestal raises the door opening and height of the washer or dryer.

RISER DIMENSIONS (IN INCHES)

GFR0728PNSN - SATIN NICKEL
GFR0728PTDS - CARBON GRAPHITE
GFR0728SNWW - WHITE

This optional 7" riser raises the door opening and height of the washer or dryer while remaining ADA compliant.