

HIGHCASTLE HOMES - COLOUR SCHEDULE

Purchaser:

CHUKWUEMEKA VINCENT OKOLI

Telephone Res. / Bus:

(416) 317-8184 /

Decor Advisor:

Caroline Rajcsanyi

Property:

9Phase: 2 of Plan - Draft Plan 21T-9005B

Project:

2073737 Ontario Inc.

Model and Elevation:

Hillcrest Elev A

| KITCHEN AND VANITIES | Cabinet                       | Counter                         | Hardware    |
|----------------------|-------------------------------|---------------------------------|-------------|
| Kitchen              | Lv6 - Tuscany Paint - Cannoli | Lv1 - GR-Serenata               | 9677 Handle |
| Main Bathroom        | NA                            | N/A                             | N/A         |
| Ensuite Bathroom     | Lv2 - Simcoe 3DL - Cafe Noir  | 4954K-22 Italian White Di Pesco | 9677 Handle |
| Ensuite 2            | Lv2 - Simcoe 3DL - Cafe Noir  | 4954K-22 Italian White Di Pesco | 9677 Handle |
| Ensuite 3            | Lv2 - Simcoe 3DL - Cafe Noir  | 4954K-22 Italian White Di Pesco | 9677 Handle |
| Ensuite 4            | Lv2 - Simcoe 3DL - Cafe Noir  | 4954K-22 Italian White Di Pesco | 9677 Handle |
| Ensuite 5            | Lv2 - Simcoe 3DL - Cafe Noir  | 4954K-22 Italian White Di Pesco | 9677 Handle |
| Powder Room          | Lv2 - Simcoe 3DL - Coconut    | 4971K-52 Bronzite               | 9677 Handle |
| Laundry              | Lv2 - Simcoe 3DL - Cafe Noir  | 4954K-22 Italian White Di Pesco | 9677 Handle |
|                      |                               |                                 |             |
|                      |                               |                                 |             |
| Opt. Breakfast Bar   | Counter Height/Flush          | Kitchen Hood Fan                | Standard    |
|                      |                               | Kitchen Upper Height            | 100 cm      |

Stove opening – if not specified will be set to builders standard opening of approximately 30 in width

Fridge Opening – if not specified will be set to builders minimum opening of approximately 33 x71 height (townhouses)

- if not specified will be set to builders minimum opening of approximately 36 x 71 height (singles)

Counter top Edge

Kitchen

Double Edge (1 1/2") Double Bevelled

Opt. Kitchen Extras

PARQUET / HARDWOOD OR BROADLOOM

|                         |   |                  |   |
|-------------------------|---|------------------|---|
| Kitchen / Breakfast     | N/A   | Master Bedroom   | *Oak Strip Lauzon Essential Expert 3 1/8" x 3/4"-Graphite |
| Great Room              | N/A   | Bedroom 2        | Lv2 -TXP140 Lv2 - T15                                     |
| Living / Formal Room    | *Oak Strip Lauzon Essential Expert 4 1/8" x 3/4"-Graphite | Bedroom 3        | Lv2 -TXP140 Lv2 - T15                                     |
| Dining Room             | *Oak Strip Lauzon Essential Expert 4 1/8" x 3/4"-Graphite | Bedroom 4        | Lv2 -TXP140 Lv2 - T15                                     |
| Family Room             | *Oak Strip Lauzon Essential Expert 4 1/8" x 3/4"-Graphite | Bedroom 5        | Lv2 -TXP140 Lv2 - T15                                     |
| Main Hall               | *Oak Strip Lauzon Essential Expert 4 1/8" x 3/4"-Graphite |                  |   |
| Main Stairs             | Oak   | Fin Bsmt Area    | *1-Laminate-8mm SF Trend 4 7/8" x 5/16" - Midnight        |
| Upper Hall              | *Oak Strip Lauzon Essential Expert 3 1/8" x 3/4"-Graphite | Utility Stairs   | Lv2 -TXP140 Lv2 - T15                                     |
| Com. Centre/Home Office | N/A   | Basement         | N/A   |
| Main Stair Landing      | *Oak Strip Lauzon Essential Expert 4 1/8" x 3/4"-Graphite | Basement Landing | *Oak Strip Lauzon Essential Expert 4 1/8" x 3/4"-Graphite |
| Library/Den/Study       | *Oak Strip Lauzon Essential Expert 4 1/8" x 3/4"-Graphite | Basement Stairs  | Oak   |
| In Law Suite            | N/A   |                  |   |

Carpet Runner ☐ Yes ☒ No

| Underpad Main Floor | Underpad 2nd Floor    | Underpad Main Stairs |
|---------------------|-----------------------|----------------------|
| NA                  | Lv1 Underpad-standard | NA                   |

Opt. Flooring Extras

| FLOOR AND WALL TILES | Floor Tile                       | Wall Tile               | Decor | Listello                 |
|----------------------|----------------------------------|-------------------------|-------|--------------------------|
| Front Foyer          | 3-18x18, New Byzantine, Grey     |                         |       |                          |
| Main Hall            | 3-18x18, New Byzantine, Grey     |                         |       |                          |
| Kitchen/Breakfast    | 3-18x18, New Byzantine, Grey     | Kitchen Backsplash      | N/A   | <input type="checkbox"/> |
| Powder Room          | 3-18x18, New Byzantine, Grey     | Pwdr Wall if Applicable | N/A   | <input type="checkbox"/> |
| Laundry              | 2-13x13, Alabastrino, Grey White |                         |       |                          |

|               | Floor                        | Tub Wall                     | Shower Wall                  | Deck Skirt                   | Deck Splash                  | Decor                               | Listello                 |
|---------------|------------------------------|------------------------------|------------------------------|------------------------------|------------------------------|-------------------------------------|--------------------------|
| Main Bathroom | N/A                          | NA                           | N/A                          | N/A                          | NA                           | <input type="checkbox"/>            | <input type="checkbox"/> |
| Master Ens    | 2-13x13, Alabastrino, Grey V | N/A                          | 3-10x13, Alabastrino, Grey/V | 2-13x13, Alabastrino, Grey V | 2-13x13, Alabastrino, Grey V | <input checked="" type="checkbox"/> | <input type="checkbox"/> |
| Ensuite 2     | 2-13x13, Alabastrino, Grey V | 3-10x13, Alabastrino, Grey/V | N/A                          | N/A                          | NA                           | <input checked="" type="checkbox"/> | <input type="checkbox"/> |
| Ensuite 3     | 2-13x13, Alabastrino, Grey V | 3-10x13, Alabastrino, Grey/V | N/A                          | N/A                          | NA                           | <input checked="" type="checkbox"/> | <input type="checkbox"/> |
| Ensuite 4     | 2-13x13, Alabastrino, Grey V | 3-10x13, Alabastrino, Grey/V | N/A                          | N/A                          | NA                           | <input checked="" type="checkbox"/> | <input type="checkbox"/> |
| Ensuite 5     | 2-13x13, Alabastrino, Grey V | 3-10x13, Alabastrino, Grey/V | N/A                          | N/A                          | NA                           | <input checked="" type="checkbox"/> | <input type="checkbox"/> |

Shower - Upgrade Floor

Opt. Tile Extras

HIGHCASTLE HOMES - COLOUR SCHEDULE

Purchaser:

CHUKWUEMEKA VINCENT OKOLI

Telephone Res. / Bus:

(416) 317-8184 /

Decor Advisor:

Caroline Rajcsanyi

Property:

9Phase: 2 of Plan - Draft Plan 21T-9005B

Project:

2073737 Ontario Inc.

Model and Elevation:

Hillcrest Elev A

PLUMBING / FAUCETS

|                |          |           |          |
|----------------|----------|-----------|----------|
| Powder Room    | Standard | Laundry   | Standard |
| Main Bath      | N/A      | Ensuite 3 | Standard |
| Master Ensuite | Standard | Ensuite 4 | Standard |
| 2nd Ensuite    | Standard | Ensuite 5 | Standard |
| R.I. Bath      | *3 Piece |           |          |

Kitchen Sink

\*Undermount

Kitchen Faucet

Standard

Drain for 2nd floor Laundry

☒ Yes

☐ No

Waterline for fridge

☒ Yes

☐ No

Supply and install all toilet paper holders, towel bars and soap dishes

☐ Yes

☒ No

Whirlpool

Opt. Plumbing Extras

PAINTING

|              |             |                   |                |                   |
|--------------|-------------|-------------------|----------------|-------------------|
| Wall Colour  | Trim Colour | Railing Colour    | Pickets Colour | Stair Colour      |
| 22 Warm Grey | Standard    | *Stained as Floor | *Wrought Iron  | *Stained as Floor |

Opt. Paint Extras

MISCELLANEOUS

Railing Style

RAILING - UPGRADE 1 - 1/2in Wrought iron BLACK square picket with square collar on alternating picket, 3in oak handrail and 3 1/2in oak std. post.

Opt. Garage Door

\*Yes-Grade Permitting

Opt. Side Door

NA

Stair Type

Oak

Interior Doors

Carrera

Int. Door Hardware

\*1 - Elite Pewter Lever

Ext. Door Hardware

\*Pewter Exterior package

Trim Style

STEP-7 1/4" 1st flr, 5 1/4" 2nd flr base w/3 1/2" case

Cold Cellar

☒

Smooth Ceiling 1st Floor

☒ Yes

☐ No

Smooth Ceiling 2nd Floor

☐ Yes

☒ No

Supply and Install Standard Mirrors

☒ Yes

☐ No

Basement Windows Upgrade

☐ Yes

☒ No

Misc.

HEATING

|                |              |            |          |        |
|----------------|--------------|------------|----------|--------|
| Fireplace      | Type         | Mantle     | Surround | Hearth |
| Family Room    | Standard 36" | *Stonecast | N/A      | N/A    |
| Master Bedroom | Standard 36" | *Stonecast | N/A      | N/A    |

Air Conditioning

☐ \*Yes

☒ No

Hood Fan Duct

☒ 6 inch

☐ 8 inch

☐ 10 inch

Gas Provisions for Dryer

☐ Yes

☒ No

Gas Provisions for Stove

☒ Yes

☐ No

Gas Provisions for BBQ

☒ Yes

☐ No

Humidifier

☒ Yes

☐ No

|                         |                        |
|-------------------------|------------------------|
| Exterior Colour Scheme: | Pre-selected By Vendor |
|-------------------------|------------------------|

NOTE: The Purchaser(s) agree(s) that:

a) Colours of materials are as close as possible to Vendor's selections, but not necessarily identical due to variances in manufacturing or manufacturers.

b) Purchaser(s) has checked and acknowledges accuracy of the above selections. Where omissions occur on the original colour selection sheet Purchaser(s) acknowledge that the Builder's selection will be final.

c) Upgrades or extras listed on this schedule will not be deemed part of the Agreement of Purchase and Sale. Any such upgrades or extras shall be null and void unless accompanied by a separate invoice and amendment. Said invoice must be paid in full.

d) The Purchaser(s) further agrees that in the event that the Vendor has preselected colours prior to the purchase of the house, the prescribed colours are final not withstanding that the Purchaser may have completed a colour selection schedule

d) The Purchaser(s) Acknowledges that once this colour schedule is signed and dated, no changes, additions or deletions will be permitted other than re-selection due to unavailability.

A \$350.00 (Per Occurance) change/administration fee will apply to above exceptions.

This Interior Colour Selection is final and approved by:

Signature:

Date:

SEP 13, 2016

Printed 9/13/2016 14:45:51

Builder's Agent:

Date:

Sept 13, 16





## Highcastle Homes Décor Centre Disclaimers

Lot#: 9 Model:Hillcrest Elev A in Riverwalk II - 2073737 Ontario Inc.

PURCHASER: CHUKWUEMEKA VINCENT OKOLI

TEL: RES.: 416-317-8184

*Through years of doing business, we at Highcastle Homes have encountered issues beyond our control. The following disclaimers apply to all instances of Purchaser's Extras forms and all Interior Colour Scheme forms.*

### Fireplaces

Fireplace Marble: Due to the many variables that can affect the pattern and/or design, frequently the marble installed on the fireplace will not be identical to the samples. We will make every attempt to come as close to the samples as possible, but cannot be responsible for results which differ from the samples.

### Ceramic Floor Tile

Many variables including variegation can affect tile colour, pattern and/or design which mean installed tiles may not be identical to the samples. We will make every attempt to come as close as possible, but cannot be responsible for results which differ from the samples.

### Hardwood Flooring

The purchaser is advised that cupping and shrinkage are characteristics of hardwood flooring normal appearing some time after installation, and no warranty is provided by the flooring supplier with respect to such cupping and shrinkage. The vendor agrees to install any hardwood flooring ordered by the purchaser in good and workmanlike manner, but shall not be responsible for, and is hereby released by the purchaser from responsibility and liability for cupping and shrinkage of hardwood flooring.

Shrinking and expanding/cupping of the hardwood floors may occur if the humidity levels in the home are not kept at industry recommendations. If the hardwood floors shrink or expand due to the homeowner not complying with these levels, the hardwood floor will no longer be under warranty and it will be the homeowner's responsibility to repair the flooring.

### Stain Colours

Due to many variables that can affect the outcome of a stain colour on wood, staircases, railings, and fireplaces, will not be identical to samples. Factors such as density, age humidity, air temperature, and the uniqueness of each piece of wood can result in wide variations in darkness or lightness. We will make every attempt to come as close to the sample as possible, but cannot be responsible for results which differ from the samples.

Stain on pre-finished hardwood floors will not be an exact match to the stain colours available on stairs, pickets and rails. The purchaser is responsible for choosing the stain on these areas to their satisfaction.

### Appliances

All fridge openings are set to builder's standard width. Please advise Décor Centre at time of colour appointment if custom sizing of cabinets is required for any built - in appliances. The purchaser is responsible for costs and fees associated with changes to pre-manufactured kitchens made subsequent to colour appointments.

### Kitchen Cabinets

The kitchen you order/purchase will undoubtedly contain slight colour variations. The degree of these variations is virtually impossible to determine before the kitchen is installed in its intended location. The amount of and type of lighting will also affect various highlights in the finish. Note: No two pieces of wood are identical. Variations in colour tone and grain patterns make a perfect colour match virtually impossible. It is generally agreed that these variations add to the natural beauty of a wood kitchen.

Shrinking and expanding of the kitchen cabinets may occur if the humidity levels in the home are not kept at industry recommendations. If the cabinets shrink or expand due to the homeowner not complying with these levels, the cabinets will no longer be under warranty and it will be the homeowner's responsibility to repair the cabinets.

### Plaster Mouldings and Medallions

Plaster mouldings will not be installed in open to above areas or areas with 2 storey elements.

### Metal Spindles

Due to the characteristics of wrought iron railing production, it is possible for the wrought iron to develop a scale effect. This scale may or may not be totally covered during the painting process. In effect, once the wrought iron picket is painted, the paint may in effect amplify the iron scale depending on the colour chosen. This is a natural effect of wrought iron and should not be construed as a defect or damage.

I hereby acknowledge reading and understanding the above copy and will not hold Highcastle Homes responsible for any issues in relation to above.

Purchasers Signature(s):

Date:

5/8/13, 2016

Lot 9



STANDARD EDGE

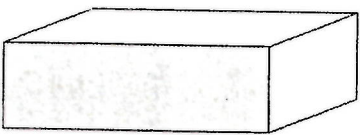

Single Straight polished 3/4"



Single Bullnose 3/4"

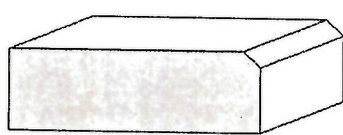

Single Bevel 1/4" top bevel 3/4" thick

UPGRADE #1 EDGES

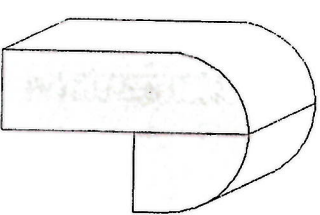

Double Bullnose 1.5" thick

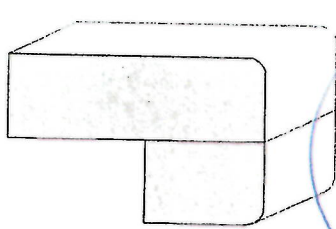

Double Pencil 1.5" thick

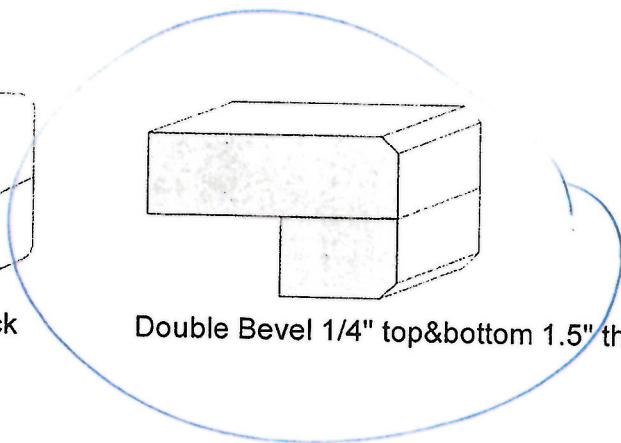

Double Bevel 1/4" top&bottom 1.5" thick

UPGRADE #2 EDGES

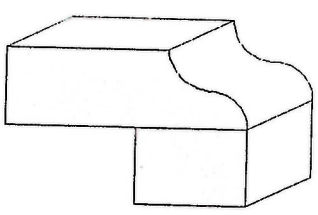

Double Ogee 1.5" thick

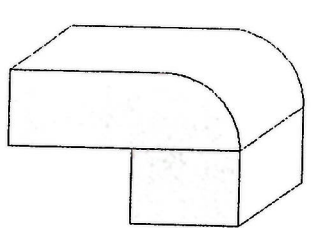

Double Quarter Moon 1.5" thick

*sig tlm*

Date sep 13/2016



### Elevation A

 Pendant

Q. R. H.

(R) Receptacle

Lot 9

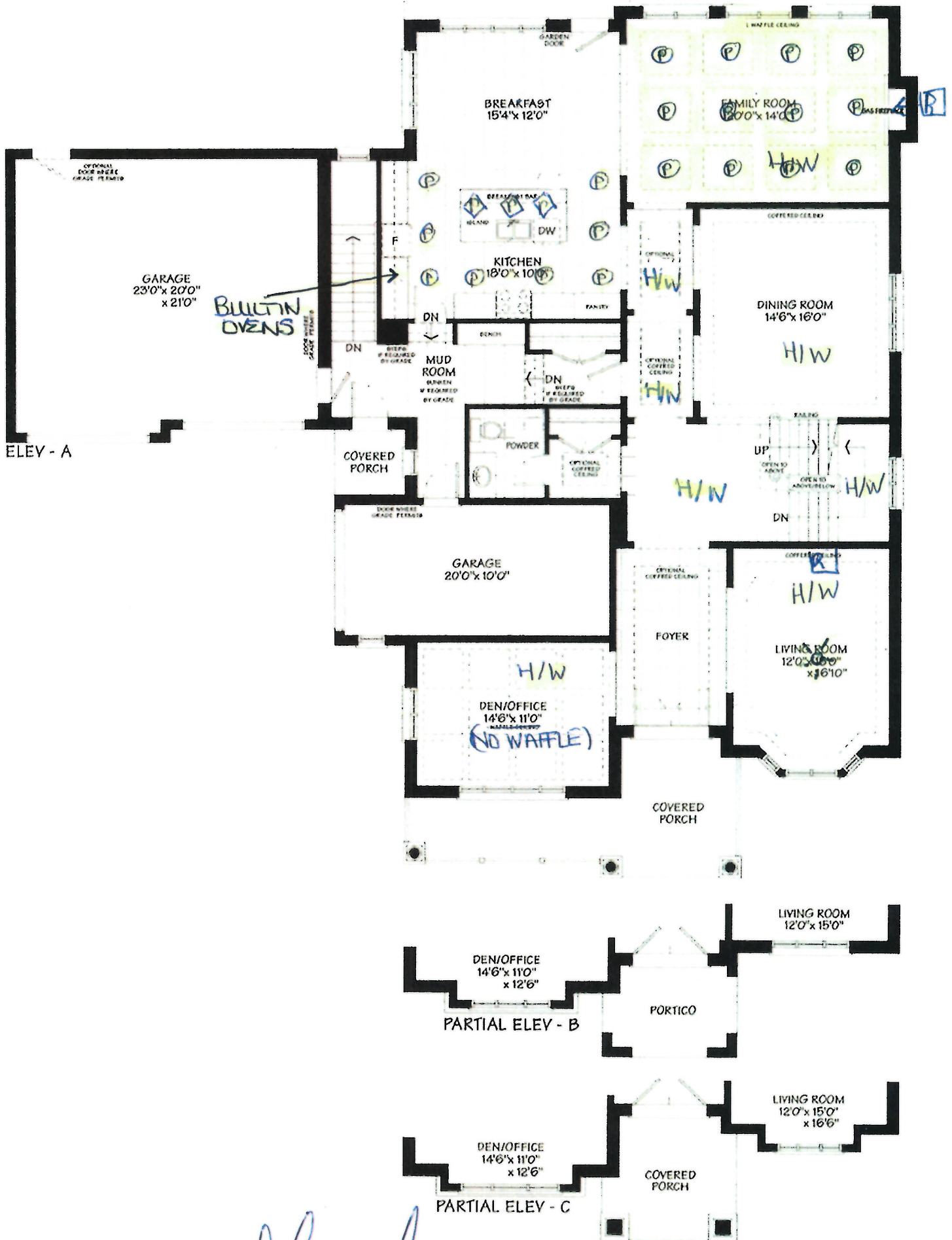

sign *Clamb*

Date 4/13/2016

## MAIN FLOOR

LOT 9.

A -4963 sq.ft. • Elevation B -4982 sq.ft. • Elevation C

[B] Receptacle



SECOND FLOOR

Sign *Chen*

Date: SEP 13, 2016

Lot 9.

n C -4945 sq.ft.

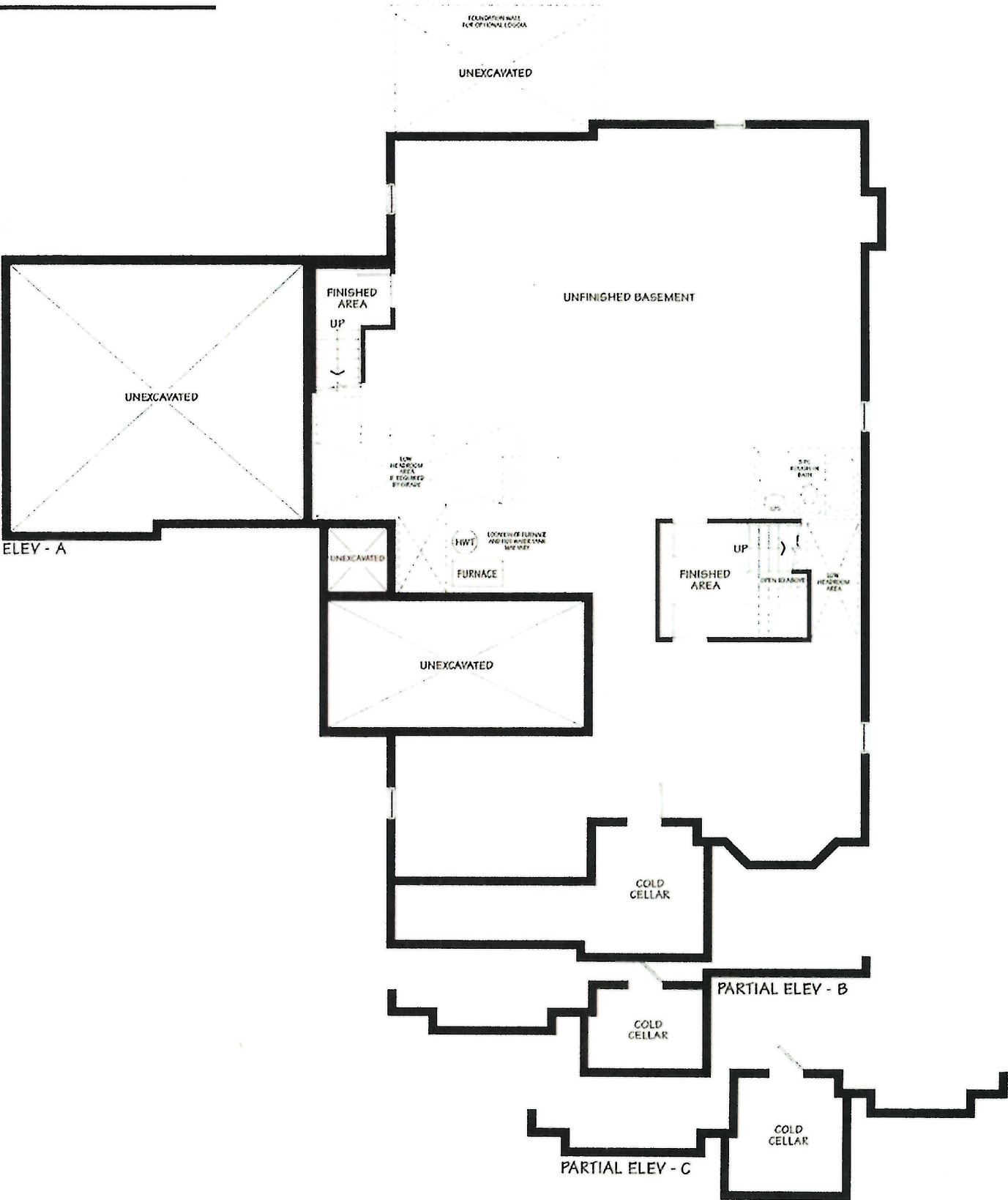

Schedule "FP"

sig Clark

Date SEP 13, 2016

BASEMENT



Lot 9  
Riverwalk ii



SPECIFICATIONS  
**AV SERIES**  
RANGE HOODS



**180 CFM/7.0 Sones @ 0.10" SP. Horizontal**  
**180 CFM/7.5 Sones @ 0.10" SP. Vertical**

- Dimensions**  
Overall bottom projection - 18<sup>3</sup>/<sub>8</sub>"  
Overall top projection - 12"  
Height - 6"  
Available widths: 21", 24", 30", 36" & 42"
- Hood Body**  
Stainless Steel: 24 gauge, grade 430 stainless steel.  
Painted: 23 gauge cold rolled commercial grade (CRCQ) steel, auto welded, coated with a baked enamel finish.
- Motor**  
2 speed, single coil, thermally protected, permanently lubricated.  
Rated 120 volts, 60 hz. Complete with 200°C lead wires.
- Lighting**  
Single 60 watt cook light capacity (bulb not included).
- Ducting Options**  
Horizontal ducting: 3 1/4"x10" (duct adapter and damper included).  
Vertical ducting: 3 1/4"x10" (duct adapter and damper included).  
Vertical ducting: 7" round (duct adapter and damper not included).  
Ductless: removable front vent (charcoal filter not included).
- Fan Blade**  
One piece polymeric, electronically balanced blade. 6<sup>5</sup>/<sub>8</sub>" diameter with 5 paddles.
- Electrical connection**  
Hood top - 7/8" knockout hole for use with 1/2" cable clamp  
Hood back - 7/8" knockout hole for use with 1/2" cable clamp

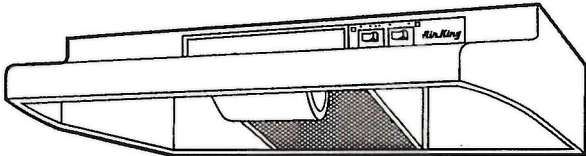

**AV SERIES**

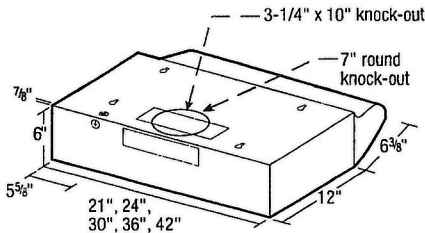

- Filters**  
UL rated, class 2 filter.  
Grease Filter: RF35 - 8 7/8"x10 3/8" (included).  
Charcoal Filter: RF34 (not included).  
Combo Grease/Charcoal: RF55 (not included).
- Available Finishes**  
White, Biscuit, Almond, Black & Stainless Steel.

| EXPANDED PERFORMANCE    |                                  |      |     |      |     |      |               |               |             |      |
|-------------------------|----------------------------------|------|-----|------|-----|------|---------------|---------------|-------------|------|
| Air Flow - CFM          | Static Pressure (inches of w.g.) |      |     |      |     |      | Sones @ .1 SP | Fan Speed RPM | Power Watts | Amps |
|                         | 0                                | 0.05 | 0.1 | 0.15 | 0.2 | 0.25 |               |               |             |      |
| Vertical Ducting High   | 246                              | 232  | 218 | 203  | 181 | 147  | 7.5           | 2973          | 87.0        | 2.1  |
| Horizontal Ducting High | 225                              | 210  | 180 | 175  | 155 | 120  | 7.0           | 3024          | 87.0        | 2.1  |

|            |              |     |         |     |       |      |              |     |                              |  |
|------------|--------------|-----|---------|-----|-------|------|--------------|-----|------------------------------|--|
| PROJECT    |              |     |         |     |       |      | ARCHITECT    |     |                              |  |
| LOCATION   |              |     |         |     |       |      | ENGINEER     |     |                              |  |
| CONTRACTOR |              |     |         |     |       |      | SUBMITTED BY |     | DATE                         |  |
| FAN NUMBER | MODEL NUMBER | CFM | IN W.C. | RPM | WATTS | AMPS | SONES        | QTY | OPTIONAL EQUIPMENT & REMARKS |  |
|            |              |     |         |     |       |      |              |     |                              |  |



Air King: 820 Lincoln Avenue  
West Chester, Pennsylvania 19380-4466  
Tel: (610) 692-7400 • 877-304-3785  
Fax: (610) 696-8048

Specifications subject to change without notice.

Updated 3-16

*Charles* Nov 11, 2016.



PLS DELETE  
PREV CONS SUMMARY

CONSTRUCTION SUMMARY

Nov 11-16

Riverwalk II - 2073737 Ontario Inc.

PURCHASER: CHUKWUEMEKA VINCENT OKOLI

TEL: RES.: 416-317-8184

| LOT / PHASE | REG. PLAN #          | HOUSE TYPE       | CLOSING DATE |
|-------------|----------------------|------------------|--------------|
| 9 / 2       | Draft Plan 21T-9005B | Hillcrest Elev A | 31-May-17    |

1) CONSTRUCTION

|   |  |
|---|--|
| 1 - RELOCATE WAFFLE CEILING FROM DEN TO GREAT ROOM (WITH MOULDING)<br>01Jun16 Note:<br>11,180/31043 |  |
|---|--|

3) HEATING / AIR CONDITIONING

|  |  |
|--|--|
| 1 - GAS LINE - ROUGH-IN FOR STOVE INCLUDING ELECTRICAL OUTLET<br>13Sep16 Note:<br>11,181/31229 |  |
|--|--|

4) PLUMBING

|   |  |
|---|--|
| 1 - SINK - KITCHEN - UNDERMOUNTED (RECTANGULAR SQUARE - DOUBLE EQUAL BOWL)<br>13Sep16 Note:<br>11,181/32381 |  |
| 1 - LAUNDRY FLOOR DRAIN - ADD FLOOR DRAIN (NO SLOPED FLOOR OR LINER)<br>13Sep16 Note:<br>11,181/31250       |  |
| 1 - WATER LINE - FRIDGE - ROUGH IN ONLY<br>13Sep16 Note:<br>11,181/31235                                    |  |

5) ELECTRICAL

|  |                 |
|--|-----------------|
| 1 - HOOD FAN - CHANGE STANDARD HOOD FAN TO A 36" HOOD FAN (SEE SPECS ATTACHED)<br>11Nov16 Note:<br>11,248/32759  | <del>NOTE</del> |
| 3 - PLUG - INTERIOR RECEPTICAL - OVER FIREPLACE IN FAMILY ROOM FOR FUTURE WALL MOUNT TV, ON WALL OF LIVING ROOM FOR FUTURE WALL MOUNT TV, ON WALL OF MASTER BEDROOM FOR FUTURE WALL MOUNT TV (SEE SMART TECH LAYOUT ATTACHED)<br>13Sep16 Note:<br>11,181/32378 |                 |
| 1 - LIGHT - ROUGH-IN ONLY - ON SEPARATE SINGLE SWITCH (LIVING ROOM)<br>13Sep16 Note:<br>11,181/31240   |                 |
| 3 - LIGHT - ROUGH-IN ONLY - ON SEPARATE SINGLE SWITCH (PENDANT LIGHT R/I OVER ISLAND)<br>13Sep16 Note:<br>11,181/31239   |                 |
| 20 - POT LIGHT - 4 INCH POTLIGHT WITH LED ENERGY STAR BULB ( 10 MINIMUM - PRICE IS EACH) 12 X FAMILY ROOM (DELETE STANDARD CEILING LIGHT), 8 X KITCHEN (DELETE STANDARD CEILING LIGHT) - (SEE PLAN)<br>13Sep16 Note:<br>11,181/31238                           |                 |

6) FLOORING & WALL TILE

|   |  |
|---|--|
| 1 - KITCHEN - DO NOT SUPPLY OR INSTALL BACKSPLASH IN KITCHEN<br>13Sep16 Note:<br>11,181/32379   |  |
| 1 - TOWEL BAR/SOAP DISHES/TOILET PAPER HOLDERS - DO NOT SUPPLY AND INSTALL ALL TOILET PAPER HOLDERS, SOAP DISHES AND TOWEL BARS THROUGHOUT<br>13Sep16 Note:<br>11,181/31237 |  |

8) FINISHING

|  |  |
|--|--|
| 2 - STAIN STAIR & RAILING PER FLOOR<br>13Sep16 Note:<br>11,181/31247 |  |
|--|--|

9) CABINETRY

|  |  |
|--|--|
| 1 - RANGETOP CABINET (MODIFIED HEIGHT) WITH DRAWERS BELOW (ELECTRICAL INCLUDED) - LEVEL 6<br>13Sep16 Note:<br>11,181/31228 |  |
|--|--|





CONSTRUCTION SUMMARY

Riverwalk II - 2073737 Ontario Inc.

PURCHASER: CHUKWUEMEKA VINCENT OKOLI

TEL: RES.: 416-317-8184

|                      |                                     |                                |                           |
|----------------------|-------------------------------------|--------------------------------|---------------------------|
| LOT / PHASE<br>9 / 2 | REG. PLAN #<br>Draft Plan 21T-9005B | HOUSE TYPE<br>Hillcrest Elev A | CLOSING DATE<br>31-May-17 |
|----------------------|-------------------------------------|--------------------------------|---------------------------|

9) CABINETRY

|   |  |
|---|--|
| 1 - BUILT IN DOUBLE APPLIANCE CABINET WITH DRAWER BELOW (TRIMKIT REQUIRED)(ELECTRICAL ROUGH IN ONLY) - LEVEL 6<br>13Sep16 Note:<br>11,181/31227 |  |
| 1 - CABINETS - KITCHEN - LEVEL 6<br>13Sep16 Note:<br>11,181/31049   |  |

Hardwood

|  |  |
|--|--|
| 1 - OAK - 3/4" X 4 1/8" ENGINEERED - UPGRADE FROM CERAMIC TILE - - MAIN STAIR HALL (UPGRADE FROM CERAMIC)<br>13Sep16 Note:<br>11,181/32377                                       |  |
| 1 - OAK - 3/4" X 3 1/8" ENGINEERED STAINED - UPGRADE FROM 3/4" X 3 1/8" OAK NATURAL - - UPPER HALL (UPGRADE FROM 3/4"x3 1/4" NATURAL HARDWOOD))<br>13Sep16 Note:<br>11,181/31246 |  |
| 1 - OAK - 3/4" X 3 1/8" ENGINEERED STAINED - UPGRADE FROM 3/4" X 3 1/8" OAK NATURAL - - MASTER (UPGRADE FROM 3/4"x3 1/4" NATURAL HARDWOOD))<br>13Sep16 Note:<br>11,181/31245     |  |
| 1 - OAK - 3/4" X 4 1/8" ENGINEERED - UPGRADE FROM 3/4" X 3 1/8" OAK NATURAL - - LIVING ROOM (UPGRADE FROM 3/4"x3 1/4" NATURAL HARDWOOD))<br>13Sep16 Note:<br>11,181/31244        |  |
| 1 - OAK - 3/4" X 4 1/8" ENGINEERED - UPGRADE FROM 3/4" X 3 1/8" OAK NATURAL - - FAMILY ROOM (UPGRADE FROM 3/4"x3 1/4" NATURAL HARDWOOD))<br>13Sep16 Note:<br>11,181/31243        |  |
| 1 - OAK - 3/4" X 4 1/8" ENGINEERED - UPGRADE FROM 3/4" X 3 1/8" OAK NATURAL - - DINING ROOM (UPGRADE FROM 3/4"x3 1/4" NATURAL HARDWOOD))<br>13Sep16 Note:<br>11,181/31242        |  |
| 1 - OAK - 3/4" X 4 1/8" ENGINEERED - UPGRADE FROM 3/4" X 3 1/8" OAK NATURAL - - DEN / OFFICE (UPGRADE FROM 3/4"x3 1/4" NATURAL HARDWOOD))<br>13Sep16 Note:<br>11,181/31241       |  |

This Document is Extremely Time Sensitive - Printed 11 Nov 16 at 12:29



## PRODUCT MODEL NUMBERS

KRFF507E                      KRFF607E  
KRFF707E

**Electrical:** A 115 volt, 60 Hz, AC only 15- or 20-amp fused, grounded electrical supply is required. It is recommended that a separate circuit serving only your refrigerator be provided. Use an outlet that cannot be turned off by a switch. Do not use an extension cord.

**Water:** A cold water supply with water pressure between 35 and 120 psi (241 and 827 kPa) is required to operate the water dispenser and ice maker. If you have questions about your water pressure, call a licensed, qualified plumber.

**NOTE:** If the water pressure is less than what is required, the flow of water from the water dispenser could decrease or ice cubes could be hollow or irregular shaped.

### Reverse Osmosis Water Supply:

**IMPORTANT:** The pressure of the water supply coming out of a reverse osmosis system going to the water inlet valve of the refrigerator needs to be between 35 and 120 psi (241 and 827 kPa).

If a reverse osmosis water filtration system is connected to your cold water supply, the water pressure to the reverse osmosis system needs to be a minimum of 40 to 60 psi (276 to 414 kPa).

## Bottom Mount Refrigerator

## PRODUCT DIMENSIONS

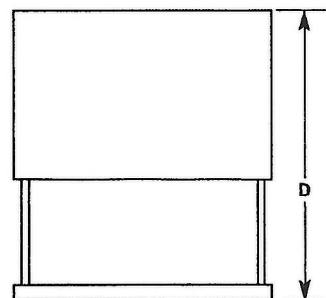
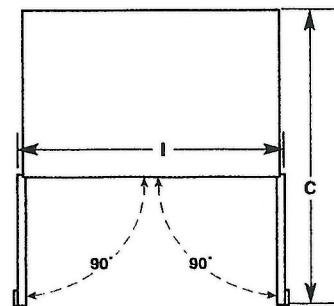
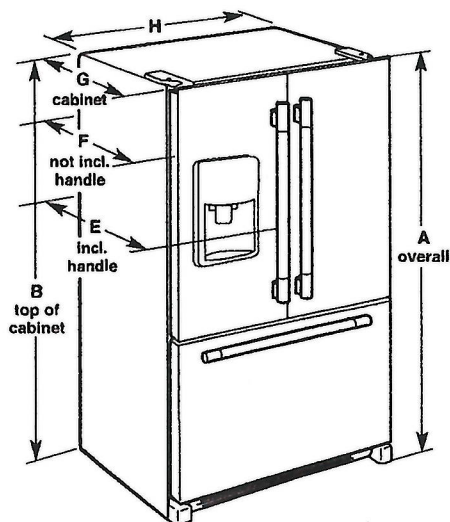

| Model Size | Height - Overall "A" | Height - Top of Cabinet "B" | Depth - Doors Open 90° "C" | Depth - Drawer Open "D" | Depth - With Handles "E" | Depth - Without Handles "F" | Depth - Cabinet Only "G" | Width - Cabinet "H" | Width - Door Open 90° "I" |
|------------|----------------------|-----------------------------|----------------------------|-------------------------|--------------------------|-----------------------------|--------------------------|---------------------|---------------------------|
| 26.8       | 70¾"                 | 68¾"                        | 49"                        | 54¾"                    | 36¾"                     | 34"                         | 29¾"                     | 35¾"                | 39¾"                      |

## LOCATION REQUIREMENTS

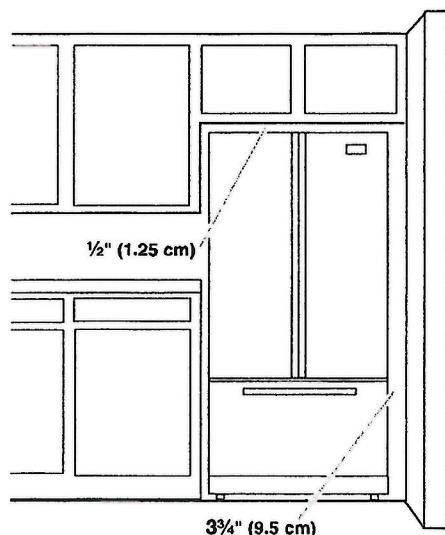

To ensure proper ventilation for your refrigerator, allow for a ½" (1.25 cm) of space on each side and at the top. Allow for a 1" (2.54 cm) space behind the refrigerator. If your refrigerator has an ice maker, allow extra space at the back for the water line connections. When installing your refrigerator next to a fixed wall, leave a 3¼" (9.5 cm) minimum space between the refrigerator and wall to allow the door to swing open.

**NOTE:** This refrigerator is intended for use in a location where the temperature ranges from a minimum of 55°F (13°C) to a maximum of 110°F (43°C). The preferred room temperature range for optimum performance, which reduces electricity usage and provides superior cooling, is between 60°F (15°C) and 90°F (32°C). It is recommended that you do not install the refrigerator near a heat source, such as an oven or radiator.

Lot 9  
Riverwalk II

KitchenAid®

KitchenAid® 36-Inch 6-Burner Gas  
Rangetop, Commercial-Style

4.8

80 Reviews Write a Review

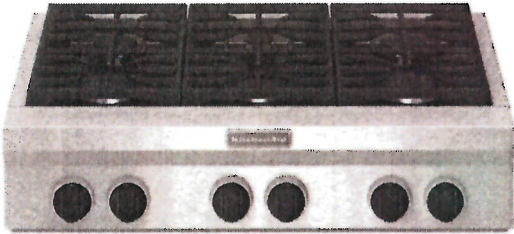

With six burners, this 36-inch gas rangetop has a commercial appeal that will satisfy even the most discriminating cooks. You'll enjoy both power and versatility with two 20K BTU Ultra Power™ Dual-Flame Burners. A 5K BTU simmer/melt burner will help you maintain the low temperatures needed for melting or gentle simmering.

AVAILABLE COLOR OPTIONS

☒ Stainless Steel - KGCU467VSS

FEATURES

Commercial-Style Design with Bold, Heavy-Duty Look and Robust, Die-Cast Black Control Knobs

Provides you with the look and performance that comes from professional, restaurant-quality appliances.

Two 20K BTU Ultra Power™ Dual-Flame Burners

Our most powerful and versatile burners give you two levels of gas flame. At full power, each burner can generate up to 20,000 BTUs for searing and stir-frying.

Three 15K BTU Professional Burners

Give you the power to quickly boil water, perform high-heat cooking techniques, and get restaurant-quality results at both high and low temperatures.

Additional Features

5K BTU Simmer/Melt Burner

Allows you to keep your delicate sauces and gravies warm without scorching and at its lowest setting it can be used for melting.

LP Conversion Kit Included

Allows you to convert the cooktop so it can be used with LP gas.

Continuous Surface with Heavy-Duty Grates

Make it easy to move cookware from one burner to another without having to lift them. The durable cast-iron grates add to the commercial appeal.

Sign

Date SEP 13, 2016  
Umm



Lot 9  
Riverwalk II



Lot 9  
Riverwalk

KitchenAid®

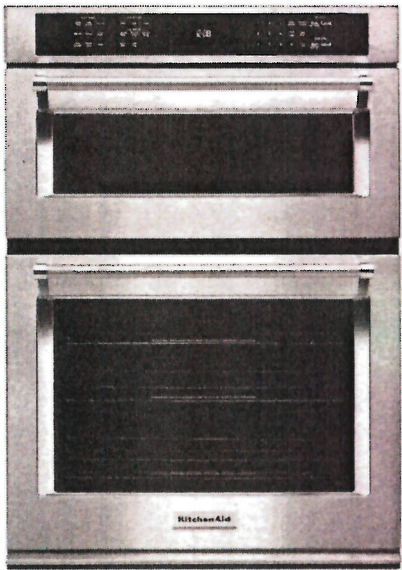

NEW

KitchenAid® 30" Combination Wall  
Oven with Even-Heat™ True  
Convection (lower oven)

5.0

[1 Review](#) [Write a Review](#)

This 30" Combination Wall Oven with Even-Heat™ True Convection provides consistent heating and even cooking. A unique bow-tie shaped design and convection fan helps ensure there are no burnt edges or under cooked centers. Its upper Microwave Convection Cooking Oven combines a 900 watt microwave with a 1600 watt convection element for high speed cooking. Bold design details are the perfect balance of elegance and functionality.

AVAILABLE COLOR OPTIONS

■ □

Stainless Steel **KOCE50DESS**

FEATURES

Even-Heat™ True Convection  
Oven (lower oven)

Produces flawless results. The unique bow-tie design and convection fan ensure the inside of the oven is heated to, and stays at, the perfect temperature.

Microwave Convection Cooking  
(upper oven)

Combines the power of a 900 watt microwave with a 1600 watt convection element to increase the speed of cooking and provide a secondary convection option.

Professionally-Inspired Design  
(VBL Light)

Combines a bold blend of professionally-inspired styling with sleek touches for the home. This beautiful built-in wall oven features Satin Textured Handles and the KitchenAid® Badge, a symbol of uncompromised quality.

Additional Features

Temperature Probe

Allows accurate measurement of internal temperatures of meats, poultry, and casseroles without having to open the oven so that food can be cooked perfectly.

5.0 Cu. Ft. Capacity (lower oven)

Provides an extra-large cooking capacity that's unsurpassed among 30" wall ovens and is perfect for large turkeys and roasts. It can even make multiple dishes at once.

SatinGlide™ Roll-Out Extension Rack (lower oven)

Allows easy roll-out for loading and unloading and features an easy-grip handle, giving confidence to cook with large or heavy dishes.

EasyConvect™ Conversion System

Takes guesswork out of convection cooking by ensuring you can get exceptional results when experimenting with new or familiar recipes.

1.4 Cu. Ft. Capacity (upper oven)

Provides spacious cooking capacity while complementing your lower convection oven.

Crispwave™ Microwave Technology and Crisper Pan  
(upper oven)

Allows grilling, frying and convection cooking in the microwave. The specially designed crisper pan can be used to brown, crisp, and pan-fry foods.

Lot 9  
Riverwalk Kii

PRODUCT MODEL NUMBERS

KEMS309E KOCE500E KOCE507E

ELECTRICAL CONNECTION

If codes permit and a separate ground wire is used, it is recommended that a qualified electrical installer determine that the ground path and the wire gauge are in accordance with local codes. Check with a qualified electrical installer if you are not sure the oven is properly grounded.

This oven must be connected to a grounded metal, permanent wiring system.

Be sure that the electrical connection and wire size are adequate and in conformance with the National Electrical Code, ANSI/NFPA 70-latest edition or CSA Standards C22.1-94, Canadian Electrical Code, Part 1 and C22.2 No. 0-M91-latest edition, and all local codes and ordinances.

To properly install your oven, you must determine the type of electrical connection you will be using and follow the instructions provided for it here.

- Oven must be connected to the proper electrical voltage and frequency as specified on the model/serial/rating plate. See the following illustration.

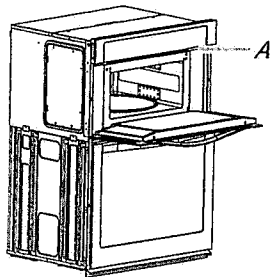

A. Model/serial/rating plate

- Models rated from 7.3 to 9.6 kW at 240 volts (5.4 to 7.4 kW at 208 volts) require a separate 40-amp circuit. Models rated at 4.8 kW and below at 240 volts (3.6 kW and below at 208 volts) require a separate 30-amp circuit.
- A circuit breaker is recommended.
- Connect directly to the fused disconnect (or circuit breaker box) through flexible, armored or nonmetallic sheathed, copper cable (with grounding wire). See "Make Electrical Connection" section.
- Flexible conduit from the oven should be connected directly to the junction box.
- Do not cut the conduit. The length of conduit provided is for serviceability of the oven.
- A UL listed or CSA approved conduit connector must be provided.
- If the house has aluminum wiring, follow the procedure below:
  - Connect a section of solid copper wire to the pigtail leads.
  - Connect the aluminum wiring to the added section of copper wire using special connectors and/or tools designed and UL listed for joining copper to aluminum.

Follow the electrical connector manufacturer's recommended procedure. Aluminum/copper connection must conform with local codes and industry accepted wiring practices.

For power requirements, refer to the following table.

| Model             | Voltage | Amperage (L1)* | Amperage (L2)* | Rating (W) |
|-------------------|---------|----------------|----------------|------------|
| KOCE507E/KOCE500E | 120/240 | 32             | 30             | 8000       |
| KOCE507E/KOCE500E | 120/208 | 30             | 28             | 6600       |

\*Amperage values noted above are for information purposes only: the units are rated in watts.

PRODUCT DIMENSIONS

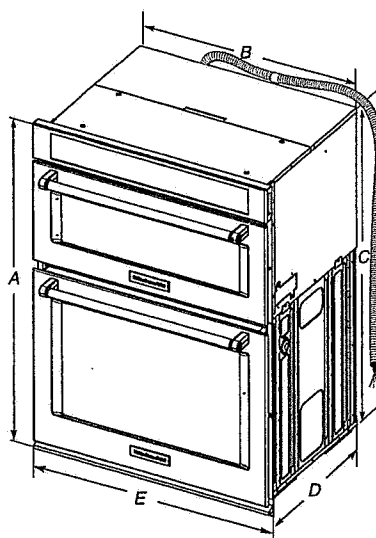

- 27" (68.6 cm) models**
- A. 42<sup>9</sup>/<sub>16</sub>" (108.0 cm) overall height
  - B. 25<sup>7</sup>/<sub>16</sub>" (64.6 cm) recessed width
  - C. 41" (104.1 cm) recessed height
  - D. 23<sup>1</sup>/<sub>4</sub>" (59.1 cm) max. recessed depth
  - E. 27" (68.6 cm) overall width
  - F. 48" (121.9 cm) flexible conduit length measured from the conduit clamp located at the rear of the oven. Do not remove the conduit clamp.
- 30" (76.2 cm) models**
- A. 42<sup>9</sup>/<sub>16</sub>" (108.0 cm) overall height
  - B. 28<sup>7</sup>/<sub>16</sub>" (72.3 cm) recessed width
  - C. 41" (104.1 cm) recessed height
  - D. 23<sup>1</sup>/<sub>4</sub>" (59.1 cm) max. recessed depth
  - E. 30" (76.2 cm) overall width
  - F. 48" (121.9 cm) flexible conduit length measured from the conduit clamp located at the rear of the oven. Do not remove the conduit clamp.

Cabinet Dimensions

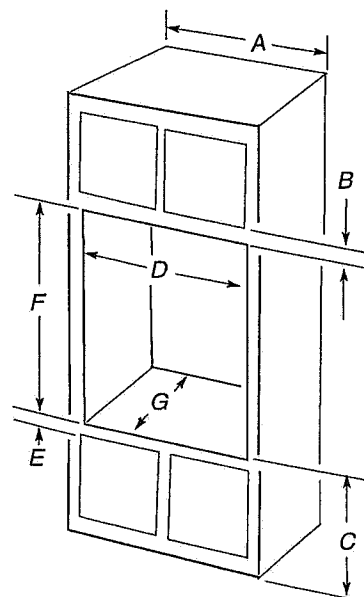

- 27" (68.6 cm) models**
- A. 27" (68.6 cm) min. cabinet width
  - B. 1" (2.5 cm) top of cutout to bottom of upper cabinet door
  - C. 19<sup>1</sup>/<sub>4</sub>" (48.9 cm) bottom of cutout to floor is recommended. 4"-19<sup>1</sup>/<sub>4</sub>" (10.2-48.9 cm) bottom of cutout to floor is acceptable.
  - D. 25<sup>1</sup>/<sub>2</sub>" (64.8 cm) cutout width
  - E. 1<sup>1</sup>/<sub>2</sub>" (3.8 cm) min. bottom of cutout to top of cabinet door
  - F. 41<sup>5</sup>/<sub>16</sub>" (105 cm)\* recommended cutout height
  - G. 24" (60.7 cm) cutout depth
- 30" (76.2 cm) models**
- A. 30" (76.2 cm) min. cabinet width
  - B. 1" (2.5 cm) top of cutout to bottom
  - C. 19<sup>1</sup>/<sub>4</sub>" (48.9 cm) bottom of cutout to floor is recommended. 4"-19<sup>1</sup>/<sub>4</sub>" (10.2-48.9 cm) bottom of cutout to floor is acceptable.
  - D. 28<sup>1</sup>/<sub>2</sub>" (72.4 cm) cutout width
  - E. 1<sup>1</sup>/<sub>2</sub>" (3.8 cm) min. bottom of cutout
  - F. 41<sup>5</sup>/<sub>16</sub>" (105 cm)\* recommended cutout
  - G. 24" (60.7 cm) cutout depth

\* NOTE: The cabinet height can be between 41" (104.1 cm) and 41<sup>1</sup>/<sub>2</sub>" (105.6 cm) for microwave/oven combination.

Lot 9  
Riverwalk ii

KitchenAid®



NEW

KitchenAid®46 dBA Dishwasher with ProScrub™ Option

4.1

15 Reviews | Write a Review

This powerful top control dishwasher features the ProScrub™ Option, offering superior cleaning with 40 targeted spray jets. The jets make quick work of the most stubborn messes. It has a Third Level Rack that's perfect for long, flat items and frees additional space on the other racks. It also features the ProWash™ Cycle, which determines the ideal cycle based on load size and soil level.

AVAILABLE COLOR OPTIONS

■ ■ ■ ■  
Stainless Steel - KDTE204ESS

FEATURES

ProScrub® Option

Helps eliminate soaking or pre-scrubbing with 40 targeted spray jets that help remove stubborn messes like seared or baked-on foods.

Third Level Rack

Makes it easy to clean hard-to-place items such as spatulas, serving utensils and measuring cups, freeing up space in the lower two racks.

Professionally-Inspired Design

Combines a bold blend of professionally-inspired styling with sleek touches for the home. This beautiful console dishwasher features the KitchenAid® Badge, a symbol of uncompromised quality.

Additional Features

ProWash™ Cycle

Determines the ideal cycle for washing dishes based on soil level and then makes real-time adjustments to achieve the best cleaning performance.

Heat Dry Option

engages a recessed heating element during the dry cycle to ensure dry dishes.

Fold-Down Tines in Lower Rack

Can be adjusted in one of three positions so water can clean inside deep or wide dishes.

SatinGlide® Max Rails (Upper Rack)

Creates a smooth, premium feeling when pulling out the upper rack, particularly with heavy loads.

Fold-Down Shelf with Stemware holder

Provides extra room in the upper rack that's perfect for additional cups, wine glasses, or longer items like utensils and spatulas.

Express Wash Cycle

Quickly and effortlessly handles the heaviest soils, even stubborn baked and seared-on messes in less time.

Filter Based Wash System

Provides exceptionally quiet and efficient wash performance with stainless steel wash arms that optimize water pressure to key areas of the dishwasher for exceptional cleaning.

Sani-Rinse Option

Heats the final rinse water to 155°F, eliminating 99.999% of food soil bacteria.



**Undercounter Dishwasher**

Lot 9  
Riverwalk II

**PRODUCT MODEL NUMBERS**

KDFE204E, KDFE454C, KDTE104E, KDTE204E,  
KDTE254E, KDTM354E, KDTM384E, KDTM404E,  
KDTM504E, KDTM704E, KDTM804E

**Electrical Requirements:** 120-volt, 60 Hz, AC-only, 15- or 20-amp, fused electrical supply. Copper wire only. A time delay fuse or circuit breaker and separate circuit is recommended.

**If direct wiring dishwasher:** Use flexible, armored or nonmetallic, sheathed copper wire with grounding wire that meets the wiring requirements for your home and local codes and ordinances. Use a UL Listed or CSA Approved conduit connector.

**If connecting dishwasher with a power supply cord:**

Use power supply cord kit (Part Number 4317824) marked for use with dishwashers. Follow the kit instructions for installing the power supply cord.

Power supply cord must plug into a grounded 3 prong outlet located in the cabinet next to the dishwasher opening. Outlet must meet all local codes and ordinances.

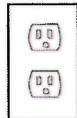
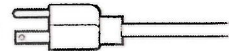

**Water Supply Requirements:** A hot water line with 20 to 120 psi (138 to 862 kPa) water pressure. Water temperature must be 120°F (49°C) water at dishwasher. Use 3/8" O.D. copper tubing with compression fitting or flexible braided water supply line

**Note:** 1/2" minimum plastic tubing is not recommended. Use a 90° elbow with 3/4" hose connection with rubber washer (Part Number W10273460). Do not solder within 6" (15.2 cm) from water inlet valve.

**Drain Requirements:** A new drain hose is supplied with your dishwasher. If this is not long enough, use a new drain hose with a maximum length of 12' (3.7 m) (Part Number 3385556) that meets all current AHAM/IAPMO test standards, is resistant to heat and detergent, and fits the 1" (2.5 cm) drain connector of the dishwasher.

Make sure to connect the drain hose to waste tee or disposer inlet above drain trap in house plumbing and 20" (50.8 cm) minimum above the floor. It is recommended

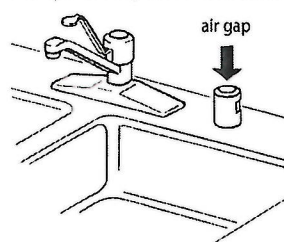

that the drain hose either be looped up and securely fastened to the underside of the counter or be connected to an air gap.

Make sure to use an air gap if the drain hose is connected to house plumbing lower than 20" (50.8 cm) above subfloor or floor.

Use 1/2" (1.3 cm) minimum I.D. drain line fittings.

If required, the air gap should be installed in accordance with the air gap installation instructions. When connecting the air gap, a rubber hose (not provided) will be needed to connect to the waste tee or disposer inlet.

**PRODUCT DIMENSIONS**

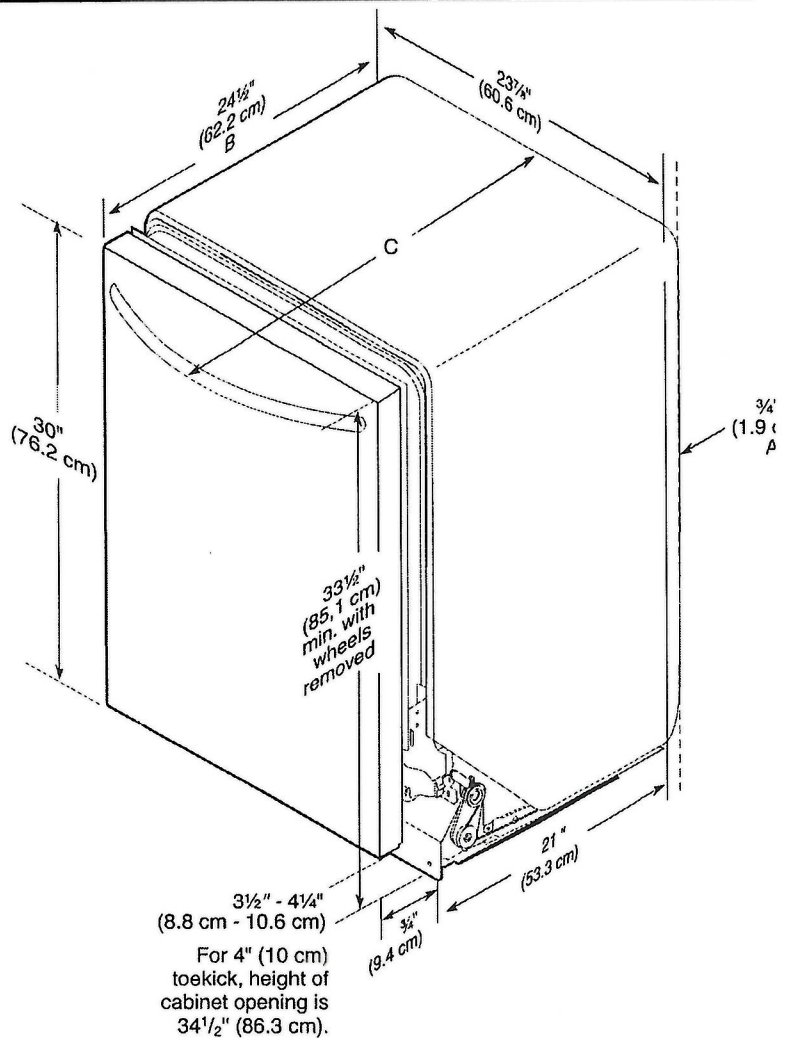

- A. Insulation may be compressed (not used on all models).
- B. For panel-ready models, dishwasher depth is 24" (60 cm) not including the 3/4" (1.9 cm) custom door panel.
- C. Door handles may protrude forward of the face of the dishwasher; varies by model.