

HIGHCASTLE HOMES - COLOUR SCHEDULE

Purchasers: ERIK PETROVIC & SARA ELIZABETH VOISIN
 Telephone Res. / Bus: /
 Decor Advisor: Caroline Rajcsanyi

Property: Block 48 Unit 2Phase: 4 of Plan - 40M-2633
 Project: 2174372 Ontario Ltd.
 Model and Elevation: White Chestnut (T-2) Elev B2

KITCHEN AND VANITIES

	Cabinet	Counter	Hardware
Kitchen	Lv2 - Charleston 3DL - Orchid	Lv3 - Caesarstone-Misty Carrera	12881 Handle
Main Bathroom	Lv2 - Simcoe - Café Noir	Calcutta Marble 4925K-07	12881 Handle
Ensuite Bathroom	Lv2 - Simcoe - Café Noir	Calcutta Marble 4925K-07	12881 Handle
Opt. Breakfast Bar	Counter Height/Flush	Kitchen Hood Fan Kitchen Upper Height	Accommodate for over-range microwave 100 cm

Stove opening – if not specified will be set to builders standard opening of approximately 30 in width
 Fridge Opening – if not specified will be set to builders minimum opening of approximately 33 x71 height (townhouses)
 - if not specified will be set to builders minimum opening of approximately 36 x 71 height (singles)

Counter top Edge

Kitchen	Single Edge (3/4") Single Pencil	

Opt. Kitchen Extras *****2FT PANTRY X 66 CM DEEP ADDED TO END OF CABINETRY*** (SEE PLAN)**
******ISLAND ROTATED, SEE NEW FRENDEL LAYOUT ATTACHED *****

PARQUET / HARDWOOD OR BROADLOOM

Kitchen / Breakfast	*1-Laminate-8mm Satin Finish Trend 4 7/8"x5/16" Oslo	Master Bedroom	*1-Laminate-8mmSatin FinishTrend4 7/8"x 5/16" Oslo
Great Room	*1-Laminate-8mm Satin Finish Trend 4 7/8"x5/16" Oslo	Bedroom 2	*1-Laminate-8mmSatin FinishTrend4 7/8"x 5/16" Oslo
Living / Formal Room	N/A	Bedroom 3	*1-Laminate-8mmSatin FinishTrend4 7/8"x 5/16" Oslo
Dining Room	N/A	Bedroom 4	N/A
Family Room	N/A		
Main Hall	*1-Laminate-8mm Satin Finish Trend 4 7/8"x5/16" Oslo		
Main Stairs	Oak		
Upper Hall	*1-Laminate-8mm Satin Finish Trend 4 7/8"x5/16" Oslo		
Com. Centre/Home Office	N/A	Basement	N/A
Main Stair Landing	*1-Laminate-8mm Satin Finish Trend 4 7/8"x5/16" Oslo	Basement Landing	N/A
Library/Den/Study	*1-Laminate-8mm Satin Finish Trend 4 7/8"x5/16" Oslo	Basement Stairs	Paint Grade (Grey)
In Law Suite	N/A		

Carpet Runner Yes No

Underpad Main Floor Underpad 2nd Floor Underpad Main Stairs

NA	NA	NA
----	----	----

Opt. Flooring Extras

*****FOYER - *1-Laminate-8mmSatin FinishTrend4 7/8"x 5/16" Oslo**

FLOOR AND WALL TILES

Floor Tile	Wall Tile
Front Foyer	*1-Laminate- 8mmSatin FinishTrend 4 7/8"x 5/16" Oslo
Main Hall	N/A
Kitchen/Breakfast	N/A
Powder Room	1-13x13, Serpentine White
Laundry	1-13x13, Serpentine White

Kitchen Backsplash
 Pwdr Wall if Applicable

	Floor	Tub Wall	Shower Wall	Deck Skirt	Deck Splash		
Main Bathroom	1-13x13, Serpentine White	1-8x10, Weave, Tender Grey	N/A	N/A	NA	<input type="checkbox"/>	<input type="checkbox"/>
Master Ens	1-13x13, Serpentine White	N/A	1-8x10, Serpentine White	N/A	NA	<input type="checkbox"/>	<input type="checkbox"/>
						<input type="checkbox"/>	<input type="checkbox"/>
						<input type="checkbox"/>	<input type="checkbox"/>
						<input type="checkbox"/>	<input type="checkbox"/>
						<input type="checkbox"/>	<input type="checkbox"/>

Shower - Upgrade Floor

Opt. Tile Extras

HIGHCASTLE HOMES - COLOUR SCHEDULE

Purchasers: ERIK PETROVIC & SARA ELIZABETH VOISIN
 Telephone Res. / Bus: /
 Decor Advisor: Caroline Rajcsanyi

Property: Block 48 Unit 2Phase: 4 of Plan - 40M-2633
 Project: 2174372 Ontario Ltd.
 Model and Elevation: White Chestnut (T-2) Elev B2

PLUMBING / FAUCETS

Powder Room	Standard	Laundry	N/A
Main Bath	Standard		
Master Ensuite	Standard		
2nd Ensuite	N/A		
R.I. Bath	*3 Piece		
Kitchen Sink	*Undermount		
Kitchen Faucet	Standard		

Drain for 2nd floor Laundry Yes No
 Waterline for fridge Yes No
 Supply and install all toilet paper holders, towel bars and soap dishes Yes No

Whirlpool

Opt. Plumbing Extras

*** DOUBLE SINKS IN MASTER ENSUITE ***

PAINTING

Wall Colour	Trim Colour	Railing Colour	Pickets Colour	Stair Colour
22 Warm Grey	N/A	*Stained as Floor	*Wrought Iron	*Stained as Floor

Opt. Paint Extras

MISCELLANEOUS

Railing Style RAILING - UPGRADE 2- 1/2in Wrought iron square picket with square collar on alternating picket, 3in oak handrail and 3 1/2in oak std. post.

Opt. Garage Door	*Yes-Grade Permitting	Opt. Side Door	NA
Interior Doors	*1 - Carrara	Int. Door Hardware	*Pewter Knob
		Trim Style	*1 - 2 3/4in Case & 4in Baseboard
			Ext. Door Hardware
			*Pewter Exterior package
			Cold Cellar <input type="checkbox"/>

Smooth Ceiling 1st Floor Yes No
 Smooth Ceiling 2nd Floor Yes No
 Supply and Install Standard Mirrors Yes No

Misc.

HEATING

Fireplace	Type	Mantle	Surround	Hearth

Air Conditioning *Yes No
 Hood Fan Duct 6 inch 8 inch 10 inch
 Gas Provisions for Dryer Yes No
 Gas Provisions for Stove Yes No

Gas Provisions for BBQ Yes No
 Humidifier Yes No

Exterior Colour Scheme: Pre-selected By Vendor

NOTE: The Purchaser(s) agree(s) that:

- a) Colours of materials are as close as possible to Vendor's selections, but not necessarily identical due to variances in manufacturing or manufacturers.
- b) Purchaser(s) has checked and acknowledges accuracy of the above selections. Where omissions occur on the original colour selection sheet Purchaser(s) acknowledge that the Builder's selection will be final.
- c) Upgrades or extras listed on this schedule will not be deemed part of the Agreement of Purchase and Sale. Any such upgrades or extras shall be null and void unless accompanied by a separate invoice and amendment. Said invoice must be paid in full.
- d) The Purchaser(s) further agrees that in the event that the Vendor has preselected colours prior to the purchase of the house, the prescribed colours are final not withstanding that the Purchaser may have completed a colour selection schedule
- e) The Purchaser(s) Acknowledges that once this colour schedule is signed and dated, no changes, additions or deletions will be permitted other than re-selection due to unavailability.

A \$350.00 (Per Occurance) change/administration fee will apply to above exceptions.

This Interior Colour Selection is final and approved by:

Signature:  Date: 05/20/20

Printed 5/20/2020 15:30:47

Signature:  Date: May 20 2020
 Builder's Agent: Rajcsanyi Date: May 20 2020



Highcastle Homes Décor Centre Disclaimers

Lot#: Block 48 Unit 2 Model: White Chestnut (T-2) Elev B2 in Northglen (H) - 2174372 Ontario Ltd.

PURCHASERS: ERIK PETROVIC and SARA ELIZABETH VOISIN

TEL:

Through years of doing business, we at Highcastle Homes have encountered issues beyond our control. The following disclaimers apply to all instances of Purchaser's Extras forms and all Interior Colour Scheme forms.

Fireplaces

Fireplace Marble: Due to the many variables that can affect the pattern and/or design, frequently the marble installed on the fireplace will not be identical to the samples. We will make every attempt to come as close to the samples as possible, but cannot be responsible for results which differ from the samples.

Ceramic Floor Tile

Many variables including variegation can affect tile colour, pattern and/or design which mean installed tiles may not be identical to the samples. We will make every attempt to come as close as possible, but cannot be responsible for results which differ from the samples.

Hardwood Flooring

The purchaser is advised that cupping and shrinkage are characteristics of hardwood flooring normal appearing some time after installation, and no warranty is provided by the flooring supplier with respect to such cupping and shrinkage. The vendor agrees to install any hardwood flooring ordered by the purchaser in good and workmanlike manner, but shall not be responsible for, and is hereby released by the purchaser from responsibility and liability for cupping and shrinkage of hardwood flooring.

Shrinking and expanding/cupping of the hardwood floors may occur if the humidity levels in the home are not kept at industry recommendations. If the hardwood floors shrink or expand due to the homeowner not complying with these levels, the hardwood floor will no longer be under warranty and it will be the homeowner's responsibility to repair the flooring.

Stain Colours

Due to many variables that can affect the outcome of a stain colour on wood, staircases, railings, and fireplaces, will not be identical to samples. Factors such as density, age humidity, air temperature, and the uniqueness of each piece of wood can result in wide variations in darkness or lightness. We will make every attempt to come as close to the sample as possible, but cannot be responsible for results which differ from the samples.

Stain on pre-finished hardwood floors will not be an exact match to the stain colours available on stairs, pickets and rails. The purchaser is responsible for choosing the stain on these areas to their satisfaction.

Appliances

All fridge openings are set to builder's standard width. Please advise Décor Centre at time of colour appointment if custom sizing of cabinets is required for any built - in appliances. The purchaser is responsible for costs and fees associated with changes to pre-manufactured kitchens made subsequent to colour appointments.

Kitchen Cabinets

The kitchen you order/purchase will undoubtedly contain slight colour variations. The degree of these variations is virtually impossible to determine before the kitchen is installed in its intended location. The amount of and type of lighting will also affect various highlights in the finish. Note: No two pieces of wood are identical. Variations in colour tone and grain patterns make a perfect colour match virtually impossible. It is generally agreed that these variations add to the natural beauty of a wood kitchen.

Shrinking and expanding of the kitchen cabinets may occur if the humidity levels in the home are not kept at industry recommendations. If the cabinets shrink or expand due to the homeowner not complying with these levels, the cabinets will no longer be under warranty and it will be the homeowner's responsibility to repair the cabinets.

Plaster Mouldings and Medallions

Plaster mouldings will not be installed in open to above areas or areas with 2 storey elements.

Metal Spindles

Due to the characteristics of wrought iron railing production, it is possible for the wrought iron to develop a scale effect. This scale may or may not be totally covered during the painting process. In effect, once the wrought iron picket is painted, the paint may in effect amplify the iron scale depending on the colour chosen. This is a natural effect of wrought iron and should not be construed as a defect or damage.

I hereby acknowledge reading and understanding the above copy and will not hold Highcastle Homes responsible for any issues in relation to above.

Purchasers Signature(s):

Date:

May 20/20

COAST APPLIANCES

905-303-6909, Unit 1, Vaughan, ON L4K 5V8

APPLIANCE VOUCHER

STON
LEN



HOMEOWNER ACKNOWLEDGES THAT THEY HAVE READ AND ACCEPT THE ABOVE TERMS AND CONDITIONS.

APPLIANCE PACKAGE INCLUDES REFRIGERATOR, RANGE, DISHWASHER, WASHER AND DRYER OR LAUNDRY CENTRE

SITE: Northglen PH4 HOMEOWNERS: Erik Petrovic
Sara Vaisin
 BLOCK # 48 LOT # 2 CLOSING DATE: Nov 26, 2020
289-979-8944
 HOME # _____ CELL # 226-220-0883
 EMAIL: erikpetrovic@live.ca
Sara.vaisine@hotmail.com
 BUS # _____
 AUTHORIZATION: _____
 DATE May 20, 2020 PER _____
 EXTENDED WARRANTIES AVAILABLE - *ASK FOR COMPLETE DETAILS

with Frank DeRose at 905-303-6909
 If homeowner agreement is voided or if the agreement is deleted, we will delete any or all of the appliances.
 Responsibility to arrange appliance installation. All appliance delivery of products and removal of packaging materials.
 If customer wishes to upgrade appliances, a credit based on the old appliances will be applied to the price of the upgraded product.
 Subject to change without notice. Door swings must be noted.
 If package is delivered, exchanges or returns will not be accepted.
 Do not purchase appliances directly with Coast Appliances. Any purchase made directly to Coast Appliances and purchasers are responsible for any changes to the dimensions of the appliances.
 Coast Appliances is not responsible for not fitting appliances due to late changes in lines and rough-ins are not included and must be noted at the time of purchase. Highcastle Homes is not responsible for any changes made through Coast Appliances.
 This voucher has no cash value, and is non-transferable.
 Delivery is to be arranged for delivery 30 days before closing.
 Installation is to be arranged 2 months before closing.
 Please call to order appliances and arrange for delivery after closing.

905) 303-6909 fderose@coastappliances.com

COAST APPLIANCES



Whirlpool Stainless Steel, 30" Self Clean Range

Whirlpool Stainless Steel 24" Dishwasher

Whirlpool White 27" Top Load Washer

Whirlpool White 27" Top Load Electric Dryer

Whirlpool White 27" Electric Laundry Centre

This certificate entitles you to the above appliances supplied by Coast Appliances courtesy of Highcastle Homes.

Enk Petrovik, Sara Voisin
ISSUED TO

May 20, 2020
DATE OF ISSUE

N



THIS OFFER BY APPOINTMENT ONLY. PLEASE CONTACT



FRANK DEROSE
fderose@coastappliances.com

Tel: (905) 303-6909 Fax: (905) 856-9908 1-888-745-0622

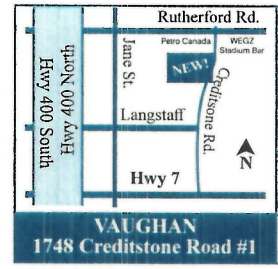

days after closing. This offer applies to all Highcastle Homes purchasers that receive an Appliance Package in their offer to purchase. Appliance pictures are for representation only. Models may change without notice. See reverse for terms and conditions

Block 48-2.

STONE EDGE PROFILES

Approx 2CM or 3/4" Standard Edge

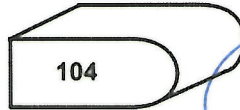
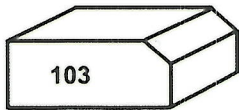
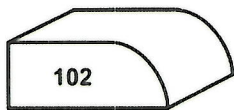

Single pencil

1st UPGRADE

Approx 4CM or 1.5" - SEAMS WILL BE VISIBLE

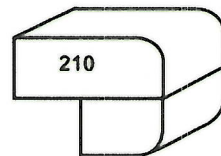
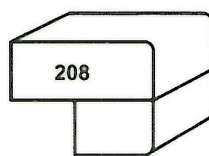
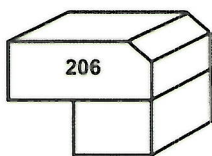
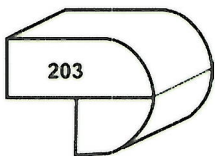

2nd UPGRADE



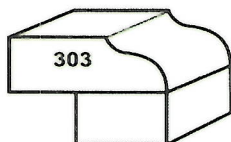

Approx 4CM or 1.5" - SEAMS WILL BE VISIBLE



Sign Edge
Sign with

Date May 2020
Date Nov 11 20

Block 4B-2

-  Bell
-  Cable
-  Receptacle
-  S

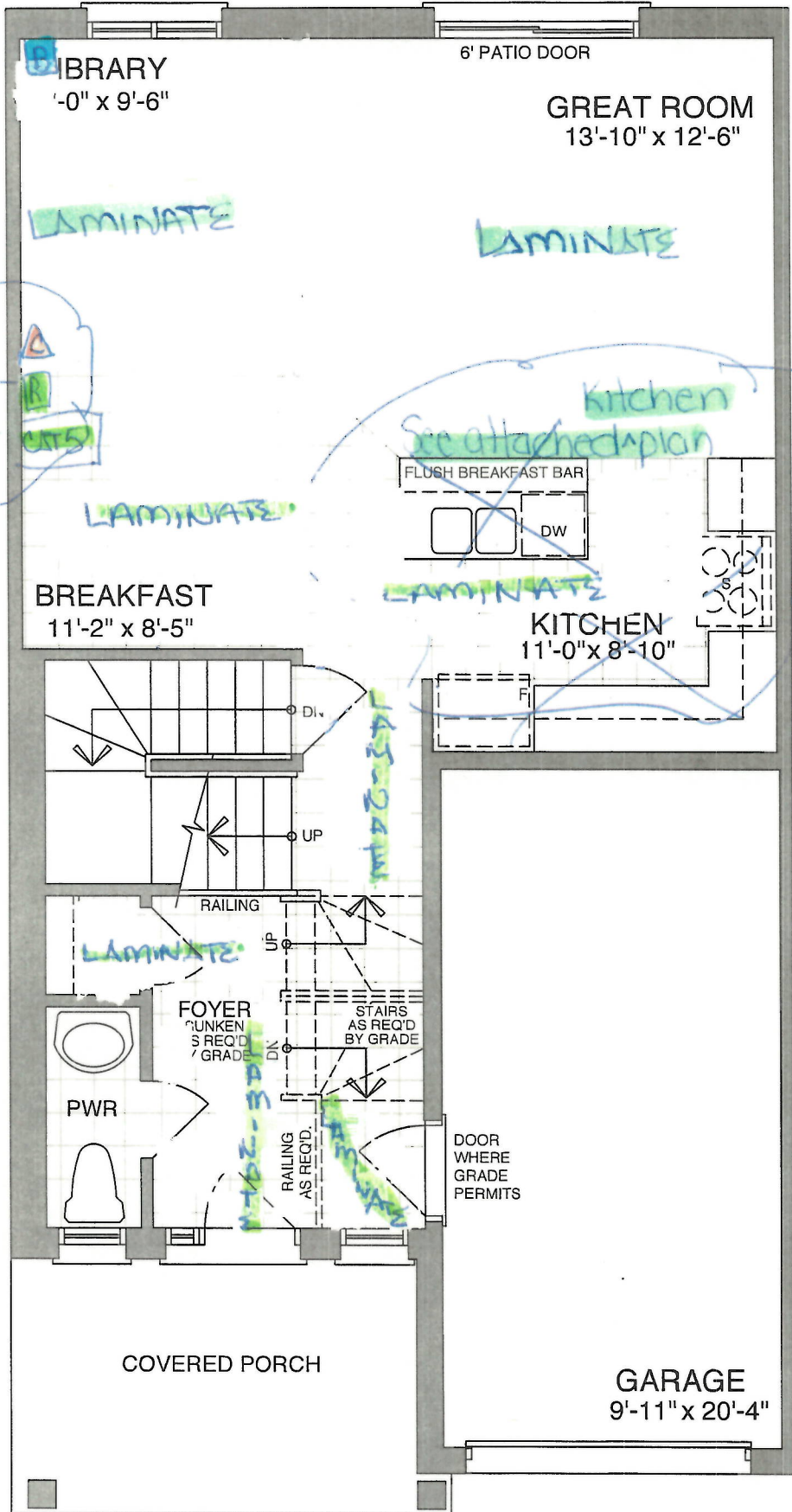

MAIN FLOOR - ELEV A & B

Sign 
 Sign 

Date May 20/20
 Date May 20/20

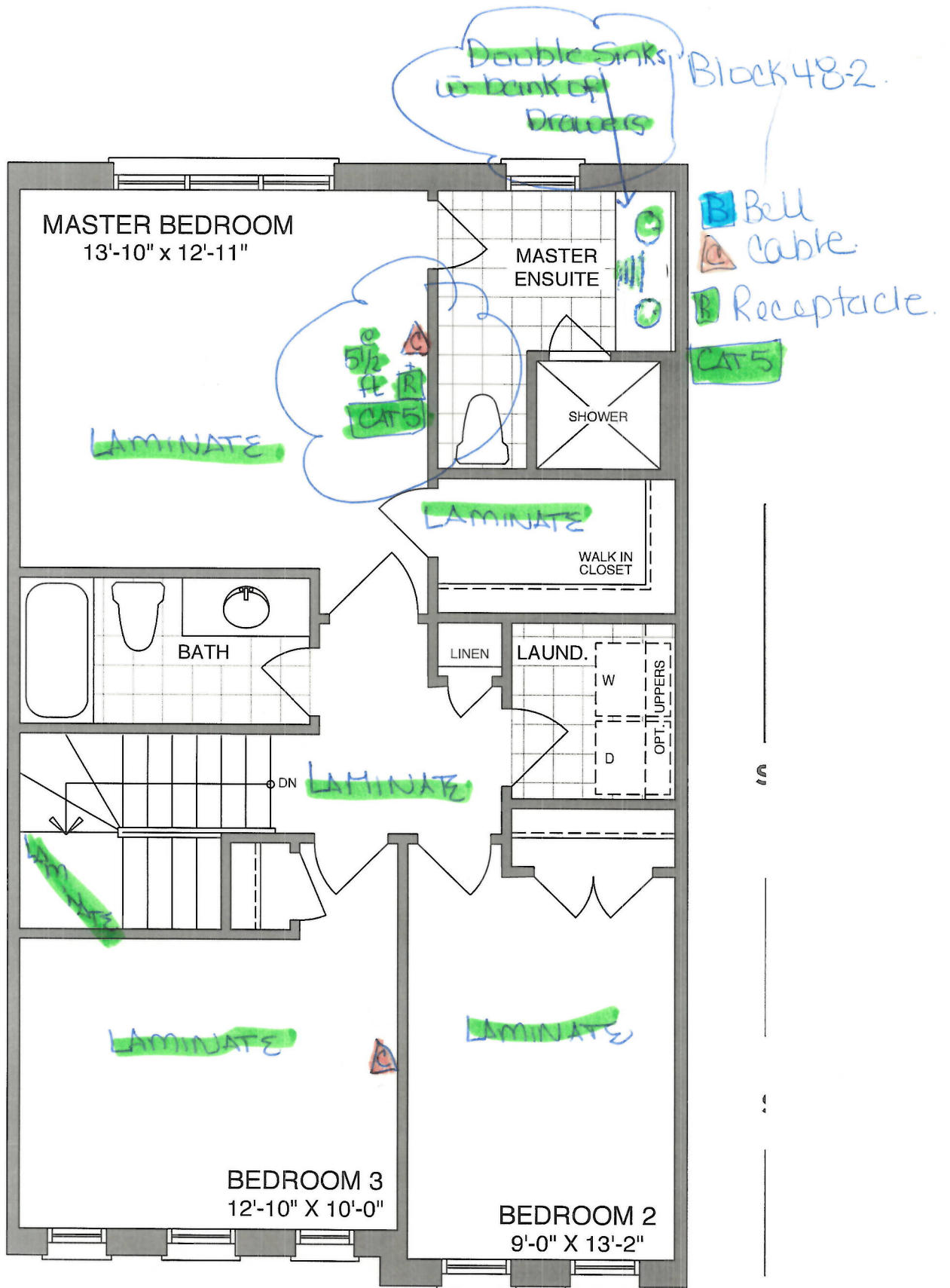

SECOND FLOOR - ELEV A1 & A2

Sign *[Signature]*
 Sign *[Signature]*

Date *May 20/20*
 Date *May 20/20*

Block 48-2

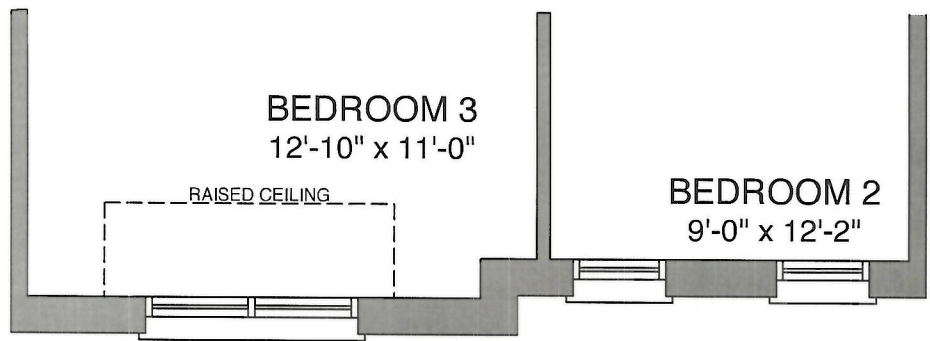

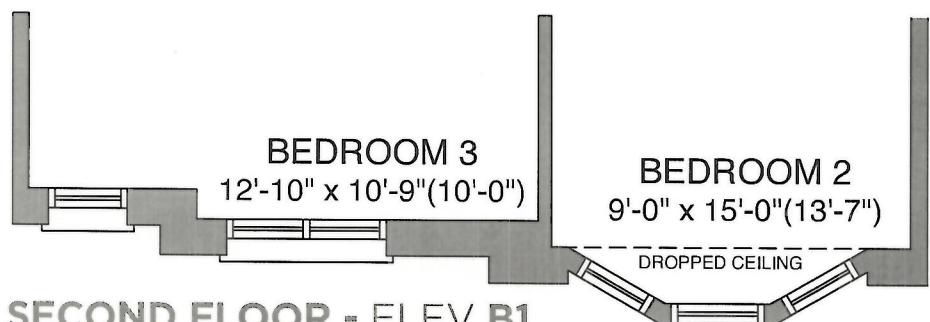

SECOND FLOOR - ELEV A3 & A4

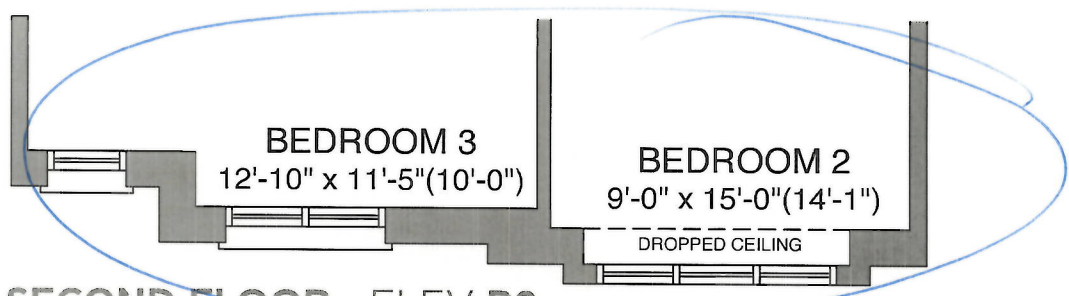

SECOND FLOOR - ELEV B1



SECOND FLOOR - ELEV B2

Sign 
Sign 

Date May 2010
Date May 2010

Block 48-2
Northglenn PH4

36" x 24" 36" x 24"

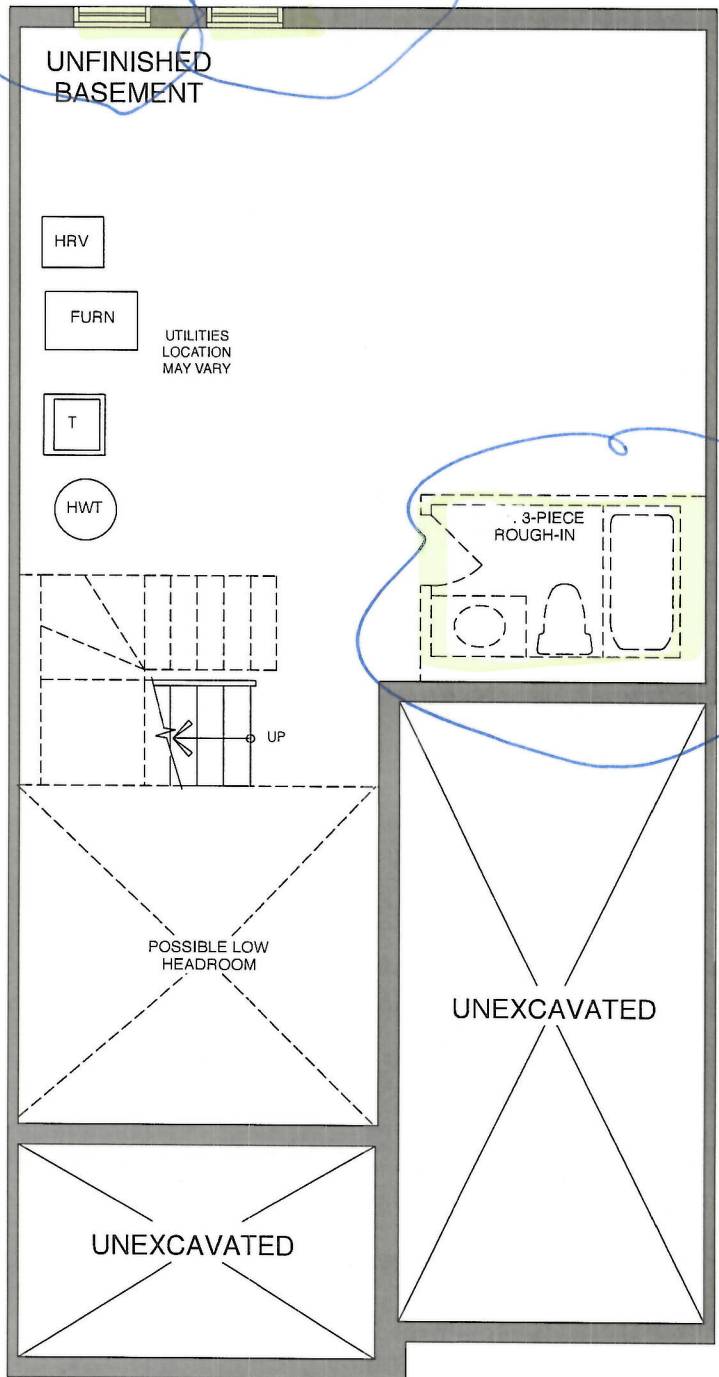

BASEMENT - ELEV A & B

Sign 
Sign 

Date: May 20/20
Date: May 20/20

BLK 48-2

WRF532SMH FRENCH DOOR REFRIGERATOR

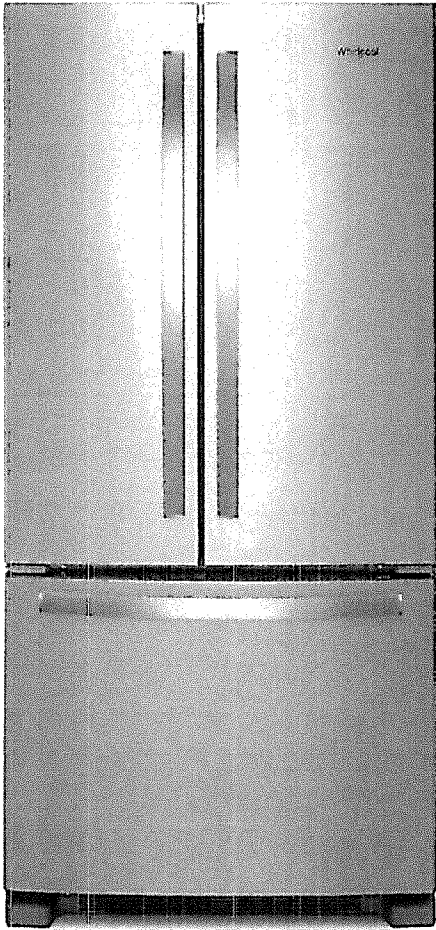

FULL-WIDTH, TEMPERATURE-CONTROLLED DRAWER



Store wide items like party platters and sheet cakes or preserve large amounts of meat and cheese at just the right temperature.

FRAMELESS GLASS SHELVES



Store more items on each shelf with wall-to-wall frameless glass shelves, which offer greater storage flexibility.

GALLON DOOR BINS

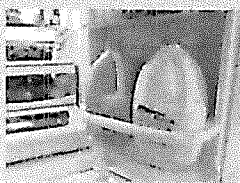

Free up shelf space by storing gallons of milk and other containers in the door.

OTHER FEATURES

- Humidity-controlled crispers
- Accu-Chill™ temperature management system
- Adaptive defrost
- FreshFlow™ produce preserver
- LED interior lighting

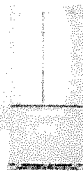

White
(W)



Black
(B)



Fingerprint Resistant
Stainless Steel (Z)



Fingerprint Resistant
Black Stainless Steel (V)

MODEL	WRF532SMHW	WRF532SMHB	WRF532SMHZ	WRF532SMHV
Max height (in)	70-1/8"	70-1/8"	70-1/8"	70-1/8"
Width (in)	32-5/8"	32-5/8"	32-5/8"	32-5/8"
Depth (in)	34-1/2"	34-1/2"	34-1/2"	34-1/2"



BIK 48-2

WMH31017H OVER-THE-RANGE MICROWAVE

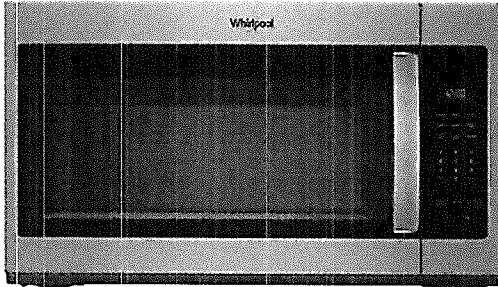

DISHWASHER-SAFE TURNTABLE PLATE



Clean up spills on the turntable by simply putting it in the dishwasher.

2-SPEED, 300 CFM MOTOR CLASS*

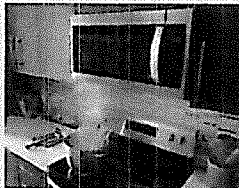

Match the right amount of ventilation to the dish being prepared and quickly get rid of cooking odors with two different fan speed settings.

MICROWAVE PRESETS



Get just the right amount of heat and time, whether you're cooking or defrosting, with specific preset options.

OTHER FEATURES

- Add 30 seconds option
- Electronic touch controls
- Adjustable cooktop lighting

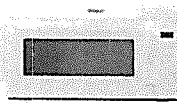

White (W)

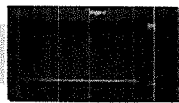

Black (B)



Fingerprint Resistant Stainless Steel (Z)



Silver (S)

MODEL	WMH31017HW	WMH31017HB	WMH31017HZ	WMH31017HS
Max height (in)	17-1/8"	17-1/8"	17-1/8"	17-1/8"
Width (in)	29-15/16"	29-15/16"	29-15/16"	29-15/16"
Depth (in)	15-9/16"	15-9/16"	15-9/16"	15-9/16"



*Performance varies based on installation.

©/™ ©2018 Whirlpool. All rights reserved. 1/18. WC170107A

2020 Design - [T-2 - WHITE CHESTNUT 'A,B' with Island Turned]

Block 48-2

ceiling light relocated in kitchen
to over island *

extended uppers *

OVER THE RANGE
MICRO

2 FT PANTRY
60cm
dep

light not
to scale

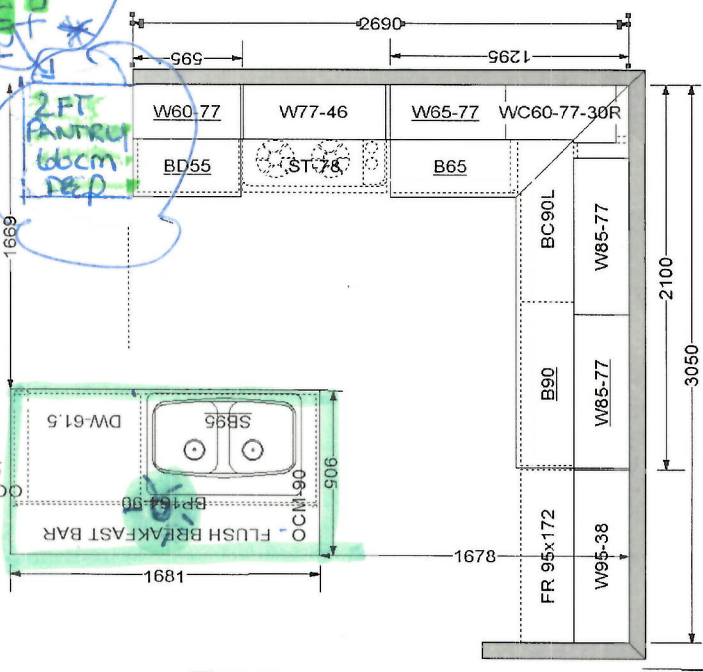

Date: 11/10/20
Date: 11/11/20

Signature
Signature

This sketch is for DESIGN PURPOSES ONLY - It is not meant to be an exact rendition.



CONSTRUCTION SUMMARY

Northglen (H) - 2174372 Ontario Ltd.

PURCHASERS: ERIK PETROVIC and SARA ELIZABETH VOISIN

TEL:

LOT / PHASE	REG. PLAN #	HOUSE TYPE	CLOSING DATE
Block 48 Unit 2 / 4	40M-2633	White Chestnut (T-2) Elev B2	26-Nov-20

Agreement of Purchase and Sale

BONUS: 5 APPLIANCE PACKAGE - INCLUDES STAINLESS STEEL: FRIDGE, STOVE, BUILT-IN DISHWASHER: WHITE: WASHER/DRYER-BUILDERS STANDARD PACKAGE <i>Worksheet</i> Note:	
BONUS: GRANITE KITCHEN COUNTER TOP - AS PER PLAN (FROM BUILDERS STANDARD SAMPLES) <i>Worksheet</i> Note:	
BONUS: 2 1/4 INCH NATURAL HARDWOOD FLOORING ON MAIN FLOOR (EXCLUDING TILE AREAS) - AS PER PLAN (FROM BUILDERS STANDARD SAMPLES). <i>Worksheet</i> Note:	
BONUS: 1ST UPGRADE COLONIAL TRIM - AS PER PLAN (FROM BUILDERS STANDARD SAMPLES) <i>Worksheet</i> Note:	
BONUS: \$5,000.00 IN UPGRADES - TO BE USED AT BUILDERS DECORE CENTRE AT TIME OF COLOUR SELECTIONS (INCLUSIVE OF HST) <i>Worksheet</i> Note:	
BUILDER TO DELETE THE TWO INTERIOR WALLS ENCLOSING THE LIBRARY (AS PER PLAN ATTACHED HERETO). <i>Worksheet</i> Note:	



CONSTRUCTION SUMMARY

Northglen (H) - 2174372 Ontario Ltd.

PURCHASERS: ERIK PETROVIC and SARA ELIZABETH VOISIN

TEL:

LOT / PHASE	REG. PLAN #	HOUSE TYPE	CLOSING DATE
Block 48 Unit 2 / 4	40M-2633	White Chestnut (T-2) Elev B2	26-Nov-20

1) CONSTRUCTION

1 - KITCHEN - ISLAND ROTATED (SEE ATTACHED KITCHEN PLAN) 20May20 Note: 11,443/35308	
---	--

10) COUNTERTOPS

1 - UPGRADE GRANITE COUNTERTOP - FROM LEVEL 1 TO LEVEL 3 - - KITCHEN 20May20 Note: 11,443/35306	
---	--

4) PLUMBING

1 - WATER LINE - FRIDGE - ROUGH IN ONLY 20May20 Note: 11,443/35318	
1 - SINK - KITCHEN - UNDERMOUNTED (RECTANGULAR SQUARE - SINGLE LARGE BOWL) 20May20 Note: 11,443/35317	
1 - SINK - WASHROOM VANITY - ADDITIONAL (INCLUDES STANDARD FAUCET) - MASTER ENSUITE 20May20 Note: 11,443/35303	
1 - 3 PIECE ROUGH IN BASEMENT 03Apr20 Note: 11,425/35095	

5) ELECTRICAL

1 - KITCHEN - STANDARD CEILING LIGHT TO BE RELOCATED OVER BREAKFAST BAR 20May20 Note: 11,443/35309	
1 - CABLE JACK - ADDITIONAL - ROUGH-IN (BEDROOM 3) SEE PLAN 20May20 Note: 11,443/35292	
1 - **PHONE ONLY IN CORNER OF LIBRARY (SEE PLAN) ** 20May20 Note: 11,443/35291	
1 - PLUG - INTERIOR RECEPTICAL (NOT DEDICATED) (MASTER BEDROOM, SEE PLAN) BESIDE CABLE AND CAT 5 AT 5 1/2 FT FOR FUTURE WALL MOUNT TV 20May20 Note: 11,443/35290	
1 - NETWORK JACK - ADDITIONAL - CAT5E ROUGH-IN (MASTER BEDROOM, SEE PLAN) BESIDE CABLE AND RECEPTACLE AT 5 1/2 FT FOR FUTURE WALL MOUNT TV 20May20 Note: 11,443/35289	
1 - PLUG - INTERIOR RECEPTICAL (NOT DEDICATED) (BREAKFAST AREA, SIDE WALL, SEE PLAN) BESIDE CABLE AND CAT 5 AT 5 1/2 FT FOR FUTURE WALL MOUNT TV 20May20 Note: 11,443/35288	
1 - NETWORK JACK - ADDITIONAL - CAT5E ROUGH-IN (BREAKFAST AREA, SIDE WALL, SEE PLAN) BESIDE CABLE AND RECEPTACLE AT 5 1/2 FT FOR FUTURE WALL MOUNT TV 20May20 Note: 11,443/35287	

6) FLOORING & WALL TILE

1 - LAMINATE FLOORING - LEVEL 1 - UPGRADE FROM CARPET - - BEDROOM 3 (UPGRADE FROM CARPET) 20May20 Note: 11,443/35315	
1 - LAMINATE FLOORING - LEVEL 1 - UPGRADE FROM CARPET - - BEDROOM 2 (UPGRADE FROM CARPET) 20May20 Note: 11,443/35314	



CONSTRUCTION SUMMARY

Northglen (H) - 2174372 Ontario Ltd.

PURCHASERS: ERIK PETROVIC and SARA ELIZABETH VOISIN

TEL:

LOT / PHASE	REG. PLAN #	HOUSE TYPE	CLOSING DATE
Block 48 Unit 2 / 4	40M-2633	White Chestnut (T-2) Elev B2	26-Nov-20

6) FLOORING & WALL TILE

1 - LAMINATE FLOORING - LEVEL 1 - UPGRADE FROM CARPET - - MASTER BEDROOM (UPGRADE FROM CARPET) <i>20May20</i> Note: 11,443/35313	
1 - LAMINATE FLOORING - LEVEL 1 - UPGRADE FROM CARPET - - UPPER HALL (UPGRADE FROM CARPET) <i>20May20</i> Note: 11,443/35312	
1 - LAMINATE FLOORING - LEVEL 1 - UPGRADE FROM CERAMIC - - FOYER AND MAIN HALL (UPGRADE FROM CERAMIC) - <i>20May20</i> Note: 11,443/35311	
1 - LAMINATE FLOORING - LEVEL 1 - CHANGE FROM 2 1/4 X 3/4 NATURAL IN GREAT ROOM AND LIBRARY <i>20May20</i> Note: 11,443/35310	
1 - DO NOT SUPPLY OR INSTALL ALL MIRRORS THROUGHOUT <i>20May20</i> Note: 11,443/35305	

8) FINISHING

1 - RAILING - UPGRADE 2 - 1/2 INCH WROUGHT IRON SQUARE PICKET WITH SINGLE SQUARE COLLAR ON ALTERNATING PICKET, 3 INCH OAK HANDRAIL AND 3 1/2 INCH OAK STANDARD POST. <i>20May20</i> Note: 11,443/35328	
--	--

9) CABINETRY

1 - CABINETS - MASTER ENSUITE - LEVEL 2 <i>20May20</i> Note: 11,443/35324	
1 - CABINETS - MAIN BATH - LEVEL 2 <i>20May20</i> Note: 11,443/35323	
1 - UPPER CABINETS - EXTENDED UPPER CABINET (90 CM AND 100CM TALL) - GROUP 1 - 4 <i>20May20</i> Note: 11,443/35301	
2 - PANTRY CABINETS - PANTRY 66CM DEEP PER FOOT (COUNTER DEPTH) - GROUP 1 - 4 (AT END OF CABINETS (SEE KITCHEN PLAN) <i>20May20</i> Note: 11,443/35300	
1 - APPLIANCE CABINETS - HOOD FAN - ACCOMMODATE FOR MICROWAVE/HOOD FAN COMBO (SUPPLY SPECS) INCLUDES ELECTRICAL DEDICATED LINE <i>20May20</i> Note: 11,443/35296	
1 - CABINETS - KITCHEN - LEVEL 2 <i>20May20</i> Note: 11,443/35293	

CABINETRY - VANITY

1 - VANITY CABINETS - DRAWERS - VANITY BANK OF DRAWERS (60CM TO 90CM WIDE) - GROUP 1 - 4 (MASTER ENSUITE) <i>20May20</i> Note: 11,443/35302	
---	--

STAIR AND RAILING

1 - STAIN STAIR AND RAILING PER FLOOR <i>20May20</i> Note: 11,443/35321	
1 - UPGRADE STANDARD STAIR TO ALL OAK IN NATURAL FINISH (WITH NATURAL STRIP LANDING) <i>20May20</i> Note: 11,443/35320	

TRIM DOORS AND HARDWARE - INTERIOR



CONSTRUCTION SUMMARY

Northglen (H) - 2174372 Ontario Ltd.

PURCHASERS: ERIK PETROVIC and SARA ELIZABETH VOISIN

TEL:

LOT / PHASE	REG. PLAN #	HOUSE TYPE	CLOSING DATE
Block 48 Unit 2 / 4	40M-2633	White Chestnut (T-2) Elev B2	26-Nov-20

TRIM DOORS AND HARDWARE - INTERIOR

1 - 2 PANEL SMOOTH DOORS THROUGHOUT (STD. HOLLOW CORE) 20May20 Note: 11,443/35327	
---	--

WINDOWS AND DOORS - EXTERIOR

2 - WINDOW - BASEMENT -ENLARGE STANDARD TO 36 INCH (W) X 24 INCH (H) - EACH ADDITIONAL 03Apr20 Note: 11,425/35096	
---	--

This Document is Extremely Time Sensitive - Printed 20 May 20 at 15:32