

HIGHCASTLE HOMES - COLOUR SCHEDULE

Purchasers:

ALISON,ELIZABETH MCCAUGHEY, & SCOTT WILLIAM .

Property: 21 Block DPhase: 1 of Plan -

Telephone Res. / Bus:

/

Project: 2174372 ONTARIO LTD.

Decor Advisor:

Caroline Rajcsanyi

Model and Elevation: The Clarke (T-1)

KITCHEN AND VANITIES

	Cabinet	Counter	Hardware
Kitchen	Lv1 - Hudson - Ontario White	Lv1 - GR-San Gabriel	Handle - 12881
Main Bathroom	Lv1 - Maitland 3DL - Café Noir	Calcutta Marble 4925K-07	Handle - 12881
Ensuite Bathroom	Lv1 - Maitland 3DL - Café Noir	Calcutta Marble 4925K-07	Handle - 12881
Opt. Breakfast Bar	Counter Height/Flush	Kitchen Hood Fan	Accommodate for over-range microwave
		Kitchen Upper Height	77 cm - Standard

Stove opening – if not specified will be set to builders standard opening of approximately 30 in width  
Fridge Opening – if not specified will be set to builders minimum opening of approximately 33 x71 height (townhouses)  
- if not specified will be set to builders minimum opening of approximately 36 x 71 height (singles)

Counter top Edge

Kitchen	Single Edge (3/4") Pencil	

Opt. Kitchen Extras

PARQUET / HARDWOOD OR BROADLOOM

Kitchen / Breakfast	N/A	Master Bedroom	Lv1 -TXP135 Lv1 - T04
Great Room	N/A	Bedroom 2	Lv1 -TXP135 Lv1 - T04
Living / Formal Room	*1-Lam-Concerto 1/2x5x48in,Caruso Maple, #54360031	Bedroom 3	Lv1 -TXP135 Lv1 - T04
Dining Room	*1-Lam-Concerto 1/2x5x48in,Caruso Maple, #54360031	Bedroom 4	N/A
Family Room	N/A		
Main Hall	N/A	Grnd Flr Stairs	Lv1 -TXP135 Lv1 - T04
Main Stairs	Lv1 -TXP135 Lv1 - T04	Grnd Flr Hall	*1-Lam-Concerto 1/2x5x48in,Caruso,Maple#54360031
Upper Hall	*1-Lam-Concerto 1/2x5x48in,Caruso Maple, #54360031		
Com. Centre/Home Office	N/A	Basement	N/A
Main Stair Landing	Lv1 -TXP135 Lv1 - T04	Basement Landing	N/A
Library/Den/Study	N/A	Basement Stairs	NA
In Law Suite	N/A		

Carpet Runner ☐ Yes ☒ No

Underpad Main Floor	Underpad 2nd Floor	Underpad Main Stairs
NA	Lv1 Underpad-standard	Lv1 Underpad-standard

Opt. Flooring Extras

FLOOR AND WALL TILES

	Floor Tile	Wall Tile	Decor	Listello
Front Foyer	1-13x13, Serpentine White			
Main Hall	NA			
Kitchen/Breakfast	1-13x13, Serpentine White	Kitchen Backsplash	N/A	<input type="checkbox"/>
Powder Room	1-13x13, Serpentine White	Pwdr Wall if Applicable	N/A	<input type="checkbox"/>
Laundry	1-13x13, Serpentine White			

	Floor	Tub Wall	Shower Wall	Deck Skirt	Deck Splash	Decor	Listello
Main Bathroom	1-13x13, Serpentine White	1-8x10, Weave, White	N/A	N/A	NA	<input type="checkbox"/>	<input type="checkbox"/>
Master Ens	1-13x13, Serpentine White	1-8x10, Serpentine White	N/A	N/A	NA	<input type="checkbox"/>	<input type="checkbox"/>
						<input type="checkbox"/>	<input type="checkbox"/>
						<input type="checkbox"/>	<input type="checkbox"/>
						<input type="checkbox"/>	<input type="checkbox"/>
						<input type="checkbox"/>	<input type="checkbox"/>

Shower - Upgrade Floor

Opt. Tile Extras

HIGHCASTLE HOMES - COLOUR SCHEDULE

Purchasers:	ALISON,ELIZABETH MCCAUGHEY, & SCOTT WILLIAM	Property:	21 Block DPhase: 1 of Plan -
Telephone Res. / Bus:	/	Project:	2174372 ONTARIO LTD.
Decor Advisor:	Caroline Rajcsanyi	Model and Elevation:	The Clarke (T-1)

PLUMBING / FAUCETS

Powder Room

Standard

Main Bath

Standard

Master Ensuite

Standard

2nd Ensuite

N/A

R.I. Bath

NA

Laundry

Standard

Kitchen Sink

\*Undermount

Kitchen Faucet

Upgrade

Drain for 2nd floor Laundry

☐ Yes
 ☒ No

Waterline for fridge

☒ Yes
 ☐ No

Supply and install all toilet paper holders, towel bars and soap dishes

☒ Yes
 ☐ No

Whirlpool

Opt. Plumbing Extras

PAINTING

Wall Colour

22 Warm Grey

Trim Colour

Standard

Railing Colour

\*Stained as Floor

Pickets Colour

\*Stained as Floor

Stair Colour

Carpet On Stair

Opt. Paint Extras

MISCELLANEOUS

Railing Style

RAILING - STANDARD - 1 5/16in oak picket, 2 1/2in oak handrail and 2 3/4in oak post.

Opt. Garage Door

\*Yes-Grade Permitting

Opt. Side Door

NA

Stair Type

Standard

Interior Doors

Standard - Classique

Int. Door Hardware

\*Straight Pewter Lever

Ext. Door Hardware

\*Pewter Exterior package

Trim Style

\*1 - 2 3/4in Case & 4in Baseboard

Basement Windows Upgrade

☐ Yes
 ☒ No

Cold Cellar

☐

Smooth Ceiling 1st Floor

☐ Yes
 ☒ No

Smooth Ceiling 2nd Floor

☐ Yes
 ☒ No

Supply and Install Standard Mirrors

☒ Yes
 ☐ No

Misc.

HEATING

Fireplace

Type

Mantle

Surround

Hearth

Air Conditioning

☒ \*Yes
 ☐ No

Hood Fan Duct

☒ 6 inch
 ☐ 8 inch
 ☐ 10 inch

Gas Provisions for Dryer

☐ Yes
 ☒ No

Gas Provisions for Stove

☐ Yes
 ☒ No

Gas Provisions for BBQ

☐ Yes
 ☒ No

Humidifier

☐ Yes
 ☒ No

Exterior Colour Scheme:
 Pre-selected By Vendor

NOTE: The Purchaser(s) agree(s) that:

a) Colours of materials are as close as possible to Vendor's selections, but not necessarily identical due to variances in manufacturing or manufacturers.

b) Purchaser(s) has checked and acknowledges accuracy of the above selections.Where omissions occur on the original colour selection sheet Purchaser(s) acknowledge that the Builder's selection will be final.

c) Upgrades or extras listed on this schedule will not be deemed part of the Agreement of Purchase and Sale. Any such upgrades or extras shall be null and void unless accompanied by a separate invoice and amendment. Said invoice must be paid in f

d) The Purchaser(s) further agrees that in the event that the Vendor has preselected colours prior to the purchase of the house, the prescribed colours are final not withstanding that the Purchaser may have completed a colour selection schedule

e) The Purchaser(s) Acknowledges that once this colour schedule is signed and dated, no changes, additions or deletions will be permitted other than re-selection due to unavailability.

A \$350 (Per item) administration fee will apply to the above exceptions (if the change is possible).

This Interior Colour Selection is final and approved by:

Signature:

Date: 18/03/21

Signature:

Date: 18/03/21

Builder's Agent:

Date: March 18, 2021

Printed 3/18/2021 12:42:50



<b>Highcastle Homes Décor Centre Disclaimers</b>	
Lot#: 21 Block D Model:The Clarke (T-1) in Orchards Enclave - 2174372 ONTARIO LTD.	
PURCHASERS: ALISON,ELIZABETH MCCAUGHEY, and SCOTT WILLIAM J DESROCHES // LINDA D MCCAUGHEY	TEL:

*Through years of doing business, we at Highcastle Homes have encountered issues beyond our control. The following disclaimers apply to all instances of Purchaser's Extras forms and all Interior Colour Scheme forms.*

**Fireplaces**

Fireplace Marble: Due to the many variables that can affect the pattern and/or design, frequently the marble installed on the fireplace will not be identical to the samples. We will make every attempt to come as close to the samples as possible, but cannot be responsible for results which differ from the samples.

**Ceramic Floor Tile**

Many variables including variegation can affect tile colour, pattern and/or design which mean installed tiles may not be identical to the samples. We will make every attempt to come as close as possible, but cannot be responsible for results which differ from the samples.

**Hardwood Flooring**

The purchaser is advised that cupping and shrinkage are characteristics of hardwood flooring normal appearing some time after installation, and no warranty is provided by the flooring supplier with respect to such cupping and shrinkage. The vendor agrees to install any hardwood flooring ordered by the purchaser in good and workmanlike manner, but shall not be responsible for, and is hereby released by the purchaser from responsibility and liability for cupping and shrinkage of hardwood flooring.

Shrinking and expanding/cupping of the hardwood floors may occur if the humidity levels in the home are not kept at industry recommendations. If the hardwood floors shrink or expand due to the homeowner not complying with these levels, the hardwood floor will no longer be under warranty and it will be the homeowner's responsibility to repair the flooring.

**Stain Colours**

Due to many variables that can affect the outcome of a stain colour on wood, staircases, railings, and fireplaces, will not be identical to samples. Factors such as density, age humidity, air temperature, and the uniqueness of each piece of wood can result in wide variations in darkness or lightness. We will make every attempt to come as close to the sample as possible, but cannot be responsible for results which differ from the samples.

Stain on pre-finished hardwood floors will not be an exact match to the stain colours available on stairs, pickets and rails. The purchaser is responsible for choosing the stain on these areas to their satisfaction.

**Appliances**

All fridge openings are set to builder's standard width. Please advise Décor Centre at time of colour appointment if custom sizing of cabinets is required for any built - in appliances. The purchaser is responsible for costs and fees associated with changes to pre-manufactured kitchens made subsequent to colour appointments.

**Kitchen Cabinets**

The kitchen you order/purchase will undoubtedly contain slight colour variations. The degree of these variations is virtually impossible to determine before the kitchen is installed in its intended location. The amount of and type of lighting will also affect various highlights in the finish. Note: No two pieces of wood are identical. Variations in colour tone and grain patterns make a perfect colour match virtually impossible. It is generally agreed that these variations add to the natural beauty of a wood kitchen.

Shrinking and expanding of the kitchen cabinets may occur if the humidity levels in the home are not kept at industry recommendations. If the cabinets shrink or expand due to the homeowner not complying with these levels, the cabinets will no longer be under warranty and it will be the homeowner's responsibility to repair the cabinets.

**Plaster Mouldings and Medallions**

Plaster mouldings will not be installed in open to above areas or areas with 2 storey elements.

**Metal Spindles**

Due to the characteristics of wrought iron railing production, it is possible for the wrought iron to develop a scale effect. This scale may or may not be totally covered during the painting process. In effect, once the wrought iron picket is painted, the paint may in effect amplify the iron scale depending on the colour chosen. This is a natural effect of wrought iron and should not be constued as a defect or damage.

I hereby acknowledge reading and understanding the above copy and will not hold Highcastle Homes responsible for any issues in relation to above.

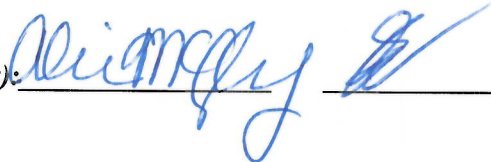
Purchasers Signature(s):  Date: 18/03/2021

Lot 21.  
Bik D.

# STONE EDGE PROFILES

Approx 2CM or  $\frac{3}{4}$ " Standard Edge

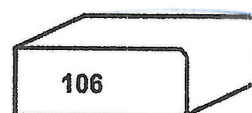
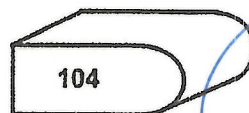
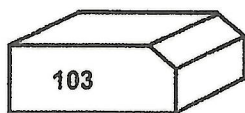
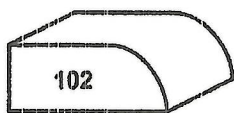

Kitchen  
 $\frac{3}{4}$ " Pencil

1<sup>st</sup> UPGRADE

Approx 4CM or 1.5" - SEAMS WILL BE VISIBLE

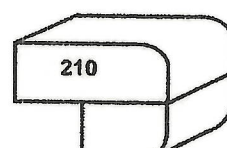
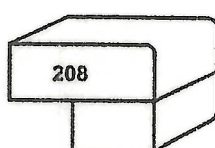
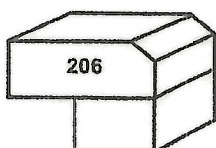
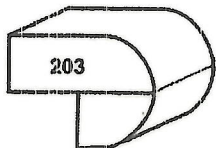

2<sup>nd</sup> UPGRADE

Approx 4CM or 1.5" - SEAMS WILL BE VISIBLE

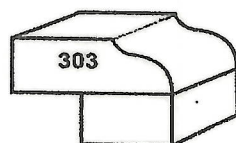

Sign Alin McElroy  
Sign

Date 18/03/21  
Date 18/03/21

LG REFRIGERATION

LFXS28566S

28 cu.ft. 3-Door Refrigerator w/ Door-in-Door®

- 27.7 cu.ft.
- Stainless Steel Finish
- Fingerprint & Smudge Resistant Finish
- Door-In-Door® with ColdSaver™ Panel
- Door Cooling+
- Slim SpacePlus® Ice System
- SpillProtector™ Tempered Glass Shelf / 1 Folding Shelf
- Smart Cooling Plus System
- 10 Year Limited Manufacturer's Warranty on Linear Compressor
- ENERGY STAR® Qualified



Enjoy new ways to control your home with LG smart appliances

- Get an alert when kids forget to close the door
- Make more ice while you're at work
- Works with LG SmartThinQ™ app, the Google Assistant and Amazon Alexa

CAPACITY	
Refrigerator (cu.ft.)	18.4
Freezer (cu.ft.)	9.3
Total (cu.ft.)	27.7
FEATURES	
Energy Consumption (kWh/Year)	724
ENERGY STAR® Qualified	Yes
SmartThinQ™ SMART FEATURES	
wi-fi Enable	Yes
Voice Activation	Yes
SmartDiagnosis™ System	Yes
Adjust Fresh Food/Freezer Temperatures	Yes
Turn IcePlus™ On/Off	Yes
Turn Fresh Air Filter On/Off	Yes
Door Open Smartphone Notifications	Yes
WATER & ICE SYSTEM	
Ice & Water Dispenser	Yes
Dispenser Type	Integrated
Daily Ice Production (lbs)	3.5
IcePlus™ Production (lbs)	3.8
Ice Storage Capacity (lbs)	2.5 + 4.0
Ice System	Slim SpacePlus®
Dispenser Light	Yes
Water Filter	LT1000P
COOLING	
Linear Compressor	Yes
Smart Cooling® System	Yes
Multi-Air Flow Cooling	Yes
Temperature Sensors	6
Fresh Air Filter	Yes
Evaporator	Yes
CONVENIENCE	
Display Type	Membrane / White LED
Temperature Controls	Electronic/Digital
Door Alarm	Yes
Child Lock	Yes
Auto Closing Door Hinge	Yes
LoDecibel™ Quiet Operation	Yes
REFRIGERATOR	
No. of Shelves	4 Split (3 Fixed+1Folding)
Folding Shelf	1
Cantilevered Shelves	Hybrid Cantilevered
Shelf Construction	Spill Protector™ Tempered Glass



Crisper Bins	2 Humidity Crispers
Glide N' Serve® Drawer	Yes
Refrigerator Light	Ceiling LED
REFRIGERATOR DOOR	
Door-In-Door® with ColdSaver™ Panel	Yes
No. of Bins	9 Total (Including Door-in-Door®)
Door Cooling+	Yes
Door Bin Construction	1 Piece (Clear)
FREEZER	
Door Type	Pull Drawer
Drawers	2-Tier Organization
DuraBase™ Solid Drawer Base	Yes
Drawer Divider	Yes
Freezer Light	LED Lighting
Freezer Handle	SmartPull™ Handle
MATERIALS AND FINISHES	
Fingerprint & Smudge Resistant Finish	Yes
Contour Door	Yes
Hidden Hinges	Yes
Surface	Smooth
Back	Flush & Metal Cover Over Mechanical Parts
Handles	Matching Commercial Handles
All Available Colors	Stainless Steel, Black Stainless Steel, Matte Black Stainless Steel
DIMENSIONS/CLEARANCES/WEIGHTS	
Depth with Handles	36 1/4"
Depth without Handles	33 3/4"
Depth without Door	29 7/8"
Depth (Total with Door Open)	48 1/4"
Height to Top of Case	68 3/8"
Height to Top of Door Hinge	69 3/4"
Width	35 3/4"
Width (Door Open 90° with Handle)	44 1/4"
Width (Door Open 90° without Handle)	39 1/4"
Top to Bottom Clearance	Top 1", Back 2"
Weight (Unit/Carton)	316 lbs. / 341 lbs.
Carton Dimensions (WxHxD)	38" x 73" x 39"
LIMITED WARRANTY	
Parts & Labor	1 Year
Sealed System	7 Years
Linear Compressor	10 Years
UPC CODES	
LFXS28566S Stainless Steel	048231794848

LREL6321S

6.3 cu. ft. Electric Smart Range with EasyClean®



Lot 21  
BIK D.

ThinQ® & Proactive Customer Care

6.3 cu.ft Large Capacity

Two 9" Dual Elements

EasyClean®

Tinted Window

AVAILABLE COLORS



STAINLESS STEEL

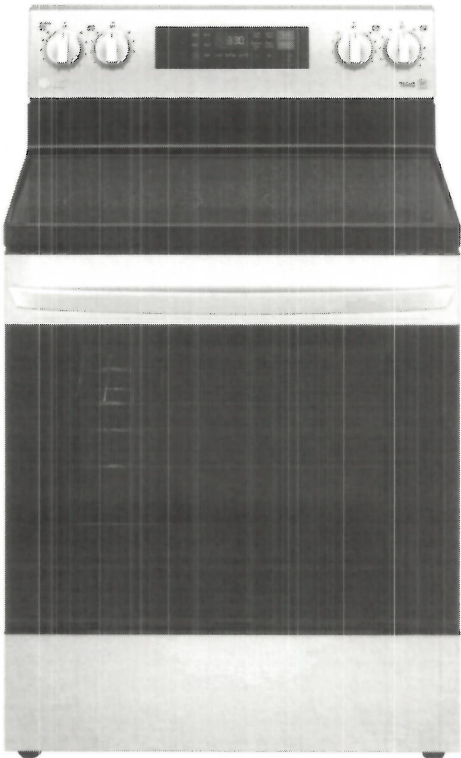

Enjoy new ways to control your home with LG smart appliances

LG ThinQ®

- Install Setup Quick Check
- Preventative Alerts & Guidance
- Performance & Usage Reports



works with the  
Google Assistant



WORKS WITH  
alexa

CAPACITY

Oven Capacity (cu. ft.)	6.3 cu.ft.
Storage Drawer Capacity (cu.ft.)	0.8 (No Handle)
<b>COOKTOP</b>	
Type	Radiant
No. of Radiant Elements	5
Element Size/Wattage - Left Rear	1200 (6")
Element Size/Wattage - Right Rear	1200 (6")
Element Size/Wattage - Left Front	3200 (9") / 1400 (6") (Ultra-Heat™)
Element Size/Wattage - Right Front	3200 (9") / 1400 (6") (Ultra-Heat™)
Center (Warming Zone)	100 (7")
Hot Surface LED Indicator	Yes

OVEN FEATURES

Broil Element (Watt)	Sheath 4200 / 6 Pass
Oven Bake Element Wattage	3400
Oven Modes	Bake, Broil, Easy Clean, Keep Warm
Oven Control Features	Keypad
EasyClean®	Yes (10 min)
Oven Light	1 Light
No. of Rack Positions	7
Door Lock	Yes
Automatic Safety Shut-Down	After 12 Hours

DRAWER FEATURES

Type	Storage
------	---------

CONTROL

Cooktop Control Type	Front Control Knobs
Oven Control Type	Keypad
Display	White LED
Language	English
Clock	12 hr or 24 hr (option)
Kitchen Timer	Yes
Timed Cook	Yes
Temperature Unit of Measure	Fahrenheit / Celsius
Cooking Complete Reminder Volume	Beeper (Hi, Lo, Off)
Certified Sabbath mode	Yes

APPEARANCE

All Available Colors	Stainless Steel
Knobs	Stainless Steel
Handle	Stainless Steel
Oven Door Feature	WideView™ Window (Smog Glass)
Cooktop Trim	Black Porcelain

SMART FEATURES

Wi-Fi Connectivity	Yes
ThinQ®	Yes
Works with	Google Assistant & Amazon Alexa
SmartDiagnosis™	Yes
3rd Party Recipe App	Sidechef, Innit, Drop, Tovaia
Proactive Customer Care Service	Yes

DIMENSIONS/CLEARANCES/WEIGHTS

Shipping Weight (lbs)	198
Product Weight (lbs)	164
Cabinet Width (in)	30"
Overall Depth (in) - including handle	28 15/16"
Overall Height (in)	47 5/16"
Overall Width (in)	29 7/8"
Oven Interior Dimensions (in) (W x H x D)	24 7/8" x 21 3/8" x 20"
Height to Cooking Surface (in)	36"
Drawer Dimensions (in) (W x H x D)	22 3/16" x 4 1/2" x 16 3/8"
Carton Dimensions (in) (W x H x D)	31 1/2" x 51" x 30 11/32"

POWER/RATINGS

Amp Rating at 208V	48.6A
Amp Rating at 240V	56.3A
KW Rating at 208V	10.1kW
KW Rating at 240V	13.5kW
Required Power Supply (amp)	40A

ACCESSORIES

Standard Rack	2
Spray Bottle	Yes
Scouring Pad	Yes

LIMITED WARRANTY

Parts & Labor	1 Year
---------------	--------

UPC CODES

LREL6321S (Stainless Steel)	048231341417
-----------------------------	--------------

AM SD Mar. 18. 2021

Specifications

Brand	LG
Capacity	48.14 L (1.7 cu. ft.)
Colour	Stainless Steel
Dimensions - Depth	38.43 cm (15.13 in.)
Dimensions - Height	41.76 cm (16.44 in.)
Dimensions - Width	75.9 cm (29.88 in.)
Microwave Type	Over the Range
Model	LMV1751ST
Vent Power (CFM)	300 CFM
Vent Speeds	2
Weight	22 kg (48.5 lb.)

Feedback

Manuals & Guides

 Product Manual

Warranty & Services

- ✓ 2nd Year Warranty
  - ✓ Free Technical Support
  - ✓ 90 Day Return Policy
- [Learn About Costco Concierge Services](#)

Shipping & Returns

Standard shipping via UPS is included in the quoted price. **The estimated delivery time will be approximately 2 - 7 business days from the time of order.**  
**For more information regarding UPS delivery, click here.**

**This item is subject to some delivery restrictions. Please proceed to checkout to verify if delivery is available to your postal code.**

SHOP CONFIDENTLY

We are committed to offering the best value to our members, with a risk-free 100% satisfaction guarantee on both your membership and merchandise. If you have questions about your membership or products you've purchased at Costco, please visit the membership counter at your local Costco or

LG DISHWASHERS

LDP6797ST/WW/BB

Top Control Dishwasher with QuadWash™

15 Place Settings

QuadWash™

10-Year Warranty on Inverter Direct Drive Motor

SmartThinQ™ Technology with Wi-Fi

EasyRack™ Plus

Glide Rail

Height Adjustable 3rd Rack

LoDecibel™ Quiet Operation (44 dBA)

Dual Zone

ENERGY STAR® Qualified



SmartThinQ™

Enjoy new ways to control your home with LG smart appliances

- Get notifications when dishes are clean
- Monitor the cycle time from your smartphone
- Works with the LG SmartThinQ™ app, the Google Assistant and Amazon Alexa

CAPACITY	
Total Place Settings	15
Upper Rack Dish Height Limit	7.1"
Lower Rack Dish Height Limit	12.5"
RACKS AND BASKETS	
Cutlery Baskets	Yes
Cup Rack	Yes
Stemware Holder	Yes
Fold-Down Tines	Yes (Half Fold on Upper & Lower)
BPA-Free Nylon Coated Racks and Tines	Yes
Rack Handle	Yes (Upper/Lower)
Glide Rail	Yes (Upper)
EasyRack™ Plus System	Yes
Height Adjustable Upper Rack	Yes (One Touch, 3 Level)
Height-Adjustable 3rd Rack	Yes
STYLE AND DESIGN	
Control Panel Location	Top
Electronic Controls	Hidden SmoothTouch™ Controls with LED Display
Signalight™ Cycle Indicator Lights	3
Time Remaining Indicator	Yes (LED)
Tub Material	NeveRust™ Stainless Steel
Tub Light	No
Handle	Flush
All Available Colors	Matte Black Stainless Steel, Black Stainless Steel, Stainless Steel, Black, White
FEATURES	
TrueSteam®	No
QuadWash®	Yes
Inverter Direct Drive Motor	Yes
LoDecibel™ Quiet Operation	44 dB
Number of Wash Cycles	9 (Auto, Heavy, Delicate, Normal, Turbo, Download Cycle, Machine Clean, Rinse, Express)
Number of Options	8 (Dual Zone, Half Load, Energy Saver, High Temp, Extra Dry, Delay Start, Control Lock, Night Dry)
Number of Spray Arms	3 (Top, Upper, Lower)
SenseClean™ Wash System	Yes
VarioWash	Yes
Detergent and Rinse Aid Dispenser	Yes
Hybrid Condensing Drying System	Yes
End of Cycle Indicator	Yes (Beeper + END indication on display)
Hidden Water Heater	Yes



Lot 21  
BIK D.

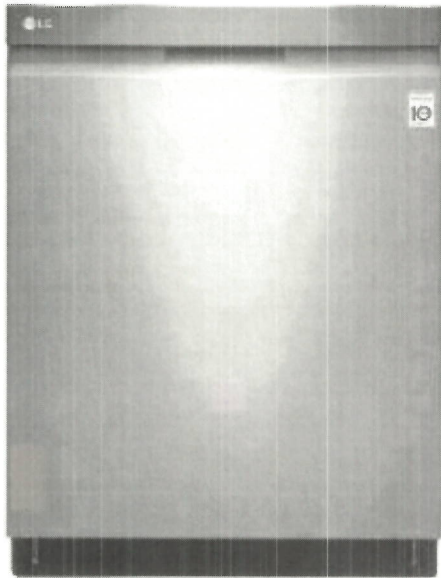

Safety Float Switch (Leaks)	Yes
Soil (Turbidity) Sensor	Yes
Tub Insulation (Damping Sheet)	Yes
Sound Absorbing Material (felt) Base	Yes
BPA-Free Nylon Coated Racks and Tines	Yes
Anti-Bacterial Treatment (Sump, Inner / Outer filter, Drain pump case, Drain hose)	Yes
Balanced Door	Yes
Multi-Level (S) Water Direction	Yes (Top Nozzle (Down), Upper Nozzle (Up/Down), Lower Nozzle (Up/Down))
3-Stage Filtration System	Yes
SmartThinQ™ SMART FEATURES	
Wi-Fi Enabled	Yes
NFC Tag On	No
SmartDiagnosis™ System	Yes
POWER RATINGS	
ENERGY STAR® Qualified	Yes
CEE Tier	1
Energy Use (kWh/Year)	258 kWh
Water Factor (WF)	2.8
DIMENSIONS / CLEARANCES / WEIGHT	
Product Dimensions (in) (W x H x D)	23.75" x 33.6" x 24.6"
Product Weight (lbs)	81.6 lbs
Depth with Door Closed with Handle (in)	27 1/8"
Depth with Door Open (in)	50.5"
Clearances (W x H x D)	24" x 33.5" x 24"
Carton Dimensions (in) (W x H x D)	28" x 34.7" x 29.6"
Shipping Weight with Carton (lbs)	94.8 lbs
LIMITED WARRANTY	
Labor	1 Year
Parts	1 Year
Control Board and Rack Parts	5 Years
Direct Drive Motor	10 Years
Stainless Steel Door Liner or Tub	Lifetime
UPC CODES	
LDP6797ST Stainless Steel	04823 022156
LDP6797WW White	04823 022170
LDP6797BB Black	04823 022163

SD Am March 21 / 2021

WM3500CW  
4.5 cu. ft. Front Load Washer

- 4.5 Cu.Ft. Capacity
- 10 Wash Programs
- 6Motion™ Technology
- Inverter Direct Drive Motor with 10-Year Warranty
- TWINWash™ Compatibility
- SmartThinQ® (Wi-Fi Enabled)
- SmartDiagnosis™
- ColdWash™ Option
- ENERGY STAR® Most Efficient 2019
- NeverRust™ Stainless Steel Drum
- Available in White (W)



Enjoy new ways to control your home with LG smart appliances

- Start the laundry while you're out shopping
- Get alerts when the cycle is finished
- Works with the LG SmartThinQ® app

SmartThinQ® works with the Google Assistant

WORKS WITH alexa

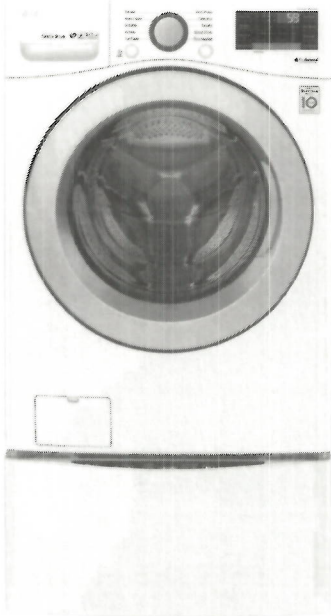

Lot 21  
Bik D

SUMMARY	
Capacity (cu.ft.)	4.5 cu. ft.
Matching Electric Dryer	DLE3500W
Matching Gas Dryer	DLG3501W
Color	White (W)
APPEARANCE	
Hard Buttons	Yes
Touch Buttons	Yes
Dial-A-Cycle™	Yes
ENERGY	
ENERGY STAR® Most Efficient 2019	Yes
ENERGY STAR® Qualified	Yes
CEE Tier	2
IMEF	2.92
IWF	2.9
WASH PROGRAMS	
No. of Programs	10
	Normal, Perm. Press, Heavy Duty, Delicates, Towels, Speed Wash, Bedding, Tub Clean, Whites, Downloaded
WASH OPTIONS	
No. of Options	10
	Fresh Care, Prewash, Remote Start, Delay Wash, wi-fi, Add Garments, ColdWash, Extra Rinse, Rinse+Spin, Child Lock
WASH DETAILS	
No. of Wash/Rinse Temps	3
Wash/Rinse Temps	Hot, Warm, Cold
No. of Spin Speeds	3
Spin Speeds	High, Medium, Low
Max RPM	1300
Water Levels	Load Sensing
No. of Soil Levels	3

FABRIC CARE FEATURES	
ColdWash™ Option	Yes
SenseClean™ System	Yes
CONVENIENCE FEATURES	
TrueBalance™ Anti-Vibration System	Yes
4 Tray Dispenser	Prewash, Main Wash (with liquid detergent cup), Bleach, Fabric Softener
LoDecibel™ Quiet Operation	Yes
End of Cycle Signal	Yes
LoadSense	Yes
Child Lock	Yes
Auto Suds Removal	Yes
Leveling Legs	4 Adjustable Legs
Easy Loading Tilt™	Yes
SMARTTHINQ® TECHNOLOGY	
SmartDiagnosis™ (v3.0)	Yes
Wi-Fi	Yes
Cycle Monitoring and Notification	Yes
Energy Monitoring	Yes
MOTOR	
Motor Type	Inverter Direct Drive Motor
Axis	Horizontal
MATERIALS AND FINISHES	
NeverRust™ Stainless Steel Drum	Yes
Cabinet	PCM
Control Panel	Plastic
Top Plate	Painted
Door / Rim	Glass/Silver Spray
Door Cover	Clear Round Cover
All Available Colors	White (W)

POWER SOURCE	
Ratings	UL Listed
Electrical Requirements	120V, 10 Amps
Type	Electric
OPTIONS/ACCESSORIES	
Pedestal	WDP4W
Pedestal (WxHxD)	27 x 14 1/8 x 30 3/4 (50 9/16 D with door open)
LG Sidekick™ Pedestal Washer	WD100CW
LG Sidekick™ Pedestal Washer (WxHxD)	27 x 14 1/8 x 30 3/4 (50 9/16 D with door open)
Stacking Kit	KSTK1
DIMENSIONS	
Product (WxHxD)	27" x 39" x 30 1/4"
Depth with Door Open	(55" D with door open)
Carton (WxHxD)	29 23/32" x 41 27/32" x 31 17/32"
Weight (Product/Carton)	169.2 / 218.2 lbs.
LIMITED WARRANTY	
Parts and Labor	1 Year
Direct Drive Motor	10 Years
Drum	Limited Lifetime
UPC CODES	
WM3500CW (Washer White)	048231024990
DLE3500W (Electric Dryer White)	048231024983
DLG3501W (Gas Dryer White)	048231025003
WD100CW (LG SideKick™ White)	048231015172

SD AM March 18 / 2021

DLE3500W/DLG3501W

7.4 cu. ft. Front Load Dryer

- 7.4 cu. ft. Capacity
- 10 Dryer Programs
- Sensor Dry
- ENERGY STAR® Qualified
- SmartThinQ® Technology
- Wi-Fi Connectivity
- SmartDiagnosis™



SmartThinQ®

Enjoy new ways to control your home with LG smart appliances

- Start the laundry while you're out shopping
- Get alerts when the cycle is finished
- Works with the LG SmartThinQ® app



works with the Google Assistant



works with alexa

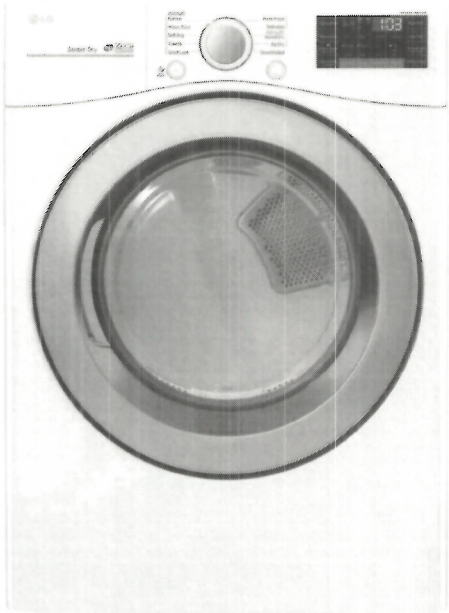

Lot 21  
BIK D

 **LG**  
Life's Good

SUMMARY		CONVENIENCE FEATURES		POWER SOURCE	
Capacity	7.4 cu. ft.	3 Minute Installation Check	Yes	Ratings	CSA Listed
Matching Washer	WM3500CW	LoDecibel™ Quiet Operation	Yes	Electrical Requirements	Gas: 120V, 15 Amps Electric: 240V 30 Amps
Sensor Dry	Yes	End of Cycle Signal	Yes	Type	Electric (DLE3500W) Gas (DLG3501W)
Colors	White (W)	Reversible Door	Yes	BTU Rating	10,000 Feet
APPEARANCE		FlowSense™ Duct Clogging Indicator	Yes	OPTIONS/ACCESSORIES	
Intelligent Electronic Controls with I.F.D. Display	Yes	Wrinkle Care Option	Yes	LP Conversion Kit	383EEL3002D
Dial-A-Cycle™	Yes	Child Lock	Yes	Side Venting Kit	383EEL9001B
Touch Buttons	Yes	Venting Option	Gas: 3 Way Venting Electric: 4 Way Venting	Pedestal	WDP4W
DRYER PROGRAMS		4 Adjustable Legs	Yes	Pedestal (WxHxD)	27 x 14 1/8 x 30 3/4 (50 1/2 D with door open)
No. of Programs	10	Remaining Time Display/Status Indicator(s)	Yes	DIMENSIONS	
	Normal, Heavy Duty, Bedding, Towels, Small Load, Perm Press, Delicates, Speed Dry (Manual Dry), Air Dry (Manual Dry), Downloaded	SMARTTHINQ® TECHNOLOGY		Product (WxHxD)	27" x 38 11/16" x 30"
DRYER OPTIONS		SmartDiagnosis™	Yes	Depth with Door Open	51"
No. of Options	11	Wi-Fi	Yes	Carton (WxHxD)	29 19/32" x 43 3/8" x 31 3/8"
	More Time, Less Time, Damp Dry Signal, Wrinkle Care, Control Lock, Custom Program, PGM Save, Wi-Fi Connect, Anti-Bacterial, Energy Saver, Remote Start	Remote Control	Yes	Weight (Product)	Gas: 124.7 Electric: 122
Temperature Settings	High, Medium, Ultra Low	Cycle Monitoring and Notification	Yes	Weight Carton	Gas: 137.9 Electric: 135.2
Drying Levels	Very Dry, Normal Dry, Damp Dry	Energy Monitoring	Yes (Wi-Fi)	WARRANTY	
Manual Dry Times	60 min., 40 min., 20 min., More Time/Less Time	ENERGY		Parts and Labor	1 Year
		ENERGY STAR® Qualified	Yes	UPC CODES	
FABRIC CARE FEATURES		MATERIALS AND FINISHES		DLE3500W (Electric Dryer White)	048231024983
Sensor Dry	Yes	Aluminized Alloy Steel Drum	Yes	DLG3501W (Gas Dryer White)	048231025003
Precise Temperature Control with Variable Heater	Yes	Tub Rear	Painted	WM3500CW (Washer White)	048231024990
		Cabinet	Painted Steel	WDP4W (Pedestal White)	048231011211
		Door	Round w/ silver painted trim		
		All Available Colors	White (W)		

SD AM March 18/2021

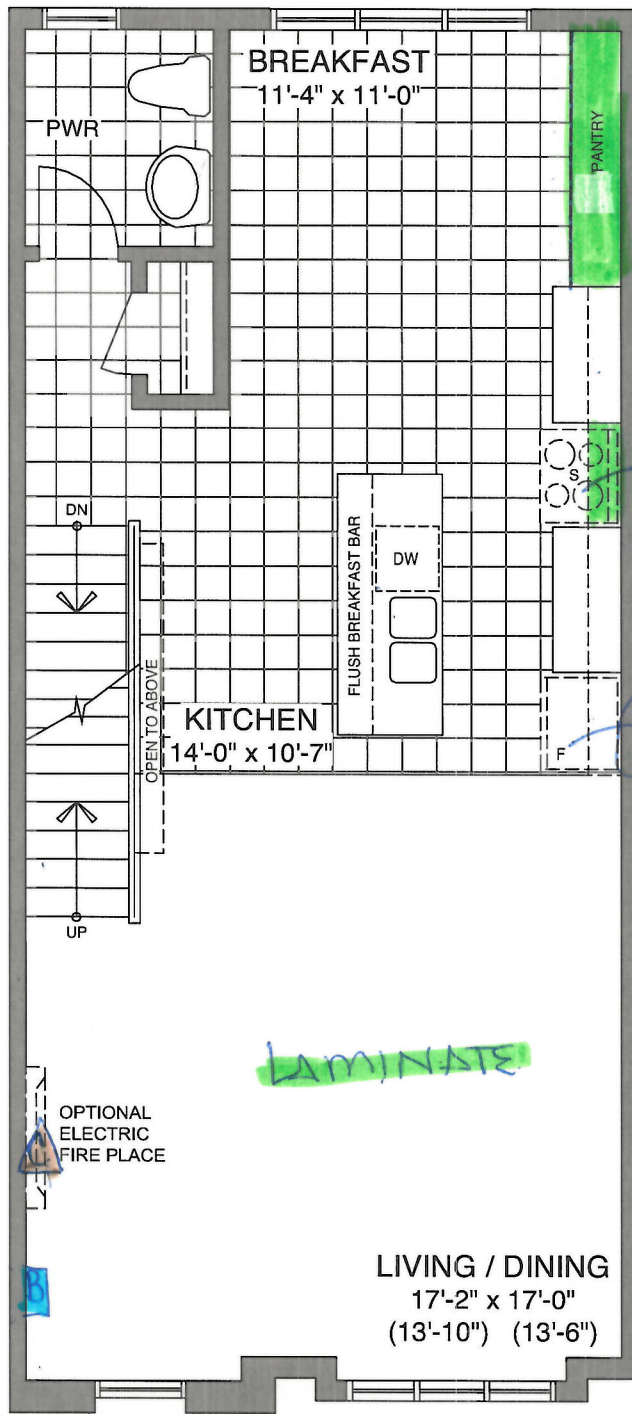

Lot 21  
Bik D.

 Bell  
 Cable

over the range  
microwave

waterline for fridge

LAMINATE

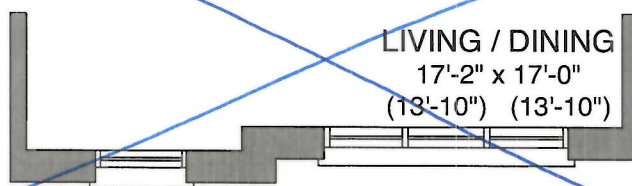

MAIN FLOOR - ELEV A1 & A4

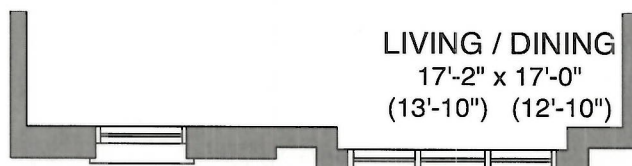

MAIN FLOOR - ELEV A2

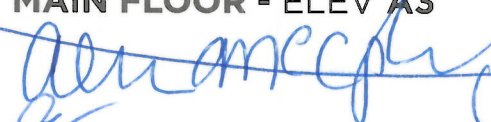

MAIN FLOOR - ELEV A3

Sign  Date 18/03/21  
Sign  Date 18/03/21

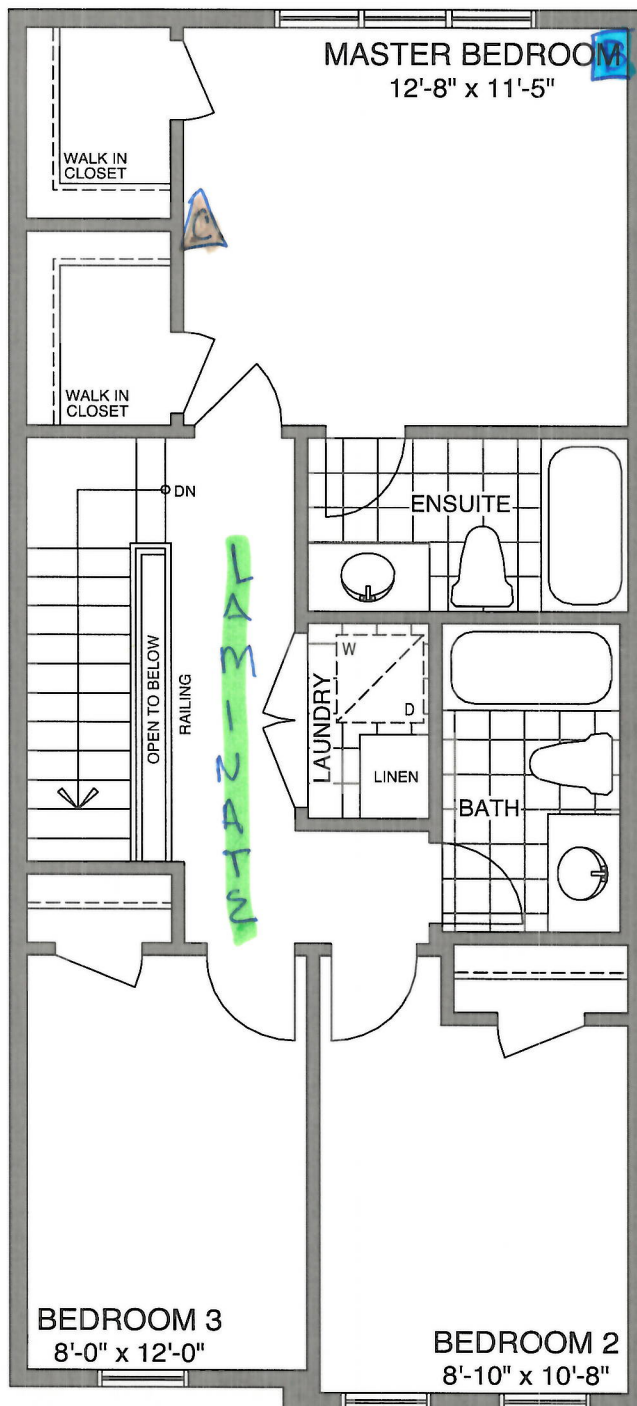

Lot 21  
B/K D.  
B Bell  
C Cable

THIRD FLOOR - ELEV A1 & A4

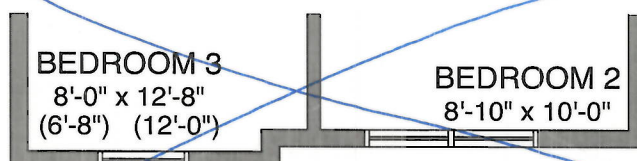

THIRD FLOOR - ELEV A2

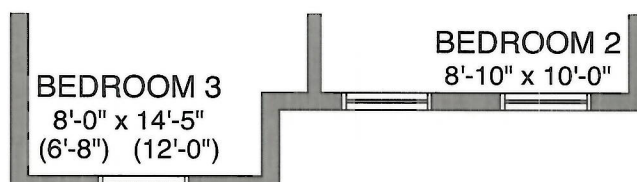

THIRD FLOOR - ELEV A3

Sign *[Signature]* Date 18/03/21  
Sign *[Signature]* Date 18/03/21

Lot 21  
Bik D.

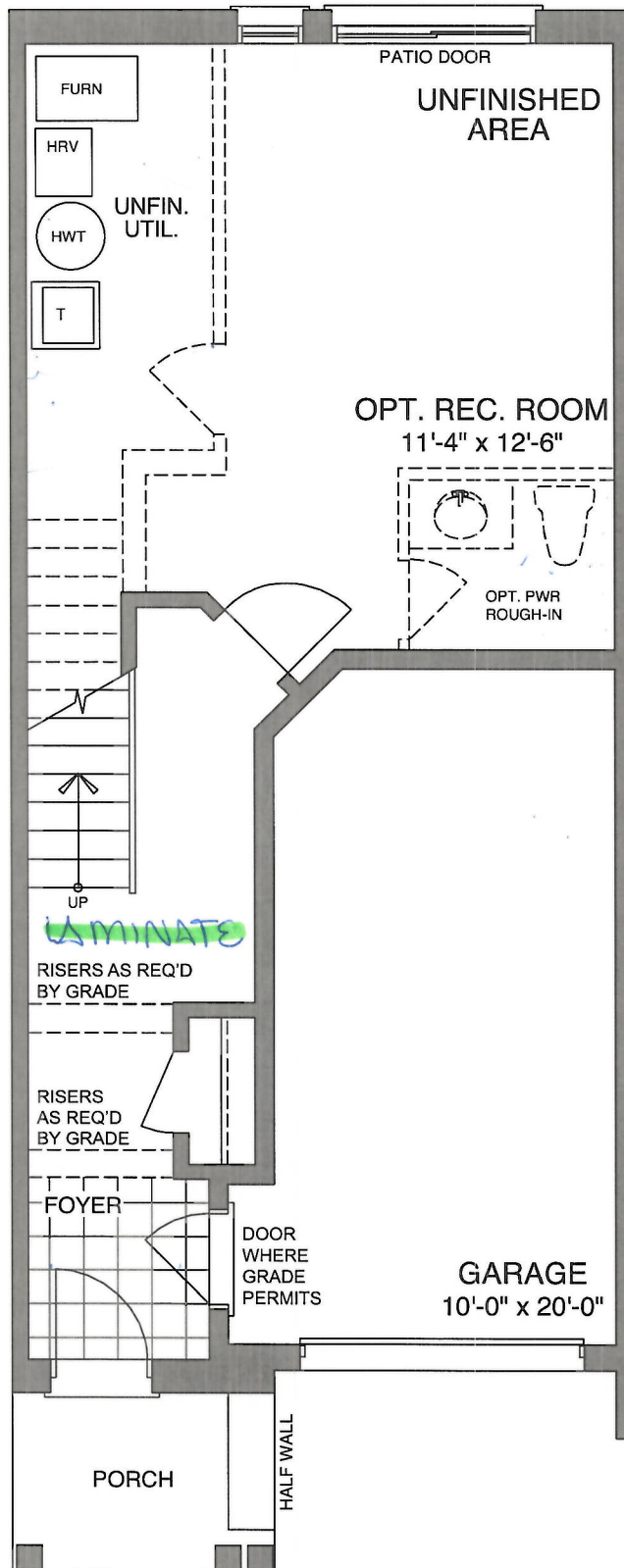

GROUND FLOOR - ELEV A1, A2 & A4

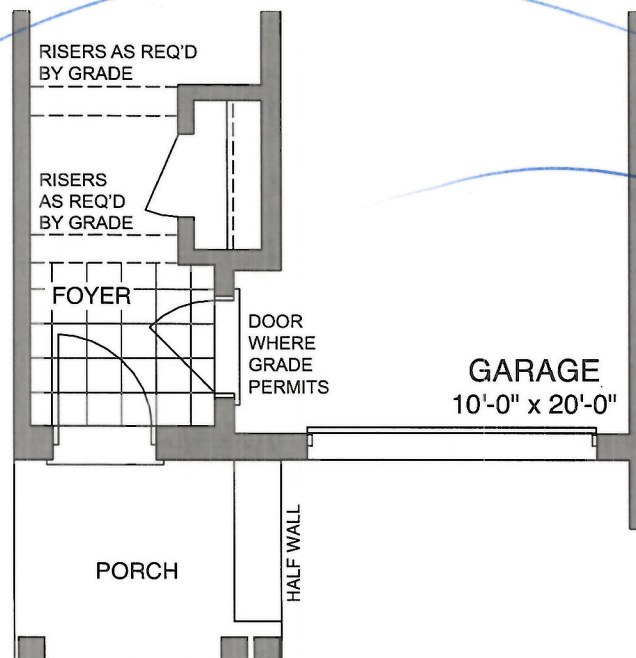

GROUND FLOOR - ELEV A3

Sign *[Signature]* Date 18/03/21  
Seal *[Signature]* Date 18/03/21



CONSTRUCTION SUMMARY				
Orchards Enclave - 2174372 ONTARIO LTD.				
PURCHASERS: ALISON,ELIZABETH MCCAUGHEY, and SCOTT WILLIAM J DESROCHES // LINDA D MCCAUGHEY				TEL:
LOT / PHASE 21 Block D / 1	REG. PLAN #	HOUSE TYPE The Clarke (T-1)		CLOSING DATE 07-Dec-21

Agreement of Purchase and Sale

Central air conditioner (builders standard line) <i>Worksheet</i> Note:	
Laminate Flooring in leiu of carpet on main floor, as per plan, from builders standard samples. <i>Worksheet</i> Note:	
Granite kitchen countertops, (as per plan-from builders standard samples). <i>Worksheet</i> Note:	

4) PLUMBING

1 - KITCHEN - ALIGN 7565 CHROME, 1 HOLE APPLICATION <i>18Mar21</i> Note: 11,567/37193	
1 - SINK - KITCHEN - UNDERMOUNTED (RECTANGULAR SQUARE - DOUBLE EQUAL BOWL) <i>18Mar21</i> Note: 11,567/37192	
1 - WATER LINE - FRIDGE - ROUGH IN ONLY <i>18Mar21</i> Note: 11,567/37191	

6) FLOORING & WALL TILE

1 - LAMINATE FLOORING - LEVEL 1 - UPGRADE FROM CARPET - UPPER HALL (UPGRADE FROM CARPET) - <i>18Mar21</i> Note: 11,567/37202	
--	--

9) CABINETRY

1 - APPLIANCE CABINETS - HOOD FAN - ACCOMMODATE FOR MICROWAVE/HOOD FAN COMBO (SUPPLY SPECS) INCLUDES ELECTRICAL DEDICATED LINE <i>18Mar21</i> Note: 11,567/37185	
1 - CABINETS - KITCHEN - OPT PANTRY - LEVEL 1 <i>18Mar21</i> Note: 11,567/37183	

STAIR AND RAILING

1 - STAIN HANDRAIL AND PICKETS AND STRINGERS ONLY <i>18Mar21</i> Note: 11,567/37205	
---	--

TRIM DOORS AND HARDWARE - INTERIOR

1 - DOOR HANDLE - UPGRADE TO PEWTER STRAIGHT LEVERS <i>18Mar21</i> Note: 11,567/37199	
---	--

This Document is Extremely Time Sensitive - Printed 18 Mar 21 at 12:42