

HIGHCASTLE HOMES - COLOUR SCHEDULE

Purchasers:ODIONG,IME ENEH & CAROL ODIONG ENEH

Property: 48 Block HPhase: 1 of Plan -

Telephone Res. / Bus: /

Project: 2174372 ONTARIO LTD.

Decor Advisor:Caroline Rajcsanyi

Model and Elevation: The Victoria END (TB-3)

KITCHEN AND VANITIES

	Cabinet	Counter	Hardware
Kitchen	Lv1 - Camden Oak - Shale Grey CL	Lv1 - GR-San Gabriel	12881
Main Bathroom	Lv1 - Camden Oak - Poppyseed	Argento Romano 6697-46	12881
Ensuite Bathroom	Lv1 - Hudson - Ontario White	Calcutta Marble 4925K-07	12881
Rec Room 2 Pc Bathroom	Lv1 - Camden Oak - Poppyseed	Argento Romano 6697-46	12881
Opt. Breakfast Bar	Counter Height/Flush	Kitchen Hood Fan	Accommodate for over-range microwave
		Kitchen Upper Height	77 cm - Standard

Stove opening – if not specified will be set to builders standard opening of approximately 30 in width
Fridge Opening – if not specified will be set to builders minimum opening of approximately 33 x71 height (townhouses)
- if not specified will be set to builders minimum opening of approximately 36 x 71 height (singles)

Counter top Edge

Kitchen	Single Edge (3/4") Top Bevelled	

Opt. Kitchen Extras

PARQUET / HARDWOOD OR BROADLOOM

Kitchen / Breakfast	N/A	Master Bedroom	Lv1 -TXP135 Lv1 - T15
Great Room	N/A	Bedroom 2	Lv1 -TXP135 Lv1 - T15
Living / Formal Room	*1-Lam,Concerto,1/2x5x48",Tenor Oak, #54360205	Bedroom 3	Lv1 -TXP135 Lv1 - T15
Dining Room	*1-Lam,Concerto,1/2x5x48",Tenor Oak, #54360205	Bedroom 4	N/A
Family Room	N/A	Gnd Flr Stairs	Lv1 -TXP135 Lv1 - T15
Main Hall	*1-Lam,Concerto,1/2x5x48",Tenor Oak, #54360205	GndFlrLanding	Lv1 -TXP135 Lv1 - T15
Main Stairs	Lv1 -TXP135 Lv1 - T15	Rec Rm	*1-Lam,Concerto,1/2x5x48",Tenor Oak, #54360205
Upper Hall	Lv1 -TXP135 Lv1 - T15	Grn Flr Hall	*1-Lam,Concerto,1/2x5x48",Tenor Oak, #54360205
Com. Centre/Home Office	N/A	Basement	N/A
Main Stair Landing	N/A	Basement Landing	N/A
Library/Den/Study	N/A	Basement Stairs	NA
In Law Suite	N/A		

Carpet Runner ☐ Yes ☒ No

Underpad Main Floor	Underpad 2nd Floor	Underpad Main Stairs
NA	Lv1 Underpad-standard	Lv1 Underpad-standard

Opt. Flooring Extras

FLOOR AND WALL TILES

	Floor Tile	Wall Tile	Decor	Listello
Front Foyer	1-13x13, Serpentine White			
Main Hall	NA			
Kitchen/Breakfast	1-13x13, Serpentine White	Kitchen Backsplash	N/A	<input type="checkbox"/>
Powder Room	1-13x13, Serpentine White	Pwdr Wall if Applicable	N/A	<input type="checkbox"/>
Laundry	1-13x13, Serpentine White			

	Floor	Tub Wall	Shower Wall	Deck Skirt	Deck Splash	Decor	Listello
Main Bathroom	1-13x13, Serpentine White	1-8x10, Serpentine White	N/A	N/A	NA	<input type="checkbox"/>	<input type="checkbox"/>
Master Ens	1-13x13, Serpentine Grey	1-8x10, Serpentine Grey	N/A	N/A	NA	<input type="checkbox"/>	<input type="checkbox"/>
Rec Rm 2pc	1-13x13, Serpentine White	N/A	N/A	N/A	NA	<input type="checkbox"/>	<input type="checkbox"/>
RecRmFoyer	1-13x13, Serpentine White					<input type="checkbox"/>	<input type="checkbox"/>
						<input type="checkbox"/>	<input type="checkbox"/>
						<input type="checkbox"/>	<input type="checkbox"/>

Shower - Upgrade Floor

Opt. Tile Extras

HIGHCASTLE HOMES - COLOUR SCHEDULE

Purchasers:
Telephone Res. / Bus:
Decor Advisor:

ODIONG,IME ENEH & CAROL ODIONG ENEH
/
Caroline Rajcsanyi

Property: 48 Block HPhase: 1 of Plan -
Project: 2174372 ONTARIO LTD.
Model and Elevation: The Victoria END (TB-3)

PLUMBING / FAUCETS

Powder Room
Main Bath
Master Ensuite
2nd Ensuite
R.I. Bath

Standard
Standard
Standard
N/A
****FINISHED 2 PC IN REC ROOM****

Laundry
Rec Room 2 pc bathroom

Standard
Standard

Kitchen Sink
Kitchen Faucet

*Undermount
Upgrade

Drain for 2nd floor Laundry
Waterline for fridge

☐ Yes
☒ Yes

☒ No
☐ No

Supply and install all toilet paper holders, towel bars and soap dishes

☒ Yes
☐ No

Whirlpool

Opt. Plumbing Extras

PAINTING

Wall Colour

Trim Colour

Railing Colour

Pickets Colour

Stair Colour

22 Warm Grey

Standard

*Stained as Floor

*Wrought Iron

Carpet On Stair

Opt. Paint Extras

MISCELLANEOUS

Railing Style

RAILING - UPGRADE 1 - 1/2in Wrought iron BLACK square picket with square collar on alternating picket, 3in oak handrail and 3 1/2in oak std. post.

Opt. Garage Door

*Yes-Grade Permitting

Opt. Side Door

NA

Stair Type

Standard

Interior Doors

Standard - Classique

Int. Door Hardware

*Pewter Knob

Ext. Door Hardware

*Pewter Exterior package

Trim Style

*1 - 2 3/4in Case & 4in Baseboard

Cold Cellar

☐

Smooth Ceiling 1st Floor

☐ Yes
☒ No

Smooth Ceiling 2nd Floor

☐ Yes
☒ No

Supply and Install Standard Mirrors

☒ Yes
☐ No

Misc.

HEATING

Fireplace

Type

Mantle

Surround

Hearth

Air Conditioning

☒ *Yes
☐ No

Gas Provisions for BBQ

☐ Yes
☒ No

Hood Fan Duct

☒ 6 inch
☐ 8 inch
☐ 10 inch

Humidifier

☐ Yes
☒ No

Gas Provisions for Dryer

☐ Yes
☒ No

Gas Provisions for Stove

☐ Yes
☒ No

Exterior Colour Scheme: Pre-selected By Vendor

NOTE: The Purchaser(s) agree(s) that:

a) Colours of materials are as close as possible to Vendor's selections, but not necessarily identical due to variances in manufacturing or manufacturers.

b) Purchaser(s) has checked and acknowledges accuracy of the above selections.Where omissions occur on the original colour selection sheet Purchaser(s) acknowledge that the Builder's selection will be final.

c) Upgrades or extras listed on this schedule will not be deemed part of the Agreement of Purchase and Sale. Any such upgrades or extras shall be null and void unless accompanied by a separate invoice and amendment. Said invoice must be paid in f

d) The Purchaser(s) further agrees that in the event that the Vendor has preselected colours prior to the purchase of the house, the prescribed colours are final notwithstanding that the Purchaser may have completed a colour selection schedule

e) The Purchaser(s) Acknowledges that once this colour schedule is signed and dated, no changes, additions or deletions will be permitted other than re-selection due to unavailability.

A \$350 (Per item) administration fee will apply to the above exceptions (if the change is possible).

This Interior Colour Selection is final and approved by:

Signature:  Date: 31/5/2021

Signature:  Date: 31/05/2021

Printed 5/31/2021 12:26:04

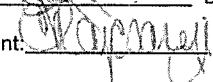
Builder's Agent:  Date: 31/05/2021



Highcastle Homes Décor Centre Disclaimers

Lot#: 48 Block H Model:The Victoria END (TB-3) in Orchards Enclave - 2174372 ONTARIO LTD.

PURCHASERS: ODIONG,IME ENEH and CAROL ODIONG ENEH

TEL:

Through years of doing business, we at Highcastle Homes have encountered issues beyond our control. The following disclaimers apply to all instances of Purchaser's Extras forms and all Interior Colour Scheme forms.

Fireplaces

Fireplace Marble: Due to the many variables that can affect the pattern and/or design, frequently the marble installed on the fireplace will not be identical to the samples. We will make every attempt to come as close to the samples as possible, but cannot be responsible for results which differ from the samples.

Ceramic Floor Tile

Many variables including variegation can affect tile colour, pattern and/or design which mean installed tiles may not be identical to the samples. We will make every attempt to come as close as possible, but cannot be responsible for results which differ from the samples.

Hardwood Flooring

The purchaser is advised that cupping and shrinkage are characteristics of hardwood flooring normal appearing some time after installation, and no warranty is provided by the flooring supplier with respect to such cupping and shrinkage. The vendor agrees to install any hardwood flooring ordered by the purchaser in good and workmanlike manner, but shall not be responsible for, and is hereby released by the purchaser from responsibility and liability for cupping and shrinkage of hardwood flooring.

Shrinking and expanding/cupping of the hardwood floors may occur if the humidity levels in the home are not kept at industry recommendations. If the hardwood floors shrink or expand due to the homeowner not complying with these levels, the hardwood floor will no longer be under warranty and it will be the homeowner's responsibility to repair the flooring.

Stain Colours

Due to many variables that can affect the outcome of a stain colour on wood, staircases, railings, and fireplaces, will not be identical to samples. Factors such as density, age humidity, air temperature, and the uniqueness of each piece of wood can result in wide variations in darkness or lightness. We will make every attempt to come as close to the sample as possible, but cannot be responsible for results which differ from the samples.

Stain on pre-finished hardwood floors will not be an exact match to the stain colours available on stairs, pickets and rails. The purchaser is responsible for choosing the stain on these areas to their satisfaction.

Appliances

All fridge openings are set to builder's standard width. Please advise Décor Centre at time of colour appointment if custom sizing of cabinets is required for any built - in appliances. The purchaser is responsible for costs and fees associated with changes to pre-manufactured kitchens made subsequent to colour appointments.

Kitchen Cabinets

The kitchen you order/purchase will undoubtedly contain slight colour variations. The degree of these variations is virtually impossible to determine before the kitchen is installed in its intended location. The amount of and type of lighting will also affect various highlights in the finish. Note: No two pieces of wood are identical. Variations in colour tone and grain patterns make a perfect colour match virtually impossible. It is generally agreed that these variations add to the natural beauty of a wood kitchen.

Shrinking and expanding of the kitchen cabinets may occur if the humidity levels in the home are not kept at industry recommendations. If the cabinets shrink or expand due to the homeowner not complying with these levels, the cabinets will no longer be under warranty and it will be the homeowner's responsibility to repair the cabinets.

Plaster Mouldings and Medallions



Plaster mouldings will not be installed in open to above areas or areas with 2 storey elements.

Metal Spindles

Due to the characteristics of wrought iron railing production, it is possible for the wrought iron to develop a scale effect. This scale may or may not be totally covered during the painting process. In effect, once the wrought iron picket is painted, the paint may in effect amplify the iron scale depending on the colour chosen. This is a natural effect of wrought iron and should not be constued as a defect or damage.

I hereby acknowledge reading and understanding the above copy and will not hold Highcastle Homes responsible for any issues in relation to above.

Purchasers Signature(s):



Date: 31/05/21

LOT 48, BIK H
Orchards
Enclave

STONE EDGE PROFILES

Approx 2CM or $\frac{3}{4}$ " Standard Edge

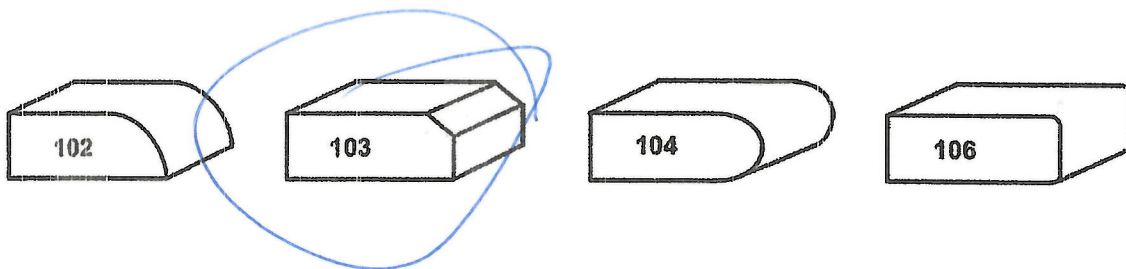

1st UPGRADE

Approx 4CM or 1.5" - SEAMS WILL BE VISIBLE

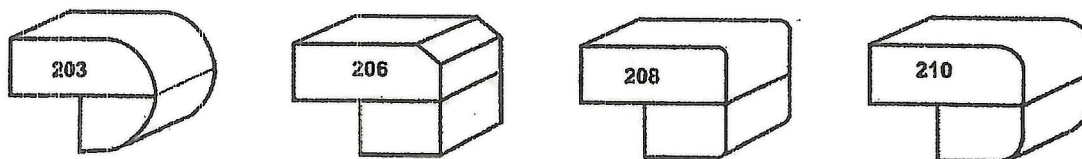

2nd UPGRADE

Approx 4CM or 1.5" - SEAMS WILL BE VISIBLE

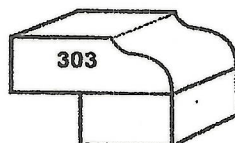

Sign 
Sign

Date
Date

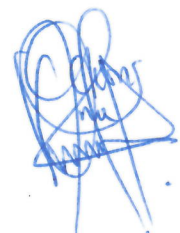

31/05/2021

Lot 48, BLK H
Orchards Enclave.

ifications
nsions

mbled Depth (in s)	18.0625	Assembled Height (in inches)	17.0625
mbled Weight (in lb)	59.1	Assembled Width (in inches)	29.875
aged Depth (in inches)	19.41	Packaged Height (in inches)	46.5
aged Weight (In lb)	69.4	Packaged Width (in inches)	29.5

Is

ance Type	Microwave	Colour Family	Stainless Steel
try of Origin	MY-Malaysia	Cubic Feet/Minute (CFM)	400
ures - Defrost	Yes	Features - Fingerprint Resistanant	Yes
wave Capacity (l.)	2.1	Microwave Features	Fingerprint Resistar Defrost
wave Size (in.)	30	Room Type	Kitchen
or Cook	Yes	Smart Technology	No
ch Colour	Stainless Steel	Vent Type	Convertible
age	1500 watts		

anty / Certifications

(1) Year All Parts and Labour Five (5) Years Parts on Magnetron



My Store: **Hamilton Mountain** | **Open** • Closes 8 p.m. ▾
Curbside Pick-Up & Garden Centre Shopping Only

- Rental
- Credit Services
- For the Pro
- Order Status
- Customer Support
- Gift Cards
- Français

Q

Account / Sign In ▾ Cart

- Shop by Department ▾
- Shop by Room
- Ideas & How-to
- Home Services
- Warehouse Value & Specials
- Weekly Flyer

Due to extremely high order volumes some store pick-up orders may be delayed. Please wait for your “ready for pick-up” email before proceeding to store. [Learn More](#)



Frigidaire Gallery 30-inch 5.4 cu. ft. Freestanding Induction Range with Air Fry in Smudge-Proof® Black Stainless Steel

Model # GCRI305CAD | Store SKU # 1001542823

★★★★☆ (343)

[Write a Review](#)

[Q&A \(1\)](#)

\$1,495.00 / each

Delivery Charges Apply

Choose Your Options

Colour/Finish: **Black Stainless Steel**

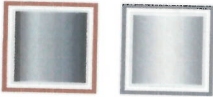

APPLIANCE DELIVERY

Earliest Delivery Date: **June 04, 2021** ?

Estimated Shipping Cost for [L8J0B4](#): **\$59.98**

Add To Cart



C.O.E

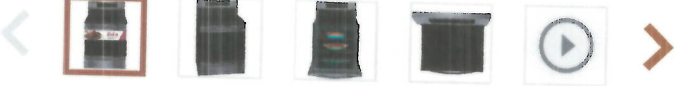

Dimensions:

Shipping Weight (lbs): 31 lbs

Weight (Product): 26 lbs.

Depth: 17"

Height: 12 3/23"

Width: 21 2/5"

Cavity (WxHxD): 15.43" x 10.31" x 15.98"

Carton Dimensions (in) (W x H x D): 23.94" x 13.03" x 18.78"

Exterior (WxHxD): 21.41" x 12.13" x 17"



Lot 48, B1KH.

My Store: **Hamilton Mountain** | **Open** • Closes 8 p.m.
Curbside Pick-Up & Garden Centre Shopping Only

- Rental
- Credit Services
- For the Pro
- Order Status
- Customer Support
- Gift Cards
- Français

Account / Sign In Cart

- Shop by Department
- Shop by Room
- Ideas & How-to
- Home Services
- Warehouse Value & Specials
- Weekly Flyer

Due to extremely high order volumes some store pick-up orders may be delayed. Please wait for your “ready for pick-up” email before proceeding to store. [Learn More](#)



Frigidaire Gallery 36-inch W 26.8 cu. ft. French Door Refrigerator in Black Stainless Steel - ENERGY STAR®

Model # FGHB2868TD | Store SKU # 1001090730

★★★★★ (2806)

[Write a Review](#)

[Q&A \(0\)](#)

\$2,395.00 / each



Delivery Charges Apply

Choose Your Options

Colour/Finish: **Black Stainless Steel**

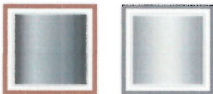

APPLIANCE DELIVERY

Enter your postal code for availability and earliest delivery date:

A1A 1A1

Submit

C.O.E



Specifications

Dimensions

Assembled Depth (in inches)	29.87	Assembled Height (in inches)	69.75
Assembled Weight (in lbs)	357	Assembled Width (in inches)	35.75
Packaged Depth (in inches)	38	Packaged Height (in inches)	73
Packaged Weight (In lbs)	382	Packaged Width (in inches)	38

Details

Adjustable Door Bins	2	Appliance Type	Refrigerator
Built-In	No	Cantilever Shelves	Yes
Capacity (cu. ft.)	28	Colour Family	Black Stainless Steel
Counter or Standard Depth	Standard Depth	Country of Origin	CA-Canada
Dairy Centre	Yes	Defrost Type	Automatic
Deli Drawer	Yes	Depth Excluding Handles (in.)	32
Dispenser Controls	Electronic	Door Finish	Contoured
ENERGY STAR®	No	Freezer Door Type	Pull
General Features	Fingerprint Resistant	Height to Top of Door Hinge (In.)	69.7
Height to Top of Refrigerator (in.)	68.375	Humidity Controlled Crispers	2
Ice Maker Type	Single Ice Maker	Ice/Water Dispenser	Water and Ice Dispenser
Labour	1 year	Matching Water Filter	LT1000P
Number of Doors	3	Number of Shelves	4

We're here to get you what you need.

Shop online for pickup or delivery, or visit a store for a safe shopping and service experience. [Learn more >](#)

Lot 48, BIK H

StoresCart

Search Best Buy



[Home](#) > [Appliances](#) > [Major Appliances](#) > [Dishwashers](#) > [Built-In Dishwashers](#) > [Product Details](#)

Bosch Ascenta 24" 50 dB Dishwasher with Stainless Steel Tub (SHE3AR76UC) - Black

Model Number: SHE3AR76UC Web Code: 10409093

★★★★★ 4.5 (2117 Reviews)

[Write your review >](#)



1 of 8

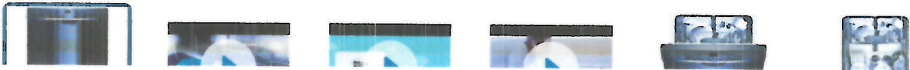

C.D.E

Type	24 in Dishwasher
Colour	Black
Colour Family	Black
Interior Finish	Stainless Steel; Polypropylene Bottom
Handle Type	Recessed
Silence Rating	50 dB

Racking

Adjustable Upper Rack	No
Third Rack	No

Cycles and Options

Number of Wash Cycles	6
Rinse and Hold	No
Sanitization Option	Yes
Wi-Fi Connectivity	No
ENERGY STAR Qualified	Yes

Dimensions

Width (Inches)	23.2 in
----------------	---------

Depth (Inches)

22.4 in

Width

58.93 cm

Height

86.11 cm

Depth

57 cm

Weight

43 kg

Lot 48, BIK H.
Archards Enclave

Cable
Receptacle

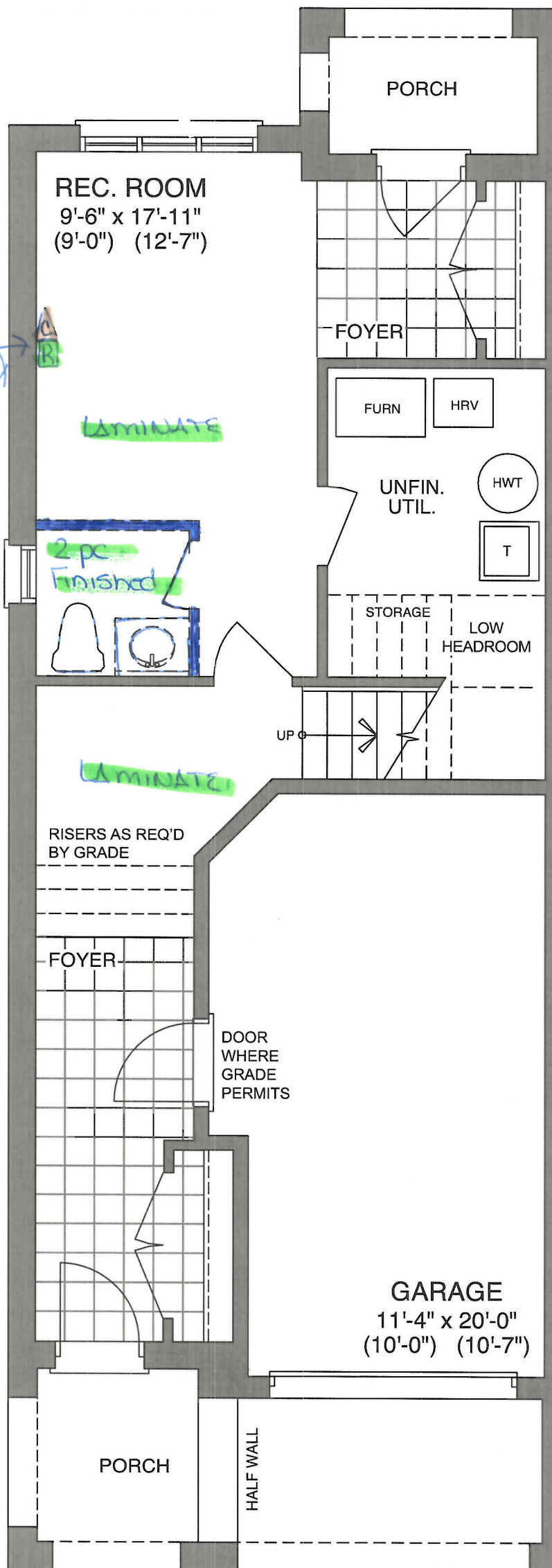

GROUND FLOOR - ELEV A END UNIT ~~35~~ & 48

Signature
Signature

Date 31/5/2021
Date 31/05/2021

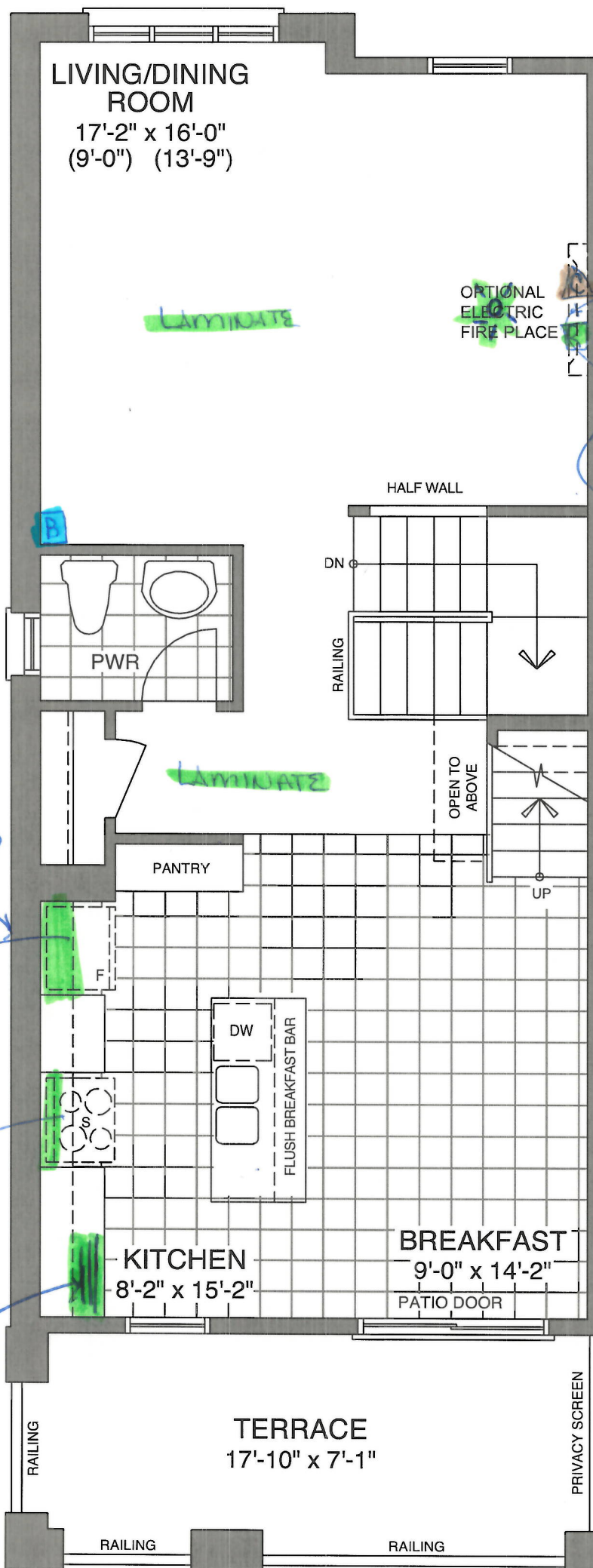

Lot 48, BLKH
Orchards Enclave

B Bell
C Cable
R Receptacle

5 1/2 ft for
future wall
mount tv.
light rli on
separate switch

Waterline for
fridge

Deep fridge
upper to 2
cabinets

Over the
range micro

Pots and
pans

MAIN FLOOR - ELEV A END UNIT ~~35~~ & 48

Signature
Sign

Date 31/5/2021
Date 31/5/2021

Lot 48, BLKH
Orchards Enclave

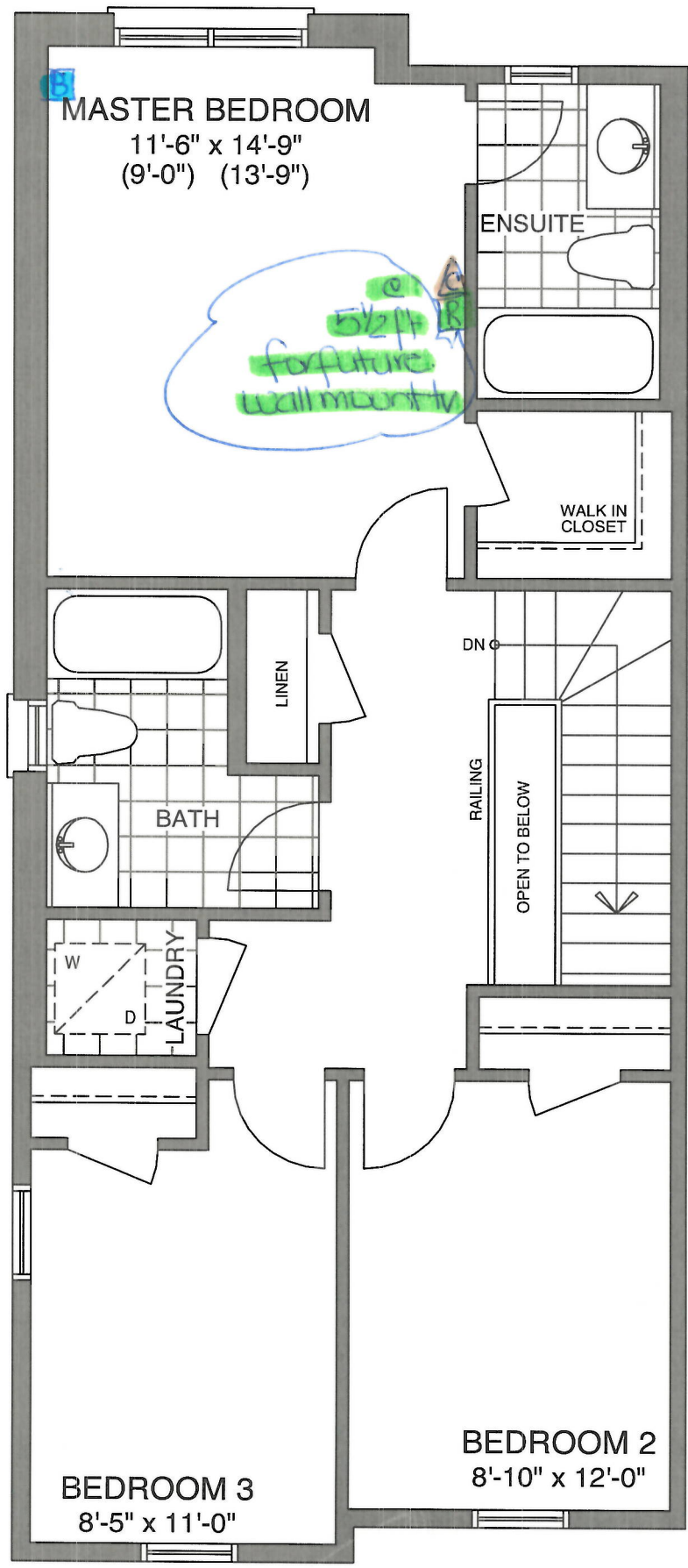

- B Bell
- △ Cable
- B Receptacle

THIRD FLOOR - ELEV A END UNIT ~~35~~ & 48

Sign [Signature]
Sign [Signature]

Date 31/05/2021
Date 31/05/2021



CONSTRUCTION SUMMARY				
Orchards Enclave - 2174372 ONTARIO LTD.				
PURCHASERS: ODIONG,IME ENEH and CAROL ODIONG ENEH				TEL:
LOT / PHASE 48 Block H / 1	REG. PLAN #	HOUSE TYPE The Victoria END (TB-3)		CLOSING DATE 22-Mar-22

Agreement of Purchase and Sale

Central air conditioner (builders standard line) <i>Worksheet</i> Note:	
Laminate Flooring in leiu of carpet on main floor, as per plan, from builders standard samples. <i>Worksheet</i> Note:	
Granite kitchen countertops, (as per plan-from builders standard samples). <i>Worksheet</i> Note:	
Optional Powder Room In Rec Room, as per plan, from builder standard samples <i>Worksheet</i> Note:	



CONSTRUCTION SUMMARY				
Orchards Enclave - 2174372 ONTARIO LTD.				
PURCHASERS: ODIONG,IME ENEH and CAROL ODIONG ENEH				TEL:
LOT / PHASE 48 Block H / 1	REG. PLAN #	HOUSE TYPE The Victoria END (TB-3)		CLOSING DATE 22-Mar-22

4) PLUMBING

1 - KITCHEN - ALIGN 7565 CHROME, 1 HOLE APPLICATION 31May21 Note: 11,611/37826	
1 - WATER LINE - FRIDGE - ROUGH IN ONLY 31May21 Note: 11,611/37825	
1 - SINK - KITCHEN - UNDERMOUNTED (RECTANGULAR SQUARE - DOUBLE EQUAL BOWL) 31May21 Note: 11,611/37824	

5) ELECTRICAL

1 - LIGHT - ROUGH-IN ONLY - ON SEPARATE SINGLE SWITCH - LIVING ROOM (SEE PLAN) 31May21 Note: 11,611/37818	
1 - PLUG - INTERIOR RECEPTICAL (NOT DEDICATED) - REC ROOM - BESIDE CABLE AT 5 1/2 FT FOR FUTURE WALL MOUNT TV 31May21 Note: 11,611/37812	
1 - CABLE JACK - ADDITIONAL - ROUGH-IN - REC ROOM - BESIDE RECEPTACLE AT 5 1/2 FT FOR FUTURE WALL MOUNT TV 31May21 Note: 11,611/37811	
1 - PLUG - INTERIOR RECEPTICAL (NOT DEDICATED) - MASTER BEDROOM BESIDE CABLE AT 5 1/2 FT FOR FUTURE WALL MOUNT TV 31May21 Note: 11,611/37810	
1 - PLUG - INTERIOR RECEPTICAL (NOT DEDICATED) - LIVING ROOM BESIDE CABLE AT 5 1/2 FT FOR FUTURE WALL MOUNT TV 31May21 Note: 11,611/37809	

8) FINISHING

1 - RAILING - 1/2 INCH WROUGHT IRON BLACK SQUARE PICKET WITH SINGLE SQUARE COLLAR ON ALTERNATING PICKET, 3 INCH OAK HANDRAIL AND 3 1/2 INCH OAK STANDARD POST 31May21 Note: 11,611/37828	
--	--

9) CABINETRY

1 - BASE CABINETS - DRAWERS - POTS AND PANS DRAWERS (WIDTH MIN. 60CM/MAX. 90 CM) (SIZE SUBJECT TO FLOOR PLAN) - GROUP 1 - 4 (BESIDE BANK OF DRAWERS - SEE PLAN) 31May21 Note: 11,611/37815	
1 - APPLIANCE CABINETS - HOOD FAN - ACCOMMODATE FOR MICROWAVE/HOOD FAN COMBO (SUPPLY SPECS) INCLUDES ELECTRICAL DEDICATED LINE 31May21 Note: 11,611/37814	
1 - APPLIANCE CABINETS - FRIDGE - 66CM DEEP FRIDGE ENCLOSURE (COUNTER DEPTH) WITH NO WALLS ([2] 66CM DEEP GABLES AND [1] 66CM DEEP CABINET) (THIS IS NOT A ZERO CLEARANCE ENCLOSURE. STANDARD HEIGHTS AND WIDTHS WILL BE USED.) 31May21 Note: 11,611/37813	

STAIR AND RAILING

1 - STAIN HANDRAIL AND STRINGERS ONLY 31May21 Note: 11,611/37830	
--	--