

HIGHCASTLE HOMES - COLOUR SCHEDULE

Purchasers:	HANAN OSMAN & BASSAM YAACOUB	Property:	3 Block APhase: 1 of Plan -
Telephone Res. / Bus:	/	Project:	2174372 ONTARIO LTD.
Decor Advisor:	Caroline Rajcsanyi	Model and Elevation:	The Clarke (T-1) Alt Main Floor Opt Rec Room

KITCHEN AND VANITIES	Cabinet	Counter	Hardware
Kitchen	Lv1 - Hudson - Ontario White	Lv1 - GR-San Gabriel	12881 Handle
Main Bathroom	Lv1 - Maitland 3DL - Café Noir	Calcutta Marble 4925K-07	12881 Handle
Ensuite Bathroom	Lv1 - Maitland 3DL - Café Noir	Calcutta Marble 4925K-07	12881 Handle
Powder Room #2 (Grnd Flr)	Lv1 - Maitland 3DL - Café Noir	Calcutta Marble 4925K-07	12881 Handle

Opt. Breakfast Bar	Counter Height/Flush	Kitchen Hood Fan	Standard
		Kitchen Upper Height	100 cm

Stove opening – if not specified will be set to builders standard opening of approximately 30 in width
Fridge Opening -- if not specified will be set to builders minimum opening of approximately 33 x71 height (townhouses)
- if not specified will be set to builders minimum opening of approximately 36 x 71 height (singles)

Counter top Edge	
Kitchen	Single Edge (3/4") Top Bevelled

Opt. Kitchen
Extras

PARQUET / HARDWOOD OR BROADLOOM			
Kitchen / Breakfast	N/A	Master Bedroom	Lvl 2 -Laminate -Concerto,Romance Oak, #54360615
Great Room	N/A	Bedroom 2	Lvl 2 -Laminate -Concerto,Romance Oak, #54360615
Living / Formal Room	Lvl 2 - Laminate - Concerto, Romance Oak, #54360615	Bedroom 3	Lvl 2 -Laminate -Concerto,Romance Oak, #54360615
Dining Room	Lvl 2 - Laminate - Concerto, Romance Oak, #54360615	Bedroom 4	N/A
Family Room	N/A		N/A
Main Hall	Lvl 2 - Laminate - Concerto, Romance Oak, #54360615	Ground fl stairs	Oak
Main Stairs	Oak	Rec room	Lvl 2 -Laminate -Concerto,Romance Oak, #54360615
Upper Hall	Lvl 2 - Laminate - Concerto, Romance Oak, #54360615		
Com. Centre/Home Office	N/A	Basement	N/A
Main Stair Landing	Lvl 2 - Laminate - Concerto, Romance Oak, #54360615	Basement Landing	N/A
Library/Den/Study	N/A	Basement Stairs	NA
In Law Suite	N/A		

Carpet Runner ☐ Yes ☒ No

Underpad Main Floor	Underpad 2nd Floor	Underpad Main Stairs
NA	NA	NA

Opt. Flooring Extras

FLOOR AND WALL TILES	Floor Tile	Wall Tile
Front Foyer	3 - 12 x 24, Biel Bianco (white)	
Main Hall	N/A	
Kitchen/Breakfast	3 - 12 x 24, Biel Bianco (white)	Kitchen Backsplash N/A
Powder Room	3 - 12 x 24, Biel Bianco (white)	Pwdr Wall if Applicable N/A
Laundry	1-13x13, Serpentine White	

	Floor	Tub Wall	Shower Wall	Deck Skirt	Deck Splash	Decor	Listello
Main Bathroom	1-13x13, Serpentine White	1-8x10, Serpentine White	N/A	N/A	NA	<input type="checkbox"/>	<input type="checkbox"/>
Master Ens	1-13x13, Serpentine White	1-8x10, Serpentine White	N/A	N/A	NA	<input type="checkbox"/>	<input type="checkbox"/>
Pwdr rm 2	1-13x13, Serpentine White	N/A	N/A	N/A	NA	<input type="checkbox"/>	<input type="checkbox"/>
						<input type="checkbox"/>	<input type="checkbox"/>
						<input type="checkbox"/>	<input type="checkbox"/>

Shower - Upgrade Floor

Opt. Tile Extras

HIGHCASTLE HOMES - COLOUR SCHEDULE

Purchasers:	HANAN OSMAN & BASSAM YAACOUB	Property:	3 Block APhase: 1 of Plan -
Telephone Res. / Bus:	/	Project:	2174372 ONTARIO LTD.
Decor Advisor:	Caroline Rajcsanyi	Model and Elevation:	The Clarke (T-1) Alt Main Floor Opt Rec Room

PLUMBING / FAUCETS

Powder Room	Standard	Laundry	Standard
Main Bath	Standard		
Master Ensuite	Standard		
2nd Ensuite	NA		
R.I. Bath	2 pc finished in Rec room		
Kitchen Sink	*Undermount		
Kitchen Faucet	Upgrade		
Drain for 2nd floor Laundry	<input type="radio"/> Yes <input checked="" type="radio"/> No		
Waterline for fridge	<input type="radio"/> Yes <input checked="" type="radio"/> No		
Supply and install all toilet paper holders, towel bars and soap dishes	<input checked="" type="radio"/> Yes <input type="radio"/> No		
Whirlpool			

Opt. Plumbing Extras

PAINTING

Wall Colour	Trim Colour	Railing Colour	Pickets Colour	Stair Colour
22 Warm Grey	Standard	*Stained as Floor	*Wrought Iron	*Stained as Floor
Opt. Paint Extras				

MISCELLANEOUS

Railing Style	RAILING - UPGRADE 1 - 1/2in Wrought iron square picket with square collar on alternating picket, 3in oak handrail and 3 1/2in oak std. post.			
Opt. Garage Door	*Yes-Grade Permitting	Opt. Side Door	No	Stair Type
Interior Doors	*1Carrara Smooth 2	Int. Door Hardware	*Straight Pewter Lever	*Oak
		Trim Style	*1 - 2 3/4in Case & 4in Baseboard	Ext. Door Hardware
				*Pewter Exterior package
Smooth Ceiling 1st Floor	<input checked="" type="radio"/> Yes <input type="radio"/> No		Basement Windows Upgrade	Cold Cellar <input type="checkbox"/>
Smooth Ceiling 2nd Floor	<input checked="" type="radio"/> Yes <input type="radio"/> No		<input type="radio"/> Yes <input checked="" type="radio"/> No	
Supply and Install Standard Mirrors	<input checked="" type="radio"/> Yes <input type="radio"/> No			
Misc.				
***SMOOTH CEILING - ALL FLOORS ***				

HEATING

Fireplace	Type	Mantle	Surround	Hearth
Air Conditioning	<input checked="" type="radio"/> *Yes <input type="radio"/> No		Gas Provisions for BBQ	<input type="radio"/> Yes <input checked="" type="radio"/> No
Hood Fan Duct	<input checked="" type="radio"/> 6 inch <input type="radio"/> 8 inch <input type="radio"/> 10 inch		Humidifier	<input type="radio"/> Yes <input checked="" type="radio"/> No
Gas Provisions for Dryer	<input type="radio"/> Yes <input checked="" type="radio"/> No			
Gas Provisions for Stove	<input type="radio"/> Yes <input checked="" type="radio"/> No			

Exterior Colour Scheme: Pre-selected By Vendor

NOTE: The Purchaser(s) agree(s) that:	
a) Colours of materials are as close as possible to Vendor's selections, but not necessarily identical due to variances in manufacturing or manufacturers.	
b) Purchaser(s) has checked and acknowledges accuracy of the above selections. Where omissions occur on the original colour selection sheet Purchaser(s) acknowledge that the Builder's selection will be final.	
c) Upgrades or extras listed on this schedule will not be deemed part of the Agreement of Purchase and Sale. Any such upgrades or extras shall be null and void unless accompanied by a separate invoice and amendment. Said invoice must be paid in f	
d) The Purchaser(s) further agrees that in the event that the Vendor has preselected colours prior to the purchase of the house, the prescribed colours are final not withstanding that the Purchaser may have completed a colour selection schedule	
e) The Purchaser(s) Acknowledges that once this colour schedule is signed and dated, no changes, additions or deletions will be permitted other than re-selection due to unavailability.	
A \$350 (Per item) administration fee will apply to the above exceptions (if the change is possible).	

This Interior Colour Selection is final and approved by:

Signature: _____ Date: _____	Signature: _____ Date: _____
Printed 4/20/2022 10:33:11	Builder's Agent: <u>Clayton</u> Date: <u>Apr 20-22</u>

Lot 3, Bika
Orchards.
Enclave

STONE EDGE PROFILES

Approx 2CM or $\frac{3}{4}$ " Standard Edge

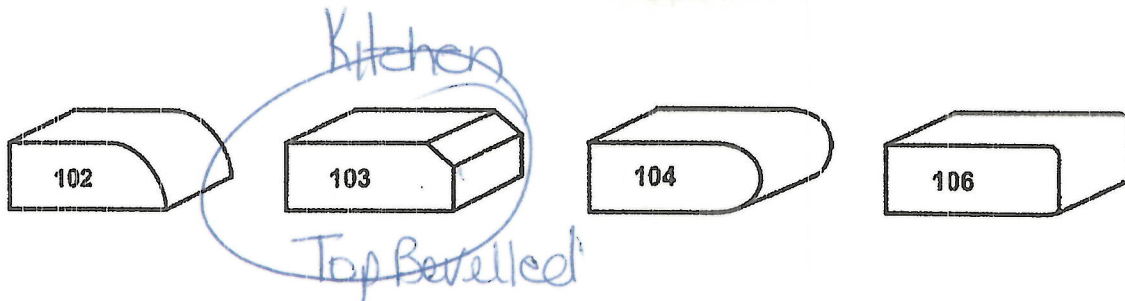

1st UPGRADE

Approx 4CM or 1.5" - SEAMS WILL BE VISIBLE

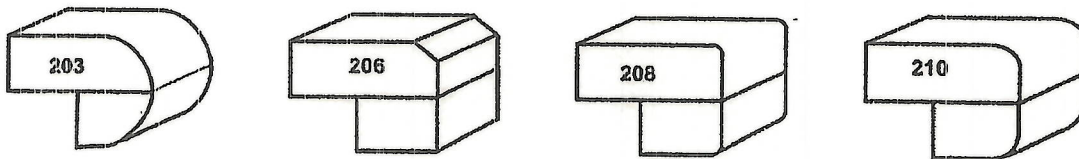

2nd UPGRADE

Approx 4CM or 1.5" - SEAMS WILL BE VISIBLE

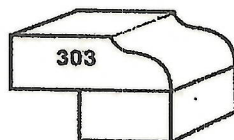

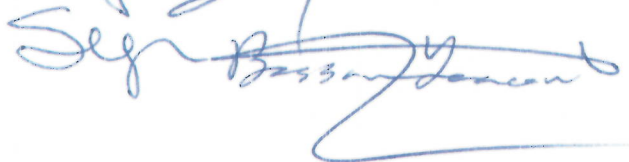
Sign 
Sign 

Date 03/01/2021
Date 03/01/2021

Lot 3.
Orchards
Enclave.

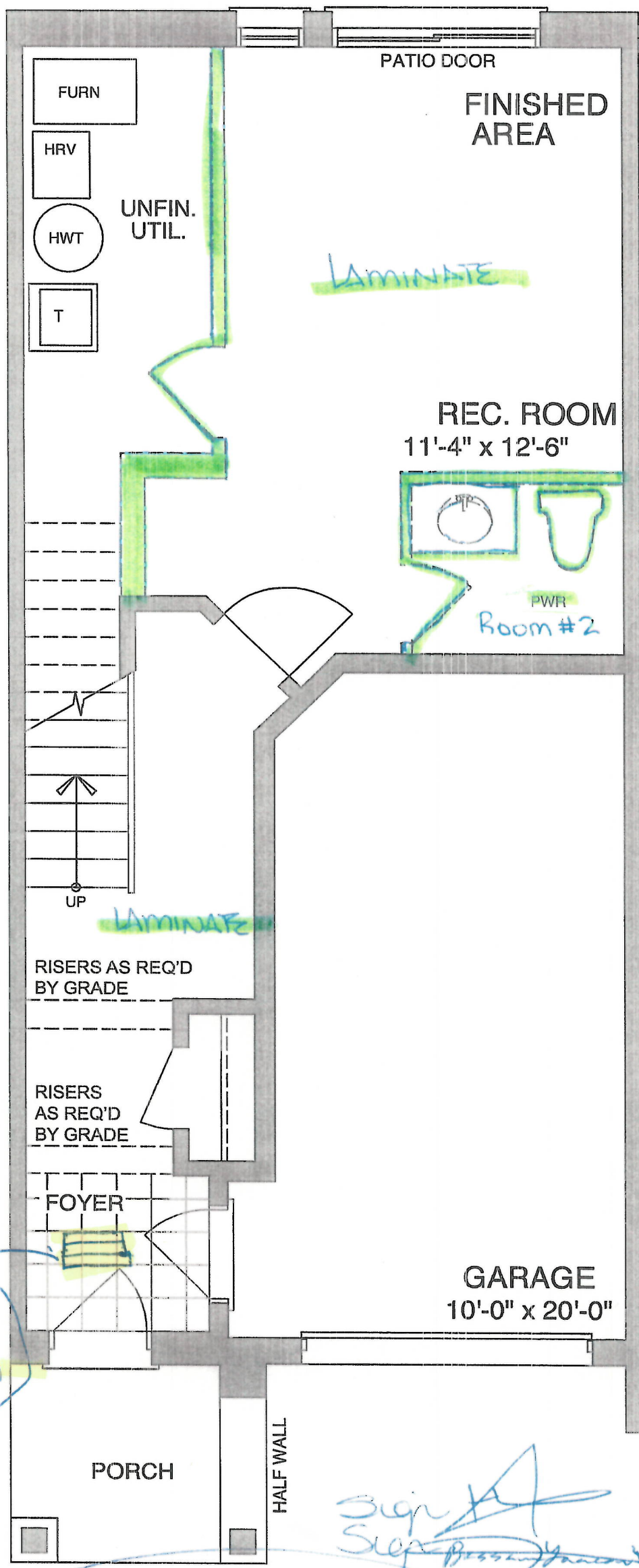

Tile
Direction

Sign
Step

Date 03/01/
Date 03/01/2012

GROUND FLOOR - ELEV B

Lot 3 - BIK A
Orchards
Enclave

- Bell
- ▲ Cable
- Receptacle

Extended Uppers

Tile Direction

Deep fridge upper w 2 cables

c 5 1/2 ft

Tile Direction

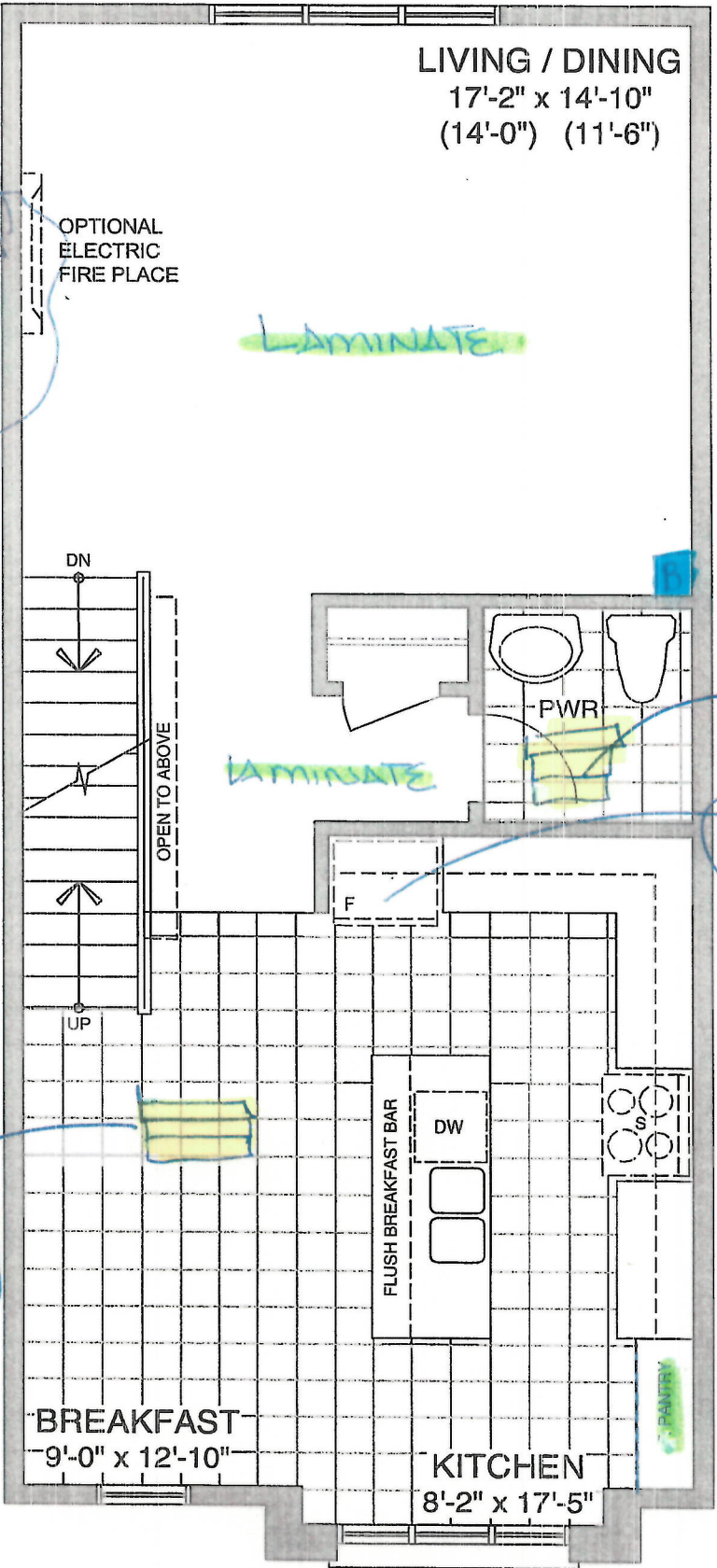

ALT. MAIN FLOOR - ELEV B1

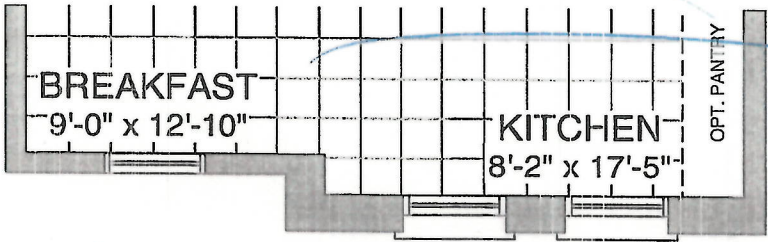

ALT. MAIN FLOOR - ELEV B2

Signatures

Date 03/01/2021
Date 03/01/2021

Lot 3 - B1KA
Orchards
Enclave.

 Bell
 Cable

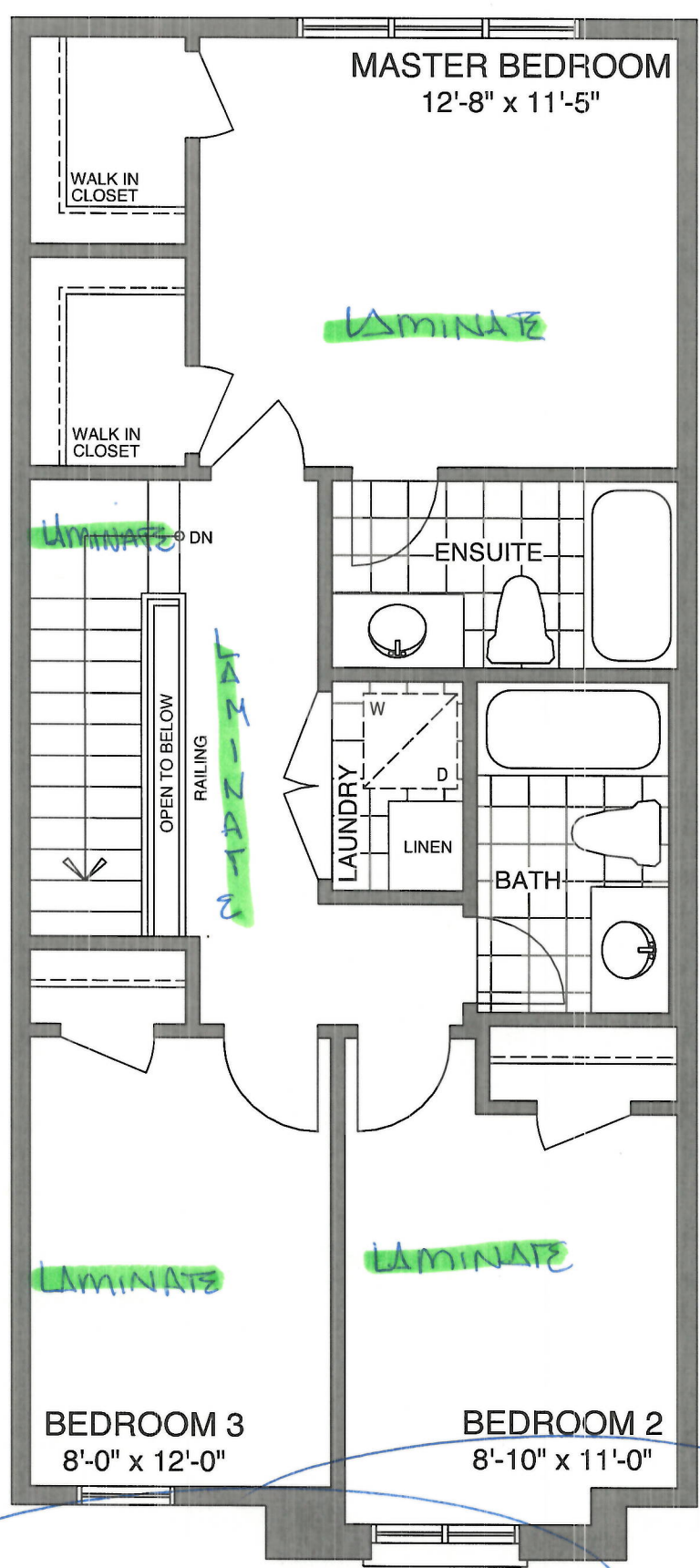

THIRD FLOOR - ELEV B1

Sign Date
Sign Date

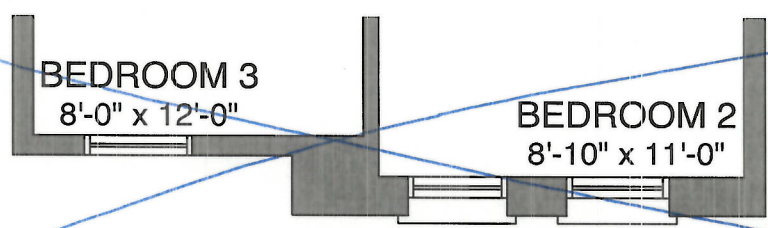

THIRD FLOOR - ELEV B2

Sign
Sign
Bessie

Date 03/01/2021
Date 03/01/2021



<div>CONSTRUCTION SUMMARY</div> <div>Orchards Enclave - 2174372 ONTARIO LTD.</div>				
PURCHASERS: HANAN OSMAN and BASSAM YAACOUB				TEL:
LOT / PHASE	REG. PLAN #	HOUSE TYPE		CLOSING DATE
3 Block A / 1		The Clarke (T-1) Alt Main Floor Opt Rec Room		07-Dec-21

Agreement of Purchase and Sale

Central air conditioner (builders standard line) <i>Worksheet</i> Note:	
Laminate Flooring in lieu of carpet on main floor, as per plan, from builders standard samples. <i>Worksheet</i> Note:	
Granite kitchen countertops, (as per plan-from builders standard samples). <i>Worksheet</i> Note:	
Includes Optional two piece powder room in rec room, as per plan, Builders standard samples. <i>Worksheet</i> Note:	



<div>CONSTRUCTION SUMMARY</div> <div>Orchards Enclave - 2174372 ONTARIO LTD.</div>				
PURCHASERS: HANAN OSMAN and BASSAM YAACOUB				TEL:
LOT / PHASE	REG. PLAN #	HOUSE TYPE		CLOSING DATE
3 Block A / 1		The Clarke (T-1) Alt Main Floor Opt Rec Room		07-Dec-21

1) CONSTRUCTION

1 - CEILING - SMOOTH FINISH - ALL FLOORS - 3 BEDROOM (CLASSIC SERIES) 10May21 Note: 11,599/37684	
--	--

4) PLUMBING

1 - KITCHEN - ALIGN 7565 CHROME, 1 HOLE APPLICATION 01Mar21 Note: 11,554/37059	
1 - SINK - KITCHEN - UNDERMOUNTED (RECTANGULAR SQUARE - SINGLE LARGE BOWL) 01Mar21 Note: 11,554/37058	

5) ELECTRICAL

1 - PLUG - INTERIOR RECEPTICAL (NOT DEDICATED) - LIVING ROOM ON WALL BESIDE CABLE AT 5 1/2 FT FOR FUTURE WALL MOUNT TV. 01Mar21 Note: 11,554/37046	
--	--

6) FLOORING & WALL TILE

1 - UPGRADE FLOOR TILE TO LEVEL 3 - POWDER ROOM 20Apr22 Note: 11,638/38063	
1 - UPGRADE FLOOR TILE TO LEVEL 3 - KITCHEN/BREAKFAST 20Apr22 Note: 11,638/38062	
1 - UPGRADE FLOOR TILE TO LEVEL 3 - FOYER 20Apr22 Note: 11,638/38061	
1 - LAMINATE FLOORING - LEVEL 2 - UPGRADE FROM CARPET - BEDROOM 3 (UPGRADE FROM CARPET) - 01Mar21 Note: 11,554/37053	
1 - LAMINATE FLOORING - LEVEL 2 - UPGRADE FROM CARPET - BEDROOM 2 (UPGRADE FROM CARPET) - 01Mar21 Note: 11,554/37052	
1 - LAMINATE FLOORING - LEVEL 2 - UPGRADE FROM CARPET - MASTER BEDROOM (UPGRADE FROM CARPET) - 01Mar21 Note: 11,554/37051	
1 - LAMINATE FLOORING - LEVEL 2 - UPGRADE FROM CARPET - UPPER HALL (UPGRADE FROM CARPET) - 01Mar21 Note: 11,554/37050	
1 - LAMINATE FLOORING - LEVEL 2 - UPGRADE FROM LEVEL 1 LAMINATE - OPT REC ROOM (UPGRADE FROM HARDWOOD) - 01Mar21 Note: 11,554/37049	
1 - LAMINATE FLOORING - LEVEL 2 - UPGRADE FROM LEVEL 1 LAMINATE - MAIN HALL (UPGRADE FROM HARDWOOD) - 01Mar21 Note: 11,554/37048	
1 - LAMINATE FLOORING - LEVEL 2 - UPGRADE FROM LEVEL 1 LAMINATE - LIVING/DINING ROOM (UPGRADE FROM HARDWOOD) - 01Mar21 Note: 11,554/37047	

8) FINISHING

1 - RAILING - 1/2 INCH WROUGHT IRON SQUARE PICKET WITH SINGLE SQUARE COLLAR ON ALTERNATING PICKET, 3 INCH OAK HANDRAIL AND 3 1/2 INCH OAK STANDARD POST 20Apr22 Note: 11,638/38064	
--	--

9) CABINETRY

--	--



<div>CONSTRUCTION SUMMARY</div> <div>Orchards Enclave - 2174372 ONTARIO LTD.</div>				
PURCHASERS: HANAN OSMAN and BASSAM YAACOUB				TEL:
LOT / PHASE	REG. PLAN #	HOUSE TYPE		CLOSING DATE
3 Block A / 1		The Clarke (T-1) Alt Main Floor Opt Rec Room		07-Dec-21

9) CABINETRY

1 - **PURCHASERS WANTS TO LEAVE ALL STANDARD OPENINGS FOR APPLIANCES** 01Mar21 Note: 11,554/37056	
1 - UPPER CABINETS - EXTENDED UPPER CABINET (90 CM AND 100CM TALL) - GROUP 1 - 4 01Mar21 Note: 11,554/37045	
1 - APPLIANCE CABINETS - FRIDGE - 66CM DEEP FRIDGE ENCLOSURE (COUNTER DEPTH) WITH NO WALLS ([2] 66CM DEEP GABLES AND [1] 66CM DEEP CABINET) (THIS IS NOT A ZERO CLEARANCE ENCLOSURE. STANDARD HEIGHTS AND WIDTHS WILL BE USED.) 01Mar21 Note: 11,554/37044	
1 - CABINETS - KITCHEN - OPT PANTRY - LEVEL 1 01Mar21 Note: 11,554/37040	

STAIR AND RAILING

1 - STAIN STAIR AND RAILING 01Mar21 Note: 11,554/37043	
1 - UPGRADE STANDARD STAIR TO ALL OAK IN NATURAL FINISH (WITH LAMINATE LANDING) 01Mar21 Note: 11,554/37042	

TRIM DOORS AND HARDWARE - INTERIOR

1 - 2 PANEL SMOOTH DOORS THROUGHOUT (STD. HOLLOW CORE) 01Mar21 Note: 11,554/37060	
1 - DOOR HANDLE - UPGRADE TO PEWTER STRAIGHT LEVERS 01Mar21 Note: 11,554/37055	

This Document is Extremely Time Sensitive - Printed 20 Apr 22 at 10:37