



CONSTRUCTION SUMMARY

Carrville Investments Ltd. / Loggias of Richvale

Lot/Unit: 18 Phase/Building: 2 Model/Floor Plan: The Ferrara (50-3) Elev A

CABINETRY

Inv.4171	1 - LOCATION: KITCHEN ACCOMMODATE FOR BUILT IN FRIDGE WITH INTEGRATED INSET INSTALLATION (07H) Line 53321 Note: 17Aug17 / 6Sep17	
Inv.4171	1 - LOCATION: KITCHEN RELOCATE FRIDGE OPENING TO BACK ONTO PANTRY WALL INCREASE SIZE OF OPENING TO ACCOMMODATE 42" FRIDGE Line 53319 Note: 17Aug17 / 6Sep17	
Inv.4171	1 - LOCATION: KITCHEN CONVERT EXISTING DOUBLE DOOR 30CM TO 61CM HIGH WALL CABINET TO ONE (1) OR (2) FLIP UP DOORS ABOVE FRIDGE Line 53322 Note: 17Aug17 / 6Sep17	
Inv.4171	3 - LOCATION: KITCHEN UPPER CABINET - PRICE IS PER FOOT - UPGRADE 3 TO FILL IN SPACE TO FORMER FRIDGE AREA Line 53324 Note: 17Aug17 / 6Sep17	
Inv.4171	1 - LOCATION: KITCHEN CENTRE THE STOVE AND THE CHIMNEY HOOD FAN TO CABINET SURROUND BASED ON FRIDGE BEING RELOCATED. 36" SLIDE IN STOVE Line 53326 Note: 17Aug17 / 6Sep17	
Inv.4171	1 - LOCATION: KITCHEN LOCATE A STANDARD SET OF POT/PAN DRAWERS ON EITHER SIDE OF STOVE AS IT HAS BEEN RELOCATED. SEE SKETCH ATTACHED Line 53327 Note: 17Aug17 / 6Sep17	
Inv.4171	1 - LOCATION: KITCHEN SUPPLY A BAR FRIDGE OPENING IN LIEU OF BASE CABINETS ON WALL BACKING ONTO PANTRY. SEE SKETCH ATTACHED Line 53330 Note: 17Aug17 / 6Sep17	
Inv.4171	1 - LOCATION: KITCHEN RELOCATE THE STANDARD BANK OF DRAWERS IN THE ISLAND TO BE NEXT TO DISHWASHER IF POSSIBLE Line 53340 Note: 17Aug17 / 6Sep17	



CONSTRUCTION SUMMARY

Carrville Investments Ltd. / Loggias of Richvale

Lot/Unit: 18 Phase/Building: 2 Model/Floor Plan: The Ferrara (50-3) Elev A

Inv.4171	1 - LOCATION: KITCHEN	
	SUPPLY AND INSTALL STACKED UPPER CABINETS WITH FASCIA/PAN AND CROWN MOULDING TO CLOSE OFF SPACE BETWEEN CEILING AND TOP OF CABINETS	
Line 53356	Note: NO GLASS OR MATCHING INTERIOR	
17Aug17 / 6Sep17		

Inv.4171	1 - LOCATION: WALL WITH BUILT IN APPLIANCES	
	WHERE POSSIBLE, INSTALL FLIP UP DOORS ABOVE FRIDGE, BUILT IN MICROWAVE AND UPPER CABINET WHERE BAR FRIDGE LOCATED. SEE SKETCH	
Line 53399	Note:	
17Aug17 / 6Sep17		

Inv.4171	1 - LOCATION: KITCHEN	
	SUPPLY AND INSTALL BASE LEMANS CORNER SYSTEM TO BE LOCATED AS PER SKETCH ATTACHED	
Line 53411	Note:	
17Aug17 / 6Sep17		

CABINETRY BASE CABINETS

Inv.4171	3 - LOCATION: KITCHEN	
	BASE CABINET 30 CM (24 INCH) DEEP - PRICE IS PER FOOT - UPGRADE 3 TO FILL IN SPACE TO FORMER FRIDGE AREA	
Line 53323	Note:	
17Aug17 / 6Sep17		

CABINETRY HARDWARE

Inv.4171	1 - LOCATION: KITCHEN ISLAND	
	BASE WASTE / RECYCLE CENTER PULL OUT DOOR - ONLY AVAILABLE IN 45 CM CABINET (2) 35L BINS - PRICE IS PER UNIT	
Line 53339	Note: TO BE LOCATED IN ISLAND IN LIEU OF STANDARD BANK OF DRAWERS	
17Aug17 / 6Sep17		

CABINETRY MICROWAVE OVEN STOVE COOKTOP

Inv.4171	1 - LOCATION: KITCHEN	
	BUILT IN DOUBLE APPLIANCE CABINET WITH DRAWER BELOW - TRIM KIT REQUIRED - PURCHASER MUST SUPPLY SPECS - UPGRADE 3	
Line 53338	Note: MICROWAVE AND WARMING DRAWER BELOW	
17Aug17 / 6Sep17		

CABINETRY VANITY

Inv.4171	8 - LOCATIOIN: ALL BATHROOMS	
	SUPPLY AND INSTALL RAISED VANITIES AT COMFORT HEIGHT IN ALL BATHROOMS	
Line 53348	Note:	
17Aug17 / 6Sep17		



CONSTRUCTION SUMMARY

Carrville Investments Ltd. / Loggias of Richvale

Lot/Unit: 18 Phase/Building: 2 Model/Floor Plan: The Ferrara (50-3) Elev A

Inv.4171	1 - LOCATION: YOGA ROOM BATHROOM	
	VANITY BANK OF DRAWERS (60 CM TO 90 CM) - SEE NOTE L - UPGRADE 3 TO BE LOCATED ON SIDE CLOSEST TO WINDOW.	
Line 53351	Note: NOTE: SINK HAS BEEN OFFSET - SEE SKETCH	
17Aug17 / 6Sep17		
Inv.4171	1 - LOCATION: MASTER ENSUITE - HER SIDE	
	VANITY BANK OF DRAWERS (60 CM TO 90 CM) - SEE NOTE L - UPGRADE 3 TO BE LOCATED ON SIDE CLOSEST TO FREE STANDING TUB	
Line 53352	Note:	
17Aug17 / 6Sep17		

COUNTER TOP - GRANITE

Inv.4171	1 - LOCATION: KITCHEN	
	SUPPLY AND INSTALL STANDARD LINE CAESARSTONE COUNTER-TOP WITH STANDARD EDGE PROFILE TO BASE CABINETS ADDED IN FORMER FRIDGE AREA	
Line 53325	Note: 7141 QUARTZ REFLECTIONS CAESARSTONE	
17Aug17 / 6Sep17		
Inv.4171	2 - LOCATION: KITCHEN ISLAND	
	SUPPLY AND INSTALL - COUNTER TOP WATER FALL GABLE - MITRE SEAM - GROUP 5 2CM UP TO 36 INCHES	
Line 53358	Note: 7141 QUARTZ REFLECTIONS CAESARSTONE	
17Aug17 / 6Sep17		

COUNTER TOP - KITCHEN

Inv.4171	1 - LOCATION: KITCHEN ISLAND	
	SUPPLY AND INSTALL GRANITE CUTOUT AND POLISHED EDGE FOR UNDERMOUNT SINK	
Line 53342	Note: SINGLE HOLE FAUCET AND UNDERMOUNT SINK PURCHASED SEPARATELY.	
17Aug17 / 6Sep17		

ELECTRICAL

Inv.3978	8 - LOCATION: DINING / LIVING ROOM - PART 5	
	TO LOCATE EIGHT (8) STANDARD POTLIGHTS INCLUDED IN OFFER	
Line 53258	Note: A SEPARATE SWITCH TO OPERATE THESE POTLIGHTS HAS BEEN PURCHASED	
24Jan17 / 14Aug17		
Inv.3978	1 - LOCATION: DINING/LIVING ROOM	
	SUPPLY A SEPARATE SWITCH TO OPERATE THE EIGHT (8) POTLIGHTS IN DINING/LIVING ROOM	
Line 53259	Note:	
24Jan17 / 14Aug17		



CONSTRUCTION SUMMARY

Carrville Investments Ltd. / Loggias of Richvale

Lot/Unit: 18 Phase/Building: 2 Model/Floor Plan: The Ferrara (50-3) Elev A

Inv.3978	4 - LOCATION: DEN	
	TO LOCATE FOUR (4) STANDARD POTLIGHTS INCLUDED IN OFFER DO NOT DELETE THE STANDARD CEILING FIXTURE	
Line 53260	Note: A SEPARATE SWITCH TO OPERATE THESE POTLIGHTS HAS BEEN PURCHASED	
24Jan17 / 14Aug17		
Inv.3978	1 - LOCATION: DEN	
	SUPPLY A SEPARATE SWITCH TO OPERATE THE FOUR (4) POTLIGHTS IN DEN.	
Line 53261	Note:	
24Jan17 / 14Aug17		
Inv.3978	8 - LOCATION: GREAT ROOM	
	TO LOCATE EIGHT (8) STANDARD POTLIGHTS INCLUDED IN OFFER DO NOT DELETE THE STANDARD CEILING FIXTURE IN THE MIDDLE OF THE CEILING	
Line 53262	Note: A SEPARATE SWITCH TO OPERATE THESE POTLIGHTS HAS BEEN PURCHASED	
24Jan17 / 14Aug17		
Inv.3978	1 - LOCATION: GREAT ROOM	
	SUPPLY A SEPARATE SWITCH TO OPERATE THE POTLIGHTS IN THE GREAT ROOM	
Line 53263	Note:	
24Jan17 / 14Aug17		
Inv.4171	1 - LOCATION: KITCHEN	
	SUPPLY AND INSTALL 20 AMP ELECTRICAL OUTLET REQUIRED FOR 42" FRIDGE	
Line 53320	Note:	
17Aug17 / 6Sep17		
Inv.4171	1 - LOCATION: KITCHEN	
	SUPPLY AND INSTALL ADDITIONAL INTERIOR RECEPTACLE ON SEPARATE CIRCUIT FOR BAR FRIDGE	
Line 53331	Note: LOCATION AS PER SKETCH ATTACHED.	
17Aug17 / 6Sep17		
Inv.4171	1 - LOCATION: KITCHEN	
	ELECTRICAL - CONNECTION FOR BUILT-IN MICROWAVE AND WARMING DRAWER	
Line 53336	Note:	
17Aug17 / 6Sep17		
Inv.4171	4 - LOCATION: BATHROOMS	
	SUPPLY AND INSTALL ADDITIONAL INTERIOR GROUND FAULT RECEPTACLE. TO BE LOCATED NEXT TO EACH TOILET (RIGHT SIDE WHEN SITTING DOWN)	
Line 53353	Note: 2 IN MASTER ENSUITE, 1 IN TWIN BATH, 1 ENSUITE 4	
17Aug17 / 6Sep17		
Inv.4171	1 - LOCATION: KITCHEN	
	SUPPLY AND INSTALL LIGHT VALANCE ROUGH IN (INCLUDES 1 SWITCH) INCLUDING SERVERY AREA	
Line 53396	Note: LOCATION AS PER SKETCH ATTACHED.	
17Aug17 / 6Sep17		



CONSTRUCTION SUMMARY

Carrville Investments Ltd. / Loggias of Richvale

Lot/Unit: 18 Phase/Building: 2 Model/Floor Plan: The Ferrara (50-3) Elev A

MISCELLANEOUS

Inv.3978	1 - LOCATION: DINING / LIVING ROOM - PART 1 DELETE THE 2 SIDED FIREPLACE BETWEEN THE LIVING & DINING ROOM DELETE THE WALLS ON EITHER SIDE OF 2 SIDED FIREPLACE AND CREATE ONE LARGE ROOM - NIBS WILL WILL REMAIN IF AND WHERE REQUIRED	
Line 53254	Note:	
24Jan17 / 14Aug17		
Inv.3978	1 - LOCATION: DINING / LIVING ROOM - PART 2 INCREASE SIDE WALL BY APPROXIMATELY 18" ON EITHER SIDE TO BALANCE OFF ENTRY BETWEEN THE HALL AND THE NEW DINING/LIVING ROOM.	
Line 53255	Note:	
24Jan17 / 14Aug17		
Inv.3978	1 - LOCATION: DINING / LIVING ROOM - PART 3 EXTEND THE COFFERED CEILING TO ENCOMPASS DINING AND LIVING ROOM - ONE CONTINUOUS COFFERED CEILING IN LIEU OF TWO	
Line 53256	Note:	
24Jan17 / 14Aug17		
Inv.3978	3 - LOCATION: DINING / LIVING ROOM - PART 4 SUPPLY AND INSTALL THREE (3) CAPPED CEILING OUTLET WITH ONE (1) SEPARATE SWITCH. TO BE EQUALLY SPACED AND CENTRED BETWEEN THE DINING/LIVING ROOM.	
Line 53257	Note:	
24Jan17 / 14Aug17		
Inv.3978	1 - LOCATION: BEDROOM 4 AND BEDROOM 5 - PART 1 DELETE THE WALL BETWEEN BETWEEN 4 AND 5 TO CREATE ONE LARGE ROOM. RELOCATE THE DOORS AND CREATE A DOUBLE DOOR ENTRY INTO THE NEW ROOM.	
Line 53264	Note:	
24Jan17 / 14Aug17		
Inv.3978	1 - LOCATION: BEDROOM 4 AND BEDROOM 5 - PART 1 DELETE THE WALK IN CLOSET IN BEDROOM 5 AND USE SPACE TO INCREASE THE SIZE OF THE BATHROOM.	
Line 53265	Note:	
24Jan17 / 14Aug17		
Inv.3978	1 - LOCATION: BATHROOM FOR BEDROOM 5 CLOSE OFF ENTRY TO BATHROOM FROM BEDROOM 5 AND RELOCATE THE ENTRY TO BATHROOM FROM THE YOGA ROOM.	
Line 53266	Note:	
24Jan17 / 14Aug17		
Inv.3978	1 - LOCATION: YOGA BATHROOM DELETE THE TUB AND SUPPLY AND INSTALL SHOWER STALL STALL WITH FRAMELESS FRONTAL GLASS ONLY. SUPPLY A SHOWER POTLIGHT. STANDARD CERAMIC TILES ARE INCLUDED.	
Line 53267	Note:	
24Jan17 / 14Aug17		



CONSTRUCTION SUMMARY

Carrville Investments Ltd. / Loggias of Richvale

Lot/Unit: 18 Phase/Building: 2 Model/Floor Plan: The Ferrara (50-3) Elev A

Inv.3978	1 - LOCATION: YOGA BATHROOM INCREASE SIZE OF VANITY AND INSTALL SINK "OFF CENTRE" TO ONE SIDE TO ALLOW FOR MORE COUNTER SPACE. RELOCATE THE TOILET.	
Line 53268	Note:	
24Jan17 / 14Aug17		
Inv.3978	1 - BULK PRICE FOR CHANGES TO MAIN FLOOR AND SECOND FLOOR. AS PER A. MIRIGELLO DOES NOT INCLUDE THE ELECTRICAL CHARGES WHICH ARE PRICED SEPARATELY.	
Line 53269	Note:	
24Jan17 / 14Aug17		
Inv.4171	1 - LOCATION: ALL BATHROOMS DELETE DO NOT INSTALL AND DO NOT SUPPLY BATHROOM MIRRORS, TOILET PAPER HOLDERS, TOWEL BARS, SOAP DISHES IN ALL BATHROOMS	
Line 53346	Note:	
17Aug17 / 6Sep17		
Inv.4171	1 - LOCATION: SHOWER STALLS SUPPLY A SHOWER NICHE IN SHOWER STALL FOR MASTER ENSUITE, YOGA BATHROOM AND ENSUITE 4	
Line 53359	Note:	
17Aug17 / 6Sep17		

PLUMBING

Inv.4171	1 - LOCATION: KITCHEN ISLAND SUPPLY AND INSTALL OPTIONAL PREP SINK IN ISLAND FRANKE TECHN A TCX110-18 UNDERMOUNT	
Line 53341	Note: INCLUDES ROUGH IN FOR SINK AND FAUCET	
17Aug17 / 6Sep17		
Inv.4171	1 - LOCATION: KITCHEN SUPPLY AND INSTALL UPGRADE FAUCET FOR OPTIONAL PREP SINK IN ISLAND. GROHE CONCETTO PREP 31479000 - CHROME FINISH	
Line 53343	Note:	
17Aug17 / 6Sep17		
Inv.4171	1 - LOCATION: KITCHEN SUPPLY AND INSTALL POT FILLER IN WALL BEHIND STOVE GROHE CONTEMPORARY 31075SDO	
Line 53344	Note: INCLUDES ROUGH IN POT FILLER AND CONNECTION	
17Aug17 / 6Sep17		



CONSTRUCTION SUMMARY

Carrville Investments Ltd. / Loggias of Richvale

Lot/Unit: 18 Phase/Building: 2 Model/Floor Plan: The Ferrara (50-3) Elev A

Inv.4171	3 - LOCATION: SHOWER STALLS	
	SUPPLY AND INSTALL ACO 36 LINEAR DRAIN COMPLETE WITH GRID TO MASTER ENSUITE SHOWER STALL, ENSUITE 4 SHOWER STALL AND YOGA BATHROOM SHOWER STALL	
Line 53345	Note:	
17Aug17 / 6Sep17		
Inv.4171	1 - LOCATION: ENSUITE 4 BATHROOM	
	SUPPLY AND INSTALL GROHE AGIRA HAND SHOWER AND SLIDE BAR TO THE EXISTING TUB/SHOWER FAUCET. DO NOT DELETE THE SHOWER HEAD.	
Line 53355	Note:	
17Aug17 / 6Sep17		
Inv.4171	1 - LOCATION: BATHROOM TOILETS	
	WHERE POSSIBLE AVOID INSTALLING TOILETS ON NORTH EAST WALLS CLIENT ACKNOWLEDGES AND ACCEPTS THAT THIS IS A COURTESY REQUEST ONLY AND CANNOT BE GUARANTEED	
Line 53390	Note:	
17Aug17 / 6Sep17		

TILE

Inv.4171	1 - LOCATION: MASTER ENSUITE - HER SIDE	
	FLOOR TILE - UPGRADE 3 - MASTER ENSUITE - HIS - HERS - FLOOR STANDARD STACKED INSTALL - SEE SKETCH FOR TILE DIRECTION	
Line 53400	Note: 12" X 24" SANDS EXPERIENCE GREY LINEAR (IG.SE.GRY.1224.LN)	
17Aug17 / 6Sep17		
Inv.4171	1 - LOCATION: ENSUITE 4	
	FLOOR TILE - UPGRADE 2 - ENSUITE 4 - FLOOR STANDARD STACKED INSTALL - SEE SKETCH FOR TILE DIRECTION	
Line 53404	Note: 12" X 24" ALLURE POLISHED GREY (QT.AU.GRY.1224.PL)	
17Aug17 / 6Sep17		
Inv.4171	1 - LOCATION: ENSUITE 4	
	FLOOR TILE - UPGRADE 2 - SHOWER WITH CEILING STANDARD STACKED INSTALL - HORIZONTAL INSTALL	
Line 53406	Note: 12" X 24" ALLURE POLISHED GREY (QT.AU.GRY.1224.PL)	
17Aug17 / 6Sep17		
Inv.4171	1 - LOCATION: YOGA ROOM SHOWER STALL	
	SUPPLY AND INSTALL UPGRADE SHOWER FLOOR TILE IN YOGA ROOM SHOWER STALL	
Line 53409	Note: 2 X 2 ONTARIO MOSAIC TENDER GREY MATTE (OD.ON.TGR.0202.MT.N)	
17Aug17 / 6Sep17		
Inv.4171	1 - LOCATION: MASTER ENSUITE HIS SIDE	
	FLOOR TILE - UPGRADE 3 - MASTER ENSUITE - HIS - HERS - SHOWER FLOOR STANDARD STACKED INSTALL - SEE SKETCH FOR TILE DIRECTION	
Line 53401	Note: 12" X 24" SANDS EXPERIENCE GREY LINEAR (IG.SE.GRY.1224.LN)	
17Aug17 / 6Sep17		



CONSTRUCTION SUMMARY

Carrville Investments Ltd. / Loggias of Richvale

Lot/Unit: 18 Phase/Building: 2 Model/Floor Plan: The Ferrara (50-3) Elev A

Inv.4171	1 - LOCATION: KITCHEN /BREAKFAST/SERVERY/PANTRY FLOOR TILE - UPGRADE 6 - KITCHEN - BREAKFAST - SERVERY - PANTRY FLOOR STANDARD STACKED INSTALL - SEE SKETCH FOR TILE DIRECTION Line 53391 Note: 24" X 48" TIMELESS WHITE POLISHED (OV. TL.WHT.2448.PL) 17Aug17 / 6Sep17	
Inv.4171	1 - LOCATION: POWDER ROOM FLOOR TILE - UPGRADE 6 - POWDER ROOM - FLOOR STANDARD STACKED INSTALL - SEE SKETCH FOR TILE DIRECTION Line 53392 Note: 24" X 48" TIMELESS WHITE POLISHED (OV. TL.WHT.2448.PL) 17Aug17 / 6Sep17	
Inv.4171	1 - LOCATION: SIDE HALL / GARAGE ENTRANCE FLOOR TILE - UPGRADE 6 - SIDE ENTRANCE - GARAGE - FLOOR STANDARD STACKED INSTALL - SEE SKETCH FOR TILE DIRECTION Line 53393 Note: 24" X 48" TIMELESS WHITE POLISHED (OV. TL.WHT.2448.PL) 17Aug17 / 6Sep17	
Inv.4171	1 - LOCATION: FOYER / CLOAK ROOM FLOOR TILE - UPGRADE 6 - VESTIBULE - WALK IN CLOSET- FLOOR STANDARD STACKED INSTALL - SEE SKETCH FOR TILE DIRECTION Line 53394 Note: 24" X 48" TIMELESS WHITE POLISHED (OV. TL.WHT.2448.PL) 17Aug17 / 6Sep17	
Inv.4171	1 - LOCATION: LAUNDRY/HOBBY ROM FLOOR TILE - UPGRADE 6 - LAUNDRY ROOM - HOBBY ROOM - FLOOR STANDARD STACKED INSTALL - SEE SKETCH FOR TILE DIRECTION Line 53395 Note: 24" X 48" TIMELESS WHITE POLISHED (OV. TL.WHT.2448.PL) 17Aug17 / 6Sep17	
Inv.4171	1 - LOCATION: TWIN BATHROOM FLOOR TILE - UPGRADE 2 TWIN BATH FLOOR STANDARD STACKED INSTALL - SEE SKETCH FOR TILE DIRECTION Line 53403 Note: 12" X 24" ALLURE POLISHED GREY (QT.AU.GRY.1224.PL) 17Aug17 / 6Sep17	
Inv.4171	1 - LOCATION: TWIN BATH FLOOR - UPGRADE 2 - TUB ENCLOSURE AND CEILING STANDARD STACKED INSTALL - HORIZONTAL INSTALL Line 53405 Note: 12" X 24" ALLURE POLISHED GREY (QT.AU.GRY.1224.PL) 17Aug17 / 6Sep17	
Inv.4171	1 - LOCATION: ENSUITE 4 SHOWER STALL SUPPLY AND INSTALL UPGRADE SHOWER FLOOR TILE Line 53407 Note: 2 X 2 ONTARIO MOSAIC TAUPE MATTE (OD.ON.TPE.0202.MT.N) 17Aug17 / 6Sep17	
Inv.4171	1 - LOCATION: MASTER ENSUITE SHOWER STALL SUPPLY AND INSTALL UPGRADE SHOWER FLOOR TILE IN MASTER ENSUITE SHOWER STALL Line 53408 Note: 2 X 2 ONTARIO MOSAIC TENDER GREY MATTE (OD.ON.TGR.0202.MT.N) 17Aug17 / 6Sep17	



CONSTRUCTION SUMMARY

Carrville Investments Ltd. / Loggias of Richvale

Lot/Unit: 18 Phase/Building: 2 Model/Floor Plan: The Ferrara (50-3) Elev A

Inv.4171	1 - LOCATION: MASTER ENSUITE SHOWER STALL	
	WALL TILE - UPGRADE 6 - MASTER ENSUITE - SHOWER WITH CEILING STANDARD STACKED INSTALL - HORIZONTAL INSTALL	
Line 53410	Note: 4" X 16" CRISTALLO DOVE GREY GLASS (KV.CR.DGY.0416.GL)	
17Aug17 / 6Sep17		

EXTRAS AS PER OFFER

The Vendor agrees to allow the purchaser the one time right to assign this transaction, and Purchaser agrees to use the Vendors approved form of assignment. The cost of such assignment will be \$7,500 payable to the Vendor should the purchaser decide to <i>Worksheet</i> Note:	
Subzero/Wolf Kitchen Appliances including 36 inch stainless steel fridge and 36 inch gas range, 36 inch stainless steel chimney style hood fan and ASKO stainless steel dishwasher, from Vendors standard package. No cash value, non-transferrable and no <i>Worksheet</i> Note:	
The Purchaser has selected Exterior Package No:____as their FIRST choice. As a SECOND choice, should the FIRST package become unavailable or should there be any architectural control conflicts, the Purchasers SECOND choice is Exterior Package No:_____. <i>Worksheet</i> Note:	
The Vendor agrees to allow the Purchaser to tranfser this transaction into an immediate family members name (parents or sibling) by way of Amendment prior to the closing date but not later than 60 days before completion. No Charge <i>Worksheet</i> Note:	
Optional 5 Bedroom Second Floor <i>Worksheet</i> Note:	



INTERIOR COLOUR SCHEME

Ph 2 #18.

Purchaser: RUHI JAFFER
Telephone Res. / Bus: (416) 834-7867 /
Decor Advisor: Steffanee Appio

Property: 18 of Plan -
Project: Carrville Investments Ltd.
Model and Elevation: The Ferrara (50-3) Elev A

Layout Changes: ☒ Yes ☐ No Sketch Attached: ☒ Yes ☐ No Exterior Colour Scheme:

1. Cabinetry

	Style and Colour	Counter Top	Hardware
Kitchen / Breakfast	WINDSOR PAINT WINTER WHITE	7141 QUARTZ REFLECTIONS	9677 HANDLE
Kitchen Island	WINDSOR PAINT WINTER WHITE	7141 QUARTZ REFLECTIONS	9677 HANDLE
Laundry Room	PVC SLAB LATITUDE EAST	6698-46 PALOMA POLAR	9677 HANDLE
Powder Room	OTTAWA MAPLE SOAPSTONE CL	BIANCO SARDO GRANITE	196 KNOB
Main Bathroom			
Master Ensuite Bathroom	OTTAWA MAPLE SOAPSTONE CL	BIANCO SARDO GRANITE	196 KNOB
Second Ensuite Bathroom (If Applicable)	PVC SLAB LATITUDE EAST - YOGA	BIANCO SARDO GRANITE	9677 HANDLE
ENSUITE 4	OTTAWA MAPLE SOAPSTONE CL	NEW CALEDONIA GRANITE	196 KNOB
TWIN BATH	OTTAWA MAPLE SOAPSTONE CL	NEW CALEDONIA GRANITE	196 KNOB

Appliances

Custom Size Fridge

☒ Yes ☐ No

Valance Lighting

☒ Yes ☐ No

Microwave / Range Hood

☐ Yes ☒ No

Cooktop / Rangetop

☐ Yes ☒ No

Built in Wall Oven

☒ Yes ☐ No

Slide-in Range

☒ Yes ☐ No

Comment

STANDARD EDGE PROFILE TO STONE COUNTER-TOPS IN KITCHEN AND BATHROOMS

2. Flooring

Selection

FOYER	24" X 48" TIMELESS POLISHED WHITE (OV.TL.WHT.2448.PL) STANDARD STACKED INSTALL
Main Hall	5" VINTAGE OAK HANDSCRAPED - GOTHAM
Back Hall	24" X 48" TIMELESS POLISHED WHITE (OV.TL.WHT.2448.PL) SIDE HALL / GARAGE ENTRANCE
Breakfast	24" X 48" TIMELESS POLISHED WHITE (OV.TL.WHT.2448.PL) STANDARD STACKED INSTALL
Laundry Room	24" X 48" TIMELESS POLISHED WHITE (OV.TL.WHT.2448.PL) STANDARD STACKED INSTALL
Kitchen	24" X 48" TIMELESS POLISHED WHITE (OV.TL.WHT.2448.PL) STANDARD STACKED INSTALL
Powder Room	24" X 48" TIMELESS POLISHED WHITE (OV.TL.WHT.2448.PL) STANDARD STACKED INSTALL
Main Bathroom	N/A
Master Ensuite	12" X 24" SANDS EXPERIENCE LINEAR GREY (IG.SE.GRY.1224.LN) STANDARD STACKED
Bathroom (If Applicable)	12" X 24" ALLURE POLISHED GREY (QT.AU.GRY.1224.PL) ENSUITE 4
Mud Room	24" X 48" TIMELESS POLISHED WHITE (OV.TL.WHT.2448.PL) STANDARD STACKED INSTALL
TWIN BATH	12" X 24" ALLURE POLISHED GREY (QT.AU.GRY.1224.PL) STANDARD STACKED INSTALL
Living Room	5" VINTAGE OAK HANDSCRAPED - GOTHAM
Dining Room	5" VINTAGE OAK HANDSCRAPED - GOTHAM
Family / Great Room	5" VINTAGE OAK HANDSCRAPED - GOTHAM
Den / Library / Study	5" VINTAGE OAK HANDSCRAPED - GOTHAM
Basement Landing (If Applies)	13" X 13" SERPENTINE BEYAZ WHITE (TR.ST.BYZ.1313) LANDING AREA AT BASEMENT
Lower Landing (If Applicable)	5" VINTAGE OAK HANDSCRAPED - GOTHAM
Upper Landing	5" VINTAGE OAK HANDSCRAPED - GOTHAM
Upper Hall	5" VINTAGE OAK HANDSCRAPED - GOTHAM
Master Bedroom	5" VINTAGE OAK HANDSCRAPED - GOTHAM
Bedroom #2	5" VINTAGE OAK HANDSCRAPED - GOTHAM
Bedroom #3	5" VINTAGE OAK HANDSCRAPED - GOTHAM
Bedroom #4	5" VINTAGE OAK HANDSCRAPED - GOTHAM
Bedroom #5	5" VINTAGE OAK HANDSCRAPED - GOTHAM - YOGA ROOM
YOGA BATHROOM	13" X 13" SERPENTINE BEYAZ WHITE (TR.ST.BYZ.1313)

Flooring Continued on Page 2

Initial: 

Page 1 of 3



INTERIOR COLOUR SCHEME

Purchaser: RUHI JAFFER
Telephone Res. / Bus: (416) 834-7867 /
Decor Advisor: Steffanee Appio

Property: 18 of Plan -
Project: Carville Investments Ltd.
Model and Elevation: The Ferrara (50-3) Elev A

2. Flooring - Continued -

Upgrade Underpad	Type	Area
Carpet on Stairs	Capped	Runner - "Upgrade
Comment		

3. Plumbing Fixtures / Faucets

Kitchen	STD	Second Ensuite	STD	Powder Room	STD
Master Ensuite	STD			Other Room	STD
Main Bathroom		TWIN BATH	STD		

Comment
PREP SINK AND FAUCET IN ISLAND
POT FILLER BEHIND STOVE

4. Wall Tile

	Tile Selection	Listello	Insert	Insert Selection
Main Bathroom		<input type="checkbox"/>	<input type="checkbox"/>	
Master Ensuite		<input type="checkbox"/>	<input type="checkbox"/>	
Tub Deck		<input type="checkbox"/>	<input type="checkbox"/>	
Tub Apron		<input type="checkbox"/>	<input type="checkbox"/>	
Tub Surround		<input type="checkbox"/>	<input type="checkbox"/>	
Shower Stall	4" X 16" CRISTALO DOVE GREY GLASS -HORIZONTAL	<input type="checkbox"/>	<input type="checkbox"/>	KV.CR.DGY.0416.GL
Second Ensuite	8" X 10" SERPENTINE BEYAZ WHITE - YOGA	<input type="checkbox"/>	<input type="checkbox"/>	TR.ST.BYZ.WHT.0810
TWIN BATH	12" X 24" ALLURE POLISHED GREY - HORIZONTAL	<input type="checkbox"/>	<input type="checkbox"/>	QT.AU.GRY.1224.PL
ENSUITE 4	12" X 24" ALLURE POLISHED GREY - HORIZONTAL	<input type="checkbox"/>	<input type="checkbox"/>	QT.AU.GRY.1224.PL
Kitchen Backsplash		<input type="checkbox"/>	<input type="checkbox"/>	
Complete Backsplash		<input type="checkbox"/>	<input type="checkbox"/>	

Comment
MASTER ENSUITE AND YOGA SHOWER STALL - 2 X 2 MOSAIC TENDER GREY (OD.ON.TGR.0202.MT.N)
ENSUITE 4 SHOWER STALL - 2 X 2 MOSAIC TAUPE (OD.ON.TPE.0202.MT.N)
WALL/FLOOR TILES IN SHOWER STALLS & TUB ENCLOSURE TO BE INSTALLED HORIZONTAL

5. Fireplace

	Living Room			Family Room			Other Room - Specify		
	Purchased	As Per Plan	N/A	Purchased	As Per Plan	N/A	Purchased	As Per Plan	N/A
Fireplace Type	<input type="radio"/>	<input type="radio"/>	<input type="radio"/>	<input type="radio"/>	<input checked="" type="radio"/>	<input type="radio"/>	<input type="radio"/>	<input type="radio"/>	<input type="radio"/>
Mantle Type				STANDARD BLACK INSERT					
Over Mantle				MILLA NOVA					
Colour / Stain									
Surround									
Hearth									
Comment									

Initial:



INTERIOR COLOUR SCHEME

Ph 2#13.

Purchaser: RUHI JAFFER
Telephone Res. / Bus: (416) 834-7867 /
Decor Advisor: Steffannee Appio

Property: 18 of Plan -
Project: Carrville Investments Ltd.
Model and Elevation: The Ferrara (50-3) Elev A

6. Trim Carpentry

Door Hardware STANDARD

Interior Trim STANDARD

Comment

Interior Doors

- ☐ 2 Panel Arch Top
☒ 2 Panel Square Top
☐ 6 Panel

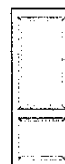

Initial for Door Style RS

7. Railings and Pickets

Railing Package STANDARD

Railing Colour GOTHAM

Wood Stairs ☐ No ☒ Oak

Picket Colour FLAT BLACK METAL

Tread Colour GOTHAM

Comment

STAIN STAIRS TO COMPLEMENT HARDWOOD - GOTHAM

8. Plaster Mouldings and Medallions

Foyer

Main Hall

Living Room

Dining Room

Family Room

Comment

Kitchen/Breakfast

Den/Library

Lower Landing

9. Wall Paint

STANDARD SENATOR WHITE

Smooth Ceilings

- ☐ First Floor
☐ First Floor incl. Second Floor Hall
☐ First and Second Floor
☒ Throughout
☐ Not Applicable

Trim Paint

10. Additional Comments

11. Disclaimers and Notes

- Colours of all materials are as close as possible to builder's selection, but not necessarily identical due to variances in manufacturing.
- Any extras listed above are null and void unless accompanied by a separate invoice/amendment. Said invoice must be paid in full.
- The Purchaser acknowledges that after Interior Colour Selection form is signed and dated, no further changes will be permitted other than re-selection due to unavailability. Purchaser's Initials
- The Purchaser acknowledges reading and accepting the "Senator Homes Décor Centre Disclaimers" form. This document contains other miscellaneous disclaimers.

This Interior Colour Selection is final and approved by:

Purchaser:

Signature: RS

Date: 9/28/17

Vendor:

Carrville Investments Ltd.

FERRARA

ELEV. A 4,603 SQ.FT. | ELEV. B 4,574 SQ.FT.

Pr 2#18.

This sketch is provided solely for
noted on the accompanying "U
details, dimensions & layouts are
only a may not be applicable

Site Car 2
Date 8/14/17
Purchaser Initials _____ Prod

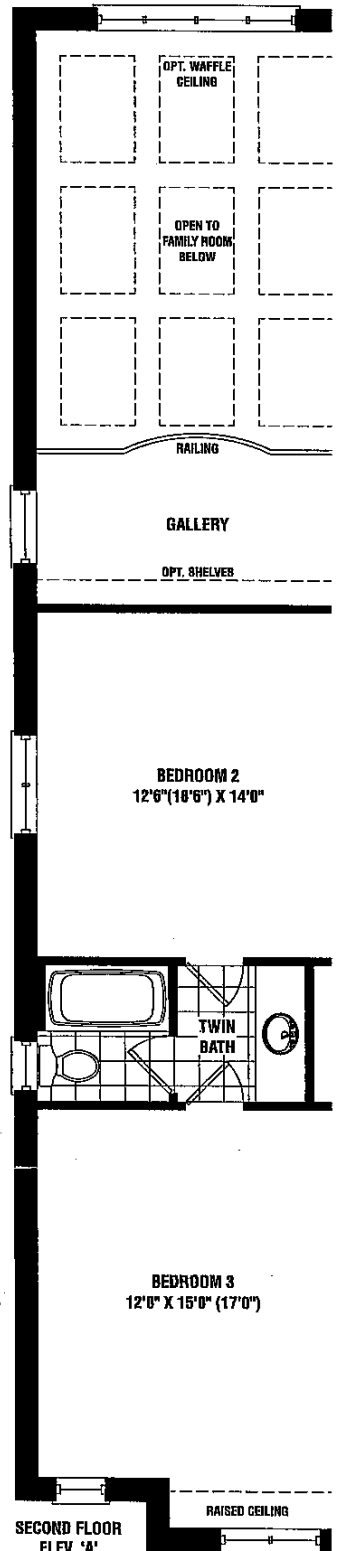
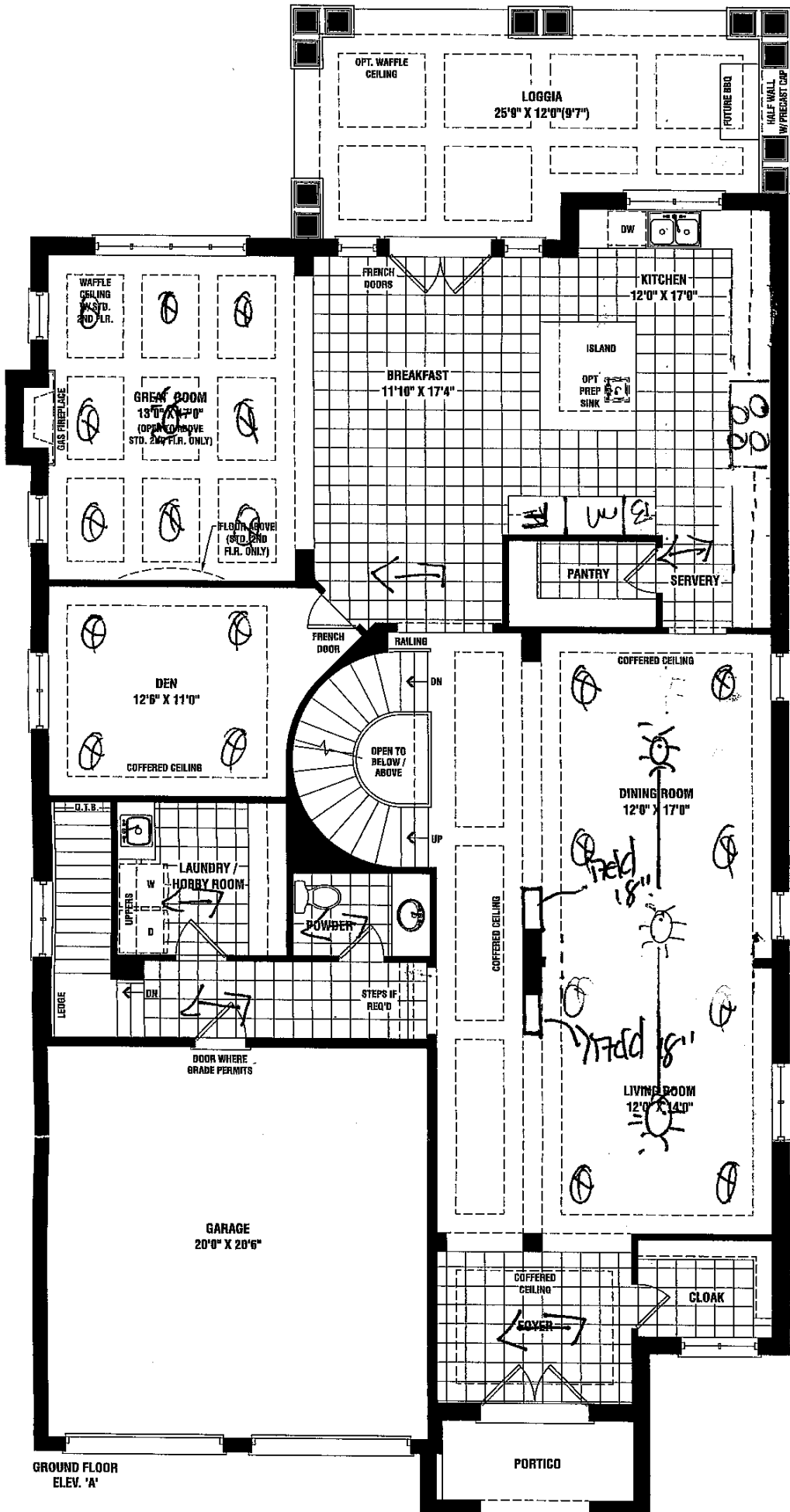

Car 2 8/14/17 18

 Date: _____

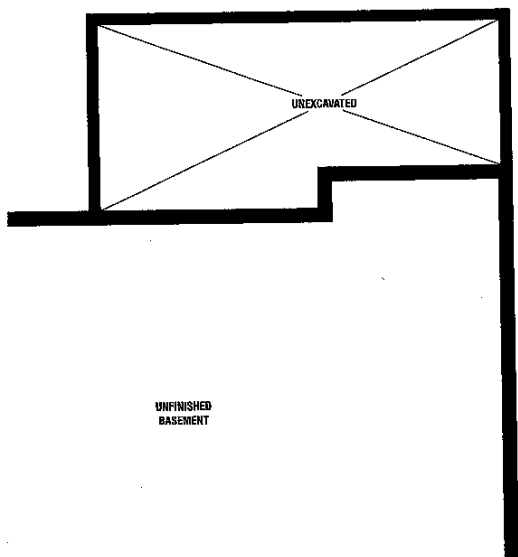

- (2) Delete w.i.c. in bed #5
- (3) Double door entry (bed 4/5)
- (4) Shower in lieu of tub
- (5) Larger vanity with offset sink

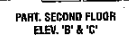

**PART. OPT. SECOND FLOOR
ELEV. 'B' & 'C'
5 BEDROOM / YOGA ROOM**

WALL CABINETS NOT INCLUDED
(AS PER ARCHITECTURAL DWGS)

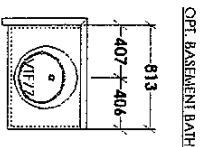
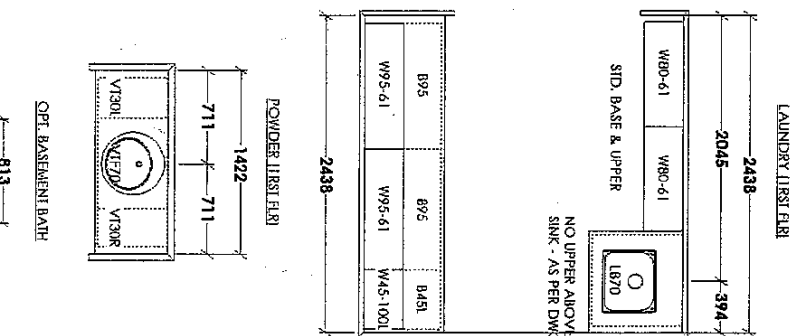

(1) stacked ops

F R E N D E Y
K I T C H E N S L I M I T E D
1350 Sheppard Drive, Mississauga, ON L4W 1G5



SENATOR HOMES
RICHVALE PHASE 2
MODEL: FERRARA
50-3 (1st FLR)

STANDARD CONTRACT INCLUDES:

- Kitchen**
 - Canopy Hood 104 +/- cm Wide opening
 - Deep fridge 95cm Wide - gables at exposed ends
 - Slide in range 92 Wide opening
 - Soft close hinges
 - Elite collections receive soft close Tandem drawers
 - Pots and pan drawers (x2 sets)
 - 1 bank of 4 drawers
 - Crown moulding
 - Light valance
 - Backing on all cabinets (excluding sink base)
 - Countertop by others
- Vanity**
 - Vanities - 80cm H
 - Vanities are 53.4cm Deep
 - Vanities include top drawers
 - Soft close hinges
 - Elite collections receive soft close Tandem drawers
 - Countertop by others

THIS DRAWING IS FOR DESIGN PURPOSES ONLY.
IT IS NOT AN EXACT REPRESENTATION.

5/9/2017

Hand-drawn diagram of a 4x4 grid representing a 16-bit register. The columns are labeled 'b', 'd', 'e', and 'f' at the top. The rows are labeled 'ind', 'ind', 'ind', and 'ind' on the right side. The first row contains 'ind', 'ind', 'ind', and 'ind'. The second row contains 'ind', 'ind', 'ind', and 'ind'. The third row contains 'ind', 'ind', 'ind', and 'ind'. The fourth row contains 'ind', 'ind', 'ind', and 'ind'. An arrow labeled 'micro' points to the second column. An arrow labeled 'flip up doors' points to the top of the grid. An arrow labeled 'door' points to the first row.

This sketch is provided solely for reference to those items noted on the accompanying "Licenses/Extras". All other details, dimensions & layouts are for illustrative purposes only and may not be applicable to the Purchaser's Model.

Site Car 2 Lot 18
Date 8/22/17
Purchaser Initials _____ Production Initials _____

lot # 18 M/D

Ph 2 #18.

STANDARD 2ND FLR - ELEV. A, B, C

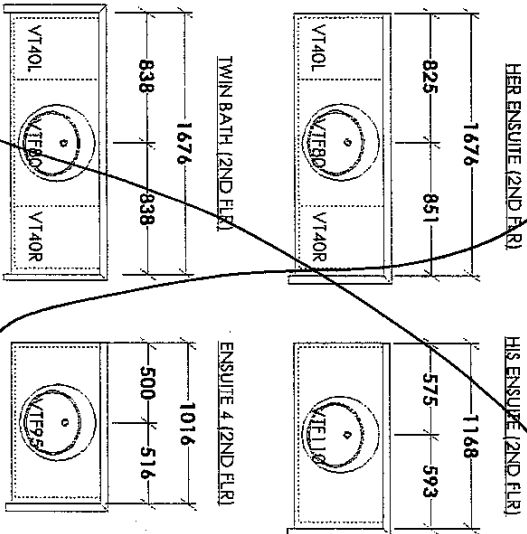

OPT. 2ND FLR - ELEV. A, B, C - 5 BEDROOM - YOGA RM

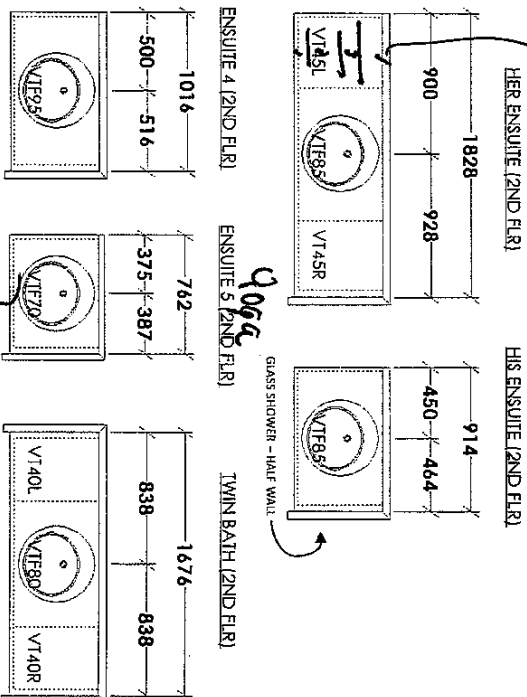

Knobs

Yoga

Yoga Room Bedroom

Yoga Room Bedroom
Sink is offset and vanity size
increased, measure on site
Add bank of drawers



SENATOR HOMES
RICHVALE PHASE 2
MODEL: FERRARA
50-3 (2nd FLR)

STANDARD CONTRACT INCLUDES:

- Vanity**
- Vanities - 80cm H
 - Vanities are 53.4cm Deep
 - Vanities include top drawers
 - Soft close hinges
 - Elite collections receive soft close Tandem drawers
 - Countertop by others

DRAWING IS FOR DESIGN PURPOSES ONLY.
IT IS NOT AN EXACT REPRESENTATION.
5/9/2017

hot 18- dec 2

hotis-Cora
9/13/17

42" BUILT-IN FRENCH DOOR REFRIGERATOR/FREEZER WITH INTERNAL DISPENSER

SUB-ZERO

BI-42UFDID/S

More
Senator
Lot 18



FEATURES

- Discreet interior water dispense with advanced filtration
- LED Lighting for brighter interior
- Maximum capacity in a 42" French door model
- Dual refrigeration keeps food fresher longer
- Air purification system fights spoilage, odors
- Crispers and deli drawers in low-temp, high-humidity zones for optimum freshness
- Microprocessor control assures peak performance
- Two-column shelving for customized storage
- Soft-close deli drawer for meats, cheeses and more
- Freshness cards for maximum food preservation
- Adjustable shelves for maximum convenience
- Rigorously tested in our U.S. manufacturing facilities to ensure decades of use
- Exceptional 24/7 support from Madison, WI-based Customer Care team
- Over-and-under refrigerator/freezer storage
- Magnetic door seal system locks in cold air
- Automatic ice maker with "max ice" feature

ACCESSORIES

- Air Purification Cartridge
- Built-In Custom Side Panel Mounting Kit
- Egg Container
- Stainless Steel Side Panel
- Water Filter 4204490
- White Side Panel
- Stainless steel kickplate
- Grilles for 83" or 88" finished height (84" is standard)
- Side panel mounting kit

Accessories are available through an authorized Sub-Zero dealer.
For local dealer information, visit subzero-wolf.com/locator.

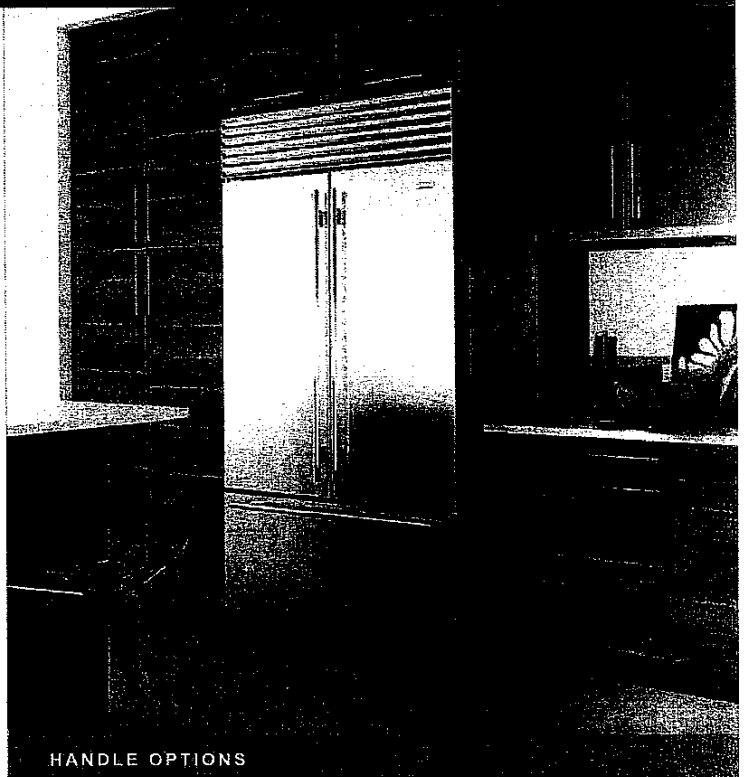

HANDLE OPTIONS

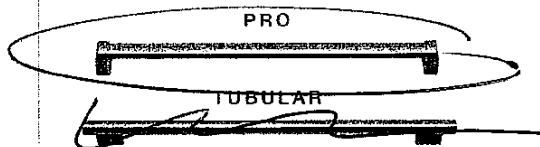

PRODUCT DETAILS

REFRIGERATOR

- 6 Adjustable glass shelves
- 1 Stationary glass shelf
- 1 Deli drawer with dividers
- 2 Crisper drawers
- 4 Adjustable door shelves
- 2 Stationary door shelves
- 2 Adjustable dairy compartments

FREEZER

- Full-extension roll-out freezer drawer
- Two-tier wire storage baskets
- Automatic ice maker

hot18-Cor2
9/13/17

42" BUILT-IN FRENCH DOOR REFRIGERATOR/FREEZER WITH INTERNAL DISPENSER SUB-ZERO

PRODUCT SPECIFICATIONS

Model	BI-42UFDID/S
Dimensions	42"W x 84"H x 24"D
Door Clearance	22 1/4"
Drawer Clearance	23 5/8"
Weight	582 lbs
Refrigerator Capacity	17.9 cu. ft.
Freezer Capacity	6.3 cu. ft.
Electrical Supply	115 VAC, 60 Hz
Electrical Service	15 amp dedicated circuit
Receptacle	3-prong grounding-type

ELECTRICAL

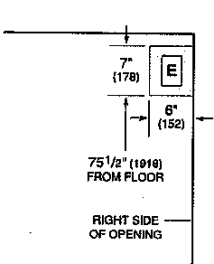

PLUMBING

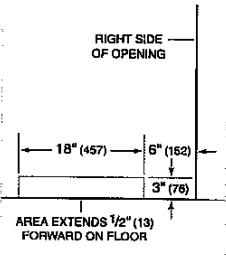

NOTE:
Dimensions in parenthesis are in millimeters unless otherwise specified

INTERIOR VIEW

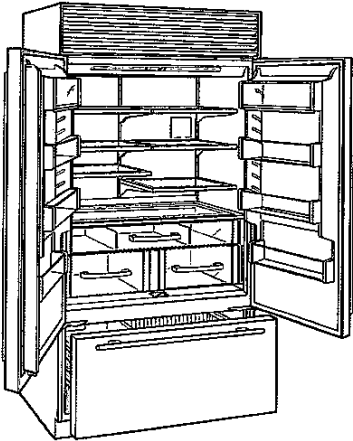

This illustration is intended for interior reference only and may not represent the exterior of the model being specified.

DIMENSIONS

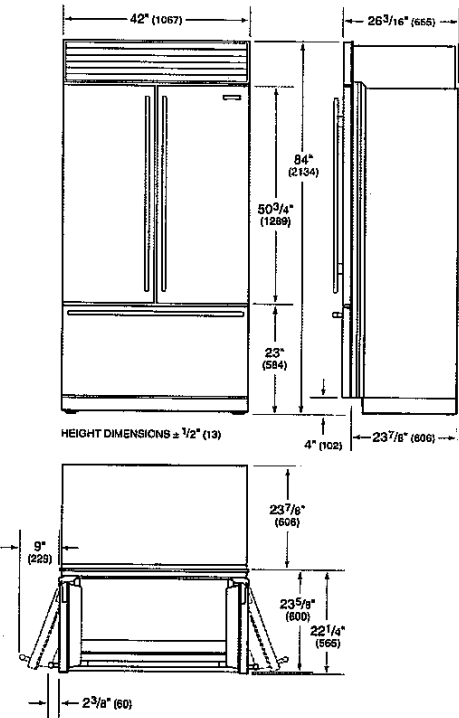

STANDARD INSTALLATION

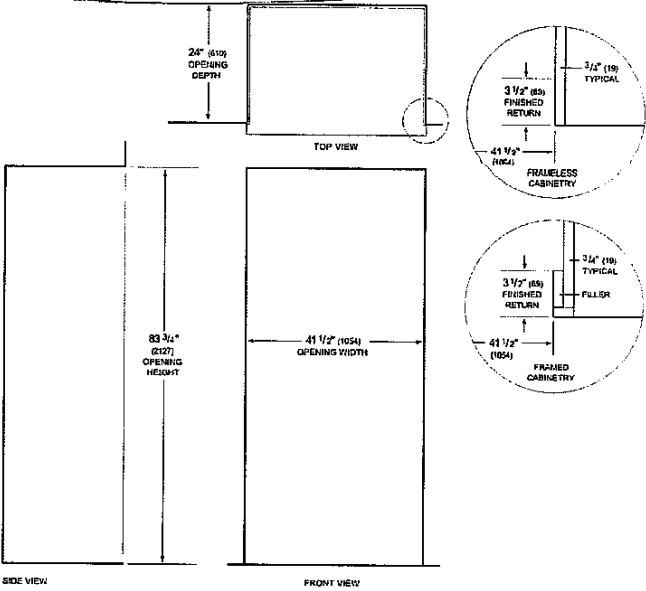

NOTE: 3/16" (5mm) finished returns will be visible and should be finished to match cabinetry. Shaded line represents profile of unit.

hotis-carz
9/13/17

36" GAS RANGE - 4 BURNERS AND INFRARED GRIDDLE

GR364G



FEATURES

- 4 dual-stacked burners plus 15,000 Btu infrared griddle
- Convection oven for faster, more consistent cooking
- Dual-stacked, sealed burners for higher highs, lower lows
- Infrared broiler inside oven sears quickly and evenly
- Heavy-gauge stainless steel
- Continuous cast-iron grates for easy movement of pots and pans
- Rigorously tested in our U.S. manufacturing facilities for decades of use
- Exceptional 24/7 support from our Customer Care team in Madison
- Signature red infinite control knobs
- Spark ignition system re-ignites if flame goes out
- Adjustable legs for stability, plus rear casters

ACCESSORIES

- 11" Cutting Board
- Stainless Steel Kickplate
- Bake stone kit (stone, rack and peel)
- Stainless steel, brass or chrome bezels
- High altitude conversion kit
- Full-extension easy glide oven rack
- Cast Iron S-grates and wok grate
- Stainless steel kickplate
- Signature red, black or stainless steel control knobs
- Front leg covers
- 5" and 10" stainless steel risers, and 20" riser with shelf

Accessories available through an authorized Sub-Zero dealer.
For local dealer information, visit subzero-wolf.com/locator.



KNOB OPTIONS



TOP CONFIGURATION

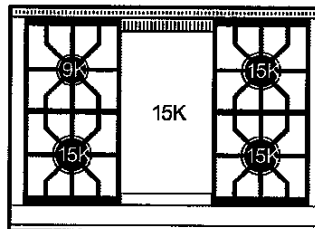

RANGETOP SPECIFICATIONS

- 1 - 9,200 Btu Burner
- 3 - 15,000 Btu Burners
- 1 - 15,000 Btu (13,000 Btu LP) Griddle

Lot 18-Cara2
9/13/17

36" GAS RANGE - 4 BURNERS AND INFRARED GRIDDLE



PRODUCT SPECIFICATIONS

Model	GR364G
Dimensions	35 7/8"W x 37"H x 28 3/8"D
Oven 1 Interior Dimensions	30"W x 18 5/8"H x 17"D
Oven 1 Usable Capacity	3.7 cu. ft.
Oven 1 Overall Capacity	5.5 cu. ft.
Door Clearance	19 1/2"
Weight	470 lbs
Electrical Supply	110/120 VAC, 50/60 Hz
Electrical Service	15 amp dedicated circuit
Gas Supply	3/4" ID line
Gas Inlet	1/2" NPT female
Receptacle	3-prong grounding-type

DIMENSIONS

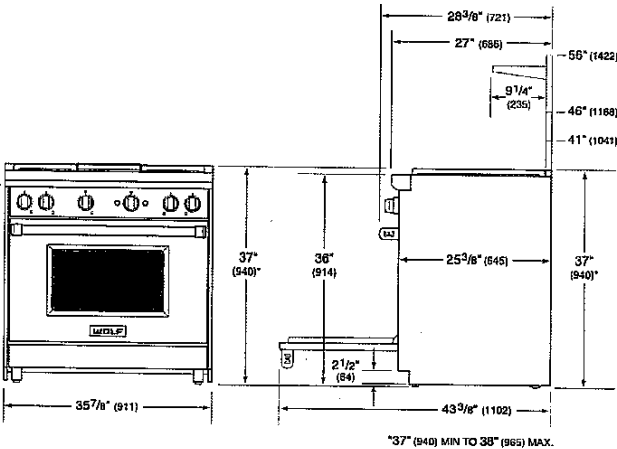

STANDARD INSTALLATION

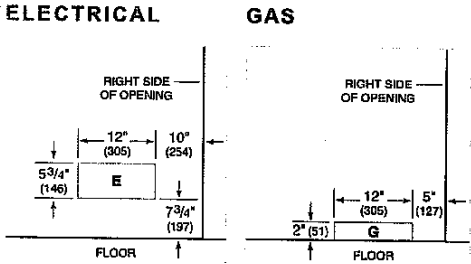

NOTE:

Dimensions in parenthesis are in millimeters unless otherwise specified

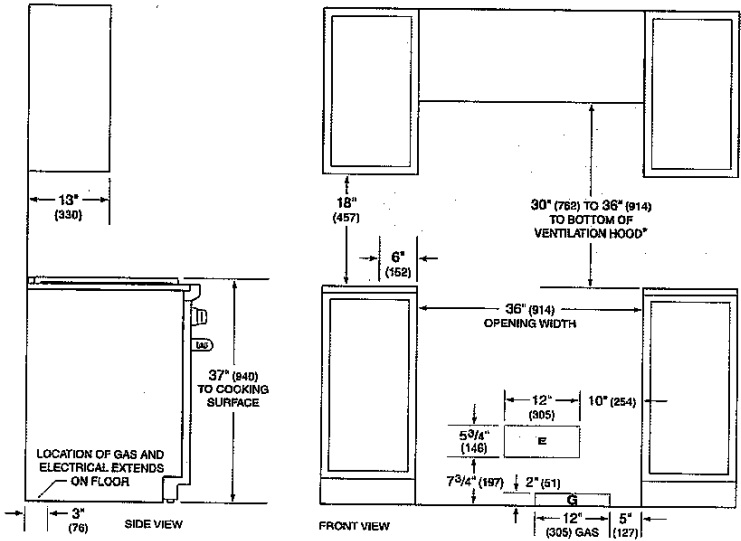

*Without ventilation hood, 42" (1067) minimum clearance countertop to combustible materials, charcoal requires non-combustible materials.
NOTE: Shaded area above countertop indicates minimum clearance to combustible surfaces, combustible materials cannot be located within this area.
For island installation, 12" (305) minimum clearance back of range to combustible rear wall above countertop.

Lot 18- dar2
9/13/17

30" WARMING DRAWER

WWD30



FEATURES

- Temperature range of 80°F to 200°F
- 30" wide, it's spacious enough for an entrée and several sides
- Matches Wolf ovens and ranges, or accepts custom panel
- Hidden electronic controls
- Automatic shut-off
- Rigorously tested in our U.S. manufacturing facilities for decades of use
- Exceptional 24/7 support from our Customer Care team in Madison
- UL approved for warming towels
- Four preset temperatures make it easy to warm favorite foods
- Fan assist for even heat distribution that keeps juicy foods juicy, crisp foods crisp
- Removable rack lets you double-stack items
- Full-extension drawer for easy access to foods
- Removable stainless steel drawer pan for easy clean-up

ACCESSORIES

- 30" Contemporary E Series Front Panel
- 30" Contemporary Stainless M Series Front Panel
- 30" Professional Drawer Front - M Series
- 6-Piece Container Set
- Contemporary Handle- E Series
- Contemporary/Transitional Handle
- Professional Handle-E Series
- Professional Handle-M Series
- Transitional Handle- M Series

Accessories available through an authorized Sub-Zero dealer.
For local dealer information, visit subzero-wolf.com/locator.

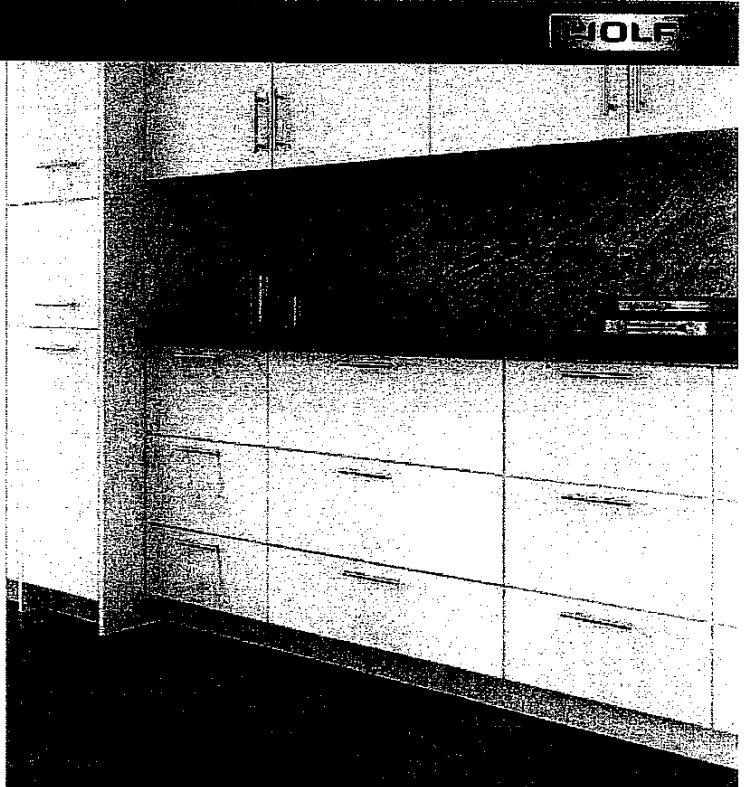

FRONT PANEL OPTIONS

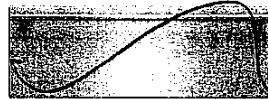

30" E SERIES TRANSITIONAL

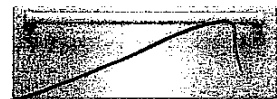

30" E SERIES PROFESSIONAL



30" E SERIES CONTEMPORARY



30" M SERIES CONTEMPORARY



30" M SERIES TRANSITIONAL



30" M SERIES CONTEMPORARY STAINLESS

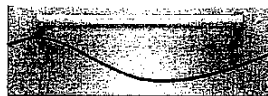

30" M SERIES PROFESSIONAL



30" L SERIES



30" INTEGRATED

panel front

Lot 18 Car 2
9/13/17

WARMING DRAWERS

Warming Drawers

Wolf warming drawers are designed to take care of prepared foods until it's time to serve them. You can adjust the temperature, keeping moist foods moist and crisp foods crisp. Warming drawers are ideal for proofing dough. They can also be used to warm robes and towels. Drawer fronts are available to match the look of Wolf ovens, sealed burner rangetops and outdoor grills. The integrated drawer front allows for a custom panel and handle. Model WWD300, approved for outdoor installations, is ideal for any outdoor kitchen.

WARMING DRAWER FRONTS

M/E SERIES



TRANSITIONAL

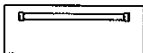

PROFESSIONAL



CONTEMPORARY

L SERIES



TRANSITIONAL

INTEGRATED



CUSTOM PANEL

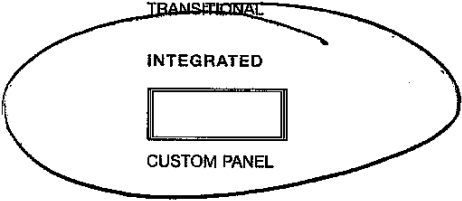

WARMING DRAWERS

Warming Drawers

DRAWER FRONT OPTIONS

Wolf warming drawer fronts allow for many design options, but the warming drawer itself will be the same for all applications. A panel mounting kit is required when installing a custom panel. The panel mounting kit is available through an authorized Wolf dealer. For local dealer information, visit the find a showroom section of our website, wolfappliance.com.

The 2" (51) thick drawer front, in 30" and 36" widths, is designed to be installed below a sealed burner rangetop or outdoor gas grill, so the panel aligns properly with the front of the rangetop or grill. Dimensions for the warming drawer remain the same, even though the drawer front may be wider to match a Wolf 36" oven, sealed burner rangetop or outdoor grill.

DIMENSIONS

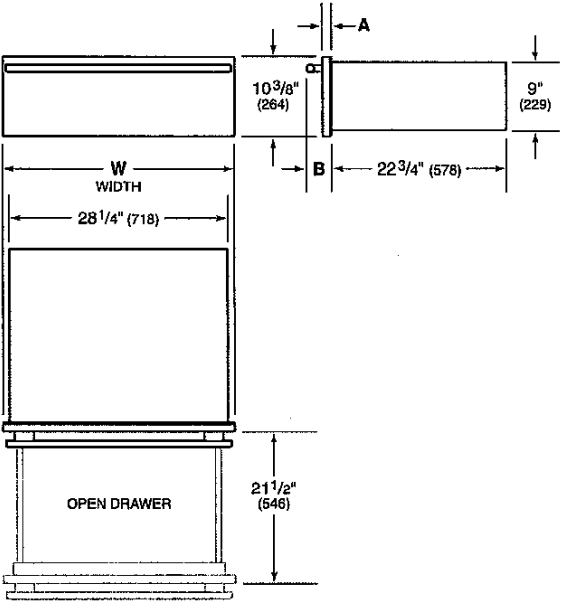

STAINLESS STEEL DRAWER FRONT

WIDTH	W	
30" Drawer Front	29 7/8"	(759)
36" Drawer Front	35 7/8"	(911)
M SERIES	A	B
Transitional/Professional	7/8" (22)	3 1/4" (83)
Contemporary Stainless	7/8" (22)	3 1/4" (83)
Contemporary Black	1" (25)	3 3/8" (86)
E SERIES	A	B
Transitional/Professional	1 1/8" (29)	3 1/2" (89)
Professional (2" thick)	2 1/8" (54)	4 1/2" (114)
Contemporary	1 1/4" (32)	3 5/8" (92)
L SERIES	A	B
Transitional	7/8" (22)	3 1/2" (89)

INTEGRATED DRAWER FRONT

CUSTOM PANEL	W	H	D
Dimensions (typical)	29 7/8" (759)	10 3/8" (264)	3/4" (19)
Min Thickness			5/8" (16)

Lot 18 Car 2
9/13/17

Lot 18-Car 2
9/13/17

WARMING DRAWERS

Planning Information

The warming drawer must be installed with a Wolf drawer front, available through an authorized Wolf dealer. For local dealer information, visit the find a showroom section of our website, wolfappliance.com. Specific installation instructions are included with the drawer front.

The warming drawer can be installed in a standard or flush inset application (excludes L series drawer front).

For a standard installation, the drawer collar and front panel sit proud of the cabinet face frame. A recessed installation requires the cabinetry be recessed by 3/16" (5) so the collar is flush with the cabinet face frame but the drawer front will sit proud. A flush inset installation (excludes L series) requires the drawer collar and front panel be recessed to be flush with surrounding cabinetry. Refer to illustrations on the following pages for minimum cabinet dimensions for your specific installation.

Finish the edges of the opening. They may be visible when the drawer is open.

For standard installations, face trim will overlap stiles and rails. Refer to the chart below.

For flush inset installations, a minimum 1/8" (3) reveal is required on all sides. To ensure consistent reveals, each corner of the opening must be exactly 90°.

Model WWD300 is CSA approved for outdoor installations.

INSTALLATION REQUIREMENTS

Min Base Support	200 lb (90 kg)
Trim Overlap (top, bottom, sides)	5/8" (16)

ELECTRICAL

Installation must comply with all applicable electrical codes.

Locate the electrical supply flush with the back wall and within the shaded area shown in the illustrations on the following pages. For ease of installation, the electrical supply for the warming drawer can be placed in an adjacent cabinet within reach of the power cord.

IMPORTANT NOTE: When installed outdoors, a ground fault circuit interrupter (GFCI) is required to reduce the risk of electrical shock.

ELECTRICAL REQUIREMENTS

Electrical Supply	grounded, 120 VAC, 60 Hz
Service	15 amp dedicated circuit
Receptacle	3-prong grounding-type
Power Cord	3' (.9 m)

BUILT-IN OVENS

COOK TOPS | COFFEE

RANGES | RANGERS

OUTDOOR GRILLS

VENTILATION

WARMING DRAWERS

Warming Drawer
STANDARD INSTALLATION

option #1

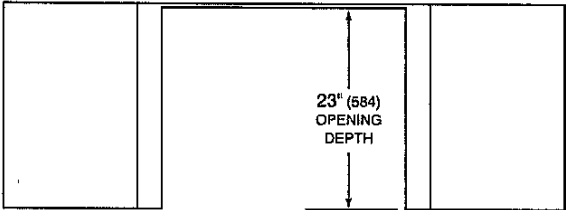

TOP VIEW

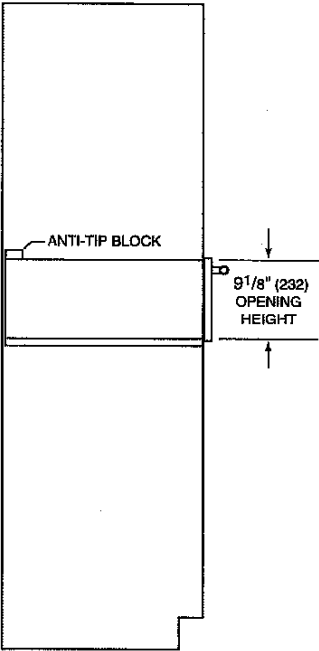

SIDE VIEW

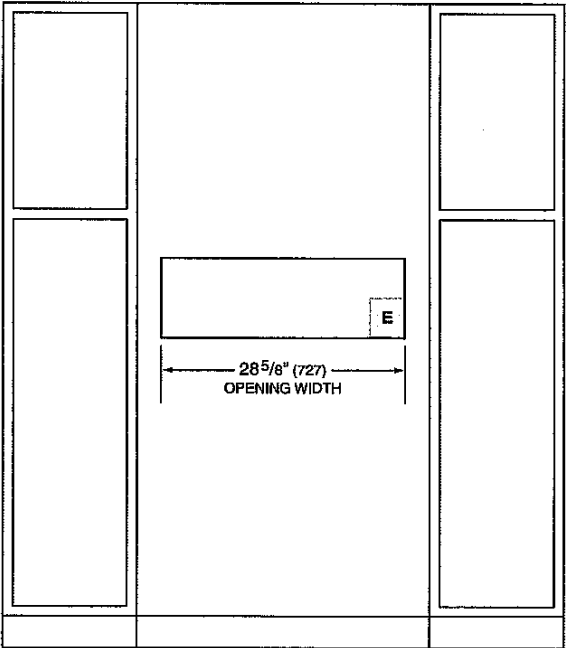

FRONT VIEW

NOTE: Location of electrical supply within opening may require additional cabinet depth.

WARMING DRAWERS

option #2

Warming Drawer

FLUSH INSET INSTALLATION

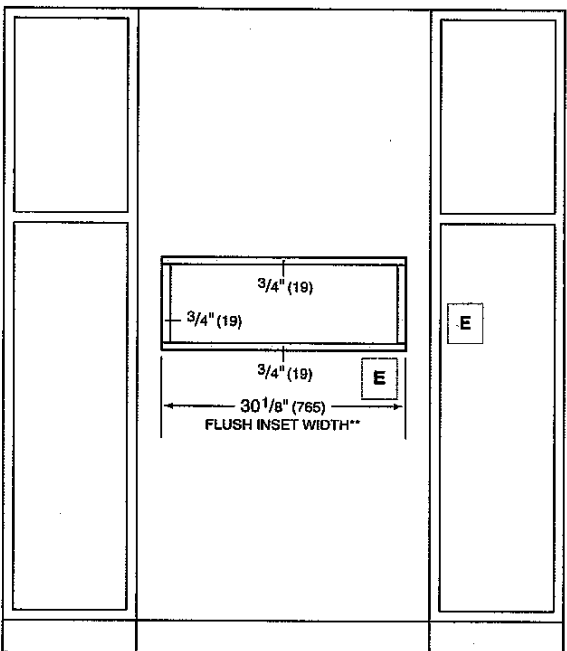
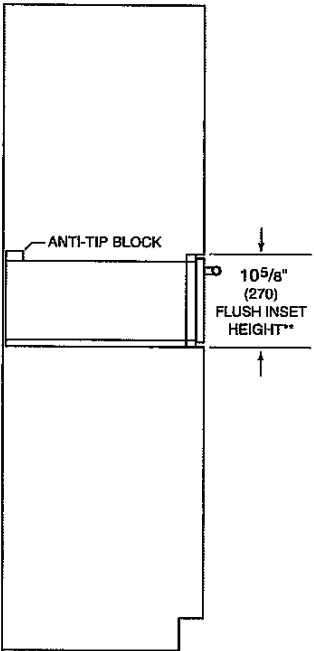
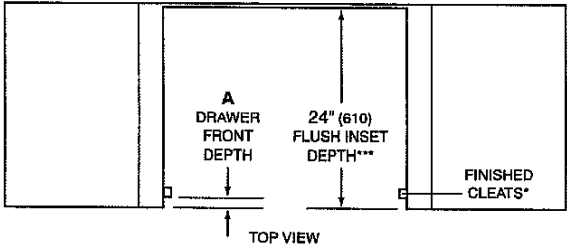

SIDE VIEW

FRONT VIEW

*Will be visible and should be finished to match cabinetry.

**Dimension provides minimum reveals.

***24 1/8" (613) for E series contemporary drawer front.

NOTE: Location of electrical supply within opening may require additional cabinet depth.

DRAWER FRONT DEPTH (A)	M SERIES	E SERIES
Transitional/Professional	7/8" (22)	1 1/8" (29)
Professional (2" thick)	NA	2 1/8" (54)
Contemporary Stainless	7/8" (22)	NA
Contemporary Black	1" (25)	1 3/8" (35)

Custom front panel depth is dependent on panel thickness. Add 1/4" (6) to the panel thickness to determine the drawer front depth.

Lot 18 Cara
9/13/17

24" UNDERCOUNTER BEVERAGE CENTER - STAINLESS DOOR

SUB-ZERO

UC-24BG/S



FEATURES

- Compact unit fits in anywhere
- Roller-glide wine shelf holds eight 750 ml bottles
- Spill-proof glass shelves for easy clean-ups
- Bright interior lighting
- Clear-view, triple-pane and UV-resistant glass door
- Easy-access touch control panel
- Clear utility bin for smaller items
- Rigorously tested in our U.S. manufacturing facilities to ensure decades of use
- Exceptional 24/7 support from Madison, WI-based Customer Care team

ACCESSORIES

- Dual Installation Kit
- Silver Dual Kickplate
- Undercounter Black Dual Kickplate
- Undercounter Door Lock Kit
- Undercounter Solid Overlay Door
- Adjustable glass shelf
- Adjustable wine storage shelf

Accessories are available through an authorized Sub-Zero dealer.
For local dealer information, visit subzero-wolf.com/locator.

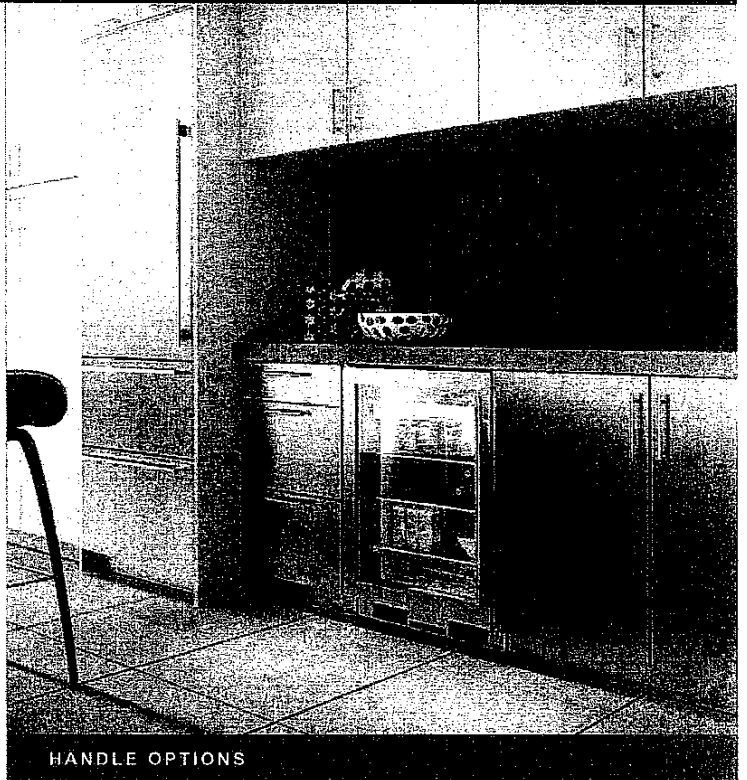

HANDLE OPTIONS

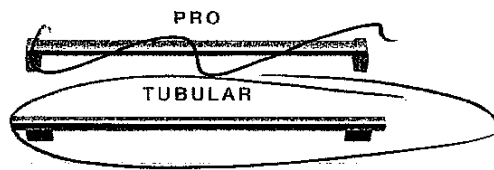

PRODUCT DETAILS

REFRIGERATOR

- 1 Adjustable wine storage rack
- 2 Adjustable glass shelves
- 1 Stationary glass shelf
- Utility bin

hinged or
Right
please
confirm

Lot 18. Car 2
9/13/17

24" UNDERCOUNTER BEVERAGE CENTER - STAINLESS DOOR

SUB-ZERO

PRODUCT SPECIFICATIONS

Model	UC-24BG/S
Dimensions	23 7/8"W x 34"H x 24"D
Door Clearance	23 3/8"
Weight	130 lbs
Refrigerator Capacity	6 cu. ft.
Electrical Supply	115 VAC, 60 Hz
Electrical Service	15 amp dedicated circuit
Wine Storage Capacity	8 Bottles
Receptacle	3-prong grounding-type

ELECTRICAL

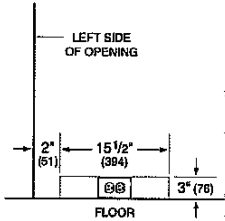

NOTE:

Dimensions in parenthesis are in millimeters unless otherwise specified

INTERIOR VIEW

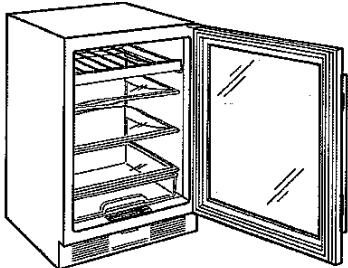

This illustration is intended for interior reference only and may not represent the exterior of the model being specified.

DIMENSIONS

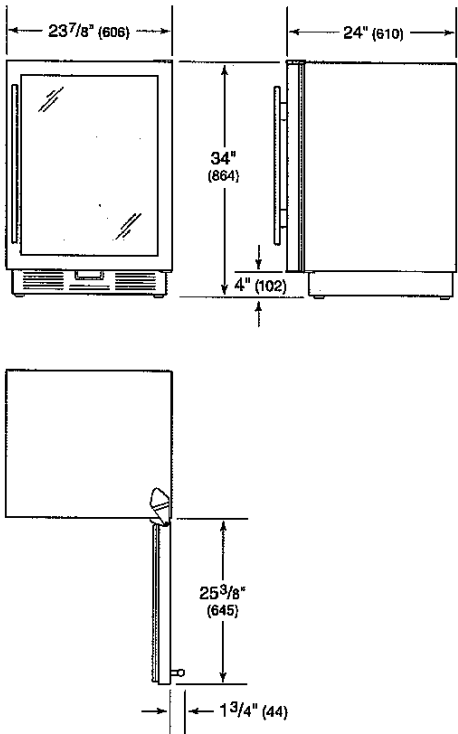

STANDARD INSTALLATION

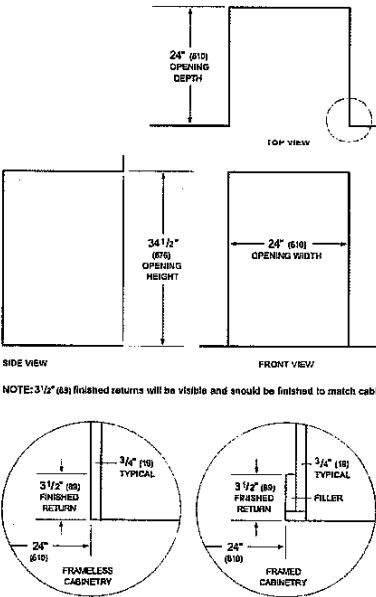



Microwave Ovens Cyclonic Inverter™
Countertop NN-SD786S

+ 26 1/2" trim kit

MODEL & SIZE	Model Number	NN-SD786S
	Type	Full Size
	Installation	Counter Top or Built-in
	Oven Capacity	1.6 cu. ft.
	Cooking Power	1,200 Watt
PANASONIC TECHNOLOGY	Turntable Diameter	15"
	Parasonic Inverter®	Inverter®
	Sensor	Prestige® Genius®
	Colour	Fingerprint Resistant Stainless Steel
	Control Panel	"Flashing Blue" Ring Dial with Button Panel
DESIGN	Display Panel	"Blue" 6-Digit Expanded Display
	Cooking Options	Microwave Cooking
	Door Front	Stainless Steel
	Door Window	Reflective Mirror Finish
	Exterior Wrap	Stainless Steel
STYLE	Door Release	Push Button

Lot 18 per 2
9/13/17

Lot 18 para
9/13/17

PERFORMANCE		Oven Interior	Epoxy
PERFORMANCE	Power Settings		10 levels
	Multi-stage Cooking		5 stages
	Automatic Turntable		Revolving & Removable
	Menu Action Screen		Interactive Multi-Lingual
	Sensor Cook		Sensor 18 Menu Items
PROGRAMMABLE FEATURES	Sensor Reheat		yes
	More / Less Control		yes
	Inverter® Turbo Defrost		yes
	Keep Warm Button		yes
	Popcorn Button		yes
SPECIFICATIONS	Quick Minute		yes
	Delay Start		yes
	Delay Timer		yes
	Power Requirements		120 V 60 Hz; 12.7 A, 1,460 Watt; AC only
	Cavity Dimensions (W x D x H)		418 x 470 x 229 mm 16.4 x 18.5 x 9 inch
	Unit Dimensions (W x D x H)		556 x 506 x 303 mm 21.9 x 19.9 x 12 inch
	Carton Dimensions (W x D x H)		625 x 533 x 375 mm (24-5/8" x 21" x 14-3/4")

9/9/2017

ACCESSORIES	TRIM KITS	Net Weight	Approx. 14.3 kg (32 lb)
		Gross Weight	17.7 kg (39 lb)
		27" Model Number	NN-TK729SF (stainless)
		30" Model Number	NN-TK739SF (stainless)

Copyright ©Panasonic Canada Inc.

Lot 18-Car 2
9/13/17

Lot 18-0007
9/13/17

MWTK-60

24" Stainless Steel Trim Kit

Compatible with Panasonic NNSD786, NNSD797 microwave

microwave
trim kit

 **AEG**
perfekt in form und funktion

Lot 18 cur 2
9/13/17

MWTK-60

24" / 60cm Stainless Steel Trim Kit

1. Unscrew the 4 screws holding the 2 pieces of wood in place, and retain the screws
2. Hold the MWTK-60 in place and position the 2 pieces of wood against the cabinet sides and against the MWTK. Remove the MWTK
3. Screw the 2 pieces of wood onto the base of the cabinet. The wooden strips should touch the inside of the front of the MWTK-60, and be aligned against the side gables.
(wooden stripes 18" = 46cm apart)
4. Being careful not to scratch the microwave door, lift the microwave onto the wooden strips, and move it back about 2 inches.
5. Place the MWTK-60 into position. Use the 4 screws and screw them through the flanges into the side gables.
6. Pull the microwave forward, and align the front of the microwave with the front of the MWTK-60
7. To stop the microwave from sliding backwards whilst opening it, it might be necessary to attach a piece of wood behind the feet of the microwave, on the wooden supports
8. Air must be able to flow from the microwave upwards and into the room, or roof space. Failure to comply will void the manufacturer's warranty on the micro wave oven.

Specifications are subject to change without notice
V1.0



Lot 18 Carz
9/13/17

MWTK-60

24" / 60cm Stainless Steel Trim Kit

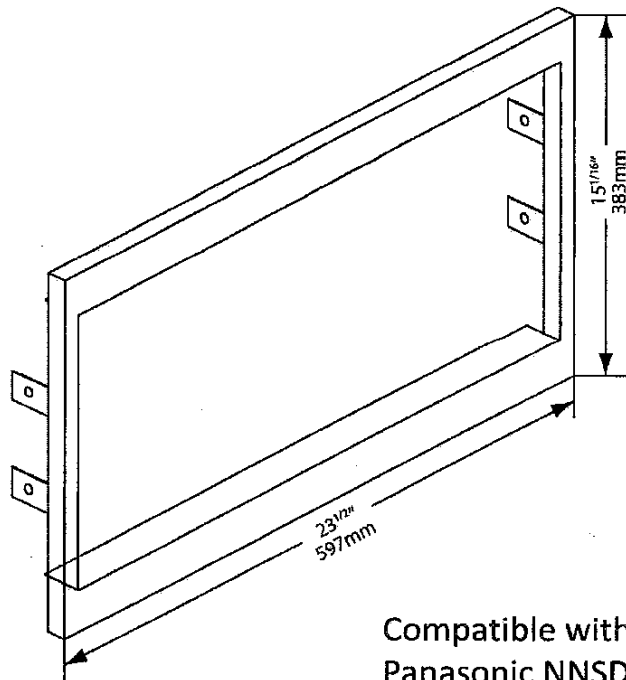
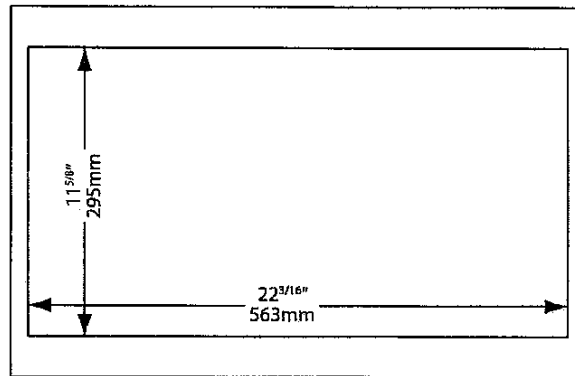
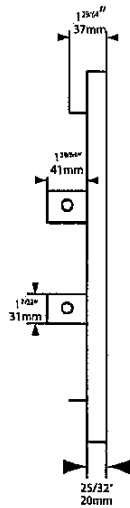

Compatible with
Panasonic NNSD786, NNSD797 microwave

Specifications are subject to change without notice
V1.0



Lot 18/cars
9/13/17

MWTK-60

24" / 60cm Stainless Steel Trim Kit

VOID CUT-OUT

1. Unscrew the 4 screws holding the 2 pieces of wood in place, and retain the screws
2. Hold the MWTK-60 in place and position the 2 pieces of wood against the cabinet sides and against the MWTK. Remove the MWTK
3. Screw the 2 pieces of wood onto the base of the cabinet. The wooden strips should touch the inside of the front of the MWTK-60, and be aligned against the side gables.
(wooden stripes 18"= 46cm apart)
4. Being careful not to scratch the microwave door, lift the microwave onto the wooden strips, and move it back about 2 inches.
5. Place the MWTK-60 into position. Use the 4 screws and screw them through the flanges into the side gables.
6. Pull the microwave forward, and align the front of the microwave with the front of the MWTK-60
7. To stop the microwave from sliding backwards whilst opening it, it might be necessary to attach a piece of wood behind the feet of the microwave, on the wooden supports
8. Air must be able to flow from the microwave upwards and into the room, or roof space. Failure to comply will void the manufacturer's warranty on the micro wave oven.

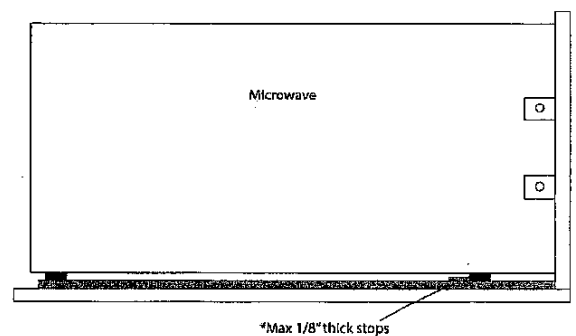
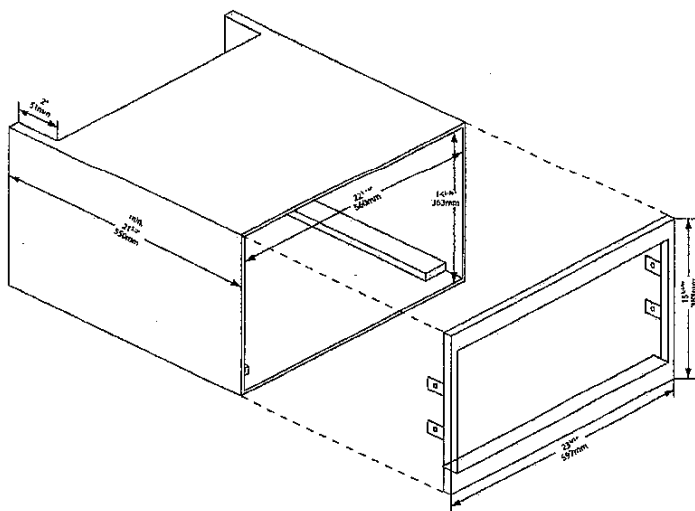

Specifications are subject to change without notice
V1.0

Lot 18 car 2
9/13/17

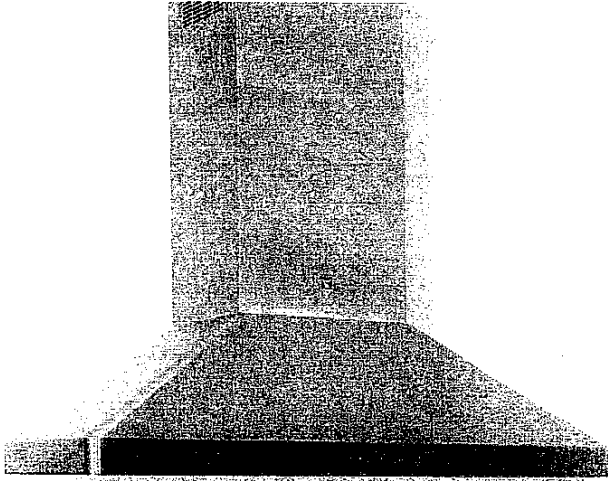

SU54

SU54

- SU54 36" 42" 48" Motor: 2 x EBM 1100 cfm (Duct Size 8")
- SU54 30" 1 x EBM 600 cfm (Duct Size 6")
- Pressure: 800 Pa
- Noise level: 66 dBA/5.1 sones



- Lighting:
 - 2x20W Halogen lamps in 30" version
 - 2x20W Halogen lamps in 36" version
 - 3x20W Halogen lamps in 42" version
 - 4x20W Halogen lamps in 48" version



- Control panel: 4 speed push-button + timer + light switch



- grease filter: commercial style baffle filters
- Stainless steel: AISI 430

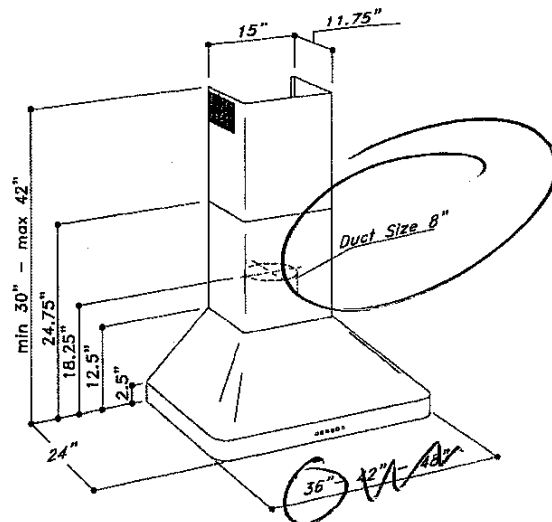
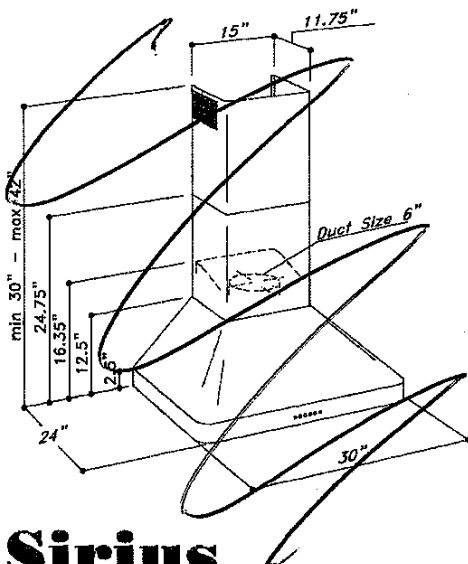

Sirius

Lot 18-der2
9/13/17

24" BUILT-IN DISHWASHER—INTEGRATED HANDLE



MODEL D5426XLS



FEATURES

- Integrated handle and front controls
- TouchProof™ stainless steel
- Condensation drying system
- 15 place-setting capacity
- Quiet operation—46 dB(A)
- 7Spray™ wash system; separate spray nozzles clean pot & pans and continuously spray cutlery basket
- 6 wash programs
- Heavy-duty stainless steel construction with nylon-coated steel racks
- Touch screen display
- Remaining time and program end indicator
- ADA height compliant

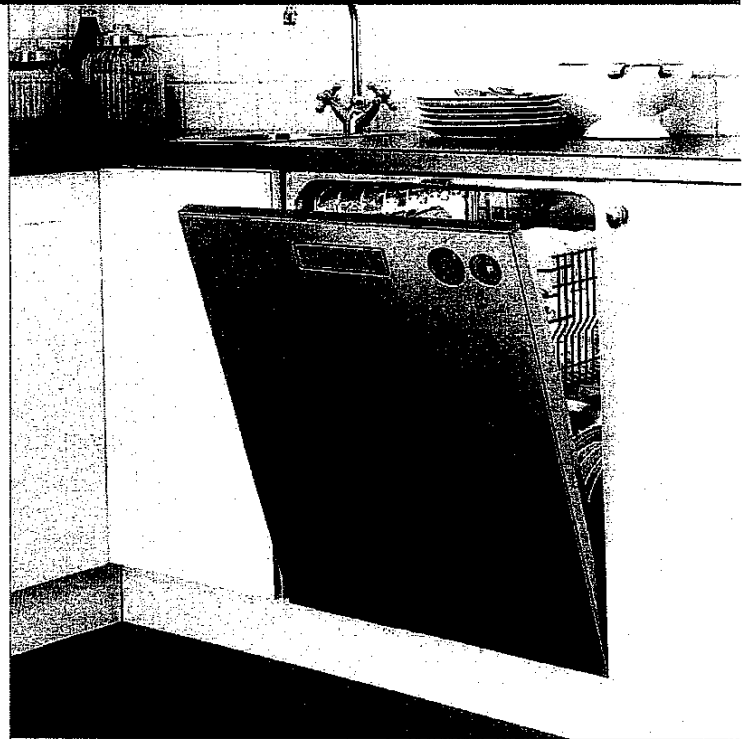

INTERIOR FEATURES

- Standard upper rack
- Standard lower rack

PROGRAMS

- Sanitation Wash
- Normal Wash
- Heavy Wash
- Quick Wash
- Eco Wash
- Rinse and Hold

Lot 18 dw
2/
9/13/17

24" BUILT-IN DISHWASHER—INTEGRATED HANDLE

ASKO
Inspired by Scandinavian

PRODUCT SPECIFICATIONS

Model	D5426XLS
Width	23 ⁷ / ₈ "
Height	32 ³ / ₄ "***–34 ⁵ / ₈ "
Depth	22 ⁷ / ₈ "
Door Clearance	24 ⁵ / ₈ "
Weight	115 lb
Max Loading Height Upper Rack	9"
Max Loading Height Lower Rack	12 ¹ / ₄ "
Electrical Supply	115 VAC, 60 Hz
Electrical Service	15 amp circuit
Plumbing Supply	1/4" OD copper, braided stainless steel or PEX tubing
Pressure	4.2–140 psi

Electrical supply, plumbing supply and drain should be located in an adjacent cabinet. If not, they must be located within the shaded area shown in the illustrations below.

ELECTRICAL | PLUMBING

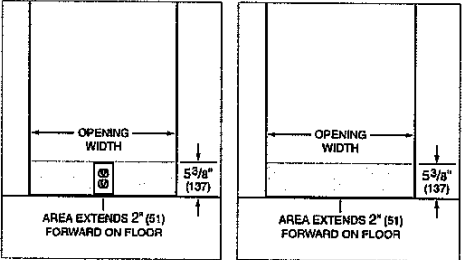

DIMENSIONS

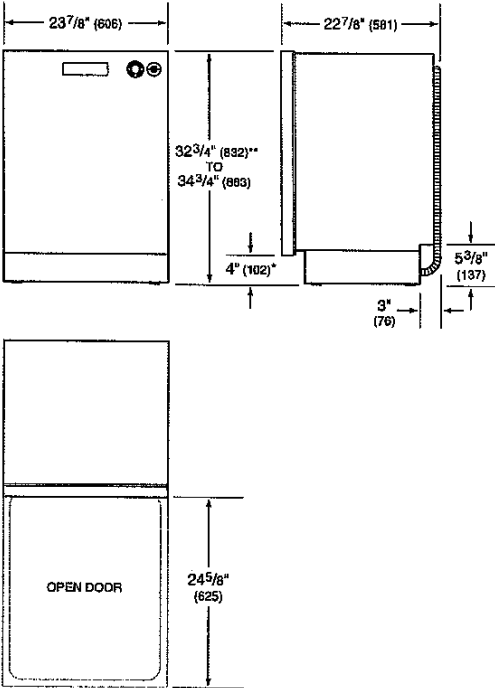

*Dimension will vary with product height.
**Can be reduced to 32 1/4" (818) by removing top trim and lowering side trim.

INSTALLATION

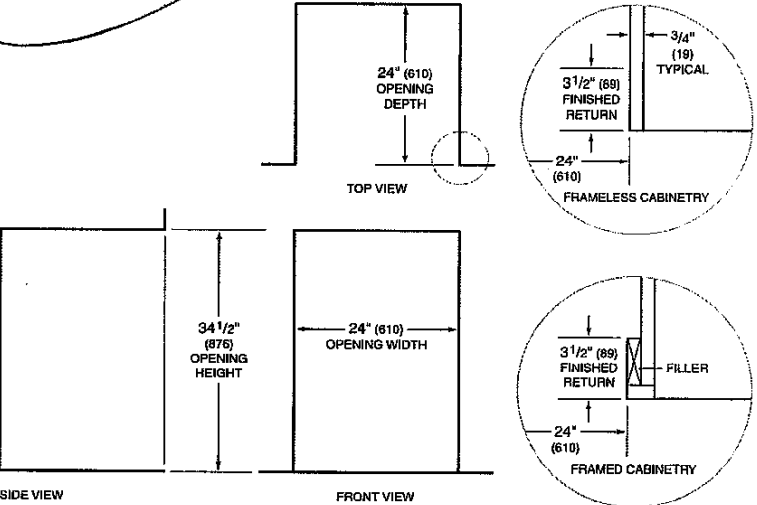

NOTE: 3 1/2" (89) finished returns will be visible and should be finished to match cabinetry.