

This sketch is provided solely for reference to those items noted on the accompanying "Upgrades/Extras". All other details, dimensions & layouts are for illustrative purposes only and may not be applicable to the Purchaser's Model Site Thomas Lot 20  
Date 12/11/17  
Purchaser Initials BJ Production Initials \_\_\_\_\_

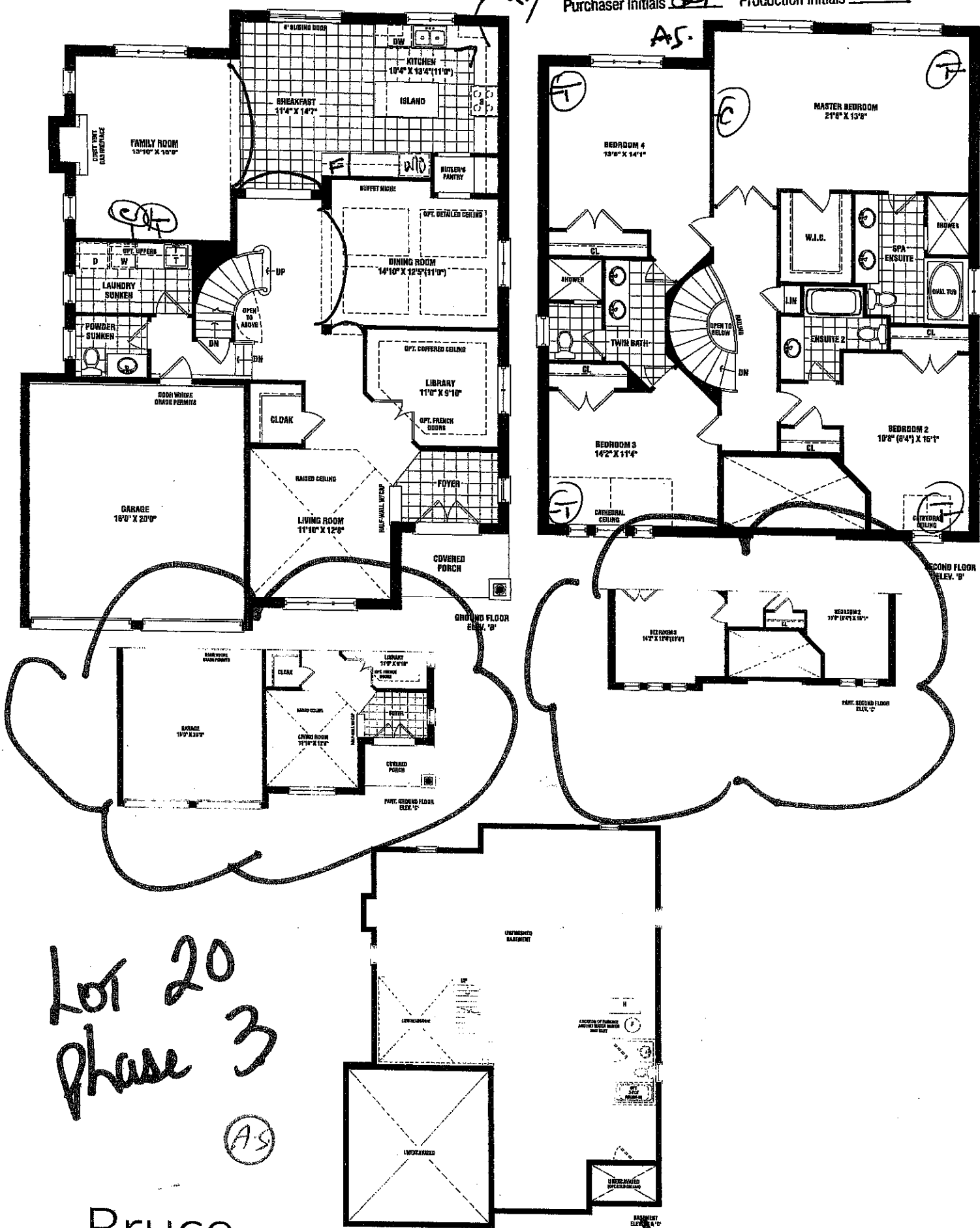

Lot 20  
Phase 3

A.S.

Bruce  
~~8,145 sq. ft. Elev. B~~  
3,155 sq. ft. Elev. C

Materials, specifications, and floor plans are subject to change without notice. All house renderings are artist's conceptions. All floor plans are approximate dimensions. Actual usable floor space may vary from the stated floor area. Square footage includes open to below. Double transoms shown on elevation are lot specific and may not apply to all lots and models, and only apply to sunken foyer condition. E. & O.E. 50-05

SCHEDULE B1



- (1) 48" High (re-labeled)
- (2) 36" x 48" / hard cover
- (3) High instace to replace (new)

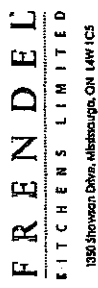

Havelock Corner PH3A  
(Woodstock)

Bruce/50-5

### STANDARD FEATURES:

- 100cm Uppers
- Crown moulding
- Light valance
- Bank of drawers as specified on plan
- Pot/pan drawers as specified on plan
- Blum Tandembox Antaro soft-closing drawers
- Opening for 36" FR (95cm x 180cm)
- Laminate countertops
- Laundry base as specified on plan
- Opt. Laundry uppers as specified on plan

Drawn By: Bethany O  
Date: Oct 06, 2017  
Scale: Not To Scale

Approved By Builder:

Date:

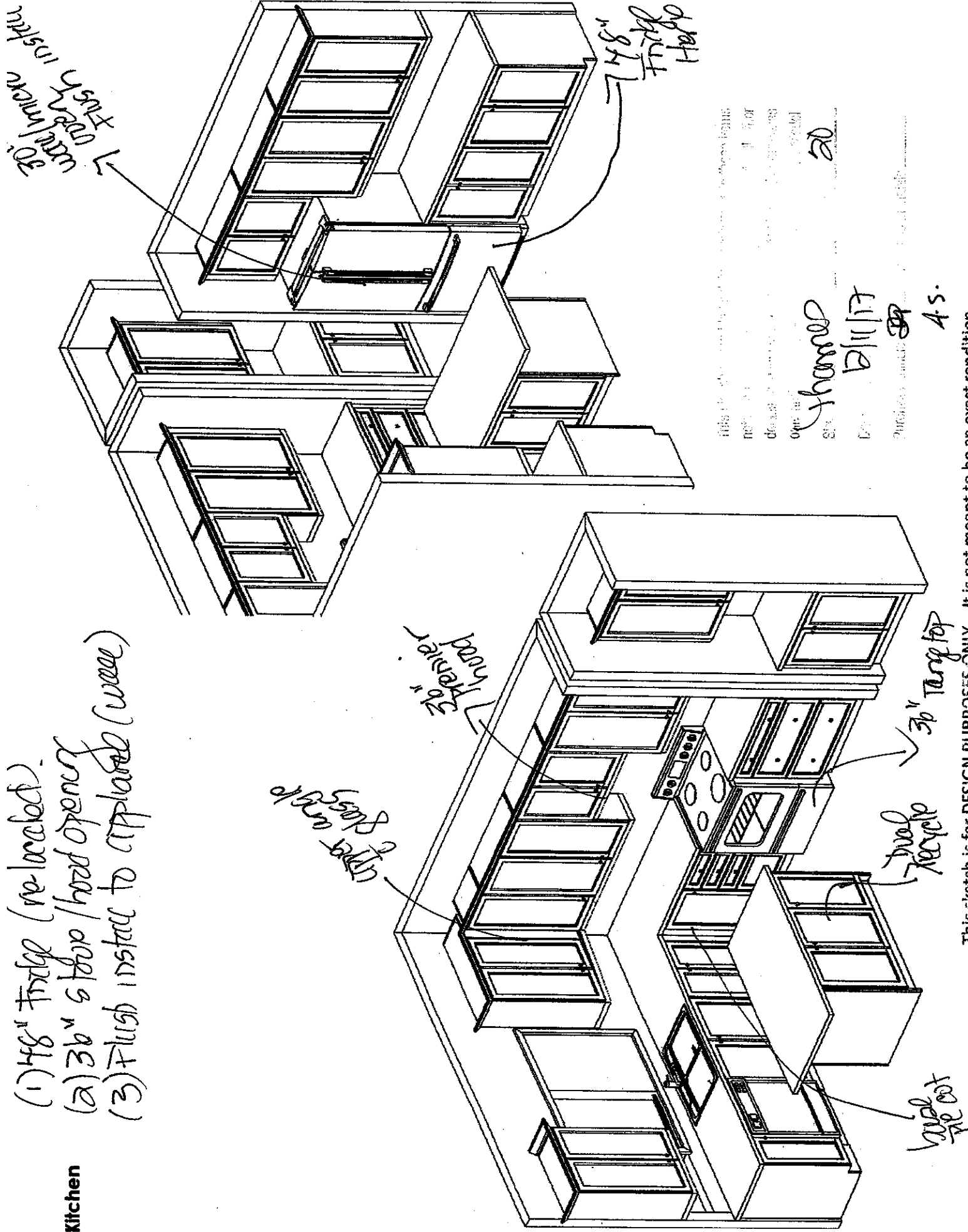

This chart is for DESIGN PURPOSE ONLY. It is not meant to be an exact reproduction.



INTERIOR COLOUR SCHEME

Purchaser: Amarjit Singh

Property: 20 of Plan - TBA

Telephone Res. / Bus: (416) 272-9993 /

Project: Thames Developments (2011) Ltd.

Decor Advisor: Steffanee Appjo

Model and Elevation: Bruce (50-5) Elev C

Layout Changes: ☐ Yes ☒ No

Sketch Attached: ☒ Yes ☐ No

Exterior Colour Scheme:

1. Cabinetry

	Style and Colour	Counter Top	Hardware
Kitchen / Breakfast	CAMDEN MAPLE SHALE GREY CL	1881K-52 CIPOLLINO BIANCO	9677 HANDLE
Kitchen Island	CAMDEN MAPLE SHALE GREY CL	1881K-52 CIPOLLINO BIANCO	9677 HANDLE
Laundry Room	BELWOOD ONTARIO WHITE	1882K-52 CIPOLLINO GRIGIO	9660 HANDLE
Powder Room	BELWOOD ONTARIO WHITE	1882K-52 CIPOLLINO GRIGIO	9660 HANDLE
Main Bathroom			
Master Ensuite Bathroom	CAMDEN OAK POPPY SEED	1877K-52 ATUMN CARNIVAL	9677 HANDLE
Second Ensuite Bathroom (If Applicable)	CAMDEN OAK OYSTER CL	1876K-52 SPRING CARNIVAL	9677 HANDLE
TWIN BATH	CAMDEN OAK OYSTER CL	1876K-52 SPRING CARNIVAL	9677 HANDLE

Appliances

Custom Size Fridge  
☒ Yes ☐ No

Valance Lighting  
☐ Yes ☒ No

Microwave / Range Hood  
☐ Yes ☒ No

Cooktop / Rangetop  
☒ Yes ☐ No

Built in Wall Oven  
☒ Yes ☐ No

Slide-in Range  
☐ Yes ☒ No

Comment

2. Flooring

	Selection
FOYER	13" X 13" SERPENTINE SYRAK CHARCOAL (TR.ST.SRK.1313)
Main Hall	3-1/2" X 3/4" OAK ELEMENTS NATURAL FINISH
Back Hall	
Breakfast	13" X 13" REFLEX OLIVE (GE.RF.OLV.1313)
Laundry Room	13" X 13" SERPENTINE SYRAK CHARCOAL (TR.ST.SRK.1313)
Kitchen	13" X 13" REFLEX OLIVE (GE.RF.OLV.1313)
Powder Room	13" X 13" SERPENTINE SYRAK CHARCOAL (TR.ST.SRK.1313)
Main Bathroom	
Master Ensuite	13" X 13" SERPENTINE TAUPE (TR.ST.TPE.1313)
Bathroom (If Applicable)	13" X 13" SERPENTINE KREM (TR.ST.KRM.1313) ENSUITE 2
Mud Room	
TWIN BATH	13" X 13" SERPENTINE KREM (TR.ST.KRM.1313)
Living Room	3-1/2" X 3/4" OAK ELEMENTS NATURAL FINISH
Dining Room	3-1/2" X 3/4" OAK ELEMENTS NATURAL FINISH
Family / Great Room	3-1/2" X 3/4" OAK ELEMENTS NATURAL FINISH
Den / Library / Study	3-1/2" X 3/4" OAK ELEMENTS NATURAL FINISH
Basement Landing (If Applies)	
Lower Landing (If Applicable)	3-1/2" X 3/4" OAK ELEMENTS NATURAL FINISH
Upper Landing	
Upper Hall	3-1/2" X 3/4" OAK ELEMENTS NATURAL FINISH
Master Bedroom	MOHAWK SO SWEET # 01 WITH STANDARD UNDERPAD
Bedroom #2	MOHAWK SO SWEET # 01 WITH STANDARD UNDERPAD
Bedroom #3	MOHAWK SO SWEET # 01 WITH STANDARD UNDERPAD
Bedroom #4	MOHAWK SO SWEET # 01 WITH STANDARD UNDERPAD
Bedroom #5	

Flooring Continued on Page 2

Initial:

Purchaser: Amarjit Singh  
Telephone Res. / Bus: (416) 272-9993 /  
Decor Advisor: Steffannee Appio

Property: 20 of Plan - TBA  
Project: Thames Developments (2011) Ltd.  
Model and Elevation: Bruce (50-5) Elev C

2. Flooring - Continued -

Upgrade Underpad	Type	Area
	STANDARD	ALL BEDROOMS
Carpet on Stairs	Capped	Runner - *Upgrade
Comment		
MOHAWK SO SWEET #01 WITH STANDARD UNDERPAD		

3. Plumbing Fixtures / Faucets

Kitchen	STD	Second Ensuite	STD	Powder Room	STD
Master Ensuite	STD			Other Room	
Main Bathroom		TWIN BATH	STD		
Comment					

4. Wall Tile

	Tile Selection	Listello	Insert	Insert Selection
Main Bathroom		<input type="checkbox"/>	<input type="checkbox"/>	
Master Ensuite				
Tub Deck	13" X 13" SERPENTINE TAUPE	<input type="checkbox"/>	<input type="checkbox"/>	TR.ST.TPE.1313
Tub Apron	13" X 13" SERPENTINE TAUPE	<input type="checkbox"/>	<input type="checkbox"/>	
Tub Surround	13" X 13" SERPENTINE TAUPE	<input type="checkbox"/>	<input type="checkbox"/>	
Shower Stall	8" X 10" SERPENTINE TAUPE	<input type="checkbox"/>	<input type="checkbox"/>	TR.ST.TPE.0810
Second Ensuite	8 "X 10" SERPENTINE KREM	<input type="checkbox"/>	<input type="checkbox"/>	TR.ST.KRM.0810
TWIN BATH	8 "X 10" SERPENTINE KREM	<input type="checkbox"/>	<input type="checkbox"/>	
		<input type="checkbox"/>	<input type="checkbox"/>	
Kitchen Backsplash		<input type="checkbox"/>	<input type="checkbox"/>	
Complete Backsplash		<input type="checkbox"/>	<input type="checkbox"/>	
Comment	STANDARD 2" X 2" MOSAIC WHITE SHOWER FLOOR TILE IN MASTER ENSUITE AND TWIN BATH SHOWER STALLS			

5. Fireplace

	Living Room			Family Room			Other Room - Specify		
	Purchased	As Per Plan	N/A	Purchased	As Per Plan	N/A	Purchased	As Per Plan	N/A
	<input type="radio"/>	<input type="radio"/>	<input type="radio"/>	<input type="radio"/>	<input checked="" type="radio"/>	<input type="radio"/>	<input type="radio"/>	<input type="radio"/>	<input type="radio"/>
Fireplace Type				STANDARD					
Mantle Type				STANDARD ER22 WHITE PAINT					
Over Mantle									
Colour / Stain									
Surround				NERO					
Hearth									
Comment									

Purchaser: Amarjit Singh  
Telephone Res. / Bus: (416) 272-9993 /  
Decor Advisor: Steffanee Appio

Property: 20 of Plan - TBA  
Project: Thames Developments (2011) Ltd.  
Model and Elevation: Bruce (50-5) Elev C

6. Trim Carpentry

Door Hardware

STANDARD

Interior Trim

STANDARD

Comment

Interior Doors

☐ 2 Panel Arch Top

☐ 2 Panel Square Top

☒ 6 Panel



Initial for Door Style

AS.

7. Railings and Pickets

Railing Package

STANDARD

Railing Colour

NATURAL FINISH

Wood Stairs

☐ No
☒ Oak

Picket Colour

STANDARD

Tread Colour

NATURAL FINISH

Comment

STANDARD NATURAL FINISH OAK STAIRS

8. Plaster Mouldings and Medallions

Foyer

Main Hall

Living Room

Dining Room

Family Room

Kitchen/Breakfast

Den/Library

Lower Landing

Comment

9. Wall Paint

STANDARD SENATOR WHITE

Smooth Ceilings

☒ First Floor
☐ First Floor incl. Second Floor Hall
☐ First and Second Floor
☐ Throughout
☐ Not Applicable

Trim Paint

10. Additional Comments

11. Disclaimers and Notes

1) Colours of all materials are as close as possible to builder's selection, but not necessarily identical due to variances in manufacturing.
2) Any extras listed above are null and void unless accompanied by a separate invoice/amendment. Said invoice must be paid in full.
3) The Purchaser acknowledges that after Interior Colour Selection form is signed and dated, no further changes will be permitted other than re-selection due to unavailability.

Purchaser's Initials

4) The Purchaser acknowledges reading and accepting the "Senator Homes Décor Centre Disclaimers" form. This document contains other miscellaneous disclaimers.

This Interior Colour Selection is final and approved by:
Purchaser:

Signature:

Date:

12.11.2017

Vendor:

Thames Developments (2011) Ltd.

Printed 12/11/2017 15:51:16

Page 3 of 3

# AREZZO

ASPIRE SERIES

## Dimensions

28 1/2" W x 22" D x 11 1/2" H  
 34 1/2" W x 22" D x 11 1/2" H  
 40 1/2" W x 22" D x 11 1/2" H  
 46 1/2" W x 22" D x 11 1/2" H

## Models

EAR628S2 Arezzo 28" Stainless  
 EAR134S2 Arezzo 34" Stainless  
 EAR140S2 Arezzo 40" Stainless  
 EAR146S2 Arezzo 46" Stainless

hot to handle  
 12/11/17



halogen lamps



metallic rotating knob controls



stainless steel baffle slot filters

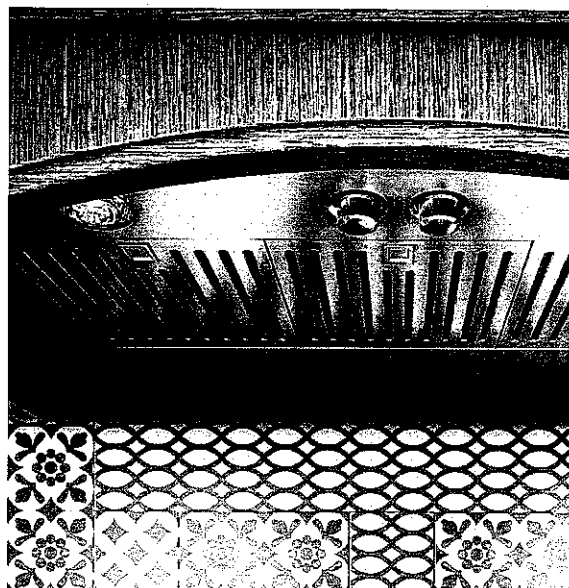

Arezzo provides professional grade performance, while being discreetly mounted inside the cabinetry.

Arezzo is available in 28 1/2" width with a 600 CFM blower, and equipped with a 1200 CFM blower for widths of 34 1/2", 40 1/2" and 46 1/2" for extraordinary ventilating power.

The extra depth (22") is ideal for supporting powerful professional ranges. Plus the All-In-One design avoids the need to purchase a stainless liner. Metallic rotating knob controls operate the 4 speed blower and halogen lighting.

Easy maintenance, higher efficiency and a cleaner kitchen are ensured by Elica's patented Baffle Slot Filters, which capture a higher percentage of contaminants and hold larger volumes of grease than traditional baffle filters. Arezzo is designed for standard ducted installation only.

 elica

FEATURES

Size (in) & Type Finish	28", 34", 40" or 46" Wide Insert Stainless Steel
Controls	Metallic Rotating Knob
Illumination	2, 40 Watt Halogen Lamps, 1 Light Intensity (28" & 34") (bulbs included) 4, 40 Watt Halogen Lamps, 1 Light Intensity (40" & 46") (bulbs included)
Installation Type	Ducted Installation Only
Blower Type	600 CFM, 4-Speed Internal (28" Unit) 1200 CFM, 4-Speed Internal (34", 40", 46" Units)
Blower Performance	Speed 1, 90 CFM, 2.1 Sones / 380 CFM, 2.8 Sones Speed 2, 330 CFM, 4.4 Sones / 660 CFM, 6.7 Sones Speed 3, 490 CFM, 7.8 Sones / 950 CFM, 8.5 Sones Speed 4, 600 CFM, 11.9 Sones / 1200 CFM, 14.3 Sones
Filter Type	Dishwasher-Safe, Stainless Steel Baffle Slot (2 w/ 28" Unit, 3 w/ 34" & 40" Units, 4 w/ 46" Unit)
Duct Transition	10" Round with Back Draft Damper (top only)
Electrical	120V-60Hz 550 Watts at 4.6 Amps (600 CFM) 1000 Watts at 8.3 Amps (1200 CFM)
Warranty	2 Year Parts & Labor, In-Home Service

8" round duct opening

ACCESSORIES

Replacement Grease Filter (1)  
CODE: GF061A

Replacement Light Bulb (1)  
CODE: 2006BH

Consumable parts are sold in units of one (1).  
Order accordingly.

LINE DRAWING

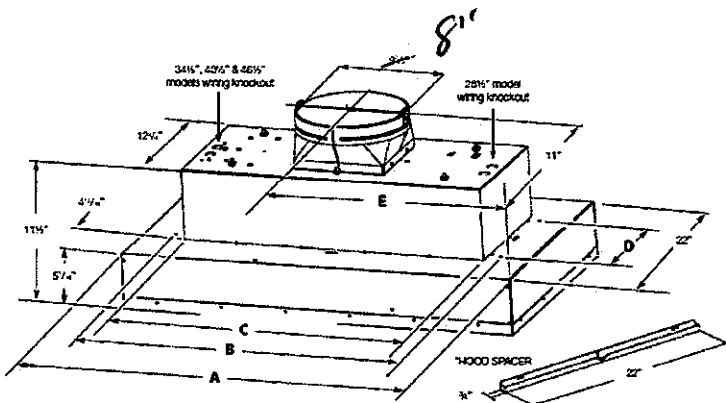

Range Hood mod.	DIMENSIONS				
	DIM A	DIM A + spacers	DIM B	DIM C mounting holes	DIM D mounting holes
EAR628SS	28 1/2"	33"	24 1/4"	22"	11"
EAR134SS	34 1/2"	38"	29 3/4"	27 1/2"	17"
EAR140SS	40 1/2"	44"	29 3/4"	27 1/2"	17 1/2"
EAR146SS	46 1/2"	50"	29 3/4"	27 1/2"	17 1/2"

Handwritten notes and signatures: "James", "12/11/17", "AS", and a signature.

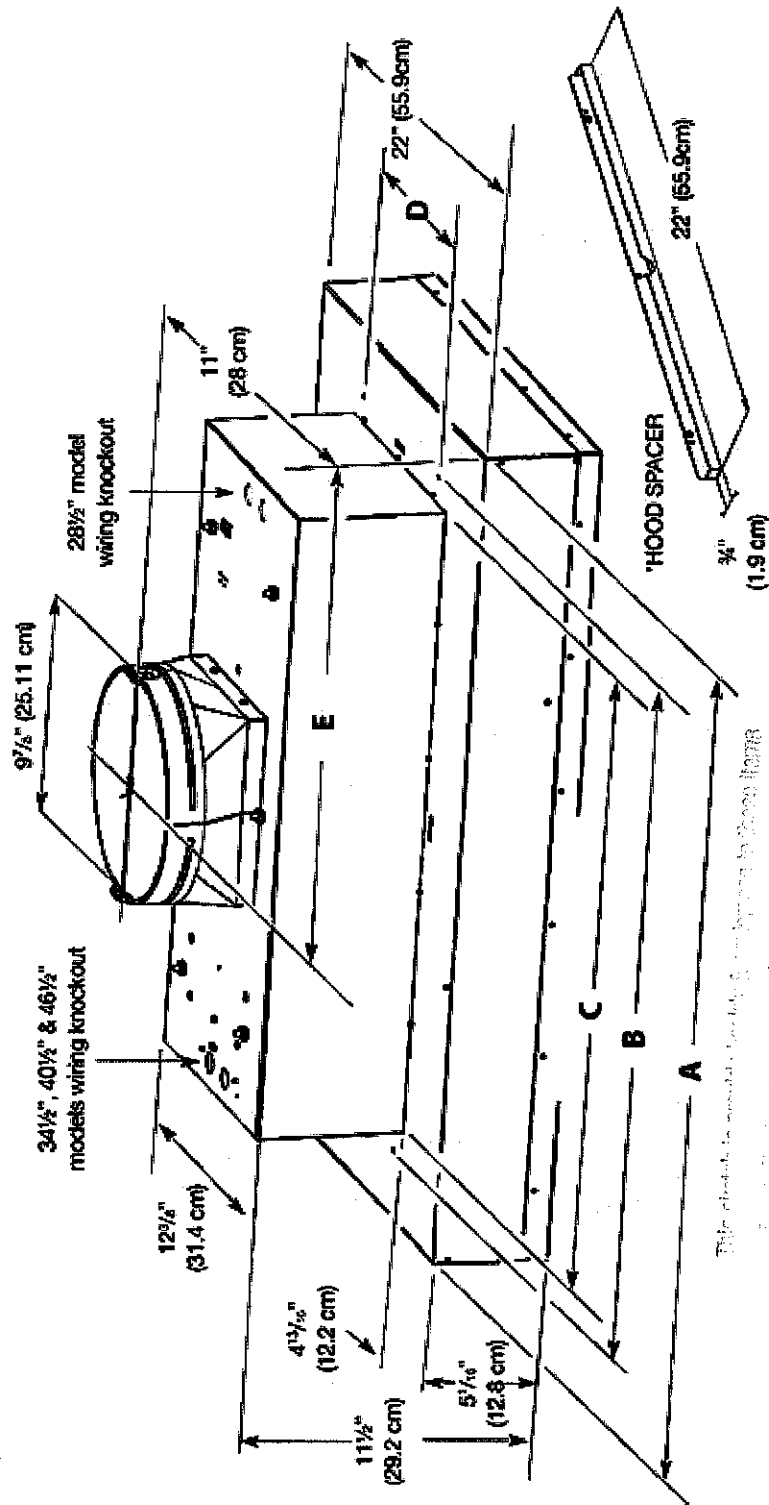

This drawing is intended for use by the customer to order parts.

Note: 8" duct opening to be supplied.

Thermo 20  
 12/11/17  
 AS.



36" PRO-STYLE® RANGETOP  
JGCP436WP – 35¾" x 14⅝" x 28⅜"

PRODUCT DIMENSIONS

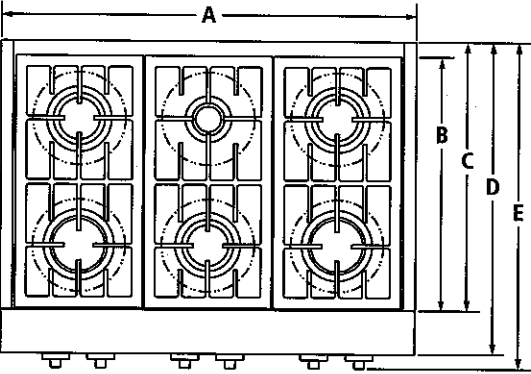

TOP VIEW

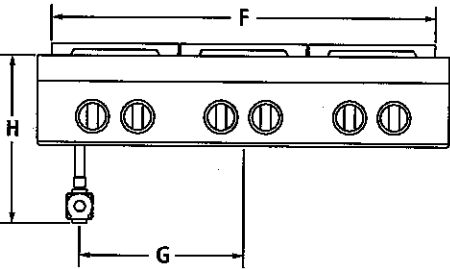

FRONT VIEW

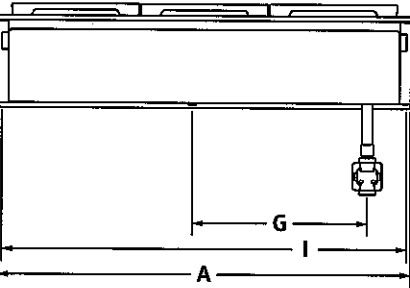

BACK VIEW

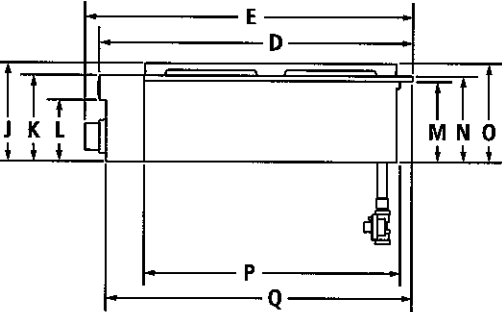

SIDE VIEW

MODEL #		JGCP436WP	
		in	cm
A	Overall width	35¾	90.7
B	Depth of grates	21¼	55.2
C	Depth without control panel	23¼	59.0
D	Depth with control panel overhang	27⅞	68.9
E	Depth with knobs	28⅜	72.0
F	Width of grates	33	83.8
G	Center of rangetop to center of gas inlet	14⅞	35.9
H	Height from gas inlet to cooking surface	14⅝	37.1
I	Width of recessed rangetop	35	89.0
J	Height including grates	8½	21.7
K	Height of control panel	7½	19.0
L	Height to bullnose	5⅝	13.5
M	Height of recessed rangetop	7	17.7
N	Height to cooking surface	7⅞	18.8
O	Height of recessed rangetop with grates	8½	21.6
P	Depth of recessed rangetop	22⅞	56.3
Q	Depth with control panel	26⅞	67.3

This sketch is provided solely for reference to those items noted on the accompanying "Upgrades/Extras". All other details, dimensions & layouts are for illustrative purposes only and may not be applicable to the Purchaser's Model

Site Thames Lot 20

Date 02/11/17

Purchaser Initials AS Production Initials \_\_\_\_\_

**IMPORTANT:** Dimensional specifications are provided for planning purposes only.  
**Do not make any cutouts based on this information.** Refer to the Installation Guide before selecting cabinetry, verifying electrical/gas connections, making cutouts or beginning installation.  
All Jenn-Air® appliances are appropriately UL, CUL or CSA approved.



8631BdZw915

36" PRO-STYLE® RANGETOP  
JGCP436WP – 35¾" x 14⅝" x 28⅜"

OPENING/CLEARANCE DIMENSIONS

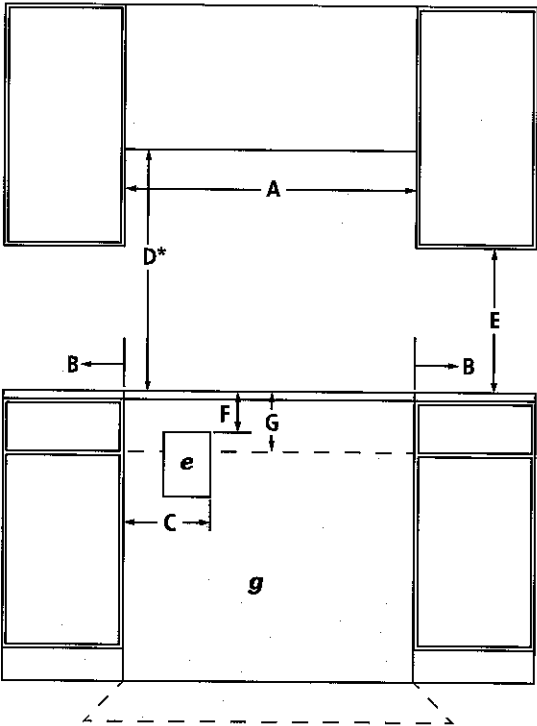

FRONT VIEW

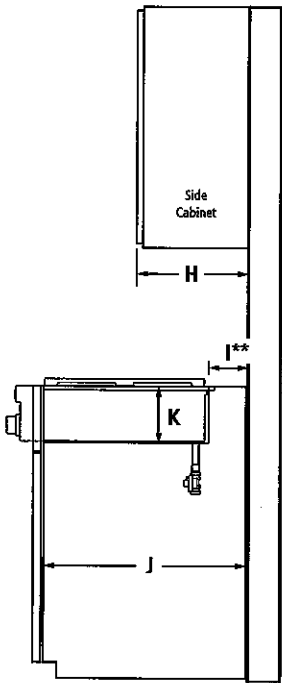

SIDE VIEW

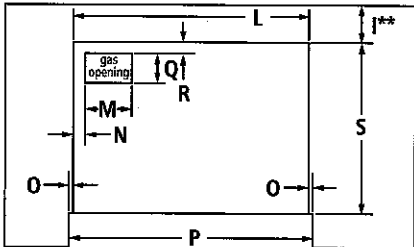

TOP VIEW – CUTOUT  
(solid platform not shown)

MODEL #		JGCP436WP	
		in	cm
A	Width of combustible area above cooking surface (min.)	36	91.4
B	Width from rangetop to fixed wall or other combustible material (min.)	6	15.2
C	Width to inner edge of outlet (max.)	16	40.6
D*	Height to bottom of uncovered wood or metal cabinet above cooking surface (min.)	42	106.7
E	Height to bottom of uncovered wood or metal cabinet (min.)	18	45.7
F	Height to top edge of outlet (min.)	10	25.4
G	Height to gas supply line area	14	35.6
H	Depth of upper cabinet (recommended)	13	33.0
I**	Depth from cutout to wall	1¼	4.4
J	Depth of cabinet	24	61.0
K	Height from cabinet to countertop	7¼	18.4
L	Width of cutout (countertop and cabinet)	35¼	89.5
M	Width of gas opening	12½	31.7
N	Width from cutout to gas opening	2	5.1
O	Width of notch	⅜	1.0
	Zero clearance	⅝	0.8
P	Width of cutout (countertop only)	36	91.4
	Zero clearance	35¾	90.8
Q	Depth of gas opening	6⅞	17.5
R	Depth from cutout to gas opening	¾	1.9
S	Depth of cutout (countertop and cabinet)	22¼	56.5
e	Recommended electrical outlet location		
g	Recommended gas supply line location		

\*Dimension can be reduced by 6" (15.2 cm) when bottom of wood or metal cabinet is covered by not less than ¼" (0.6 cm) flame retardant millboard covered with not less than No. 28 MSG sheet metal, 0.015" (0.4 mm) stainless steel, 0.024" (0.6 mm) aluminum or 0.020" (0.5 mm) copper.  
If installing a hood above the rangetop, follow the hood instructions for dimensional clearances above the cooking surface.

\*\*If back wall is constructed of a combustable material and a backsplash is not installed, a 4¾" (12.1 cm) minimum clearance is required.

GAS REQUIREMENTS

Natural Gas

This rangetop is factory-set for use with natural gas.

LP Gas Conversion

Conversion must be done by a qualified service technician. To convert to LP gas, use the LP gas conversion kit provided with the rangetop.

ELECTRICAL REQUIREMENTS

120 volt, 60 Hz, AC only, 15-amp fused, electrical circuit is required. A time-delay fuse or dedicated circuit is recommended.

This sketch is provided solely for reference to those items noted on the accompanying "Upgrades/Extras". All other details, dimensions & layouts are for illustrative purposes only and may not be applicable to the Purchaser's Model

Site Thermlo Lot 20

Date 2/11/17

Purchaser Initials PA Production Initials 45

JENN-AIR®

8631BdZw915

**IMPORTANT:** Dimensional specifications are provided for planning purposes only.  
**Do not make any cutouts based on this information.** Refer to the Installation Guide before selecting cabinetry, verifying electrical/gas connections, making cutouts or beginning installation.  
All Jenn-Air® appliances are appropriately UL, CUL or CSA approved.

30" SINGLE WALL OVENS

JJW3430D, JJW2430D – 30" x 29<sup>7</sup>/<sub>8</sub>" x 25<sup>5</sup>/<sub>16</sub>"

PRODUCT DIMENSIONS

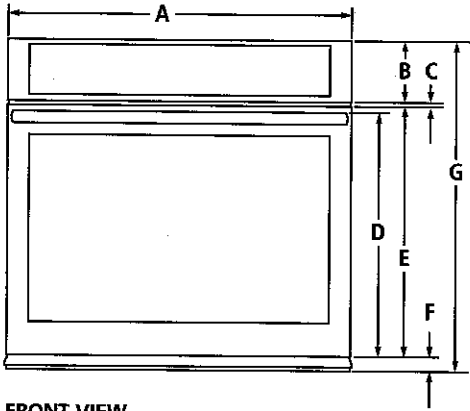

FRONT VIEW

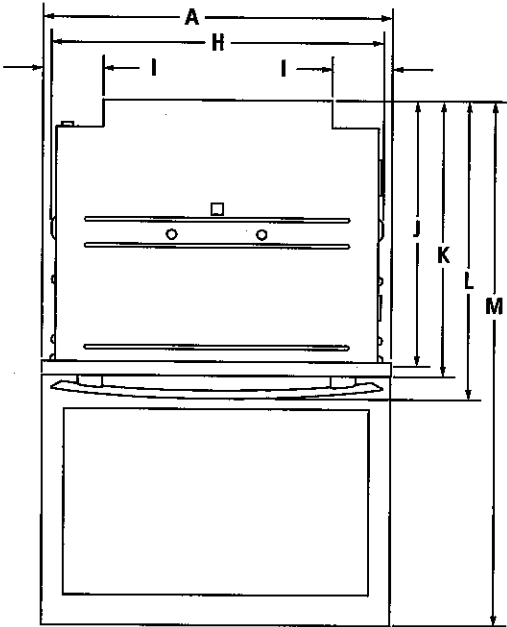

TOP VIEW

MODEL #		JJW3430D JJW2430D	
		in	cm
A	Overall width		
	Pro-Style® Stainless or Euro-Style Stainless	30	76.2
	Floating Glass	29 <sup>15</sup> / <sub>16</sub>	76.1
B	Height of control panel	5 <sup>1</sup> / <sub>2</sub>	14.0
C	Space between control panel and door	<sup>7</sup> / <sub>16</sub>	1.1
D	Height to top of handle		
	Pro-Style® Stainless	21 <sup>11</sup> / <sub>16</sub>	55.0
	Euro-Style (color-coordinating)	21 <sup>7</sup> / <sub>16</sub>	54.4
E	Height of door	22 <sup>1</sup> / <sub>8</sub>	56.2
F	Height of trim	1 <sup>11</sup> / <sub>16</sub>	4.3
G	Overall height	29 <sup>7</sup> / <sub>8</sub>	75.8
H	Width of recessed oven	28 <sup>7</sup> / <sub>16</sub>	72.2
I	Width of conduit channel	3 <sup>5</sup> / <sub>16</sub>	8.8
J	Depth of recessed oven	23 <sup>1</sup> / <sub>8</sub>	58.7
K	Depth with door	24 <sup>5</sup> / <sub>16</sub>	61.8
L	Depth with handle		
	Pro-Style® Stainless	26 <sup>5</sup> / <sub>16</sub>	66.9
	Euro-Style (color-coordinating)	25 <sup>5</sup> / <sub>16</sub>	64.3
M	Depth with door fully open	45 <sup>3</sup> / <sub>8</sub>	115.3

This sketch is provided solely for reference to those items noted on the accompanying "Upgrades/Extras". All other details, dimensions & layouts are for illustrative purposes only and may not be applicable to the Purchaser's Model

Site Thomas Lot 20

Date 6/11/17

Purchaser Initials JB Production Initials \_\_\_\_\_

**IMPORTANT:** Dimensional specifications are provided for planning purposes only. Do not make any cutouts based on this information. Refer to the Installation Guide before selecting cabinetry, verifying electrical/gas connections, making cutouts or beginning installation. All Jenn-Air® appliances are appropriately UL, CUL or CSA approved.

A.S.  8660BdZw1015

30" SINGLE WALL OVENS

JJW3430D, JJW2430D – 30" x 29<sup>7</sup>/<sub>8</sub>" x 25<sup>5</sup>/<sub>16</sub>"

DIMENSIONS AS INSTALLED

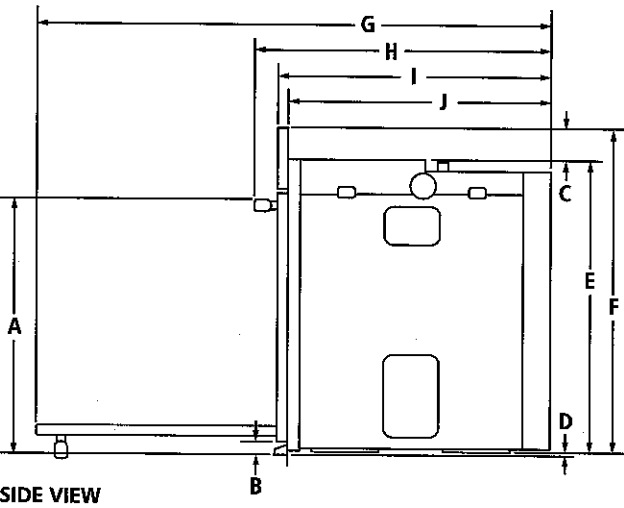

MODEL #		JJW3430D JJW2430D	
		in	cm
A	Height to top of handle Pro-Style® Stainless	22 <sup>3</sup> / <sub>4</sub>	57.8
	Euro-Style (color-coordinating)	22 <sup>5</sup> / <sub>16</sub>	57.3
B	Height of trim extending below cutout	1 <sup>1</sup> / <sub>8</sub>	2.9
C	Height from top of recessed oven to top of control panel JJW3430D	2 <sup>1</sup> / <sub>2</sub>	6.3
	JJW2430D	2 <sup>15</sup> / <sub>16</sub>	7.4
D	Height from bottom of recessed oven foot to bottom of oven vent	<sup>3</sup> / <sub>16</sub>	0.5
E	Height of recessed oven	26 <sup>3</sup> / <sub>4</sub>	67.9
F	Height to top of control panel	29 <sup>7</sup> / <sub>8</sub>	75.8
G	Depth with door fully open	45 <sup>5</sup> / <sub>8</sub>	115.3
H	Depth with handle Pro-Style® Stainless	26 <sup>5</sup> / <sub>16</sub>	66.9
	Euro-Style (color-coordinating)	25 <sup>5</sup> / <sub>16</sub>	64.3
I	Depth with door	24 <sup>5</sup> / <sub>16</sub>	61.8
J	Depth of recessed oven	23 <sup>1</sup> / <sub>16</sub>	58.6

This sketch is provided solely for reference to those items noted on the accompanying "Upgrades/Extras". All other details, dimensions & layouts are for illustrative purposes only and may not be applicable to the Purchaser's Model

Site Thomson Lot 20

Date 12/11/17

Purchaser Initials AS Production Initials \_\_\_\_\_

**IMPORTANT:** Dimensional specifications are provided for planning purposes only.  
**Do not make any cutouts based on this information.** Refer to the Installation Guide before selecting cabinetry, verifying electrical/gas connections, making cutouts or beginning installation.  
All Jenn-Air® appliances are appropriately UL, CUL or CSA approved.



8660BdZw1015

30" SINGLE WALL OVENS

JJW3430D, JJW2430D – 30" x 29⅞" x 25⅝"

OPENING/CLEARANCE DIMENSIONS

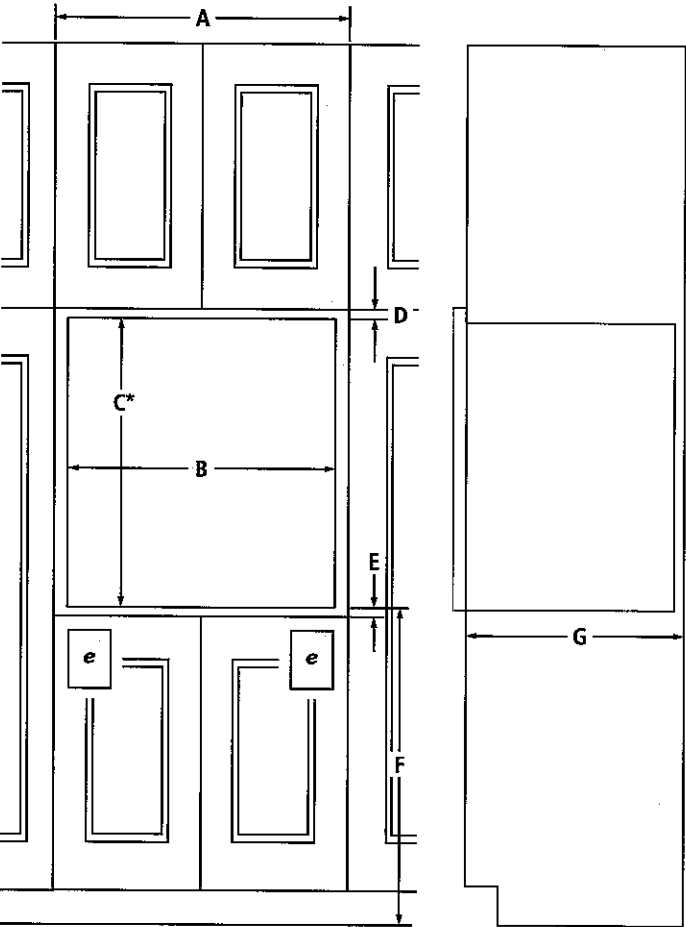

FRONT VIEW

SIDE VIEW

MODEL #		JJW3430D JJW2430D	
		in	cm
A	Width of cabinet (min.)	30	76.2
B	Width of cutout	28½	72.4
C*	Height of cutout (recommended)	28	71.2
D	Top of cutout to bottom of upper cabinet door (min.)	2⅜	5.5
E	Bottom of cutout to top of lower cabinet door (min.)	1½	3.8
F	Bottom of cutout to floor	32	81.3
G	Depth of cutout (min.)	24	61.0
H	Top of countertop to bottom of cutout (min.)	30⅜	76.7
I	Top of cutout to underside of countertop (min.)	1½	3.8
J	Bottom of cutout to floor	4⅝	11.0
e	Recommended junction box location		

\*Will fit cutout height from 26⅝" (68.4 cm) to 29⅞" (74.8 cm).

ELECTRICAL REQUIREMENTS

240 volt, 20-amp fused, grounded circuit is required. A dedicated circuit is required.

The length of conduit provided is for serviceability. Do not cut the conduit. The junction box should be located 3" (7.6 cm) maximum below the support surface. Drill a 1" (2.5 cm) minimum diameter hole in the right rear or left rear corner of the support surface for access to the junction box.

NOTE: For under counter installation, the junction box should be located in the adjacent right or left cabinet. Drill a 1" (2.5 cm) minimum diameter hole in an upper corner of the side wall for access to the junction box.

CABINET REQUIREMENTS

NOTE: When using under counter installation, check cabinet manufacturer's specifications to verify fit.

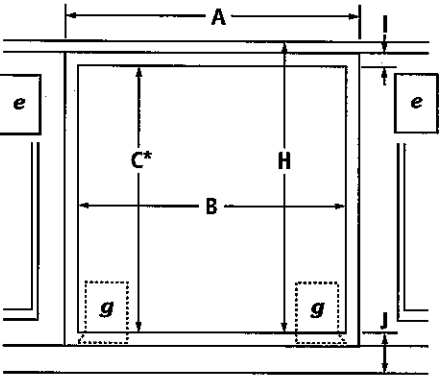

UNDER COUNTER INSTALLATION  
(without cooktop installed above)

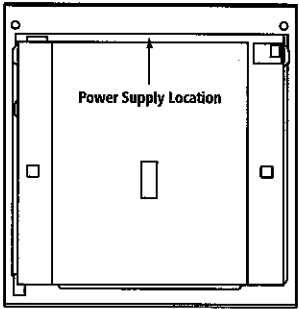

BACK VIEW

**IMPORTANT:** Dimensional specifications are provided for planning purposes only.  
**Do not make any cutouts based on this information.** Refer to the Installation Guide *before* selecting cabinetry, verifying electrical/gas connections, making cutouts or beginning installation.  
All Jenn-Air® appliances are appropriately UL, CUL or CSA approved.

This sketch is provided solely for reference to those items noted on the accompanying "Upgrades/Extras". All other details, dimensions & layouts are for illustrative purposes and may not be applicable to the Purchaser's Model.

Purchaser Initials Thurman Lot 20  
Production Initials A.S.  
**JENN-AIR**

8660BdZw1015

30" SINGLE WALL OVENS – FLUSH INSTALLATION

JJW3430D, JJW2430D – 30" x 29 7/8" x 24 5/16" (depth without handle)

OPENING/CLEARANCE DIMENSIONS

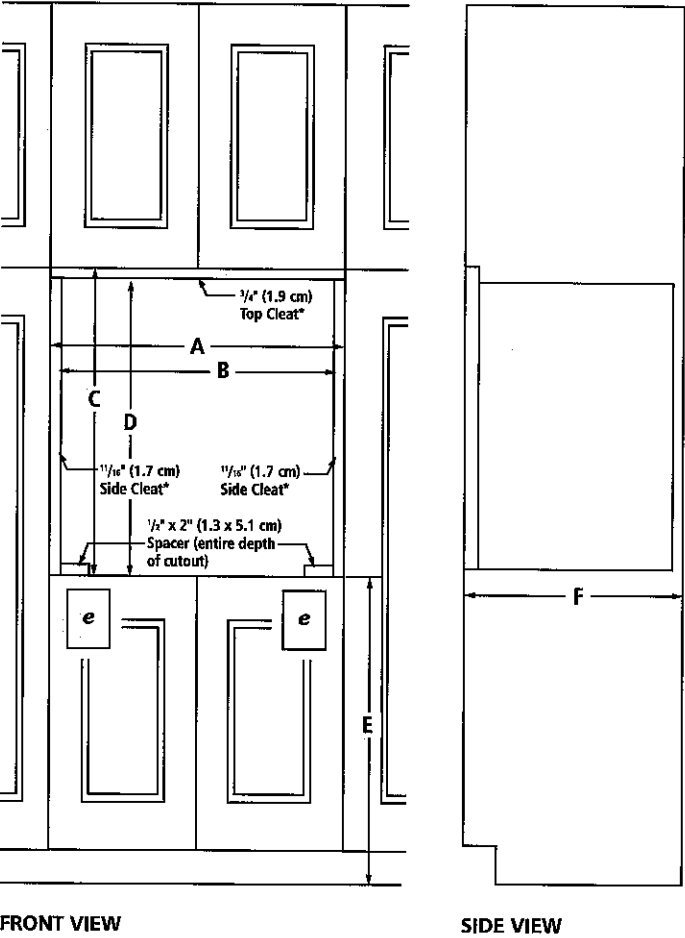

MODEL #		JJW3430D JJW2430D	
		in	cm
A	Width of flush inset cutout (min.)	30 3/4	76.8
B	Width of opening (min.)	28 3/8	73.3
C	Height of flush inset cutout (min.)	30 1/16	77.3
D	Height of opening (min.)	29 1/16	75.4
E	Bottom of cutout to floor	4 5/8-32	11.7-81.3
F	Depth of cutout (min.)	25	63.5
G	Bottom of cutout to floor for under counter	4 1/16	10.3
e	Recommended junction box location		

ELECTRICAL REQUIREMENTS

240 volt, 20-amp fused, grounded circuit is required. A dedicated circuit is required.

The length of conduit provided is for serviceability. Do not cut the conduit. The junction box should be located 3" (7.6 cm) maximum below the support surface. Drill a 1" (2.5 cm) minimum diameter hole in the right rear or left rear corner of the support surface for access to the junction box.

NOTE: For under counter installation, the junction box should be located in the adjacent right or left cabinet. Drill a 1" (2.5 cm) minimum diameter hole in an upper corner of the side wall for access to the junction box.

FLUSH INSTALLATION REQUIREMENTS

A 25" (63.5 cm) minimum cutout depth is required.

These dimensions will result in a 1/4" (0.6 cm) reveal on the top, a 1/4" (0.6 cm) reveal on the sides and a 1/8" (0.3 cm) reveal on the bottom of the wall oven.

The front face of the cleats and spacers will be visible and should be treated as a finished surface.

CABINET REQUIREMENTS

NOTE: When using under counter installation, check cabinet manufacturer's specifications to verify fit.

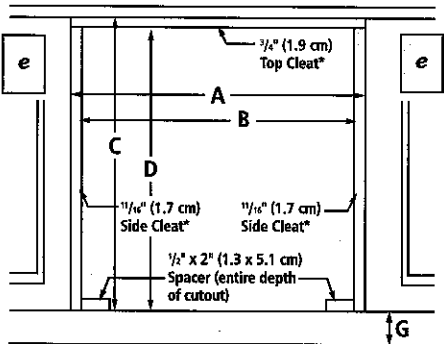

UNDER COUNTER INSTALLATION  
(without cooktop installed above)

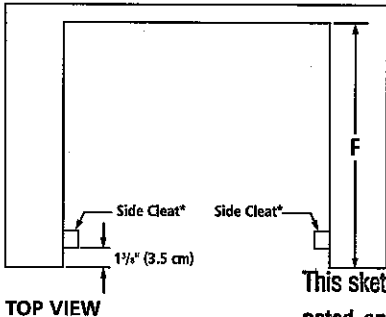

TOP VIEW

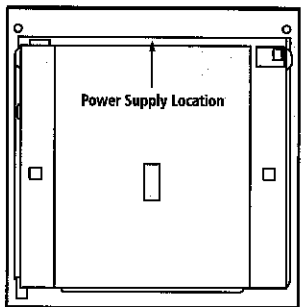

BACK VIEW

\* Cleats and spacers must be recessed 1 3/8" (3.5 cm) from the front of the cabinet.

**IMPORTANT:** Dimensional specifications are provided for planning purposes only. Do not make any cutouts based on this information. Refer to the Installation Guide before selecting cabinetry, verifying electrical/gas connections, making cutouts or beginning installation. All Jenn-Air® appliances are appropriately UL, CUL or CSA approved.

This sketch is provided solely for reference to those items noted on the accompanying "Upgrades/Extras". All other details, dimensions & layouts are for illustrative purposes only and may not be applicable to the Purchaser's Model

Site Yonkers Lot 20  
Date 12/11/17  
**JENN-AIR**  
8660BdZw1015  
Purchaser Initials JA Production Initials AS

## BUILT-IN MICROWAVE OVENS

~~JMC2430D – 29<sup>3</sup>/<sub>4</sub>" x 19<sup>7</sup>/<sub>8</sub>" x 24<sup>3</sup>/<sub>4</sub>"~~JMC2427D – 26<sup>3</sup>/<sub>4</sub>" x 19<sup>7</sup>/<sub>8</sub>" x 24<sup>1</sup>/<sub>16</sub>"

## PRODUCT DIMENSIONS

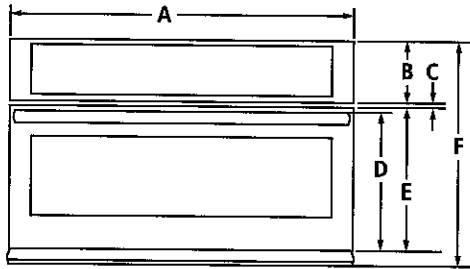

FRONT VIEW

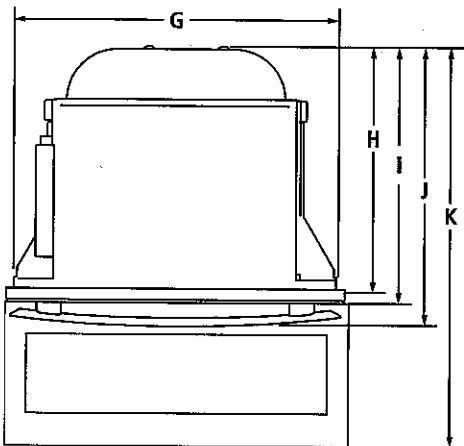

TOP VIEW

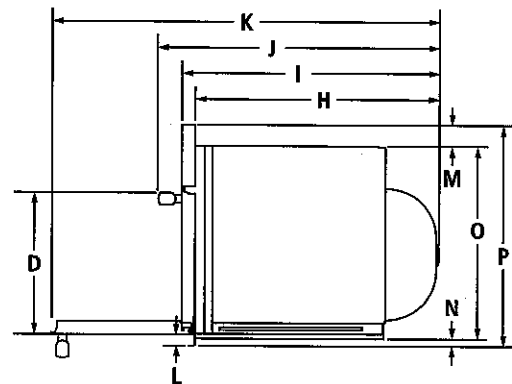

SIDE VIEW

MODEL #		JMC2430D		JMC2427D	
		in	cm	in	cm
A	Overall width	29 <sup>3</sup> / <sub>4</sub>	75.6	26 <sup>3</sup> / <sub>4</sub>	68.0
B	Height of control panel	5 <sup>1</sup> / <sub>2</sub>	14.0	5 <sup>1</sup> / <sub>2</sub>	14.0
C	Space between control panel and door				
	Pro-Style® Stainless	7 <sup>1</sup> / <sub>16</sub>	1.1	—	—
	Euro-Style Stainless	7 <sup>1</sup> / <sub>16</sub>	1.1	7 <sup>1</sup> / <sub>16</sub>	1.1
	Black Floating Glass	1 <sup>1</sup> / <sub>2</sub>	1.2	—	—
D	Height to top of handle				
	Pro-Style® Stainless	12 <sup>3</sup> / <sub>8</sub>	31.4	—	—
	Euro-Style Stainless	12 <sup>3</sup> / <sub>16</sub>	31.0	12 <sup>3</sup> / <sub>16</sub>	31.0
	Black Floating Glass	12 <sup>3</sup> / <sub>16</sub>	31.0	—	—
E	Height of door	12 <sup>3</sup> / <sub>4</sub>	32.3	12 <sup>3</sup> / <sub>4</sub>	32.3
F	Overall height	19 <sup>7</sup> / <sub>8</sub>	50.3	19 <sup>7</sup> / <sub>8</sub>	50.3
G	Width of recessed oven	28 <sup>3</sup> / <sub>8</sub>	72.1	25 <sup>3</sup> / <sub>8</sub>	64.5
H	Depth of recessed oven	21 <sup>1</sup> / <sub>2</sub>	54.6	21 <sup>1</sup> / <sub>2</sub>	54.6
I	Depth with door				
	Pro-Style® Stainless	22 <sup>1</sup> / <sub>16</sub>	57.7	—	—
	Euro-Style Stainless	22 <sup>1</sup> / <sub>16</sub>	57.7	22 <sup>5</sup> / <sub>8</sub>	57.5
	Black Floating Glass	22 <sup>5</sup> / <sub>8</sub>	57.5	—	—
J	Depth with handle				
	Pro-Style® Stainless	25 <sup>3</sup> / <sub>8</sub>	64.4	—	—
	Euro-Style Stainless	24 <sup>3</sup> / <sub>4</sub>	62.9	24 <sup>1</sup> / <sub>16</sub>	62.8
	Black Floating Glass	24 <sup>1</sup> / <sub>16</sub>	62.8	—	—
K	Depth with door fully open				
	Pro-Style® Stainless	34 <sup>3</sup> / <sub>8</sub>	87.4	—	—
	Euro-Style Stainless	34 <sup>3</sup> / <sub>8</sub>	87.4	34 <sup>3</sup> / <sub>8</sub>	87.4
	Black Floating Glass	34 <sup>1</sup> / <sub>2</sub>	87.6	—	—
L	Height of trim				
	Pro-Style® Stainless	1 <sup>1</sup> / <sub>8</sub>	2.9	—	—
	Euro-Style Stainless	1 <sup>1</sup> / <sub>8</sub>	2.9	1 <sup>3</sup> / <sub>16</sub>	3.0
	Black Floating Glass	1 <sup>3</sup> / <sub>16</sub>	3.0	—	—
M	Height from top of recessed oven to top of control panel	1 <sup>15</sup> / <sub>16</sub>	5.0	1 <sup>15</sup> / <sub>16</sub>	5.0
N	Height from bottom of recessed oven to bottom of trim	5 <sup>1</sup> / <sub>8</sub>	1.6	5 <sup>1</sup> / <sub>8</sub>	1.6
O	Height of recessed oven	17 <sup>3</sup> / <sub>8</sub>	44.1	17 <sup>3</sup> / <sub>8</sub>	44.1
P	Height to top of control panel	19 <sup>3</sup> / <sub>16</sub>	48.8	19 <sup>3</sup> / <sub>16</sub>	48.8

This sketch is provided solely for reference to those items noted on the accompanying "Upgrades/Extras". All other details, dimensions & layouts are for illustrative purposes only and may not be applicable to the Purchaser's Model

**IMPORTANT:** Dimensional specifications are provided for planning purposes only.

**Do not make any cutouts based on this information.** Refer to the Installation Guide before selecting cabinetry, verifying electrical/gas connections, making cutouts or beginning installation.

All Jenn-Air® appliances are appropriately UL, CUL or CSA approved.

Site

Date

Purchaser Initials

JENN-AIR®

8673AdZw1115

Production Initials

BUILT-IN MICROWAVE OVENS

JMC2430D – 29¾" x 19⅞" x 24¾"

JMC2427D – 26¾" x 19⅞" x 24⅞"

OPENING/CLEARANCE DIMENSIONS

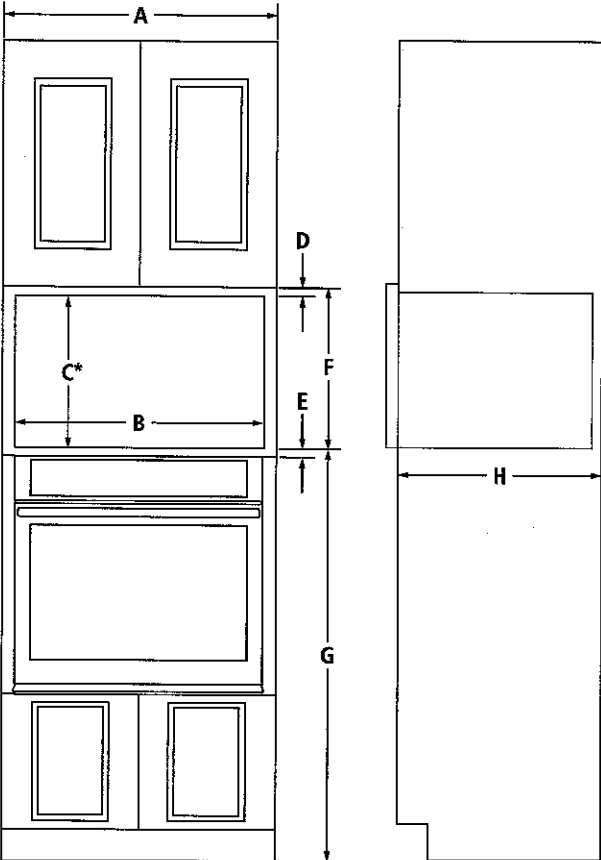

FRONT VIEW – INSTALLATION OVER SINGLE OVEN

SIDE VIEW

Approved models: JJW3430D, JJW2430D, JJW2427D

MODEL #		JMC2430D		JMC2427D	
		in	cm	in	cm
A	Width of cabinet (min.)	30	76.2	27	68.6
B	Width of cutout	28½	72.4	25½	64.8
C*	Height of cutout	17⅞-17¾	44.1-45.1	17⅞-17¾	44.1-45.1
D	Top of cutout to bottom of upper cabinet (min.)	2⅜	5.5	2⅜	5.5
E	Bottom of cutout to top of single oven (min.)	1	2.5	1	2.5
	Bottom of cutout to top of cabinet door (min.)	1½	3.8	1½	3.8
F	Bottom of cutout to bottom of upper cabinet door	19⅞	50.3	19⅞	50.3
G	Bottom of cutout to floor (recommended)	40	101.6	40	101.6
H	Depth of cutout (min.)	21⅞	55.5	21⅞	55.5

\*Optional spacer kits are available for a cutout height of 19"-19⅜" (48.3-50.2 cm).

ELECTRICAL REQUIREMENTS

240 volt, 20-amp fused, grounded circuit is required. A dedicated circuit is recommended.

The length of conduit provided is for serviceability. Do not cut the conduit. The junction box should be located 3" (7.6 cm) maximum below the support surface. Drill a 1" (2.5 cm) minimum diameter hole in the left rear corner of the support surface for access to the junction box.

If the junction box is on the rear wall behind the oven, it must be recessed and located in any corner of the cabinet.

LOCATION REQUIREMENTS

Support structure must be able to support 90 lb (41.0 kg) including microwave oven and contents.

This sketch is provided solely for reference to those items noted on the accompanying "Upgrades/Extras". All other details, dimensions & layouts are for illustrative purposes only and may not be applicable to the Purchaser's Model

Site Yuma Lot 20

Date 12/11/17

Purchaser Initials AS Production Initials \_\_\_\_\_

**IMPORTANT:** Dimensional specifications are provided for planning purposes only. Do not make any cutouts based on this information. Refer to the Installation Guide before selecting cabinetry, verifying electrical/gas connections, making cutouts or beginning installation. All Jenn-Air® appliances are appropriately UL, CUL or CSA approved.



8673AdZw1115



BUILT-IN MICROWAVE OVENS – FLUSH INSTALLATION

JMC2430D – 29¾" x 19⅞" x 22⅛" (depth without handle)  
JMC2427D – 26¾" x 19⅞" x 22⅝" (depth without handle)

OPENING/CLEARANCE DIMENSIONS

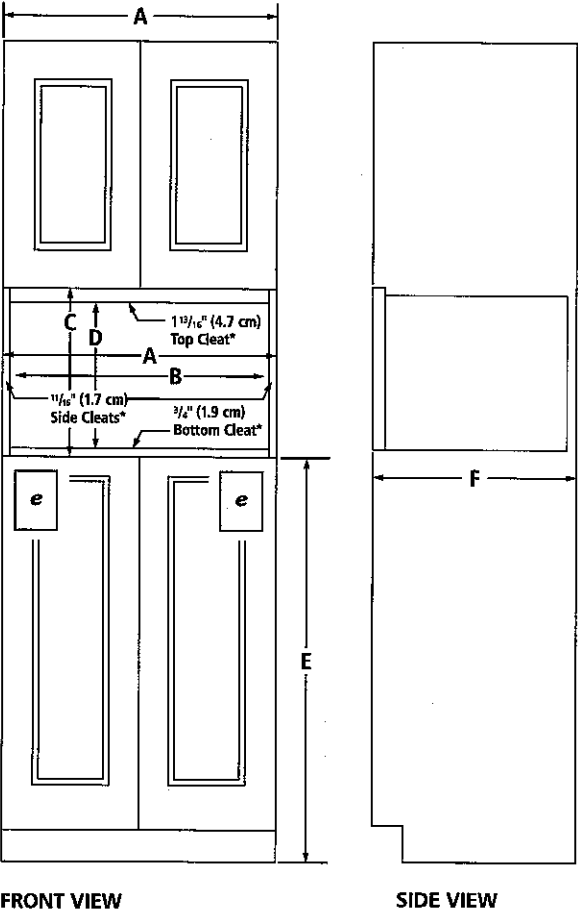

MODEL #		JMC2430D		JMC2427D	
		in	cm		
A	Width of flush inset cutout (min.)	30¼	76.8	27¼	69.2
B	Width of opening (min.)	28⅞	70.8	25⅞	65.7
C	Height of flush inset cutout (min.)	20⅞	51.3	20⅞	51.3
D	Height of opening (min.)	17⅞	44.7	17⅞	44.7
E	Bottom of cutout to floor	40	101.6	40	101.6
F	Depth of cutout (min.)	23¼	59.0	23¼	59.0
e	Recommended junction box location				

ELECTRICAL REQUIREMENTS

240 volt, 20-amp fused, grounded circuit is required. A dedicated circuit is recommended.

The length of conduit provided is for serviceability. Do not cut the conduit. The junction box should be located 3" (7.6 cm) maximum below the support surface. Drill a 1" (2.5 cm) minimum diameter hole in the left rear corner of the support surface for access to the junction box.

FLUSH INSTALLATION REQUIREMENTS

A 23¼" (59.0 cm) minimum cutout depth is required.  
These dimensions will result in a ¼" (0.6 cm) reveal on the top, a ¼" (0.6 cm) reveal on the sides and a ⅛" (0.3 cm) reveal on the bottom of the microwave oven.  
The front face of the cleats and platform will be visible and should be treated as a finished surface.

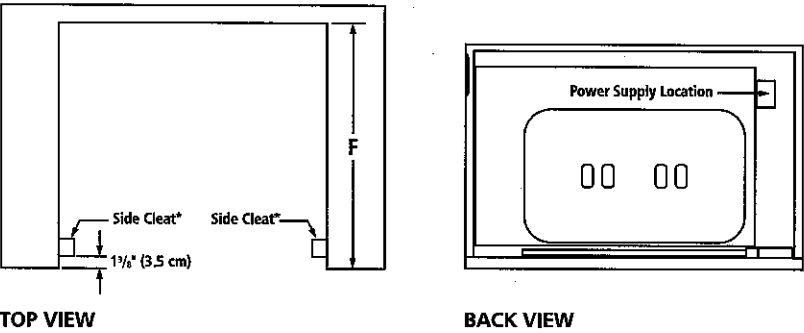

\*Cleats and platform must be recessed 1⅞" (3.5 cm) from the front of the cabinet.

**IMPORTANT:** Dimensional specifications are provided for planning purposes only.  
**Do not make any cutouts based on this information.** Refer to the Installation Guide before selecting cabinetry, verifying electrical/gas connections, making cutouts or beginning installation.  
All Jenn-Air® appliances are appropriately UL, CUL or CSA approved.

This sketch is provided solely for reference to those items noted on the accompanying "Upgrades/Extras". All other details, dimensions & layouts are for illustrative purposes only and may not be applicable to the Purchaser's Model

Sale James Lot 20  
Date 12/11/17  
Purchaser Initials JA Product Line Initials \_\_\_\_\_

45



8673AdZw1115

48" SIDE-BY-SIDE REFRIGERATORS WITH ICE & WATER DISPENSER

JS48PPDUDE – 48⅜" x 83⅜" x 27¼" (with handles)

JS48SSDUDE – 48⅜" x 83⅜" x 27⅞" (with handles)

PRODUCT DIMENSIONS

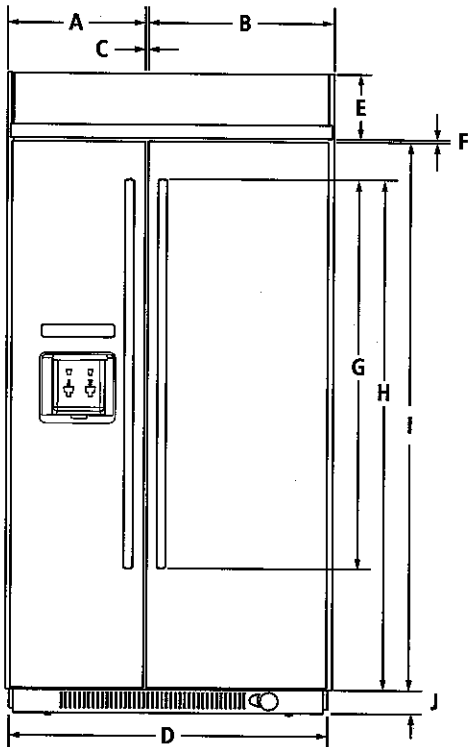

FRONT VIEW

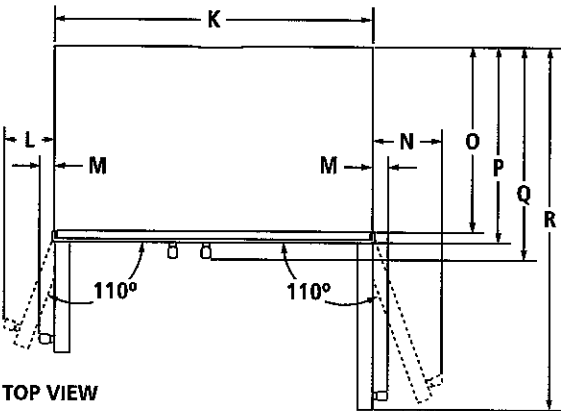

TOP VIEW

MODEL #	JS48PPDUDE JS48SSDUDE	
	in	cm
A	Width of freezer door (including hinge side offset)	20 50.8
B	Width of refrigerator door (including hinge side offset)	27 68.6
C	Space between doors	⅜ 1.0
D	Overall width (Including side trim)	48⅜ 122.9
E	Height of top grille	8⅝ 21.7
F	Space between doors and top grille	⅜ 1.0
G	Height of handles	
	Pro-Style® Stainless	45⅝ 115.7
H	Euro Style Stainless	50 127.1
	Height to top of handles	
I	Pro-Style® Stainless	63⅞ 163.5
	Euro Style Stainless	65¾ 167.0
J	Height of doors	71 180.2
K	Height of bottom grille	3 7.6
L	Width of recessed refrigerator	47 119.4
M	Width from side of refrigerator to freezer handle – door fully open 110°	
	Pro-Style® Stainless	8⅝ 21.3
N	Euro Style Stainless	8 20.3
	Width from side of refrigerator to handle – door open 90°	
O	Pro-Style® Stainless	2⅝ 6.7
	Euro Style Stainless	2 5.1
P	Width from side of refrigerator to refrigerator handle – door fully open 110°	
	Pro-Style® Stainless	10⅝ 27.6
Q	Euro Style Stainless	10¼ 26.1
	Depth without doors	22⅝ 56.2
R	Depth with doors	25⅝ 63.8
S	Depth with handles	
	Pro-Style® Stainless	27¾ 70.5
T	Euro Style Stainless	27⅞ 68.8
	Depth with refrigerator door open 90°	50⅞ 129.0

This sketch is provided solely for reference to those items noted on the accompanying "Upgrades/Extras". All other details, dimensions & layouts are for illustrative purposes only and may not be applicable to the Purchaser's Model

Site James Lot 20

IMPORTANT: Dimensional specifications are provided for planning purposes only.

Do not make any cutouts based on this information. Refer to the Installation or Use & Care Guide

before selecting cabinetry, verifying electrical/gas connections, making cutouts or beginning installation.

All Jenn-Air® appliances are appropriately UL, CUL or CSA approved.

Date 6/11/17

Purchaser Initials AS

JENN-AIR®

Production Initials 8116AdZw915

AS.

48" SIDE-BY-SIDE REFRIGERATORS WITH ICE & WATER DISPENSER

JS48PPDUDE – 48⅜" x 83⅜" x 27¾" (with handles)

JS48SSDUDE – 48⅜" x 83⅜" x 27⅞" (with handles)

DIMENSIONS AS INSTALLED

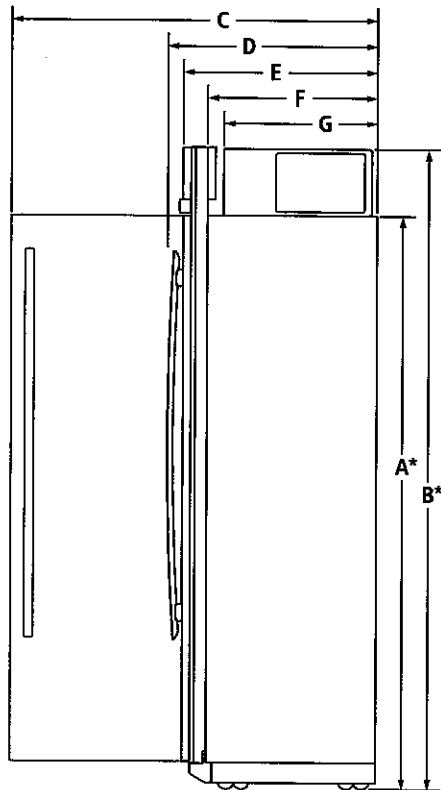

SIDE VIEW

MODEL #	JS48PPDUDE JS48SSDUDE	
	in	cm
A* Height without compressor (min.)	74⅜	188.9
B* Height of recessed refrigerator (min.)	83⅜	211.8
C Depth with refrigerator door open 90° (min.)	51⅞	129.7
Depth with handles (min.)		
D Pro-Style® Stainless	27¾	70.5
Euro Style Stainless	27⅞	68.8
E Depth with doors (min.)	25⅞	63.8
F Depth without doors (min.)	22⅞	56.2
G Depth of compressor (min.)	19⅞	49.8

\*Add 1¼" (3.2 cm) to the height dimension when leveling legs are fully extended.

This sketch is provided solely for reference to those items noted on the accompanying "Upgrades/Extras". All other details, dimensions & layouts are for illustrative purposes only and may not be applicable to the Purchaser's Model.

Site Thames Lot 20  
Date 12/11/17  
Purchaser Initials JA Production Initials \_\_\_\_\_  
A-S

**IMPORTANT:** Dimensional specifications are provided for planning purposes only. Do not make any cutouts based on this information. Refer to the Installation or Use & Care Guide before selecting cabinetry, verifying electrical/gas connections, making cutouts or beginning installation. All Jenn-Air® appliances are appropriately UL, CUL or CSA approved.

48" SIDE-BY-SIDE REFRIGERATORS WITH ICE & WATER DISPENSER

JS48PPDUDE – 48⅜" x 83⅜" x 27¼" (with handles)  
JS48SSDUDE – 48⅜" x 83⅜" x 27⅞" (with handles)

OPENING/CLEARANCE DIMENSIONS

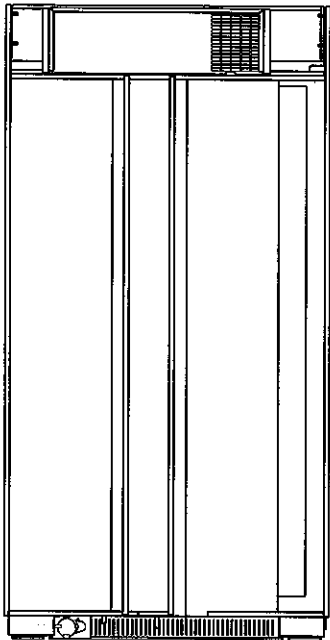
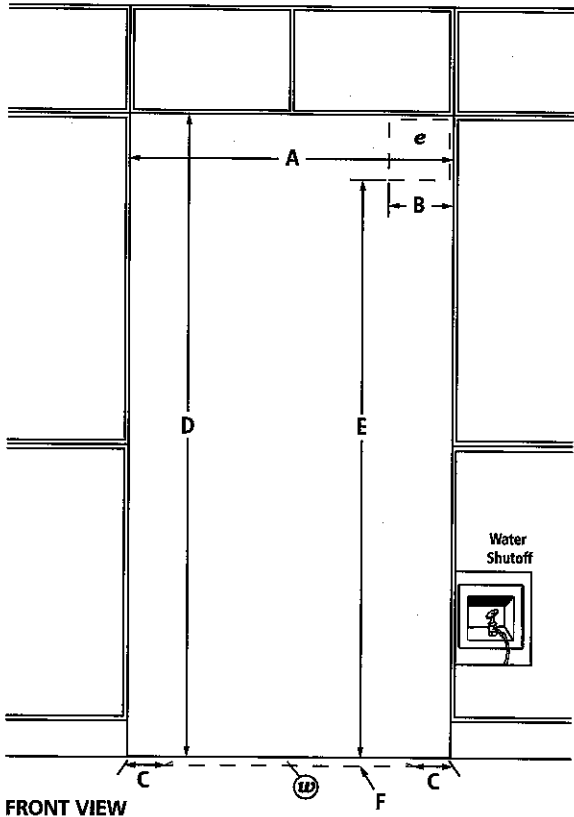

BACK VIEW

MODEL #	JS48PPDUDE JS48SSDUDE	
	in	cm
A	Width (min.)	47½ 120.7
B	Width of recommended electrical location	13½ 34.3
C	Distance from side of cabinet to recommended water connection location	6 15.2
D	Height (min.)	84 213.4
E	Height to recommended electrical location	77 195.6
F	Depth of recommended water connection location (max.)	1 2.5
e	Recommended electrical connection location	
w	Recommended water connection location	

ELECTRICAL REQUIREMENTS

115 volt, 60 Hz, AC only, 15- or 20-amp fused, grounded circuit is required. A dedicated circuit is recommended. Use an outlet that cannot be turned off by a switch.  
Minimum length of power cord is 84" (213.4 cm). Do not use an extension cord.

WATER PRESSURE REQUIREMENTS

A cold water supply with water pressure between 30 and 120 psi (207 and 827 kPa) is required to operate the water dispenser and ice maker. Call a licensed, qualified plumber with any questions about the water pressure.

Reverse Osmosis Water Supply

**IMPORTANT:** The pressure of the water coming out of a reverse osmosis system going to the water inlet valve of the refrigerator needs to be between 30 and 120 psi (207 and 827 kPa).  
If a reverse osmosis water filtration system is connected to the cold water supply, the water pressure to the reverse osmosis system needs to be a minimum of 40 to 60 psi (276 to 414 kPa).

LOCATION REQUIREMENTS

Floor must be able to support refrigerator (more than 600 lb [272 kg]) and contents of the refrigerator and must be at the same level as flooring in the room.

This sketch is provided for A-S- as reference to these items  
and is not intended for use as a blueprint. All other  
details, dimensions, quantities, etc., are for reference purposes  
only and are not to be used for construction or fabrication.

Site James Date 7/11/17  
Purchase Order 20 Product Number 20

**IMPORTANT:** Dimensional specifications are provided for planning purposes only.  
**Do not make any cutouts based on this information.** Refer to the Installation or Use & Care Guide before selecting cabinetry, verifying electrical/gas connections, making cutouts or beginning installation.  
All Jenn-Air® appliances are appropriately UL, CUL or CSA approved.

hot 20 Thomas  
 2/11/17

SA A-5

# Product and Cabinet Opening Dimensions

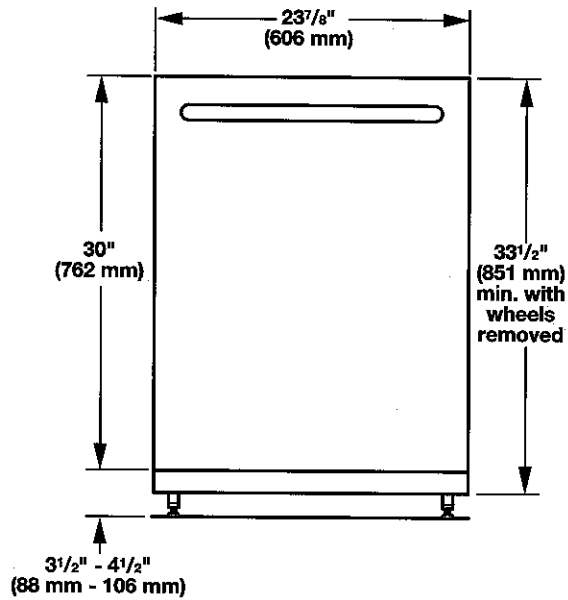

For 4" (100 mm) toe kick, height of cabinet opening is 34 <sup>1</sup>/<sub>2</sub>" (863 mm).

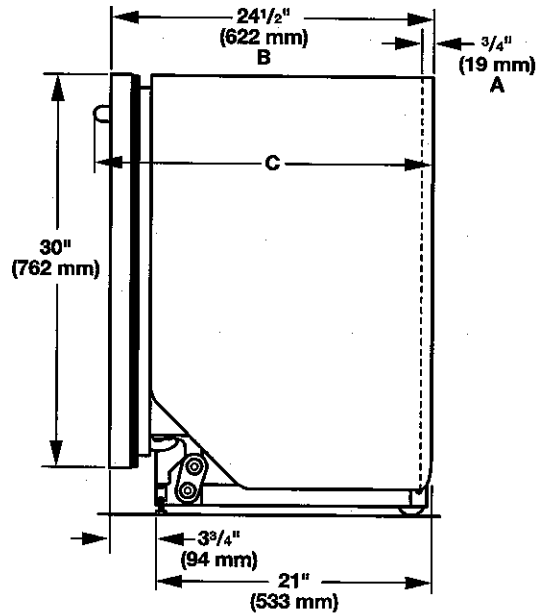

- A. Insulation may be compressed (not used on all models).
- B. For panel-ready models, dishwasher depth is 24" (610 mm), not including the 3/4" (19 mm) custom door panel.
- C. Door handles may protrude forward of the face of the dishwasher, varies by model.

Check that all surfaces have no protrusions that would prohibit dishwasher installation.

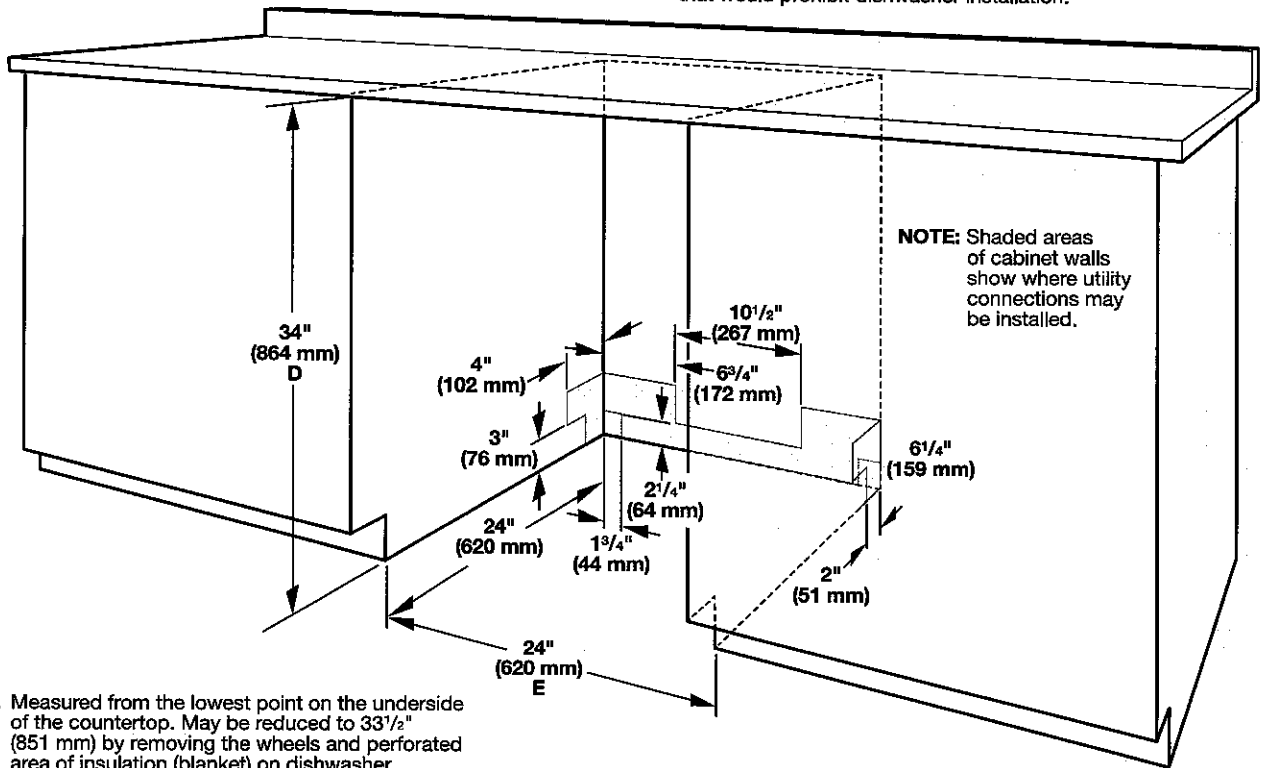

- D. Measured from the lowest point on the underside of the countertop. May be reduced to 33 <sup>1</sup>/<sub>2</sub>" (851 mm) by removing the wheels and perforated area of insulation (blanket) on dishwasher.
- E. Minimum, measured from narrowest point of opening

## DRAIN REQUIREMENTS

- A new drain hose is supplied with your dishwasher. If drain hose is not long enough, use a new drain hose with a maximum length of 12 ft (3.7 m) that meets all current AHAM/IAPMO test standards, is resistant to heat and detergent, and fits the 1" (25 mm) drain connector of the dishwasher. See the "Tools and Parts" section at the front of the guide for part details and orders.

**NOTE:** Do not connect multiple drain hoses together.

- Make sure to connect drain hose to waste tee or disposer inlet above drain trap in house plumbing and 20" (508 mm) minimum above the floor. It is recommended that the drain hose either be looped up and securely fastened to the underside of the counter or be connected to an air gap.
- Make sure to use an air gap if the drain hose is connected to house plumbing lower than 20" (508 mm) above subfloor or floor.

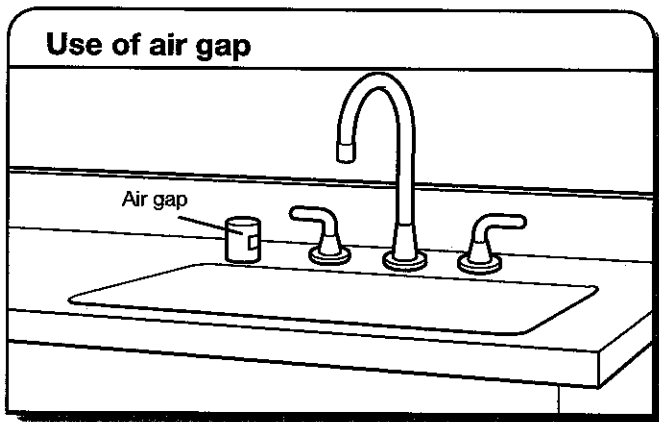

- If required, the air gap should be installed in accordance with the air gap installation instructions. When you are connecting the air gap, a rubber hose (not provided) will be needed to connect to the waste tee or disposer inlet.
- Use 1/2" minimum I.D. drain line fittings.

## WATER SUPPLY REQUIREMENTS

- This dishwasher has a water heating feature and also requires a connection to a hot water supply line.
- A hot water line with 20 to 120 psi (138 to 862 kPa) water pressure can be verified by a licensed plumber.
- 120°F (49°C) water at dishwasher
- 3/8" O.D. copper tubing with compression fitting or flexible braided water supply line. See the "Tools and Parts" section at the front of the guide for part details and orders.

**NOTE:** 1/2" minimum plastic tubing is not recommended.

- A 90° elbow with 3/4" hose connection with rubber washer. See the "Tools and Parts" section at the front of the guide for part details and orders.
- Do not solder within 6" (152 mm) of the water inlet valve.
- If installed in new construction, make sure the house water supply lines have been flushed prior to connecting the dishwasher to remove any debris that may exist in the supply line.

**NOTE:** If replacing an existing dishwasher, it is recommended to install a new water line (see the "Tools and Parts" section at the front of the guide for part details) and drain hose (supplied) with the new dishwasher.

## ELECTRICAL REQUIREMENTS

Be sure that the electrical connection and wire size are adequate and in conformance with the National Electrical Code, ANSI/NFPA 70 - latest edition, and all local codes and ordinances.

A copy of the above code standards can be obtained from:

National Fire Protection Association  
1 Batterymarch Park  
Quincy, MA 02169-7471

### You Must Have:

- 120-volt, 60 Hz, AC-only, 15- or 20-amp, fused electrical supply
- Copper wire only
- A maximum of 2 field wiring supply conductors (12 AWG largest size) plus 1 grounding conductor are permitted in the terminal box.

### We Recommend:

- A time-delay fuse or circuit breaker
- A separate circuit

### If Connecting Dishwasher with a Power Cord:

- Use UL Listed power cord kit marked for use with dishwasher. See the "Tools and Parts" section at the front of the guide for part details and orders.
- Plug into a grounded 3 prong outlet. Outlet must meet all local codes and ordinances.

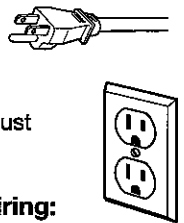

### If Connecting Dishwasher with Direct Wiring:

- Use flexible, armored, or nonmetallic sheathed copper wire with grounding wire that meets the wiring requirements for your home and local codes and ordinances.
- Use a UL Listed/CSA Approved metallic strain relief. See the "Tools and Parts" section at the front of the guide for part details and orders.





CONSTRUCTION SUMMARY

Thames Developments (2011) Ltd. / Havelock Corners

Lot/Unit: 20    Phase/Building: 3    Model/Floor Plan: Bruce (50-5) Elev C

CABINETRY

Inv.4289	1 - LOCATION: KITCHEN	
	SUPPLY A 36" STOVE AND HOOD FAN OPENING IN LIEU OF STANDARD 30"	
Line 54518	Note:	
11Dec17 / 11Dec17		
Inv.4289	1 - LOCATION: KITCHEN	
	SUPPLY A 48" FRIDGE OPENING IN LIEU OF STANDARD 36" OPENING	
Line 54521	Note:	
11Dec17 / 11Dec17		
Inv.4289	1 - LOCATION: KITCHEN	
	RELOCATE THE FRIDGE OPENING AND ELECTRICAL TO END OF WALL AS PER SKETCH ATTACHED	
Line 54540	Note:	
11Dec17 / 11Dec17		

CABINETRY APPLIANCE - FRIDGE

Inv.4289	1 - LOCATION: KITCHEN	
	SUPPLY AND INSTALL DEEP UPPERS (FRIDGE ENCLOSURE) 07H FLUSH INSTALL FOR 48" FRIDGE - SPECS ATTACHED	
Line 54528	Note:	
11Dec17 / 11Dec17		

CABINETRY BASE CABINETS

Inv.4289	1 - LOCATION: KITCHEN	
	BASE PIE CUT CORNER - UPGRADE 1	
Line 54533	Note:	
11Dec17 / 11Dec17		

CABINETRY HARDWARE

Inv.4289	1 - LOCATION: ISLAND	
	BASE WASTE / RECYCLE CENTER PULL OUT DOOR - ONLY AVAILABLE IN 45 CM CABINET (2) 35L BINS - PRICE IS PER UNIT	
Line 54539	Note: TO BE INSTALLED IN ISLAND	
11Dec17 / 11Dec17		

CABINETRY HOOD FANS

Inv.4289	1 - LOCATION: KITCHEN	
	PREMIER HOOD CABINET ONLY 10H (MAXIMUM 36 INCH COOK TOP) - UPGRADE PURCHASER TO SUPPLY AND INSTALL THEIR OWN HOOD INSERT AFTER CLOSING	
Line 54519	Note: SEE SPECS ATTACHED FOR HOOD INSERT	
11Dec17 / 11Dec17		



CONSTRUCTION SUMMARY

Thames Developments (2011) Ltd. / Havelock Corners

Lot/Unit: 20    Phase/Building: 3    Model/Floor Plan: Bruce (50-5) Elev C

Inv.4289	1 - LOCATION: KITCHEN	
	ADD CORBELS (2) TO PREMIER HOOD FAN CABINET - UPGRADE 3	
Line 54520	Note:	
11Dec17 / 11Dec17		

Inv.4289	1 - LOCATION: KITCHEN	
	ADD APPLIQUE TO PREMIER HOOD FAN CABINET - UPGRADE 3	
Line 54524	Note:	
11Dec17 / 11Dec17		

CABINETRY MICROWAVE OVEN STOVE COOKTOP

Inv.4289	1 - LOCATION: KITCHEN	
	RANGETOP CABINET (MODIFIED HEIGHT) WITH DRAWERS BELOW - PURCHASER MUST SUPPLY SPECS - UPGRADE 3	
	LAMINATE COUNTER-TOP	
Line 54525	Note: SEE SPECS ATTACHED	
11Dec17 / 11Dec17		

Inv.4289	1 - LOCATION: KITCHEN	
	BUILT IN DOUBLE APPLIANCE CABINET WITH DRAWER BELOW - 19H FLUSH MOUNT INSTALLATION - SEE SPECS ATTACHED	
Line 54526	Note:	
11Dec17 / 11Dec17		

CABINETRY WALL AND HUTCH

Inv.4289	1 - LOCATION: KITCHEN	
	UPPER ANGLE CORNER - PRICE IS PER UNIT - UPGRADE 1	
Line 54534	Note:	
11Dec17 / 11Dec17		

Inv.4289	1 - LOCATION: UPPER ANGLE CORNER CABINET	
	GLASS DOOR CLEAR - WHITE CABINET INTERIOR - UPGRADE 1	
Line 54535	Note:	
11Dec17 / 11Dec17		

Inv.4289	1 - LOCATION: UPPER ANGLE CORNER CABINET	
	MATCHING INTERIOR FOR GLASS DOOR CABINETS - PRICE IS PER CABINET - UPGRADE 1	
Line 54536	Note:	
11Dec17 / 11Dec17		

ELECTRICAL

Inv.4289	1 - ELECTRICAL - CONNECTION FOR BUILT-IN OVEN	
Line 54531	Note:	
11Dec17 / 11Dec17		





CONSTRUCTION SUMMARY

Thames Developments (2011) Ltd. / Havelock Corners

Lot/Unit: 20    Phase/Building: 3    Model/Floor Plan: Bruce (50-5) Elev C

Inv.4289	1 - LOCATION: KITCHEN	
	SUPPLY AND INSTALL A DEDICATED 20AM ELECTRICAL OUTLET REQUIRED FOR 48" FRIDGE - SEE SPECS ATTACHED	
Line 54532	Note:	
11Dec17 / 11Dec17		

HARDWOOD

Inv.4289	1 - LOCATION: UPPER HALLWAY	
	AS PER SCHEDULE PE ITEM #3 - SUPPLY AND INSTALL NATURAL FINISH HARDWOOD IN LIEU OF CARPET TO THE UPPER HALLWAY. SELECTION IS FROM VEDNOR'S STANDARD SAMPLE	
Line 54515	Note:	
11Dec17 / 11Dec17		

HEATING AND AIR CONDITIONING

Inv.4289	1 - LOCATION: KITCHEN	
	UPGRADE GAS LINE FROM 3/4 INCH TO 1 INCH	
Line 54522	Note:	
11Dec17 / 11Dec17		

Inv.4289	1 - LOCATION: KITCHEN	
	SUPPLY AN 8' DUCT EXHAUST OPENING IN LIEU OF STANDARD 6"	
Line 54523	Note:	
11Dec17 / 11Dec17		

MISCELLANEOUS

Inv.4289	7 - LOCATION: MAIN FLOOR	
	SUPPLY AND INSTALL CURVED ARCHWAYS IN LIEU OF FLAT (NOT TRIMMED) TO AREAS MARKED ON SKETCH ATTACHED	
Line 54565	Note:	
11Dec17 / 11Dec17		

PAINT AND DRYWALL

Inv.4289	1 - SUPPLY AND INSTALL SMOOTH CEILINGS IN LIEU OF STANDARD FEATURE - MAIN FLOOR	
Line 54542	Note:	
11Dec17 / 11Dec17		

PLUMBING

Inv.4289	1 - LOCATION: MASTER ENSUITE	
	FRAMELESS GLASS SHOWER ENCLOSURE WITH FRAMELESS GLASS DOOR. FULL GLASS TO FRONT PORTION ONLY - HALF GLASS NEXT TO OVAL TUB	
Line 54551	Note:	
11Dec17 / 11Dec17		



CONSTRUCTION SUMMARY

Thames Developments (2011) Ltd. / Havelock Corners

Lot/Unit: 20    Phase/Building: 3    Model/Floor Plan: Bruce (50-5) Elev C

Inv.4289	1 - LOCATION: KITCHEN	
	SUPPLY AND INSTALL WATERLINE ROUGH-IN TO THE FRIDGE LOCATION (NO HOOK UP)	
Line 54530	Note:	
11Dec17 / 11Dec17		
Inv.4289	1 - LOCATION: TWIN BATH	
	SHOWER DOOR - CHROME FRAME - GLASS SHOWER DOOR - CLEAR GLASS	
Line 54550	Note:	
11Dec17 / 11Dec17		

EXTRAS AS PER OFFER

VENDOR TO INSTALL 3PC RI AS PER PLAN	
Worksheet Note:	
VENDOR TO INSTALL ENGINEERED HARDWOOD IN THE HALLWAY ON THE 2ND FLOOR IN LIEU OF INCLUDED CARPET AS PER PLAN. ENGINEERED HARDWOOD TO BE SELECTED FROM BUILDERS STANDARD SAMPLES.	
Worksheet Note:	
VENDOR AGREES TO ENLARGE THE BASEMENT WINDOWS TO 24 INCHES X 30 INCHES (where applicable) AS PER PLAN. PURCHASER FURTHER ACKNOWLEDGES THAT THERE MAY BE WINDOW WELLS INSTALLED TO ACCOMMODATE ENLARGED BASEMENT WINDOWS.	
Worksheet Note:	
VENDOR TO INSTALL GAS LINE (ROUGH-IN ONLY) TO KITCHEN IN AT STOVE LOCATION (AS PER PLAN) TO INCLUDE 110V CODE REQUIREMENT.	
Worksheet Note:	
VENDOR TO SUPPLY & INSTALL AIR CONDITIONING UNIT, SIZED ACCORDINGLY, FROM VENDORS STANDARD SAMPLES.	
Worksheet Note:	
VENDOR TO INSTALL CAPPED GAS LINE (ROUGH-IN ONLY) AT REAR OF HOME FOR FUTURE BBQ LOCATION AS MARKED ON SKETCH.	
Worksheet Note:	
PURCHASER ACKNOWLEDGES THAT GRADING PLANS HAVE NOT BEEN FINALIZED AND AS SUCH INFORMATION ON DECK AND WALK OUT CONDITIONS ARE NOT YET AVAILABLE. GRADING IS SUBJECT TO THE TERMS AND CONDITIONS CAPTIONED IN THE AGREEMENT OF PURCHASE AND SALE HEREIN.	
Worksheet Note:	