

Kingsmen (Thames) Inc. / Havelock Corners (Kingsmen)

Lot/Unit: 54    Phase/Building: 4B    Model/Floor Plan: Arthur (4205) Elev B 4 Bed - 4+1 Bath

CABINETRY VANITY

Inv.4953	1 - To supply & install VANITY BANK OF DRAWERS - CLASSIC SERIES in the master ensuite... see sketch # 2	
Line 63881	Note:	
6Apr21 / 15Apr21		

ELECTRICAL

Inv.4953	1 - To supply & install the standard T.V. rough in in the great room and master bedroom... see sketch # 1 & # 2	
	To supply & install the standard Phone ( CAT 5 ) rough in in the great room, master bedroom and computer niche area on the second floor...	
Line 63868	Note: See sketch # 1 & # 2	
6Apr21 / 15Apr21		
Inv.4953	1 - To SUPPLY AND INSTALL CONDUIT FOR TV OVER THE FIREPLACE – TERMINATED IN SAME ROOM at approx. 66" + - up from the floor, centered + - to the F/P mantle and terminated next to + - the std. T.V. & Phone rough in in the great room, see sketch # 1	
Line 63870	Note:	
6Apr21 / 15Apr21		
Inv.4953	1 - To SUPPLY AND INSTALL AN ADDITIONAL BASIC RECEPTACLE (NOT DEDICATED) at approx. 66 " + - up from the floor next to + - the upg. conduit pipe centered + -	
Line 63871	Note: to the F/P mantle... see sketch # 1	
6Apr21 / 15Apr21		
Inv.4953	1 - To SUPPLY AND INSTALL CAT-5 ROUGH IN WIRE PER DROP in the study area on the main floor... see sketech # 1	
Line 63872	Note:	
6Apr21 / 15Apr21		
Inv.4953	1 - To supply & install FOR AN ADDITIONAL SINGLE POLE SWITCH connected to the upgraded ceiling capped elec. over the breakfast bar in the kitchen.	
Line 63874	Note:	
6Apr21 / 15Apr21		
Inv.4953	1 - To SUPPLY AND INSTALL EXTRA CEILING BOX ROUGH IN CAPPED (DOES NOT INCLUDE SWITCH) above the breakfast bar area in the kitchen, see sketch # 1	
Line 63875	Note: This capped elec. will be connected to a sep. switch, see sep. extra.	
6Apr21 / 15Apr21		
Inv.4953	1 - To SUPPLY AND INSTALL REINFORCING FOR A CEILING to the O.T.B. area on the second floor.... see sketch # 2	
Line 63878	Note:	
6Apr21 / 15Apr21		

HEATING AND AIR CONDITIONING

Inv.4953	1 - As per schedule "PE": Vendor to install capped gas line ( rough in only ) at rear of home for future BBQ location. Location to be finalized at vendor sole discretion.	
Line 63861	Note:	
6Apr21 / 15Apr21		

Kingsmen (Thames) Inc. / Havelock Corners (Kingsmen)

Lot/Unit: 54    Phase/Building: 4B    Model/Floor Plan: Arthur (4205) Elev B 4 Bed - 4+1 Bath

Inv.4953	1 - As per schedule "PE": Vendor to install gas line ( rough in only ) to kitchen in at stove location ( as per plan) to include 110V code requirement.	
Line 63862	Note:	
6Apr21 / 15Apr21		
Inv.4953	1 - As per schedule "PE": Vendor to supply & install air conditioning unit, sized accordingly, from endors standard samples.	
Line 63863	Note:	
6Apr21 / 15Apr21		
Inv.4953	1 - To supply & install a HUMMIDIFIER to the furnace...	
Line 63864	Note:	
6Apr21 / 15Apr21		

PAINT AND DRYWALL

Inv.4953	1 - To supply & install the standard COFFERED CEILING in the Dining room... see sketch # 1	
Line 63869	Note:	
6Apr21 / 15Apr21		

PLUMBING

Inv.4953	1 - To supply & install the BLANCO QUATRUS U2 undermount kitchen sink model # 401247 in lieu of the standard under mount sink... see spec's	
Line 63886	Note: Still to install the standard single hole kitchen faucet.	
6Apr21 / 15Apr21		

EXTRAS AS PER OFFER

VENDOR TO INSTALL CAPPED GAS LINE (ROUGH-IN ONLY) AT REAR OF HOME FOR FUTURE BBQ LOCATION. LOCATION TO BE FINALIZED AT VENDORS SOLE DISCRETION. <i>Worksheet</i> Note:	
VENDOR TO INSTALL GAS LINE (ROUGH-IN ONLY) TO KITCHEN IN AT STOVE LOCATION (AS PER PLAN) TO INCLUDE 110V CODE REQUIREMENT. <i>Worksheet</i> Note:	
VENDOR TO SUPPLY & INSTALL AIR CONDITIONING UNIT, SIZED ACCORDINGLY, FROM VENDORS STANDARD SAMPLES. <i>Worksheet</i> Note:	

APR 19 2021

Purchaser: BALJINDER SINGH

Property: 54 of Plan - Draft Approval SB17-03-08

Telephone Res. / Bus: /

Project: Kingsmen (Thames) Inc.

Decor Advisor: Barbara Coccia

Model and Elevation: Arthur (4205) Elev B 4 Bed - 4+1 Bath

Layout Changes: ☐ Yes ☒ No

Sketch Attached: ☒ Yes ☐ No

Exterior Colour Scheme:

### 1. Cabinetry

	Style and Colour	Counter Top	Hardware
Kitchen / Breakfast	#3 Camden Maple Espresso CL	#1, C/S # 9141 Ice Snow 3cm.	# 12843 handle
Kitchen Island	#3 Camden Maple Espresso CL	#1, C/S # 9141 Ice Snow 3cm.	# 12843 handle
Laundry Room			
Powder Room	#3 Camden Maple Espresso CL	4924-38 White Carrara	# 12843 handle
Main Bathroom			
Master Ensuite Bathroom	#3 Charleston 3DL Orchid	#4987K-07 Leche Vesta	# 9661 Handle
Second Ensuite Bathroom (If Applicable)	#3 Charleston 3DL Orchid	#4987K-07 Leche Vesta	# 9661 Handle
Ens. 3 bathroom	#3 Charleston 3DL Orchid	#4987K-07 Leche Vesta	# 9661 Handle
Ens. 4 bathroom	#3 Charleston 3DL Orchid	#4987K-07 Leche Vesta	# 9661 Handle

### Appliances

#### Custom Size Fridge

☐ Yes ☒ No

#### Valance Lighting

☐ Yes ☒ No

#### Microwave / Range Hood

☐ Yes ☒ No

#### Cooktop / Rangetop

☐ Yes ☒ No

#### Built in Wall Oven

☐ Yes ☒ No

#### Slide-in Range

☐ Yes ☒ No

Comment

### 2. Flooring

	Selection
Foyer	13x13" Malena Ice
Main Hall	13x13" Malena Ice
Back Hall	
Breakfast	13x13" Malena Ice
Laundry Room	13x13" Malena Ice
Kitchen	13x13" Malena Ice
Powder Room	13x13" Malena Ice
Main Bathroom	Ens. # 2 bathroom: 13 x 13" Cinq Grey
Master Ensuite	13 x 13" Cinq Grey Shower Floor: 2x2" Soho White Matte
Bathroom (If Applicable)	Ens. #3 bathroom : 13 x 13" Cinq Grey Shower Floor: 2x2" Soho White Matte
Mud Room	13x13" Malena Ice
Ens. #4's Bathroom	13 x 13" Cinq Grey
Living Room	/
Dining Room	3 1/2" Elements Oak Bearskin
Family / Great Room	3 1/2" Elements Oak Bearskin
Den / Library / Study	3 1/2" Elements Oak Bearskin
Basement Landing (If Applies)	
Lower Landing (If Applicable)	/
Upper Landing	/
Upper Hall	Sylsh Story 1, # 919 Early Frost ( including the computer niche area )
Master Bedroom	Sylsh Story 1, # 919 Early Frost
Bedroom #2	Sylsh Story 1, # 919 Early Frost
Bedroom #3	Sylsh Story 1, # 919 Early Frost
Bedroom #4	Sylsh Story 1, # 919 Early Frost
Bedroom #5	/
Shower Jamb/sill	Master ensuite and Ens. #3's bathroom: Anatolia Marmiline SNOW

SEE ATTACHED FOR SIGNATURES



Flooring Continued on Page 2

Initial: \_\_\_\_\_

Page 1 of 3

APR 19 2021

Purchaser: BALJINDER SINGH

Property: 54 of Plan - Draft Approval SB17-03-08

Telephone Res. / Bus: /

Project: Kingsmen (Thames) Inc.

Decor Advisor: Barbara Coccia

Model and Elevation: Arthur (4205) Elev B 4 Bed - 4+1 Bath

### 2. Flooring - Continued -

Upgrade Underpad	Type	Area
	Standard	2nd. Floor
Carpet on Stairs	Capped	Runner - *Upgrade
Comment	/	/

### 3. Plumbing Fixtures / Faucets

Kitchen	Standard	Second Ensuite	Standard	Powder Room	Standard
Master Ensuite	Standard			Other Room	
Main Bathroom		Ens. #3 & #4 bathroom	Standard		

#### Comment

Purchaser has upgraded the kitchen sink, see invoice for details, still to install the std. single hold kitchen faucet.

### 4. Wall Tile

	Tile Selection	Listello	Insert	Insert Selection
Main Bathroom	//	<input type="checkbox"/>	<input type="checkbox"/>	
Master Ensuite				
Tub Deck	/	<input type="checkbox"/>	<input type="checkbox"/>	
Tub Apron	/	<input type="checkbox"/>	<input type="checkbox"/>	
Tub Surround	/	<input type="checkbox"/>	<input type="checkbox"/>	
Shower Stall	8 x 10" Cinq Grey	<input type="checkbox"/>	<input type="checkbox"/>	
Second Ensuite	8 x 10" Cinq Grey	<input type="checkbox"/>	<input type="checkbox"/>	
Ens. #3 bathroom	8 x 10" Cinq Grey	<input type="checkbox"/>	<input type="checkbox"/>	
Ens. #4 bathroom	8 x 10" Cinq Grey	<input type="checkbox"/>	<input type="checkbox"/>	
Kitchen Backsplash	/	<input type="checkbox"/>	<input type="checkbox"/>	
Complete Backsplash	/	<input type="checkbox"/>	<input type="checkbox"/>	

#### Comment

/

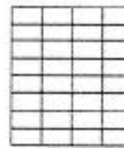

horizontal stacked

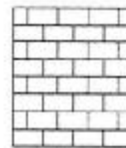

brick pattern



vertical stacked



diagonal/diamond

### 5. Fireplace

	Living Room			Family Room			Other Room - Specify Great/Study		
	Purchased	As Per Plan	N/A	Purchased	As Per Plan	N/A	Purchased	As Per Plan	N/A
Fireplace Type	<input type="radio"/>	<input type="radio"/>	<input checked="" type="radio"/>	<input type="radio"/>	<input type="radio"/>	<input checked="" type="radio"/>	<input type="radio"/>	<input checked="" type="radio"/>	<input type="radio"/>
Mantle Type							2 sided		
Over Mantle							NF-08		
Colour / Stain							/		
Surround							White		
Hearth							/		
Comment							/		

/



SEE ATTACHED FOR SIGNATURES



Initial: \_\_\_\_\_

Page 2 of 3



Purchaser: BALJINDER SINGH

Property: 54 of Plan - Draft Approval SB17-03-08

Telephone Res. / Bus: /

Project: Kingsmen (Thames) Inc.

Decor Advisor: Barbara Coccia

Model and Elevation: Arthur (4205) Elev B 4 Bed - 4+1 Bath

### 6. Trim Carpentry

Door Hardware Standard

Interior Trim Standard

Comment

/

#### Interior Doors

☐ 2 Panel Arch Top

☒ 2 Panel Square Top

☐ 6 Panel



Initial for Door Style



### 7. Railings and Pickets

Railing Package Standard Oak Turned

Railing Colour Elements Bearskin

Wood Stairs ☐ No ☒ Oak

Picket Colour Elements Bearskin

Tread Colour Elements Bearskin

Comment

SEE ATTACHED FOR SIGNATURES

### 8. Plaster Mouldings and Medallions

Foyer /

Main Hall /

Living Room /

Dining Room /

Family Room /

Kitchen/Breakfast /

Den/Library /

Lower Landing /

Comment

/

### 9. Wall Paint

Kingsmen White

#### Smooth Ceilings

☐ First Floor

☐ First Floor incl. Second Floor Hall

☐ First and Second Floor

☒ Throughout

☐ Not Applicable

Trim Paint Kingsmen White

### 10. Additional Comments

/

### 11. Disclaimers and Notes

- Colours of all materials are as close as possible to builder's selection, but not necessarily identical due to variances in manufacturing.
- Any extras listed above are null and void unless accompanied by a separate invoice/amendment. Said invoice must be paid in full.
- The Purchaser acknowledges that after Interior Colour Selection form is signed and dated, no further changes will be permitted other than re-selection due to unavailability. Purchaser's Initials
- The Purchaser acknowledges reading and accepting the "Kingsmen Group Décor Centre Disclaimers" form. This document contains other miscellaneous disclaimers.

SEE ATTACHED FOR SIGNATURES

This Interior Colour Selection is final and approved by:

Purchaser:

Signature: SEE ATTACHED FOR SIGNATURES Date:

Vendor:

Kingsmen (Thames) Inc.

SCHEDULE "B-1"  
Floor Plan

APR 19 2001

Lot 54  
Phase 4B  
Model: Arthur (4205) Elev B 4 Bed - 4+1 Bath  
Standard

Sketch #1

4B-54

Capped wire.  
Dep. Switch

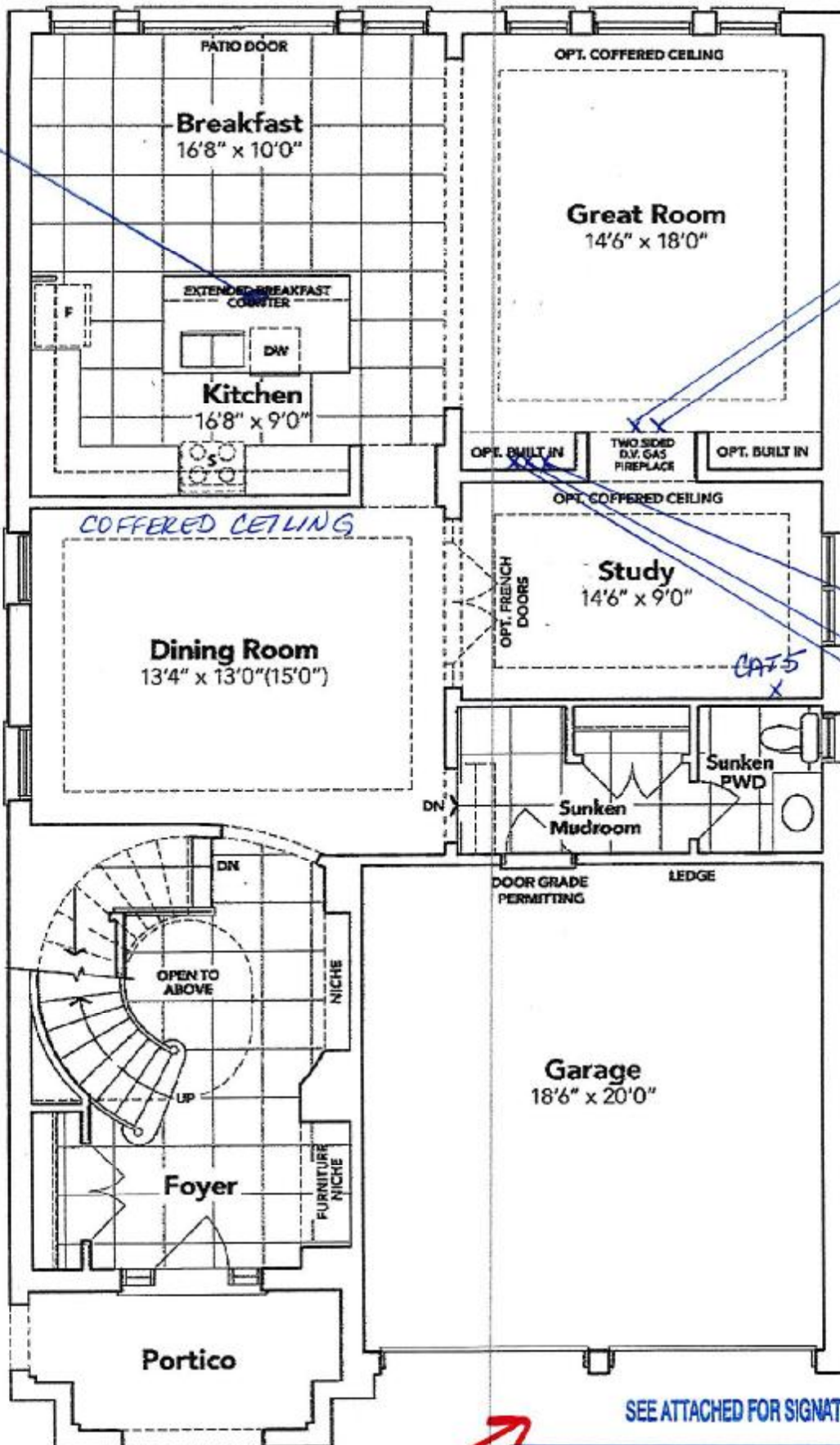

GROUND FLOOR EL. B

SEE ATTACHED FOR SIGNATURES

The floor plans and elevations shown are pre-construction plans and may be revised or improved as necessitated by architectural controls and the construction process. The measurements adhere to the rules and regulations of the TARIION Warranty Corporation's official method for the calculation of floor area. Materials, specifications and floor plans are subject to change without notice. All house renderings are artist's concept only. Actual usable floor space may vary from the stated floor area. All options shown are upgrades. E. & O. E.

SCHEDULE "B-1" - Page 3 of 3



**SCHEDULE "B-1"**  
**Floor Plan**

APR 19 2021  
Lot 54  
Phase 4B  
Model: Arthur (4205) Elev B 4 Bed - 4+1 Bath  
Standard

*Sketch #2*

*4B-54*

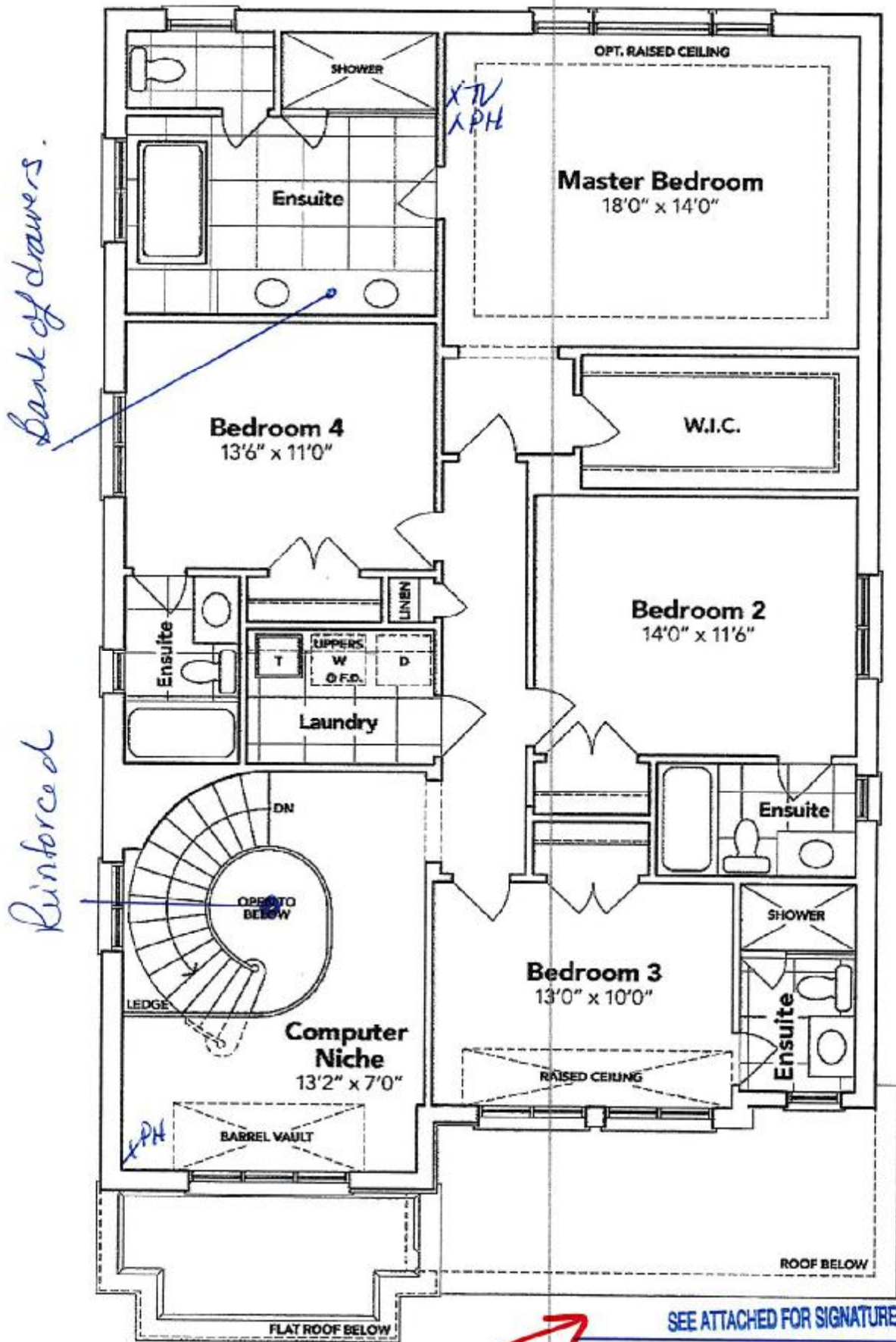

**SECOND FLOOR EL. B**

The floor plans and elevations shown are pre-construction plans and may be revised or improved as necessitated by architectural controls and the construction process. The measurements adhere to the rules and regulations of the TARIION Warranty Corporation's official method for the calculation of floor area. Materials, specifications and floor plans are subject to change without notice. All house renderings are artist's concept only. Actual usable floor space may vary from the stated floor area. All options shown are upgrades. E. & O. E.

SCHEDULE "B-1"  
Floor Plan

APR 19 2021  
Model: Arthur (4205) Elev B 4 Bed - 4+1 Bath  
Standard

Lot 54  
Phase 4B  
4B-54

Sketch #3

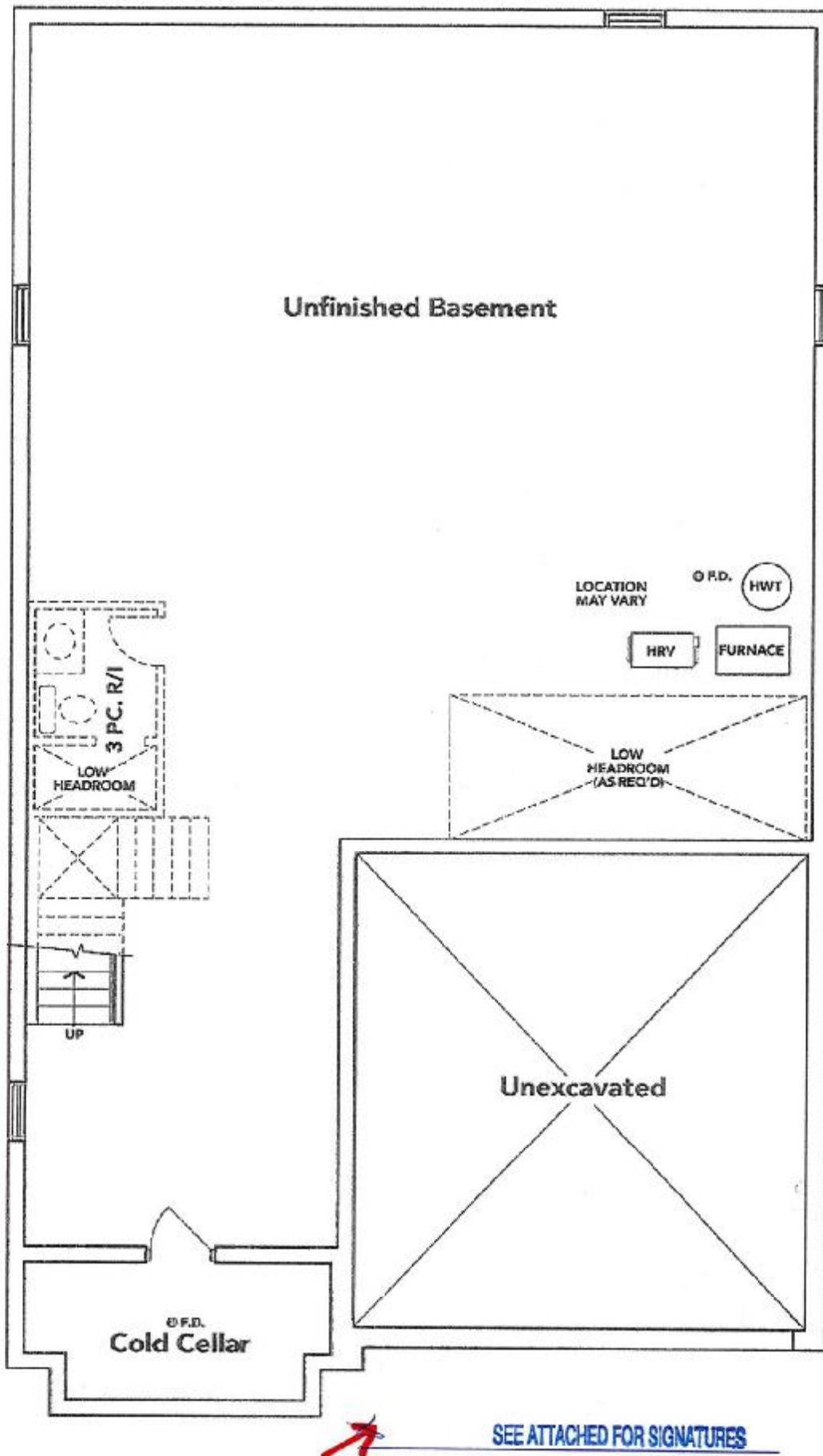

BASEMENT EL. B

The floor plans and elevations shown are pre-construction plans and may be revised or improved as necessitated by architectural controls and the construction process. The measurements adhere to the rules and regulations of the TARIION Warranty Corporation's official method for the calculation of floor area. Materials, specifications and floor plans are subject to change without notice. All house renderings are artist's concept only. Actual usable floor space may vary from the stated floor area. All options shown are upgrades. E. & O. E.



APR 19 2021

4B-54

LOT: 54 Thomas PH: 4B

Re: UPGRADED KITCHEN SINK & SOAP DISPENSER

SEE ATTACHED FOR SIGNATURES



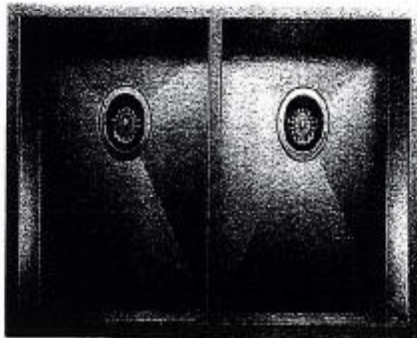

## QUATRUS U2

MODEL: 401247

German engineered with 304 series, 18-gauge stainless steel

Zero-radius corners, X-pattern drain grooves

Double bowl configuration for easy multi-tasking

18/10 chrome-nickel content for exceptional luster, durability and strength

Undermount installation

Minimum cabinet size: 36"