

Kingsmen (Thames) Inc. / Havelock Corners (Kingsmen)

Lot/Unit: 55 Phase/Building: 4B Model/Floor Plan: Arthur (4205) Elev A 4 Bed - 4+1 Bath

CABINETRY APPLIANCE - FRIDGE

Inv.4959	1 - To supply & install the 66CM DEEP FRIDGE ENCLOSURE - COUNTER DEPTH WITH - 1 WALL - 1 66CM DEEP GABLE AND 1 66CM DEEP CABINET - ' WITH FLIP UP DOOR ' THIS IS NOT A ZERO CLEARANCE ENCLOSURE. STANDARD HEIGHTS AND WIDTHS WILL BE USED.CLASSIC SERIES	
Line 63915	Note: in the kitchen... see sketch # 1	
9Apr21 / 21Apr21		

CABINETRY BASE CABINETS

Inv.4959	1 - To supply & install an additional BANK OF DRAWERS CABINET - - SIZE SUBJECT TO FLOOR PLAN - CLASSIC SERIES in the kitchen... see sketch # 1	
Line 63916	Note:	
9Apr21 / 21Apr21		

CABINETRY VANITY

Inv.4959	1 - To supply & install a VANITY BANK OF DRAWERS - CLASSIC SERIES in the master ensuite... see sketch # 2	
Line 63917	Note:	
9Apr21 / 21Apr21		

ELECTRICAL

Inv.4959	1 - To supply & install the standard T.V. rough in in the great room and master bedroom... see sketch # 1 & # 2	
Line 63909	Note:	
9Apr21 / 21Apr21		
Inv.4959	1 - To supply & install the std. Phone (CAT 5) rough in in the great room, master bedroom and computer niche area on the second floor...see sketch # 1 & # 2	
Line 63910	Note:	
9Apr21 / 21Apr21		
Inv.4959	1 - To SUPPLY AND INSTALL CONDUIT FOR TV OVER THE FIREPLACE – TERMINATED IN SAME ROOM at approx. 66 " + - up from the floor centered + - to the F/P mantle and terminated next to + - the std. T.V. and Phone (CAT 5) rough in in the great room..see sketch # 1	
Line 63911	Note:	
9Apr21 / 21Apr21		
Inv.4959	1 - To SUPPLY AND INSTALL AN ADDITIONAL BASIC RECEPTACLE (NOT DEDICATED) at approx. 66 " + - up from the floor centered + - to the F/P mantle next to	
Line 63912	Note: + - the upgraded conduit pipe... see sketch # 1	
9Apr21 / 21Apr21		
Inv.4959	1 - To SUPPLY AND INSTALL EXTRA CEILING BOX ROUGH IN CAPPED (DOES NOT INCLUDE SWITCH) over the breakfast bar at kitchen island... see sketch # 1	
Line 63913	Note: This capped elec. will be connected to a sep. switch, switch sold sep.	
9Apr21 / 21Apr21		
Inv.4959	1 - To supply & install AN ADDITIONAL SINGLE POLE SWITCH connected to the upgraded capped ceiling elec. over the breakfast bar in the kitchen.	
Line 63914	Note:	
9Apr21 / 21Apr21		

Kingsmen (Thames) Inc. / Havelock Corners (Kingsmen)

Lot/Unit: 55 Phase/Building: 4B Model/Floor Plan: Arthur (4205) Elev A 4 Bed - 4+1 Bath

FIREPLACE

Inv.4989	1 - To supply & install the NF-20 white F/P mantle to both sides of the 2 sided fireplace between the great room and study area in lieu of the original F/P mantles selected on April 21, 2021.	
Line 64299	Note: Reslection was requested by the F/P supplier, this will be at no charge.	
29Apr21 / 29Apr21		

HEATING AND AIR CONDITIONING

Inv.4959	1 - As per Schedule "PE": Vendor to install capped gas line (rough in only) at rear of home for future BBQ locaion. Location to be finalized at Vendors sole discrection.	
Line 63903	Note:	
9Apr21 / 21Apr21		
Inv.4959	1 - As per Schedule "PE": Vendor to install gas line (rough in only) to kitchen in at stove location. (as per plan) to include 110V code requirement.	
Line 63904	Note:	
9Apr21 / 21Apr21		
Inv.4959	1 - As per Schedule "PE": Vendor to supply & install air conditioning unit, sized accordingly, from vendors standard samples.	
Line 63905	Note:	
9Apr21 / 21Apr21		

MISCELLANEOUS

Inv.4959	1 - To supply & instal the standard COFFERED CEILING in the dining room as per plan... see sketch # 1	
Line 63908	Note:	
9Apr21 / 21Apr21		

PLUMBING

Inv.4959	1 - To supply & install the BLANCO QUATRUS U2 under mount kitchen sink model 401247 in lieu of the standard under mount kitchen sink... see spec's	
Line 63918	Note: Still to install the standard single hole kitchen faucet.	
9Apr21 / 21Apr21		
Inv.4959	1 - To supply & install the upgraded MIROIN " BROOKE " free standing tub in the master ensuite in lieu of the std. free standing tub... see spec's	
Line 63906	Note:	
9Apr21 / 21Apr21		
Inv.4959	2 - Raise the standard toe tester in the master ensuite and ensuite #3's shower to approx. 22" + - up from unfinished floors..	
Line 63907	Note:	
9Apr21 / 21Apr21		



CONSTRUCTION SUMMARY

Kingsmen (Thames) Inc. / Havelock Corners (Kingsmen)

Lot/Unit: 55 Phase/Building: 4B Model/Floor Plan: Arthur (4205) Elev A 4 Bed - 4+1 Bath

EXTRAS AS PER OFFER

VENDOR TO INSTALL CAPPED GAS LINE (ROUGH-IN ONLY) AT REAR OF HOME FOR FUTURE BBQ LOCATION. LOCATION TO BE FINALIZED AT VENDORS SOLE DISCRETION. <i>Worksheet</i> Note:	
VENDOR TO INSTALL GAS LINE (ROUGH-IN ONLY) TO KITCHEN IN AT STOVE LOCATION (AS PER PLAN) TO INCLUDE 110V CODE REQUIREMENT. <i>Worksheet</i> Note:	
VENDOR TO SUPPLY & INSTALL AIR CONDITIONING UNIT, SIZED ACCORDINGLY, FROM VENDORS STANDARD SAMPLES. <i>Worksheet</i> Note:	

Purchaser: DALJIT SINGH BRAR

Property: 55 of Plan - Draft Approval SB17-03-08

Telephone Res. / Bus: /

Project: Kingsmen (Thames) Inc.

Decor Advisor: Barbara Coccia

Model and Elevation: Arthur (4205) Elev A 4 Bed - 4+1 Bath

Layout Changes: ☐ Yes ☒ No Sketch Attached: ☒ Yes ☐ No Exterior Colour Scheme:

1. Cabinetry

	Style and Colour	Counter Top	Hardware
Kitchen / Breakfast	#3 Manchester Maple Shale Grey CL	#1 C/S #9141 Ice Snow 3cm	12881 Handle
Kitchen Island	#3 Manchester Maple Shale Grey CL	#1 C/S #9141 Ice Snow 3cm	12881 Handle
Laundry Room	/	/	/
Powder Room	#3 Soho LPL Cafe Noir	Calcutta Marble 4925K-07	12881 Handle
Main Bathroom	/	/	/
Master Ensuite Bathroom	#3 Manchester Maple Shale Grey CL	Calcutta Marble 4925K-07	12881 Handle
Second Ensuite Bathroom (If Applicable)	#3 Manchester Maple Shale Grey CL	Calcutta Marble 4925K-07	12881 Handle
Bedroom #3 Bathroom	#3 Manchester Maple Shale Grey CL	Calcutta Marble 4925K-07	12881 Handle
Bedroom #4 Bathroom	#3 Manchester Maple Shale Grey CL	Calcutta Marble 4925K-07	12881 Handle

Appliances

Custom Size Fridge

☐ Yes ☒ No

Cooktop / Rangetop

☐ Yes ☒ No

Valance Lighting

☐ Yes ☒ No

Built in Wall Oven

☐ Yes ☒ No

Microwave / Range Hood

☐ Yes ☒ No

Slide-in Range

☐ Yes ☒ No

Comment

2. Flooring

Selection

Foyer	13x13" Keaton Ice
Main Hall	13x13" Keaton Ice
Back Hall	/
Breakfast	13x13" Keaton Ice
Laundry Room	13x13" Keaton Ice
Kitchen	13x13" Keaton Ice
Powder Room	13x13" Keaton Ice
Main Bathroom	(Bedroom #2 Bathroom)-13x13" Keaton Ice
Master Ensuite	13x13" Keaton Ice SH/FL: 2x2" Soho White Matte
Bathroom (If Applicable)	(Bedroom #3 Bathroom)-13x13" Keaton Ice SH/FL: 2x2" Soho White Matte
Mud Room	13x13" Keaton Ice
Bedroom #4 Bathroom	13x13" Keaton Ice
Living Room	/
Dining Room	3 1/2" Elements Oak Sturgeon
Family / Great Room	3 1/2" Elements Oak Sturgeon
Den / Library / Study	3 1/2" Elements Oak Sturgeon
Basement Landing (If Applies)	/
Lower Landing (If Applicable)	/
Upper Landing	/
Upper Hall	Stylish Story 1: Iron Bars (Including Computer Niche)
Master Bedroom	Stylish Story 1: Iron Bars
Bedroom #2	Stylish Story 1: Iron Bars
Bedroom #3	Stylish Story 1: Iron Bars
Bedroom #4	Stylish Story 1: Iron Bars
Bedroom #5	/
Shower Jams	Master Bedroom and Bedroom #3: Anatolia Marmiline SNOW

SEE ATTACHED FOR SIGNATURES



Flooring Continued on Page 2

Initial: _____

Page 1 of 3

Purchaser: DALJIT SINGH BRAR

Property: 55 of Plan - Draft Approval SB17-03-08

Telephone Res. / Bus: /

Project: Kingsmen (Thames) Inc.

Decor Advisor: Barbara Coccia

Model and Elevation: Arthur (4205) Elev A 4 Bed - 4+1 Bath

2. Flooring - Continued -

Upgrade Underpad	Type	Area
	Standard	2nd Floor
Carpet on Stairs	Capped	Runner - *Upgrade
	/	/

Comment

3. Plumbing Fixtures / Faucets

Kitchen	Standard	Second Ensuite	Standard	Powder Room	Standard
Master Ensuite	Standard			Other Room	
Main Bathroom	/	Bedroom #3/#4 Bathroom	Standard		

Comment

NOTE: To supply and install the upgraded kitchen sink and standard single hole faucet in the kitchen. To supply and install the standard topmount sinks and faucets in all bathrooms (Powder Room, Master Ensuite, Bedroom #2, #3 and #4).

4. Wall Tile

	Tile Selection	Listello	Insert	Insert Selection
Main Bathroom	/	<input type="checkbox"/>	<input type="checkbox"/>	/
Master Ensuite	/	<input type="checkbox"/>	<input type="checkbox"/>	/
Tub Deck	/	<input type="checkbox"/>	<input type="checkbox"/>	/
Tub Apron	/	<input type="checkbox"/>	<input type="checkbox"/>	/
Tub Surround	/	<input type="checkbox"/>	<input type="checkbox"/>	/
Shower Stall	8x10" Cinq Black	<input type="checkbox"/>	<input type="checkbox"/>	/
Second Ensuite	8x10" Keaton Ice	<input type="checkbox"/>	<input type="checkbox"/>	/
Bedroom #3 Bathroom	8x10" Keaton Ice	<input type="checkbox"/>	<input type="checkbox"/>	/
Bedroom #4 Bathroom	8x10" Keaton Ice	<input type="checkbox"/>	<input type="checkbox"/>	/
Kitchen Backsplash	/	<input type="checkbox"/>	<input type="checkbox"/>	/
Complete Backsplash	/	<input type="checkbox"/>	<input type="checkbox"/>	/

Comment

NOTE: To supply and install all wall tiles in all bathrooms (Master, Bedroom #2, #3 and #4) on the 10" side horizontally stacked.

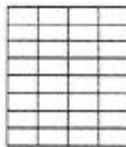

horizontal stacked

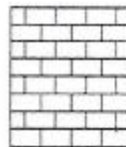

brick pattern



vertical stacked

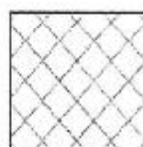

diagonal/diamond

5. Fireplace

	Living Room			Family Room			Other Room - Specify Greatroom		
	Purchased	As Per Plan	N/A	Purchased	As Per Plan	N/A	Purchased	As Per Plan	N/A
Fireplace Type	<input type="radio"/>	<input type="radio"/>	<input type="radio"/>	<input type="radio"/>	<input type="radio"/>	<input type="radio"/>	<input checked="" type="radio"/>	<input type="radio"/>	<input type="radio"/>
Mantle Type							Front Facing		
Over Mantle							NF-08		
Colour / Stain							White		
Surround							/		
Hearth							/		

Comment

SEE ATTACHED FOR SIGNATURES

Initial:

Page 2 of 3

Purchaser: DALJIT SINGH BRAR

Property: 55 of Plan - Draft Approval SB17-03-08

Telephone Res. / Bus: /

Project: Kingsmen (Thames) Inc.

Decor Advisor: Barbara Coccia

Model and Elevation: Arthur (4205) Elev A 4 Bed - 4+1 Bath

6. Trim Carpentry

Door Hardware

Interior Trim

Comment

Interior Doors

☐ 2 Panel Arch Top

☒ 2 Panel Square Top

☐ 5 Panel



Initial for Door Style

7. Railings and Pickets

Railing Package

Railing Colour

Wood Stairs ☐ No ☒ Oak

Picket Colour

Tread Colour

Comment

SEE ATTACHED FOR SIGNATURES

8. Plaster Mouldings and Medallions

Foyer

Kitchen/Breakfast

Main Hall

Den/Library

Living Room

Lower Landing

Dining Room

/

Family Room

Comment

9. Wall Paint

Kingsmen White

Smooth Ceilings ☐ First Floor

☐ First Floor incl. Second Floor Hall

☐ First and Second Floor

☒ Throughout

☐ Not Applicable

Trim Paint

10. Additional Comments

11. Disclaimers and Notes

- Colours of all materials are as close as possible to builder's selection, but not necessarily identical due to variances in manufacturing.
- Any extras listed above are null and void unless accompanied by a separate invoice/amendment. Said invoice must be paid in full.
- The Purchaser acknowledges that after Interior Colour Selection form is signed and dated, no further changes will be permitted other than re-selection due to unavailability. Purchaser's Initials **SEE ATTACHED FOR SIGNATURES**
- The Purchaser acknowledges reading and accepting the "Kingsmen Group Décor Centre Disclaimers" form. This document contains other miscellaneous disclaimers.

This Interior Colour Selection is final and approved by:

Purchaser:

Signature: **SEE ATTACHED FOR SIGNATURES** Date: _____

Vendor:

Kingsmen (Thames) Inc.

SCHEDULE "B-1"
Floor Plan

LOT 55
Phase 4B
Model: Arthur (4205) Elev A 4 Bed - 4+1 Bath
Standard

LOT 55 THAMES PH. 4 B
SKETCH # 1

4B-55

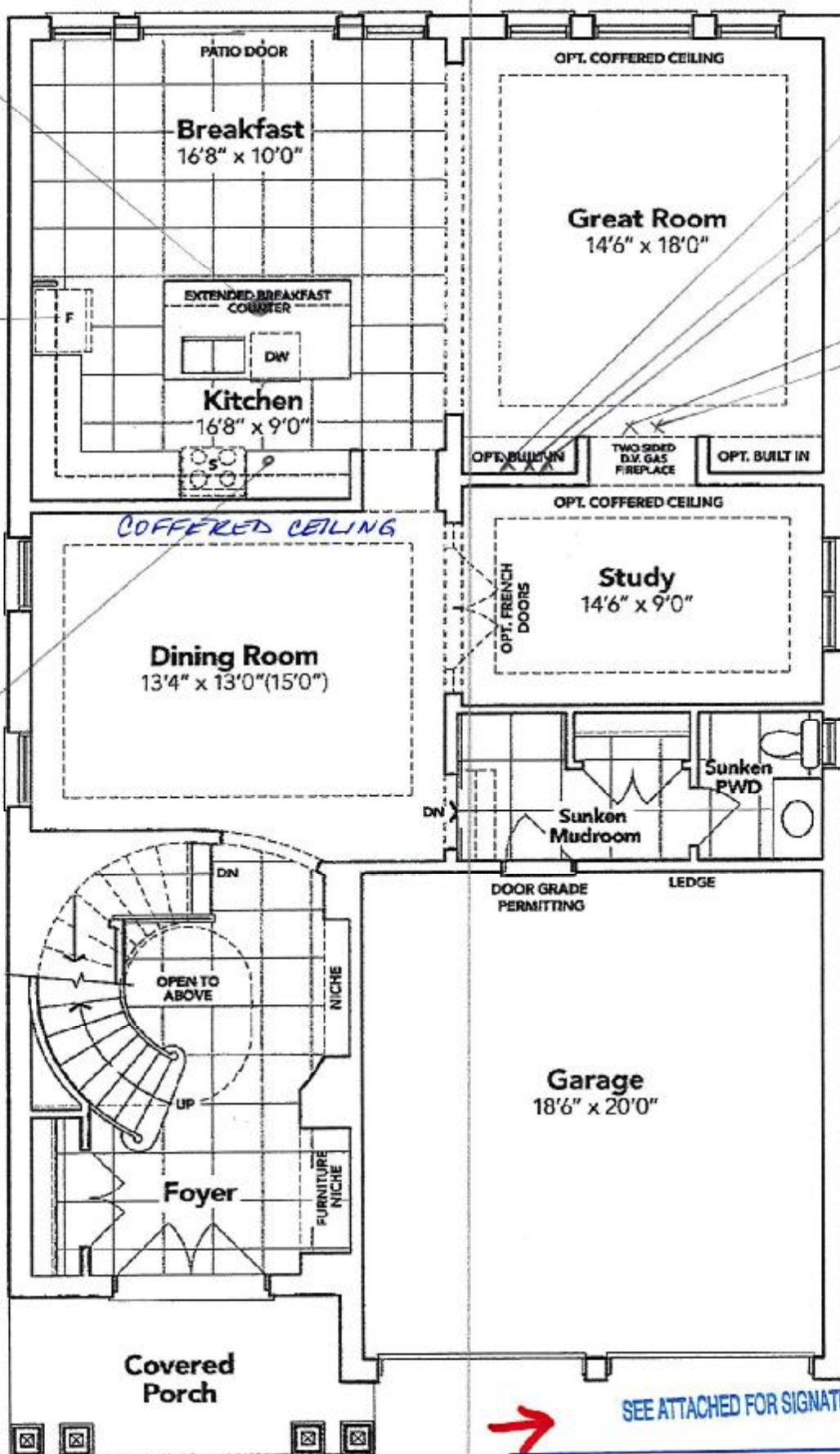

GROUND FLOOR EL. A

The floor plans and elevations shown are pre-construction plans and may be revised or improved as necessitated by architectural controls and the construction process. The measurements adhere to the rules and regulations of the TARION Warranty Corporation's official method for the calculation of floor area. Materials, specifications and floor plans are subject to change without notice. All house renderings are artist's concept only. Actual usable floor space may vary from the stated floor area. All options shown are upgrades. E. & O. E.

SCHEDULE "B-1"
Floor Plan

LOT 55
Phase 4B
Model: Arthur (4205) Elev A 4 Bed - 4+1 Bath
Standard

LOT 55 THAMES PH. 4 B
SKETCH # 2

4B-55

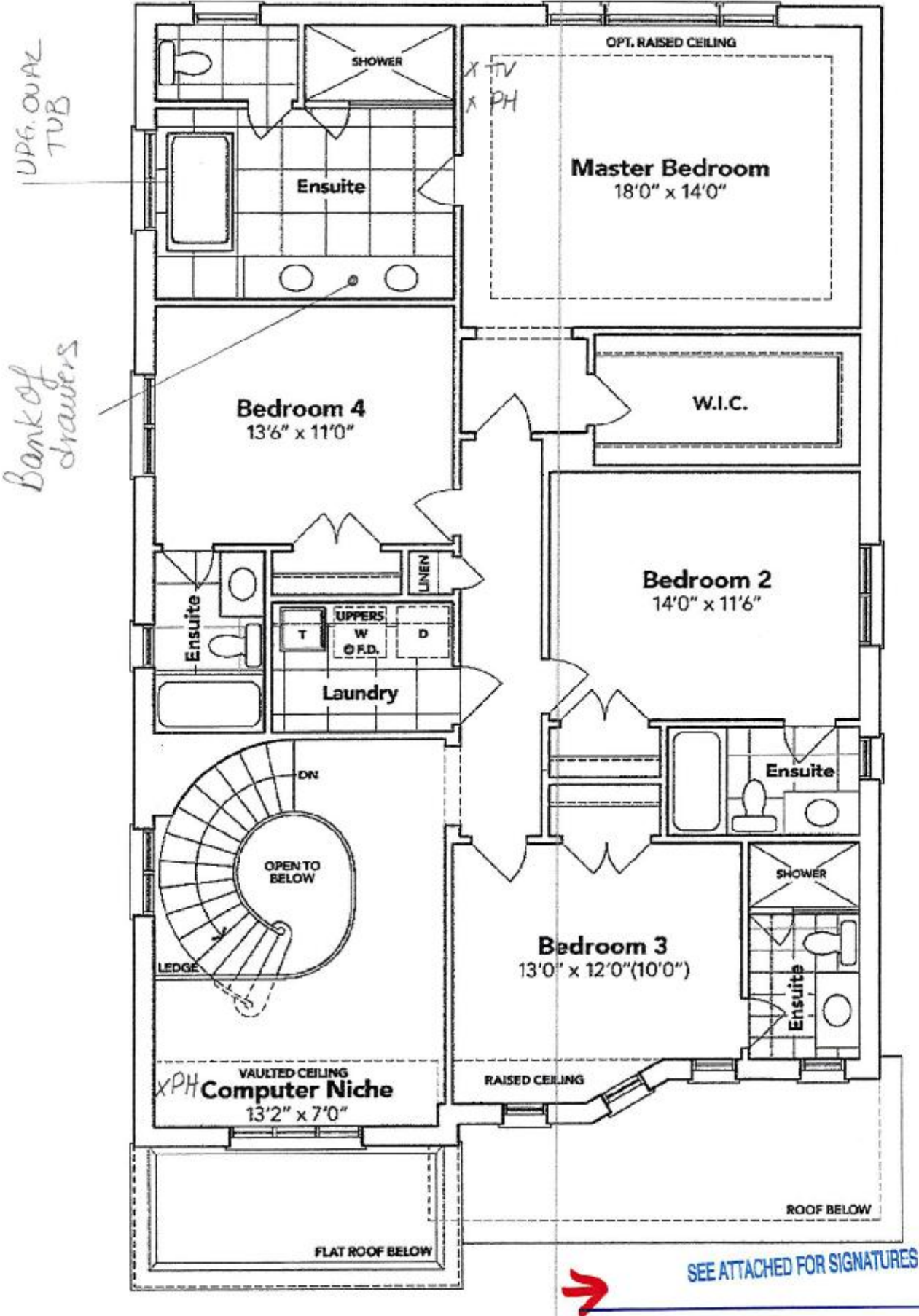

SECOND FLOOR EL. A

SEE ATTACHED FOR SIGNATURES

The floor plans and elevations shown are pre-construction plans and may be revised or improved as necessitated by architectural controls and the construction process. The measurements adhere to the rules and regulations of the TARION Warranty Corporation's official method for the calculation of floor area. Materials, specifications and floor plans are subject to change without notice. All house renderings are artist's concept only. Actual usable floor space may vary from the stated floor area. All options shown are upgrades. E. & O. E.

Initials: DS

SCHEDULE "B-1"
Floor Plan

LOT 55 THAMES PH. 4 B
SKETCH # 3

Lot 55
Phase 4B
Model: Arthur (4205) Elev A 4 Bed - 4+1 Bath
Standard

4B-55

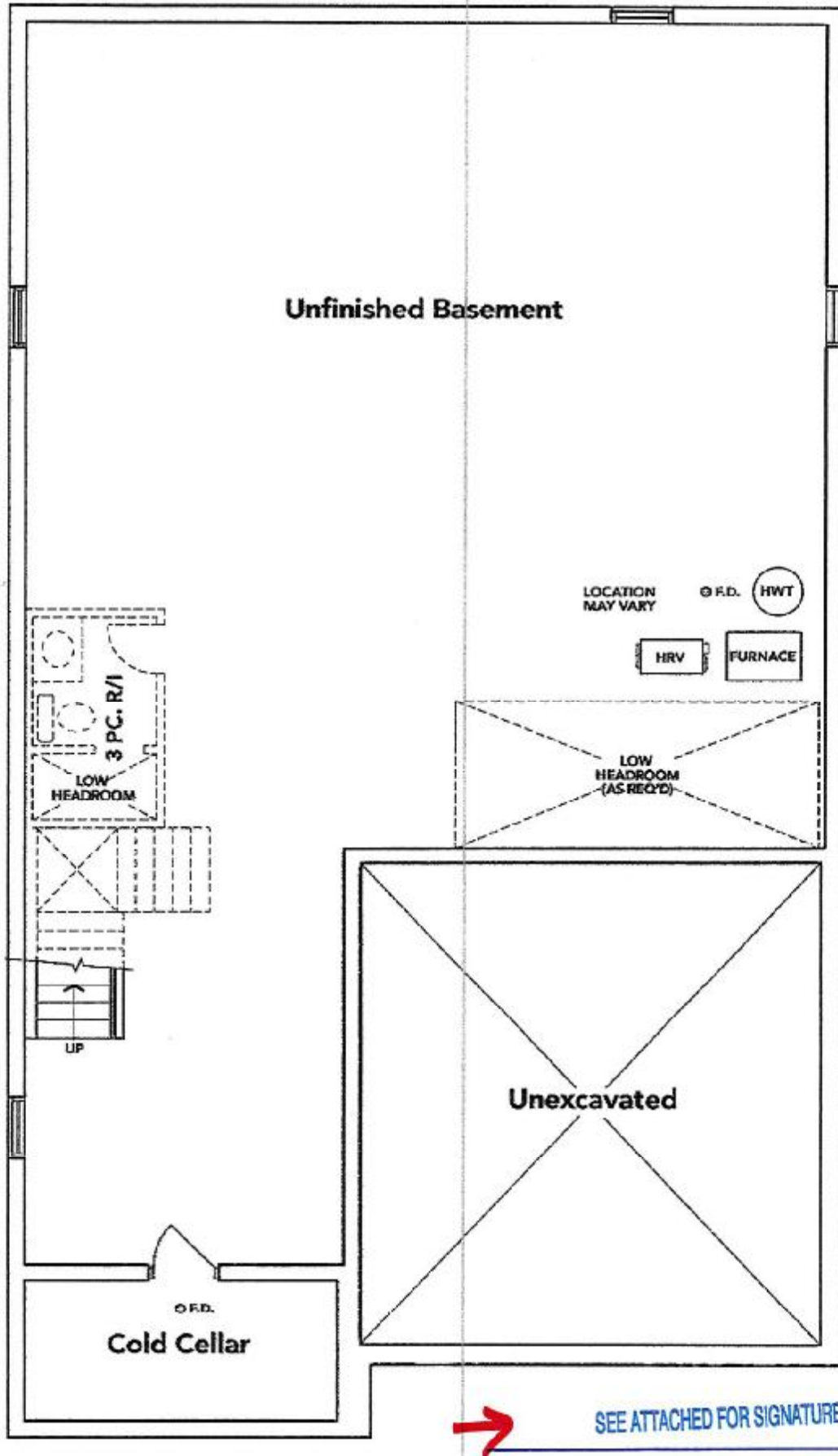

BASEMENT EL. A

The floor plans and elevations shown are pre-construction plans and may be revised or improved as necessitated by architectural controls and the construction process. The measurements adhere to the rules and regulations of the TARION Warranty Corporation's official method for the calculation of floor area. Materials, specifications and floor plans are subject to change without notice. All house renderings are artist's concept only. Actual usable floor space may vary from the stated floor area. All options shown are upgrades. E. & O. E.

4B-55

LOT 55 THAMES PH. 4 B

RE: UPGRADED TUB FOR MASTER ENSUITE

SEE ATTACHED FOR SIGNATURES



Brooke™ | 1

Brooke™

Categories: Acrylic Freestanding

DESCRIPTION

68" Freestanding Bath
SKU #: CF2002

FEATURES

- Installation friendly two piece design
- Accepts deck mounted faucet
- Includes a chrome integral pop up drain and rectangular overflow
- ~~Brushed nickel drain and overflow covers available~~
- Centre drain
- Includes levelling feet
- Available in White Only

DIMENSIONS

68" x 36" x 23"



RE: UPGRADED KITCHEN SINK

BLANCO

Sink Specifications

Colour	SKU
brushed finish	401247

Design and planning tips

- Min cabinet size: 36 in (915 mm)
- Bowl Depth: 9 in (230.0 mm)

Specifications:

Installation clips, Sink template, Installation instructions, 3 1/2" (90 mm) stainless steel strainers

Depending on cabinet construction, a different cabinet size may be required. Consult the cabinet manufacturer.

QUATRUS U 2

