

Kingsmen (Thames) Inc. / Havelock Corners (Kingsmen)

Lot/Unit: 117    Phase/Building: 4B    Model/Floor Plan: Spencer (4204) Elev C 4 Bed - 4+1 Bath

CABINETRY

Inv.4995	1 - To accomodate the cabinetry for the 36" hoodfan	
Line 64438	Note:	
4May21 / 12May21		
Inv.4995	1 - To accomdate for a 36" opening stove opening in the kitchen.	
Line 64446	Note:	
4May21 / 12May21		

CABINETRY APPLIANCE - FRIDGE

Inv.4995	1 - To supply and install 66CM DEEP FRIDGE ENCLOSURE - COUNTER DEPTH WITH - 1 WALL - 1 66CM DEEP GABLE AND 1 66CM DEEP CABINET - THIS IS NOT A ZERO CLEARANCE ENCLOSURE. STANDARD HEIGHTS AND WIDTHS WILL BE USED. - CLASSIC SERIES	
Line 64448	Note: See fridge spec's	
4May21 / 12May21		

CABINETRY BASE CABINETS

Inv.4995	1 - To supply and install BANK OF DRAWERS CABINET - approx. 40cm wide + - - SIZE SUBJECT TO FLOOR PLAN - CLASSIC SERIES in the kitchen.. see sketch #1	
Line 64450	Note:	
4May21 / 12May21		

CABINETRY HOOD FANS

Inv.4995	1 - To supply and install HOOD FAN - PRO COLLECTION (SCB72236-NF) WALL MOUNT RANGE HOOD WITH 650 CFM FAN - 36 INCH - in lieu of the standard hoodfan	
Line 64437	Note:	
4May21 / 12May21		

CABINETRY MICROWAVE OVEN STOVE COOKTOP

Inv.4995	1 - To accomodate for the futur 36" COOKTOP CABINET WITH FALSE TOP DRAWER AND POTS AND PANS DRAWERS BELOW - SUPPLY SPECS - CLASSIC SERIES in the kitchen... see sketch # 1	
Line 64444	Note:	
4May21 / 12May21		
Inv.4995	1 - To accomodate for the future BUILT-IN TALL APPLIANCE CABINET WITH DRAWER - S BELOW FOR PANEL-MOUNT - PROUD - OR TRIM KIT INSTALLATIONS - TRIM KIT REQUIRED - SUPPLY ALL SPECS AND INSTALLATION GUIDES - COUNTER DEPTH - CLASSIC SERIES in the kitchen..	
Line 64445	Note: See sketch # 1	
4May21 / 12May21		

CABINETRY PANTRY

Inv.4995	1 - To supply & install a 12" + - wide PANTRY 66 CM DEEP IN LIEU OF UPPER - BASE - COUNTER DEPTH - CLASSIC SERIES in the kitchen... see sketch # 1	
Line 64469	Note:	
4May21 / 12May21		

COUNTER TOP

Kingsmen (Thames) Inc. / Havelock Corners (Kingsmen)

Lot/Unit: 117    Phase/Building: 4B    Model/Floor Plan: Spencer (4204) Elev C 4 Bed - 4+1 Bath

Inv.4995 Line 64447 4May21 / 12May21	1 - To accomodate the quartz countertop for the 36" cooktop.. see spec's Note:	
Inv.4995 Line 64423 4May21 / 12May21	1 - As per Schedule "PE": Vendor to include level 1, 2cm. granite or quartz in all bathrooms, as per plan, in lieu of the included laminate counter tops. Selections to be made from builders standard samples. Note:	

COUNTER TOP - KITCHEN

Inv.4995 Line 64466 4May21 / 12May21	1 - To supply and install COUNTER TOP - KITCHEN - KITCHEN - 3CM COUNTER TOP - UPGRADE LEVEL 3 in lieu of the standard counter top Note:	
--	--	--

COUNTER TOP - VANITY

Inv.4995 Line 64461 4May21 / 12May21	1 - To supply and install COUNTER TOP - VANITY - MASTER ENSUITE - 2CM COUNTER TOP - UPGRADE LEVEL 3 in lieu of the standard counter top Note:	
Inv.4995 Line 64462 4May21 / 12May21	1 - To supply and install COUNTER TOP - VANITY - POWDER ROOM - 2CM COUNTER TOP - UPGRADE LEVEL 3 in lieu of the standard counter top Note:	
Inv.4995 Line 64463 4May21 / 12May21	1 - To supply and install COUNTER TOP - VANITY - ENSUITE 2 - 2CM COUNTER TOP - UPGRADE LEVEL 3 in lieu of the standard counter top Note:	
Inv.4995 Line 64464 4May21 / 12May21	1 - To supply and install COUNTER TOP - VANITY - ENSUITE 3 - 2CM COUNTER TOP - UPGRADE LEVEL 3 in lieu of the standard counter top Note:	
Inv.4995 Line 64465 4May21 / 12May21	1 - To supply and install COUNTER TOP - VANITY - ENSUITE 4 - 2CM COUNTER TOP - UPGRADE LEVEL 3 in lieu of the standard counter top Note:	

ELECTRICAL

Inv.4995 Line 64431 4May21 / 12May21	1 - To supply and install the standard T.V rough-in, in the Great Room and Master Bedroom... see sketch #1 and #2 Note:	
Inv.4995 Line 64432 4May21 / 12May21	1 - To supply and install the standard Phone (CAT 5) rough-in, in the Great Room, Master Bedroom and Media Niche.. See sketch #1 and #2 Note:	

**Kingsmen (Thames) Inc. / Havelock Corners (Kingsmen)**

**Lot/Unit: 117    Phase/Building: 4B    Model/Floor Plan: Spencer (4204) Elev C 4 Bed - 4+1 Bath**

Inv. <b>4995</b>  <b>Line 64433</b>  4May21 / 12May21	<b>1</b> - To SUPPLY AND INSTALL AN ADDITIONAL BASIC RECEPTACLE (NOT DEDICATED) at 66"+- centered +- above the F/P Mantle in the Greatroom, next to +- the upg. conduit pipe.. see sketch #1  Note:	
Inv. <b>4995</b>  <b>Line 64434</b>  4May21 / 12May21	<b>1</b> - To SUPPLY AND INSTALL CONDUIT FOR TV OVER THE FIREPLACE at approx. 66" + - up from the floor next to +- the upg. electrical outlet – TERMINATED IN THE GREATROOM, next to +- the standard Phone and T.V rough-in.. see sketch #1  Note:	
Inv. <b>4995</b>  <b>Line 64435</b>  4May21 / 12May21	<b>1</b> - To SUPPLY AND INSTALL EXTRA CEILING BOX ROUGH IN CAPPED (ON A SEPARATE SWITCH) in the kitchen over the breakfast bar.. see sketch #1  Note:	
Inv. <b>4995</b>  <b>Line 64436</b>  4May21 / 12May21	<b>1</b> - To relocate the standard light on the 2nd floor stair landing to open to below.. see sketch #2  Note:	
Inv. <b>4995</b>  <b>Line 64439</b>  4May21 / 12May21	<b>1</b> - To SUPPLY AND INSTALL an EXTRA 240 STOVE PLUG for the Wall oven combination.. see spec's  Note:	

**HARDWOOD**

Inv. <b>4995</b>  <b>Line 64424</b>  4May21 / 12May21	<b>1</b> - As per Schedule "PE": Vendor to install engineered hardwood throughtout the second level in lieu of included carpet as per plan, and as per schedule A. Purchaser to select from Builders standard samples. There is no cash value.  Note:	
---	---	--

**HEATING AND AIR CONDITIONING**

Inv. <b>4995</b>  <b>Line 64420</b>  4May21 / 12May21	<b>1</b> - As per Schedule "PE": Vendor to install capped gas line ( rough in only ) at rear of home for future BBQ location. Location to be finalized at vendors sole discretion.  Note:	
Inv. <b>4995</b>  <b>Line 64421</b>  4May21 / 12May21	<b>1</b> - As per Schedule "PE": Vendor to install gas line ( rough in only ) to kitchen in at stove location ( as per plan) to include 110V code requirement.  Note:	
Inv. <b>4995</b>  <b>Line 64422</b>  4May21 / 12May21	<b>1</b> - As per Schedule "PE": Vendor to supply & install air conditioning unit, sized accordingly, from vendors standard samples.  Note:	
Inv. <b>4995</b>  <b>Line 64428</b>  4May21 / 12May21	<b>1</b> - To supply and install a humidifier  Note:	

**MISCELLANEOUS**

Kingsmen (Thames) Inc. / Havelock Corners (Kingsmen)

Lot/Unit: 117    Phase/Building: 4B    Model/Floor Plan: Spencer (4204) Elev C 4 Bed - 4+1 Bath

Inv.4995	1 - To relocate the fridge.. see sketch #1	
Line 64430	Note:	
4May21 / 12May21		
Inv.4995	1 - To supply & install the standard COFFERED CEILING in the dining room area as per plan... see sketch # 1	
Line 64425	Note:	
4May21 / 12May21		

PLUMBING

Inv.4995	1 - To supply and install the Mirolin Brook free standing tub in the Master Ensuite, in lieu of the free stand up standard tub.. see spec's	
Line 64429	Note:	
4May21 / 12May21		
Inv.4995	1 - To supply and install a WATERLINE ROUGH-IN TO THE FRIDGE LOCATION (NO HOOK UP)	
Line 64440	Note:	
4May21 / 12May21		
Inv.4995	1 - To supply and install the upgraded under mount Quatrus U2 MODEL #401247 kitchen sink in lieu of the standard under mount kitchen sink.. see spec's	
Line 64441	Note: PURCHASER HAS UPGRADED THE FAUCET.. SEE SEPARATE UPGRADE	
4May21 / 12May21		
Inv.4995	6 - To supply and install VANITY SINK - CONTRAC CATENA UNDERMOUNT - MODEL 4210CIY in white in the powder room, master ensuite, bedroom #2, #3 and #4 in lieu of the standard topmount sinks	
Line 64443	Note: STILL TO INSTALL THE STANDARD FAUCETS	
4May21 / 12May21		
Inv.4995	1 - To supply and install the KITCHEN FAUCET - MOEN ALIGN CHROME MODEL 5923 in lieu of the standard kitchen faucet	
Line 64451	Note:	
4May21 / 12May21		

RAILING

Inv.4995	1 - To supply and install RAILING - UPGRADE 3 - METAL HANDRAIL WINDSOR IN OAK - PICKETS STEEL ½ INCH SQUARE, PLAIN/PTMA, WITH SHOES IN FLAT BLACK - POSTS 3½ INCH SQUARE IRP-12 NO CAP IN OAK in lieu of the standard	
Line 64467	Note:	
4May21 / 12May21		

TILE - FLOOR

Inv.4995	1 - To supply and install UPGRADE 4 - FLOOR TILE - STACKED- FOYER TILE in lieu of the standard floor tile	
Line 64452	Note:	
4May21 / 12May21		
Inv.4995	1 - To supply and install UPGRADE 4 - FLOOR TILE - STACKED- KITCHEN/BREAKFAST TILE in lieu of the standard floor tile	
Line 64453	Note:	
4May21 / 12May21		

Kingsmen (Thames) Inc. / Havelock Corners (Kingsmen)

Lot/Unit: 117    Phase/Building: 4B    Model/Floor Plan: Spencer (4204) Elev C 4 Bed - 4+1 Bath

Inv.4995	1 - To supply and install UPGRADE 4 - FLOOR TILE - STACKED - MUDROOM TILE in lieu of the standard floor tile	
Line 64454	Note:	
4May21 / 12May21		
Inv.4995	1 - To supply and install UPGRADE 4 - FLOOR TILE - STACKED- POWDER ROOM TILE in lieu of the standard floor tile	
Line 64455	Note:	
4May21 / 12May21		
Inv.4995	1 - To supply and install UPGRADE 3 - FLOOR TILE - STACKED- MASTER ENSUITE FLOOR TILE in lieu of the standard floor tile	
Line 64456	Note:	
4May21 / 12May21		
Inv.4995	1 - To supply and install UPGRADE 3 - FLOOR TILE - STACKED - BATHROOM 2 FLOOR TILE in lieu of the standard floor tile	
Line 64457	Note:	
4May21 / 12May21		
Inv.4995	1 - To supply and install UPGRADE 3 - FLOOR TILE - STACKED- BATHROOM 3 FLOOR TILE in lieu of the standard floor tile	
Line 64458	Note:	
4May21 / 12May21		
Inv.4995	1 - To supply and install UPGRADE 3 - FLOOR TILE - STACKED - BATHROOM 4 FLOOR TILE in lieu of the standard floor tile	
Line 64459	Note:	
4May21 / 12May21		
Inv.4995	1 - To supply and install UPGRADE 3 - FLOOR TILE - STACKED- LAUNDRY TILE in lieu of the standard floor tile	
Line 64460	Note:	
4May21 / 12May21		

TRIM

Inv.4995	1 - To supply and install DOOR LEVER - UPGRADE TO MONTREAL SQUARE ROSE PASSAGE LEVERS - MATTE BLACK (HINGES INCLUDED)	
Line 64468	Note:	
4May21 / 12May21		

EXTRAS AS PER OFFER

Note:	
-------	--



MAY 05 2021

Purchasers: RANVIR S GREWAL & MANPREET KAUR

Property: 117 of Plan - Draft Approval SB17-03-08

Telephone Res. / Bus: /

Project: Kingsmen (Thames) Inc.

Decor Advisor: Barbara Coccia

Model and Elevation: Spencer (4204) Elev C 4 Bed - 4+1 Bath

Layout Changes: ☐ Yes ☒ No

Sketch Attached: ☒ Yes ☐ No

Exterior Colour Scheme:

### 1. Cabinetry

	Style and Colour	Counter Top	Hardware
Kitchen / Breakfast	#3 Simcoe Rain Cloud	#3 H/S Italian Waves 3cm	12881 Handle
Kitchen Island	#3 Simcoe Rain Cloud	#3 H/S Italian Waves 3cm	12881 Handle
Laundry Room	/	/	/
Powder Room	#3 Simcoe Rain Cloud	#3 H/S Italian Waves 2cm	12881 Handle
Main Bathroom	/	/	/
Master Ensuite Bathroom	#3 Simcoe Moonlight	#3 H/S Italian Waves 2cm	135 Knob
Second Ensuite Bathroom (If Applicable)	#3 Simcoe Moonlight	#3 H/S Italian Waves 2cm	135 Knob
Ens. #3 Bathroom	#3 Simcoe Moonlight	#3 H/S Italian Waves 2cm	135 Knob
Ens. #4 Bathroom	#3 Simcoe Moonlight	#3 H/S Italian Waves 2cm	135 Knob

### Appliances

#### Custom Size Fridge

☒ Yes ☐ No

#### Valance Lighting

☐ Yes ☒ No

#### Microwave / Range Hood

☐ Yes ☒ No

#### Cooktop / Rangetop

☒ Yes ☐ No

#### Built in Wall Oven

☒ Yes ☐ No

#### Slide-in Range

☐ Yes ☒ No

Comment

/

### 2. Flooring

#### Selection

Foyer	*UPG #4: 24x24" Mayfair Statuario Venato HD Polished Rect. STACKED.
Main Hall	3 1/2" Elements Oak Wolfhound
Back Hall	/
Breakfast	*UPG #4: 24x24" Mayfair Statuario Venato HD Polished Rect. STACKED
Laundry Room	*UPG #3: 12x24" Mayfair Statuario Venato HD Polished Rect. STACKED
Kitchen	*UPG #4: 24x24" Mayfair Statuario Venato HD Polished Rect. STACKED
Powder Room	*UPG #4: 24x24" Mayfair Statuario Venato HD Polished Rect. STACKED
Main Bathroom	Ens.#2 Bath:12x24" Mayfair Statuario Venato HD Polished Rect. STACKED Sh/fl:2x2" Soho White Matte
Master Ensuite	*UPG #3: 12x24" Mayfair Statuario Venato HD Polished Rect. STACKED Sh/fl:2x2" Soho White Matte
Bathroom (If Applicable)	Ens. #3 Bathroom:12x24" Mayfair Statuario Venato HD Polished Rect. STACKED
Mud Room	*UPG #4: 24x24" Mayfair Statuario Venato HD Polished Rect. STACKED
Ens. # 4 Bathroom	12x24" Mayfair Statuario Venato HD Polished Rect. STACKED
Living Room	/
Dining Room	3 1/2" Elements Oak Wolfhound
Family / Great Room	3 1/2" Elements Oak Wolfhound
Den / Library / Study	/
Basement Landing (If Applies)	
Lower Landing (If Applicable)	3 1/2" Elements Oak Wolfhound
Upper Landing	3 1/2" Elements Oak Wolfhound
Upper Hall	3 1/2" Elements Oak Wolfhound ( including Media Niche )
Master Bedroom	3 1/2" Elements Oak Wolfhound
Bedroom #2	3 1/2" Elements Oak Wolfhound
Bedroom #3	3 1/2" Elements Oak Wolfhound
Bedroom #4	3 1/2" Elements Oak Wolfhound
Bedroom #5	/
Shower jamb/sill:	Master Ens & Ens. # 2: Anatolia Marmiline SNOW

Flooring Continued on Page 2

Initial:  

Page 1 of 3

MAY 05 2021

**Purchasers:** RANVIR S GREWAL & MANPREET KAUR **Property:** 117 of Plan - Draft Approval SB17-03-08  
**Telephone Res. / Bus:** / **Project:** Kingsmen (Thames) Inc.  
**Decor Advisor:** Barbara Coccia **Model and Elevation:** Spencer (4204) Elev C 4 Bed - 4+1 Bath

### 2. Flooring - Continued -

Upgrade Underpad	Type	Area
	/	/
Carpet on Stairs	Capped	Runner - *Upgrade
Comment	/	/
/		

### 3. Plumbing Fixtures / Faucets

Kitchen	Upgrade	Second Ensuite	Standard	Powder Room	Standard
Master Ensuite	Standard			Other Room	/
Main Bathroom	/	Ens. #3 & #4 Bathroom:	Standard		

#### Comment

NOTE: Purchasers have upgraded the kitchen sink and faucet.. see spec's. Purchasers have upgraded all bathroom sinks, still to install the standard faucet.

### 4. Wall Tile

	Tile Selection	Listello	Insert	Insert Selection
Main Bathroom	/	<input type="checkbox"/>	<input type="checkbox"/>	
Master Ensuite				
Tub Deck	/	<input type="checkbox"/>	<input type="checkbox"/>	
Tub Apron	/	<input type="checkbox"/>	<input type="checkbox"/>	
Tub Surround	/	<input type="checkbox"/>	<input type="checkbox"/>	
Shower Stall	8x10" Cinq Grey	<input type="checkbox"/>	<input type="checkbox"/>	
Second Ensuite	8x10" Cinq Grey	<input type="checkbox"/>	<input type="checkbox"/>	
Ens. #3 Bathroom	8x10" Cinq Grey	<input type="checkbox"/>	<input type="checkbox"/>	
Ens. #4 Bathroom	8x10" Cinq Grey	<input type="checkbox"/>	<input type="checkbox"/>	
Kitchen Backsplash		<input type="checkbox"/>	<input type="checkbox"/>	
Complete Backsplash		<input type="checkbox"/>	<input type="checkbox"/>	

#### Comment

NOTE: To supply and install all wall tiles on the 10" side horizontally stacked where applicable.



horizontal stacked

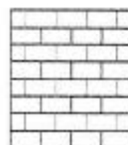

brick pattern

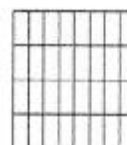

vertical stacked



diagonal/diamond

### 5. Fireplace

	Living Room			Family Room			Other Room - Specify Great Room		
	Purchased	As Per Plan	N/A	Purchased	As Per Plan	N/A	Purchased	As Per Plan	N/A
Fireplace Type	<input type="radio"/>	<input type="radio"/>	<input checked="" type="radio"/>	<input type="radio"/>	<input type="radio"/>	<input checked="" type="radio"/>	<input type="radio"/>	<input checked="" type="radio"/>	<input type="radio"/>
Mantle Type									
Over Mantle									
Colour / Stain									
Surround									
Hearth									
Comment	/								

MR R.G.

Initial: \_\_\_\_\_

Page 2 of 3



MAY 05 2021

Purchasers: RANVIR S GREWAL & MANPREET KAUR

Property: 117 of Plan - Draft Approval SB17-03-08

Telephone Res. / Bus: /

Project: Kingsmen (Thames) Inc.

Decor Advisor: Barbara Coccia

Model and Elevation: Spencer (4204) Elev C 4 Bed - 4+1 Bath

### 6. Trim Carpentry

Door Hardware **\*\*Upgrade**

Interior Trim Standard

Comment

See invoice for upgraded door hardware and trim.

Interior Doors

☐ 2 Panel Arch Top

☒ 2 Panel Square Top

☐ 6 Panel



Initial for Door Style

MK RG

### 7. Railings and Pickets

Railing Package **\*\*Upgrade #3 Metal Package**

Railing Colour Elements Wolfhound

Picket Colour Black Metal

Wood Stairs ☐ No ☒ Oak

Tread Colour Elements Wolfhound

Comment

### 8. Plaster Mouldings and Medallions

Foyer

/

Kitchen/Breakfast

/

Main Hall

/

Den/Library

/

Living Room

/

Lower Landing

/

Dining Room

/

/

Family Room

/

Comment

### 9. Wall Paint

Kingsmen White

Smooth Ceilings ☐ First Floor

☐ First Floor incl. Second Floor Hall

☐ First and Second Floor

☒ Throughout

☐ Not Applicable

Trim Paint Kingsmen White

### 10. Additional Comments

### 11. Disclaimers and Notes

- Colours of all materials are as close as possible to builder's selection, but not necessarily identical due to variances in manufacturing.
- Any extras listed above are null and void unless accompanied by a separate invoice/amendment. Said invoice must be paid in full.
- The Purchaser acknowledges that after Interior Colour Selection form is signed and dated, no further changes will be permitted other than re-selection due to unavailability. **MK RG** Purchaser's Initials
- The Purchaser acknowledges reading and accepting the "Kingsmen Group Décor Centre Disclaimers" form. This document contains other miscellaneous disclaimers.

This Interior Colour Selection is final and approved by:

Purchaser:

Signature: Manpreet Kaur Date: May 5, 21

Signature: Barbara Coccia Date: May 5, 21

Vendor:

Kingsmen (Thames) Inc.



THAMES 4B: LOT 117  
SKETCH #1

### Plan

Phase 4B  
Model: Spencer (4204) Elev C 4 Bed - 4+1 Bath  
Standard

MAY 05 2021

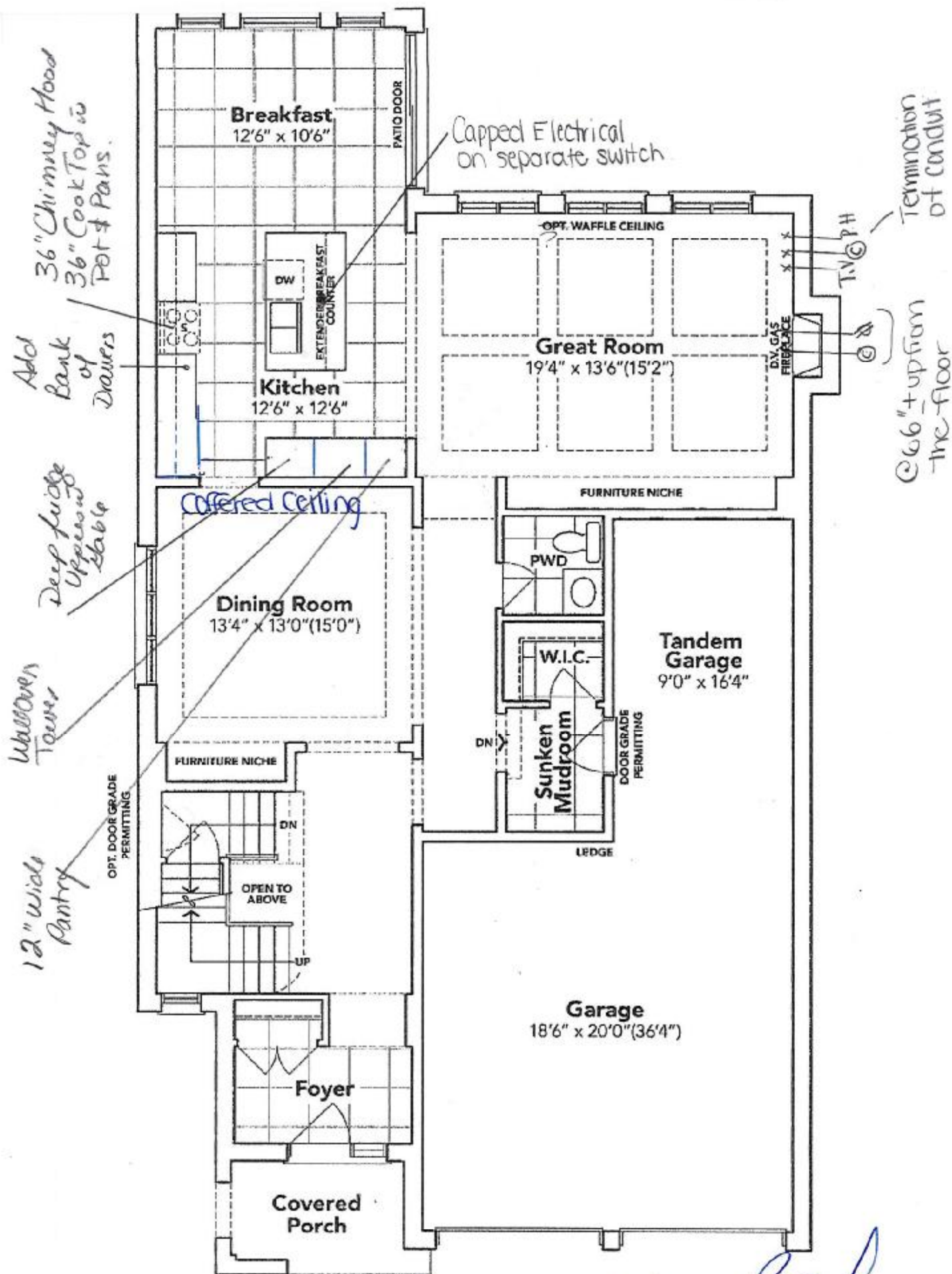

**GROUND FLOOR EL. C**

The floor plans and elevations shown are pre-construction plans and may be revised or improved as necessitated by architectural controls and the construction process. The measurements adhere to the rules and regulations of the TARIION Warranty Corporation's official method for the calculation of floor area. Materials, specifications and floor plans are subject to change without notice. All house renderings are artist's concept only. Actual usable floor space may vary from the stated floor area. All options shown are upgrades. E. & O. E.

SCHEDULE "B-1" - Page 3 of 3

inMS\_014.rpt 22Sep18

Initials:

RG 14.19

THAMES 4B: LOT 117  
SKETCH #2

LE D-1  
Plan

Phase 4B  
Model: Spencer (4204) Elev C 4 Bed - 4+1 Bath  
Standard

MAY 05 2021

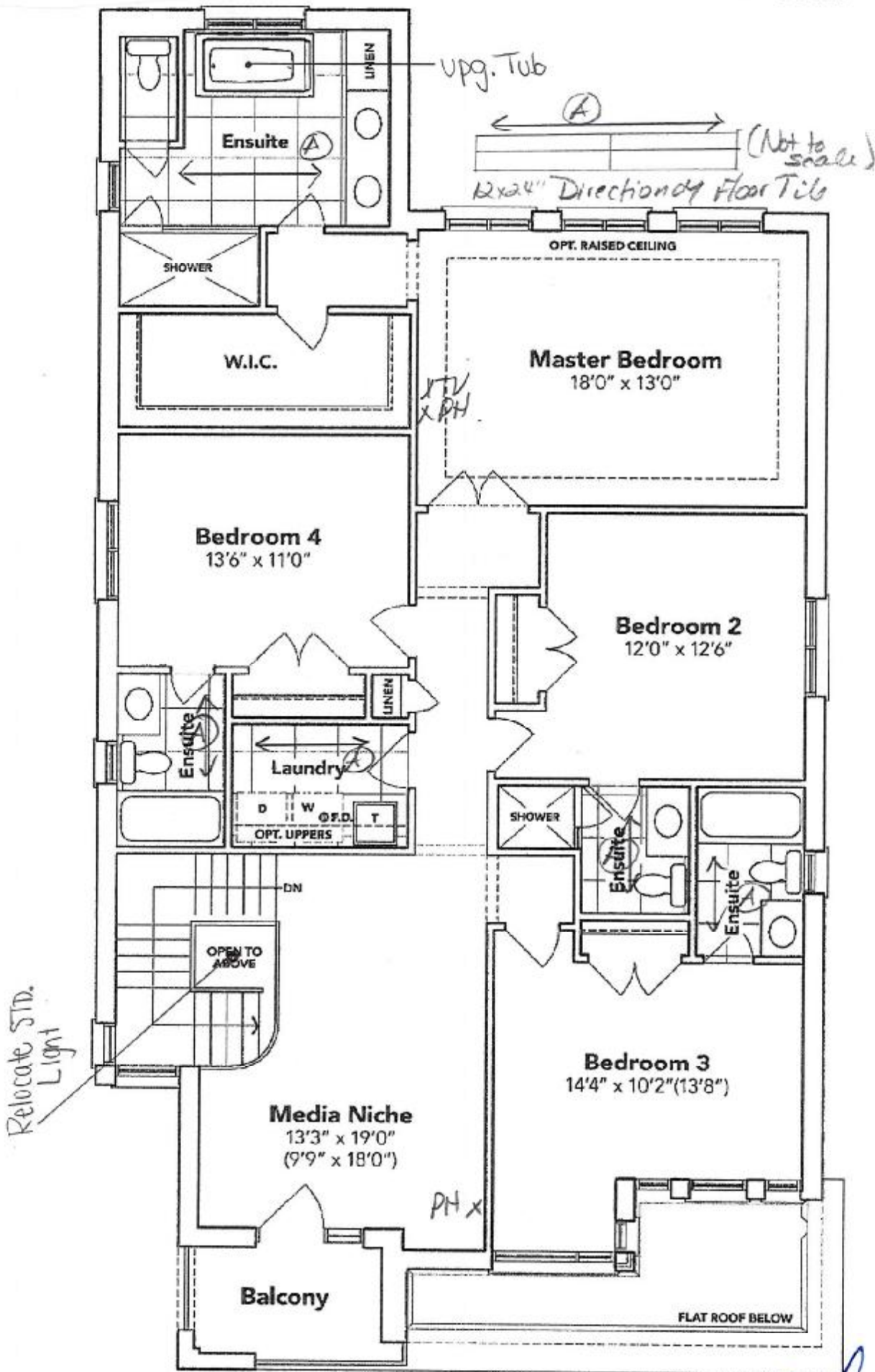

SECOND FLOOR EL. C *Manfred Kour*

The floor plans and elevations shown are pre-construction plans and may be revised or improved as necessitated by architectural controls and the construction process. The measurements adhere to the rules and regulations of the TARION Warranty Corporation's official method for the calculation of floor area. Materials, specifications and floor plans are subject to change without notice. All house renderings are artist's concept only. Actual usable floor space may vary from the stated floor area. All options shown are upgrades. E. & O. E.



THAMES 4B: LOT 117  
SKETCH #3

E D-1  
Plan

Phase 4B  
Model: Spencer (4204) Elev C 4 Bed - 4+1 Bath  
Standard

MAY 05 2021

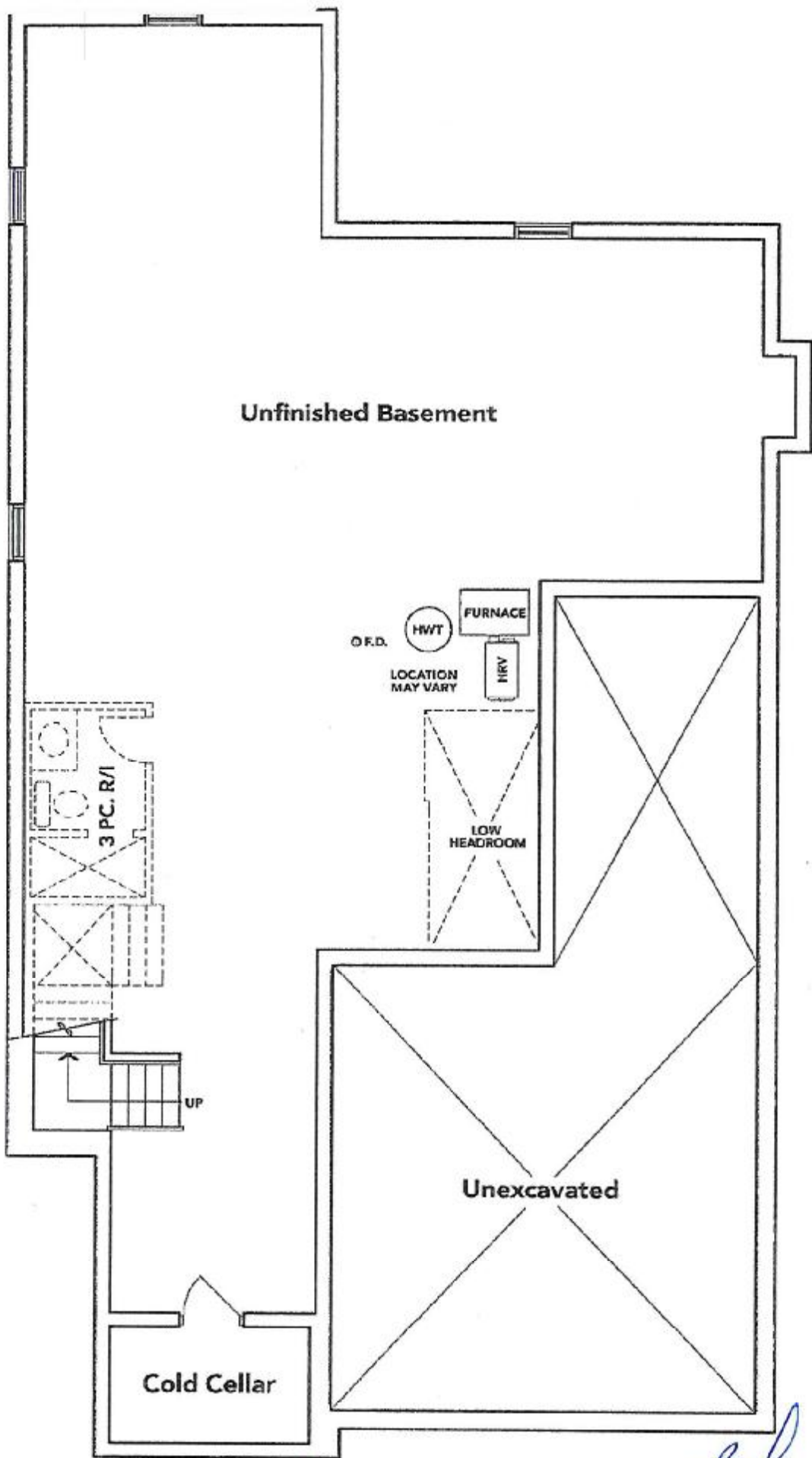

**BASEMENT EL. C** *Handwritten signature*

The floor plans and elevations shown are pre-construction plans and may be revised or improved as necessitated by architectural controls and the construction process. The measurements adhere to the rules and regulations of the TARION Warranty Corporation's official method for the calculation of floor area. Materials, specifications and floor plans are subject to change without notice. All house renderings are artist's concept only. Actual usable floor space may vary from the stated floor area. All options shown are upgrades. E. & O. E.

THAMES 4B: LOT 117  
RE:36" UPG CHIMNEY  
HOODFAN

## Specifications

MAY 05 2021

Air Flow Volume: 650 CFM  
Electrical Connection: 120V/60Hz  
Power Consumption: 240 Watts  
Current: 2.0 Amps  
Fan Speed: 1599 RPM  
Finishes: Stainless Steel  
Duct: 6" Round  
Knock-out: 6" Round - Top Only  
Dimensions: Width: 30"/36"  
Height: 44 1/2"  
Depth: 19 3/4"  
Noise Level: Min. 2 Sones  
Max. 7 Sones

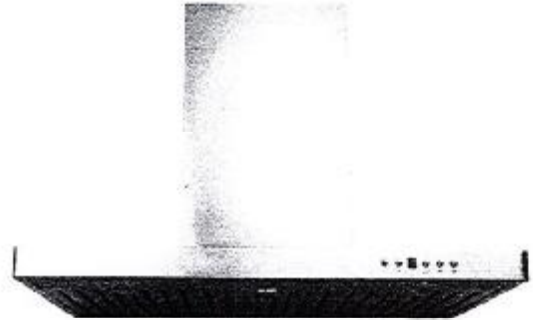

SCB722 - Baffle Filter



## Ordering Model Chart

Model	Colour	Knock-out	Duct	Size	Filter	CFM
SCB72230	Stainless Steel	6"	6" Round	30"	Baffle	650
SCB72236	Stainless Steel	6"	6" Round	36"	Baffle	650

Notes

*May 1st 2021* *AKP*

**Cyclone**<sup>®</sup>  
Breathe Better



THAMES 4B: LOT 117  
RE: UPG. KITCHEN SINK,  
& FAUCET

MAY 05 2021

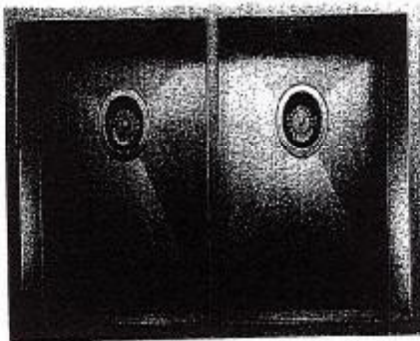

## QUATRUS U2

MODEL: 401247

Common engineered with 304 series, 13-gauge stainless steel

Zero-radius corners; X-pollent drain grooves

Double horizontal configuration for easy install-testing

18/10 chrome-plated content for exceptional finish, durability and strength

Undermount installation

Minimum cabinet size: 36"



### Single Handle Pre-Rinse Spring Pulldown Kitchen Faucet

Model 5923

Chrome

Other

Black Stainless

Manfred Kar

[Signature]

THAMES 4B: LOT 117  
RE: UPG. UNDERMOUNT SINKS  
(PWD, MASTER ENSUITE,  
BEDROOM #2, #3 & #4)

MAY 05 2021

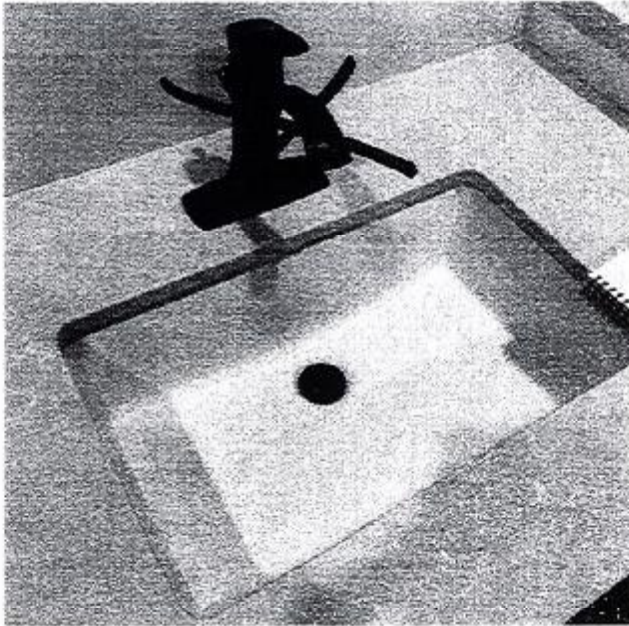

## DISPLAY ITEMS

### Sink ( Item 9)

Contrac Catena Undermount  
Model 4210CIY

Manfred Kern SP

MAY 05 2021



Brooke™ | 1

### Brooke™

Categories: Acrylic Freestanding

#### DESCRIPTION

68" Freestanding Bath  
SKU #: CF2002

#### FEATURES

- Installation friendly two piece design
- Accepts deck mounted faucet
- Includes a chrome integral pop up drain and rectangular overflow
- ~~Brushed nickel drain and overflow covers available~~
- Centre drain
- Includes levelling feet
- Available in White Only

#### DIMENSIONS

68" x 36" x 23"

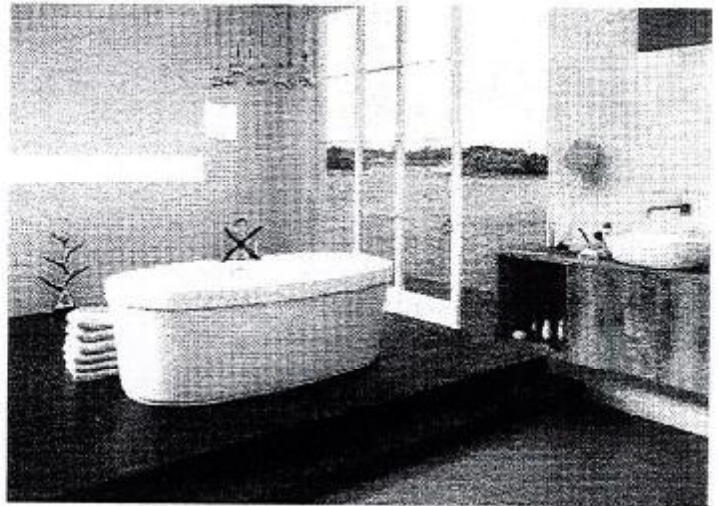

Margaret Law

[Signature]



36" Gas Cooktop

500 Series – Stainless Steel NGM5656UC

THAMES 4B: LOT 117  
RE: 36" GAS COOKTOP

MAY 05 2021

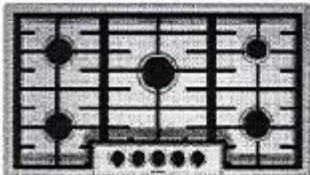

NGM5656UC  
Stainless Steel

Bosch gas cooktops are engineered to perform precisely, offering high heat and low simmer options for optimal cooking flexibility.

Features & Benefits

Powerful 16,000 BTU burner for boiling, searing and stir-frying

OptiSim® Burner – simmer delicate sauces and melt chocolate without scorching

Electronic re-ignition will automatically re-ignite the burner in case the flame goes out

Seamless, one-piece stainless steel design makes clean-up simple

Continuous grates make moving heavy pots easier

General Properties

Knob material	Metal
Sealed burners	Yes
Grate material	Cast iron

Element Performance

Total BTU load (NG / LP)	51,500 / 47,300
Power of front left burner (NG / LP)	10,000 / 9,100
Power of back left burner (NG / LP)	10,000 / 9,100
Power of center burner (NG / LP)	16,000 / 15,000
Power of back right burner (NG / LP)	5,500 / 5,000
Power of front right burner (NG / LP)	10,000 / 9,100

Technical Details

Watts	360 W
Circuit breaker	15 A
Volts	120 V
Frequency	60 Hz
Plug type	3 prong
Power cord length	60"
Energy source	Gas
Convertible to LP (kit required)	Yes

Dimensions & Weight

Overall appliance dimensions (HxWxD)	3 13/16" x 37" x 21 1/4"
Required cutout size (HxWxD)	3 13/16" x 34 15/16" x 19 1/8"
Minimum distance from counter front	1 7/8"
Minimum distance from rear wall	3"
Net weight	39 lbs

Accessories – Included

Included	LP conversion kit
----------	-------------------

Accessories – Optional



HEZ298102  
Wok ring



HEZGR301  
Griddle



+ Manpreet Kaur  
+ [Signature]

For help and assistance with Bosch accessories please visit: [www.bosch-eshop.com/eshop/bosch/us](http://www.bosch-eshop.com/eshop/bosch/us) or call 1-800-944-2904 Mon-Fri 5am to 6pm PST Sat 6am to 3pm PST

Notes: All height, width and depth dimensions are shown in inches. BSH reserves the absolute and unrestricted right to change product materials and specifications, at any time, without notice. Consult the product's installation instructions for final dimensional data and other details prior to making cutout. Applicable product warranty can be found in accompanying product literature or you may contact your account manager for further details.

Warranties: Bosch warrants that the Product is free from defects in materials and workmanship for a period of three hundred and sixty-five (365) days from the date of purchase. The foregoing timeline begins to run upon the date of purchase, and shall not be stalled, tolled, extended, or suspended, for any reason whatsoever. This Product is also warranted to be free from cosmetic defects in material and workmanship (such as scratches of stainless steel, paint/porcelain blemishes, chip, dents, or other damage) to the finish of the Product, for a period of thirty (30) days from the date of purchase or closing date for new construction. This cosmetic warranty excludes slight color variations due to inherent differences in painted and porcelain parts, as well as differences caused by kitchen lighting, product location, or other similar factors. This cosmetic warranty specifically excludes any display, floor, "As Is", or "H" stock appliances.

For more information on our entire line of products, go to [www.bosch-home.com/us](http://www.bosch-home.com/us) or call 1-800-944-2904

© BSH Home Appliances Corporation. All rights reserved. Bosch is a registered trademark of Robert Bosch GmbH.



# 36" Gas Cooktop

500 Series – Stainless Steel NGM5656UC

THAMES 4B: LOT 117  
RE: 36" GAS COOKTOP

MAY 05 2021

## Installation Details

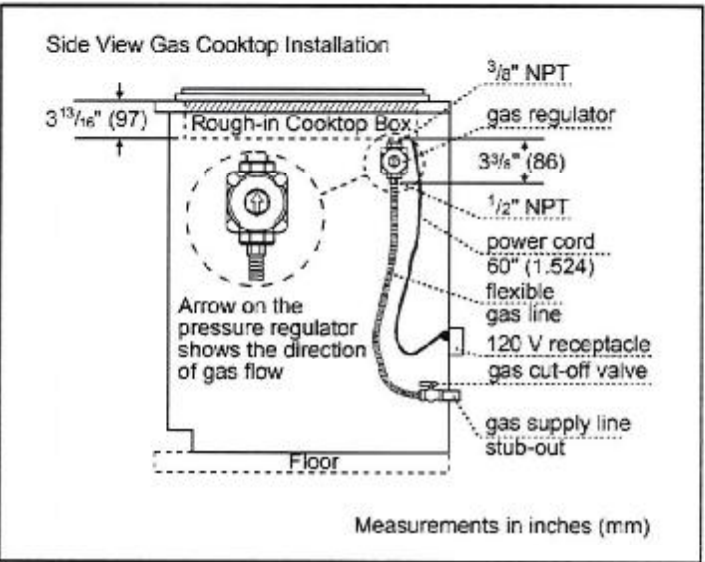
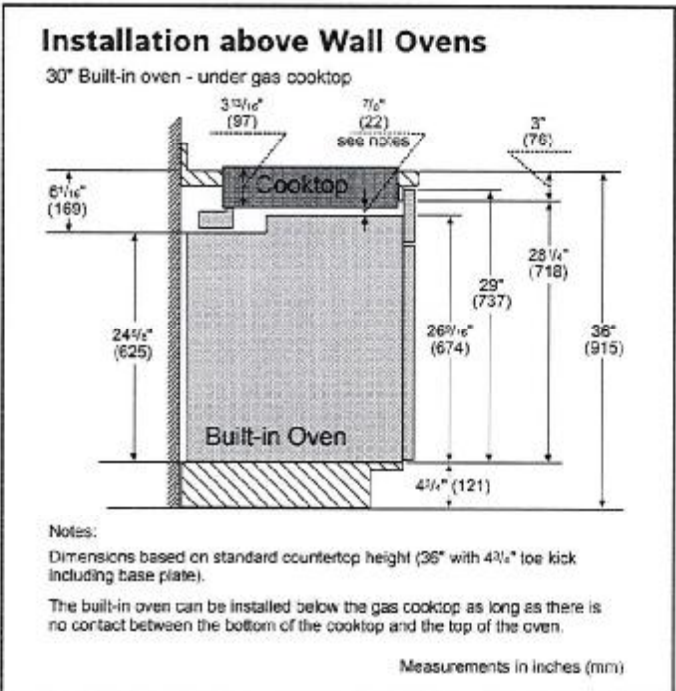
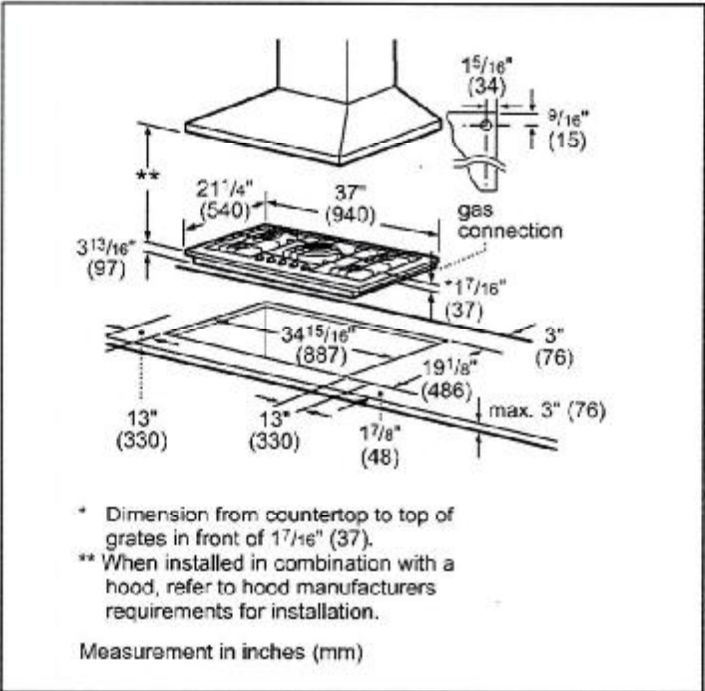

+ Manpreet Kaur

+ [Signature]

For help and assistance with Bosch accessories please visit: [www.bosch-eshop.com/eshop/bosch/us](http://www.bosch-eshop.com/eshop/bosch/us) or call 1-800-944-2904 Mon-Fri 8am to 6pm PST Sat 8am to 3pm PST

Notes: All height, width and depth dimensions are shown in inches. BSH reserves the absolute and unrestricted right to change product, materials and specifications, at any time, without notice. Consult the product's installation instructions for final dimensional data and other details prior to making cutout. Applicable product warranty can be found in accompanying product literature or you may contact your account manager for further details.

Warranties: Bosch warrants that the Product is free from defects in materials and workmanship for a period of three hundred and sixty-five (365) days from the date of purchase. The foregoing timeline begins to run upon the date of purchase, and shall not be stalled, tolled, extended, or suspended, for any reason whatsoever. This Product is also warranted to be free from cosmetic defects in material and workmanship (such as scratches of stainless steel, paint/porcelain blemishes, chips, dents, or other damage) to the finish of the Product, for a period of thirty (30) days from the date of purchase or closing date for new construction. This cosmetic warranty excludes slight color variations due to inherent differences in painted and porcelain parts, as well as differences caused by kitchen lighting, product location, or other similar factors. This cosmetic warranty specifically excludes any display, floor, "As Is", or "B" stock appliances.

For more information on our entire line of products, go to [www.bosch-home.com/us](http://www.bosch-home.com/us) or call 1-800-944-2904

© BSH Home Appliances Corporation. All rights reserved. Bosch is a registered trademark of Robert Bosch GmbH.

# 36" Gas Cooktop

500 Series – Stainless Steel NGM5656UC

THAMES 4B: LOT 117  
RE: 36" GAS COOKTOP

MAY 05 2021

## Installation Details

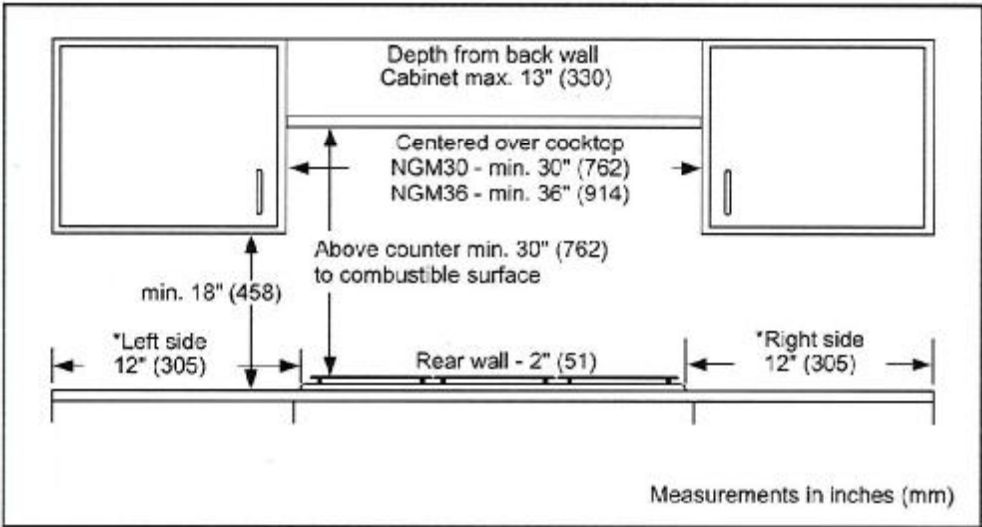

+ Manfred Kaur  
+ [Signature]

For help and assistance with Bosch accessories please visit: [www.bosch-eshop.com/eshop/bosch/us](http://www.bosch-eshop.com/eshop/bosch/us) or call 1-800-944-2904 Mon-Fri 5am to 6pm PST Sat 6am to 3pm PST

Notes: All height, width and depth dimensions are shown in inches. BSH reserves the absolute and unrestricted right to change product materials and specifications, at any time, without notice. Consult the product's installation instructions for final dimensional data and other details prior to making cutout. Applicable product warranty can be found in accompanying product literature or you may contact your account manager for further details.

Warranties: Bosch warrants that the Product is free from defects in materials and workmanship for a period of three hundred and sixty-five (365) days from the date of purchase. The foregoing timeline begins to run upon the date of purchase, and shall not be stalled, tolled, extended, or suspended, for any reason whatsoever. This Product is also warranted to be free from cosmetic defects in material and workmanship (such as scratches of stainless steel, paint/porcelain blemishes, chip, dents, or other damage) to the finish of the Product, for a period of thirty (30) days from the date of purchase or closing date for new construction. This cosmetic warranty excludes slight color variations due to inherent differences in painted and porcelain parts, as well as differences caused by kitchen lighting, product location, or other similar factors. This cosmetic warranty specifically excludes any display, floor, "As Is", or "E" stock appliances.

For more information on our entire line of products, go to [www.bosch-home.com/us](http://www.bosch-home.com/us) or call 1-800-944-2904

© BSH Home Appliances Corporation. All rights reserved. Bosch is a registered trademark of Robert Bosch GmbH.

# NQ70M7770DS

30" Microwave Combination Wall Oven

THAMES 4B: LOT 117  
RE:30" MICROWAVE  
COMBINATION WALL OVEN

MAY 05 2021

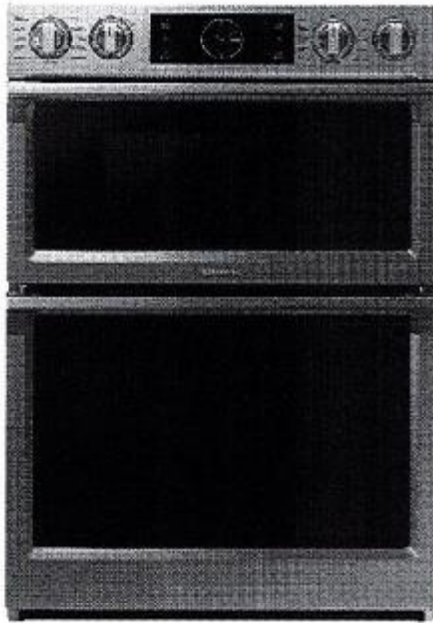

## Signature Features

### Steam Cook (Oven)

- Delivers moisture at precise times for a crisp, browned outside and tender inside.

### Speed Cook (Microwave)

- Cook food faster and more evenly by using power convection.

### Flex Duo™ (Oven)

- Cook two dishes at different temperatures simultaneously with the Smart Divider.

## Available Colors



Stainless Steel (shown)



Black Stainless Steel

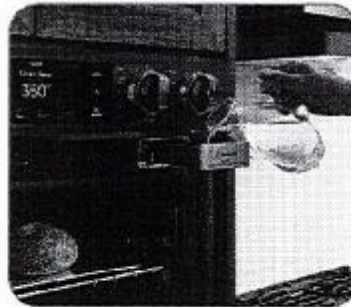

Steam Cook

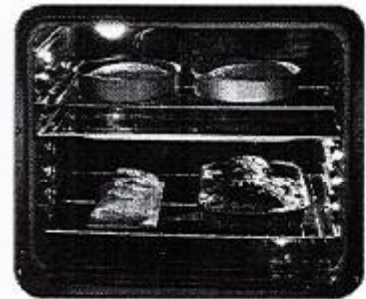

Flex Duo™

## Features

- Digital-Analog Controls
- 1.9/5.1 cu. ft. Capacity
- Hybrid Clean and Self-Clean (Oven)
- Gourmet Cook (Oven)
- Dual Convection (Oven)
- Wi-Fi Connectivity
- Wi-Fi Enabled Temperature Probe (Oven)
- LED Spotlights (Oven)
- Easy View Window
- 3 Heavy-Duty Racks including a Gliding Rack (Oven)
- Soft-Close Door (Oven)
- Ceramic Plate (Microwave)
- Rapid Preheat (Oven)
- Auto Latch Microwave Door
- 6 Oven Modes including Steam Bake and Steam Roast
- Blue LED Illuminated Knobs
- Broil Element
- Smart Control Key (Oven)
- 6 Rack Positions (Oven)
- Drop-Down Door Design
- LCD Display

## Convenience

- Hidden Heating Element (Oven)
- Sabbath Mode (Oven)
- Delay Start (Oven)
- Proofing (Oven)
- Warming Mode (Oven)
- Kitchen Timer
- Child Safety Lock
- Convection Conversion

+Manfred Kaur



# NQ70M7770DS

30" Microwave Combination Wall Oven

THAMES 4B: LOT 117  
RE:30" MICROWAVE  
COMBINATION WALL OVEN

MAY 05 2021

## Cabinet Dimensions

Combination Oven Installed in Cabinet

\*Junction Box

\*\*Allow a minimum of 22" for clearance to adjacent corners, drawers, walls, etc. when door is open.

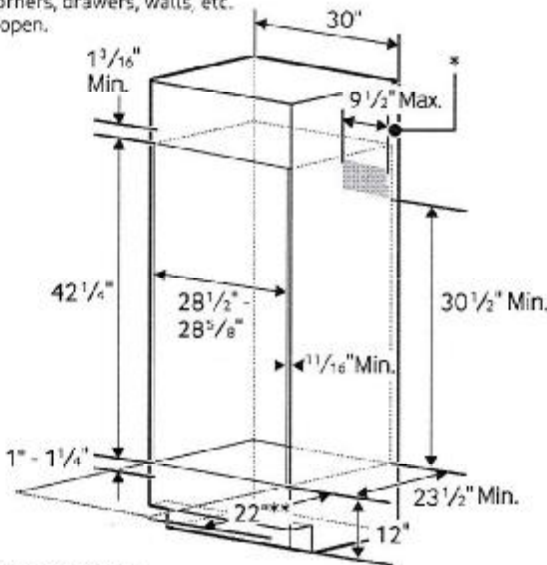

## Product Dimensions

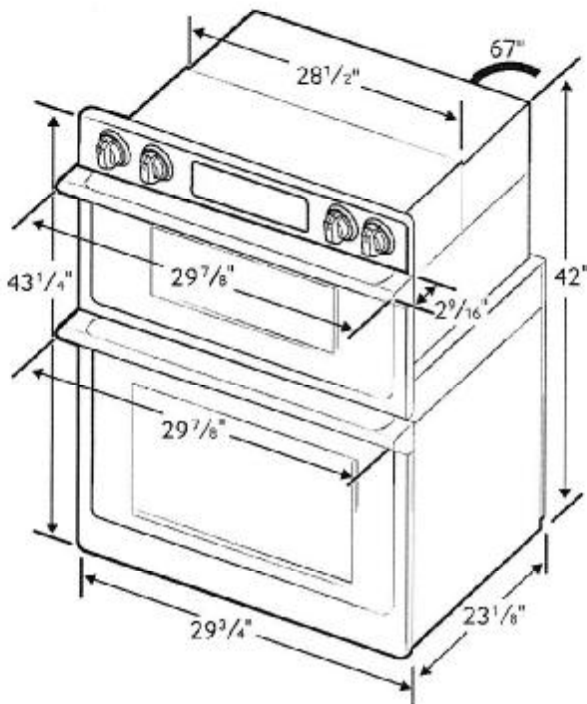

## Total Capacity: 1.9/5.1 cu. ft.

- Microwave: 1.9 cu. ft.
- Wall Oven: 5.1 cu. ft. total, 2.8/2.2 cu. ft.
- Hidden Bake Element
- Bake: 175°F–550°F
- Convection Bake: 175°F–550°F
- Convection Roast: 175°F–550°F
- Broil: Low-High
- Steam Bake: 230°F–550°F
- Steam Roast: 230°F–550°F
- Proofing
- Sabbath Mode

## Warranty

One (1) Year All Parts and Labor  
Ten (10) Years Parts Warranty for Magnetron

## Product Dimensions & Weight (WxHxD)

Outside (Max) Combination Oven Dimensions:  
29 7/8" x 43 1/4" x 25 1/16"

Combination Oven Cut-Out Dimensions:  
28 1/2" x 42 1/4" x 23 1/2"

Weight: 119 lbs.

## Shipping Dimensions & Weight (WxHxD)

Dimensions:  
33 5/8" x 48 3/16" x 29 51/64"

Weight: 132.5 lbs.

## Color

Stainless Steel  
Black Stainless Steel

## Model #

NQ70M7770DS  
NQ70M7770DG

## UPC Code

887276195186  
887276195162

RATING	
240V	9.5 kW
208V	7.2 kW
BREAKER SIZE	
240V	40 Amps
208V	40 Amps

Actual color may vary. Design, specifications, and color availability are subject to change without notice. Non-metric weights and measurements are approximate.  
©2017 Samsung Electronics America, Inc. 85 Challenger Road, Ridgefield Park, NJ 07668. Tel: 800-SAMSUNG. samsung.com. Samsung is a registered trademark of Samsung Electronics Co. Ltd.

*[Handwritten signature]*



# RF23R6201SR

THAMES 4B: LOT 117  
RE: FRIDGE SPEC'S

23 cu. ft. Counter-Depth, 3-Door French Door Refrigerator  
with CoolSelect Pantry™

MAY 05 2021



## Signature Features

### Twin Cooling Plus®

- Independent fridge and freezer controls keep food fresher longer.

### CoolSelect Pantry™

- Full-width drawer with three temperature control settings to chill or defrost food to ideal temperatures.

### Ice Max

- Large capacity, stores up to 2.7 lbs of ice.

### Counter Depth

- Offers a premium, built-in look.

### Fingerprint Resistant Finish

- A special finish to reduce smudges and minimize cleaning.

## Available Colors

 Fingerprint Resistant  
Stainless Steel (shown)

 Fingerprint Resistant  
Black Stainless Steel

 Fingerprint Resistant  
Tuscan Stainless Steel

 White



CoolSelect Pantry™ with  
Temperature Control



Ice Max

## Convenience

- CoolSelect Pantry™ with Temperature Control and Pantry Divider
- Wi-Fi and Bixby Enabled
- Adjustable Shelves for Tall Oversized Items
- Auto Pull-Out Upper Freezer Drawer
- Water Filter Indicator

## Design

- Counter Depth
- Fingerprint Resistant Finish
- Premium External Filtered Water and Ice Dispenser with Light
- High Efficiency LED Lighting
- Accessibility (ADA Compliant)
- EZ-Open Handle™ on Freezer Door
- Tempered Glass Spill-Proof Shelves
- Gallon Door Bins

## Performance

- Twin Cooling Plus®
- Ice Max - Stores up to 2.7 lbs of Ice
- ENERGY STAR® Compliant
- Two Humidity-Controlled Crispers
- Power Freeze and Power Cool Options
- CoolTight Door
- Door Alarm

## Rating



ENERGY STAR® rated:  
699 kWh/yr

*Manfred Kan*  
*[Signature]*

# RF23R6201SR

THAMES 4B: LOT 117  
RE: FRIDGE SPEC'S

## 23 cu. ft. Counter-Depth, 3-Door French Door Refrigerator with CoolSelect Pantry™

MAY 05 2021

### Installation Specifications

1. Measure the height, width and depth of the opening, making sure to include baseboards, molding tile, countertop overhang, etc. Check to be sure there is enough room to open the door (consider walls, islands or other obstacles when measuring).
2. Refer to illustration below to determine dimensions.
3. Allow 2.5" of clearance on hinge side of refrigerator when installing next to a wall where handle may make contact.
4. Allow 1" minimum clearance at rear for proper air circulation and water/electrical connections. Allow a 3/8" minimum clearance at sides and top for ease of installation.
5. Ensure each door and entryway in the home is wide enough for the refrigerator to be moved through easily.

For optimal usage and to be able to open refrigerator doors completely, do not install next to a wall.

Please note: The following dimension and cutout information is for planning purposes only. For complete installation details, consult manual packed with product, or download manual online at [samsung.com](http://samsung.com).

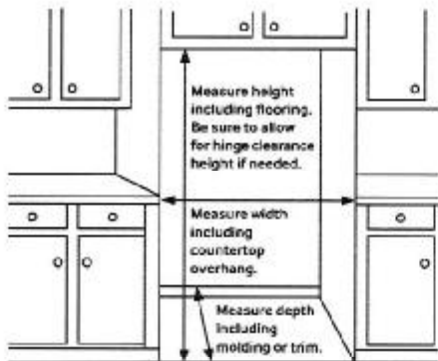

### Dimensions

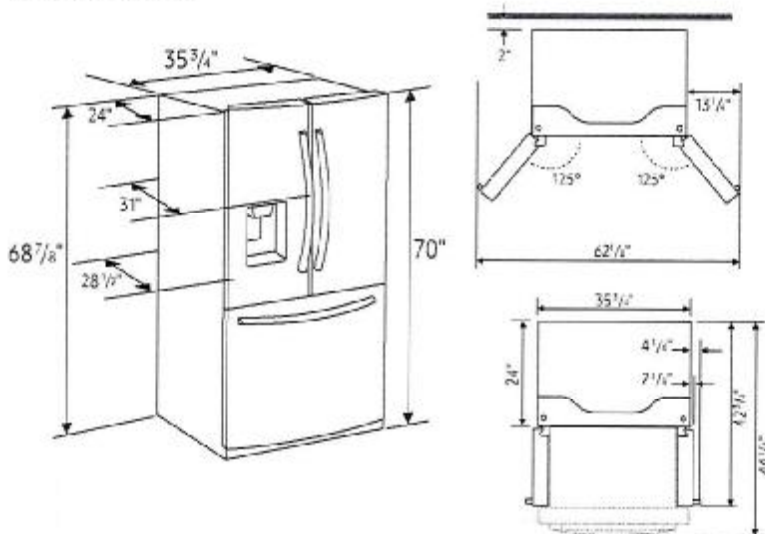

Total Capacity: 22.6 cu. ft.

Refrigerator: 15.7 cu. ft.

- Premium External Filtered Water and Ice Dispenser – Crushed or Cubed Ice
- Ice Max
- CoolSelect Pantry™ with Temperature Control – Deli (41°F), Fresh (38°F) and Chilled (32°F) Options
- Pantry Divider
- 2 Humidity-Controlled Crispers
- 5 Tempered Glass Spill-Proof Shelves:
  - 1 Slide-In
  - 1 Foldable Half
  - 3 Fixed
- 6 Clear Door Bins
  - Right Door: 3 Gallon Bins
  - Left Door: 3 Regular Bins
- Adjustable Shelves for Tall Oversized Items
- High Efficiency Top LED Lighting

Freezer: 6.9 cu. ft.

- EZ-Open Handle™
- 2 Drawer Dividers
- High Efficiency LED Lighting

### Accessories

Water Filter: HAF-QIN

### Warranty

One (1) Year Parts and Labor on Refrigerator  
Five (5) Years Parts and Labor on Sealed Refrigeration System Only\*  
Ten (10) Years Parts and Five (5) Years Labor on Digital Inverter Compressor

\*Compressor, evaporator, condenser, drier and connecting tubing.

### Product Dimensions & Weight

Dimensions (WxHxD with hinges, handles and doors): 35 3/4" x 70" x 31"

Dimensions (WxHxD without hinges and door): 35 3/4" x 68 7/8" x 24"

Dimensions (WxHxD with hinge and door, no handle): 35 3/4" x 70" x 28 1/2"

Weight: 279 lbs

### Shipping Dimensions & Weight (WxHxD)

Dimensions: 38 1/4" x 76" x 31 1/4"

Weight: 300 lbs

Color	Model #	UPC Code
Fingerprint Resistant Stainless Steel	RF23R6201SR	887276341286
Fingerprint Resistant Black Stainless Steel	RF23R6201SG	887276341279
Fingerprint Resistant Tuscan Stainless Steel	RF23R6201DT	887276341262
White	RF23R6201WW	887276341293

Actual color may vary. Design, specifications, and color availability are subject to change without notice. Non-metric weights and measurements are approximate.

*Handwritten signature: Manfred Bar*  
*Handwritten signature: [illegible]*