

Kingsmen (Islington) Inc. / 9560 Islington

Lot/Unit: U239 Block 3 Phase/Building: 3 Model/Floor Plan: The Venice - 3 Bed (B6-3B)

CABINETRY ACCESSORIES

| | | |
|------------------|---|--|
| Inv.4927 | 3 - To supply & install the LIGHT VALANCE - - LIGHT VALANCE IS NOW APPROXIMATELY 2INCHES 50MM HIGH - CLASSIC SERIES in the kitchen... | |
| Line 63354 | Note: Puck lights are sold sep. | |
| 5Mar21 / 18May21 | | |

CABINETRY APPLIANCE - FRIDGE

| | | |
|------------------|---|--|
| Inv.4927 | 1 - To supply and install 66CM DEEP FRIDGE ENCLOSURE - COUNTER DEPTH WITH - 1 WALL - 1 66CM DEEP GABLE AND 1 66CM DEEP CABINET - THIS IS NOT A ZERO CLEARANCE ENCLOSURE. STANDARD HEIGHTS AND WIDTHS WILL BE USED. - CLASSIC SERIES | |
| Line 63357 | Note: | |
| 5Mar21 / 18May21 | | |

CABINETRY HOOD FANS

| | | |
|------------------|--|--|
| Inv.4927 | 1 - To ACCOMMODATE FOR MICROWAVE HOOD FAN COMBO - CLASSIC SERIES in the kitchen NO OTR HAS BEEN PURCHASED | |
| Line 63350 | Note: STILL TO INSTALL THE STANDARD HOOD FAN | |
| 5Mar21 / 18May21 | | |

CABINETRY VANITY

| | | |
|------------------|---|--|
| Inv.4927 | 1 - To INCREASE VANITY TO KITCHEN HEIGHT - 90CM HIGH - MAINTAINS VANITY DEPTH - CLASSIC SERIES in the Powder Room | |
| Line 63362 | Note: | |
| 5Mar21 / 18May21 | | |
| Inv.4927 | 2 - To supply and install a LOWER DRAWER -CLASSIC I SERIES in the Powder room.. see sketch #1 | |
| Line 63363 | Note: | |
| 5Mar21 / 18May21 | | |
| Inv.4927 | 2 - To supply and install a LOWER DRAWER - CLASSIC I SERIES in the Master Ensuite... see sketch #2 | |
| Line 63364 | Note: | |
| 5Mar21 / 18May21 | | |
| Inv.4927 | 2 - To supply a LOWER DRAWER - CLASSIC I SERIES in the Main Bathroom.. see sketch #2 | |
| Line 63365 | Note: | |
| 5Mar21 / 18May21 | | |

COUNTER TOP - KITCHEN

| | | |
|------------------|--|--|
| Inv.4927 | 1 - To supply COUNTER TOP - KITCHEN - KITCHEN - 3CM QUARTZ COUNTER TOP - UPGRADE LEVEL 2 in lieu of the standard... see colour chart | |
| Line 63358 | Note: | |
| 5Mar21 / 18May21 | | |

COUNTER TOP - VANITY

Kingsmen (Islington) Inc. / 9560 Islington

Lot/Unit: U239 Block 3 Phase/Building: 3 Model/Floor Plan: The Venice - 3 Bed (B6-3B)

| | | |
|------------------|--|--|
| Inv.4927 | 1 - To supply and install COUNTER TOP - VANITY - POWDER ROOM - 2CM QUARTZ COUNTER TOP - UPGRADE LEVEL 2 in lieu of the standard.. see colour chart | |
| Line 63359 | Note: | |
| 5Mar21 / 18May21 | | |
| Inv.4927 | 1 - To supply COUNTER TOP - VANITY - MASTER ENSUITE - 2CM QUARTZ COUNTER TOP - UPGRADE LEVEL 2 in lieu of the standard.. see colout chart | |
| Line 63360 | Note: | |
| 5Mar21 / 18May21 | | |
| Inv.4927 | 1 - To supply and install COUNTER TOP - VANITY - MAIN BATHROOM - 2CM QUARTZ COUNTER TOP - UPGRADE LEVEL 2 in lieu of the standard.. see colour chart | |
| Line 63361 | Note: | |
| 5Mar21 / 18May21 | | |

ELECTRICAL

| | | |
|------------------|---|--|
| Inv.4927 | 4 - DO NOT INSTALL THE STANDARD LIGHT IN THE KITCHEN, LEAVE THE STANDARD SWITCH AND.. Supply and install FOUR SLIM LED DOWN AFR4-0930-WH in the kitchen connected to the standard switch.. see sketch #1 | |
| Line 63351 | Note: | |
| 5Mar21 / 18May21 | | |
| Inv.4927 | 1 - Supply and install SIX SLIM LED DOWN AFR4-0930-WH in the living room connected to the standard switch.. see sketch #1 | |
| Line 63352 | Note: | |
| 5Mar21 / 18May21 | | |
| Inv.4927 | 1 - To supply and install THREE LED under cabinet puck lights CA360WH connected to a separate switch in the kitchen.. see sketch #1 | |
| Line 63353 | Note: | |
| 5Mar21 / 18May21 | | |
| Inv.4927 | 1 - To supply and install the standard Phone (CAT 5) rough in, in the Living room, master bedroom and bedroom #3.. see sketch #1 and #2 | |
| Line 63326 | Note: | |
| 5Mar21 / 18May21 | | |
| Inv.4927 | 1 - To supply and install the standard T.V rough in, in the living room and master bedroom.. see sketch #1 and #2 | |
| Line 63327 | Note: | |
| 5Mar21 / 18May21 | | |
| Inv.4927 | 1 - To supply and install the electrical required for a future OTR OVER THE COUNTER MICROWAVE/RANGEHOOD NO OTR HAS BEEN PURCHASED | |
| Line 63349 | Note: SILL TO INSTALL THE STANDARD HOOD FAN | |
| 5Mar21 / 18May21 | | |

HARDWOOD

| | | |
|------------------|---|--|
| Inv.4927 | 1 - To supply and install HARDWOOD - MASTER BEDROOM - STANDARD FLOOR IN NON STANDARD AREAS in lieu of the standard carpet | |
| Line 63371 | Note: | |
| 5Mar21 / 18May21 | | |

Kingsmen (Islington) Inc. / 9560 Islington

Lot/Unit: U239 Block 3 Phase/Building: 3 Model/Floor Plan: The Venice - 3 Bed (B6-3B)

| | | |
|------------------|--|--|
| Inv.4927 | 1 - To supply and install HARDWOOD - BEDROOM 2 - STANDARD FLOOR IN NON STANDARD AREAS in lieu of the standard carpet | |
| Line 63372 | Note: | |
| 5Mar21 / 18May21 | | |
| Inv.4927 | 1 - To supply and install HARDWOOD - BEDROOM 3 - STANDARD FLOOR IN NON STANDARD AREAS in lieu of the standard carpet | |
| Line 63373 | Note: | |
| 5Mar21 / 18May21 | | |

PLUMBING

| | | |
|------------------|--|--|
| Inv.4927 | 1 - To supply and install the BLANCO QUATRUS 2 MODEL #401247 in lieu of the standard kitchen sink.. see spec's | |
| Line 63355 | Note: STILL TO INSTALL THE STANDARD SINGLE HOLE FAUCET | |
| 5Mar21 / 18May21 | | |
| Inv.4927 | 3 - To supply and install CONTRAC CATENA 4210CIY in the Powder Room, Master Ensuite and Main Bathroom in lieu of the standard.. see spec's | |
| Line 63356 | Note: STILL TO INSTALL THE STANDARD FAUCET | |
| 5Mar21 / 18May21 | | |

TILE - FLOOR

| | | |
|------------------|--|--|
| Inv.4927 | 1 - To suppy and install UPGRADE 1 - FLOOR TILE - - POWDER ROOM TILE in lieu of the standard | |
| Line 63366 | Note: | |
| 5Mar21 / 18May21 | | |
| Inv.4927 | 1 - To supply and install UPGRADE 1 - FLOOR TILE - - MASTER ENSUITE TILE in lieu of the standard | |
| Line 63367 | Note: | |
| 5Mar21 / 18May21 | | |
| Inv.4927 | 1 - To supply and install UPGRADE 2 - FLOOR TILE - - MAIN BATHROOM TILE in lieu of the standard | |
| Line 63368 | Note: | |
| 5Mar21 / 18May21 | | |

TILE - WALL

| | | |
|------------------|--|--|
| Inv.4927 | 1 - To install the standard wall TILE - BRICK PATTERN - - MASTER ENSUITE SHOWER WALL TILE ...see sketch # 2 for details. | |
| Line 63369 | Note: | |
| 5Mar21 / 18May21 | | |
| Inv.4927 | 1 - To install the standard wall TILE - BRICK PATTERN - - MAIN BATHROOM WALL TILE ...see sketch #2 for details. | |
| Line 63370 | Note: | |
| 5Mar21 / 18May21 | | |

Purchaser:INVENTORY UNIT_U239

Property: U239 Block 3 of Plan -

Telephone Res. / Bus: /

Project: Kingsmen (Islington) Inc.

Decor Advisor: Barbara Coccia

Model and Elevation: The Venice - 3 Bed (B6-3B)

Layout Changes: ☐ Yes ☒ No

Sketch Attached: ☒ Yes ☐ No

Exterior Colour Scheme:

| 1. Cabinetry | Style and Colour | Counter Top | Hardware |
|---|------------------|-----------------------|--------------|
| Kitchen / Breakfast | #3 Simcoe Orchid | *UPG #2 H/S Aspen 3cm | 12881 Handle |
| Kitchen Island | #3 Simcoe Orchid | *UPG #2 H/S Aspen 3cm | 12881 Handle |
| Laundry Room | / | / | / |
| Powder Room | #3 Simcoe Orchid | *UPG #2 H/S Aspen 2cm | 12881 Handle |
| Main Bathroom | #3 Simcoe Orchid | *UPG #2 H/S Aspen 2cm | 12881 Handle |
| Master Ensuite Bathroom | #3 Simcoe Orchid | *UPG #2 H/S Aspen 2cm | 12881 Handle |
| Second Ensuite Bathroom (If Applicable) | / | / | / |
| | / | / | / |
| | / | / | / |

Appliances

Custom Size Fridge
☐ Yes ☒ No

Valance Lighting
☒ Yes ☐ No

Microwave / Range Hood
☒ Yes ☐ No

Cooktop / Rangetop
☐ Yes ☒ No

Built in Wall Oven
☐ Yes ☒ No

Slide-in Range
☐ Yes ☒ No

Comment

| 2. Flooring | Selection |
|-------------------------------|---|
| Main Hall | / |
| Back Hall | / |
| Breakfast | / |
| Laundry Room | 13x13" Cinq Grey |
| Kitchen | 5" Elements Brushed Oak Magpie |
| Powder Room | **UPG #1 13X13" Davenport Earth HD Porcelain Tile |
| Main Bathroom | **UPG #1 13X13" Davenport Earth HD Porcelain Tile |
| Master Ensuite | **UPG #1 13X13" Davenport Earth HD Porcelain Tile |
| Bathroom (If Applicable) | / |
| Mud Room | / |
| Master SH/FL | 2x2" Soho White Matte |
| Living Room | 5" Elements Brushed Oak Magpie |
| Dining Room | 5" Elements Brushed Oak Magpie |
| Family / Great Room | / |
| Den / Library / Study | / |
| Basement Landing (If Applies) | |
| Lower Landing (If Applicable) | 5" Elements Brushed Oak Magpie |
| Upper Landing | 5" Elements Brushed Oak Magpie |
| Upper Hall | 5" Elements Brushed Oak Magpie |
| Master Bedroom | **5" Elements Brushed Oak Magpie |
| Bedroom #2 | **5" Elements Brushed Oak Magpie |
| Bedroom #3 | **5" Elements Brushed Oak Magpie |
| Bedroom #4 | / |
| Bedroom #5 | / |

Purchaser: INVENTORY UNIT_U239

Property: U239 Block 3 of Plan -

Telephone Res. / Bus: /

Project: Kingsmen (Islington) Inc.

Decor Advisor: Barbara Coccia

Model and Elevation: The Venice - 3 Bed (B6-3B)

2. Flooring - Continued -

| Upgrade Underpad | Type | Area |
|------------------|--------|-------------------|
| | / | / |
| Carpet on Stairs | Capped | Runner - *Upgrade |
| | / | / |
| Comment | | |
| / | | |

3. Plumbing Fixtures / Faucets

| | | | | | |
|----------------|----------|----------------|---|-------------|----------|
| Kitchen | Standard | Second Ensuite | / | Powder Room | Standard |
| Master Ensuite | Standard | | | Other Room | |
| Main Bathroom | Standard | | / | | |

Comment

Note: The kitchen sink has been upgraded.. still to install the standard single hole faucet.

All bathrooms (Powder room, master ensuite and main bathroom) have upgraded to undermount sinks.. still to install the standard faucet.

4. Wall Tile

| | Tile Selection | Listello | Insert | Insert Selection |
|---------------------|--------------------------------------|--------------------------|--------------------------|------------------|
| Main Bathroom | 8x10" Cinq White 70/30 Brick Pattern | <input type="checkbox"/> | <input type="checkbox"/> | / |
| Master Ensuite | | | | |
| Tub Deck | / | <input type="checkbox"/> | <input type="checkbox"/> | / |
| Tub Apron | / | <input type="checkbox"/> | <input type="checkbox"/> | / |
| Tub Surround | / | <input type="checkbox"/> | <input type="checkbox"/> | / |
| Shower Stall | 8x10" Cinq White 70/30 Brick Pattern | <input type="checkbox"/> | <input type="checkbox"/> | / |
| Second Ensuite | / | <input type="checkbox"/> | <input type="checkbox"/> | / |
| | / | <input type="checkbox"/> | <input type="checkbox"/> | / |
| | / | <input type="checkbox"/> | <input type="checkbox"/> | / |
| Kitchen Backsplash | / | <input type="checkbox"/> | <input type="checkbox"/> | / |
| Complete Backsplash | / | <input type="checkbox"/> | <input type="checkbox"/> | / |

Comment

NOTE: To supply and install all wall tiles in the Main Bathroom and Master Ensuite on the 10" side horizontally in a brick pattern

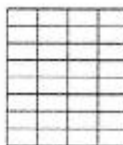

horizontal stacked

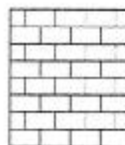

brick pattern



vertical stacked



diagonal/diamond

5. Fireplace

| | Living Room | | | Family Room | | | Other Room - Specify | | |
|----------------|-----------------------|-----------------------|----------------------------------|-----------------------|-----------------------|----------------------------------|-----------------------|-----------------------|----------------------------------|
| | Purchased | As Per Plan | N/A | Purchased | As Per Plan | N/A | Purchased | As Per Plan | N/A |
| Fireplace Type | <input type="radio"/> | <input type="radio"/> | <input checked="" type="radio"/> | <input type="radio"/> | <input type="radio"/> | <input checked="" type="radio"/> | <input type="radio"/> | <input type="radio"/> | <input checked="" type="radio"/> |
| Mantle Type | | | | | | | | | |
| Over Mantle | | | | | | | | | |
| Colour / Stain | | | | | | | | | |
| Surround | | | | | | | | | |
| Hearth | | | | | | | | | |
| Comment | | | | | | | | | |

Initial: _____

Page 2 of 3

Purchaser: INVENTORY UNIT_U239

Telephone Res. / Bus: /

Decor Advisor: Barbara Coccia

Property: U239 Block 3 of Plan -

Project: Kingsmen (Islington) Inc.

Model and Elevation: The Venice - 3 Bed (B6-3B)

6. Trim Carpentry

Door Hardware Standard Handle

Interior Trim Standard

Comment

/

Interior Doors

☐ 2 Panel Arch Top

☒ 2 Panel Square Top

☐ 6 Panel



Initial for Door Style _____

7. Railings and Pickets

Railing Package Standard Metal Package

Railing Colour Elements Magppie

Wood Stairs ☐ No ☒ Oak

Picket Colour Black Metal

Tread Colour Elements Magppie

Comment

/

8. Plaster Mouldings and Medallions

| | | | | | |
|-------------|---|---|-------------------|---|---|
| Foyer | / | / | Kitchen/Breakfast | / | / |
| Main Hall | / | / | Den/Library | / | / |
| Living Room | / | / | Lower Landing | / | / |
| Dining Room | / | / | | / | / |
| Family Room | / | / | | / | / |

Comment

/

9. Wall Paint

Kingsmen White

Smooth Ceilings ☐ First Floor
☐ First Floor incl. Second Floor Hall
☐ First and Second Floor
☒ Throughout
☐ Not Applicable

Trim Paint Kingsmen White

10. Additional Comments

/

11. Disclaimers and Notes

- Colours of all materials are as close as possible to builder's selection, but not necessarily identical due to variances in manufacturing
- Any extras listed above are null and void unless accompanied by a separate invoice/amendment. Said invoice must be paid in full.
- The Purchaser acknowledges that after Interior Colour Selection form is signed and dated, no further changes will be permitted other than re-selection due to unavailability. _____ Purchaser's Initials
- The Purchaser acknowledges reading and accepting the "Kingsmen Group Décor Centre Disclaimers" form. This document contains other miscellaneous disclaimers.

This Interior Colour Selection is final and approved by:

Purchaser:

Signature: _____ Date: _____

Vendor:

Kingsmen (Islington) Inc.

May 18, 2021

UNIT: U239
BLOCK #3
9560 ISLINGTON
SKETCH # 1

OPTIONAL
B6 THE VENICE |
SKYLINE COLLECTION

1505 SQ. FT.
2 BDR | 1 BATH | 1 KITCHEN | 1 BATH

9560
ISLINGTON

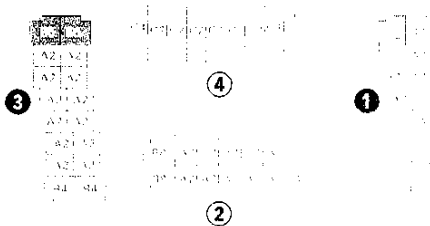
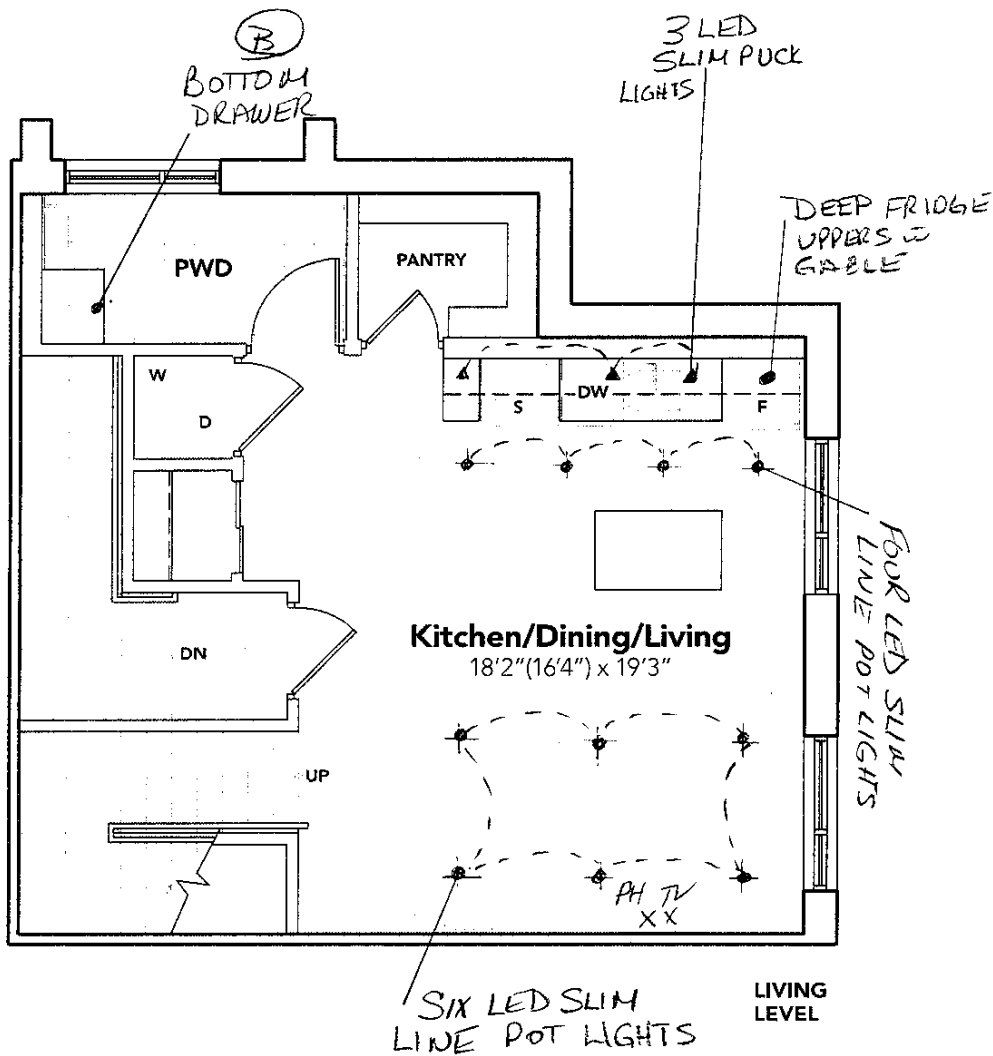
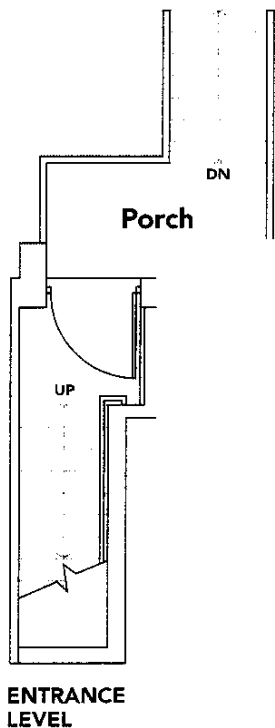

BLOCKS 1 & 3

All unit layouts, sizes, specific items and construction are subject to change without notice. All prices and charges are estimates only. Approximate. Mechanical locations, actual cable floor plans, being provided upon request may vary from depicted floor plan. Dimensions are in feet and inches (ft. x in.).

KINGSIIEN

SKETCH # 2

SKYLINE COLLECTION

[illegible]

ISLINGTON



BEDROCK
LEVEL



**TERRACE
LEVEL**

KINGSLEY

UNIT: U239
BLOCK #3
9560 ISLINGTON
RE: UPGRADED UNDER MOUNT
KITCHEN SINK

BLANCO

Sink Specifications

| Colour | SKU |
|----------------|--------|
| brushed finish | 401247 |

Design and planning tips

- Min cabinet size: 36 in (915 mm)
- Bowl Depth: 9 in (230.0 mm)

Specifications:
Installation clips, Sink template, Installation instructions, 3
½" (90 mm) stainless steel strainers

Depending on cabinet construction, a different cabinet
size may be required. Consult the cabinet manufacturer.

QUATRUS U 2

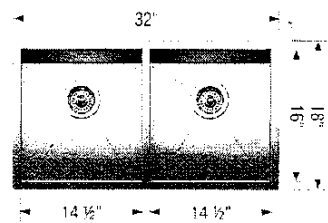

UNIT: U239
BLOCK #3
9560 ISLINGTON
RE: UPGRADED UNDER MOUNT
BATHROOM SINKS.



Main Floor Vanity Display

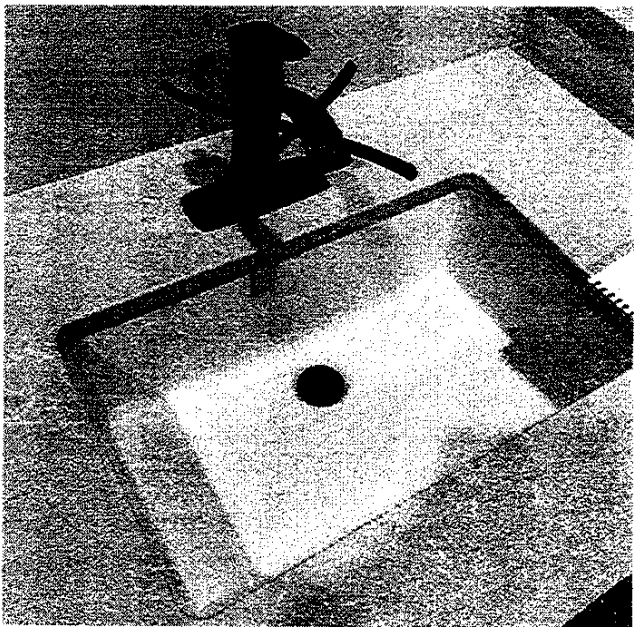

DISPLAY ITEMS

Sink (Item 9)
Contrac Catena Undermount
Model 4210CIY