



CONSTRUCTION SUMMARY

Kingsmen (Thames) Inc. / Havelock Corners (Kingsmen)

Lot/Unit: 53    Phase/Building: 4B    Model/Floor Plan: Spencer (4204) Elev A 4 Bed - 4+1 Bath

COUNTER TOP

Inv.5050	1 - As per schedule "PE": Vendor to include Level 1, 2cm granite or quartz in all bathrooms, as per plan, in lieu of the included laminate counter tops. Selections to be made from builders standard samples.	
Line 65572	Note:	
28Jun21 / 28Jun21		

DOORS AND WINDOWS

Inv.5050	1 - To supply and install the optional side door in grade permits, as per plan	
Line 65575	Note:	
28Jun21 / 28Jun21		

ELECTRICAL

Inv.5050	1 - To supply and install the standard T.V rough-in, in the Great Room and Master Bedroom.. see sketch #1 and #2	
Line 65589	Note:	
28Jun21 / 28Jun21		
Inv.5050	1 - To supply and install the standard Phone (CAT 5) Rough-in, in the Great Room, Master Bedroom and Media Niche.. see sketch #1 and #2	
Line 65590	Note:	
28Jun21 / 28Jun21		
Inv.5050	1 - To SUPPLY AND INSTALL AN ADDITIONAL BASIC RECEPTACLE (NOT DEDICATED) centered +- over the F/P Mantle in the Great Room, at approx. 66"+- up from the floor.. see sketch #1	
Line 65591	Note: THIS IS FOR FUTURE WALL MOUNT T.V	
28Jun21 / 28Jun21		
Inv.5050	1 - To SUPPLY AND INSTALL CONDUIT FOR TV OVER THE FIREPLACE nex to +- the elec. outlet– TERMINATED IN SAME ROOM next to +- the standard Phone and T.V rough-in.. see sketch #1	
Line 65593	Note: THIS IS FOR FUTURE WALL MOUNT T.V	
28Jun21 / 28Jun21		
Inv.5050	1 - To SUPPLY AND INSTALL EXTRA CEILING BOX ROUGH IN CAPPED (ON A SEP SWITCH) over the breakfast bar in the kitchen.. see sketch #1	
Line 65594	Note:	
28Jun21 / 28Jun21		
Inv.5050	1 - To relocate the standard light from the 2nd floor landing to the Open to Below area.. see sketch #2	
Line 65597	Note:	
28Jun21 / 28Jun21		

HARDWOOD

Inv.5050	1 - As per Schedule "PE": Vendor to include engineered hardwood throughout the 2nd floor in lieu of included carpet, as per plan, and selections as outlined in schedule A. This has no cash value.	
Line 65573	Note:	
28Jun21 / 28Jun21		

HEATING AND AIR CONDITIONING



CONSTRUCTION SUMMARY

Kingsmen (Thames) Inc. / Havelock Corners (Kingsmen)

Lot/Unit: 53    Phase/Building: 4B    Model/Floor Plan: Spencer (4204) Elev A 4 Bed - 4+1 Bath

Inv.5050	1 - As per Schedule "PE": Vendor to supply and install air conditioning unit, sized accordingly, from Vendors standard samples.	
Line 65571	Note:	
28Jun21 / 28Jun21		

HVAC

Inv.5050	1 - As per Schedule "PE": Vendor to install capped gas line (rough-in ONLY) at rear of home for future BBQ location. Location to be finalized at Vendors sole discretion.	
Line 65569	Note:	
28Jun21 / 28Jun21		

Inv.5050	1 - As per Schedule "PE": Vendor to install gas line (rough-in ONLY) to kitchen in at stove location (as per plan) to include 110V code requirement.	
Line 65570	Note:	
28Jun21 / 28Jun21		

MISCELLANEOUS

PAINT AND DRYWALL

Inv.5050	1 - To supply and install the standard Coffered Ceiling in the Dining Room as per plan.. see sketch #1	
Line 65574	Note:	
28Jun21 / 28Jun21		

PLUMBING

Inv.5050	6 - To supply and install the VANITY SINK - CONTRAC CATENA UNDERMOUNT - MODEL 4210CIY in the Pwd, Master Ensuite, Bedroom #2, #3 and #4 bathroom in lieu of the standard topmount sinks.. see spec's	
Line 65598	Note: STILL TO INSTALL THE STANDARD FAUCETS	
28Jun21 / 28Jun21		

RAILING

Inv.5050	1 - To supply and install RAILING - UPGRADE 1 - METAL HANDRAIL 3 INCH OVAL IN OAK - PICKETS STEEL ½ INCH SQUARE, PLAIN, WITH SHOES IN FLAT BLACK - POSTS 3½ INCH SQUARE, WITH CAP OAK IN OAK in lieu of the standard	
Line 65603	Note:	
28Jun21 / 28Jun21		

TILE - FLOOR

Inv.5050	1 - To supply and install UPGRADE 3 - FLOOR TILE - STACKED - FOYER TILE in lieu of the standard floor tile	
Line 65599	Note:	
28Jun21 / 28Jun21		

Inv.5050	1 - To supply and install UPGRADE 3 - FLOOR TILE - STACKED - KITCHEN/BREAKFAST TILE in lieu of the standard floor tile	
Line 65600	Note:	
28Jun21 / 28Jun21		



CONSTRUCTION SUMMARY

Kingsmen (Thames) Inc. / Havelock Corners (Kingsmen)

Lot/Unit: 53    Phase/Building: 4B    Model/Floor Plan: Spencer (4204) Elev A 4 Bed - 4+1 Bath

Inv.5050	1 - To supply and install UPGRADE 3 - FLOOR TILE - STACKED - POWDER ROOM TILE in lieu of the standard floor tile	
Line 65602	Note:	
28Jun21 / 28Jun21		

EXTRAS AS PER OFFER

VENDOR TO INSTALL CAPPED GAS LINE (ROUGH-IN ONLY) AT REAR OF HOME FOR FUTURE BBQ LOCATION. LOCATION TO BE FINALIZED AT VENDORS SOLE DISCRETION. <i>Worksheet</i> Note:	
VENDOR TO INSTALL GAS LINE (ROUGH-IN ONLY) TO KITCHEN IN AT STOVE LOCATION (AS PER PLAN) TO INCLUDE 110V CODE REQUIREMENT. <i>Worksheet</i> Note:	
VENDOR TO SUPPLY & INSTALL AIR CONDITIONING UNIT, SIZED ACCORDINGLY, FROM VENDORS STANDARD SAMPLES. <i>Worksheet</i> Note:	
VENDOR TO INCLUDE LEVEL 1, 20CM GRANITE OR QUARTZ IN ALL BATHROOMS, AS PER PLAN, IN LIEU OF THE INCLUDED LAMINATE COUNTER TOPS. SELECTIONS TO BE MADE FROM BUILDERS STANDARD SAMPLES. <i>Worksheet</i> Note:	
VENDOR TO INCLUDE ENGINEERED HARDWOOD THROUGHOUT THE 2ND FLOOR IN LIEU OF INCLUDED CARPET, AS PER PLAN, AND SELECTIONS AS OUTLINED IN SCHEDULE A. THIS HAS NO CASH VALUE <i>Worksheet</i> Note:	

JUN 28 2021

**Purchasers:** JASWANT SINGH PUREWAL & AMANDEEP KAP**Property:** 53 of Plan - Draft Approval SB17-03-08  
**Telephone Res. / Bus:** / **Project:** Kingsmen (Thames) Inc.  
**Decor Advisor:** Barbara Coccia **Model and Elevation:** Spencer (4204) Elev A 4 Bed - 4+1 Bath

**Layout Changes:** ☒ Yes ☐ No **Sketch Attached:** ☐ Yes ☒ No **Exterior Colour Scheme:**

### 1. Cabinetry

	Style and Colour	Counter Top	Hardware
Kitchen / Breakfast	#3 Manchester Maple Shale Grey CL	#1 C/S #9141 Ice Snow 3cm	12881 Handle
Kitchen Island	#3 Manchester Maple Shale Grey CL	#1 C/S #9141 Ice Snow 3cm	12881 Handle
Laundry Room	/	/	/
Powder Room	#3 Manchester Maple Shale Grey CL	#1 C/S #9141 Ice Snow 2cm	12881 Handle
Main Bathroom	/	/	/
Master Ensuite Bathroom	#3 Charleston 3DL Orchid	#1 C/S #9141 Ice Snow 2cm	135 Knob
Second Ensuite Bathroom (If Applicable)	#3 Manchester Maple Shale Grey CL	#1 C/S #9141 Ice Snow 2cm	135 Knob
Bedroom #3 Bathroom	#3 Manchester Maple Shale Grey CL	#1 C/S #9141 Ice Snow 2cm	135 Knob
Bedroom #4 Bathroom	#3 Manchester Maple Shale Grey CL	#1 C/S #9141 Ice Snow 2cm	135 Knob

**Appliances**

<b>Custom Size Fridge</b> <input type="radio"/> Yes <input checked="" type="radio"/> No	<b>Valance Lighting</b> <input type="radio"/> Yes <input checked="" type="radio"/> No	<b>Microwave / Range Hood</b> <input type="radio"/> Yes <input checked="" type="radio"/> No
<b>Cooktop / Rangetop</b> <input type="radio"/> Yes <input checked="" type="radio"/> No	<b>Built in Wall Oven</b> <input type="radio"/> Yes <input checked="" type="radio"/> No	<b>Slide-in Range</b> <input type="radio"/> Yes <input checked="" type="radio"/> No

**Comment**

### 2. Flooring

	Selection
Foyer	**UPG #3: 12x24" Mayfair Calacatta Oro HD Polished Rect. Porcelain Tile STACKED
Main Hall	3 1/2" Elements Oak Sturgeon
Back Hall	/
Breakfast	**UPG #3: 12x24" Mayfair Calacatta Oro HD Polished Rect. Porcelain Tile STACKED
Laundry Room	13x13" Keaton Ice
Kitchen	**UPG #3: 12x24" Mayfair Calacatta Oro HD Polished Rect. Porcelain Tile STACKED
Powder Room	**UPG #3: 12x24" Mayfair Calacatta Oro HD Polished Rect. Porcelain Tile STACKED
Main Bathroom	(Bedroom #2 13x13" Keaton Ice SH/FL:2x2" Soho White Matte
Master Ensuite	13x13" Keaton Ice SH/FL:2x2" Soho White Matte
Bathroom (If Applicable)	(Bedroom #3 Bathroom)-13x13" Keaton Ice
Mud Room	13x13" Keaton Ice
Bedroom #4 Bathroom	13x13" Keaton Ice
Living Room	/
Dining Room	3 1/2" Elements Oak Sturgeon
Family / Great Room	3 1/2" Elements Oak Sturgeon
Den / Library / Study	/
Basement Landing (If Applies)	
Lower Landing (If Applicable)	3 1/2" Elements Oak Sturgeon
Upper Landing	3 1/2" Elements Oak Sturgeon
Upper Hall	3 1/2" Elements Oak Sturgeon (Including Media Niche)
Master Bedroom	3 1/2" Elements Oak Sturgeon
Bedroom #2	3 1/2" Elements Oak Sturgeon
Bedroom #3	3 1/2" Elements Oak Sturgeon
Bedroom #4	3 1/2" Elements Oak Sturgeon
Bedroom #5	/
Shower Jamb (Sill)	Master Ens. & Ens. #2: Anatolia Marmiline SNOW

Flooring Continued on Page 2

Initial: 

Page 1 of 3

JUN 28 2021

**Purchasers:** JASWANT SINGH PUREWAL & AMANDEEP KA  
**Telephone Res. / Bus:** /  
**Decor Advisor:** Barbara Coccia  
**Property:** 53 of Plan - Draft Approval SB17-03-08  
**Project:** Kingsmen (Thames) Inc.  
**Model and Elevation:** Spencer (4204) Elev A 4 Bed - 4+1 Bath

### 2. Flooring - Continued -

Upgrade Underpad	Type	Area
	/	/
Carpet on Stairs	Capped	Runner - *Upgrade
Comment	/	/

### 3. Plumbing Fixtures / Faucets

Kitchen	Standard	Second Ensuite	Standard	Powder Room	Standard
Master Ensuite	Standard			Other Room	/
Main Bathroom	/	Bedroom #3/#4	Standard		

#### Comment

NOTE: To supply and install the standard undermount kitchen sink, with the standard faucet. ALL bathroom sinks have been upgraded.. see spec's, still to install the standard faucets.

### 4. Wall Tile

	Tile Selection	Listello	Insert	Insert Selection
Main Bathroom	/	<input type="checkbox"/>	<input type="checkbox"/>	/
Master Ensuite				
Tub Deck	/	<input type="checkbox"/>	<input type="checkbox"/>	/
Tub Apron	/	<input type="checkbox"/>	<input type="checkbox"/>	/
Tub Surround	/	<input type="checkbox"/>	<input type="checkbox"/>	/
Shower Stall	8x10" Keaton Ice	<input type="checkbox"/>	<input type="checkbox"/>	/
Second Ensuite	8x10" Keaton Ice	<input type="checkbox"/>	<input type="checkbox"/>	/
Bedroom #3 Bathroom	8x10" Keaton Ice	<input type="checkbox"/>	<input type="checkbox"/>	/
Bedroom #4 Bathroom	8x10" Keaton Ice	<input type="checkbox"/>	<input type="checkbox"/>	/
Kitchen Backsplash		<input type="checkbox"/>	<input type="checkbox"/>	/
Complete Backsplash		<input type="checkbox"/>	<input type="checkbox"/>	/

#### Comment

NOTE: To supply and install all wall tiles, in all bathrooms (where applicable) on the 10" side horizontally STACKED.



horizontal stacked



brick pattern



vertical stacked



diagonal/diamond

### 5. Fireplace

	Living Room			Family Room			Other Room - Specify			Great Room
	Purchased	As Per Plan	N/A	Purchased	As Per Plan	N/A	Purchased	As Per Plan	N/A	
Fireplace Type	<input type="radio"/>	<input type="radio"/>	<input type="radio"/>	<input type="radio"/>	<input type="radio"/>	<input type="radio"/>	<input type="radio"/>	<input checked="" type="radio"/>	<input type="radio"/>	
Mantle Type										Front Facing
Over Mantle										NF-08
Colour / Stain										/
Surround										White
Hearth										/
Comment	/									

Initial:

*[Handwritten initials]*

JUN 28 2021

**Purchasers:** JASWANT SINGH PUREWAL & AMANDEEP KAPUR  
**Telephone Res. / Bus:** /  
**Decor Advisor:** Barbara Coccia  
**Property:** 53 of Plan - Draft Approval SB17-03-08  
**Project:** Kingsmen (Thames) Inc.  
**Model and Elevation:** Spencer (4204) Elev A 4 Bed - 4+1 Bath

### 6. Trim Carpentry

Door Hardware Standard Handle

Interior Trim Standard

Comment

/

#### Interior Doors

☐ 2 Panel Arch Top

☒ 2 Panel Square Top

☐ 6 Panel

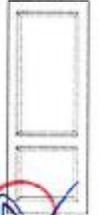

Initial for Door Style

JP

### 7. Railings and Pickets

Railing Package \*\*UPG #1 Metal Package

Railing Colour Elements Sturgeon

Wood Stairs ☐ No ☒ Oak

Picket Colour Black Metal

Tread Colour Elements Sturgeon

Comment

/

### 8. Plaster Mouldings and Medallions

Foyer / /  
 Main Hall / /  
 Living Room / /  
 Dining Room / /  
 Family Room / /

Kitchen/Breakfast / /  
 Den/Library / /  
 Lower Landing / /

Comment

/

### 9. Wall Paint

Kingsmen White

Smooth Ceilings ☐ First Floor  
☐ First Floor incl. Second Floor Hall  
☐ First and Second Floor  
☒ Throughout  
☐ Not Applicable

Trim Paint Kingsmen White

### 10. Additional Comments

/

### 11. Disclaimers and Notes

- Colours of all materials are as close as possible to builder's selection, but not necessarily identical due to variances in manufacturing.
- Any extras listed above are null and void unless accompanied by a separate invoice/amendment. Said invoice must be paid in full.
- The Purchaser acknowledges that after Interior Colour Selection form is signed and dated, no further changes will be permitted other than re-selection due to unavailability. JP
- The Purchaser acknowledges reading and accepting the "Kingsmen Group Décor Centre Disclaimers" form. This document contains other miscellaneous disclaimers.

This Interior Colour Selection is final and approved by:

Purchaser: Jaswant Singh Purewal Date: June 28/21

Signature: [Signature] Date: June 28/21

Vendor: [Signature]  
 Kingsmen (Thames) Inc.

Floor Plan

Model: Spencer (4204) Elev A 4 Bed - 4+1 Bath  
Standard

LOT #53  
Phase 4B

JUN 28 2021

4B-53

SKETCH #1

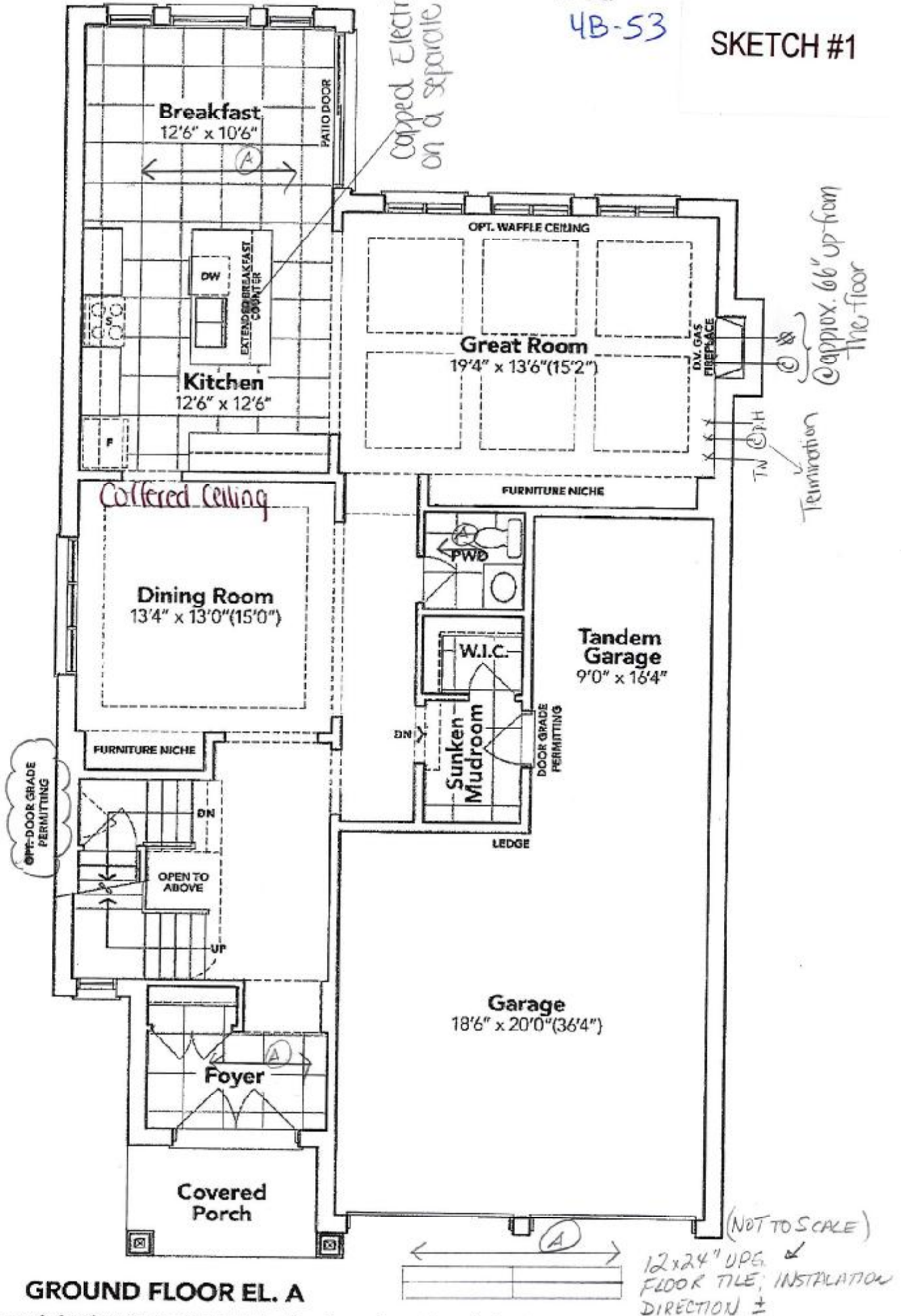

GROUND FLOOR EL. A

The floor plans and elevations shown are pre-construction plans and may be revised or improved as necessitated by architectural controls and the construction process. The measurements adhere to the rules and regulations of the TARION Warranty Corporation's official method for the calculation of floor area. Materials, specifications and floor plans are subject to change without notice. All house renderings are artist's concept only. Actual usable floor space may vary from the stated floor area. All options shown are upgrades. E. & O. E.

*James A. Paul + [Signature]*

## Floor Plan

Model: Spencer (4204) Elev A 4 Bed - 4+1 Bath  
Standard

JUN 28 2021

4B-53

### SKETCH #2

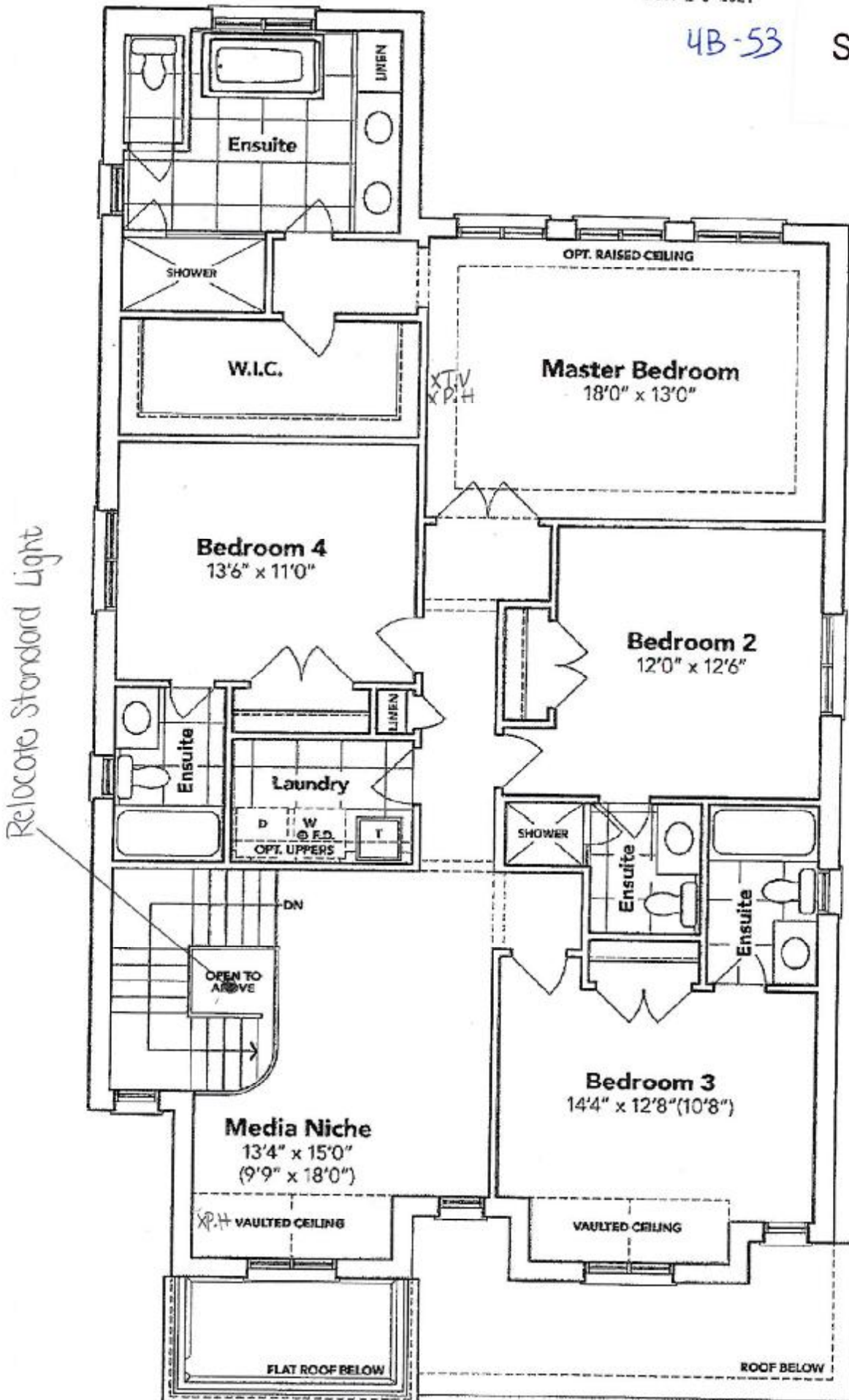

**SECOND FLOOR EL. A**

The floor plans and elevations shown are pre-construction plans and may be revised or improved as necessitated by architectural controls and the construction process. The measurements adhere to the rules and regulations of the TARION Warranty Corporation's official method for the calculation of floor area. Materials, specifications and floor plans are subject to change without notice. All house renderings are artist's concept only. Actual usable floor space may vary from the stated floor area. All options shown are upgrades. E. & O. E.

SCHEDULE "B-1" - Page 2 of 3

Initials:

inMS D14.rpt 22Sep18

Floor Plan

Model: Spencer (4204) Elev A 4 Bed - 4+1 Bath  
Standard

JUN 28 2021

4B-53

SKETCH #3

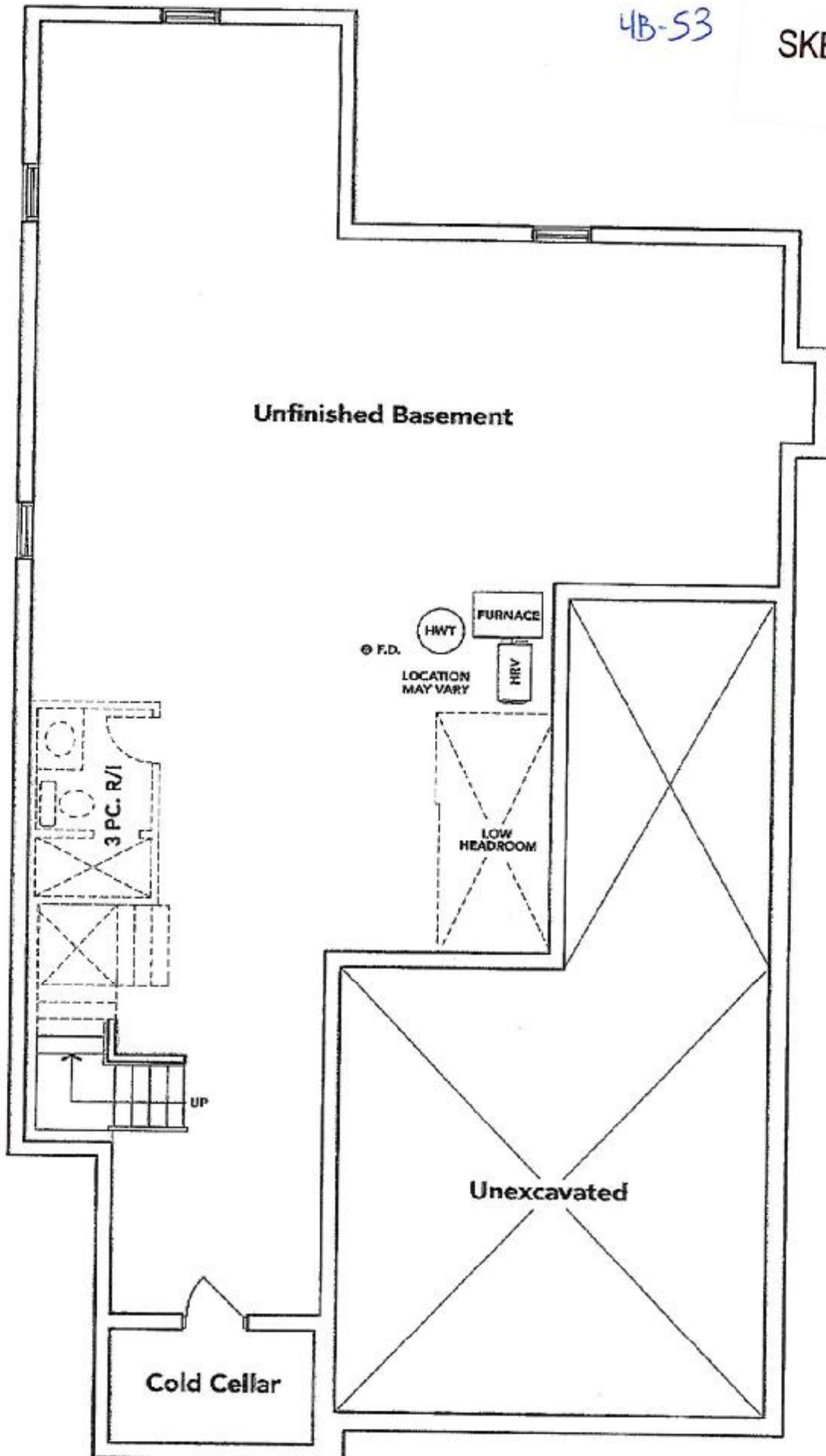

BASEMENT EL. A

The floor plans and elevations shown are pre-construction plans and may be revised or improved as necessitated by architectural controls and the construction process. The measurements adhere to the rules and regulations of the TARION Warranty Corporation's official method for the calculation of floor area. Materials, specifications and floor plans are subject to change without notice. All house renderings are artist's concept only. Actual usable floor space may vary from the stated floor area. All options shown are upgrades. E. & O. E.

+ *James A. Paul*

+ *[Signature]*

SCHEDULE "B-1" - Page 1 of 3

THAMES 4B: LOT 53  
RE: UPG SINKS (PWD, MASTER  
ENSUITE, BEDROOM #2, #3 AND #4)

JUN 28 2021

4B-53

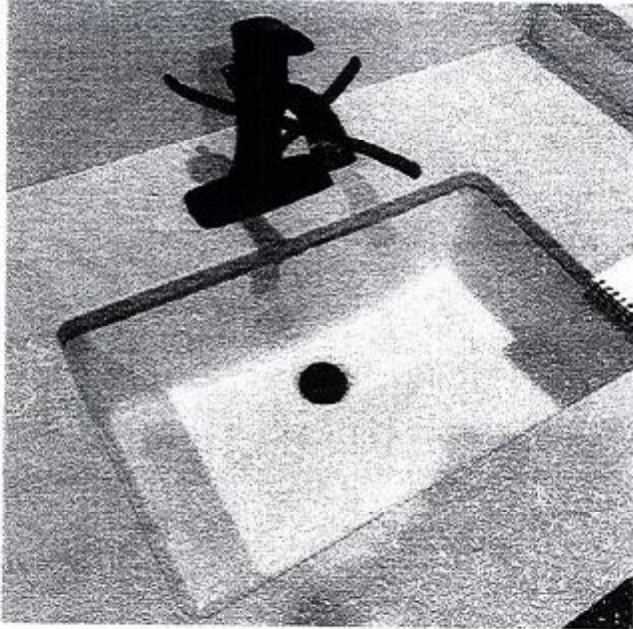

## DISPLAY ITEMS

### Sink ( Item 9)

Contrac Catena Undermount  
Model 4210CIY

+ Tamara Ant Bush  
+ [Signature]