

Kingsmen (Thames) Inc. / Havelock Corners (Kingsmen)

Lot/Unit: 41    Phase/Building: 4B    Model/Floor Plan: Nottingham(5003)Elev B 4 BED-3+1 BATH

CABINETRY HOOD FANS

Inv.5052	1 - To ACCOMMODATE FOR MICROWAVE HOOD FAN COMBO - CLASSIC SERIES for future OTR in the Kitchen	
Line 65625	Note: STILL TO INSTALL STANDARD HOODFAN NO OTR HAS BEEN PURCHASED	
29Jun21 / 30Jun21		

COUNTER TOP

Inv.5052	3 - To supply and install a Shower Niche in the Master Ensuite, Bedroom #2 and Shared Bathroom shower.. see sketch #2	
Line 65627	Note: MASTER ENSUITE: Imperial White BEDROOM #2 BATHROOM: Imperial Black SHARED BATHROOM: Dark Grey	
29Jun21 / 30Jun21		
Inv.5052	1 - As per schedule "PE": Vendor to include level 1, 2cm. granite or quartz in all bathrooms, as per plan, in lieu of the included laminate coutnert otps. Selections to be made from builders standard samples.	
Line 65615	Note:	
29Jun21 / 30Jun21		

DOORS AND WINDOWS

Inv.5052	1 - As per schedule "PE": Vendor agrees to increase the size of the front door to 42 inches wide door, which will have no side lights or transom, and the door will not have a glass insert, but a peep hole.	
Line 65616	Note:	
29Jun21 / 30Jun21		

ELECTRICAL

Inv.5052	1 - To supply and install the standard T.V Rough-in, in the Great Room and Master Bedroom.. see sketch #1 and #2	
Line 65617	Note:	
29Jun21 / 30Jun21		
Inv.5052	1 - To supply and install the standard Phone (CAT 5) rough-in, in the Great Room, Master Bedroom and Study.. see sketch #1 and #2	
Line 65618	Note:	
29Jun21 / 30Jun21		
Inv.5052	1 - To SUPPLY AND INSTALL AN ADDITIONAL BASIC RECEPTACLE (NOT DEDICATED) centered +- over the F/P Mantle in the Great Room at approx. 66" +- up from the floor... see sketch #1	
Line 65619	Note: THIS IS FOR FUTURE WALL MOUNT T.V	
29Jun21 / 30Jun21		
Inv.5052	1 - To SUPPLY AND INSTALL CONDUIT FOR TV OVER THE FIREPLACE in the Great Room next to +- the upg. electrical outlet – TERMINATED IN SAME ROOM next to +- the standard T.V and Phone Rough-in.. see sketch #1	
Line 65620	Note: THIS IS FOR FUTURE WALL MOUNT T.V	
29Jun21 / 30Jun21		
Inv.5052	1 - To relocate the standard light in the Living/Dining Room... see sketch #1	
Line 65621	Note:	
29Jun21 / 30Jun21		

Kingsmen (Thames) Inc. / Havelock Corners (Kingsmen)

Lot/Unit: 41    Phase/Building: 4B    Model/Floor Plan: Nottingham(5003)Elev B 4 BED-3+1  
BATH

Inv.5052	1 - To relocate the standard light in the 2nd floor hallway to the open to below area.. see sketch #2	
Line 65622	Note:	
29Jun21 / 30Jun21		
Inv.5052	1 - To SUPPLY AND INSTALL REINFORCING FOR A CEILING for the standard light in the open to below area... see sketch #2	
Line 65623	Note:	
29Jun21 / 30Jun21		
Inv.5052	1 - TO SUPPLY AND INSTALL AN ADDITIONAL BASIC RECEPTACLE (DEDICATED CIRCUIT AND INCLUDES ARC FAULT BREAKER) for Future OTR RANGE/MICROWAVE HOODFAN	
Line 65624	Note: STILL TO INSTALL THE STANDARD HOODFAN NO OTR HAS BEEN PURCHASED	
29Jun21 / 30Jun21		

HEATING AND AIR CONDITIONING

Inv.5052	1 - As per schedule "PE": Vendor to install capped gas line ( rough in only ) at rear of home for future BBQ location. Location to be finalized at vendors sole discretion.	
Line 65612	Note:	
29Jun21 / 30Jun21		
Inv.5052	1 - As per schedule "PE": Vendor to install gas line ( rough in only ) to kitchen in at stove location ( as per plan) to include 110V code requirement.	
Line 65613	Note:	
29Jun21 / 30Jun21		
Inv.5052	1 - As per schedule "PE": Vendor to supply & install air conditioning unit, sized accordingly, from vendors standard samples.	
Line 65614	Note:	
29Jun21 / 30Jun21		

MISCELLANEOUS

Inv.5052	1 - As per schedule "PE": Purchaser acknowledges this home will receive a corner lot upgrade to the elevation. Such upgrade will be designed and approved by the builder and /or their architects and is not subject to change or modifications by the purchaser	
Line 65611	Note: Purchase price includes corner lot premium.	
29Jun21 / 30Jun21		

PLUMBING

Inv.5052	6 - To supply and install the VANITY SINK - CONTRAC CATENA UNDERMOUNT - MODEL 4210CIY in the Powder Room, Master Ensuite, Bedroom #2 and Shared Bathroom in lieu of the standard sink.. see spec's	
Line 65626	Note:	
29Jun21 / 30Jun21		



CONSTRUCTION SUMMARY

Kingsmen (Thames) Inc. / Havelock Corners (Kingsmen)

Lot/Unit: 41    Phase/Building: 4B    Model/Floor Plan: Nottingham(5003)Elev B 4 BED-3+1  
BATH

EXTRAS AS PER OFFER

PURCHASER ACKNOWLEDGES THIS HOME WILL RECIEVE A CORNER LOT UPGRADE TO THE ELEVATION. SUCH UPGRADE WILL BE DESIGNED AND APPROVED BY THE BUILDER AND/OR THEIR ARCHITECTS AND IS NOT SUBJECT TO CHANGE OR MODIFICATION BY THE PURCHASER.Purchase price includes <i>Worksheet</i> Note:	
VENDOR TO INSTALL CAPPED GAS LINE (ROUGH-IN ONLY) AT REAR OF HOME FOR FUTURE BBQ LOCATION. LOCATION TO BE FINALIZED AT VENDORS SOLE DISCRETION. <i>Worksheet</i> Note:	
VENDOR TO INSTALL GAS LINE (ROUGH-IN ONLY) TO KITCHEN IN AT STOVE LOCATION (AS PER PLAN) TO INCLUDE 110V CODE REQUIREMENT. <i>Worksheet</i> Note:	
VENDOR TO SUPPLY & INSTALL AIR CONDITIONING UNIT, SIZED ACCORDINGLY, FROM VENDORS STANDARD SAMPLES. <i>Worksheet</i> Note:	
VENDOR TO INCLUDE LEVEL 1, 20CM GRANITE OR QUARTZ IN ALL BATHROOMS, AS PER PLAN, IN LIEU OF THE INCLUDED LAMINATE COUNTER TOPS. SELECTIONS TO BE MADE FROM BUILDERS STANDARD SAMPLES. <i>Worksheet</i> Note:	
VENDOR AGREES TO INCREASE THE SIZE OF THE FRONT DOOR TO 42 INCHES WIDE DOOR, WHICH WILL HAVE NO SIDE LIGHTS OR TRANSOM, AND THE DOOR WILL NOT HAVE A GLASS INSERT, BUT A PEEP HOLE. <i>Worksheet</i> Note:	

JUN 30 2021

Purchasers: ZAMAN ALI & BIBI AALI  
Telephone Res. / Bus: /  
Decor Advisor: Barbara Coccia

Property: 41 of Plan - Draft Approval SB17-03-08  
Project: Kingsmen (Thames) Inc.  
Model and Elevation: Nottingham(5003)Elev B 4 BED-3+1 BATH

Layout Changes: ☐ Yes ☒ No

Sketch Attached: ☒ Yes ☐ No

Exterior Colour Scheme:

1. Cabinetry	Style and Colour	Counter Top	Hardware
Kitchen / Breakfast	#3 Charleston 3DL Orchid	#1 C/S #9141 Ice Snow 3cm	12881 Handle
Kitchen Island	#3 Charleston 3DL Orchid	#1 C/S #9141 Ice Snow 3cm	12881 Handle
Laundry Room	/	/	/
Powder Room	#3 Charleston 3DL Orchid	#1 C/S #9141 Ice Snow 2cm	12881 Handle
Main Bathroom	/	/	/
Master Ensuite Bathroom	#3 Charleston 3DL Orchid	#1 C/S #9141 Ice Snow 2cm	135 Knob
Second Ensuite Bathroom (If Applicable)	#3 Charleston 3DL Moonlight	#1 C/S #9141 Ice Snow 2cm	12881 Handle
Shared Bathroom	#3 Camden Maple Oyster CL	#1 C/S #6041 Nordic Loft 2cm	9671 Handle
	/	/	/

Appliances

Custom Size Fridge

☒ Yes
☐ No

Cooktop / Rangetop

☐ Yes
☒ No

Valance Lighting

☐ Yes
☒ No

Built in Wall Oven

☐ Yes
☒ No

Microwave / Range Hood

☒ Yes
☐ No

Slide-in Range

☐ Yes
☒ No

Comment

2. Flooring	Selection
Foyer	12x24" Classic Calacatta HD porcelain Tile STACKED
Main Hall	5" Elements Brushed Oak Bobcat
Back Hall	/
Breakfast	12x24" Classic Calacatta HD porcelain Tile STACKED
Laundry Room	12x24" Classic Calacatta HD porcelain Tile STACKED
Kitchen	12x24" Classic Calacatta HD porcelain Tile STACKED
Powder Room	12x24" Classic Calacatta HD porcelain Tile STACKED
Main Bathroom	(Bedroom #2 Bathroom)- 13x13" Cinq Grey SH/FL:2x2" Soho White Matte
Master Ensuite Bathroom (If Applicable)	12x24" Classic Carrara HD Porcelain Tile STACKED SH/FL:2x2" Soho White Matte
Mud Room	(Shared Bathroom)- 13x13" Bellina Grey SH/FL:2x2" Soho White Matte
	/
	/
Living Room	5" Elements Brushed Oak Bobcat
Dining Room	5" Elements Brushed Oak Bobcat
Family / Great Room	5" Elements Brushed Oak Bobcat
Den / Library / Study	5" Elements Brushed Oak Bobcat
Basement Landing (If Applies)	
Lower Landing (If Applicable)	5" Elements Brushed Oak Bobcat
Upper Landing	5" Elements Brushed Oak Bobcat
Upper Hall	5" Elements Brushed Oak Bobcat
Master Bedroom	5" Elements Brushed Oak Bobcat
Bedroom #2	5" Elements Brushed Oak Bobcat
Bedroom #3	5" Elements Brushed Oak Bobcat
Bedroom #4	5" Elements Brushed Oak Bobcat
Bedroom #5	/
Shower Jambs (Sill)	Master, Bedroom #2 and Shared Bathroom- ANATOLIA MARMILINE SNOW

Flooring Continued on Page 2

Initial:

BA

JUN 30 2021

Purchasers: ZAMAN ALI & BIBI AALI

Property: 41 of Plan - Draft Approval SB17-03-08

Telephone Res. / Bus: /

Project: Kingsmen (Thames) Inc.

Decor Advisor: Barbara Coccia

Model and Elevation: Nottingham(5003)Elev B 4 BED-3+1 BATH

### 2. Flooring - Continued -

Upgrade Underpad	Type	Area
	/	/
Carpet on Stairs	Capped	Runner - *Upgrade
Comment	/	/

### 3. Plumbing Fixtures / Faucets

Kitchen	Standard	Second Ensuite	Standard	Powder Room	Standard
Master Ensuite	Standard			Other Room	/
Main Bathroom	/	Shared Bathroom	Standard		

#### Comment

NOTE: To supply and install the standard undermount sink with the standard single hole faucet. To supply and install the upgraded undermount sink in ALL bathrooms.. still to install the standard faucet.

### 4. Wall Tile

	Tile Selection	Listello	Insert	Insert Selection
Main Bathroom	/	<input type="checkbox"/>	<input type="checkbox"/>	/
Master Ensuite				
Tub Deck	/	<input type="checkbox"/>	<input type="checkbox"/>	/
Tub Apron	/	<input type="checkbox"/>	<input type="checkbox"/>	/
Tub Surround	/	<input type="checkbox"/>	<input type="checkbox"/>	/
Shower Stall	8x10" Keaton Ice	<input type="checkbox"/>	<input type="checkbox"/>	/
Second Ensuite	8x10" Cinq Black	<input type="checkbox"/>	<input type="checkbox"/>	/
Shared Bathroom	8x10" Bellina Grey	<input type="checkbox"/>	<input type="checkbox"/>	/
/	/	<input type="checkbox"/>	<input type="checkbox"/>	/
Kitchen Backsplash	/	<input type="checkbox"/>	<input type="checkbox"/>	/
Complete Backsplash	/	<input type="checkbox"/>	<input type="checkbox"/>	/

#### Comment

NOTE: To supply and install all wall tiles on the 10" side horizontally STACKED in all bathrooms (where applicable).

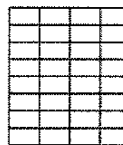

horizontal stacked

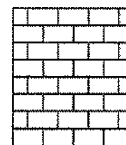

brick pattern

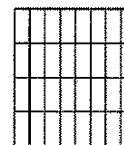

vertical stacked

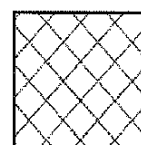

diagonal/diamond

### 5. Fireplace

#### Living Room

Purchased As Per Plan N/A

☐ ☐ ☐

#### Family Room

Purchased As Per Plan N/A

☐ ☐ ☐

#### Other Room - Specify Great Room

Purchased As Per Plan N/A

☐ ☒ ☐

Fireplace Type		Two Sided
Mantle Type		NF-08
Over Mantle		/
Colour / Stain		White
Surround		/
Hearth		/
Comment		



Initial: \_\_\_\_\_

Page 2 of 3

Purchasers: ZAMAN ALI & BIBI AALI

JUN 30 2021  
Property: 41 of Plan - Draft Approval SB17-03-08

Telephone Res. / Bus: /

Project: Kingsmen (Thames) Inc.

Decor Advisor: Barbara Coccia

Model and Elevation: Nottingham(5003)Elev B 4 BED-3+1 BATH

### 6. Trim Carpentry

Door Hardware

Interior Trim

Comment

#### Interior Doors

☐ 2 Panel Arch Top

☒ 2 Panel Square Top

☐ 6 Panel

Initial for Door Style



### 7. Railings and Pickets

Railing Package

Railing Colour

Picket Colour

Wood Stairs ☐ No ☒ Oak

Tread Colour

Comment

BC BC  
June 30/21

### 8. Plaster Mouldings and Medallions

Foyer

Kitchen/Breakfast

Main Hall

Den/Library

Living Room

Lower Landing

Dining Room

/

Family Room

Comment

### 9. Wall Paint

Kingsmen White

#### Smooth Ceilings

☐ First Floor

☐ First Floor incl. Second Floor Hall

☐ First and Second Floor

☒ Throughout

☐ Not Applicable

Trim Paint

### 10. Additional Comments

### 11. Disclaimers and Notes

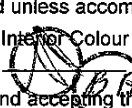
- Colours of all materials are as close as possible to builder's selection, but not necessarily identical due to variances in manufacturing.
- Any extras listed above are null and void unless accompanied by a separate invoice/amendment. Said invoice must be paid in full.
- The Purchaser acknowledges that after Interior Colour Selection form is signed and dated, no further changes will be permitted other than re-selection due to unavailability.  Purchaser's Initials
- The Purchaser acknowledges reading and accepting the "Kingsmen Group Décor Centre Disclaimers" form. This document contains other miscellaneous disclaimers.

This Interior Colour Selection is final and approved by:

Purchaser:

Signature: 

Date:

6/29/2021

Signature: 

Date:

6/29/2021

Vendor:



Kingsmen (Thames) Inc.

THAMES 4B: LOT 41  
RE: SKETCH #1

JUN 30 2021

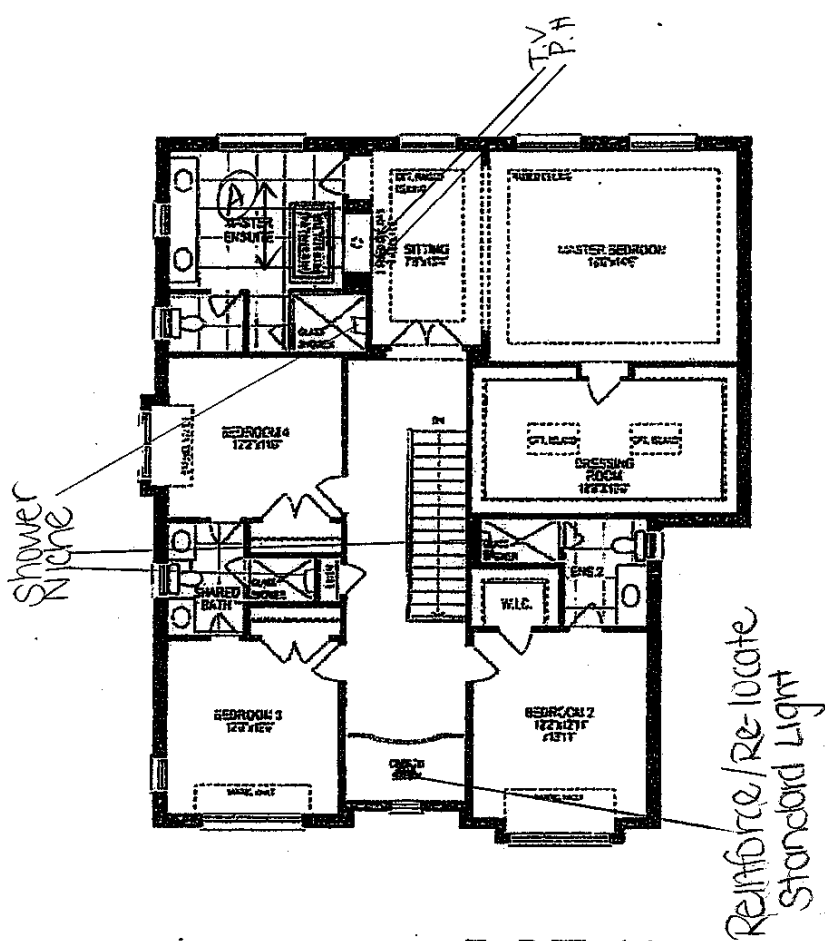

SECOND FLOOR PLAN 'B' - LOT 41  
**LOT 41**  
CORNER,  
Elev. B

Measurements, specifications, and floor plans are subject to change without notice.  
No warranty is made as to the accuracy of the information. All floor plans are approximate dimensions.  
Actual results may vary from the floor plan. See P. 4.2.3.  
Square footage includes 1/2" of wall space.

Schedule B

+ Bill De

THAMES 4B: LOT 41  
RE: SKETCH #2

JUN 30 2021

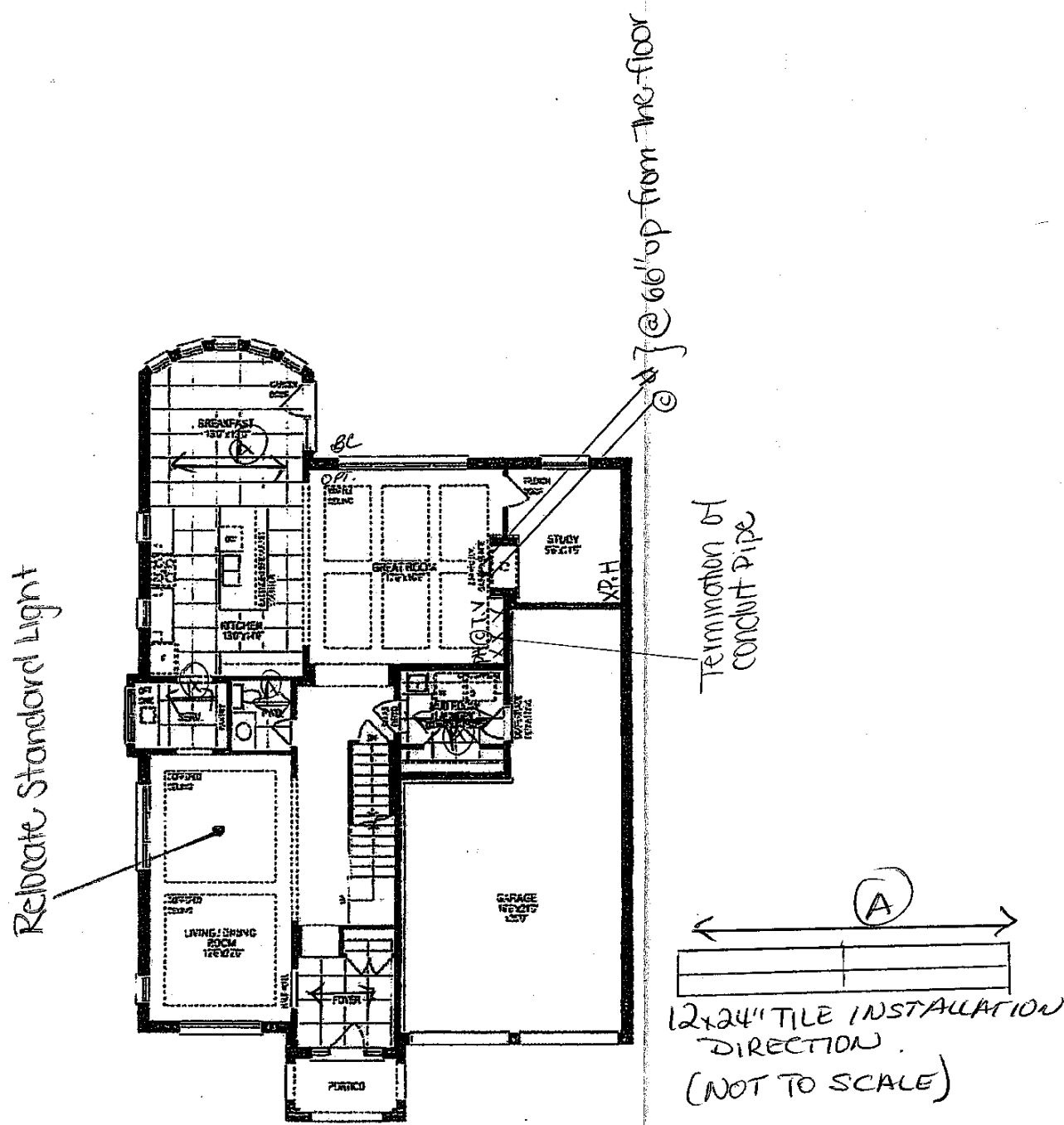

GROUND FLOOR PLAN "B" - LOT 41

*[Handwritten signature]* + *[Handwritten signature]*



THAMES 4B: LOT 41  
RE: SKETCH #3

JUN 30 2021

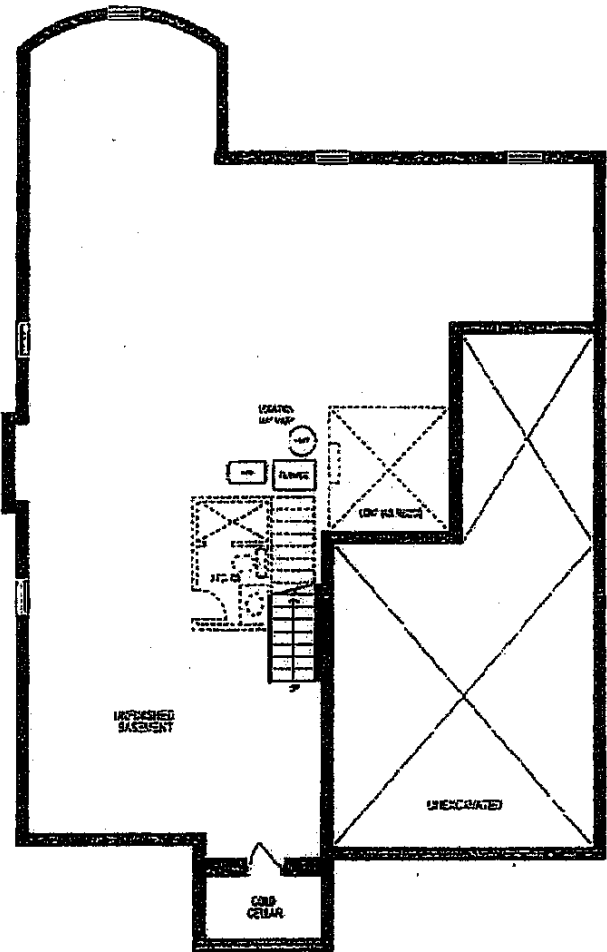

BASEMENT PLAN, 'B' - LOT 41

*[Handwritten signature]*  
+ *Bis* *Dr*

JUN 30 2021

THAMES 4B: LOT 41  
RE: UPG. SINKS (PWD, MASTER ENSUITE,  
BEDROOM #2 & SHARED BATHROOM)

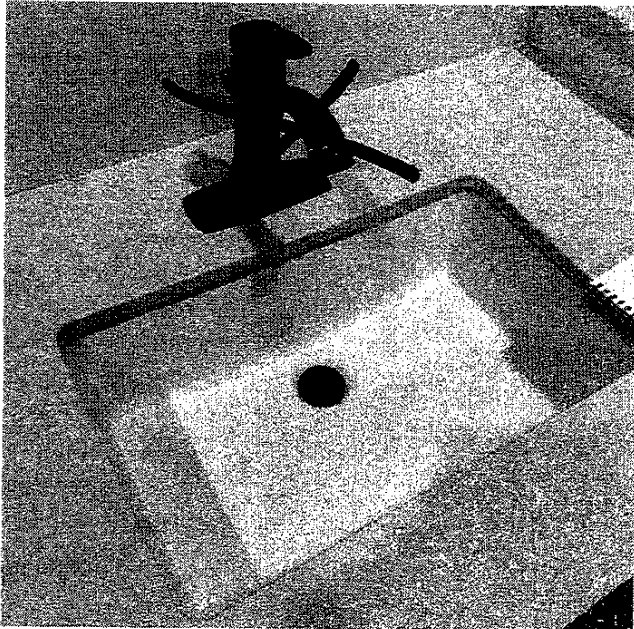

## DISPLAY ITEMS

### Sink ( Item 9)

Contrac Catena Undermount  
Model 4210CIY

+ 

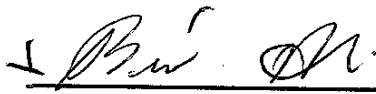
↓ 

JUN 30 2021 THAMES 4B: LOT 41  
RE: FRIDGE SPEC'S

\* No Waterline has been purchased\*

# RF27T5201SR

**SAMSUNG**

27 cu. ft. Large Capacity 3-Door French Door Refrigerator  
with External Water & Ice Dispenser

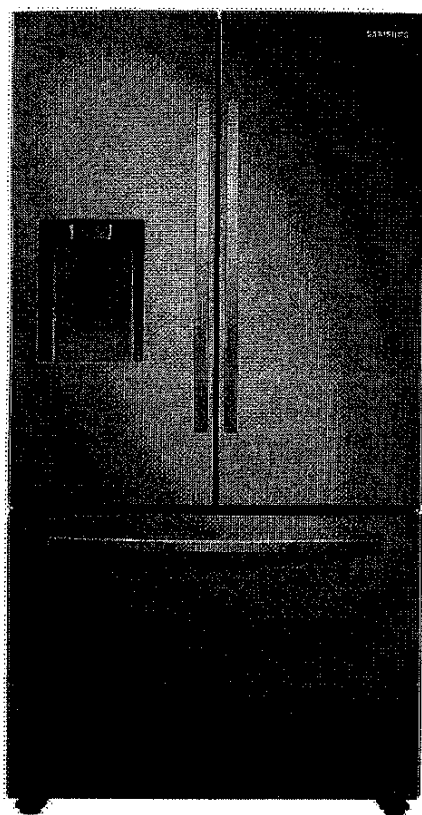

## Signature Features

### Large Capacity

A completely redesigned interior with 27 cu. ft. capacity that fits 10% more groceries.\*

\*When compared to Samsung 3-Door model RF263BEAE with 24.6 cu. ft. capacity

### Modern Design

Clean lines and modern form blend beautifully into your kitchen.

### Fingerprint Resistant Finish

A finish that withstands everyday smudges, so you spend less time cleaning.

## Available Colors



Fingerprint Resistant  
Stainless Steel (shown)



Fingerprint Resistant  
Black Stainless Steel



White

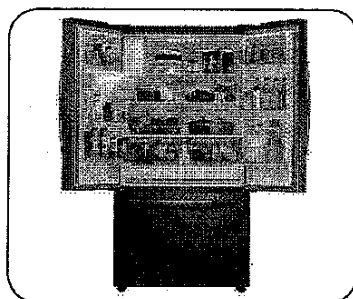

Large Capacity

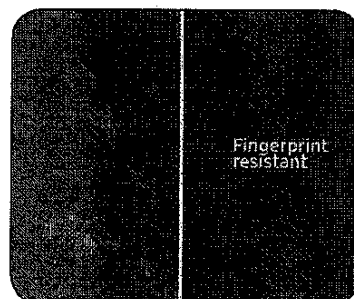

Fingerprint Resistant Finish

## Design

- Large Capacity of 27 cu. ft.
- Fingerprint Resistant Finish
- Minimal Display Dispenser: external filtered water and ice
- High Efficiency LED Lighting
- EZ-Open Handle™

## Convenience

- Full-width internal refrigerator drawer
- Adjustable Spill Proof Shelves
- Door Alarm
- Water Filter Indicator

## Performance

- All-Around Cooling
- Ice Max Ice Maker - Stores up to 4.2 lbs of ice
- Sabbath Mode

## Rating



ENERGY STAR® rated:  
705 kWh/yr



ADA Compliant

*[Handwritten signature]*  
*+ Bin AC*

*\*No water line has been purchased\**

# RF27T5201SR SAMSUNG

27 cu. ft. Large Capacity 3-Door French Door Refrigerator  
with External Water & Ice Dispenser

## Installation Specifications

1. Measure the height, width and depth of the opening, making sure to include baseboards, molding tile, countertop overhang, etc. Check to be sure there is enough room to open the door (consider walls, islands or other obstacles when measuring).
2. Refer to illustration below to determine dimensions.
3. Allow 2.5" of clearance on hinge side of refrigerator when installing next to a wall where handle may make contact.
4. Allow 1" minimum clearance at rear for proper air circulation and water/electrical connections. Allow a 3/8" minimum clearance at sides and top for ease of installation.
5. Ensure each door and entryway in the home is wide enough for the refrigerator to be moved through easily.

For optimal usage and to be able to open refrigerator doors completely, do not install next to a wall.

Please note: The following dimension and cutout information is for planning purposes only. For complete installation details, consult manual packed with product, or download manual online at [samsung.com](http://samsung.com).

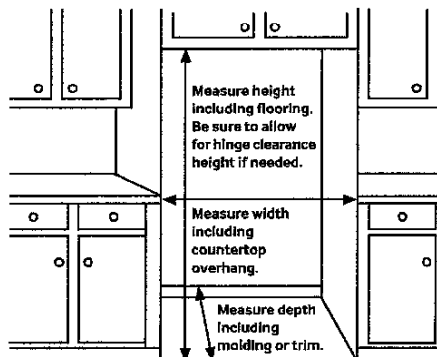

## Dimensions

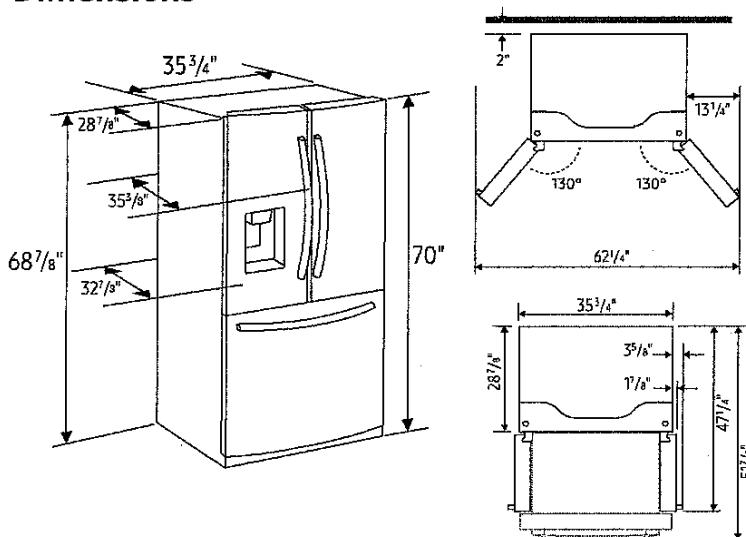

Total Capacity: 27.0 cu. ft.

Refrigerator: 18.4 cu. ft.

- External Filtered Water and Ice Dispenser
  - Crushed or Cubed Ice
- Full Width Drawer
- 4 Tempered Glass Spill-Proof Shelves
- 2 Humidity-Controlled Crispers
- 6 Door Bins
  - Right Door: 3 Gallon Bins
  - Left Door: 3 Regular Bins
- Adjustable Shelves for Tall Oversized Items
- High Efficiency LED Lighting

Freezer: 8.6 cu. ft.

- EZ-Open Handle™
- 1 Large Opaque Bin with 1 Divider
- Auto Pull-Out Upper Drawer
- High Efficiency LED Lighting

## Accessories

Water Filter: HAF-QIN

## Warranty

One (1) Year Parts and Labor on Refrigerator

Five (5) Years Parts and Labor on Sealed Refrigeration System Only\*

Ten (10) Years Parts and Five (5) Years Labor on Digital Inverter Compressor

\*Compressor, evaporator, condenser, drier and connecting tubing.

## Product Dimensions & Weight

Dimensions (WxHxD with hinges, handles and doors):

35 3/4" x 70" x 35 3/8"

Dimensions (WxHxD without hinges and door):

35 3/4" x 68 7/8" x 28 7/8"

Dimensions (WxHxD with hinge and door, no handle):

35 3/4" x 70" x 32 7/8"

Weight: 295 lbs

## Shipping Dimensions & Weight (WxHxD)

Dimensions: 37 3/4" x 75 5/16" x 35 15/16"

Weight: 305 lbs

Color	Model #	UPC Code
Fingerprint Resistant Stainless Steel	RF27T5201SR	887276408729
Fingerprint Resistant Black Stainless Steel	RF27T5201SG	887276408712
White	RF27T5201WW	887276408736

*[Handwritten signature]*

*[Handwritten signature]*

Gas range components

Overview

MODEL NX58\*565\*\*\*

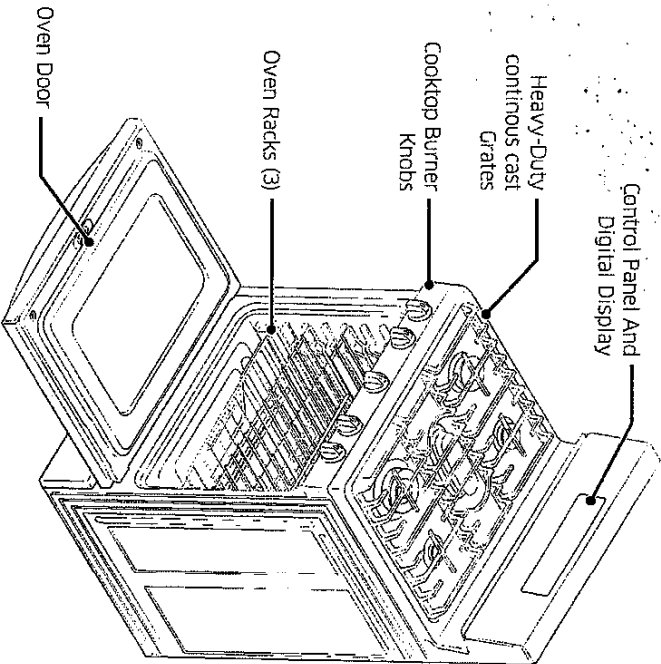

Cooktop Burner Placement

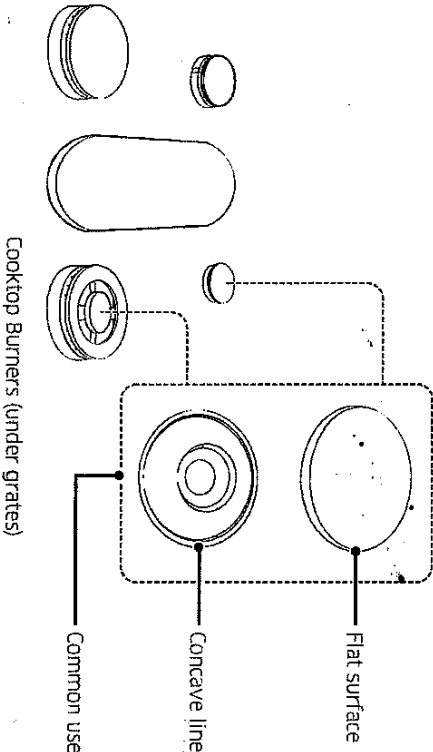

Burner Locations and Output Ratings

Location	Output Rating (Nominal BTU)
Left Front (LF)	15,000 BTU
Left Rear (LR)	9,500 BTU
Center (CEN)	9,500 BTU
Right Rear (RR)	5,000 BTU
Right Front (RF)	18,000 BTU
Warming Drawer (with Full Extension Roller Guide Rails)	

*[Handwritten signature]*  
*[Handwritten signature]*

Gas range components

MODEL NX58\*560\*\*\*

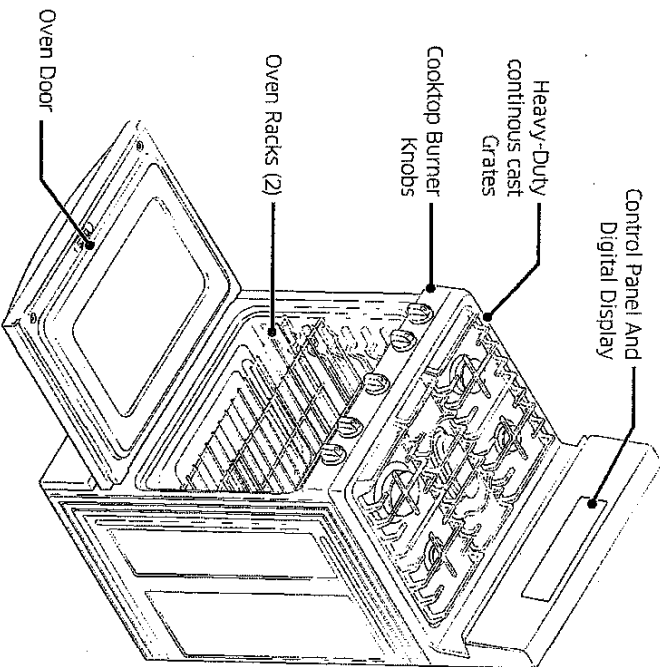

Cooktop Burner Placement

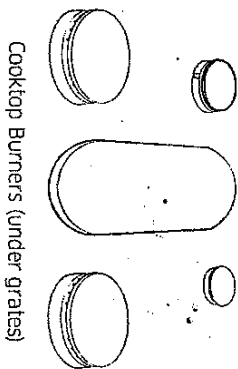

Burner Locations and Output Ratings

Location	Output Rating (Natural Gas)
Left-Rear (LR)	15,000 BTU
Left-Rear (ER)	9,500 BTU
Center (CR)	9,500 BTU
Right-Rear (RR)	5,000 BTU
Right-Front (RF)	17,000 BTU
Storage Drawer	

*[Handwritten signature]* + *Bis* *Dr*

Gas range components

Gas range specifications

MODEL NX58\*565\*\*\*

DESCRIPTION	Gas Free-Standing Range
OVERALL DIMENSIONS	29 15/16" (W) x 46 11/16" (H) x 28 5/16" (D) 761 mm (W) x 1,186.2 mm (H) x 718.7 mm (D)
NET WEIGHT	204 lb (92.4 Kg)
ELECTRICAL	Refer to the rating label.
GAS, NG (NATURAL GAS)	5-13 in WC
GAS, LP (LIQUID PROPANE)	10-13 in WC
SURFACE BURNERS (NG)	(LF)-15,000 BTU / (LR)-9,500 BTU / (CTR)-9,500 BTU / (RR)-5,000 BTU / (RF)-18,000 BTU
SURFACE BURNERS (LP)	(LF)-11,500 BTU / (LR)-7,500 BTU / (CTR)-7,500 BTU / (RR)-4,000 BTU / (RF)-14,500 BTU
OVEN BURNERS (NG)	Broil (Upper)-13,500 BTU / Bake (Lower)-18,000 BTU
OVEN BURNERS (LP)	Broil (Upper)-11,500 BTU / Bake (Lower)-15,000 BTU

MODEL NX58\*560\*\*\*

DESCRIPTION	Gas Free-Standing Range
OVERALL DIMENSIONS	29 15/16" (W) x 46 11/16" (H) x 28 5/16" (D) 761 mm (W) x 1,186.2 mm (H) x 718.7 mm (D)
NET WEIGHT	186 lb (84.5 Kg)
ELECTRICAL	Refer to the rating label.
GAS, NG (NATURAL GAS)	5-13 in WC
GAS, LP (LIQUID PROPANE)	10-13 in WC
SURFACE BURNERS (NG)	(LF)-15,000 BTU / (LR)-9,500 BTU / (CTR)-9,500 BTU / (RR)-5,000 BTU / (RF)-17,000 BTU
SURFACE BURNERS (LP)	(LF)-10,000 BTU / (LR)-7,500 BTU / (CTR)-7,500 BTU / (RR)-4,000 BTU / (RF)-12,500 BTU
OVEN BURNERS (NG)	Broil (Upper)-13,500 BTU / Bake (Lower)-18,000 BTU
OVEN BURNERS (LP)	Broil (Upper)-11,500 BTU / Bake (Lower)-15,000 BTU

Gas range components

JUN 30 2021

THAMES 4B: LOT 41  
RE: STOVE SPEC'S

Gas range components

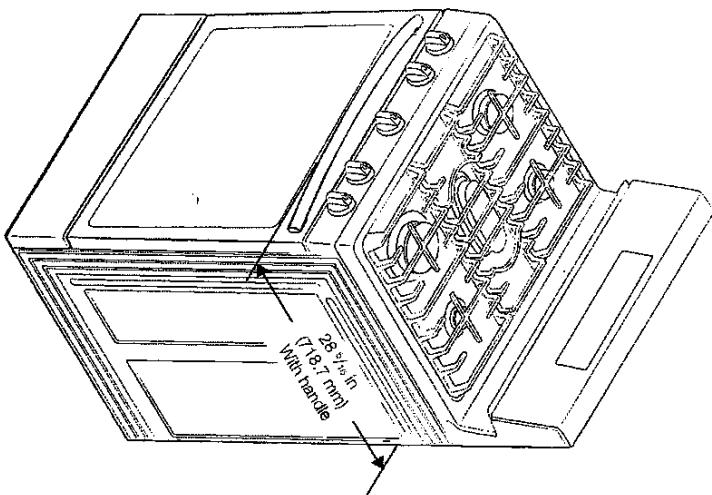
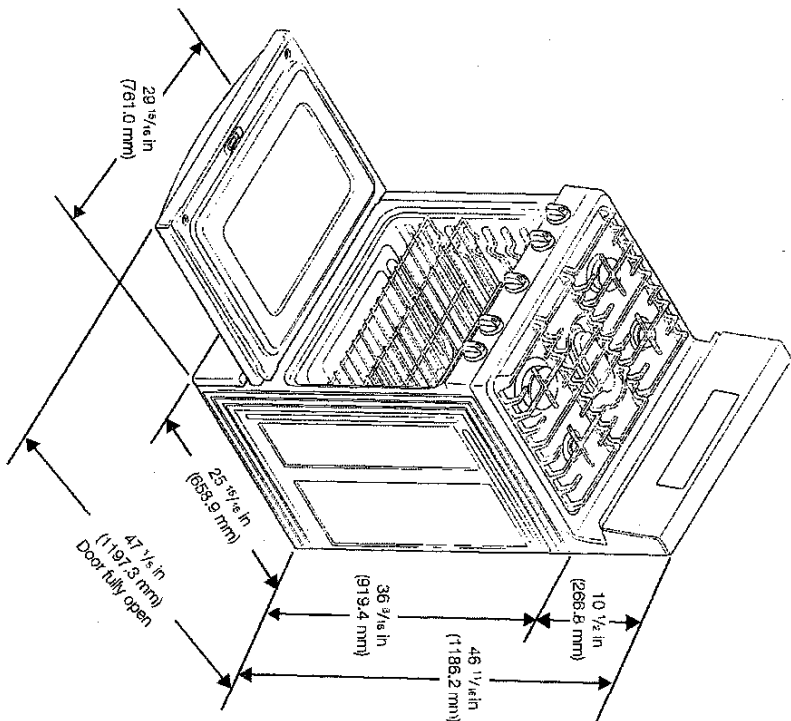

+  + Bill Dr.



JUN 30 2021

# Installation requirements

## Location requirements

### Clearances and dimensions

#### NOTE

For OTR over Gas Stove, please follow local GAS CODE.

**BEFORE YOU BEGIN** to install this appliance, refer to the following information, dimensions, and clearances. **Do not locate the range where it may be subject to strong drafts.** Provide adequate clearances between the range and adjacent combustible surfaces. These dimensions must be met for safe use of the range. The location of the electrical outlet and gas piping may be adjusted to meet the following dimensions and clearances.

**For installation in Canada, a free-standing range is not to be installed closer than 4.7" (12 cm) from any adjacent surface.**

#### CAUTION

This range has been designed to comply with the maximum allowable wood cabinet temperature of 194 °F (90 °C). Make sure the wall covering, countertops, and cabinets around the range can withstand the heat (up to 194 °F [90 °C]) generated by the range. If not, discoloration, delamination, or melting may occur.

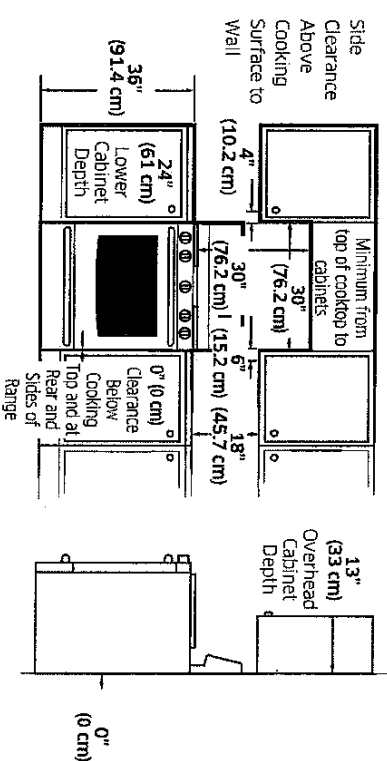

## Minimum dimensions

#### WARNING

If overhead cabinets are provided, a range hood should also be provided that projects horizontally a minimum of 5" (12.7 cm) beyond the front of the cabinets. This will dissipate any heat buildup in the overhead cabinets to prevent death, personal injury, and/or fire hazard. The ventilating hood must be constructed of sheet metal not less than 0.0122" thick. Install above the cooktop with a clearance of not less than 1/4" between the hood and the underside of the combustible material or metal cabinet. The hood must be at least as wide as the appliance and centered over the appliance. Clearance between the cooking surface and the ventilation hood surface must never be less than 24".

**Exception:** Installation of a listed microwave oven or cooking appliance over the cooktop shall conform to the installations packed with that appliance.

- 30" (101.6 cm) minimum clearance between the top of the cooking surface and the bottom of an unprotected wood or metal cabinet; or if no 30" (101.6 cm) minimum clearance, 24" (61 cm) minimum when the bottom of the wood or metal cabinet is protected by not less than 0.25" (0.64 cm) flame-retardant millboard covered with not less than no. 28 MSG sheet steel, 0.015" (0.038 cm) stainless steel, 0.024" (0.061 cm) aluminum, or 0.020" (0.051 cm) copper.
- 18" (45.7 cm) minimum between the countertop and the adjacent cabinet bottom.

Installation requirements

JUN 30 2021

# Installation requirements

Recommended locations for gas piping and electrical outlets  
(For models NX58\*565\*\*/NX58\*560\*\*)

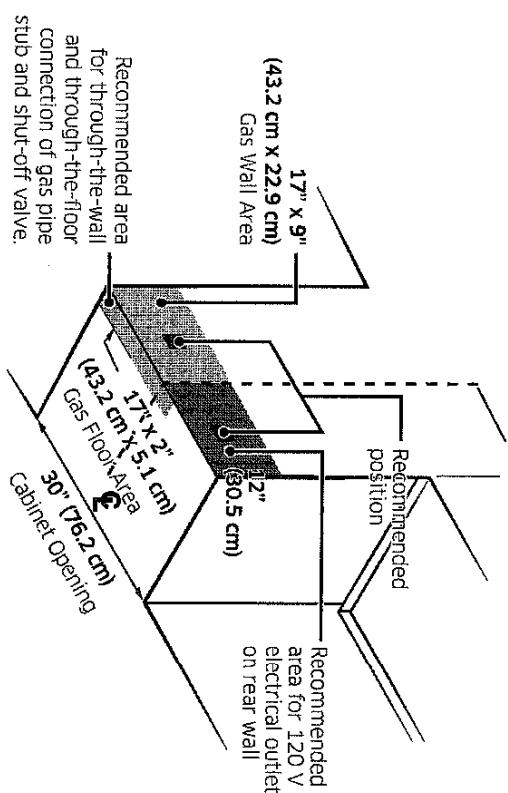

## Gas requirements

### Provide adequate gas supply

This range is designed to operate at a pressure of 5" (13 cm) of water column on natural gas or 10" (25 cm) of water column on LP gas (propane or butane).

Make sure you are supplying your range with the type of gas for which it is designed. **Do not attempt to convert the appliance from the gas specified in this manual to a different gas without consulting the gas supplier.**

This range is convertible for use on natural or propane gas. If you decide to use this range on LP gas, conversion must be made by a qualified LP installer before attempting to operate the range.

For proper operation, the pressure of natural gas supplied to the regulator must be between 5" and 13" (13 cm and 33 cm) of water column.

For LP gas, the pressure supplied must be between 10" and 13" (25 cm and 33 cm) of water column.

When checking for proper operation of the regulator, the inlet pressure must be at least 1" (2.5 cm) greater than the operating (manifold) pressure as given.

The pressure regulator located at the inlet of the range manifold must remain in the supply line regardless of whether natural or LP gas is being used.

A flexible-metal appliance connector used to connect the range to the gas supply line should have an I.D. of 0.5" (1.3 cm) and be 5 ft (152 cm) in length for ease of installation. In Canada, flexible connectors must be single-wall metal connectors no longer than 6 ft (183 cm) in length.

**Do not kink or damage the flexible metal tubing when moving the range.**

*[Handwritten signature]*

*[Handwritten signature]*