

Kingsmen (Thames) Inc. / Havelock Corners (Kingsmen)

Lot/Unit: 50    Phase/Building: 4B    Model/Floor Plan: Spencer (4204) Elev B 4 Bed - 4+1 Bath

CABINETRY APPLIANCE - FRIDGE

Inv.5045	1 - To supply & install the 66CM DEEP FRIDGE ENCLOSURE - COUNTER DEPTH WITH - 1 WALL - 1 66CM DEEP GABLE AND 1 66CM DEEP CABINET - THIS IS NOT A ZERO CLEARANCE ENCLOSURE. STANDARD HEIGHTS AND WIDTHS WILL BE USED. - CLASSIC SERIES in the kitchen....	
Line 65498	Note: ... see sketch # 1	
23Jun21 / 24Jun21		

COUNTER TOP

Inv.5045	1 - As per schedule "PE": Vendor to include level 1, 2cm. granite or quartz in all bathrooms, as per plan, in lieu of the included laminate counter tops. Selections to be made from builders standard samples.	
Line 65482	Note:	
23Jun21 / 24Jun21		

DOORS AND WINDOWS

Inv.5045	1 - To supply and install the optional side door.. see sketch #1	
Line 65488	Note:	
23Jun21 / 24Jun21		

ELECTRICAL

Inv.5045	1 - To supply and install the standard Phone (CAT 5) rough-in, in the Great Room, Master Bedroom and Media Niche.. see sketch #1 and #2	
Line 65489	Note:	
23Jun21 / 24Jun21		
Inv.5045	1 - To supply and install the standard T.V Rough-in, in the Great Room and Master Bedroom.. see sketch #1 and #2	
Line 65490	Note:	
23Jun21 / 24Jun21		
Inv.5045	1 - To SUPPLY AND INSTALL AN ADDITIONAL BASIC RECEPTACLE (NOT DEDICATED) centered +- over the F/P Mantle in the Great Room at approx. +- 66" up from the floor.. see sketch #1	
Line 65491	Note: THIS IS FOR FUTURE WALL MOUNT T.V	
23Jun21 / 24Jun21                      NO CONDUIT PIPE HAS BEEN PURCHASED.		
Inv.5045	1 - To relocate the standard light from the 2nd floor landing to the open to below area.. see sketch #2	
Line 65494	Note:	
23Jun21 / 24Jun21		

HARDWOOD

Inv.5045	1 - As per schedule "PE": Vendor to include engineered hardwood throughout the 2nd floor in lieu of inlcuded carpet, as per plan, and selections as outlined in scheduel A. This has no cash value.	
Line 65484	Note:	
23Jun21 / 24Jun21		

HEATING AND AIR CONDITIONING

Kingsmen (Thames) Inc. / Havelock Corners (Kingsmen)

Lot/Unit: 50    Phase/Building: 4B    Model/Floor Plan: Spencer (4204) Elev B 4 Bed - 4+1 Bath

Inv. <b>5045</b>  Line <b>65479</b>  23Jun21 / 24Jun21	<b>1</b> - As per schedule "PE": Vendor to install capped gas line ( rough in only ) at rear of home for future BBQ location. Location to be finalized at vendors sole discretion.  Note:  	
Inv. <b>5045</b>  Line <b>65480</b>  23Jun21 / 24Jun21	<b>1</b> - As per schedule "PE": Vendor to install gas line ( rough in only ) to kitchen in at stove location ( as per plan ) to include 110V code requirement.  Note:  	
Inv. <b>5045</b>  Line <b>65481</b>  23Jun21 / 24Jun21	<b>1</b> - As per schedule "PE": Vendor to supply & install air conditioning unit, siezed accordingly, from vendors standard samples.  Note:  	

MISCELLANEOUS

PAINT AND DRYWALL

Inv. <b>5045</b>  Line <b>65485</b>  23Jun21 / 24Jun21	<b>1</b> - To supply and install the standard Coffered Ceiling in the Dining Room, as per plan.. see sketch #1  Note:  	
--	---	--

PLUMBING

Inv. <b>5045</b>  Line <b>65486</b>  23Jun21 / 24Jun21	<b>1</b> - To supply and install the upgraded Mirolin Brooke Free-standing tub in the Master Ensuite in lieu of the standard free standing tub.. see spec's  Note: STILL TO INSTALL THE STANDARD FAUCETS.  	
Inv. <b>5045</b>  Line <b>65497</b>  23Jun21 / 24Jun21	<b>6</b> - To supply and install VANITY SINK - CONTRAC CATENA UNDERMOUNT - MODEL 4210CIY in the Powder Room, Master Ensuite, Bedroom #2, #3 and #4 bathroom in lieu of the standard sinks.... see spec's  Note: STILL TO INSTALL THE STANDARD FAUCETS  	



CONSTRUCTION SUMMARY

Kingsmen (Thames) Inc. / Havelock Corners (Kingsmen)

Lot/Unit: 50    Phase/Building: 4B    Model/Floor Plan: Spencer (4204) Elev B 4 Bed - 4+1 Bath

EXTRAS AS PER OFFER

VENDOR TO INSTALL CAPPED GAS LINE (ROUGH-IN ONLY) AT REAR OF HOME FOR FUTURE BBQ LOCATION. LOCATION TO BE FINALIZED AT VENDORS SOLE DISCRETION. <i>Worksheet</i> Note:	
VENDOR TO INSTALL GAS LINE (ROUGH-IN ONLY) TO KITCHEN IN AT STOVE LOCATION (AS PER PLAN) TO INCLUDE 110V CODE REQUIREMENT. <i>Worksheet</i> Note:	
VENDOR TO SUPPLY & INSTALL AIR CONDITIONING UNIT, SIZED ACCORDINGLY, FROM VENDORS STANDARD SAMPLES. <i>Worksheet</i> Note:	
VENDOR TO INCLUDE LEVEL 1, 20CM GRANITE OR QUARTZ IN ALL BATHROOMS, AS PER PLAN, IN LIEU OF THE INCLUDED LAMINATE COUNTER TOPS. SELECTIONS TO BE MADE FROM BUILDERS STANDARD SAMPLES. <i>Worksheet</i> Note:	
VENDOR TO INCLUDE ENGINEERED HARDWOOD THROUGHOUT THE 2ND FLORR IN LIEU OF INCLUDED CARPET, AS PER PLAN, AND SELECTIONS AS OUTLINED IN SCHEDULE A. THIS HAS NO CASH VALUE. <i>Worksheet</i> Note:	

Purchasers: RAJAN AGGARWAL & SUMAN PRABIRKUMAR Property: 50 of Plan - Draft Approval SB17-03-08  
Telephone Res. / Bus: / Project: Kingsmen (Thames) Inc.  
Decor Advisor: Barbara Coccia Model and Elevation: Spencer (4204) Elev B 4 Bed - 4+1 Bath

Layout Changes: ☒ Yes ☐ No Sketch Attached: ☐ Yes ☒ No Exterior Colour Scheme:

**1. Cabinetry**

	Style and Colour	Counter Top	Hardware
Kitchen / Breakfast	#3 Simcoe Moonlight	#1 C/S #9141 Ice Snow 3cm	12881 Handle
Kitchen Island	#3 Simcoe Moonlight	#1 C/S #9141 Ice Snow 3cm	12881 Handle
Laundry Room	/	/	/
Powder Room	#3 Simcoe Moonlight	#1 C/S #9141 Ice Snow 2cm	12881 Handle
Main Bathroom	/	/	/
Master Ensuite Bathroom	#3 Simcoe Orchid	#1 C/S #3040 Cement 2cm	135 Knob
Second Ensuite Bathroom (If Applicable)	#3 Simcoe Orchid	#1 C/S #3040 Cement 2cm	135 Knob
Bedroom #3 Bathroom	#3 Simcoe Orchid	#1 C/S #3040 Cement 2cm	135 Knob
Bedroom #4 Bathroom	#3 Simcoe Orchid	#1 C/S #3040 Cement 2cm	135 Knob

Appliances Custom Size Fridge ☐ Yes ☒ No Valance Lighting ☐ Yes ☒ No Microwave / Range Hood ☐ Yes ☒ No

Cooktop / Rangetop ☐ Yes ☒ No Built in Wall Oven ☐ Yes ☒ No Slide-in Range ☐ Yes ☒ No

Comment

**2. Flooring**

	Selection
Foyer	13x13' Malena Ice
Main Hall	3 1/2" Elements Oak Sturgeon
Back Hall	/
Breakfast	13x13" Malena Ice
Laundry Room	13x13" Malena Ice
Kitchen	13x13" Malena Ice
Powder Room	13x13" Malena Ice
Main Bathroom	(Bedroom #2 Bathroom)- 13x13" Cinq Grey SH/FL:2x2: Soho White Matte
Master Ensuite	13x13" Cinq Black SH/FL:2x2: Soho White Matte
Bathroom (If Applicable)	(Bedroom #3 Bathroom)- 13x13" Cinq Black
Mud Room	13x13" Malena Ice
Bedroom #4 Bathroom	13x13" Cinq Grey
Living Room	/
Dining Room	3 1/2" Elements Oak Sturgeon
Family / Great Room	3 1/2" Elements Oak Sturgeon
Den / Library / Study	/
Basement Landing (If Applies)	/
Lower Landing (If Applicable)	3 1/2" Elements Oak Sturgeon
Upper Landing	3 1/2" Elements Oak Sturgeon
Upper Hall	3 1/2" Elements Oak Sturgeon ( including media niche)
Master Bedroom	3 1/2" Elements Oak Sturgeon
Bedroom #2	3 1/2" Elements Oak Sturgeon
Bedroom #3	3 1/2" Elements Oak Sturgeon
Bedroom #4	3 1/2" Elements Oak Sturgeon
Bedroom #5	/
Shower Jambs	Master Ensuite and Bedroom #2: Anatolia Marmiline SNOW

SEE ATTACHED FOR SIGNATURES

Initial:

JUN 30 2021

4B-50

**Purchasers:** RAJAN AGGARWAL & SUMAN PRABIRKUMAR **Property:** 50 of Plan - Draft Approval SB17-03-08  
**Telephone Res. / Bus:** / **Project:** Kingsmen (Thames) Inc.  
**Decor Advisor:** Barbara Coccia **Model and Elevation:** Spencer (4204) Elev B 4 Bed - 4+1 Bath

### 2. Flooring - Continued -

Upgrade Underpad	Type	Area
	/	/
Carpet on Stairs	Capped	Runner - *Upgrade
Comment	/	/

### 3. Plumbing Fixtures / Faucets

Kitchen	Standard	Second Ensuite	Standard	Powder Room	Standard
Master Ensuite	Standard			Other Room	/
Main Bathroom	/	Bedroom #3 and #4	Standard		

#### Comment

NOTE: Still to install the standard undermount kitchen sink, with the standard faucet. To supply and install the upgraded undermount sink in all bathrooms... still to install the standard faucets.

### 4. Wall Tile

	Tile Selection	Listello	Insert	Insert Selection
Main Bathroom	/	<input type="checkbox"/>	<input type="checkbox"/>	/
Master Ensuite				
Tub Deck	/	<input type="checkbox"/>	<input type="checkbox"/>	/
Tub Apron	/	<input type="checkbox"/>	<input type="checkbox"/>	/
Tub Surround	/	<input type="checkbox"/>	<input type="checkbox"/>	/
Shower Stall	8x10" Cinq Black	<input type="checkbox"/>	<input type="checkbox"/>	/
Second Ensuite	8x10" Cinq Grey	<input type="checkbox"/>	<input type="checkbox"/>	/
Bedroom #3 Bathroom	8x10" Cinq Grey	<input type="checkbox"/>	<input type="checkbox"/>	/
Bedroom #4 Bathroom	8x10" Cinq Black	<input type="checkbox"/>	<input type="checkbox"/>	/
Kitchen Backsplash	/	<input type="checkbox"/>	<input type="checkbox"/>	/
Complete Backsplash	/	<input type="checkbox"/>	<input type="checkbox"/>	/

#### Comment

NOTE: To supply and install all wall tiles in all bathrooms (where applicable) on the 10" side horizontally stacked.

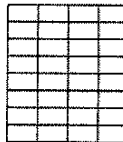

horizontal stacked

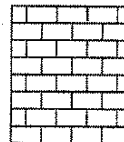

brick pattern

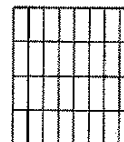

vertical stacked

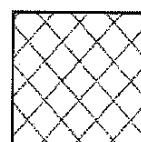

diagonal/diamond

### 5. Fireplace

	Living Room			Family Room			Other Room - Specify			Great Room
	Purchased	As Per Plan	N/A	Purchased	As Per Plan	N/A	Purchased	As Per Plan	N/A	
Fireplace Type	<input type="radio"/>	<input type="radio"/>	<input type="radio"/>	<input type="radio"/>	<input type="radio"/>	<input type="radio"/>	<input type="radio"/>	<input checked="" type="radio"/>	<input type="radio"/>	

Mantle Type			Front Facing
Over Mantle			NF-08
Colour / Stain			White
Surround			/
Hearth			/
Comment			

SEE ATTACHED FOR SIGNATURES

Initial: \_\_\_\_\_

Page 2 of 3

JUN 30 2021

4B-50

Purchasers: RAJAN AGGARWAL & SUMAN PRABIRKUMAR Property: 50 of Plan - Draft Approval SB17-03-08  
Telephone Res. / Bus: / Project: Kingsmen (Thames) Inc.  
Decor Advisor: Barbara Coccia Model and Elevation: Spencer (4204) Elev B 4 Bed - 4+1 Bath

## 6. Trim Carpentry

Door Hardware Interior Trim 

Comment

## Interior Doors

☐ 2 Panel Arch Top☒ 2 Panel Square Top☐ 6 Panel

Initial for Door Style



## 7. Railings and Pickets

Railing Package Railing Colour Picket Colour Wood Stairs ☐ No ☒ OakTread Colour 

Comment

SEE ATTACHED FOR SIGNATURES

## 8. Plaster Mouldings and Medallions

Foyer

Main Hall

Living Room

Dining Room

Family Room

Kitchen/Breakfast

Den/Library

Lower Landing

Comment

## 9. Wall Paint

## Smooth Ceilings

☐ First Floor☐ First Floor incl. Second Floor Hall☐ First and Second Floor☒ Throughout☐ Not ApplicableTrim Paint 

## 10. Additional Comments

## 11. Disclaimers and Notes

- Colours of all materials are as close as possible to builder's selection, but not necessarily identical due to variances in manufacturing.
- Any extras listed above are null and void unless accompanied by a separate invoice/amendment. Said invoice must be paid in full.
- The Purchaser acknowledges that after Interior Colour Selection form is signed and dated, no further changes will be permitted other than re-selection due to unavailability. Purchaser's Initials: 
- The Purchaser acknowledges reading and accepting the "Kingsmen Group Decor Centre Disclaimers" form. This document contains other miscellaneous disclaimers.

This Interior Colour Selection is final and approved by:

Purchaser:

Signature:  Date: Signature:  Date: 

Vendor:

Kingsmen (Thames) Inc.

# SCHEDULE "B-1"

## Floor Plan

4B-50  
 Lot 50  
 Phase 4B  
 Model: Spencer (4204) Elev B 4 Bed - 4+1 Bath  
 Standard

JUN 30 2021

SKETCH #1

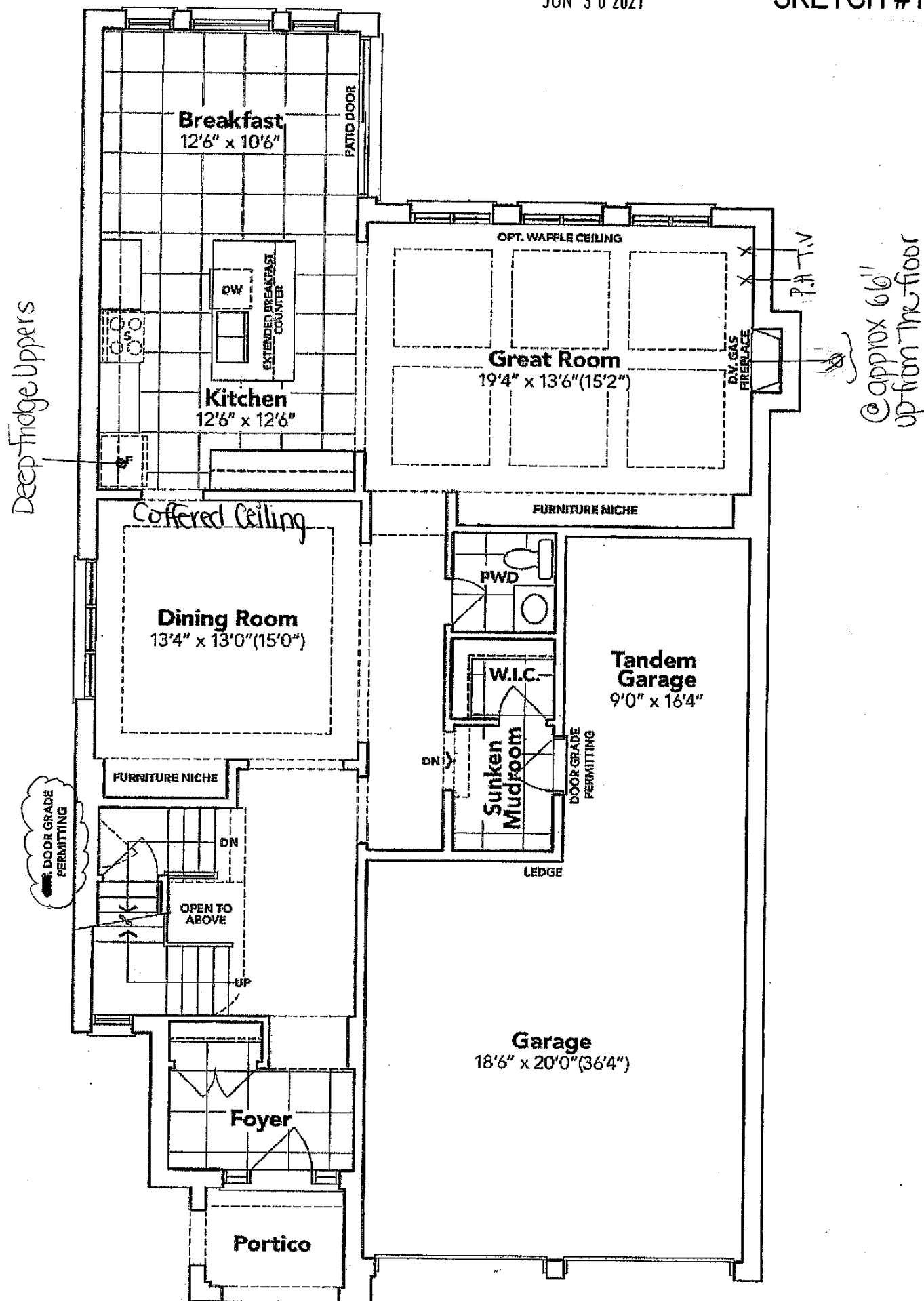

### GROUND FLOOR EL. B

The floor plans and elevations shown are pre-construction plans and may be revised or improved as necessitated by architectural controls and the construction process. The measurements adhere to the rules and regulations of the TARION Warranty Corporation's official method for the calculation of floor area. Materials, specifications and floor plans are subject to change without notice. All house renderings are artist's concept only. Actual usable floor space may vary from the stated floor area. All options shown are upgrades. E. & O. E.

SEE ATTACHED FOR SIGNATURES

SEE ATTACHED FOR SIGNATURES

SCHEDULE "B-1" - Page 3 of 3

inMS\_1014 Opt 22 Sep 18

Initials:

Initials: (Signature)

## SKETCH #2



SCHEDULE "B-1"  
Floor Plan

JUN 30 2021  
Lot 50  
Phase 4B  
Model: Spencer (4204) Elev B 4 Bed - 4+1 Bath  
Standard

4B-50

SKETCH #3

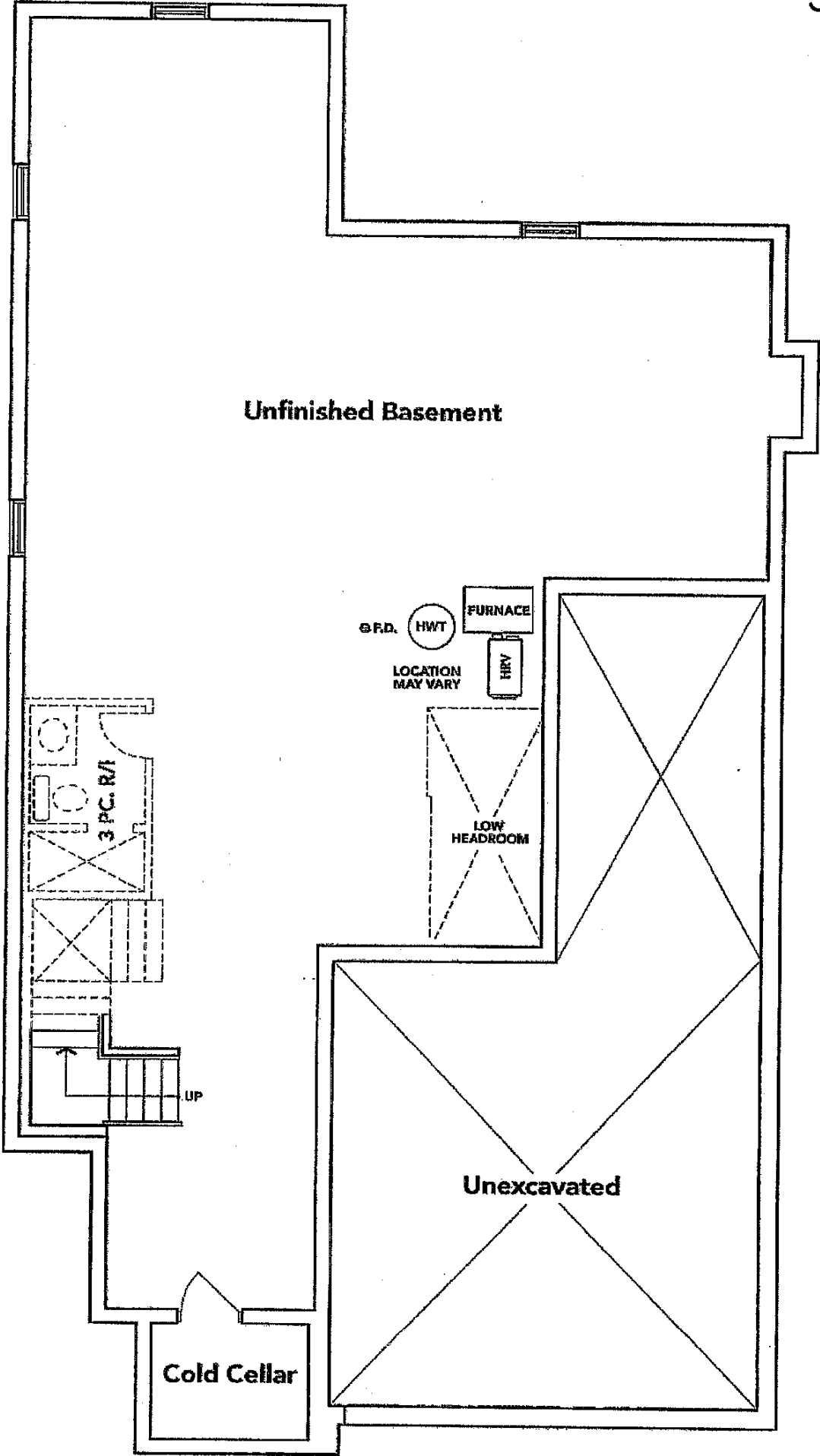

BASEMENT EL. B

The floor plans and elevations shown are pre-construction plans and may be revised or improved as necessitated by architectural controls and the construction process. The measurements adhere to the rules and regulations of the TARION Warranty Corporation's official method for the calculation of floor area. Materials, specifications and floor plans are subject to change without notice. All house renderings are artist's concept only. Actual usable floor space may vary from the stated floor area. All options shown are upgrades. J. & O. E.

SEE ATTACHED FOR SIGNATURES

SCHEDULE "B-1" - Page 1 of 3

SEE ATTACHED FOR SIGNATURES

Initials:

RB

4B-50



Brooke™ | 1

**Brooke™**

Categories: Acrylic Freestanding

**DESCRIPTION**

68" Freestanding Bath  
SKU #: CF2002

**FEATURES**

- Installation friendly two piece design
- Accepts deck mounted faucet
- Includes a chrome integral pop up drain and rectangular overflow
- ~~• Brushed nickel drain and overflow covers available~~
- Centre drain
- Includes levelling feet
- Available in White Only

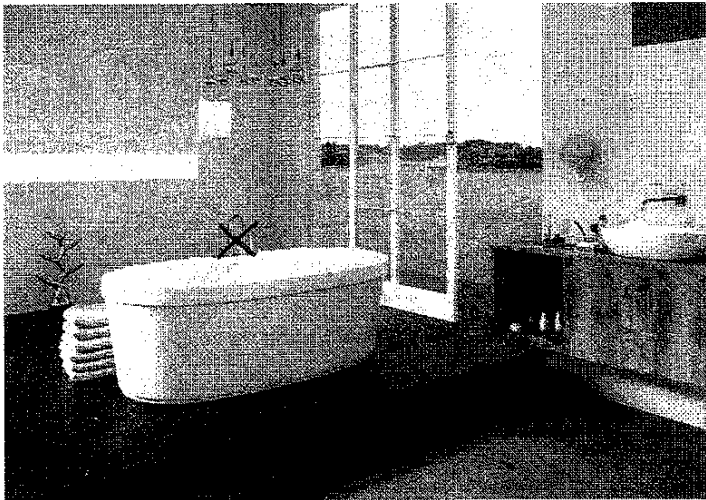

**DIMENSIONS**

68" x 36" x 23"

+

*Raymond*

---

➔ SEE ATTACHED FOR SIGNATURES

---

➔ SEE ATTACHED FOR SIGNATURES

---

THAMES 4B: LOT 50  
RE: UPG SINKS (PWD, MASTER ENSUITE,  
BEDROOM #2, #3 & #4 BATHROOM)

4B-50

**KINGSIIEN**  
GROUP INC.

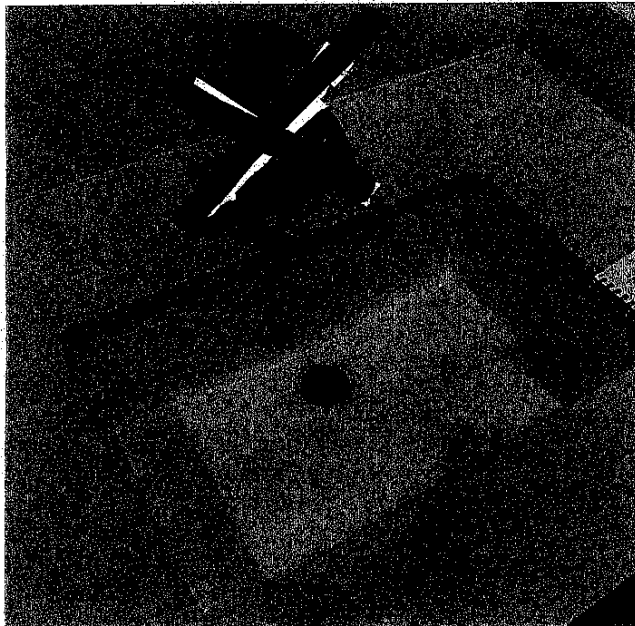

## Main Floor Vanity Display



### DISPLAY ITEMS

#### Sink ( Item 9)

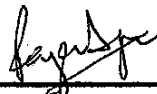
Contrac Catena Undermount  
Model 4210CIY

+   
+  SEE ATTACHED FOR SIGNATURES  
+  SEE ATTACHED FOR SIGNATURES  
+