



CONSTRUCTION SUMMARY

Kingsmen (Thames) Inc. / Havelock Corners (Kingsmen)

Lot/Unit: 93 Phase/Building: 4B Model/Floor Plan: Spencer (4204) Elev C 4 Bed - 4+1 Bath

COUNTER TOP

Inv.5064	1 - As per schedule "PE": Vendor to include level 1, 2cm. granite or quartz in the master ensuite only, as per plan, in lieu of the included laminate counter tops. Selections to be made from builders standard samples. This has no cash value.	
Line 65953	Note:	
20Jul21 / 20Jul21		

DOORS AND WINDOWS

Inv.5064	1 - To supply & install the optional side door to house if grade permits... see sketch # 1	
Line 65955	Note:	
20Jul21 / 20Jul21		

HARDWOOD

Inv.5064	1 - As per schedule "PE": Vendor to include engineered hardwood flooring throughout the second floor hallway in lieu of included carpet, as per plan, and selections as outlined in schedule A for included engineered hardwood on the main floor.	
Line 65954	Note: This has no cash value.	
20Jul21 / 20Jul21		

HEATING AND AIR CONDITIONING

Inv.5064	1 - As per schedule "PE": Vendor to install capped gas line (rough in only) at rear of home for future BBQ location. Location to be finalized at vendors sole discretion.	
Line 65950	Note:	
20Jul21 / 20Jul21		
Inv.5064	1 - As per schedule "PE": Vendor to install gas line (rough in only) to kitchen in at stove location (as per plan) to include 110V code requirement.	
Line 65951	Note:	
20Jul21 / 20Jul21		
Inv.5064	1 - As per schedule "PE": Vendor to supply & install air conditioning unit, sized accordingly, from vendors standard samples.	
Line 65952	Note:	
20Jul21 / 20Jul21		



CONSTRUCTION SUMMARY

Kingsmen (Thames) Inc. / Havelock Corners (Kingsmen)

Lot/Unit: 93 Phase/Building: 4B Model/Floor Plan: Spencer (4204) Elev C 4 Bed - 4+1 Bath

EXTRAS AS PER OFFER

VENDOR TO INSTALL CAPPED GAS LINE (ROUGH-IN ONLY) AT REAR OF HOME FOR FUTURE BBQ LOCATION. LOCATION TO BE FINALIZED AT VENDORS SOLE DISCRETION. <i>Worksheet</i> Note:	
VENDOR TO INSTALL GAS LINE (ROUGH-IN ONLY) TO KITCHEN IN AT STOVE LOCATION (AS PER PLAN) TO INCLUDE 110V CODE REQUIREMENT. <i>Worksheet</i> Note:	
VENDOR TO SUPPLY & INSTALL AIR CONDITIONING UNIT, SIZED ACCORDINGLY, FROM VENDORS STANDARD SAMPLES. <i>Worksheet</i> Note:	
VENDOR TO INCLUDE LEVEL 1, 2CM GRANITE OR QUARTZ IN THE MASTER ENSUITE ONLY, AS PER PLAN, IN LIEU OF THE INCLUDED LAMINATE COUNTER TOPS. SELECTIONS TO BE MADE FROM BUILDERS STANDARD SAMPLES. THIS HAS NO CASH VALUE <i>Worksheet</i> Note:	
VENDOR TO INCLUDE ENGINEERED HARDWOOD FLOORING THROUGHOUT THE SECOND FLOOR HALLWAY IN LIEU OF INCLUDED CARPET, AS PER PLAN, AND SELECTIONS AS OUTLINED IN SCHEDULE A FOR INCLUDED ENGINEERED HARDWOOD ON THE MAIN FLOOR. THIS HAS NO CASH VALUE. <i>Worksheet</i> Note:	

SCHEDULE "B-1" Floor Plan

Lot 93
Phase 4B
Model: Spencer (4204) Elev C 4 Bed - 4+1 Bath
Standard

JUL 21 2021

Sketch #1.

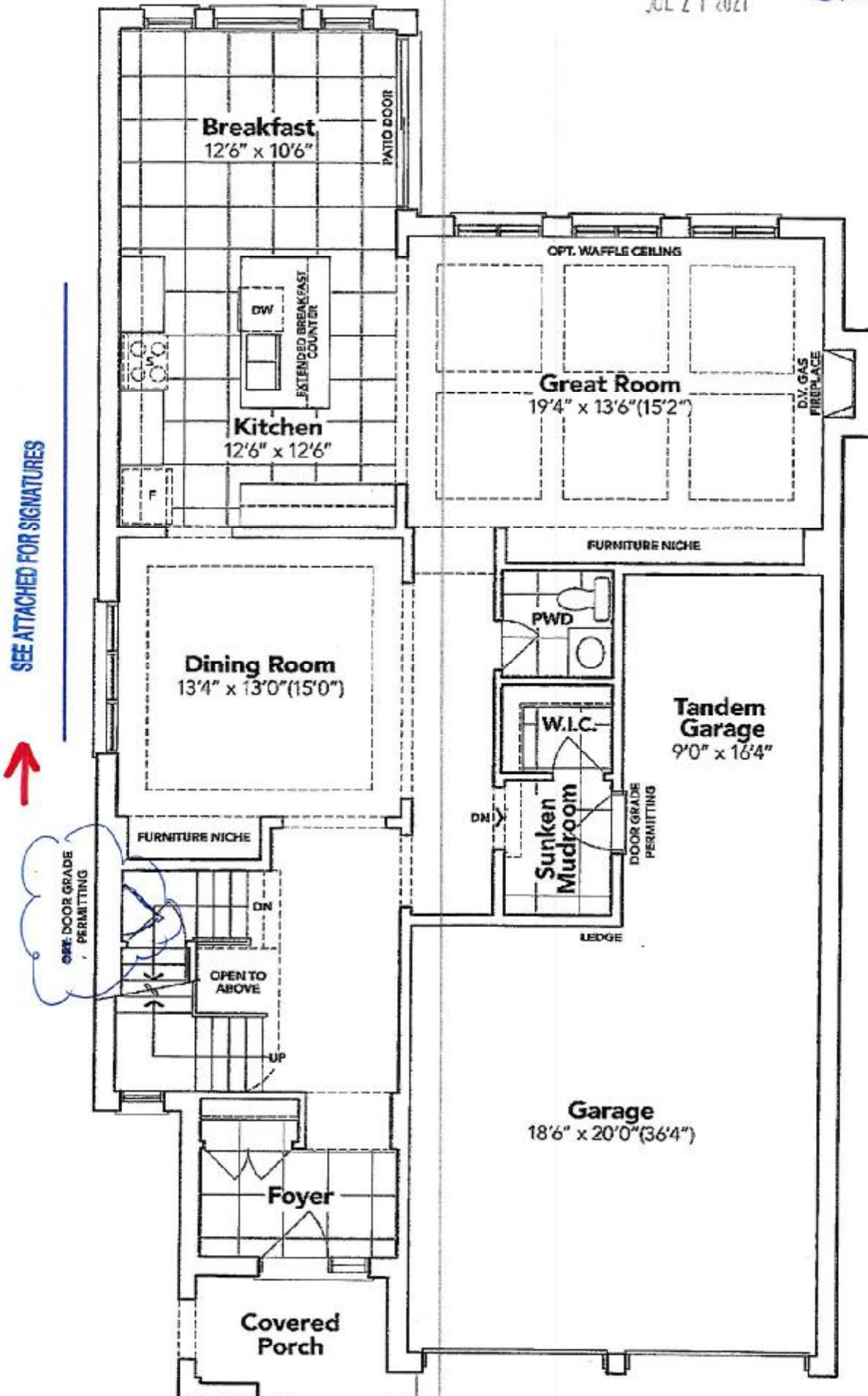

GROUND FLOOR EL. C

The floor plans and elevations shown are pre-construction plans and may be revised or improved as necessitated by architectural controls and the construction process. The measurements adhere to the rules and regulations of the TARJON Warranty Corporation's official method for the calculation of floor area. Materials, specifications and floor plans are subject to change without notice. All house renderings are artist's concept only. Actual usable floor space may vary from the stated floor area. All options shown are upgrades. E. & O. E.

