

KINGSMEN (THAMES) INC. / Havelock Corners (Kingsmen)

Lot/Unit: 203 BLOCK 183 Phase/Building: 5A Model/Floor Plan: Henry (2601) Elev B2A 3
Bed - 2+1 Bath

CABINETRY ACCESSORIES

Inv.5142	4 - To supply & install LIGHT VALANCE - - LIGHT VALANCE IS NOW APPROXIMATELY 2INCHES 50MM HIGH - CLASSIC SERIES in the kitchen..	
Line 67576	Note: Rough in wires are sold sep.	
22Oct21 / 22Oct21	NO LIGHTS HAVE BEEN PURCHASED>	

CABINETRY APPLIANCE - FRIDGE

Inv.5142	1 - To supply & install the 66CM DEEP FRIDGE ENCLOSURE - COUNTER DEPTH WITH - 1 WALL - 1 66CM DEEP GABLE AND 1 66CM DEEP CABINET - THIS IS NOT A ZERO CLEARANCE ENCLOSURE. STANDARD HEIGHTS AND WIDTHS WILL BE USED. - CLASSIC SERIES.. see sketch # 1	
Line 67571	Note:	
22Oct21 / 22Oct21		

CABINETRY BASE CABINETS

Inv.5142	1 - To supply & install an additional BANK OF DRAWERS CABINET - 50 CM MAXIMUM + - - SIZE SUBJECT TO FLOOR PLAN - CLASSIC SERIES in the kitchen... see sketch # 1	
Line 67572	Note:	
22Oct21 / 22Oct21		
Inv.5142	1 - To supply & install the BASE PIE CUT CORNER - CLASSIC SERIES... see sketch # 1	
Line 67575	Note:	
22Oct21 / 22Oct21		

CABINETRY HOOD FANS

Inv.5142	1 - To ACCOMMODATE FOR MICROWAVE HOOD FAN COMBO -- CLASSIC SERIES still to install the std. stainless steel hood fan.	
Line 67580	Note:	
22Oct21 / 22Oct21		

CABINETRY VANITY

Inv.5142	1 - To supply & install a VANITY BANK OF DRAWERS - CLASSIC SERIES in the master ensuite ... see sketch # 2	
Line 67578	Note:	
22Oct21 / 22Oct21		

CABINETRY WALL AND HUTCH

Inv.5142	1 - To supply & install the UPPER ANGLE CORNER PER UNIT - CLASSIC SERIES in the kitchen ... see sketch # 1	
Line 67574	Note:	
22Oct21 / 22Oct21		

COUNTER TOP

Inv.5142	1 - As per schedule "PE": Vendor to inlcude level 1, 2cm. quartz in all bathrooms, as per plan, in lieu of the included laminate countertops. Selections to be made from builders standard samples.	
Line 67550	Note:	
22Oct21 / 22Oct21		

KINGSMEN (THAMES) INC. / Havelock Corners (Kingsmen)

**Lot/Unit: 203 BLOCK 183 Phase/Building: 5A Model/Floor Plan: Henry (2601) Elev B2A 3
Bed - 2+1 Bath**

ELECTRICAL

Inv.5142	1 - To supply & install the standard T.V. rough in in the great room and master bedroom...see sketch # 1 & # 2	
Line 67554	Note:	
22Oct21 / 22Oct21		
Inv.5142	1 - To supply & install the standard Phone (CAT 5) rough in in the great room, master bedroom and bedroom # 3 ...see sketch # 1 & # 2	
Line 67555	Note:	
22Oct21 / 22Oct21		
Inv.5142	1 - To SUPPLY AND INSTALL RG6 CABLE ROUGH IN WIRE in bedroom # 3.... see sketch # 2	
Line 67556	Note:	
22Oct21 / 22Oct21		
Inv.5142	1 - To SUPPLY AND INSTALL AN ADDITIONAL BASIC RECEPTACLE (NOT DEDICATED) at approx. 66'+ - up from the floor centered to the F/P mantle see sketch # 1	
Line 67557	Note: This is for a futue wall mount t.v.	
22Oct21 / 22Oct21		
Inv.5142	1 - To SUPPLY AND INSTALL CONDUIT FOR TV OVER THE FIREPLACE – TERMINATED IN SAME ROOM at approx. 66" + - up from the floor centered to the F/P mantle and terminated next to + - the std. T.V. & Phone rough in in the great room... see sketch # 1	
Line 67558	Note:	
22Oct21 / 22Oct21		
Inv.5142	1 - To supply & install rough in wires on a sep. switch for future lower valance lights..	
Line 67577	Note: Lower valance trim sold sep.	
22Oct21 / 22Oct21		NO LIGHTS HAVE BEEN PURCHASED
Inv.5142	1 - To SUPPLY AND INSTALL AN ADDITIONAL BASIC RECEPTACLE (DEDICATED CIRCUIT AND INCLUDES ARC FAULT BREAKER) for the future O.T.R. in the kitchen...	
Line 67581	Note:	
22Oct21 / 22Oct21		

FIREPLACE

Inv.5142	1 - To supply & install a FAN to the F/P in the great room..	
Line 67569	Note:	
22Oct21 / 22Oct21		

HARDWOOD

Inv.5142	1 - To supply & install the 3 1/2" Elements stained hardwood to the main floor and stair landings wherre applicable in leiu of the std. 3 1/2" Elements natural hardwood... see colour chart for details.	
Line 67561	Note:	
22Oct21 / 22Oct21		
Inv.5142	1 - To supply & install the 3 1/2" Elements stained hardwood to the kitchen and breakfast area in leiu of the std. ceramic floor tiles... see colour chart for details.	
Line 67562	Note:	
22Oct21 / 22Oct21		

KINGSMEN (THAMES) INC. / Havelock Corners (Kingsmen)

Lot/Unit: 203 BLOCK 183 Phase/Building: 5A Model/Floor Plan: Henry (2601) Elev B2A 3
Bed - 2+1 Bath

Inv.5142	1 - To supply & install the 3 1/2" Elements stained hardwood to the upper hallway in lieu of the standard carpet. .. see colour chart for details.	
Line 67563	Note:	
22Oct21 / 22Oct21		

HEATING AND AIR CONDITIONING

Inv.5142	1 - As per schedule "PE": Vendor to install capped gas line (rough in only) at rear of home for future BBQ location. Location to be finalized at vendors sole discretion.	
Line 67548	Note:	
22Oct21 / 22Oct21		

Inv.5142	1 - As per schedule "PE": Vendor to supply & install air conditioning unit, sized accordingly, from vendors standard samples.	
Line 67549	Note:	
22Oct21 / 22Oct21		

MISCELLANEOUS

PAINT AND DRYWALL

Inv.5142	1 - To PAINT EXTRAS - STAIN RAILINGS WITH IRON PICKETS (INCLUDING STAIRS) in lieu of the natural finish.... see colour chart for details.	
Line 67565	Note:	
22Oct21 / 22Oct21		

PLUMBING

Inv.5142	1 - To supply & install the BLANCO QUARTUS U2 Undermount model: 401247 in the kitchen in lieu of the std top mount kitchen sink...see spec's	
Line 67559	Note: Still to install the single hole kitchen faucet... NO PLATE	
22Oct21 / 22Oct21		

Inv.5142	4 - To supply & installed the under mount CONTRAC CATENA Model 4210CIY in the powder room, master ensuite and main bathroom in lieu of the standard top mount vanity sinks... see spec's	
Line 67560	Note: Still to install the standard lav. faucet.	
22Oct21 / 22Oct21		

RAILING

Inv.5142	1 - To supply & install the RAILING - UPGRADE 1 - METAL HANDRAIL 3 INCH OVAL IN OAK - PICKETS STEEL ½ INCH SQUARE, PLAIN, WITH SHOES IN FLAT BLACK - POSTS 3½ INCH SQUARE, WITH CAP OAK IN OAK in lieu of the standard pickets and rails.	
Line 67564	Note:	
22Oct21 / 22Oct21		

TILE - FLOOR

Inv.5142	1 - To supply & install the UPGRADE 2 - FLOOR TILE - STACKED - FOYER TILE in lieu of the standard floor tiles... see colour chart for details.... see sktch # 1 for installation direction.	
Line 67566	Note:	
22Oct21 / 22Oct21		

KINGSMEN (THAMES) INC. / Havelock Corners (Kingsmen)

Lot/Unit: 203 BLOCK 183 Phase/Building: 5A Model/Floor Plan: Henry (2601) Elev B2A 3
Bed - 2+1 Bath

Inv.5142	1 - To supply & install the UPGRADE 2 - FLOOR TILE - STACKED - HALL TILE in lieu of the standard floor tiles... see colour chart for details.... see sktch # 1 for installation direction.	
Line 67567	Note:	
22Oct21 / 22Oct21		
Inv.5142	1 - To supply & install the UPGRADE 2 - FLOOR TILE - STACKED - POWDER ROOM TILE in lieu of the standard floor tiles... see colour chart for details.... see sktch # 1 for installation direction.	
Line 67568	Note:	
22Oct21 / 22Oct21		
Inv.5142	1 - To supply & install the UPGRADE 1 - SHOWER FLOOR TILE - - ENSUITE SHOWER FLOOR TILE in lieu of the std. shower floor tile... see colour chart for details.	
Line 67570	Note:	
22Oct21 / 22Oct21		

EXTRAS AS PER OFFER

VENDOR TO INSTALL CAPPED GAS LINE (ROUGH-IN ONLY) AT REAR OF HOME FOR FUTURE BBQ LOCATION. LOCATION TO BE FINALIZED AT VENDORS SOLE DISCRETION. <i>Worksheet</i> Note:	
VENDOR TO SUPPLY & INSTALL AIR CONDITIONING UNIT, SIZED ACCORDINGLY, FROM VENDORS STANDARD SAMPLES. <i>Worksheet</i> Note:	
VENDOR TO INCLUDE LEVEL 1, 2CM QUARTZ IN ALL BATHROOMS, AS PER PLAN, IN LIEU OF THE INCLUDED LAMINATE COUNTER TOPS. SELECTIONS TO BE MADE FROM BUILDERS STANDARD SAMPLES. <i>Worksheet</i> Note:	

Purchaser: MICHAEL WESLEY RHODES

Property: 203 BLOCK 183 of Plan - Draft Approval S

Telephone Res. / Bus: (289) 775-6072 /

Project: KINGSMEN (THAMES) INC.

Decor Advisor: Barbara Coccia

Model and Elevation: Henry (2601) Elev B2A 3 Bed - 2+1 Bath

Layout Changes: ☐ Yes ☒ No

Sketch Attached: ☒ Yes ☐ No

Exterior Colour Scheme:

1. Cabinetry

	Style and Colour	Counter Top	Hardware
Kitchen / Breakfast	#3 Simcoe Rain Cloud	#1, C/S # 9141 Ice Snow 3cm.	#12881 Handle
Kitchen Island	#3 Simcoe Rain Cloud	#1, C/S # 9141 Ice Snow 3cm.	#12881 Handle
Laundry Room	/		
Powder Room	#3 Simcoe Orchid	#1, C/S # 3040 Cement 2cm.	#12881 Handle
Main Bathroom	#4 Soho Viva Sunset Cruise	#1, C/S # 6041 Nordic Loft 2cm.	#12881 Handle
Master Ensuite Bathroom	#3 Simcoe Moonlight	#1, C/S # 9141 Ice Snow 2cm.	#12881 Handle
Second Ensuite Bathroom (If Applicable)	/		
	/		
	/		

Appliances

Custom Size Fridge

☐ Yes ☒ No

Valance Lighting

☒ Yes ☐ No

Microwave / Range Hood

☒ Yes ☐ No

Cooktop / Rangetop

☐ Yes ☒ No

Built in Wall Oven

☐ Yes ☒ No

Slide-in Range

☐ Yes ☒ No

Comment

2. Flooring

Selection

Foyer	* Upg.2. 12 x 24" Classic Calacatta HD Stacked Porcelan Tile
Main Hall	(in front of powder room) * Upg.2. 12 x 24" Classic Calacatta HD Stacked Porcelan Tile
Back Hall	/
Breakfast	* 3 1/2" Elements Oak Strugeon
Laundry Room	13 x 13" Keaton Ice
Kitchen	* 3 1/2" Elements Oak Strugeon
Powder Room	* Upg.2. 12 x 24" Classic Calacatta HD Stacked Porcelan Tile
Main Bathroom	13 x 13" Keaton Ice
Master Ensuite	13 x 13" Keaton Ice
Bathroom (If Applicable)	/
Mud Room	/
Master Ens. Shower Floor	* 2 x2 " Land Plain Black Matte
Living Room	/
Dining Room	* 3 1/2" Elements Oak Strugeon
Family / Great Room	* 3 1/2" Elements Oak Strugeon
Den / Library / Study	/
Basement Landing (If Applies)	
Lower Landing (If Applicable)/	
Upper Landing	* 3 1/2" Elements Oak Strugeon
Upper Hall	* 3 1/2" Elements Oak Strugeon
Master Bedroom	Stylish Story 1, # 945 Felt Hat
Bedroom #2	Stylish Story 1, # 945 Felt Hat
Bedroom #3	Stylish Story 1, # 945 Felt Hat
Bedroom #4	/
Bedroom #5	/
Master ens. Shower sill	Anatolia marmiline SNOW

Flooring Continued on Page 2

Initial:

Page 1 of 3

Purchaser: MICHAEL WESLEY RHODES

Property: 203 BLOCK 183 of Plan - Draft Approval S

Telephone Res. / Bus: (289) 775-6072 /

Project: KINGSMEN (THAMES) INC.

Decor Advisor: Barbara Coccia

Model and Elevation: Henry (2601) Elev B2A 3 Bed - 2+1 Bath

2. Flooring - Continued -

Upgrade Underpad	Type	Area
	Standard	Master bedroom, bedroom #2, #3 #4
Carpet on Stairs	Capped	Runner - *Upgrade
Comment	/	/

3. Plumbing Fixtures / Faucets

Kitchen	Standard	Second Ensuite	/	Powder Room	Standard
Master Ensuite	Standard			Other Room	/
Main Bathroom	Standard		/		

Comment

Purchaser has upgraded to a under mount kitchen sink, still to install the std. kitchen single hole faucet NO PLATE.
Purchaser has upgraded to under mount vanity sinks in all bathrooms... still to install the std. lav. faucets.

4. Wall Tile

	Tile Selection	Listello	Insert	Insert Selection
Main Bathroom	8 x 10" Keaton Ice	<input type="checkbox"/>	<input type="checkbox"/>	
Master Ensuite				
Tub Deck	13 x 13" Keaton Ice	<input type="checkbox"/>	<input type="checkbox"/>	
Tub Apron	13 x 13" Keaton Ice	<input type="checkbox"/>	<input type="checkbox"/>	
Tub Surround	13 x 13" Keaton Ice	<input type="checkbox"/>	<input type="checkbox"/>	
Shower Stall	8 x 10" Cinq Black	<input type="checkbox"/>	<input type="checkbox"/>	
Second Ensuite	/	<input type="checkbox"/>	<input type="checkbox"/>	
	/	<input type="checkbox"/>	<input type="checkbox"/>	
	/	<input type="checkbox"/>	<input type="checkbox"/>	
Kitchen Backsplash	/	<input type="checkbox"/>	<input type="checkbox"/>	
Complete Backsplash	/	<input type="checkbox"/>	<input type="checkbox"/>	

Comment

Install all wall tiles where applicable on the 10" side stacked horizontally.



horizontal stacked



brick pattern



vertical stacked



diagonal/diamond

5. Fireplace

Living Room

Purchased ☐ As Per Plan ☐ N/A ☒

Family Room

Purchased ☐ As Per Plan ☐ N/A ☒

Other Room - Specify Great Room

Purchased ☐ As Per Plan ☒ N/A ☐

Fireplace Type

Mantle Type

Over Mantle

Colour / Stain

Surround

Hearth

Comment

/

Front Facing

NF-08

/

White

/

/

Initial: _____

Page 2 of 3

Purchaser: MICHAEL WESLEY RHODES

Telephone Res. / Bus: (289) 775-6072 /

Decor Advisor: Barbara Coccia

Property: 203 BLOCK 183 of Plan - Draft Approval S

Project: KINGSMEN (THAMES) INC.

Model and Elevation: Henry (2601) Elev B2A 3 Bed - 2+1 Bath

6. Trim Carpentry

Door Hardware

Interior Trim

Comment

/

Interior Doors

☐ 2 Panel Arch Top

☒ 2 Panel Square Top

☐ 6 Panel

Initial for Door Style

7. Railings and Pickets

Railing Package

Railing Colour

Wood Stairs ☐ No ☒ Oak

Picket Colour

Tread Colour

Comment

/

8. Plaster Mouldings and Medallions

Foyer

/

Main Hall

/

Living Room

/

Dining Room

/

Family Room

/

Kitchen/Breakfast

/

Den/Library

/

Lower Landing

/

Comment

/

9. Wall Paint

Kingsmen White

Smooth Ceilings ☐ First Floor

☐ First Floor incl. Second Floor Hall

☐ First and Second Floor

☒ Throughout

☐ Not Applicable

Trim Paint

10. Additional Comments

/

11. Disclaimers and Notes

- Colours of all materials are as close as possible to builder's selection, but not necessarily identical due to variances in manufacturing.
- Any extras listed above are null and void unless accompanied by a separate invoice/amendment. Said invoice must be paid in full.
- The Purchaser acknowledges that after Interior Colour Selection form is signed and dated, no further changes will be permitted other than re-selection due to unavailability. MS Purchaser's Initials
- The Purchaser acknowledges reading and accepting the "Kingsmen Group Décor Centre Disclaimers" form. This document contains other miscellaneous disclaimers.

This Interior Colour Selection is final and approved by:

Purchaser:

Signature: MS

Date: Oct 22/21

Vendor:

KINGSMEN (THAMES) INC.

26 October, 2021

SCHEDULE "B-1"
Floor Plan

Townhouse No. 203 BLOCK 183
Phase 5A
Model: Henry (2601) Elev B2A 3 Bed - 2+1 Bath
Interior - Standard

Sketch #1

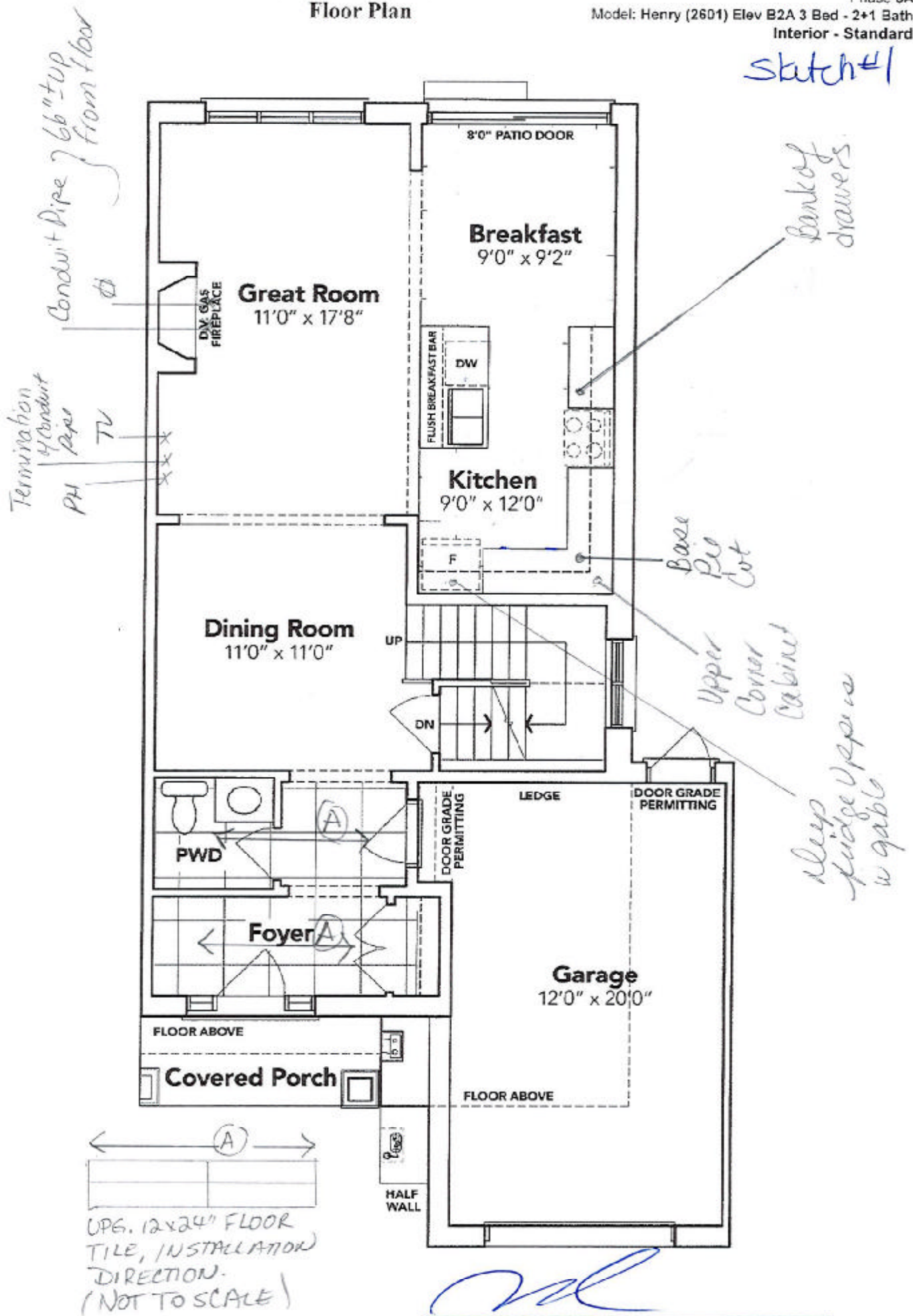

MAIN FLOOR EL. B2A

The floor plans and elevations shown are pre-construction plans and may be revised or improved as necessitated by architectural controls and the construction process. The measurements adhere to the rules and regulations of the TARIION Warranty Corporation's official method for the calculation of floor area. Materials, specifications and floor plans are subject to change without notice. All house renderings are artist's concept only. Actual usable floor space may vary from the stated floor area. All options shown are upgrades. E. & O. E.

SCHEDULE "B-1"
Floor Plan

Townhouse No. 203 BLOCK 183
Phase 5A
Model: Henry (2601) Elev B2A 3 Bed - 2+1 Bath
Interior - Standard

Sketch #2

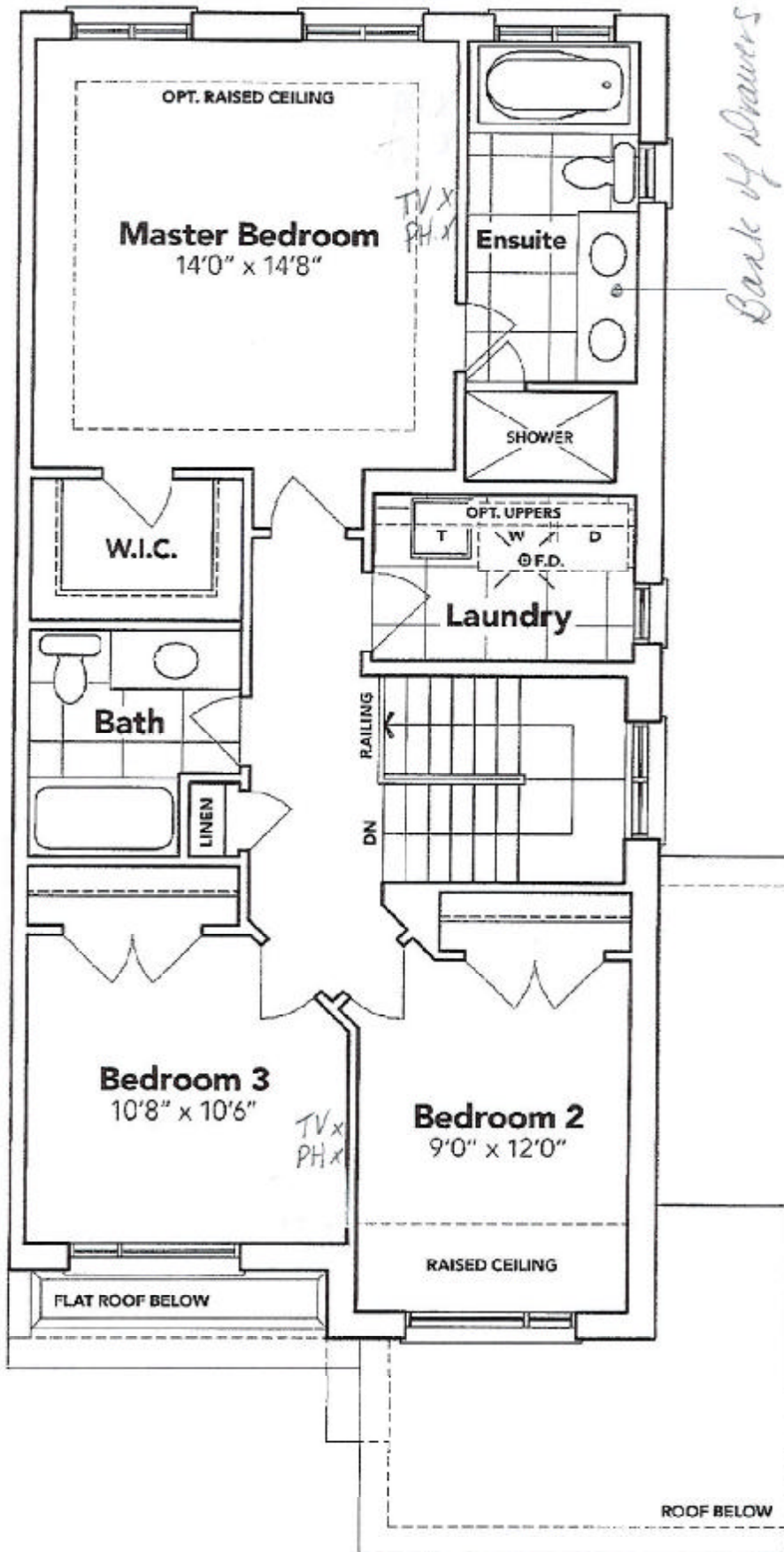

SECOND FLOOR EL. B2A

The floor plans and elevations shown are pre-construction plans and may be revised or improved as necessitated by architectural controls and the construction process. The measurements adhere to the rules and regulations of the TARION Warranty Corporation's official method for the calculation of floor area. Materials, specifications and floor plans are subject to change without notice. All house renderings are artist's concept only. Actual usable floor space may vary from the stated floor area. All options shown are upgrades. E. & O. E.

SCHEDULE "B-1" - Page 2 of 3

Initials: *[Signature]*

SCHEDULE "B-1"
Floor Plan

Townhouse No. 203 BLOCK 183
Phase 5A
Model: Henry (2601) Elev B2A 3 Bed - 2+1 Bath
Interior - Standard

sketch #3

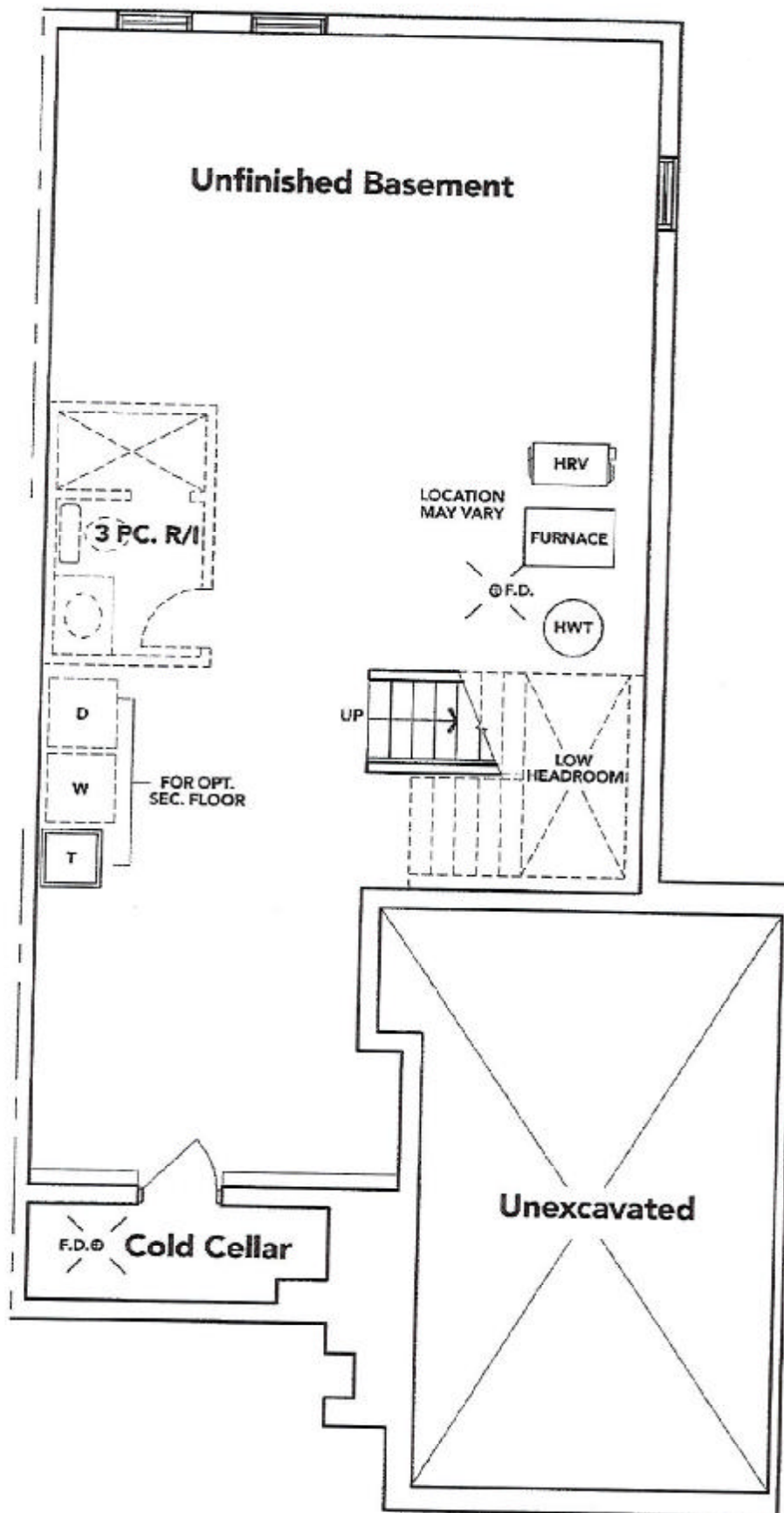

ml

BASEMENT EL. B2A

The floor plans and elevations shown are pre-construction plans and may be revised or improved as necessitated by architectural controls and the construction process. The measurements adhere to the rules and regulations of the TARIION Warranty Corporation's official method for the calculation of floor area. Materials, specifications and floor plans are subject to change without notice. All house renderings are artist's concept only. Actual usable floor space may vary from the stated floor area. All options shown are upgrades, E. & O. E.

[Signature]

LOT: 203
Thomas PH: 5A

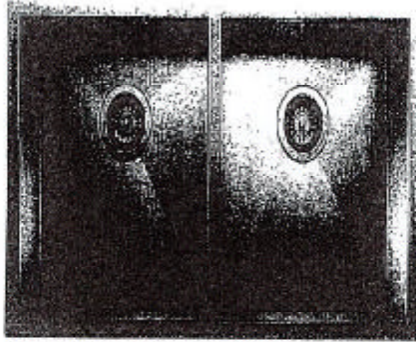

-UPG KITCHEN SINK-
QUATRUS U2
MODEL: 401247

Germian engineered with 304 series, 16-gauge stainless steel

Zero-radius corners; X-polished drain grates

Double bowl configuration for easy food handling

12/10 advanced-rivet system for exceptional finish, durability and strength

Undermount installation

Minimum cabinet size: 36"

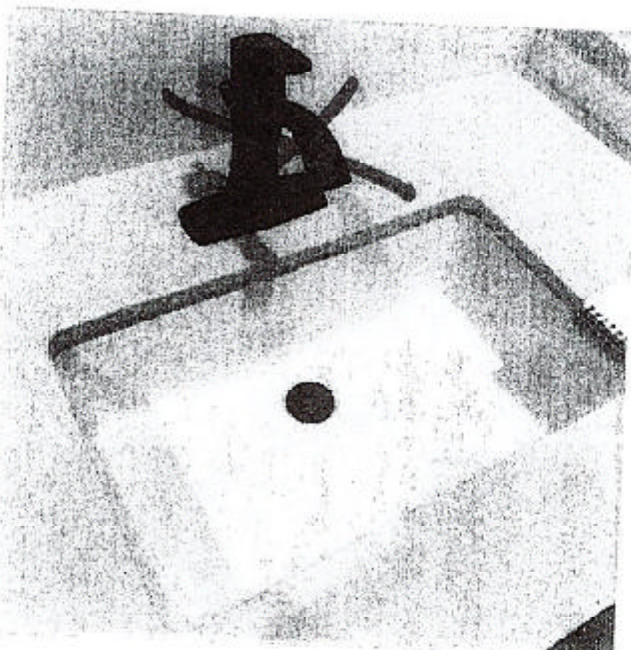

-UPG VAWITY SINKS -
ALL BATHROOM.
DISPLAY ITEMS

Sink (Item 9)

Contrac Catena Undermount
Model 4210CIY