

KINGSMEN (THAMES) INC. / Havelock Corners (Kingsmen)

Lot/Unit: 190 BLOCK 181 Phase/Building: 5A Model/Floor Plan: George (2603) Elev B2 4
Bed - 2+1 Bath

ELECTRICAL

Inv.5163	1 - To supply and install the standard T.V Rough-in in the Great Room and Master Bedroom.. see sketch #1 and #2	
Line 67826	Note: TO SUPPLY AND INSTALL THE STANDARD T.V ROUGH-IN, IN THE GREAT ROOM AT APPROX. 66" UP FROM THE FLOOR OVER THE F/P MANTLE	
8Nov21 / 8Nov21		
Inv.5163	1 - To supply and install the Phone (CAT 5) Rough-in, in the Great Room, Master Bedroom and Bedroom #3.. see sketch #1 and #2	
Line 67827	Note: TO SUPPLY AND INSTALL THE STANDARD PHONE (CAT 5) ROUGH-IN, IN THE GREAT ROOM AT APPROX. 66" UP FROM THE FLOOR OVER THE F/P MANTLE	
8Nov21 / 8Nov21		
Inv.5163	1 - To SUPPLY AND INSTALL AN ADDITIONAL BASIC RECEPTACLE (NOT DEDICATED) centered +- above the F/P Mantle in the Great Room at approx. 66"+- up from the floor.. see sketch #1	
Line 67829	Note: TO SUPPLY AND INSTALL THE STANDARD PHONE AND T.V ROUGH-IN NEXT TO +- THE UPG. ELEC. OUTLET	
8Nov21 / 8Nov21		

HEATING AND AIR CONDITIONING

Inv.5163	1 - As per schedule "PE": Vendor to install capped gas line (rough in only) at rear of home for future BBQ location. Location to be finalized at vendors sole discretion.	
Line 67802	Note:	
8Nov21 / 8Nov21		
Inv.5163	1 - As per schedule "PE": Vendor to supply & install air conditioning unit, sized accordingly, from vendors standard samples.	
Line 67803	Note:	
8Nov21 / 8Nov21		

MISCELLANEOUS

Inv.5163	1 - INTERIOR FINISHES SELECTED NOV 8/2021	
Line 67830	Note:	
8Nov21 / 8Nov21		

EXTRAS AS PER OFFER

5 FREE APPLIANCES – STAINLESS STEEL FRONT - FRIDGE: STOVE AND DISHWASHER. WHITE WASHER AND DRYER (SUPPLIED ONLY, NOT INSTALLED, FROM BUILDERS STANDARD LINE). AN APPLIANCES VOUCHER WILL BE GIVEN BY OUR DECOR CONSULTANT AT THE TIME OF BOOKING YOUR COLOUR A Worksheet Note:	
VENDOR TO INSTALL CAPPED GAS LINE (ROUGH-IN ONLY) AT REAR OF HOME FOR FUTURE BBQ LOCATION. LOCATION TO BE FINALIZED AT VENDORS SOLE DISCRETION. Worksheet Note:	
VENDOR TO SUPPLY & INSTALL AIR CONDITIONING UNIT, SIZED ACCORDINGLY, FROM VENDORS STANDARD SAMPLES. Worksheet Note:	

Purchasers: PARDEEP SINGH CHAHAL & INDERJIT KAUR (Property: 190 BLOCK 181 of Plan - Draft Approval S

Telephone Res. / Bus: /

Project: KINGSMEN (THAMES) INC.

Decor Advisor: Barbara Coccia

Model and Elevation: George (2603) Elev B2 4 Bed - 2+1 Bath

Layout Changes: ☐ Yes ☒ NoSketch Attached: ☒ Yes ☐ No

Exterior Colour Scheme:

1. Cabinetry

	Style and Colour	Counter Top	Hardware
Kitchen / Breakfast	#3 Simcoe Orchid	#1 C/S #9141 Ice Snow 3cm	12881 Handle
Kitchen Island	#3 Simcoe Orchid	#1 C/S #9141 Ice Snow 3cm	12881 Handle
Laundry Room	/	/	/
Powder Room	#3 Simcoe Orchid	Calcutta Marble 4925k-07	12881 Handle
Main Bathroom	#3 Simcoe Moonlight	Leche Vesta 4987k-07	12881 Handle
Master Ensuite Bathroom	#3 Simcoe Moonlight	Leche Vesta 4987k-07	12881 Handle
Second Ensuite Bathroom (If Applicable)	/	/	/

Appliances

Custom Size Fridge

☐ Yes ☒ No

Valance Lighting

☐ Yes ☒ No

Microwave / Range Hood

☐ Yes ☒ No

Cooktop / Rangetop

☐ Yes ☒ No

Built in Wall Oven

☐ Yes ☒ No

Slide-in Range

☐ Yes ☒ No

Comment

/

2. Flooring

	Selection
Foyer	13x13" Keaton Ice
Main Hall	3 1/2" Elements Oak Natural
Back Hall	(In Front of PWD)-13x13" Keaton Ice
Breakfast	13x13" Keaton Ice
Laundry Room	13x13" Cinq White
Kitchen	13x13" Keaton Ice
Powder Room	13x13" Keaton Ice
Main Bathroom	13x13" Cinq White
Master Ensuite	13x13" Cinq White
Bathroom (If Applicable)	/
Mud Room	13x13" Keaton Ice
Master Ens. SH/FL	2x2" Ontario Snow White Matte
Living Room	/
Dining Room	3 1/2" Elements Oak Natural
Family / Great Room	3 1/2" Elements Oak Natural
Den / Library / Study	/
Basement Landing (If Applies)	
Lower Landing (If Applicable)	3 1/2" Elements Oak Natural
Upper Landing	3 1/2" Elements Oak Natural
Upper Hall	Stylish Story 1: 945 Felt Hat
Master Bedroom	Stylish Story 1: 945 Felt Hat
Bedroom #2	Stylish Story 1: 945 Felt Hat
Bedroom #3	Stylish Story 1: 945 Felt Hat
Bedroom #4	Stylish Story 1: 945 Felt Hat
Bedroom #5	/
Master Ens Shower Jamb	Anatolia Marmiline SNOW

Flooring Continued on Page 2

Initial:

SC PS

Page 1 of 3

Purchasers: PARDEEP SINGH CHAHAL & INDERJIT KAUR (Property: 190 BLOCK 181 of Plan - Draft Approval S

Telephone Res. / Bus: /

Project: KINGSMEN (THAMES) INC.

Decor Advisor: Barbara Coccia

Model and Elevation: George (2603) Elev B2 4 Bed - 2+1 Bath

2. Flooring - Continued -

Upgrade Underpad	Type STANDARD	Area 2ND FLOOR
Carpet on Stairs	Capped /	Runner - *Upgrade /
Comment	/	

3. Plumbing Fixtures / Faucets

Kitchen	STANDARD	Second Ensuite	/	Powder Room	STANDARD
Master Ensuite	STANDARD			Other Room	/
Main Bathroom	STANDARD		/		

Comment

NOTE: To supply and install the STANDARD TOPMOUNT KITCHEN SINK, with the standard faucet. To supply and install the STANDARD TOPMOUNT SINK IN ALL BATHROOMS, with the standard faucet.

4. Wall Tile

	Tile Selection	Listello	Insert	Insert Selection
Main Bathroom	8x10" Cinq Grey	<input type="checkbox"/>	<input type="checkbox"/>	/
Master Ensuite				
Tub Deck	13x13" Cinq White	<input type="checkbox"/>	<input type="checkbox"/>	/
Tub Apron	13x13" Cinq White	<input type="checkbox"/>	<input type="checkbox"/>	/
Tub Surround	13x13" Cinq White	<input type="checkbox"/>	<input type="checkbox"/>	/
Shower Stall	8x10" Cinq Grey	<input type="checkbox"/>	<input type="checkbox"/>	/
Second Ensuite	/	<input type="checkbox"/>	<input type="checkbox"/>	/
	/	<input type="checkbox"/>	<input type="checkbox"/>	/
	/	<input type="checkbox"/>	<input type="checkbox"/>	/
Kitchen Backsplash	/	<input type="checkbox"/>	<input type="checkbox"/>	/
Complete Backsplash	/	<input type="checkbox"/>	<input type="checkbox"/>	/

Comment

NOTE: To supply and install the standard wall tiles on the 10" side stacked (where applicable).



horizontal stacked



brick pattern



vertical stacked



diagonal/diamond

5. Fireplace

Living Room

Purchased ☐ As Per Plan ☐ N/A ☐

Family Room

Purchased ☐ As Per Plan ☐ N/A ☐

Other Room - Specify Great Room

Purchased ☐ As Per Plan ☒ N/A ☐

Fireplace Type

Mantle Type

Over Mantle

Colour / Stain

Surround

Hearth

Comment

Front Facing

NF-08

/

White

/

/

Initial: _____

Page 2 of 3

Purchasers: PARDEEP SINGH CHAHAL & INDERJIT KAUR (**Property:** 190 BLOCK 181 of Plan - Draft Approval S
Telephone Res. / Bus: / **Project:** KINGSMEN (THAMES) INC.
Decor Advisor: Barbara Coccia **Model and Elevation:** George (2603) Elev B2 4 Bed - 2+1 Bath

6. Trim Carpentry

Door Hardware Standard Handle

Interior Trim Standard

Comment

/

Interior Doors

☐ 2 Panel Arch Top

☒ 2 Panel Square Top

☐ 6 Panel



Initial for Door Style

7. Railings and Pickets

Railing Package Standard Straight Oak Package

Railing Colour Elements Natural

Picket Colour Elements Natural

Wood Stairs ☐ No ☒ Oak

Tread Colour Elements Natural

Comment

/

8. Plaster Mouldings and Medallions

Foyer	/	/	Kitchen/Breakfast	/	/
Main Hall	/	/	Den/Library	/	/
Living Room	/	/	Lower Landing	/	/
Dining Room	/	/	/	/	/
Family Room	/	/			

Comment

/

9. Wall Paint

Kingsmen White

Smooth Ceilings ☐ First Floor
☐ First Floor incl. Second Floor Hall
☐ First and Second Floor
☒ Throughout
☐ Not Applicable

Trim Paint Kingsmen White

10. Additional Comments

/

11. Disclaimers and Notes

- Colours of all materials are as close as possible to builder's selection, but not necessarily identical due to variances in manufacturing.
- Any extras listed above are null and void unless accompanied by a separate invoice/amendment. Said invoice must be paid in full.
- The Purchaser acknowledges that after Interior Colour Selection form is signed and dated, no further changes will be permitted other than re-selection due to unavailability. AC PF Purchaser's Initials
- The Purchaser acknowledges reading and accepting the "Kingsmen Group Decor Centre Disclaimers" form. This document contains other miscellaneous disclaimers.

This Interior Colour Selection is final and approved by:

Purchaser:

Signature: Inderjit Kaur Date: Nov 08, 2021

Signature: Pardeep Singh Date: Nov-08, 2021 Vendor: 

KINGSMEN (THAMES) INC.

Nov 8/21

SCHEDULE "B-1"
Floor Plan

Townhouse No. 190 BLOCK 181

Phase 5A

Model: George (2603) Elev B2 4 Bed - 2+1 Bath

End Alternate - Standard

Sketch #1

@ 66" up from the floor.

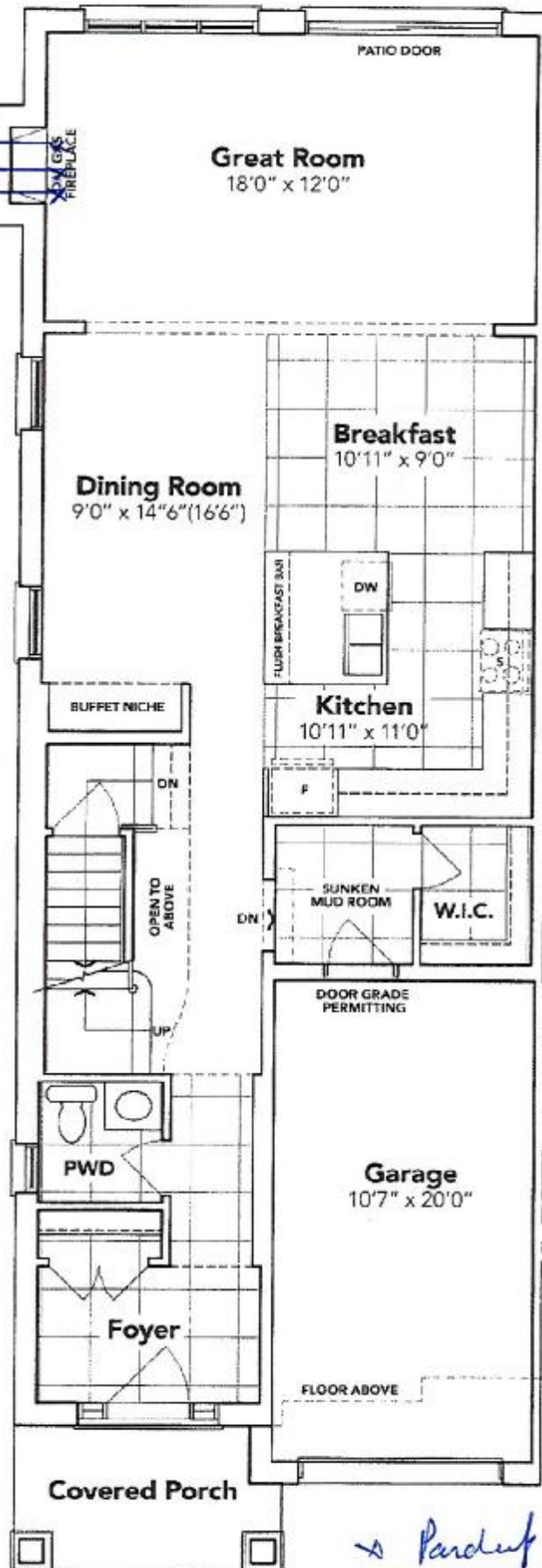

MAIN FLOOR EL. B2A *+ Anshjit Kaur.*

The floor plans and elevations shown are pre-construction plans and may be revised or improved as necessitated by architectural controls and the construction process. The measurements adhere to the rules and regulations of the TARIION Warranty Corporation's official method for the calculation of floor area. Materials, specifications and floor plans are subject to change without notice. All house renderings are artist's concept only. Actual usable floor space may vary from the stated floor area. All options shown are upgrades. E. & O. E.

SCHEDULE "B-1" - Page 3 of 3

SCHEDULE "B-1"
Floor Plan

Townhouse No. 190 BLOCK 181
Phase 5A
Model: George (2603) Elev B2 4 Bed - 2+1 Bath
End Alternate - Standard

Sketch #2

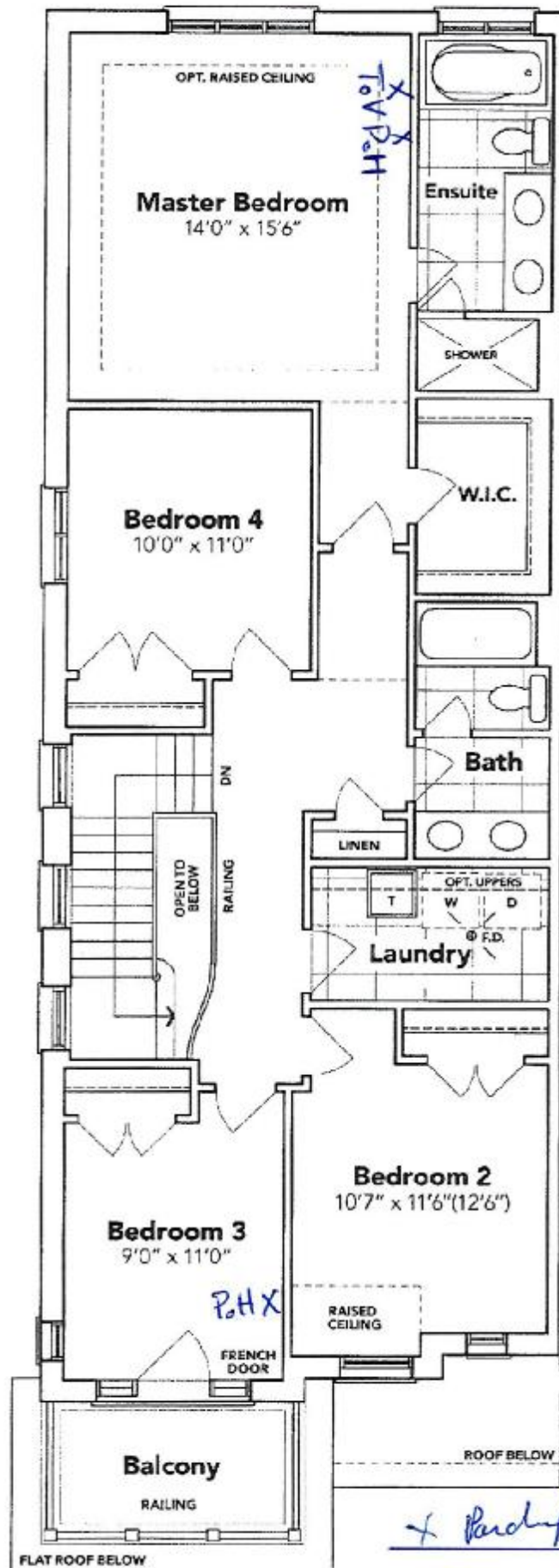

+ Parul Singh

SECOND FLOOR EL. B2A

+ Indrajit Kaur

The floor plans and elevations shown are pre-construction plans and may be revised or improved as necessitated by architectural controls and the construction process. The measurements adhere to the rules and regulations of the TARIION Warranty Corporation's official method for the calculation of floor area. Materials, specifications and floor plans are subject to change without notice. All house renderings are artist's concept only. Actual usable floor space may vary from the stated floor area. All options shown are upgrades. E. & O. E.

SCHEDULE "B-1"
Floor Plan

Townhouse No. 190 BLOCK 181
Phase 5A
Model: George (2603) Elev B2 4 Bed - 2+1 Bath
End Alternate - Standard

Sketch #3

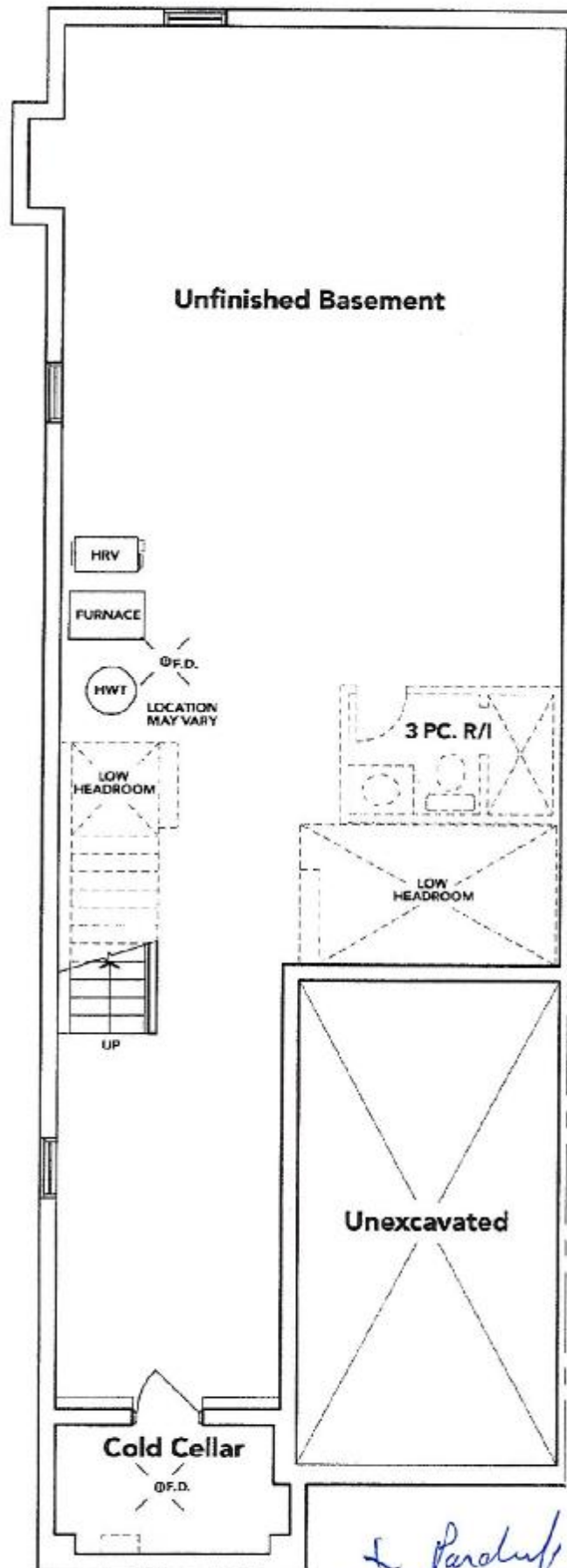

L. Pandey Singh
** Sanderjit Kaur.*

BASEMENT EL. B2A

The floor plans and elevations shown are pre-construction plans and may be revised or improved as necessitated by architectural controls and the construction process. The measurements adhere to the rules and regulations of the TARIION Warranty Corporation's official method for the calculation of floor area. Materials, specifications and floor plans are subject to change without notice. All house renderings are artist's concept only. Actual usable floor space may vary from the stated floor area. All options shown are upgrades. E. & O. E.

SCHEDULE "B-1" - Page 1 of 3