

Kingsmen (Islington) Inc. / 9560 Islington

Lot/Unit: U224 Block 2 Phase/Building: 1 Model/Floor Plan: The Lisbon - 3 Bed (B8)

CABINETRY BASE CABINETS

Inv.5307	3 - To supply & install THREE SETS OF POTS & PANS DRAWER -- CLASSIC SERIES in the kitchen... see sketch # 1	
Line 69144	Note:	
21Jan22 / 21Jan22		
Inv.5307	1 - To supply & install the 45CM WIDE PULL-OUT DOOR BASE CABINET WASTE - RECYCLE CENTRE - 2 35L BINS - AVAILABLE ONLY WITH 45CM WIDE CABINET - CLASSIC SERIES in the kitchen....see sketch # 1	
Line 69146	Note:	
21Jan22 / 21Jan22		

CABINETRY VANITY

Inv.5307	2 - To supply & install ONE VANITY LOWER DRAWER in the master ensuite... see sketch # 2	
Line 69147	Note:	
21Jan22 / 21Jan22		
Inv.5307	3 - To INCREASE VANITY TO KITCHEN HEIGHT- MAINTAINS VANITY DEPTH - CLASSIC SERIES in the powder room, master ensuite and main bathroom...	
Line 69148	Note:	
21Jan22 / 21Jan22		

COUNTER TOP

Inv.5307	1 - As per schedule "PE": Vendor agrees to supply and install quartz or granite in kitchen and all bahtrooms from standard samples of the vendor. This promotion has no cash value, is non-neotiable and non-transferrable.	
Line 69125	Note:	
21Jan22 / 21Jan22		
Inv.5307	3 - To supply & install an approx. 4" quartz backsplash to the countertop for the powder room, main and master ensuite same colour as the quartz counter top in the bahrooms.	
Line 69136	Note:	
21Jan22 / 21Jan22		

COUNTER TOP - KITCHEN

Inv.5307	1 - To supply & install the COUNTER TOP - KITCHEN - KITCHEN - 3CM QUARTZ COUNTER TOP - UPGRADE LEVEL 2 in lieu of the standard quartz countertop... see colour chart for details.	
Line 69132	Note: Purchaser has upgraded the kitchen sink... see sep. upgrade	
21Jan22 / 21Jan22		

COUNTER TOP - VANITY

Inv.5307	1 - To supply & install the COUNTER TOP - VANITY - POWDER ROOM - 2CM QUARTZ COUNTER TOP - UPGRADE LEVEL 2 in lieu of the standard quartz.. see colour chart for details	
Line 69133	Note: Purchaser has upgraded to an under mount sink... see sep. upgrade	
21Jan22 / 21Jan22		

Kingsmen (Islington) Inc. / 9560 Islington

Lot/Unit: U224 Block 2 Phase/Building: 1 Model/Floor Plan: The Lisbon - 3 Bed (B8)

Inv.5307	1 - To supply & install the COUNTER TOP - VANITY - MAIN BATHROOM - 2CM QUARTZ COUNTER TOP - UPGRADE LEVEL 2 in lieu of the standard quartz.. see colour chart for details	
Line 69134	Note: Purchaser has upgraded to an under mount sink... see sep. upgrade	
21Jan22 / 21Jan22		
Inv.5307	1 - To supply & install the COUNTER TOP - VANITY - MASTER BATHROOM - 2CM QUARTZ COUNTER TOP - UPGRADE LEVEL 2 in lieu of the standard quartz.. see colour chart for details	
Line 69135	Note: Purchaser has upgraded to an under mount sink... see sep. upgrade	
21Jan22 / 21Jan22		

HARDWOOD

Inv.5307	1 - As per schedule "PE": Vendor agrees to supply and install hardwood flooring in the upper hallway from standard samples of the vendor. This promotion has no cash value, is non-neotiable and non-transferrable.	
Line 69124	Note:	
21Jan22 / 21Jan22		
Inv.5307	1 - To supply & install the 5" Elements HARDWOOD in the MASTER BEDROOM -in lieu of the standard carpet... see colour chart for details.	
Line 69129	Note:	
21Jan22 / 21Jan22		
Inv.5307	1 - To supply & install the 5" Elements HARDWOOD in BEDROOM # 2 in lieu of the standard carpet... see colour chart for details.	
Line 69130	Note:	
21Jan22 / 21Jan22		
Inv.5307	1 - To supply & install the 5" Elements HARDWOOD in BEDROOM # 3 in lieu of the standard carpet... see colour chart for details.	
Line 69131	Note:	
21Jan22 / 21Jan22		

MISCELLANEOUS

Inv.5307	1 - As per schedule "PE": \$7,500 includes HST in decor dollars. this offer is non-negotiable, non-transferrable and has no cash vaue.	
Line 69126	Note:	
21Jan22 / 21Jan22		

PLUMBING

Inv.5307	1 - To supply & install the Blanco QUATRUS U 1 3/4 under mount sink in the kitchen model 401244 in lieu of the standard under mount kitchen sink... see spec's	
Line 69127	Note: Still to install the standard single hole kitchen faucet.	
21Jan22 / 21Jan22		
Inv.5307	3 - To supply and install the CONTRAC CATENA under mount bathroom sinks modle 4210CLY in the powder room, master ensuite and main bathroom... see spec's	
Line 69128	Note: Still to install the standard lav faucets	
21Jan22 / 21Jan22		

TILE - FLOOR

Kingsmen (Islington) Inc. / 9560 Islington

Lot/Unit: U224 Block 2 Phase/Building: 1 Model/Floor Plan: The Lisbon - 3 Bed (B8)

Inv.5307	1 - To supply & install the UPGRADE 3 - FLOOR TILE - stacked - POWDER ROOM TILE... see sketch # 1 for installation direction.	
Line 69149	Note:	
21Jan22 / 21Jan22		
Inv.5307	1 - To supply & install the UPGRADE 3 - FLOOR TILE - stacked - MAIN BATHROOM TILE... see sketch # 2 for installation direction.	
Line 69150	Note:	
21Jan22 / 21Jan22		
Inv.5307	1 - To supply & install the UPGRADE 3 - FLOOR TILE - stacked - MASTER BATHROOM TILE... see sketch # 2 for installation direction.	
Line 69151	Note:	
21Jan22 / 21Jan22		

TILE - WALL

Inv.5307	1 - To supply & install UPGRADE 3 - WALL TILE - HORIZONTAL STACKED - MAIN BATHROOM WALL TILE in lieu of the standard wall tiles.	
Line 69152	Note:	
21Jan22 / 21Jan22		
Inv.5307	1 - To supply & install UPGRADE 3 - WALL TILE - HORIZONTAL STACKED - MASTER ENSUITE SHOWER BATHROOM WALL TILE in lieu of the standard wall tiles.	
Line 69153	Note:	
21Jan22 / 21Jan22		

EXTRAS AS PER OFFER

5 Appliances including Stainless Steel Fridge, Stove, Dishwasher and white Washer / Dryer, from the standard offer of the Vendor. This promotion has no cash value, is non-negotiable and non-transferrable. Worksheet Note:	
Vendor agrees to supply and install hardwood flooring in the upper hallway from standard samples of the Vendor. This promotion has no cash value, is non-negotiable and non-transferrable. Worksheet Note:	
Vendor agrees to supply and install quartz or granite countertops in kitchen and all bathrooms from standard samples of the Vendor. This promotion has no cash value, is non-negotiable and non-tranferrable. Worksheet Note:	

Purchaser: RACHAEL ANNE CAUCHI Property: U224 Block 2 of Plan -
Telephone Res. / Bus: / Project: Kingsmen (Islington) Inc.
Decor Advisor: Barbara Coccia Model and Elevation: The Lisbon - 3 Bed (B8)
Layout Changes: Yes No Sketch Attached: Yes No Exterior Colour Scheme:

1. Cabinetry
Table with 4 columns: Room, Style and Colour, Counter Top, Hardware. Rows include Kitchen / Breakfast, Kitchen Island, Laundry Room, Powder Room, Main Bathroom, Master Ensuite Bathroom, Second Ensuite Bathroom (If Applicable).

Appliances: Custom Size Fridge, Valance Lighting, Microwave / Range Hood, Cooktop / Rangetop, Built in Wall Oven, Slide-in Range.
Comment:

2. Flooring

Table with 2 columns: Room, Selection. Rows include Main Hall, Back Hall, Breakfast, Laundry Room, Kitchen, Powder Room, Main Bathroom, Master Ensuite Bathroom (If Applicable), Mud Room, Master Ensuite Shower, Living Room, Dining Room, Family / Great Room, Den / Library / Study, Basement Landing (If Applies), Lower Landing (If Applicable), Upper Landing, Upper Hall, Master Bedroom, Bedroom #2, Bedroom #3, Bedroom #4, Bedroom #5.

Purchaser: RACHAEL ANNE CAUCHI
Telephone Res. / Bus: /
Decor Advisor: Barbara Coccia
Property: U224 Block 2 of Plan -
Project: Kingsmen (Islington) Inc.
Model and Elevation: The Lisbon - 3 Bed (B8)

2. Flooring - Continued -

Upgrade Underpad
Type
Area
Carpet on Stairs
Capped
Runner - *Upgrade
Comment

3. Plumbing Fixtures / Faucets

Kitchen
Master Ensuite
Main Bathroom
Second Ensuite
Powder Room
Other Room
Comment
Purchaser has upgraded the kitchen sink, see invoice for details. Still to install the standard single hole kitchen faucet.
Purchaser has upgraded to under mount sinks in all bathrooms, see invoice for details, still to install the standard lav. faucets.

4. Wall Tile

Tile Selection
Listello
Insert
Insert Selection
Main Bathroom
Master Ensuite
Tub Deck
Tub Apron
Tub Surround
Shower Stall
Second Ensuite
Kitchen Backsplash
Complete Backsplash
Comment
Bathroom wall tiles con't: horizontally stacked in both main and master bathroom where applicable.

5. Fireplace

Living Room
Family Room
Other Room - Specify
Purchased
As Per Plan
N/A
Fireplace Type
Mantle Type
Over Mantle
Colour / Stain
Surround
Hearth
Comment

Initial: RL

Purchaser: RACHAEL ANNE CAUCHI

Property: U224 Block 2 of Plan -

Telephone Res. / Bus: /

Project: Kingsmen (Islington) Inc.

Decor Advisor: Barbara Coccia

Model and Elevation: The Lisbon - 3 Bed (B8)

6. Trim Carpentry

Door Hardware: Standard handle

Interior Trim: Standard

Comment:

Interior Doors

☐ 2 Panel Arch Top

☒ 2 Panel Square Top

☐ 6 Panel

Initial for Door Style: Re

7. Railings and Pickets

Railing Package: Standard Metal picket package

Railing Colour: Elements Stonecrop

Picket Colour: BLACK

Wood Stairs: ☐ No ☒ Oak

Tread Colour: Elements Stonecrop

Comment:

8. Plaster Mouldings and Medallions

Foyer: /

Main Hall: /

Living Room: /

Dining Room: /

Family Room: /

Kitchen/Breakfast: /

Den/Library: /

Lower Landing: /

Comment:

9. Wall Paint

Kingsmen White

Smooth Ceilings

☐ First Floor

☐ First Floor incl. Second Floor Hall

☐ First and Second Floor

☒ Throughout

☐ Not Applicable

Trim Paint: Kingsmen White

10. Additional Comments

11. Disclaimers and Notes

- Colours of all materials are as close as possible to builder's selection, but not necessarily identical due to variances in manufacturing.
- Any extras listed above are null and void unless accompanied by a separate invoice/amendment. Said invoice must be paid in full.
- The Purchaser acknowledges that after Interior Colour Selection form is signed and dated, no further changes will be permitted other than re-selection due to unavailability. Re Purchaser's Initials
- The Purchaser acknowledges reading and accepting the "Kingsmen Group Décor Centre Disclaimers" form. This document contains other miscellaneous disclaimers.

This Interior Colour Selection is final and approved by:

Purchaser:

Signature: Rachael Cauchi Date: 01/21/22

Vendor:

Kingsmen (Islington) Inc.

RECEIVED

JAN 21 2022

Jan 24, 22

KINGSIIEN

B8 THE LISBON

SKYLINE COLLECTION

1625 SQ. FT.

TERRACE 451 SQ. FT. | 3 BED, 2 + 1 BATH

Lot: U224 Bk: 2
9560 Islington
Sketch #2

9560
ISLINGTON

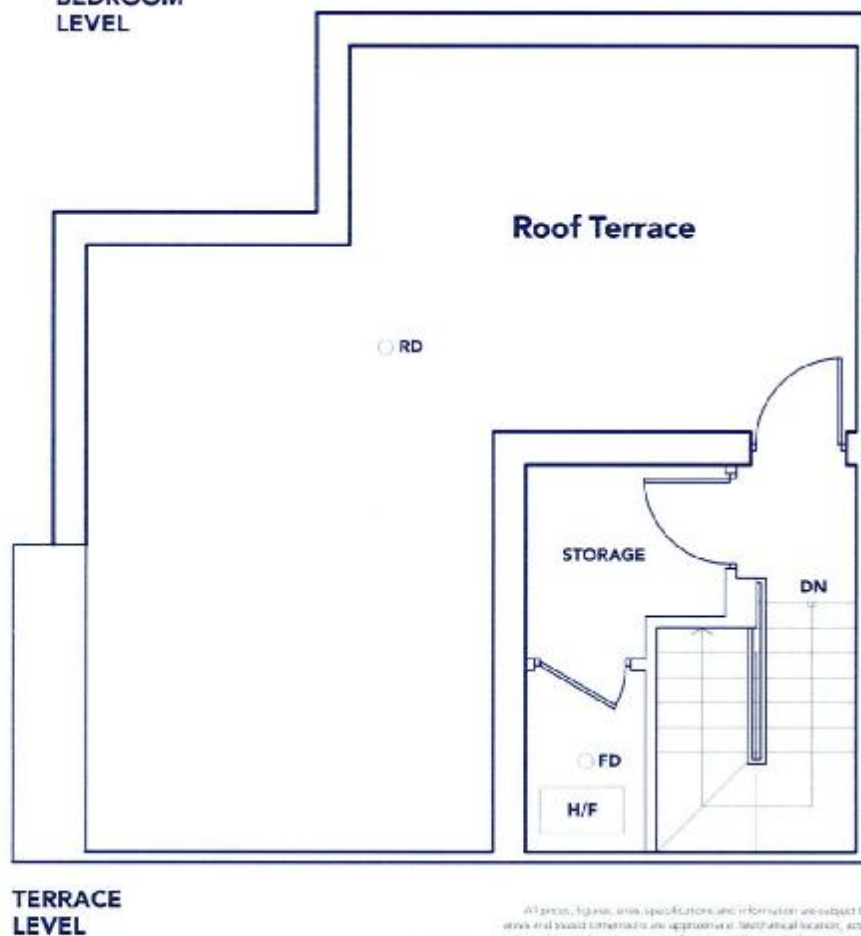
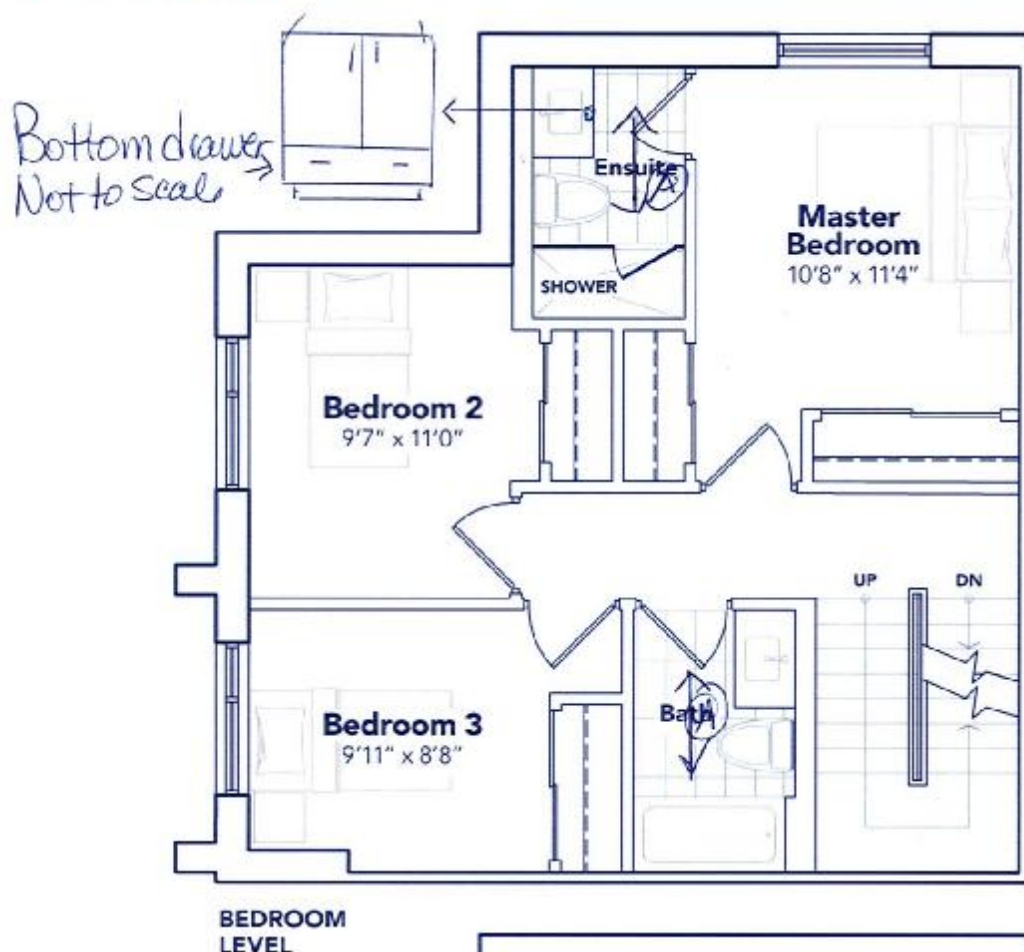

All prices, fixtures, finish specifications and information are subject to change without notice. All areas and build dimensions are approximate. Electrical location, accessible floor space, living area and square footage may vary from stated floor area. Illustrations are artist's conceptions. E. & O. E.

KINGSTON

D. Reed

Lot: 0224 Block #2
Re: UPG. Undermount
Vanity Sinks for all
Bathrooms.

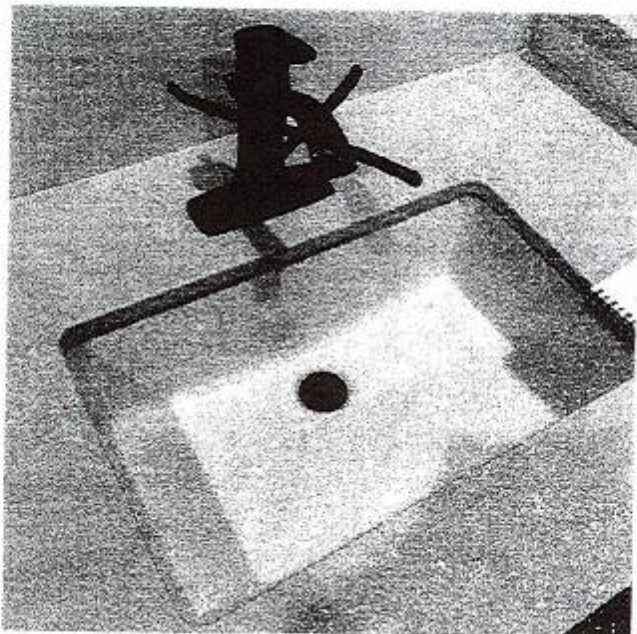

DISPLAY ITEMS

Sink (Item 9)

Contrac Catena Undermount
Model 4210CIY

or Rebuilt

9560
ISLAND

KINGSIIEN
GROUP INC.

Lot: U224 Block #2
Re: UPG. Kitchen Sink



QUATRUS U 1 $\frac{3}{4}$

German engineered with 304 series, 18-gauge stainless steel

Zero-radius corners; X-pattern drain grooves

Double bowl configuration for easy multi-tasking

18% chrome-nickel content for exceptional luster, durability and strength

Undermount installation

Minimum cabinet size: 36"

Model #401244

R. R. R. R. R.

BLANCO