



CONSTRUCTION SUMMARY

Kingsmen (Islington) Inc. / 9560 Islington

Lot/Unit: U251 Block 4    Phase/Building: 1    Model/Floor Plan: The Santorini - 2 Bed+Den (C2-2B)

COUNTER TOP

Inv.5552	1 - As per Schedule "PE": Vendor agrees to supply and install quartz or granite counter tops in kitchen from standard samples of the Vendor. This promotion has no cash value, is non-negotiable and non-transferrable.	
Line 70771	Note:	
14Apr22 / 26Apr22		

ELECTRICAL

Inv.5552	1 - As per Schedule "PE": The purchaser acknowledges all electrical has been completed at the time of execution of this agreement. No further electrical changes can be made. Total cash value of electrical upgrades was \$3335.00 (EXCLUDING HST).	
Line 70770	Note: This offer is non-negotiable, non-transferrable and has no cash value.	
14Apr22 / 26Apr22		

PLUMBING

Inv.5552	1 - To supply and install the standard TOPMOUNT RECTANGLE SINKS IN ALL BATHROOMS (PWD, MASTER AND SECOND ENSUITE), as per plan	
Line 70896	Note:	
14Apr22 / 26Apr22		

EXTRAS AS PER OFFER

Vendor agrees to supply and install quartz or granite countertops in kitchen from standard samples of the Vendor. This promotion has no cash value, is non-negotiable and non-tranferrable. Worksheet    Note:	
The purchaser acknowledges all electrical has been completed at the time of execution of this agreement. No further electrical changes can be made. Total cash value of electrical upgrades was \$3335.00 (excluding HST). This offer is non-negotiable, non-tr Worksheet    Note:	

MISC

5 Appliances including Stainless Steel Fridge, Stove, Dishwasher and white Washer / Dryer, from the standard offer of the Vendor. This promotion has no cash value, is non-negotiable and non-transferrable. Worksheet    Note:	
------------------------------------------------------------------------------------------------------------------------------------------------------------------------------------------------------------------------------------	--

KINGSMEN

INTERIOR COLOUR SCHEME

9860-251

\*\*\* NOTE: This is not an approved document. Document must be locked \*\*\*

Purchaser: DANIAL UMAR  
Telephone Res. / Bus: /  
Decor Advisor: Barbara Coccia  
Layout Changes: ☐ Yes ☒ No  
Property: U251 Block 4 of Plan -  
Project: Kingsmen (Islington) Inc.  
Model and Elevation: The Santorini - 2 Bed+Den (C2-2B)  
Sketch Attached: ☒ Yes ☐ No  
Exterior Colour Scheme:

1. Cabinetry	Style and Colour	Counter Top	Hardware
Kitchen / Breakfast	Trinity DHGL Arctic Gloss MWP	#1 C/S #3040 Cement 3cm	12881 HANDLE
Kitchen Island	Trinity DHGL Arctic Gloss MWP	#1 C/S #3040 Cement 3cm	12881 HANDLE
Laundry Room	/	/	/
Powder Room	Trinity DHGL Arctic Gloss MWP	Calcutta Marble 4925k-07	135 KNOB
Main Bathroom	/	/	/
Master Ensuite Bathroom	Trinity DHGL Arctic Gloss MWP	Calcutta Marble 4925k-07	135 KNOB
Second Ensuite Bathroom (If Applicable)	Trinity DHGL Arctic Gloss MWP	Calcutta Marble 4925k-07	135 KNOB

Appliances Custom Size Fridge Valance Lighting Microwave / Range Hood  
☐ Yes ☒ No ☐ Yes ☒ No ☐ Yes ☒ No  
Cooktop / Rangetop Built in Wall Oven Slide-in Range  
☐ Yes ☒ No ☐ Yes ☒ No ☐ Yes ☒ No  
Comment

2. Flooring

	Selection
Main Hall	/
Back Hall	/
Breakfast	/
Laundry Room	13X13" Cinq Grey
Kitchen	5" Kentwood Brushed Oak Coho
Powder Room	13x13" Malena Ice
Main Bathroom	(Second Ensuite)-13x13" Cinq Black
Master Ensuite	13x13" Cinq Black
Bathroom (If Applicable)	/
Mud Room	/
Master Ensuite SH/FL	2X2" Ontario Snow White Matte
Living Room	5" Kentwood Brushed Oak Coho
Dining Room	5" Kentwood Brushed Oak Coho
Family / Great Room	/
Den / Library / Study	5" Kentwood Brushed Oak Coho
Basement Landing (If Applies)	
Lower Landing (If Applicable)	5" Kentwood Brushed Oak Coho
Upper Landing	5" Kentwood Brushed Oak Coho
Upper Hall	5" Kentwood Brushed Oak Coho
Master Bedroom	Remarkable Quality: 956 Gypsy
Bedroom #2	Remarkable Quality: 956 Gypsy
Bedroom #3	/
Bedroom #4	/
Bedroom #5	/
Master Ens. Shower Jamb	Anatolia Marmiline SNOW

Flooring Continued on Page 2



Initial: DU

9560-251

KINGSMEN

INTERIOR COLOUR SCHEME

\*\*\* NOTE: This is not an approved document. Document must be locked \*\*\*

Purchaser: DANIAL UMAR  
Telephone Res. / Bus: /  
Decor Advisor: Barbara Coccia  
2. Flooring - Continued -

Property: U251 Block 4 of Plan -  
Project: Kingsmen (Islington) Inc.  
Model and Elevation: The Santorini - 2 Bed+Den (C2-2B)

Upgrade Underpad	Type STANDARD	Area MASTER AND BEDROOM #2
Carpet on Stairs	Capped	Runner - *Upgrade
Comment		

3. Plumbing Fixtures / Faucets



Kitchen	Standard	Second Ensuite	Standard	Powder Room	Standard
Master Ensuite	Standard			Other Room	/
Main Bathroom	/				

Comment

Note: To supply and install the standard undermount kitchen sink, with the standard faucet in the kitchen. To supply and install the standard topmount sinks, as per plan in all bathrooms, with the standard faucets.

4. Wall Tile

	Tile Selection	Listello	Insert	Insert Selection
Main Bathroom	/	<input type="checkbox"/>	<input type="checkbox"/>	
Master Ensuite				
Tub Deck	/	<input type="checkbox"/>	<input type="checkbox"/>	
Tub Apron	/	<input type="checkbox"/>	<input type="checkbox"/>	
Tub Surround	/	<input type="checkbox"/>	<input type="checkbox"/>	
Shower Stall	8x10" Cinq Grey	<input type="checkbox"/>	<input type="checkbox"/>	
Second Ensuite	8x10" Cinq Grey	<input type="checkbox"/>	<input type="checkbox"/>	
	/	<input type="checkbox"/>	<input type="checkbox"/>	
	/	<input type="checkbox"/>	<input type="checkbox"/>	
Kitchen Backsplash	/	<input type="checkbox"/>	<input type="checkbox"/>	
Complete Backsplash	/	<input type="checkbox"/>	<input type="checkbox"/>	
Comment	/			

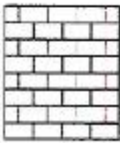
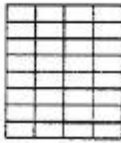

horizontal stacked

brick pattern

vertical stacked

diagonal/diamond

5. Fireplace

	Living Room			Family Room			Other Room - Specify		
	Purchased	As Per Plan	N/A	Purchased	As Per Plan	N/A	Purchased	As Per Plan	N/A
Fireplace Type	<input type="radio"/>	<input type="radio"/>	<input checked="" type="radio"/>	<input type="radio"/>	<input type="radio"/>	<input checked="" type="radio"/>	<input type="radio"/>	<input type="radio"/>	<input checked="" type="radio"/>
Mantle Type									
Over Mantle									
Colour / Stain									
Surround									
Hearth									
Comment	/								



OS  
DU

Initial: \_\_\_\_\_



**KINGSMEN****INTERIOR COLOUR SCHEME****\*\*\* NOTE: This is not an approved document. Document must be locked \*\*\***

**Purchaser:** DANIAL UMAR  
**Telephone Res. / Bus:** /  
**Decor Advisor:** Barbara Coccia

**Property:** U251 Block 4 of Plan -  
**Project:** Kingsmen (Islington) Inc.  
**Model and Elevation:** The Santorini - 2 Bed+Den (C2-2B)

**6. Trim Carpentry**

**Door Hardware** STANDARD HANDLE  
**Interior Trim** STANARD  
**Comment**  
/

**Interior Doors**

- ☐ 2 Panel Arch Top  
☒ 2 Panel Square Top  
☐ 6 Panel



Initial for Door Style

DS  
DU**7. Railings and Pickets**

**Railing Package** Standard Metal Package  
**Railing Colour** KENTWOOD COHO  
**Wood Stairs** ☐ No ☒ Oak  
**Comment**  
/

**Picket Colour** Black Metal  
**Tread Colour** KENTWOOD COHO

**8. Plaster Mouldings and Medallions**

**Foyer** / /  
**Main Hall** / /  
**Living Room** / /  
**Dining Room** / /  
**Family Room** / /  
**Comment**  
/

**Kitchen/Breakfast** / /  
**Den/Library** / /  
**Lower Landing** / /  
/ / /

**9. Wall Paint**

Kingsmen White

- Smooth Ceilings** ☐ First Floor  
☐ First Floor incl. Second Floor Hall  
☐ First and Second Floor  
☒ Throughout  
☐ Not Applicable

**Trim Paint** Kingsmen White**10. Additional Comments****11. Disclaimers and Notes**

- Colours of all materials are as close as possible to builder's selection, but not necessarily identical due to variances in manufacturing.
- Any extras listed above are null and void unless accompanied by a separate invoice/amendment. Said invoice must be paid in full.
- The Purchaser acknowledges that after Interior Colour Selection form is signed and dated, no further changes will be permitted other than re-selection due to unavailability. DU Purchaser's Initials
- The Purchaser acknowledges reading and accepting the "Kingsmen Group Décor Centre Disclaimers" form. This document contains other miscellaneous disclaimers.

This Interior Colour Selection is final and approved by:

**Purchaser:** Daniel Umar  
**Signature:** 000A7DC5EAED41A **Date:** 5/2/2022



**Vendor:** [Signature]  
Kingsmen (Islington) Inc. May 2/22

Page 3 of 3

**SCHEDULE "B-1"**  
**Floor Plan**

Townhouse No. **U251 Block 4**

### Phase 1

Model: The Santorini - 2 Bed+Den (C2-2B)

c:\prospect\ graphics\C2-1.bmp

9560: ISLINGTON UNIT 251 BLOCK 4  
RE:SKETCH #1

**C2 THE SANTORINI**  
SKYLINE COLLECTION

**1955 SQ. FT.**

PATIO 678 SQ. FT.

2 BED + DEN. 2 + 1 BATH

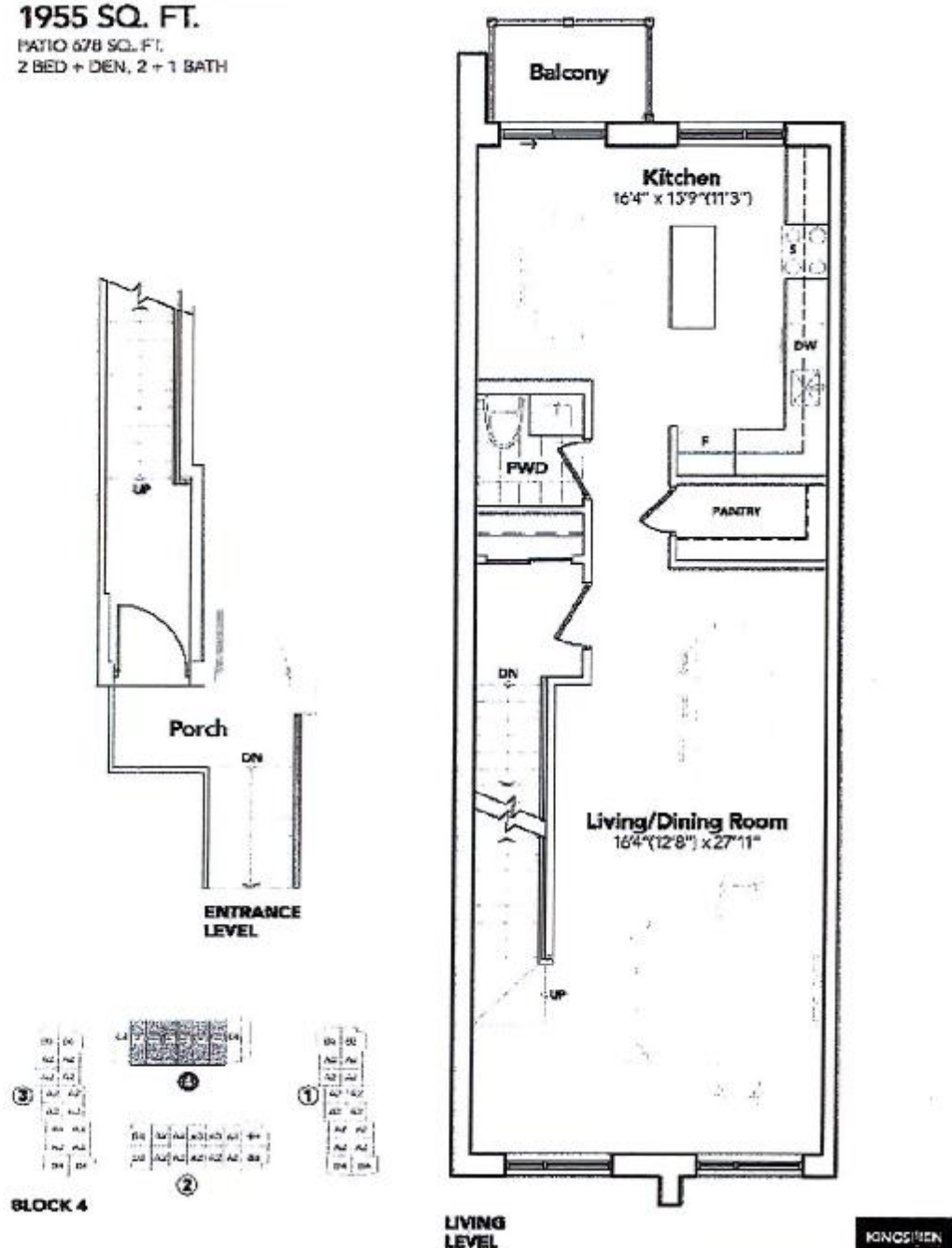

The floor plans and elevations shown are pre-construction plans and may be revised or improved as necessitated by architectural controls and the construction process. The measurements adhere to the rules and regulations of the TARIION Warranty Corporation's official method for the calculation of floor area. Materials, specifications and floor plans are subject to change without notice. All house renderings are artist's concept only. Actual usable floor space may vary from the stated floor area. All options shown are upgrades. E. & O. E.

-DocuSigned by:

Daniel Umar

