

KINGSMEN (THAMES) INC. / Havelock Corners (Kingsmen)

Lot/Unit: 14    Phase/Building: 5A    Model/Floor Plan: Robert (3604) Elev C 4 Bed - 2+1 Bath

CABINETRY APPLIANCE - FRIDGE

Inv.5595	1 - To supply & install the 66CM DEEP FRIDGE ENCLOSURE - COUNTER DEPTH WITH - 1 WALL - 1 66CM DEEP GABLE AND 1 66CM DEEP CABINET - THIS IS NOT A ZERO CLEARANCE ENCLOSURE. STANDARD HEIGHTS AND WIDTHS WILL BE USED. -see sketch # 1	
Line 71362	Note: See fridge spec's attached.	
6May22 / 9May22		

CABINETRY BASE CABINETS

Inv.5595	1 - To accomodate for a 36" stove opening in lieu of the standard 30" stove opening....	
Line 71314	Note:	
6May22 / 9May22		
Inv.5595	1 - To supply & install the BASE PIE CUT CORNER - in the kitchen... see sketch # 1	
Line 71316	Note:	
6May22 / 9May22		
Inv.5595	1 -	
Line 71317	Note:	
6May22 / 9May22		
Inv.5595	1 - To supply & install the 45CM WIDE PULL-OUT DOOR BASE CABINET WASTE - RECYCLE CENTRE 2 35L BINS - AVAILABLE ONLY WITH 45CM WIDE CABINET - CLASSIC SERIES in the kitchen...see sketch # 1	
Line 71318	Note:	
6May22 / 9May22		

CABINETRY HOOD FANS

Inv.5595	1 -	
Line 71311	Note:	
6May22 / 9May22		
Inv.5595	1 - To supply & install the HOOD FAN - PRO COLLECTION (SCB72236) WALL MOUNT RANGE HOOD WITH 650 CFM FAN - 36 INCH in lieu of the standard hood fan... see spec's	
Line 71312	Note:	
6May22 / 9May22		
Inv.5595	1 - To accomodate for the upgraded 36" chimney hood fan in the kitchen.	
Line 71313	Note:	
6May22 / 9May22		

CABINETRY MICROWAVE OVEN STOVE COOKTOP

Inv.5595	1 - To accomodate for the future 36" COOKTOP CABINET WITH FALSE TOP DRAWER AND POTS AND PANS DRAWERS BELOW - SUPPLY SPECS - - CLASSIC SERIES in the kitchen... see spec's	
Line 71364	Note:	
6May22 / 9May22		
Inv.5595	1 - To supply & install accomodations for the future BUILT-IN TALL APPLIANCE CABINET WITH DRAWER CLASSIC SERIES in the kitchen... see sketch # 1 ... see spec's	
Line 71366	Note:	
6May22 / 9May22		

**KINGSMEN (THAMES) INC. / Havelock Corners (Kingsmen)**

**Lot/Unit: 14    Phase/Building: 5A    Model/Floor Plan: Robert (3604) Elev C 4 Bed - 2+1 Bath**

**CABINETRY VANITY**

Inv.5595	2 - To supply & install a VANITY - LOWER DRAWER CLASSIC SERIES in the powder room... see sketch # 1	
Line 71319	Note:	
6May22 / 9May22		
Inv.5595	2 - To supply & install a VANITY - LOWER DRAWER CLASSIC SERIES in the main bathroom... see sketch # 1	
Line 71320	Note:	
6May22 / 9May22		
Inv.5595	1 - To upply & install a VANITY BANK OF DRAWERS CLASSIC SERIES in the master ensuite bathroom... see sketch # 2	
Line 71321	Note:	
6May22 / 9May22		
Inv.5595	1 - To INCREASE VANITY TO KITCHEN HEIGHT - MAINTAINS VANITY DEPTH - CLASSIC SERIES in the powder room in lieu of the standard vanity height.	
Line 71322	Note:	
6May22 / 9May22		
Inv.5595	1 - To INCREASE VANITY TO KITCHEN HEIGHT - MAINTAINS VANITY DEPTH - CLASSIC SERIES in the main bathroom in lieu of the standard vanity height.	
Line 71323	Note:	
6May22 / 9May22		
Inv.5595	1 - To INCREASE VANITY TO KITCHEN HEIGHT - MAINTAINS VANITY DEPTH - CLASSIC SERIES in the master ensuite bathroom in lieu of the standard vanity height.	
Line 71324	Note:	
6May22 / 9May22		

**CABINETRY WALL AND HUTCH**

Inv.5595	1 - To supply & install the UPPER ANGLE CORNER PER UNIT - in the kitchen... see sketch # 1	
Line 71315	Note:	
6May22 / 9May22		

**COUNTER TOP**

Inv.5595	1 - As per schedule "PE" Vendor to include level 1, 2cm. quartz in all bathrooms, as per plan, in lieu of the included laminatd counter tops. Selections to be made from builders standard samples.	
Line 71306	Note:	
6May22 / 9May22		

**COUNTER TOP - KITCHEN**

Inv.5595	1 - To accomodate the quartz countertop for the 36" cook top ... see spec's	
Line 71365	Note:	
6May22 / 9May22		

**ELECTRICAL**

**KINGSMEN (THAMES) INC. / Havelock Corners (Kingsmen)**

**Lot/Unit: 14    Phase/Building: 5A    Model/Floor Plan: Robert (3604) Elev C 4 Bed - 2+1 Bath**

Inv.5595	1 - TO SUPPLY AND INSTALL EXTRA 240 STOVE PLUG for the future built in microwave/wall oven...see spec's	
Line 71367	Note:	
6May22 / 9May22		
Inv.5595	1 - To SUPPLY AND INSTALL AN ADDITIONAL BASIC RECEPTACLE (NOT DEDICATED) at approx. 66" + - up from the floor centered + - to the F/P mantle in the great	
Line 71360	Note: room... see sketch # 1 THIS IS FOR A FUTURE WALL MOUNT T.V.	
6May22 / 9May22		
Inv.5595	1 - To SUPPLY AND INSTALL CONDUIT FOR TV OVER THE FIREPLACE at approx. 66" + - up from the floor, centered + - to the F/P mantle and TERMINATED IN SAME ROOM next to + - to the std. T.V. Phone rough in in the great room..see sketch # 2	
Line 71361	Note: THIS IS FOR A FUTURE WALL MOUNT T.V.	
6May22 / 9May22		
Inv.5595	1 - To supply & install the standard T.V. rough in in the great room and master bedroom.. see sketch # 1 & # 2	
Line 71308	Note:	
6May22 / 9May22		
Inv.5595	1 - To supply & install the standard Phone ( CAT 5 ) . rough in in the great room, master bedroom and living room area .. see sketch # 1 & # 2	
Line 71309	Note:	
6May22 / 9May22		
Inv.5595	2 - To SUPPLY AND INSTALL EXTRA CEILING BOX ROUGH IN CAPPED connected to a sep. switch over the kitchen island... see sketch # 1	
Line 71310	Note:	
6May22 / 9May22		

**HARDWOOD**

Inv.5595	1 - To supply & install the 3 1/2" Elements Oak Engineered hardwood on the main floor where applicable in an upgraded colour in lieu of the standard as per APS.. see colour chart for details.	
Line 71328	Note:	
6May22 / 9May22		
Inv.5595	1 - To supply & install the 3 1/2" Elements Oak engenieered hardwood in living room area in lieu of the standard carpet. see colour chart for details.	
Line 71329	Note:	
6May22 / 9May22		
Inv.5595	1 - To supply & install the 3 1/2" Elements Oak engenieered hardwood to the upper hallway area in lieu of the standard carpet. see colour chart for details.	
Line 71330	Note:	
6May22 / 9May22		

**HEATING AND AIR CONDITIONING**

Inv.5595	1 - As per schedule "PE" Vendor to install capped gas line ( rough in only ) at rear of home for future BBQ location. Location to be finalized at vendors sole discretion	
Line 71304	Note:	
6May22 / 9May22		

KINGSMEN (THAMES) INC. / Havelock Corners (Kingsmen)

Lot/Unit: 14    Phase/Building: 5A    Model/Floor Plan: Robert (3604) Elev C 4 Bed - 2+1 Bath

Inv.5595	1 - As per schedule "PE" Vendor to supply & install air conditioning unit, sized accordingly, from vendors standard samples.	
Line 71305	Note:	
6May22 / 9May22		

HVAC

Inv.5595	1 - To supply & install a capped- GAS LINE FOR STOVE rough in only, with an electrical outlet for a future gas cooktop....	
Line 71307	Note:	
6May22 / 9May22		

MISCELLANEOUS

PAINT AND DRYWALL

Inv.5595	2 - To supply & install - STAIN RAILINGS AND PICKETS (PER FLIGHT) in lieu of the standard natural... see colour chart for details.	
Line 71331	Note:	
6May22 / 9May22		
Inv.5595	2 - To supply & install PAINT EXTRAS - STAIN STAIRS (EXCLUDING RAILINGS) (PER FLIGHT - OAK) throughout where applicable in lieu of the standard natural..see colour chart for details	
Line 71332	Note:	
6May22 / 9May22		

PLUMBING

Inv.5595	1 - To supply & install a WATERLINE ROUGH-IN TO THE FRIDGE LOCATION (NO HOOK UP) in the kitchen...	
Line 71363	Note:	
6May22 / 9May22		
Inv.5595	1 - To supply & install the KITCHEN SINK - BLANCO QUATRUS U2 DBL UNDERMOUNT- MODEL 401247 in the kitchen in lieu of the standard top mount kitchen sink.... see spec's	
Line 71325	Note: Still to install the standard single hole kitchen faucet, NO PLATE.	
6May22 / 9May22		
Inv.5595	1 - To supply & install the KITCHEN SOAP Dispencer - MOEN CHROME - MODEL 3942 in the kitchen... see spec's, see sketch # 2 for installation location.	
Line 71326	Note:	
6May22 / 9May22		
Inv.5595	4 - To supply & install the VANITY SINK - CONTRAC CATENA UNDERMOUNT - MODEL 4210CIY in the powder room, main bathroom and master ensuite bathroom in lieu of the standard top mount vanity sinks... see spec's	
Line 71327	Note: Still to install the standard lav facuets.	
6May22 / 9May22		



CONSTRUCTION SUMMARY

KINGSMEN (THAMES) INC. / Havelock Corners (Kingsmen)

Lot/Unit: 14    Phase/Building: 5A    Model/Floor Plan: Robert (3604) Elev C 4 Bed - 2+1 Bath

EXTRAS AS PER OFFER

5 FREE APPLIANCES – STAINLESS STEEL FRONT - FRIDGE: STOVE AND DISHWASHER. WHITE WASHER AND DRYER (SUPPLIED ONLY, NOT INSTALLED, FROM BUILDERS STANDARD LINE). AN APPLIANCES VOUCHER WILL BE GIVEN BY OUR DECOR CONSULTANT AT THE TIME OF BOOKING YOUR COLOUR A <i>Worksheet</i> Note:	
VENDOR TO INSTALL CAPPED GAS LINE (ROUGH-IN ONLY) AT REAR OF HOME FOR FUTURE BBQ LOCATION.    LOCATION TO BE FINALIZED AT VENDORS SOLE DISCRETION. <i>Worksheet</i> Note:	
VENDOR TO SUPPLY & INSTALL AIR CONDITIONING UNIT, SIZED ACCORDINGLY, FROM VENDORS STANDARD SAMPLES. <i>Worksheet</i> Note:	
VENDOR TO INCLUDE LEVEL 1, 2CM QUARTZ IN ALL BATHROOMS, AS PER PLAN, IN LIEU OF THE INCLUDED LAMINATE COUNTER TOPS.    SELECTIONS TO BE MADE FROM BUILDERS STANDARD SAMPLES. <i>Worksheet</i> Note:	



Purchasers:

Telephone Res. / Bus:

Decor Advisor:

Layout Changes:

KULJINDER SINGH BRAR & GURPREET KAUF

(647) 548-7020 /

Barbara Coccia

☐ Yes ☒ No

Property:

Project:

Model and Elevation:

Exterior Colour Scheme:

14 of Plan - Draft Approval SB17-03-08

KINGSMEN (THAMES) INC.

Robert (3604) Elev C 4 Bed - 2+1 Bath

1. Cabinetry	Style and Colour	Counter Top	Hardware
Kitchen / Breakfast	#3 Slab Silk Touch White Cloud	#1, C/S # 3040 Cement 3cm.	#12881 Handle
Kitchen Island	#3 Slab Silk Touch White Cloud	#1, C/S # 3040 Cement 3cm.	#12881 Handle
Laundry Room	/		
Powder Room	#3 Slab Silk Touch White Cloud	#1, C/S # 3040 Cement 2cm.	#12881 Handle
Main Bathroom	#3 Slab Silk Touch White Cloud	#1, C/S # 3040 Cement 2cm.	#12881 Handle
Master Ensuite Bathroom	#3 Slab Silk Touch White Cloud	#1, C/S # 3040 Cement 2cm.	#12881 Handle
Second Ensuite Bathroom (If Applicable)	/		
	/		
	/		

Appliances

Custom Size Fridge

Valance Lighting

Microwave / Range Hood

☒ Yes ☐ No

☐ Yes ☒ No

☐ Yes ☒ No

Cooktop / Rangetop

Built in Wall Oven

Slide-in Range

☒ Yes ☐ No

☒ Yes ☐ No

☐ Yes ☒ No

Comment

2. Flooring

	Selection
Foyer	13 x 13" Cinq Grey
Main Hall	* 3 1/2" Elements Oak Sturgeon
Back Hall	/
Breakfast	/
Laundry Room	13 x 13" Cinq Grey
Kitchen	13 x 13" Cinq Grey
Powder Room	13 x 13" Cinq Grey
Main Bathroom	13 x 13" Cinq Grey
Master Ensuite	13 x 13" Cinq Grey
Bathroom (If Applicable)	/
Mud Room	/
Master Ens. shower floor	2x2" Ontario Snow White Matte
Living Room	* 3 1/2" Elements Oak Sturgeon
Dining Room	* 3 1/2" Elements Oak Sturgeon
Family / Great Room	* 3 1/2" Elements Oak Sturgeon
Den / Library / Study	/
Basement Landing (If Applies)	13 x 13" Cinq Grey ( basement foyer )
Lower Landing (If Applicable)	/
Upper Landing	/
Upper Hall	* 3 1/2" Elements Oak Sturgeon
Master Bedroom	Modern Story 1 , #827 Perfect Neutral
Bedroom #2	Modern Story 1 , #827 Perfect Neutral
Bedroom #3	Modern Story 1 , #827 Perfect Neutral
Bedroom #4	Modern Story 1 , #827 Perfect Neutral
Bedroom #5	/
Master ensuite shower jamb	Anatolia Marmiline SNOW



Flooring Continued on Page 2

Initial:



Purchasers: KULJINDER SINGH BRAR & GURPREET KAUFProperty: 14 of Plan - Draft Approval SB17-03-08  
Telephone Res. / Bus: (647) 548-7020 / Project: KINGSMEN (THAMES) INC.  
Decor Advisor: Barbara Coccia Model and Elevation: Robert (3604) Elev C 4 Bed - 2+1 Bath  
2. Flooring - Continued -



Upgrade Underpad	Type Standard	Area Bedrooms
Carpet on Stairs	Capped	Runner - *Upgrade
Comment	/	/

3. Plumbing Fixtures / Faucets

Kitchen	Standard	Second Ensuite	/	Powder Room	Standard
Master Ensuite	Standard			Other Room	/
Main Bathroom	Standard				
Comment	Purchaser has upgraded to an under mount kitchen sink, still to install the standard kitchen faucet with NO PLATE. Purchaser has upgaded to under mount sinks in the bathrooms, still to install the standard lav faucets				

4. Wall Tile

	Tile Selection	Listello	Insert	Insert Selection
Main Bathroom	8x10" Cinq Grey	<input type="checkbox"/>	<input type="checkbox"/>	
Master Ensuite				
Tub Deck	13 x 13" Cinq Grey	<input type="checkbox"/>	<input type="checkbox"/>	
Tub Apron	13 x 13" Cinq Grey	<input type="checkbox"/>	<input type="checkbox"/>	
Tub Surround	13 x 13" Cinq Grey	<input type="checkbox"/>	<input type="checkbox"/>	
Shower Stall	8x10" Cinq Grey	<input type="checkbox"/>	<input type="checkbox"/>	
Second Ensuite	/	<input type="checkbox"/>	<input type="checkbox"/>	
	/	<input type="checkbox"/>	<input type="checkbox"/>	
	/	<input type="checkbox"/>	<input type="checkbox"/>	
Kitchen Backsplash	/	<input type="checkbox"/>	<input type="checkbox"/>	
Complete Backsplash	/	<input type="checkbox"/>	<input type="checkbox"/>	
Comment	Install the standard 8x10" wall tiles on the 10" side stacked horizontally where applicable to the main and master ensuite			

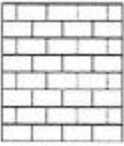
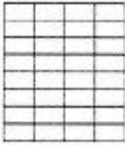

horizontal stackedbrick patternvertical stackeddiagonal/diamond

5. Fireplace

	Living Room			Family Room			Other Room - Specify		
	Purchased	As Per Plan	N/A	Purchased	As Per Plan	N/A	Purchased	As Per Plan	N/A
Fireplace Type	<input type="radio"/>	<input type="radio"/>	<input checked="" type="radio"/>	<input type="radio"/>	<input type="radio"/>	<input checked="" type="radio"/>	<input type="radio"/>	<input checked="" type="radio"/>	<input type="radio"/>
Mantle Type							Front Facing		
Over Mantle							NF-08		
Colour / Stain							/		
Surround							White		
Hearth							/		
Comment	/						/		

RECEIVED  
MAY 09 2022





**Purchasers:** KULJINDER SINGH BRAR & GURPREET KAUF **Property:** 14 of Plan - Draft Approval SB17-03-08  
**Telephone Res. / Bus:** (647) 548-7020 / **Project:** KINGSMEN (THAMES) INC.  
**Decor Advisor:** Barbara Coccia **Model and Elevation:** Robert (3604) Elev C 4 Bed - 2+1 Bath

### 6. Trim Carpentry

**Door Hardware** Standard handle

**Interior Trim** Standard

**Comment**

/

#### Interior Doors

☐ 2 Panel Arch Top

☒ 2 Panel Square Top

☐ 6 Panel



Initial for Door Style

SK

### 7. Railings and Pickets

**Railing Package** Standard Oak STRAIGHT picket package

**Railing Colour** \* Elements Sturgeon

**Picket Colour** \* Elements Sturgeon

**Wood Stairs** ☐ No ☒ Oak

**Tread Colour** \* Elements Sturgeon

**Comment**

/

### 8. Plaster Mouldings and Medallions

**Foyer** /   
**Main Hall** /   
**Living Room** /   
**Dining Room** /   
**Family Room** /

**Kitchen/Breakfast** /   
**Den/Library** /   
**Lower Landing** /

**Comment**

/

### 9. Wall Paint

Kingsmen White

#### Smooth Ceilings

☐ First Floor

☐ First Floor incl. Second Floor Hall

☐ First and Second Floor

☒ Throughout

☐ Not Applicable

**Trim Paint** Kingsmen White

### 10. Additional Comments

/

RECEIVED

MAY 09 2022

### 11. Disclaimers and Notes

- Colours of all materials are as close as possible to builder's selection, but not necessarily identical due to variances in manufacturing.
- Any extras listed above are null and void unless accompanied by a separate invoice/amendment. Said invoice must be paid in full.
- The Purchaser acknowledges that after Interior Colour Selection form is signed and dated, no further changes will be permitted other than re-selection due to unavailability.  Purchaser's Initials
- The Purchaser acknowledges reading and accepting the "Kingsmen Group Décor Centre Disclaimers" form. This document contains other miscellaneous disclaimers.

This Interior Colour Selection is final and approved by:

**Purchaser:**  **Date:** 9th May 2022

**Signature:**  **Date:** May 9, 2022 **Vendor:** 

KINGSMEN (THAMES) INC.

May 9, 22



Lot 14  
Phase 5A  
Model: Robert (3604) Elev C 4 Bed - 2+1 Bath  
Standard

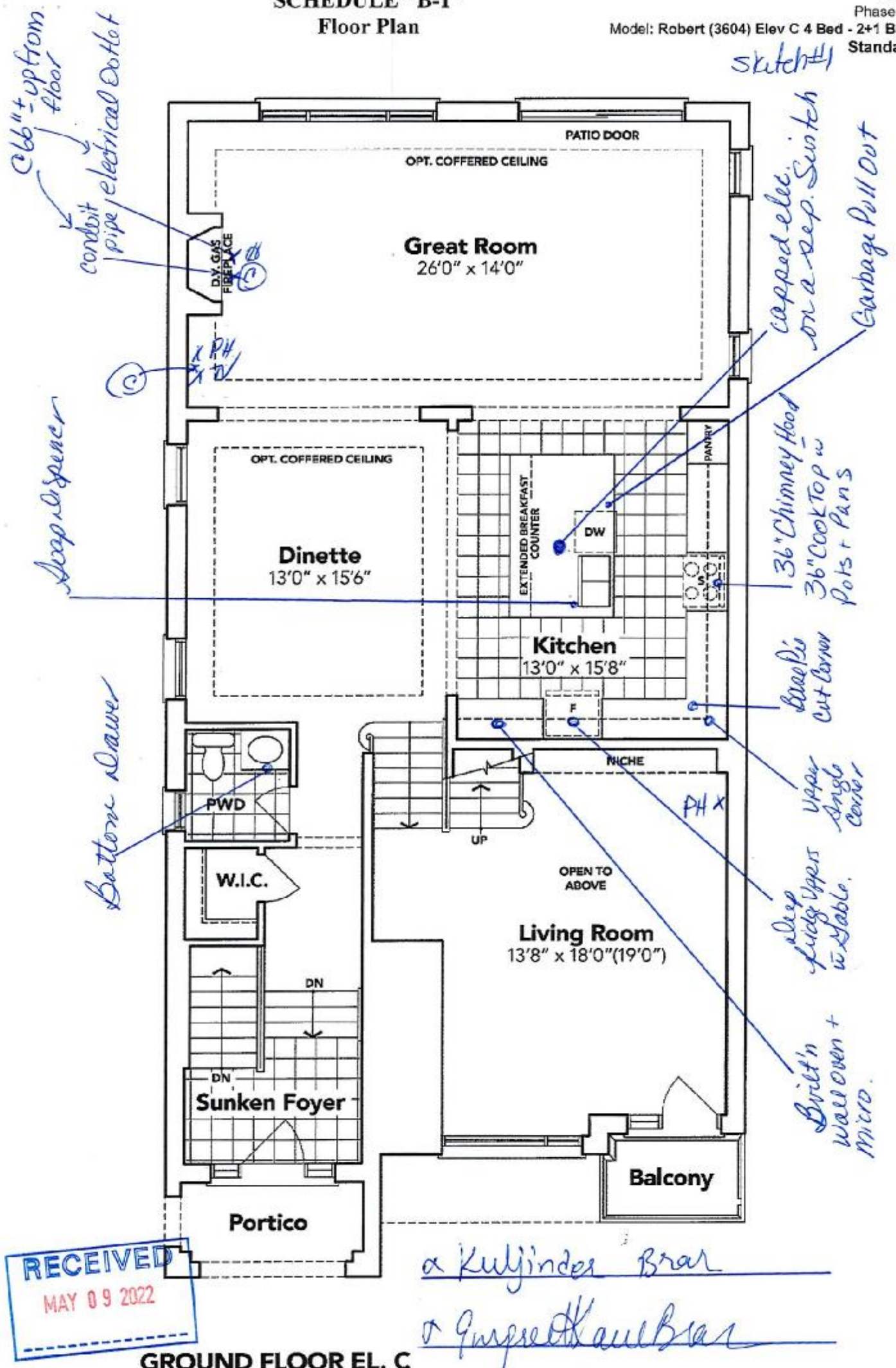

The floor plans and elevations shown are pre-construction plans and may be revised or improved as necessitated by architectural controls and the construction process. The measurements adhere to the rules and regulations of the TARIION Warranty Corporation's official method for the calculation of floor area. Materials, specifications and floor plans are subject to change without notice. All house renderings are artist's concept only. Actual usable floor space may vary from the stated floor area. All options shown are upgrades. E. & O. E.

**SCHEDULE "B-1"**  
**Floor Plan**

Lot 14  
Phase 5A  
Model: Robert (3604) Elev C 4 Bed - 2+1 Bath  
Standard

*Sketch #2*

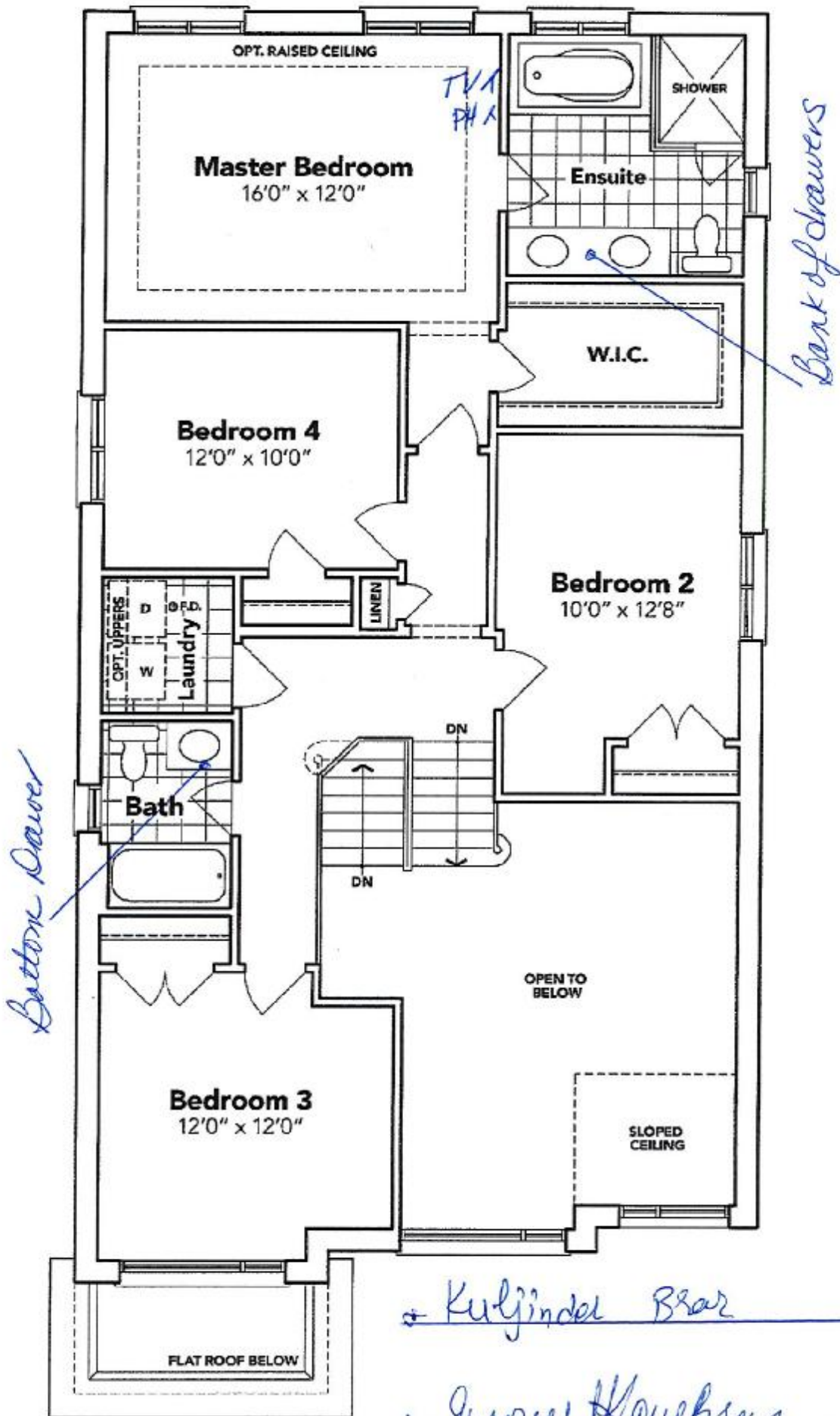

**SECOND FLOOR EL. C**

The floor plans and elevations shown are pre-construction plans and may be revised or improved as necessitated by architectural controls and the construction process. The measurements adhere to the rules and regulations of the TARION Warranty Corporation's official method for the calculation of floor area. Materials, specifications and floor plans are subject to change without notice. All house renderings are artist's concept only. Actual usable floor space may vary from the stated floor area. All options shown are upgrades. B. & O. E.



**SCHEDULE "B-1"**  
**Floor Plan**

Lot 14  
Phase 5A  
Model: Robert (3604) Elev C 4 Bed - 2+1 Bath  
Standard

*Sketch #3*

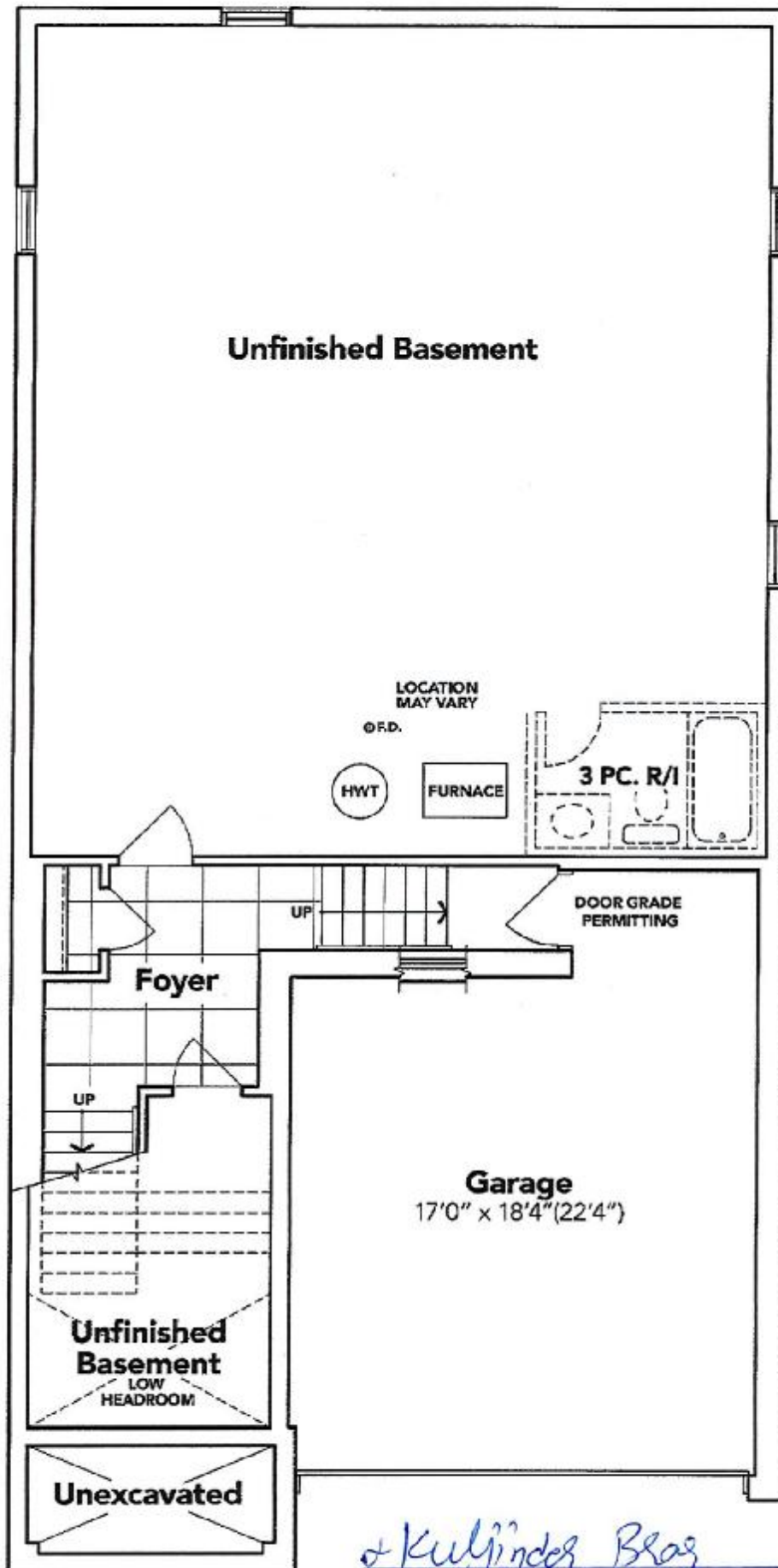

*Kuljinder Bhas*

*Gurpreet Kaur Bhas*

**BASEMENT EL. C**

The floor plans and elevations shown are pre-construction plans and may be revised or improved as necessitated by architectural controls and the construction process. The measurements adhere to the rules and regulations of the TARION Warranty Corporation's official method for the calculation of floor area. Materials, specifications and floor plans are subject to change without notice. All house renderings are artist's concept only. Actual usable floor space may vary from the stated floor area. All options shown are upgrades. E. & O. E.

LOT: 14 THAMES PH. 5A  
RE: UPG. 36" CHIMNEY HOOD FAN

Kuljinder Bhat  
Gurpreet Lamba

Specifications

Air Flow Volume: 650 CFM  
Electrical Connection: 120V/60Hz  
Power Consumption: 240 Watts  
Current: 2.0 Amps  
Fan Speed: 1599 RPM  
Finishes: Stainless Steel  
Duct: 6" Round  
Knock-out: 6" Round - Top Only  
Dimensions: Width: 30"/36"  
Height: 44 1/2"  
Depth: 19 3/4"  
Noise Level: Min. 2 Sones  
Max. 7 Sones



SCB722 - Baffle Filter



Ordering Model Chart

Model	Colour	Knock-out	Duct	Size	Filter	CFM
SCB72230	Stainless Steel	6"	6" Round	30"	Baffle	650
SCB72236	Stainless Steel	6"	6" Round	36"	Baffle	650

Notes

---

---

---

---

---

---

---



LOT: 14 THAMES PH. 5A

**KINGSIIEN**  
GROUP INC.

## Main Floor Vanity Display

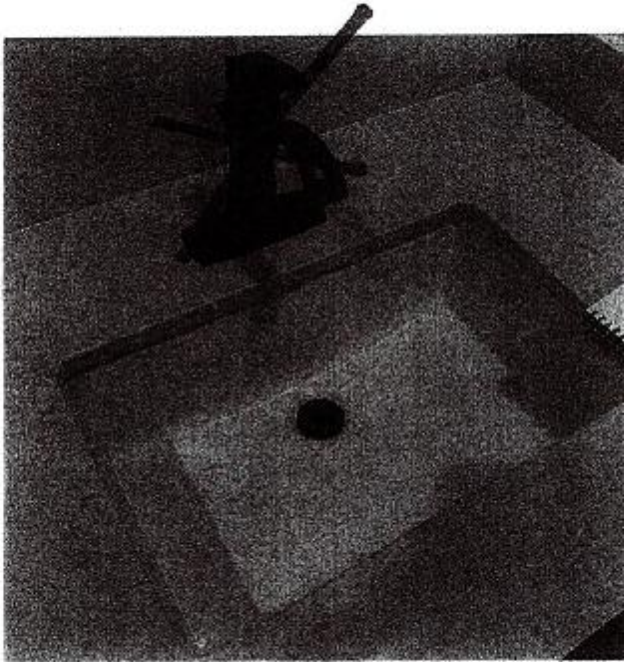

### DISPLAY ITEMS

#### Sink (Item 9)

Contrac Catena Undermount  
Model 4210CIY

← UPG. UNDERMOUNT  
VANITY SINKS

~ Kufinder Bear  
~ Gusfrut Kanebar

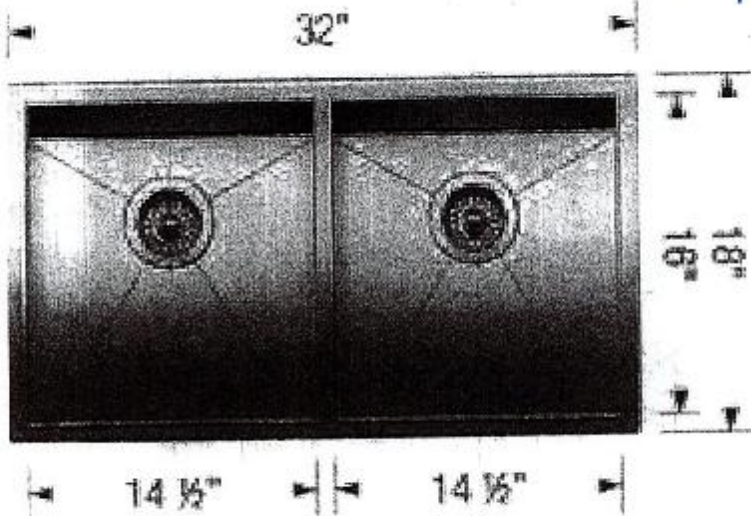

UPG. UNDERMOUNT  
KITCHEN  
SINK

### DISPLAY ITEMS

#### Sink (Item 17)

Blanco Quatrus U2 DBL Undermount  
O- Radius  
Model 401247

SOAP  
DISPENSER



Transitional Soap or  
Lotion Dispenser

Model 3942

Chrome

LOT: 14 THAMES PH. 5A  
RE: FRIDGE SPEC'S

*x Kuljinder Bar*  
*x Gurspreet Kaur Bar*

RF27T5201SR

SAMSUNG

27 cu. ft. Large Capacity 3-Door French Door Refrigerator  
with External Water & Ice Dispenser



Signature Features

**Large Capacity**  
A completely redesigned interior with 27 cu. ft. capacity that fits 10% more groceries.\*

\*When compared to Samsung 3-Door model RF263BEAE with 24.6 cu. ft. capacity

**Modern Design**  
Clean lines and modern form blend beautifully into your kitchen.

**Fingerprint Resistant Finish**  
A finish that withstands everyday smudges, so you spend less time cleaning.

Available Colors

-  Fingerprint Resistant  
Stainless Steel (shown)
-  Fingerprint Resistant  
Black Stainless Steel
-  White



Large Capacity



Fingerprint Resistant Finish

Design

- Large Capacity of 27 cu. ft.
- Fingerprint Resistant Finish
- Minimal Display Dispenser: external filtered water and ice
- High Efficiency LED Lighting
- EZ-Open Handle™

Convenience

- Full-width internal refrigerator drawer
- Adjustable Spill Proof Shelves
- Door Alarm
- Water Filter Indicator

Performance

- All-Around Cooling
- Ice Max Ice Maker - Stores up to 4.2 lbs of ice
- Sabbath Mode

Rating

 ENERGY STAR® rated:  
705 kWh/yr

 ADA Compliant



x Kuljinder Bas.

a Giuseppe Hane Bas

# RF27T5201SR

## 27 cu. ft. Large Capacity 3-Door French Door Refrigerator with External Water & Ice Dispenser

SAMSUNG

Installation Specifications

- 1. Measure the height, width and depth of the opening, making sure to include baseboards, molding tile, countertop overhang, etc. Check to be sure there is enough room to open the door (consider walls, islands or other obstacles when measuring).
- 2. Refer to illustration below to determine dimensions.
- 3. Allow 2.5" of clearance on hinge side of refrigerator when installing next to a wall where handle may make contact.
- 4. Allow 1" minimum clearance at rear for proper air circulation and water/electrical connections. Allow a 3/8" minimum clearance at sides and top for ease of installation.
- 5. Ensure each door and entryway in the home is wide enough for the refrigerator to be moved through easily.

For optimal usage and to be able to open refrigerator doors completely, do not install next to a wall.

Please note: The following dimension and cutout information is for planning purposes only. For complete installation details, consult manual packed with product, or download manual online at [samsung.com](http://samsung.com).

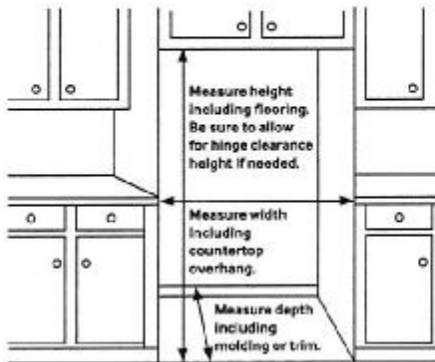

Dimensions

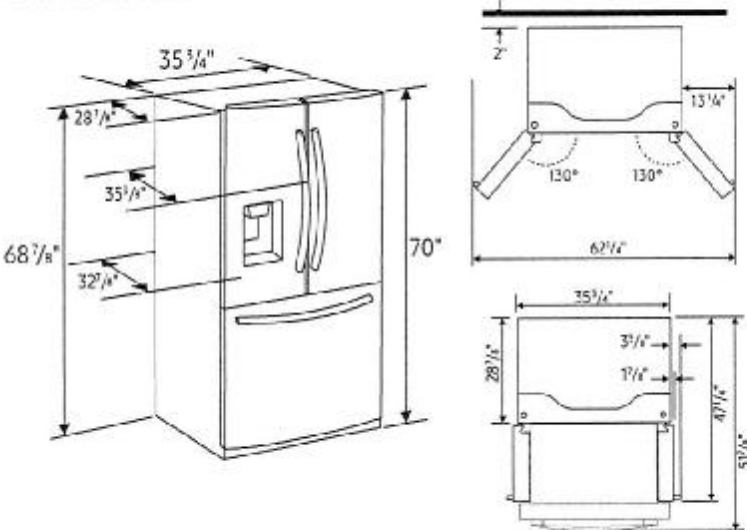

Total Capacity: 27.0 cu. ft.

Refrigerator: 18.4 cu. ft.

- External Filtered Water and Ice Dispenser
  - Crushed or Cubed Ice
- Full Width Drawer
- 4 Tempered Glass Spill-Proof Shelves
- 2 Humidity-Controlled Crispers
- 6 Door Bins
  - Right Door: 3 Gallon Bins
  - Left Door: 3 Regular Bins
- Adjustable Shelves for Tall Oversized Items
- High Efficiency LED Lighting

Freezer: 8.6 cu. ft.

- EZ-Open Handle™
- 1 Large Opaque Bin with 1 Divider
- Auto Pull-Out Upper Drawer
- High Efficiency LED Lighting

Accessories

Water Filter: HAF-QIN

Warranty

One (1) Year Parts and Labor on Refrigerator  
Five (5) Years Parts and Labor on Sealed Refrigeration System Only\*  
Ten (10) Years Parts and Five (5) Years Labor on Digital Inverter Compressor

\*Compressor, evaporator, condenser, drier and connecting tubing.

Product Dimensions & Weight

Dimensions (WxHxD with hinges, handles and doors):

35 3/4" x 70" x 35 3/8"

Dimensions (WxHxD without hinges and door):

35 3/4" x 68 7/8" x 28 7/8"

Dimensions (WxHxD with hinge and door, no handle):

35 3/4" x 70" x 32 7/8"

Weight: 295 lbs

Shipping Dimensions & Weight (WxHxD)

Dimensions: 37 3/4" x 75 5/16" x 35 15/16"

Weight: 305 lbs

Color	Model #	UPC Code
Fingerprint Resistant Stainless Steel	RF27T5201SR	887276408729
Fingerprint Resistant Black Stainless Steel	RF27T5201SG	887276408712
White	RF27T5201WW	887276408736

LOT: 14 THAMES PH. 5A  
RE: 36" GAS COOKTOP SPEC'S

*Kuljinder Bax*  
*Gurpreet Bax*

# NA36N7755TS

36" Gas Cooktop

SAMSUNG



### Signature Features

#### 22K True Dual-Power Burner

- Two independent heating burners offer intense heat and precise control to quickly boil water or temper chocolate.

#### Analog Controls with Digital Wi-Fi and Bluetooth® Technology

- The ultimate combination of analog comfort and digital technology delivers exceptional cooking performance.

#### Cast Iron Griddle

- Cook breakfast, grill sandwiches, or sauté vegetables on the removable griddle.

### Available Colors

- Stainless Steel (shown)
- Fingerprint Resistant Black Stainless Steel



22K True Dual-Power Burner



Cast Iron Griddle

### Features

- Bluetooth® Connected to Hood
- Blue LED Lights
- Wi-Fi Connectivity
- Powerful Cooktop
  - Right Front: 13K BTU
  - Left Front: 9.5K BTU
  - Right Rear: 5K BTU
  - Left Rear: 9.5K BTU
  - Center: True Dual, 22K BTU (Brass)

- Cast Iron 3-Piece Grates
- Sealed Burners
- Burner On/Off Monitoring
- ADA Compliant

### Convenience

- Wok Grate
- LP Conversion Kit



ADA Compliant



LOT: 14 THAMES PH. 5A  
RE: 36" GAS COOKTOP SPEC'S  
CON'T

*a Kuljinder Bhas*

*a Gupreet Bhas*

# NA36N7755TS

SAMSUNG

## 36" Gas Cooktop

### Installation Requirements

Countertop cut-out and minimum clearance dimensions:

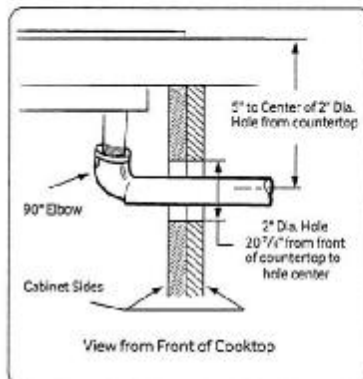
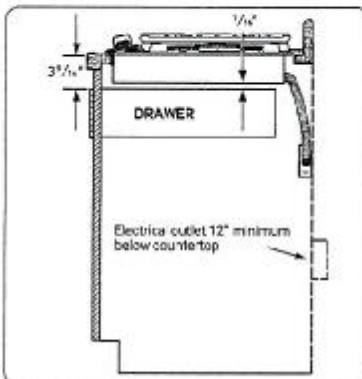
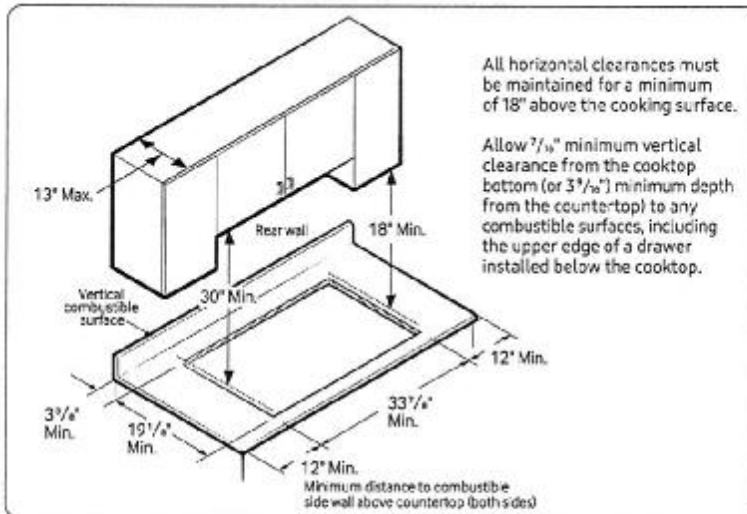

### Total Power (BTU)

59K

### Power Source

120V / 60 Hz / 1A

### Gas Cooktop (BTU)

- Right Front: 13K
- Left Front: 9.5K
- Right Rear: 5K Simmer
- Left Rear: 9.5K
- Center: 22K (True Dual)

### Warranty

One (1) Year All Parts and Labor

### Product Dimensions & Weight (WxHxD)

Outside (Max) Cooktop Dimensions:

36" x 5  $\frac{1}{12}$ " x 22  $\frac{1}{3}$ "

Cooktop Cut-Out Dimensions:

33  $\frac{7}{8}$ " x 3  $\frac{1}{8}$ " x 19  $\frac{1}{8}$ "

Weight: 87.7 lbs. (88.4 lbs. Fingerprint Resistant Black Stainless Steel)

### Shipping Dimensions & Weight (WxHxD)

Dimensions: 40  $\frac{9}{16}$ " x 10  $\frac{5}{8}$ " x 25  $\frac{5}{8}$ "

Weight: 95.9 lbs. (97.2 lbs. Fingerprint Resistant Black Stainless Steel)

### Color

Stainless Steel

### Model #

NA36N7755TS

### UPC Code

887276281766

Fingerprint Resistant

Black Stainless Steel

NA36N7755TG

887276281759

### Installing Over a Single Oven

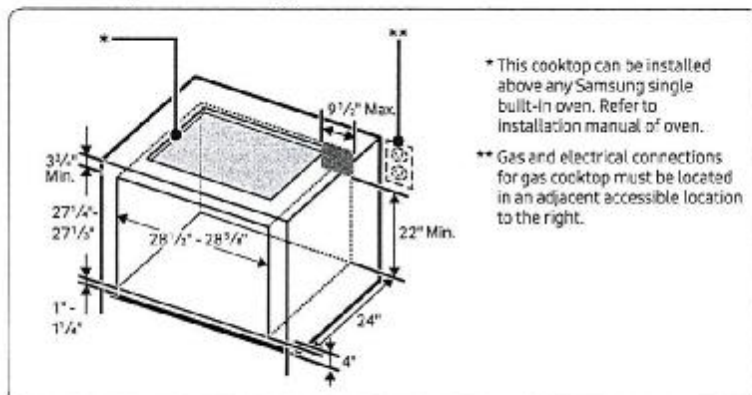

### Cooktop Dimensions

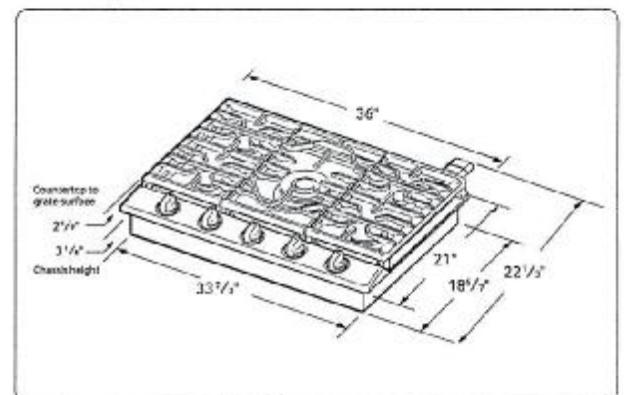

LOT: 14 THAMES PH. 5A  
RE: BUILT IN MICRO/WALL OVEN  
SPEC'S

Kellyndel Bras  
Gurpreet Kaur

# NQ70M7770DS

**SAMSUNG**

30" Microwave Combination Wall Oven

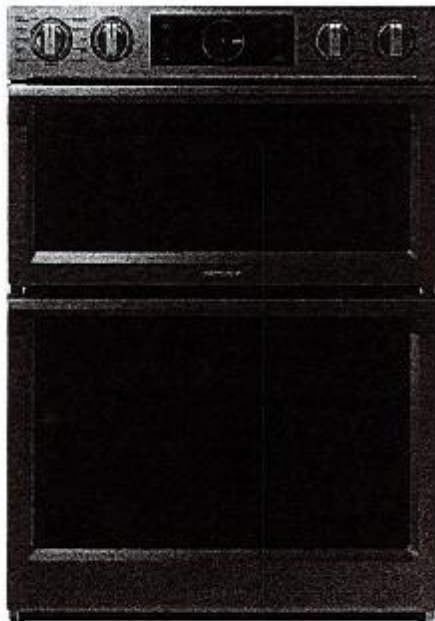

## Signature Features

### Steam Cook (Oven)

- Delivers moisture at precise times for a crisp, browned outside and tender inside.

### Speed Cook (Microwave)

- Cook food faster and more evenly by using power convection.

### Flex Duo™ (Oven)

- Cook two dishes at different temperatures simultaneously with the Smart Divider.

## Available Colors



Stainless Steel (shown)



Black Stainless Steel

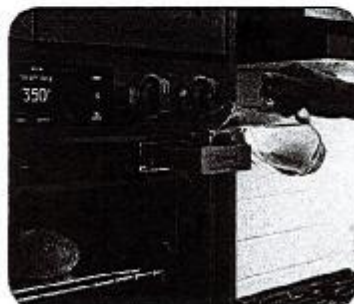

Steam Cook

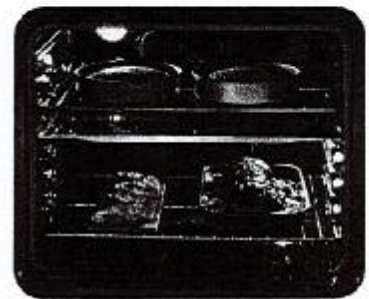

Flex Duo™

## Features

- Digital-Analog Controls
- 1.9/5.1 cu. ft. Capacity
- Hybrid Clean and Self-Clean (Oven)
- Gourmet Cook (Oven)
- Dual Convection (Oven)
- Wi-Fi Connectivity
- Wi-Fi Enabled Temperature Probe (Oven)
- LED Spotlights (Oven)
- Easy View Window
- 3 Heavy-Duty Racks including a Gliding Rack (Oven)
- Soft-Close Door (Oven)
- Ceramic Plate (Microwave)
- Rapid Preheat (Oven)
- Auto Latch Microwave Door
- 6 Oven Modes including Steam Bake and Steam Roast
- Blue LED Illuminated Knobs
- Broil Element
- Smart Control Key (Oven)
- 6 Rack Positions (Oven)
- Drop-Down Door Design
- LCD Display

## Convenience

- Hidden Heating Element (Oven)
- Sabbath Mode (Oven)
- Delay Start (Oven)
- Proofing (Oven)
- Warming Mode (Oven)
- Kitchen Timer
- Child Safety Lock
- Convection Conversion



LOT: 14 THAMES PH. 5A  
RE: BUILT IN MICRO/WALL OVEN  
SPEC'S CON'T

*oKuljinder Bas*

*oGreggKuehler*

# NQ70M7770DS

SAMSUNG

## 30" Microwave Combination Wall Oven

### Cabinet Dimensions

Combination Oven Installed in Cabinet

\*Junction Box

\*\*Allow a minimum of 22" for clearance to adjacent corners, drawers, walls, etc. when door is open.

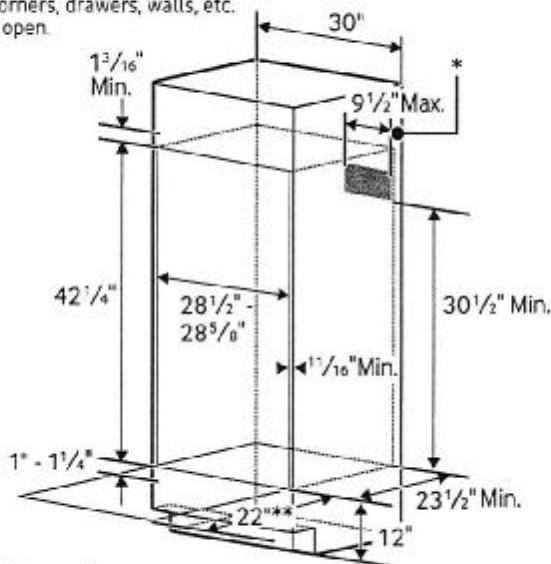

### Product Dimensions

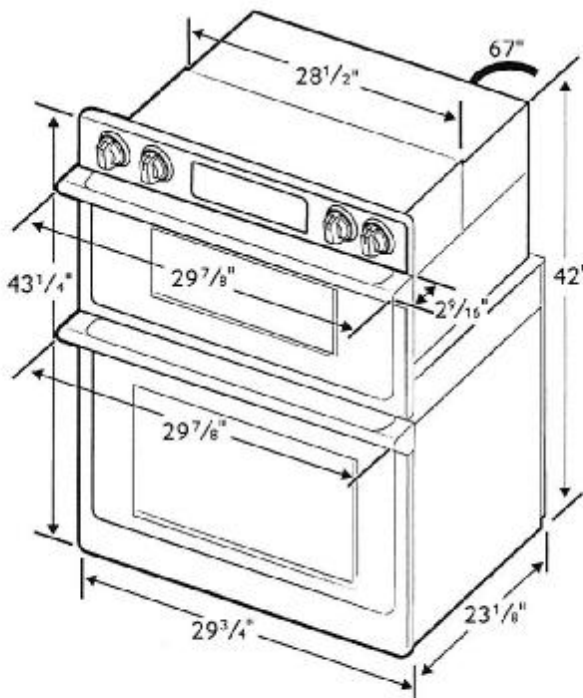

### Total Capacity: 1.9/5.1 cu. ft.

- Microwave: 1.9 cu. ft.
- Wall Oven: 5.1 cu. ft. total, 2.8/2.2 cu. ft.
- Hidden Bake Element
- Bake: 175°F–550°F
- Convection Bake: 175°F–550°F
- Convection Roast: 175°F–550°F
- Broil: Low-High
- Steam Bake: 230°F–550°F
- Steam Roast: 230°F–550°F
- Proofing
- Sabbath Mode

### Warranty

One (1) Year All Parts and Labor

Ten (10) Years Parts Warranty for Magnetron

### Product Dimensions & Weight (WxHxD)

Outside (Max) Combination Oven Dimensions:

29 7/8" x 43 1/4" x 25 11/16"

Combination Oven Cut-Out Dimensions:

28 1/2" x 42 1/4" x 23 1/2"

Weight: 119 lbs.

### Shipping Dimensions & Weight (WxHxD)

Dimensions:

33 5/8" x 48 3/16" x 29 51/64"

Weight: 132.5 lbs.

### Color

Stainless Steel

Black Stainless Steel

### Model #

NQ70M7770DS

NQ70M7770DG

### UPC Code

887276195186

887276195162

RATING	
240V	9.5 kW
208V	7.2 kW
BREAKER SIZE	
240V	40 Amps
208V	40 Amps