



CONSTRUCTION SUMMARY

KINGSMEN (THAMES) INC. / Havelock Corners (Kingsmen)

Lot/Unit: 17 Phase/Building: 5A Model/Floor Plan: Andrew (3603) Elev A 4 Bed - 2+1 Bath

COUNTER TOP

ELECTRICAL

Inv.5608	1 - To supply & install the standard T.V. rough in in the great room and master bedroom... see sketch # 4 & # 5	
Line 71525	Note:	
13May22 / 13May22		
Inv.5608	1 - To supply & install the standard Phone (CAT 5) rough in in the great room, master bedroom and bedroom # 4... see sketch # 4 & # 5	
Line 71526	Note:	
13May22 / 13May22		

HEATING AND AIR CONDITIONING

MISCELLANEOUS

EXTRAS AS PER OFFER

Purchaser: KULWANT SINGH JANJUA Property: 17 of Plan - Draft Approval SB17-03-08
Telephone Res. / Bus: / Project: KINGSMEN (THAMES) INC.
Decor Advisor: Barbara Coccia Model and Elevation: Andrew (3603) Elev A 4 Bed - 2+1 Bath
Layout Changes: ☐ Yes ☒ No Sketch Attached: ☒ Yes ☐ No Exterior Colour Scheme:

1. Cabinetry	Style and Colour	Counter Top	Hardware
Kitchen / Breakfast	#3, Camden Maple Chocolate CL	#1, C/S # 9141 Ice Snow 3cm.	#12881 Handle
Kitchen Island	#3, Camden Maple Chocolate CL	#1, C/S # 9141 Ice Snow 3cm.	#12881 Handle
Laundry Room	/		
Powder Room	#3, Camden Maple Chocolate CL	#1, C/S # 9141 Ice Snow 2cm.	#12881 Handle
Main Bathroom	#3, Camden Maple Chocolate CL	#1, C/S # 9141 Ice Snow 2cm.	#12881 Handle
Master Ensuite Bathroom	#3, Camden Maple Chocolate CL	#1, C/S # 9141 Ice Snow 2cm.	#12881 Handle
Second Ensuite Bathroom (If Applicable)	/		
	/		
	/		

Appliances Custom Size Fridge Valance Lighting Microwave / Range Hood
☐ Yes ☒ No ☐ Yes ☒ No ☐ Yes ☒ No
Cooktop / Rangetop Built in Wall Oven Slide-in Range
☐ Yes ☒ No ☐ Yes ☒ No ☐ Yes ☒ No
Comment
/

2. Flooring	Selection
Foyer	13 x 13" Bellina Grey
Main Hall	13 x 13" Bellina Grey
Back Hall	/
Breakfast	/
Laundry Room	13 x 13" Bellina Grey
Kitchen	13 x 13" Bellina Grey
Powder Room	13 x 13" Bellina Grey
Main Bathroom	13 x 13" Bellina Grey
Master Ensuite	13 x 13" Bellina Grey
Bathroom (If Applicable)	/
Mud Room	13 x 13" Bellina Grey
Master ens. shower floor	2x2" Ontario Snow White matte
Living Room	/
Dining Room	(Dinette) 3 1/2" Elements Oak Natural
Family / Great Room	3 1/2" Elements Oak Natural
Den / Library / Study	/
Basement Landing (If Applies)	
Lower Landing (If Applicable)	3 1/2" Elements Oak Natural
Upper Landing	3 1/2" Elements Oak Natural
Upper Hall	Modern Story 1, # 808 Dawn
Master Bedroom	Modern Story 1, # 808 Dawn
Bedroom #2	Modern Story 1, # 808 Dawn
Bedroom #3	Modern Story 1, # 808 Dawn
Bedroom #4	Modern Story 1, # 808 Dawn
Bedroom #5	/
Master ens. shower jamb	Anatolia Marmiline SNOW



Flooring Continued on Page 2



Initial: _____

Purchaser: KULWANT SINGH JANJUA Property: 17 of Plan - Draft Approval SB17-03-08
Telephone Res. / Bus: / Project: KINGSMEN (THAMES) INC.
Decor Advisor: Barbara Coccia Model and Elevation: Andrew (3603) Elev A 4 Bed - 2+1 Bath
2. Flooring - Continued -

Upgrade Underpad	Type	Area
	Standard	2nd. floor
Carpet on Stairs	Capped	Runner - *Upgrade
Comment	/	/
/		

3. Plumbing Fixtures / Faucets

Kitchen	Standard	Second Ensuite	/	Powder Room	Standard
Master Ensuite	Standard			Other Room	/
Main Bathroom	Standard		/		

Comment
Still to install the standard ledge back top mount kitchen sink with the standard kitchen faucet. Still to install the standard top mount vanity sinks with the standard lav. faucets.

4. Wall Tile

	Tile Selection	Listello	Insert	Insert Selection
Main Bathroom	8x10" Bellina Grey	<input type="checkbox"/>	<input type="checkbox"/>	
Master Ensuite				
Tub Deck	13 x13" Bellina Grey	<input type="checkbox"/>	<input type="checkbox"/>	
Tub Apron	13 x13" Bellina Grey	<input type="checkbox"/>	<input type="checkbox"/>	
Tub Surround	13 x13" Bellina Grey	<input type="checkbox"/>		
Shower Stall	8x10" Bellina Grey	<input type="checkbox"/>	<input type="checkbox"/>	
Second Ensuite	/	<input type="checkbox"/>	<input type="checkbox"/>	
	/	<input type="checkbox"/>	<input type="checkbox"/>	
	/	<input type="checkbox"/>	<input type="checkbox"/>	
Kitchen Backsplash	/	<input type="checkbox"/>	<input type="checkbox"/>	
Complete Backsplash	/	<input type="checkbox"/>	<input type="checkbox"/>	

Comment
Install the 8 x 10" wall tiles in the bathrooms on the 10" side stacked horizontally where applicable.

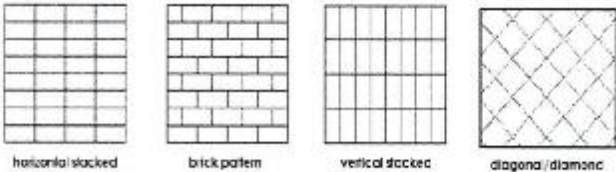

5. Fireplace

	Living Room			Family Room			Other Room - Specify Great Room		
	Purchased	As Per Plan	N/A	Purchased	As Per Plan	N/A	Purchased	As Per Plan	N/A
Fireplace Type	<input type="radio"/>	<input type="radio"/>	<input checked="" type="radio"/>	<input type="radio"/>	<input type="radio"/>	<input checked="" type="radio"/>	<input type="radio"/>	<input checked="" type="radio"/>	<input type="radio"/>
Mantle Type							Front facing		
Over Mantle							NF-08		
Colour / Stain							/		
Surround							White		
Hearth							/		
Comment							/		
/									



Initial: _____

Purchaser: KULWANT SINGH JANJUA

Property: 17 of Plan - Draft Approval SB17-03-08

Telephone Res. / Bus: /

Project: KINGSMEN (THAMES) INC.

Decor Advisor: Barbara Coccia

Model and Elevation: Andrew (3603) Elev A 4 Bed - 2+1 Bath

6. Trim Carpentry

Door Hardware Standard handle

Interior Trim Standard

Comment

Interior Doors

☐ 2 Panel Arch Top

☒ 2 Panel Square Top

☐ 6 Panel

Initial for Door Style

KS

7. Railings and Pickets

Railing Package Standard oak STRAIGHT picket package

Railing Colour Elements Natural

Picket Colour Elements Natural

Wood Stairs ☐ No ☒ Oak

Tread Colour Elements Natural

Comment

8. Plaster Mouldings and Medallions

Foyer

Main Hall

Living Room

Dining Room

Family Room

Kitchen/Breakfast

Den/Library

Lower Landing

Comment

9. Wall Paint

Kingsmen White

Smooth Ceilings ☐ First Floor

☐ First Floor incl. Second Floor Hall

☐ First and Second Floor

☒ Throughout

☐ Not Applicable

Trim Paint Kingsmen White

10. Additional Comments



11. Disclaimers and Notes

- Colours of all materials are as close as possible to builder's selection, but not necessarily identical due to variances in manufacturing.
- Any extras listed above are null and void unless accompanied by a separate invoice/amendment. Said invoice must be paid in full.
- The Purchaser acknowledges that after Interior Colour Selection form is signed and dated, no further changes will be permitted other than re-selection due to unavailability.  Purchaser's Initials
- The Purchaser acknowledges reading and accepting the "Kingsmen Group Décor Centre Disclaimers" form. This document contains other miscellaneous disclaimers.

This Interior Colour Selection is final and approved by:

Purchaser:

Signature:  Date: MAY 13 2022

Vendor:

KINGSMEN (THAMES) INC.

May 16, 22

SCHEDULE "B-1"
Floor Plan

Lot 17
Phase 5A
Model: Andrew (3603) Elev A 4 Bed - 2+1 Bath
Standard

Sketch
#4

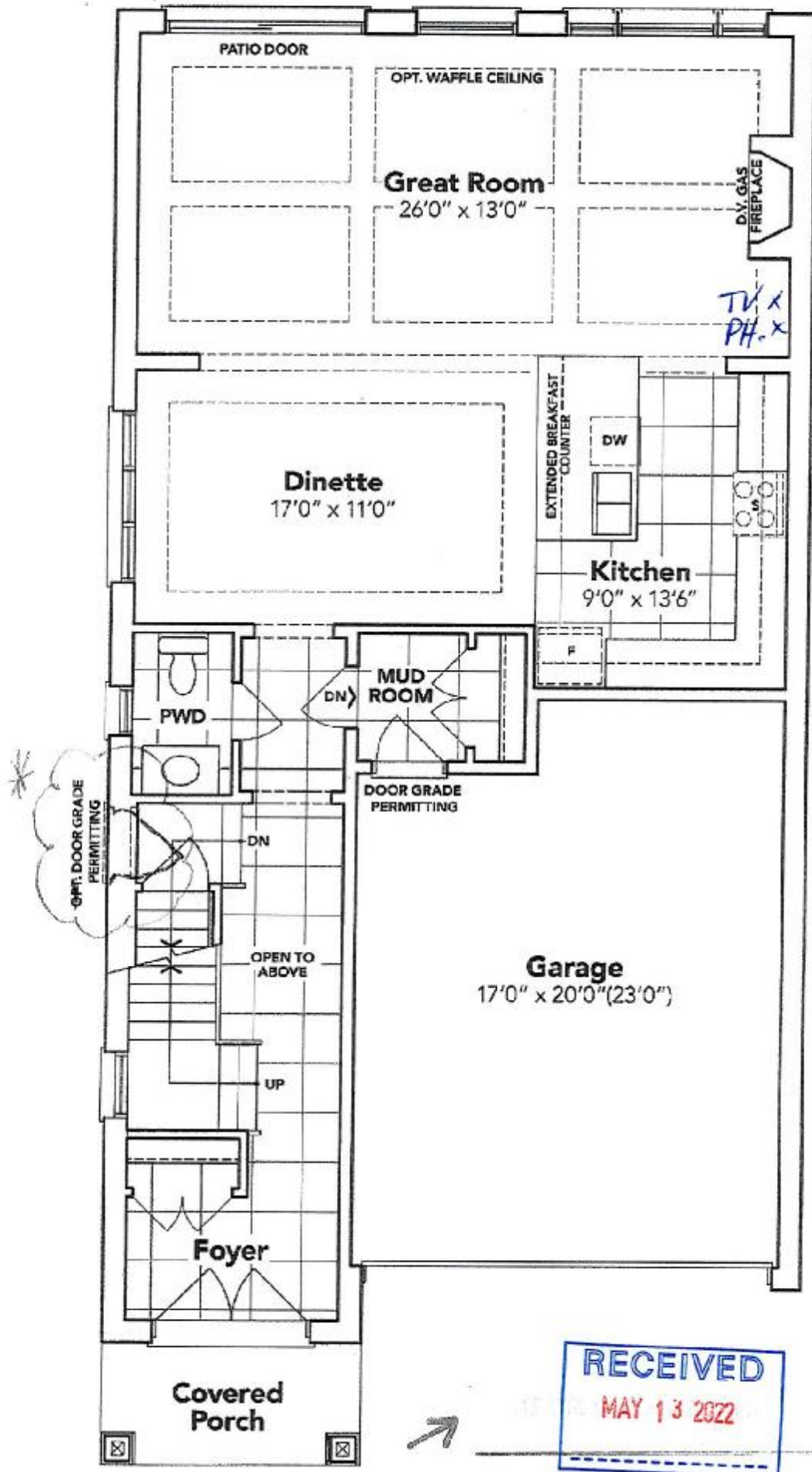

GROUND FLOOR EL. A

The floor plans and elevations shown are pre-construction plans and may be revised or improved as necessitated by architectural controls and the construction process. The measurements adhere to the rules and regulations of the TARION Warranty Corporation's official method for the calculation of floor area. Materials, specifications and floor plans are subject to change without notice. All house renderings are artist's concept only. Actual usable floor space may vary from the stated floor area. All options shown are upgrades. E. & O. E.

SCHEDULE "B-1"
Floor Plan

Lot 17
Phase 5A
Model: Andrew (3803) Elev A 4 Bed - 2+1 Bath
Standard

Sketch
#5

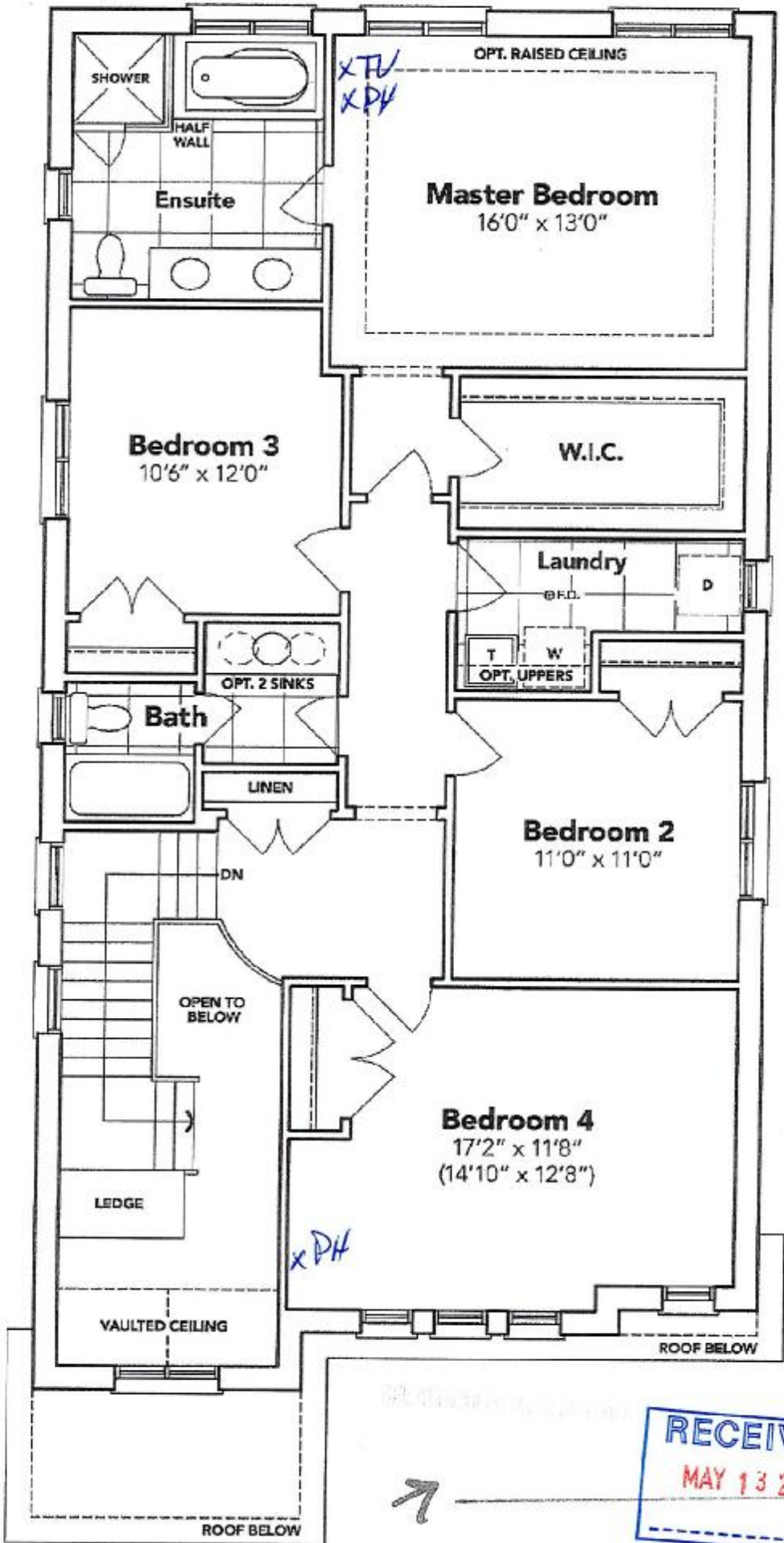

SECOND FLOOR EL. A

The floor plans and elevations shown are pre-construction plans and may be revised or improved as necessitated by architectural controls and the construction process. The measurements adhere to the rules and regulations of the TARION Warranty Corporation's official method for the calculation of floor area. Materials, specifications and floor plans are subject to change without notice. All house renderings are artist's concept only. Actual usable floor space may vary from the stated floor area. All options shown are upgrades. E. & O. E.