



CONSTRUCTION SUMMARY

Kingsmen (Islington) Inc. / 9560 Islington

Lot/Unit: U248 Block 4    Phase/Building: 1    Model/Floor Plan: The Santorini - 2 Bed+Den (C2-2B)

CABINETRY VANITY

Inv.5599	1 - To INCREASE VANITY TO KITCHEN HEIGHT - 90CM HIGH - MAINTAINS VANITY DEPTH - CLASSIC SERIES in the PWD, MASTER ENSUITE AND SECOND ENSUITE	
Line 72307	Note:	
10May22 / 16Jun22		

COUNTER TOP - KITCHEN

Inv.5599	1 - To supply and install COUNTER TOP - KITCHEN - KITCHEN - 3CM QUARTZ COUNTER TOP - UPGRADE LEVEL 2 see colour chart for details	
Line 71371	Note:	
10May22 / 16Jun22		

COUNTER TOP - VANITY

Inv.5599	1 - To supply and install COUNTER TOP - VANITY - POWDER ROOM - 2CM QUARTZ COUNTER TOP - UPGRADE LEVEL 2 see colour chart for details	
Line 71372	Note:	
10May22 / 16Jun22		
Inv.5599	1 - To supply and install COUNTER TOP - VANITY - MASTER ENSUITE - 2CM QUARTZ COUNTER TOP - UPGRADE LEVEL 2 see colour chart for details	
Line 71373	Note:	
10May22 / 16Jun22		
Inv.5599	1 - To supply and install COUNTER TOP - VANITY - SECOND ENSUITE BATHROOM- 2CM QUARTZ COUNTER TOP - UPGRADE LEVEL 2.. see colour chart for details	
Line 71374	Note:	
10May22 / 16Jun22		

ELECTRICAL

HARDWOOD

Inv.5599	1 - To supply and install HARDWOOD - MASTER BEDROOM - STANDARD FLOOR IN NON STANDARD AREAS.. see colour chart for details	
Line 71379	Note:	
10May22 / 16Jun22		
Inv.5599	1 - To supply and install HARDWOOD - BEDROOM 2 - STANDARD FLOOR IN NON STANDARD AREAS.. see colour chart for details	
Line 71380	Note:	
10May22 / 16Jun22		

MISCELLANEOUS

Inv.5599	1 - INTERIOR FINISHES SELECTED 05/10/2022	
Line 71370	Note:	
10May22 / 16Jun22		

PLUMBING

Kingsmen (Islington) Inc. / 9560 Islington

Lot/Unit: U248 Block 4    Phase/Building: 1    Model/Floor Plan: The Santorini - 2 Bed+Den (C2-2B)

Inv.5599	1 - To supply and install install the QUATRUS U1 SUPER SINGLE MODEL 401248 in the kitchen.. see spec's	
Line 71381	Note: STILL TO INSTALL THE STANDARD FAUCET	
10May22 / 16Jun22		
Inv.5599	3 - To supply and install the CONTRAC CATENA MODEL 4210CIY in ALL bathrooms, in lieu of the standard.. see spec's	
Line 71382	Note: STILL TO SUPPLY AND INSTALL THE STANDARD FAUCETS	
10May22 / 16Jun22		

TILE - FLOOR

Inv.5599	1 - To supply and install UPGRADE 3 - FLOOR TILE - - SECOND ENSUITE BATHROOM TILE STACKED.. see colour chart	
Line 72304	Note: SEE SKETCH #4 FOR TILE DIRECTION	
10May22 / 16Jun22		
Inv.5599	1 - To supply and install UPGRADE 3- FLOOR TILE - - POWDER ROOM TILE STACKED see colour chart for details	
Line 71375	Note: SEE SKETCH #3 FOR TILE DIRECTION	
10May22 / 16Jun22		
Inv.5599	1 - To supply and install UPGRADE 3 - FLOOR TILE - - MASTER ENSUITE TILE STACKED. see colour chart for details	
Line 71376	Note: SEE SKETCH #4 FOR TILE DIRECTION	
10May22 / 16Jun22		
Inv.5599	1 - To supply and install UPGRADE 2 - FLOOR TILE - - MASTER ENSUITE SHOWER FLOOR TILE.. see colour chart for detais	
Line 72306	Note:	
10May22 / 16Jun22		

TILE - WALL

Inv.5599	1 - To supply and install UPGRADE 1- BACKSPLASH - STACKED HORIZONTALLY- BACKSPLASH TILE.. see colour chart	
Line 72308	Note:	
10May22 / 16Jun22		
Inv.5599	1 - To supply and install UPGRADE 1 - WALL TILE - - MASTER ENSUITE SHOWER WALL TILE STACKED HORIZONTALLY.. see colour chart for details	
Line 71378	Note:	
10May22 / 16Jun22		
Inv.5599	1 - To supply and install UPGRADE 1 - WALL TILE -STACKED HORIZONTALLY - SECOND ENSUITE BATHROOM WALL TILE HORIZONTALLY STACKED.. See colour chart	
Line 72305	Note:	
10May22 / 16Jun22		

EXTRAS AS PER OFFER

MISC

Kingsmen (Islington) Inc. / 9560 Islington

Lot/Unit: U248 Block 4    Phase/Building: 1    Model/Floor Plan: The Santorini - 2 Bed+Den  
(C2-2B)

Purchaser: INVENTORY U248 Block 4

Property: U248 Block 4 of Plan -

Telephone Res. / Bus: /

Project: Kingsmen (Islington) Inc.

Decor Advisor: Barbara Coccia

Model and Elevation: The Santorini - 2 Bed+Den (C2-2B)

Layout Changes: ☐ Yes ☒ NoSketch Attached: ☒ Yes ☐ No

Exterior Colour Scheme:

## 1. Cabinetry

	Style and Colour	Counter Top	Hardware
Kitchen / Breakfast	Trinity DHGL Arctico Gloss MWP	UPG2:C/S 4800 Organic Wh. 3cm	12881 Handle
Kitchen Island	Trinity DHGL Arctico Gloss MWP	UPG2:C/S 4800 Organic Wh. 3cm	12881 Handle
Laundry Room	/	/	/
Powder Room	Trinity DHGL Arctico Gloss MWP	UPG2:C/S 4800 Organic Wh.2cm	169 Knob
Main Bathroom	/	/	/
Master Ensuite Bathroom	#3 Simcoe Raincloud	UPG2:CS5810 Black Temple2cm	135 Knob
Second Ensuite Bathroom (If Applicable)	#3 Simcoe Raincloud	UPG2:CS5810 Black Temple2cm	135 Knob

## Appliances

## Custom Size Fridge

☐ Yes ☒ No

## Valance Lighting

☐ Yes ☒ No

## Microwave / Range Hood

☐ Yes ☒ No

## Cooktop / Rangetop

☐ Yes ☒ No

## Built in Wall Oven

☐ Yes ☒ No

## Slide-in Range

☐ Yes ☒ No

Comment

## 2. Flooring

	Selection
	/
Main Hall	/
Back Hall	/
Breakfast	/
Laundry Room	13x13" Cinq Grey
Kitchen	5" Kentwood Brushed Oak Stonecrop
Powder Room	"UPG #3: 12x24" Mayfair Volakas Grgio HD Porcelain Tile Stacked
Main Bathroom	/
Master Ensuite	UPG #3: 12x24" Mayfair Volakas Grgio HD Porcelain Tile Stacked
Bathroom (If Applicable)	(SECOND ENSUITE)-UPG #3: 12x24" Mayfair Volakas Grgio HD Porcelain Tile Stacked
Mud Room	/
Master Ensuite SH/FL	"UPG #2: 2x2" Mayfair Volakas Grigio HD Porcelain Basketweave Mosaics
Living Room	5" Kentwood Brushed Oak Stonecrop
Dining Room	5" Kentwood Brushed Oak Stonecrop
Family / Great Room	/
Den / Library / Study	5" Kentwood Brushed Oak Stonecrop
Basement Landing (If Applies)	
Lower Landing (If Applicable)	5" Kentwood Brushed Oak Stonecrop
Upper Landing	5" Kentwood Brushed Oak Stonecrop
Upper Hall	5" Kentwood Brushed Oak Stonecrop
Master Bedroom	5" Kentwood Brushed Oak Stonecrop
Bedroom #2	5" Kentwood Brushed Oak Stonecrop
Bedroom #3	/
Bedroom #4	/
Bedroom #5	/
Master Ensuite SH Jamb	Anatolia Marmiline SNOW

RECEIVED

JUN 16 2022

Flooring Continued on Page 2

Initial: \_\_\_\_\_

Page 1 of 3



Purchaser: INVENTORY U248 Block 4

Property: U248 Block 4 of Plan -

Telephone Res. / Bus: /

Project: Kingsmen (Islington) Inc.

Decor Advisor: Barbara Coccia

Model and Elevation: The Santorini - 2 Bed+Den (C2-2B)

### 2. Flooring - Continued -

Upgrade Underpad	Type	Area
	/	/
Carpet on Stairs	Capped	Runner - *Upgrade
Comment	/	/

### 3. Plumbing Fixtures / Faucets

Kitchen	STANDARD	Second Ensuite	STANDARD	Powder Room	STANDARD
Master Ensuite	STANDARD			Other Room	/
Main Bathroom	/	/	/		

#### Comment

NOTE: To supply and install the upgraded undermount kitchen sink, with the standard faucet in the Kitchen. To supply and install the standard faucets and upgraded undermount sinks in ALL Bathrooms.

### 4. Wall Tile

	Tile Selection	Listello	Insert	Insert Selection
Main Bathroom	/	<input type="checkbox"/>	<input type="checkbox"/>	
Master Ensuite				
Tub Deck	/	<input type="checkbox"/>	<input type="checkbox"/>	
Tub Apron	/	<input type="checkbox"/>	<input type="checkbox"/>	
Tub Surround	/	<input type="checkbox"/>	<input type="checkbox"/>	
Shower Stall	UPG1: 4x12" Marlow Cloud Glossy	<input type="checkbox"/>	<input type="checkbox"/>	
Second Ensuite	UPG1: 4x12" Marlow Smoke Glossy	<input type="checkbox"/>	<input type="checkbox"/>	
	/	<input type="checkbox"/>	<input type="checkbox"/>	
	/	<input type="checkbox"/>	<input type="checkbox"/>	
Kitchen Backsplash	UPG1: 4x12" Marlow Cloud Glossy	<input type="checkbox"/>	<input type="checkbox"/>	
Complete Backsplash	/	<input type="checkbox"/>	<input type="checkbox"/>	

#### Comment

TO SUPPLY AND INSTALL ALL WALL TILES STACKED HORIZONTALLY



horizontal stacked



brick pattern



vertical stacked



diagonal/diamond

### 5. Fireplace

	Living Room			Family Room			Other Room - Specify		
	Purchased	As Per Plan	N/A	Purchased	As Per Plan	N/A	Purchased	As Per Plan	N/A
Fireplace Type	<input type="radio"/>	<input type="radio"/>	<input checked="" type="radio"/>	<input type="radio"/>	<input type="radio"/>	<input checked="" type="radio"/>	<input type="radio"/>	<input type="radio"/>	<input checked="" type="radio"/>
Mantle Type									
Over Mantle									
Colour / Stain									
Surround									
Hearth									
Comment									



Initial: \_\_\_\_\_

Page 2 of 3

Purchaser: INVENTORY U248 Block 4

Property: U248 Block 4 of Plan -

Telephone Res. / Bus: /

Project: Kingsmen (Islington) Inc.

Decor Advisor: Barbara Coccia

Model and Elevation: The Santorini - 2 Bed+Den (C2-2B)

### 6. Trim Carpentry

Door Hardware STANDARD HANDLE

Interior Trim STANDARD

Comment

#### Interior Doors

☐ 2 Panel Arch Top

☒ 2 Panel Square Top

☐ 6 Panel



Initial for Door Style \_\_\_\_\_

### 7. Railings and Pickets

Railing Package Standard Metal Picket Package

Railing Colour KENTWOOD STONECROP

Picket Colour BLACK METAL

Wood Stairs ☐ No ☒ Oak

Tread Colour KENTWOOD STONECROP

Comment

### 8. Plaster Mouldings and Medallions

Foyer	/	/
Main Hall	/	/
Living Room	/	/
Dining Room	/	/
Family Room	/	/

Kitchen/Breakfast	/	/
Den/Library	/	/
Lower Landing	/	/
/	/	/

Comment

### 9. Wall Paint

Kingsmen White

Smooth Ceilings ☐ First Floor  
☐ First Floor incl. Second Floor Hall  
☐ First and Second Floor  
☒ Throughout  
☐ Not Applicable

Trim Paint Kingsmen White

### 10. Additional Comments

RECEIVED

JUN 16 2022

### 11. Disclaimers and Notes

- Colours of all materials are as close as possible to builder's selection, but not necessarily identical due to variances in manufacturing.
- Any extras listed above are null and void unless accompanied by a separate invoice/amendment. Said invoice must be paid in full.
- The Purchaser acknowledges that after Interior Colour Selection form is signed and dated, no further changes will be permitted other than re-selection due to unavailability. \_\_\_\_\_ Purchaser's Initials
- The Purchaser acknowledges reading and accepting the "Kingsmen Group Décor Centre Disclaimers" form. This document contains other miscellaneous disclaimers.

This Interior Colour Selection is final and approved by:

Purchaser:

Signature: \_\_\_\_\_ Date: \_\_\_\_\_

Vendor:

Kingsmen (Islington) Inc.

June 16/22

# C2 THE SANTORINI

SKYLINE COLLECTION

1955 SQ. FT.

PATIO: 578 SQ. FT.  
2 BED + GEN + 1 BATH

9560  
ISLINGTON

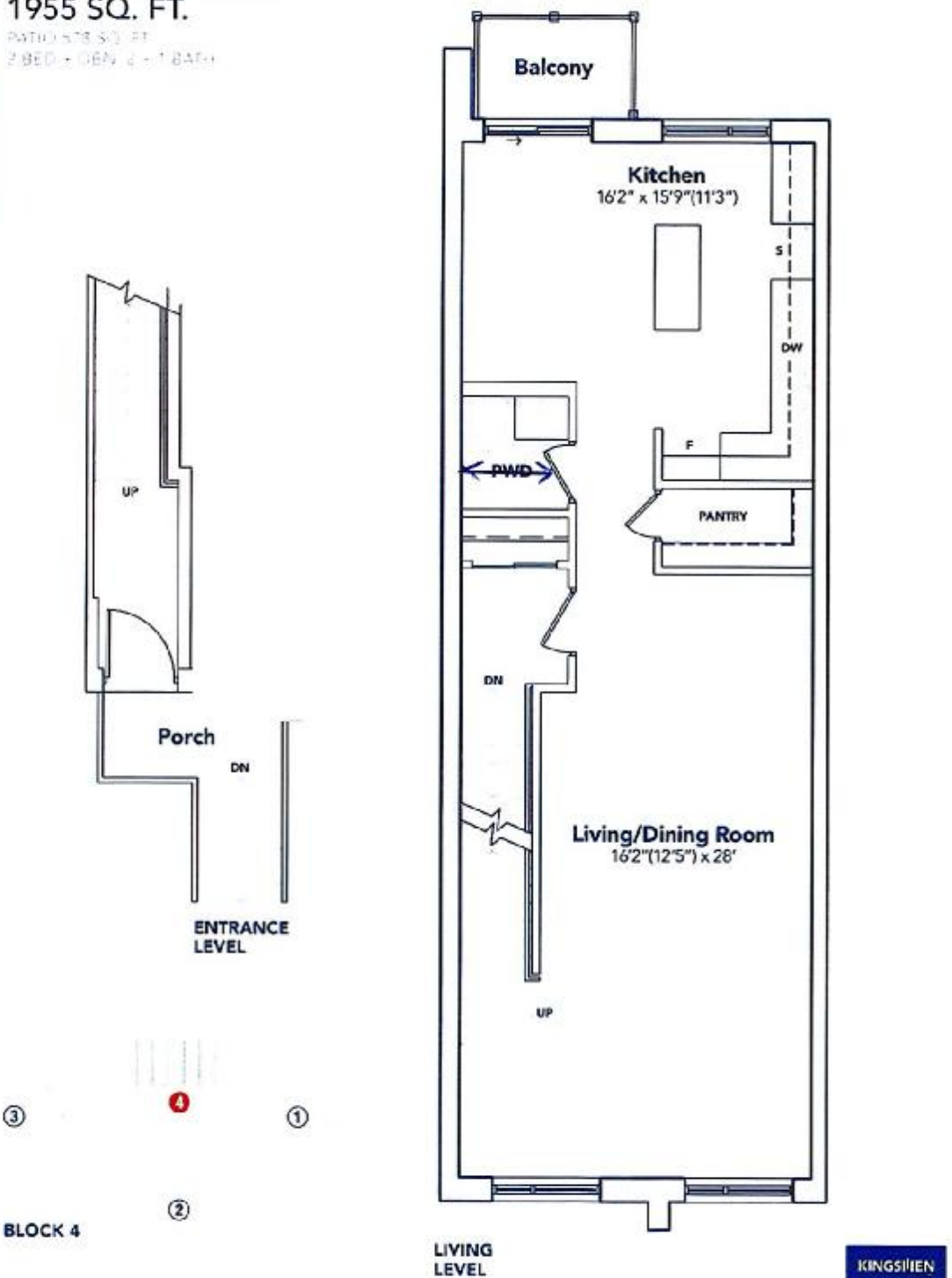

RECEIVED

JUN 16 2022



C2 THE SANTORINI

SKYLINE COLLECTION

1955 SQ. FT.

PATIO 578 SQ. FT.  
2 BED - DEN 2 + 1 BATH

9560  
ISLINGTON

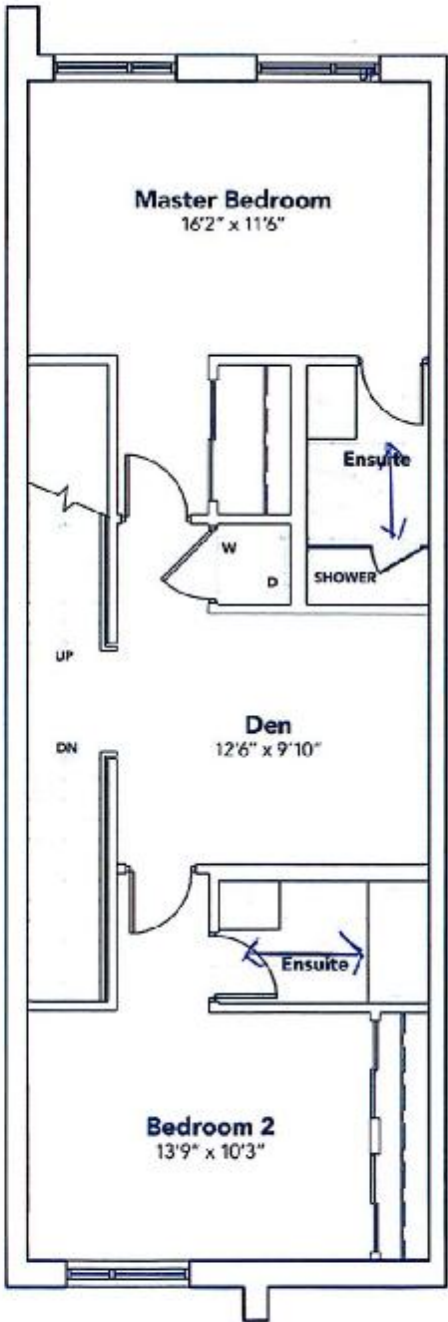

BEDROOM  
LEVEL

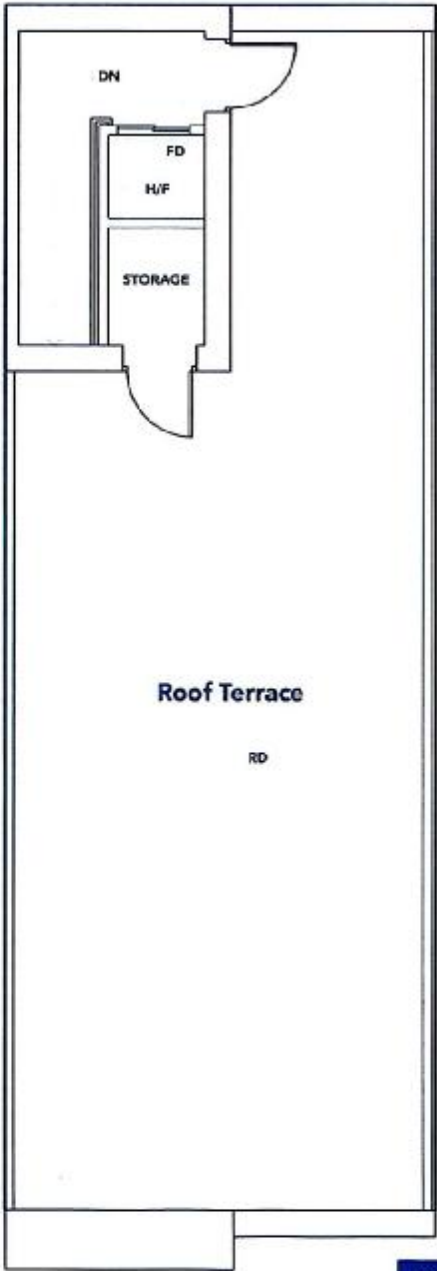

TERRACE  
LEVEL

KINGSLEY

RECEIVED  
JUN 16 2022



# BLANCO

## Sink Specifications

Colour                      SKU  
brushed finish            401248

### Design and planning tips

- Min cabinet size: 36 in ( 915 mm )
- Bowl Depth: 9 in ( 230.0 mm )

### Specifications:

Installation clips, Sink template, Installation instructions, 3 ½" (90 mm) stainless steel strainer

Depending on cabinet construction, a different cabinet size may be required. Consult the cabinet manufacturer.

Codes/Standards: ASME A112.19.3-2017/ CSA B45.4-17

### Optional Accessories

Elevated Grid                      406346  
Workstation                      406344  
CapFlow Strainer Cover       517666  
Ash Cutting Board              406345  
Sink Grid                          402125

9560 ISLINGTON: UNIT U248 (BLK 4)  
RE: UPG. KITCHEN SINK

## QUATRUS U 1 SUPER SINGLE

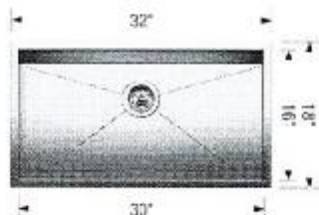

### Warranty

Limited lifetime warranty on all sinks and faucets. One-year warranty on all accessories and soap dispensers.

### Code/Standards Compliance

BLANCO sinks and faucets are third-party tested and certified to CSA, cUPC, ANSI/ASME, IAPMO and NSF standards and listed by applicable certification bodies. For more information on individual product listings, contact our office or listing organization.



Need support? Learn more by watching our sink & faucet How-to videos:

<https://www.blanco.com/ca-en/support/how-to-videos/how-to-videos-for-sinks/>



BLANCO Canada Inc  
100 Corporation Drive  
Brampton ON L6S 6B5

### Tel & Fax

Tel: 905-494-2400 Toll free: 1-877-425-2626  
Fax: 905-494-2425 Toll free: 1-877-825-2626

While BLANCO strives to provide accurate information, all images and dimensions in this document are intended for reference only and are subject to change at any time without notice. This document is not intended for use as an installation guide. For technical installation details, refer to installation instructions provided with the product. BLANCO assumes no responsibility for the use of superseded or voided specifications.

RECEIVED

JUN 16 2022

CATENA  
RECTANGULAR UNDERMOUNT SINK

4210CIV Undermount Sink

**PRODUCT SPECS:**  
- Vitreous china  
- Front overflow hole  
- Template and mounting hardware supplied

**DIMENSIONS:**  
**Outer:**  
510mm W x 390mm D x 190mm H  
20" W x 15 1/4" D x 7 1/2" H  
**Inner:**  
458mm W x 340mm D x 140mm H  
18" W x 13 1/4" D x 5 1/2" H

**COMPLIANCE CERTIFICATIONS**  
Meets or exceeds the following:  
- IAPMO cUPC  
- ASME A112.19.2 / CSA B45.1  
- OBC Section 3.8 Barrier Free design and CSA B651 Standard

**SHIPPING**  
Cube 1.72  
GW 27 lbs

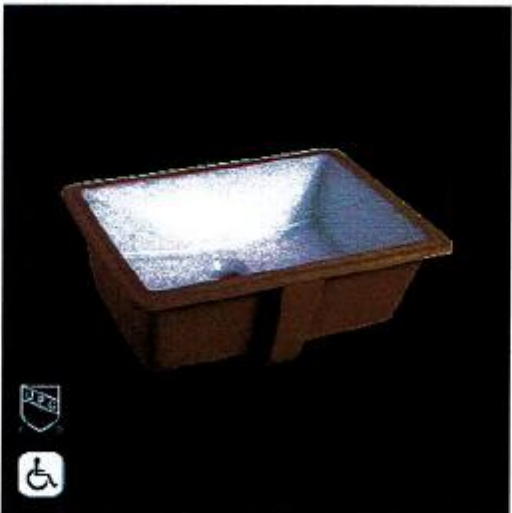
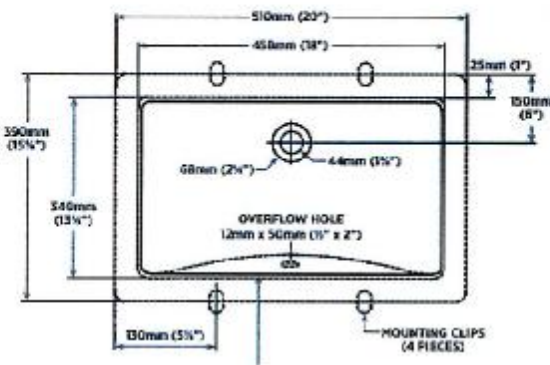

TO BE SPECIFIED

Color:  
■ Soft White

**NOTES:** Dimensions of fixtures are nominal and may vary within the range of tolerances established by ASME standard A112.19.2. These measurements are subject to change for convenience. No responsibility is assumed for use of superseded or revised pages.  
Products are designed to comply with CSA B651 Standard and OBC barrier-free requirements. It shall be the responsibility of the installer to comply with the local disability codes and standards prior to installing the product.

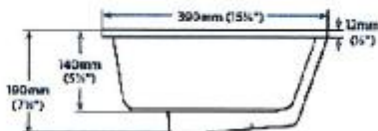

RECEIVED  
JUN 16 2022