



CONSTRUCTION SUMMARY

KINGSMEN (THAMES) INC. / Havelock Corners (Kingsmen)

Lot/Unit: 24 Phase/Building: 5A Model/Floor Plan: Arthur (4205) Elev A 4 Bed - 4+1 Bath

CABINETRY

CABINETRY ACCESSORIES

CABINETRY APPLIANCE - FRIDGE

CABINETRY BASE CABINETS

CABINETRY HARDWARE

CABINETRY HOOD FANS

CABINETRY MICROWAVE OVEN STOVE COOKTOP

CABINETRY VANITY

CABINETRY WALL AND HUTCH

COUNTER TOP

COUNTER TOP - ACCESSORIES

COUNTER TOP - KITCHEN

COUNTER TOP - VANITY

DOORS AND WINDOWS

ELECTRICAL

Inv. 5639	1 - To SUPPLY AND INSTALL EXTRA 240 PLUG IN THE GARAGE... SEE SKETCH #7 FOR DETAILS	
Line 72193	Note: APPROX. LOCATION ONLY.... SUBJECT TO CHANGE PER ELECTRICAN	
1Jun22 / 10Jun22		

HARDWOOD

HEATING AND AIR CONDITIONING

HVAC

MISCELLANEOUS

PAINT AND DRYWALL

PLUMBING

RAILING

TILE - FLOOR

TILE - WALL

KINGSMEN (THAMES) INC. / Havelock Corners (Kingsmen)

Lot/Unit: 24 Phase/Building: 5A Model/Floor Plan: Arthur (4205) Elev A 4 Bed - 4+1 Bath

TRIM

EXTRAS AS PER OFFER

SCHEDULE "B-1"
Floor Plan

Lot 24
Phase 5A
Model: Arthur (4205) Elev A 4 Bed - 4+1 Bath
Pie and Court Standard
Sketch # 7

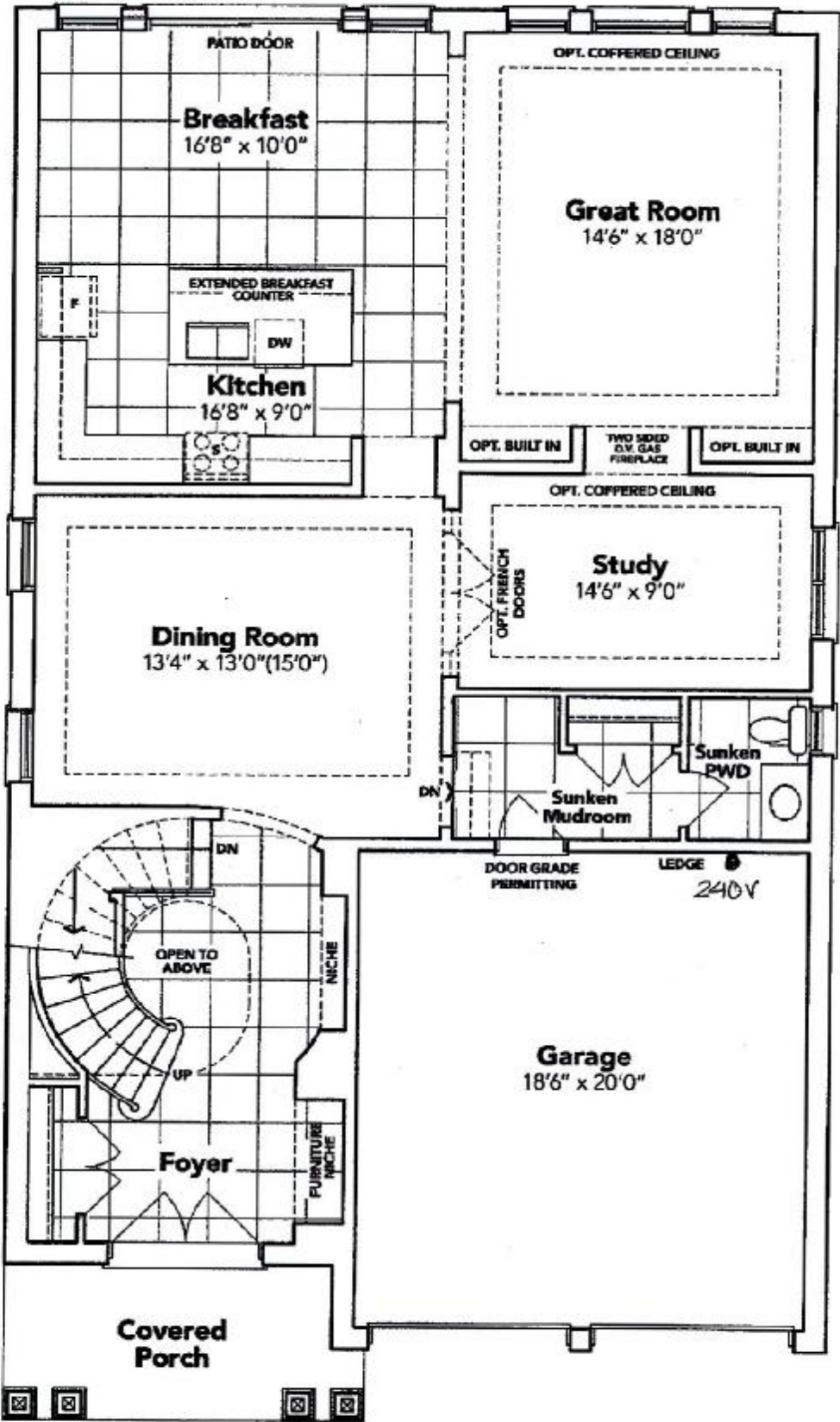

GROUND FLOOR EL. A

DS
GSS
DS
CS

The floor plans and elevations shown are pre-construction plans and may be revised or improved as necessitated by architectural controls and the construction process. The measurements adhere to the rules and regulations of the TARIION Warranty Corporation's official method for the calculation of floor area. Materials, specifications and floor plans are subject to change without notice. All house renderings are artist's concept only. Actual usable floor space may vary from the stated floor area. All options shown are upgrades. E. & O. E.

RECEIVED
JUN 10 2022