

KINGSMEN (THAMES) INC. / Havelock Corners (Kingsmen)

Lot/Unit: 94 Phase/Building: 5A Model/Floor Plan: Spencer (4204) Elev B 4 Bed - 4+1 Bath

CABINETRY

Inv.5669	1 - To accomdate for a 36" wide stove opening in lieu of the standard stove opening.	
Line 72514	Note:	
11Jul22 / 11Jul22		

CABINETRY APPLIANCE - FRIDGE

Inv.5669	1 - See fridge spec's attached.	
Line 72513	Note:	
11Jul22 / 11Jul22		

CABINETRY BASE CABINETS

Inv.5669	1 - To supply & install the 45CM WIDE PULL-OUT DOOR BASE CABINET WASTE - RECYCLE CENTRE 2 35L BINS - AVAILABLE ONLY WITH 45CM WIDE CABINET - in the kitchen... see sketch # 2	
Line 72532	Note:	
11Jul22 / 11Jul22		
Inv.5669	1 - To supply & install the PULL-OUT SPICE RACK CABINET - FULL-HEIGHT CABINET RECEIVES 3 TRAYS - TOP DRAWER CABINET RECEIVES 2 TRAYS - 30CM WIDE CABINETS in the kitchen... see sketch # 2	
Line 72533	Note:	
11Jul22 / 11Jul22		
Inv.5669	1 - To suply & install the POTS & PANS DRAWERS in the kitchen... see sketch # 1	
Line 72519	Note:	
11Jul22 / 11Jul22		

CABINETRY MICROWAVE OVEN STOVE COOKTOP

Inv.5669	1 - To accomdate for the future BUILT-IN TALL APPLIANCE CABINET WITH DRAWER - S BELOW FOR PANEL-MOUNT - PROUD - OR TRIM KIT INSTALLATIONS - TRIM KIT REQUIRED - SUPPLY ALL SPECS AND INSTALLATION GUIDES - COUNTER DEPTH -...see sketch # 1	
Line 72518	Note: NO FLUSH INSTALLATION.	
11Jul22 / 11Jul22		
Inv.5669	1 - To accomdate for the COOKTOP CABINET WITH FALSE TOP DRAWER AND POTS AND PANS DRAWERS BELOW - SUPPLY SPECS - in the kitchen... see spec's... see sketch # 2	
Line 72515	Note:	
11Jul22 / 11Jul22		

CABINETRY VANITY

Inv.5669	1 - To supply & install a VANITY BANK OF DRAWERS -in the master ensuite bathroom... see sketch # 2	
Line 72520	Note:	
11Jul22 / 11Jul22		
Inv.5669	2 - To supply & install a VANITY LOWER DRAWER in ensuite # 2's bathroom... see sketch # 2	
Line 72521	Note:	
11Jul22 / 11Jul22		

KINGSMEN (THAMES) INC. / Havelock Corners (Kingsmen)

Lot/Unit: 94 Phase/Building: 5A Model/Floor Plan: Spencer (4204) Elev B 4 Bed - 4+1 Bath

COUNTER TOP

Inv.5669	1 - To supply & install a quartz shower niche ' IMPERIAL BLACK' in the master ensuite shower ... see sketch # 2	
Line 72531	Note:	
11Jul22 / 11Jul22		
Inv.5669	1 - To accomodate the quartz countertop for the future 36" cooktop in the kitchen... see spec's	
Line 72516	Note:	
11Jul22 / 11Jul22		
Inv.5669	1 - As per schedule "PE": Vendor to include level 1, 2cm. quartz in all bathrooms, as per plan, in lieu of the included laminate counter tops. Selections to be made from builders standard samples.	
Line 72501	Note:	
11Jul22 / 11Jul22		

COUNTER TOP - KITCHEN

Inv.5669	1 - To supply & install the COUNTER TOP - KITCHEN - KITCHEN - 3CM COUNTER TOP - UPGRADE LEVEL 2 in lieu of the standard quartz countertop... see colour chart for details.	
Line 72517	Note:	
11Jul22 / 11Jul22		

ELECTRICAL

Inv.5669	1 - To SUPPLY AND INSTALL EXTRA 240 STOVE PLUG for the future wall oven/ microwave tower in the kitchen... see spec's... see sketch #1	
Line 72511	Note:	
11Jul22 / 11Jul22		
Inv.5669	1 - To upply & install a 36" wide reg. stainless steel hood fan in lieu of the standard 30" stainless steel hood fan in kitchen.	
Line 72512	Note:	
11Jul22 / 11Jul22		
Inv.5669	1 - To supply & install the standard T.V. rough in in the great room and master bedroom... see sketch # 1 & # 2	
Line 72502	Note: Install the standard T.V. rough in at approx. 66" + - up from the floor centered + - to the F/P mantle in the great room .	
11Jul22 / 11Jul22		
Inv.5669	1 - To supply & install the standard Phone (CAT 5) rough in in the great room, master bedroom and Media niche area on the second floor. ... see sketch # 1 & # 2	
Line 72503	Note: Install the standard Phone (CAT 5) rough in at approx. 66" + - up from the floor centered + - to the F/P mantle in the great room .	
11Jul22 / 11Jul22		
Inv.5669	1 - To SUPPLY AND INSTALL AN ADDITIONAL BASIC RECEPTACLE (NOT DEDICATED) at approx. 66" + - up from the floor centered + - to the F/P	
Line 72504	Note: in the great room... see sketch # 1	
11Jul22 / 11Jul22		
This is for a future wall mount T.V		
NO CONDUIT PIPE HAS BEEN PURCHASED.		
Inv.5669	1 - SUPPLY AND INSTALL EXTRA CEILING BOX ROUGH IN CAPPED (DOES NOT INCLUDE SWITCH)	
Line 72505	Note:	
11Jul22 / 11Jul22		

KINGSMEN (THAMES) INC. / Havelock Corners (Kingsmen)

Lot/Unit: 94 Phase/Building: 5A Model/Floor Plan: Spencer (4204) Elev B 4 Bed - 4+1 Bath

Inv.5669	1 - To supply & install AN ADDITIONAL SINGLE POLE SWITCH connected to the capped elec. over the kitchen island.	
Line 72506	Note:	
11Jul22 / 11Jul22		
Inv.5669	1 - Relocate the standard ceiling light from the upper stair landing to the O.T.B. area on the second floor... see sketch # 2	
Line 72507	Note: NO REINFORCING HAS BEEN PURCHASED.	
11Jul22 / 11Jul22		

HEATING AND AIR CONDITIONING

Inv.5669	1 - To supply & install a capped gas line (rough in only) with a 110 V elec. outlet code requirement for the future gas cooktop in the kitchen.	
Line 72508	Note:	
11Jul22 / 11Jul22		
Inv.5669	1 - As per schedule "PE": Vendor to install capped gas line (rough in only) at rear of home for future BBQ location. Location to be finalized at vendors sole descretion.	
Line 72499	Note:	
11Jul22 / 11Jul22		
Inv.5669	1 - As per schedule "PE": Vendor to supply & install air conditioning unit, sized accordingly, from vendors standard samples.	
Line 72500	Note:	
11Jul22 / 11Jul22		

MISCELLANEOUS

PLUMBING

Inv.5669	1 - To supply & install the KITCHEN SINK - BLANCO QUATRUS U2 DBL UNDERMOUNT - MODEL 401247 in the kitchen in lieu of the standard undermount kitchen sink... see spec's	
Line 72522	Note: Still to install the standard single hole kitchen faucet NO PLATE.	
11Jul22 / 11Jul22		
Inv.5669	6 - To supply & install the VANITY SINK - CONTRAC CATENA UNDERMOUNT - MODEL 4210CIY in the powder room, master ensuite, ensuite #2, #3 & #4s bathroom in lieu of the standard top mount vanity sinks... see spec's	
Line 72523	Note: Still to install the standard lav. faucets.	
11Jul22 / 11Jul22		
Inv.5669	1 - To supply & install the KITCHEN SOAP Dispencer - MOEN CHROME - MODEL 3944 in the kitchen... see spec's... see sketch for installation location..	
Line 72524	Note:	
11Jul22 / 11Jul22		
Inv.5669	1 - To suply & insall a WATERLINE ROUGH-IN TO THE FRIDGE LOCATION (NO HOOK UP) in the kitchen.	
Line 72509	Note:	
11Jul22 / 11Jul22		
Inv.5669	1 - To supply & install a WATERLINE ROUGH-IN TO THE DRYER LOCATION (NO HOOK UP) in the laundry room	
Line 72510	Note:	
11Jul22 / 11Jul22		

KINGSMEN (THAMES) INC. / Havelock Corners (Kingsmen)

Lot/Unit: 94 Phase/Building: 5A Model/Floor Plan: Spencer (4204) Elev B 4 Bed - 4+1 Bath

TILE - FLOOR

Inv.5669	1 - To supply & install the UPGRADE 4 - FLOOR TILE - STACKED - FOYER TILE in lieu of the standard floor tile... see colour chart for details.	
Line 72525	Note:	
11Jul22 / 11Jul22		
Inv.5669	1 - To supply & install the UPGRADE 4 - FLOOR TILE - STACKED - MUD ROOM TILE in lieu of the standard floor tile... see colour chart for details.	
Line 72526	Note:	
11Jul22 / 11Jul22		
Inv.5669	1 - To supply & install the UPGRADE 4 - FLOOR TILE - STACKED - POWDER ROOM TILE in lieu of the standard floor tile... see colour chart for details.	
Line 72527	Note:	
11Jul22 / 11Jul22		
Inv.5669	1 - To supply & install the UPGRADE 4 - FLOOR TILE - STACKED - KITCHEN/BREAKFAST TILE in lieu of the standard floor tile... see colour chart for details.	
Line 72528	Note:	
11Jul22 / 11Jul22		

EXTRAS AS PER OFFER

5 FREE APPLIANCES – STAINLESS STEEL FRONT - FRIDGE; STOVE AND DISHWASHER. WHITE WASHER AND DRYER (SUPPLIED ONLY, NOT INSTALLED, FROM BUILDERS STANDARD LINE). AN APPLIANCES VOUCHER WILL BE GIVEN BY OUR DECOR CONSULTANT AT THE TIME OF BOOKING YOUR COLOUR A <i>Worksheet</i> Note:	
VENDOR TO INSTALL CAPPED GAS LINE (ROUGH-IN ONLY) AT REAR OF HOME FOR FUTURE BBQ LOCATION. LOCATION TO BE FINALIZED AT VENDORS SOLE DISCRETION. <i>Worksheet</i> Note:	
VENDOR TO SUPPLY & INSTALL AIR CONDITIONING UNIT, SIZED ACCORDINGLY, FROM VENDORS STANDARD SAMPLES. <i>Worksheet</i> Note:	
VENDOR TO INCLUDE LEVEL 1, 2CM QUARTZ IN ALL BATHROOMS, AS PER PLAN, IN LIEU OF THE INCLUDED LAMINATE COUNTER TOPS. SELECTIONS TO BE MADE FROM BUILDERS STANDARD SAMPLES. <i>Worksheet</i> Note:	

5A-10794



Purchaser: GURIQBAL SINGH

Property: 94 of Plan - Draft Approval SB17-03-08

Telephone Res. / Bus: /

Project: KINGSMEN (THAMES) INC.

Decor Advisor: Barbara Coccia

Model and Elevation: Spencer (4204) Elev B 4 Bed - 4+1 Bath

Layout Changes: ☐ Yes ☒ No

Sketch Attached: ☒ Yes ☐ No

Exterior Colour Scheme:

1. Cabinetry

	Style and Colour	Counter Top	Hardware
Kitchen / Breakfast	#3, Manchester Maple Shale Grey CL	*#2, H/S Whistler 3cm.	# 12881 Handle
Kitchen Island	#3, Manchester Maple Shale Grey CL	*#2, H/S Whistler 3cm.	# 12881 Handle
Laundry Room	/		
Powder Room	#3, Simcoe Orchid	#1, C/S # 3040 Cement 2cm.	#96171 Handle
Main Bathroom	/		
Master Ensuite Bathroom	#3, Manchester Maple Cavier CL	#1, C/S # 9141 Ice Snow 2cm.	#96171 Handle
Second Ensuite Bathroom (If Applicable)	#3, Simcoe Rain Cloud	#1, C/S # 9141 Ice Snow 2cm.	#96171 Handle
Ens. #3's bathroom	#3, Simcoe Rain Cloud	#1, C/S # 9141 Ice Snow 2cm.	#96171 Handle
Ens. #4's bathroom	#3, Trinity Viva Weekend Getaway	#1, C/S #6041 Nordic Loft 2cm.	#96171 Handle

Appliances

Custom Size Fridge

☒ Yes ☐ No

Valance Lighting

☐ Yes ☒ No

Microwave / Range Hood

☐ Yes ☒ No

Cooktop / Rangetop

☒ Yes ☐ No

Built in Wall Oven

☒ Yes ☐ No

Slide-in Range

☐ Yes ☒ No

Comment

2. Flooring

	Selection
Foyer	**Upg. 4, 24 x 24" Mayfair Volakas Grigio HD Polished Porcelain STACKED
Main Hall	3 1/2" Elements oak Sturgeon
Back Hall	/
Breakfast	**Upg. 4, 24 x 24" Mayfair Volakas Grigio HD Polished Porcelain STACKED
Laundry Room	13 x 13" Bellina Grey
Kitchen	**Upg. 4, 24 x 24" Mayfair Volakas Grigio HD Polished Porcelain STACKED
Powder Room	**Upg. 4, 24 x 24" Mayfair Volakas Grigio HD Polished Porcelain STACKED
Main Bathroom	/
Master Ensuite	13 x 13" Bellina Grey
Bathroom (If Applicable)	Ens. #2 & #3 Bathrooms: 13 x13" Cinq Black
Mud Room	**Upg. 4, 24 x 24" Mayfair Volakas Grigio HD Polished Porcelain STACKED
Master & ens.#2's shower	Floor: 2x2" Ontario Snow white matte
Living Room	Ensuite #4's bathroom: 13 x13" Keaton Carbon
Dining Room	3 1/2" Elements oak Sturgeon
Family / Great Room	3 1/2" Elements oak Sturgeon
Den / Library / Study	/
Basement Landing (If Applies)	
Lower Landing (If Applicable)	3 1/2" Elements oak Sturgeon
Upper Landing	3 1/2" Elements oak Sturgeon
Upper Hall	Modern Story , # 827 Perfect Neutral
Master Bedroom	Modern Story , # 827 Perfect Neutral
Bedroom #2	Modern Story , # 827 Perfect Neutral
Bedroom #3	Modern Story , # 827 Perfect Neutral
Bedroom #4	Modern Story , # 827 Perfect Neutral
Bedroom #5	/
Master&Ens.2 shower jamb	Anatolia marmilne SNOW

SEE ATTACHED FOR SIGNATURES

RECEIVED

JUL 13 2022

Flooring Continued on Page 2

Initial:



Page 1 of 3

Purchaser: GURIBAL SINGH

Property: 94 of Plan - Draft Approval SB17-03-08

Telephone Res. / Bus: /

Project: KINGSMEN (THAMES) INC.

Decor Advisor: Barbara Coccia

Model and Elevation: Spencer (4204) Elev B 4 Bed - 4+1 Bath

2. Flooring - Continued -

Upgrade Underpad	Type	Area
	Standard	2nd. Floor
Carpet on Stairs	Capped	Runner - *Upgrade
Comment	/	/

3. Plumbing Fixtures / Faucets

Kitchen	Standard	Second Ensuite	Standard	Powder Room	Standard
Master Ensuite	Standard			Other Room	/
Main Bathroom	/	Ens. # & 4's bathrooms	Standard		

Comment

Purchaser has upgraded the under mount kitchen sink, still to install the standard single hole kitchen faucet NO PLATE.
Purchaser has upgraded to under mount vanity sinks to ALL bathroom, still to install the standard lav. faucets.

4. Wall Tile

	Tile Selection	Listello	Insert	Insert Selection
Main Bathroom	/	<input type="checkbox"/>	<input type="checkbox"/>	
Master Ensuite				
Tub Deck	/	<input type="checkbox"/>	<input type="checkbox"/>	
Tub Apron	/	<input type="checkbox"/>	<input type="checkbox"/>	
Tub Surround	/	<input type="checkbox"/>		
Shower Stall	8x10" Cinq Black	<input type="checkbox"/>	<input type="checkbox"/>	
Second Ensuite	8x10" Cinq Grey	<input type="checkbox"/>	<input type="checkbox"/>	
Ensuite #3's bathroom	8x10" Cinq Grey	<input type="checkbox"/>	<input type="checkbox"/>	
Ensuite #4's bathroom	8x10: Keaton Carbon	<input type="checkbox"/>	<input type="checkbox"/>	
Kitchen Backsplash	/	<input type="checkbox"/>	<input type="checkbox"/>	
Complete Backsplash	/	<input type="checkbox"/>	<input type="checkbox"/>	

Comment

Install the standard 8x10" wall tiles on the 10" side stacked horizontally to ALL bathrooms where applicable.

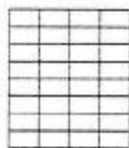

horizontal stacked

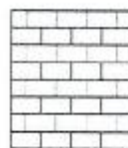

brick pattern

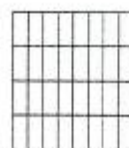

vertical stacked



diagonal/diamond

5. Fireplace

	Living Room			Family Room			Other Room - Specify			Great Room
	Purchased	As Per Plan	N/A	Purchased	As Per Plan	N/A	Purchased	As Per Plan	N/A	
Fireplace Type	<input type="radio"/>	<input type="radio"/>	<input checked="" type="radio"/>	<input type="radio"/>	<input type="radio"/>	<input checked="" type="radio"/>	<input type="radio"/>	<input checked="" type="radio"/>	<input type="radio"/>	
Mantle Type										NF-08
Over Mantle										Front Facing
Colour / Stain										/
Surround										White
Hearth										/
Comment										/

RECEIVED

JUL 13 2022

SEE ATTACHED FOR SIGNATURES



Initial: _____



Page 2 of 3

Purchaser: GURIBAL SINGH

Telephone Res. / Bus: /

Decor Advisor: Barbara Coccia

Property: 94 of Plan - Draft Approval SB17-03-08

Project: KINGSMEN (THAMES) INC.

Model and Elevation: Spencer (4204) Elev B 4 Bed - 4+1 Bath

6. Trim Carpentry

Door Hardware Standard handle

Interior Trim Standard

Comment

/

Interior Doors

☐ 2 Panel Arch Top

☒ 2 Panel Square Top

☐ 6 Panel

Initial for Door Style



7. Railings and Pickets

Railing Package Standard oak STRAIGHT picket package

Railing Colour Elements Sturgeon

Wood Stairs ☐ No ☒ Oak

Comment

/

Picket Colour Elements Sturgeon

Tread Colour Elements Sturgeon

SEE ATTACHED FOR SIGNATURES

8. Plaster Mouldings and Medallions

Foyer /

Main Hall /

Living Room /

Dining Room /

Family Room /

Comment

/

Kitchen/Breakfast /

Den/Library /

Lower Landing /

9. Wall Paint

Kingsmen White

Smooth Ceilings

☐ First Floor

☐ First Floor incl. Second Floor Hall

☐ First and Second Floor

☒ Throughout

☐ Not Applicable

Trim Paint Kingsmen White

10. Additional Comments

/

11. Disclaimers and Notes

- Colours of all materials are as close as possible to builder's selection, but not necessarily identical due to variances in manufacturing.
- Any extras listed above are null and void unless accompanied by a separate invoice/amendment. Said invoice must be paid in full.
- The Purchaser acknowledges that after Interior Colour Selection form is signed and dated, no further changes will be permitted other than re-selection due to unavailability. Purchaser's Initials **SEE ATTACHED FOR SIGNATURES**
- The Purchaser acknowledges reading and accepting the "Kingsmen Group Decor Centre Disclaimers" form. This document contains other miscellaneous disclaimers.

This Interior Colour Selection is final and approved by:

Purchaser:

Signature: **SEE ATTACHED FOR SIGNATURES**

Date

RECEIVED

JUL 13 2022

Vendor:

KINGSMEN (THAMES) INC.

July 13/22

SCHEDULE "B-1" Floor Plan

Lot 94
Phase 5A
Model: Spencer (4204) Elev B 4 Bed - 4+1 Bath
Standard

sketch 4/

SEE ATTACHED FOR SIGNATURES

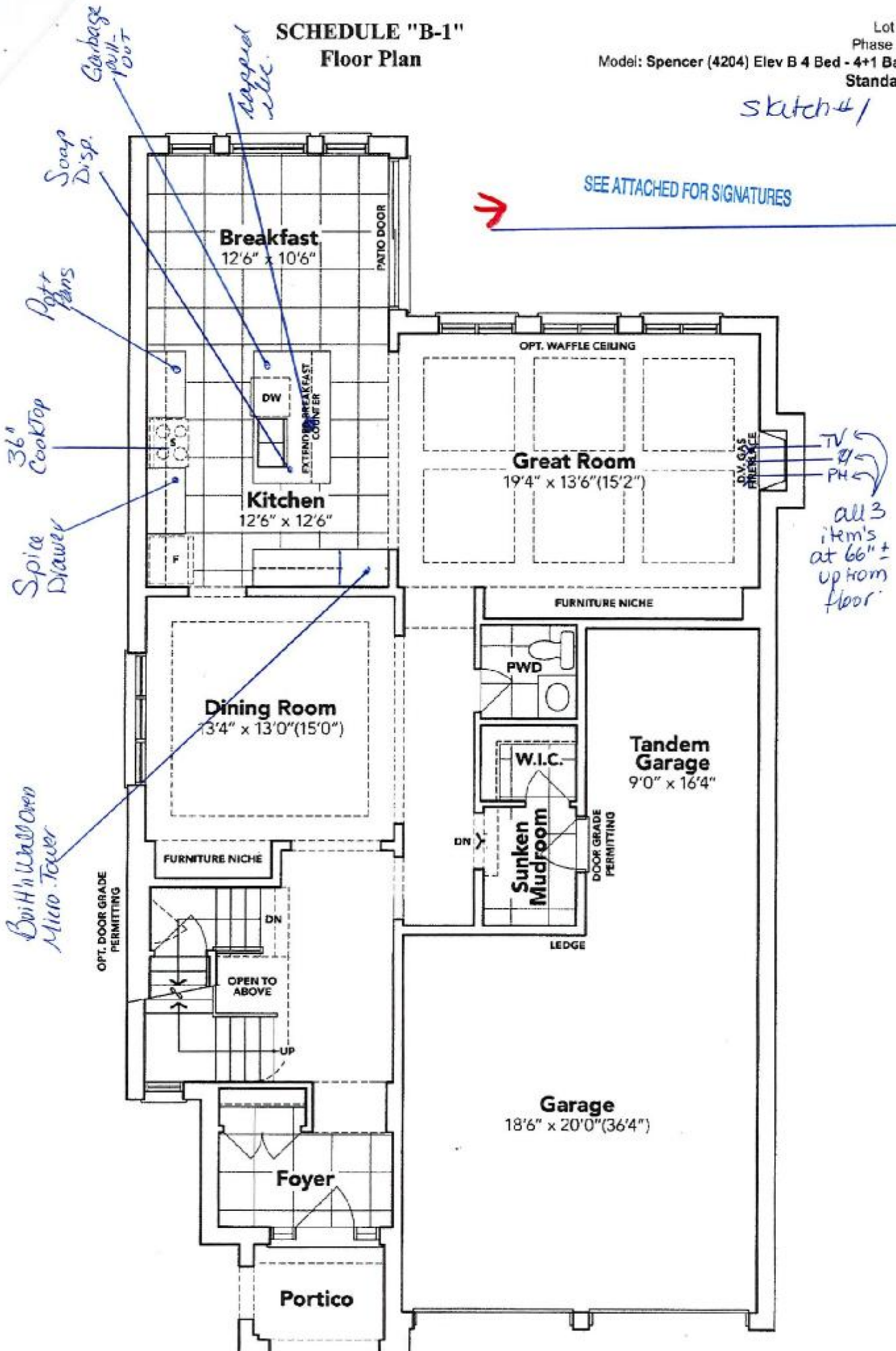

GROUND FLOOR EL. B

The floor plans and elevations shown are pre-construction plans and may be revised or improved as necessitated by architectural controls and the construction process. The measurements adhere to the rules and regulations of the TARION Warranty Corporation's official method for the calculation of floor area. Materials, specifications and floor plans are subject to change without notice. All house renderings are artist's concept only. Actual usable floor space may vary from the stated floor area. All options shown, are upgrades. E. & O. E.

RECEIVED

JUL 13 2022

SCHEDULE "B-1" Page 3 of 3

Initials: GS

SCHEDULE "B-1"
Floor Plan

Lot 94
Phase 5A
Model: Spencer (4204) Elev B 4 Bed - 4+1 Bath
Standard

Sketch #2

SEE ATTACHED FOR SIGNATURES

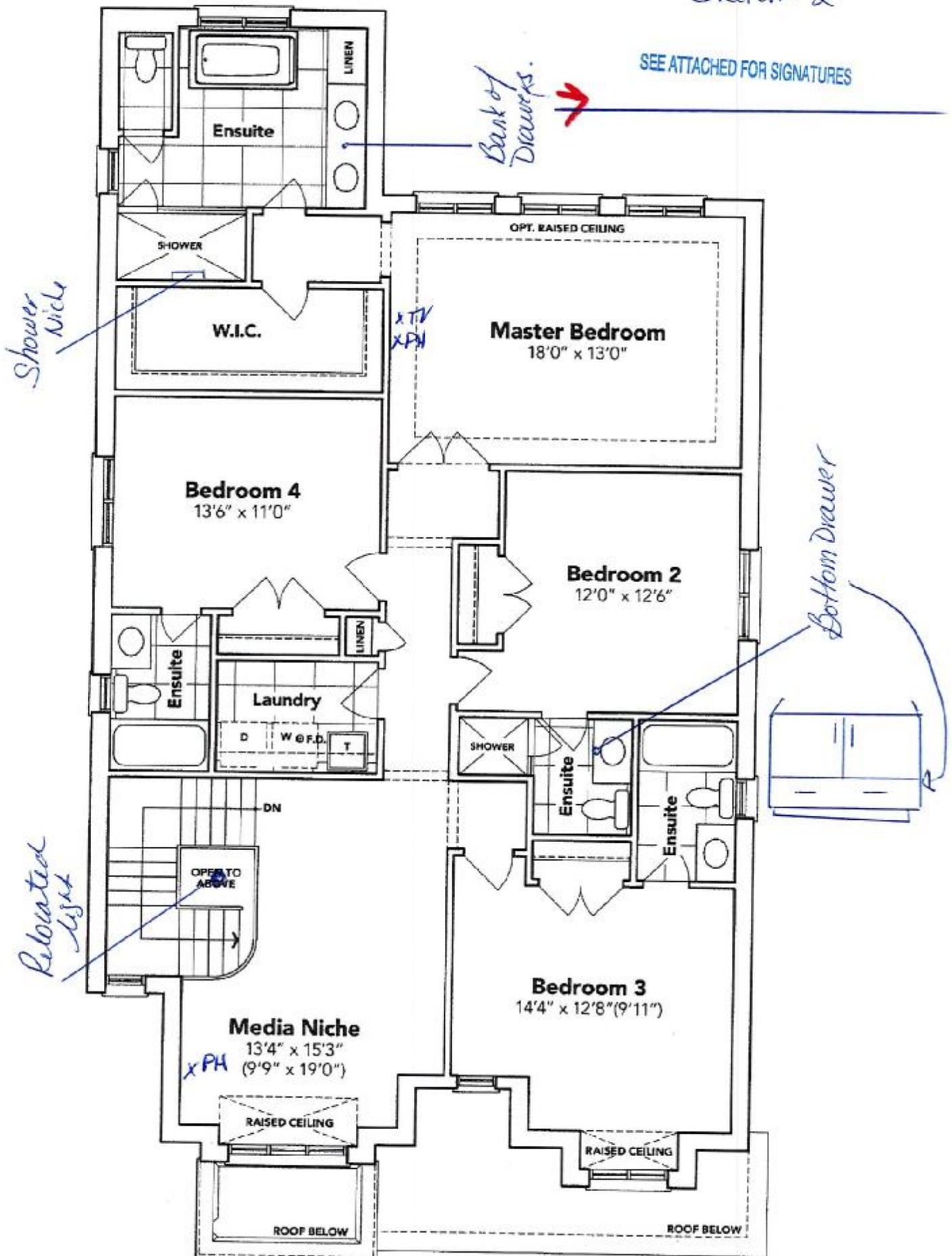

SECOND FLOOR EL. B

The floor plans and elevations shown are pre-construction plans and may be revised or improved as necessitated by architectural controls and the construction process. The measurements adhere to the rules and regulations of the TARIION Warranty Corporation's official method for the calculation of floor area. Materials, specifications and floor plans are subject to change without notice. All house renderings are artist's concept only. Actual usable floor space may vary from the stated floor area. All options shown are upgrades. E. & O. E.

RECEIVED
JUL 13 2022

SCHEDULE "B-1" - Page 2 of 3

Initials: _____

CS

SCHEDULE "B-1"
Floor Plan

Lot 94
Phase 5A
Model: Spencer (4204) Elev B 4 Bed - 4+1 Bath
Standard

Sketch #3

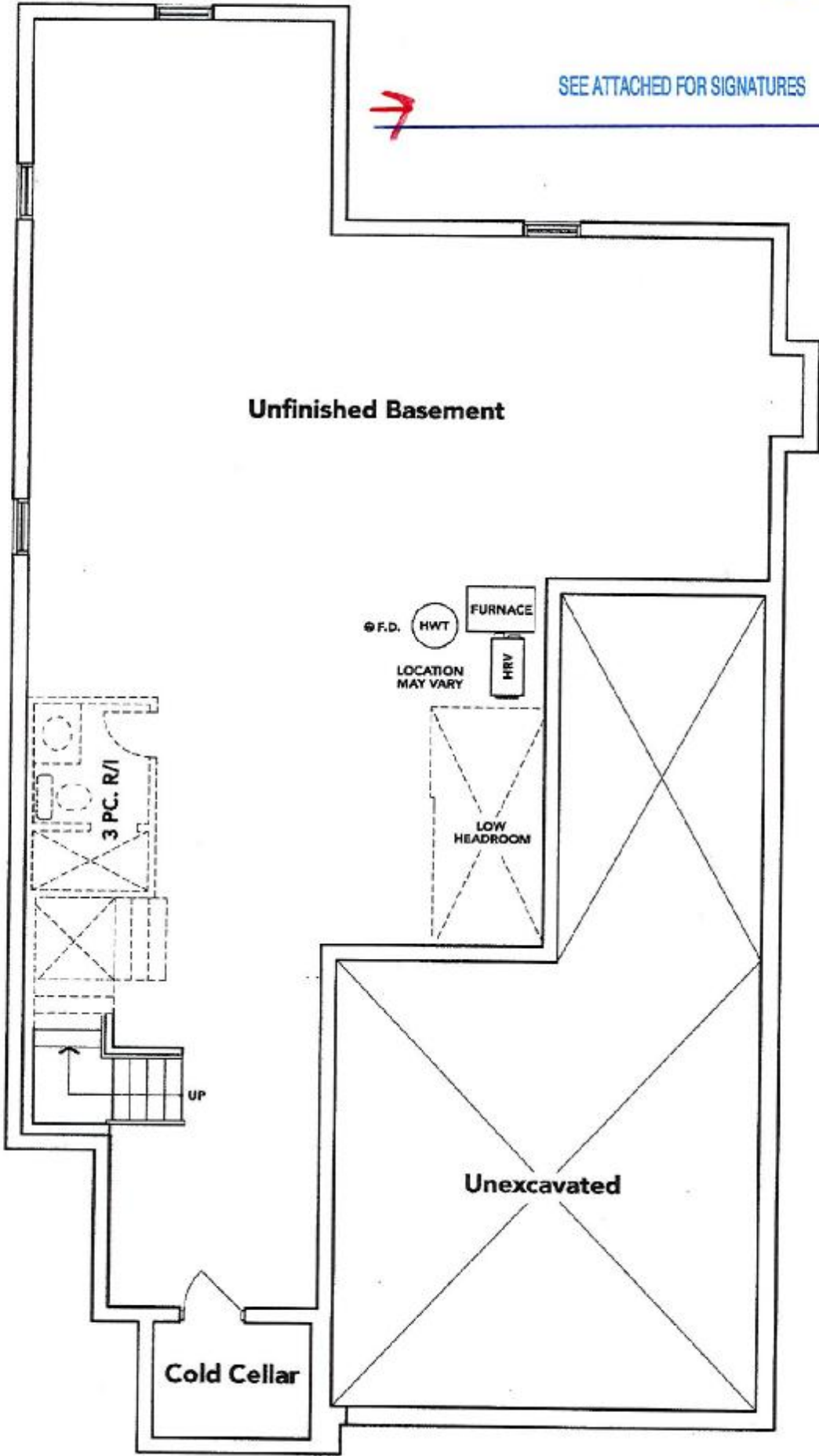

BASEMENT EL. B

The floor plans and elevations shown are pre-construction plans and may be revised or improved as necessitated by architectural controls and the construction process. The measurements adhere to the rules and regulations of the TARION Warranty Corporation's official method for the calculation of floor area. Materials, specifications and floor plans are subject to change without notice. All house renderings are artist's concept only. Actual usable floor space may vary from the stated floor area. All options shown are upgrades. E. & O. E.



LOT 94 THAMES PH. 5 A
RE: UPGRADE UNDER MOUNT KITCHEN
SINK WITH SOAP DISPENSER

SEE ATTACHED FOR SIGNATURES



BLANCO

Sink Specifications

Colour	SKU
brushed finish	401247

Design and planning tips

- Min cabinet size: 36 in (915 mm)
- Bowl Depth: 9 in (230.0 mm)

Specifications:

Installation clips, Sink template, Installation instructions, 3
1/2" (90 mm) stainless steel strainers

Depending on cabinet construction, a different cabinet
size may be required. Consult the cabinet manufacturer.

QUATRUS U 2

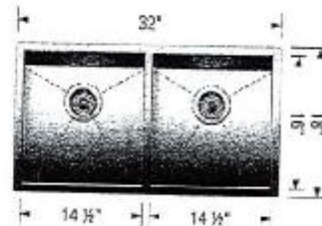

Transitional Soap or Lotion
Dispenser

Model 3944



LOT 94 THAMES PH. 5 A
RE: UPGRADE UNDER MOUNT VANITY
SINKS FOR ALL BATHROOMS



SEE ATTACHED FOR SIGNATURES

CATENA
RECTANGULAR UNDERMOUNT SINK

4210CIV Undermount Sink

PRODUCT SPECS:

- Vitreous china
- Front overflow hole
- Template and mounting hardware supplied

DIMENSIONS:

Outer:
510mm W x 390mm D x 190mm H
20" W x 15 1/2" D x 7 1/2" H
Inner:
458mm W x 340mm D x 140mm H
18" W x 13 1/2" D x 5 1/2" H

COMPLIANCE CERTIFICATIONS

- Meets or exceeds the following:
- IAPMO cUPC
 - ASME A112.19.2 / CSA B45.1
 - OBC Section 3.8 Barrier Free design and CSA B651 Standard

SHIPPING

Cube 1.72
GW 27 lbs

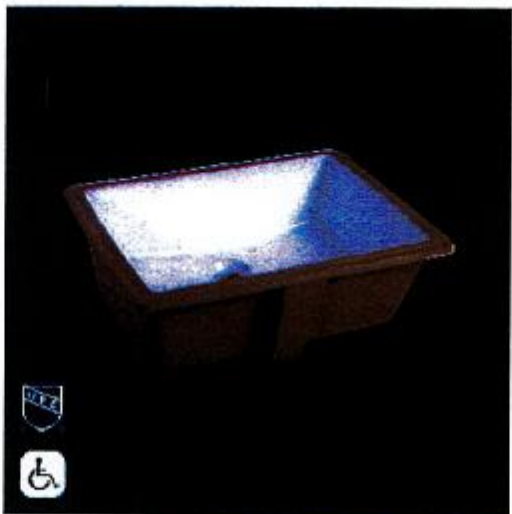
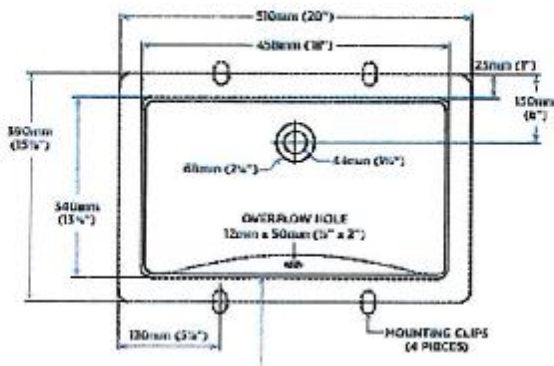

TO BE SPECIFIED

- Color
- Soft White

NOTES: Dimensions of fixtures are nominal and may vary within the range of variances established by ASME, Unified A11.2. These dimensions are subject to change or correction. Responsibility is assumed for use of superseded or voided pages.

Products are designed to comply with CSA B651 Standard and OBC barrier free requirements. It is the responsibility of the specifier to comply with the local disability codes and standards prior to installing the product.

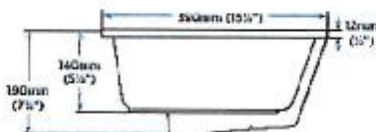

LOT: 94 THAMES PH. 5 A
RE: FRIDGE SPEC'S

SEE ATTACHED FOR SIGNATURES



36" Counter-Depth 4-Door Refrigerator

800 Series – Stainless Steel B36CL80ENS



BOSCH
Invented for life

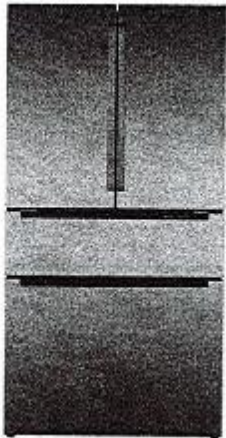

B36CL80ENS
Stainless Steel w/
Recessed Handles

Introducing the revolutionary, new FarmFresh System™, with four freshness technologies designed to work together to keep your food fresher, longer. Enjoy less food waste, new innovative features and more thoughtful design.

Features & Benefits

VitaFreshPro™ provides pre-programmed freshness settings to optimize temperature and humidity to keep meat, fish, and produce fresher, longer.

Interior Water Dispenser is thoughtfully placed inside for refreshing water at the touch of a button or a push of a nozzle.

FlexBar™ utilizes typically unused space in the upper refrigerator cavity.

Recessed handle provides flush design to match any sleek kitchen.

General Properties

Full 72" height and true counter depth for built-in appearance	Yes
Easy Clean Stainless Steel	Yes
Lighting	Recessed LED light bars
Number of compressors/evaporators	2 / 2
Defrost process refrigerator section	Frost-free
Number of shelves – refrigerator	5
Adjustable shelves – refrigerator	4 half-width
Shelf material – refrigerator	Tempered glass
Type of shelves – refrigerator	Frameless split shelves with metal trim
Flexible storage bar	FlexBar™
Gallon storage bins	2
Humidity control compartments	2
Full width temp. & humidity controlled drawer	VitaFreshPro™
Ice maker	Yes
Water filter	UltraClarityPro™
Internal water dispenser	Yes
Touch control panel	Yes
AirFresh® filter	Yes
FreshProtect™ ethylene filter	Yes
MultiAirFlow™	Yes
Stainless steel back wall	Yes
Defrost process freezer section	Automatic
Number of drawers – freezer	3
Wi-Fi enabled	Yes, Home Connect™ app

Capacity

Total capacity (cu. ft.)	20.5
Refrigerator capacity (cu. ft.)	14.5
Freezer capacity (cu. ft.)	6

Technical Details

Current (A)	15 A
Volts (V)	115 V
Frequency (Hz)	60 Hz
Power cord length (in.)	91
Plug type	120V-3 prong

Dimensions & Weight

Appliance dimensions with hinges and doors (H x W x D) (in.)	72** x 35 5/8" x 28 3/4"
Appliance dimensions without hinges and doors (H x W x D) (in.)	71 1/2" x 35 5/8" x 24***
Required cutout size (H x W x D) (in.)	72" x 36" x 25"
Net weight (lbs)	350 lbs

Efficiency

Energy consumption (kWh/yr)	568
ENERGY STAR® qualified	Yes

Accessories

UltraClarityPro™ Water Filter: BORPLFTR50
FlexBar™ Bottle Holder: BOFLEXBOTL
FlexBar™ Deep Shelf: BOFLEXLGSH
FlexBar™ Shallow Shelf: BOFLEXSMH
Ethylene Filter Refill Kit: FPETHRF50

Home Connect



*When leveling legs are fully extended, add 5/8" to overall height, total 72 5/8".

**The cutout depth of 25" includes the required 1" airflow. The electrical covers on the back of unit do not require additional depth.

Accessories: To purchase Bosch accessories, cleaners & parts please visit www.bosch-home.com/us/store or call 1-800-944-2904 (Mon to Fri 5 am to 6 pm PST, Sat 6 am to 3 pm PST).

Notes: All height, width and depth dimensions are shown in inches. BSH reserves the absolute and unrestricted right to change product materials and specifications, at any time, without notice. Consult the product's installation instructions for final dimensional data and other details prior to making cutout.

Warranties: Please see Use & Care manual or Bosch website for statement of limited warranty.

For more information on our entire line of products, go to www.bosch-home.com/us or call 1-800-944-2904

© BSH Home Appliances Corporation. All rights reserved. Bosch is a registered trademark of Robert Bosch GmbH.



SEE ATTACHED FOR SIGNATURES

36" Counter-Depth 4-Door Refrigerator

800 Series – Stainless Steel B36CL80ENS



BOSCH
Invented for life

Installation Details

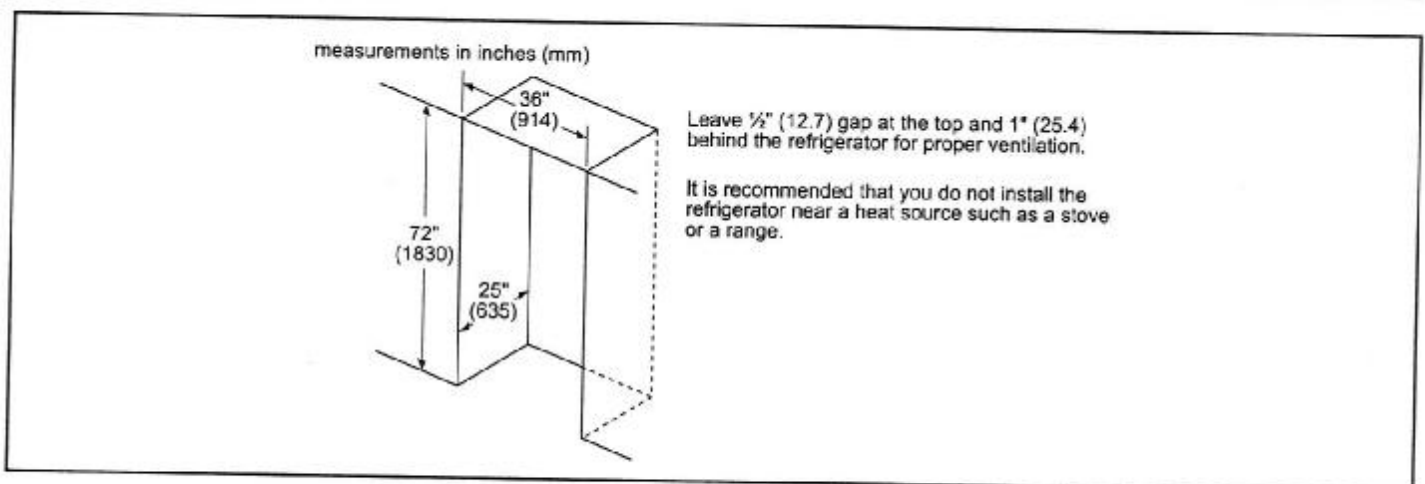
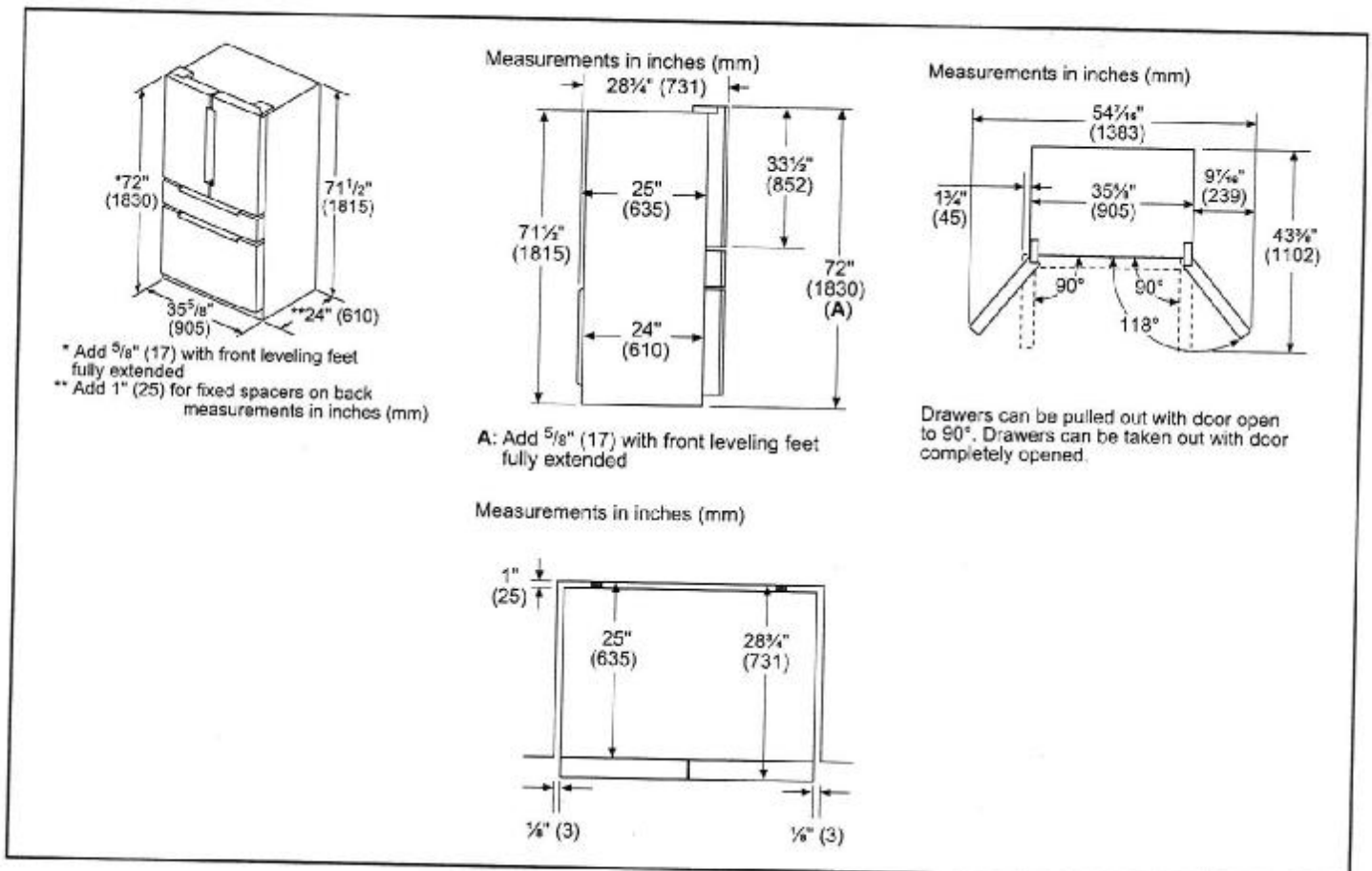

Accessories: To purchase Bosch accessories, cleaners & parts please visit www.bosch-home.com/us/store or call 1-800-944-2904 (Mon to Fri 5 am to 6 pm PST, Sat 6 am to 3 pm PST).
Notes: All height, width and depth dimensions are shown in inches. BSH reserves the absolute and unrestricted right to change product materials and specifications, at any time, without notice. Consult the product's installation instructions for final dimensional data and other details prior to making cutout.
Warranties: Please see Use & Care manual or Bosch website for statement of limited warranty.

For more information on our entire line of products, go to www.bosch-home.com/us or call 1-800-944-2904

© BSH Home Appliances Corporation. All rights reserved. Bosch is a registered trademark of Robert Bosch GmbH.

LOT: 94 THAMES PH. 5 A
RE: 35" GAS COOK TOP SPEC'S



SEE ATTACHED FOR SIGNATURES

36" Gas Cooktop

800 Series – Stainless Steel NGM8657UC



NGM8657UC
Stainless Steel

The stainless steel gas cooktop with FlameSelect® – achieve consistent cooking results thanks to nine precisely defined power levels.

Features & Benefits

FlameSelect® – allows for a precise adjustment of the flame size with nine defined power levels

Dual flame power burner with two heat options, quickly boil water or maintain a precise simmer

Heavy-duty grates can be easily and quickly cleaned in the dishwasher

OptiSim® burner – simmer delicate sauces and melt chocolate without scorching

Low profile stainless steel cooking surface is easily accessible and quick to clean

General Properties

No. of burners	5
Knob color	Stainless steel appearance
Control location	Front-center
Sealed burners	Yes
Gas valves	Five 9-level step valves
Ignition system	Electric; thermocouple safety control
Cooktop surface material	Stainless steel
Grate material	Cast iron
Grate features	Continuous grates; dishwasher safe

Element Performance

Total BTU load (NG / LP)	41,400 / 40,100
Power of front left burner (NG / LP) OptiSim®	3,400 / 3,400 BTU
Power of back left burner (NG / LP)	6,000 / 6,000 BTU
Power of center burner (NG / LP) Dual-flame	17,000 / 15,700 BTU
Power of back right burner (NG / LP)	9,000 / 9,000 BTU
Power of front right burner (NG / LP)	6,000 / 6,000 BTU

Technical Details

Circuit breaker	15 A
Volts	120 V
Frequency	60 Hz
Plug type	3-prong
Power cord length	40"
Fuel type	Natural Gas (factory set)
Convertible to LP (kit required)	Yes

Dimensions & Weight

Overall appliance dimensions (HxWxD)	2 23/64" x 36" x 20 1/2"
Required cutout size (HxWxD)	1 1/4" x 33 1/2" x 19 5/16"
Minimum distance from counter front	1 7/8"
Minimum distance from rear wall	3"
Net weight	42 lbs

Accessories – Included

Included	LP conversion kit, OptiSim® cap
----------	---------------------------------

Accessories – Optional



HEZ298107
Wok ring



FlameSelect

Accessories: To purchase Bosch accessories, cleaners & parts please visit www.bosch-home.com/us/store or call 1-800-944-2904 (Mon to Fri 5 am to 6 pm PST, Sat 6 am to 3 pm PST).
Notes: All height, width and depth dimensions are shown in inches. BSH reserves the absolute and unrestricted right to change product materials and specifications, at any time, without notice. Consult the product's installation instructions for final dimensional data and other details prior to making cutout.
Warranties: Please see Use & Care manual or Bosch website for statement of limited warranty.
For more information on our entire line of products, go to www.bosch-home.com/us or call 1-800-944-2904
© BSH Home Appliances Corporation. All rights reserved. Bosch is a registered trademark of Robert Bosch GmbH.

SEE ATTACHED FOR SIGNATURES

36" Gas Cooktop

800 Series – Stainless Steel NGM8657UC



Installation Details

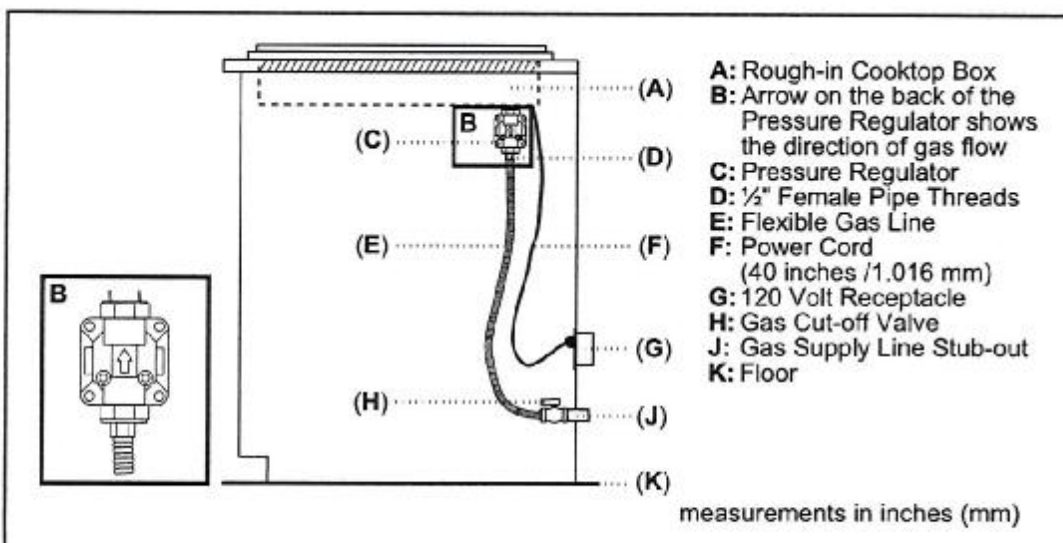
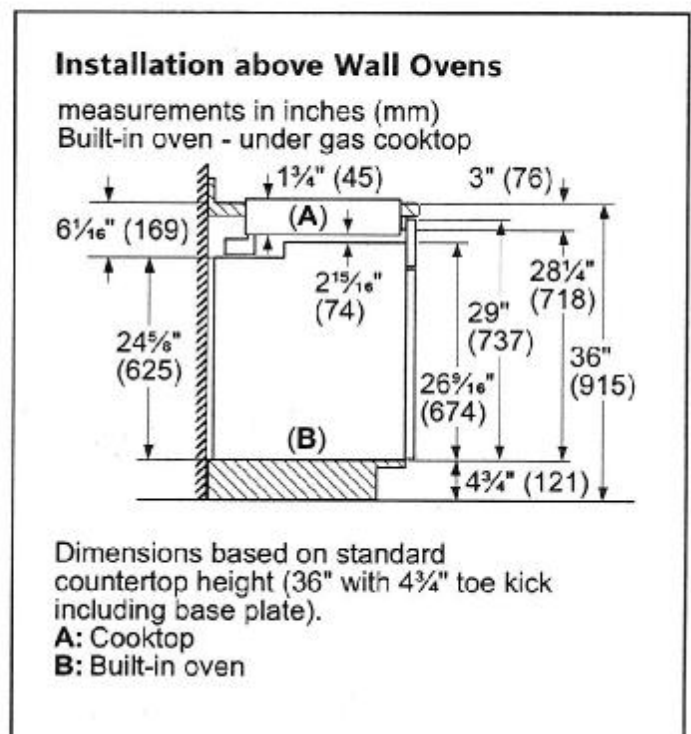
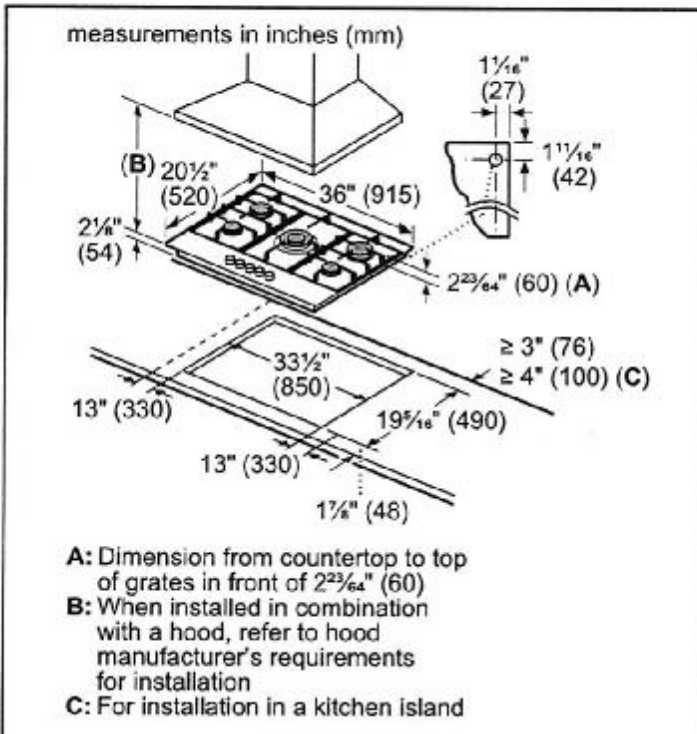

Accessories: To purchase Bosch accessories, cleaners & parts please visit www.bosch-home.com/us/store or call 1-800-944-2904 (Mon to Fri 5 am to 6 pm PST, Sat 6 am to 3 pm PST).
Notes: All height, width and depth dimensions are shown in inches. BSH reserves the absolute and unrestricted right to change product materials and specifications, at any time, without notice. Consult the product's installation instructions for final dimensional data and other details prior to making cutout.

Warranties: Please see Use & Care manual or Bosch website for statement of limited warranty.

For more information on our entire line of products, go to www.bosch-home.com/us or call 1-800-944-2904

© BSH Home Appliances Corporation. All rights reserved. Bosch is a registered trademark of Robert Bosch GmbH.

LOT: 94 THAMES PH. 5 A
RE: 36" GAS COOK TOP SPEC'S CONT

SEE ATTACHED FOR SIGNATURES



36" Gas Cooktop

800 Series – Stainless Steel NGM8657UC



BOSCH
Invented for life

Installation Details

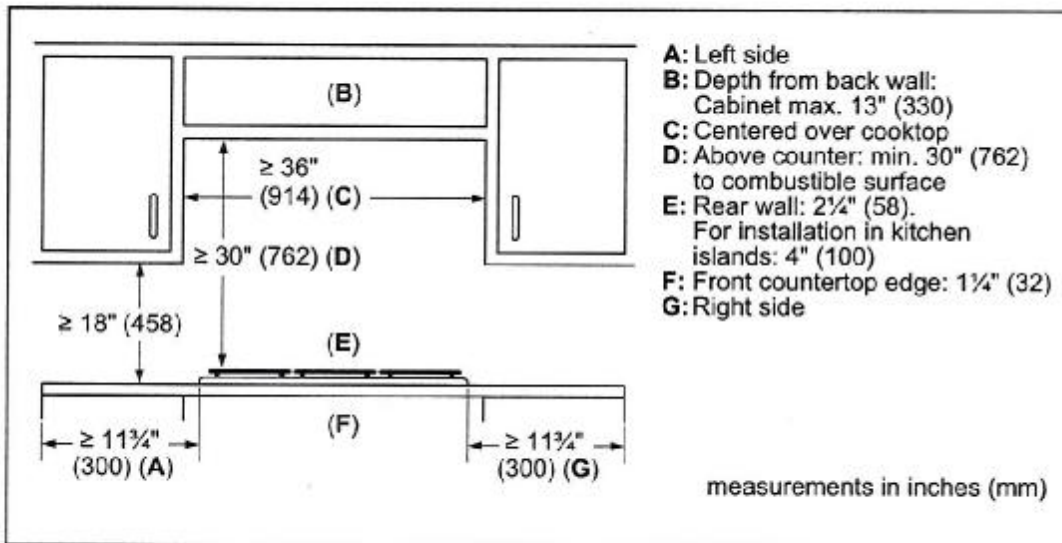

Accessories: To purchase Bosch accessories, cleaners & parts please visit www.bosch-home.com/us/store or call 1-800-944-2904 (Mon to Fri 5 am to 6 pm PST, Sat 6 am to 3 pm PST).

Notes: All height, width and depth dimensions are shown in inches. BSH reserves the absolute and unrestricted right to change product materials and specifications, at any time, without notice. Consult the product's installation instructions for final dimensional data and other details prior to making cutout.

Warranties: Please see Use & Care manual or Bosch website for statement of limited warranty.

For more information on our entire line of products, go to www.bosch-home.com/us or call 1-800-944-2904

© BSH Home Appliances Corporation. All rights reserved. Bosch is a registered trademark of Robert Bosch GmbH.

06/19

LOT: 94 THAMES PH. 5 A
RE: WALL OVEN COMBO SPEC'S
" NO FLUSH MOUNT ACCOMODATIONS"

SEE ATTACHED FOR SIGNATURES

30" Speed Combination Oven

800 Series – Stainless Steel HBL8753UC



HBL8753UC
Stainless Steel

Also available in:

Black HBL8743UC
Stainless Steel

Bosch speed combination ovens create an all-in-one cooking center with an upper speed oven and a Genuine European Convection oven below.

Features & Benefits

2-in-1 microwave and convection oven with 9 SpeedChef® programs to simplify cooking with fast results.

Lower oven's convection multi-rack mode gives uniform baking results even when using all 3 racks simultaneously.

Oven is equipped with a self-cleaning cycle that easily cleans itself via 2, 3, and 4 hour cycle options.

Download the Home Connect app to remotely monitor and control your Bosch wall oven with your smart phone or tablet.

General Properties

Home Connect™ – lower cavity (WiFi enabled)	Yes
Cooking modes – upper cavity	Speed oven; 12 Auto Programs (including Auto Defrost, Melt Butter, Soften Ice Cream, Pizza), 9 Sensor Cook Programs, 9 SpeedChef® Programs, Hi & Lo Broil, European Convection, Keep Warm, Frozen Foods
Cooking modes – lower cavity	Bake, Variable Broil (hi & low), Roast, Warm, Sabbath, Proof Dough, Convection Bake, Convection Broil, Convection Roast, Pizza, Multi Rack Genuine European Convection, Convection Conversion, Temperature Probe, Fast Preheat
Cleaning type – lower	Self Clean
Telescopic rack	1
Illumination type	LED (Upper) / Incandescent (Lower)
Interior lights	1 Upper / 2 Lower

Oven Performance

Microwave power – upper cavity	1000 W
Bake / broil element wattages – upper cavity	600 / 1,750 W
Convection element wattages – upper cavity	1,700 W
Bake / broil element wattages – lower cavity	2,400 / 3,800 W
Convection element wattages – lower cavity	2,000 W

Technical Details

Watts (W)	9,600 W
Circuit breaker (A)	40 A
Volts (V); Frequency (Hz)	240 / 208 V; 60 Hz
Power cord length (in)	50"
Plug type	Fixed Connection, No Plug
Energy source	Electric

Dimensions & Weight

Overall appliance dimensions (HxWxD) (in)	49" x 29 3/4" x 24 1/2"
Required cutout size – Standard (HxWxD) (in)	48 5/8" x 28 1/2" x 23 1/2"
Required cutout size – Flush (HxWxD) (in)	49 1/8" x 30" x 24 1/2"
Speed oven cavity size – upper	1.6 cu. ft.
Overall upper speed oven interior dimensions (HxWxD) (in.)	9 7/8" x 16 1/2" x 16 1/2"
Metal turntable diameter (in)	14 1/8" dia.
Ceramic tray diameter (in)	13 3/4" dia.
Rack – rectangular cookware max. – upper	15" x 12"
Oven cavity size – lower	4.6 cu. ft.
Overall lower oven interior dimensions (HxWxD) (in)	17 13/16" x 24 1/8" x 19"
Usable lower oven interior dimensions (HxWxD) (in)	12 1/4" x 23 1/4" x 15 1/4"
Net weight (lbs)	259 lbs

Accessories – Included

Upper Oven: Metal Turntable, Square rack, Ceramic Cooking Tray
Lower Oven: 1 Telescopic and 2 Standard Oven Racks, Meat Probe

Accessories – Optional



HE2TR301
30" Telescopic Rack



home
connect

*Lower wall oven only

Accessories: To purchase Bosch accessories, cleaners & parts please visit www.bosch-home.com/us/store or call 1-800-944-2904 (Mon to Fri 5 am to 6 pm PST, Sat 6 am to 3 pm PST).
Notes: All height, width and depth dimensions are shown in inches. BSH reserves the absolute and unrestricted right to change product materials and specifications, at any time, without notice. Consult the product's installation instructions for final dimensional data and other details prior to making cutout.
Warranties: Please see Use & Care manual or Bosch website for statement of limited warranty.
For more information on our entire line of products, go to www.bosch-home.com/us or call 1-800-944-2904
© BSH Home Appliances Corporation. All rights reserved. Bosch is a registered trademark of Robert Bosch GmbH.

LOT: 94 THAMES PH. 5 A
RE: WALL OVEN COMBO SPEC'S CONT
" NO FLUSH MOUNT ACCOMODATIONS"



SEE ATTACHED FOR SIGNATURES

30" Speed Combination Oven

800 Series – Stainless Steel HBL8753UC



Installation Details

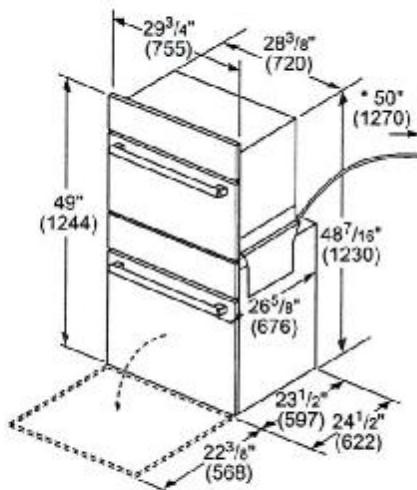

* Power cable 50" (1270 mm) from the lower oven.

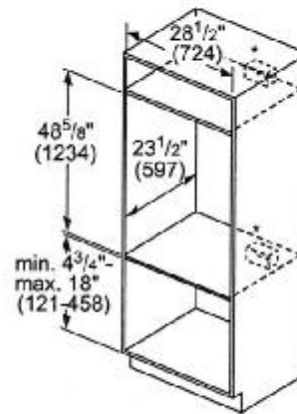

* Junction box may be installed above, below, or to the left or right of the unit within reach of the power cable

measurements in inches (mm)

Flush installation Top view

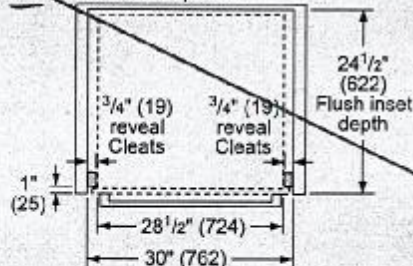

Side view

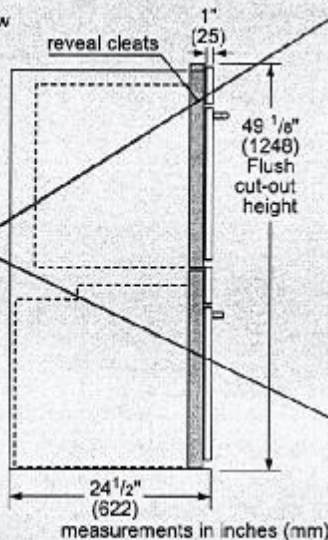

measurements in inches (mm)

Example Flush Install

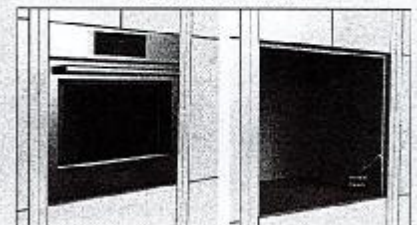

Single wall oven shown

Accessories: To purchase Bosch accessories, cleaners & parts please visit www.bosch-home.com/us/store or call 1-800-944-2904 (Mon to Fri 5 am to 6 pm PST, Sat 6 am to 3 pm PST).
Notes: All height, width and depth dimensions are shown in inches. BSH reserves the absolute and unrestricted right to change product materials and specifications, at any time, without notice. Consult the product's installation instructions for final dimensional data and other details prior to making cutout.

Warranties: Please see Use & Care manual or Bosch website for statement of limited warranty.

For more information on our entire line of products, go to www.bosch-home.com/us or call 1-800-944-2904

© BSH Home Appliances Corporation. All rights reserved. Bosch is a registered trademark of Robert Bosch GmbH.

LOT: 94 THAMES PH. 5 A
RE: WALL OVEN COMBO SPEC'S CON'T
" NO FLUSH MOUNT ACCOMODATIONS"



SEE ATTACHED FOR SIGNATURES

30" Speed Combination Oven

800 Series – Stainless Steel HBL8753UC



BOSCH

Invented for life

Installation Details

Standard Installation

Combination oven over storage or warming drawer

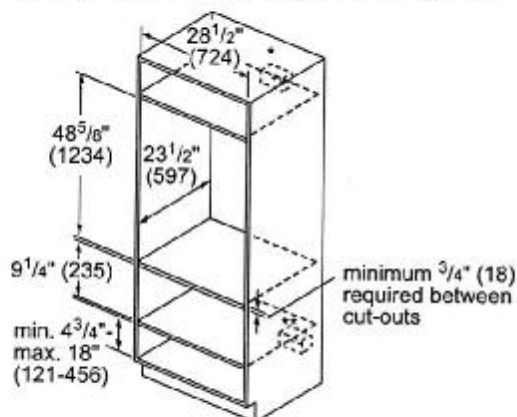

*Wall oven junction box may be located above or to the right or left of the unit within reach of the power cable.

**Electrical hook-up may be located below (depending on space) or next to the drawer within reach of the power cable.

measurements in inches (mm)

Flush installation

Combination oven over storage or warming drawer

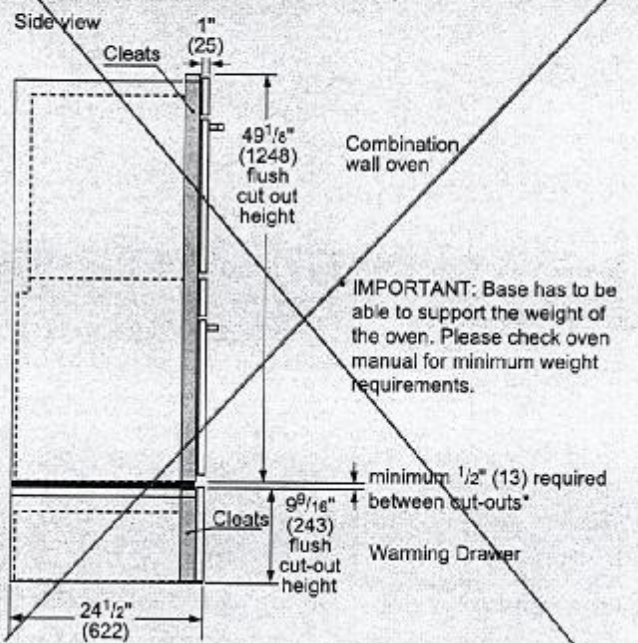

IMPORTANT: Base has to be able to support the weight of the oven. Please check oven manual for minimum weight requirements.

measurements in inches (mm)

Accessories: To purchase Bosch accessories, cleaners & parts please visit www.bosch-home.com/us/store or call 1-800-944-2904 (Mon to Fri 5 am to 6 pm PST, Sat 6 am to 3 pm PST).

Notes: All height, width and depth dimensions are shown in inches. BSH reserves the absolute and unrestricted right to change product materials and specifications, at any time, without notice. Consult the product's installation instructions for final dimensional data and other details prior to making cutout.

Warranties: Please see Use & Care manual or Bosch website for statement of limited warranty.

For more information on our entire line of products, go to www.bosch-home.com/us or call 1-800-944-2904

© BSH Home Appliances Corporation. All rights reserved. Bosch is a registered trademark of Robert Bosch GmbH.