

**KINGSMEN (THAMES) INC. / Havelock Corners (Kingsmen)**

**Lot/Unit: 92    Phase/Building: 5A    Model/Floor Plan: Louis (4203) Elev B 4 Bed - 4+1 Bath**

**CABINETRY APPLIANCE - FRIDGE**

|                   |   |  |
|-------------------|---|--|
| Inv.5678          | 1 - To supply & instal the 66CM DEEP FRIDGE ENCLOSURE - COUNTER DEPTH WITH - 1 WALL - 1 66CM DEEP GABLE AND 1 66CM DEEP CABINET - THIS IS NOT A ZERO CLEARANCE ENCLOSURE. STANDARD HEIGHTS AND WIDTHS WILL BE USED. -in the kitchen... see sketch # 1 |  |
| Line 72704        | Note: See fridge spec's attached.   |  |
| 18Jul22 / 18Jul22 |   |  |

**CABINETRY BASE CABINETS**

|                   |   |  |
|-------------------|---|--|
| Inv.5678          | 1 - To supply & install the 45CM WIDE PULL-OUT DOOR BASE CABINET WASTE - RECYCLE CENTRE - 2 35L BINS - AVAILABLE ONLY WITH 45CM WIDE CABINET in the kitchen... see sketch # 1 |  |
| Line 72709        | Note:   |  |
| 18Jul22 / 18Jul22 |   |  |
| Inv.5678          | 1 - To supply & install a different colour kitchen island in the kitchen, see colour chart for details.   |  |
| Line 72717        | Note:   |  |
| 18Jul22 / 18Jul22 |   |  |

**CABINETRY MICROWAVE OVEN STOVE COOKTOP**

|                   |   |  |
|-------------------|---|--|
| Inv.5678          | 1 - To supply & install accomodations for the future 30" COOKTOP CABINET WITH FALSE TOP DRAWER AND POTS AND PANS DRAWERS BELOW - SUPPLY SPECS - in the kitchen... see sketch # 1  |  |
| Line 72702        | Note:   |  |
| 18Jul22 / 18Jul22 |   |  |
| Inv.5678          | 1 - To supply & install accomodations for the future BUILT-IN TALL APPLIANCE CABINET WITH DRAWER - S BELOW FOR PANEL-MOUNT - PROUD - OR TRIM KIT INSTALLATIONS - TRIM KIT REQUIRED - SUPPLY ALL SPECS AND INSTALLATION GUIDES - COUNTER DEPTH in the kitchen... |  |
| Line 72703        | Note: See sketch # 1  |  |
| 18Jul22 / 18Jul22 |   |  |

**CABINETRY VANITY**

|                   |   |  |
|-------------------|---|--|
| Inv.5678          | 1 - To supply & install ONE top drawer in the master enusite bathroom... see sketch # 2 |  |
| Line 72710        | Note:   |  |
| 18Jul22 / 18Jul22 |   |  |

**CABINETRY WALL AND HUTCH**

|                   |  |  |
|-------------------|--|--|
| Inv.5678          | 1 - To supply & install the UPPER ANGLE CORNER PER UNIT - in the kitchen... see sketch # 1   |  |
| Line 72705        | Note:  |  |
| 18Jul22 / 18Jul22 |  |  |
| Inv.5678          | 1 - To supply & install a GLASS DOOR - SPECIFY CLEAR --- UNFINISHED CABINET INTERIOR - PRICED PER EACH - to the upgraded upper angled corner cabinet in the kitchen.. see sketch # 1 |  |
| Line 72706        | Note:  |  |
| 18Jul22 / 18Jul22 |  |  |

**CARPET**

KINGSMEN (THAMES) INC. / Havelock Corners (Kingsmen)

Lot/Unit: 92    Phase/Building: 5A    Model/Floor Plan: Louis (4203) Elev B 4 Bed - 4+1 Bath

|                   |   |  |
|-------------------|---|--|
| Inv.5678          | 1 - To supply & install the upgrade 2 carpet under pad to the master bedroom, bedroom #2, # 3 & # 4 in lieu of the standard carpet under pad. |  |
| Line 72725        | Note:   |  |
| 18Jul22 / 18Jul22 |   |  |

COUNTER TOP

|                   |   |  |
|-------------------|---|--|
| Inv.5678          | 1 - To supply & install accomodations for the future 30" gas cook top in the kitchen... see spec's ... see sketch # 1 |  |
| Line 72701        | Note:   |  |
| 18Jul22 / 18Jul22 |   |  |

|                   |  |  |
|-------------------|--|--|
| Inv.5678          | 1 - As per schedule "PE": Vendor to include level 1, 2cm. quartz in kitchen and all bathrooms, as per plan, in lieu of the included laminate counter tops. Selections to be made from builders standard samples. |  |
| Line 72689        | Note:  |  |
| 18Jul22 / 18Jul22 |  |  |

COUNTER TOP - ACCESSORIES

|                   |  |  |
|-------------------|--|--|
| Inv.5678          | 1 - To supply & install the quartz shower niche " IMPERIAL BLACK" in the master ensuite shower... see sketch #2 for installation location. |  |
| Line 72714        | Note:  |  |
| 18Jul22 / 18Jul22 |  |  |

COUNTER TOP - KITCHEN

|                   |   |  |
|-------------------|---|--|
| Inv.5678          | 1 - To supply & install the COUNTER TOP - KITCHEN - KITCHEN - 3CM COUNTER TOP - UPGRADE LEVEL 2 in leiu of the standard quartz... see colour chart for details. |  |
| Line 72718        | Note:   |  |
| 18Jul22 / 18Jul22 |   |  |

ELECTRICAL

|                   |  |  |
|-------------------|--|--|
| Inv.5678          | 1 - To supply & install the standard T.V. rough in in the great room and master bedroom... see sketch # 1 & # 2        |  |
| Line 72690        | Note: Install the T.V. rough in at approx. 66" + - up from the floor centered + - to the F/P mantle in the great room. |  |
| 18Jul22 / 18Jul22 |  |  |

|                   |  |  |
|-------------------|--|--|
| Inv.5678          | 1 - To supply & install the standard Phone ( CAT 5 ) rough in in the great room, master bedroom and bedroom # 4 ... see sketch # 1 & # 2 |  |
| Line 72691        | Note: Install the Phone ( CAT 5 ) rough in at approx. 66" + - up from the floor centered + - to the F/P mantle in the great room.        |  |
| 18Jul22 / 18Jul22 |  |  |

|   |  |  |
|---|--|--|
| Inv.5678  | 1 - To SUPPLY AND INSTALL AN ADDITIONAL BASIC RECEPTACLE (NOT DEDICATED) at approx. 66" + - up from the floor centered + - to the F/P mantle in the great room |  |
| Line 72692  | Note: See sketch # 1   |  |
| 18Jul22 / 18Jul22                      This is for a future wall mount T.V. |  |  |

|                   |  |  |
|-------------------|--|--|
| Inv.5678          | 1 - To SUPPLY AND INSTALL CONDUIT FOR TV OVER THE FIREPLACE at approx.66" + - up from the floor centered + - to the F/P mante – TERMINATED TO BASEMENT CEILING |  |
| Line 72693        | Note: This is for a future wall mount T.V.   |  |
| 18Jul22 / 18Jul22 |  |  |

**KINGSMEN (THAMES) INC. / Havelock Corners (Kingsmen)**

**Lot/Unit: 92    Phase/Building: 5A    Model/Floor Plan: Louis (4203) Elev B 4 Bed - 4+1 Bath**

|  |  |  |
|--|--|--|
| Inv. <b>5678</b><br><br><b>Line 72694</b><br><br>18Jul22 / 18Jul22 | <b>1</b> - To SUPPLY AND INSTALL EXTRA CEILING BOX ROUGH IN CAPPED (DOES NOT INCLUDE SWITCH) over the kitchen island in the kitchen... see sketch # 1<br><br>Note: This capped elec. will be connected to a sep. switch, swith sold sep. |  |
| Inv. <b>5678</b><br><br><b>Line 72695</b><br><br>18Jul22 / 18Jul22 | <b>1</b> - To supply & install AN ADDITIONAL SINGLE POLE SWITCH connected to the capped elec. over the kitchen island in the kitchen.<br><br>Note:   |  |
| Inv. <b>5678</b><br><br><b>Line 72696</b><br><br>18Jul22 / 18Jul22 | <b>1</b> - Relocate the standard ceiling light from the upper stair landing to the O.T.B. area on the second floor... see sketch # 2<br><br>Note:  |  |
| Inv. <b>5678</b><br><br><b>Line 72698</b><br><br>18Jul22 / 18Jul22 | <b>1</b> - To SUPPLY AND INSTALL EXTRA 240 STOVE PLUG at the future built in wall oven/ microwave tower in the kitchen... see spec's see sketch # 1<br><br>Note:   |  |

**HARDWOOD**

|  |   |  |
|--|---|--|
| Inv. <b>5678</b><br><br><b>Line 72723</b><br><br>18Jul22 / 18Jul22 | <b>1</b> - To supply & install the 3 1/2" Elements stained engineered hardwood floor to the upper hallway area in lieu of the standard carpet... see colour chart for details.<br><br>Note: |  |
|--|---|--|

**HEATING AND AIR CONDITIONING**

|  |   |  |
|--|---|--|
| Inv. <b>5678</b><br><br><b>Line 72687</b><br><br>18Jul22 / 18Jul22 | <b>1</b> - As per schedule "PE": Vendor to install capped gas line ( rough in only ) at rear of home for future BBQ location. Location to be finalized at vendors sole discretion.<br><br>Note: |  |
| Inv. <b>5678</b><br><br><b>Line 72688</b><br><br>18Jul22 / 18Jul22 | <b>1</b> - As per schedule "PE": Vendor to supply & install air conitioning unit, sized accordingly, from vendors standard samples.<br><br>Note:  |  |
| Inv. <b>5678</b><br><br><b>Line 72697</b><br><br>18Jul22 / 18Jul22 | <b>1</b> - To supply & install a capped gas rough in including a 110V elec. outlet, code requirement at stove location in the kitchen...<br><br>Note:   |  |

**PLUMBING**

|  |   |  |
|--|---|--|
| Inv. <b>5678</b><br><br><b>Line 72715</b><br><br>18Jul22 / 18Jul22 | <b>6</b> - To supply & install the VANITY SINK - CONTRAC CATENA UNDERMOUNT - MODEL 4210CIY in the powder room, master ensuite, ensuite #2, #3 & #4's bathrooms in lieu of the standard top mount sinks... see spec's<br><br>Note: Still to install the standard lav. faucets. |  |
| Inv. <b>5678</b><br><br><b>Line 72716</b><br><br>18Jul22 / 18Jul22 | <b>1</b> - To supply & install the BLANCO QUATRUS U1 SUPER SINGLE under mount kitchen sink model # 401248 in the kitchen in lieu of the standard under mount kitchen sink... see spec's<br><br>Note: Still to install the standard single hole kitchen faucet NO PLATE.       |  |

KINGSMEN (THAMES) INC. / Havelock Corners (Kingsmen)

Lot/Unit: 92    Phase/Building: 5A    Model/Floor Plan: Louis (4203) Elev B 4 Bed - 4+1 Bath

RAILING

|                   |   |  |
|-------------------|---|--|
| Inv.5678          | 1 - To supply & install the MIROLYN " BROOKE" free standing tub in the master ensuite in lieu of the standard free standing tub... see spec's   |  |
| Line 72713        | Note:   |  |
| 18Jul22 / 18Jul22 |   |  |
| Inv.5678          | 1 - To supply & install the RAILING - UPGRADE 1 - METAL HANDRAIL 3 INCH OVAL IN OAK - PICKETS STEEL ½ INCH SQUARE, PLAIN, WITH SHOES IN FLAT BLACK - POSTS 3½ INCH SQUARE, WITH CAP OAK IN OAK throughout in lieu of the standard picket and rails. |  |
| Line 72724        | Note:   |  |
| 18Jul22 / 18Jul22 |   |  |

TILE - FLOOR

|                   |  |  |
|-------------------|--|--|
| Inv.5678          | 1 - To supply & install athe UPGRADE 2 - SHOWER FLOOR TILE - - ENSUITE SHOWER FLOOR TILE in lieu of the standard shower floor tiles. ... see colour chart for details. |  |
| Line 72726        | Note:  |  |
| 18Jul22 / 18Jul22 |  |  |
| Inv.5678          | 1 - To supply & install the UPGRADE 4 - FLOOR TILE - STACKED - FOYER TILE in lieu of the standard floor tiles... see colour chart for details.                         |  |
| Line 72719        | Note:  |  |
| 18Jul22 / 18Jul22 |  |  |
| Inv.5678          | 1 - To supply & install the UPGRADE 4 - FLOOR TILE - STACKED - POWDER ROOM TILE in lieu of the standard floor tiles... see colour chart for details.                   |  |
| Line 72720        | Note:  |  |
| 18Jul22 / 18Jul22 |  |  |
| Inv.5678          | 1 - To supply & install the UPGRADE 4 - FLOOR TILE - STACKED - MUD ROOM TILE in lieu of the standard floor tiles... see colour chart for details.                      |  |
| Line 72721        | Note:  |  |
| 18Jul22 / 18Jul22 |  |  |
| Inv.5678          | 1 - To supply & install the UPGRADE 4 - FLOOR TILE - STACKED -KITCHEN/BREAKFAST ROOM TILE in lieu of the standard floor tiles... see colour chart for details.         |  |
| Line 72722        | Note: ( including the pantry area )  |  |
| 18Jul22 / 18Jul22 |  |  |

**KINGSMEN (THAMES) INC. / Havelock Corners (Kingsmen)**

**Lot/Unit: 92    Phase/Building: 5A    Model/Floor Plan: Louis (4203) Elev B 4 Bed - 4+1 Bath**

**EXTRAS AS PER OFFER**

|  |  |
|--|--|
| 5 FREE APPLIANCES – STAINLESS STEEL FRONT - FRIDGE; STOVE AND DISHWASHER. WHITE WASHER AND DRYER (SUPPLIED ONLY, NOT INSTALLED, FROM BUILDERS STANDARD LINE). AN APPLIANCES VOUCHER WILL BE GIVEN BY OUR DECOR CONSULTANT AT THE TIME OF BOOKING YOUR COLOUR A<br><i>Worksheet</i> Note: |  |
| VENDOR TO INSTALL CAPPED GAS LINE (ROUGH-IN ONLY) AT REAR OF HOME FOR FUTURE BBQ LOCATION.    LOCATION TO BE FINALIZED AT VENDORS SOLE DISCRETION.<br><i>Worksheet</i> Note:   |  |
| VENDOR TO SUPPLY & INSTALL AIR CONDITIONING UNIT, SIZED ACCORDINGLY, FROM VENDORS STANDARD SAMPLES.<br><i>Worksheet</i> Note:  |  |
| VENDOR TO INCLUDE LEVEL 1, 2CM QUARTZ IN KITCHEN AND ALL BATHROOMS, AS PER PLAN, IN LIEU OF THE INCLUDED LAMINATE COUNTER TOPS. SELECTIONS TO BE MADE FROM BUILDERS STANDARD SAMPLES.<br><i>Worksheet</i> Note:  |  |



**Purchasers:** Jatinder Singh Aujla & Gagandeep Aujla **Property:** 92 of Plan - Draft Approval SB17-03-08  
**Telephone Res. / Bus:** / **Project:** KINGSMEN (THAMES) INC.  
**Decor Advisor:** Barbara Coccia **Model and Elevation:** Louis (4203) Elev B 4 Bed - 4+1 Bath  
**Layout Changes:** ☐ Yes ☒ No **Sketch Attached:** ☒ Yes ☐ No **Exterior Colour Scheme:**

### 1. Cabinetry

|   | Style and Colour        | Counter Top                  | Hardware      |
|---|-------------------------|------------------------------|---------------|
| Kitchen / Breakfast                     | #3, Simcoe Orchid       | **#2, H/S Whistler 3cm.      | #12881 Handle |
| Kitchen Island                          | **#3, Simcoe Rain Cloud | **#2, H/S Whistler 3cm.      | #12881 Handle |
| Laundry Room                            | /                       |                              |               |
| Powder Room                             | #3, Simcoe Orchid       | #1, C/S # 3040 Cement 2cm.   | #135 Knob     |
| Main Bathroom                           | /                       |                              |               |
| Master Ensuite Bathroom                 | #3, Simcoe Moonlight    | #1, C/S # 9141 Ice Snow 2cm. | #12881 Handle |
| Second Ensuite Bathroom (If Applicable) | #3, Simcoe Moonlight    | #1, C/S # 9141 Ice Snow 2cm. | #12881 Handle |
| Ens. #3's bathroom                      | #3, Simcoe Moonlight    | #1, C/S # 9141 Ice Snow 2cm. | #135 Knob     |
| Ens. #3's bathroom                      | #3, Simcoe Orchid       | #1, C/S # 3040 Cement 2cm.   | #135 Knob     |

**Appliances** **Custom Size Fridge** ☒ Yes ☐ No **Valance Lighting** ☐ Yes ☒ No **Microwave / Range Hood** ☐ Yes ☒ No  
**Cooktop / Rangetop** ☒ Yes ☐ No **Built in Wall Oven** ☒ Yes ☐ No **Slide-in Range** ☐ Yes ☒ No  
**Comment**

### 2. Flooring

|                               | Selection  |
|-------------------------------|--|
| Foyer                         | **Upg. 4, 24 x 24" Mayfair Volakas Grigio HD. Polished Rec. Porcelain STACKED              |
| Main Hall                     | 3 1/2" Elements Oak Bearskin   |
| Back Hall                     | /  |
| Breakfast                     | **Upg. 4, 24 x 24" Mayfair Volakas Grigio HD. Polished Rec. Porcelain STACKED (inc pantry) |
| Laundry Room                  | 13 x 13" Malena Ice  |
| Kitchen                       | **Upg. 4, 24 x 24" Mayfair Volakas Grigio HD. Polished Rec. Porcelain STACKED              |
| Powder Room                   | **Upg. 4, 24 x 24" Mayfair Volakas Grigio HD. Polished Rec. Porcelain STACKED              |
| Main Bathroom                 | Ens. # 3: 13x13" Cinq Grey   |
| Master Ensuite                | & Ens. # 2: 13 x 13" Malena Ice  |
| Bathroom (If Applicable)      | Ens. # 4: 13 x 13" Malena Carbon   |
| Mud Room                      | **Upg. 4, 24 x 24" Mayfair Volakas Grigio HD. Polished Rec. Porcelain STACKED              |
| Master ens. shower floor      | ** Upg. 2 x2" Malena Carbon mosaic   |
| Living Room                   | Ens. #2's shower floor: 2x2" Ontario Snow White Matte                                      |
| Dining Room                   | ( sitting room) 3 1/2" Elements Oak Bearskin   |
| Family / Great Room           | 3 1/2" Elements Oak Bearskin   |
| Den / Library / Study         | /  |
| Basement Landing (If Applies) |  |
| Lower Landing (If Applicable) | 3 1/2" Elements Oak Bearskin   |
| Upper Landing                 | ( if applicable ) 3 1/2" Elements Oak Bearskin   |
| Upper Hall                    | **3 1/2" Elements Oak Bearskin   |
| Master Bedroom                | Modern Story 1, # 927 Morning Rain   |
| Bedroom #2                    | Modern Story 1, # 927 Morning Rain   |
| Bedroom #3                    | Modern Story 1, # 927 Morning Rain   |
| Bedroom #4                    | Modern Story 1, # 927 Morning Rain   |
| Bedroom #5                    | /  |
| Mas. Ens & Ens. #2's          | Shower Jamb: Anatolia Marmilne SNOW  |

Flooring Continued on Page 2

RECEIVED

JUL 18 2022

Initial:

ISA

GIA





**Purchasers:** Jatinder Singh Aujla & Gagandeep Aujla **Property:** 92 of Plan - Draft Approval SB17-03-08  
**Telephone Res. / Bus:** / **Project:** KINGSMEN (THAMES) INC.  
**Decor Advisor:** Barbara Coccia **Model and Elevation:** Louis (4203) Elev B 4 Bed - 4+1 Bath  
**2. Flooring - Continued -**

| Upgrade Underpad        | Type          | Area                                |
|-------------------------|---------------|-------------------------------------|
|                         | 2nd. upgrade  | Master bedroom, bedroom #2, #3 & #4 |
| <b>Carpet on Stairs</b> | <b>Capped</b> | <b>Runner - *Upgrade</b>            |
| <b>Comment</b>          | /             | /                                   |
| /                       |               |                                     |

### 3. Plumbing Fixtures / Faucets

| Kitchen  | Standard | Second Ensuite      | Standard | Powder Room | Standard |
|--|----------|---------------------|----------|-------------|----------|
| Master Ensuite   | Standard |                     |          | Other Room  | /        |
| Main Bathroom  | /        | Ens. 3 & 4 bathroom | Standard |             |          |
| <b>Comment</b>   |          |                     |          |             |          |
| Purchaser has upgraded the kitchen sink, still to install the standard single hole kitchen faucet, NO PLATE.<br>Purchaser has upgraded to under mount vanity sinks in ALL bathrooms. still to insall the standard lav faucets. |          |                     |          |             |          |

### 4. Wall Tile

|   | Tile Selection   | Listello  | Insert  | Insert Selection  |
|---|--|---|---|---|
| Main Bathroom   | /  | <input type="checkbox"/>  | <input type="checkbox"/>  |   |
| Master Ensuite  |  |   |   |   |
| Tub Deck  | /  | <input type="checkbox"/>  | <input type="checkbox"/>  |   |
| Tub Apron   | /  | <input type="checkbox"/>  | <input type="checkbox"/>  |   |
| Tub Surround  | /  | <input type="checkbox"/>  | <input type="checkbox"/>  |   |
| Shower Stall  | 8x10" Malena Carbon  | <input type="checkbox"/>  | <input type="checkbox"/>  |   |
| Second Ensuite  | 8x10" Malena Carbon  | <input type="checkbox"/>  | <input type="checkbox"/>  |   |
| Ens. #3's bathroom  | 8x10" Cinq Grey  | <input type="checkbox"/>  | <input type="checkbox"/>  |   |
| Ens. #4's bathroom  | 8x10" Malena Ice   | <input type="checkbox"/>  | <input type="checkbox"/>  |   |
| Kitchen Backsplash  | /  | <input type="checkbox"/>  | <input type="checkbox"/>  |   |
| Complete Backsplash   | /  | <input type="checkbox"/>  | <input type="checkbox"/>  |   |
| <b>Comment</b>  |  |   |   |   |
| Install the standard 8 x 10" wall tiles on the 10" side stacked horizontally where applicable in all bathrooms. |  |   |   |   |
|   |  |  |  |  |
|   | horizontal stacked   | brick pattern   | vertical stacked  | diagonal/diamond  |

### 5. Fireplace

|                       | Living Room           |                       |                                  | Family Room           |                       |                                  | Other Room - Specify Great room |                                  |                       |
|-----------------------|-----------------------|-----------------------|----------------------------------|-----------------------|-----------------------|----------------------------------|---------------------------------|----------------------------------|-----------------------|
|                       | Purchased             | As Per Plan           | N/A                              | Purchased             | As Per Plan           | N/A                              | Purchased                       | As Per Plan                      | N/A                   |
| <b>Fireplace Type</b> | <input type="radio"/> | <input type="radio"/> | <input checked="" type="radio"/> | <input type="radio"/> | <input type="radio"/> | <input checked="" type="radio"/> | <input type="radio"/>           | <input checked="" type="radio"/> | <input type="radio"/> |
| <b>Mantle Type</b>    |                       |                       |                                  |                       |                       |                                  |                                 |                                  |                       |
| <b>Over Mantle</b>    |                       |                       |                                  |                       |                       |                                  |                                 |                                  |                       |
| <b>Colour / Stain</b> |                       |                       |                                  |                       |                       |                                  |                                 |                                  |                       |
| <b>Surround</b>       |                       |                       |                                  |                       |                       |                                  |                                 |                                  |                       |
| <b>Hearth</b>         |                       |                       |                                  |                       |                       |                                  |                                 |                                  |                       |
| <b>Comment</b>        |                       |                       |                                  |                       |                       |                                  |                                 |                                  |                       |
| /                     |                       |                       |                                  |                       |                       |                                  |                                 |                                  |                       |



Initial: \_\_\_\_\_



**Purchasers:** Jatinder Singh Aujla & Gagandeep Aujla

**Property:** 92 of Plan - Draft Approval SB17-03-08

**Telephone Res. / Bus:** /

**Project:** KINGSMEN (THAMES) INC.

**Decor Advisor:** Barbara Coccia

**Model and Elevation:** Louis (4203) Elev B 4 Bed - 4+1 Bath

### 6. Trim Carpentry

**Door Hardware** Standard Handle

**Interior Trim** Standard

**Comment**

/

#### Interior Doors

☐ 2 Panel Arch Top

☒ 2 Panel Square Top

☐ 6 Panel



Initial for Door Style

JS

GA

### 7. Railings and Pickets

**Railing Package** \* 1st. upgrade Metal picket package

**Railing Colour** Elements Bearskin

**Picket Colour** BLACK

**Wood Stairs** ☐ No ☒ Oak

**Tread Colour** Elements Bearskin

**Comment**

### 8. Plaster Mouldings and Medallions

**Foyer** /

**Main Hall** /

**Living Room** /

**Dining Room** /

**Family Room** /

**Kitchen/Breakfast** /

**Den/Library** /

**Lower Landing** /

**Comment**

/

### 9. Wall Paint

Kingsmen White

#### Smooth Ceilings

☐ First Floor

☐ First Floor incl. Second Floor Hall

☐ First and Second Floor

☒ Throughout

☐ Not Applicable

**Trim Paint** Kingsmen White

### 10. Additional Comments

/



### 11. Disclaimers and Notes

- Colours of all materials are as close as possible to builder's selection, but not necessarily identical due to variances in manufacturing.
- Any extras listed above are null and void unless accompanied by a separate invoice/amendment. Said invoice must be paid in full.
- The Purchaser acknowledges that after Interior Colour Selection form is signed and dated, no further changes will be permitted other than re-selection due to unavailability. JS GA Purchaser's Initials
- The Purchaser acknowledges reading and accepting the "Kingsmen Group Décor Centre Disclaimers" form. This document contains other miscellaneous disclaimers.

This Interior Colour Selection is final and approved by:

**Purchaser:**

**Signature:**  **Date:** 7/18/22

**Signature:**  **Date:** 7/18/22

**Vendor:** 

KINGSMEN (THAMES) INC.

July 18/22



# SCHEDULE "B-1"

## Floor Plan

Lot 92  
Phase 5A  
Model: Louis (4203) Elev B 4 Bed - 4+1 Bath  
Standard

Sketch #1

all 4 items @ 66" ±  
up from floor.  
① = Conduit.  
PH

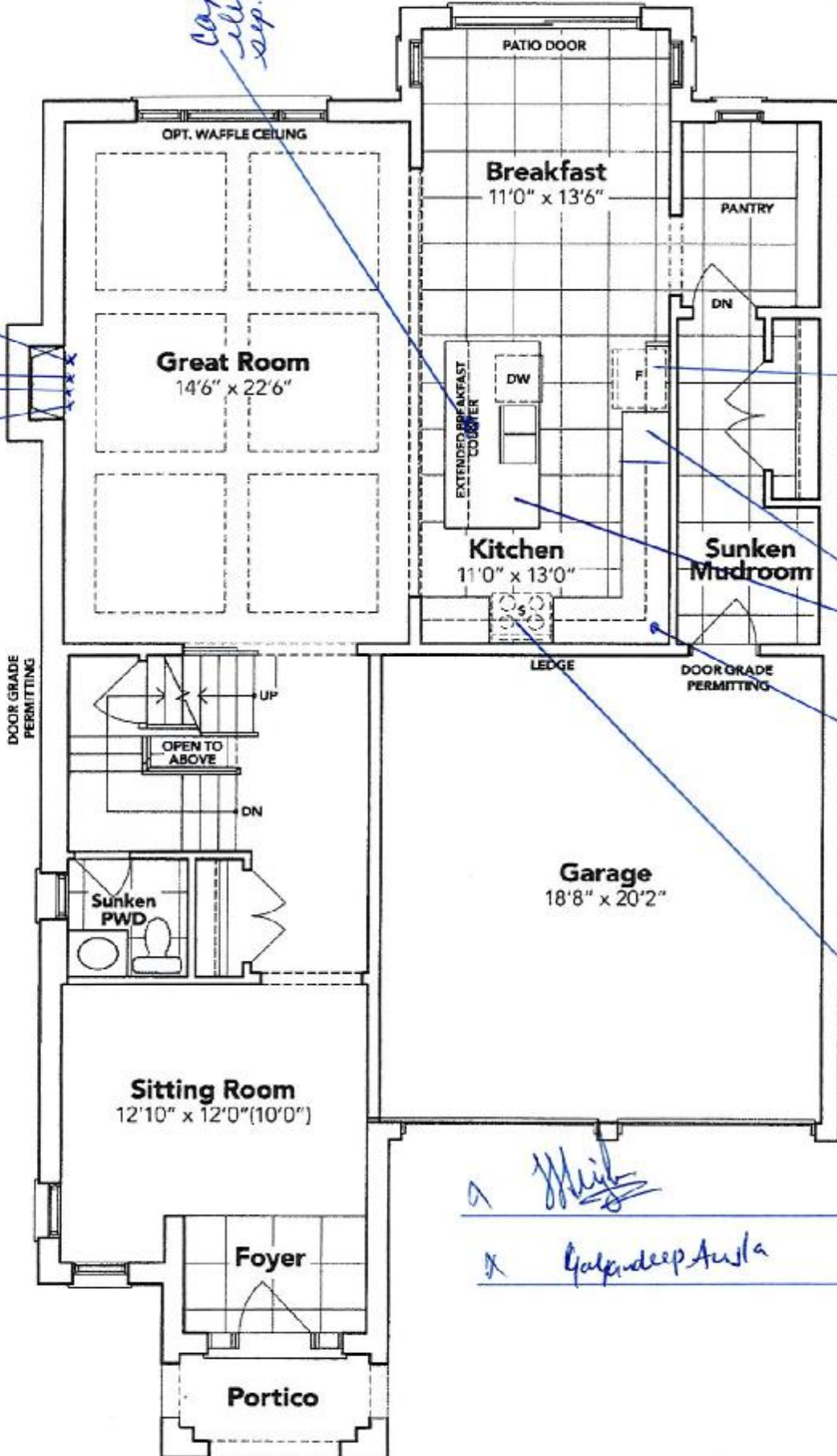

## GROUND FLOOR EL. B

The floor plans and elevations shown are pre-construction plans and may be revised or improved as necessitated by architectural controls and the construction process. The measurements adhere to the rules and regulations of the TARIION Warranty Corporation's official method for the calculation of floor area. Materials, specifications and floor plans are subject to change without notice. All house renderings are artist's concept only. Actual floor area may vary from the stated floor area. All options shown are upgrades. E. & O. E.

RECEIVED  
JUL 18 2022

SCHEDULE "B-1" - Page 3 of 3

Initials

G.A.

S.S.A.

**SCHEDULE "B-1"**  
**Floor Plan**

Lot 92  
Phase 5A  
Model: Louis (4203) Elev B 4 Bed - 4+1 Bath  
Standard

*Sketch #2*

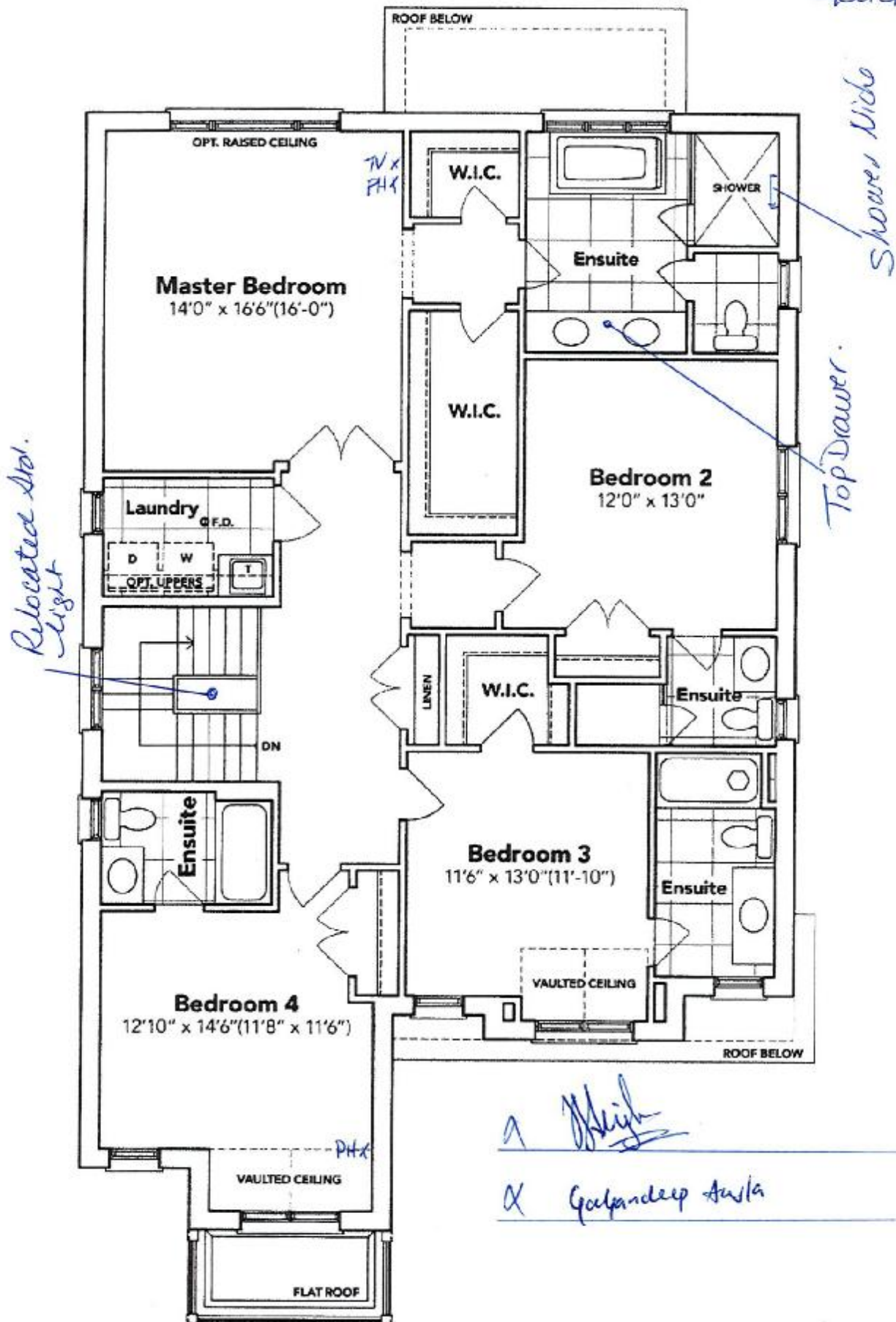

**SECOND FLOOR EL. B**

The floor plans and elevations shown are pre-construction plans and may be revised or improved as necessitated by architectural controls and the construction process. The measurements adhere to the rules and regulations of the TARION Warranty Corporation's official method for the calculation of floor area. Materials, specifications and floor plans are subject to change without notice. All house renderings are artist's concept only. Actual usable floor space may vary from the stated floor area. All options shown are upgrades. E. & O. E.

SCHEDULE "B-1" - Page 2 of 3

Initials:

GA SSA



**SCHEDULE "B-1"**  
**Floor Plan**

Lot 92  
Phase 5A  
Model: Louis (4203) Elev B 4 Bed - 4+1 Bath  
Standard

*Sketch #3*

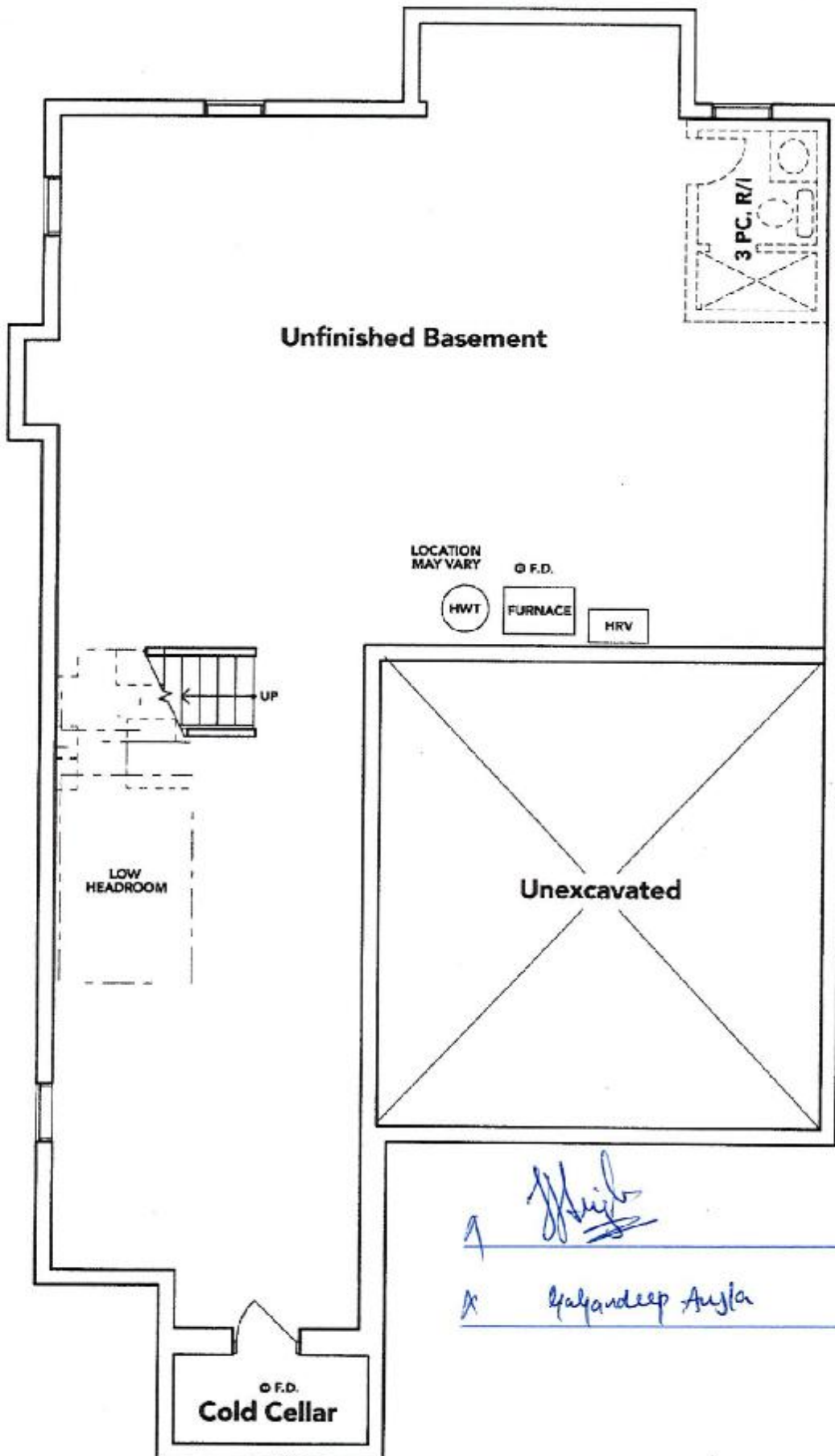

**BASEMENT EL. B**

*Handwritten signatures and initials:*  
↑ *[Signature]*  
X *Gagandeep Anja*

The floor plans and elevations shown are pre-construction plans and may be revised or improved as necessitated by architectural controls and the construction process. The measurements adhere to the rules and regulations of the TARIION Warranty Corporation's official method for the calculation of floor area. Materials, specifications and floor plans are subject to change without notice. All house renderings are artist's concept only. Actual usable floor space may vary from the stated floor area. All options shown are upgrades. E. & O. E.

LOT 92 THAMES PH. 5 A  
RE: UPGRADED UNDER MOUNT SINKS  
FOR ALL BATHROOMS.

CATENA  
RECTANGULAR UNDERMOUNT SINK

4210CIV Undermount Sink

PRODUCT SPECS:

- Vitreous china
- Front overflow hole
- Template and mounting hardware supplied

DIMENSIONS:

Outer:

510mm W x 390mm D x 190mm H  
20" W x 15 1/2" D x 7 1/2" H

Inner:

458mm W x 340mm D x 110mm H  
18" W x 13 1/2" D x 5 1/2" H

COMPLIANCE CERTIFICATIONS

Meets or exceeds the following:

- IAPMO cUPC
- ASME A112.19.2 / CSA B45.1
- OBC Section 5.8 Barrier Free design and CSA B651 Standard

SHIPPING

Cube 1.72  
GW 27 lbs

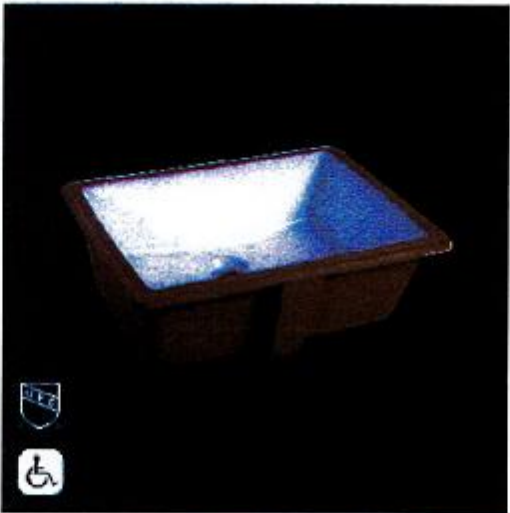
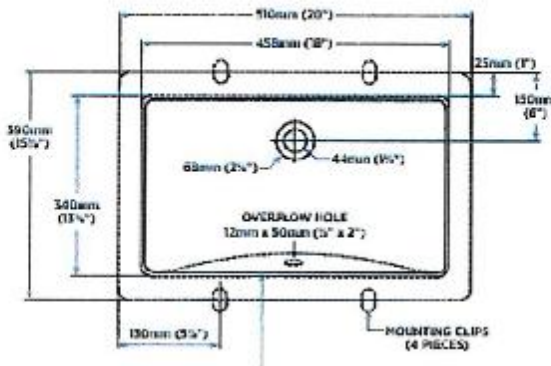

TO BE SPECIFIED

- CCV-1
- Soft V1-10

NOTES: Dimensions of features are nominal and may vary within the range of tolerances permitted by ASME standard B86.19.2. These dimensions are subject to change in construction. No responsibility is assumed for use of substituted or revised parts.

Products are designed to comply with CEH 4051 Standard and OBC Barrier Free requirements. It shall be the responsibility of the specifier to comply with the accessibility code and standards prior to installing the product.

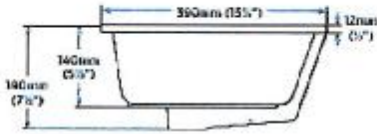

Handwritten signature: *High*

Handwritten signature: *Deepdeep Anja*



# BLANCO

## Sink Specifications

Colour                      SKU  
brushed finish            401248

### Design and planning tips

- Min cabinet size: 36 in ( 915 mm )
- Bowl Depth: 9 in ( 230.0 mm )

### Specifications:

Installation clips, Sink template, Installation instructions, 3 1/2" (90 mm) stainless steel strainer

Depending on cabinet construction, a different cabinet size may be required. Consult the cabinet manufacturer.

Codes/Standards: ASME A112.19.3-2017/ CSA B45.4-17

## QUATRUS U 1 SUPER SINGLE

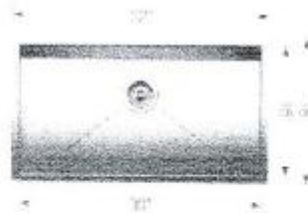

α *[Signature]*

α *Gayandeep Arora*

LOT 92 THAMES PH. 5 A  
RE: UPGRADED FREE STANDING TUB  
FOR MASTER ENSUITE.

## Free Standing Tub

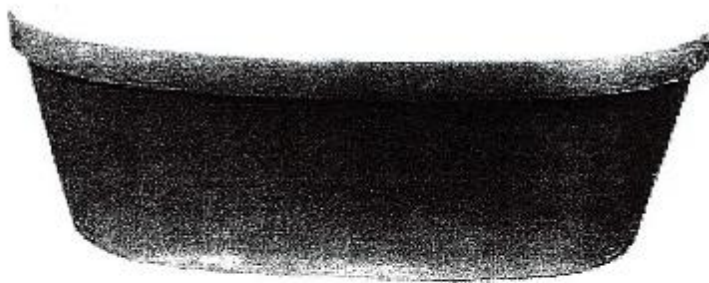

**Mirolin Brooke CF2002**  
**68x36x23**

- Acrylic Bath
- 2PC Construction
- End Drain Application
- F2 Drain Assembly

 **mirolin**

*a* *High*

*a* *Gayandeep Arora*

LOT 92 THAMES PH. 5 A

RE: FRIDGE SPEC'S

"NO ROUGH IN WATERLINE  
PURCHASED"

**Prepared by**

Arshdeep Singh

arshdeepsg2011@gmail.com (437) 779-5400



**TELETIME**  
TV • ELECTRONICS • APPLIANCES • FURNITURE



**23.8 cu. ft. 36" Counter-Depth French Door  
Platinum Interior Refrigerator with PrintShield™  
Finish**

KRFC704FPS

**Available Finishes/Colours**



KRFC704FBS  
Black Stainless Steel with PrintShield™ Finish



KRFC704FPS  
Stainless Steel with PrintShield™ #8482 Finish

**Dimensions**

|        |          |
|--------|----------|
| Depth  | 31 1/2   |
| Height | 71 7/8   |
| Width  | 35 13/16 |

**Compatibility**

|            |    |
|------------|----|
| Works With | No |
|------------|----|

**Controls**

|                              |                                     |
|------------------------------|-------------------------------------|
| Control Type                 | Electronic                          |
| Air Filter Indicator/Reset   | Yes                                 |
| Automatic Defrost            | Yes                                 |
| LCD Touch Screen             | No                                  |
| Control Location             | Exterior<br>Dispenser, Side<br>Door |
| Door Ajar/Open Alarm         | Yes                                 |
| Control Lockout              | Yes                                 |
| Max Cool/Fast Cool           | Yes                                 |
| Water Filter Indicator/Reset | Yes                                 |

**AHAM Volumes And Shelf Area**

|                             |       |
|-----------------------------|-------|
| Freezer Volume (Cu Ft)      | 6.30  |
| Refrigerator Volume (Cu Ft) | 17.50 |

**Details**

|                         |  |
|-------------------------|--|
| Advance Foam Insulation | 99.9% lower<br>Global Warming<br>Potential and<br>Better Energy<br>Performance |
| Cooling Type            | Dual Evaporator  |
| Counter Depth           | Yes  |

**Compatibility**

|              |    |
|--------------|----|
| Connectivity | No |
|--------------|----|

The largest capacity counter-depth refrigerator in its class features PrintShield™ finish to resist fingerprints outside and flexible storage options inside. A slide-away shelf retracts to fit tall items, and full-extension self-close crispers and custom temperature pantry let you store more and find it easily. Plus, the Preserva® Food Care System with Linear Compressor helps keep it all at the peak of freshness.

**Top Features**

Preserva® Food Care System with Linear Compressor

Under-Shelf Prep Zone

Slide-Away Shelf

**Manuals & Literature:**

- [Dimension Guide](#) [Energy Guide](#)  
[Use and Care Guide](#) [Warranty Information](#)

✓

α

**KitchenAid**

Because Whirlpool Corporation policy includes a continuous commitment to improve our products, we reserve the right to change materials and specifications without notice. Dimensions are for planning purposes only. For complete details, see Installation Instructions packed with product. Specifications subject to change without notice.

LOT 92 THAMES PH. 5 A  
RE: FRIDGE SPEC'S CONT

"NO ROUGH IN WATERLINE  
PURCHASED"

## KitchenAid® French Door Bottom Mount Refrigerator with Ice Dispenser (KRFC704F, KRFC604F)

### PRODUCT DIMENSIONS

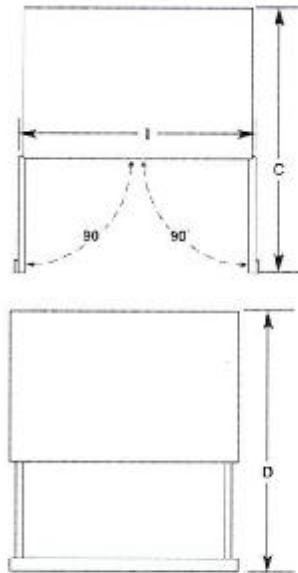
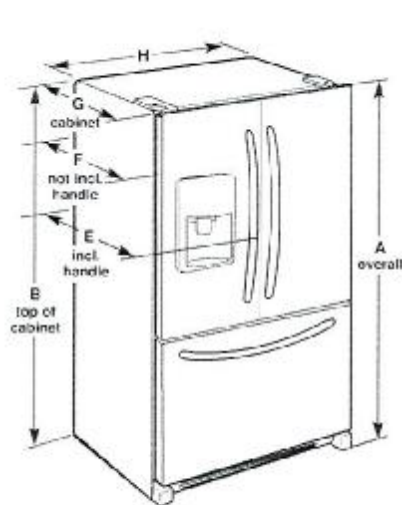

|                             |                        |
|-----------------------------|------------------------|
| Model Number                | KRFC704F, KRFC604F     |
| Model Size                  | 23.8 cu. ft. (673.9 L) |
| Height - Overall "A"        | 71 1/2" (182.6 cm)     |
| Height - Top of Cabinet "B" | 70 1/2" (180.0 cm)     |
| Depth - Doors Open 90° "C"  | 43 3/4" (111.1 cm)     |
| Depth - Drawer Open "D"     | 45 1/2" (116.5 cm)     |
| Depth - With Handles "E"    | 31 1/2" (80.0 cm)      |
| Depth - Without Handles "F" | 28 1/2" (73.3 cm)      |
| Depth - Cabinet Only "G"    | 24 1/2" (61.9 cm)      |
| Width - Cabinet "H"         | 35 1/2" (90.5 cm)      |
| Width - Door Open 90° "I"   | 43 1/2" (110.8 cm)     |

### ⚠ WARNING



#### Electrical Shock Hazard

Plug into a grounded 3 prong outlet.

Do not remove ground prong.

Do not use an adapter.

Do not use an extension cord.

Failure to follow these instructions can result in death, fire, or electrical shock.

✓ High

✗ Gargandeep Arora

**Electrical:** A 115 V 60 Hz., AC only, 15 or 20 A fused, grounded electrical supply is required. It is recommended that a separate circuit serving only your freezer be provided. Use an outlet that cannot be turned off by a switch. Do not use an extension cord.

**Water:** A cold water supply with water pressure between 35 and 120 psi (241 and 827 kPa) is required to operate the water dispenser and ice maker. If you have questions about your water pressure, call a licensed, qualified plumber.

**NOTE:** If the water pressure is less than what is required, the flow of water from the water dispenser could decrease or ice cubes could be hollow or irregular shaped.

#### Reverse Osmosis Water Supply

**IMPORTANT:** The pressure of the water supply coming out of a reverse osmosis system going to the water inlet valve of the refrigerator needs to be between 35 and 120 psi (241 and 827 kPa).

If a reverse osmosis water filtration system is connected to your home cold water supply, the water pressure to the reverse osmosis system needs to be a minimum of 40 to 60 psi (276 to 414 kPa).



LOT 92 THAMES PH. 5 A  
RE: FRIDGE SPEC'S CONT

"NO ROUGH IN WATERLINE  
PURCHASED"

## KitchenAid® French Door Bottom Mount Refrigerator with Ice Dispenser

### LOCATION REQUIREMENTS

#### ⚠ WARNING



##### Explosion Hazard

Keep flammable materials and vapors, such as gasoline, away from refrigerator.

Failure to do so can result in death, explosion, or fire.

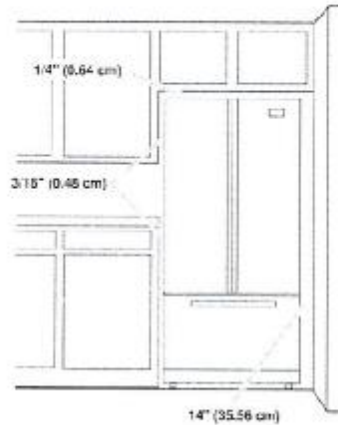

**IMPORTANT:** This refrigerator is designed for indoor and household use only.

To ensure proper ventilation for your refrigerator, allow for a 3/16\" (0.48 cm) of space on each side and 1/4\" (0.64 cm) space at the top. Allow for a 1\" (2.54 cm) space behind the refrigerator. If your refrigerator has an ice maker, allow extra space at the back for the water line connections. When installing your refrigerator next to a fixed wall, leave a 14\" (35.56 cm) minimum space between the refrigerator and wall to allow the door to swing open.

**NOTE:** This refrigerator is intended for use in a location where the temperature ranges from a minimum of 55°F (13°C) to a maximum of 110°F (43°C). The preferred room temperature range for optimum performance, which reduces electricity usage and provides superior cooling, is between 60°F (15°C) and 90°F (32°C). It is recommended that you do not install the refrigerator near a heat source, such as an oven or radiator.

α High

α Gayandeep Arora

Prepared by  
Arshdeep Singh  
arshdeepsg2011@gmail.com (437) 779-5400



30" 5-Burner Gas Cooktop with Griddle  
KCGS950ESS

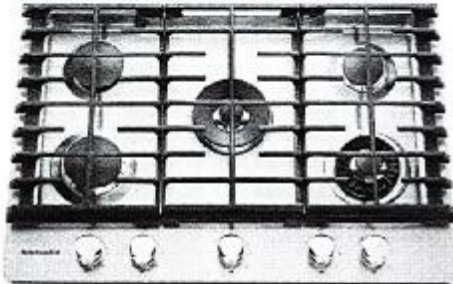

Available Finishes/Colours

KCGS950ESS  
Stainless Steel

| Dimensions              |                 | Features                           |  |
|-------------------------|-----------------|------------------------------------|--|
| Depth                   | 21              | Digital Display                    | No   |
| Height                  | 3 11/16         | Downdraft Vent                     | No   |
| Width                   | 30              | Heating Element On Indicator Light | Yes  |
| Controls                |                 | Hot Surface Indicator Light        | No   |
| Control Location        | Front           | Installs Over Built-In Oven        | Yes  |
| Control Type            | Knobs           | Griddle                            | Included                                     |
| Infinite Heat Controls  | Yes             | LP Convertible                     | Yes - Kit Included                           |
| Knob Color              | Stainless Steel | Power Boost                        | No   |
| Knob Type               | Metal           | Power Outage Compatible            | Yes  |
| Features                |                 | Selection                          | Automatic Re-ignition, Lighted Knobs, Simmer |
| Automatic Pan Detection | No              |                                    |  |

Top Features

- 10,000 BTU Even-Heat™ Torch Burner
- 17K BTU Professional Dual Ring Burner
- Removable Griddle Included

Manuals & Literature:

- Dimension Guide
- Installation Guide
- Use and Care Guide
- Warranty Information

*[Signature]*  
*[Signature]*

KitchenAid

Because Whirlpool Corporation policy includes a continuous commitment to improve our products, we reserve the right to change materials and specifications without notice. Dimensions are for planning purposes only. For complete details, see Installation Instructions packed with product. Specifications subject to change without notice.

30" (76.2 CM) AND 36" (91.4 CM) GAS BUILT-IN COOKTOP

PRODUCT MODEL NUMBERS

|          |          |           |           |
|----------|----------|-----------|-----------|
| KCGS350E | KCGS950E | MGC9530D  | WCG75US0D |
| KCGS356E | KCGS956E | MGC9536D  | WCG97US0D |
| KCGS550E | MGC7430D | WCG51US0D | WCG97US6D |
| KCGS556E | MGC7536D | WCG51US6D |           |

GAS SUPPLY REQUIREMENTS

Type of Gas

Natural Gas:

This cooktop is design-certified by CSA International for use with Natural gas or, after proper conversion, for use with LP gas.

- This cooktop is factory set for use with Natural gas. If converting to LP gas, see the "LP Gas Conversion" instructions provided in the package containing literature. The model/serial rating plate located on the underside of the cooktop base has information on the types of gas that can be used. If the types of gas listed do not include the type of gas available, check with the local gas supplier.

LP Gas Conversion:

Conversion must be done by a qualified service technician.

No attempt shall be made to convert the cooktop from the gas specified on the model/serial rating plate for use with a different gas without consulting the serving gas supplier. See the Gas Conversion instructions provided in the package containing literature.

Gas Supply Line

- Provide a gas supply line of 3/4" (1.9 cm) rigid pipe to the cooktop location. A smaller size pipe on longer runs may result in insufficient gas supply. Pipe-joint compounds that resist the action of LP gas must be used. Do not use TEFLON<sup>®</sup> tape. With LP gas, piping or tubing size should be 1/2" minimum. Usually, LP gas suppliers determine the size and materials used in the system.

Flexible metal appliance connector:

- If local codes permit, use a 1/2" or 3/4" I.D. flexible stainless steel tubing gas connector, designed by CSA to connect the cooktop to the rigid gas supply line.



- A 1/2" male pipe thread is needed for connection to the female pipe threads of the inlet to the cooktop pressure regulator.
- Do not kink or damage the flexible metal tubing when moving the cooktop.

- Must include a shutoff valve:

The supply line must be equipped with a manual shutoff valve. This valve should be located in the same room but external to the cooktop opening, such as an adjacent cabinet. It must be accessible without removing the cooktop, and it should be in a location that allows ease of opening and closing. Do not block access to shutoff valve. The valve is for turning on or shutting off gas to the cooktop.

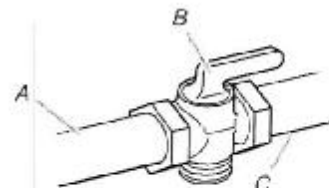

A. Gas supply line  
B. Shutoff valve "open" position  
C. To cooktop

<sup>†</sup>TEFLON is a registered trademark of E.I. Du Pont De Nemours and Company.

ELECTRICAL REQUIREMENTS

- A 120 volt, 60 Hz, AC only, 15-amp, fused electrical circuit is required. A time-delay fuse or circuit breaker is also recommended. It is recommended that a separate circuit serving only this cooktop be provided.
- Electronic ignition systems operate within wide voltage limits, but proper grounding and polarity are necessary. Check that the outlet provides 120-volt power and is correctly grounded.

x *[Signature]*

x *Gagandeep Arora*



LOT 92 THAMES PH. 5 A  
RE: 30" GAS COOK TOP SPEC'S CONT

PRODUCT DIMENSIONS

KCGS550ESS and KCGS950ESS Models

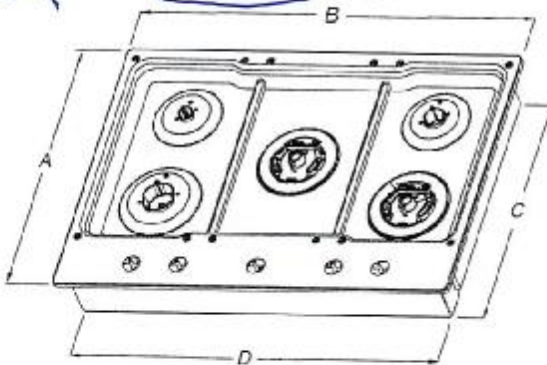

- |                      |                     |
|----------------------|---------------------|
| A. 21" (53.3 cm)     | E. 3 3/8" (9.2 cm)  |
| B. 30" (76.2 cm)     | F. 4 1/8" (11.6 cm) |
| C. 19 1/2" (49.2 cm) | G. 1 1/2" (3.4 cm)  |
| D. 28 1/2" (72.1 cm) |                     |

KCGS556ESS and KCGS956ESS Models

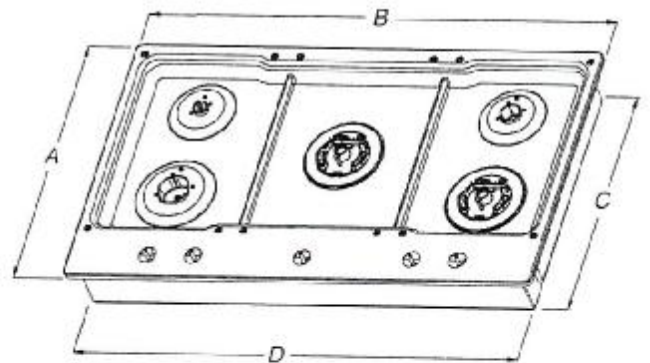

- |                      |                     |
|----------------------|---------------------|
| A. 21" (53.3 cm)     | E. 3 3/8" (9.2 cm)  |
| B. 36 1/2" (92.0 cm) | F. 4 3/8" (11.6 cm) |
| C. 19 1/2" (49.2 cm) | G. 1 7/8" (3.5 cm)  |
| D. 34 3/8" (88.1 cm) |                     |

All Other 30" (76.2 cm) Models

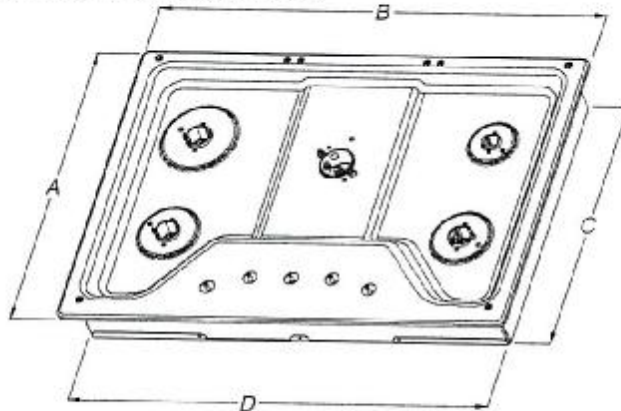

- |                      |                     |
|----------------------|---------------------|
| A. 21" (53.3 cm)     | E. 3 3/8" (8.6 cm)  |
| B. 30" (76.2 cm)     | F. 4 1/8" (10.5 cm) |
| C. 18 3/8" (48.0 cm) | G. 1 1/2" (3.8 cm)  |
| D. 28 3/8" (72.1 cm) |                     |

All Other 36" (91.4 cm) Models

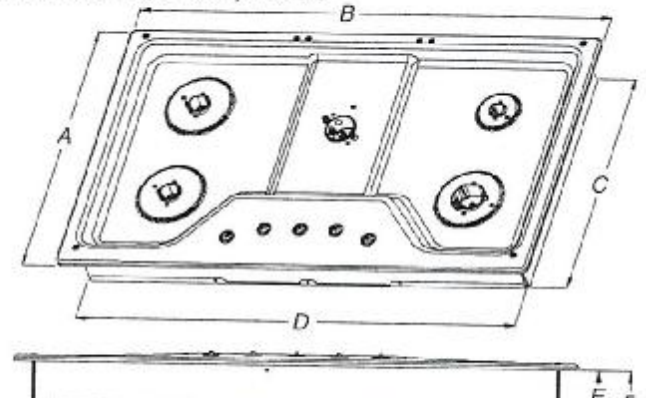

- |                      |                     |
|----------------------|---------------------|
| A. 21" (53.3 cm)     | E. 3 3/8" (8.5 cm)  |
| B. 36" (91.4 cm)     | F. 4 1/8" (10.5 cm) |
| C. 18 7/8" (48.0 cm) | G. 1 1/2" (3.8 cm)  |
| D. 33 3/8" (85.7 cm) |                     |

*[Handwritten signature]*

*[Handwritten signature: Gyanandeep Anila]*



LOT 92 THAMES PH. 5 A  
RE: 30" GAS COOK TOP SPEC'S CONT

CABINET DIMENSIONS

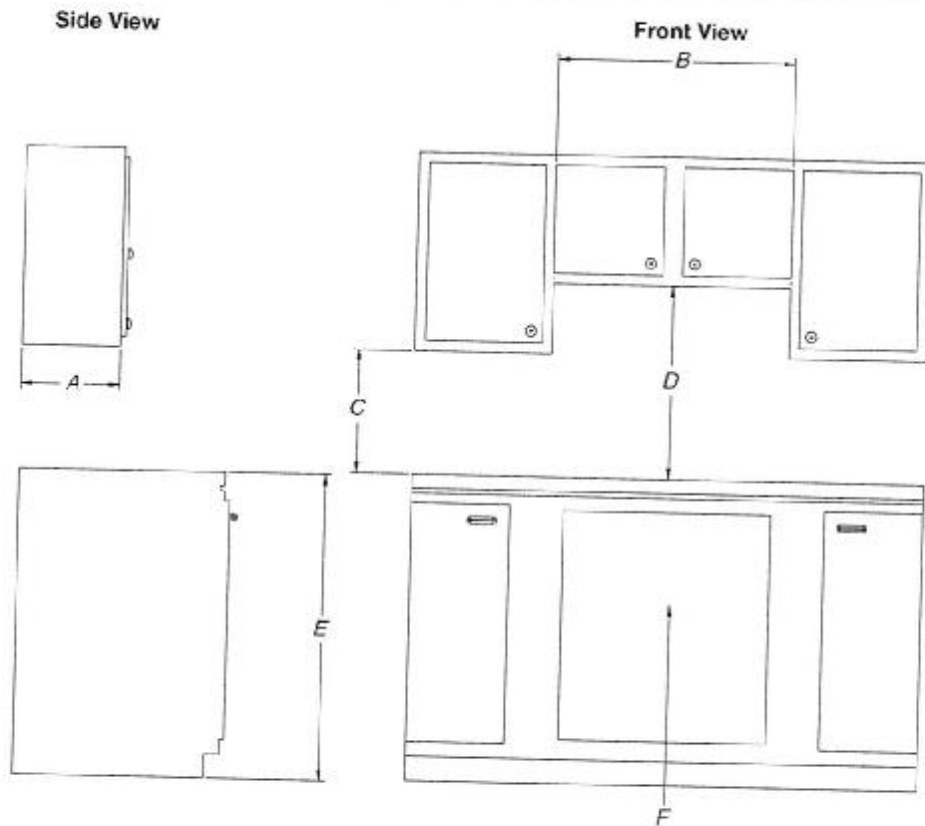

- A. 13" (33.0 cm) recommended upper cabinet depth.  
 B. 30" (76.2 cm) for 30" models; 36" (91.4 cm) for 36" models.  
 C. 18" (45.7 cm) minimum clearance from upper cabinet to countertop within minimum horizontal clearances to cooktop.  
 D. 30" (76.2 cm) minimum clearance between top of cooktop platform and bottom of uncovered wood or metal cabinet. 24" (61 cm) minimum clearance if bottom of wood or metal cabinet is covered by not less than 1/4" (0.6 cm) flame retardant miliboard covered with not less than No. 28 MSG sheet steel, 0.015" (0.04 cm) stainless steel, or 0.024" (0.06 cm) aluminum or 0.020" (0.05 cm) copper.  
 E. 36" (91.4 cm) top of countertop to floor.  
 F. Gas line opening - Wall: anywhere 6" (12.7 cm) below underside of countertop. Cabinet floor: anywhere within 6" (15.2 cm) of rear wall is recommended.

*[Signature]*

*[Signature]*

LOT 92 THAMES PH. 5 A  
 RE: 30" GAS COOK TOP SPEC'S CONT

✓ *[Signature]*  
 ✓ *Galvandeep Arora*

CABINET DIMENSIONS (cont.)

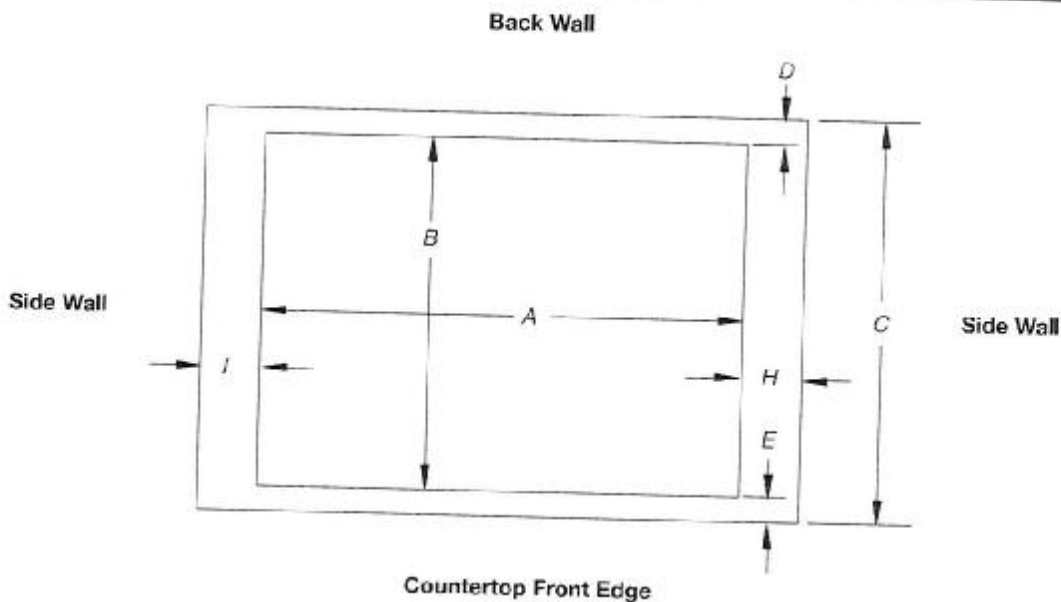

| Cutout (Product Opening) Dimensions                   |  |   |  |                                    |  |                                |
|---|--|---|--|------------------------------------|--|--------------------------------|
| 30" (76.2 cm) Models                                  |  |   |  |                                    |  |                                |
| Models  | A                                      |   |  | B                                  |  |                                |
|   | Min                                    | Recommended                             | Max                                      | Min                                | Recommended                              | Max                            |
| KCGS550 and KCGS950<br>All Other 30" (76.2 cm) Models | 28 1/8" (72.4 cm)<br>28 1/8" (72.4 cm) | 28 7/8" (73.4 cm)<br>28 7/8" (73.4 cm)  | 29 3/16" (74.3 cm)<br>29 3/16" (74.3 cm) | 19 1/2" (49.5 cm)<br>19" (48.3 cm) | 19 13/16" (50.2 cm)<br>19 1/8" (49.5 cm) | 20" (50.8 cm)<br>20" (50.8 cm) |
| 36" (91.4 cm) Models                                  |  |   |  |                                    |  |                                |
| KCGS556 and KCGS956<br>All Other 36" (91.4 cm) Models | 34 7/8" (88.4 cm)<br>33 3/8" (86.0 cm) | 35 3/16" (89.4 cm)<br>34 5/8" (87.0 cm) | 35 5/8" (90.3 cm)<br>35 1/4" (89.5 cm)   | 19 1/2" (49.5 cm)<br>19" (48.3 cm) | 19 13/16" (50.2 cm)<br>19 1/8" (49.5 cm) | 20" (50.8 cm)<br>20" (50.8 cm) |

| Side Walls (Combustible Surfaces)             |   |
|---|---|
| Models  | H and I   |
| KCGS5 and KCGS9                               | H and I added together must be at least 48" (122.0 cm), with each side individually being at least 8" (20.3 cm).  |
| KCGS350, KCGS356, MGC9536, WCG97US0, WCG97US6 | H and I added together must be at least 48" (122.0 cm), with each side individually being at least 12" (30.5 cm). |
| All Other Models                              | Both have to be 8" (20.3 cm) or more  |

| Back Wall and Countertop Front Dimensions |               |                 |                 |
|---|---------------|-----------------|-----------------|
| Models                                    | C             | D               | E               |
| KCGS550 and KCGS950                       | 25" (63.5 cm) | 2 7/8" (7.3 cm) | 2 3/4" (6.9 cm) |
| All Other Models                          |               |                 | 3 1/8" (7.9 cm) |

**NOTES:** After making the countertop cutout, some installations may require notching down the base cabinet side walls to clear the cooktop base. To avoid this modification, use a base cabinet with sidewalls wider than the cutout.  
 If cabinet has a drawer, a 4" (10.2 cm) depth clearance from the countertop to the top of the drawer (or other obstruction) in base cabinet is required. The drawer depth may need to be shortened to avoid interfering with the regulator.  
**IMPORTANT:** If a built-in wall oven is to be installed below this cooktop, the grounded outlet and gas supply piping must be located in an adjacent cabinet.  
 This cooktop and its gas and electrical supply sources must be installed before the undercounter built-in wall oven is installed.



**LOT 92 THAMES PH. 5 A**  
**RE: 30" WALL OVEN/MICRO. COMBO**  
**SPEC'S CONT**  
**" NO FLUSH MOUNT INSTALLATION"**

**KitchenAid® 27" (68.6 cm) and 30" (76.2 cm) Electric Built-In Microwave/Oven Combination**

**PRODUCT MODEL NUMBERS**

KEMS309E KOCE500E KOCE507E

**ELECTRICAL CONNECTION**

If codes permit and a separate ground wire is used, it is recommended that a qualified electrical installer determine that the ground path and the wire gauge are in accordance with local codes. Check with a qualified electrical installer if you are not sure the oven is properly grounded.

This oven must be connected to a grounded metal, permanent wiring system.

Be sure that the electrical connection and wire size are adequate and in conformance with the National Electrical Code, ANSI/NFPA 70-latest edition or CSA Standards C22.1-94, Canadian Electrical Code, Part 1 and C22.2 No. 0-M91 latest edition, and all local codes and ordinances.

To properly install your oven, you must determine the type of electrical connection you will be using and follow the instructions provided for it here.

- Oven must be connected to the proper electrical voltage and frequency as specified on the model/serial/rating plate. See the following illustration.

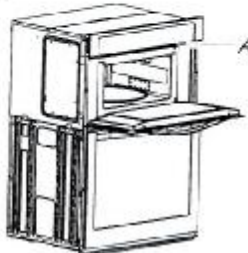

A. Model/serial/rating plate

- Models rated from 7.3 to 9.6 kW at 240 volts (5.4 to 7.4 kW at 208 volts) require a separate 40-amp circuit. Models rated at 4.8 kW and below at 240 volts (3.6 kW and below at 208 volts) require a separate 30-amp circuit.
- A circuit breaker is recommended.
- Connect directly to the fused disconnect (or circuit breaker box) through flexible, armored or nonmetallic sheathed, copper cable (with grounding wire). See "Make Electrical Connection" section.
- Flexible conduit from the oven should be connected directly to the junction box.
- Do not cut the conduit. The length of conduit provided is for serviceability of the oven.
- A UL listed or CSA approved conduit connector must be provided.
- If the house has aluminum wiring, follow the procedure below:
  1. Connect a section of solid copper wire to the pigtail leads.
  2. Connect the aluminum wiring to the added section of copper wire using special connectors and/or tools designed and UL listed for joining copper to aluminum.

Follow the electrical connector manufacturer's recommended procedure. Aluminum/copper connection must conform with local codes and industry accepted wiring practices.

For power requirements, refer to the following table.

| Model             | Voltage | Amperage (L1)* | Amperage (L2)* | Rating (W) |
|-------------------|---------|----------------|----------------|------------|
| KOCE507E/KOCE500E | 120/240 | 32             | 30             | 8000       |
| KOCE507E/KOCE500E | 120/208 | 30             | 28             | 6600       |

\*Amperage values noted above are for information purposes only; the units are rated in watts.

Because Whirlpool Corporation includes a continuous commitment to improve our products, we reserve the right to change materials and specifications without notice.

**PRODUCT DIMENSIONS**

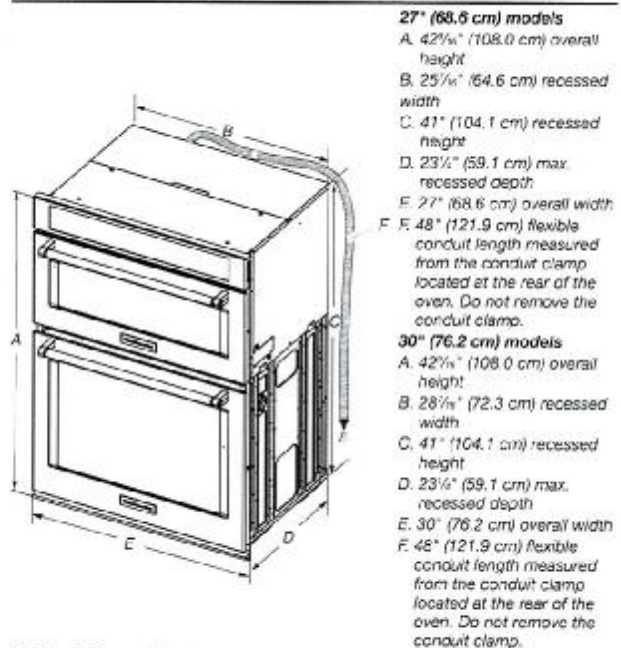

**27" (68.6 cm) models**

- A. 42 1/4" (108.0 cm) overall height
- B. 25 1/4" (64.6 cm) recessed width
- C. 41" (104.1 cm) recessed height
- D. 23 1/2" (59.1 cm) max. recessed depth
- E. 27" (68.6 cm) overall width
- F. 48" (121.9 cm) flexible conduit length measured from the conduit clamp located at the rear of the oven. Do not remove the conduit clamp.

**30" (76.2 cm) models**

- A. 42 1/4" (108.0 cm) overall height
- B. 28 1/4" (72.3 cm) recessed width
- C. 41" (104.1 cm) recessed height
- D. 23 1/2" (59.1 cm) max. recessed depth
- E. 30" (76.2 cm) overall width
- F. 48" (121.9 cm) flexible conduit length measured from the conduit clamp located at the rear of the oven. Do not remove the conduit clamp.

**Cabinet Dimensions**

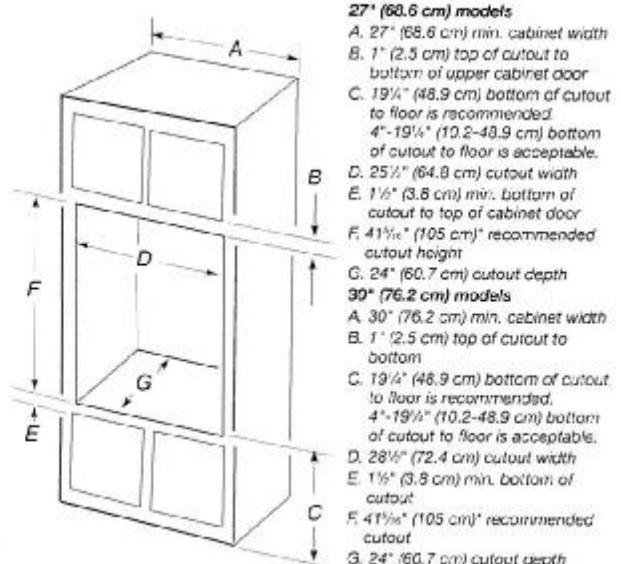

**27" (68.6 cm) models**

- A. 27" (68.6 cm) min. cabinet width
- B. 1" (2.5 cm) top of cutout to bottom of upper cabinet door
- C. 19 1/4" (48.9 cm) bottom of cutout to floor is recommended. 4"-19 1/4" (10.2-48.9 cm) bottom of cutout to floor is acceptable.
- D. 25 1/4" (64.6 cm) cutout width
- E. 1 1/2" (3.8 cm) min. bottom of cutout to top of cabinet door
- F. 41 1/4" (105 cm) recommended cutout height
- G. 24" (60.7 cm) cutout depth

**30" (76.2 cm) models**

- A. 30" (76.2 cm) min. cabinet width
- B. 1" (2.5 cm) top of cutout to bottom
- C. 19 1/4" (48.9 cm) bottom of cutout to floor is recommended. 4"-19 1/4" (10.2-48.9 cm) bottom of cutout to floor is acceptable.
- D. 28 1/4" (72.4 cm) cutout width
- E. 1 1/2" (3.8 cm) min. bottom of cutout
- F. 41 1/4" (105 cm) recommended cutout
- G. 24" (60.7 cm) cutout depth

\* NOTE: The cabinet height can be between 41" (104.1 cm) and 41 1/2" (105.6 cm) for microwave/oven combination.

*Handwritten signature: H. H. H.*  
*Handwritten signature: Gagandeep Anula*

Because Whirlpool Corporation includes a continuous commitment to improve our products, we reserve the right to change materials and specifications without notice.

Dimensions are for planning purposes only. For complete details, see installation instructions packed with product. Specifications subject to change without notice.

Ref. W10725983E  
 2/10/15

LOT 92 THAMES PH. 5 A  
RE: 30" WALL OVEN/MICRO. COMBO  
SPEC'S  
" NO FLUSH MOUNT INSTALLATION"

Prepared by  
Arshdeep Singh  
arshdeepsg2011@gmail.com (437) 778-5400

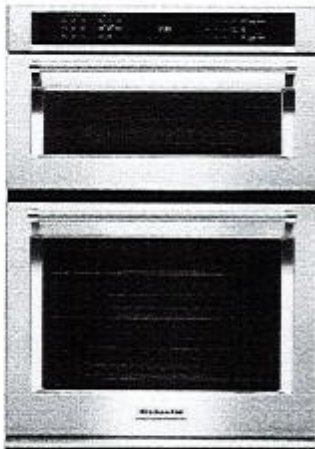

### 30" Combination Wall Oven with Even-Heat™ True Convection (Lower Oven)

KOCE500ESS

Available Finishes/Colours

- ☒ KOCE500EBL Black
- ☐ KOCE500EWH White

KOCE500ESS  
Stainless Steel

#### Dimensions

|        |        |
|--------|--------|
| Depth  | 27 1/8 |
| Height | 42 1/2 |
| Width  | 30     |

#### Controls

|                         |                             |
|-------------------------|-----------------------------|
| Control Type            | Glass Touch Digital Display |
| Electronic Display Type | Digital                     |

#### Exterior

|                             |                 |
|-----------------------------|-----------------|
| Door Removable              | Yes             |
| Door Release                | Handle          |
| Door Lock                   | Yes             |
| Door Type                   | Metal & Glass   |
| Flush Installation Approved | Yes             |
| Oven Window Size            | Extra Large     |
| Handle Color                | Stainless Steel |
| Handle Material             | Metal           |

#### GDS

|                 |            |
|-----------------|------------|
| isBaseUnit      | true       |
| isConsumerUnit  | true       |
| isDispatchUnit  | -          |
| isInvoiceUnit   | true       |
| isOrderableUnit | true       |
| Product Type    | EA         |
| UDEX            | 1100400623 |
| GPC Code        | 10001950   |

This 30" Combination Wall Oven with Even-Heat™ True Convection provides consistent heating and even cooking. A unique bow-tie shaped design and convection fan helps ensure there are no burnt edges or under cooked centers. Its upper Microwave Convection Cooking Oven combines a 900 watt microwave with a 1600 watt convection element for high speed cooking. Bold design details are the perfect balance of elegance and functionality.

#### Top Features

- Even-Heat™ True Convection Oven (lower oven)
- Microwave Convection Cooking (upper oven)
- Temperature Probe

#### Manuals & Literature:

- [Dimension Guide](#)
- [Installation Guide](#)
- [Use and Care Guide](#)
- [Warranty Information](#)

#### Controls

|               |       |
|---------------|-------|
| Display Color | White |
|---------------|-------|

#### Features

|                     |                 |
|---------------------|-----------------|
| Sensor Cooking      | Yes - Microwave |
| Language Conversion | English/French  |

#### Microwave Details

|                              |     |
|------------------------------|-----|
| Microwave Capacity (cu. ft.) | 1.4 |
|------------------------------|-----|

*Handwritten signature*

*Handwritten signature: Gargandeep Arula*

**KitchenAid**

Because Whirlpool Corporation policy includes a continuous commitment to improve our products, we reserve the right to change materials and specifications without notice. Dimensions are for planning purposes only. For complete details, see installation instructions packed with product. Specifications subject to change without notice.