

**KINGSMEN (THAMES) INC. / Havelock Corners (Kingsmen)**

**Lot/Unit: 165    Phase/Building: 5A    Model/Floor Plan: Louis (4203) Elev C 4 Bed - 4+1 Bath**

**COUNTER TOP**

Inv.5680	1 - As per schedule "PE": Vendor to include level 1, 2cm. quartz in all bathrooms, as per plan, in lieu of the included laminate counter tops. Selections to be made from builders standard samples.	
Line 72748	Note:	
20Jul22 / 20Jul22		

**ELECTRICAL**

Inv.5680	1 - To supply & install the standard T.V. rough in in the great room and master bedroom... see sketch # 1 & # 2	
Line 72749	Note: Install the standard T.V. rough in at approx. 66" + - up from the floor centered +- to the F/P mantle	
20Jul22 / 20Jul22		
Inv.5680	1 - To supply & install the standard Phone ( CAT 5 ) rough in in the great room, master bedroom & bedroom # 4 ... see sketch # 1 & # 2	
Line 72750	Note: Install the standard Phone ( CAT 5 ) rough in at approx. 66" + - up from the floor centered +- to the F/P mantle	
20Jul22 / 20Jul22		
Inv.5680	1 - To SUPPLY AND INSTALL AN ADDITIONAL BASIC RECEPTACLE (NOT DEDICATED) at approx. 66" + - up from the floor centered + - to the F/P mantle	
Line 72751	Note: in the great room.	
20Jul22 / 20Jul22		
This is for a future wall mount T.V.		
NO CONDUIT PIPE HAS BEEN PURCHASED.		
Inv.5680	1 - To SUPPLY AND INSTALL EXTRA CEILING BOX ROUGH IN CAPPED (DOES NOT INCLUDE SWITCH) over the kitchen island.... see sketch # 1	
Line 72752	Note: This cap will be connected to a sep. switch, switch sold sep.	
20Jul22 / 20Jul22		
Inv.5680	1 - To supply & install AN ADDITIONAL SINGLE POLE SWITCH connected to the upgraded capped elec. over the kitchen island.	
Line 72753	Note:	
20Jul22 / 20Jul22		
Inv.5680	1 - Relocate the standard ceiling light from the upper stair landing to the O.T.B. area on the second floor... see sketch # 2	
Line 72754	Note: NO REINFORCING HAS BEEN PURCHASED.	
20Jul22 / 20Jul22		

**HEATING AND AIR CONDITIONING**

Inv.5680	1 - As per schedule "PE": Vendor to install capped gas line ( rough in only ) at rear of home for future BBQ location. Location to be finalized at vendors sole discretion.	
Line 72746	Note:	
20Jul22 / 20Jul22		
Inv.5680	1 - As per schedule "PE": Vendor to supply & install air conditioning unit, sized accordingly, from vendors standard samples.	
Line 72747	Note:	
20Jul22 / 20Jul22		



CONSTRUCTION SUMMARY

KINGSMEN (THAMES) INC. / Havelock Corners (Kingsmen)

Lot/Unit: 165    Phase/Building: 5A    Model/Floor Plan: Louis (4203) Elev C 4 Bed - 4+1 Bath

EXTRAS AS PER OFFER

5 FREE APPLIANCES – STAINLESS STEEL FRONT - FRIDGE: STOVE AND DISHWASHER. WHITE WASHER AND DRYER (SUPPLIED ONLY, NOT INSTALLED, FROM BUILDERS STANDARD LINE). AN APPLIANCES VOUCHER WILL BE GIVEN BY OUR DECOR CONSULTANT AT THE TIME OF BOOKING YOUR COLOUR A <i>Worksheet</i> Note:	
VENDOR TO INSTALL CAPPED GAS LINE (ROUGH-IN ONLY) AT REAR OF HOME FOR FUTURE BBQ LOCATION.    LOCATION TO BE FINALIZED AT VENDORS SOLE DISCRETION. <i>Worksheet</i> Note:	
VENDOR TO SUPPLY & INSTALL AIR CONDITIONING UNIT, SIZED ACCORDINGLY, FROM VENDORS STANDARD SAMPLES. <i>Worksheet</i> Note:	
VENDOR TO INCLUDE LEVEL 1, 2CM QUARTZ IN ALL BATHROOMS, AS PER PLAN, IN LIEU OF THE INCLUDED LAMINATE COUNTER TOPS.    SELECTIONS TO BE MADE FROM BUILDERS STANDARD SAMPLES. <i>Worksheet</i> Note:	

Purchaser: HARJINDER SINGH SAGU

Property: 165 of Plan - Draft Approval SB17-03-08

Telephone Res. / Bus: /

Project: KINGSMEN (THAMES) INC.

Decor Advisor: Barbara Coccia

Model and Elevation: Louis (4203) Elev C 4 Bed - 4+1 Bath

Layout Changes: ☐ Yes ☒ No

Sketch Attached: ☒ Yes ☐ No

Exterior Colour Scheme:

### 1. Cabinetry

	Style and Colour	Counter Top	Hardware
Kitchen / Breakfast	#3, Slab Silk Touch Twilight Grey	# 1, C/S # 3040 Cement 3cm.	#12881 Handle
Kitchen Island	#3, Slab Silk Touch Twilight Grey	# 1, C/S # 3040 Cement 3cm.	#12881 Handle
Laundry Room	/		
Powder Room	#3, Slab Silk Touch Twilight Grey	# 1, C/S # 3040 Cement 2cm.	#12881 Handle
Main Bathroom	/		
Master Ensuite Bathroom	#3, Slab Silk Touch Twilight Grey	# 1, C/S # 3040 Cement 2cm.	#12881 Handle
Second Ensuite Bathroom (If Applicable)	#3, Slab Silk Touch Twilight Grey	# 1, C/S # 3040 Cement 2cm.	#12881 Handle
Ens. #3's bathroom	#3, Slab Silk Touch Twilight Grey	# 1, C/S # 3040 Cement 2cm.	#12881 Handle
Ens. #4's bathroom	#3, Slab Silk Touch Twilight Grey	# 1, C/S # 3040 Cement 2cm.	#12881 Handle

### Appliances

#### Custom Size Fridge

☐ Yes ☒ No

#### Valance Lighting

☐ Yes ☒ No

#### Microwave / Range Hood

☐ Yes ☒ No

#### Cooktop / Rangetop

☐ Yes ☒ No

#### Built in Wall Oven

☐ Yes ☒ No

#### Slide-in Range

☐ Yes ☒ No

Comment

### 2. Flooring

	Selection
Foyer	13 x 13" Malena Carbon
Main Hall	3 1/2" Elements Oak Sturgeon
Back Hall	/
Breakfast	13 x 13" Malena Carbon
Laundry Room	13 x 13" Malena Carbon
Kitchen	13 x 13" Malena Carbon
Powder Room	13 x 13" Malena Carbon
Main Bathroom	Ens. # 2's bathroom: 13 x 13" Malena Carbon
Master Ensuite	13 x 13" Malena Carbon
Bathroom (If Applicable)	Ens. # 3's bathroom: 13 x 13" Malena Carbon
Mud Room	
Shower floor:	Master ens. & Ens. # 2's bathroom: 2x2" ontario Snow white Matte
Living Room	Ens. #4's bathroom: 13 x 13" Malena Carbon
Dining Room	( SITTING ROOM ) 3 1/2" Elements Oak Sturgeon
Family / Great Room	3 1/2" Elements Oak Sturgeon
Den / Library / Study	/
Basement Landing (If Applies)	
Lower Landing (If Applicable)	3 1/2" Elements Oak Sturgeon
Upper Landing	( if applicable ) 3 1/2" Elements Oak Sturgeon
Upper Hall	Modern Story 1, # 950 Boulders
Master Bedroom	Modern Story 1, # 950 Boulders
Bedroom #2	Modern Story 1, # 950 Boulders
Bedroom #3	Modern Story 1, # 950 Boulders
Bedroom #4	Modern Story 1, # 950 Boulders
Bedroom #5	/
Shower jamb:	Master ens. & Ens # 2's bathroom: Anatolia marmiline SNOW

Flooring Continued on Page 2

RECEIVED

JUL 20 2022

Initial: \_\_\_\_\_



Page 1 of 3

Purchaser: HARJINDER SINGH SAGU

Property: 165 of Plan - Draft Approval SB17-03-08

Telephone Res. / Bus: /

Project: KINGSMEN (THAMES) INC.

Decor Advisor: Barbara Coccia

Model and Elevation: Louis (4203) Elev C 4 Bed - 4+1 Bath

2. Flooring - Continued -

Upgrade Underpad	Type	Area
	Standard	2nd floor
Carpet on Stairs	Capped	Runner - *Upgrade
Comment	/	/

### 3. Plumbing Fixtures / Faucets

Kitchen	Standard	Second Ensuite	Standard	Powder Room	Standard
Master Ensuite	Standard			Other Room	/
Main Bathroom	/	Ens. #3 & #4's bathroom	Standard		

#### Comment

Still to install the standard under mount kitchen sink with the standard single hole kitchen faucet "NO PLATE".  
Still to install the standard top mount vanity sinks with standard lav faucets throughout ALL bathrooms.

### 4. Wall Tile

	Tile Selection	Listello	Insert	Insert Selection
Main Bathroom	/	<input type="checkbox"/>	<input type="checkbox"/>	
Master Ensuite				
Tub Deck	/	<input type="checkbox"/>	<input type="checkbox"/>	
Tub Apron	/	<input type="checkbox"/>	<input type="checkbox"/>	
Tub Surround	/	<input type="checkbox"/>	<input type="checkbox"/>	
Shower Stall	8x10" Cinq Black	<input type="checkbox"/>	<input type="checkbox"/>	
Second Ensuite	8x10" Malena Carbon	<input type="checkbox"/>	<input type="checkbox"/>	
Ens. #3's bathroom	8x10" Malena Carbon	<input type="checkbox"/>	<input type="checkbox"/>	
Ens. #4's bathroom	8x10" Malena Carbon	<input type="checkbox"/>	<input type="checkbox"/>	
Kitchen Backsplash	/	<input type="checkbox"/>	<input type="checkbox"/>	
Complete Backsplash	/	<input type="checkbox"/>	<input type="checkbox"/>	

#### Comment

Install the standard 8x10" wall tiles on the 10" side stacked horizontally to all bathrooms where applicable.



horizontal stacked



brick pattern



vertical stacked



diagonal diamond

### 5. Fireplace

	Living Room			Family Room			Other Room - Specify Great Room		
	Purchased	As Per Plan	N/A	Purchased	As Per Plan	N/A	Purchased	As Per Plan	N/A
Fireplace Type	<input type="radio"/>	<input type="radio"/>	<input checked="" type="radio"/>	<input type="radio"/>	<input type="radio"/>	<input checked="" type="radio"/>	<input type="radio"/>	<input checked="" type="radio"/>	<input type="radio"/>
Mantle Type							Front Facing		
Over Mantle							NF-08		
Colour / Stain							/		
Surround							White		
Hearth							/		
Comment							/		

RECEIVED

JUL 20 2022

Initial:

HS

Page 2 of 3



Purchaser: HARJINDER SINGH SAGU

Property: 165 of Plan - Draft Approval SB17-03-08

Telephone Res. / Bus: /

Project: KINGSMEN (THAMES) INC.

Decor Advisor: Barbara Coccia

Model and Elevation: Louis (4203) Elev C 4 Bed - 4+1 Bath

### 6. Trim Carpentry

Door Hardware Standard handle

Interior Trim Standard

Comment

/

#### Interior Doors

☐ 2 Panel Arch Top

☒ 2 Panel Square Top

☐ 6 Panel

Initial for Door Style

HS

### 7. Railings and Pickets

Railing Package Standard oak STRAIGHT picket package

Railing Colour Elements Sturgeon

Picket Colour Elements Sturgeon

Wood Stairs ☐ No ☒ Oak

Tread Colour Elements Sturgeon

Comment

/

### 8. Plaster Mouldings and Medallions

Foyer /

Main Hall /

Living Room /

Dining Room /

Family Room /

Kitchen/Breakfast /

Den/Library /

Lower Landing /

Comment

/

### 9. Wall Paint

Kingsmen White

#### Smooth Ceilings

☐ First Floor

☐ First Floor incl. Second Floor Hall

☐ First and Second Floor

☒ Throughout

☐ Not Applicable

Trim Paint Kingsmen White

### 10. Additional Comments

/

RECEIVED

JUL 20 2022

### 11. Disclaimers and Notes

- Colours of all materials are as close as possible to builder's selection, but not necessarily identical due to variances in manufacturing.
- Any extras listed above are null and void unless accompanied by a separate invoice/amendment. Said invoice must be paid in full.
- The Purchaser acknowledges that after Interior Colour Selection form is signed and dated, no further changes will be permitted other than re-selection due to unavailability. HS Purchaser's Initials
- The Purchaser acknowledges reading and accepting the "Kingsmen Group Décor Centre Disclaimers" form. This document contains other miscellaneous disclaimers.

This Interior Colour Selection is final and approved by:

Purchaser:

Signature: Harjinder Singh Date: 20/7/22

Vendor

KINGSMEN (THAMES) INC.

July 20/22

Page 3 of 3

# SCHEDULE "B-1"

## Floor Plan

Lot 165  
Phase 5A  
Model: Louis (4203) Elev C 4 Bed - 4+1 Bath  
Standard

Sketch #1

all 3 item's  
@ 66" up from  
floor

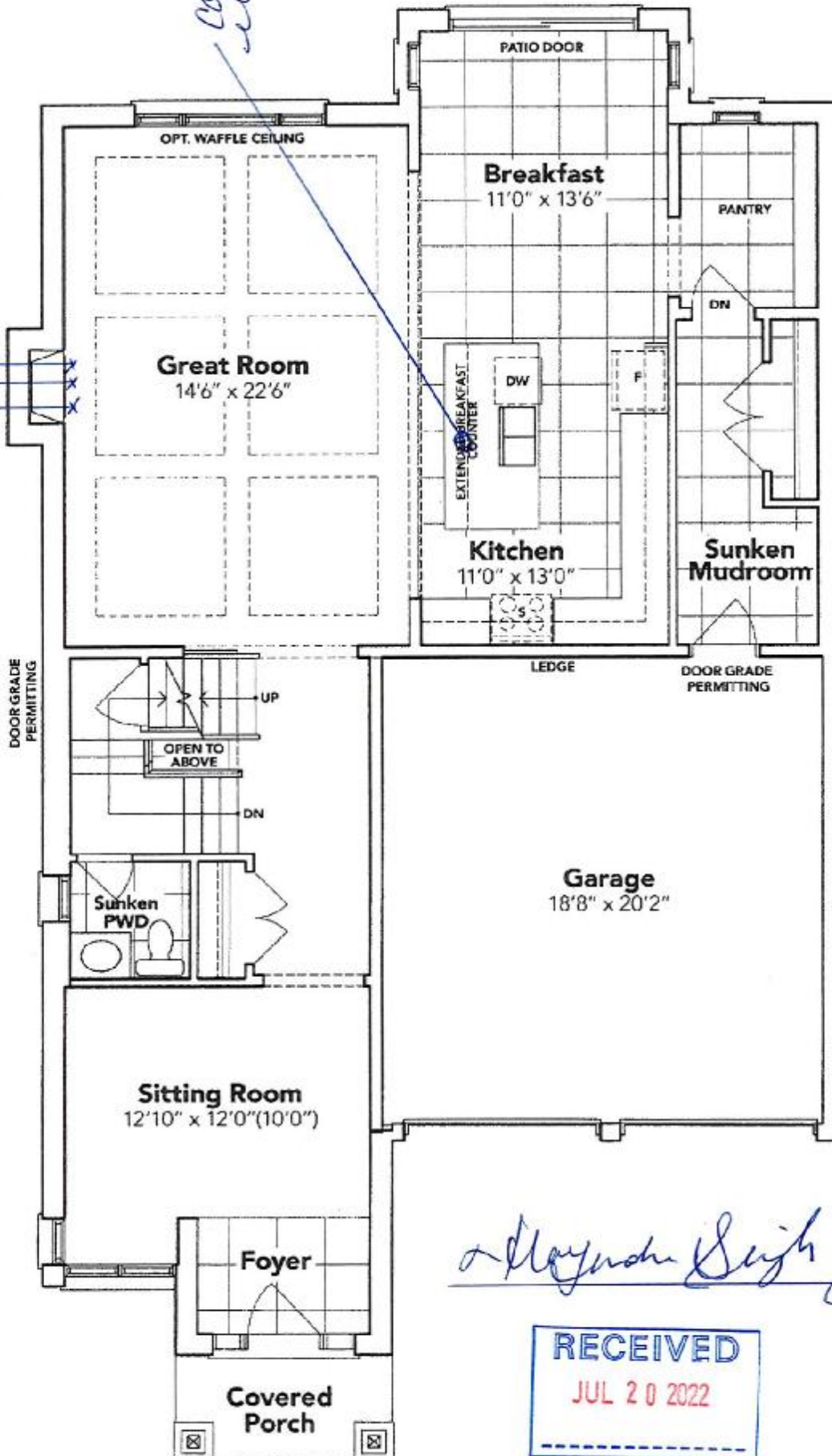

*Handwritten signature: Mayank Singh Sagar*



## GROUND FLOOR EL. C

The floor plans and elevations shown are pre-construction plans and may be revised or improved as necessitated by architectural controls and the construction process. The measurements adhere to the rules and regulations of the TARIION Warranty Corporation's official method for the calculation of floor area. Materials, specifications and floor plans are subject to change without notice. All house renderings are artist's concept only. Actual usable floor space may vary from the stated floor area. All options shown are upgrades. E. & O. E.

HS



**SCHEDULE "B-1"**  
**Floor Plan**

Lot 165  
Phase 5A  
Model: Louis (4203) Elev C 4 Bed - 4+1 Bath  
Standard

*Sketch #2*

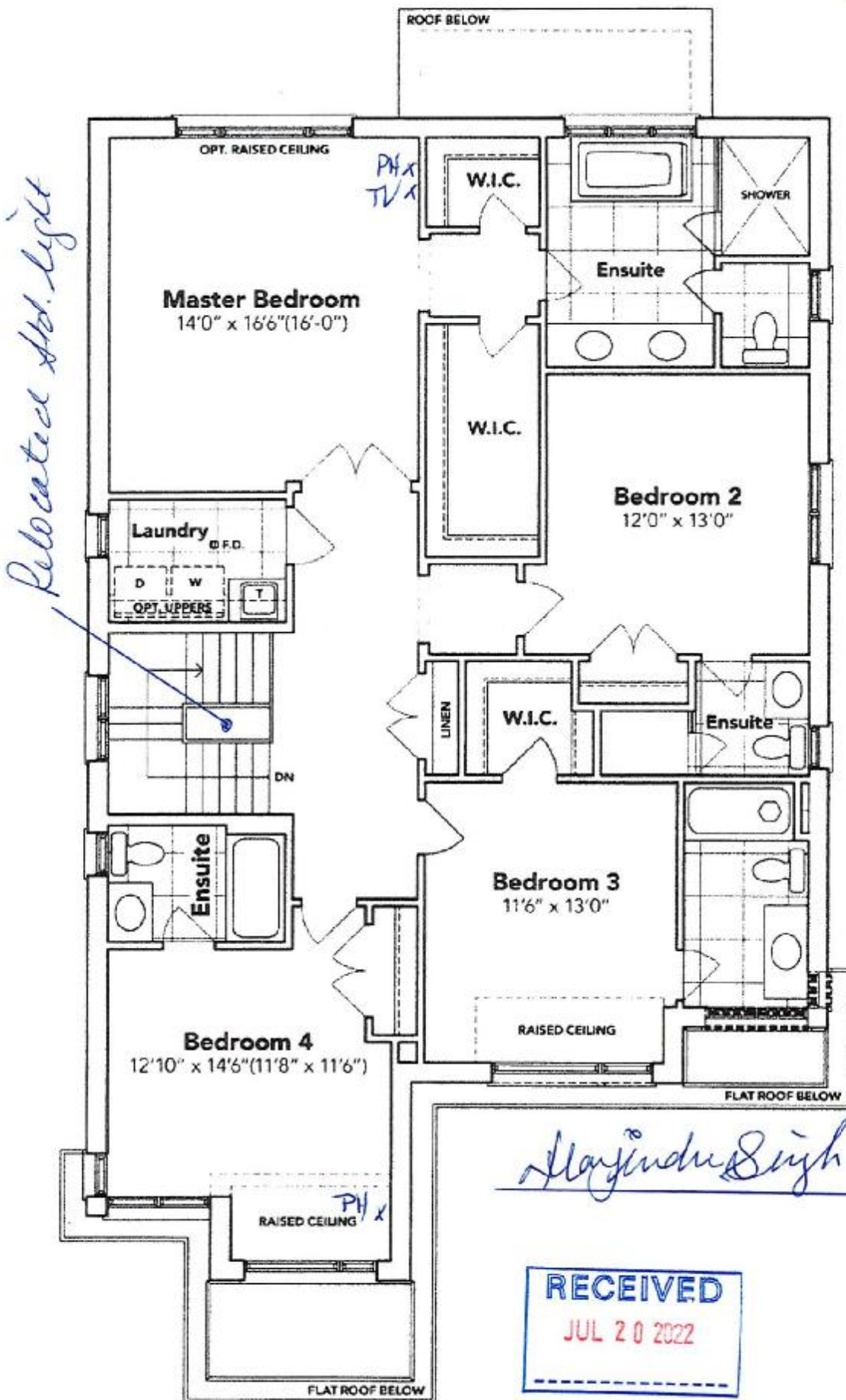

**SECOND FLOOR EL. C**

The floor plans and elevations shown are pre-construction plans and may be revised or improved as necessitated by architectural controls and the construction process. The measurements adhere to the rules and regulations of the TARIION Warranty Corporation's official method for the calculation of floor area. Materials, specifications and floor plans are subject to change without notice. All house renderings are artist's concept only. Actual usable floor space may vary from the stated floor area. All options shown are upgrades. E. & O. E.

**SCHEDULE "B-1"**  
**Floor Plan**

Lot 165  
Phase 5A  
Model: Louis (4203) Elev C 4 Bed - 4+1 Bath  
Standard

*Sketch #3*

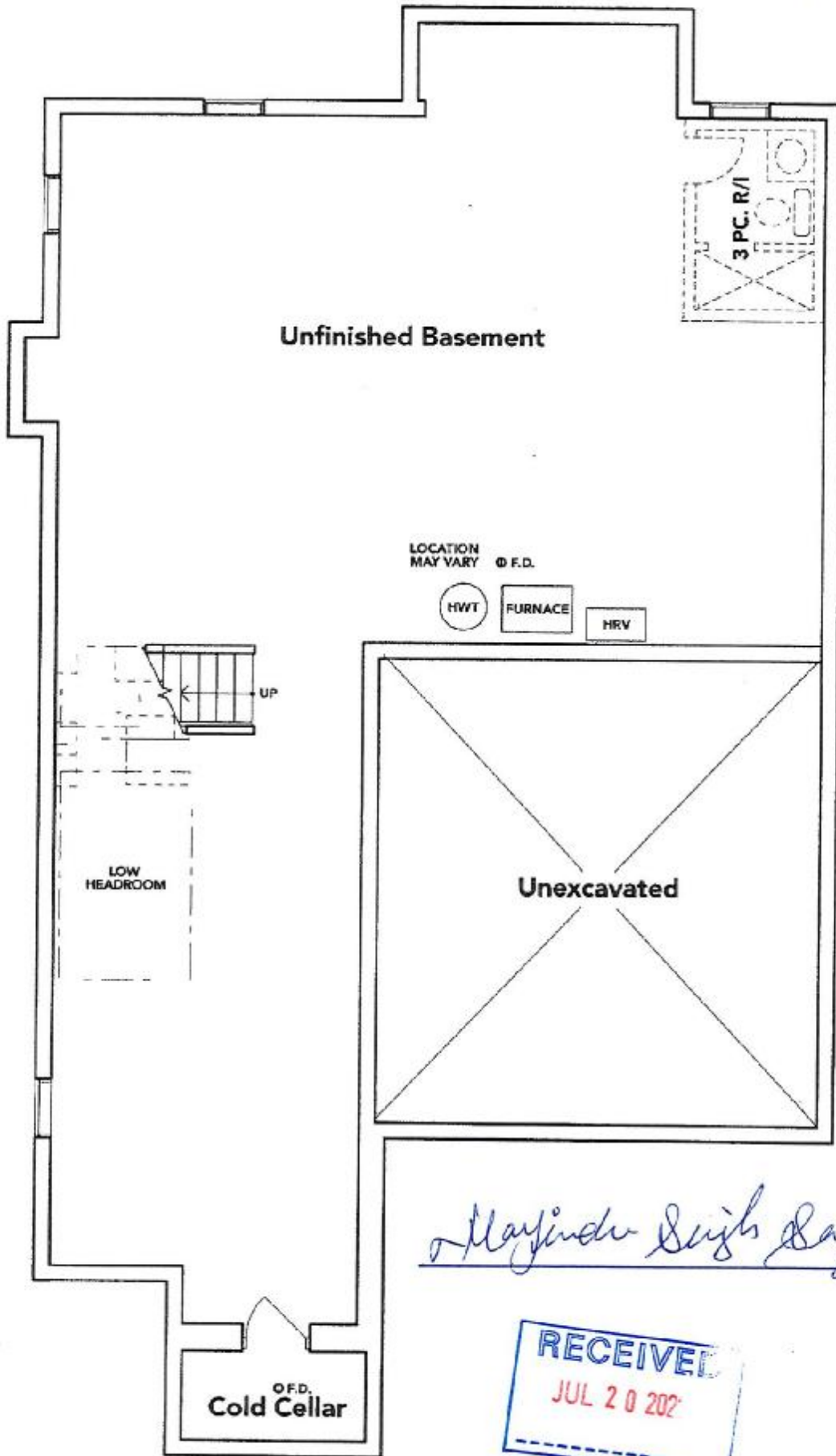

**BASEMENT EL. C**

*Mayinder Singh Sagoo*



The floor plans and elevations shown are pre-construction plans and may be revised or improved as necessitated by architectural controls and the construction process. The measurements adhere to the rules and regulations of the TARIION Warranty Corporation's official method for the calculation of floor area. Materials, specifications and floor plans are subject to change without notice. All house renderings are artist's concept only. Actual usable floor space may vary from the stated floor area. All options shown are upgrades. E. & O. E.