

KINGSMEN (THAMES) INC. / Havelock Corners (Kingsmen)

Lot/Unit: 169 Phase/Building: 5A Model/Floor Plan: John (4201) Elev B 4 Bed - 2+1 Bath

CABINETRY MICROWAVE OVEN STOVE COOKTOP

Inv.5705	1 - To supply & install WALL CABINET WITH SHELF FOR MICROWAVE - FINISHED INTERIOR - OPENING 24INCHESW X 13 3 - 4INCHESH X 17INCHESD in the kitchen... see sketch # 1	
Line 73067	Note: Elec. for this upgrade is sold sep.	
10Aug22 / 10Aug22		

CABINETRY VANITY

Inv.5705	1 - To supply & install an INCREASE VANITY TO KITCHEN HEIGHT - 90CM HIGH - MAINTAINS VANITY DEPTH - in the master ensuite only in lieu of the standard height.	
Line 73070	Note:	
10Aug22 / 10Aug22		

COUNTER TOP

Inv.5705	1 - As per schedule "PE": Vendor to include level 1, 2cm. quartz in all bathrooms, as per plan, in lieu of the included laminate counter tops. Selections to be made from builders standard samples.	
Line 73053	Note:	
10Aug22 / 10Aug22		

ELECTRICAL

Inv.5705	1 - To supply & install the standard T.V. rough in in the great room and master bedroom... see sketch # 1 & # 2	
Line 73054	Note: Install the standard T.V. rough in in the great room and master bedroom at approx. 66" + - up from the floor...	
10Aug22 / 10Aug22		
Inv.5705	1 - To supply & install the standard Phone (CAT 5) rough in in the great room, master bedroom & bedroom #3 ... see sketch # 1 & # 2	
Line 73055	Note: Install the standard Phone (CAT 5) rough in in the great room & master bedroom at approx. 66" + - up from the floor...	
10Aug22 / 10Aug22		
Inv.5705	1 - To SUPPLY AND INSTALL AN ADDITIONAL BASIC RECEPTACLE (NOT DEDICATED) at approx. 66" + - up from the floor centerd + - to the F/P mantle	
Line 73059	Note: in the great room... see sketch # 1	
10Aug22 / 10Aug22 This is for a future wall mount T.V.		
NO CONDUIT PIPE HAS BEEN PURCHAED.		
Inv.5705	1 - To SUPPLY AND INSTALL AN ADDITIONAL BASIC RECEPTACLE (NOT DEDICATED) at approx. 66" + - up from the floor	
Line 73060	Note: in the master bedroom... see sketch # 2	
10Aug22 / 10Aug22 This is for a future wall mount T.V.		
NO CONDUIT PIPE HAS BEEN PURCHAED.		
Inv.5705	1 - To SUPPLY AND INSTALL EXTRA CEILING BOX ROUGH IN CAPPED (DOES NOT INCLUDE SWITCH) over the island in the kitchen... see sketch # 1	
Line 73063	Note: This cap will be connected to a sep. switch, switch sold sep.	
10Aug22 / 10Aug22		
Inv.5705	1 - To supply & install AN ADDITIONAL SINGLE POLE SWITCH connected to the upgraded capped elec. over the island in the kitchen.	
Line 73064	Note:	
10Aug22 / 10Aug22		

KINGSMEN (THAMES) INC. / Havelock Corners (Kingsmen)

Lot/Unit: 169 Phase/Building: 5A Model/Floor Plan: John (4201) Elev B 4 Bed - 2+1 Bath

Inv.5705	1 - To SUPPLY AND INSTALL AN ADDITIONAL BASIC RECEPTACLE (DEDICATED CIRCUIT AND INCLUDES ARC FAULT BREAKER) for the upgraded microwave shelf in the kitchen...	
Line 73068	Note: See sketch # 1	
10Aug22 / 10Aug22		

HEATING AND AIR CONDITIONING

Inv.5705	1 - As per schedule "PE": Vendor to install capped gas line (rough in only) at rear of home for future BBQ location. Location to be finalized at vendors sole discretion.	
Line 73051	Note:	
10Aug22 / 10Aug22		

Inv.5705	1 - As per schedule "PE": Vendor to supply & install air conditioning unit, sized accordingly, from vendors standard samples.	
Line 73052	Note:	
10Aug22 / 10Aug22		

MISCELLANEOUS

PLUMBING

Inv.5705	1 - To supply & install a WATERLINE ROUGH-IN TO THE FRIDGE LOCATION (NO HOOK UP) in the kitchen...	
Line 73062	Note:	
10Aug22 / 10Aug22		

Inv.5705	5 - To supply & install the VANITY SINK - CONTRAC CATENA UNDERMOUNT - MODEL 4210CIY? in the powder room, master ensuite and main bathroom in lieu of the standard top mount sinks...see spec's	
Line 73072	Note:	
10Aug22 / 10Aug22		

Inv.5705	1 - To supply & install the KITCHEN SOAP Dispencer - MOEN CHROME - MODEL 3942 in the kitchen.. see spec's... see sketch # 1 for installation location.	
Line 73073	Note:	
10Aug22 / 10Aug22		

RAILING

Inv.5705	1 - To supply & install the RAILING - UPGRADE 1 - METAL HANDRAIL 3 INCH OVAL IN OAK - PICKETS STEEL ½ INCH SQUARE, PLAIN, WITH SHOES IN FLAT BLACK - POSTS 3½ INCH SQUARE, WITH CAP OAK IN OAK in lieu of the standard pickets and rails.	
Line 73075	Note:	
10Aug22 / 10Aug22		

TILE - FLOOR

Inv.5705	1 - To supply & install the UPGRADE 4 - FLOOR TILE - STACKED - FOYER TILE in lieu of the standard floor tiles... see colour chart for details.	
Line 73076	Note:	
10Aug22 / 10Aug22		

KINGSMEN (THAMES) INC. / Havelock Corners (Kingsmen)

Lot/Unit: 169 Phase/Building: 5A Model/Floor Plan: John (4201) Elev B 4 Bed - 2+1 Bath

Inv.5705	1 - To supply & install the UPGRADE 4 - FLOOR TILE - STACKED - POWDER ROOM TILE in lieu of the standard floor tiles... see colour chart for details.	
Line 73077	Note:	
10Aug22 / 10Aug22		
Inv.5705	1 - To supply & install the UPGRADE 4 - FLOOR TILE - STACKED - MUD ROOM TILE in lieu of the standard floor tiles... see colour chart for details.	
Line 73078	Note:	
10Aug22 / 10Aug22		
Inv.5705	1 - To supply & install the UPGRADE 4 - FLOOR TILE - STACKED - KITCHEN/BREAKFAST TILE in lieu of the standard floor tiles... see colour chart for details.	
Line 73079	Note:	
10Aug22 / 10Aug22		

EXTRAS AS PER OFFER

PURCHASER ACKNOWLEDGES THAT GRADING PLANS HAVE NOT BEEN FINALIZED AND AS SUCH INFORMATION ON DECK AND WALK OUT CONDITIONS ARE NOT YET AVAILABLE. GRADING IS SUBJECT TO THE TERMS AND CONDITIONS CAPTIONED IN THE AGREEMENT OF PURCHASE AND SALE HEREIN. <i>Worksheet</i> Note:	
5 FREE APPLIANCES ? STAINLESS STEEL FRONT - FRIDGE: STOVE AND DISHWASHER. WHITE WASHER AND DRYER (SUPPLIED ONLY, NOT INSTALLED, FROM BUILDERS STANDARD LINE). AN APPLIANCES VOUCHER WILL BE GIVEN BY OUR DECOR CONSULTANT AT THE TIME OF BOOKING YOUR COLOUR A <i>Worksheet</i> Note:	
5 FREE APPLIANCES – STAINLESS STEEL FRONT - FRIDGE: STOVE AND DISHWASHER. WHITE WASHER AND DRYER (SUPPLIED ONLY, NOT INSTALLED, FROM BUILDERS STANDARD LINE). AN APPLIANCES VOUCHER WILL BE GIVEN BY OUR DECOR CONSULTANT AT THE TIME OF BOOKING YOUR COLOUR A <i>Worksheet</i> Note:	
VENDOR TO INSTALL CAPPED GAS LINE (ROUGH-IN ONLY) AT REAR OF HOME FOR FUTURE BBQ LOCATION. LOCATION TO BE FINALIZED AT VENDORS SOLE DISCRETION. <i>Worksheet</i> Note:	
VENDOR TO SUPPLY & INSTALL AIR CONDITIONING UNIT, SIZED ACCORDINGLY, FROM VENDORS STANDARD SAMPLES. <i>Worksheet</i> Note:	
VENDOR TO INCLUDE LEVEL 1, 2CM QUARTZ IN ALL BATHROOMS, AS PER PLAN, IN LIEU OF THE INCLUDED LAMINATE COUNTER TOPS. SELECTIONS TO BE MADE FROM BUILDERS STANDARD SAMPLES. <i>Worksheet</i> Note:	

Purchasers: HIMANI SOOD & JAGJEET SINGH

Property: 169 of Plan - Draft Approval SB17-03-08

Telephone Res. / Bus: (647) 297-2273 /

Project: KINGSMEN (THAMES) INC.

Decor Advisor: Barbara Coccia

Model and Elevation: John (4201) Elev B 4 Bed - 2+1 Bath

Layout Changes: ☐ Yes ☒ No

Sketch Attached: ☒ Yes ☐ No

Exterior Colour Scheme:

1. Cabinetry

	Style and Colour	Counter Top	Hardware
Kitchen / Breakfast	#2 Slab LPL Stainless	#1 C/S # 9141 Ice Snow 3cm.	#12881 Handle
Kitchen Island	#2 Slab LPL Stainless	#1 C/S # 9141 Ice Snow 3cm.	#12881 Handle
Laundry Room	/		
Powder Room	#2 Slab LPL Stainless	#1 C/S # 9141 Ice Snow 2cm.	#12881 Handle
Main Bathroom	#3 Simcoe Orchid	#1, C/S # 3040 Cement 2cm.	#12881 Handle
Master Ensuite Bathroom	#3 Simcoe Orchid	#1, C/S # 3040 Cement 2cm.	#12881 Handle
Second Ensuite Bathroom (If Applicable)	/		
	/		
	/		

Appliances

Custom Size Fridge

☐ Yes ☒ No

Valance Lighting

☐ Yes ☒ No

Microwave / Range Hood

☐ Yes ☒ No

Cooktop / Rangetop

☐ Yes ☒ No

Built in Wall Oven

☐ Yes ☒ No

Slide-in Range

☐ Yes ☒ No

Comment

/

2. Flooring

Selection

Foyer	** Upg. 4, 24 x 24" Mayfair Calacatta Oro HD Matte Rect. Porcelain .. STACKED
Main Hall	/
Back Hall	3 1/2" Elements Oak Sturgeon
Breakfast	** Upg. 4, 24 x 24" Mayfair Calacatta Oro HD Matte Rect. Porcelain .. STACKED
Laundry Room	13 x 13" Cinq Grey
Kitchen	** Upg. 4, 24 x 24" Mayfair Calacatta Oro HD Matte Rect. Porcelain .. STACKED
Powder Room	** Upg. 4, 24 x 24" Mayfair Calacatta Oro HD Matte Rect. Porcelain .. STACKED
Main Bathroom	13 x 13" Cinq Grey
Master Ensuite	13 x 13" Cinq Grey
Bathroom (If Applicable)	/
Mud Room	** Upg. 4, 24 x 24" Mayfair Calacatta Oro HD Matte Rect. Porcelain .. STACKED
Master ens. shower floor	2x2" Ontario Snow White Matte
Living Room	/
Dining Room	(formal room) 3 1/2" Elements Oak Sturgeon
Family / Great Room	3 1/2" Elements Oak Sturgeon
Den / Library / Study	/
Basement Landing (If Applies)	
Lower Landing (If Applicable)	3 1/2" Elements Oak Sturgeon
Upper Landing	(if applicable) 3 1/2" Elements Oak Sturgeon
Upper Hall	Modern Story 1, # 966 Spellbound
Master Bedroom	Modern Story 1, # 966 Spellbound
Bedroom #2	Modern Story 1, # 966 Spellbound
Bedroom #3	Modern Story 1, # 966 Spellbound
Bedroom #4	Modern Story 1, # 966 Spellbound
Bedroom #5	/
Master ens. shower jamb	Anatolia Marmiline SNOW

RECEIVED

AUG 11 2022

Flooring Continued on Page 2

Initial:

Page 1 of 3

Purchasers: HIMANI SOOD & JAGJEET SINGH **Property:** 169 of Plan - Draft Approval SB17-03-08
Telephone Res. / Bus: (647) 297-2273 / **Project:** KINGSMEN (THAMES) INC.
Decor Advisor: Barbara Coccia **Model and Elevation:** John (4201) Elev B 4 Bed - 2+1 Bath
2. Flooring - Continued -

Upgrade Underpad	Type Standard	Area 2nd floor BC Master bedroom, bedroom #2, #3 & #4
Carpet on Stairs	Capped	Runner - *Upgrade
Comment	/	/

3. Plumbing Fixtures / Faucets

Kitchen	Standard	Second Ensuite	/	Powder Room	Standard
Master Ensuite	Standard			Other Room	/
Main Bathroom	Standard				

Comment
 Still to install the standard under mount kitchen sink with the standard single hole kitchen faucet, NO PLATE.
 Purchaser has upgraded to under mount sinks in ALL bathroom, still to install the standard lav. faucets.

4. Wall Tile

	Tile Selection	Listello	Insert	Insert Selection
Main Bathroom	8 x10" Cinq Black	<input type="checkbox"/>	<input type="checkbox"/>	
Master Ensuite				
Tub Deck	/	<input type="checkbox"/>	<input type="checkbox"/>	
Tub Apron	/	<input type="checkbox"/>	<input type="checkbox"/>	
Tub Surround	/	<input type="checkbox"/>	<input type="checkbox"/>	
Shower Stall	8 x10" Cinq Black	<input type="checkbox"/>	<input type="checkbox"/>	
Second Ensuite	/	<input type="checkbox"/>	<input type="checkbox"/>	
	/	<input type="checkbox"/>	<input type="checkbox"/>	
	/	<input type="checkbox"/>	<input type="checkbox"/>	
Kitchen Backsplash	/	<input type="checkbox"/>	<input type="checkbox"/>	
Complete Backsplash	/	<input type="checkbox"/>	<input type="checkbox"/>	

Comment
 Install the standard 8x10" wall tiles on the 10" side stacked horizontally in all bathrooms where applicable.

 horizontal stacked

 brick pattern

 vertical stacked

 diagonal diamond

5. Fireplace

	Living Room			Family Room			Other Room - Specify Great Room		
	Purchased	As Per Plan	N/A	Purchased	As Per Plan	N/A	Purchased	As Per Plan	N/A
Fireplace Type	<input type="radio"/>	<input type="radio"/>	<input checked="" type="radio"/>	<input type="radio"/>	<input type="radio"/>	<input checked="" type="radio"/>	<input type="radio"/>	<input checked="" type="radio"/>	<input type="radio"/>
Mantle Type									
Over Mantle									
Colour / Stain									
Surround									
Hearth									
Comment									

RECEIVED
 AUG 11 2022

Front Facing
 NF-08
 /
 White
 /
 /

Purchasers: HIMANI SOOD & JAGJEET SINGH
 Telephone Res. / Bus: (647) 297-2273 /
 Decor Advisor: Barbara Coccia

Property: 169 of Plan - Draft Approval SB17-03-08
 Project: KINGSMEN (THAMES) INC.
 Model and Elevation: John (4201) Elev B 4 Bed - 2+1 Bath

6. Trim Carpentry

Door Hardware Standard handle

Interior Trim Standard

Comment

Interior Doors

☐ 2 Panel Arch Top

☒ 2 Panel Square Top

☐ 6 Panel

Initial for Door Style

7. Railings and Pickets

Railing Package **Upg. # 1 Metal Picket package

Railing Colour Elements Sturgeon

Wood Stairs ☐ No ☒ Oak

Picket Colour BLACK

Tread Colour Elements Sturgeon

Comment

8. Plaster Mouldings and Medallions

Foyer /

Main Hall /

Living Room /

Dining Room /

Family Room /

Kitchen/Breakfast /

Den/Library /

Lower Landing /

Comment

9. Wall Paint

Kingsmen white

Smooth Ceilings

☐ First Floor

☐ First Floor incl. Second Floor Hall

☐ First and Second Floor

☒ Throughout

☐ Not Applicable

Trim Paint Kingsmen white

10. Additional Comments

RECEIVED

AUG 11 2022

11. Disclaimers and Notes

- Colours of all materials are as close as possible to builder's selection, but not necessarily identical due to variances in manufacturing.
- Any extras listed above are null and void unless accompanied by a separate invoice/amendment. Said invoice must be paid in full.
- The Purchaser acknowledges that after Interior Colour Selection form is signed and dated, no further changes will be permitted other than re-selection due to unavailability.  Purchaser's Initials
- The Purchaser acknowledges reading and accepting the "Kingsmen Group Décor Centre Disclaimers" form. This document contains other miscellaneous disclaimers.

This Interior Colour Selection is final and approved by:

Purchaser:

Signature: Himani Sood Date: Aug 10-2022

Signature: [Signature] Date: Aug 10-2022 Vendor:

KINGSMEN (THAMES) INC.

Aug 11/22

SCHEDULE "B-1"
Floor Plan

Lot 169
Phase 5A
Model: John (4201) Elev B 4 Bed - 2+1 Bath
Standard

Sketch #1

Soap Dispenser
capped elec.
on a sep. Switch

Micro. Shelf
w/ Outlet

all 3 items @ 66" up from
floor

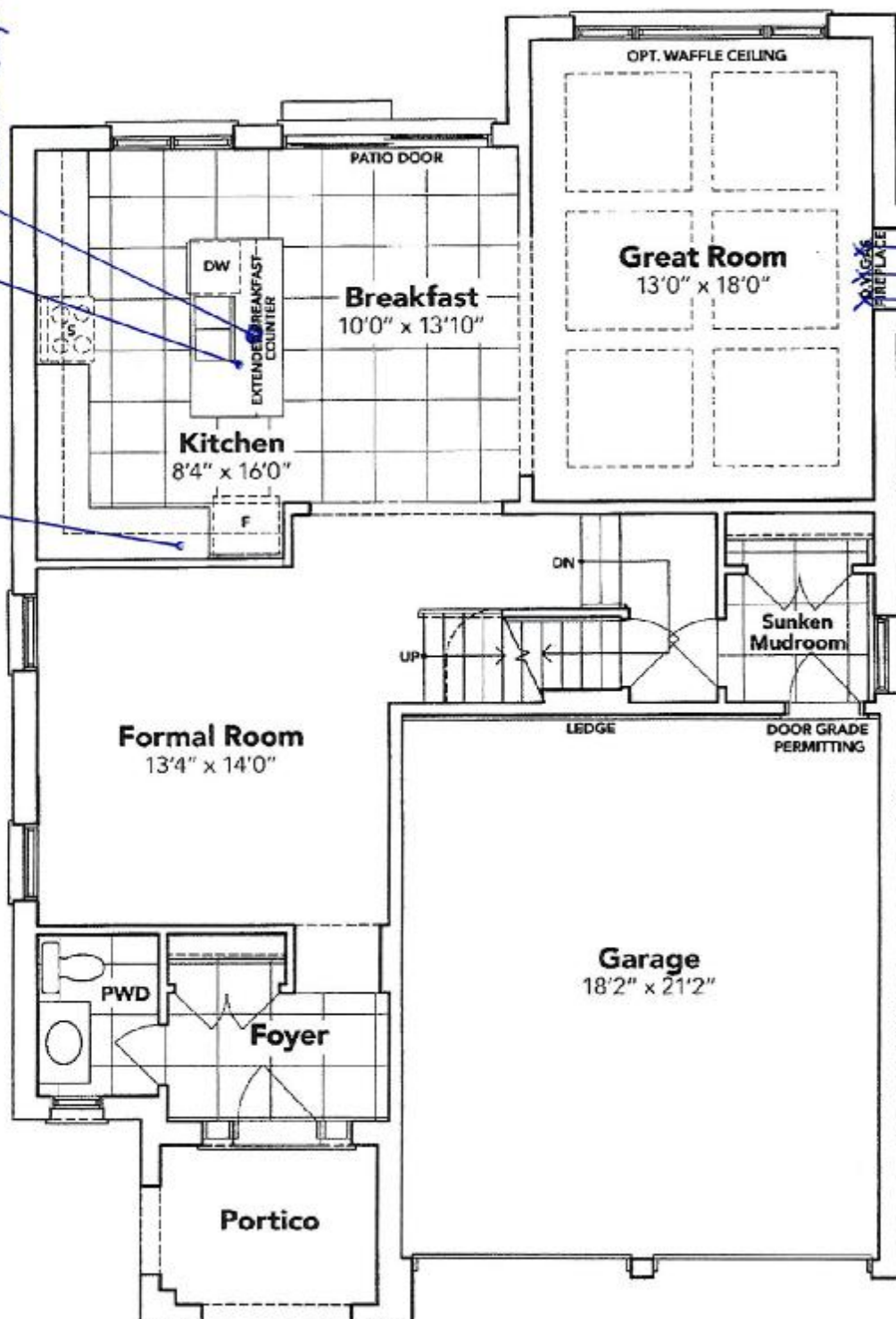

[Signature]

[Signature]

GROUND FLOOR EL. B

The floor plans and elevations shown are pre-construction plans and may be revised or improved as necessitated by architectural controls and the construction process. The measurements adhere to the rules and regulations of the TARION Warranty Corporation's official method for the calculation of floor area. Materials, specifications and floor plans are subject to change without notice. All house renderings are artist's concept only. Actual usable floor space may vary from the stated floor area. All options shown are upgrades. E. & O. E.



SCHEDULE "B-1" Page 3 of 3
Initials: *[Signature]*

SCHEDULE "B-1"
Floor Plan

Lot 169
Phase 5A
Model: John (4201) Elev B 4 Bed - 2+1 Bath
Standard

Sketch #2
BC

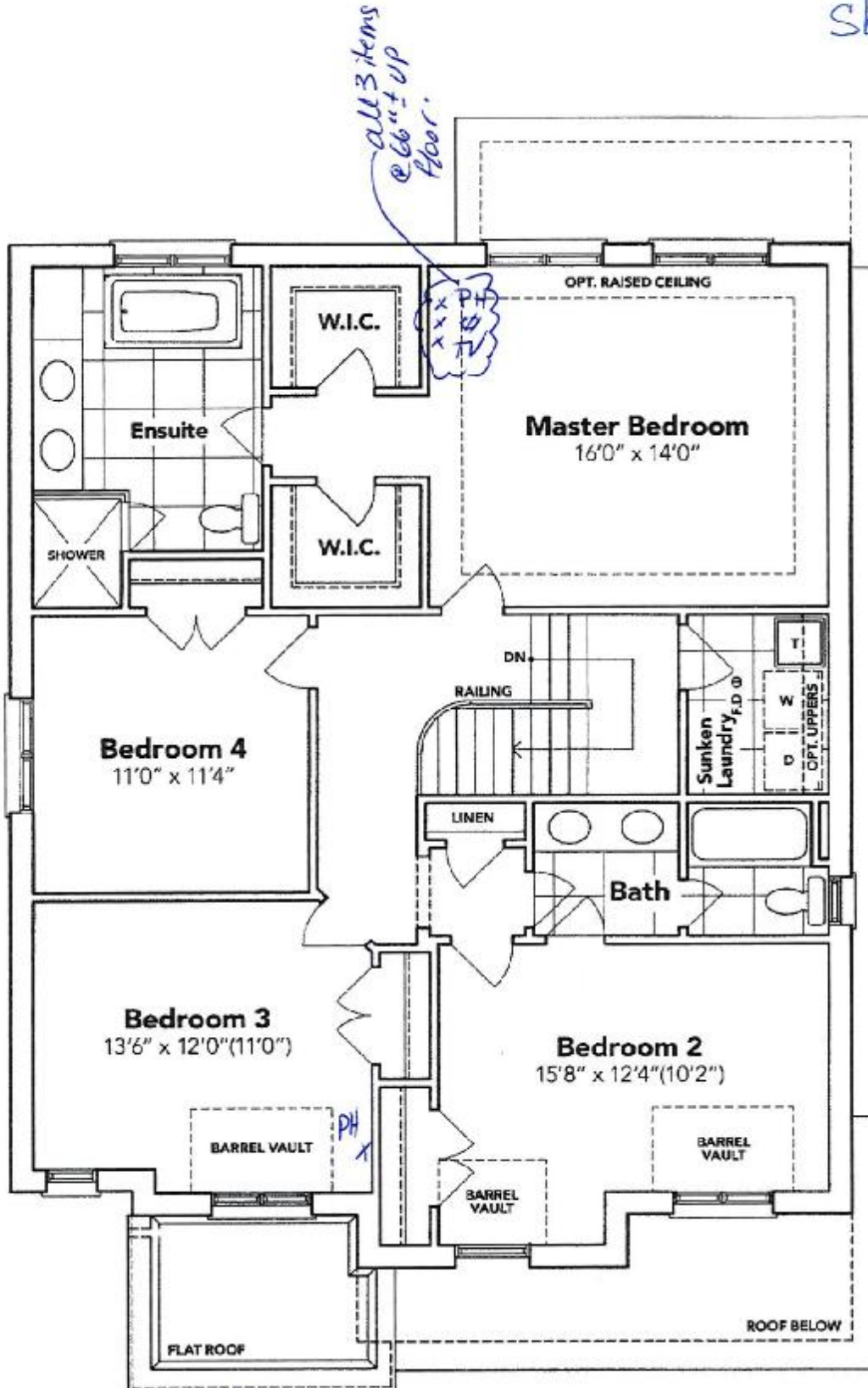

[Handwritten signature]

x Himani Sod

RECEIVED

AUG 11 2022

SECOND FLOOR EL. B

The floor plans and elevations shown are pre-construction plans and may be revised or improved as necessitated by architectural controls and the construction process. The measurements adhere to the rules and regulations of the TARIION Warranty Corporation's official method for the calculation of floor area. Materials, specifications and floor plans are subject to change without notice. All house renderings are artist's concept only. Actual usable floor space may vary from the stated floor area. All options shown are upgrades. E. & O. E.

SCHEDULE "B-1" - Page 2 of 3

Initials

SCHEDULE "B-1"
Floor Plan

Lot 169
Phase 5A
Model: John (4201) Elev B 4 Bed - 2+1 Bath
Standard

Sketch #3
BC

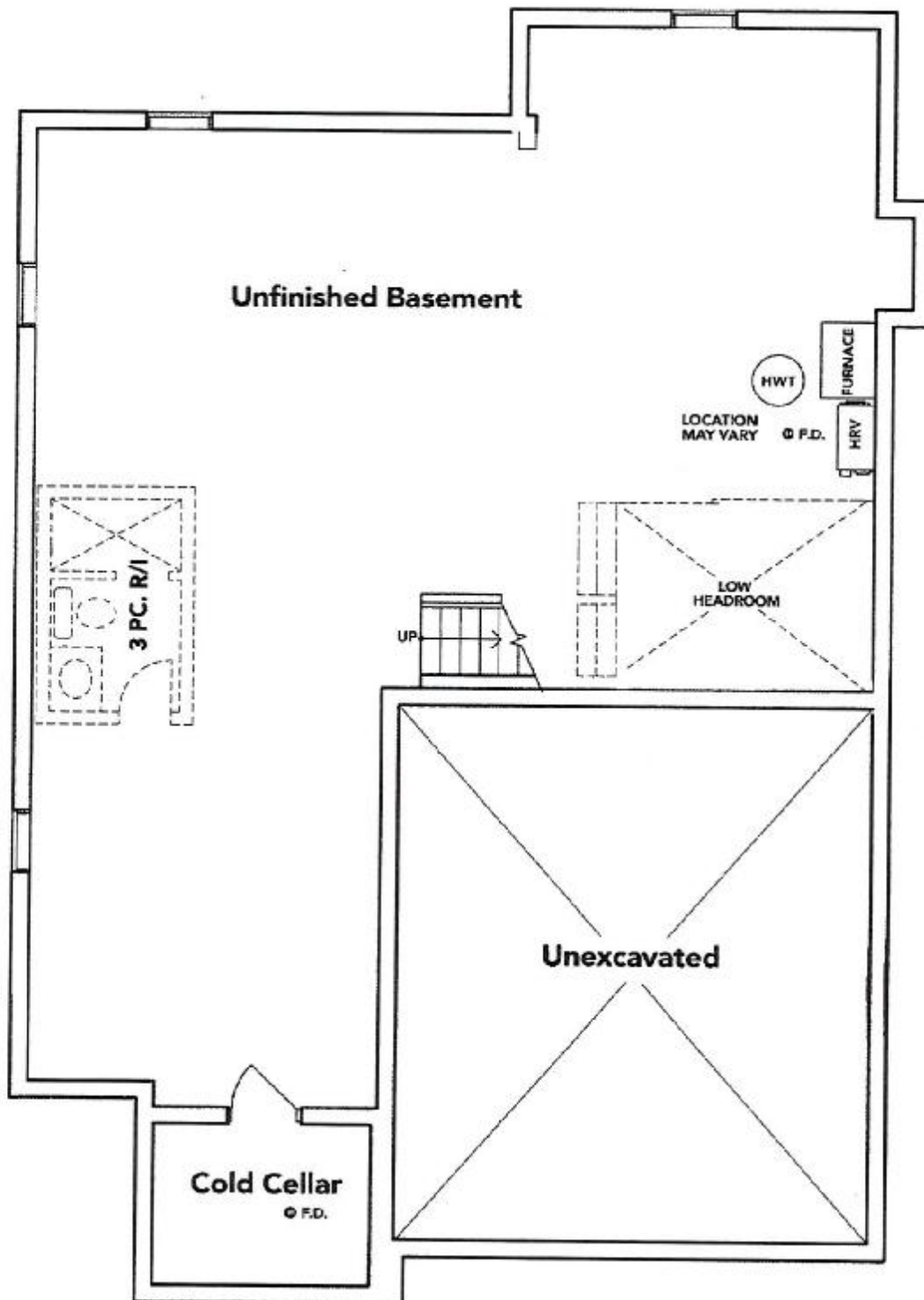

[Signature]

[Signature]

BASEMENT EL. B



The floor plans and elevations shown are pre-construction plans and may be revised or improved as necessitated by architectural controls and the construction process. The measurements adhere to the rules and regulations of the TARION Warranty Corporation's official method for the calculation of floor area. Materials, specifications and floor plans are subject to change without notice. All house renderings are artist's concept only. Actual usable floor space may vary from the stated floor area. All options shown are upgrades. E. & O. E.

SCHEDULE "B-1" *Page 1 of 3*

LOT 169 THAMES PH. 5 A
RE: UPGRADED UNDERMOUNT VANITY
SINKS IN ALL BATHROOMS

CATENA
RECTANGULAR UNDERMOUNT SINK

4210CIV Undermount Sink

PRODUCT SPECS:

- Vitreous china
- Front overflow hole
- Toilets and mounting hardware supplied

DIMENSIONS:

Outer:

510mm W x 390mm D x 190mm H
20" W x 15 1/2" D x 7 1/2" H

Inner:

458mm W x 340mm D x 140mm H
18" W x 13 3/4" D x 5 1/2" H

COMPLIANCE CERTIFICATIONS

Meets or exceeds the following:

- IAPMO CUPC
- ASME A112.19.2 / CSA B45.1
- OBC Section 3.8 Barrier Free design and CSA B551 Standard

SHIPPING

Cube 1.72
GW 27 lbs

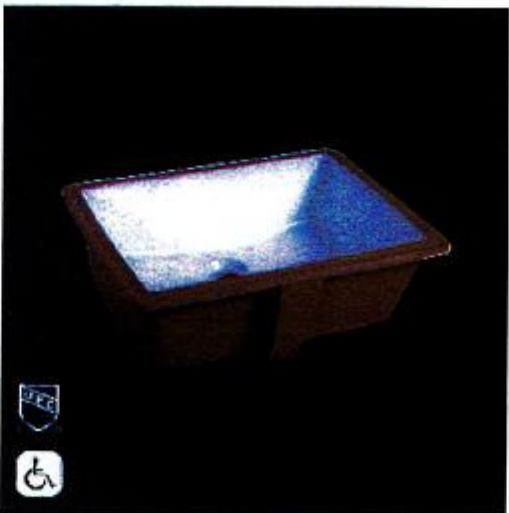
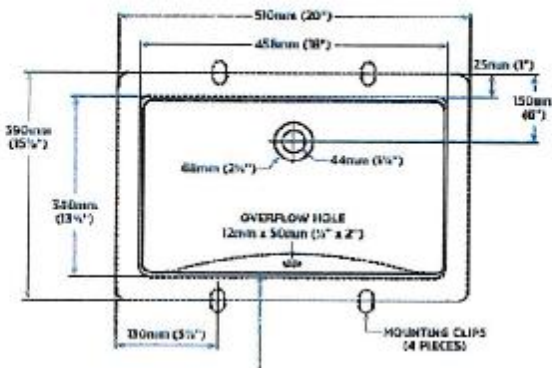

TO BE SPECIFIED

- CCU-1
- 5011 17" 10

NOTES: DIMENSIONS OF FIXTURES ARE NOMINAL AND MAY VARY WITHIN THE RANGE OF TOLERANCES ESTABLISHED BY ASTM STANDARD A112.19.2. THESE REQUIREMENTS ARE SUBJECT TO CHANGE OR CANCELLATION. NO RESPONSIBILITY IS ASSUMED FOR USE OF SUPPLEMENTAL OR MODIFIED EDGES. PRODUCTS ARE DESIGNED TO COMPLY WITH CANADA'S ACCESSIBLE AND OBC SECTION 3.8 BARRIER FREE DESIGN. IT SHALL BE THE RESPONSIBILITY OF THE INSTALLER TO COMPLY WITH THE LOCAL BUILDING CODES AND STANDARDS PRIOR TO INSTALLING THE PRODUCT.

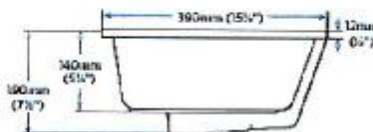

[Handwritten signature]

A Himani Jood



LOT 169 THAMES PH. 5 A
RE: SOAP DISPENSER IN KITCHEN

Soap or Lotion Dispensers

Traditional Transitional Modern

However you define your kitchen's style,
you can assure a coordinated look with Misco soap dispensers.

KITCHEN



Transitional Soap or
Lotion Dispenser

Model 3942

a [Signature]

a Himani Swet