

KINGSMEN (THAMES) INC. / Havelock Corners (Kingsmen)

Lot/Unit: 79 Phase/Building: 5A Model/Floor Plan: James (3601) Elev A 4 Bed - 2+1 Bath

COUNTER TOP

Inv.5797	1 - As per schedule "PE": Vendor to include level 1, 2cm. quartz in all bathrooms, as per plan, in lieu of the included laminate countertops. Selections to be made from builders standard samples.	
Line 73887	Note:	
6Sep22 / 6Sep22		

ELECTRICAL

Inv.5797	1 - To supply & install the standard T.V. rough in in the great room and master bedroom... see sketch # 1 & # 2	
Line 73888	Note:	
6Sep22 / 6Sep22		
Inv.5797	1 - To supply & install the standard Phone (CAT 5) rough in in the great room, master bedroom & bedroom # 2 ... see sketch # 1 & # 2	
Line 73889	Note:	
6Sep22 / 6Sep22		

HEATING AND AIR CONDITIONING

Inv.5797	1 - As per schedule "PE": Vendor to install capped gas line (rough in only) at rear of home for future BBQ location. Location to be finalized at vendors sole discretion.	
Line 73885	Note:	
6Sep22 / 6Sep22		
Inv.5797	1 - As per schedule "PE": Vendor to supply & install air conitioning unit, sized accordingly, from vendors standard samples.	
Line 73886	Note:	
6Sep22 / 6Sep22		

EXTRAS AS PER OFFER

5 FREE APPLIANCES – STAINLESS STEEL FRONT - FRIDGE; STOVE AND DISHWASHER. WHITE WASHER AND DRYER (SUPPLIED ONLY, NOT INSTALLED, FROM BUILDERS STANDARD LINE). AN APPLIANCES VOUCHER WILL BE GIVEN BY OUR DECOR CONSULTANT AT THE TIME OF BOOKING YOUR COLOUR A Worksheet Note:	
VENDOR TO INSTALL CAPPED GAS LINE (ROUGH-IN ONLY) AT REAR OF HOME FOR FUTURE BBQ LOCATION. LOCATION TO BE FINALIZED AT VENDORS SOLE DISCRETION. Worksheet Note:	
VENDOR TO SUPPLY & INSTALL AIR CONDITIONING UNIT, SIZED ACCORDINGLY, FROM VENDORS STANDARD SAMPLES. Worksheet Note:	
VENDOR TO INCLUDE LEVEL 1, 2CM QUARTZ IN ALL BATHROOMS, AS PER PLAN, IN LIEU OF THE INCLUDED LAMINATE COUNTER TOPS. SELECTIONS TO BE MADE FROM BUILDERS STANDARD SAMPLES. Worksheet Note:	

Purchasers: RANDEEP SINGH & Harleen Kaur Bajwa

Telephone Res. / Bus: /

Decor Advisor: Barbara Coccia

Layout Changes: ☐ Yes ☒ No

Property: 79 of Plan - Draft Approval SB17-03-08

Project: KINGSMEN (THAMES) INC.

Model and Elevation: James (3601) Elev A 4 Bed - 2+1 Bath

Sketch Attached: ☒ Yes ☐ No

Exterior Colour Scheme:

1. Cabinetry

	Style and Colour	Counter Top	Hardware
Kitchen / Breakfast	#3 Charleston 3DL Moonlight	#1, C/S # 9141 Ice Snow 3cm.	#12881 Handle
Kitchen Island	#3 Charleston 3DL Moonlight	#1, C/S # 9141 Ice Snow 3cm.	#12881 Handle
Laundry Room	/		
Powder Room	#3 Charleston 3DL Moonlight	#1, C/S # 9141 Ice Snow 2cm.	#12881 Handle
Main Bathroom	#3 Charleston 3DL Moonlight	#1, C/S # 9141 Ice Snow 2cm.	#12881 Handle
Master Ensuite Bathroom	#3 Charleston 3DL Moonlight	#1, C/S # 9141 Ice Snow 2cm.	#12881 Handle
Second Ensuite Bathroom (If Applicable)	/		
	/		
	/		

Appliances

Custom Size Fridge
☐ Yes ☒ No

Cooktop / Rangetop
☐ Yes ☒ No

Valance Lighting

☐ Yes ☒ No

Built in Wall Oven
☐ Yes ☒ No

Microwave / Range Hood

☐ Yes ☒ No

Slide-in Range
☐ Yes ☒ No

Comment

/

2. Flooring

	Selection
Foyer	13 x 13" Malena Ice
Main Hall	13 x 13" Malena Ice
Back Hall	/
Breakfast	13 x 13" Malena Ice
Laundry Room	13 x 13" Malena Ice
Kitchen	13 x 13" Malena Ice
Powder Room	13 x 13" Malena Ice
Main Bathroom	13 x 13" Malena Ice
Master Ensuite	13 x 13" Malena Ice
Bathroom (If Applicable)	/
Mud Room	13 x 13" Malena Ice
Master ens. shower floor	2x2" Ontario Snow White Matte
Living Room	/
Dining Room	/
Family / Great Room	3 1/2" Elements oak Natural
Den / Library / Study	/
Basement Landing (If Applies)	
Lower Landing (If Applicable)	3 1/2" Elements oak Natural
Upper Landing	(if applicable) 3 1/2" Elements oak Natural
Upper Hall	Modern Story 1, # 945 Felt Hat
Master Bedroom	Modern Story 1, # 945 Felt Hat
Bedroom #2	Modern Story 1, # 945 Felt Hat
Bedroom #3	Modern Story 1, # 945 Felt Hat
Bedroom #4	Modern Story 1, # 945 Felt Hat
Bedroom #5	/
Master ens. shower jamb	Anatolia Marmilline SNOW



SEE ATTACHED FOR SIGNATURES

Purchasers: RANDEEP SINGH & Harleen Kaur Bajwa Property: 79 of Plan - Draft Approval SB17-03-08
Telephone Res. / Bus: / Project: KINGSMEN (THAMES) INC.
Decor Advisor: Barbara Coccia Model and Elevation: James (3601) Elev A 4 Bed - 2+1 Bath
2. Flooring - Continued -

Upgrade Underpad	Type	Area
	Standard	2nd. Floor
Carpet on Stairs	Capped	Runner - *Upgrade
Comment	/	/

3. Plumbing Fixtures / Faucets

Kitchen	Standard	Second Ensuite	/	Powder Room	Standard
Master Ensuite	Standard			Other Room	/
Main Bathroom	Standard		/		
Comment	Still to the standard top mount kitchen and vanity sinks.				

4. Wall Tile

	Tile Selection	Listello	Insert	Insert Selection
Main Bathroom	8x10" Malena Carbon	<input type="checkbox"/>	<input type="checkbox"/>	
Master Ensuite				
Tub Deck	13 x 13" Malena Ice	<input type="checkbox"/>	<input type="checkbox"/>	
Tub Apron	13 x 13" Malena Ice	<input type="checkbox"/>	<input type="checkbox"/>	
Tub Surround	13 x 13" Malena Ice	<input type="checkbox"/>	<input type="checkbox"/>	
Shower Stall	8x10" Malena Carbon	<input type="checkbox"/>	<input type="checkbox"/>	
Second Ensuite	/	<input type="checkbox"/>	<input type="checkbox"/>	
	/	<input type="checkbox"/>	<input type="checkbox"/>	
	/	<input type="checkbox"/>	<input type="checkbox"/>	
Kitchen Backsplash	/	<input type="checkbox"/>	<input type="checkbox"/>	
Complete Backsplash	/	<input type="checkbox"/>	<input type="checkbox"/>	

Comment
Install the standard 8x10" wall tiles on the 10" side stacked horizontally in the bathrooms where applicable.

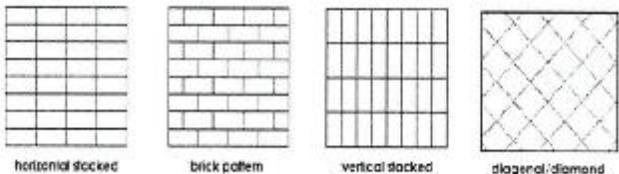

5. Fireplace

	Living Room			Family Room			Other Room - Specify Great room		
	Purchased	As Per Plan	N/A	Purchased	As Per Plan	N/A	Purchased	As Per Plan	N/A
Fireplace Type	<input type="radio"/>	<input type="radio"/>	<input checked="" type="radio"/>	<input type="radio"/>	<input type="radio"/>	<input checked="" type="radio"/>	<input type="radio"/>	<input checked="" type="radio"/>	<input type="radio"/>
Mantle Type									
Over Mantle									
Colour / Stain									
Surround									
Hearth									
Comment	/								



SEE ATTACHED FOR SIGNATURES

Initial:

PS

Purchasers: RANDEEP SINGH & Harleen Kaur Bajwa

Property: 79 of Plan - Draft Approval SB17-03-08

Telephone Res. / Bus: /

Project: KINGSMEN (THAMES) INC.

Decor Advisor: Barbara Coccia

Model and Elevation: James (3601) Elev A 4 Bed - 2+1 Bath

6. Trim Carpentry

Door Hardware Standard handle

Interior Trim Standard

Comment

/

Interior Doors

☐ 2 Panel Arch Top

☒ 2 Panel Square Top

☐ 6 Panel



Initial for Door Style

RS

7. Railings and Pickets

Railing Package Standard Oak STRAIGHT picket Package

Railing Colour Elements Natural

Picket Colour Elements Natural

Wood Stairs ☐ No ☒ Oak

Tread Colour Elements Natural

Comment

/

SEE ATTACHED FOR SIGNATURES

8. Plaster Mouldings and Medallions

Foyer /

Kitchen/Breakfast /

Main Hall /

Den/Library /

Living Room /

Lower Landing /

Dining Room /

Family Room /

Comment

/

9. Wall Paint

Kingsmen White

Smooth Ceilings ☐ First Floor

☐ First Floor incl. Second Floor Hall

☐ First and Second Floor

☒ Throughout

☐ Not Applicable

Trim Paint Kingsmen White

10. Additional Comments

/

RECEIVED

SEP 09 2022

11. Disclaimers and Notes

1) Colours of all materials are as close as possible to builder's selection, but not necessarily identical due to variances in manufacturing.

2) Any extras listed above are null and void unless accompanied by a separate invoice/amendment. Said invoice must be paid in full.

3) The Purchaser acknowledges that after Interior Colour Selection form is signed and dated, no further changes will be permitted other than re-selection due to unavailability. RS Purchaser's Initials

4) The Purchaser acknowledges reading and accepting the "Kingsmen Group Décor Centre Disclaimers" form. This document contains other miscellaneous disclaimers.

This Interior Colour Selection is final and approved by:

Purchaser:

Signature:

Date:

06/09/2022

Signature:

SEE ATTACHED FOR SIGNATURES

Date:

Vendor:

KINGSMEN (THAMES) INC.

Sept 12/22

SCHEDULE "B-1"
Floor Plan

Lot 79
Phase 5A
Model: James (3601) Elev A 4 Bed - 2+1 Bath
Standard

Sketch #1

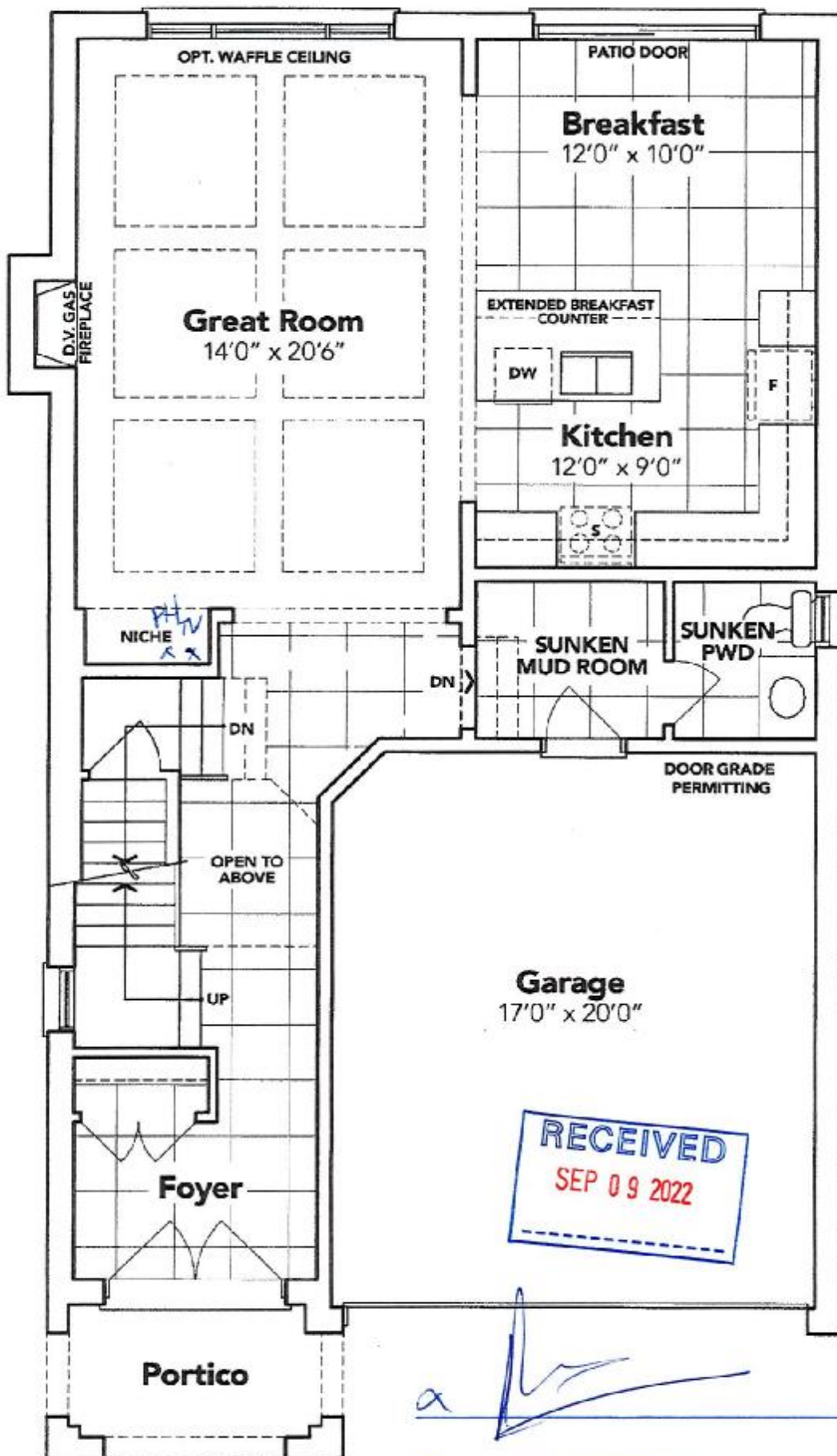

SEE ATTACHED FOR SIGNATURES

GROUND FLOOR EL. A

The floor plans and elevations shown are pre-construction plans and may be revised or improved as necessitated by architectural controls and the construction process. The measurements adhere to the rules and regulations of the TARIION Warranty Corporation's official method for the calculation of floor area. Materials, specifications and floor plans are subject to change without notice. All house renderings are artist's concept only. Actual usable floor space may vary from the stated floor area. All options shown are upgrades. E. & O. E.

SCHEDULE "B-1"
Floor Plan

Lot 79
Phase 5A
Model: James (3801) Elev A 4 Bed - 2+1 Bath
Standard

Sketch #2

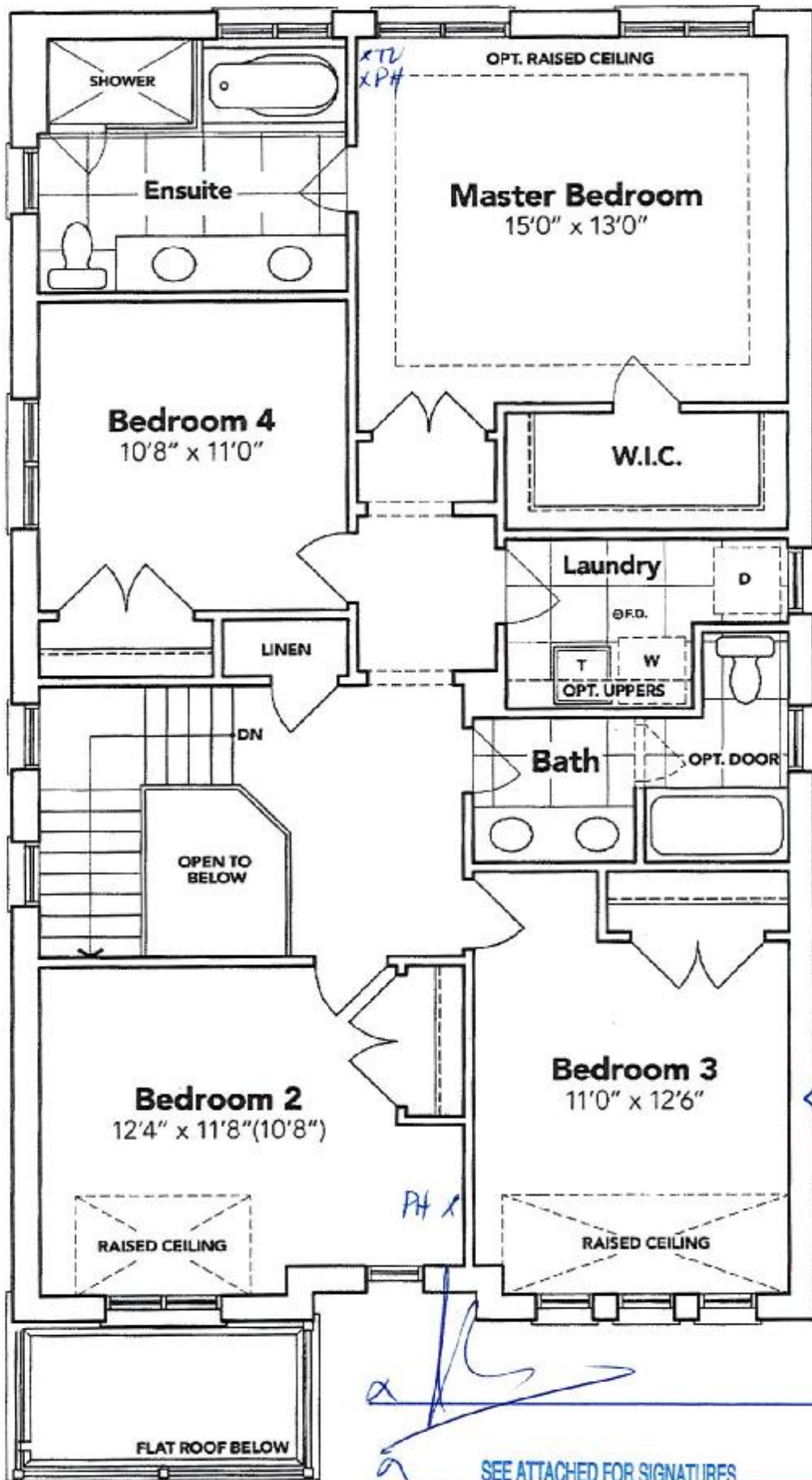

SEE ATTACHED FOR SIGNATURES

SECOND FLOOR EL. A

The floor plans and elevations shown are pre-construction plans and may be revised or improved as necessitated by architectural controls and the construction process. The measurements adhere to the rules and regulations of the TARIION Warranty Corporation's official method for the calculation of floor area. Materials, specifications and floor plans are subject to change without notice. All house renderings are artist's concept only. Actual usable floor space may vary from the stated floor area. All options shown are upgrades. E. & O. E.

SCHEDULE "B-1"
Floor Plan

Lot 79
Phase 5A
Model: James (3601) Elev A 4 Bed - 2+1 Bath
Standard

Sketch #1

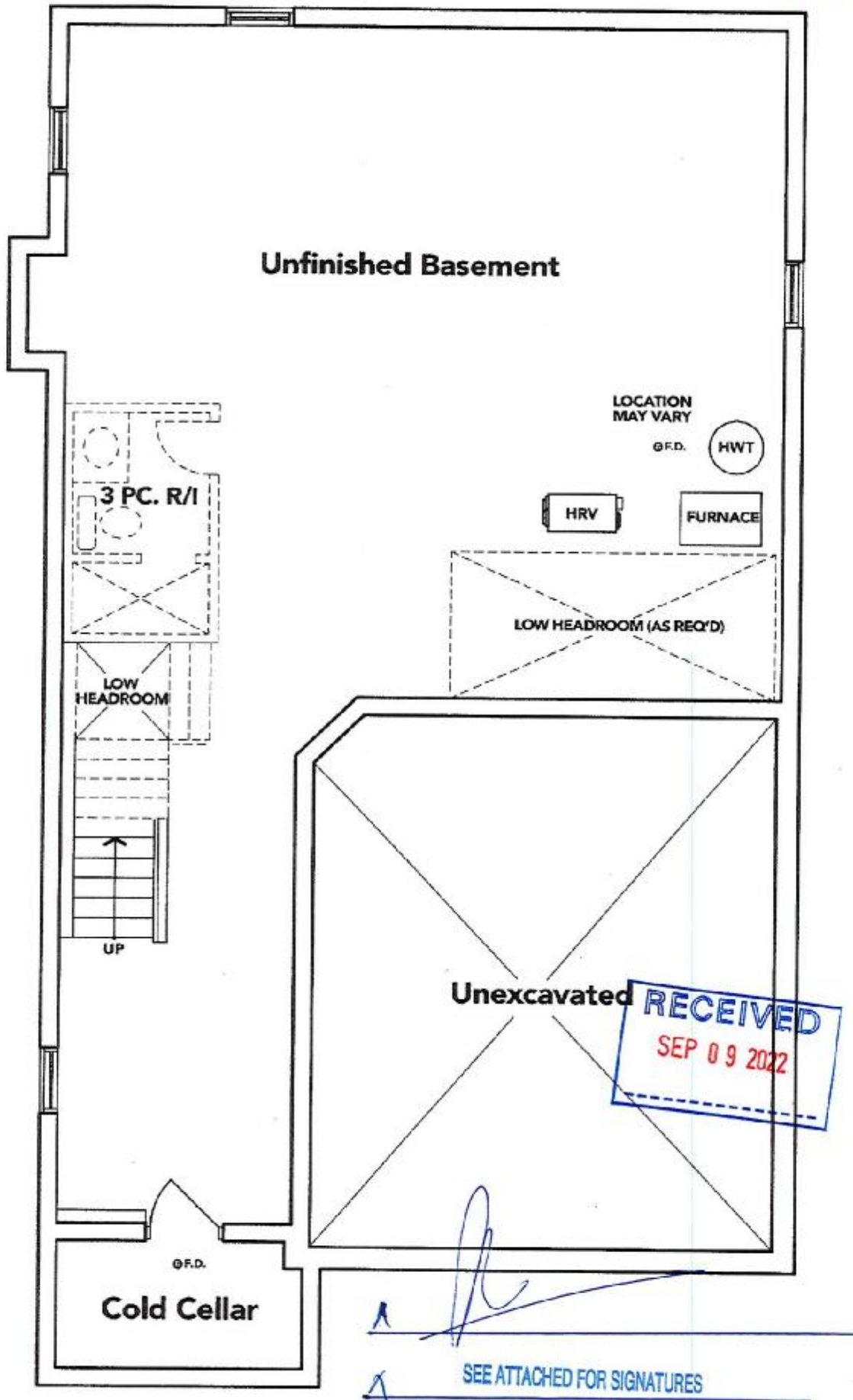

BASEMENT EL. A

The floor plans and elevations shown are pre-construction plans and may be revised or improved as necessitated by architectural controls and the construction process. The measurements adhere to the rules and regulations of the TARIION Warranty Corporation's official method for the calculation of floor area. Materials, specifications and floor plans are subject to change without notice. All house renderings are artist's concept only. Actual usable floor space may vary from the stated floor area. All options shown are upgrades. E. & O. E.