



CONSTRUCTION SUMMARY

KINGSMEN (THAMES) INC. / Havelock Corners (Kingsmen)

Lot/Unit: 119 Phase/Building: 5A Model/Floor Plan: James (3601) Elev B 4 Bed - 2+1 Bath

CABINETRY VANITY

Inv.5893	1 - To supply & install a VANITY BANK OF DRAWERS in the master ensuite... see sketch # 2	
Line 74837	Note:	
4Oct22 / 4Oct22		
Inv.5893	1 - To supply & install a VANITY BANK OF DRAWERS in the main bathroom... see sketch # 2	
Line 74838	Note:	
4Oct22 / 4Oct22		

COUNTER TOP

Inv.5893	1 - As per schedule "PE": Vendor to include level 1, 2cm. quartz in all bathrooms, as per plan, in lieu of the inlcuded laminate countertops Selections to be made from builders standard samples.	
Line 74820	Note:	
4Oct22 / 4Oct22		

ELECTRICAL

Inv.5893	1 - To supply & install the standard T.V. rough in in the great room and master bedroom... see sketch # 1 & # 2	
Line 74821	Note: Install the standard T.V. rough in at approx. 66" + - up from the floor centered + - to the F/p mantle.	
4Oct22 / 4Oct22		
Inv.5893	1 - To supply & install the standard Phone (CAT 5) rough in in the great room, master bedroom & bedroom # 2... see sketch # 1 & # 2	
Line 74822	Note: Install the standard Phone (CAT 5) rough in at approx. 66" + - up from the floor centered + - to the F/p mantle.	
4Oct22 / 4Oct22		
Inv.5893	1 - To SUPPLY AND INSTALL AN ADDITIONAL BASIC RECEPTACLE (NOT DEDICATED) at approx. 66" + - up from the floor centered + - to the F/P	
Line 74836	Note: mantle in the great room...see sketch # 1	
4Oct22 / 4Oct22		

HEATING AND AIR CONDITIONING

Inv.5893	1 - As per schedule "PE": Vendor to install capped gas line (rough in only) at rear of home for future BBQ location. Location to be finalized at vendors sole discretion.	
Line 74817	Note:	
4Oct22 / 4Oct22		
Inv.5893	1 - As per schedule "PE": Vendor to supply & install air conditioning unit, sized accordingly, from vendors standard samples.	
Line 74818	Note:	
4Oct22 / 4Oct22		
Inv.5893	1 - As per schedule "PE" Vendor to install gas line (rough in only) to kitchen in at stove location (as per plan) to include 110V code requirement.	
Line 74819	Note:	
4Oct22 / 4Oct22		

MISCELLANEOUS

PLUMBING

KINGSMEN (THAMES) INC. / Havelock Corners (Kingsmen)

Lot/Unit: 119 Phase/Building: 5A Model/Floor Plan: James (3601) Elev B 4 Bed - 2+1 Bath

Inv.5893	1 - To supply & install the KITCHEN SINK - BLANCO QUATRUS U2 DBL UNDERMOUNT - MODEL 401247 in lieu of the standard top mount sink in the kitchen... see spec's	
Line 74839	Note: Still to install the standard single hole kitchen faucet...NO PLATE.	
4Oct22 / 4Oct22		
Inv.5893	5 - To supply & install the VANITY SINK - CONTRAC CATENA UNDERMOUNT - MODEL 4210CIY in the powder room, master ensuite and main bathroom in lieu of the standard top mount sinks... see spec's	
Line 74840	Note: Still to install the standard lav. faucets.	
4Oct22 / 4Oct22		

EXTRAS AS PER OFFER

5 FREE APPLIANCES – STAINLESS STEEL FRONT - FRIDGE: STOVE AND DISHWASHER. WHITE WASHER AND DRYER (SUPPLIED ONLY, NOT INSTALLED, FROM BUILDERS STANDARD LINE). AN APPLIANCES VOUCHER WILL BE GIVEN BY OUR DECOR CONSULTANT AT THE TIME OF BOOKING YOUR COLOUR A <i>Worksheet</i> Note:	
VENDOR TO INSTALL CAPPED GAS LINE (ROUGH-IN ONLY) AT REAR OF HOME FOR FUTURE BBQ LOCATION. LOCATION TO BE FINALIZED AT VENDORS SOLE DISCRETION. <i>Worksheet</i> Note:	
VENDOR TO SUPPLY & INSTALL AIR CONDITIONING UNIT, SIZED ACCORDINGLY, FROM VENDORS STANDARD SAMPLES. <i>Worksheet</i> Note:	
VENDOR TO INCLUDE LEVEL 1, 2CM QUARTZ IN ALL BATHROOMS, AS PER PLAN, IN LIEU OF THE INCLUDED LAMINATE COUNTER TOPS. SELECTIONS TO BE MADE FROM BUILDERS STANDARD SAMPLES. <i>Worksheet</i> Note:	
VENDOR TO INSTALL GAS LINE (ROUGH-IN ONLY) TO KITCHEN IN AT STOVE LOCATION (AS PER PLAN) TO INCLUDE 110V CODE REQUIREMENT. <i>Worksheet</i> Note:	
VENDOR AGREES TO INCREASE THE SIZE OF THE FRONT DOOR TO 42 INCHES WIDE DOOR, WHICH WILL HAVE NO SIDE LIGHTS OR TRANSOM, AND THE DOOR WILL NOT HAVE A GLASS INSERT <i>Worksheet</i> Note:	

Purchaser: NISHAN SINGH BRAR

Property: 119 of Plan - Draft Approval SB17-03-08

Telephone Res. / Bus: /

Project: KINGSMEN (THAMES) INC.

Decor Advisor: Barbara Coccia

Model and Elevation: James (3601) Elev B 4 Bed - 2+1 Bath

Layout Changes: ☐ Yes ☒ No

Sketch Attached: ☒ Yes ☐ No

Exterior Colour Scheme:

1. Cabinetry	Style and Colour	Counter Top	Hardware
Kitchen / Breakfast	#3 Simcoe Orchid	#1, C/S # 3040 Cement 3cm.	#12881 Handle
Kitchen Island	#3 Simcoe Orchid	#1, C/S # 3040 Cement 3cm.	#12881 Handle
Laundry Room	/	/	
Powder Room	#3 Simcoe Orchid	#1, C/S # 3040 Cement 2cm.	#12881 Handle
Main Bathroom	#3 Trinity Viva Weekend Getaway	#1, C/S # 9141 Ice Snow 2cm.	# 9661 Handle
Master Ensuite Bathroom	#3 Simcoe Moonlight	#1, C/S # 9141 Ice Snow 2cm.	# 9661 Handle
Second Ensuite Bathroom (If Applicable)	/		
	/		
	/		

Appliances

Custom Size Fridge
☐ Yes ☒ No

Cooktop / Rangetop
☐ Yes ☒ No

Valance Lighting
☐ Yes ☒ No

Built in Wall Oven
☐ Yes ☒ No

Microwave / Range Hood
☐ Yes ☒ No

Slide-in Range
☐ Yes ☒ No

Comment

/

2. Flooring	Selection
Foyer	13 x13" Malena Ice
Main Hall	13 x13" Malena Ice
Back Hall	/
Breakfast	13 x13" Malena Ice
Laundry Room	13 x13" Cinq Grey
Kitchen	13 x13" Malena Ice
Powder Room	13 x13" Malena Ice
Main Bathroom	13 x13" Cinq Grey
Master Ensuite	13 x13" Keaton Ice
Bathroom (If Applicable)	/
Mud Room	13 x13" Malena Ice
Master ens. shower floor	2x2" Ontario Snow White Matte
Living Room	/
Dining Room	/
Family / Great Room	3 1/2" Elements Oak Natural
Den / Library / Study	/
Basement Landing (If Applies)	
Lower Landing (If Applicable)	3 1/2" Elements Oak Natural
Upper Landing	(If applicable) 3 1/2" Elements Oak Natural
Upper Hall	Modern Story 1, # 927 Morning Rain
Master Bedroom	Modern Story 1, # 927 Morning Rain
Bedroom #2	Modern Story 1, # 927 Morning Rain
Bedroom #3	Modern Story 1, # 927 Morning Rain
Bedroom #4	Modern Story 1, # 927 Morning Rain
Bedroom #5	/
Master ens. shower jamb:	Anatolia Marmiline SNOW

Purchaser: NISHAN SINGH BRAR

Telephone Res. / Bus: /

Decor Advisor: Barbara Coccia

2. Flooring - Continued -

Property: 119 of Plan - Draft Approval SB17-03-08

Project: KINGSMEN (THAMES) INC.

Model and Elevation: James (3601) Elev B 4 Bed - 2+1 Bath

Upgrade Underpad	Type	Area
	Standard	2nd. floor
Carpet on Stairs	Capped	Runner - *Upgrade
Comment	/	/
/		

3. Plumbing Fixtures / Faucets

Kitchen	Standard	Second Ensuite	/	Powder Room	Standard
Master Ensuite	Standard			Other Room	/
Main Bathroom	Standard		/		

Comment

Purchaser has upgraded to an under mount kitchen sink, still to install the standard single hole kitchen faucet NO PLATE.

Purchaser has upgraded to under mount sinks in ALL bathrooms, still to install the standard lav faucets.

4. Wall Tile

	Tile Selection	Listello	Insert	Insert Selection
Main Bathroom	8x10" Cinq Grey	<input type="checkbox"/>	<input type="checkbox"/>	
Master Ensuite				
Tub Deck	13 x13" Keaton Ice	<input type="checkbox"/>	<input type="checkbox"/>	
Tub Apron	13 x13" Keaton Ice	<input type="checkbox"/>	<input type="checkbox"/>	
Tub Surround	13 x13" Keaton Ice	<input type="checkbox"/>		
Shower Stall	8 x 10" Keaton Ice	<input type="checkbox"/>	<input type="checkbox"/>	
Second Ensuite	/	<input type="checkbox"/>	<input type="checkbox"/>	
	/	<input type="checkbox"/>	<input type="checkbox"/>	
	/	<input type="checkbox"/>	<input type="checkbox"/>	
Kitchen Backsplash	/	<input type="checkbox"/>	<input type="checkbox"/>	
Complete Backsplash	/	<input type="checkbox"/>	<input type="checkbox"/>	

Comment

/

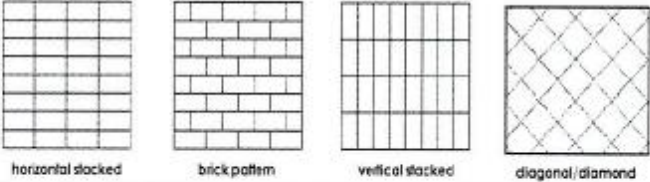

5. Fireplace

	Living Room			Family Room			Other Room - Specify Great room		
	Purchased	As Per Plan	N/A	Purchased	As Per Plan	N/A	Purchased	As Per Plan	N/A
Fireplace Type	<input type="radio"/>	<input type="radio"/>	<input checked="" type="radio"/>	<input type="radio"/>	<input type="radio"/>	<input checked="" type="radio"/>	<input type="radio"/>	<input checked="" type="radio"/>	<input type="radio"/>
Mantle Type							Front Facing		
Over Mantle							NF-08		
Colour / Stain							/		
Surround							White		
Hearth							/		
Comment	/								

MB

Purchaser: NISHAN SINGH BRAR

Telephone Res. / Bus: /

Decor Advisor: Barbara Coccia

Property: 119 of Plan - Draft Approval SB17-03-08

Project: KINGSMEN (THAMES) INC.

Model and Elevation: James (3601) Elev B 4 Bed - 2+1 Bath

6. Trim Carpentry

Door Hardware Standard Handle

Interior Trim Standard

Comment /

Interior Doors

☐ 2 Panel Arch Top

☒ 2 Panel Square Top

☐ 6 Panel

Initial for Door Style 

7. Railings and Pickets

Railing Package Standard oak TURNED picket package

Railing Colour Elements Natural

Wood Stairs ☐ No ☒ Oak

Comment /

Picket Colour Elements Natural

Tread Colour Elements Natural

8. Plaster Mouldings and Medallions

Foyer	/	Kitchen/Breakfast	/
Main Hall	/	Den/Library	/
Living Room	/	Lower Landing	/
Dining Room	/		/
Family Room	/		/

Comment /

9. Wall Paint

Kingsmen White

Smooth Ceilings

☐ First Floor

☐ First Floor incl. Second Floor Hall

☐ First and Second Floor

☒ Throughout

☐ Not Applicable

Trim Paint Kingsmen White

10. Additional Comments

/

11. Disclaimers and Notes

1) Colours of all materials are as close as possible to builder's selection, but not necessarily identical due to variances in manufacturing.

2) Any extras listed above are null and void unless accompanied by a separate invoice/amendment. Said invoice must be paid in full.

3) The Purchaser acknowledges that after Interior Colour Selection form is signed and dated, no further changes will be permitted other than re-selection due to unavailability.  Purchaser's Initials

4) The Purchaser acknowledges reading and accepting the "Kingsmen Group Décor Centre Disclaimers" form. This document contains other miscellaneous disclaimers.

This Interior Colour Selection is final and approved by:

Purchaser:

Signature:  Date: OCT 4th 2022

Vendor:



KINGSMEN (THAMES) INC.
OCT 5/22

Page 3 of 3

Printed 10/4/2022 15:05:30

SCHEDULE "B-1"
Floor Plan

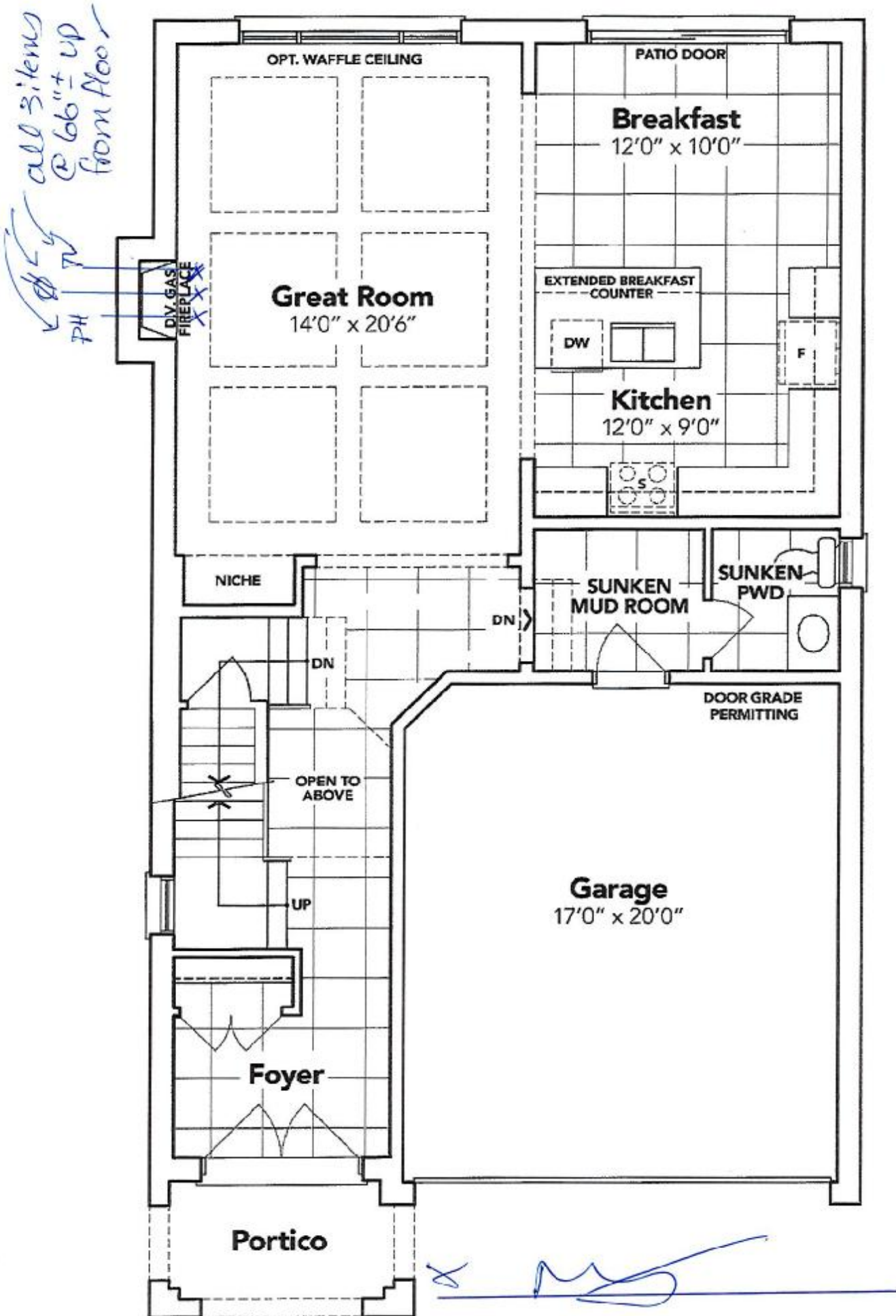
Lot 119
Phase 5A
Model: James (3601) Elev B 4 Bed - 2+1 Bath
Standard



GROUND FLOOR EL. B

The floor plans and elevations shown are pre-construction plans and may be revised or improved as necessitated by architectural controls and the construction process. The measurements adhere to the rules and regulations of the TARION Warranty Corporation's official method for the calculation of floor area. Materials, specifications and floor plans are subject to change without notice. All house renderings are artist's concept only. Actual usable floor space may vary from the stated floor area. All options shown are upgrades. E. & O. E.



SCHEDULE "B-1"
Floor Plan

Lot 119
Phase 5A
Model: James (3601) Elev B 4 Bed - 2+1 Bath
Standard

Sketch #2

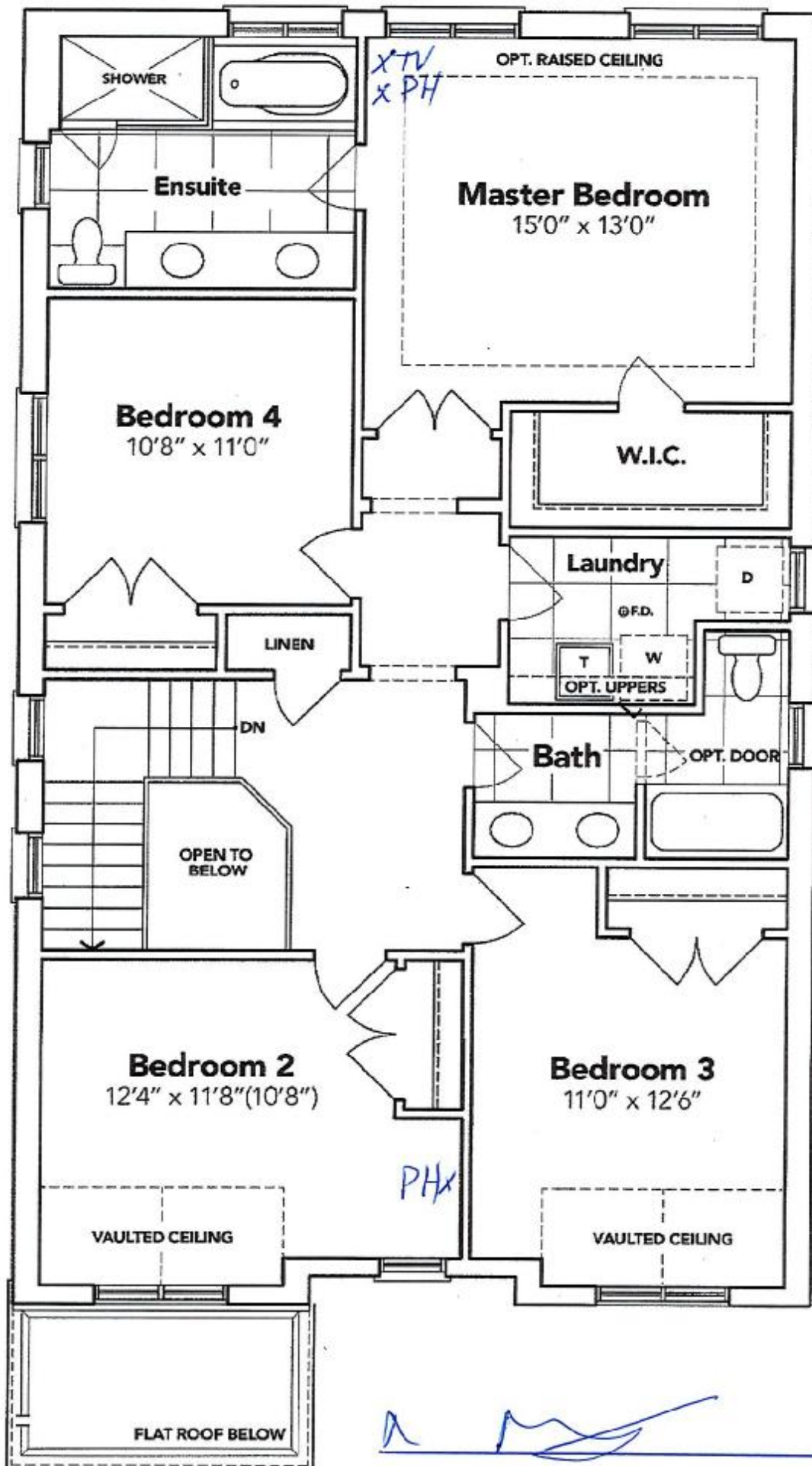

SECOND FLOOR EL. B

The floor plans and elevations shown are pre-construction plans and may be revised or improved as necessitated by architectural controls and the construction process. The measurements adhere to the rules and regulations of the TARION Warranty Corporation's official method for the calculation of floor area. Materials, specifications and floor plans are subject to change without notice. All house renderings are artist's concept only. Actual usable floor space may vary from the stated floor area. All options shown are upgrades, E. & O. E.

SCHEDULE "B-1"
Floor Plan

Lot 119
Phase 5A
Model: James (3601) Elev B 4 Bed - 2+1 Bath
Standard

Sketch #3

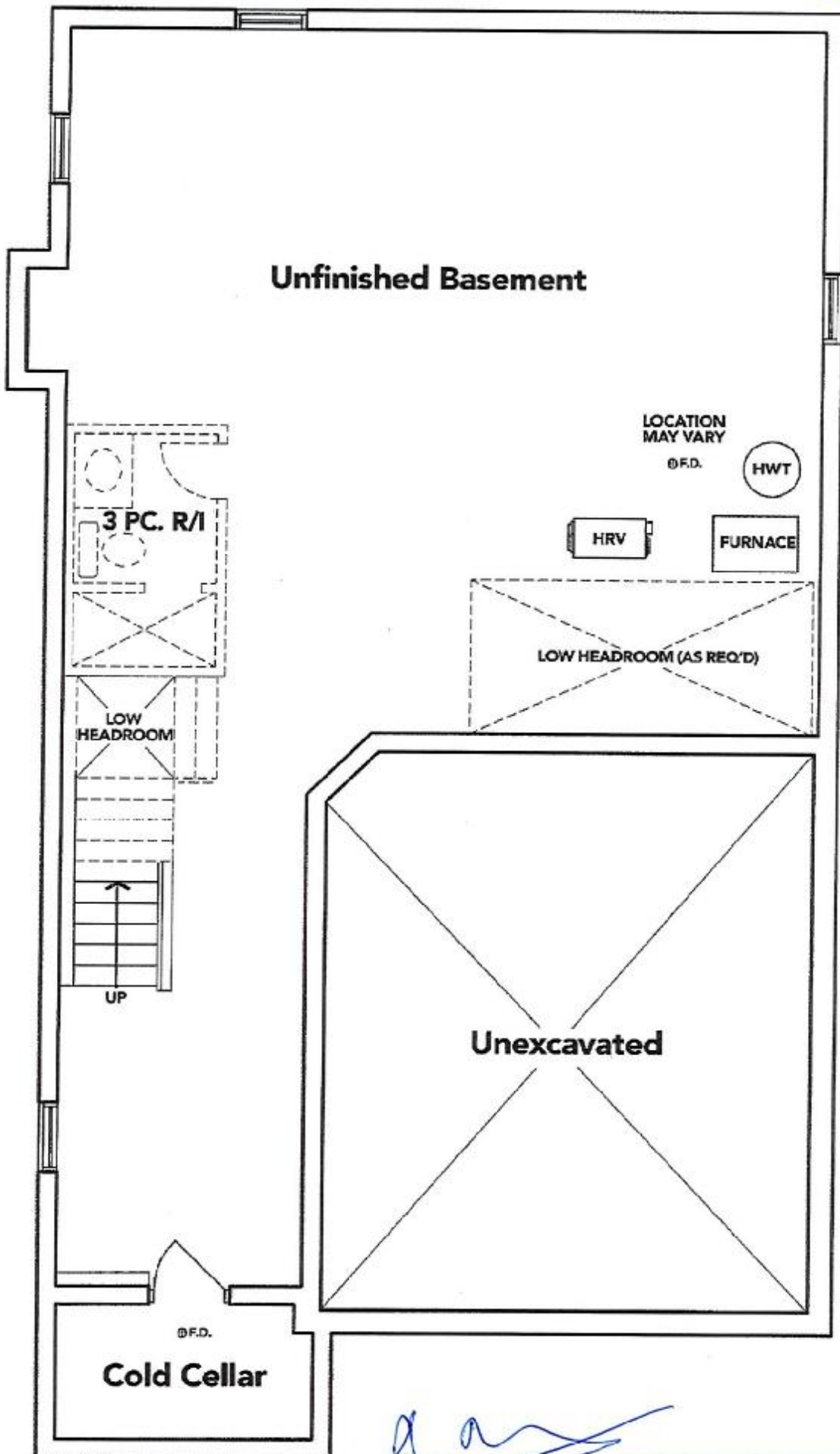

BASEMENT EL. B

The floor plans and elevations shown are pre-construction plans and may be revised or improved as necessitated by architectural controls and the construction process. The measurements adhere to the rules and regulations of the TARIION Warranty Corporation's official method for the calculation of floor area. Materials, specifications and floor plans are subject to change without notice. All house renderings are artist's concept only. Actual usable floor space may vary from the stated floor area. All options shown are upgrades. E. & O. E.

LOT 119 THAMES PH. 5 A
RE: UPGRADED UNDER MOUNT KITCHEN
SINK.

BLANCO

Sink Specifications

Colour	SKU
brushed finish	401247

QUATRUS U 2

Design and planning tips

- Min cabinet size: 36 in (915 mm)
- Bowl Depth: 9 in (230.0 mm)

Specifications:
Installation clips, Sink template, Installation instructions, 3
1/2" (90 mm) stainless steel strainers

Depending on cabinet construction, a different cabinet
size may be required. Consult the cabinet manufacturer.

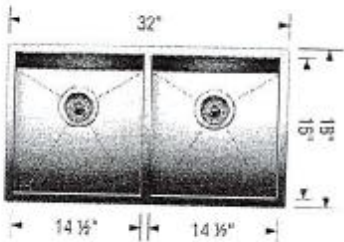

[Handwritten signature]

CATENA
RECTANGULAR UNDERMOUNT SINK

4210CIV Undermount Sink

PRODUCT SPECS:

- Vitreous china
- Front overflow hole
- Furniture and mounting hardware supplied

DIMENSIONS:

Outer:
510mm W x 590mm D x 190mm H
20" W x 23 1/2" D x 7 1/2" H
Inner:
450mm W x 510mm D x 160mm H
18" W x 20" D x 6 1/4" H

COMPLIANCE CERTIFICATIONS

- Meets or exceeds the following:
- IAPMO CUPC
 - ASME A112.19.2 / CSA B45.1
 - DBC Section 3.8 Barrier Free design and CSA B65.1 Standard

SHIPPING

Case: 1/2
GW: 27 lbs

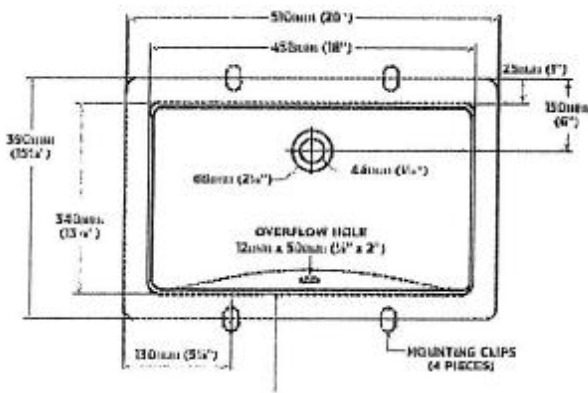

TO BE SPECIFIED

- 4210CIV
- 4210CIV-1

NOTES: Dimensions of fixtures are given in millimeters and inches. The inch dimensions are given in parentheses. The inch dimensions are subject to change without notice. The manufacturer is not responsible for any errors or omissions in this document. The manufacturer is not responsible for any errors or omissions in this document. The manufacturer is not responsible for any errors or omissions in this document.



[Handwritten signature]