

KINGSMEN (THAMES) INC. / Havelock Corners (Kingsmen)

Lot/Unit: 126 Phase/Building: 5A Model/Floor Plan: Robert (3604) Elev B 4 Bed - 2+1 Bath

CABINETRY

Inv.5905	1 - To supply & install the special kitchen cabinets in lieu of the standard kitchen cabinets... see colour chart for details.	
Line 74947	Note:	
7Oct22 / 7Oct22		

CABINETRY ACCESSORIES

Inv.5905	4 - To supply & install the LIGHT VALANCE - APPROXIMATELY 2INCHES 50MM HIGH in the ktichen...	
Line 74937	Note: Rough in wires on a sep. switch sold sep.	
7Oct22 / 7Oct22 NO LIGHTS HAVE BEEN PURCHASED.		

CABINETRY APPLIANCE - FRIDGE

Inv.5905	1 - To supply & install the 66CM DEEP FRIDGE ENCLOSURE - COUNTER DEPTH WITH - 1 WALL - 1 66CM DEEP GABLE AND 1 66CM DEEP CABINET - THIS IS NOT A ZERO CLEARANCE ENCLOSURE. STANDARD HEIGHTS AND WIDTHS WILL BE USED. - in the kitchen..see sketch # 1	
Line 74935	Note: See fridge spec's attached.	
7Oct22 / 7Oct22		

CABINETRY BASE CABINETS

Inv.5905	1 - To supply & install an additional BANK OF DRAWERS CABINET - approx. 45 CM + - wide in the kitchen... see sketch # 1	
Line 74936	Note:	
7Oct22 / 7Oct22		

CABINETRY MICROWAVE OVEN STOVE COOKTOP

Inv.5905	1 - To supply & install the accomodations for a futureBUILT-IN TALL APPLIANCE CABINET WITH DRAWER - S BELOW FOR PANEL-MOUNT - PROUD - OR TRIM KIT INSTALLATIONS - TRIM KIT REQUIRED - SUPPLY ALL SPECS AND INSTALLATION GUIDES - COUNTER DEPTH in the kitchen..	
Line 74932	Note: See sketch # 1 INSTALL THIS TOWER NEXT TO THE FRIDGE..	
7Oct22 / 7Oct22		
Inv.5905	1 - To supply & install accomdations for the future 30" COOKTOP CABINET WITH FALSE TOP DRAWER AND POTS AND PANS DRAWERS BELOW - SUPPLY SPECS - in the kitchen... see spec's... see sketch # 1	
Line 74930	Note:	
7Oct22 / 7Oct22		

CABINETRY VANITY

Inv.5905	2 - To supply & install a - LOWER DRAWER PRICE PER DRAWER in the powder room... see sketch # 1	
Line 74939	Note:	
7Oct22 / 7Oct22		
Inv.5905	1 - To supply & install a VANITY BANK OF DRAWERS -in the master ensuite bathroom...see sketch # 2	
Line 74940	Note:	
7Oct22 / 7Oct22		

KINGSMEN (THAMES) INC. / Havelock Corners (Kingsmen)

Lot/Unit: 126 Phase/Building: 5A Model/Floor Plan: Robert (3604) Elev B 4 Bed - 2+1 Bath

Inv.5905	1 - To supply & install an INCREASE VANITY TO KITCHEN HEIGHT 90CM HIGH + - MAINTAINS VANITY DEPTH - in the powder room in lieu of the standard height cabinet.	
Line 74941	Note:	
7Oct22 / 7Oct22		
Inv.5905	1 - To supply & install an INCREASE VANITY TO KITCHEN HEIGHT 90CM HIGH + - MAINTAINS VANITY DEPTH - in the main bathroom in lieu of the standard height cabinet.	
Line 74942	Note:	
7Oct22 / 7Oct22		
Inv.5905	1 - To supply & install an INCREASE VANITY TO KITCHEN HEIGHT 90CM HIGH + - MAINTAINS VANITY DEPTH - in the master ensuite bathroom in lieu of the standard height cabinet.	
Line 74943	Note:	
7Oct22 / 7Oct22		

CABINETRY WALL AND HUTCH

Inv.5905	1 - To supply & install the UPPER ANGLE CORNER PER UNIT - in the kitchen... see sketch # 1	
Line 74934	Note:	
7Oct22 / 7Oct22		

COUNTER TOP

Inv.5905	1 - To accomdate the quartz countertop for the future 30" cook top in the kitchen... see spec's...see sketch # 1	
Line 74929	Note:	
7Oct22 / 7Oct22		
Inv.5905	1 - As per schedule "PE": Vendor to include level 1, 2cm. quartz in all bathrooms, as per plan, in lieu of the include laminate counter tops. Selections to be made from builders standard samples.	
Line 74913	Note:	
7Oct22 / 7Oct22		

ELECTRICAL

Inv.5905	1 - To supply & install the standard T.V. rough in in the great room and master bedroom... see sketch # 1 & # 2	
Line 74914	Note: Install the standard T.V. rough in at approx. 66" + - up from the floor in the great room above the F/P mantle.	
7Oct22 / 7Oct22		
Inv.5905	1 - To supply & install the standard Phone (CAT 5) rough in in the great room, master bedroom & bedroom # 2 ... see sketch # 1 & # 2	
Line 74915	Note: Install the standard Phone (CAT 5) rough in at approx. 66" + - up from the floor in the great room above the F/P mantle.	
7Oct22 / 7Oct22		
Inv.5905	1 - To SUPPLY AND INSTALL AN ADDITIONAL BASIC RECEPTACLE (NOT DEDICATED) at approx. 66" + - up from the the floor, OFF CENTERED to the F/P mantle	
Line 74925	Note: in the great room... see sketch # 1	
7Oct22 / 7Oct22		
Inv.5905	1 - To SUPPLY AND INSTALL EXTRA CEILING BOX ROUGH IN CAPPED (DOES NOT INCLUDE SWITCH) over the island in the kitchen... see sketch # 1	
Line 74926	Note: This cap will be connected to a sep. switch, switch is sold sep.	
7Oct22 / 7Oct22		

KINGSMEN (THAMES) INC. / Havelock Corners (Kingsmen)

Lot/Unit: 126 Phase/Building: 5A Model/Floor Plan: Robert (3604) Elev B 4 Bed - 2+1 Bath

Inv.5905	1 - To supply & install AN ADDITIONAL SINGLE POLE SWITCH connected to the upgraded capped elec. over the island in the kitchen.	
Line 74927	Note:	
7Oct22 / 7Oct22		
Inv.5905	1 - To SUPPLY AND INSTALL EXTRA 240 STOVE PLUG for the future wall oven/micro. combo in the kitchen... see sketch # 1	
Line 74931	Note:	
7Oct22 / 7Oct22		
Inv.5905	1 - To supply & install rough in wires on a sep. switch for future lower valance lights in the kitchen.	
Line 74938	Note: Lower valance trim is sold sep.	
7Oct22 / 7Oct22		NO LIGHTS HAVE BEEN PURCHASED.

HARDWOOD

Inv.5905	1 - To supply & install the 3 1/2" Engineered stained hardwood to the main floor area (and stair landing if applicable) in lieu of the standard 3 1/2" Engineered natural hardwood ... see colour chart for details.	
Line 74948	Note:	
7Oct22 / 7Oct22		
Inv.5905	1 - To supply & install the 3 1/2" Engineered stained hardwood to the living room area in lieu of the standard carpet... see colour chart for details.	
Line 74949	Note:	
7Oct22 / 7Oct22		
Inv.5905	1 - To supply & install the 3 1/2" Engineered stained hardwood to the upper hallway area in lieu of the standard carpet... see colour chart for details.	
Line 74950	Note:	
7Oct22 / 7Oct22		

HEATING AND AIR CONDITIONING

Inv.5905	1 - To supply & install a capped gas line (ROUGH IN ONLY) at stove location for future 30" gas cooktop, to include a 110 V elec. outlet (code requirement) ... see spec's... see sketh # 1	
Line 74933	Note:	
7Oct22 / 7Oct22		
Inv.5905	1 - As per schedule "PE": Vendor to install capped gas line (rough in only) at rear of ome for future BBQ location. Location to be finalzied at vendors sole discretion.	
Line 74911	Note:	
7Oct22 / 7Oct22		
Inv.5905	1 - As per schedule "PE": Vendor to supply & install air conditioning unit, sized accordingly, from vendors standard samples.	
Line 74912	Note:	
7Oct22 / 7Oct22		
Inv.5905	1 - To supply & install a HUMMIDIFIER to the furnace...	
Line 74928	Note:	
7Oct22 / 7Oct22		

MISCELLANEOUS

PAINT AND DRYWALL

KINGSMEN (THAMES) INC. / Havelock Corners (Kingsmen)

Lot/Unit: 126 Phase/Building: 5A Model/Floor Plan: Robert (3604) Elev B 4 Bed - 2+1 Bath

Inv. 5905	2 - To supply & install the PAINT EXTRAS - STAIN RAILINGS WITH IRON PICKETS (INCLUDING STAIRS) to the main and basement stairs in lieu of the standard ... see colour chart for details.	
Line 74951	Note:	
7Oct22 / 7Oct22		

PLUMBING

Inv. 5905	4 - To supply & install the VANITY SINK - CONTRAC CATENA UNDERMOUNT - MODEL 4210CIY in the powder room, main bathroom and master ensuite in lieu of the standard top mount sinks...see spec's	
Line 74944	Note: Still to install the standard lav. faucets.	
7Oct22 / 7Oct22		
Inv. 5905	1 - To supply & install the KITCHEN SINK - BLANCO QUATRUS U2 DBL UNDERMOUNT MODEL 401247 in the kitchen in lieu of the standard top mount kitchen sink... see spec's	
Line 74945	Note: Still to install the standard single hole kitchen faucet, NO PLATE.	
7Oct22 / 7Oct22		
Inv. 5905	1 - To supply & install the KITCHEN SOAP Dispencer - MOEN CHROME - MODEL 3942 in the kitchen... see spec's...see sketch # 1 for installation location	
Line 74946	Note:	
7Oct22 / 7Oct22		

RAILING

Inv. 5905	2 - To supply & install the RAILING - UPGRADE 1 - METAL HANDRAIL 3 INCH OVAL IN OAK - PICKETS STEEL ½ INCH SQUARE, PLAIN, WITH SHOES IN FLAT BLACK - POSTS 3½ INCH SQUARE, WITH CAP OAK IN OAK throughout where applicable in lieu of the standard pickets & rails	
Line 74952	Note:	
7Oct22 / 7Oct22		

TILE - FLOOR

Inv. 5905	1 - To supply & install the UPGRADE 3 - FLOOR TILE - STACKED - FOYER TILE in lieu of the standard tiles...see colour chart for details.	
Line 74953	Note:	
7Oct22 / 7Oct22		
Inv. 5905	1 - To supply & install the UPGRADE 3 - FLOOR TILE - STACKED - POWDER ROOM TILE in lieu of the standard tiles...see colour chart for details.	
Line 74954	Note:	
7Oct22 / 7Oct22		
Inv. 5905	1 - To supply & install the UPGRADE 3 - FLOOR TILE - STACKED - KITCHEN AREA TILE in lieu of the standard tiles...see colour chart for details.	
Line 74955	Note:	
7Oct22 / 7Oct22		

KINGSMEN (THAMES) INC. / Havelock Corners (Kingsmen)

Lot/Unit: 126 Phase/Building: 5A Model/Floor Plan: Robert (3604) Elev B 4 Bed - 2+1 Bath

EXTRAS AS PER OFFER

5 FREE APPLIANCES – STAINLESS STEEL FRONT - FRIDGE: STOVE AND DISHWASHER. WHITE WASHER AND DRYER (SUPPLIED ONLY, NOT INSTALLED, FROM BUILDERS STANDARD LINE). AN APPLIANCES VOUCHER WILL BE GIVEN BY OUR DECOR CONSULTANT AT THE TIME OF BOOKING YOUR COLOUR A <i>Worksheet</i> Note:	
VENDOR TO INSTALL CAPPED GAS LINE (ROUGH-IN ONLY) AT REAR OF HOME FOR FUTURE BBQ LOCATION. LOCATION TO BE FINALIZED AT VENDORS SOLE DISCRETION. <i>Worksheet</i> Note:	
VENDOR TO SUPPLY & INSTALL AIR CONDITIONING UNIT, SIZED ACCORDINGLY, FROM VENDORS STANDARD SAMPLES. <i>Worksheet</i> Note:	
VENDOR TO INCLUDE LEVEL 1, 2CM QUARTZ IN ALL BATHROOMS, AS PER PLAN, IN LIEU OF THE INCLUDED LAMINATE COUNTER TOPS. SELECTIONS TO BE MADE FROM BUILDERS STANDARD SAMPLES. <i>Worksheet</i> Note:	

Purchaser: SATWINDER SINGH

Property: 126 of Plan - Draft Approval SB17-03-08

Telephone Res. / Bus: /

Project: KINGSMEN (THAMES) INC.

Decor Advisor: Barbara Coccia

Model and Elevation: Robert (3604) Elev B 4 Bed - 2+1 Bath

Layout Changes: ☐ Yes ☒ No

Sketch Attached: ☒ Yes ☐ No

Exterior Colour Scheme:

1. Cabinetry	Style and Colour	Counter Top	Hardware
Kitchen / Breakfast	** Cape Cod Paint Macadamia	#1, C/S # 9141 Ice Snow 3cm.	#135 Knob
Kitchen Island	** Cape Cod Paint Macadamia	#1, C/S # 9141 Ice Snow 3cm.	#135 Knob
Laundry Room	/		
Powder Room	#3, Charleston 3DL Orchid	#1, C/S # 9141 Ice Snow 2cm.	#135 Knob
Main Bathroom	#3, Charleston 3DL Orchid	#1, C/S # 9141 Ice Snow 2cm.	#12881 Handle
Master Ensuite Bathroom	#3, Charleston 3DL Orchid	#1, C/S # 9141 Ice Snow 2cm.	#12881 Handle
Second Ensuite Bathroom (If Applicable)	/		
	/		
	/		

Appliances

Custom Size Fridge
☒ Yes ☐ No

Valance Lighting
☐ Yes ☐ No

Microwave / Range Hood
☐ Yes ☒ No

Comment

Cooktop / Rangetop
☒ Yes ☐ No

Built in Wall Oven
☒ Yes ☐ No

Slide-in Range
☐ Yes ☒ No

2. Flooring	Selection
Foyer	**Upg. 3, 12 x 24" Mayfair Calacatta Oro HD. Rec. Porcelain Matte STACKED
Main Hall	**3 1/2" Elements Oak Bearskin
Back Hall	/
Breakfast	/
Laundry Room	13 x13" Cinq White
Kitchen	**Upg. 3, 12 x 24" Mayfair Calacatta Oro HD. Rec. Porcelain Matte STACKED
Powder Room	**Upg. 3, 12 x 24" Mayfair Calacatta Oro HD. Rec. Porcelain Matte STACKED
Main Bathroom	13 x13" Cinq White
Master Ensuite	13 x13" Cinq White
Bathroom (If Applicable)	/
Mud Room	/
Master ens. shower floor:	2x2" Ontario Snow White Matte
Living Room	**3 1/2" Elements Oak Bearskin
Dining Room	(Dinette) **3 1/2" Elements Oak Bearskin
Family / Great Room	**3 1/2" Elements Oak Bearskin
Den / Library / Study	/
Basement Landing (If Applies)	(Basement Foyer) 13 x13" Cinq White
Lower Landing (If Applicable)	**3 1/2" Elements Oak Bearskin
Upper Landing	(If applicable) **3 1/2" Elements Oak Bearskin
Upper Hall	**3 1/2" Elements Oak Bearskin
Master Bedroom	Modern Story 1, # 945 Felt Hat
Bedroom #2	Modern Story 1, # 945 Felt Hat
Bedroom #3	Modern Story 1, # 945 Felt Hat
Bedroom #4	Modern Story 1, # 945 Felt Hat
Bedroom #5	/
Master ens. shower jamb:	Anatolia Marmiline SNOW



Purchaser: SATWINDER SINGH

Telephone Res. / Bus: /

Decor Advisor: Barbara Coccia

2. Flooring - Continued -

Property: 126 of Plan - Draft Approval SB17-03-08

Project: KINGSMEN (THAMES) INC.



Model and Elevation: Robert (3604) Elev B 4 Bed - 2+1 Bath

Upgrade Underpad	Type	Area
	Standard	Master bedroom, bedroom # 2, #3 & # 4
Carpet on Stairs	Capped	Runner - *Upgrade
Comment	/	/

3. Plumbing Fixtures / Faucets

Kitchen	Standard	Second Ensuite	/	Powder Room	Standard					
Master Ensuite	Standard			Other Room	/					
Main Bathroom	Standard		/							
Comment										
Purchaser has upgraded to an under mount kitchen sink..still to install the standard single hole kitchen faucet, NO PLATE. Purchaser has upgraded to under mount sinks in ALL bathrooms, still to install the standard lav. faucets										

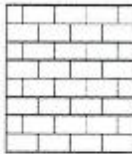
4. Wall Tile

	Tile Selection	Listello	Insert	Insert Selection				
Main Bathroom	8x10" Cinq White	<input type="checkbox"/>	<input type="checkbox"/>					
Master Ensuite								
Tub Deck	13 x13" Cinq White	<input type="checkbox"/>	<input type="checkbox"/>					
Tub Apron	13 x13" Cinq White	<input type="checkbox"/>	<input type="checkbox"/>					
Tub Surround	13 x13" Cinq White	<input type="checkbox"/>						
Shower Stall	8x10" Cinq Black	<input type="checkbox"/>	<input type="checkbox"/>					
Second Ensuite	/	<input type="checkbox"/>	<input type="checkbox"/>					
	/	<input type="checkbox"/>	<input type="checkbox"/>					
	/	<input type="checkbox"/>	<input type="checkbox"/>					
Kitchen Backsplash	/	<input type="checkbox"/>	<input type="checkbox"/>					
Complete Backsplash	/	<input type="checkbox"/>	<input type="checkbox"/>					
Comment								
Install the standard 8x10" wall tiles on the 10" side stacked horizontally in the bathrooms where applicable.								
<div><div> horizontal stacked</div><div> brick pattern</div><div> vertical stacked</div><div> diagonal/diamond</div></div>								

5. Fireplace

	Living Room			Family Room			Other Room - Specify Great Room		
	Purchased	As Per Plan	N/A	Purchased	As Per Plan	N/A	Purchased	As Per Plan	N/A
Fireplace Type	<input type="radio"/>	<input type="radio"/>	<input checked="" type="radio"/>	<input type="radio"/>	<input type="radio"/>	<input checked="" type="radio"/>	<input type="radio"/>	<input checked="" type="radio"/>	<input type="radio"/>
Mantle Type							Front Facing		
Over Mantle							NF-08		
Colour / Stain							/		
Surround							White		
Hearth							/		
Comment									



Initial: _____

Purchaser: SATWINDER SINGH Property: 126 of Plan - Draft Approval SB17-03-08
Telephone Res. / Bus: / Project: KINGSMEN (THAMES) INC.
Decor Advisor: Barbara Coccia Model and Elevation: Robert (3604) Elev B 4 Bed - 2+1 Bath

6. Trim Carpentry

Door Hardware	Standard handle	Interior Doors <input type="radio"/> 2 Panel Arch Top <input checked="" type="radio"/> 2 Panel Square Top <input type="radio"/> 6 Panel Initial for Door Style 
Interior Trim	Standard	
Comment	/	

7. Railings and Pickets

Railing Package	**Upg. #1 Metal Picket package		
Railing Colour	**Elements Bearskin	Picket Colour	BLACK
Wood Stairs	<input type="radio"/> No <input checked="" type="radio"/> Oak	Tread Colour	**Elements Bearskin
Comment	/		

8. Plaster Mouldings and Medallions

Foyer		Kitchen/Breakfast	
Main Hall		Den/Library	
Living Room		Lower Landing	
Dining Room			
Family Room			
Comment	/		

9. Wall Paint

Kingsmen White	Smooth Ceilings <input type="radio"/> First Floor <input type="radio"/> First Floor incl. Second Floor Hall <input type="radio"/> First and Second Floor <input checked="" type="radio"/> Throughout <input type="radio"/> Not Applicable
	Trim Paint Kingsmen White

10. Additional Comments

/

RECEIVED
OCT 11 2022

11. Disclaimers and Notes

1) Colours of all materials are as close as possible to builder's selection, but not necessarily identical due to variances in manufacturing.
2) Any extras listed above are null and void unless accompanied by a separate invoice/amendment. Said invoice must be paid in full.
3) The Purchaser acknowledges that after Interior Colour Selection form is signed and dated, no further changes will be permitted other than re-selection due to unavailability.  Purchaser's Initials
4) The Purchaser acknowledges reading and accepting the "Kingsmen Group Décor Centre Disclaimers" form. This document contains other miscellaneous disclaimers.

This Interior Colour Selection is final and approved by:

Purchaser:
Signature:  Date: 10-7-22

Vendor: 
KINGSMEN (THAMES) INC. Oct 11/22

SCHEDULE "B-1"
Floor Plan

Lot 12
Phase 5.
Model: Robert (3604) Elev B 4 Bed - 2+1 Bat
Standar

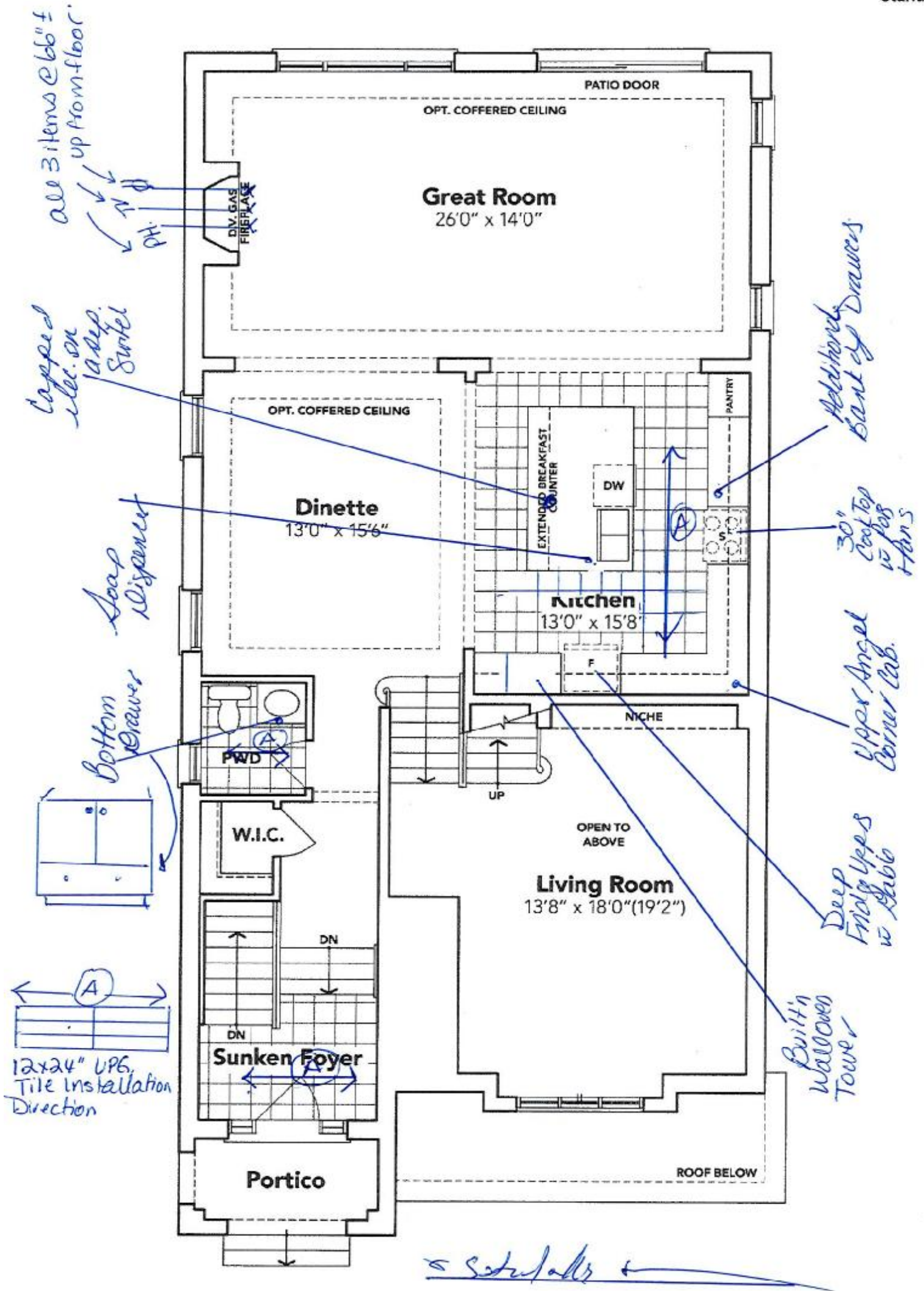

GROUND FLOOR EL. B

The floor plans and elevations shown are pre-construction plans and may be revised or improved as necessitated by architectural controls and the construction process. The measurements adhere to the rules and regulations of the TARION Warranty Corporation's official method for the calculation of floor area. Materials, specifications and floor plans are subject to change without notice. All house renderings are artist's concept only. Actual usable floor space may vary from the stated floor area. All options shown are upgrades. E. & O. E.

SCHEDULE "B-1" Floor Plan

Lot 12
Phase 5
Model: Robert (3604) Elev B 4 Bed - 2+1 Bat
Standar

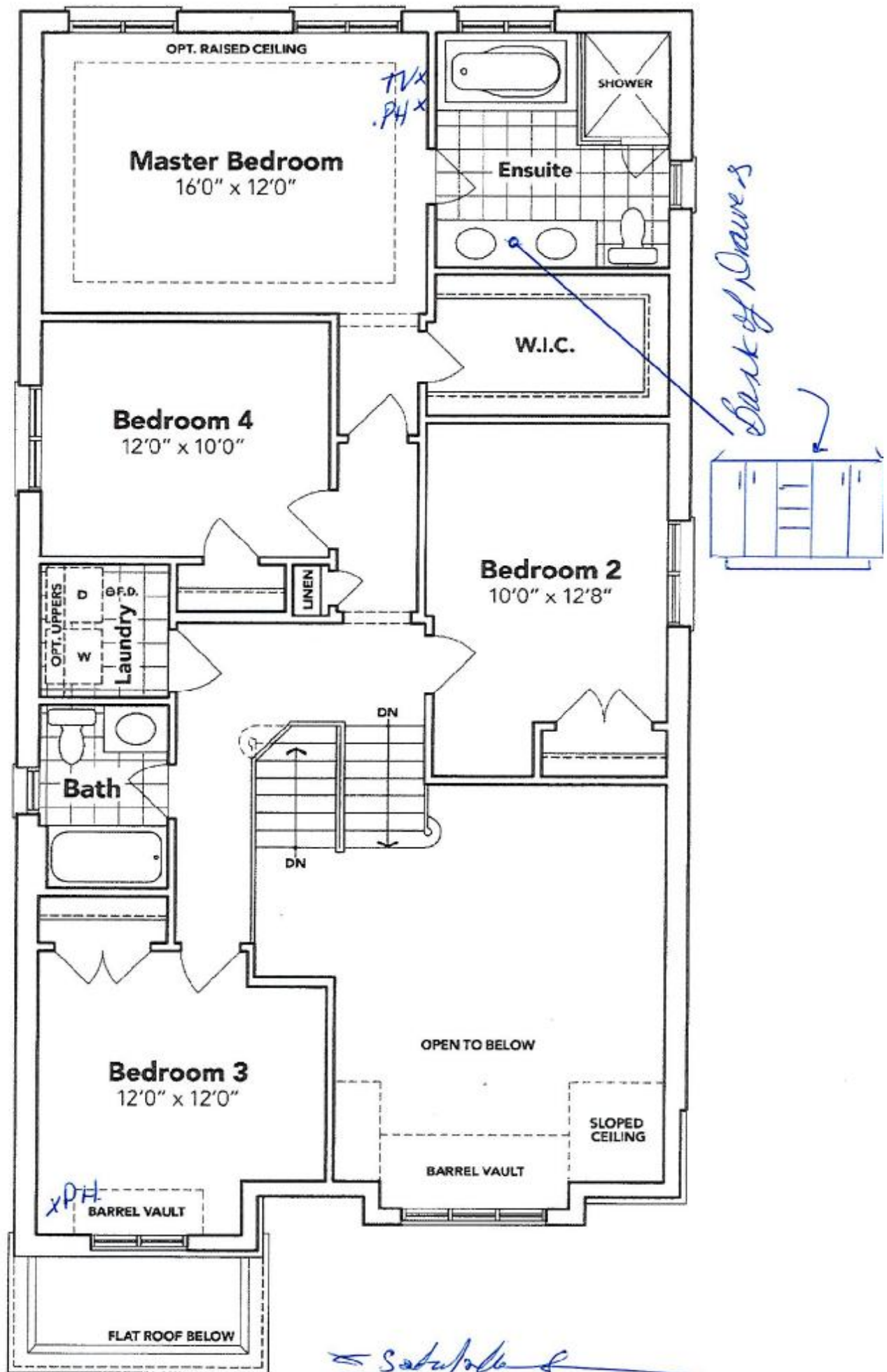

SECOND FLOOR EL. B

The floor plans and elevations shown are pre-construction plans and may be revised or improved as necessitated by architectural controls and the construction process. The measurements adhere to the rules and regulations of the TARION Warranty Corporation's official method for the calculation of floor area. Materials, specifications and floor plans are subject to change without notice. All house renderings are artist's concept only. Actual usable floor space may vary from the stated floor area. All options shown are upgrades. E. & O. E.

SCHEDULE "B-1"
Floor Plan

Lot 12
Phase 5.
Model: Robert (3604) Elev B 4 Bed - 2+1 Bat
Standar

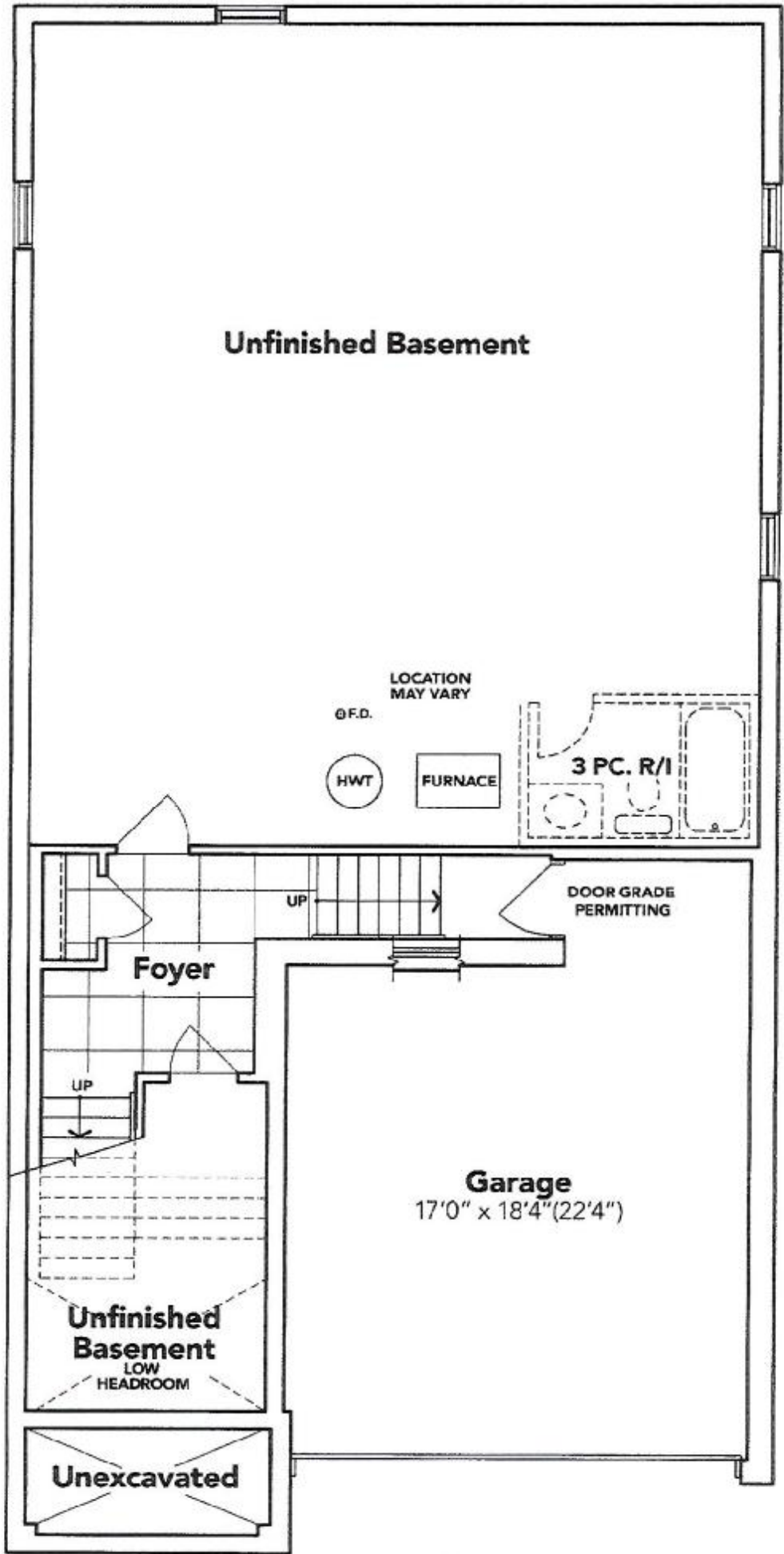

BASEMENT EL. B

The floor plans and elevations shown are pre-construction plans and may be revised or improved as necessitated by architectural controls and the construction process. The measurements adhere to the rules and regulations of the TARION Warranty Corporation's official method for the calculation of floor area. Materials, specifications and floor plans are subject to change without notice. All house renderings are artist's concept only. Actual usable floor space may vary from the stated floor area. All options shown are upgrades. E. & O. E.



LOT 126 THAMES PH. 5 A
RE:UPGRADED UNDER MOUNT KITCHEN
SINK AND SOAP DISPENSER

A Catulsky

BLANCO

Sink Specifications

Colour	SKU
brushed finish	401247

QUATRUS U 2

Design and planning tips

- Min cabinet size: 36 in (915 mm)
- Bowl Depth: 9 in (230.0 mm)

Specifications:
Installation clips, Sink template, Installation instructions, 3
½" (90 mm) stainless steel strainers

Depending on cabinet construction, a different cabinet
size may be required. Consult the cabinet manufacturer.

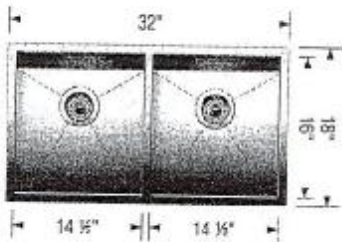

Soap or Lotion Dispensers

Traditional Transitional Modern

*However you define your faucet's style,
you can assure a coordinated look with Moen soap dispensers.*



Transitional Soap or
Lotion Dispenser

Model 3942

KITCHEN

LOT 126 THAMES PH. 5 A
RE:UPGRADED UNDER MOUNT VANITY
SINKS IN ALL BATHROOMS

CATENA
RECTANGULAR UNDERMOUNT SINK

4210CIV Undermount Sink

PRODUCT SPECS:

- Vitreous China
- Front overflow hole
- Template and mounting hardware supplied

DIMENSIONS:

Outer:
510mm W x 390mm D x 190mm H
20" W x 15 1/2" D x 7 1/2" H
Inner:
450mm W x 340mm D x 140mm H
18" W x 13 1/2" D x 5 1/2" H

COMPLIANCE CERTIFICATIONS

- Meets or exceeds the following:
- AIAA/CES
 - ASME A112.19.2 / CSA B45.1
 - OBC Section 3.8 Barrier Free design and CSA B051 Standard

SHIPPING

Cube: 1.72
GW: 27 lbs

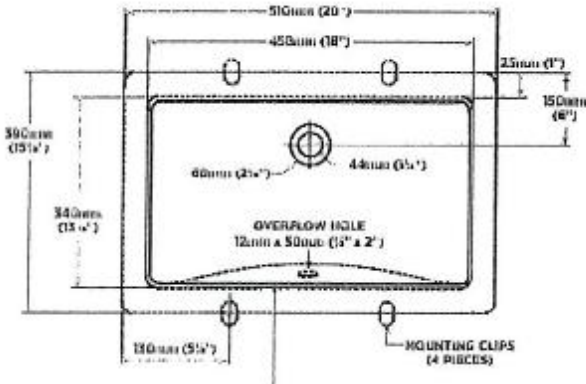

TO BE SPECIFIED

- 1/2"
- 1/2"

NOTES: Dimensions of fixtures are nominal and may vary within the range of tolerances indicated by ASME Standard A112.19.2. The manufacturer reserves the right to change or discontinue the product without notice. Products are designed for use with ADA compliant and other similar free requirements. It is the responsibility of the installer to comply with all applicable building codes and standards prior to installing the product.



Handwritten signature

LOT 126 THAMES PH. 5 A
RE: FRIDGE SPEC'S
NO ROUGH IN WATER LINE PURCHASED

A. Schuler

RF30BB6200QLAA

SAMSUNG

BESPOKE French Door Refrigerator with AutoFill Water Pitcher
30.1 cu. ft.



Signature Features

Customizable Door Panels

Customize the colour of your refrigerator. Choose from eleven colours and two finishes to create a space that fits your style.¹
This model ships with Stainless Steel panels.

AutoFill Water Pitcher

A BPA Free² Autofill Water Pitcher located in the fridge door fills up automatically to give you easy access to cold flavoured water.

Dual Auto Ice Maker

Be prepared for any occasion with two different types of ice. The Dual auto ice maker makes both cubed ice and ice bites.

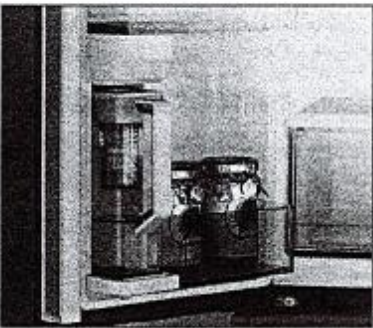

AutoFill™ Water Pitcher

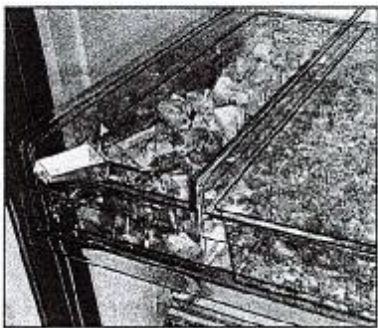

Dual Ice Maker with Cubed Ice and IceBites™

BESPOKE Panel Colour Selection

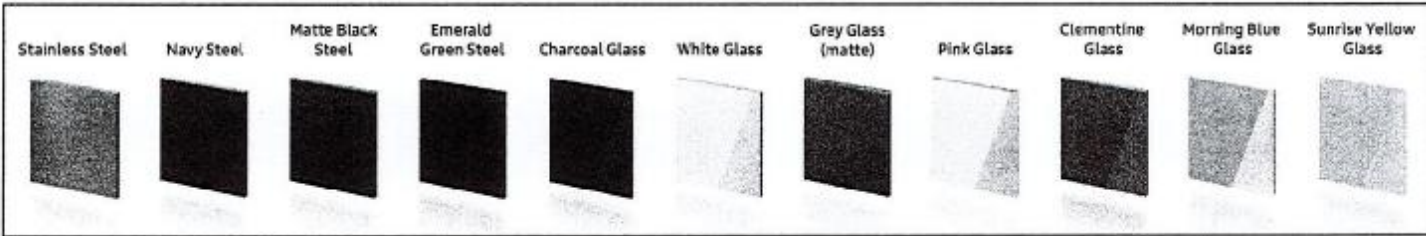

Features

- 36" Wide
- Large Storage Capacity – 30.1 cu. ft.
- BESPOKE - customizable door panels
- Twin Cooling Plus
- Crisper+
- Tempered Glass Spill-Proof Shelves
- Fingerprint Resistant Finish
- Sabbath Mode
- ADA Compliant

Convenience

- Autofill Water Pitcher
- Dual Auto Ice Maker
- Door Alarm
- Wi-Fi Connectivity
- Power Cool
- Power Freeze

Rating



- ENERGY STAR® - Rated
- Energy Consumption (annual) = 695 kWh/yr

¹ Stainless Steel panels included. Other colour door panels sold separately.

² Does not contain the chemical Bisphenol A.

A. Schuler

RF30BB6200QLAA

SAMSUNG

BESPOKE French Door Refrigerator with AutoFill Water Pitcher
30.1 cu. ft.

Installation Specifications

- 1. Measure the height, width and depth of the opening, making sure to include baseboards, molding tile, countertop overhang, etc. Check to be sure there is enough room to open the door (consider walls, islands or other obstacles when measuring).
- 2. Refer to illustration below to determine dimensions.
- 3. Allow 11 3/8" of clearance on hinge side of refrigerator when installing next to a wall where door may make contact.
- 4. Allow 2" minimum clearance at rear for proper air circulation and water/ electrical connections. Allow a 3/8" minimum clearance at sides and top for ease of installation.
- 5. Ensure each door and entryway in the home is wide enough for the refrigerator to be moved through easily.

For optimal usage and to be able to open refrigerator doors completely, do not install next to a wall.

Please note: The following dimension and cutout information is for planning purposes only. For complete installation details, consult manual packed with product, or download manual online at [samsung.com](https://www.samsung.com).

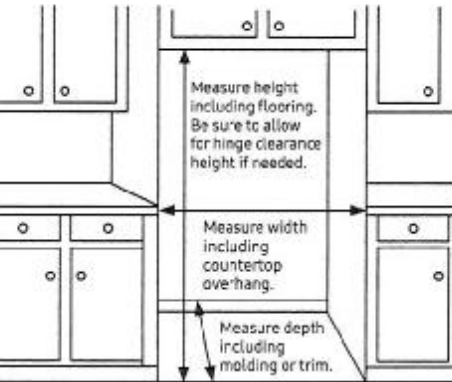

Dimensions

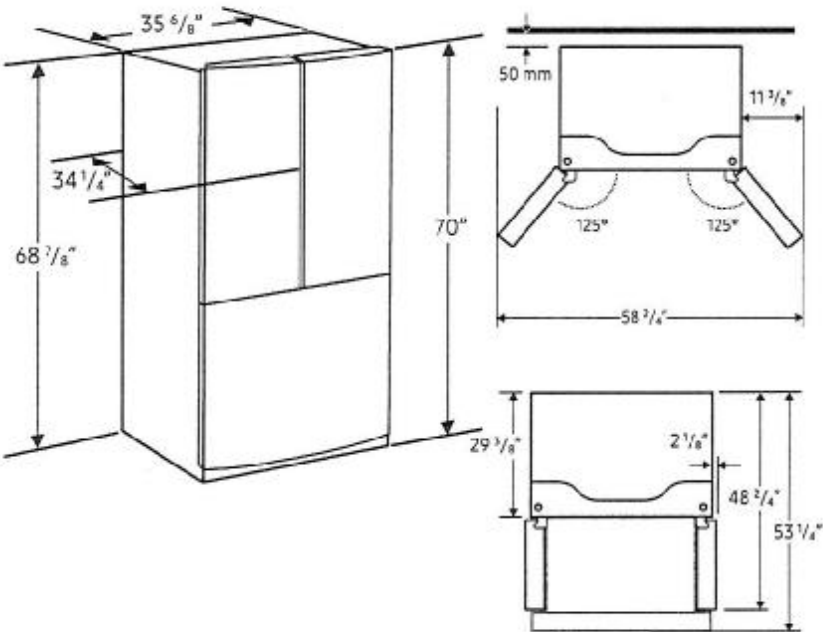

Total Capacity: 30.1 cu. ft.

Refrigerator: 21.1 cu. ft.
4 Tempered Glass Spill-Proof Shelves
2 Clear Drawers including Crisper+
8 Door Bins
- Right: 1 Gallon Bin, 3 Regular Bins
- Left: 1 Gallon Bin, 3 Regular Bins
LED Lighting

Freezer: 9 cu. ft.
Dual Ice Maker in Freezer (Cubed Ice or Ice Bites)
- 2 Ice Buckets with Cover and 1 Scoop
2 Boxes
LED Lighting

Accessories
Water Filter: HAF-QIN

Volt/Amps	115V / 60Hz / 3.5A
Power Cord Length	2 meters

Warranty
One (1) Year Parts and Labour on Refrigerator
Ten (10) Years Parts on Digital Inverter Compressor

Product Dimensions & Weight (WxHxD)
Dimensions (WxHxD with hinges, handles and doors):
35 5/8" x 70" x 34 1/4"
Dimensions (WxHxD without hinges and door):
35 5/8" x 68 7/8" x 29 3/8"
Dimensions (WxHxD with hinge and door, no handle):
35 5/8" x 70" x 34 1/4"
Weight: 313.1 lbs (142 kg)

Shipping Dimensions & Weight (WxHxD)
Dimensions: 38 1/4" x 76 3/4" x 36 1/4"
Weight: 337 lbs (153 kg)

Style	Model #	UPC
Pre-Built Stainless Steel Panels	RF30BB6200QLAA	887276624396
Without Panels	RE30BB6200APAA	887276624389

D. Schindler

NA30R5310F

30" Gas Cooktop

SAMSUNG

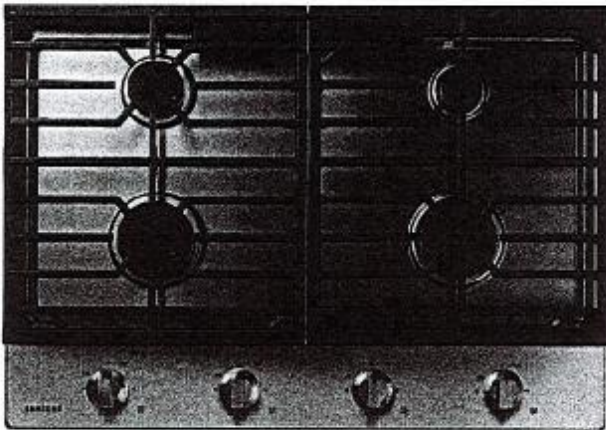

Signature Features

Powerful Burners

- Powerful burners have the flexibility to accommodate a number of dishes at once.

Front Controls

- Front Controls are easy to reach.

Continuous Cast Iron Grates

- Continuous Cast Iron Grates provide a sleek and smooth design.

Available Colors



Stainless Steel (shown)



Fingerprint Resistant
Black Stainless Steel

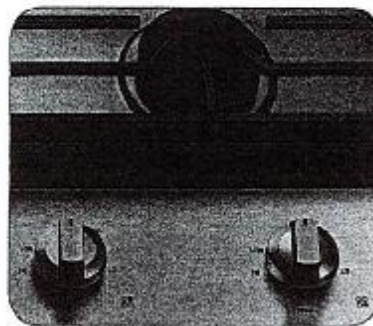

Front Controls

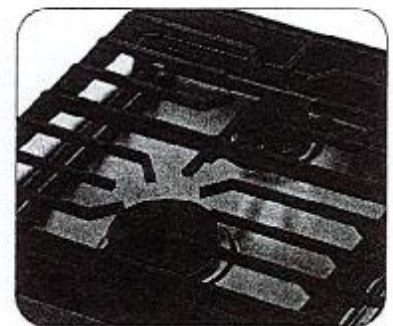

Continuous Cast Iron Grates

Features

- Powerful Cooktop
 - Right Front: 17K BTU (Power Burner)
 - Left Front: 10K BTU
 - Right Rear: 5K BTU (Simmer)
 - Left Rear: 13K BTU
- Cast Iron 2-Piece Grates
- Sealed Burners
- ADA Compliant

Convenience

- LP Conversion Kit



ADA Compliant

SAMSUNG

Countertop cut-out and minimum clearance dimensions:

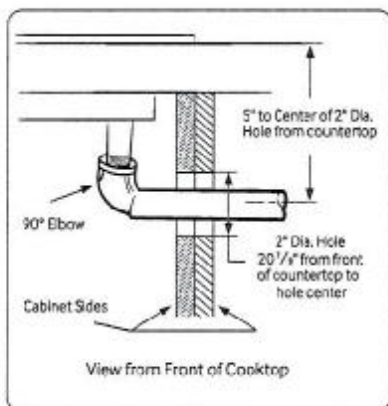

60.7 lbs (Fingerprint Resistant
Black Stainless Steel)

Black Stainless Steel NA30R5310FG/AA 88727629891

Technical drawing of the 30-inch wide cooktop. The drawing shows a perspective view of the cooktop with four burners. Dimensions are indicated with arrows and text:

- Overall width: 30"
- Overall depth: 21"
- Depth of the cooktop body: 19 3/8"
- Countertop to grate surface: 2 7/16"
- Chassis height: 3 1/4"
- Internal width dimension: 28 1/8"

LOT 126 THAMES PH. 5 A
RE: BUILT IN WALL OVEN/MICRO SPEC'S
NO FLUSH MOUNT ACCOMODATIONS

Whirlpool®

6.4 cu. ft. Smart Combination Wall Oven
WOC54EC0H



Stainless Steel
WOC54EC0HS

Also available in:

- ☐ White **WOC54EC0HW**
☒ Black **WOC54EC0HB**

Capacity

Oven 6.4 cu. ft.

General Features & Properties

Frozen Bake™ technology
Multi-Step Cooking
Steam Clean option
Scan-to-Connect Technology
Remote Start
Keep Warm Setting
Party Mode
Enhanced Troubleshooting
Guided Service

Electrical Details

Amps 40
Volts 240

Certifications

Connected/Smart Appliance Yes
Star-K Certified/Kosher Yes

Technical Details

Fuel Type Electric
Oven Type Combination
Oven Cooking System Thermal
Number of Oven Racks 2
Cleaning Type Self-Cleaning w/Steam

Dimensions

Product Dimensions (H x W x D) 42-9/16" x 30" x 26-1/2"
Depth with Door Open 90° 46-3/4"
Cutout Dimensions (H x W x D) 41-5/16" x 28-1/2" x 24"

Reference Material

[Install Guide](#)

[Use & Care Guide](#)

[Warranty](#)

Key Features & Benefits

Smart Appliance

Care smarter with connected features that let you send cooking instructions to the oven from your smartphone, control your kitchen with voice commands using a compatible voice-enabled device* or skip preheating.

Touchscreen

Get instant access to the settings you use most with a touchscreen that learns, adapts and suggests customized presets based on your family's routines.

Voice Control with a Compatible Voice-Enabled Device**

Control your kitchen no matter what you've got on your hands with simple voice commands using the Google Assistant or an Alexa-enabled device.

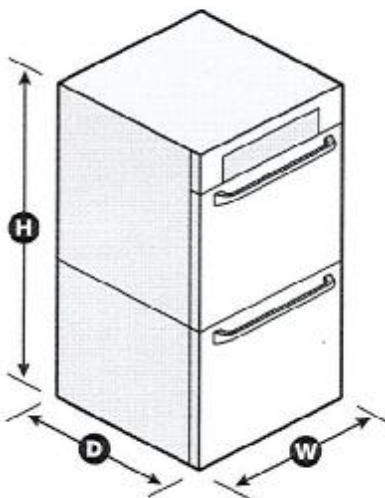

*Appliance must be set to remote enable. WiFi & App Required. Features subject to change. Details and privacy info at whirlpool.com/connect. **U.S. Only. NOTE: Dimensions are for planning purposes only. For complete details, see Installation Instructions packed with product. Specifications subject to change without notice.

©/™ 2020. All rights reserved. Printed in the U.S.A. D200104XXE. WOC54EC0HSpecSheetV01.

This manual downloaded from <http://www.manualowl.com>

LOT 126 THAMES PH. 5 A
RE: BUILT IN WALL OVEN/MICRO SPEC'S
CON'T
NO FLUSH MOUNT ACCOMODATIONS

A. Schuler



Whirlpool Model: WOC54EC0HS

6.4 cu. ft. Smart Combination Wall Oven with Touchscreen

Color  Stainless Steel

Product Description

Get the right settings every time with this self-cleaning combination wall oven. The touchscreen provides instant access to settings your family uses most. Also, use your smartphone or tablet to send multiple cooking instructions to the smart oven all at once.

Specifications

Certifications

Kosher Consumer Friendly	Yes
CUL	Yes
Prop 65	 CALIFORNIA RESIDENTS ONLY - WARNING: Cancer and Reproductive Harm - www.P65Warnings.ca.gov
Energy Rating	356

Features

Door Lock	Yes
Door Removable	Yes
Language Conversion	English/French/Spanish
Temperature Conversion	Yes
Automatic Shut-Off	Yes
Door Broil Position	Closed
Oven Cooking System	Thermal
Interior Color	Grey
Bake Element Power	2800W
Broiler Location	Top of Oven
Oven Rack 1 Type	Standard
Oven Rack 2 Type	Standard
Oven Light Type	Incandescent
Number of Oven Lights	2
Self-Cleaning Oven Racks	No
Number of Oven Racks	2
Number of Rack Guides	6
Oven Self-Cleaning	Self-Cleaning
Hidden Bake Element	Yes

Microwave Details

Door Swing	Drop Down
Turntable	Yes
Grill	No
Microwave Capacity	1-2/5
Number of Racks	0
Cooking Power	900
Microwave Selections	Add 30 Seconds Control Lock Cook Cook Power Cook Time Defrost Dinner Plate End of Cycle Signal Favorites Keep Warm Languages - English/French Off/Cancel Popcorn Reheat Soften/Melt Sound On/Off Steam
Scrolling Electronic Display	No
Convection	No
Interior Light	Halogen
Sensor Cooking	Yes - Microwave

Description

Fuel Type	Electric
Size	30
Oven Type	Combination

LOT 126 THAMES PH. 5 A
RE: BUILT IN WALL OVEN/MICRO SPEC'S
CON'T
NO FLUSH MOUNT ACCOMODATIONS

Handwritten signature

Details

Number of Rack Guides	6
Oven Capacity	5.0
Door Broil Position	Closed
Interior Color	Grey
Broiler Location	Top of Oven
Oven Rack 2 Type	Standard
Oven Light Type	Incandescent
Oven Interior Depth	48.26 19.0
Oven Interior Height	45.72 18.0
Oven Interior Width	63.50 25.0
Number of Oven Racks	2
Hidden Bake Element	Yes

Compatibility

Connectivity	Nest
Works With	WiFi App Remote Access Voice Controlled

Appearance

Handle Material	Stainless Steel
Door Type	Metal & Glass
Handle Color	White
Flush Installation Approved	Yes

Dimensions

Poids Brut	102.51 226
Net Weight	96.62 213
Depth Closed Excluding	62.23 24-1/2
Depth With Door Open 90	118.74 46-3/4
Height	108.11 42-9/16
Width	76.20 30.0
Oven Capacity	141.50 5.0
Depth	67.31 26-1/2

Controls

Scrolling Electronic Display	No
Number of Keypads	1

Configuration and Overview

Size	76.20 30
Fuel Type	Electric
Oven Type	Combination
CUL	Yes
ADA Compliant	No
UL	UL

Exterior

Handle Material	Stainless Steel
Door Lock	Yes
Flush Installation Approved	Yes

Key Features

Voice control with a compatible voice-enabled Frozen Bake™ technology
Steam Clean option
Scan-to-Connect Technology
Remote Start
Keep Warm Setting
Party Mode
Enhanced Troubleshooting
Guided Service
Temperature Sensor
Rapid Preheat
Control Lock Mode
6.4 cu. ft. Total Capacity
Extra-Large Window
Sabbath Mode
#1 Selling Appliance Brand in the U.S.A.

Electrical Requirements

Power Cord Included	No
Hz	60

UPC Listing

Model : WOC54EC0HB	UPC : 883049444918
Model : WOC54EC0HS	UPC : 883049444901
Model : WOC54EC0HW	UPC : 883049444925