

KINGSMEN (THAMES) INC. / Havelock Corners (Kingsmen)

Lot/Unit: 162 Block 146    Phase/Building: 5B    Model/Floor Plan: Richard (2602) Elev B1 Opt  
4 Bed - 2+1 Bath

ELECTRICAL

Inv.6034	1 - To supply & install the standard T.V. rough in in the great room and master bedroom... see sketch # 1 & # 2	
Line 76982	Note: Install the standard T.V. Rough in at approx. 66" + - up from the floor centered + - to the F/P mantle in the great room.	
23Jan23 / 31Jan23		
Inv.6034	1 - To supply & install the standard Phone ( CAT5 ) rough in in the great room, master bedroom and Bedroom # 4 ... see sketch # 1 & # 2	
Line 76983	Note: Install the standard Phone ( CAT 5) Rough in at approx. 66" + - up from the floor centered + - to the F/P mantle in the great room.	
23Jan23 / 31Jan23		
Inv.6034	1 - To SUPPLY AND INSTALL AN ADDITIONAL BASIC RECEPTACLE (NOT DEDICATED) at arpprox. 66" + - up from the floor centered + - to the F/P mantle	
Line 77053	Note: in the great room ... see sketch # 1	
23Jan23 / 31Jan23	This is for a future wall mout T.V. NO CONDUIT PIPE HAS BEEN PURCHASED.	
Inv.6034	1 - To SUPPLY AND INSTALL EXTRA CEILING BOX ROUGH IN CAPPED (DOES NOT INCLUDE SWITCH) over the island in the kitchen... see sketch # 1	
Line 77054	Note: This capped elec. will be connected to a sep. switch. Switch sold sep.	
23Jan23 / 31Jan23		
Inv.6034	1 - To supply & install AN ADDITIONAL SINGLE POLE SWITCH connected to the upgraded capped elec. over the island in the kitchen.	
Line 77055	Note:	
23Jan23 / 31Jan23		
Inv.6034	1 - Relocate the standard ceiling light in the great room... see sketch # 1	
Line 77056	Note:	
23Jan23 / 31Jan23		
Inv.6034	1 - To SUPPLY AND INSTALL EXTRA CEILING BOX ROUGH IN CAPPED (DOES NOT INCLUDE SWITCH) in the great room...see sketch # 1	
Line 77057	Note: This capped elec. will be connected to a sep. switch. Switch sold sep.	
23Jan23 / 31Jan23		
Inv.6034	1 - To supply & install AN ADDITIONAL SINGLE POLE SWITCH connected to the upgraded capped elec. in the great room.	
Line 77058	Note:	
23Jan23 / 31Jan23		
Inv.6034	1 - Relocate the standard ceiling light from the upper stair landing to the O.T.B. area on the second floor... see sketch # 2	
Line 77059	Note:	
23Jan23 / 31Jan23		

HEATING AND AIR CONDITIONING

Inv.6034	1 - As per schedule "PE": Vendor to install capped gas line ( Rough in only ) at rear of home for future BBQ location. Location to be finalized at vendors sole discretion.	
Line 76980	Note:	
23Jan23 / 31Jan23		
Inv.6034	1 - As per schedule "PE": Vendor to supply & install air conditioning unit, sized accordingly, from vendors standard samples.	
Line 76981	Note:	
23Jan23 / 31Jan23		



CONSTRUCTION SUMMARY

KINGSMEN (THAMES) INC. / Havelock Corners (Kingsmen)

Lot/Unit: 162 Block 146    Phase/Building: 5B    Model/Floor Plan: Richard (2602) Elev B1 Opt  
4 Bed - 2+1 Bath

EXTRAS AS PER OFFER

5 FREE APPLIANCES – STAINLESS STEEL FRONT - FRIDGE; STOVE AND DISHWASHER. WHITE WASHER AND DRYER (SUPPLIED ONLY, NOT INSTALLED, FROM BUILDERS STANDARD LINE). AN APPLIANCES VOUCHER WILL BE GIVEN BY OUR DECOR CONSULTANT AT THE TIME OF BOOKING YOUR COLOUR A <i>Worksheet</i> Note:	
VENDOR TO INSTALL CAPPED GAS LINE (ROUGH-IN ONLY) AT REAR OF HOME FOR FUTURE BBQ LOCATION.    LOCATION TO BE FINALIZED AT VENDORS SOLE DISCRETION. <i>Worksheet</i> Note:	
VENDOR TO SUPPLY & INSTALL AIR CONDITIONING UNIT, SIZED ACCORDINGLY, FROM VENDORS STANDARD SAMPLES. <i>Worksheet</i> Note:	

Purchasers: HASMUKHBHAI,V PATEL, & KAUSHIKABAHEN,Property: 162 Block 146 of Plan - Draft Approval SB  
 Telephone Res. / Bus: / Project: KINGSMEN (THAMES) INC.  
 Decor Advisor: Barbara Coccia Model and Elevation: Richard (2602) Elev B1 Opt 4 Bed - 2+1 Ba  
 Layout Changes: ☐ Yes ☒ No Sketch Attached: ☒ Yes ☐ No Exterior Colour Scheme:

1. Cabinetry	Style and Colour	Counter Top	Hardware
Kitchen / Breakfast	#3 Simcoe Rain Cloud	#1, C/S # 9141 Ice Snow 3cm.	# 12881 Handle
Kitchen Island	#3 Simcoe Rain Cloud	#1, C/S # 9141 Ice Snow 3cm.	# 12881 Handle
Laundry Room	/		
Powder Room	#3 Simcoe Navy Blue	# 6698-46 Paloma Polar	# 135 Knob
Main Bathroom	#3 Simcoe Moonlight	# 4988K-07 Mercury Vesta	# 135 Knob
Master Ensuite Bathroom	#3 Simcoe Moonlight	# 4988K-07 Mercury Vesta	# 135 Knob
Second Ensuite Bathroom (If Applicable)	/		
	/		
	/		

Appliances Custom Size Fridge Valance Lighting Microwave / Range Hood  
☐ Yes ☒ No ☐ Yes ☒ No ☐ Yes ☒ No  
 Cooktop / Rangetop Built in Wall Oven Slide-in Range  
☐ Yes ☒ No ☐ Yes ☒ No ☐ Yes ☒ No  
 Comment

2. Flooring	Selection
Foyer	13 x 13" Malena Carbon
Main Hall	13 x 13" Malena Carbon
Back Hall	/
Breakfast	( Dinette ) 13 x 13" Malena Carbon
Laundry Room	13 x 13" Malena Ice
Kitchen	13 x 13" Malena Carbon
Powder Room	13 x 13" Malena Carbon
Main Bathroom	13 x 13" Malena Ice
Master Ensuite	13 x 13" Malena Ice
Bathroom (If Applicable)	/
Mud Room	13 x 13" Malena Carbon
Master & Main bathroom	Shower floors: 2x2" Ontario Snow White matte
Living Room	/
Dining Room	/
Family / Great Room	3 1/2" Elements Oak Natural
Den / Library / Study	/
Basement Landing (If Applies)	
Lower Landing (If Applicable)	3 1/2" Elements Oak Natural
Upper Landing	( If applicable ) 3 1/2" Elements Oak Natural
Upper Hall	Modern Story 1, # 945 Felt Hat
Master Bedroom	Modern Story 1, # 945 Felt Hat
Bedroom #2	Modern Story 1, # 945 Felt Hat
Bedroom #3	Modern Story 1, # 945 Felt Hat
Bedroom #4	Modern Story 1, # 945 Felt Hat
Bedroom #5	/
Master & Main bathroom	Shower jamb: Anatolia Marmiline SNOW

FEB 1 - 2023

**Purchasers:** HASMUKHBHAI, V PATEL, & KAUSHIKABAHEN, **Property:** 162 Block 146 of Plan - Draft Approval SB  
**Telephone Res. / Bus:** / **Project:** KINGSMEN (THAMES) INC.  
**Decor Advisor:** Barbara Coccia **Model and Elevation:** Richard (2602) Elev B1 Opt 4 Bed - 2+1 Ba  
**2. Flooring - Continued -**

Upgrade Underpad	Type	Area
	Standard	2nd. Floor
Carpet on Stairs	Capped	Runner - *Upgrade
Comment	/	/
/		

### 3. Plumbing Fixtures / Faucets

Kitchen	Standard	Second Ensuite	/	Powder Room	Standard
Master Ensuite	Standard			Other Room	/
Main Bathroom	Standard		/		

**Comment**  
 Still to install the standard top mount kitchen sink.

### 4. Wall Tile

	Tile Selection	Listello	Insert	Insert Selection
Main Bathroom	8x10" Cinq Black	<input type="checkbox"/>	<input type="checkbox"/>	
Master Ensuite				
Tub Deck	13 x 13" Malena Ice	<input type="checkbox"/>	<input type="checkbox"/>	
Tub Apron	13 x 13" Malena Ice	<input type="checkbox"/>	<input type="checkbox"/>	
Tub Surround	13 x 13" Malena Ice	<input type="checkbox"/>	<input type="checkbox"/>	
Shower Stall	8x10" Cinq Black	<input type="checkbox"/>	<input type="checkbox"/>	
Second Ensuite	/	<input type="checkbox"/>	<input type="checkbox"/>	
	/	<input type="checkbox"/>	<input type="checkbox"/>	
	/	<input type="checkbox"/>	<input type="checkbox"/>	
Kitchen Backsplash	/	<input type="checkbox"/>	<input type="checkbox"/>	
Complete Backsplash	/	<input type="checkbox"/>	<input type="checkbox"/>	

**Comment**  
 /

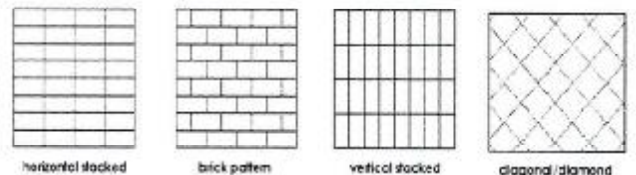

### 5. Fireplace

	Living Room			Family Room			Other Room - Specify Great Room		
	Purchased	As Per Plan	N/A	Purchased	As Per Plan	N/A	Purchased	As Per Plan	N/A
Fireplace Type	<input type="radio"/>	<input type="radio"/>	<input checked="" type="radio"/>	<input type="radio"/>	<input type="radio"/>	<input checked="" type="radio"/>	<input type="radio"/>	<input checked="" type="radio"/>	<input type="radio"/>
Mantle Type							Front Facing		
Over Mantle							NF-08		
Colour / Stain							/		
Surround							White		
Hearth							/		
Comment							/		
/									

Initial:



FEB 1 - 2023

**Purchasers:** HASMUKHBHAI, V PATEL, & KAUSHIKABAHEN, **Property:** 162 Block 146 of Plan - Draft Approval SB  
**Telephone Res. / Bus:** / **Project:** KINGSMEN (THAMES) INC.  
**Decor Advisor:** Barbara Coccia **Model and Elevation:** Richard (2602) Elev B1 Opt 4 Bed - 2+1 Ba

### 6. Trim Carpentry

Door Hardware Standard Handle

Interior Trim Standard

Comment

/

#### Interior Doors

☐ 2 Panel Arch Top

☒ 2 Panel Square Top

☐ 6 Panel

Initial for Door Style

K H.P.

### 7. Railings and Pickets

Railing Package Standard oak TURNED picket package

Railing Colour Elements natural

Picket Colour Elements natural

Wood Stairs ☐ No ☒ Oak

Tread Colour Elements natural

Comment

/

### 8. Plaster Mouldings and Medallions

Foyer /

Main Hall /

Living Room /

Dining Room /

Family Room /

Kitchen/Breakfast /

Den/Library /

Lower Landing /

Comment

/

### 9. Wall Paint

Kingsmen White

Smooth Ceilings ☐ First Floor

☐ First Floor incl. Second Floor Hall

☐ First and Second Floor

☒ Throughout

☐ Not Applicable

Trim Paint Kingsmen White

### 10. Additional Comments

/

### 11. Disclaimers and Notes

- Colours of all materials are as close as possible to builder's selection, but not necessarily identical due to variances in manufacturing.
- Any extras listed above are null and void unless accompanied by a separate invoice/amendment. Said invoice must be paid in full.
- The Purchaser acknowledges that after Interior Colour Selection form is signed and dated, no further changes will be permitted other than re-selection due to unavailability. *K H.P.* Purchaser's Initials
- The Purchaser acknowledges reading and accepting the "Kingsmen Group Decor Centre Disclaimers" form. This document contains other miscellaneous disclaimers.

This Interior Colour Selection is final and approved by:

Purchaser:

Signature: *K. H. Patel* Date: *01-31-23*

Signature: *H.V. Patel* Date: *Jan. 31/2023*

Vendor:

*[Signature]*

KINGSMEN (THAMES) INC.

FEB 1 - 2023

5B-162

5B-LOT 162

LOT 162  
BLOCK 146  
THAMES PH. 5 B  
SKETCH # 1

all 3 items  
@ 66" up from  
floor.

Relocated  
Std. light

capped  
elec. ma  
sep switch

capped elec.  
on a sep.  
switch

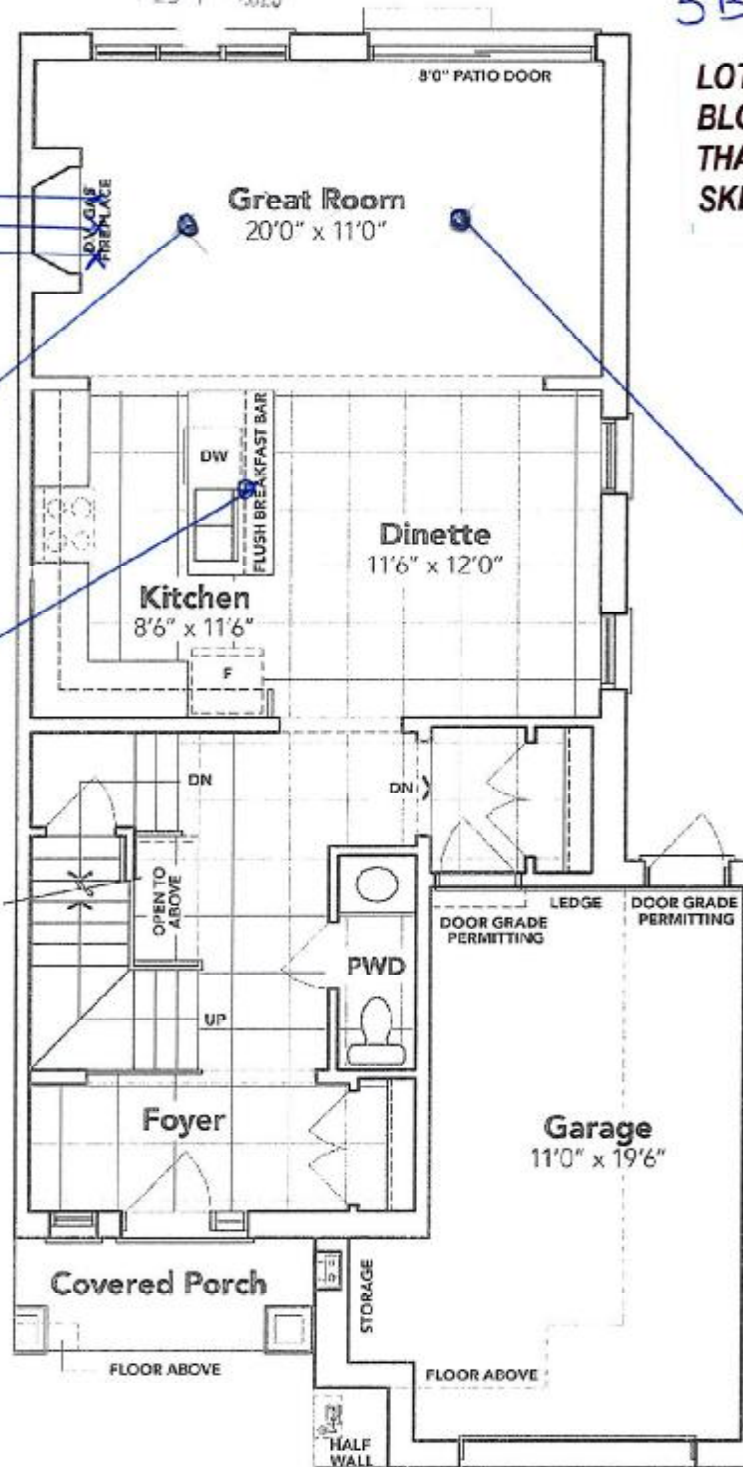

X H. Patel

H.V. Patel

### MAIN FLOOR EL. B1

The floor plans and elevations shown are pre-construction plans and may be revised or improved as necessitated by architectural controls and the construction process. The measurements adhere to the rules and regulations of the TARIION Warranty Corporation's official method for the calculation of floor area. Materials, specifications and floor plans are subject to change without notice. All house renderings are artist's concept only. Actual usable floor space may vary from the stated floor area. All options shown are upgrades. E. & O. E.

FEB 1 - 2023

SB LOT 162

SB-162

LOT 162  
BLOCK 146  
THAMES PH. 5 B  
SKETCH # 2

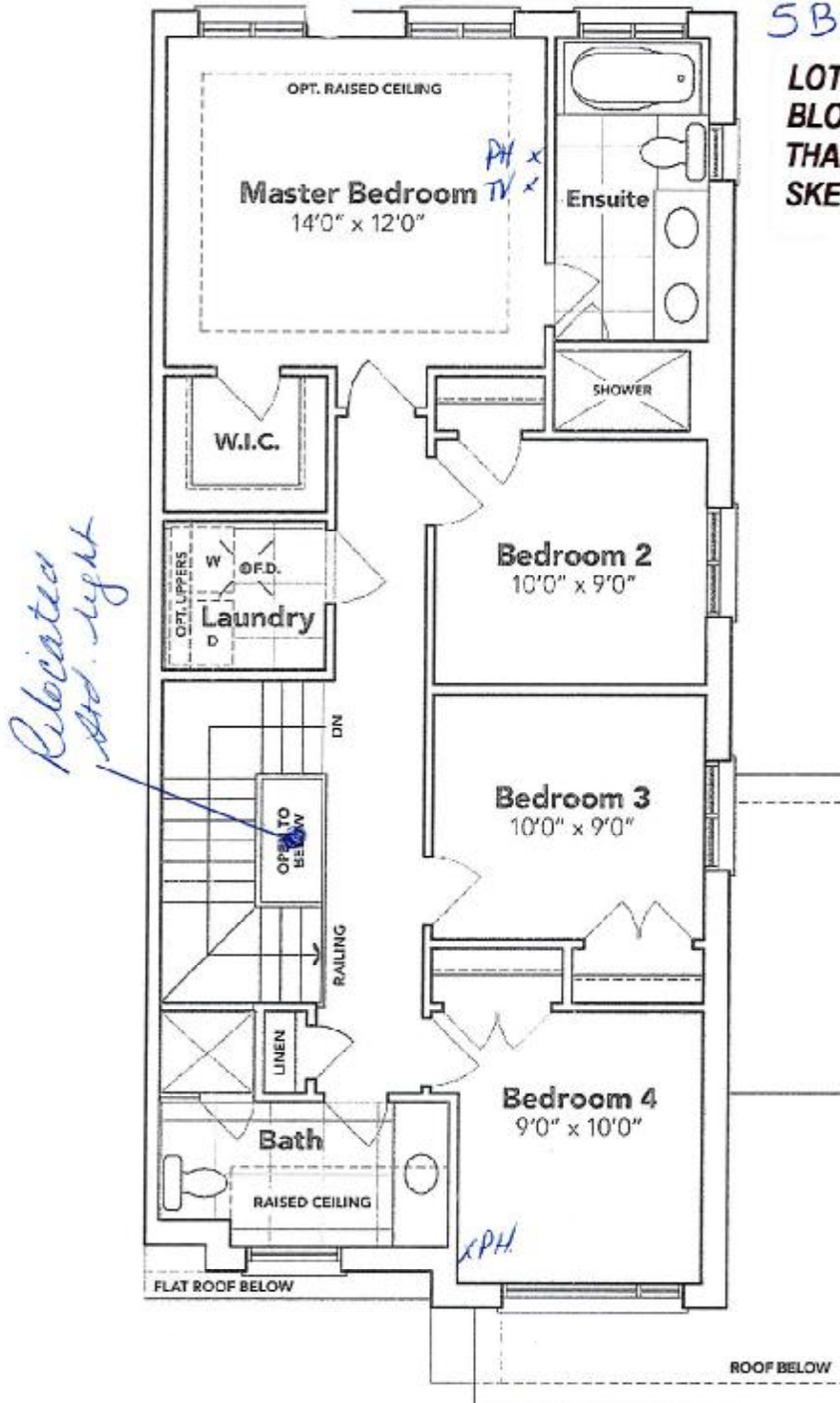

\* L. H. Patel

H. V. Patel

### OPT. SECOND FLOOR EL. B1

The floor plans and elevations shown are pre-construction plans and may be revised or improved as necessitated by architectural controls and the construction process. The measurements adhere to the rules and regulations of the TARIION Warranty Corporation's official method for the calculation of floor area. Materials, specifications and floor plans are subject to change without notice. All house renderings are artist's concept only. Actual usable floor space may vary from the stated floor area. All options shown are upgrades. E. & O. E.

*(Signature)*

*(Signature)*



LOT 162  
BLOCK 146  
THAMES PH. 5 B  
SKETCH # 3

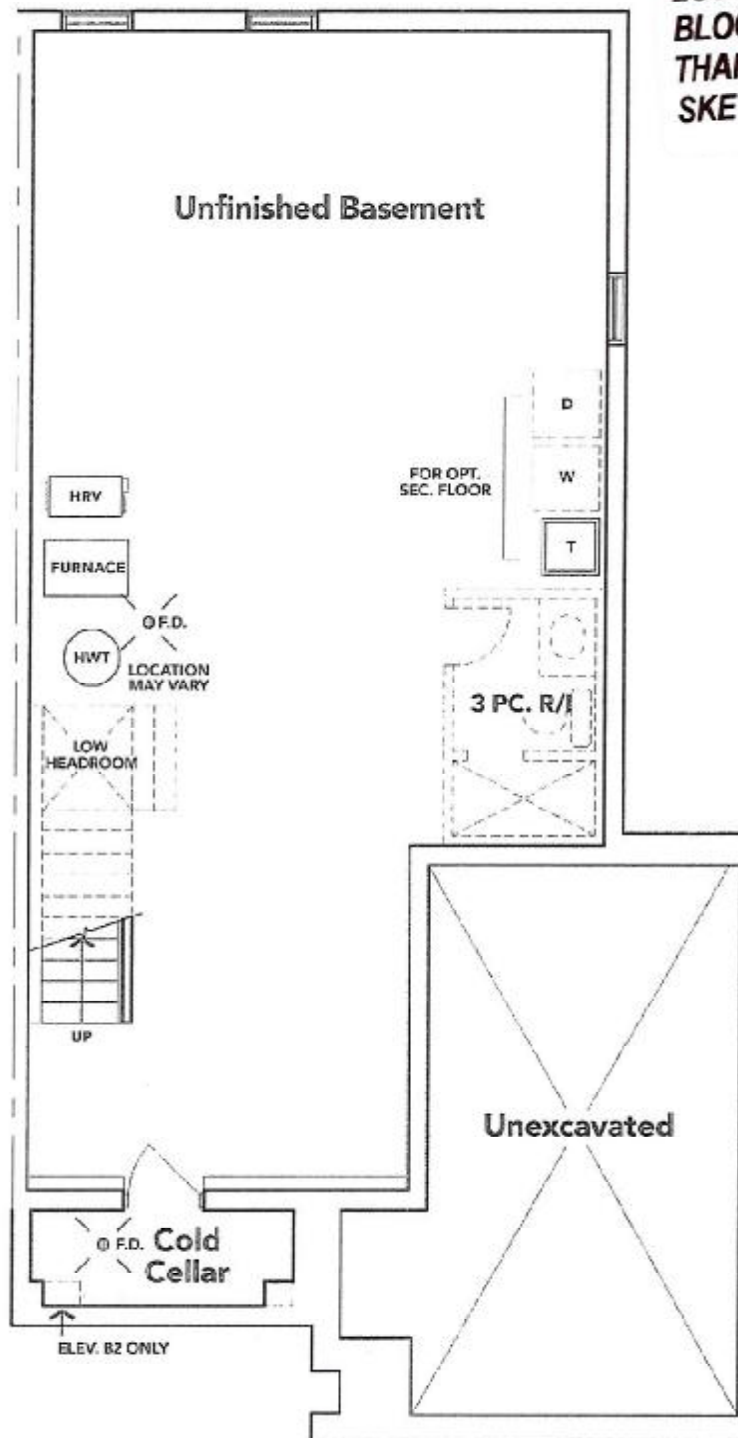

R. H. Puzel

H. V. Pado

### BASEMENT EL. B1

The floor plans and elevations shown are pre-construction plans and may be revised or improved as necessitated by architectural controls and the construction process. The measurements adhere to the rules and regulations of the TARIION Warranty Corporation's official method for the calculation of floor area. Materials, specifications and floor plans are subject to change without notice. All house renderings are artist's concept only. Actual usable floor space may vary from the stated floor area. All options shown are upgrades. E. & O. E.