

KINGSMEN (THAMES) INC. / Havelock Corners (Kingsmen)

Lot/Unit: 188 Block 151 Phase/Building: 5B Model/Floor Plan: William (2603) Elev B1 4
Bed - 2+1 Bath

CABINETRY VANITY

Inv.6056	1 - To supply & install a VANITY BANK OF DRAWERS in the master ensuite bathroom...see sketch # 2	
Line 77190	Note:	
9Feb23 / 13Feb23		
Inv.6056	1 - To supply & install a VANITY BANK OF DRAWERS in the main bathroom...see sketch # 2	
Line 77191	Note:	
9Feb23 / 13Feb23		

CARPET

Inv.6056	1 - To supply & install the ESCAPE TO MAUI carpet to the master bedroom, bedroom # 2, bedroom #3 and bedroom# 4 in lieu of the standard carpet. See colour chart for details.	
Line 77193	Note:	
9Feb23 / 13Feb23		

COUNTER TOP - ACCESSORIES

Inv.6056	1 - To supply & install a QUARTZ SHOWER NICHE " IMPERIAL WHITE " in the master ensuite shower... see sketch # 2 for installation location.	
Line 77189	Note:	
9Feb23 / 13Feb23		

ELECTRICAL

Inv.6056	1 - To supply & install the standard T.V. rough in in the great room and master bedroom... see sketch # 1 & # 2	
Line 77165	Note: Install the standard T.V. Rough in at approx. 66" + - up from the floor in the great room and master bedroom.	
9Feb23 / 13Feb23		
Inv.6056	1 - To supply & install the standard Phone (CAT5) rough in in the great room, master bedroom and Bedroom # 3 ... see sketch # 1 & # 2	
Line 77166	Note: Install the standard Phone (CAT 5) Rough in at approx. 66" + - up from the floor in the great room and master bedroom.	
9Feb23 / 13Feb23		
Inv.6056	1 - To SUPPLY AND INSTALL AN ADDITIONAL BASIC RECEPTACLE (NOT DEDICATED) at approx. 66" + - up from the floor centered +- to the F/P mantle	
Line 77183	Note: in the great room... see sketch # 1	
9Feb23 / 13Feb23		
This is for a futue wall mount T.V. NO CONDUIT PIPE HAS BEEN PURCHASD.		
Inv.6056	1 - To SUPPLY AND INSTALL AN ADDITIONAL BASIC RECEPTACLE (NOT DEDICATED)at approx. 66" + - up from the floor in the master bedroom..see sketch # 2	
Line 77184	Note: This is for a futue wall mount T.V. NO CONDUIT PIPE HAS BEEN PURCHASD.	
9Feb23 / 13Feb23		
Inv.6056	1 - To SUPPLY AND INSTALL RG6 CABLE ROUGH IN in bedroom # 3.. see sketch # 2	
Line 77185	Note:	
9Feb23 / 13Feb23		
Inv.6056	1 - To SUPPLY AND INSTALL EXTRA CEILING BOX ROUGH IN CAPPED (DOES NOT INCLUDE SWITCH) over the island in the kitchen...see sketch # 1	
Line 77186	Note: This cap will be connected to a sep. switch, switch sold sep.	
9Feb23 / 13Feb23		

KINGSMEN (THAMES) INC. / Havelock Corners (Kingsmen)

Lot/Unit: 188 Block 151 Phase/Building: 5B Model/Floor Plan: William (2603) Elev B1 4
Bed - 2+1 Bath

Inv.6056	1 - To supply & install AN ADDITIONAL SINGLE POLE SWITCH connected to the upgraded capped elec. over the island in the kitchen.	
Line 77187	Note:	
9Feb23 / 13Feb23		

HARDWOOD

Inv.6056	1 - To supply & install the 3 1/2" Elements Oak Natural engineered hardwood floor to the uppper hallway in lieu of the standard carpet.	
Line 77192	Note:	
9Feb23 / 13Feb23		

HEATING AND AIR CONDITIONING

Inv.6056	1 - As per schedule "PE": Vendor to install capped gas line (Rough in only) at rear of home for future BBQ location. Location to be finalized at vendors sole discretion.	
Line 77163	Note:	
9Feb23 / 13Feb23		
Inv.6056	1 - As per schedule "PE": Vendor to supply & install air conditioning unit, sized accordingly, from vendors standard samples.	
Line 77164	Note:	
9Feb23 / 13Feb23		

PLUMBING

Inv.6056	1 - To supply & install a WATERLINE ROUGH-IN TO THE FRIDGE LOCATION (NO HOOK UP) in the kitchen.	
Line 77188	Note:	
9Feb23 / 13Feb23		

EXTRAS AS PER OFFER

5 FREE APPLIANCES – STAINLESS STEEL FRONT - FRIDGE; STOVE AND DISHWASHER. WHITE WASHER AND DRYER (SUPPLIED ONLY, NOT INSTALLED, FROM BUILDERS STANDARD LINE). AN APPLIANCES VOUCHER WILL BE GIVEN BY OUR DECOR CONSULTANT AT THE TIME OF BOOKING YOUR COLOUR A <i>Worksheet</i> Note:	
VENDOR TO INSTALL CAPPED GAS LINE (ROUGH-IN ONLY) AT REAR OF HOME FOR FUTURE BBQ LOCATION. LOCATION TO BE FINALIZED AT VENDORS SOLE DISCRETION. <i>Worksheet</i> Note:	
VENDOR TO SUPPLY & INSTALL AIR CONDITIONING UNIT, SIZED ACCORDINGLY, FROM VENDORS STANDARD SAMPLES. <i>Worksheet</i> Note:	

FEB 13 2023

Purchaser: MANGA SINGH,

Property: 188 Block 151 of Plan - Draft Approval SB

Telephone Res. / Bus: /

Project: KINGSMEN (THAMES) INC.

Decor Advisor: Barbara Coccia

Model and Elevation: William (2603) Elev B1 4 Bed - 2+1 Bath

Layout Changes: ☐ Yes ☒ No

Sketch Attached: ☒ Yes ☐ No

Exterior Colour Scheme:

1. Cabinetry

	Style and Colour	Counter Top	Hardware
Kitchen / Breakfast	#2 Georgian Rain Cloud	# 1, C/S # 3040 Cement 3cm.	# 12881 Handle
Kitchen Island	#2 Georgian Rain Cloud	# 1, C/S # 3040 Cement 3cm.	# 12881 Handle
Laundry Room	/		
Powder Room	#2 Georgian Rain Cloud	# 4924-38 White Carrara	# 12881 Handle
Main Bathroom	#2, Slab LPL Stainless	# 4924-38 White Carrara	# 12881 Handle
Master Ensuite Bathroom	#2, Slab LPL Stainless	# 4924-38 White Carrara	# 12881 Handle
Second Ensuite Bathroom (If Applicable)	/		
	/		
	/		

Appliances

Custom Size Fridge

☐ Yes ☒ No

Valance Lighting

☐ Yes ☒ No

Microwave / Range Hood

☐ Yes ☒ No

Cooktop / Rangetop

☐ Yes ☒ No

Built in Wall Oven

☐ Yes ☒ No

Slide-in Range

☐ Yes ☒ No

Comment

/

2. Flooring

	Selection
Foyer	13 x 13" Cinq Black
Main Hall	3 1/2" Elements oak Natural
Back Hall	/
Breakfast	13 x 13" Cinq Black
Laundry Room	13 x 13" Cinq Grey
Kitchen	13 x 13" Cinq Black
Powder Room	(& small hallway in front of powder room) 13 x 13" Cinq Black
Main Bathroom	13 x 13" Cinq Grey
Master Ensuite	13 x 13" Cinq Grey
Bathroom (If Applicable)	/
Mud Room	13 x 13" Cinq Black
Master ens. shower floor:	2x2" Ontario Snow White Matte
Living Room	/
Dining Room	3 1/2" Elements oak Natural
Family / Great Room	3 1/2" Elements oak Natural
Den / Library / Study	/
Basement Landing (If Applies)	
Lower Landing (If Applicable)	3 1/2" Elements oak Natural
Upper Landing	(If applicable) 3 1/2" Elements oak Natural
Upper Hall	**3 1/2" Elements oak Natural
Master Bedroom	** Escape to Maui # 89816 Pilgrim's Path
Bedroom #2	** Escape to Maui # 89816 Pilgrim's Path
Bedroom #3	** Escape to Maui # 89816 Pilgrim's Path
Bedroom #4	** Escape to Maui # 89816 Pilgrim's Path
Bedroom #5	/
Master ens. shower jamb:	Anatolia Marmiline SNOW

Flooring Continued on Page 2



Initial:

Page 1 of 3

FEB 13 2023

Purchaser: MANGA SINGH, Property: 188 Block 151 of Plan - Draft Approval SB
 Telephone Res. / Bus: / Project: KINGSMEN (THAMES) INC.
 Decor Advisor: Barbara Coccia Model and Elevation: William (2603) Elev B1 4 Bed - 2+1 Bath
 2. Flooring - Continued -

Upgrade Underpad	Type	Area
	Standard	Master bedroom, bedroom #2, #3 & #4
Carpet on Stairs	Capped	Runner - *Upgrade
Comment	/	/
/		

3. Plumbing Fixtures / Faucets

Kitchen	Standard	Second Ensuite	/	Powder Room	Standard
Master Ensuite	Standard			Other Room	/
Main Bathroom	Standard		/		
Comment					
Still to install the standard top mount kitchen sink.					

4. Wall Tile

	Tile Selection	Listello	Insert	Insert Selection
Main Bathroom	8x10" Keaton Ice	<input type="checkbox"/>	<input type="checkbox"/>	
Master Ensuite				
Tub Deck	13 x13" Cinq Grey	<input type="checkbox"/>	<input type="checkbox"/>	
Tub Apron	13 x13" Cinq Grey	<input type="checkbox"/>	<input type="checkbox"/>	
Tub Surround	13 x13" Cinq Grey	<input type="checkbox"/>	<input type="checkbox"/>	
Shower Stall	8x10" Keaton Ice	<input type="checkbox"/>	<input type="checkbox"/>	
Second Ensuite	/	<input type="checkbox"/>	<input type="checkbox"/>	
	/	<input type="checkbox"/>	<input type="checkbox"/>	
	/	<input type="checkbox"/>	<input type="checkbox"/>	
Kitchen Backsplash	/	<input type="checkbox"/>	<input type="checkbox"/>	
Complete Backsplash	/	<input type="checkbox"/>	<input type="checkbox"/>	

Comment
 To supply & install the standard 8x10" wall tiles on the 10" side stacked horizontally in the bathrooms where applicable.

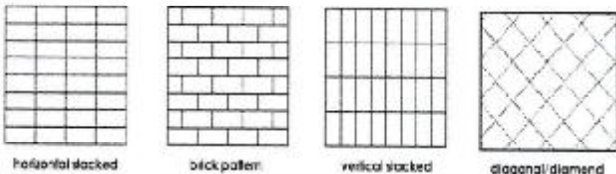

5. Fireplace

	Living Room			Family Room			Other Room - Specify Great Room		
	Purchased	As Per Plan	N/A	Purchased	As Per Plan	N/A	Purchased	As Per Plan	N/A
	<input type="radio"/>	<input type="radio"/>	<input checked="" type="radio"/>	<input type="radio"/>	<input type="radio"/>	<input checked="" type="radio"/>	<input type="radio"/>	<input checked="" type="radio"/>	<input type="radio"/>
Fireplace Type							Front Facing		
Mantle Type							NF-08		
Over Mantle							/		
Colour / Stain							White		
Surround							/		
Hearth							/		
Comment									
/									

Initial:

AB

FEB 13 2023

Purchaser: MANGA SINGH,

Property: 188 Block 151 of Plan - Draft Approval SB

Telephone Res. / Bus: /

Project: KINGSMEN (THAMES) INC.

Decor Advisor: Barbara Coccia

Model and Elevation: William (2603) Elev B1 4 Bed - 2+1 Bath

6. Trim Carpentry

Door Hardware Standard handle

Interior Trim Standard

Comment

/

Interior Doors

☐ 2 Panel Arch Top

☒ 2 Panel Square Top

☐ 6 Panel

Initial for Door Style



47

7. Railings and Pickets

Railing Package Standard Oak STRAIGHT picket package

Railing Colour Elements Natural

Picket Colour Elements Natural

Wood Stairs ☐ No ☒ Oak

Tread Colour Elements Natural

Comment

/

8. Plaster Mouldings and Medallions

Foyer /

Kitchen/Breakfast /

Main Hall /

Den/Library /

Living Room /

Lower Landing /

Dining Room /

Family Room /

Comment

/

9. Wall Paint

Kingsmen White

Smooth Ceilings

☐ First Floor

☐ First Floor incl. Second Floor Hall

☐ First and Second Floor

☒ Throughout

☐ Not Applicable

Trim Paint Kingsmen White

10. Additional Comments

/

11. Disclaimers and Notes

- Colours of all materials are as close as possible to builder's selection, but not necessarily identical due to variances in manufacturing.
- Any extras listed above are null and void unless accompanied by a separate invoice/amendment. Said invoice must be paid in full.
- The Purchaser acknowledges that after Interior Colour Selection form is signed and dated, no further changes will be permitted other than re-selection due to unavailability. MS Purchaser's Initials
- The Purchaser acknowledges reading and accepting the "Kingsmen Group Décor Centre Disclaimers" form. This document contains other miscellaneous disclaimers.

This Interior Colour Selection is final and approved by:

Purchaser:

Signature: Manga Singh

Date: Feb 13/2023

Vendor:

KINGSMEN (THAMES) INC.

Feb 15/23

FEB 13 2023

5B-188

all 3 items @
66" up from
floor,
PH
TV

LOT 188
BLOCK 151
THAMES PH. 5 B
SKETCH # 1

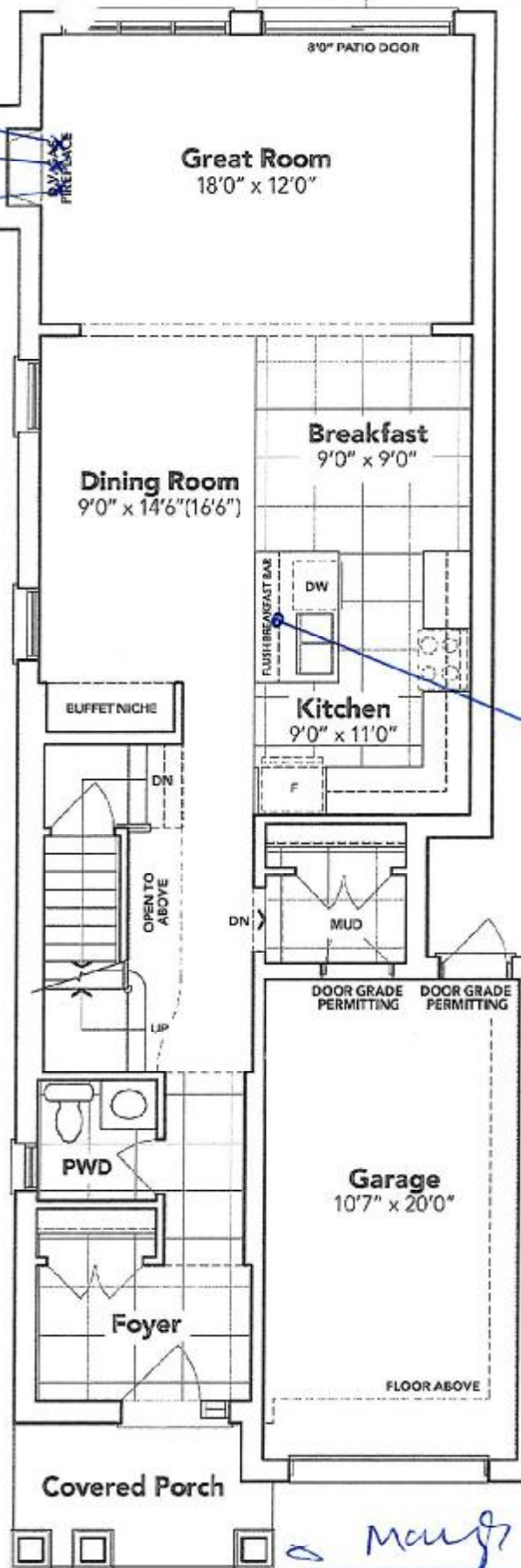

MAIN FLOOR EL. B1

The floor plans and elevations shown are pre-construction plans and may be revised or improved as necessitated by architectural controls and the construction process. The measurements adhere to the rules and regulations of the TARION Warranty Corporation's official method for the calculation of floor area. Materials, specifications and floor plans are subject to change without notice. All house renderings are artist's concept only. Actual usable floor space may vary from the stated floor area. All options shown are upgrades. E. & O. E.

FEB 13 2023

SB-188

*All 3 items
@ 66" up from
floor.*

**LOT 188
BLOCK 151
THAMES PH. 5 B
SKETCH # 2**

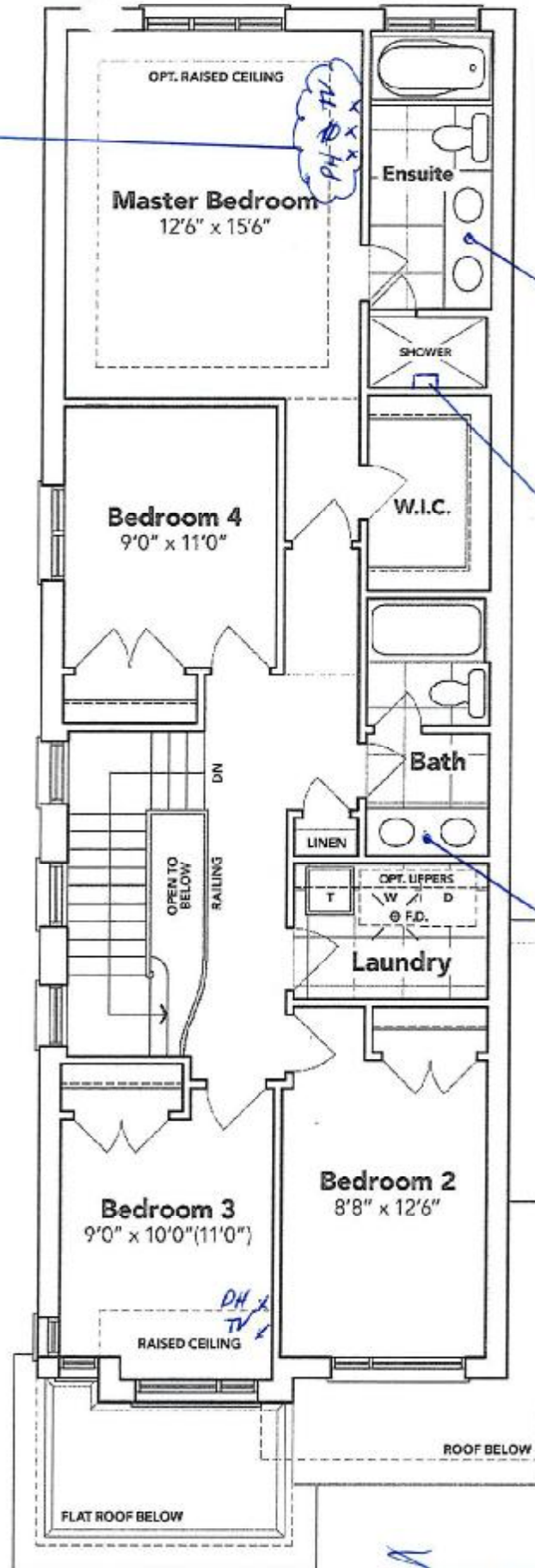

SECOND FLOOR EL. B1

The floor plans and elevations shown are pre-construction plans and may be revised or improved as necessitated by architectural controls and the construction process. The measurements adhere to the rules and regulations of the TARIION Warranty Corporation's official method for the calculation of floor area. Materials, specifications and floor plans are subject to change without notice. All house renderings are artist's concept only. Actual usable floor space may vary from the stated floor area. All options shown are upgrades. E. & O. E.

SCHEDULE "B-1"
Floor Plan

FEB 13 2023

5B-188
Townhouse No. 188 Block 151
Phase 5B
Model: william (2603) Elev B1 4 Bed - 2+1 Bath
End - Standard

LOT 188
BLOCK 151
THAMES PH. 5 B
SKETCH # 3

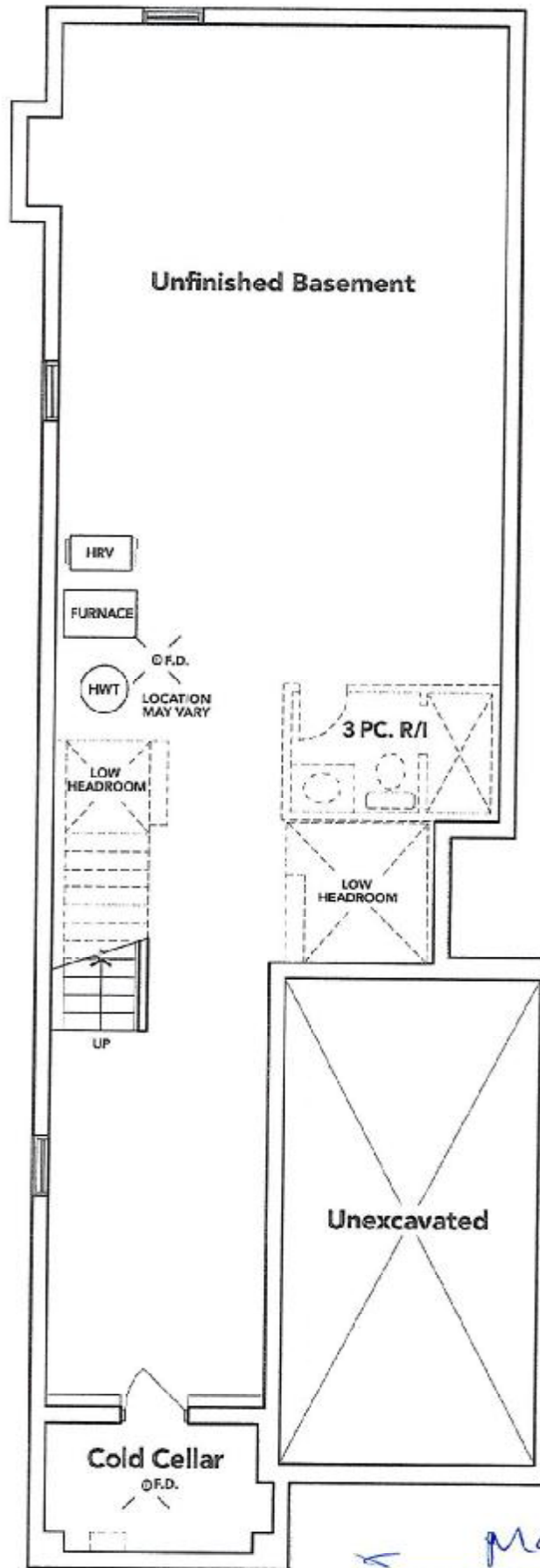

BASEMENT EL. B1

The floor plans and elevations shown are pre-construction plans and may be revised or improved as necessitated by architectural controls and the construction process. The measurements adhere to the rules and regulations of the TARIION Warranty Corporation's official method for the calculation of floor area. Materials, specifications and floor plans are subject to change without notice. All house renderings are artist's concept only. Actual usable floor space may vary from the stated floor area. All options shown are upgrades. E. & O. E.