

KINGSMEN (THAMES) INC. / Havelock Corners (Kingsmen)

Lot/Unit: 195 Block 153 Phase/Building: 5B Model/Floor Plan: William (2603) Elev B1 4
Bed - 2+1 Bath

ELECTRICAL

Inv.6060	1 - To supply & install the standard T.V. rough in in the great room and master bedroom... see sketch # 1 & # 2	
Line 77181	Note: Install the standard T.V. rough in at approx. 66" + - up from the floor centered + - to the F/P mantle in the great room.	
9Feb23 / 17Feb23		
Inv.6060	1 - To supply & install the standard Phone (CAT5) rough in in the great room, master bedroom and Bedroom # 3 ... see sketch # 1 & # 2	
Line 77182	Note: Install the standard Phone (CAT 5) rough in at approx. 66" + - up from the floor centered + - to the F/P mantle in the great room.	
9Feb23 / 17Feb23		
Inv.6060	1 - To SUPPLY AND INSTALL AN ADDITIONAL BASIC RECEPTACLE (NOT DEDICATED) at approx. 66" + - up from the floor centered +- to the F/P mantle	
Line 77240	Note: in the great room... see sketch # 1	
9Feb23 / 17Feb23		
This is for a future wall mount T.V. NO CONUDIT PIPE HAS BEEN PURCHASED.		
Inv.6060	1 - To SUPPLY AND INSTALL EXTRA CEILING BOX ROUGH IN CAPPED (DOES NOT INCLUDE SWITCH) over the island in the kitchen.. see sketch # 1	
Line 77241	Note: This capped elec. will be connected to a sep. switch, switch sold sep.	
9Feb23 / 17Feb23		
Inv.6060	1 - To suply & install AN ADDITIONAL SINGLE POLE SWITCH connected to the upgraded capped elec. over the island in the kitchen.	
Line 77242	Note:	
9Feb23 / 17Feb23		
Inv.6060	1 - Relocate the standard ceiling light from the upper stair landing to the O.T.B. area on the second floor... see sketch #2	
Line 77243	Note:	
9Feb23 / 17Feb23		

HEATING AND AIR CONDITIONING

Inv.6060	1 - As per schedule "PE": Vendor to install capped gas line (Rough in only) at rear of home for future BBQ location. Location to be finalized at vendors sole discretion.	
Line 77179	Note:	
9Feb23 / 17Feb23		
Inv.6060	1 - As per schedule "PE": Vendor to supply & install air conditioning unit, sized accordingly, from vendors standard samples.	
Line 77180	Note:	
9Feb23 / 17Feb23		

TILE - WALL

Inv.6060	1 - To supply & install the UPGRADE 1 - BACKSPLASH TILE - - KITCHEN SPLASH TILE in a 70/30 + - off set horizontal pattern... see colour chart for details.	
Line 77244	Note:	
9Feb23 / 17Feb23		



CONSTRUCTION SUMMARY

KINGSMEN (THAMES) INC. / Havelock Corners (Kingsmen)

Lot/Unit: 195 Block 153 Phase/Building: 5B Model/Floor Plan: William (2603) Elev B1 4
Bed - 2+1 Bath

EXTRAS AS PER OFFER

5 FREE APPLIANCES – STAINLESS STEEL FRONT - FRIDGE; STOVE AND DISHWASHER. WHITE WASHER AND DRYER (SUPPLIED ONLY, NOT INSTALLED, FROM BUILDERS STANDARD LINE). AN APPLIANCES VOUCHER WILL BE GIVEN BY OUR DECOR CONSULTANT AT THE TIME OF BOOKING YOUR COLOUR A <i>Worksheet</i> Note:	
VENDOR TO INSTALL CAPPED GAS LINE (ROUGH-IN ONLY) AT REAR OF HOME FOR FUTURE BBQ LOCATION. LOCATION TO BE FINALIZED AT VENDORS SOLE DISCRETION. <i>Worksheet</i> Note:	
VENDOR TO SUPPLY & INSTALL AIR CONDITIONING UNIT, SIZED ACCORDINGLY, FROM VENDORS STANDARD SAMPLES. <i>Worksheet</i> Note:	

FEB 17 2023

Purchasers: SURINDER, SINGH VIRK, & TEJINDERPAL, KAUPROPERTY: 195 Block 153 of Plan - Draft Approval SB

Telephone Res. / Bus: /

Project: KINGSMEN (THAMES) INC.

Decor Advisor: Barbara Coccia

Model and Elevation: William (2603) Elev B1 4 Bed - 2+1 Bath

Layout Changes: ☐ Yes ☒ NoSketch Attached: ☒ Yes ☐ No

Exterior Colour Scheme:

1. Cabinetry

	Style and Colour	Counter Top	Hardware
Kitchen / Breakfast	#3 Simcoe Rain Cloud	#1, C/S # 9141 Ice Snow 3cm.	#12881 handle
Kitchen Island	#3 Simcoe Rain Cloud	#1, C/S # 9141 Ice Snow 3cm.	#12881 handle
Laundry Room	/		
Powder Room	#3 Simcoe Rain Cloud	# 6698-46 Paloma Polar	#12881 handle
Main Bathroom	#3 Simcoe Rain Cloud	# 6698-46 Paloma Polar	#12881 handle
Master Ensuite Bathroom	#3 Simcoe Rain Cloud	# 6698-46 Paloma Polar	#12881 handle
Second Ensuite Bathroom (If Applicable)	/		
	/		
	/		

Appliances

Custom Size Fridge

☐ Yes ☒ No

Valance Lighting

☐ Yes ☒ No

Microwave / Range Hood

☐ Yes ☒ No

Cooktop / Rangetop

☐ Yes ☒ No

Built in Wall Oven

☐ Yes ☒ No

Slide-in Range

☐ Yes ☒ No

Comment

2. Flooring

	Selection
Foyer	13 x13" Keaton Ice
Main Hall	3 1/2" Elements Oak Natural
Back Hall	/
Breakfast	13 x13" Keaton Ice
Laundry Room	13 x13" Keaton Ice
Kitchen	13 x13" Keaton Ice
Powder Room	(& small hallway infront of powder room) 13 x13" Keaton Ice
Main Bathroom	13 x13" Keaton Ice
Master Ensuite	13 x13" Keaton Ice
Bathroom (If Applicable)	/
Mud Room	13 x13" Keaton Ice
Master ens. shower floor:	2x2" Ontario Snow White Matte
Living Room	/
Dining Room	3 1/2" Elements Oak Natural
Family / Great Room	3 1/2" Elements Oak Natural
Den / Library / Study	/
Basement Landing (If Applies)	
Lower Landing (If Applicable)	3 1/2" Elements Oak Natural
Upper Landing	(If applicable) 3 1/2" Elements Oak Natural
Upper Hall	Modern Story 1, # 810 Rocky Top
Master Bedroom	Modern Story 1, # 810 Rocky Top
Bedroom #2	Modern Story 1, # 810 Rocky Top
Bedroom #3	Modern Story 1, # 810 Rocky Top
Bedroom #4	Modern Story 1, # 810 Rocky Top
Bedroom #5	/
Master ens. shower jamb:	Anatolia Marmiline SNOW

Flooring Continued on Page 2

Initial:



Page 1 of 3

FEB 17 2023

Purchasers: SURINDER, SINGH VIRK, & TEJINDER PAL, KAUP **Property:** 195 Block 153 of Plan - Draft Approval SB
Telephone Res. / Bus: / **Project:** KINGSMEN (THAMES) INC.
Decor Advisor: Barbara Coccia **Model and Elevation:** William (2603) Elev B1 4 Bed - 2+1 Bath
 2. Flooring - Continued -

Upgrade Underpad	Type	Area
	Standard	2nd. Floor
Carpet on Stairs	Capped	Runner - *Upgrade
Comment	/	/

3. Plumbing Fixtures / Faucets

Kitchen	Standard	Second Ensuite	/	Powder Room	Standard
Master Ensuite	Standard			Other Room	/
Main Bathroom	Standard		/		

Comment

Still to install the standard top mount kitchen sink.

4. Wall Tile

	Tile Selection	Listello	Insert	Insert Selection
Main Bathroom	8x10" Keaton Ice	<input type="checkbox"/>	<input type="checkbox"/>	
Master Ensuite				
Tub Deck	13 x13" Keaton Ice	<input type="checkbox"/>	<input type="checkbox"/>	
Tub Apron	13 x13" Keaton Ice	<input type="checkbox"/>	<input type="checkbox"/>	
Tub Surround	13 x13" Keaton Ice	<input type="checkbox"/>	<input type="checkbox"/>	
Shower Stall	8x10" Keaton Ice	<input type="checkbox"/>	<input type="checkbox"/>	
Second Ensuite	/	<input type="checkbox"/>	<input type="checkbox"/>	
	/	<input type="checkbox"/>	<input type="checkbox"/>	
	/	<input type="checkbox"/>	<input type="checkbox"/>	
Kitchen Backsplash	*4x16" Soho Loft Grey Glossy Press 70/30+ - Horizontal	<input type="checkbox"/>	<input type="checkbox"/>	
Complete Backsplash	/	<input type="checkbox"/>	<input type="checkbox"/>	

Comment

/

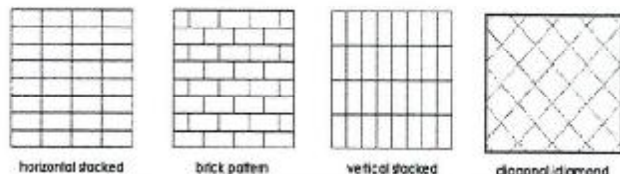

5. Fireplace

Living Room

Purchased ☐ As Per Plan ☐ N/A ☒

Family Room

Purchased ☐ As Per Plan ☐ N/A ☒

Other Room - Specify Great Room

Purchased ☐ As Per Plan ☒ N/A ☐

Fireplace Type

Mantle Type

Over Mantle

Colour / Stain

Surround

Hearth

Comment

/

Front Facing

NF-08

/

White

/

/

(Handwritten initials and stamps)

Initial: _____

Page 2 of 3

FEB 17 2023

Purchasers: SURINDER, SINGH VIRK, & TEJINDER PAL, KAUP **Property:** 195 Block 153 of Plan - Draft Approval SB
Telephone Res. / Bus: / **Project:** KINGSMEN (THAMES) INC.
Decor Advisor: Barbara Coccia **Model and Elevation:** William (2603) Elev B1 4 Bed - 2+1 Bath

6. Trim Carpentry

Door Hardware Standard handle

Interior Trim Standard

Comment

/

Interior Doors

☐ 2 Panel Arch Top

☒ 2 Panel Square Top

☐ 6 Panel



Initial for Door Style

Handwritten initials and a circled 'B'.

7. Railings and Pickets

Railing Package Standard Oak TURNED picket package

Railing Colour Elements Natural

Picket Colour Elements Natural

Wood Stairs ☐ No ☒ Oak

Tread Colour Elements Natural

Comment

/

8. Plaster Mouldings and Medallions

Foyer	/	
Main Hall	/	
Living Room	/	
Dining Room	/	
Family Room	/	

Kitchen/Breakfast	/	
Den/Library	/	
Lower Landing	/	

Comment

/

9. Wall Paint

Kingsmen White

Smooth Ceilings ☐ First Floor
☐ First Floor incl. Second Floor Hall
☐ First and Second Floor
☒ Throughout
☐ Not Applicable

Trim Paint Kingsmen White

10. Additional Comments

/

11. Disclaimers and Notes

- Colours of all materials are as close as possible to builder's selection, but not necessarily identical due to variances in manufacturing.
- Any extras listed above are null and void unless accompanied by a separate invoice/amendment. Said invoice must be paid in full.
- The Purchaser acknowledges that after Interior Colour Selection form is signed and dated, no further changes will be permitted other than re-selection due to unavailability. *Handwritten initials and a circled 'B'.* Purchaser's Initials
- The Purchaser acknowledges reading and accepting the "Kingsmen Group Décor Centre Disclaimers" form. This document contains other miscellaneous disclaimers.

This Interior Colour Selection is final and approved by:

Purchaser: *Handwritten signature* Date: 02/17/23

Signature: *Handwritten signature* Date: 02/17/23

Vendor: *Handwritten signature*
KINGSMEN (THAMES) INC.

FEB 17/23

FEB 17 2023

SB-60195

all 3.1m x 6.6" + up from floor

LOT 195
BLOCK 153
THAMES PH. 5 B
SKETCH # 1

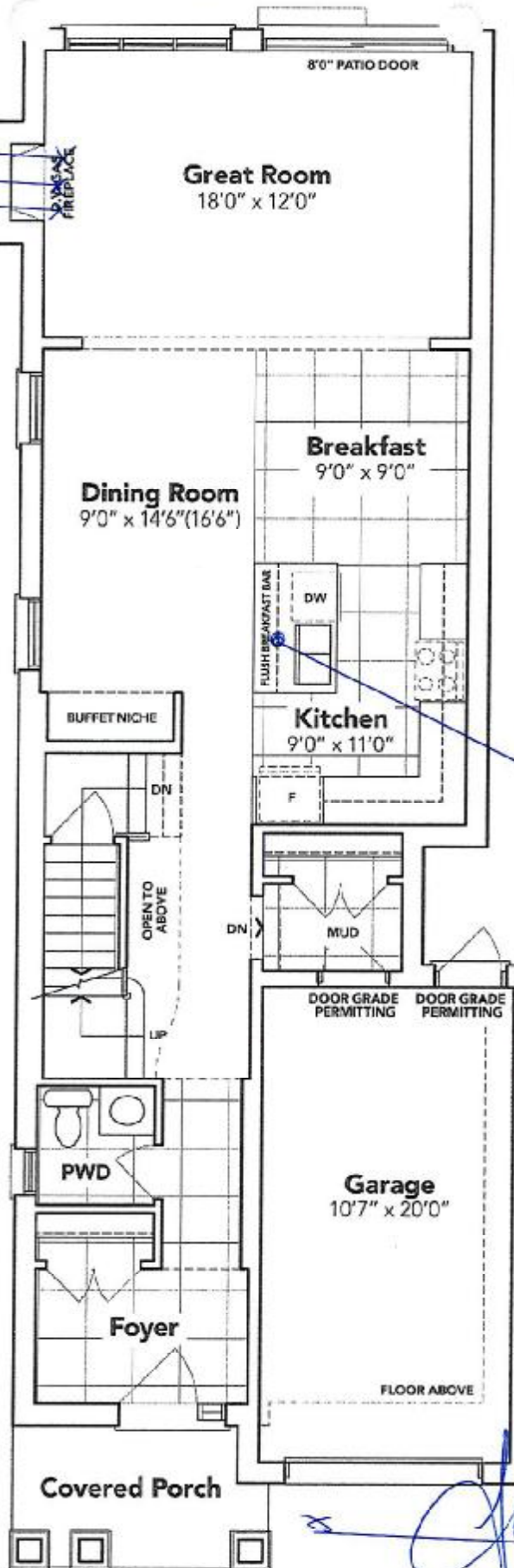

MAIN FLOOR EL. B1

The floor plans and elevations shown are pre-construction plans and may be revised or improved as necessitated by architectural controls and the construction process. The measurements adhere to the rules and regulations of the TARION Warranty Corporation's official method for the calculation of floor area. Materials, specifications and floor plans are subject to change without notice. All house renderings are artist's concept only. Actual usable floor space may vary from the stated floor area. All options shown are upgrades. E. & O. E.

FCR 17 2023

SB-LOT 195

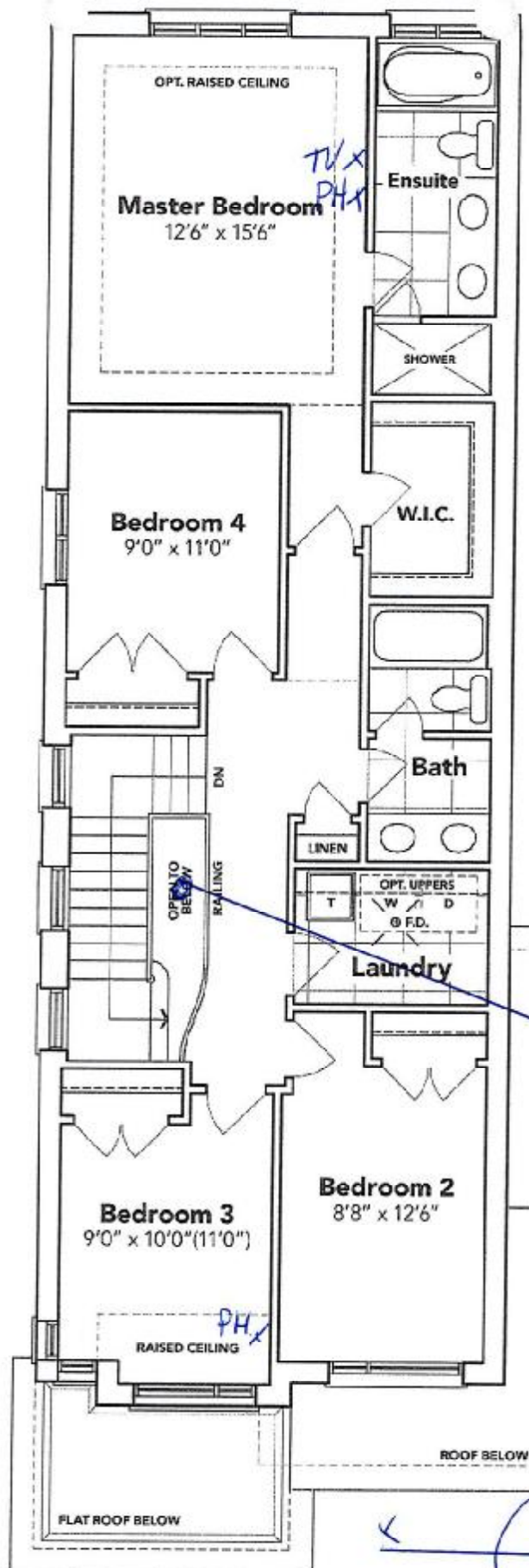

**LOT 195
BLOCK 153
THAMES PH. 5 B
SKETCH # 2**

*Subelected Slab.
Light*

SECOND FLOOR EL. B1

The floor plans and elevations shown are pre-construction plans and may be revised or improved as necessitated by architectural controls and the construction process. The measurements adhere to the rules and regulations of the TARION Warranty Corporation's official method for the calculation of floor area. Materials, specifications and floor plans are subject to change without notice. All house renderings are artist's concept only. Actual usable floor space may vary from the stated floor area. All options shown are upgrades. E. & O. E.

SCHEDULE "B-1"
Floor Plan

FEB 17 2023

5B-195
Townhouse No. 195 Block 153
Phase 5B
Model: William (2603) Elev B1 4 Bed - 2+1 Bath
End - Standard

LOT 195
BLOCK 153
THAMES PH. 5 B
SKETCH # 3

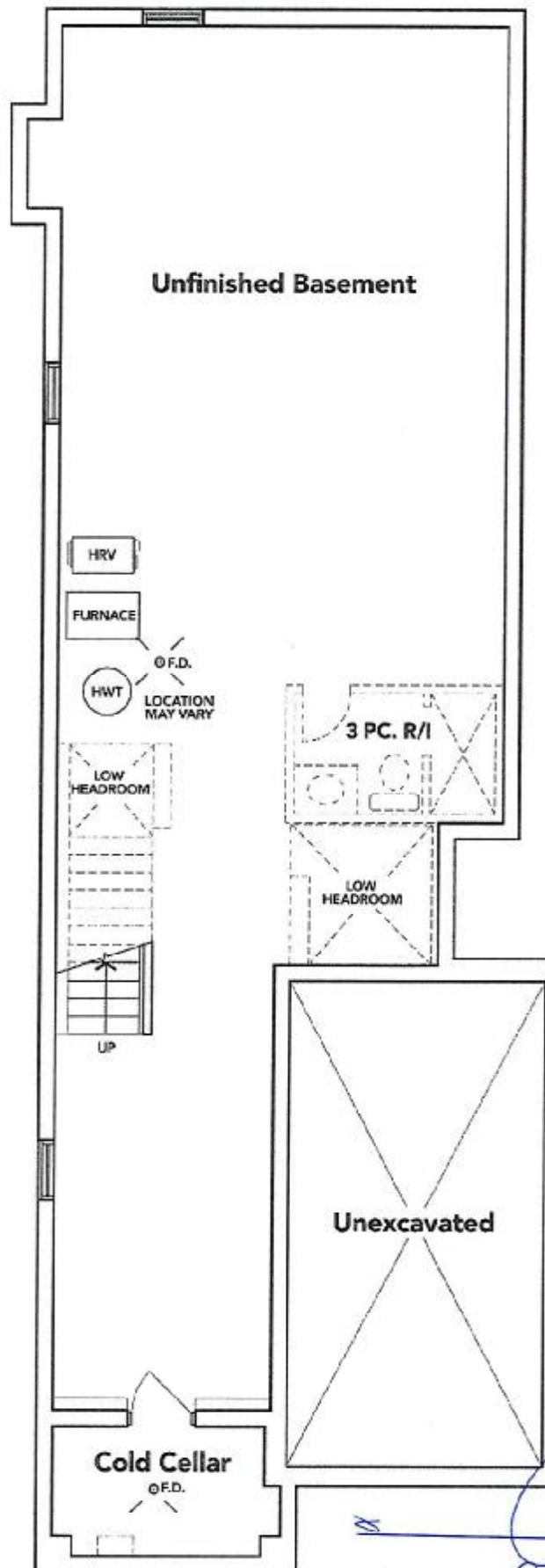

BASEMENT EL. B1

The floor plans and elevations shown are pre-construction plans and may be revised or improved as necessitated by architectural controls and the construction process. The measurements adhere to the rules and regulations of the TARIION Warranty Corporation's official method for the calculation of floor area. Materials, specifications and floor plans are subject to change without notice. All house renderings are artist's concept only. Actual usable floor space may vary from the stated floor area. All options shown are upgrades. E. & O. E.