

KINGSMEN (THAMES) INC. / Havelock Corners (Kingsmen)

Lot/Unit: 181 Block 150 Phase/Building: 5B Model/Floor Plan: Richard (2602) Elev B2 Opt
4 Bed - 2+1 Bath

ELECTRICAL

Inv.6098	1 - To supply & install the standard T.V. rough in in the great room and master bedroom... see sketch # 1 & # 2	
Line 77475	Note:	
6Mar23 / 6Mar23		
Inv.6098	1 - To supply & install the standard Phone (CAT5) rough in in the great room, master bedroom and Bedroom #4 ... see sketch # 1 & # 2	
Line 77476	Note:	
6Mar23 / 6Mar23		

HEATING AND AIR CONDITIONING

Inv.6098	1 - As per schedule "PE": Vendor to install capped gas line (Rough in only) at rear of home for future BBQ location. Location to be finalized at vendors sole discretion.	
Line 77473	Note:	
6Mar23 / 6Mar23		
Inv.6098	1 - As per schedule "PE": Vendor to supply & install air conditioning unit, sized accordingly, from vendors standard samples.	
Line 77474	Note:	
6Mar23 / 6Mar23		

EXTRAS AS PER OFFER

5 FREE APPLIANCES ? STAINLESS STEEL FRONT - FRIDGE: STOVE AND DISHWASHER. WHITE WASHER AND DRYER (SUPPLIED ONLY, NOT INSTALLED, FROM BUILDERS STANDARD LINE). AN APPLIANCES VOUCHER WILL BE GIVEN BY OUR DECOR CONSULTANT AT THE TIME OF BOOKING YOUR COLOUR A Worksheet Note:	
5 FREE APPLIANCES – STAINLESS STEEL FRONT - FRIDGE; STOVE AND DISHWASHER. WHITE WASHER AND DRYER (SUPPLIED ONLY, NOT INSTALLED, FROM BUILDERS STANDARD LINE). AN APPLIANCES VOUCHER WILL BE GIVEN BY OUR DECOR CONSULTANT AT THE TIME OF BOOKING YOUR COLOUR A Worksheet Note:	
VENDOR TO INSTALL CAPPED GAS LINE (ROUGH-IN ONLY) AT REAR OF HOME FOR FUTURE BBQ LOCATION. LOCATION TO BE FINALIZED AT VENDORS SOLE DISCRETION. Worksheet Note:	
VENDOR TO SUPPLY & INSTALL AIR CONDITIONING UNIT, SIZED ACCORDINGLY, FROM VENDORS STANDARD SAMPLES. Worksheet Note:	

MAR 06 2023

Purchaser: SHAMSHER SINGH SANDHA Property: 181 Block 150 of Plan - Draft Approval SB
Telephone Res. / Bus: / Project: KINGSMEN (THAMES) INC.
Decor Advisor: Barbara Coccia Model and Elevation: Richard (2602) Elev B2 Opt 4 Bed - 2+1 B
Layout Changes: ☐ Yes ☒ No Sketch Attached: ☒ Yes ☐ No Exterior Colour Scheme:

1. Cabinetry

	Style and Colour	Counter Top	Hardware
Kitchen / Breakfast	#3 Simcoe Orchid	#1 C/S # 3040 Cement 3cm.	# 135 Knob
Kitchen Island	#3 Simcoe Orchid	#1 C/S # 3040 Cement 3cm.	# 135 Knob
Laundry Room	/		
Powder Room	#3 Simcoe Orchid	4925K-07 Calcutta Marble	# 135 Knob
Main Bathroom	#3 Simcoe Orchid	4925K-07 Calcutta Marble	# 135 Knob
Master Ensuite Bathroom	#3 Simcoe Orchid	4925K-07 Calcutta Marble	# 135 Knob
Second Ensuite Bathroom (If Applicable)	/		
	/		
	/		

Appliances

Custom Size Fridge

☐ Yes ☒ No

Valance Lighting

☐ Yes ☒ No

Microwave / Range Hood

☐ Yes ☒ No

Cooktop / Rangetop

☐ Yes ☒ No

Built in Wall Oven

☐ Yes ☒ No

Slide-in Range

☐ Yes ☒ No

Comment

2. Flooring

	Selection
Foyer	13 x13" Malena Ice
Main Hall	13 x13" Malena Ice
Back Hall	/
Breakfast	(Dinette) 13 x13" Malena Ice
Laundry Room	13 x13" Malena Ice
Kitchen	13 x13" Malena Ice
Powder Room	13 x13" Malena Ice
Main Bathroom	13 x13" Malena Ice
Master Ensuite	13 x13" Malena Ice
Bathroom (If Applicable)	/
Mud Room	13 x13" Malena Ice
Master & Main bathroom	Shower floor: 2x2" Ontario Snow White Matte
Living Room	/
Dining Room	/
Family / Great Room	3 1/2" Elements Oak Natural
Den / Library / Study	/
Basement Landing (If Applies)	
Lower Landing (If Applicable)	3 1/2" Elements Oak Natural
Upper Landing	(If applicable) 3 1/2" Elements Oak Natural
Upper Hall	Modern Story 1, # 927 Morning Rain
Master Bedroom	Modern Story 1, # 927 Morning Rain
Bedroom #2	Modern Story 1, # 927 Morning Rain
Bedroom #3	Modern Story 1, # 927 Morning Rain
Bedroom #4	Modern Story 1, # 927 Morning Rain
Bedroom #5	/
Master & Main bathroom	Shower jamb: Anatolia Marmiline SNOW

SEE ATTACHED FOR SIGNATURES



MAR 06 2023

Purchaser: SHAMSHER SINGH SANDHA Property: 181 Block 150 of Plan - Draft Approval SB
Telephone Res. / Bus: / Project: KINGSMEN (THAMES) INC.
Decor Advisor: Barbara Coccia Model and Elevation: Richard (2602) Elev B2 Opt 4 Bed - 2+1 Ba
2. Flooring - Continued -

Upgrade Underpad	Type Standard	Area 2nd. Floor
Carpet on Stairs	Capped	Runner - *Upgrade
Comment	/	/

3. Plumbing Fixtures / Faucets



Kitchen	Standard	Second Ensuite	/	Powder Room	Standard
Master Ensuite	Standard			Other Room	/
Main Bathroom	Standard		/		

Comment
Still to install the standard top mount kitchen sink.

4. Wall Tile

	Tile Selection	Listello	Insert	Insert Selection
Main Bathroom	8x10" Malena Ice	<input type="checkbox"/>	<input type="checkbox"/>	
Master Ensuite				
Tub Deck	13x13 " Malena Ice	<input type="checkbox"/>	<input type="checkbox"/>	
Tub Apron	13x13 " Malena Ice	<input type="checkbox"/>	<input type="checkbox"/>	
Tub Surround	13x13 " Malena Ice	<input type="checkbox"/>		
Shower Stall	8x10" Malena Ice	<input type="checkbox"/>	<input type="checkbox"/>	
Second Ensuite	/	<input type="checkbox"/>	<input type="checkbox"/>	
	/	<input type="checkbox"/>	<input type="checkbox"/>	
	/	<input type="checkbox"/>	<input type="checkbox"/>	
Kitchen Backsplash	/	<input type="checkbox"/>	<input type="checkbox"/>	
Complete Backsplash	/	<input type="checkbox"/>	<input type="checkbox"/>	

Comment
Install the standard 8x10" wall tiles on the 10" side stacked horizontally in the bathrooms where applicable.

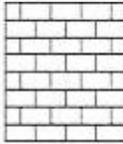
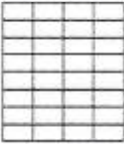

horizontal stacked

brick pattern

vertical stacked

diagonal diamond

5. Fireplace

	Living Room			Family Room			Other Room - Specify Great Room		
	Purchased	As Per Plan	N/A	Purchased	As Per Plan	N/A	Purchased	As Per Plan	N/A
Fireplace Type	<input type="radio"/>	<input type="radio"/>	<input checked="" type="radio"/>	<input type="radio"/>	<input type="radio"/>	<input checked="" type="radio"/>	<input type="radio"/>	<input checked="" type="radio"/>	<input type="radio"/>
Mantle Type							Front Facing		
Over Mantle							NF-08		
Colour / Stain							/		
Surround							White		
Hearth							/		
Comment	/								

SEE ATTACHED FOR SIGNATURES

Initial: 

MAR 06 2023

Purchaser: SHAMSHER SINGH SANDHA

Property: 181 Block 150 of Plan - Draft Approval SB

Telephone Res. / Bus: /

Project: KINGSMEN (THAMES) INC.

Decor Advisor: Barbara Coccia

Model and Elevation: Richard (2602) Elev B2 Opt 4 Bed - 2+1 Ba

6. Trim Carpentry

Door Hardware Standard Handle

Interior Trim Standard

Comment

/

Interior Doors

☐ 2 Panel Arch Top

☒ 2 Panel Square Top

☐ 6 Panel



Initial for Door Style

7. Railings and Pickets

Railing Package Standard Oak STRAIGHT picket package

Railing Colour Elements Natural

Picket Colour Elements Natural

Wood Stairs ☐ No ☒ Oak

Tread Colour Elements Natural

Comment

/

SEE ATTACHED FOR SIGNATURES

8. Plaster Mouldings and Medallions

Foyer /

Kitchen/Breakfast /

Main Hall /

Den/Library /

Living Room /

Lower Landing /

Dining Room /

Family Room /

Comment

/

9. Wall Paint

Kingsmen White

Smooth Ceilings

☐ First Floor

☐ First Floor incl. Second Floor Hall

☐ First and Second Floor

☒ Throughout

☐ Not Applicable

Trim Paint Kingsmen White

10. Additional Comments

/

11. Disclaimers and Notes

- Colours of all materials are as close as possible to builder's selection, but not necessarily identical due to variances in manufacturing.
- Any extras listed above are null and void unless accompanied by a separate invoice/amendment. Said invoice must be paid in full.
- The Purchaser acknowledges that after Interior Colour Selection form is signed and dated, no further changes will be permitted other than re-selection due to unavailability. Purchaser's Initials
- The Purchaser acknowledges reading and accepting the "Kingsmen Group Décor Centre Disclaimers" form. This document contains other miscellaneous disclaimers.

SEE ATTACHED FOR SIGNATURES

This Interior Colour Selection is final and approved by:

Purchaser:

Signature: SEE ATTACHED FOR SIGNATURES

Vendor:

KINGSMEN (THAMES) INC.

MAR 06 2023

5B-Lot 181

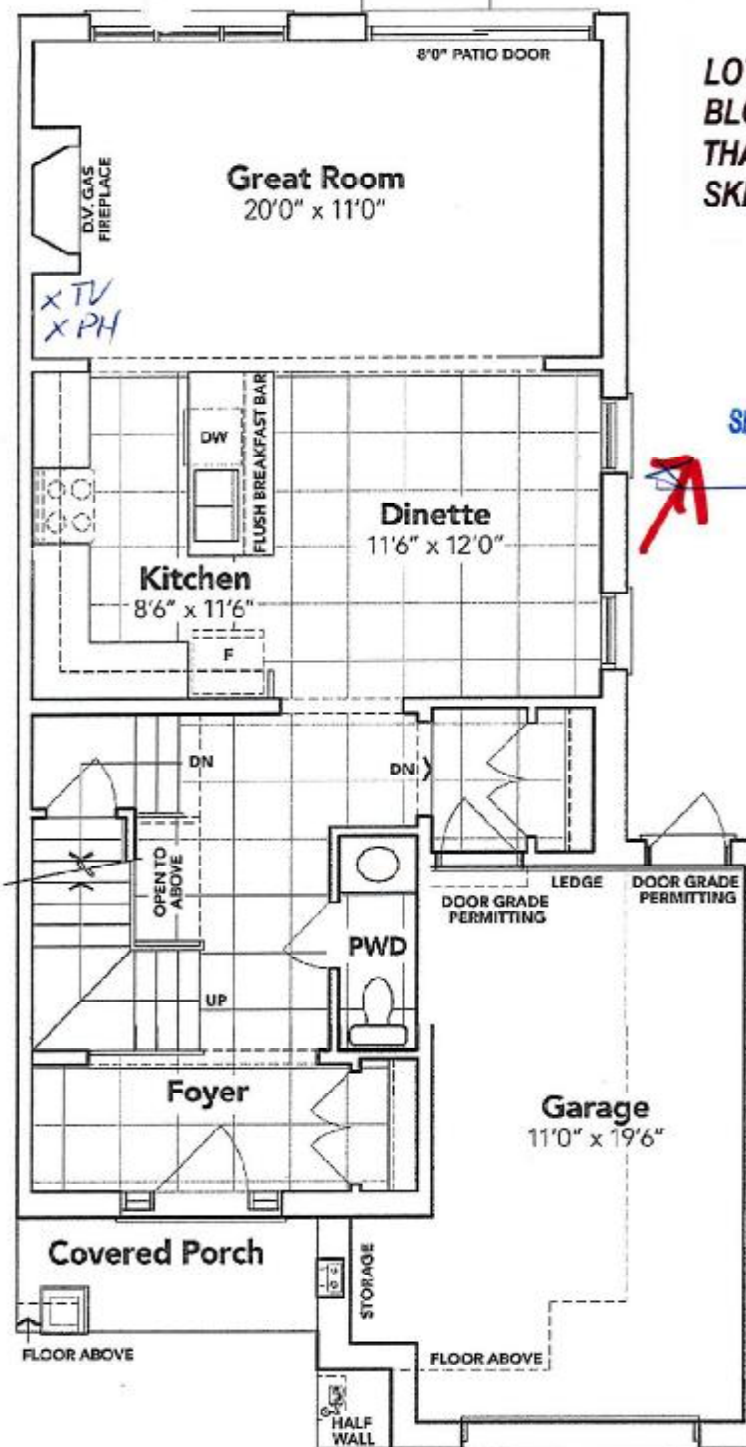

**LOT 181
BLOCK 150
THAMES PH. 5B
SKETCH # 1**

SEE ATTACHED FOR SIGNATURES

MAIN FLOOR EL. B2A

The floor plans and elevations shown are pre-construction plans and may be revised or improved as necessitated by architectural controls and the construction process. The measurements adhere to the rules and regulations of the TARION Warranty Corporation's official method for the calculation of floor area. Materials, specifications and floor plans are subject to change without notice. All house renderings are artist's concept only. Actual usable floor space may vary from the stated floor area. All options shown are upgrades. E. & O. E.



OPT. SECOND FLOOR EL. B2A

The floor plans and elevations shown are pre-construction plans and may be revised or improved as necessitated by architectural controls and the construction process. The measurements adhere to the rules and regulations of the TARION Warranty Corporation's official method for the calculation of floor area. Materials, specifications and floor plans are subject to change without notice. All house renderings are artist's concept only. Actual usable floor space may vary from the stated floor area. All options shown are upgrades. E. & O. E.

SCHEDULE "B-1"
Floor Plan

MAR 06 2003

5B-181
Townhouse No. 181 Block 150
Phase 5B
Model: Richard (2602) Elev B2 Opt 4 Bed - 2+1 Bath
Interior - Optional Plan

LOT 181
BLOCK 150
THAMES PH. 5B
SKETCH # 3

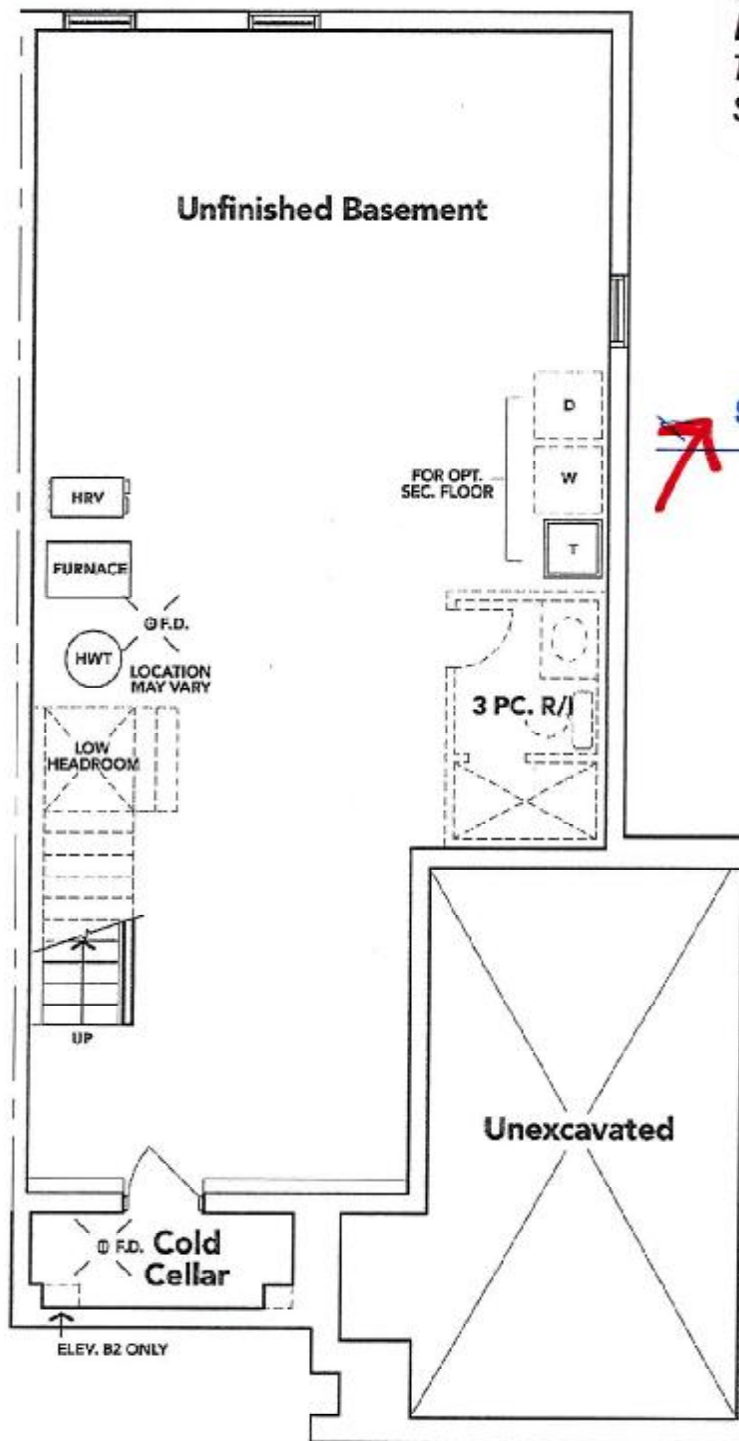

SEE ATTACHED FOR SIGNATURES

BASEMENT EL. B2A

The floor plans and elevations shown are pre-construction plans and may be revised or improved as necessitated by architectural controls and the construction process. The measurements adhere to the rules and regulations of the TARIION Warranty Corporation's official method for the calculation of floor area. Materials, specifications and floor plans are subject to change without notice. All house renderings are artist's concept only. Actual usable floor space may vary from the stated floor area. All options shown are upgrades. E. & O. E.