

KINGSMEN (THAMES) INC. / Havelock Corners (Kingsmen)

Lot/Unit: 208 Block 155    Phase/Building: 5B    Model/Floor Plan: William (2603) Elev B1 4  
Bed - 2+1 Bath

CABINETRY VANITY

Inv.6076	1 - To supply & install a VANITY BANK OF DRAWERS -in the master ensuite ... see sketch # 2	
Line 77373	Note:	
24Feb23 / 28Feb23		

ELECTRICAL

Inv.6076	1 - To supply & install the standard T.V. rough in in the great room and master bedroom... see sketch # 1 & # 2	
Line 77333	Note: Install the standard T.V. rough in at approx. 66" + - up from the floor centered + - to the F/P mantle in the great room	
24Feb23 / 28Feb23		
Inv.6076	1 - To supply & install the standard Phone ( CAT5 ) rough in in the great room, master bedroom and Bedroom #3 ... see sketch # 1 & # 2	
Line 77334	Note: Install the standard Phone (CAT 5) rough in at approx. 66" + - up from the floor centered + - to the F/P mantle in the great room.	
24Feb23 / 28Feb23		
Inv.6076	1 - To SUPPLY AND INSTALL AN ADDITIONAL BASIC RECEPTACLE (NOT DEDICATED) at approx. 66" + - up from the floor centered + - to the F/P mantle	
Line 77372	Note: in the great room...see sketch # 1	
24Feb23 / 28Feb23		
This is for a futue wall mount T.V. NO CONDUIT PIPE HAS BEEN PURCHASED.		

HARDWOOD

Inv.6076	1 - To supply & install the 3 1/2" Elements stained engineered hardwood floor to the main floor and stair landing(s) where applicable in lieu of the standard 3 1/2" Elements Natural engineered hardwood floor... see colour chart for details.	
Line 77374	Note:	
24Feb23 / 28Feb23		

HEATING AND AIR CONDITIONING

Inv.6076	1 - As per schedule "PE": Vendor to install capped gas line ( Rough in only ) at rear of home for future BBQ location. Location to be finalized at vendors sole discretion.	
Line 77331	Note:	
24Feb23 / 28Feb23		
Inv.6076	1 - As per schedule "PE": Vendor to supply & install air conditioning unit, sized accordingly, from vendors standard samples.	
Line 77332	Note:	
24Feb23 / 28Feb23		

PAINT AND DRYWALL

Inv.6076	1 - To supply & intall the PAINT EXTRAS - STAIN RAILINGS WITH IRON PICKETS (INCLUDING STAIRS) ... see colour chart for details.	
Line 77376	Note:	
24Feb23 / 28Feb23		

RAILING



CONSTRUCTION SUMMARY

KINGSMEN (THAMES) INC. / Havelock Corners (Kingsmen)

Lot/Unit: 208 Block 155    Phase/Building: 5B    Model/Floor Plan: William (2603) Elev B1 4  
Bed - 2+1 Bath

Inv.6076	1 - To supply & install the RAILING - UPGRADE 1 - METAL HANDRAIL 3 INCH OVAL IN OAK - PICKETS STEEL ½ INCH SQUARE, PLAIN, WITH SHOES IN FLAT BLACK - POSTS 3½ INCH SQUARE, WITH CAP OAK IN OAK in lieu of the standard pickets and rails.	
Line 77375	Note:	
24Feb23 / 28Feb23		

EXTRAS AS PER OFFER

5 FREE APPLIANCES ? STAINLESS STEEL FRONT - FRIDGE: STOVE AND DISHWASHER. WHITE WASHER AND DRYER (SUPPLIED ONLY, NOT INSTALLED, FROM BUILDERS STANDARD LINE). AN APPLIANCES VOUCHER WILL BE GIVEN BY OUR DECOR CONSULTANT AT THE TIME OF BOOKING YOUR COLOUR A <i>Worksheet</i> Note:	
5 FREE APPLIANCES – STAINLESS STEEL FRONT - FRIDGE; STOVE AND DISHWASHER. WHITE WASHER AND DRYER (SUPPLIED ONLY, NOT INSTALLED, FROM BUILDERS STANDARD LINE). AN APPLIANCES VOUCHER WILL BE GIVEN BY OUR DECOR CONSULTANT AT THE TIME OF BOOKING YOUR COLOUR A <i>Worksheet</i> Note:	
VENDOR TO INSTALL CAPPED GAS LINE (ROUGH-IN ONLY) AT REAR OF HOME FOR FUTURE BBQ LOCATION.    LOCATION TO BE FINALIZED AT VENDORS SOLE DISCRETION. <i>Worksheet</i> Note:	
VENDOR TO SUPPLY & INSTALL AIR CONDITIONING UNIT, SIZED ACCORDINGLY, FROM VENDORS STANDARD SAMPLES. <i>Worksheet</i> Note:	

MAR 03 2023

**Purchasers:** RAVINDERJIT BASRA, & HARPREET KAUR SA **Property:** 208 Block 155 of Plan - Draft Approval SB  
**Telephone Res. / Bus:** (416) 845-6232 / (416) 710-1500 **Project:** KINGSMEN (THAMES) INC.  
**Decor Advisor:** Barbara Coccia **Model and Elevation:** William (2603) Elev B1 4 Bed - 2+1 Bath  
**Layout Changes:** ☐ Yes ☒ No **Sketch Attached:** ☒ Yes ☐ No **Exterior Colour Scheme:** \_\_\_\_\_

### 1. Cabinetry

	Style and Colour	Counter Top	Hardware
Kitchen / Breakfast	#3 Muskoka Moonlight	#1, C/S # 9141 Ice Snow 3cm.	# 12881 Handle
Kitchen Island	#3 Muskoka Moonlight	#1, C/S # 9141 Ice Snow 3cm.	# 12881 Handle
Laundry Room	/		
Powder Room	#3 Muskoka Navy Blue	# 4925K-07 Calcutta Marble	# 12881 Handle
Main Bathroom	#3 Charleston 3DL Rain Cloud	# 4926K-07 Black Alicante	# 9661 Handle
Master Ensuite Bathroom	#3 Trinity LPL Free Spirit L580K	# 4971K-52 Bronzite	# 9671 Handle
Second Ensuite Bathroom (If Applicable)	/		
	/		
	/		

**Appliances** **Custom Size Fridge** ☐ Yes ☒ No **Valance Lighting** ☐ Yes ☒ No **Microwave / Range Hood** ☐ Yes ☒ No  
**Cooktop / Rangetop** ☐ Yes ☒ No **Built in Wall Oven** ☐ Yes ☒ No **Slide-in Range** ☐ Yes ☒ No  
**Comment** \_\_\_\_\_

### 2. Flooring

	Selection
Foyer	13 x13" Keaton Ice
Main Hall	**3 1/2" Elements Oak Wolfhound
Back Hall	/
Breakfast	13 x13" Keaton Ice
Laundry Room	13 x13" Malena Carbon
Kitchen	13 x13" Keaton Ice
Powder Room	( & small hallway infront of powder room ) 13 x13" Keaton Ice
Main Bathroom	13 x13" Malena Carbon
Master Ensuite	13 x13" Keaton Carbon
Bathroom (If Applicable)	/
Mud Room	13 x13" Keaton Ice
Master ens. shower floor	2x2" Ontario Snow White Matte
Living Room	/
Dining Room	**3 1/2" Elements Oak Wolfhound
Family / Great Room	**3 1/2" Elements Oak Wolfhound
Den / Library / Study	/
Basement Landing (If Applies)	
Lower Landing (If Applicable)	**3 1/2" Elements Oak Wolfhound
Upper Landing	( if applicable ) **3 1/2" Elements Oak Wolfhound
Upper Hall	Modern Story 1, # 927 Rain Cloud
Master Bedroom	Modern Story 1, # 927 Rain Cloud
Bedroom #2	Modern Story 1, # 927 Rain Cloud
Bedroom #3	Modern Story 1, # 927 Rain Cloud
Bedroom #4	Modern Story 1, # 927 Rain Cloud
Bedroom #5	/
Master ens. shower jamb:	Anatolia Marmiline SNOW

Flooring Continued on Page 2

Initial: \_\_\_\_\_



Page 1 of 3

**Purchasers:** RAVINDERJIT BASRA, & HARPREET KAUR SA **Property:** 208 Block 155 of Plan - Draft Approval SB  
**Telephone Res. / Bus:** (416) 845-6232 / (416) 710-1500 **Project:** KINGSMEN (THAMES) INC.  
**Decor Advisor:** Barbara Coccia **Model and Elevation:** William (2603) Elev B1 4 Bed - 2+1 Bath  
 2. Flooring - Continued -

Upgrade Underpad	Type	Area
	Standard	2nd. Floor
Carpet on Stairs	Capped	Runner - *Upgrade
Comment	/	/

### 3. Plumbing Fixtures / Faucets

Kitchen	Standard	Second Ensuite	/	Powder Room	Standard
Master Ensuite	Standard			Other Room	/
Main Bathroom	Standard		/		

#### Comment

Still to install the standard kitchen top mount sink.

### 4. Wall Tile

	Tile Selection	Listello	Insert	Insert Selection
Main Bathroom	8x10" Malena Ice	<input type="checkbox"/>	<input type="checkbox"/>	
Master Ensuite				
Tub Deck	13x 13" Keaton Carbon	<input type="checkbox"/>	<input type="checkbox"/>	
Tub Apron	13x 13" Keaton Carbon	<input type="checkbox"/>	<input type="checkbox"/>	
Tub Surround	13x 13" Keaton Carbon	<input type="checkbox"/>	<input type="checkbox"/>	
Shower Stall	8x10" Keaton Ice	<input type="checkbox"/>	<input type="checkbox"/>	
Second Ensuite	/	<input type="checkbox"/>	<input type="checkbox"/>	
	/	<input type="checkbox"/>	<input type="checkbox"/>	
	/	<input type="checkbox"/>	<input type="checkbox"/>	
Kitchen Backsplash	/	<input type="checkbox"/>	<input type="checkbox"/>	
Complete Backsplash	/	<input type="checkbox"/>	<input type="checkbox"/>	
Comment				



horizontal stacked

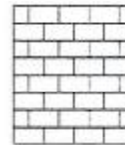

brick pattern



vertical stacked



diagonal/diamond

### 5. Fireplace

	Living Room			Family Room			Other Room - Specify Great room		
	Purchased	As Per Plan	N/A	Purchased	As Per Plan	N/A	Purchased	As Per Plan	N/A
Fireplace Type	<input type="radio"/>	<input type="radio"/>	<input checked="" type="radio"/>	<input type="radio"/>	<input type="radio"/>	<input checked="" type="radio"/>	<input type="radio"/>	<input checked="" type="radio"/>	<input type="radio"/>
Mantle Type									
Over Mantle									
Colour / Stain									
Surround									
Hearth									
Comment									

AS RB BL

Initial:

Page 2 of 3



MAR 03 2023

**Purchasers:** RAVINDERJIT BASRA, & HARPREET, KAUR SA **Property:** 208 Block 155 of Plan - Draft Approval SB  
**Telephone Res. / Bus:** (416) 845-6232 / (416) 710-1500 **Project:** KINGSMEN (THAMES) INC.  
**Decor Advisor:** Barbara Coccia **Model and Elevation:** William (2603) Elev B1 4 Bed - 2+1 Bath

### 6. Trim Carpentry

Door Hardware Standard Handle

Interior Trim Standard

Comment

/

#### Interior Doors

☐ 2 Panel Arch Top

☒ 2 Panel Square Top

☐ 6 Panel

Initial for Door Style

HS  
BS

### 7. Railings and Pickets

Railing Package \*\*Upg. #1 Metal Picket package

Railing Colour \*\*Elements Wolfhound

Picket Colour \*\*BLACK

Wood Stairs ☐ No ☒ Oak

Tread Colour \*\*Elements Wolfhound

Comment

/

### 8. Plaster Mouldings and Medallions

Foyer

/

Kitchen/Breakfast

/

Main Hall

/

Den/Library

/

Living Room

/

Lower Landing

/

Dining Room

/

Family Room

/

Comment

/

### 9. Wall Paint

Kingsmen White

#### Smooth Ceilings

☐ First Floor

☐ First Floor incl. Second Floor Hall

☐ First and Second Floor

☒ Throughout

☐ Not Applicable

Trim Paint Kingsmen White

### 10. Additional Comments

/

### 11. Disclaimers and Notes

- Colours of all materials are as close as possible to builder's selection, but not necessarily identical due to variances in manufacturing.
- Any extras listed above are null and void unless accompanied by a separate invoice/amendment. Said invoice must be paid in full.
- The Purchaser acknowledges that after Interior Colour Selection form is signed and dated, no further changes will be permitted other than re-selection due to unavailability. HS BS Purchaser's Initials
- The Purchaser acknowledges reading and accepting the "Kingsmen Group Decor Centre Disclaimers" form. This document contains other miscellaneous disclaimers.

This Interior Colour Selection is final and approved by:

Purchaser:

Signature: Harpreet Kaur Saini Date: Feb 28, 2023

Signature: Ravinderjit Basra Date: Feb 28, 2023 Vendor:

KINGSMEN (THAMES) INC.

SCHEDULE "B-1"  
Floor Plan

MAR 03 2023

SB-208  
Townhouse No. 208 Block 155  
Phase 5B  
Model: William (2603) Elev B1 4 Bed - 2+1 Bath  
End - Standard

Sketch #1

all 3 items @  
66" up from  
floor.



← Hyperlane Curve  
← Landmark Series  
= Chapel

MAIN FLOOR EL. B1

The floor plans and elevations shown are pre-construction plans and may be revised or improved as necessitated by architectural controls and the construction process. The measurements adhere to the rules and regulations of the TARION Warranty Corporation's official method for the calculation of floor area. Materials, specifications and floor plans are subject to change without notice. All house renderings are artist's concept only. Actual usable floor space may vary from the stated floor area. All options shown are upgrades. E. & O. E.

SCHEDULE "B-1"  
Floor Plan

MAR 03 2023

5B-208  
Townhouse No. 208 Block 155  
Phase 5B  
Model: William (2603) Elev B1 4 Bed - 2+1 Bath  
End - Standard

Sketch #2

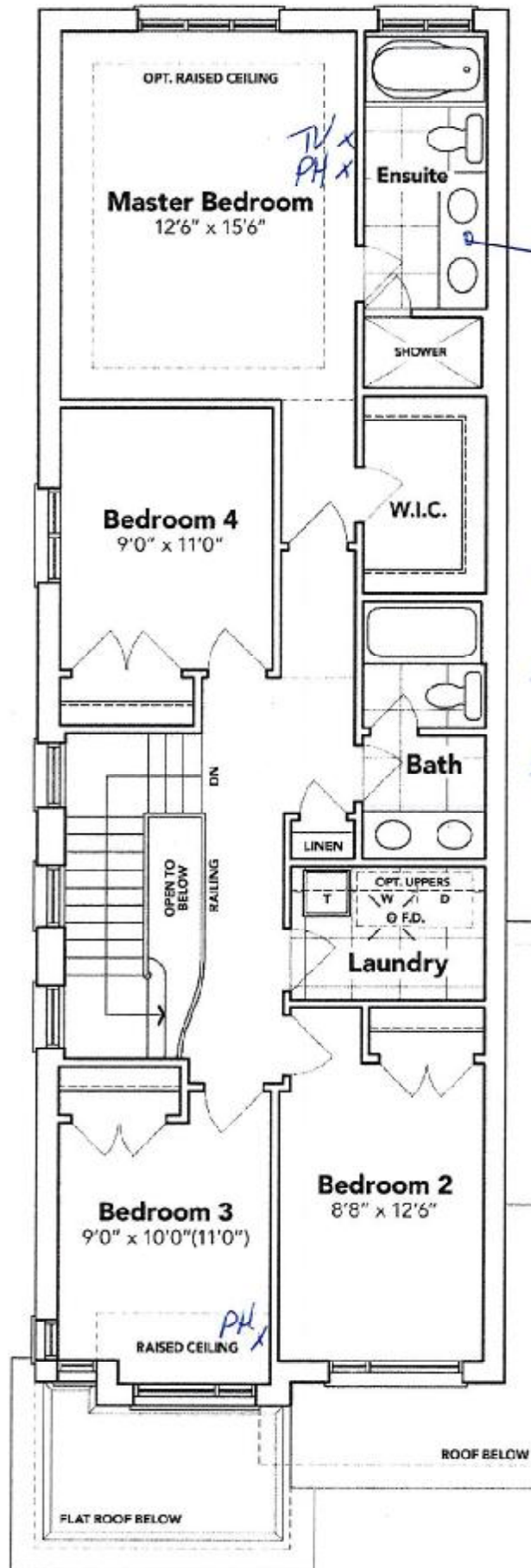

back of Drawers.

< Impact Kam Sain  
< Lavender Room  
< Shower

SECOND FLOOR EL. B1

The floor plans and elevations shown are pre-construction plans and may be revised or improved as necessitated by architectural controls and the construction process. The measurements adhere to the rules and regulations of the TARIION Warranty Corporation's official method for the calculation of floor area. Materials, specifications and floor plans are subject to change without notice. All house renderings are artist's concept only. Actual usable floor space may vary from the stated floor area. All options shown are upgrades, E. & O. E.



**SCHEDULE "B-1"**  
Floor Plan

MAR 03 2023

Townhouse No. 208 Block 155  
Phase 5B  
Model: William (2603) Elev B1 4 Bed - 2+1 Bath  
End - Standard

SB-208

Sketch #3

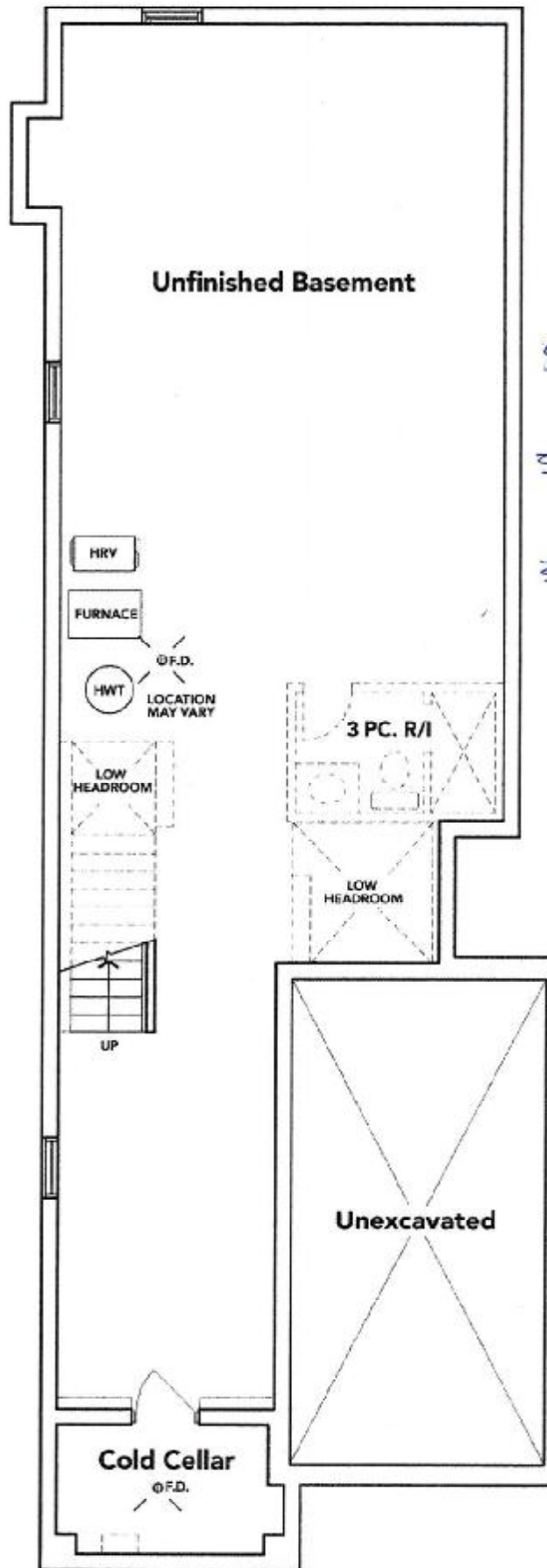

Harpreet Kaur Saini  
Saini Design Group  
Architect

**BASEMENT EL. B1**

The floor plans and elevations shown are pre-construction plans and may be revised or improved as necessitated by architectural controls and the construction process. The measurements adhere to the rules and regulations of the TARION Warranty Corporation's official method for the calculation of floor area. Materials, specifications and floor plans are subject to change without notice. All house renderings are artist's concept only. Actual usable floor space may vary from the stated floor area. All options shown are upgrades. E. & O. E.

KS BL